

550500

Number..... 42

.....Chippewa.....National Forest

CORNER... $\frac{1}{4}$ to secs. 11 and 14.....T. 147....., R. 27 W., 5th. P. Mer.

CORNER DESCRIPTION AND MARKINGS No. corner

WITNESSES Norway stub 7' high, 16" diameter bearing N 20 E
Metal location poster is on BT .

GENERAL LOCATION In little patch of jack pine, open stuff, BT 20 feet N of very old drag road.
(Relation to other corners by alignment and measurement, also with topographic features, roads, streams, trails, fence corners or other distinctive objects which will enable others to locate. mention blazing done if any).

C. B. Stott, Forest Ranger
.....
Forest.....Chippewa.....
Date Found...7/21/27.....

550500

Form 874-9—Revised May, 1918

U. S. DEPARTMENT OF AGRICULTURE
FOREST SERVICE

Minn

NATIONAL FOREST

CORNERS OF THE PUBLIC SURVEY

T. 147N R. 27W 5 Mer.

1/4 Corner common to Sections
11, and 14

Corner consists of a — (not) in place
State condition —

Dimensions above ground — inches.
Sketch grooves, letters, figures, or notches, on proper face or edge.

CARDINAL POSITION

DIAGONAL POSITION

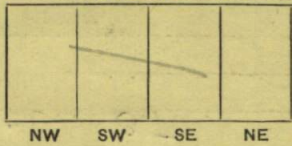
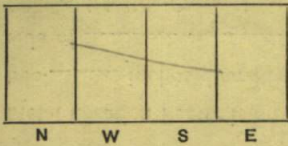

Mound of — is located —

Pits are located —

Sketch markings of Bearing Trees (or Rocks) in proper box and fill blanks below, giving bearings from Corner to Trees and Distances in Links.

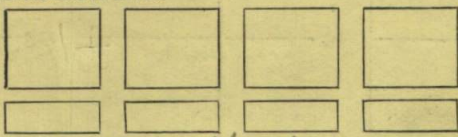

Species Not stub 7' high

Diameter 16"

Bearing N 20 E

Distance 70 L

Do you believe this to be a genuine Land Office Corner? Yes

If not, why? —

[Signature]

Signature

7-21-22

Date

Title

T. 147 N R. 27 W 5 Mer.

8-3027

(Make sketch of topography near Corner.)

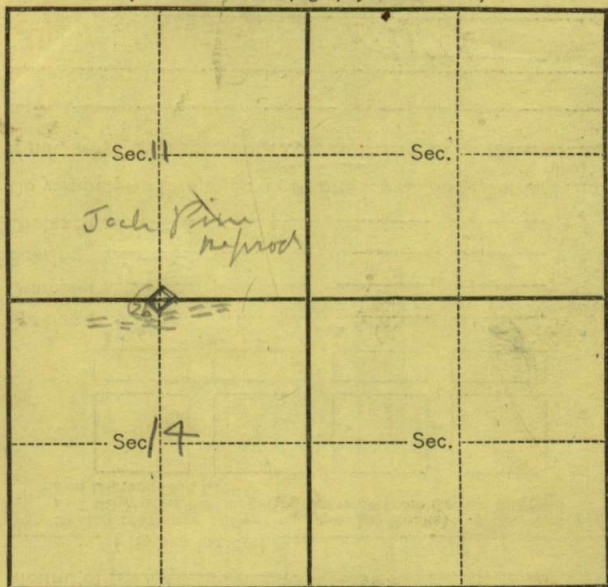

Metal Location Poster is on a the B.T
tree _____ inches diameter, on the _____
side of _____
from which this Corner bears _____
_____ chains distant.

Give any further facts which will aid in finding this
Corner again.

In little patch of
Jock Pine open stuff
B.T 20 feet N. of very
old drag road