

600400

67

Minnesota National Forest
Township Range Meridian

Corner See Corner

Corner Description See 13-14-23 and 24-T144-27 ✓

Corner Markings Two poplar cor. 5 feet high.

Witnesses Two witnesses - small poplar set around cor

General Location on high land surrounded by poplar.

(Relation to other corners by alignment and measurement, also with topographic features, roads, streams, trails, fence corners or other distinctive objects which will enable others to locate. Mention blazing done if any.)

JAN 9 1924

Melville Cummings
Forest East Forest Ranger
Sgt
3-28
1/25
H.H.

101007

RECEIVED BY THE OFFICE OF THE SECRETARY OF THE ARMY
ON 10/10/54 AT 10:10 AM
FOR THE OFFICE OF THE SECRETARY OF THE ARMY
WASHINGTON, D.C.

GENERAL INVESTIGATION

MEMORANDUM

INDEXED & FILED

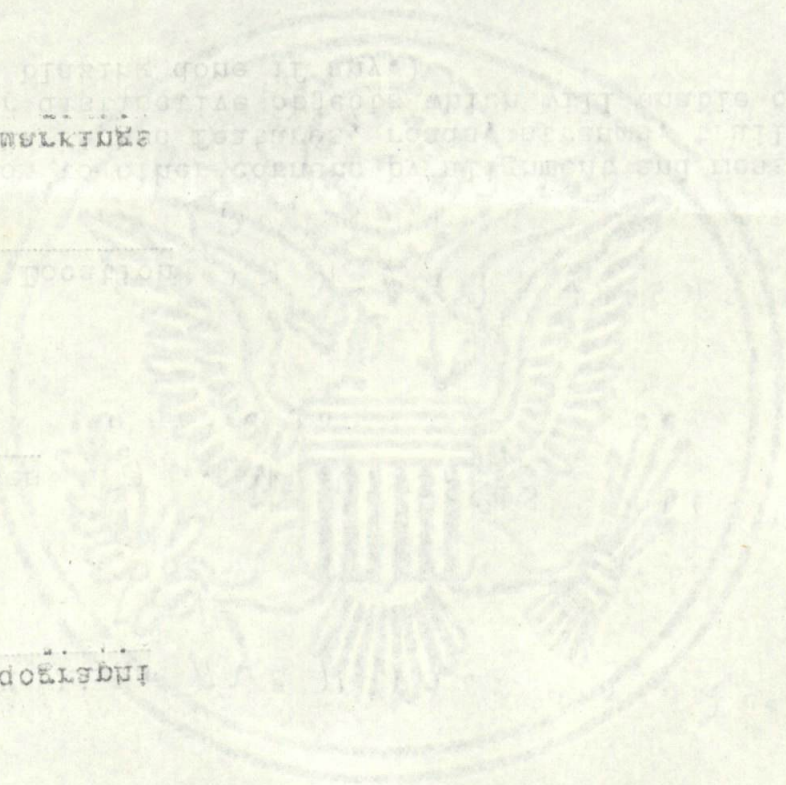

OFFICE OF THE SECRETARY OF THE ARMY

CRANE & COMPANY

MEMORANDUM

BOND No 29

DATE

INITIALS

U. S. DEPARTMENT OF AGRICULTURE
FOREST SERVICE

Quinn NATIONAL FOREST

CORNERS OF THE PUBLIC SURVEY

T. 144N R. 27W 5 Mer.

Sec Corner common to Sections
13, 14, 23, and 24

DESCRIPTION OF CORNER

Corner consists of a 4" stake

Dimension above ground leaning inches.

Sketch grooves, letters, figures, or notches, on proper face or edge.

CARDINAL POSITION

DIAGONAL POSITION

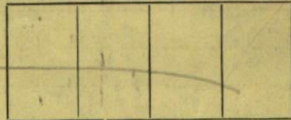
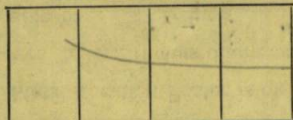

N W S E

NW SW SE NE

Mound of _____ is located _____

Pits are located _____

Sketch markings of Bearing Trees (or Rocks) in proper box and fill blanks below, giving bearings from Corner to Trees and Distances in Links.

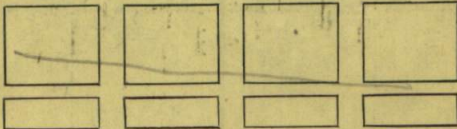

Species _____

Diameter _____

Bearing _____

Distance _____

Do you believe this to be a genuine Land Office Corner? _____

If not, why? Do not know

D. Kishman

CRS stat

Signature.

Dec 5, 1927

Date.

Title.

T. 144^N R. 27^W 5 Mer.

8-3027

(Make sketch of topography near Corner.)

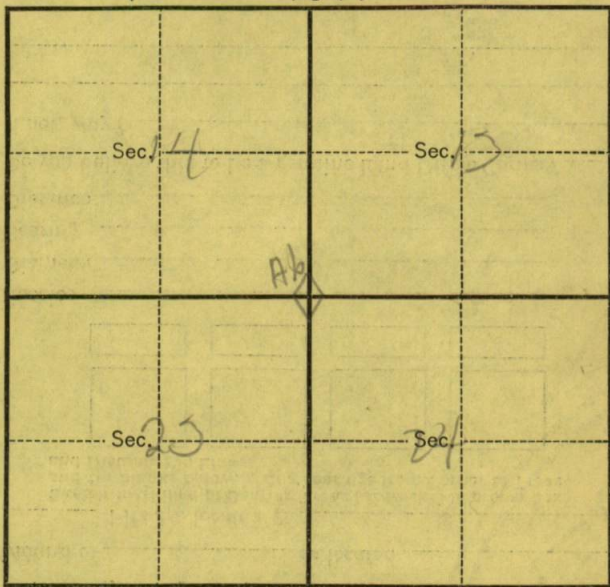

Metal Location Poster is on a W Birch
tree 8 inches diameter, on the W
side of N+S line
from which this Corner bears N 87 W
about 30 L chains distant.

Give any further facts which will aid in finding this
Corner again.

In popple knotana
one other clippert
about 15 L marked N 104 E