

Minnesota National Forest
Township Range Meridian

Corner 16-17-20-21 144 27 5th

Corner Description

3" soft maple stake new

Corner Markings

Witnesses

Birch 12" S 46 N 12 feet scribed T 144 N R 27 W S 20 B.T.

Poplar Stake 5 feet High N 50 N scribed B.T.

no other trees in evidence

General Location

(Relation to other corners by alignment and measurement, also with topographic features, roads, streams, trails, fence corners or other distinctive objects which will enable others to locate. Mention blazing done if any.)

JAN 9 1924

J.A. Soney
Forest Ranger

5th
3-28
checked
1/25
#H

U. S. DEPARTMENT OF AGRICULTURE
FOREST SERVICE

NATIONAL FOREST

CORNERS OF THE PUBLIC SURVEY

T. 144 R. 27W Mer. 6

Section Corner common to Sections

16, 17, 20, and 21

DESCRIPTION OF CORNER

Corner consists of a wooden stake

Dimension above ground 4" x 4" inches.

Sketch grooves, letters, figures, or notches, on proper face or edge.

CARDINAL POSITION

DIAGONAL POSITION

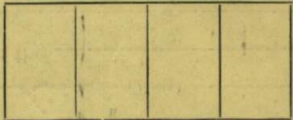
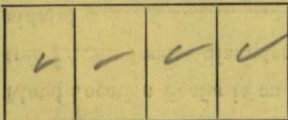

N W S E

NW SW SE NE

Mound of _____ is located _____

Pits are located _____

Sketch markings of Bearing Trees (or Rocks) in proper box and fill blanks below, giving bearings from Corner to Trees and Distances in Links.

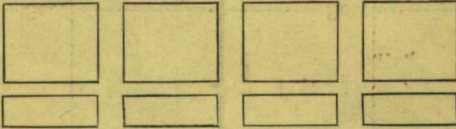

Species _____

Diameter No bearing trees

Bearing _____

Distance _____

Do you believe this to be a genuine Land Office Corner? yes

If not, why? _____

P.O.T.

Signature.

12-8-27

Date.

Title.

T. 144 R. 27 5 Mer.

8-3027

(Make sketch of topography near Corner.)

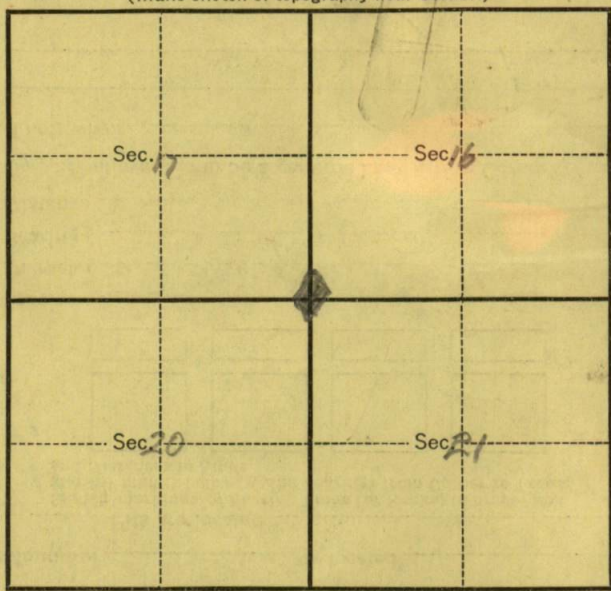

Metal Location Poster is on a Bunch
tree 12 inches diameter, on the _____
side of _____
from which this Corner bears N. 21 Links
_____ chains distant.

Give any further facts which will aid in finding this
Corner again.

