

**LEGEND**

○ = Corner having information on form 7100-52 in this file.

T147N R27W 5th PM

**FILING INSTRUCTION**

(Ref. FSM 7150)

File 7100-52 card record by letter and number coordinates behind the file guide for the township in which it falls.

File the 7100-52 card record by letter and then by number i.e., all A cards first, then B cards etc.

The first card behind the file guide (if data have been obtained and recorded) will be card A-1 for N.W. Township Corner, then card A-2 for 1/16 corner then card A-3 for 1/4 corner etc.

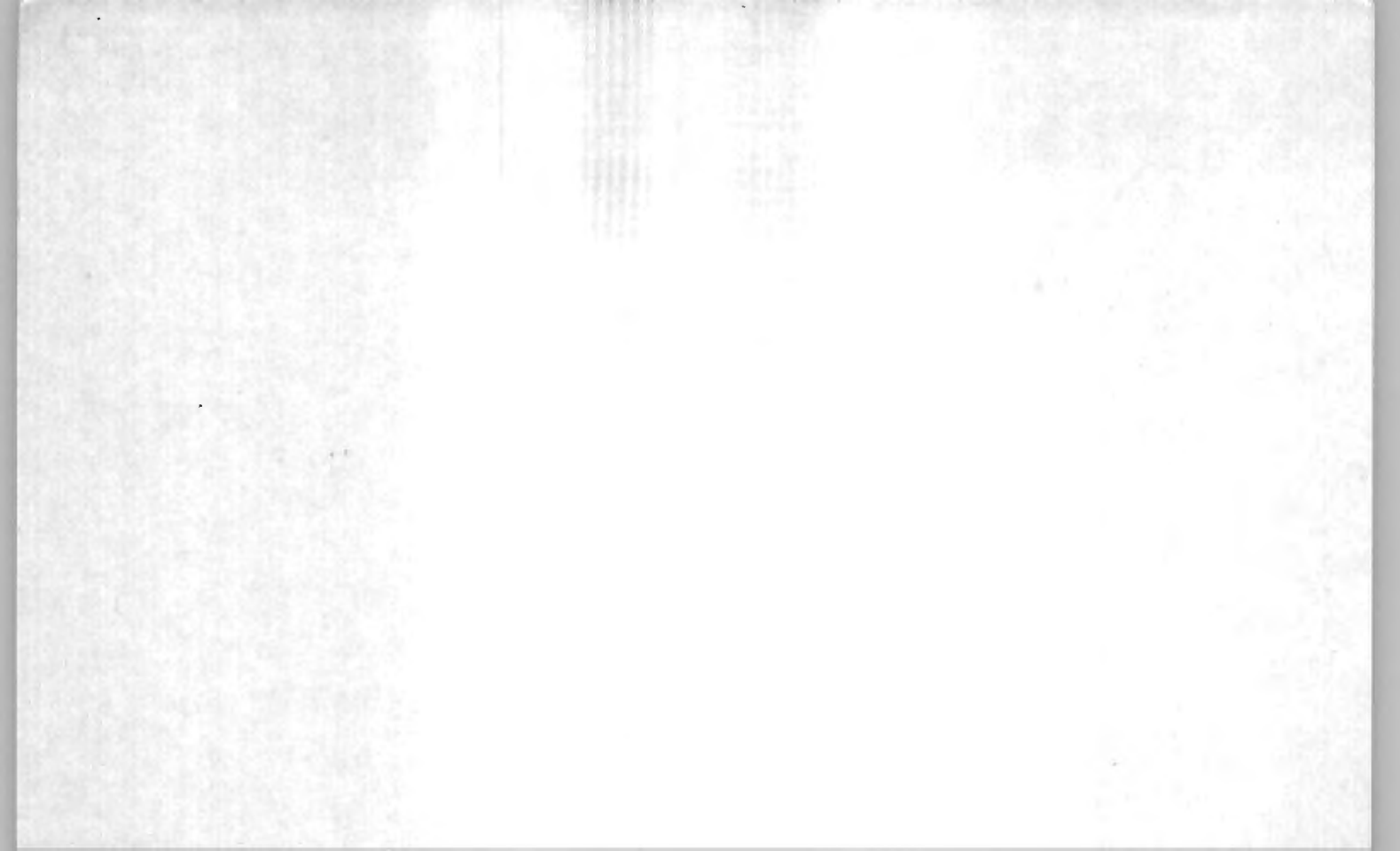

Index No. A-1  
(Alphabetical - Numerical)

148-27  
BOOK 1  
Pg. 32

LAND CORNER RECORD  
(RECTANGULAR SURVEYS)

R9-7160-4 (Rev. 6/13/67)  
 GPO 802-127

T. 147 R. 27 S. 5 Mer. N.F. CHIPPEWA County ITASCA State MN.  
TOWNSHIP COR. Corner common to sections 1, 6, 31 and 36

EXISTING SURVEYS

Original Government Survey

Year surveyed 1875 B.C. BALDWIN-RESURVEY  
 Original monument WOOD POST  
(Wood post, stone, pile of stones, pipe, etc.)

Bearing Trees

Species	<u>W. PINE</u>	<u>N. PINE</u>	<u>N. PINE</u>	<u>ASPEN</u>
Diameter	<u>24</u>	<u>12</u>	<u>18</u>	<u>4</u>
Bearing	<u>N72E</u>	<u>N17W</u>	<u>S20W</u>	<u>S20E</u>
Distance	<u>20 LKS.</u> <u>13.20'</u>	<u>68 LKS.</u> <u>44.88'</u>	<u>75 LKS.</u> <u>49.50'</u>	<u>55 LKS.</u> <u>36.30'</u>

Subsequent Corner Restoration

Year surveyed 1936 By GLO RESURVEY  
 Where filed or recorded ON FILE AT S.P.  
 Monument 6" X 24" CONCRETE CYLINDER  
(6" diam., concrete post, 24" high, etc.)  
WITH BRASS CAP MARKED

MARKED NEW BT

Bearing Trees, Reference Objects

Species	<u>W. OAK</u>			
Diameter	<u>7</u>			
Bearing	<u>S35E</u>			
Distance	<u>79 LKS.</u> <u>52.14'</u>			

Original Evidence Found

Year of search 1936 By GLO  
 Monument found Ed. ORIG. B.T.S.

Original Bearing Trees Found

Species	<u>W. PINE</u>	<u>N. PINE</u>	<u>N. PINE</u>	<u>STR. HOLE</u>
Diameter	<u>48</u>	<u>22</u>	<u>20</u>	
Bearing	<u>N74E</u>	<u>S21W</u>	<u>N17W</u>	<u>S20E</u>
Distance	<u>13.86'</u>	<u>49.5'</u>	<u>44.2'</u>	<u>36.3'</u>

Evidence of Subsequent Corner Restoration Found

Year of search 9-20-94 By C.K.  
Ed. GLO CONCRETE CYLINDER - IN PLACE  
3" ABOVE GROUND - IN THICK BRUSH  
WITH OAK - ASPEN + SCATTERED PINE

SEE BACK

Bearing Trees, Reference Objects

Species				
Diameter				
Bearing				
Distance				

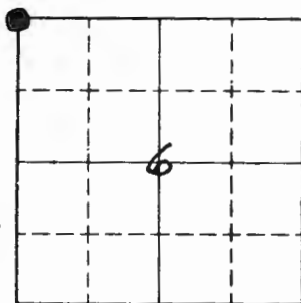

Sketch

○ Corner     F.S. Land

Relation of Evidence to Record Features Along Section Lines

Section line to sections \_\_\_\_\_  
 Object \_\_\_\_\_  
 Record distance \_\_\_\_\_  
 Measured distance \_\_\_\_\_

Other Evidence

Describe evidence of use and occupation such as roads, fences, clearings, timber cutting lines, plantations, etc.. Cite source of testimony if any. 9-20-94 CK

FD. 4 X 4 CEDAR POST ON SOUTH SIDE OF FR 2196 OR COUNTY ROAD #156 - POST WAS ABOUT 40' SOUTH OF ROAD MOVED POST NEARER TO ROAD - CORNER IS 430' SOUTH OF CEDAR POST

At time of search:

1. Did you have the record description?

Yes  No \_\_\_\_\_

THERE IS A 6" W. OAK - 2.5' N35W OF GLO 12" W. OAK  
 \* ORIG. W. PINE STUMP LARGE N74E - 13.86' STILL FAIRLY SOLID

2. How was search area located?

Pacing, chaining, photos, maps, etc. \_\_\_\_\_

Perpetuation Record

Monument and accessories established. Include brief description of area.

\* ORIG. N. PINE 27" N16W - 44.2' IN GOOD CONDITION  
 \* " N. PINE 31" S21W - 49.2' IN GOOD CONDITION  
GLO W. OAK 12" S35E - 52.10' TAGGED + PAINTED  
BOTH ORIG. PINE BT'S HAVE SCRIBE VISIBLE - TAGGED + PAINTED  
MARKED NEW BT 9-20-94

3. Man hours spent in search 1/2 hr.

W. OAK 10 N86E - 67.72' MKD S3/ BT.  
8' STEEL SIGN POST DUE SOUTH 3.6'

4. Do you think additional search might recover evidence? Yes \_\_\_\_\_ No \_\_\_\_\_

Certified corner restoration certificate prepared: Yes \_\_\_\_\_ No \_\_\_\_\_

Filed in county records at \_\_\_\_\_ Date \_\_\_\_\_ County Document No. \_\_\_\_\_

Identified on aerial photo No. \_\_\_\_\_ Which is filed at \_\_\_\_\_

5. Signature Curt Krause

Index No. A-3  
(Alphabetical - Numerical)148-27  
BOOK 1  
Pg. 31LAND CORNER RECORD  
(RECTANGULAR SURVEYS)R9-7150-4 (Rev. 6/13/67)  
GPO 802-127T. 147 R. 27 5 Mer. N.F. CHIPPEWA County ITASCA State MN.  
QUARTER BET. Corner common to sections 6 and 31

## EXISTING SURVEYS

## Original Government Survey

Year surveyed 1874 By P.H. CONGER  
Original monument WOOD POST  
(Wood post, stone, pile of stones, pipe, etc.)

## Bearing Trees

Species TAM. TAM.  
Diameter 6 6  
Bearing NISE S8W  
Distance 50 LKS. 20 LKS.

## Subsequent Corner Restoration

Year surveyed 1936 By GLO RESURVEY  
Where filed or recorded ON FILE AT S.O.  
Monument SET 2" X 3/8" IRON POST  
(Original, concrete post, iron rod, etc.)  
WITH BRASS CAP MARKED

## Bearing Trees, Reference Objects

Species TAM. TAM.  
Diameter 5 4  
Bearing N24 1/2 E S24 1/2 E  
Distance 38 LKS. 20 LKS.  
25.08' 13.20'

## Original Evidence Found

Year of search 1936 By \_\_\_\_\_  
Monument found NO ORIG. EVIDENCE  
SET AT PROPORTIONAL DISTANCE

## Original Bearing Trees Found

Species \_\_\_\_\_  
Diameter \_\_\_\_\_  
Bearing \_\_\_\_\_  
Distance \_\_\_\_\_

## Evidence of Subsequent Corner Restoration Found

Year of search 9-26-94 By C.K.  
FD. IRON + CAP - IN PLACE - LEANING IN TAM.  
SWAMP - STRAGTEN UP AND DROVE 6' STEEL  
POST NORTH + ALONG SIDE - CAP IS 10" ABOVE  
SWAMP - CORNER IS 75' SOUTH OF FR 2196  
OLD TAG ON 16 TAM. SOUTH SIDE OF ROADBearing Trees, Reference Objects OVER

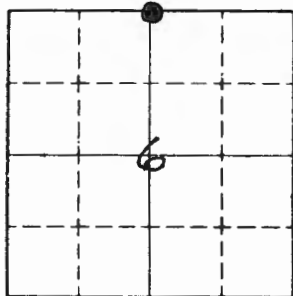

Sketch

○ Corner    ▨ F.S. Land

Relation of Evidence to Record Features Along Section Lines

Section line to sections \_\_\_\_\_  
 Object \_\_\_\_\_  
 Record distance \_\_\_\_\_  
 Measured distance \_\_\_\_\_

Other Evidence

Describe evidence of use and occupation such as roads, fences, clearings, timber cutting lines, plantations, etc.. Cite source of testimony if any. \_\_\_\_\_

THERE IS AN OLD DRAINAGE DITCH WHICH RUNS SE FROM SOUTH DITCH OF FR 2196 - ~~THE~~ DITCH IS 6' NORTH OF CORNER - WATER IN DITCH IS 2.5' DEEP CORNER IS 75' SOUTH OF FR 2196 OR COUNTY ROAD 156

At time of search:

1. Did you have the record description?

Yes  No \_\_\_\_\_

REMOVED 6' SIGN POST FROM 5' SOUTH OF COR. AND USE A TO STABILIZE MONUMENT IN WET TAM SWAMP

2. How was search area located?

Pacing, chaining, photos, maps, etc. \_\_\_\_\_

Perpetuation Record

Monument and accessories established. Include brief description of area. \_\_\_\_\_

GLO TAM. 11 S24E 13.2' - TAGGED & PAINTED  
 GLO TAM. SNAG 12 N24E 25.1'

3. Mon hours spent in search 1/2 HR.

MARKED NEW BT'S. 9-26-94  
 TAM. 6 S82W - 27.91' MKD 1/4 S6 BT  
 TAM. 12 N43W - 29.95' " 1/4 S31 BT  
 8' STEEL SIGN POSTS SOUTH 3.1 + WEST 2.8'

4. Do you think additional search might recover evidence? Yes \_\_\_\_\_ No \_\_\_\_\_

Certified corner restoration certificate prepared: Yes \_\_\_\_\_ No \_\_\_\_\_

Filed in county records of \_\_\_\_\_ Date \_\_\_\_\_ County Document No. \_\_\_\_\_

Identified on aerial photo No. \_\_\_\_\_ Which is filed at \_\_\_\_\_

5. Signature Curt Krause

Index No. A-11  
(Alphabetical - Numerical)

LAND CORNER RECORD  
(RECTANGULAR SURVEYS)

T. 147-148N R. 27W Mer. N.F. Chippewa County Itasca State Minnesota  
section Quarter Corner common to sections 33 h and

EXISTING SURVEYS

Original Government Survey	Original Evidence Found																
Year surveyed _____ Original monument _____ <small>(Wood post, stone, pile of stones, pipe, etc.)</small>	Year of search _____ By _____ Monument found _____																
<p style="text-align: center;">Bearing Trees</p> Species _____ Diameter _____ Bearing _____ Distance _____	<p style="text-align: center;">Original Bearing Trees Found</p> Species _____ Diameter _____ Bearing _____ Distance _____																
<p style="text-align: center;">Subsequent Corner Restoration</p>	<p style="text-align: center;">Evidence of Subsequent Corner Restoration Found</p>																
Year surveyed <u>1936</u> By <u>G.L.O.</u> Where filed or recorded _____ Monument <u>Iron post with brass</u> <small>(Original, concrete post, iron rod, etc.)</small> <u>cap stamped:</u>	Year of search <u>1968</u> By <u>R.H. McDonald</u> <u>Found the G.L.O brass cap marking</u> <u>corner.</u>																
<p style="text-align: center;">Bearing Trees, Reference Objects</p> <table border="0"> <tr> <td>Species <u>Birch</u></td> <td><u>Tamarack</u></td> </tr> <tr> <td>Diameter <u>4"</u></td> <td><u>10"</u></td> </tr> <tr> <td>Bearing <u>N28 3/4° E</u></td> <td><u>S14 1/2° W</u></td> </tr> <tr> <td>Distance <u>42 lks.</u></td> <td><u>160 lks.</u></td> </tr> </table>	Species <u>Birch</u>	<u>Tamarack</u>	Diameter <u>4"</u>	<u>10"</u>	Bearing <u>N28 3/4° E</u>	<u>S14 1/2° W</u>	Distance <u>42 lks.</u>	<u>160 lks.</u>	<table border="0"> <tr> <td><u>Birch</u></td> <td><u>Tamarack wind fall</u></td> </tr> <tr> <td><u>10"</u></td> <td><u>14"</u></td> </tr> <tr> <td><u>N31° E</u></td> <td><u>S16 1/2° W</u></td> </tr> <tr> <td><u>27.7'</u></td> <td><u>105.6'</u></td> </tr> </table>	<u>Birch</u>	<u>Tamarack wind fall</u>	<u>10"</u>	<u>14"</u>	<u>N31° E</u>	<u>S16 1/2° W</u>	<u>27.7'</u>	<u>105.6'</u>
Species <u>Birch</u>	<u>Tamarack</u>																
Diameter <u>4"</u>	<u>10"</u>																
Bearing <u>N28 3/4° E</u>	<u>S14 1/2° W</u>																
Distance <u>42 lks.</u>	<u>160 lks.</u>																
<u>Birch</u>	<u>Tamarack wind fall</u>																
<u>10"</u>	<u>14"</u>																
<u>N31° E</u>	<u>S16 1/2° W</u>																
<u>27.7'</u>	<u>105.6'</u>																

1/4 S 33  
 S 4  
 1936

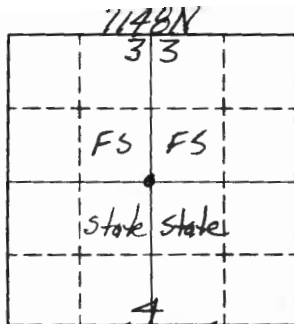

○ Corner  F.S. Land

Relation of Evidence to Record Features Along Section Lines

Section line to sections \_\_\_\_\_  
 Object \_\_\_\_\_  
 Record distance \_\_\_\_\_  
 Measured distance \_\_\_\_\_

Other Evidence

Describe evidence of use and occupation such as roads, fences, clearings, timber cutting lines, plantations, etc.. Cite source of testimony if any. MAEN-KRAUSE

FD GLO MONUMENT IN GOOD CONDITION 2" ABOVE GROUND ON THE NORTH EDGE OF A BEAVER POND. A 12" BALSAM SNAG W/ A STATE TAG IS ON THE EAST EDGE OF THE IRON. BIRCH BT IS NOW A 50FT SNAG W/ FSLP ATTACHED.

6' SIGN POST WEST 4.35'  
8' SIGN POST EAST 4.65'

LOCATION POSTER ON 10" R. LINE FROM WHICH CORNER BEARS WEST 460'  
TREE ON WEST SIDE OF HWY 66

At time of search:

1. Did you have the record description?

Yes  No \_\_\_\_\_

2. How was search area located?

Pacing, chaining, photos, maps, etc. \_\_\_\_\_

3. Man hours spent in search 2

4. Do you think additional search might recover evidence? Yes \_\_\_\_\_ No \_\_\_\_\_

Perpetuation Record

Monument and accessories established. Include brief description of area.

Set steel sign post 72" long with F.S. standard signs 54-2 & 54-7 attached set West 4.5 feet

Set 4"x4"x6' cedar post on north side of F.R. 2196 from which corner bears North 620 feet.  
4X4 POST IS GONE

Certified corner restoration certificate prepared: Yes \_\_\_\_\_ No \_\_\_\_\_

Filed in county records at \_\_\_\_\_ Date \_\_\_\_\_ County Document No. \_\_\_\_\_

Identified on aerial photo No. \_\_\_\_\_ Which is filed at \_\_\_\_\_

5. Signature Sam Donald



Index No. A-12  
(Alphabetical - Numerical)

LAND CORNER RECORD  
(RECTANGULAR SURVEYS)

R9-7150-4 (Rev. 6/13/67)  
GPO 802-127

T. 14748 R. 27 STH Mer. N.F. CHIPPENAW County ITASCA State MN  
EAST <sup>1/16</sup> Corner common to sections 4 33 and

EXISTING SURVEYS

Original Government Survey

Year surveyed 1938 HABERLE  
Original monument WOOD POST (APPROX)  
(wood post, stone, pile of stones, post, etc.)

Bearing Trees

Species \_\_\_\_\_  
Diameter \_\_\_\_\_  
Bearing \_\_\_\_\_  
Distance \_\_\_\_\_

Subsequent Corner Restoration

Year surveyed 1989 By R MAIN C/KRAUSE  
Where filed or recorded \_\_\_\_\_  
Monument FOUR SQUARED POST W/SCRIBE VISIBLE  
(Original, concrete post, iron rod, etc.)  
LYING DOWN. RESET A 3" SQ CEDAR POST  
@ THIS LOCATION.

Bearing Trees, Reference Objects

Species \_\_\_\_\_  
Diameter \_\_\_\_\_  
Bearing \_\_\_\_\_  
Distance \_\_\_\_\_

Original Evidence Found

Year of search \_\_\_\_\_ By \_\_\_\_\_  
Monument found \_\_\_\_\_

Original Bearing Trees Found

Species \_\_\_\_\_  
Diameter \_\_\_\_\_  
Bearing \_\_\_\_\_  
Distance \_\_\_\_\_

Evidence of Subsequent Corner Restoration Found

Year of search \_\_\_\_\_ By \_\_\_\_\_  
\_\_\_\_\_  
\_\_\_\_\_  
\_\_\_\_\_

Bearing Trees, Reference Objects

Species \_\_\_\_\_  
Diameter \_\_\_\_\_  
Bearing \_\_\_\_\_  
Distance \_\_\_\_\_

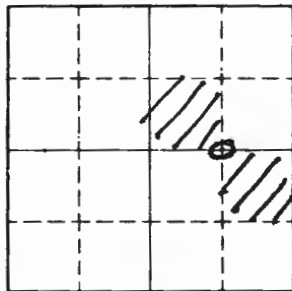

Sketch

○ Corner    ▨ F.S. Land

## Relation of Evidence to Record Features Along Section Lines

Section line to sections \_\_\_\_\_  
 Object \_\_\_\_\_  
 Record distance \_\_\_\_\_  
 Measured distance \_\_\_\_\_

## Other Evidence

Describe evidence of use and occupation such as roads, fences, clearings, timber cutting lines, plantations, etc.. Cite source of testimony if any. \_\_\_\_\_

At time of search:

1. Did you have the record description?

Yes \_\_\_\_\_ No \_\_\_\_\_

2. How was search area located?

Pacing, chaining, photos, maps,  
etc. \_\_\_\_\_

3. Mon hours spent in search \_\_\_\_\_

4. Do you think additional search might  
recover evidence? Yes \_\_\_\_\_ No \_\_\_\_\_

5. Signature \_\_\_\_\_

## Perpetuation Record

Monument and accessories established. Include brief description of area. \_\_\_\_\_

Ed A 12" CEDAR/W/ TWO LOCATION POSTERS. ONE  
 NOT READABLE. THE OTHER FROM 4/18/61 BY  
 BG WPA. WE PLACED LOCATION POSTER ON SAME  
 FROM WHICH CORNER BEARS S50W 4 FT.

Certified corner restoration certificate prepared: Yes \_\_\_\_\_ No \_\_\_\_\_

Filed in county records at \_\_\_\_\_ Date \_\_\_\_\_ County Document No. \_\_\_\_\_

Identified on aerial photo No. \_\_\_\_\_ Which is filed at \_\_\_\_\_

T. 147-148N R. 27W Mer. N.F. Chippewa County Itasca State Minnesota  
section Corner common to sections 33, 34, 3 and 4

EXISTING SURVEYS

Original Government Survey

Year surveyed \_\_\_\_\_  
 Original monument \_\_\_\_\_  
(Wood post, stone, pile of stones, pipe, etc.)  
 Bearing Trees  
 Species Nor. Pine (dead)  
 Diameter 26"  
 Bearing N53 1/2° E  
 Distance 21 lks.

Subsequent Corner Restoration

Year surveyed 1936 By G.L.O.  
 Where filed or recorded \_\_\_\_\_  
 Monument concrete mon. with brass cap stamped:  
(Original, concrete, post, iron rod, etc.)

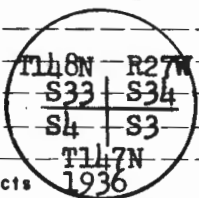

Bearing Trees, Reference Objects

Species	Nor. Pine	J. Pine	Nor. Pine	Cedar
Diameter	<u>8"</u>	<u>14"</u>	<u>6"</u>	<u>6"</u>
Bearing	<u>N37 1/2° E.</u>	<u>S53 3/4° E</u>	<u>S9 1/4° W</u>	<u>N34 3/4° W</u>
Distance	<u>50 lks.</u>	<u>48 lks.</u>	<u>80 lks.</u>	<u>23 lks.</u>

Original Evidence Found

Year of search 1970 By RHM  
 Monument found \_\_\_\_\_  
 Original Bearing Trees Found  
 Species dead Pine  
 Diameter 26"  
 Bearing N53 1/2° E  
 Distance 13.86'  
Scribe visible.

Evidence of Subsequent Corner Restoration Found

Year of search 1970 By RH McDonald  
Found the GLO Brass cap marking corner

Red Pine stp.	T. Pine	Red Pine stp.	Cedar
Diameter	<u>12"</u>	<u>12"</u>	<u>8"</u>
Bearing	<u>N37 1/2° E</u>	<u>S54° E</u>	<u>N34 3/4° W</u>
Distance	<u>33.0'</u>	<u>31.7'</u>	<u>15.2'</u>

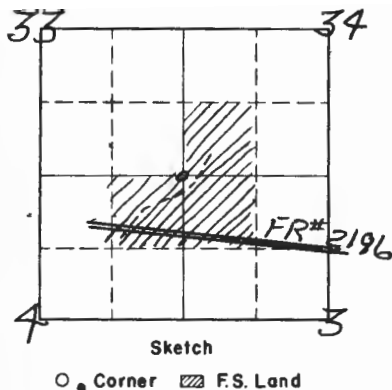

Relation of Evidence to Record Features Along Section Lines

Section line to sections \_\_\_\_\_  
 Object \_\_\_\_\_  
 Record distance \_\_\_\_\_  
 Measured distance \_\_\_\_\_

Other Evidence

Describe evidence of use and occupation such as roads, fences, clearings, timber cutting lines, plantations, etc.. Cite source of testimony if any. \_\_\_\_\_

At time of search:

1. Did you have the record description?

Yes  No \_\_\_\_\_

2. How was search area located?

Pacing, chaining, photos, maps,  
 etc. \_\_\_\_\_

3. Man hours spent in search 1

4. Do you think additional search might  
 recover evidence? Yes \_\_\_\_\_ No \_\_\_\_\_

5. Signature

*E. M. Donald*

Perpetuation Record

Monument and accessories established. Include brief description of area.

Set steel sign post 72" long with F.S. standard  
 signs 54-2 & 54-4 attached North 3.0"  
 placed BT tags on the Govt. BT's.

Certified corner restoration certificate prepared: Yes \_\_\_\_\_ No \_\_\_\_\_

Filed in county records at \_\_\_\_\_ Date \_\_\_\_\_ County Document No. \_\_\_\_\_

Identified on aerial photo No. \_\_\_\_\_ Which is filed at \_\_\_\_\_

Index No. Z-13 of 148-27  
(Alphabetical - Numerical)LAND CORNER RECORD  
(RECTANGULAR SURVEYS)R9-7150-4 (Rev. 6/13/67)  
GPO 802-127147-148 R. 27 5TH Mer. N.F. CHEPPEWA County ITASCA State MN  
SECTION Corner common to sections 3, 4, 35 and 34

## EXISTING SURVEYS

## Original Government Survey

Year surveyed 1989 MAIN-KRAUSE - GRAMAOriginal monument  
(Wood post, stone, pile of stones, pipe, etc.)

	Bearing Trees			
Species	<u>R. PINE</u>	<u>R. PINE</u>	<u>R. PINE</u>	<u>R. PINE</u>
Diameter	<u>20"</u>	<u>16"</u>	<u>17"</u>	<u>15"</u>
Bearing	<u>N18W</u>	<u>S72W</u>	<u>S85E</u>	<u>N35E</u>
Distance	<u>12.65'</u>	<u>48.91</u>	<u>20.44'</u>	<u>35.08'</u>

## Original Evidence Found

Year of search \_\_\_\_\_ By \_\_\_\_\_  
Monument found \_\_\_\_\_

## Original Bearing Trees Found

Species \_\_\_\_\_  
Diameter \_\_\_\_\_  
Bearing \_\_\_\_\_  
Distance \_\_\_\_\_

## Subsequent Corner Restoration

Year surveyed \_\_\_\_\_ By \_\_\_\_\_

Where filed or recorded \_\_\_\_\_

Monument  
(Original, concrete post, iron rod, etc.)

## Evidence of Subsequent Corner Restoration Found

Year of search \_\_\_\_\_ By \_\_\_\_\_

## Bearing Trees, Reference Objects

Species \_\_\_\_\_  
Diameter \_\_\_\_\_  
Bearing \_\_\_\_\_  
Distance \_\_\_\_\_

## Bearing Trees, Reference Objects

Species \_\_\_\_\_  
Diameter \_\_\_\_\_  
Bearing \_\_\_\_\_  
Distance \_\_\_\_\_

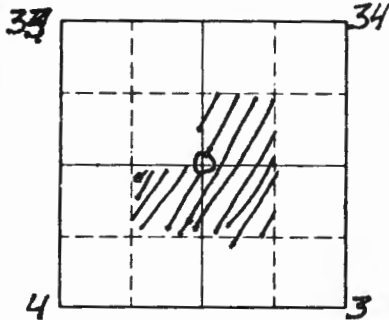

Sketch

○ Corner    ▨ F.S. Land

Relation of Evidence to Record Features Along Section Lines

Section line to sections \_\_\_\_\_  
 Object \_\_\_\_\_  
 Record distance \_\_\_\_\_  
 Measured distance \_\_\_\_\_

Other Evidence

Describe evidence of use and occupation such as roads, fences, clearings, timber cutting lines, plantations, etc.. Cite source of testimony if any. \_\_\_\_\_

At time of search:

1. Did you have the record description?

Yes \_\_\_\_\_ No \_\_\_\_\_

2. How was search area located?

Pacing, chaining, photos, maps, etc. \_\_\_\_\_

3. Man hours spent in search \_\_\_\_\_

4. Do you think additional search might recover evidence? Yes \_\_\_\_\_ No \_\_\_\_\_

5. Signature \_\_\_\_\_

Perpetuation Record

Monument and accessories established. Include brief description of area. \_\_\_\_\_

STEEL SIGN POST 3.27' NORTH 4.0' WEST

Certified corner restoration certificate prepared: Yes \_\_\_\_\_ No \_\_\_\_\_

Filed in county records at \_\_\_\_\_ Date \_\_\_\_\_ County Document No. \_\_\_\_\_

Identified on aerial photo No. \_\_\_\_\_ Which is filed at \_\_\_\_\_

Index No. A-17  
(Alphabetical - Numerical)

BOOK 1  
Pgs. 24470

LAND CORNER RECORD  
(RECTANGULAR SURVEYS)

R9-7150-4 (Rev. 6/13/67)  
GPO 802-127

T. 147 R. 27 S. Mer. N.F. CHIPPEWA County ITASCA State MN.  
SECTION Corner common to sections 2, 3, 34 and 35

EXISTING SURVEYS

Original Government Survey

Year surveyed 1874 By P.H. CONGER  
Original monument WOOD POST  
(Wood post, stone, pile of stones, pipe, etc.)

Bearing Trees

Species	J. PINE	J. PINE	N. PINE	J. PINE
Diameter	<u>6</u>	<u>6</u>	<u>6</u>	<u>7</u>
Bearing	<u>N14E</u>	<u>N42W</u>	<u>S41W</u>	<u>S35E</u>
Distance	<u>14 LKS.</u> <u>9.24'</u>	<u>37 LKS.</u> <u>24.42'</u>	<u>36 LKS.</u> <u>23.76'</u>	<u>50 LKS.</u> <u>33.0'</u>

Original Evidence Found

Year of search 1936 By GLO RESURVEY  
Monument found WOOD POST BY LOCAL SURVEYOR  
EVIDENCE OF 4 ORIG. BT'S.

Original Bearing Trees Found

Species	J. PINE	STP. HOLE	N. PINE	J. PINE
Diameter	<u>6</u>		<u>14</u>	<u>10</u>
Bearing	<u>N30E</u>	<u>S32E</u>	<u>S36W</u>	<u>N37 1/2 W</u>
Distance	<u>13 LKS.</u>	<u>48 LKS.</u>	<u>36 LKS.</u>	<u>35 LKS.</u>

SCRIBE

Subsequent Corner Restoration

Year surveyed 1936 By GLO RESURVEY  
Where filed or recorded \_\_\_\_\_  
Monument SET 6" X 24" CONCRETE CYLINDER  
(Original, concrete post, iron rod, etc.)  
WITH BRASS CAP MARKED

Bearing Trees, Reference Objects

Species	N. PINE	N. PINE	N. PINE
Diameter	<u>14</u>	<u>16</u>	<u>12</u>
Bearing	<u>N72 1/2 E</u>	<u>S13 3/4 E</u>	<u>N16 3/4 W</u>
Distance	<u>40 LKS.</u> <u>26.40'</u>	<u>57 LKS.</u> <u>37.62'</u>	<u>45 LKS.</u> <u>29.70'</u>

Evidence of Subsequent Corner Restoration Found

Year of search 9-8-94 By C.K  
Fd. CONCRETE CYLINDER - IN PLACE - 10' WEST  
OF FR. 3197 - ALL BT'S. ARE IN GOOD  
SHAPE - TAGGED + PAINTED - REMOVED 6'  
STEEL POST AND SET 8' STEEL SIGN POSTS  
NORTH 4.0' + EAST 4.0'

Bearing Trees, Reference Objects

\_\_\_\_\_  
\_\_\_\_\_  
\_\_\_\_\_

Relation of Evidence to Record Features Along Section Lines

Section line to sections \_\_\_\_\_  
 Object \_\_\_\_\_  
 Record distance \_\_\_\_\_  
 Measured distance \_\_\_\_\_

Other Evidence

Describe evidence of use and occupation such as roads, fences, clearings, timber cutting lines, plantations, etc.. Cite source of testimony if any. \_\_\_\_\_

~~FR 3197~~ FR 3197 IS 10' EAST OF CORNER - ROAD RUNS N45 - CORNER IS APPROX. .50 NORTH OF FR 2196

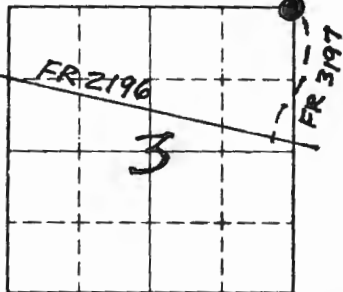

Sketch

○ Corner    ▨ F.S. Land

At time of search:

1. Did you have the record description?

Yes  No \_\_\_\_\_

2. How was search area located?

Pacing, chaining, photos, maps, etc. \_\_\_\_\_

3. Man hours spent in search 1/2 HR.

4. Do you think additional search might recover evidence? Yes \_\_\_\_\_ No \_\_\_\_\_

5. Signature Carl Kramer

Perpetuation Record

Monument and accessories established. Include brief description of area. \_\_\_\_\_

Certified corner restoration certificate prepared: Yes \_\_\_\_\_ No \_\_\_\_\_

Filed in county records at \_\_\_\_\_ Date \_\_\_\_\_ County Document No. \_\_\_\_\_

Identified on aerial photo No. \_\_\_\_\_ Which is filed at \_\_\_\_\_



Index No. A-19  
(Alphabetical - Numerical)

<sup>171-21</sup>  
 BOOK 1  
 Pg. 10

LAND CORNER RECORD  
(RECTANGULAR SURVEYS)

R9-7150-4 (Rev. 6/13/67)  
 GPO 802-127

T. 147 R. 27 S. Mer. N.F. CHIPPEWA County ITASCA State MIN.  
QUARTER BET. Corner common to sections 2 and 35

EXISTING SURVEYS

Original Government Survey  
 Year surveyed 1874 By P.H. CONGER  
 Original monument WOOD POST  
(Wood post, stone, pile of stones, pipe, etc.)  
 Bearing Trees BIRCH  
 Species POPLAR ~~\_\_\_\_\_~~  
 Diameter 8 6  
 Bearing N6W S6E  
 Distance 30 Lks. 35 Lks.

Original Evidence Found  
 Year of search 1936 By GLO RESURVEY  
 Monument found \_\_\_\_\_  
PROPORTIONAL DISTANCE  
 Original Bearing Trees Found  
 Species \_\_\_\_\_  
 Diameter \_\_\_\_\_  
 Bearing \_\_\_\_\_  
 Distance \_\_\_\_\_

Subsequent Corner Restoration  
 Year surveyed 1936 By GLO RESURVEY  
 Where filed or recorded \_\_\_\_\_  
 Monument SET 2" X 36" IRON POST WITH BRASS  
(Original, concrete post, iron rod, etc.)  
CAP MARKED  
 $\frac{1}{4} \frac{535}{52}$   
1936

Evidence of Subsequent Corner Restoration Found  
 Year of search 8-24-94 By RM YCK  
Fd. ITASCA COUNTY IRON PIPE W/ CAP - FLUSH  
WITH GROUND IN DOWN SLOPE OF CO. RD. 34  
(MAX ROAD) - 18' WEST OF Q. OF COUNTY 34  
AND 15' SOUTH OF DRIVEWAY WEST OFF COUNTY  
ROAD

Bearing Trees, Reference Objects  
 Species W. PINE J. PINE  
 Diameter 16 8  
 Bearing N20 1/4 E S55 1/4 W  
 Distance 173 Lks. 51 Lks.  
114.18' 33.66'

1936 ~~1975~~ Bearing Trees, Reference Objects OVER  
 Species W. PINE OAK  
 Diameter 33" 13.5"  
 Bearing N20 E S57 E  
 Distance 114.2' 63.70'

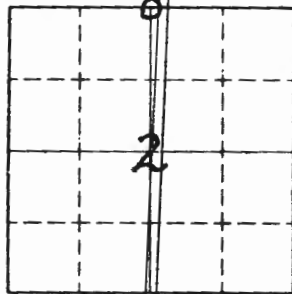

Sketch

○ Corner    ▨ F.S. Land

Relation of Evidence to Record Features Along Section Lines

Section line to sections \_\_\_\_\_  
 Object \_\_\_\_\_  
 Record distance \_\_\_\_\_  
 Measured distance \_\_\_\_\_

Other Evidence

Describe evidence of use and occupation such as roads, fences, clearings, timber cutting lines, plantations, etc.. Cite source of testimony if any. \_\_\_\_\_

*IN SHOULDER OF COUNTY ROAD 34 - FLUSH WITH GROUND - 15' SOUTH OF DRIVEWAY TO WEST 18' WEST OF CENTER LINE OF COUNTY ROAD 34 DIDN'T REMOVE COUNTY IRON - GLO IRON MAY BELOW COUNTY IRON AS NOTES BY R. McDONALD 1970 STATED IRON WAS FOUND 2' BELOW GROUND*

At time of search:

1. Did you have the record description?

Yes  No \_\_\_\_\_

2. How was search area located?

Pacing, chaining, photos, maps, etc. \_\_\_\_\_

3. Man hours spent in search \_\_\_\_\_

4. Do you think additional search might recover evidence? Yes \_\_\_\_\_ No \_\_\_\_\_

5. Signature *Curt Krause*

Perpetuation Record

Monument and accessories established. Include brief description of area. \_\_\_\_\_

*ITASCA COUNTY BT's, Ed. 8-24-94  
 N. PINE 13 NS0W - 44.10' TAGGED & PAINTED  
 N. PINE 11 S20W - 36.37' " "  
 W. OAK TWIN 6 S66E - 55.55' " "  
 4x4 CEDAR POST IN PLACE - WEST 15.5'*

*GLO W. PINE HAS DEAD TOP - MAY NOT STAND VERY LONG*

Certified corner restoration certificate prepared: Yes \_\_\_\_\_ No \_\_\_\_\_

Filed in county records at \_\_\_\_\_ Date \_\_\_\_\_ County Document No. \_\_\_\_\_

Identified on aerial photo No. \_\_\_\_\_ Which is filed at \_\_\_\_\_

Index No. C-5  
(Alphabetical - Numerical)

LAND CORNER RECORD  
(RECTANGULAR SURVEYS)

FY80

R9-7150-4 (Rev. 6/13/67)  
GPO 502-127

T. 147 N. R. 27  
1/4

5<sup>th</sup> Mer. N.F. Chippewa County Itasca  
Corner common to sections 5 6

State Minnesota

EXISTING SURVEYS

Original Government Survey

Year surveyed \_\_\_\_\_  
Original monument \_\_\_\_\_  
(Wood post, stone, pile of stones, pipe, etc.)

Bearing Trees

Species \_\_\_\_\_  
Diameter \_\_\_\_\_  
Bearing \_\_\_\_\_  
Distance \_\_\_\_\_

Subsequent Corner Restoration

Year surveyed 1936 By G.L.O.  
Where filed or recorded \_\_\_\_\_  
Monument Iron 3' x 1" w/ Brass Cap.  
(Original, concrete post, iron rod, etc.)

Bearing Trees, Reference Objects

Species J. Pine Nor Pine  
Diameter 7" 10"  
Bearing N56E S35W  
Distance 36.43 33.43  
23.76 21.78

Original Evidence Found

Year of search \_\_\_\_\_ By \_\_\_\_\_  
Monument found \_\_\_\_\_

Original Bearing Trees Found

Species \_\_\_\_\_  
Diameter \_\_\_\_\_  
Bearing \_\_\_\_\_  
Distance \_\_\_\_\_

Evidence of Subsequent Corner Restoration Found

Year of search 1980 By W. Olesen  
Pipe was sheered off by bearing cat  
base of pipe still in place.

Bearing Trees, Reference Objects

Nor Pine Rotten J Pine  
14" Skump  
S35W N52E  
21.78' 23.76  
Scar Scribe Visible  
445513+

C-5

Relation of Evidence to Record Features Along Section Lines

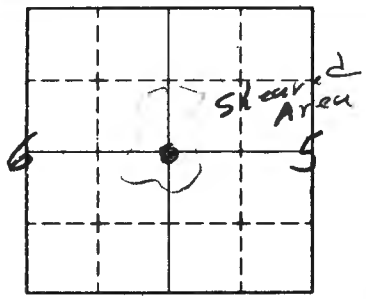

Sketch

○ Corner    ▨ F.S. Land

Section line to sections	_____	_____	_____	_____
Object	_____	_____	_____	_____
Record distance	_____	_____	_____	_____
Measured distance	_____	_____	_____	_____

Other Evidence

Describe evidence of use and occupation such as roads, fences, clearings, timber cutting lines, plantations, etc.. Cite source of testimony if any.

*This corner sets in the middle of a large Sheared Area.*

At time of search:

1. Did you have the record description?

Yes \_\_\_\_\_ No \_\_\_\_\_

2. How was search area located?

Pacing, chaining, photos, maps, etc.

3. Man hours spent in search \_\_\_\_\_

4. Do you think additional search might recover evidence? Yes \_\_\_\_\_

5. Signature \_\_\_\_\_

Perpetuation Record

Monument and accessories established. Include brief description of area.

*replaced sheared off G.L.O. Monument with a 2" x 5" Pin with brass cap. marked. Set a 8' long steel post North 1.8' with a Alignment 5-111*

*No other trees in this Area*

*5/19/80 Road Dam*

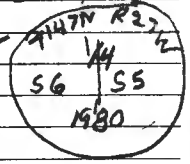

Certified corner restoration certificate prepared: Yes \_\_\_\_\_

Filed in records at *Stearns* Date *6/4/83* County Document No. *358196*

Identified aerial photo No. \_\_\_\_\_ Which is filed at \_\_\_\_\_

**CERTIFICATE FILED**

Index No. C-9  
(Alphabetical - Numerical)

LAND CORNER RECORD  
(RECTANGULAR SURVEYS)

R9-7150-4 (Rev. 6/13/67)  
GPO 802-127

T. 147 R. 27 5TH Mer. N.F. CHIPPEWA County ITASCA State MN  
QUARTER Corner common to sections 4 5 and \_\_\_\_\_

EXISTING SURVEYS

Original Government Survey

Year surveyed 1873 P.H. CONGER  
Original monument Wood Post  
(Wood post, stone, pile of stones, pipe, etc.)

Bearing Trees

Species J PINE J PINE  
Diameter 6 12  
Bearing N70W S60E  
Distance 40 lks 109 lks

Subsequent Corner Restoration

Year surveyed 1940 By HABERLE  
Where filed or recorded 874-9  
Monument IRON PIPE (GLO) FD GLO  
BTS  
(Original, concrete post, iron rod, etc.)

Bearing Trees, Reference Objects

Species \_\_\_\_\_  
Diameter \_\_\_\_\_  
Bearing \_\_\_\_\_  
Distance \_\_\_\_\_

Original Evidence Found

Year of search 1936 By GLO  
Monument found NONE  
SET 1"X3' I.P. WITH BRASS CAP

NEW Original Bearing Trees Found

Species SPRUCE SPRUCE  
Diameter 5" 4"  
Bearing S63 1/4 E S10 3/4 W  
Distance 24 lks 37 lks  
15.8' 24.4'

Evidence of Subsequent Corner Restoration Found

Year of search 1989 By R. MAIN C. KRAUSE  
FD IRON PIPE IN PLACE. FD ONE.  
BT STUMP /W/ SCRIBE VISIBLE.

Bearing Trees, Reference Objects

TAMARACK BLACK SPRUCE BLACK SPRUCE SEGN POST  
5" 5" 6"  
N35W S38E S79W EAST  
41.20 34' 40.48' 2.0'

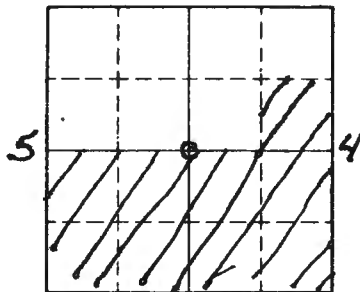

Sketch

○ Corner    ▨ F.S. Land

At time of search:

1. Did you have the record description?

Yes \_\_\_\_\_ No \_\_\_\_\_

2. How was search area located?

Pacing, chaining, photos, maps,  
etc. \_\_\_\_\_

3. Man hours spent in search \_\_\_\_\_

4. Do you think additional search might  
recover evidence? Yes \_\_\_\_\_ No \_\_\_\_\_

5. Signature \_\_\_\_\_

Relation of Evidence to Record Features Along Section Lines

Section line to sections \_\_\_\_\_  
Object \_\_\_\_\_  
Record distance \_\_\_\_\_  
Measured distance \_\_\_\_\_

Other Evidence

Describe evidence of use and occupation such as roads, fences, clearings, timber cutting lines, plantations, etc.. Cite source of testimony if any. \_\_\_\_\_

LOCATION POSTER ON 19" R. PINE @ FR 3145 FROM  
WHICH CORNER BEARS S87°E 415'

Perpetuation Record

Monument and accessories established. Include brief description of area. \_\_\_\_\_

Certified corner restoration certificate prepared: Yes \_\_\_\_\_ No \_\_\_\_\_

Filed in county records at \_\_\_\_\_ Date \_\_\_\_\_ County Document No. \_\_\_\_\_

Identified on aerial photo No. \_\_\_\_\_ Which is filed at \_\_\_\_\_

Index No. C-13  
(Alphabetical - Numerical)

LAND CORNER RECORD  
(RECTANGULAR SURVEYS)

R9-7150-4 (Rev. 6/15/67)  
 GPO 802-127

T. 147 R. 27 5th Mer. N.F. CHIPPewa County ITASCA State MN  
QUARTER Corner common to sections 3 4 and

EXISTING SURVEYS

**Original Government Survey**  
 Year surveyed 1983 A.H. CONGER  
 Original monument WOOD POST  
(Wood post, stone, pile of stones, pipe, etc.)  
**Bearing Trees**  
 Species J PINE J PINE  
 Diameter 7" 5"  
 Bearing N70E S15E  
 Distance 80 203

**Original Evidence Found**  
 Year of search GLO 1936 By GLO  
 Monument found SET 1" X 3" IRON PIPE  
W/ BRASS CAP. SET PROPORTIONATE  
**NEW Original Bearing Trees Found**  
 Species R PINE R PINE  
 Diameter 10 8"  
 Bearing N34E N25 3/4 W  
 Distance 233/ks 230/ks  
53.78' 151.80'

**Subsequent Corner Restoration**  
 Year surveyed 1989 By R. MAIN C. KRANE G. BRAMA  
 Where filed or recorded \_\_\_\_\_  
 Monument GLO I.P. FOR THE GLO  
PINE IN GOOD CONDITION  
(Original concrete post, iron rod, etc.)

**Evidence of Subsequent Corner Restoration Found**  
 Year of search \_\_\_\_\_ By \_\_\_\_\_

**Bearing Trees, Reference Objects**  
 Species R PINE R PINE R PINE  
 Diameter 6" 6" 6"  
 Bearing N16W S83E S15W  
 Distance 21.72' 5.63' 9.96'

**Bearing Trees, Reference Objects**

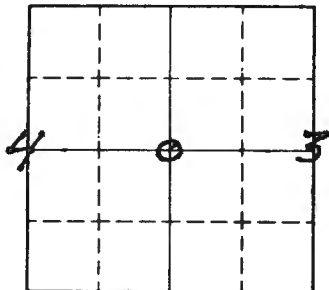

Sketch

○ Corner    ▨ F.S. Land

Relation of Evidence to Record Features Along Section Lines

Section line to sections \_\_\_\_\_  
 Object \_\_\_\_\_  
 Record distance \_\_\_\_\_  
 Measured distance \_\_\_\_\_

Other Evidence

Describe evidence of use and occupation such as roads, fences, clearings, timber cutting lines, plantations, etc.. Cite source of testimony if any. \_\_\_\_\_

CORNER IS ±150' EAST OF HWY #46 AND ±130' SOUTH OF FR 3859A

At time of search:

1. Did you have the record description?

Yes \_\_\_\_\_ No \_\_\_\_\_

2. How was search area located?

Pacing, chaining, photos, maps, etc. \_\_\_\_\_

3. Man hours spent in search \_\_\_\_\_

4. Do you think additional search might recover evidence? Yes \_\_\_\_\_ No \_\_\_\_\_

5. Signature \_\_\_\_\_

Perpetuation Record

Monument and accessories established. Include brief description of area. \_\_\_\_\_

Certified corner restoration certificate prepared: Yes \_\_\_\_\_ No \_\_\_\_\_

Filed in county records at \_\_\_\_\_ Date \_\_\_\_\_ County Document No. \_\_\_\_\_

Identified on aerial photo No. \_\_\_\_\_ Which is filed at \_\_\_\_\_





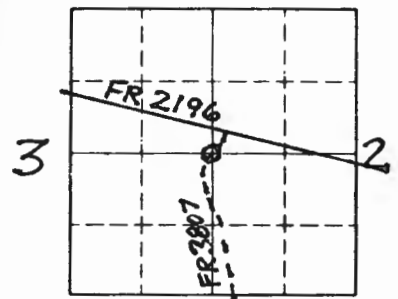

Sketch

○ Corner    ▨ F.S. Land

At time of search:

1. Did you have the record description?

Yes  No

2. How was search area located?

Pacing, chaining, photos, maps, etc.

3. Man hours spent in search

4. Do you think additional search might recover evidence? Yes  No

5. Signature Curt Krause

Relation of Evidence to Record Features Along Section Lines

Section line to sections	_____	_____	_____
Object	_____	_____	_____
Record distance	_____	_____	_____
Measured distance	_____	_____	_____

Other Evidence

Describe evidence of use and occupation such as roads, fences, clearings, timber cutting lines, plantations, etc.. Cite source of testimony if any.

CORNER FALLS IN CENTER OF FR 3807 AND ABOUT 600'S OF FR 2196

SECTION LINE HAS BEARING OF N 8° 57' W  
Ed. MONUMENT LYING BY NORTH (NEW) BT - RESET FROM  
GLO N. PINE AT N 67° W 36.80' - SCRIBE INSIDE 1/4 S 3 BT  
NO TRACE OF GLO J. PINE AT N 55° E 17.82' NOW IS  
BRUSH - WAS PART OF ROAD CLEARING

Perpetuation Record

Monument and accessories established. Include brief description of area.

MARKED NEW BT'S.  
N. PINE 13 S 74° W - 39.53' MKD. 1/4 S 3 BT  
N. PINE 13 N 34° W - 33.76' " 1/4 S 3 BT  
N. PINE 15 NORTH - 28.15' " 1/4 S 2 BT  
8' STEEL SIGN POST DUE WEST 12.9'  
I PLUNGE CUT GLO N. PINE Ed. ALL SCRIBE INSIDE - TREE  
MAY DIE - SO I MARKED 3 NEW TREES

Certified corner restoration certificate prepared: Yes  No

Filed in county records at \_\_\_\_\_ Date \_\_\_\_\_ County Document No. \_\_\_\_\_

Identified on aerial photo No. \_\_\_\_\_ Which is filed at \_\_\_\_\_

T. 147 R. 27 5TH Mer. N.F. CHIAPEWA County ITASCA State MN  
SECTION Corner common to sections 4 5 8 and 9

EXISTING SURVEYS

Original Government Survey

Year surveyed 1873 P.H. LONGER  
 Original monument WOOD POST  
(Wood post, stone, pile of stones, pipe, etc.)

Bearing Trees			
Species	<u>J PINE</u>	<u>J PINE</u>	<u>J. PINE</u>
Diameter	<u>4"</u>	<u>4"</u>	<u>4</u>
Bearing	<u>S12W</u>	<u>S53E</u>	<u>N30W</u>
Distance	<u>50</u>	<u>40</u>	<u>60</u>

Original Evidence Found

Year of search ~~1936~~ 1936 by GLO  
 Monument found NONE

Original Bearing Trees Found

Species	<u>J PINE</u>	<u>J PINE</u>	
Diameter	<u>12"</u>	<u>12"</u>	
Bearing	<u>S51E</u>	<u>S20 1/2 W</u>	
Distance	<u>40 lks</u>	<u>50 lks</u>	

Subsequent Corner Restoration

Year surveyed 1936 By GLO  
 Where filed or recorded \_\_\_\_\_  
 Monument SET 6" X 24" CONCRETE MONUMENT  
(Original, concrete post, iron rod, etc.)  
WITH BRASS CAP

Evidence of Subsequent Corner Restoration Found

Year of search 1989 By R. MAIN C. KRAUSE  
Ed GLO IRON UP 2" IN PLACE.

Bearing Trees, Reference Objects

Species	<u>J PINE</u>	<u>J PINE</u>	<u>R PINE</u>	<u>R PINE</u>
Diameter	<u>8"</u>	<u>5"</u>	<u>9"</u>	<u>10"</u>
Bearing	<u>N64 1/4 E</u>	<u>S31E</u>	<u>S58W</u>	<u>N7W</u>
Distance	<u>54 lks</u>	<u>20 lks</u>	<u>32 lks</u>	<u>7 lks</u>

GLO Bearing Trees, Reference Objects

<u>GLO</u> Species	<u>R PINE</u>	<u>R PINE</u>	<u>R PINE</u>	<u>R PINE</u>
Diameter	<u>15"</u>	<u>14"</u>	<u>20"</u>	<u>11"</u>
Bearing	<u>S58W</u>	<u>N7W</u>	<u>S63E</u>	<u>N58E</u>
Distance	<u>21.1</u>	<u>4.6'</u>	<u>44.90</u>	<u>36.35</u>

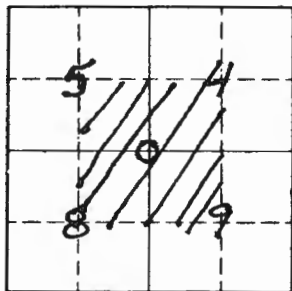

Sketch

○ Corner    ▨ F.S. Land

Relation of Evidence to Record Features Along Section Lines

Section line to sections \_\_\_\_\_  
 Object \_\_\_\_\_  
 Record distance \_\_\_\_\_  
 Measured distance \_\_\_\_\_

Other Evidence

Describe evidence of use and occupation such as roads, fences, clearings, timber cutting lines, plantations, etc.. Cite source of testimony if any.

LOCATION POSTER ON 22" R PINE ON FR 3145 FROM WHICH CORNER BEARS S74E332'.

At time of search:

1. Did you have the record description?

Yes \_\_\_\_\_ No \_\_\_\_\_

2. How was search area located?

Pacing, chaining, photos, maps, etc. \_\_\_\_\_

3. Man hours spent in search \_\_\_\_\_

4. Do you think additional search might recover evidence? Yes \_\_\_\_\_ No \_\_\_\_\_

5. Signature \_\_\_\_\_

Perpetuation Record

Monument and accessories established. Include brief description of area. \_\_\_\_\_

6' STEEL SIGN POST EAST 5.07'

Certified corner restoration certificate prepared: Yes \_\_\_\_\_ No \_\_\_\_\_

Filed in county records at \_\_\_\_\_ Date \_\_\_\_\_ County Document No. \_\_\_\_\_

Identified on aerial photo No. \_\_\_\_\_ Which is filed at \_\_\_\_\_

Index No. E-11  
(Alphabetical - Numerical)

LAND CORNER RECORD  
(RECTANGULAR SURVEYS)

R9-7150-4 (Rev. 6/13/67)  
 GPO 802-127

T. 147 R. 27 5TH Mer. N.F. CHIPPEWA County ITASCA State MN  
Q QUARTER Corner common to sections 4 9 and \_\_\_\_\_

EXISTING SURVEYS

**Original Government Survey**  
 Year surveyed 1873 By PH CONGER  
 Original monument WOOD POST  
(Wood post, stone, pile of stones, pipe, etc.)

**Bearing Trees**  
 Species J PINE J PINE  
 Diameter 8" 8"  
 Bearing N85E S86E  
 Distance 240 250  
158.4A 165.00A

**Original Evidence Found**  
 Year of search 1936 By GLO  
 Monument found SET 1" X 3" I.P.

**(D.M. 40) Original Bearing Trees Found**  
 Species J PINE J PINE  
 Diameter 16" 16"  
 Bearing N85E S86E  
 Distance 242 lks 248 lks

**Subsequent Corner Restoration**  
 Year surveyed 1936 By GLO  
 Where filed or recorded \_\_\_\_\_  
 Monument SET I.P.  
(Original, concrete post, iron rod, etc.)

**Evidence of Subsequent Corner Restoration Found**  
 Year of search 1989 By R MAINE (KAUSE-GORING)  
Ed GLO IRON 6" ABOVE GROUND.  
SE GLO BT NOW A STD W/ SCRIBE  
VISIBLE. NW BT IS GONE.

**Bearing Trees, Reference Objects**  
 Species R PINE R PINE  
 Diameter 10" 5"  
 Bearing S58E N71W  
 Distance 17 lks 29 lks  
11.22' 19.14'

**Bearing Trees, Reference Objects**  
 Species R PINE R PINE R PINE SIGN POST  
 Diameter 5" 8" 7"  
 Bearing S24E S52W N68E EAST  
 Distance 35.82 26.80 18.30 3.22'

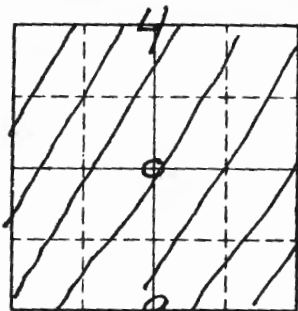

Sketch

○ Corner    ▨ F.S. Land

Relation of Evidence to Record Features Along Section Lines

Section line to sections \_\_\_\_\_  
 Object \_\_\_\_\_  
 Record distance \_\_\_\_\_  
 Measured distance \_\_\_\_\_

Other Evidence

Describe evidence of use and occupation such as roads, fences, clearings, timber cutting lines, plantations, etc.. Cite source of testimony if any. \_\_\_\_\_

CORNER IS IN A PINE PLANTATION ± 150' EAST OF  
 A GRASS SLOUGH.

At time of search:

1. Did you have the record description?

Yes \_\_\_\_\_ No \_\_\_\_\_

2. How was search area located?

Pacing, chaining, photos, maps,  
 etc. \_\_\_\_\_

3. Man hours spent in search \_\_\_\_\_

4. Do you think additional search might

recover evidence? Yes \_\_\_\_\_ No \_\_\_\_\_

Perpetuation Record

Monument and accessories established. Include brief description of area. \_\_\_\_\_

Certified corner restoration certificate prepared: Yes \_\_\_\_\_ No \_\_\_\_\_

Filed in county records at \_\_\_\_\_ Date \_\_\_\_\_ County Document No. \_\_\_\_\_

Identified on aerial photo No. \_\_\_\_\_ Which is filed at \_\_\_\_\_

Index No. E-13  
(Alphabetical - Numerical)LAND CORNER RECORD  
(RECTANGULAR SURVEYS)R9-7150-4 (Rev. 6/13/67)  
GPO 802-127T. 147 R. 27 5TH Mer. N.F. CHIPPWA County ITASCA State MN  
SECTION Corner common to sections 3 4 9 and 10

## EXISTING SURVEYS

Original Government Survey				Original Evidence Found			
Year surveyed <u>1873</u>				Year of search _____ By _____			
Original monument <u>WOOD POST</u> <small>(wood post, stone, pile of stones, pipe, etc.)</small>				Monument found _____			
<p style="text-align: center;">Bearing Trees</p> Species <u>J PINE</u> <u>J PINE</u> <u>J PINE</u> <u>PINE STUB</u> Diameter <u>8"</u> <u>8"</u> <u>6"</u> <u>8"</u> Bearing <u>S89 1/2 E</u> <u>N31 E</u> <u>N53 W</u> <u>S40 W</u> Distance <u>27 lks</u> <u>52 lks</u> <u>74 lks</u> <u>40 lks</u>				<p style="text-align: center;">Original Bearing Trees Found</p> Species _____ Diameter _____ Bearing _____ Distance _____			
Subsequent Corner Restoration				Evidence of Subsequent Corner Restoration Found			
Year surveyed <u>1936</u> By <u>GLO</u>				Year of search <u>1989</u> By <u>R MAZURKAWA G BRAMA</u>			
Where filed or recorded _____				<u>Ed GLO I.P. IN PLACE.</u>			
Monument <u>6" X 24" CONCRETE MONUMENT</u> <small>(Original, concrete post, iron rod, etc.)</small> <u>20" IN GROUND / w/ 3" BRASS CAP.</u>				<u>ORIG BT SNAG SCREW VISIBLE N67E</u> <u>12.3'</u>			
<p style="text-align: center;">Bearing Trees, Reference Objects</p> Species <u>J PINE</u> <u>J PINE</u> <u>J PINE</u> <u>J PINE</u> Diameter <u>10"</u> <u>10</u> <u>12</u> <u>12</u> Bearing <u>S27E</u> <u>S30W</u> <u>N64 1/2 W</u> <u>S80W</u> Distance <u>38 lks</u> <u>38 lks</u> <u>30 lks</u> <u>14 lks</u>				<p style="text-align: center;">Bearing Trees, Reference Objects</p> <u>R PINE</u> <u>R PINE</u> <u>R PINE</u> <u>R PINE</u> <u>9</u> <u>11</u> <u>12</u> <u>12</u> <u>N65E</u> <u>S10E</u> <u>S41W</u> <u>N20W</u> <u>7.70'</u> <u>1669</u> <u>46.49</u> <u>20.05</u>			

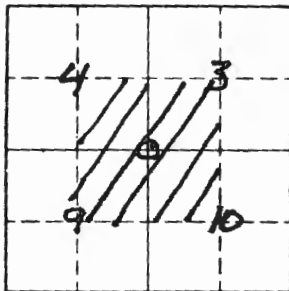

Sketch

○ Corner    ▨ F.S. Land

Relation of Evidence to Record Features Along Section Lines

Section line to sections \_\_\_\_\_  
 Object \_\_\_\_\_  
 Record distance \_\_\_\_\_  
 Measured distance \_\_\_\_\_

Other Evidence

Describe evidence of use and occupation such as roads, fences, clearings, timber cutting lines, plantations, etc.. Cite source of testimony if any. \_\_\_\_\_  
 \_\_\_\_\_  
 \_\_\_\_\_  
 \_\_\_\_\_  
 \_\_\_\_\_

At time of search:

1. Did you have the record description?

Yes \_\_\_\_\_ No \_\_\_\_\_

2. How was search area located?

Pacing, chaining, photos, maps,  
 etc. \_\_\_\_\_  
 \_\_\_\_\_

3. Man hours spent in search \_\_\_\_\_

4. Do you think additional search might  
 recover evidence? Yes \_\_\_\_\_ No \_\_\_\_\_

Perpetuation Record

Monument and accessories established. Include brief description of area. \_\_\_\_\_

*STEEL SIGN POST SOUTH 3.75 FT*

Certified corner restoration certificate prepared: Yes \_\_\_\_\_ No \_\_\_\_\_

Filed in county records at \_\_\_\_\_ Date \_\_\_\_\_ County Document No. \_\_\_\_\_

Identified on aerial photo No. \_\_\_\_\_ Which is filed at \_\_\_\_\_



Index No. B-15  
(Alphabetical - Numerical)

LAND CORNER RECORD  
(RECTANGULAR SURVEYS)

T. 147N R. 27W 5th Mer. N.F. Chippewa County Itasca State Minnesota  
quarter Corner common to sections 3, 10 and

EXISTING SURVEYS

Original Government Survey

Year surveyed 1873  
Original monument Wood Post  
(Wood post, stone, pile of stones, pipe, etc.)

Bearing Trees  
Species J. PINE J. PINE (STB)  
Diameter 6 5  
Bearing S74W N18E  
Distance 19 LKS 16 LKS  
12.54 10.56

Subsequent Corner Restoration

Year surveyed 1936 By G.L.O.  
Where filed or recorded \_\_\_\_\_  
Monument Iron post with brass cap stamped:  
(Original, concrete, post, iron rod, etc.)

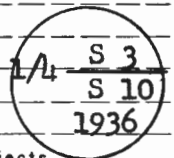

Bearing Trees, Reference Objects

Species J. Pine N. Pine  
Diameter 9" 10"  
Bearing S42 3/4 W N83 3/4 W  
Distance 49 lks. 46 lks.  
32.34 29.70

Original Evidence Found

Year of search 1936 By GLO  
Monument found NONE

Original Bearing Trees Found

Species NONE  
Diameter \_\_\_\_\_  
Bearing \_\_\_\_\_  
Distance \_\_\_\_\_

Evidence of Subsequent Corner Restoration Found

Year of search 6/13/90 By R. MAIN  
Fd GLO I.P. Slightly bent but in good condition. J. PINE BT Now a stump  
Fd SCRIBE ON STUMP. STRAIGHTENED PIPE.

GLO  
(R. PINE) R. PINE R. PINE  
19" 8" 17"  
N84W N 26W S 50E  
30.75 12.02 48.15  
TO MAIN

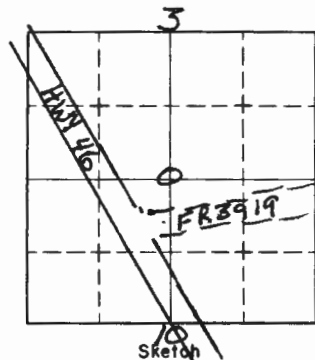

○ Corner    ▨ F.S. Land

Relation of Evidence to Record Features Along Section Lines

Section line to sections \_\_\_\_\_  
 Object \_\_\_\_\_  
 Record distance \_\_\_\_\_  
 Measured distance \_\_\_\_\_

Other Evidence

Describe evidence of use and occupation such as roads, fences, clearings, timber cutting lines, plantations, etc.. Cite source of testimony if any. \_\_\_\_\_

At time of search:

1. Did you have the record description?

Yes \_\_\_\_\_ No \_\_\_\_\_

2. How was search area located?

Pacing, chaining, photos, maps, etc. \_\_\_\_\_

3. Man hours spent in search \_\_\_\_\_

4. Do you think additional search might recover evidence? Yes \_\_\_\_\_ No \_\_\_\_\_

5. Signature \_\_\_\_\_

Perpetuation Record

Monument and accessories established. Include brief description of area. \_\_\_\_\_

STEEL SIGN POST 3.7' NORTH

Certified corner restoration certificate prepared: Yes \_\_\_\_\_ No \_\_\_\_\_

Filed in county records at \_\_\_\_\_ Date \_\_\_\_\_ County Document No. \_\_\_\_\_

Identified on aerial photo No. \_\_\_\_\_ Which is filed at \_\_\_\_\_

Index No. E-17 **BOOK 1**  
(Alphabetical - Numerical) Pg. 69

LAND CORNER RECORD  
(RECTANGULAR SURVEYS)

R9-7 150-4 (Rev. 6/15/67)  
 GPO 802-127

T. 147 R. 27 S Mer. N.F. CHIPPEWA County ITASCA State MN.  
SECTION Corner common to sections 2, 3, 10 and 11

EXISTING SURVEYS

Original Government Survey  
 Year surveyed 1874 P. H. CONGER  
 Original monument WOOD POST  
(Wood post, stone, pile of stones, pipe, etc.)

Bearing Trees  

Species	<u>N. PINE</u>	<u>N. PINE</u>	<u>N. PINE</u>	<u>J. PINE</u>
Diameter	<u>16</u>	<u>14</u>	<u>18</u>	<u>8</u>
Bearing	<u>S65E</u>	<u>N61E</u>	<u>S19W</u>	<u>N49W</u>
Distance	<u>61 LKS.</u>	<u>64 LKS.</u>	<u>60 LKS.</u>	<u>70 LKS.</u>
	<u>40.26'</u>	<u>42.24'</u>	<u>39.60'</u>	<u>46.20'</u>

Subsequent Corner Restoration  
 Year surveyed 1936 By GLO RESURVEY  
 Where filed or recorded \_\_\_\_\_  
 Monument SET 6" X 24" CONCRETE CYLINDER WITH  
(Original, concrete post, iron rod, etc.) BRASS CAP AND

NEW BT'S.  
 Bearing Trees, Reference Objects  

Species	<u>N. PINE</u>	<u>J. PINE</u>	<u>N. PINE</u>
Diameter	<u>26</u>	<u>8</u>	<u>26</u>
Bearing	<u>N41E</u>	<u>S49 3/4 E</u>	<u>N59 1/4 W</u>
Distance	<u>288 LKS.</u>	<u>42 LKS.</u>	<u>66 LKS.</u>
	<u>150.88'</u>	<u>27.72'</u>	<u>43.56'</u>

Original Evidence Found  
 Year of search 1936 By GLO RESURVEY  
 Monument found RESTORED FROM ORIG. BT'S.

Original Bearing Trees Found  

Species	<u>N. PINE STP.</u>	<u>N. PINE STP.</u>	<u>N. PINE</u>
Diameter	<u>BURNED</u>	<u>22" X 3 1/2" H</u>	<u>26</u>
Bearing	<u>N61E</u>	<u>S70 1/2 E</u>	<u>S14W</u>
Distance	<u>59 LKS.</u>	<u>61 LKS.</u>	<u>60 LKS.</u>

Evidence of Subsequent Corner Restoration Found  
 Year of search 8-11-94 By CK  
FD. GLO CONCRETE CYLINDER - IN PLACE  
3" ABOVE GROUND - CORNER IN THICK BRUSH  
WITH SCATTERED N. PINE - FD. 4X4 CEDAR  
POST 1.0' WEST OF MONUMENT  
PLACED E.S.L.P. ON 20" N. PINE N83E-575'

Bearing Trees, Reference Objects OVER  

<u>PINE STUMP</u>	<u>J. PINE STP.</u>	<u>WINDFALL PINE</u>
<u>ROTTED</u>	<u>ROTTED</u>	<u>DIRT PILE</u>
<u>N41E</u>	<u>S50E</u>	<u>N59W</u>
<u>150.48'</u>	<u>27.72'</u>	<u>43.56'</u>

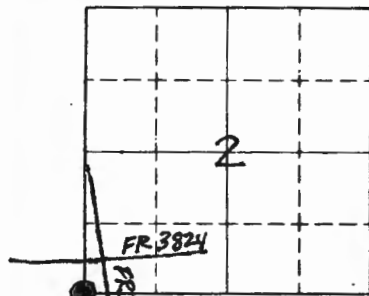

Sketch

○ Corner    ▨ F.S. Land

Relation of Evidence to Record Features Along Section Lines

Section line to sections \_\_\_\_\_  
 Object \_\_\_\_\_  
 Record distance \_\_\_\_\_  
 Measured distance \_\_\_\_\_

Other Evidence

Describe evidence of use and occupation such as roads, fences, clearings, timber cutting lines, plantations, etc.. Cite source of testimony if any.

TAG ON N. PINE 20" AT N 83 E 575' FROM CORNER - TAG IS ON EAST SIDE OF FR 3807

ORIG. BT EVIDENCE STILL REMAINING AT COR.

LARGE PINE STUB 20' HIGH AT S14W - 39.6' SCRIBE VISIBLE  
 PINE STUB 36" HIGH S70E 40.26' SOME SCRIBE VISIBLE  
 BURNED PINE STUMP 24" HIGH N61E 38 94' NO SCRIBE

Perpetuation Record

Monument and accessories established. Include brief description of area.

MARKED NEAR BT's. 8-11-94 CK  
 N. PINE 10 N36E - 25.08' MKD S2 BT  
 N. PINE 13 S54E - 23.65' MKD S11 BT  
 N. PINE 15 S20W - 25.62' MKD S10 BT  
 N. PINE 10 N41W - 23.73' MKD S3 BT  
 4X4X5' CEDAR POST 1.0 WEST OF MONUMENT  
 PAINTED RED - NO SIGN WITH AT THIS TIME

At time of search:

1. Did you have the record description?

Yes  No

2. How was search area located?

Pacing, chaining, photos, maps, etc. \_\_\_\_\_

3. Man hours spent in search 1 1/2 HRS.

4. Do you think additional search might recover evidence? Yes  No

5. Signature Curt Krause

Certified corner restoration certificate prepared: Yes  No

Filed in county records at \_\_\_\_\_ Date \_\_\_\_\_ County Document No. \_\_\_\_\_

Identified on aerial photo No. \_\_\_\_\_ Which is filed at \_\_\_\_\_

Index No. E-19 BOOK 1  
(Alphabetical - Numerical) P. 31

LAND CORNER RECORD  
(RECTANGULAR SURVEYS)

R9-7150-4 (Rev. 6/13/67)  
 GPO 802-127

T. 147 R. 27 S Mer. N.F. CHIPPEWA County ITASCA State MN.  
QUARTER BET. Corner common to sections 2 and 11

EXISTING SURVEYS

Original Government Survey

Year surveyed 1874 By P.H. CONGER  
 Original monument WOOD POST  
(Wood post, stone, pile of stones, pipe, etc.)

Bearing Trees

Species	<u>J. PINE</u>	<u>J. PINE</u>
Diameter	<u>6</u>	<u>4</u>
Bearing	<u>N15W</u>	<u>S40E</u>
Distance	<u>20 LKS.</u>	<u>4 LKS.</u>
	<u>13.20'</u>	<u>2.64'</u>

Subsequent Corner Restoration

Year surveyed 1936 By GLO RESURVEY  
 Where filed or recorded \_\_\_\_\_  
 Monument SET 1" X 36" IRON POST 1/4 CAP MKD.  
(Original, concrete post, iron rod, etc.)  
1/4 52  
S11  
1936

Bearing Trees, Reference Objects

Species	<u>N. PINE</u>	<u>N. PINE</u>
Diameter	<u>12</u>	<u>6</u>
Bearing	<u>N77 1/4 E</u>	<u>S43 1/2 W</u>
Distance	<u>46 LKS.</u>	<u>50 LKS.</u>
	<u>30.36'</u>	<u>33.00'</u>

Original Evidence Found

Year of search 1936 By GLO RESURVEY  
 Monument found NO EVIDENCE OF ORIG. RT'S.  
PROPORTIONAL DISTANCE

Original Bearing Trees Found

Species	_____
Diameter	_____
Bearing	_____
Distance	_____

Evidence of Subsequent Corner Restoration Found

Year of search 8-17-94 By CK ITASCA COUNTY  
ED. IRON CAP - IN PLACE - 1.3' BELOW  
BLACKTOP SURFACE OF COUNTY ROAD 34  
(MAX ROAD) - 1.0' WEST OF CENTERLINE.  
PATCHED HOLE IN BLACKTOP

Bearing Trees, Reference Objects OVER

Species	<u>N. PINE</u>	<u>N. PINE</u>
Diameter	<u>22"</u>	<u>20"</u>
Bearing	<u>N78E</u>	<u>S43W</u>
Distance	<u>30.4'</u>	<u>33.0'</u>
	<u>SCAR FACING COR.</u>	<u>SCAR FACING COR.</u>

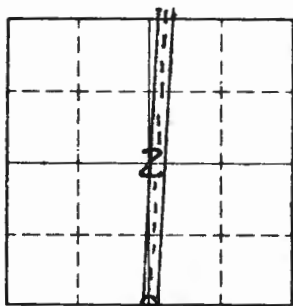

Sketch

○ Corner    ▨ F.S. Land

Relation of Evidence to Record Features Along Section Lines

Section line to sections \_\_\_\_\_  
 Object \_\_\_\_\_  
 Record distance \_\_\_\_\_  
 Measured distance \_\_\_\_\_

Other Evidence

Describe evidence of use and occupation such as roads, fences, clearings, timber cutting lines, plantations, etc.. Cite source of testimony if any. \_\_\_\_\_

1.3' BELOW SURFACE - 1.0' WEST OF CENTERLINE  
OF ITASCA COUNTY #34 (MAX ROAD)

At time of search:

1. Did you have the record description?

Yes  No \_\_\_\_\_

2. How was search area located?

Pacing, chaining, photos, maps,  
 etc. \_\_\_\_\_

3. Man hours spent in search 1/2 hr.

4. Do you think additional search might  
 recover evidence? Yes \_\_\_\_\_ No \_\_\_\_\_

5. Signature Curt Krause

Perpetuation Record

Monument and accessories established. Include brief description of area. \_\_\_\_\_

FD. THESE BT'S MARKED BY R. McDONALD 6-24-66 DATE ON TAG  
ALL TREES WERE SCRIBED YEARS AGO - SCRIBE STILL VISIBLE.

N. PINE 15.5" S 60 E - 41.60' SPK - TAG - PAINTED

N. PINE 15.5" S 22 W - 37.25' " " "

N. PINE 15.5" N 87 W - 41.63' " " "

Certified corner restoration certificate prepared: Yes \_\_\_\_\_ No \_\_\_\_\_

Filed in county records at \_\_\_\_\_ Date \_\_\_\_\_ County Document No. \_\_\_\_\_

Identified on aerial photo No. \_\_\_\_\_ Which is filed at \_\_\_\_\_

Index No. G-21  
(Alphabetical - Numerical)

LAND CORNER RECORD  
(RECTANGULAR SURVEYS)

R9-7 150-4 (Rev. 6/13/67)  
GPO 802-127

T. 148 R. 27 5TH Mer. N.F. CHIPPEWA County ITASCA State MINN  
QUARTER Corner common to sections 11, 12, and \_\_\_\_\_

EXISTING SURVEYS

Original Government Survey  
Year surveyed 1875  
Original monument WOOD POST  
(Wood post, stone, pile of stones, pipe, etc.)

Bearing Trees  
Species ASPEN ASPEN  
Diameter 8 8  
Bearing N50E S38W  
Distance 3 lks 2 lks

Subsequent Corner Restoration  
Year surveyed 1935 By EMMERT CLL  
Where filed or recorded \_\_\_\_\_  
Monument FD POST FALLEN OVER SCRIBED 4 5/16"  
1/4 5/16" PLACED MLP ON ELM 8" S36W  
95 lks 62.7'

Bearing Trees, Reference Objects  
Species BIRCH STD  
Diameter 18"  
Bearing S40W  
Distance 89 lks  
58.7'

Original Evidence Found  
Year of search 1914 By ITASCA CO RD SURVEY  
Monument found \_\_\_\_\_

Original Bearing Trees Found  
Species ASPEN BIRCH  
Diameter 13 11  
Bearing N35E S40°30'W  
Distance 6.1 62.5

Evidence of Subsequent Corner Restoration Found  
Year of search 1937 By BAIKE CLL  
SET NEW ELM POST 4 1/4" X 30". FENCE LINES  
RUN WEST AND SOUTH OF CORNER.

Bearing Trees, Reference Objects  
BIRCH STD ASPEN STD  
14" 10"  
S39°30'W N41 15E  
91 lks 97 lks  
60.0' 64.0'

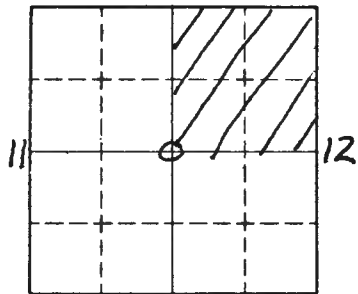

Sketch

○ Corner    ▨ F.S. Land

Relation of Evidence to Record Features Along Section Lines

Section line to sections \_\_\_\_\_  
 Object \_\_\_\_\_  
 Record distance \_\_\_\_\_  
 Measured distance \_\_\_\_\_

Other Evidence

Describe evidence of use and occupation such as roads, fences, clearings, timber cutting lines, plantations, etc.. Cite source of testimony if any. 1990. R MAIN C. KRAUSE  
FD THE SOUTH AND WEST FENCE LINES DESCRIBED BY THE 874  
FROM 1935; 1937 PROJECTED THEIR INTERSECTION AND PULLED  
A DISTANCE OF 64.0 FT TO THE E 1/4 W/ THE FSLP FROM  
1937. PLACED A 60 D SPIKE @ THIS LOCATION AND WITNESSED  
WITH THE FOLLOWING TIES.

7' E 1/4 STUB 14° 53' 6" W 64.0' TO NAIL  
ASH 6° N 19' W 72.10' TO NAE/

Perpetuation Record

Monument and accessories established. Include brief description of area. \_\_\_\_\_

At time of search:

1. Did you have the record description?

Yes \_\_\_\_\_ No \_\_\_\_\_

2. How was search area located?

Pacing, chaining, photos, maps,  
 etc. \_\_\_\_\_

3. Man hours spent in search \_\_\_\_\_

4. Do you think additional search might  
 recover evidence? Yes \_\_\_\_\_ No \_\_\_\_\_

5. Signature \_\_\_\_\_

Certified corner restoration certificate prepared: Yes \_\_\_\_\_ No \_\_\_\_\_

Filed in county records at \_\_\_\_\_ Date \_\_\_\_\_ County Document No. \_\_\_\_\_

Identified on aerial photo No. \_\_\_\_\_ Which is filed at \_\_\_\_\_



Index No. J-3  
(Alphabetical - Numerical)BOOK 1  
Pg. 76LAND CORNER RECORD  
(RECTANGULAR SURVEYS)R9-7150-4 (Rev. 6/15/67)  
GPO 802-127T. 147 R. 27 5 Mer. N.F. CHIPPEWA County ITASCA State MN.  
QUARTER BET. Corner common to sections \_\_\_\_\_, \_\_\_\_\_, \_\_\_\_\_ 7 and 18

## EXISTING SURVEYS

## Original Government Survey

Year surveyed 1874 P.H. CONGER  
Original monument WOOD POST  
(Wood post, stone, pile of stones, pipe, etc.)

## Bearing Trees

Species J. PINE J. PINE  
Diameter 6 6  
Bearing N2E S42E  
Distance 23 LKS. 35 LKS.  
15.18' 23.10'

## Subsequent Corner Restoration

Year surveyed 1936 By GLO RESURVEY  
Where filed or recorded ON FILE  
Monument SET 1" X 3/4" IRON POST  
(Original, concrete post, iron rod, etc.)

## Bearing Trees, Reference Objects

Species N. PINE N. PINE  
Diameter 20 24  
Bearing SSS 1/2 E N80 1/2 W  
Distance 106 LKS. 73 LKS.  
69.96' 48.18'

## Original Evidence Found

Year of search \_\_\_\_\_ By \_\_\_\_\_  
Monument found \_\_\_\_\_

## Original Bearing Trees Found

Species \_\_\_\_\_  
Diameter \_\_\_\_\_  
Bearing \_\_\_\_\_  
Distance \_\_\_\_\_

## Evidence of Subsequent Corner Restoration Found

Year of search 9-7-94 By CK  
FD. IRON + CAP - IN PLACE - CAP 2" HIGH  
PLACED ROCK ALONGSIDE IRON  
CORNER IS 35' NORTH OF FR 2171  
TWO BT'S. ARE ALONGSIDE SOUTH EDGE  
OF THIRD RIVER ROAD

## Bearing Trees, Reference Objects

Species N. PINE N. PINE  
Diameter 27 27  
Bearing SSSE N80W  
Distance 69.96' 48.18'

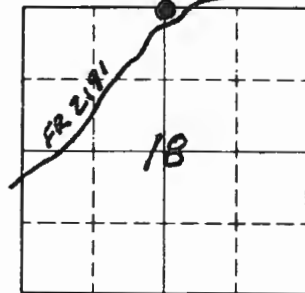

Sketch

○ Corner    ▨ F.S. Land

At time of search:

1. Did you have the record description?

Yes  No

2. How was search area located?

Pacing, chaining, photos, maps, etc.

3. Man hours spent in search 1/2 hr.

4. Do you think additional search might recover evidence? Yes  No

5. Signature Curt Kramer

Relation of Evidence to Record Features Along Section Lines

Section line to sections	_____	_____	_____	_____
Object	_____	_____	_____	_____
Record distance	_____	_____	_____	_____
Measured distance	_____	_____	_____	_____

Other Evidence

Describe evidence of use and occupation such as roads, fences, clearings, timber cutting lines, plantations, etc.. Cite source of testimony if any.

CORNER IS 35' NORTH OF FR 2171

Perpetuation Record

Monument and accessories established. Include brief description of area.

MARKED NEW B.T.S.

N. PINE 24 S11W 66.30' MKD 1/4 S18 BT

8" STEEL SIGN POST NORTH 3.15'

Certified corner restoration certificate prepared: Yes  No

Filed in county records at \_\_\_\_\_ Date \_\_\_\_\_ County Document No. \_\_\_\_\_

Identified on aerial photo No. \_\_\_\_\_ Which is filed at \_\_\_\_\_

Index No. J-15  
(Alphabetical - Numerical)BOOK 1  
Pg. 72LAND CORNER RECORD  
(RECTANGULAR SURVEYS)R9-7150-4 (Rev. 6/13/67)  
GPO 802-127T. 147 R. 27 S Mer. N.F. CHIPPEWA County ITASCA State MN.  
QUARTER BET. Corner common to sections 10 and 15

## EXISTING SURVEYS

## Original Government Survey

Year surveyed 1874 By P.H. CONGER  
Original monument WOOD POST  
(Wood post, stone, pile of stones, pipe, etc.)

## Bearing Trees

Species N. PINE N. PINE  
Diameter 14 14  
Bearing N28W S34E  
Distance 75 Lks. 102 Lks.  
49.50' 67.32'

## Subsequent Corner Restoration

Year surveyed 1936 By GLO RESURVEY  
Where filed or recorded \_\_\_\_\_  
Monument SET 1" X 36" IRON POST w/ CAP MKD.  
(Original, concrete post, iron rod, etc.)

## Bearing Trees, Reference Objects

Species N. PINE N. PINE  
Diameter 12 14  
Bearing S45 1/2 E N 4 W  
Distance 28 Lks. 3 Lks.

## Original Evidence Found

Year of search 1936 By GLO RESURVEY  
Monument found NO EVIDENCE REMAIN OF BT'S.  
PROPORTIONAL DISTANCE.

## Original Bearing Trees Found

Species \_\_\_\_\_  
Diameter \_\_\_\_\_  
Bearing \_\_\_\_\_  
Distance \_\_\_\_\_

## Evidence of Subsequent Corner Restoration Found

Year of search 8-30-94 By RM-CK  
FD. IRON + CAP - IN PLACE - 6" HIGH  
IN N. PINE PLANTATION - WITH HEAVY BRUSH  
45' N38W OF FR 3802  
BOTH GLO BT'S. ARE IN GOOD SHAPE.  
WOODS TRAIL JUST WEST OF IRON RUNS NE

## Bearing Trees, Reference Objects

Species N. PINE N. PINE  
Diameter 20 20  
Bearing S45 E N4W  
Distance 18.48 2.0'

Relation of Evidence to Record Features Along Section Lines

Section line to sections \_\_\_\_\_  
 Object \_\_\_\_\_  
 Record distance \_\_\_\_\_  
 Measured distance \_\_\_\_\_

Other Evidence

Describe evidence of use and occupation such as roads, fences, clearings, timber cutting lines, plantations, etc.. Cite source of testimony if any.

FR 3802 RUNS NE-SW 45' S E OF COR.  
 OLD WOODS TRAIL RUNS NE ALONGSIDE IRON

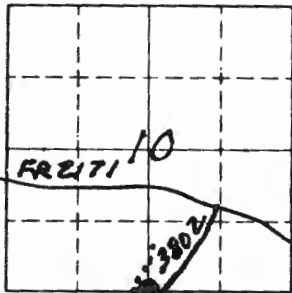

○ Corner    ▨ F.S. Land

At time of search:

1. Did you have the record description?

Yes  No \_\_\_\_\_

2. How was search area located?

Pacing, chaining, photos, maps, etc.

3. Man hours spent in search 1/2 hr.

4. Do you think additional search might recover evidence? Yes \_\_\_\_\_ No \_\_\_\_\_

5. Signature Curt Krause

Perpetuation Record

Monument and accessories established. Include brief description of area.

MARKED NEW BT  
 N. PINE 16 N 74E - 15.38' MKD S 10 BT

8' STEEL SIGN POST WEST 1.65'

Certified corner restoration certificate prepared: Yes \_\_\_\_\_ No \_\_\_\_\_

Filed in county records at \_\_\_\_\_ Date \_\_\_\_\_ County Document No. \_\_\_\_\_

Identified on aerial photo No. \_\_\_\_\_ Which is filed at \_\_\_\_\_

Index No. J-11  
(Alphabetical-Numerical)BOOK 1  
Pg. 71LAND CORNER RECORD  
(RECTANGULAR SURVEYS)R9-7 150-4 (Rev. 6/13/67)  
GPO 502-127T. 147 R. 27 S. 5 Mer. N.F. CHIPPEWA County ITASCA State MN.  
SECTION Corner common to sections 10, 11, 14 and 15

## EXISTING SURVEYS

## Original Government Survey

Year surveyed 1874 P.H. CONGER  
Original monument WOOD POST  
(Wood post, stone, pile of stones, pipe, etc.)

## Bearing Trees

Species	<u>N. PINE</u>	<u>N. PINE</u>	<u>N. PINE</u>	<u>N. PINE</u>
Diameter	<u>14</u>	<u>14</u>	<u>14</u>	<u>18</u>
Bearing	<u>S19W</u>	<u>N63W</u>	<u>S82½E</u>	<u>N60E</u>
Distance	<u>24 LKS.</u> <u>15.84</u>	<u>21 LKS.</u> <u>13.86'</u>	<u>25 LKS.</u> <u>16.50'</u>	<u>30 LKS.</u> <u>19.80'</u>

## Subsequent Corner Restoration

Year surveyed 1936 By GLO RESURVEY  
Where filed or recorded \_\_\_\_\_  
Monument SET CONCRETE CYLINDER w/ CAP MFD.  
(Original, concrete post, iron rod, etc.)

## Bearing Trees, Reference Objects

Species	<u>N. PINE</u>	<u>N. PINE</u>	<u>J. PINE</u>	<u>N. PINE</u>
Diameter	<u>8</u>	<u>6</u>	<u>6</u>	<u>8</u>
Bearing	<u>N18¼E</u>	<u>S44½E</u>	<u>S39½W</u>	<u>N62¾W</u>
Distance	<u>75 LKS.</u> <u>49.50'</u>	<u>35 LKS.</u> <u>23.10'</u>	<u>53 LKS.</u> <u>34.98'</u>	<u>68 LKS.</u> <u>44.88'</u>

## Original Evidence Found

Year of search 1936 By GLO RESURVEY  
Monument found \_\_\_\_\_

## Original Bearing Trees Found

Species	<u>BURNED PINE STP.</u>	<u>PINE STP.</u>	<u>PINE STP.</u>
Diameter	<u>20</u>	<u>18'-6"H</u>	<u>24</u>
Bearing	<u>N53½E</u>	<u>S9W</u>	<u>N65W</u>
Distance	<u>30 LKS.</u> <u>LOWER BLAZE</u>	<u>24 LKS.</u> <u>w/SCRIBE</u>	<u>21 LKS.</u> <u>LOWER BLAZE</u>

## Evidence of Subsequent Corner Restoration Found

Year of search 8-30-94 By RM-CK  
Ed. GLO MONUMENT - IN PLACE - 3" ABOVE  
GROUND - IN THICK BRUSH + N. PINE  
PLACE FSLP ON N. PINE 13 - WEST OF COR.  
ON EAST SIDE OF FR 3801° CORNER IS 165' EAST  
OF TAG

NOW	Bearing Trees, Reference	NOW	OVER
<u>N. PINE</u>	<u>N. PINE</u>	<u>J. PINE STP.</u>	<u>N. PINE</u>
<u>16"</u>	<u>14.5"</u>	<u>ROTTED</u>	<u>17</u>
<u>N18E</u>	<u>S44E</u>	<u>S39W</u>	<u>N63W</u>
<u>49.50'</u>	<u>23.10'</u>	<u>34.98'</u>	<u>44.88'</u>
<u>SCAP</u>	<u>SCAP</u>		

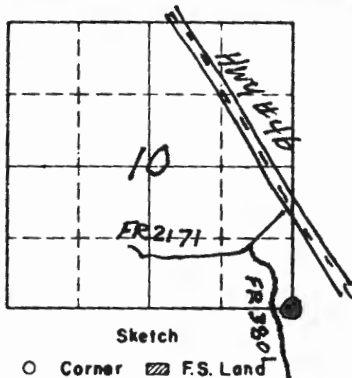

Sketch

O Corner ▨ F.S. Land

Relation of Evidence to Record Features Along Section Lines

Section line to sections \_\_\_\_\_  
 Object \_\_\_\_\_  
 Record distance \_\_\_\_\_  
 Measured distance \_\_\_\_\_

Other Evidence

Describe evidence of use and occupation such as roads, fences, clearings, timber cutting lines, plantations, etc.. Cite source of testimony if any.

**FSLP ON N. PINE 13" ON EAST SIDE OF FR. 3801 - COR. IS 165' EAST OF TAG**

**EVIDENCE OF ORIG. BT'S STILL VISIBLE**

**N. PINE STUB 4' HIGH AT S9W-15.84' - NO SCRIBE VISIBLE**  
**N. PINE STP. 2' HIGH AT N65W-13.86' - NO SCRIBE VISIBLE**  
**N. PINE STP. 1' HIGH AT N53E-19.80' - NO SCRIBE VISIBLE**

Perpetuation Record

Monument and accessories established. Include brief description of area.

**MARKED NEW BT**

**N. PINE 13 S50W - 32.23' AND S15 BT**

**8' STEEL SIGN POST EAST 3.20'**

At time of search:

1. Did you have the record description?

Yes  No \_\_\_\_\_

2. How was search area located?

Pacing, chaining, photos, maps, etc. \_\_\_\_\_

3. Man hours spent in search \_\_\_\_\_

4. Do you think additional search might recover evidence? Yes \_\_\_\_\_ No \_\_\_\_\_

Certified corner restoration certificate prepared: Yes \_\_\_\_\_ No \_\_\_\_\_

Filed in county records of \_\_\_\_\_ Date \_\_\_\_\_ County Document No. \_\_\_\_\_

Identified on aerial photo No. \_\_\_\_\_ Which is filed at \_\_\_\_\_

Signature Curt Kramer

Index No. J-25  
(Alphabetical - Numerical)LAND CORNER RECORD  
(RECTANGULAR SURVEYS)

R9-7150-4 (Rev. 6/13/67)

GPO 502-127

T. 147 R. 27 Mer. N.F. CHIPPWA County ITASCA State MW  
SEC. CORNER Corner common to sections 12 13 19 and 7  
147-27 -147-26

## EXISTING SURVEYS

## Original Government Survey

Year surveyed \_\_\_\_\_

Original monument \_\_\_\_\_  
(Wood post, stone, pile of stones, post, etc.)

## Bearing Trees

Species \_\_\_\_\_

Diameter \_\_\_\_\_

Bearing \_\_\_\_\_

Distance \_\_\_\_\_

## Original Evidence Found

Year of search 1936 By CLO

Monument found \_\_\_\_\_

## Original Bearing Trees Found

Species R. Pine J. Pine R. PineDiameter 36" Stump 4' high 36"Bearing N60°E S35°E N.57.5°WDistance 75.24' 51.48' 21.12'

## Subsequent Corner Restoration

Year surveyed 1936 By CLO

Where filed or recorded \_\_\_\_\_

Monument Concrete with BRASS CAP  
(Original, concrete post, iron rod, etc.)

## Evidence of Subsequent Corner Restoration Found

Year of search 1964 By R.A. McDonaldSpecies J. Pine W. Pine Bearing Trees, Reference ObjectsDiameter 10" 14"Bearing S92°E S24°WDistance 17.82' 35.64'

## Bearing Trees, Reference Objects

Species R. Pine R. Pine J. Pine W. PineDiameter Stump 32" (36") Stump 22"Bearing N60°E N.57.5°W S.92°E S.24°WDistance 75.24' 21.12' 17.82' 35.64'

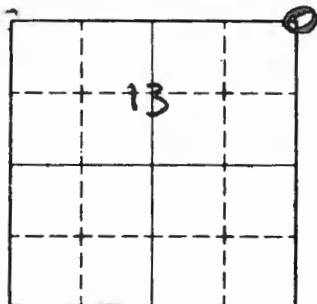

Sketch

○ Corner    ▨ F.S. Land

Relation of Evidence to Record Features Along Section Lines

Section line to sections \_\_\_\_\_  
 Object \_\_\_\_\_  
 Record distance \_\_\_\_\_  
 Measured distance \_\_\_\_\_

Other Evidence

Describe evidence of use and occupation such as roads, fences, clearings, timber cutting lines, plantations, etc.. Cite source of testimony if any. 11-78

Found NORWAY PINE N 57 1/2° W (21.12') DEAD  
WHITE PINE S 24° W (35.64') GOOD SHAPE  
NEEDS NEW B.T.'S

At time of search:

1. Did you have the record description?

Yes \_\_\_\_\_ No \_\_\_\_\_

2. How was search area located?

Pacing, chaining, photos, maps, etc. \_\_\_\_\_

3. Man hours spent in search \_\_\_\_\_

4. Do you think additional search might recover evidence? Yes  No \_\_\_\_\_

5. Signature

*Jim Schwonke*

Perpetuation Record

Monument and accessories established. Include brief description of area. \_\_\_\_\_

LINE MARKED TO STANDARD TO THE S.

11-26-78 T. Stamer Made one new B.T.

R. Pine  
15"  
N 68° E  
12.1

Certified corner restoration certificate prepared: Yes \_\_\_\_\_ No \_\_\_\_\_

Filed in county records at \_\_\_\_\_ Date \_\_\_\_\_ County Document No. \_\_\_\_\_

Identified on aerial photo No. \_\_\_\_\_ Which is filed at \_\_\_\_\_



Index No. L-25  
(Alphabetical - Numerical)

LAND CORNER RECORD  
(RECTANGULAR SURVEYS)

R9-7150-4 (Rev. 6/13/67)  
GPO 802-127

T. 147 N. 27 Mer. N.F. C. NIDOWA County ITASEA State MN  
Lucas Corner common to sections 13 and 18

EXISTING SURVEYS

616

Original Government Survey

Year surveyed 1936  
Original monument Iron post Brass cap  
(Wood post, stone, pile of stones, pipe, etc.)

Bearing Trees

Species TAM TAM  
Diameter 10" 6"  
Bearing S31 1/2° E N21 1/4° W  
Distance 17.2' 33'

Subsequent Corner Restoration

Year surveyed 1970 By R. McDonald  
Where filed or recorded \_\_\_\_\_  
Monument ---  
(Original, concrete post, iron rod, etc.)

Bearing Trees, Reference Objects

Species CROAK  
Diameter ---  
Bearing N11° W  
Distance 17.3'

Original Evidence Found

Year of search 1970 By R. McDonald  
Monument found Iron post Brass cap

Original Bearing Trees Found

Species TAM TAM  
Diameter 10" Stump  
Bearing S31 1/2° E N21 1/4° W  
Distance 17.2' 33'

Evidence of Subsequent Corner Restoration Found

Year of search 1979 By Jim Sch...

Bearing Trees, Reference Objects

Species CROAK TAM  
Diameter 7" 10"  
Bearing N11° W S31 1/2° E  
Distance 17.3 17.2'

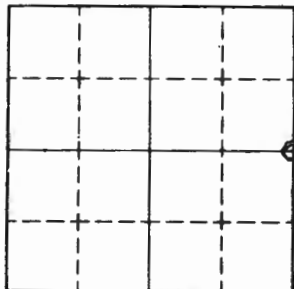

Sketch

○ Corner    ▨ F.S. Land

Relation of Evidence to Record Features Along Section Lines

Section line to sections \_\_\_\_\_

Object \_\_\_\_\_

Record distance \_\_\_\_\_

Measured distance \_\_\_\_\_

Other Evidence

Describe evidence of use and occupation such as roads, fences, clearings, timber cutting lines, plantations, etc.. Cite source of testimony if any. \_\_\_\_\_

NEEDS NEW BT

At time of search:

1. Did you have the record description?

Yes \_\_\_\_\_ No \_\_\_\_\_

2. How was search area located?

Pacing, chaining, photos, maps, etc. \_\_\_\_\_

3. Man hours spent in search \_\_\_\_\_

4. Do you think additional search might recover evidence? Yes  No \_\_\_\_\_

5. Signature \_\_\_\_\_

Perpetuation Record

Monument and accessories established. Include brief description of area. \_\_\_\_\_

Certified corner restoration certificate prepared: Yes \_\_\_\_\_ No \_\_\_\_\_

Filed in county records at \_\_\_\_\_ Date \_\_\_\_\_ County Document No. \_\_\_\_\_

Identified on aerial photo No. \_\_\_\_\_ Which is filed at \_\_\_\_\_

Index No. N-5  
(Alphabetical - Numerical)BOOK 1  
Pg. 35LAND CORNER RECORD  
(RECTANGULAR SURVEYS)R9-7150-4 (Rev. 6/15/67)  
GPO 802-127T. 147 R. 27 S Mer. N.F. CHIPPEWA County ITASCA State MN.  
SECTION Corner common to sections 17, 18, 19 and 20

## EXISTING SURVEYS

## Original Government Survey

Year surveyed 1874 P. H. CONGER  
Original monument WOOD POST  
(Wood post, stone, pile of stones, pipe, etc.)

## Bearing Trees

Species	<u>N. PINE STUB</u>	<u>J. PINE STUB</u>	<u>J. PINE</u>	<u>PINE STUB</u>
Diameter	<u>10</u>	<u>8</u>	<u>8</u>	<u>8</u>
Bearing	<u>N44E</u>	<u>NS1W</u>	<u>S45W</u>	<u>S57E</u>
Distance	<u>40 LKS.</u>	<u>35 LKS.</u>	<u>110 LKS.</u>	<u>42 LKS.</u>
	<u>26.40'</u>	<u>23.10'</u>	<u>72.60'</u>	<u>27.72'</u>

## Subsequent Corner Restoration

Year surveyed 1936 By GLO RESURVEY  
Where filed or recorded ON FILE  
Monument SET CONCRETE CYLINDER w/ CAP MKD  
(Original, concrete post, iron rod, etc.)

## Bearing Trees, Reference Objects

Species	<u>N. PINE</u>	<u>W. PINE</u>	<u>N. PINE</u>	<u>W. PINE</u>
Diameter	<u>14</u>	<u>5</u>	<u>16</u>	<u>8</u>
Bearing	<u>N48½E</u>	<u>S26½E</u>	<u>S70¼E</u>	<u>N9½W</u>
Distance	<u>61 LKS.</u>	<u>24 LKS.</u>	<u>50 LKS.</u>	<u>44 LKS.</u>
	<u>40.26'</u>	<u>15.84'</u>	<u>33.0'</u>	<u>29.04'</u>

## Original Evidence Found

Year of search \_\_\_\_\_ By \_\_\_\_\_  
Monument found \_\_\_\_\_

## Original Bearing Trees Found

Species \_\_\_\_\_  
Diameter \_\_\_\_\_  
Bearing \_\_\_\_\_  
Distance \_\_\_\_\_

## Evidence of Subsequent Corner Restoration Found

Year of search 9-29-94 By CK  
FD. CONCRETE CYLINDER - CAP 3" ABOVE GRD.  
IN THICK BRUSH AND SCATTERED N. PINE  
COR. IS 30' WEST OF FR 3865 AND 350' N  
OF COUNTY ROAD 33

## Bearing Trees, Reference Objects

Species	<u>N. PINE</u>	<u>PINE STP.</u>	<u>PINE STP.</u>	<u>FALLS</u>
Diameter	<u>24.5"</u>	<u>ROTTED</u>	<u>ROTTED</u>	<u>IN</u>
Bearing	<u>S20W</u>	<u>N9W</u>	<u>S26 E</u>	<u>ROAD</u>
Distance	<u>32.75'</u>	<u>29.0'</u>	<u>15.8'</u>	<u>CLEARING</u>
	<u>SCAR TO COR.</u>			

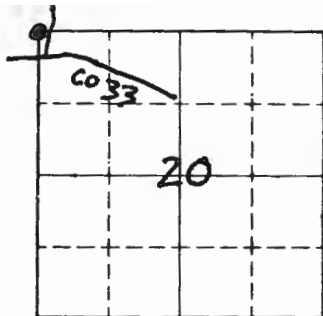

Sketch

○ Corner    ▨ F.S. Land

Relation of Evidence to Record Features Along Section Lines

Section line to sections \_\_\_\_\_  
 Object \_\_\_\_\_  
 Record distance \_\_\_\_\_  
 Measured distance \_\_\_\_\_

Other Evidence

Describe evidence of use and occupation such as roads, fences, clearings, timber cutting lines, plantations, etc.. Cite source of testimony if any. \_\_\_\_\_

30° WEST OF FR 3865  
350' NORTH OF COUNTY ROAD 33

At time of search:

1. Did you have the record description?

Yes  No \_\_\_\_\_

2. How was search area located?

Pacing, choining photos, maps  
 etc. \_\_\_\_\_

3. Man hours spent in search 2 HRS.

4. Do you think additional search might recover evidence? Yes \_\_\_\_\_ No \_\_\_\_\_

5. Signature Curt Kramer

Perpetuation Record

Monument and accessories established. Include brief description of area. \_\_\_\_\_

MARKED NEW BT's.  
N. PINE 21 S42E - 18.95' MKD S20 BT  
N. PINE 23 N78W - 17.41' MKD S18 BT  
N. PINE 21 N10W - 41.86' MKD S18 BT

8' STEEL SIGN POST WEST 3.8'  
6" SCRIBED POST NEXT TO COR. - STOOD UP

Certified corner restoration certificate prepared: Yes \_\_\_\_\_ No \_\_\_\_\_

Filed in county records at \_\_\_\_\_ Date \_\_\_\_\_ County Document No. \_\_\_\_\_

Identified on aerial photo No. \_\_\_\_\_ Which is filed at \_\_\_\_\_

T. 147 R. 27 S Mer. N.F. CHIPPEWA County ITASCA State MN.  
QUARTER BET. Corner common to sections \_\_\_\_\_, \_\_\_\_\_, 17 and 20

## EXISTING SURVEYS

Original Government Survey		Original Evidence Found	
Year surveyed <u>1874</u>	<u>P. H. CONGER</u>	Year of search _____	By _____
Original monument <u>WOOD POST</u> <small>(Wood post, stone, pile of stones, pipe, etc.)</small>		Monument found _____	
		<u>LOCAL BT</u>	
Bearing Trees		Original Bearing Trees Found	
Species <u>MAPLE</u>	<u>OAK</u>	Species <u>W. OAK</u>	
Diameter <u>6</u>	<u>18</u>	Diameter <u>18</u>	
Bearing <u>S42W</u>	<u>N40E</u>	Bearing <u>N44<sup>3</sup>/<sub>4</sub>E</u>	
Distance <u>20 LKS.</u>	<u>10 LKS.</u>	Distance <u>17 LKS.</u>	
<u>13.20'</u>	<u>6.6'</u>	<u>11.2'</u>	
Subsequent Corner Restoration		Evidence of Subsequent Corner Restoration Found	
Year surveyed <u>1936</u>	By <u>GLO RESURVEY</u>	Year of search <u>9-22-94</u>	By <u>CK</u>
Where filed or recorded <u>ON FILE</u>		<u>FD. IRON + CAP - IN PLACE - BENT OVER</u>	
Monument <u>SET 1" X 36" IRON POST w/ CAP MKS.</u> <small>(Original, concrete post, iron rod, etc.)</small>		<u>STRAIGHTEN TO STAND UPRIGHT - IN THICK</u>	
	<u>1/4 S17</u>	<u>BRUSH AND HARDWOODS - COR. IS 194' EAST</u>	
	<u>S20</u>	<u>OF FR 2379 + 214' SOUTH OF COUNTY ROAD</u>	
	<u>1936</u>	<u>33 - FSLP ON 10" N. PINE W SIDE OF FR 2379</u>	
Bearing Trees, Reference Objects		Bearing Trees, Reference Objects	
Species <u>ELM</u>	<u>ASH</u>	<u>SNAG</u> <u>ELM</u>	<u>ASH WINDFALL</u>
Diameter <u>6</u>	<u>5</u>	<u>10</u>	<u>WELL ROTTED</u>
Bearing <u>N48<sup>3</sup>/<sub>4</sub>E</u>	<u>S40E</u>	<u>N49E</u>	<u>S40E</u>
Distance <u>104 LKS.</u>	<u>59 LKS.</u>	<u>68.6'</u>	<u>38.9'</u>
<u>68.64'</u>	<u>38.94'</u>	<u>OLD TAG</u>	<u>OLD TAG</u>

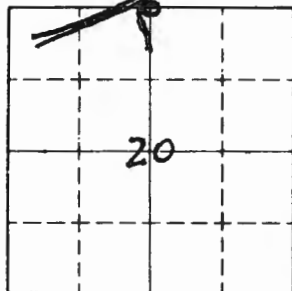

Sketch

○ Corner    ▨ F.S. Land

Relation of Evidence to Record Features Along Section Lines

Section line to sections \_\_\_\_\_  
 Object \_\_\_\_\_  
 Record distance \_\_\_\_\_  
 Measured distance \_\_\_\_\_

Other Evidence

Describe evidence of use and occupation such as roads, fences, clearings, timber cutting lines, plantations, etc.. Cite source of testimony if any.

FSLP ON 10" N. PINE ON WEST SIDE OF FR 2379  
COR. IS 194' EAST OF TAG  
215' SOUTH OF COUNTY ROAD #33

BLAZED 14" W. OAK E + W + N SIDE - THIS TREE IS  
139' WEST OF CORNER.

At time of search:

1. Did you have the record description?

Yes  No \_\_\_\_\_

2. How was search area located?

Pacing, chaining, photos maps,  
 etc. \_\_\_\_\_

3. Man hours spent in search 1 1/2 hrs.

4. Do you think additional search might  
 recover evidence? Yes \_\_\_\_\_ No \_\_\_\_\_

5. Signature Curt Keane

Perpetuation Record

Monument and accessories established. Include brief description of area.

MARKED NEW BT'S.

W. OAK 9 SBW - 41.75' MKD 1/4 S20 BT  
W. OAK 16 S8SW - 76.05' " 1/4 S20 BT  
W. OAK 12.5 NTE - 114.50' " 1/4 S17 BT

8' STEEL SIGN POST EAST 3.3'

LARGE W. OAK WINDFALL NISE 11.2' DECAYING

Certified corner restoration certificate prepared: Yes \_\_\_\_\_ No \_\_\_\_\_

Filed in county records at \_\_\_\_\_ Date \_\_\_\_\_ County Document No. \_\_\_\_\_

Identified on aerial photo No. \_\_\_\_\_ Which is filed at \_\_\_\_\_

T. 147 R. 27 5TH Mer. N.F. CHIPPewa County ITASCA State MN  
SECTION Corner common to sections 16, 17, 20 and 21

## EXISTING SURVEYS

## Original Government Survey

Year surveyed 1873  
Original monument WOOD POST  
(Wood post, stone, pile of stones, pipe, etc.)

## Bearing Trees

Species	R. PINE	R. PINE	R. PINE	R. PINE
Diameter	<u>18</u>	<u>18</u>	<u>12</u>	<u>14</u>
Bearing	<u>S41/2E</u>	<u>S54W</u>	<u>N48E</u>	<u>N54W</u>
Distance	<u>52 lks</u>	<u>70 lks</u>	<u>40 lks</u>	<u>42 lks</u>

## Subsequent Corner Restoration

Year surveyed 1927 By GLO.  
Where filed or recorded \_\_\_\_\_  
Monument 6" X 26" CONCRETE MONUMENT  
(Original: concrete post, iron rod, etc.)  
W/ 3" BRASS CAP.

## Bearing Trees, Reference Objects

Species	W. PINE	R. PINE	R. PINE	R. PINE
Diameter	<u>8"</u>	<u>6</u>	<u>10</u>	<u>5</u>
Bearing	<u>N21E</u>	<u>S62E</u>	<u>S25W</u>	<u>N75W</u>
Distance	<u>75 lks</u>	<u>226 lks</u>	<u>185 lks</u>	<u>105 lks</u>

## Original Evidence Found

Year of search 1927 By GLO  
Monument found \_\_\_\_\_

## Original Bearing Trees Found

Species	R. PINE	R. PINE	R. PINE	R. PINE
Diameter	<u>16</u>	<u>20</u>	<u>24</u>	<u>16</u>
Bearing	<u>N45E</u>	<u>S38E</u>	<u>S53W</u>	<u>N48W</u>
Distance	<u>40 lks</u>	<u>52 lks</u>	<u>63 lks</u>	<u>42 lks</u>

## Evidence of Subsequent Corner Restoration Found

Year of search 1989 By R. MAINCKRAUSE-G. BRANN  
FD GLO MONUMENT IN GOOD CONDITION  
± 25' SOUTH OF & FR 2198. A  
4X4 WOOD POST IS 6" NE OF CORNER

## Bearing Trees, Reference Objects

Species	GLO. R. PINE	GLO. R. PINE	GLO. W. PINE	R. PINE
Diameter	<u>19</u>	<u>13"</u>	<u>25"</u>	<u>13"</u>
Bearing	<u>S25W</u>	<u>N75W</u>	<u>N21E</u>	<u>S80E</u>
Distance	<u>122.10</u>	<u>67.98</u>	<u>49.62</u>	<u>45.60</u>

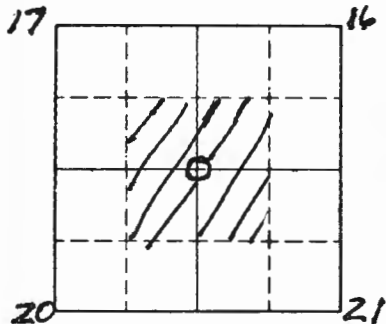

Sketch

○ Corner    ▨ F.S. Land

Relation of Evidence to Record Features Along Section Lines

Section line to sections \_\_\_\_\_  
 Object \_\_\_\_\_  
 Record distance \_\_\_\_\_  
 Measured distance \_\_\_\_\_

Other Evidence

Describe evidence of use and occupation such as roads, fences, clearings, timber cutting lines, plantations, etc.. Cite source of testimony if any. \_\_\_\_\_

At time of search:

1. Did you have the record description?

Yes \_\_\_\_\_ No \_\_\_\_\_

2. How was search area located?

Pacing, chaining, photos, maps, etc. \_\_\_\_\_

3. Man hours spent in search \_\_\_\_\_

4. Do you think additional search might recover evidence? Yes \_\_\_\_\_ No \_\_\_\_\_

5. Signature \_\_\_\_\_

Perpetuation Record

Monument and accessories established. Include brief description of area. \_\_\_\_\_

Certified corner restoration certificate prepared: Yes \_\_\_\_\_ No \_\_\_\_\_

Filed in county records at \_\_\_\_\_ Date \_\_\_\_\_ County Document No. \_\_\_\_\_

Identified on aerial photo No. \_\_\_\_\_ Which is filed at \_\_\_\_\_



Index No. N-19  
(Alphabetical - Numerical)

**BOOK 1**  
 Pg. 79

**LAND CORNER RECORD**  
(RECTANGULAR SURVEYS)

R9-7150-4 (Rev. 6/13/67)  
 GPO 902-127

T. 147 R. 27 S. Mer. N.F. CHIPPEWA County ITASCA State MN.  
QUARTER BET. Corner common to sections 14 and 23

**EXISTING SURVEYS**

**Original Government Survey**  
 Year surveyed 1874 P.H. CONGER  
 Original monument WOOD POST  
(Wood post, stone, pile of stones, pipe, etc.)

**Bearing Trees**

Species <u>N. PINE</u>	<u>N. PINE</u>
Diameter <u>12</u>	<u>14</u>
Bearing <u>N19W</u>	<u>SIDE</u>
Distance <u>13 Lks.</u>	<u>40 Lks.</u>
<u>8.58'</u>	<u>26.40'</u>

**Original Evidence Found**  
 Year of search \_\_\_\_\_ By \_\_\_\_\_  
 Monument found \_\_\_\_\_

**Original Bearing Trees Found**

Species _____	_____
Diameter _____	_____
Bearing _____	_____
Distance _____	_____

**Subsequent Corner Restoration**  
 Year surveyed 1936 By GLO RESURVEY  
 Where filed or recorded ON FILE  
 Monument SET 1" X 36" IRON POST-CAP MKD.  
(Original, concrete post, iron rod, etc.)

1/4 514  
523  
1936

**Evidence of Subsequent Corner Restoration Found**  
 Year of search 10-18-94 By RM+CK  
NO GLO IRON COULD BE LOCATED IN ROAD  
SET NEW MONUMENT FROM GLO BT  
IN CENTER OF COUNTY ROAD 33  
NEW MONUMENT 12" BELOW ROAD  
MAGNETIC PELLET 3.6' BELOW ROAD

**Bearing Trees, Reference Objects**

Species <u>J. PINE</u>	<u>N. PINE</u>
Diameter <u>6</u>	<u>24</u>
Bearing <u>S32 3/4 E</u>	<u>N0°15' W</u>
Distance <u>29 Lks.</u>	<u>79 Lks.</u>
<u>19.14'</u>	<u>52.14'</u>

**Bearing Trees, Reference Objects**

<u>N. PINE</u>	_____
<u>27</u>	_____
<u>NORTH</u>	_____
<u>52.14'</u>	_____

SCRIBE INSIDE

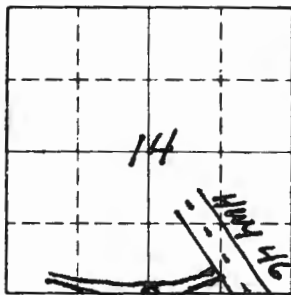

Sketch

○ Corner    ▨ F.S. Land

Relation of Evidence to Record Features Along Section Lines

Section line to sections \_\_\_\_\_  
 Object \_\_\_\_\_  
 Record distance \_\_\_\_\_  
 Measured distance \_\_\_\_\_

Other Evidence

Describe evidence of use and occupation such as roads, fences, clearings, timber cutting lines, plantations, etc.. Cite source of testimony if any. \_\_\_\_\_

CORNER IN CENTER OF COUNTY ROAD # 33

At time of search:

1. Did you have the record description?

Yes  No \_\_\_\_\_

2. How was search area located?

Pacing, gaining, photos, maps,

etc. \_\_\_\_\_

3. Man hours spent in search 1 1/2 hrs.

4. Do you think additional search might recover evidence? Yes \_\_\_\_\_ No \_\_\_\_\_

5. Signature Curt Kramer

SET 2" X 24" IRON PIPE WITH BRASS CAP MARKED  
 MAS PELLET BELOW 2" IRON - 3.6 DOWN T147N R27W  
 CAP 12" BELOW SURFACE OF ROAD

Perpetuation Record

Monument and accessories established. Include brief description of area

MARKED NEW BT's.

N. PINE 17 S44E - 52.22' MKD 1/4 S23 BT

N. PINE 13 S18W - 44.90 MKD 1/4 S23 BT

GLO N. PINE 27 NORTH S2.14' TAG & SPK

Certified corner restoration certificate prepared: Yes \_\_\_\_\_ No \_\_\_\_\_

Filed in county records at \_\_\_\_\_ Date \_\_\_\_\_ County Document No. \_\_\_\_\_

Identified on aerial photo No. \_\_\_\_\_ Which is filed at \_\_\_\_\_

Index No. N 21  
(Alphabetical - Numerical)

*BOOK # 1*  
*PAGE # 19*

LAND CORNER RECORD  
(RECTANGULAR SURVEYS)

T. 147N R. 27W Sec. 5th Mer. N.F. Chippewa County Itasca State Minnesota  
section Corner common to sections 14, 13, 23 and 24

EXISTING SURVEYS

Original Government Survey

Year surveyed \_\_\_\_\_  
Original monument \_\_\_\_\_  
(Wood post, stone, pile of stones, pipe, etc.)

Bearing Trees

Species \_\_\_\_\_  
Diameter \_\_\_\_\_  
Bearing \_\_\_\_\_  
Distance \_\_\_\_\_

Original Evidence Found

Year of search \_\_\_\_\_ By \_\_\_\_\_  
Monument found \_\_\_\_\_

Original Bearing Trees Found

Species \_\_\_\_\_  
Diameter \_\_\_\_\_  
Bearing \_\_\_\_\_  
Distance \_\_\_\_\_

Subsequent Corner Restoration

Year surveyed 1936 By G.L.O.  
Where filed or recorded \_\_\_\_\_  
Monument concrete mon. with brass  
(Original: concrete post, iron rod, etc.)  
cap stamped: T147N R27W  
S14 | S13  
S23 | S24

Evidence of Subsequent Corner Restoration Found

Year of search \_\_\_\_\_ By \_\_\_\_\_  
\_\_\_\_\_  
\_\_\_\_\_  
\_\_\_\_\_

Bearing Trees, Reference Objects 1936

Species	<u>N. Pine</u>	<u>N. Pine</u>	<u>J. Pine</u>	<u>N. Pine</u>
Diameter	<u>17"</u>	<u>5"</u>	<u>5"</u>	<u>26"</u>
Bearing	<u>N45°E</u>	<u>S31°E</u>	<u>S21½°W</u>	<u>N83½°W</u>
Distance	<u>67 lks.</u>	<u>13 lks.</u>	<u>13 lks.</u>	<u>145 lks.</u>

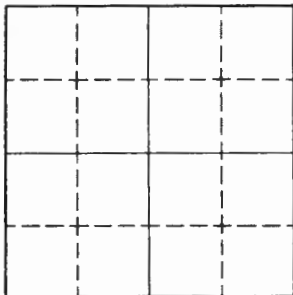

Sketch

○ Corner    ▨ F.S. Land

Relation of Evidence to Record Features Along Section Lines

Section line to sections \_\_\_\_\_  
Object \_\_\_\_\_  
Record distance \_\_\_\_\_  
Measured distance \_\_\_\_\_

Other Evidence

Describe evidence of use and occupation such as roads, fences, clearings, timber cutting lines, plantations, etc.. Cite source of testimony if any. \_\_\_\_\_  
\_\_\_\_\_  
\_\_\_\_\_  
\_\_\_\_\_  
\_\_\_\_\_

At time of search:

1. Did you have the record description?

Yes \_\_\_\_\_ No \_\_\_\_\_

2. How was search area located?

Pacing, chaining, photos, maps, etc. \_\_\_\_\_  
\_\_\_\_\_  
\_\_\_\_\_

3. Man hours spent in search \_\_\_\_\_

4. Do you think additional search might recover evidence? Yes \_\_\_\_\_ No \_\_\_\_\_

5. Signature \_\_\_\_\_

Perpetuation Record

Monument and accessories established. Include brief description of area. \_\_\_\_\_  
\_\_\_\_\_  
\_\_\_\_\_  
\_\_\_\_\_  
\_\_\_\_\_

Certified corner restoration certificate prepared: Yes \_\_\_\_\_ No \_\_\_\_\_

Filed in county records at \_\_\_\_\_ Date \_\_\_\_\_ County Document No. \_\_\_\_\_

Identified on aerial photo No. \_\_\_\_\_ Which is filed at \_\_\_\_\_

LAND CORNER RECORD  
(RECTANGULAR SURVEYS)

R9-7150-4 (Rev. 6/15/67)

GPO 808-127

T. 147 R. 27 5TH Mer. N.F. CHIPPENAWA County ITASCA State MN  
Y4 CORNER Corner common to sections 13, 24 and \_\_\_\_\_

EXISTING SURVEYS

Original Government Survey	Original Evidence Found
Year surveyed _____ Original monument _____ <small>(Wood post, stone, pile of stones, pipe, etc.)</small>	Year of search _____ By _____ Monument found _____
<p style="text-align: center;">Bearing Trees</p> Species _____ Diameter _____ Bearing _____ Distance _____	<p style="text-align: center;">Original Bearing Trees Found</p> Species _____ Diameter _____ Bearing _____ Distance _____
<p style="text-align: center;">Subsequent Corner Restoration</p> Year surveyed <u>1977</u> By _____ Where filed or recorded <u>50</u> Monument <u>6.60 brass cap</u> <small>(Original, concrete post, iron rod, etc.)</small>	<p style="text-align: center;">Evidence of Subsequent Corner Restoration Found</p> Year of search <u>1983</u> By _____ _____ _____
<p style="text-align: center;">Bearing Trees, Reference Objects</p> Species <u>Cedar</u> <u>E. Spruce</u> <u>Cedar</u> Diameter <u>6"</u> <u>3"</u> <u>4"</u> Bearing <u>S41°E</u> <u>S31°W</u> <u>N40°W</u> Distance <u>-</u> <u>40.0'</u> <u>63.0'</u>	<p style="text-align: center;">Bearing Trees, Reference Objects</p> Species <u>T</u> <u>4</u> <u>6</u> Diameter <u>5.41°E</u> <u>4</u> <u>N40°W</u> Bearing <u>43.0'</u> <u>4</u> <u>63.0'</u> Distance _____

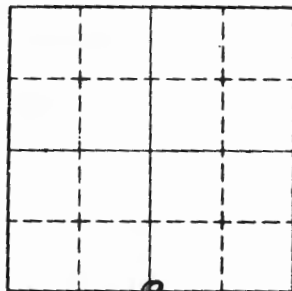

Sketch

○ Corner    ▨ F.S. Land

At time of search:

1. Did you have the record description?

Yes  No

2. How was search area located?

Pacing, chaining, photos, maps,  
etc.

3. Man hours spent in search \_\_\_\_\_

4. Do you think additional search might  
recover evidence? Yes  No

5. Signature J. Schoanover

Relation of Evidence to Record Features Along Section \_\_\_\_\_

Section line to sections \_\_\_\_\_

Object \_\_\_\_\_

Record distance \_\_\_\_\_

Measured distance \_\_\_\_\_

Other Evidence

Describe evidence of use and occupation such as roads, fences, clearings, timber cutting lines, plantations, etc.. Cite source of testimony if any. \_\_\_\_\_

Perpetuation Record

Monument and accessories established. Include brief description of area. \_\_\_\_\_

Set Steel Sign Post 12.2' E of Brass Cap

Certified corner restoration certificate prepared: Yes  No

Filed in county records at \_\_\_\_\_ Date \_\_\_\_\_ County Document No. \_\_\_\_\_

Identified on aerial photo No. \_\_\_\_\_ Which is filed at \_\_\_\_\_

Index No. N-23  
(Alphabetical - Numerical)

**BOOK # 1**  
**PAGE # 18** LAND CORNER RECORD  
(RECTANGULAR SURVEYS)

T. 147N R. 27W 5th Mer. N.F. Chippewa County Itasca State Minnesota  
Quarter Corner common to sections 13 24 and

EXISTING SURVEYS

Original Government Survey

Year surveyed \_\_\_\_\_  
Original monument \_\_\_\_\_  
(Wood post, stone, pile of stones, pipe, etc.)

Bearing Trees

Species \_\_\_\_\_  
Diameter \_\_\_\_\_  
Bearing Dead cut!  
Distance \_\_\_\_\_

Original Evidence Found

Year of search \_\_\_\_\_ By \_\_\_\_\_  
Monument found \_\_\_\_\_

Original Bearing Trees Found

Species \_\_\_\_\_  
Diameter \_\_\_\_\_  
Bearing \_\_\_\_\_  
Distance \_\_\_\_\_

Subsequent Corner Restoration

Year surveyed 1936 By G.L.O.  
Where filed or recorded \_\_\_\_\_  
Monument Iron post with brass  
(Original, concrete post, iron rod, etc.)  
cap stamped: 1/4 S13  
S24  
1936

Bearing Trees, Reference Objects

Species	<u>Tamarack</u>	<u>Tamarack</u>	<u>Spruce</u>
Diameter	<u>5"</u>	<u>5"</u>	<u>6"</u>
Bearing	<u>N30 3/4°E</u>	<u>S84 1/2°E</u>	<u>N41°W</u>
Distance	<u>50 lks.</u>	<u>62 lks.</u>	<u>47 lks.</u>

Evidence of Subsequent Corner Restoration Found

Year of search 1970 By R.H. McDonald  
Found 1" φ iron post  
with brass cap mksd.:- 1/4 S13  
S24  
1936

<u>Tamarack (Dead)</u>	<u>Tamarack stub</u>
<u>5"</u>	<u>5"</u>
<u>N33°E</u>	<u>S84°E</u>
<u>33.8'</u>	<u>40.9'</u>

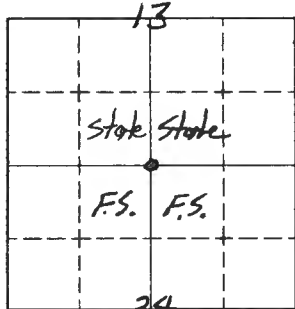

Sketch

○ Corner    ▨ F.S. Land

Relation of Evidence to Record Features Along Section Lines

Section line to sections \_\_\_\_\_  
 Object \_\_\_\_\_  
 Record distance \_\_\_\_\_  
 Measured distance \_\_\_\_\_

Other Evidence

Describe evidence of use and occupation such as roads, fences, clearings, timber cutting lines, plantations, etc.. Cite source of testimony if any. \_\_\_\_\_  
 \_\_\_\_\_  
 \_\_\_\_\_  
 \_\_\_\_\_

At time of search:

1. Did you have the record description?

Yes  No \_\_\_\_\_

2. How was search area located?

Pacing, chaining, photos, maps,  
 etc. \_\_\_\_\_  
 \_\_\_\_\_

3. Man hours spent in search 1

4. Do you think additional search might recover evidence? Yes \_\_\_\_\_ No \_\_\_\_\_

5. Signature BA McDonald

Perpetuation Record

Monument and accessories established. Include brief description of area. \_\_\_\_\_

Cedar 6" S41°E 33.0'  
Black spruce 8" S39°W 40.8'  
Cedar 7" N40°W 63.0'

Certified corner restoration certificate prepared: Yes \_\_\_\_\_ No \_\_\_\_\_

Filed in county records at \_\_\_\_\_ Date \_\_\_\_\_ County Document No. \_\_\_\_\_

Identified on aerial photo No. \_\_\_\_\_ Which is filed at \_\_\_\_\_



Index No. P-17  
(Alphabetical - Numerical)

BOOK 1  
Pg. 51

LAND CORNER RECORD  
(RECTANGULAR SURVEYS)

R9-7150-4 (Rev. 6/13/67)  
GPO 502-127

T. 147 R. 27 S Mer. N.F. CHIPPEWA County ITASCA State MN.  
QUARTER BET. Corner common to sections 22 and 23

EXISTING SURVEYS

Original Government Survey

Year surveyed 1874 P. H. CONGER

Original monument WOOD POST  
(Wood post, stone, pile of stones, pipe, etc.)

Bearing Trees

Species <u>N. PINE</u>	<u>N. PINE</u>
Diameter <u>20</u>	<u>10</u>
Bearing <u>S88W</u>	<u>N85E</u>
Distance <u>50 LKS.</u>	<u>60 LKS.</u>

Original Evidence Found

Year of search 1936 By GLO RESURVEY

Monument found \_\_\_\_\_

Original Bearing Trees Found

Species <u>DEAD N. PINE</u>	<u>PINE STP HOLE</u>
Diameter <u>18</u>	
Bearing <u>S56 1/2 E</u>	<u>N36E</u>
Distance <u>40 LKS.</u>	<u>25 LKS.</u>
<u>26.40'</u>	<u>16.5'</u>

Subsequent Corner Restoration

Year surveyed 1936 By GLO RESURVEY

Where filed or recorded ON FILE

Monument SET 1" X 36" IRON POST W/CAP MARKED  
(Original, concrete post, iron rod, etc.)

1/4  
S22 | S33

Evidence of Subsequent Corner Restoration Found

Year of search 10-5-94 By RM-CK

Fd. IRON+CAP - IN PLACE - 8" ABOVE GRD.  
IN THICK BRUSH + N. PINE - HARDWOODS TO  
N + E - FSLP ON 20" N. PINE NORTH SIDE  
OF FR 3241 - COR. IS 280' NORTH OF TAG

Bearing Trees, Reference Objects

Species <u>J. PINE</u>	<u>N. PINE</u>
Diameter <u>5</u>	<u>16</u>
Bearing <u>S74 1/2 E</u>	<u>N30 1/2 W</u>
Distance <u>16 LKS.</u>	<u>85 LKS.</u>
<u>10.56'</u>	<u>56.10'</u>

Bearing Trees, Reference Objects

<u>J. PINE</u>	<u>N. PINE</u>
<u>STUMP</u>	<u>24</u>
<u>S74E</u>	<u>N30W</u>
<u>10.56'</u>	<u>56.10'</u>

SCRIBE SURFACE ONLY      SCAR TO COR.

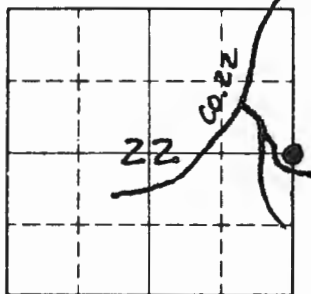

Sketch

○ Corner    ▨ F.S. Land

Relation of Evidence to Record Features Along Section Lines

Section line to sections \_\_\_\_\_  
 Object \_\_\_\_\_  
 Record distance \_\_\_\_\_  
 Measured distance \_\_\_\_\_

Other Evidence

Describe evidence of use and occupation such as roads, fences, clearings, timber cutting lines, plantations, etc.. Cite source of testimony if any. \_\_\_\_\_

FSLP ON 20" N. PINE ON NORTH SIDE OF FR 3241  
CORNER IS 280' NORTH OF TAG

At time of search:

1. Did you have the record description?

Yes  No \_\_\_\_\_

2. How was search area located?

Pacing, staining, photos, maps  
 etc. \_\_\_\_\_

3. Man hours spent in search 1 1/2 HRS.

4. Do you think additional search might recover evidence? Yes \_\_\_\_\_ No \_\_\_\_\_

5. Signature C. Kramer

Perpetuation Record

Monument and accessories established. Include brief description of area. \_\_\_\_\_

MARKED NEW BT's.  
N. PINE 9 S74E - 25.31' MKD 1/4 S23 BT  
N. PINE 17 S20W - 18.78' MKD 1/4 S22 BT

8" STEEL SIGN POST NORTH

Certified corner restoration certificate prepared: Yes \_\_\_\_\_ No \_\_\_\_\_

Filed in county records at \_\_\_\_\_ Date \_\_\_\_\_ County Document No. \_\_\_\_\_

Identified on aerial photo No. \_\_\_\_\_ Which is filed at \_\_\_\_\_

T. 147 R. 27 S. Mer. N.F. CHIPPEWA County ITASCA State MN.  
WC SECTION Corner common to sections 19, 24, 25 and 30

## EXISTING SURVEYS

Original Government Survey			Original Evidence Found		
Year surveyed <u>1874</u> <u>P. H. CONGER</u>			Year of search <u>1936</u> By <u>GLO RESURVEY</u>		
Original monument <u>WOOD POST</u> <small>(Wood post, stone, pile of stones, pipe, etc.)</small>			Monument found <u>FD. ORIG. BT</u>		
Bearing Trees			Original Bearing Trees Found		
Species	<u>OAK</u>	<u>OAK</u> <u>N. PINE</u>	Species	<u>OAK STP.</u>	
Diameter	<u>15</u>	<u>12</u> <u>18</u>	Diameter	<u>16</u>	
Bearing	<u>N12W</u>	<u>S59W</u> <u>N87 1/2 E</u>	Bearing	<u>N12W</u>	
Distance	<u>50 LKS.</u>	<u>86 LKS.</u> <u>232 LKS.</u>	Distance	<u>50 LKS.</u>	
	<u>33.0'</u>	<u>56.76'</u> <u>153.12'</u>		<u>W/O LD BLAZE</u>	
Subsequent Corner Restoration			Evidence of Subsequent Corner Restoration Found		
Year surveyed <u>1936</u> By <u>GLO RESURVEY</u>			Year of search <u>10-11-94</u> By <u>CK</u>		
Where filed or recorded <u>ON FILE</u>			<u>FD. GLO CONC. MONU. PUSHED OUT OF POSITION</u>		
Monument <u>SET 6" DIA X 24" LONG CONC. CYL.</u> <small>(Original, concrete post, iron rod, etc.)</small> <u>WITH CAP MISC.</u>			<u>By FROST - LYING IN GRASS MARSH - THIS</u>		
		<u>T147N</u> <u>R28W R27W</u> <u>S24 1/2 S19</u> <u>S25 1/2 S30</u>	<u>WOULD HAPPEN AGAIN IN A SHORT TIME</u>		
		<u>1936</u>	<u>SO I REMOVED CAP FROM CONCRETE CYL.</u>		
Bearing Trees, Reference Objects			Bearing Trees, Reference Objects <u>OVER</u>		
Species	<u>BURROAK</u>	<u>W. PINE</u>	<u>W. PINE</u>	<u>W. OAK</u>	
Diameter	<u>8</u>	<u>20</u>	<u>30</u>	<u>22</u>	
Bearing	<u>N2 1/4 E</u>	<u>N19 1/2 W</u>	<u>N14W</u>	<u>N7E</u>	
Distance	<u>83 LKS.</u>	<u>154 LKS.</u>	<u>101.64'</u>	<u>54.78'</u>	
	<u>54.78'</u>	<u>101.64'</u>	<u>SCRIBE VISIBLE</u>	<u>SCAR FACING COR.</u>	

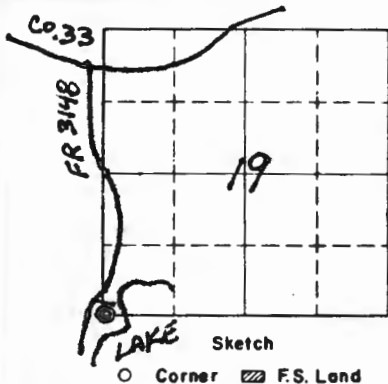

Sketch

○ Corner ▨ F.S. Land

Relation of Evidence to Record Features Along Section Lines

Section line to sections \_\_\_\_\_  
 Object \_\_\_\_\_  
 Record distance \_\_\_\_\_  
 Measured distance \_\_\_\_\_

Other Evidence

Describe evidence of use and occupation such as roads, fences, clearings, timber cutting lines, plantations, etc.. Cite source of testimony, if any. \_\_\_\_\_

CORNER IS APPROX. 22.5' EAST OF FR 3148  
WALKING TRAIL TO LAKE - JUST SOUTH OF W. PINE BT  
AND JUST NORTH OF W. OAK BT  
COR. IS 40' WEST OF WATER EDGE AND AT EDGE OF BRUSH & OPEN MARSH  
NO TAGS ON BT'S. AS OLD TAGS HAVE BEEN SHOT AT IN  
PAST YEARS  
BROKE CAP OFF GLO MONUMENT - MONUMENT LYING IN MARSH

At time of search:

1. Did you have the record description?  
 Yes  No \_\_\_\_\_

2. How was search area located?  
 Pacing, chaining, photos, maps,  
 etc. \_\_\_\_\_

3. Man hours spent in search 1 HR.

4. Do you think additional search might  
 recover evidence? Yes \_\_\_\_\_ No \_\_\_\_\_

5. Signature Curt Krause

Perpetuation Record

Monument and accessories established. Include brief description of area.  
SET 3 PIECES OF FLUTED ROD - EACH 24" LONG  
TOTAL LENGTH OF MONUMENT IS 72" X 3/4" ROD  
ALUMINUM CAP MKD. T147NR27W  
MAGNETIC PELLET N ALONGSIDE UNDERGROUND  
MKD NEW BT  
W. PINE IS N41E - 16.84' MKD BT  
8' STEEL SIGN POST SOUTH 3.45'

	W.G.
R2BW	524   519
	525   530
	1994
	USES

Certified corner restoration certificate prepared: Yes \_\_\_\_\_ No \_\_\_\_\_  
 Filed in county records at \_\_\_\_\_ Date \_\_\_\_\_ County Document No. \_\_\_\_\_  
 Identified on aerial photo No. \_\_\_\_\_ Which is filed at \_\_\_\_\_

Index No. R-7 BOOK 1  
(Alphabetical - Numerical) Pg. 77

LAND CORNER RECORD  
(RECTANGULAR SURVEYS)

R9-7150-4 (Rev. 6/13/67)  
 GPO 802-127

T. 147 R. 27 5 Mer. N.F. CHIPPEWA County ITASCA State MN.  
QUARTER BET. Corner common to sections 20 and 29

EXISTING SURVEYS

Original Government Survey  
 Year surveyed 1874 By P.H. CONGER  
 Original monument WOOD POST  
(Wood post, stone, pile of stones, pipe, etc.)  
 Bearing Trees  
 Species PINE STUB  
 Diameter 21  
 Bearing S48W  
 Distance 204 LKS.  
134.64'

Subsequent Corner Restoration  
 Year surveyed 1936 By GLO RESURVEY  
 Where filed or recorded ON FILE  
 Monument SET 1" X 3/8" IRON POST w/ CAP MKD  
(Original, concrete post, iron rod, etc.)  
1/4 S20  
1/4 S29  
1936

Bearing Trees, Reference Objects  
 Species N. PINE N. PINE  
 Diameter 14 8  
 Bearing N74E S44W  
 Distance 9 LKS. 16 LKS.  
5.94' 10.56'

Original Evidence Found  
 Year of search 1927 By GLO RESURVEY  
 Monument found COR. MKD BY 5" N. PINE SOD.  
 Original Bearing Trees Found  
 Species N. PINE  
 Diameter 14  
 Bearing N70°45E  
 Distance 11 LKS.  
7.26'

Evidence of Subsequent Corner Restoration Found  
 Year of search 9-27-94 By CK  
FD. IRON Y CAP - IN PLACE - 6" ABOVE GRD.  
CORNER IS IN THICK BRUSH + N. PINE WITH  
SCATTERED HARDWOODS - PLACED ESLP  
ON 20" N. PINE - 338' S89E TO COR.

Bearing Trees, Reference Objects  
 Species N. PINE N. PINE  
 Diameter 23 17.5"  
 Bearing N74E S44W  
 Distance 5.94' 10.56'  
SCAR TO COR.

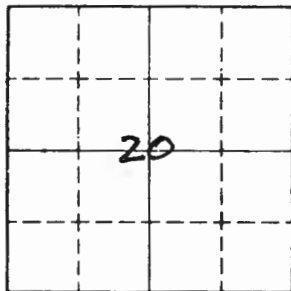

Sketch

○ Corner    F.S. Land

Relation of Evidence to Record Features Along Section Lines

Section line to sections \_\_\_\_\_  
Object \_\_\_\_\_  
Record distance \_\_\_\_\_  
Measured distance \_\_\_\_\_

Other Evidence

Describe evidence of use and occupation such as roads, fences, clearings, timber cutting lines, plantations, etc.. Cite source of testimony if any. \_\_\_\_\_

RAN LINE FROM CORNER N89W TO FR 2379 B  
CENTER OF ROAD 328'  
FD. 20" N. PINE BLAZED E+W AT 281' W OF COR.  
FSLP ON 19 N. PINE ON W SIDE OF FR 2379 B  
CORNER IS S89E - 338'

At time of search:

1. Did you have the record description?

Yes  No \_\_\_\_\_

2. How was search area located?

Pacing, chaining, photos, maps  
etc. \_\_\_\_\_

3. Man hours spent in search 1 1/2 hrs.

4. Do you think additional search might recover evidence? Yes \_\_\_\_\_ No \_\_\_\_\_

5. Signature C. Kramer

Perpetuation Record

Monument and accessories established. Include brief description of area. \_\_\_\_\_

MARKED NEW BT'S.  
N. PINE 9 N6W - 28.65' MKD 1/4 S20 BT

610 N. PINE 23 N74E 5.94'  
HAS DOUBLE SCARS  
UPPER SCAR COULD BE FROM 1927  
LOWER SCAR COULD BE FROM 1936  
OLD RUSTED TAG ON BT ALSO - COULDN'T READ

Certified corner restoration certificate prepared: Yes \_\_\_\_\_ No \_\_\_\_\_

Filed in county records at \_\_\_\_\_ Date \_\_\_\_\_ County Document No. \_\_\_\_\_

Identified on aerial photo No. \_\_\_\_\_ Which is filed at \_\_\_\_\_

Index No. R-13  
(Alphabetical-Numerical)BOOK 1  
Pg. 78LAND CORNER RECORD  
(RECTANGULAR SURVEYS)R9-7150-4 (Rev. 6/13/67)  
GPO 802-127T. 147 R. 27 5 Mer. N.F. CHIPPEWA County ITASCA State MN.  
W.C. SECTION Corner common to sections 21, 22, 27 and 28

## EXISTING SURVEYS

## Original Government Survey

Year surveyed 1874 By P. H. CONGER  
Original monument WOOD POST  
(Wood post, stone, pile of stones, pipe, etc.)

## Bearing Trees

Species	<u>PINE</u>	<u>PINE</u>	<u>N. PINE</u>	<u>N. PINE</u>
Diameter	<u>8</u>	<u>6</u>	<u>14</u>	<u>24</u>
Bearing	<u>N37E</u>	<u>N20W</u>	<u>S23W</u>	<u>S20E</u>
Distance	<u>28 LKS.</u>	<u>4 LKS.</u>	<u>35 LKS.</u>	<u>76 LKS.</u>
	<u>18.48'</u>	<u>2.64'</u>	<u>23.10'</u>	<u>50.16'</u>

## Subsequent Corner Restoration

Year surveyed 1927 By GLO RESURVEY  
Where filed or recorded ON FILE  
Monument SET 2" X 36" IRON POST W/CAP MKD  
(Original, concrete post, man rod, etc.)  
T147NR27W  
WG S21 S22  
MC S28 S27Bearing Trees, Reference Object 1927

Species	<u>BIRCH</u>		
Diameter	<u>4</u>		
Bearing	<u>S60°15'E</u>		
Distance	<u>11 LKS.</u>		
	<u>7.26'</u>		

## Original Evidence Found

Year of search 1927 By GLO RESURVEY  
Monument found Fd. SCRIBED POST + EVIDENCE  
OF 4 ORIG. B.T'S.

## DEAD Original Bearing Trees Found DEAD

Species	<u>W. PINE</u>	<u>N. PINE</u>	<u>N. PINE DOWN</u>	<u>N. PINE</u>
Diameter	<u>28</u>	<u>14</u>	<u>20</u>	<u>28</u>
Bearing	<u>N35E</u>	<u>N19W</u>	<u>S33W</u>	<u>S18E</u>
Distance	<u>37 LKS.</u>	<u>58 LKS.</u>	<u>42 LKS.</u>	<u>90 LKS.</u>
	<u>24.42'</u>	<u>38.28'</u>	<u>27.72'</u>	<u>59.40'</u>

## Evidence of Subsequent Corner Restoration Found

Year of search 10-6-94 By RM + CK  
Fd. IRON YCAP - IN PLACE - 8" ABOVE GROUND  
IN THICK BRUSH WITH SCATTERED N. PINE  
AND HARDWOODS - 150' WEST OF WOODS  
TRAIL OR FR 3154 - COR. ON SIDE SLOPE  
WEST OF TRAIL ON RIDGE TOP

## Bearing Trees, Reference Objects

Species	<u>BIRCH</u>	<u>N. PINE ORIG.</u>	
Diameter	<u>8</u>	<u>18</u>	<u>BT</u>
Bearing	<u>S60E</u>	<u>N19W</u>	
Distance	<u>7.26'</u>	<u>38.28'</u>	

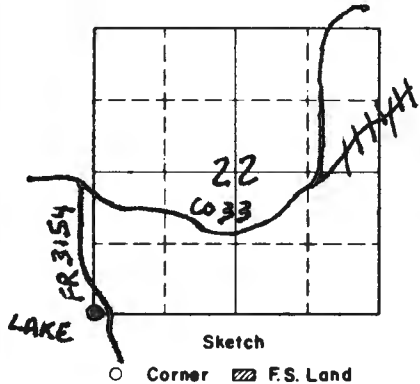

Sketch

○ Corner    ▨ F.S. Land

Relation of Evidence to Record Features Along Section Lines

Section line to sections	_____	_____	_____	_____
Object	_____	_____	_____	_____
Record distance	_____	_____	_____	_____
Measured distance	_____	_____	_____	_____

Other Evidence

Describe evidence of use and occupation such as roads, fences, clearings, timber cutting lines, plantations, etc.. Cite source of testimony if any.

WALKING TRAIL (FR 3154) ON RIDGE TOP - COR. IS 150' WEST OF TRAIL

ORIG. BT EVIDENCE

WELL ROTTED PINE STP. N35E 24.42

PINE STP. IN PIECES ON SLOPE S18E 59.4'

PINE WINDFALL S33W 27.72'

At time of search:

1. Did you have the record description?

Yes  No \_\_\_\_\_

2. How was search area located?

Pacing, chaining, photos, maps, etc.

3. Man hours spent in search 1 HR.

4. Do you think additional search might recover evidence? Yes \_\_\_\_\_ No \_\_\_\_\_

5. Signature Curt Krause

Perpetuation Record

Monument and accessories established. Include brief description of area.

NOTHING NEW MARKED - COR ON VERY STEEP SIDE HILL

NO GOOD TREES COULD BE USED AT HORIZONTAL DISTANCE

CORNER SHOULD N'T BE DISTURBED

FD. W. PINE 22" STUB AT N18E - 34.4 OLD TAG INSIDE ON

FLAT BLAZE - UNREADABLE

FD. 36 W. PINE N78E APPROX. 60' WHICH IS BLAZED E-N-N

N. PINE IS VISIBLE FROM WALKING TRAIL

Certified corner restoration certificate prepared: Yes \_\_\_\_\_ No \_\_\_\_\_

Filed in county records at \_\_\_\_\_ Date \_\_\_\_\_ County Document No. \_\_\_\_\_

Identified on aerial photo No. \_\_\_\_\_ Which is filed at \_\_\_\_\_



Index No. R-17  
(Alphabetical - Numerical)BOOK 1  
Pg. 74LAND CORNER RECORD  
(RECTANGULAR SURVEYS)RR-7150-4 (Rev. 6/13/67)  
GPO 802-127T. 147 R. 27 5 Mer. N.F. CHIPPEWA County ITASCA State MIN.  
SECTION Corner common to sections 22 23 26 and 27

## EXISTING SURVEYS

## Original Government Survey

Year surveyed 1874 P. H. CONGER  
Original monument WOOD POST  
(Wood post, stone, pile of stones, pipe, etc.)

## Bearing Trees

Species	<u>N. PINE</u>	<u>N. PINE</u>	<u>N. PINE</u>	<u>J. PINE</u>
Diameter	<u>20</u>	<u>18</u>	<u>20</u>	<u>12</u>
Bearing	<u>S72½W</u>	<u>N65½E</u>	<u>N28W</u>	<u>S27E</u>
Distance	<u>45 LKS.</u>	<u>70 LKS.</u>	<u>69 LKS.</u>	<u>62 LKS.</u>
	<u>29.70'</u>	<u>46.20'</u>	<u>45.54'</u>	<u>40.92'</u>

## Subsequent Corner Restoration

Year surveyed 1927 By GLO RESURVEY  
Where filed or recorded ON FILE  
Monument SET. 2" X 36" IRON POST w/ CAP MKD  
(Original, concrete post, iron rod, etc.)  
T147N R27W  
S22 | S23  
S27 | S26

## Bearing Trees, Reference Objects 1927

Species	<u>BIRCH</u>	<u>N. PINE</u>
Diameter	<u>10</u>	<u>16</u>
Bearing	<u>N23E</u>	<u>S53°30'E</u>
Distance	<u>13 LKS.</u>	<u>93 LKS.</u>
	<u>15.18'</u>	<u>61.38'</u>

## Original Evidence Found

Year of search 1927 By GLO RESURVEY  
Monument found SCRIBED POST + EVIDENCE  
OF ORIG. BT'S.

## Original Bearing Trees Found

Species	<u>N. PINE</u>	<u>N. PINE STP.</u>
Diameter	<u>40</u>	<u>36</u>
Bearing	<u>S56W</u>	<u>N36°45'W</u>
Distance	<u>65 LKS.</u>	<u>74 LKS.</u>
	<u>42.90'</u>	<u>48.84'</u>

## Evidence of Subsequent Corner Restoration Found

Year of search 9-6-94 By RM-CK  
FD. 2" IRON + CAP - IN PLACE - 8" ABOVE GRD.  
IN THICK BRUSH WITH SCATTERED N. PINE  
6" SCRIBED POST LYING NEXT TO IRON  
CORNER IS 75' EAST OF FR 2230  
NEW BT IS ON WEST EDGE OF ROAD N+S

## Bearing Trees, Reference Objects

Species	<u>BIRCH</u>	<u>N. PINE</u>
Diameter	<u>13</u>	<u>23</u>
Bearing	<u>N23E</u>	<u>S53E</u>
Distance	<u>15.18'</u>	<u>61.38'</u>

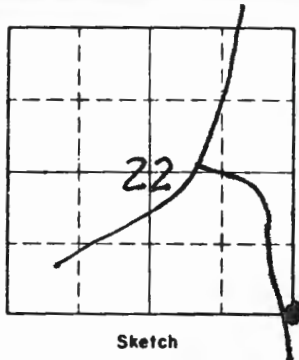

Sketch

○ Corner    ▨ F.S. Land

Relation of Evidence to Record Features Along Section Lines

Section line to sections \_\_\_\_\_  
 Object \_\_\_\_\_  
 Record distance \_\_\_\_\_  
 Measured distance \_\_\_\_\_

Other Evidence

Describe evidence of use and occupation such as roads, fences, clearings, timber cutting lines, plantations, etc.. Cite source of testimony if any.

CORNER IS 75' EAST OF FR 2230

ORIG. BT'S EVIDENCE

NOW LARGE PINE STUMP - DECAYING AT S56W-42.90'

NOW LARGE PINE STUMP - DECAYING AT N37W-48.80'

Perpetuation Record

Monument and accessories established. Include brief description of area.

MARKED NEW BT'S.

N. PINE 10 N64W-36.36' MKD S22 BT

N. PINE 12 S47W-110.80' MKD S27 BT

8" STEEL SIGN POST EAST 3.60'

Certified corner restoration certificate prepared: Yes \_\_\_\_\_ No \_\_\_\_\_

Filed in county records at \_\_\_\_\_ Date \_\_\_\_\_ County Document No. \_\_\_\_\_

Identified on aerial photo No. \_\_\_\_\_ Which is filed at \_\_\_\_\_

- At time of search:
1. Did you have the record description?  
 Yes  No \_\_\_\_\_
  2. How was search area located?  
 Pacing, chaining, photos, maps, etc. \_\_\_\_\_
  3. Man hours spent in search 1 HR.
  4. Do you think additional search might recover evidence? Yes \_\_\_\_\_ No \_\_\_\_\_

5. Signature Curt Krause

Index No. R 23  
(Alphabetical - Numerical)

*BOOK # 1*  
*PAGE # 20*

LAND CORNER RECORD  
(RECTANGULAR SURVEYS)

RS-5680-11 (5/12/64)

T. 147N R. 27W 5th Mer. N.F. Chippewa County Itasca State Minnesota  
Quarter Corner common to sections 24 25 and

EXISTING SURVEYS

Original Government Survey

Year surveyed \_\_\_\_\_  
 Original monument \_\_\_\_\_  
(Wood post, stone, pile of stones, pipe, etc.)

Bearing Trees

Species \_\_\_\_\_  
 Diameter Needs Field Work  
 Bearing \_\_\_\_\_  
 Distance \_\_\_\_\_

Subsequent Corner Restoration

Year surveyed 1936 By G.L.O.  
 Where filed or recorded \_\_\_\_\_  
 Monument Iron post with brass  
(Original, concrete post, iron rod, etc.)  
cap stamped: 1/4 S24  
S25  
1936

Bearing Trees, Reference Objects

Species J. Pine N. Pine  
 Diameter 5" 5"  
 Bearing S11 1/2° E N39 1/4° W  
 Distance 40 lks. 23 lks.

Original Evidence Found

Year of search \_\_\_\_\_ By \_\_\_\_\_  
 Monument found \_\_\_\_\_

Original Bearing Trees Found

Species \_\_\_\_\_  
 Diameter \_\_\_\_\_  
 Bearing \_\_\_\_\_  
 Distance \_\_\_\_\_

Evidence of Subsequent Corner Restoration Found

Year of search 1970 By R.H. McDonald  
The brass cap is in place  
~~\_\_\_\_\_~~  
~~\_\_\_\_\_~~

J. Pine Red Pine  
stump 11"  
S41 1/2° E N39 1/4° W  
26.4 ft. 15.2'

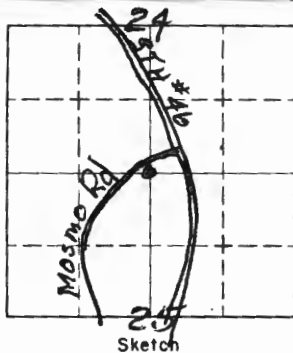

○ Corner    ▨ F.S. Land

At time of search:

1. Did you have the record description?

Yes  No

2. How was search area located?

Pacing, chaining, photos, maps,  
etc.

3. Man hours spent in search 1/2

4. Do you think additional search might  
recover evidence? Yes  No

5. Signature

*Sam Donald*

Relation of Evidence to Record Features Along Section Lines

Section line to sections \_\_\_\_\_

Object \_\_\_\_\_

Record distance \_\_\_\_\_

Measured distance \_\_\_\_\_

Other Evidence

Describe evidence of use and occupation such as roads, fences, clearings, timber cutting lines, plantations, etc.. Cite source of testimony if any. \_\_\_\_\_

Perpetuation Record

Monument and accessories established. Include brief description of area. \_\_\_\_\_

Certified corner restoration certificate prepared: Yes  No

Filed in county records at \_\_\_\_\_ Date \_\_\_\_\_ County Document No. \_\_\_\_\_

Identified on aerial photo No. \_\_\_\_\_ Which is filed at \_\_\_\_\_

T. 197N R. 21W Mer. N.F. 11ppen County Itasca State MINN  
Quarter Corner common to sections 25, 36 and

EXISTING SURVEYS

Original Government Survey

Year surveyed \_\_\_\_\_  
 Original monument \_\_\_\_\_  
(Wood post, stone, pile of stones, pipe, etc.)

Bearing Trees

Species \_\_\_\_\_  
 Diameter Need field work  
 Bearing \_\_\_\_\_  
 Distance \_\_\_\_\_

Subsequent Corner Restoration

Year surveyed 1936 By G. L. ...  
 Where filed or recorded \_\_\_\_\_  
 Monument BRASS & IRON PIPE  
(Original, concrete post, iron rod, etc.)  
Stamped: 1/4  
S25  
S36

Bearing Trees, Reference Objects 1936

Species Jack P  
 Diameter 5" 6"  
 Bearing N54°E East  
 Distance 39.6' 31.02'

Original Evidence Found

Year of search \_\_\_\_\_ By \_\_\_\_\_  
 Monument found \_\_\_\_\_

Original Bearing Trees Found

Species \_\_\_\_\_  
 Diameter \_\_\_\_\_  
 Bearing \_\_\_\_\_  
 Distance \_\_\_\_\_

Evidence of Subsequent Corner Restoration Found

Year of search 1960 By RH McDonald  
Red Pine windfall Jack Pine  
9" 11"  
N54°E East  
39.6' 31.02'

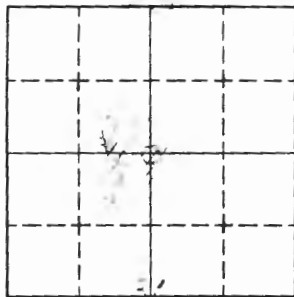

Sketch

○ Corner     F.S. Land

Relation of Evidence to Record Features Along Section Lines

Section line to sections \_\_\_\_\_  
Object \_\_\_\_\_  
Record distance \_\_\_\_\_  
Measured distance \_\_\_\_\_

Other Evidence

Describe evidence of use and occupation such as roads, fences, clearings, timber cutting lines, plantations, etc. Cite source of testimony if any. COYNEY IS IN  
Right of Way

At time of search:

1. Did you have the record description?

Yes \_\_\_\_\_ No \_\_\_\_\_

2. How was search area located?

Pacing, chaining, photos, maps,  
etc. \_\_\_\_\_

3. Man hours spent in search \_\_\_\_\_

4. Do you think additional search might  
recover evidence? Yes \_\_\_\_\_ No \_\_\_\_\_

Perpetuation Record

Monument and accessories established. Include brief description of area. \_\_\_\_\_

Found G.L.O. Brass cap in place. Set a x x x x  
and monument. In treated with red top  
South O.B. Coyney is approx. 100 feet

Certified corner restoration certificate prepared: Yes \_\_\_\_\_ No \_\_\_\_\_

Filed in county records at \_\_\_\_\_ Date \_\_\_\_\_ County Document No. \_\_\_\_\_

Identified on aerial photo No. \_\_\_\_\_ Which is filed at \_\_\_\_\_

Index No. Z-21  
(Alphabetical - Numerical)

LAND CORNER RECORD  
(RECTANGULAR SURVEYS)

R9-7150-4 (Rev. 6/13/67)  
GPO 802-127

T. 147 R. 27 5th Mor. N.F. C HIPPEWA County ITASCA State MN  
SECTION Corner common to sections 1, 2, 35 and 36

EXISTING SURVEYS

**Original Government Survey**  
Year surveyed 1874 By P.H. CONGER  
Original monument Wd Post  
(Wood post, stone, pile of stones, pipe, etc.)

Bearing Trees			
Species	J PINE	J PINE	J PINE
Diameter	<u>12</u>	<u>10</u>	<u>7</u>
Bearing	<u>NSW</u>	<u>S29E</u>	<u>N69½E</u>
Distance	<u>7 lks</u>	<u>27 lks</u>	<u>40 lks</u>
	<u>4.62</u>	<u>17.82</u>	<u>26.40</u>

**Original Evidence Found**  
Year of search 1927 By HAL O CRAIG  
Monument found SET NEW MONUMENT 3" I P/W BESS CAP.

Original Bearing Trees Found				
Species	J PINE	J PINE	J PINE	J PINE
Diameter	<u>10" DOWN</u>	<u>14" STUB</u>	<u>12" STUB</u>	<u>18"</u>
Bearing	<u>N65E</u>	<u>S30 30E</u>	<u>S45 75W</u>	<u>N44 75W</u>
Distance	<u>38 lks</u>	<u>26 lks</u>	<u>38 lks</u>	<u>7 lks</u>
	<u>25.08</u>	<u>17.16</u>	<u>25.08</u>	<u>4.62</u>

**Subsequent Corner Restoration**  
Year surveyed 9/10/58 By SAM BENZING  
Where filed or recorded \_\_\_\_\_  
Monument Ed 1927 MONUMENT & BTS  
(Original, concrete post, iron rod, etc.)

**Evidence of Subsequent Corner Restoration Found**  
Year of search 11/15/91 By R MAEN  
Ed CORNER IN PLACE AND UP 6"

Bearing Trees, Reference Objects			
Species	J PINE	J PINE	R PINE
Diameter	<u>6</u>	<u>6</u>	<u>7</u>
Bearing	<u>S25E</u>	<u>S54W</u>	<u>N47E</u>
Distance	<u>11.7</u>	<u>17.8</u>	<u>43.95</u>

Bearing Trees, Reference Objects			
Species	R PINE	NEW R PINE	R PINE
Diameter	<u>9"</u>	<u>13"</u>	<u>16"</u>
Bearing	<u>S60W</u>	<u>N54E</u>	<u>S12E</u>
Distance	<u>17.94</u>	<u>49.57</u>	<u>19.60</u>
	<u>NAE1</u>	<u>SPK</u>	<u>SPK</u>

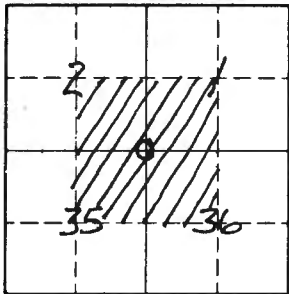

Sketch

○ Corner    ▨ F.S. Land

Relation of Evidence to Record Features Along Section Lines

Section line to sections \_\_\_\_\_  
 Object \_\_\_\_\_  
 Record distance \_\_\_\_\_  
 Measured distance \_\_\_\_\_

Other Evidence

Describe evidence of use and occupation such as roads, fences, clearings, timber cutting lines, plantations, etc.. Cite source of testimony if any. \_\_\_\_\_

At time of search:

1. Did you have the record description?

Yes \_\_\_\_\_ No \_\_\_\_\_

2. How was search area located?

Pacing, chaining, photos, maps, etc. \_\_\_\_\_

3. Man hours spent in search \_\_\_\_\_

4. Do you think additional search might recover evidence? Yes \_\_\_\_\_ No \_\_\_\_\_

5. Signature \_\_\_\_\_

Perpetuation Record

Monument and accessories established. Include brief description of area. \_\_\_\_\_

STEEL SIGN POST NORTH 3.4 FT TO FACE OF POST

MONUMENT STAMPED:

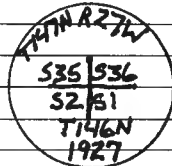

Certified corner restoration certificate prepared: Yes \_\_\_\_\_ No \_\_\_\_\_

Filed in county records at \_\_\_\_\_ Date \_\_\_\_\_ County Document No. \_\_\_\_\_

Identified on aerial photo No. \_\_\_\_\_ Which is filed at \_\_\_\_\_