

	1	2	3	4	5	6	7	8	9	10	11	12	13	14	15	16	17	18	19	20	21	22	23	24	25
A																									
B	+	+	+			+	+	+		+	+	+		+	+	+		+	+	+		+	+	+	
C	+	6	+			+	5	+		+	4	+		+	3	+		+	2	+		+	1	+	
D	+	+	+			+	+	+		+	+	+		+	+	+		+	+	+		+	+	+	
E																									
F	+	+	+			+	+	+		+	+	+		+	+	+		+	+	+		+	+	+	
G	+	7	+			+	8	+		+	9	+		+	10	+		+	11	+		+	12	+	
H	+	+	+			+	+	+		+	+	+		+	+	+		+	+	+		+	+	+	
J																									
K	+	+	+			+	+	+		+	+	+		+	+	+		+	+	+		+	+	+	
L	+	18	+			+	17	●		+	16	+		+	15	+		+	14	+		+	13	+	
M	+	+	+			+	+	+		+	+	+		+	+	+		+	+	+		+	+	+	
N								●																	
O	+	+	+			+	+	+		+	+	+		+	+	+		+	+	+		+	+	+	
P	+	19	+			+	20	+		+	21	+		+	22	+		+	23	+		+	24	+	
Q	+	+	+			+	+	+		+	+	+		+	+	+		+	+	+		+	+	+	
R																									
S	+	+	+			+	+	+		+	+	+		+	+	+		+	+	+		+	+	+	
T	+	30	+			+	29	+		+	28	+		+	27	+		+	26	+		+	25	+	
U	+	+	+			+	+	+		+	+	+		+	+	+		+	+	+		+	+	+	
V								●		●		●		●											
W	+	+	+			+	+	+		+	+	+		+	+	+		+	+	+		+	+	+	
X	+	31	+			●	32	+	●	●	●	+	●	+	34	+		+	35	+		+	36	+	
Y	+	+	+			●	●	+	●	●	+	+	+	+	+	+		+	+	+		+	+	+	
Z								●																	

LEGEND

○ = Corner having information on form 7100-52 in this file.

T146N R26W 5th PM

FILING INSTRUCTION

(Ref. FSM 7150)

File 7100-52 card record by letter and number coordinates behind the file guide for the township in which it falls.

File the 7100-52 card record by letter and then by number i.e., all A cards first, then B cards etc.

The first card behind the file guide (if data have been obtained and recorded) will be card A-1 for N.W. Township Corner, then card A-2 for 1/16 corner then card A-3 for 1/4 corner etc.

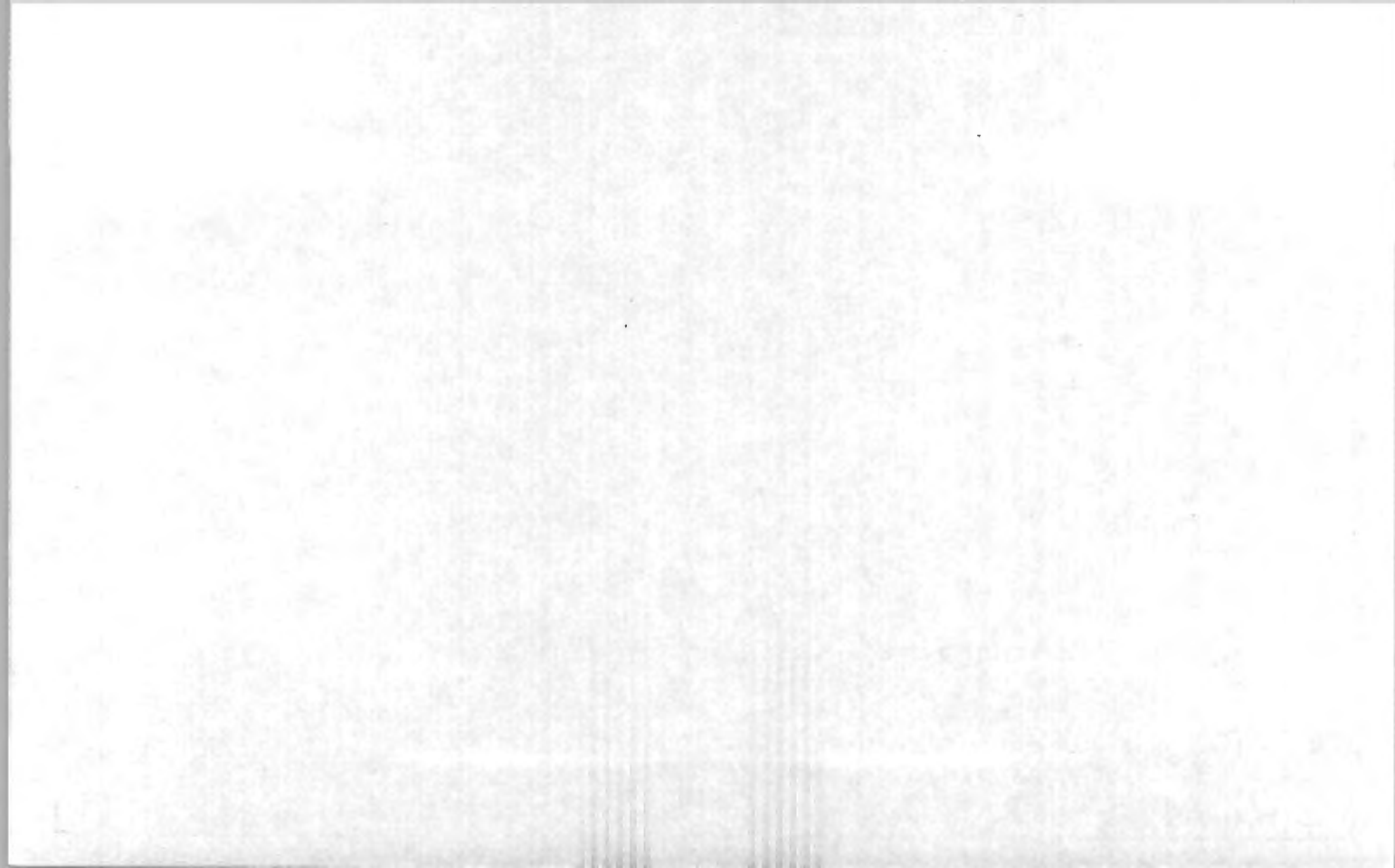

Index No. L-9
(Alphabetical - Numerical)

Book # 1
Page 15

LAND CORNER RECORD
(RECTANGULAR SURVEYS)

R9-7150-4 (Rev. 6/13/67)
GPO 802-127

T. 146 N. R. 26 W. 5th Mer. N.F. Chippewa County, Itasca State Minnesota
Quarter Corner common to sections 16 and 17

EXISTING SURVEYS

Original Government Survey

Year surveyed June 1876
Original monument Post - set by B.C. Baldwin
(Wood post, stone, pile of stones, pipe, etc.)

Bearing Trees

Species N-Pine
Diameter 12"
Bearing WEST
Distance 210 lks
138,60'

Subsequent Corner Restoration

Year surveyed June 1916 By A.W. Nelson
Where filed or recorded Itasca County Surveyors office
Monument County Rd #115 Survey
(Original, concrete post, iron rod, etc.)

Bearing Trees, Reference Objects

Species N-Pine Tamarack
Diameter 16" 12"
Bearing WEST N59°E
Distance 158.6' 29.6'
(ORIG)

Original Evidence Found

Year of search 1981 By K. Whitehorn, R. Olesen
Monument found none

Original Bearing Trees Found

Species N-Pine
Diameter 25"
Bearing WEST
Distance 138,60'

Evidence of Subsequent Corner Restoration Found

Year of search 1981 By K. Whitehorn, R. Olesen

Bearing Trees, Reference Objects

Tamarack Stump
14"
N64°E
29.60'

Relation of Evidence to Record Features Along Section Lines

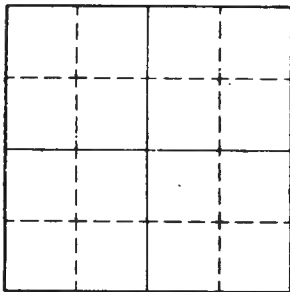

Sketch

○ Corner F.S. Land

Section line to sections _____

Object _____

Record distance _____

Measured distance _____

Other Evidence

Describe evidence of use and occupation such as roads, fences, clearings, timber cutting lines, plantations, etc.. Cite source of testimony if any. _____

At time of search:

1. Did you have the record description?

Yes No _____

2. How was search area located?

Pacing, chaining, photos, maps, etc. chaining and maps

3. Man hours spent in search 1

4. Do you think additional search might recover evidence? Yes _____ No

5. Signature [Signature]

RLS 14677

Perpetuation Record

Monument and accessories established. Include brief description of area. set 2" Brass cap monument 1' EAST of the center line of Oteneagen Road, down 0.9', marked as follows:

Ties Taken:

25" Norway Pine WEST 138.60' (ORIG)

14" Norway Pine N 61° W 72.05'

8" Tamarac N 58° E 75.57'

11" Tamarac S 81° E 79.45'

14" Norway Pine S 21° W 63.40'

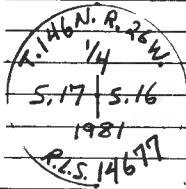

Certified corner restoration certificate prepared by _____ Yes _____ No _____

Filed in county records of _____ Date 12/14/68 County Document No. 355059

Identified on aerial photo No. _____ Which is filed at _____

CERTIFICATE FILED

Index No. N-9
(Alphabetical - Numerical)

LAND CORNER RECORD
(RECTANGULAR SURVEYS)

RP-7150-4 (Rev. 6/13/67)
 GPO 802-127

T. 57N R. 26W Mer. N.F. Chippewa County Itasca State MN
 Section _____ Corner common to sections 16, 17, 20 and 21

EXISTING SURVEYS

Original Government Survey

Year surveyed June 1876, B.C. Baldwin
 Original monument post
(Wood post, stone, pile of stones, pipe, etc.)

	Bearing Trees			
Species	<u>N. Pine</u>	<u>Aspen</u>	<u>Aspen</u>	<u>Aspen</u>
Diameter	<u>12</u>	<u>4</u>	<u>4</u>	<u>3</u>
Bearing	<u>N 78° E</u>	<u>S 25° E</u>	<u>S 1° W</u>	<u>N 77° W</u>
Distance	<u>105 lks</u>	<u>136 lks</u>	<u>115 lks</u>	<u>120 lks</u>
	<u>69.30 ft</u>	<u>89.76 ft</u>	<u>75.90 ft</u>	<u>79.70</u>

Subsequent Corner Restoration

Year surveyed July 12, 1983 By Whitehorn, Harman
 Where filed or recorded Itasca County Courthouse
 Monument E. 5 inch x 30 inch Aluminum pipe
(Original, concrete post, iron rod, etc.)
with 3.25 inch Aluminum cap;
ferre Post East 30.0 ft W 54-9 attached.
5° E. decl.

	Bearing Trees, Reference Objects			
Species	<u>N. Pine</u>	<u>Black P</u>	<u>Aspen</u>	<u>N. Pine</u>
Diameter	<u>20.3 inch</u>	<u>-</u>	<u>6.2 inch</u>	<u>5.9 inch</u>
Bearing	<u>N 12° E</u>	<u>N 43° E</u>	<u>EAST</u>	<u>S 45° W</u>
Distance	<u>273.90 ft</u>	<u>53.35 ft</u>	<u>79.80 ft</u>	<u>117.60 ft</u>

4144-2626
5.17.15.16
5.20.52.1
PL 1983
PLS 14677

Original Evidence Found

Year of search July 12, 1983 By Whitehorn, Harman
 Monument found none

	Original Bearing Trees Found			
Species	<u>Bodily decayed Pine Stump</u>			
Diameter	<u>-</u>			
Bearing	<u>N 78° E</u>			
Distance	<u>69.30 ft</u>			

Evidence of Subsequent Corner Restoration Found

Year of search _____ By _____

Bearing Trees, Reference Objects

Species				
Diameter				
Bearing				
Distance				

N-9

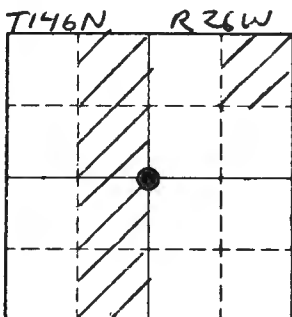

Sketch

○ Corner ▨ F.S. Land

Relation of Evidence to Record Features Along Section Lines

Section line to sections _____

Object _____

Record distance _____

Measured distance _____

Other Evidence

Describe evidence of use and occupation such as roads, fences, clearings, timber cutting lines, plantations, etc.. Cite source of testimony if any. _____

At time of search:

1. Did you have the record description?

Yes No _____

2. How was search area located?

Pacing chains, photos, maps,
etc. _____

3. Man hours spent in search 2

4. Do you think additional search might recover evidence? Yes _____ No

Perpetuation Record

Monument and accessories established. Include brief description of area. _____

Certified corner restoration certificate prepared: Yes No _____

Filed in county records at Itasca Courthouse 3-6-84 County Document No. 363215

5. Signature Kenneth E. White

Identified on aerial photo No. _____ Which is filed at _____

Index No. V-9
(Alphabetical - Numerical)

LAND CORNER RECORD
(RECTANGULAR SURVEYS)

RD-7150-4 (Rev. 6/13/67)
GPO 802-127

T. 146N R. 26W Mer. N.F. 5th CHIPPEWA County ITASCA State MINN.
SECTION Corner common to sections 28 29 32 and 33

EXISTING SURVEYS

Original Government Survey

Year surveyed 1876 B.C. BALDWIN
Original monument WOOD POST
(Wood post, stone, pile of stones, pipe, etc.)

Species	Bearing Trees			
	J. PINE	J. PINE	N. PINE	J. PINE
Diameter	10"	10"	10"	12"
Bearing	S47E	N37E	S39W	N20W
Distance	36 LKS	30 LKS	90 LKS	64 LKS

Subsequent Corner Restoration

Year surveyed 1958 By SAM BENZING
Where filed or recorded ITASCA COUNTY
Monument 60" Long, 2" Ø, CONCRETE Filled,
(Original, concrete post, iron rod, etc.)

BRASS CAPPED, STEEL PIPE.

Bearing Trees, Reference Objects

Species	Bearing Trees, Reference Objects			
	J. PINE	J. PINE	J. PINE	J. PINE
Diameter	7"	8"	9"	9"
Bearing	S35E	N38E	N68W	S38W
Distance	14.80'	17.26'	29.58'	23.51'

Original Evidence Found

Year of search 1913 By W.B. TAYLOR
Monument found WOOD POST

Original Bearing Trees Found

Species "FOUND ALL GOV'T BTS"
Diameter _____
Bearing _____
Distance _____

Evidence of Subsequent Corner Restoration Found

Year of search 1994 By JOHN HINZMANN JR.
SEAWAY ENG. COMP.

1990 - G. ROBERTSON, W. BRUCE OF THE
ITASCA COUNTY SURVEYORS OFFICE.

Bearing Trees, Reference Objects

Species	Bearing Trees, Reference Objects			
	J. PINE	J. PINE	J. PINE	J. PINE
Diameter	7"	8"	9"	9"
Bearing	S35E	N38E	N68W	S38W
Distance	14.80'	17.26'	29.58'	23.51'

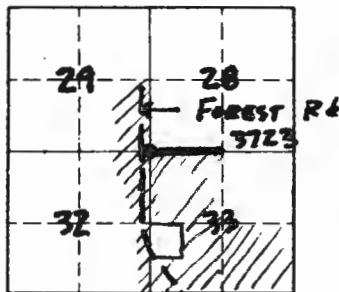

Sketch

○ Corner ▨ F.S. Land

Relation of Evidence to Record Features Along Section Lines

Section line to sections _____
 Object _____
 Record distance _____
 Measured distance _____

Other Evidence

Describe evidence of use and occupation such as roads, fences, clearings, timber cutting lines, plantations, etc.. Cite source of testimony if any. 1958 PIPE Found
Lying Down. U.S.F.S Road 3723 LIES WEST 2'
OF CORNER.

1994 - BRUSHED AND POSTED FROM NE CORNER
S32 TO N 1/4 S33.

At time of search:

1. Did you have the record description?
 Yes X No _____

2. How was search area located?
 Pacing, chaining, photos, maps,
 etc.

PHOTOS, MAPS

3. Man hours spent in search 2

4. Do you think additional search might
 recover evidence? Yes _____ No _____

Perpetuation Record

Monument and accessories established. Include brief description of area. 1994
JOHN HURDMAN JR. SET A 48", 2 1/2" φ, BRASS CAPPED,
STEEL PIPE.

W. SPROUCE	J. PINE	J. PINE	J. PINE	J. PINE	SFP
9"	12"	12" TW/W	15"	14"	
N 16 E	S 25 E	S 12 E	S 4 N W	N 61 W	EAST
57.24'	14.95'	5.4'	24.22'	29.97'	5.8'
	(FOUND)	(FOUND)	(FOUND)	(FOUND)	

Certified corner restoration certificate prepared: Yes X No _____

Filed in county records at ITASCA Date 3/95 County Document No. 459953

5. Signature John J. King Identified on aerial photo No. _____ Which is filed at _____

Index No. V-11
(Alphabetical - Numerical)

LAND CORNER RECORD
(RECTANGULAR SURVEYS)

R9-7150-4 (Rev. 6/13/67)
GPO 802-127

T. 146 N R. 26 W S^{1/4} Mer. N.F. Chippewa County ITASCA State MINN.
QUARTER Corner common to sections 28 33 and _____

EXISTING SURVEYS

Original Government Survey

Year surveyed ~~1876~~ 1876 B.C. Baldwin
Original monument WOOD POST
(Wood post, stone, pile of stones, pipe, etc.)

Bearing Trees

Species ASPEN J. PINE
Diameter 3" 12"
Bearing SOUTH NSW
Distance 7 LKS 45 LKS

Subsequent Corner Restoration

Year surveyed 1913/1916 By W.B. Taylor / Nelson, Rose
Where filed or recorded ITASCA
Monument ORIGINAL WOOD POST
(Original, concrete post, iron rod, etc.)

Bearing Trees, Reference Objects

Species	<u>J. PINE</u>	<u>BIRCH</u>	<u>POPPLE</u>
Diameter	<u>12"</u>	<u>8"</u>	<u>8"</u>
Bearing	<u>N22 1/2 W</u>	<u>N37 3/4 W</u>	<u>S25 1/2 E</u>
Distance	<u>118.9'</u> <u>(1913)</u>	<u>72.5'</u> <u>(1916)</u>	<u>79.8'</u> <u>(1916)</u>

Original Evidence Found

Year of search 1913/1916 By W.B. Taylor / Nelson, Rose
Monument found ORIGINAL WOOD POST

Original Bearing Trees Found

Species 1913 RECORDS SAY NOTHING ABOUT
Diameter WITNESSES FOUND
Bearing _____
Distance 1916 RECORDS SAY THEY FOUND
1 ORIGINAL BT.

Evidence of Subsequent Corner Restoration Found

Year of search _____ By _____

Bearing Trees, Reference Objects

Species	_____	_____	_____
Diameter	_____	_____	_____
Bearing	_____	_____	_____
Distance	_____	_____	_____

FOREST ROAD
3722.



Sketch

○ Corner ▨ F.S. Land

Relation of Evidence to Record Features Along Section Lines

Section line to sections _____
 Object _____
 Record distance _____
 Measured distance _____

Other Evidence

Describe evidence of use and occupation such as roads, fences, clearings, timber cutting lines, plantations, etc.. Cite source of testimony if any. _____

U.S.F.S. Road 3722 LIES 6' WEST OF CORNER.

1994 - BRUSHED AND POSTED FROM N 1/4 S33 TO NE COR S32 AND FROM N 1/4 S33 TO C-1/4 S33.

At time of search:

1. Did you have the record description?

Yes No _____

2. How was search area located?

Pacing, chaining, photos, maps, etc. TRAVERSE RETRACING
1913/1916 Road Surveys

3. Man hours spent in search 10

4. Do you think additional search might recover evidence? Yes _____ No

5. Signature John J. King

Perpetuation Record

Monument and accessories established. Include brief description of area. 1994
JOHN HURZMAN JR SET A 40", 2 1/2" Ø, BRASS CAPPED,
STEEL GALV PIPE, BY RETRACE OF 1916 ROAD SURVEY.

ASPEN	ASPEN	ASPEN	SFP	SFP
7"	8"	8"		
S67E	S68W	S88W	SOUTH	WEST
25.92'	25.60'	26.46'	5.6'	2.8'

Certified corner restoration certificate prepared: Yes No _____
 Filled in county records at ILLASCA Date 3/95 County Document No. 459956
 Identified on aerial photo No. _____ Which is filed at _____

Index No. V-13
(Alphabetical - Numerical)

LAND CORNER RECORD
(RECTANGULAR SURVEYS)

RD-7150-4 (Rev. 6/13/67)
GPO 802-127

T. 146 N R. 26 W
SECTION

5th Mer. N.F. Chippewa
Corner common to sections 27

County ITASCA

State Minn.
33 and 34

EXISTING SURVEYS

Original Government Survey

Year surveyed 1876 B.C. Baldwin
Original monument Wood Post
(Wood post, stone, pile of stones, pipe, etc.)

Bearing Trees			
Species	<u>ASPEN</u>	<u>ASPEN</u>	<u>ASPEN</u>
Diameter	<u>6"</u>	<u>4"</u>	<u>4"</u>
Bearing	<u>S40W</u>	<u>N38W</u>	<u>N72E</u>
Distance	<u>20 LKS</u>	<u>22 LKS</u>	<u>41 LKS</u>

Original Evidence Found

Year of search _____ By _____
Monument found _____

Original Bearing Trees Found

Species _____
Diameter _____
Bearing _____
Distance _____

Subsequent Corner Restoration

Year surveyed 1916 By NELSON, ROSE
Where filed or recorded ITASCA
Monument (Original concrete post, iron rod, etc.)
ORIGINAL CORNER LOST.
CORNER SET BY DOUBLE POST
PROPORTIONATE METHOD.

Evidence of Subsequent Corner Restoration Found

Year of search _____ By _____

Bearing Trees, Reference Objects

Species	<u>POPPLE</u>	<u>POPPLE</u>	<u>POPPLE</u>
Diameter	<u>7"</u>	<u>16"</u>	<u>9"</u>
Bearing	<u>S40 3/4 W</u>	<u>S38 3/4 W</u>	<u>N42E</u>
Distance	<u>81.2'</u>	<u>65.9'</u>	<u>53.2'</u>

Bearing Trees, Reference Objects

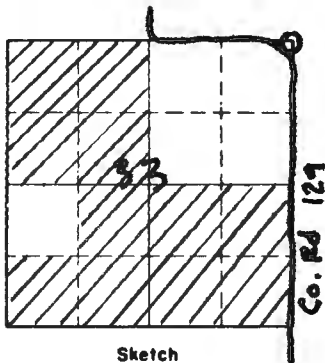

Sketch

○ Corner ▨ F.S. Land

Relation of Evidence to Record Features Along Section Lines

Section line to sections _____
 Object _____
 Record distance _____
 Measured distance _____

Other Evidence

Describe evidence of use and occupation such as roads, fences, clearings, timber cutting lines, plantations, etc.. Cite source of testimony if any. _____

At time of search:

1. Did you have the record description?
 Yes X No _____

2. How was search area located?

Pacing, chaining, photos, maps,
 etc. TRANSVERSE, RETRACE
ROAD SURVEY

3. Man hours spent in search 8

4. Do you think additional search might
 recover evidence? Yes _____ No X

Perpetuation Record

Monument and accessories established. Include brief description of area. 1994
JOHN HORNMAN JR SET A 24" 2 1/2" Ø BRASS
CAPPED, GALV STEEL PIPE, BY RETRACE OF 1916 ROAD
SURVEY.

SW House COR	NW House COR	POWER POLE	N. PINE
N12E	S64E	S56W	N55W
66.30'	129.63'	58.85'	85.65'

Certified corner restoration certificate prepared: Yes X No _____

Filed in county records at ITASCA Date 3/95 County Document No. 459961

5. Signature John J. Hornman Jr Identified on aerial photo No. _____ Which is filed at _____

Index No. V-15
(Alphabetical - Numerical)

LAND CORNER RECORD
(RECTANGULAR SURVEYS)

R9-7150-4 (Rev. 6/13/67)
GPO 802-127

T. 146N R. 26W Mer. N.F. Chippewa County ITASCA State MINN.
QUATER Corner common to sections 27 34 and _____

EXISTING SURVEYS

Original Government Survey

Year surveyed 1876 By B.C. Baldwin
Original monument WOOD POST
(Wood post, stone, pile of stones, pipe, etc.)

Bearing Trees

Species BALM of Gilead Willow
Diameter 7" 3"
Bearing N41W S3W
Distance 22 LKS 18 LKS

Subsequent Corner Restoration

Year surveyed 1922 By K.A. Russell
Where filed or recorded ITASCA
Monument _____
(Original, concrete post, iron rod, etc.)

Bearing Trees, Reference Objects

Species _____
Diameter _____
Bearing _____
Distance _____

Original Evidence Found

Year of search 1922 By K.A. Russell
Monument found IRON MONUMENT

Original Bearing Trees Found

Species " Found Gov't Balm of
Diameter _____
Bearing _____
Distance Gilead "

Evidence of Subsequent Corner Restoration Found

Year of search 1994 By JOHN HIRZMANN JR.
Found 1" ϕ WELL POINT

Bearing Trees, Reference Objects

Species _____
Diameter _____
Bearing _____
Distance _____

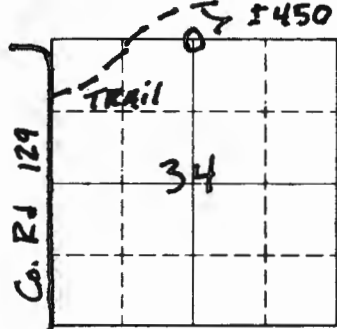

Sketch

○ Corner ▨ F.S. Land

Relation of Evidence to Record Features Along Section Lines

Section line to sections _____
 Object _____
 Record distance _____
 Measured distance _____

Other Evidence

Describe evidence of use and occupation such as roads, fences, clearings, timber cutting lines, plantations, etc.. Cite source of testimony if any.

TRAIL LIES ±450' NORTH of CORNER.

At time of search:

1. Did you have the record description?

Yes No _____

2. How was search area located?

Pacing, chaining, photos, maps, etc. Chaining

3. Man hours spent in search 4

4. Do you think additional search might recover evidence? Yes _____ No

Perpetuation Record

Monument and accessories established. Include brief description of area

1994
 JOHN HIRZMAN JR. SET 48", 2 1/2" φ, BRASS
 CAPPED, GALV. STEEL PIPE, WITH 1" WELL POINT
 ALONGSIDE.

ASH	ASH	ASH
10"	8"	5"
NSBE	S10E	NS0W
7.47'	24.76'	15.62'

Certified corner restoration certificate prepared: Yes No _____

Filed in county records at ITASCA Date 3/95 County Document No. 459960

5. Signature

John J. Hirzman Jr.

Identified on aerial photo No. _____ Which is filed at _____

Index No. X-6
(Alphabetical - Numerical)LAND CORNER RECORD
(RECTANGULAR SURVEYS)

R9-7150-4 (Rev. 6/13/67)

GPO 802-127

T. 146 N R. 26 W Mer. N.F. Oregon County Itasca State Minnesota
Center West 1/16 Corner common to sections _____ and _____

EXISTING SURVEYS

Original Government Survey

Year surveyed _____
Original monument _____
(Wood post, stone, pile of stones, pipe, etc.)

Bearing Trees

Species _____
Diameter _____
Bearing _____
Distance _____

Subsequent Corner Restoration

Year surveyed 1958 By Sam. Bering, R/S
Where filed or recorded Itasca Co & USFS
Monument 2" Iron pipe w/ Brass cap.
(Original, concrete post, iron rod, etc.)

Bearing Trees, Reference Objects

Species N. Pine S. Pine Oak
Diameter 11" 6" 5"
Bearing N 82 E W 87 S 12 E
Distance 34.18 21.18 24.84

Original Evidence Found

Year of search _____ By _____
Monument found _____

Original Bearing Trees Found

Species _____
Diameter _____
Bearing _____
Distance _____

Evidence of Subsequent Corner Restoration Found

Year of search 1978 By R. Olson
found pipe w/ cap bent badly by
logger. Bottom of pipe still in
place

Bearing Trees, Reference Objects

Species N Pine J. Pine Stump
Diameter 17" 8"
Bearing East N 93 W
Distance 84.18 21.2Scribe
Visible

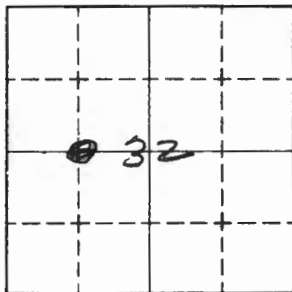

Sketch

○ Corner F.S. Land

Relation of Evidence to Record Features Along Section Lines

Section line to sections _____
 Object _____
 Record distance _____
 Measured distance _____

Other Evidence

Describe evidence of use and occupation such as roads, fences, clearings, timber cutting lines, plantations, etc.. Cite source of testimony if any. _____

At time of search:

1. Did you have the record description? _____

Yes _____ No _____

2. How was search area located? _____

Pacing, chaining, photos, maps,
 etc. _____

3. Man hours spent in search _____

4. Do you think additional search might
 recover evidence? Yes _____ No _____

5. Signature _____

Perpetuation Record

Monument and accessories established. Include brief description of area. _____

*To perpetuate this for I
 Replaced Monument w/ 3' long 2" dia. pipe w/ brass
 cap. 8" below ground
 set New B.T.
 N. Pine 19" N50W 36.30' 36.30'
 N. Pine 25.17' 25.17'*

CERTIFICATE FILED 9/15/81
 by *Sharon*

Certified corner restoration certificate prepared: Yes _____ No _____

Filed in county records at _____ Date _____ County Document No. _____

Identified on aerial photo No. _____ Which is filed at _____

Index No. X-9
(Alphabetical - Numerical)

LAND CORNER RECORD
(RECTANGULAR SURVEYS)

R9-7150-4 (Rev. 6/13/67)
 GPO 802-127

T. 146N R. 26W 5th Mer. N.F. Chippewa County ITASCA State MINN.
QUARTER Corner common to sections 32 33 and _____

EXISTING SURVEYS

Original Government Survey

Year surveyed 1876 By B.C. Baldwin
 Original monument WOOD POST
(Wood post, stone, pile of stones, pipe, etc.)

Bearing Trees
 Species BIRCH ASPEN
 Diameter 5" 4"
 Bearing S39W S73E
 Distance 11 LKS 33 LKS

Subsequent Corner Restoration

Year surveyed 1958 By SAM BENZING
 Where filed or recorded ITASCA
 Monument 60", 2 1/2" ϕ , CONCRETE Filled,
(Original, concrete post, iron rod, etc.)
BRASS CAPPED, STEEL PIPE.
ORIGINAL WAS LOST.

Bearing Trees, Reference Objects

Species BL. OAK BL. OAK ASPEN
 Diameter 7" 4" 5"
 Bearing S48E N19E N48W
 Distance 4.14' 25.98' 12.50'

Original Evidence Found

Year of search 1926 By C.B. Scott
 Monument found 3' Long OAK STAKE

Original Bearing Trees Found

Species "NO BEARING TREES
 Diameter _____
 Bearing _____
 Distance Found "

Evidence of Subsequent Corner Restoration Found

Year of search 1994 By JOHN HINZMAN JR.
Found the 1958 PIPE.
SE BLACK OAK Blown Down
NW & NE Gave to Logging.

Bearing Trees, Reference Objects

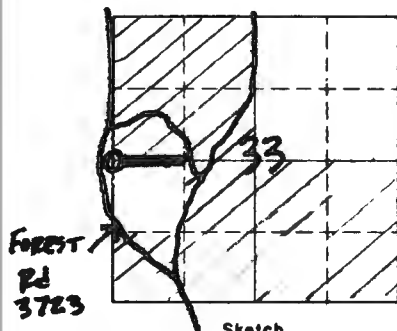

Sketch

○ Corner ▨ F.S. Land

Relation of Evidence to Record Features Along Section Lines

Section line to sections _____
 Object _____
 Record distance _____
 Measured distance _____

Other Evidence

Describe evidence of use and occupation such as roads, fences, clearings, timber cutting lines, plantations, etc.. Cite source of testimony if any.

U.S.F.S ROAD LIES WEST ± 40 OF CORNER.

1994 - BRUSHED AND POSTED FROM 1/4 32/33 TO C-W 1/16.

At time of search:

1. Did you have the record description?
 Yes No _____

2. How was search area located?
 Pacing, chaining, photos, maps, etc. _____

3. Man hours spent in search 3

4. Do you think additional search might recover evidence? Yes _____ No

Perpetuation Record

Monument and accessories established. Include brief description of area. 1994
 Found 1958 PIPE IN GOOD CONDITION.

N. PINE	N. PINE	ASPEN	SFP	SFP
50E	20"	8"		
12"	S28W	N20W	SOUTH	EAST
50.18'	55.94'	8.30'	2.4	3.4

Certified corner restoration certificate prepared: Yes No _____

Filed in county records at ITASCA Date 3/95 County Document No. 459959

5. Signature John J. King identified on aerial photo No. _____ Which is filed at _____

Index No. X-10
(Alphabetical - Numerical)

LAND CORNER RECORD
(RECTANGULAR SURVEYS)

RS-7 150-4 (Rev. 6/13/67)
GPO 802-127

T. 146 N R. 26 W Sth Mer. N.F. Chippewa County ITASCA State MINN.
CENTER WEST 1/4 Corner common to sections 33 and _____

EXISTING SURVEYS

Original Government Survey	Original Evidence Found
Year surveyed _____	Year of search _____ By _____
Original monument _____ <small>(Wood post, stone, pile of stones, pipe, etc.)</small>	Monument found _____
Bearing Trees	Original Bearing Trees Found
Species _____	Species _____
Diameter _____	Diameter _____
Bearing _____	Bearing _____
Distance _____	Distance _____
Subsequent Corner Restoration	Evidence of Subsequent Corner Restoration Found
Year surveyed _____ By _____	Year of search _____ By _____
Where filed or recorded _____	_____
Monument _____ <small>(Original, concrete post, iron rod, etc.)</small>	_____
_____	_____
Bearing Trees, Reference Objects	Bearing Trees, Reference Objects
Species _____	_____
Diameter _____	_____
Bearing _____	_____
Distance _____	_____

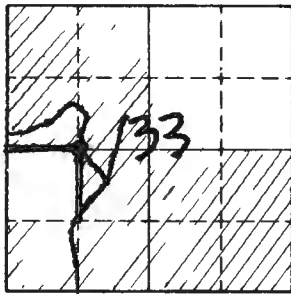

Sketch

○ Corner ▨ F.S. Land

Relation of Evidence to Record Features Along Section Lines

Section line to sections _____
 Object _____
 Record distance _____
 Measured distance _____

Other Evidence

Describe evidence of use and occupation such as roads, fences, clearings, timber cutting lines, plantations, etc.. Cite source of testimony if any. CORNER LIES 5' WEST OF

TRAIL

BRUSHED LINE FROM SW 1/16 TO CW 1/16 (1994)

BRUSHED LINE FROM CW 1/16 TO E 1/4 (1994)

At time of search:

1. Did you have the record description?

Yes _____ No _____

2. How was search area located?

Pacing, chaining, photos, maps,
 etc. _____

3. Man hours spent in search _____

4. Do you think additional search might
 recover evidence? Yes _____ No _____

5. Signature

John J. King

Perpetuation Record

Monument and accessories established. Include brief description of area. ¹⁹⁹⁴
~~SET~~ JOHN HINEMANN JR. SET A 48°, 2 1/2",
BRASS CAPPED, STEEL GALV. PIPE.

N. PINE	N. PINE	N. PINE	SFP	SFP
6"	9"	6"		
N 90E	N 70W	N 4 W	SOUTH	WEST
29.73'	14.18'	30.68'	5.0	5.2

* CERTIFICATE OF SURVEY, DOCUMENT NO. 460038

Certified corner restoration certificate prepared: Yes _____ No X

Filed in county records of * ITASCA Date 3/95 County Document No. _____

Identified on aerial photo No. _____ Which is filed at _____

Index No. X-11
(Alphabetical - Numerical)

LAND CORNER RECORD
(RECTANGULAR SURVEYS)

RD-7150-4 (Rev. 6/13/67)
GPO 802-127

T. 146N R. 26W 5TH Mer. N.F. CHIPPEWA County ITASCA State MINN.
CENTER 1/4 Corner common to sections 33 and _____

EXISTING SURVEYS

Original Government Survey

Year surveyed _____
Original monument _____
(Wood post, stone, pile of stones, pipe, etc.)

Bearing Trees

Species _____
Diameter _____
Bearing _____
Distance _____

Subsequent Corner Restoration

Year surveyed _____ By _____
Where filed or recorded _____
Monument _____
(Original, concrete post, iron rod, etc.)

Bearing Trees, Reference Objects

Species _____
Diameter _____
Bearing _____
Distance _____

Original Evidence Found

Year of search _____ By _____
Monument found _____

Original Bearing Trees Found

Species _____
Diameter _____
Bearing _____
Distance _____

Evidence of Subsequent Corner Restoration Found

Year of search _____ By _____

Bearing Trees, Reference Objects



Sketch

○ Corner ▨ F.S. Land

Relation of Evidence to Record Features Along Section Lines

Section line to sections _____
 Object _____
 Record distance _____
 Measured distance _____

Other Evidence

Describe evidence of use and occupation such as roads, fences, clearings, timber cutting lines, plantations, etc.. Cite source of testimony if any.

BRUSHED LINE FROM C¹/₄ TO N¹/₄ ~~1995~~ (1995)
 BRUSHED LINE FROM C¹/₄ TO E¹/₄ ~~1995~~ (1995)

At time of search:

1. Did you have the record description?
 Yes _____ No _____

2. How was search area located?
 Pacing, chaining, photos, maps,
 etc. _____

3. Man hours spent in search _____

4. Do you think additional search might
 recover evidence? Yes _____ No _____

Perpetuation Record

Monument and accessories established. Include brief description of area. 1995
 JOHN HINEMANN JR. SET A 48", 2 1/2" Ø, BRASS CAPPED,
 STEEL GALV. PIPE.

MAPLE	JACK PINE	N. PINE	SFP	SFP
5"	10"	14"		
S86E	S33W	N38W	NORTH	EAST
26.61'	21.25'	44.31'	5.0'	5.4'

* CERTIFICATE OF SURVEY DOCUMENT No. 460038

Certified corner restoration certificate prepared: Yes _____ No X

Filed in county records at *MITASCA Date 3/95 County Document No. _____

5. Signature John J. Hinemann Jr. Identified on aerial photo No. _____ Which is filed at _____

Index No. X-13
(Alphabetical - Numerical)

LAND CORNER RECORD
(RECTANGULAR SURVEYS)

RP-7150-4 (Rev. 6/13/67)
 GPO 802-127

T. 146 N R. 26 W 5th Mer. N.F. Chippewa County ITASCA State Miss.
QUARTER Corner common to sections 33 34 and _____

EXISTING SURVEYS

Original Government Survey

Year surveyed 1876 By B.C. Baldwin
 Original monument Wood Post
(Wood post, stone, pile of stones, pipe, etc.)

Bearing Trees

Species	<u>TAM</u>	<u>TAM</u>
Diameter	<u>5"</u>	<u>4"</u>
Bearing	<u>S21W</u>	<u>S39E</u>
Distance	<u>2.23 CH</u>	<u>3.60 CH</u>

Original Evidence Found

Year of search _____ By _____
 Monument found _____

Original Bearing Trees Found

Species	_____
Diameter	_____
Bearing	_____
Distance	_____

Subsequent Corner Restoration

Year surveyed 1913/1916 By W.B. Taylor / Nelson, Rose
 Where filed or recorded ITASCA
 Monument No indication as to what
(Original monument, post, iron rod, etc.)
was set.

Evidence of Subsequent Corner Restoration Found

Year of search _____ By _____

ORIGINAL IS LOST

Bearing Trees, Reference Objects

Species	<u>TAM</u>	<u>TAM</u>	<u>TAM</u>
Diameter	<u>12"</u>	<u>9"</u>	<u>8"</u>
Bearing	<u>S49W</u>	<u>S58³/₄W</u>	<u>S41¹/₂E</u>
Distance	<u>86'</u>	<u>98.7</u>	<u>142.0</u>
	<u>(1913)</u>	<u>(1916)</u>	<u>(1916)</u>

Bearing Trees, Reference Objects

Species	_____
Diameter	_____
Bearing	_____
Distance	_____

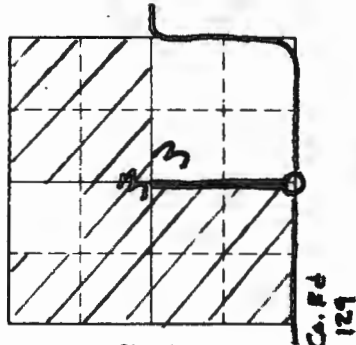

Sketch

○ Corner ▨ F.S. Land

Relation of Evidence to Record Features Along Section Lines

Section line to sections _____
 Object _____
 Record distance _____
 Measured distance _____

Other Evidence

Describe evidence of use and occupation such as roads, fences, clearings, timber cutting lines, plantations, etc.. Cite source of testimony if any. **CORNER LIES ± 10' EAST OF PHYSICAL CENTER LINE of County Road 129.**

1994 - BRUSHED AND POSTED FROM E 1/4 S33 to G-1/4 S33.

At time of search:

1. Did you have the record description?

Yes No _____

2. How was search area located?

Pacing, chaining, photos, maps, etc. **TRAVERSE, RETRACE ROAD SURVEYS.**

3. Man hours spent in search 10

4. Do you think additional search might recover evidence? Yes _____ No

Perpetuation Record

Monument and accessories established. Include brief description of area. **1994 JOHN HINZMANN JR. SET 24" 2 1/2" φ BRASS CAPPED GALV. STEEL PIPE 18" BELOW ROAD SURFACE.**

ASPEN	TAM	ASH	SFP
7"	24"	8"	
S15E	S66W	N90W	WEST
130.40'	89.41	165.08	72'

Certified corner restoration certificate prepared: Yes No _____

Filed in county records at **ITASCA** Date **3/95** County Document No. **459958**

5. Signature John J. Hin Identified on aerial photo No. _____ Which is filed at _____

Index No. 4-6
(Alphabetical - Numerical)

LAND CORNER RECORD
(RECTANGULAR SURVEYS)

R9-7150-4 (Rev. 6/13/67)
 GPO 802-127

T. 146 N. R. 26 W. 5th Mer. N.F. Chippewa County Itasca State Minnesota
S.W. 1/4 (45) Corner common to sections _____ and _____

EXISTING SURVEYS

Original Government Survey	Original Evidence Found
Year surveyed _____	Year of search _____ By _____
Original monument _____ <small>(Wood post, stone, pile of stones, pipe, etc.)</small>	Monument found _____
Bearing Trees	Original Bearing Trees Found
Species _____	Species _____
Diameter _____	Diameter _____
Bearing _____	Bearing _____
Distance _____	Distance _____
Subsequent Corner Restoration	Evidence of Subsequent Corner Restoration Found
Year surveyed <u>1958</u> By <u>Sam Benzing P.L.S.</u>	Year of search _____ By _____
Where filed or recorded <u>Itasca Co. & USFS.</u>	_____
Monument <u>2" Iron pipe w. Brass Cap.</u> <small>(Original, concrete post, iron rod, etc.)</small>	_____
_____	_____
Bearing Trees, Reference Objects	Bearing Trees, Reference Objects
Species <u>J. Pine</u> <u>Oak</u> <u>Birch</u>	<u>J. Pine</u> <u>Oak</u> <u>Birch</u>
Diameter <u>9"</u> <u>5"</u> <u>5"</u>	<u>10"</u> <u>8"</u> <u>7"</u>
Bearing <u>S45°E</u> <u>N32°E</u> <u>N50°W</u>	<u>S26E</u> <u>N50E</u> <u>N45W</u>
Distance <u>12.64'</u> <u>25.52'</u> <u>19.33'</u>	<u>12.69'</u> <u>25.52'</u> <u>19.33'</u>

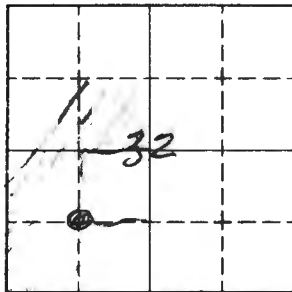

Sketch

○ Corner ▨ F.S. Land

Relation of Evidence to Record Features Along Section Lines

Section line to sections _____
 Object _____
 Record distance _____
 Measured distance _____

Other Evidence

Describe evidence of use and occupation such as roads, fences, clearings, timber cutting lines, plantations, etc.. Cite source of testimony if any. _____

At time of search:

1. Did you have the record description?

Yes _____ No _____

2. How was search area located?

Pacing, chaining, photos, maps, etc. _____

3. Man hours spent in search _____

4. Do you think additional search might recover evidence? Yes _____ No _____

5. Signature _____

Perpetuation Record

Monument and accessories established. Include brief description of area. _____

To perpetuate this cor I cut New BT²

R. Pine 8" S 4° E 34.60'

W. Oak 7" S 33° W 40.40'

8" Long Steel sign post W Signs 54-2 1/2 54-4 East 3.0'
11 11 11 11 54-4 North 2.9'

CERTIFICATE FILED 9/15/81

Certified corner restoration certificate prepared: Yes _____ No _____ by *SPH*

Filed in county records at _____ Date _____ County Document No. _____

Identified on aerial photo No. _____ Which is filed at _____

Index No. Y-7
(Alphabetical - Numerical)

LAND CORNER RECORD
(RECTANGULAR SURVEYS)

R9-7150-4 (Rev. 6/13/67)
 GPO 802-127

T. 146 N. R. 26 W. ¹⁰ 5th Mer. N.F. Chippewa County Itasca State Minnesota
 Corner common to sections 32 and _____

EXISTING SURVEYS

Original Government Survey	Original Evidence Found
Year surveyed _____	Year of search _____ By _____
Original monument _____ <small>(Wood post, stone, pile of stones, pipe, etc.)</small>	Monument found _____
Bearing Trees	Original Bearing Trees Found
Species _____	Species _____
Diameter _____	Diameter _____
Bearing _____	Bearing _____
Distance _____	Distance _____
Subsequent Corner Restoration	Evidence of Subsequent Corner Restoration Found
Year surveyed <u>1958</u> By <u>Sam Benzling R.L.S.</u>	Year of search <u>1978</u> By <u>R. Olson</u>
Where filed or recorded <u>Itasca Co. & U.S.F.S.</u>	_____
Monument <u>2" Iron pipe w/ brass cap.</u> <small>(Original, concrete post, iron rod, etc.)</small>	_____
_____	_____
_____	_____
Bearing Trees, Reference Objects	Bearing Trees, Reference Objects
Species <u>Oak</u> <u>Oak</u> <u>N. Pine</u>	<u>Stump</u> <u>Decayed Oak</u> <u>Oak</u> <u>N. Pine Stump</u>
Diameter <u>6"</u> <u>6"</u> <u>8"</u>	<u>10"</u> <u>12"</u>
Bearing <u>S13W</u> <u>N58°E</u> <u>N20W</u>	<u>S19W</u> <u>N73E</u> <u>N12W</u>
Distance <u>12.84'</u> <u>96.73</u> <u>39.21</u>	<u>12.9'</u> <u>96.73</u> <u>39.2</u>

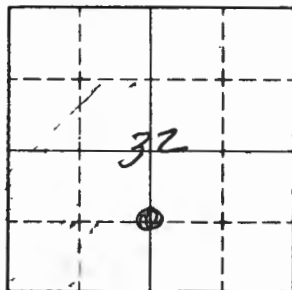

Sketch

○ Corner ▨ F.S. Land

Relation of Evidence to Record Features Along Section Lines

Section line to sections _____
 Object _____
 Record distance _____
 Measured distance _____

Other Evidence

Describe evidence of use and occupation such as roads, fences, clearings, timber cutting lines, plantations, etc.. Cite source of testimony if any. _____

At time of search:

1. Did you have the record description?

Yes No _____

2. How was search area located?

Pacing, chaining, photos, map,
 etc. _____

3. Man hours spent in search _____

4. Do you think additional search might recover evidence? Yes _____ No _____

5. Signature Ronald D. Olson

Perpetuation Record

Monument and accessories established. Include brief description of area. _____

New BT's Cut

Red Pine 16" N 70° W 39.05'

Red Pine 9" S 3 W 67.44'

4x4"x8" wood post w/sign

S 48° 54' 44" West 1.5'

11/70

Ronald Olson

CERTIFICATE FILED

9/15/81
by [Signature]

Certified corner restoration certificate _____

Filed in county records at _____ Date _____ County Document No. _____

Identified on aerial photo No. _____ Which is filed at _____

Index No. Y-9
(Alphabetical - Numerical)

LAND CORNER RECORD
(RECTANGULAR SURVEYS)

RD-7150-4 (Rev. 6/13/67)
GPO 802-127

T. 146N R. 26W 5TH Mer. N.F. CHIPPEWA County ITASCA State MINN.
SOUTH 1/16, WEST LINE Corner common to sections 33 and _____

EXISTING SURVEYS

Original Government Survey

Year surveyed _____
Original monument _____
(Wood post, stone, pile of stones, pipe, etc.)

Bearing Trees

Species _____
Diameter _____
Bearing _____
Distance _____

Subsequent Corner Restoration

Year surveyed. 1958 By SAM BENZING
Where filed or recorded ITASCA CO. RECORDERS OFFICE
Monument 60", 2 1/2" Ø BRASS CAPPED CONK. FILLED S. PIPE
(Original, concrete post, iron rod, etc.)

Bearing Trees, Reference Objects

Species	<u>MAPLE</u>	<u>BIRCH</u>	<u>RED OAK</u>
Diameter	<u>3"</u>	<u>7"</u>	<u>3"</u>
Bearing	<u>S55E</u>	<u>S5W</u>	<u>N82W</u>
Distance	<u>35.70'</u>	<u>9.42'</u>	<u>26.00'</u>

Original Evidence Found

Year of search _____ By _____
Monument found _____

Original Bearing Trees Found

Species _____
Diameter _____
Bearing _____
Distance _____

Evidence of Subsequent Corner Restoration Found

Year of search _____ By _____

Bearing Trees, Reference Objects

Species	_____	_____	_____
Diameter	_____	_____	_____
Bearing	_____	_____	_____
Distance	_____	_____	_____

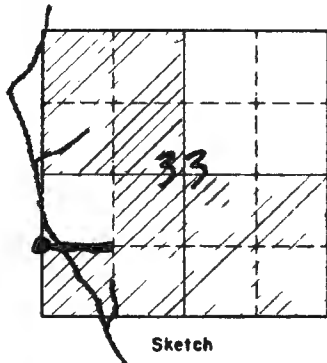

Sketch

○ Corner ▨ F.S. Land

Relation of Evidence to Record Features Along Section Lines

Section line to sections _____
 Object _____
 Record distance _____
 Measured distance _____

Other Evidence

Describe evidence of use and occupation such as roads, fences, clearings, timber cutting lines, plantations, etc.. Cite source of testimony if any.

BRUSHED LINE FROM S 1/16 WEST LINE TO SW 1/16 (1994)
 CORNER LIES ± 150' WEST OF U.S.F.S ROAD #3723

At time of search:

1. Did you have the record description?
 Yes _____ No _____

2. How was search area located?
 Pacing, chaining, photos, maps,
 etc. _____

3. Man hours spent in search _____

4. Do you think additional search might
 recover evidence? Yes _____ No _____

Perpetuation Record

Monument and accessories established. Include brief description of area. 1994
 JOHN HINEMANN JR. FOUND 1958 BRASS CAPPED, CONC. FILLED,
 STEEL PIPE. LEFT AS FOUND. FOUND AND SET WITNESSES.

J. PINE	OAK	N. PINE	SFP	SFP	GREEN TREATED POST
6"	6"	16"			6"
S72W	N74W	N53W	NORTH	EAST	WEST
21.50'	26.00'	74.08'	2.3'	5.5'	21.3'

* CERTIFICATE OF SURVEY DOCUMENT No. 460038

Certified corner restoration certificate prepared: Yes _____ No.

Filed in county records at XITAXA Date 3/95 County Document No. _____

5. Signature John Hinemann Jr. Identified on aerial photo No. _____ Which is filed at _____

T. 146 N. R. 26 W. S. 5th Mer. N.F. Chippewa County Itasca State Minnesota
5 1/16 Corner common to sections 32 33 and _____

EXISTING SURVEYS

Original Government Survey

Year surveyed _____

Original monument _____
(Wood post, stone, pile of stones, pipe, etc.)

Species Aspen Iron Bearing Tree

Diameter _____

Bearing _____

Distance _____

Original Evidence Found

Year of search _____ By _____

Monument found _____

Original Bearing Trees Found

Species _____

Diameter _____

Bearing _____

Distance _____

Subsequent Corner Restoration

Year surveyed 1958 By Sam Benzling

Where filed or recorded Co. Court House

Monument 2" Iron pipe w/ Brass Cap.
(Original, concrete post, iron rod, etc.)

Evidence of Subsequent Corner Restoration Found

Year of search 1979 By P. Oleson

Found Iron in Place

Bearing Trees, Reference Objects

Species	<u>Maple</u>	<u>Birch</u>	<u>Red Oak</u>
Diameter	<u>8"</u>	<u>7"</u>	<u>NB2W</u>
Bearing	<u>S55E</u>	<u>S5W</u>	<u>3"</u>
Distance	<u>35.70</u>	<u>9.42</u>	<u>26.00'</u>

Bearing Trees, Reference Objects

Species	<u>Rethon</u>	<u>Maple</u>	<u>Birch</u>	<u>Red Oak</u>
Diameter	<u>4"</u>	<u>10"</u>	<u>8"</u>	
Bearing	<u>S55E</u>	<u>S5W</u>	<u>NB2W</u>	
Distance	<u>38.70</u>	<u>10.42'</u>	<u>26.00'</u>	

See by
Visible

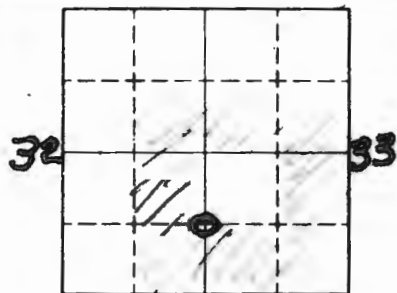

Sketch

○ Corner ▨ F.S. Land

Relation of Evidence to Record Features Along Section Lines

Section line to sections _____
 Object _____
 Record distance _____
 Measured distance _____

Other Evidence

Describe evidence of use and occupation such as roads, fences, clearings, timber cutting lines, plantations, etc.. Cite source of testimony if any. _____

At time of search:

1. Did you have the record description?

Yes _____ No _____

2. How was search area located?

Pacing, chaining, photos, maps, etc. _____

3. Man hours spent in search _____

4. Do you think additional search might recover evidence? Yes _____ No _____

5. Signature _____

Perpetuation Record

Monument and accessories established. Include brief description of area.

To perpetuate this Cor F Cor New Bearing
 Tree
 Birch Set 8' long steel sign post
 10" North 3' w/ 5944 59-2 & 54-4
 542E
 17.15
 1/16 S33 BT

Certified corner restoration certificate prepared: Yes _____ No _____

Filed in county records at _____ Date _____ County Document No. _____

Identified on aerial photo No. _____ Which is filed at _____

Index No. Y-10
(Alphabetical - Numerical)

LAND CORNER RECORD
(RECTANGULAR SURVEYS)

RD-7150-4 (Rev. 6/13/67)
GPO 802-127

T. 146N R. 26W
SOUTHWEST 1/16

5TH

Mer. N.F. CHIPPEWA County ITASCA State MINN.

Corner common to sections 33 and _____

EXISTING SURVEYS

Original Government Survey

Year surveyed _____
Original monument _____
(Wood post, stone, pile of stones, pipe, etc.)

Bearing Trees

Species _____
Diameter _____
Bearing _____
Distance _____

Subsequent Corner Restoration

Year surveyed _____ By _____
Where filed or recorded _____
Monument _____
(Original, concrete post, iron rod, etc.)

Bearing Trees, Reference Objects

Species _____
Diameter _____
Bearing _____
Distance _____

Original Evidence Found

Year of search _____ By _____
Monument found _____

Original Bearing Trees Found

Species _____
Diameter _____
Bearing _____
Distance _____

Evidence of Subsequent Corner Restoration Found

Year of search _____ By _____

Bearing Trees, Reference Objects

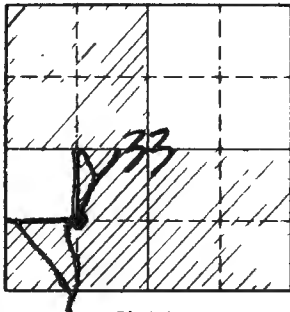

Sketch

○ Corner ▨ F.S. Land

Relation of Evidence to Record Features Along Section Lines

Section line to sections _____
 Object _____
 Record distance _____
 Measured distance _____

Other Evidence

Describe evidence of use and occupation such as roads, fences, clearings, timber cutting lines, plantations, etc.. Cite source of testimony if any. ~~TRAIL~~ **CORNER LIES**

150' SOUTH AND 35' EAST OF TRAIL.

BRUSHED LINE FROM SW 1/16 ~~TO~~ TO CW 1/16 (1994)

BRUSHED LINE FROM SW 1/16 TO S 1/2 WEST LINE (1994)

At time of search:

1. Did you have the record description?

Yes _____ No _____

2. How was search area located?

Pacing, chaining, photos, maps, etc. _____

3. Man hours spent in search _____

4. Do you think additional search might recover evidence? Yes _____ No _____

Perpetuation Record

Monument and accessories established. Include brief description of area. ¹⁹⁹⁴
JOHN HINZMANN JR. SET A 48", 2 1/2" Ø, BRASS CAPPED, STEEL GALV. PIPE.

N. PINE	N. PINE	N. PINE	SFP	SFP
12"	7"	9"		
N 20° E	N 88° E	S 14° W	NORTH	WEST
6.85'	8.35'	8.53'	5.4'	5.5'

***CERTIFICATE OF SURVEY DOCUMENT No. 460038**

Certified corner restoration certificate prepared: Yes _____ No **X**

Filed in county records of ***ITASKA** Date **3/95** County Document No. _____

5. Signature John J. Hinzmann Identified on aerial photo No. _____ Which is filed at _____

Index No. **Y-Z-8B00** 9-9

LAND CORNER RECORD
(RECTANGULAR SURVEYS)

R9-7150-4 (Rev. 6/13/67)
GPO 802-127

T. **146** R. **26** Mer. N.F. **CHippewa** County **ITASCA** State **MN**
MC No. **7** Corner common to sections **32** and

EXISTING SURVEYS

Original Government Survey

Year surveyed _____
Original monument _____
(Wood post, stone, pile of stones, pipe, etc.)

Bearing Trees

Species 1 Birch
Diameter 1100'
Bearing _____
Distance _____

Original Evidence Found

Year of search _____ By _____
Monument found _____

Original Bearing Trees Found

Species _____
Diameter _____
Bearing _____
Distance _____

Subsequent Corner Restoration

Year surveyed 1958 By SAM BENZING
Where filed or recorded ITASCA
Monument IRON PIPE WITH BRASS CAP
(Original, concrete post, iron rod, etc.)

Evidence of Subsequent Corner Restoration Found

Year of search 1979 By JIM SCHOONOVER
Monument BENT OVER

Bearing Trees, Reference Objects

Species	<u>ELM</u>	<u>BIRCH</u>	<u>ASH</u>
Diameter	<u>8"</u>	<u>8"</u>	<u>5"</u>
Bearing	<u>S. 23° E</u>	<u>S. 25 W</u>	<u>S. 10° W</u>
Distance	<u>172.20'</u>	<u>162.20'</u>	<u>280.30'</u>

Bearing Trees, Reference Objects

Species	<u>ELM</u>	<u>BIRCH</u>
Diameter	<u>19"</u>	<u>15"</u>
Bearing	<u>S. 23° E</u>	<u>S. 25 W</u>
Distance	<u>172.20'</u>	<u>162.20'</u>

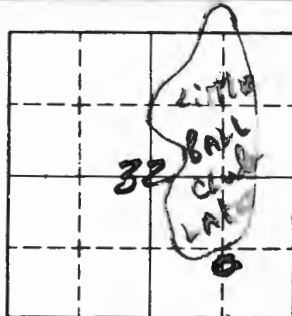

Sketch

○ Corner ▨ F.S. Land

Relation of Evidence to Record Features Along Section Lines

Section line to sections _____
 Object _____
 Record distance _____
 Measured distance _____

Other Evidence

Describe evidence of use and occupation such as roads, fences, clearings, timber cutting lines, plantations, etc.. Cite source of testimony if any. _____

Monument need to be
 strengthened out
 + one more BT

At time of search:

1. Did you have the record description?

Yes _____ No _____

2. How was search area located?

Pacing, chaining, photos, maps,
 etc. _____

3. Man hours spent in search _____

4. Do you think additional search might

recover evidence? Yes _____ No _____

5. Signature _____

Perpetuation Record

Monument and accessories established. Include brief description of area. _____

SET STEEL Post with signs — South
 OF Monument

Certified corner restoration certificate prepared: Yes _____ No _____

Filed in county records at _____ Date _____ County Document No. _____

Identified on aerial photo No. _____ Which is filed at _____