

NEW BT'S AT E.W. 1/16 S 35

~~DK~~
10" S. MAPLE N68W 71.08'
11" S. MAPLE N62E 19.78'
7" S. MAPLE S62E 63.00'

NO BT'S

6" Birch SNAG 8' SW
8" Birch

NEW BT'S AT SW 1/16 S 35

~~DK~~
12" W OAK N08E 49.03
10" R. OAK N88E 16.42

6 BT'S

11" P. OAK 14.76
14" Birch 17.34

~~SK~~
NEW BT'S AT 1/4 S 34 35
5" S. MAPLE N02E 30.64'

27.15
20.88
50.61

53

~~NEW BT'S A 4/4 S 26~~

~~17" N. PINE 016 E 132.22'~~

~~6" Ash S 35° W 27.47'~~

~~16" N. PINE S 02° W 152.74'~~

~~GLO BT~~

~~21" N. PINE S 64 E 112.2'~~

~~C E Y 16~~

~~14" N. PINE N 15 E 21.97'~~

~~14 N. PINE S 74 W 8.13'~~

~~GLO~~

~~8" N. PINE S 6° E 14.72'~~

~~2.5' N. PINE N 61 W 11.85'~~

8/8/78

DKCM

PY PD

RANDOM + TREE LINE

C.S. $\frac{1}{16}$ SG TO

S.W. $\frac{1}{16}$ SG

T147N R 31W

NEW BT AT C.S. $\frac{1}{16}$ SG

6" ELM 31.46' N70°W

BT'S PRESENT

9" ELM 18.59 S16°E

6" ELM 34.31 DUE WEST

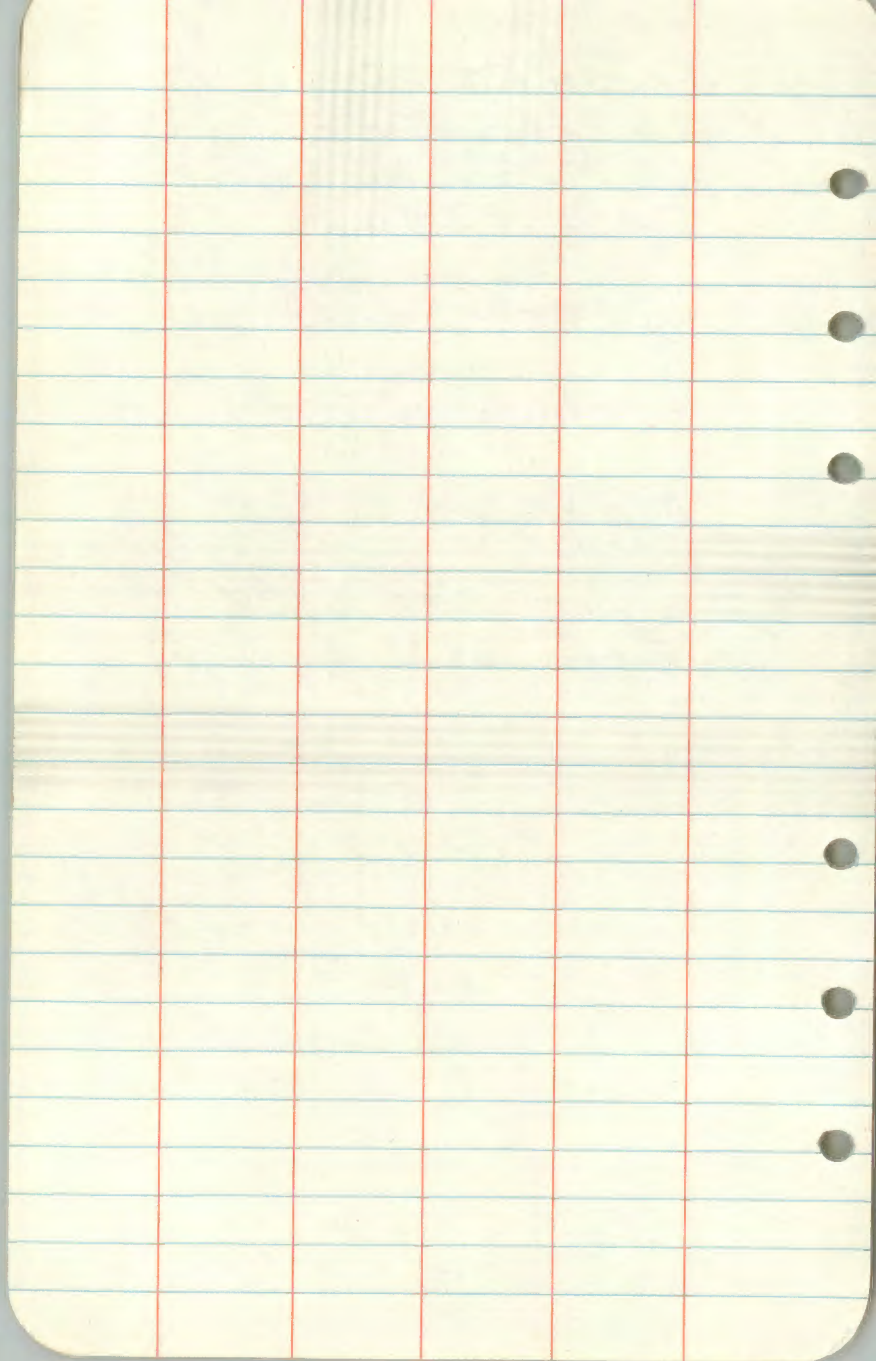

BT'S A S COR 20, 21, 16, 17

N. PINE 13" N30°E 58.20'

N. PINE 19' N58W 85.67'

W. PINE 8" S37W 75.91'

NEW BT'S

N. PINE 16" S60W 122.43'

N. PINE 19" S33W 114.88'

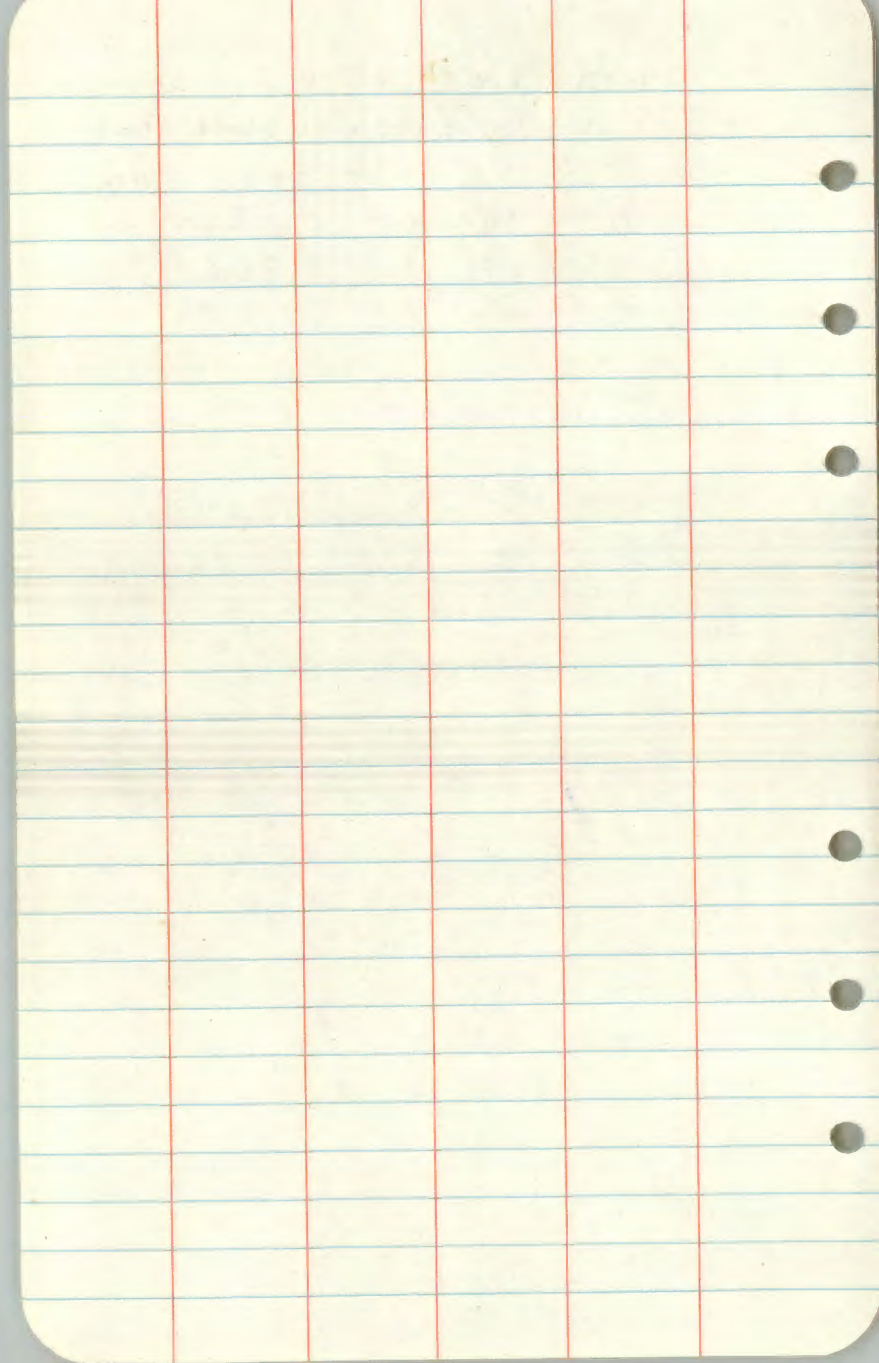

C D 8.30'
~~4.90~~ EAST OFFSET

1302.48'

D ~~3.13~~ EAST OFFSET
3.63

D See
COR 1037.29

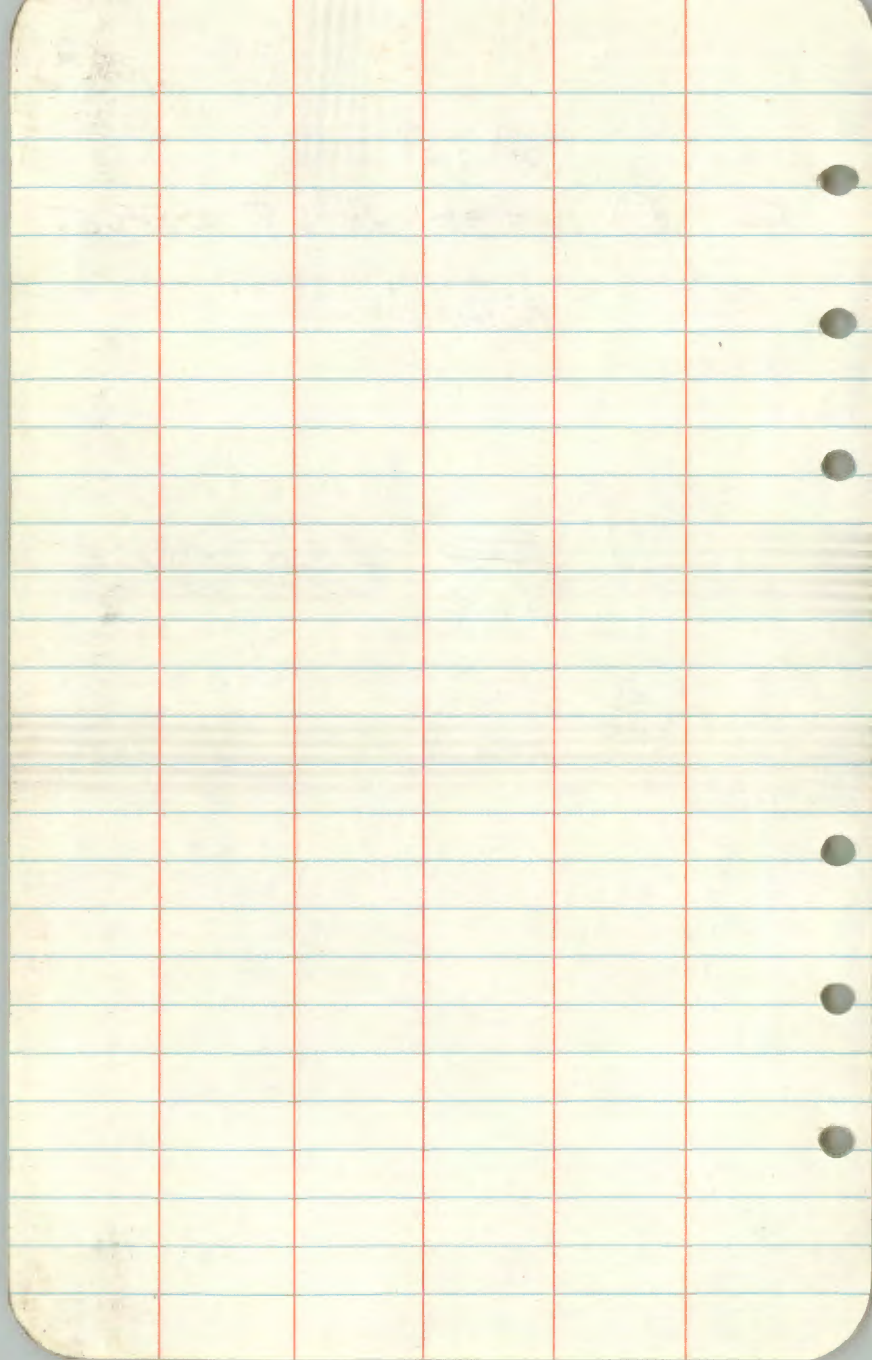

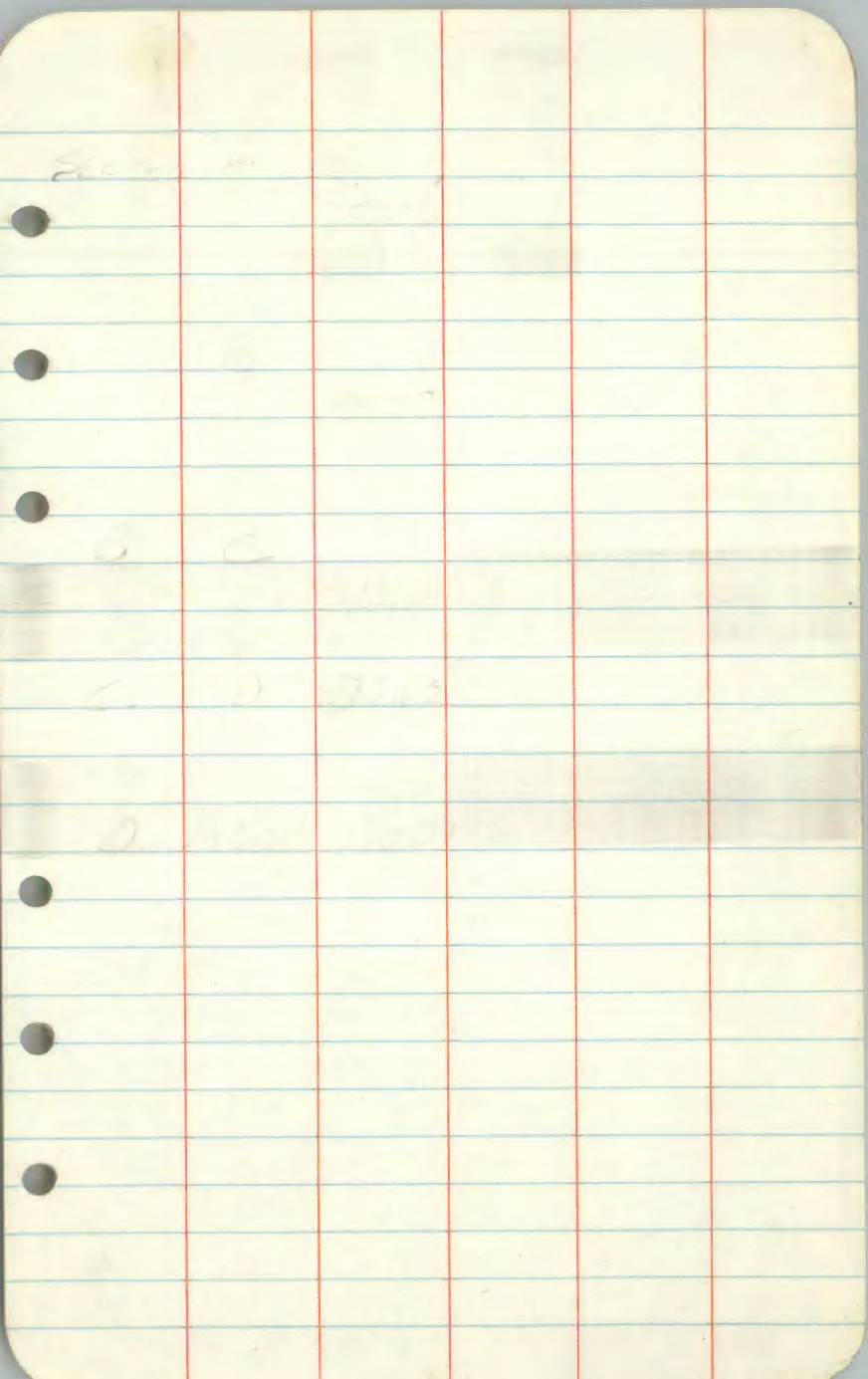

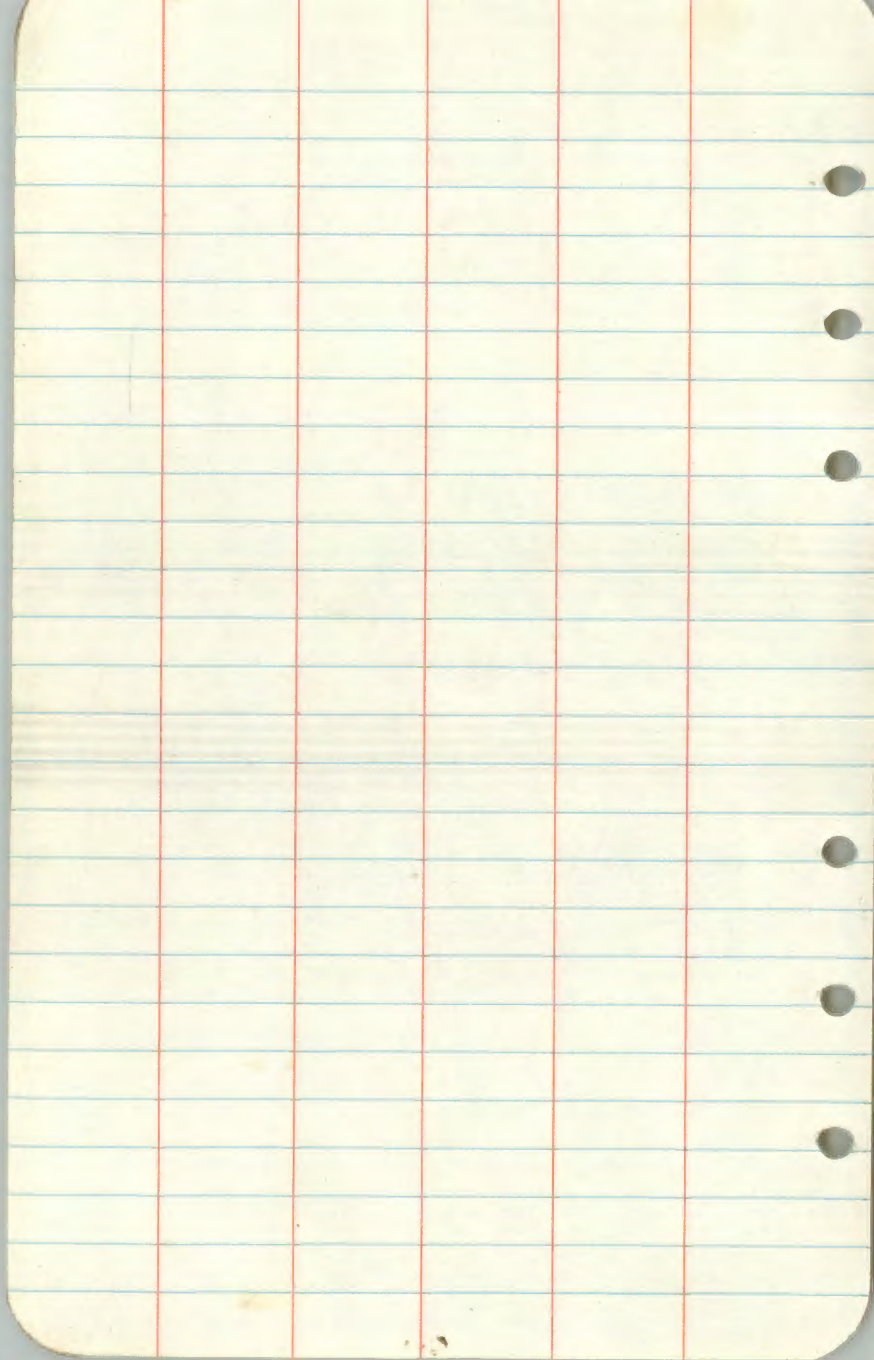

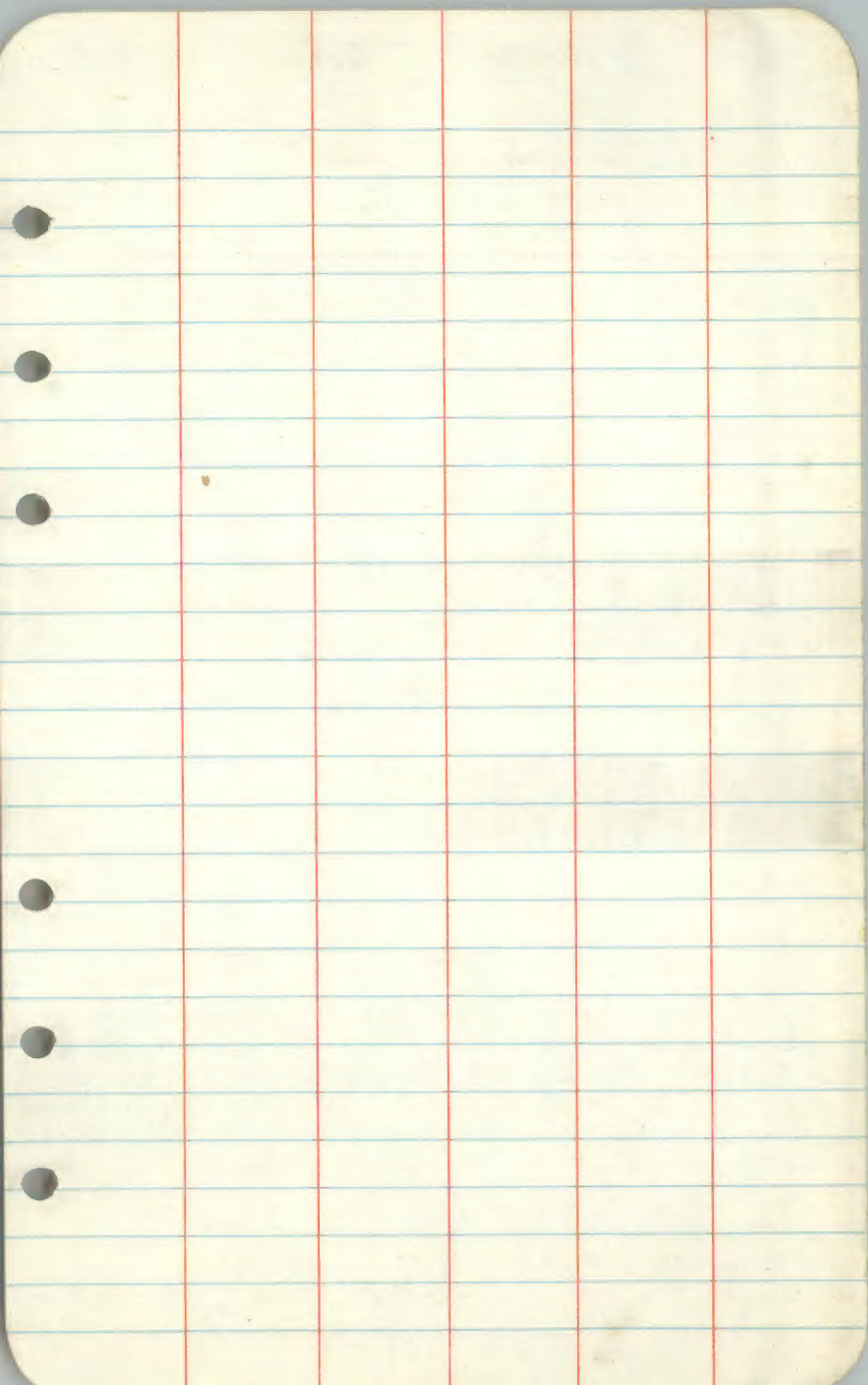

ELEV

3.6%

S

1

1392.85 4.25'

7.25 1385.33 7.77'

1385.68 AT M.H

10'1" 28' Past M.H.

8'6.5" ON M.H.

25.5"

$\frac{4''}{2'1''}$

want 3.5%

2°

1.74

1.74

3.48

2'1" / 28'

5.6"

X 1795955 ↷

139285

Sinai ELEV.

139285

ELEV

STA

1 STEP 1382.85' 4.25' AT STEP
WANT 1385.33' 7.17'
TOP M.H. 1385.68' HT 4.200'

1358.68'

28' PAST M.H. 10.1' AT
M.H. 8' 6 1/2"

ELIAT PJC 7' 9 1/2"

EL AT JET BOX 10' 10 1/4" AT 119' FR M.H.

FL SE PT 11' 4 1/4" AT 90'

EL SW PT 11' 3" AT 60'

1/2% slope

9/6/78
OK

PT.

ELEV.

M. HAT PVC 9' 1 1/4"

END OF TRUNK 9' 7 1/4"

START OF HILL 8' 1/4" 8 8 3/4

+ 18' 8' 1 1/2"

+ 36' 8' 8 1/2"

Y JCT. + 54' 9' 1/2"

LEFT Y + 12' 8' 7 1/2"

+ 36' 9' 1/4"

+ 54' 9' 1/2"

+ 72' 9' 2"

RT Y + 18' 8' 10 1/2"

+ 36' 9' 3 1/4"

+ 54' 9' 3 1/4"

+ 72' 9' 5 1/2"

AT PVC 8' 8" . 65" ✓

+ 10' 8' 9" . 25" ✓

+ 20 8' 9" . 85" ✓

+ 30' 8' 10" . 50" ✓

+ 40 8' 11" . 10" ✓

+ 50 8' 11" . 70" ✓

+ 60 9' 0" . 30" ✓

+ 70 9' 0" . 90" ✓

+ 80 9' 1" . 50" ✓

| | PT | ELEV. |
|--------|-------|----------|
| | +90' | 9'2"1" ✓ |
| | +100' | 9'2"70" |
| | +110' | 9'3"30" |
| | +120' | 9'3"90" |
| 4 JCT. | +126' | 9'4"20" |

9/17/78
DK, DD,
CMI, JH

RANDOM + TRUE LINE

SMC S20 TO CE 1/4 S20

T147N R31W

TRUE LINE IS BRUSHED
BLAZED PAINTED + POSTED
TO F.S. STANDARD

BT'S + ACCESSORIES AT SMC S20

8' METAL POST DUE EAST 4.87'

54-2 + 54-9 ATTACHED

| | | | |
|-----------|-----|------|--------|
| GLO CEDAR | 14 | S69E | 22.57' |
| CEDAR | 8" | S85E | 30.65' |
| CEDAR | 11" | N61E | 43.14' |
| CEDAR | 15 | N20E | 45.33' |

| STA OCCUPIED | STA SIGHTED | 1ST X | 2ND X | MEAN X |
|-----------------|----------------|----------------|------------|------------|
| CE 1/6 | SMC 520 | 0° 00' 00" | 0° 00' 00" | 0° 00' 00" |
| | | 99.90' | | 99.90' |
| | | 99.81' | | 99.81' |
| | | 75.85' | | 75.85' |
| | | TOTAL DISTANCE | | 275.56' |

RECORDED DISTANCE 275.88'

9/7/78

DK, DD

CM, JH

RANDOM + TRUE LINE

SMC S20 TO CE Y16 S20

T147N R31W

⊕ SMC S20

⊕ CE Y16

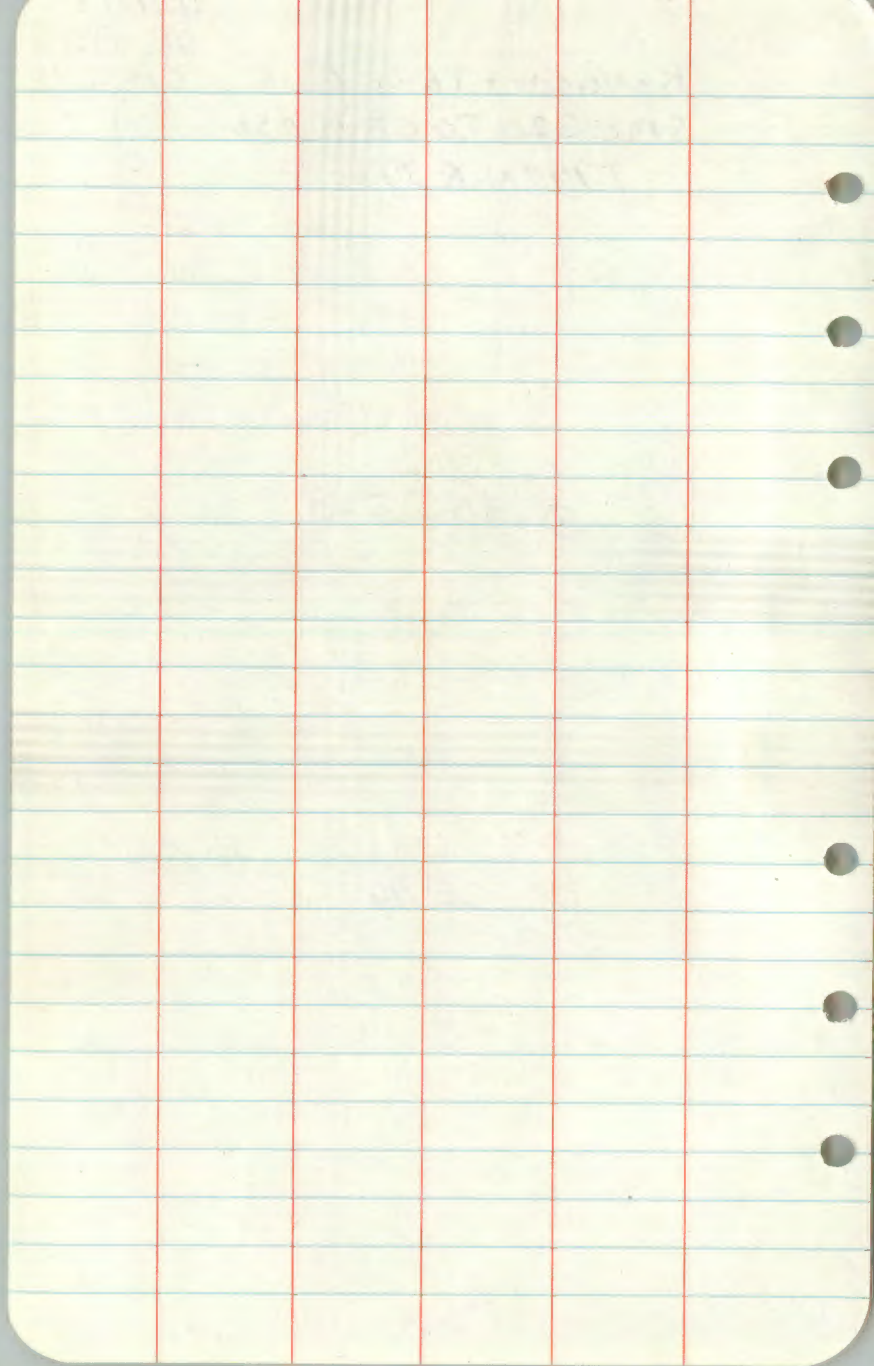

9/18/78

DK, CM
DP, JH

RANDOM + TRUE LINE

CE $\frac{1}{16}$ S20 TO $\frac{1}{4}$ S20 + 21

T147N R31W

TRUE LINE IS BRUSHED
BLAZED PAINTED + POSTED
TO F.S.M. STANDARDS

✓

BT'S + ACCESSORIES AT CE $\frac{1}{16}$ S20

8' METAL POST DUE EAST 3.25'

| STA OCCUPIED | STA SIGHTED | 1ST X | 2ND X | MEAN X |
|-----------------|----------------|------------|------------|------------|
| CE 1/16 | SMG 520 | 0°00'00" | | |
| | 1 | 180°00'00" | 360°00'00" | 180°00'00" |
| | | 99.12' | | 99.12' |
| | | 99.35' | | 99.35' |
| | | 89.47' | | 89.47' |
| | | | | 287.94' |

26 OFFSET

| | | | | |
|---|------------|------------|------------|------------|
| 1 | CE 1/16 | 0°00'00" | | |
| | 1/4 520+21 | 179°56'00" | 359°52'00" | 179°56'00" |
| | | 99.48' | | 99.48' |
| | | 99.55' | | 99.55' |
| | | 99.92' | | 99.92' |
| | | 99.34' | | 99.34' |
| | | 99.67' | | 99.67' |
| | | 99.66' | | 99.66' |
| | | 99.48' | | 99.48' |
| | | 99.99' | | 99.99' |
| | | 99.85' | | 99.85' |
| | | 99.34' | | 99.34' |
| | | 8.51' | | 8.51' |
| | | | | 1004.79' |

TOTAL DISTANCE 1292.73

RECORDED DISTANCE 1292.28

9/18/78
DK, CM
DD, JH

RANDOM + TRUE LINE
CE $\frac{1}{16}$ S20 TO $\frac{1}{4}$ S20 + 21
T147N R31W

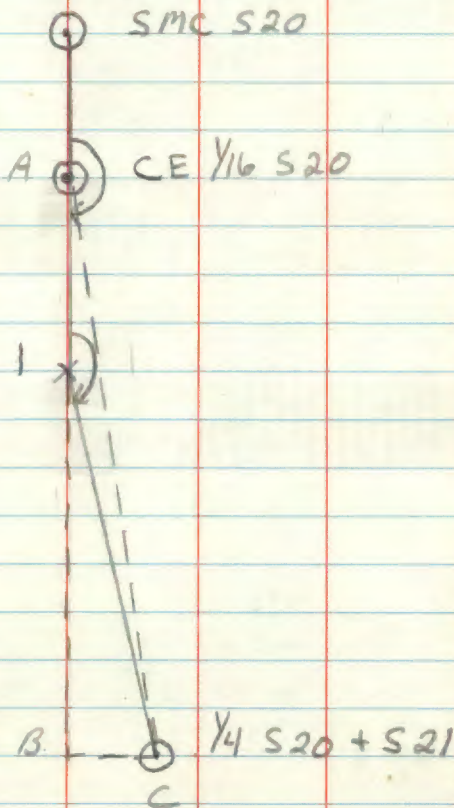

$$\begin{aligned}
 BC &= C \sin A \\
 &= 1004.79 (.00116) \\
 &= 1.165 \\
 &= 1.17' \text{ off BC.}
 \end{aligned}$$

$$\begin{aligned}
 | B &= C \cos A \\
 | B &= 1004.79 (\text{ONE}) \\
 | B &= 1004.79'
 \end{aligned}$$

$$\begin{aligned}
 \text{TAN } \angle A &= \frac{a}{b} \\
 &= \frac{1.17'}{1292.73'} \\
 &= .000905 \\
 &= .091' \text{ OFFSET N/100}'
 \end{aligned}$$

$$AC = \frac{1292.73'}{\text{ONE}}$$

$$AC = 1292.73'$$

OFFSET AT PT 1 .26'

9/18/78
DK, DD
cm, JH

RANDOM + TRUE LINE

1/4 S 20 + S 21 TO

CW 1/16 S 21

T 147N R 31W

TRUE LINE IS BRUSHED BLAZED
PAINTED + POSTED TO F.S.M. STANDARD

BT'S + ACCESSORIES AT CW 1/16 S 21

W SPRUCE 7" N 89W 10.52'

W SPRUCE 7" N 49E 41.18'

W SPRUCE 10" S 22W 9.15'

4x4 wood post 321.53' WEST 54-6

8' METAL POST DUE WEST 3.04'

54-2 + 54-9 ATTACHED

BT'S + ACCESSORIES AT 1/4 S 20 + 21

4x4 wood post 25.77' EAST

4x4 wood post 24.20' WEST

54-9 + 54-2 + 54-6

| STA | STA | 1ST X | 2ND X | MEAN X |
|----------|-----------------------------|--------------|--------------|---------------|
| occupied | sighted | | | |
| 4520121 | P ^T ON LINE W | 0° 00' 00" | | |
| | 1 | 181° 12' 00" | 362° 24' 00" | 181° 12' 00" |
| | | | | 99.02' |
| | | | | 99.59' |
| | | | | 99.57' |
| | | | | 99.41' |
| | | | | 99.76' |
| | | | | 99.94' |
| | | | | 25.82' |
| | | | | 623.11' .56'S |
| 1 | 4520121 | 0° 00' 00" | | |
| | 2 | 180° 00' 00" | 360° 00' 00" | 180° 00' 00" |
| | | | | 99.55' |
| | | | | 99.87' |
| | | | | 99.96' |
| | | | | 26.57' |
| | | | | 325.95' .85'S |
| 2 | 1 | 0° 00' 00" | | |
| | 3 | 180° 10' 30" | 360° 21' 00" | 180° 10' 30" |
| | | | | 100.00' |
| | | | | 100.00' |
| | | | | 99.53' |
| | | | | 97.34' |
| | | | | 396.87' |

9/18/78
DK CM
DD JH

RANDOM + TRUE ZONE
Y4 S20 + 21 TO
CW Y16 S21
T147N R31W

N
1

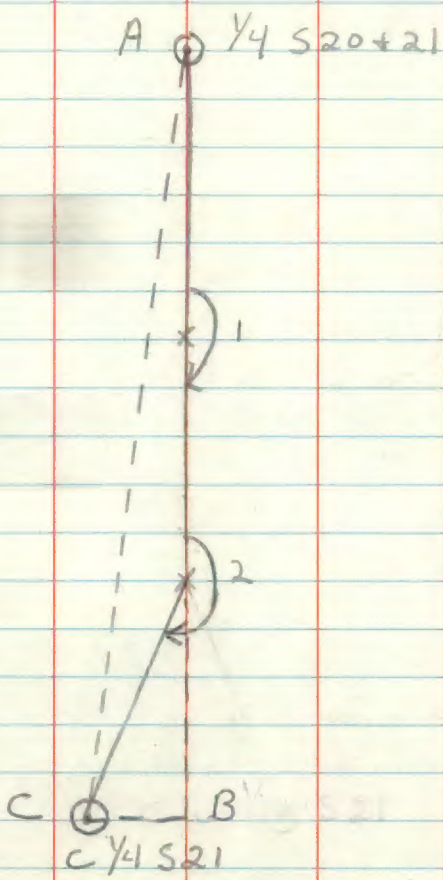

TOTAL DISTANCE 1345.93

RECORDED DISTANCE 1346.40'

COMPUTED DIST. 1345.93
.57'

$$CB = 396.87 (.00306) \\ = 1.214'$$

$$2B = CGOS A \\ = 396.87 (ONE) \\ = 396.87'$$

$$\text{TAN } \angle A = \frac{1.214'}{1345.93'} \\ = .0009019 \\ = .09' \text{ OFFSET } S / 100'$$

$$AC = \frac{1345.93}{ONE} \\ = 1345.93'$$

OFFSET AT PT 1 .56'

OFFSET AT PT 2 .85'

9/23/78
OK, CPA
DP, JH

RANDOM TRUE LINE
1/4 S 16 + 21 TO
C 1/4 S 21
T147N R31W

TRUE LINE IS BRUSHED
BLAZED PAINTED + POSTED
TO F.S.M. STANDARDS

BT'S + ACCESSORIES AT C 1/4 S 21

| | | |
|---------------|-----------|--------------|
| 8' METAL POST | ONE NORTH | 3.35' |
| MAPLE | 7" | N60E 100.75' |
| SPRUCE | 13" | S11E 80.20' |
| GLO SPRUCE | 11" | S17E 263.58' |
| SPRUCE | 11" | S04W 81.98' |

| STA | STA | 1ST Y | 2ND Y | MEAN X |
|-----|-----|-------|-------|--------|
|-----|-----|-------|-------|--------|

| | | | | |
|---------|---------|---------|--|--|
| 4516+21 | SEL COR | 0 00 00 | | |
|---------|---------|---------|--|--|

| | | | | |
|----------------|--|-------------|--|-------------|
| 16, 17, 20, 21 | | 90° 34' 00" | | 90° 34' 00" |
|----------------|--|-------------|--|-------------|

| | | | | |
|---|--|--|--|-------|
| 1 | | | | 82.90 |
|---|--|--|--|-------|

| | | | | |
|--|--|--|--|-------|
| | | | | 93.63 |
|--|--|--|--|-------|

| | | | | |
|--|--|--|--|--------|
| | | | | 176.53 |
|--|--|--|--|--------|

| | | | | |
|---|---------|---------|--|--|
| 1 | 4516+21 | 0 00 00 | | |
|---|---------|---------|--|--|

| | | | | |
|---|--|--------------|--------------|--------------|
| 2 | | 180° 00' 00" | 360° 00' 00" | 180° 00' 00" |
|---|--|--------------|--------------|--------------|

| | | | | |
|--|--|--|--|-------|
| | | | | 99.79 |
|--|--|--|--|-------|

| | | | | |
|--|--|--|--|-------|
| | | | | 99.55 |
|--|--|--|--|-------|

| | | | | |
|--|--|--|--|-------|
| | | | | 81.08 |
|--|--|--|--|-------|

| | | | | |
|--|--|--|--|--------|
| | | | | 280.42 |
|--|--|--|--|--------|

| | | | | |
|---|---|---------|--|--|
| 2 | 1 | 0 00 00 | | |
|---|---|---------|--|--|

| | | | | |
|---|--|--------------|--------------|--------------|
| 3 | | 180° 00' 00" | 360° 00' 00" | 180° 00' 00" |
|---|--|--------------|--------------|--------------|

| | | | | |
|--|--|--|--|-------|
| | | | | 99.73 |
|--|--|--|--|-------|

| | | | | |
|--|--|--|--|-------|
| | | | | 99.60 |
|--|--|--|--|-------|

| | | | | |
|--|--|--|--|-------|
| | | | | 05.79 |
|--|--|--|--|-------|

| | | | | |
|--|--|--|--|--------|
| | | | | 205.12 |
|--|--|--|--|--------|

9/25/78

DK, CM

DD, JH

RANDOM + TRUE LINE

Y4 S16 + S21 TO

C Y4 S21

T147N R31W

TRUE LINE IS BRUSHED
BLAZED PAINTED + POSTED
TO F.S.M. STANDARDS

3

2 0° 00' 00"

4 180° 00' 00" 360° 00' 00" 180° 00' 00"

99.51'

99.42'

99.76

99.81

99.78

99.71

99.54

99.65

65.32

862.50

4

3 0° 00' 00"

5 180° 00' 00" 360° 00' 00" 180° 00' 00"

99.47'

99.17'

99.45

57.03

355.10 134

9/25/78

DK, CM

DD, IH

RANDOM + TRUE LINE

Y4 S16+21 TO

CY4 S21

T147N R31W

TRUE LINE IS DOTTED

RANDOM + TRUE LINE

TO E514 S21 W1

| STA | STA | 1ST X | 2ND X | 3RD X |
|----------|---------|-------|-------|-------|
| occupied | sighted | | | |

| | | | | |
|---|---|------------|------------|------------|
| 5 | 4 | 0°00'00" | | |
| | 6 | 180°00'00" | 360°00'00" | 180°00'00" |

99.66'

99.74'

99.69'

99.63'

99.16'

99.56'

3.38'

600.82'

| | | | | |
|--------|---|------------|------------|------------|
| 6 | 5 | 0°00'00" | | |
| C/4S21 | | 179°19'00" | 358°18'00" | 179°19'00" |

99.47'

58.00'

157.47'

TOTAL DISTANCE 2637.96'

RECORDED DIST. 2636.04'

COMPUTED DIST. 2638.13'

2.09'

9/25/78
DK, CM
DD, TH

RANDOM + TRUE LINE
Y4 S16 + S21 TO
C/Y S21
T147N R31W

Y4 S16 + S21

N1

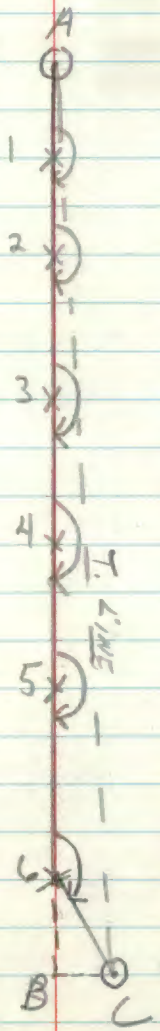

C/Y S21

$$BC = 157.47(.01193) \\ = 1.88'$$

$$6B = 157.47(.99993) \\ = 157.46'$$

$$AB = 2637.95'$$

$$\text{TAN } \alpha = \frac{1.88'}{2637.95} \\ = .0007126 \\ = .071' \text{ OFFSET E } / 100'$$

$$AC = \frac{2637.95'}{.99993} \\ = 2638.13'$$

| | |
|----------------|-------|
| OFFSET AT PT 1 | .12' |
| " AT PT 2 | .32' |
| " AT PT 3 | .47' |
| " AT PT 4 | 1.08' |
| " AT PT 5 | 1.33' |
| " AT PT 6 | 1.76' |

8/16/78

DK CM

JH

RANDOM + TRUE LINE

C/4 S22 TO CE 1/16 S22

S T 147N R 31 W

TRUE LINE IS BRUSHED
BLAZED, PAINTED + POSTED
TO F.S. STANDARDS

BT'S + ACCESSORIES - CE 1/16 S22.

8' METAL POST DUE WEST 3.00'

8' METAL POST DUE EAST 3.33'

SIGNS 54-2 + 54-9 ATTACHED

14" R. PINE N84°W 77.31'

GLO 15" R. PINE N40°E 12.94'

16" R. PINE N70°E 54.13'

| STA OCCUPIED | STA SIGHTED PT ON LINE S | 1ST X | 2ND Y | MEAN Y |
|-----------------|-----------------------------------|------------|------------|------------|
| C/4522 | | 0°00'00" | | |
| | 1 | 273°00'00" | 346°00'00" | 279°00'00" |
| | | | | 99.23' |
| | | | | 99.75' |
| | | | | 99.33' |
| | | | | 71.91' |
| | | | | 370.22' |

| | | | | |
|---|--------|------------|------------|------------|
| 1 | C/4522 | 0°00'00" | | |
| | 2 | 180°00'00" | 360°00'00" | 180°00'00" |
| | | | | 99.86' |
| | | | | 99.35' |
| | | | | 99.72' |
| | | | | 99.89' |
| | | | | 99.61' |
| | | | | 99.65' |
| | | | | 116.89' |
| | | | | 644.97' |

| | | | | |
|---|------------|------------|------------|------------|
| 2 | 1 | 0°00'00" | | |
| | CE 1/6 S22 | 179°57'00" | 359°54'00" | 179°57'00" |
| | | | | 99.52' |
| | | | | 99.78' |
| | | | | 99.42' |
| | | | | 10.90' |
| | | | | 309.62' |

TOTAL DISTANCE 1324.81'

8/16/78
DK, CM
DD, JH

RANDOM + TRUE LINE
C Y4 S22 TO CE Y16 S22
T147N R31W

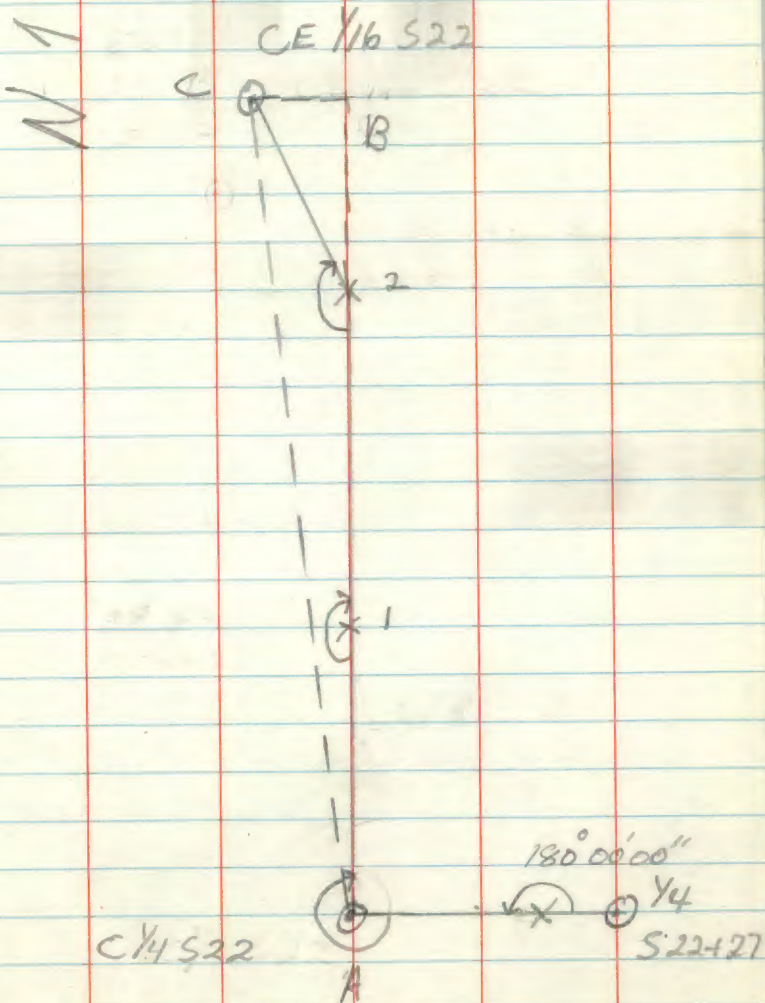

$$\begin{aligned} BC &= 309.62(.00087) \\ &= .2693 \\ &= .27' \end{aligned}$$

$$\begin{aligned} 2C &= 309.62(ONE) \\ &= 309.62 \end{aligned}$$

$$\begin{aligned} AC &= \frac{1324.81}{ONE} \\ &= 1324.81 \end{aligned}$$

$$\begin{aligned} \text{CORRECTION} &= \frac{.27'}{1324.81} \\ \text{TAN } \alpha &= \frac{.27'}{1324.81} \end{aligned}$$

$$= .0002038$$

$$= .020' \text{ OFFSET N/100'}$$

OFFSET AT PT 1 .07'
" AT PT 2 .20'

8/21/78
DK, CM
DD, J.H

RANDOM + TRUE LINE
CE 1/16 S 22 TO 1/4 S 22 + 23
T147N R31W

TRUE LINE IS BRUSHED
BLAZED PAINTED + POSTED
TO F.S.M. STANDARDS

BT'S AT 1/4 S 22 + S 23

cedar 9" S 12° W 26.39'
cedar 8" N 83° W 19.88'
cedar 8" N 15° W 8.22'

8' METAL POST DUE W 2.94'
8' METAL POST + SIGN DUE S 2.97'
54-2 + 54-4 ATTACHED

| STA | STA | 1ST X | 2ND X | MEAN X |
|------------|-----------------|------------|-------|--------|
| occupied | SIGHTED | | | |
| CE 1/6 S22 | PT ON TRUE S22W | 0° 00' 00" | | |

| | | | |
|---|--------------|--------------|--------------|
| 1 | 180° 00' 00" | 360° 00' 00" | 180° 00' 00" |
|---|--------------|--------------|--------------|

99.47'

99.22'

99.50'

79.78'

377.97'

| | | |
|---|------------|------------|
| 1 | CE 1/6 S22 | 0° 00' 00" |
|---|------------|------------|

| | | | |
|---|--------------|--------------|--------------|
| 2 | 180° 01' 30" | 360° 03' 00" | 180° 01' 30" |
|---|--------------|--------------|--------------|

99.94'

99.79'

99.50'

99.38'

99.13'

99.20'

99.56'

99.72'

99.66'

53.68'

949.56'

MEASURED DISTANCE 1327.53'

RECORDED DISTANCE 1323.96'

8/21/78
DK, CM
DR, JH

RANDOM-TRUE LINE

CE $\frac{1}{6}$ S22 TO $\frac{1}{4}$ S22 + S23

T147N R31W

N1

$\frac{1}{4}$ S22 + S23

B ○ C

PT 1 (X)

CE $\frac{1}{6}$

○

* FROM TRUE LINE
PT 2 X CE $\frac{1}{4}$ TO CE $\frac{1}{6}$ S22

$$BC = 949.56' (.00044)$$

$$= .4178064$$

$$= .42'$$

$$IC = 949.56' (\text{ONE})$$

$$= 949.56'$$

$$AC = \frac{1327.53'}{\text{ONE}}$$

$$= 1327.53'$$

$$\text{TAN } \theta = \frac{.42}{1327.53}$$

$$= .0003163$$

$$= .03 \text{ OFFSET } S/100'$$

OFFSET AT PT 1 .11'

8/22/78
DK, CM
DD, JH

RANDOM + TRUE LINE
1/4 S 22 + S 23 TO
S 1/16 S 22 + S 23
T147N R31W

TRUE LINE IS BRUSHED, BLAZED,
PAINTED + POSTED TO
F.S. STANDARDS

BT'S + ACCESSORIES AT
S 1/16 S 22 + S 23

| | | | |
|----------------------|-----|---------|--------|
| GLO CEDAR | 11" | S 58° W | 12.01' |
| CEDAR | 7" | N 10° E | 16.82' |
| CEDAR | 7" | N 10° E | 58.89' |
| GLO SPRUCE STAMP | 7" | S 71° E | 12.54' |
| 8' STEEL POST DUE N | | | 3.31' |
| 54-2 + 54-4 ATTACHED | | | |

| STA | STA | 1ST X | 2ND X | MEAN X |
|-----------|-----------------|-------------|--------------|-------------|
| occupied | SIGHTED | | | |
| 1/4 52+23 | PT ON LINE W | 0° 00' 00" | | |
| | 1 | 93° 04' 00" | 186° 08' 00" | 93° 04' 00" |
| | | 99.83' | | 99.83' |
| | | 98.75' | | 98.75' |
| | | 95.16' | | 95.16' |
| | | 99.13' | | 99.13' |
| | | 99.94' | | 99.94' |
| | | 99.76' | | 99.76' |
| | | 99.44' | | 99.44' |
| | | 86.31' | | 86.31' |
| | | | | 778.32' |

| | | | | |
|---|------------|--------------|--------------|--------------|
| 1 | 1/4 52+23 | 0° 00' 00" | | |
| | 5/16 52+23 | 180° 00' 00" | 360° 00' 00" | 180° 00' 00" |
| | | 99.45' | | 99.45' |
| | | 99.37' | | 99.37' |
| | | 78.05' | | 78.05' |
| | | 99.37' | | 99.37' |
| | | 93.11' | | 93.11' |
| | | | | 469.35' |

TOTAL DISTANCE 1247.67'
 RECORDED DISTANCE 1248.75'

8/23/78
DK, CM
DP, JH

RANDOM + TRUE 2 WDS

Y S 22 + S 23 TO

S 1/6 S 22 + S 23

T 147N R 31W

N 1

⊕ S 1/6 S 22 + S 23

PLACED 8' METAL POST

3.31' N OF BRASS CAP

⊗ 1 "WIGGLED" IN

NO OFFSETS

⊕ Y 4 S 22 + S 23

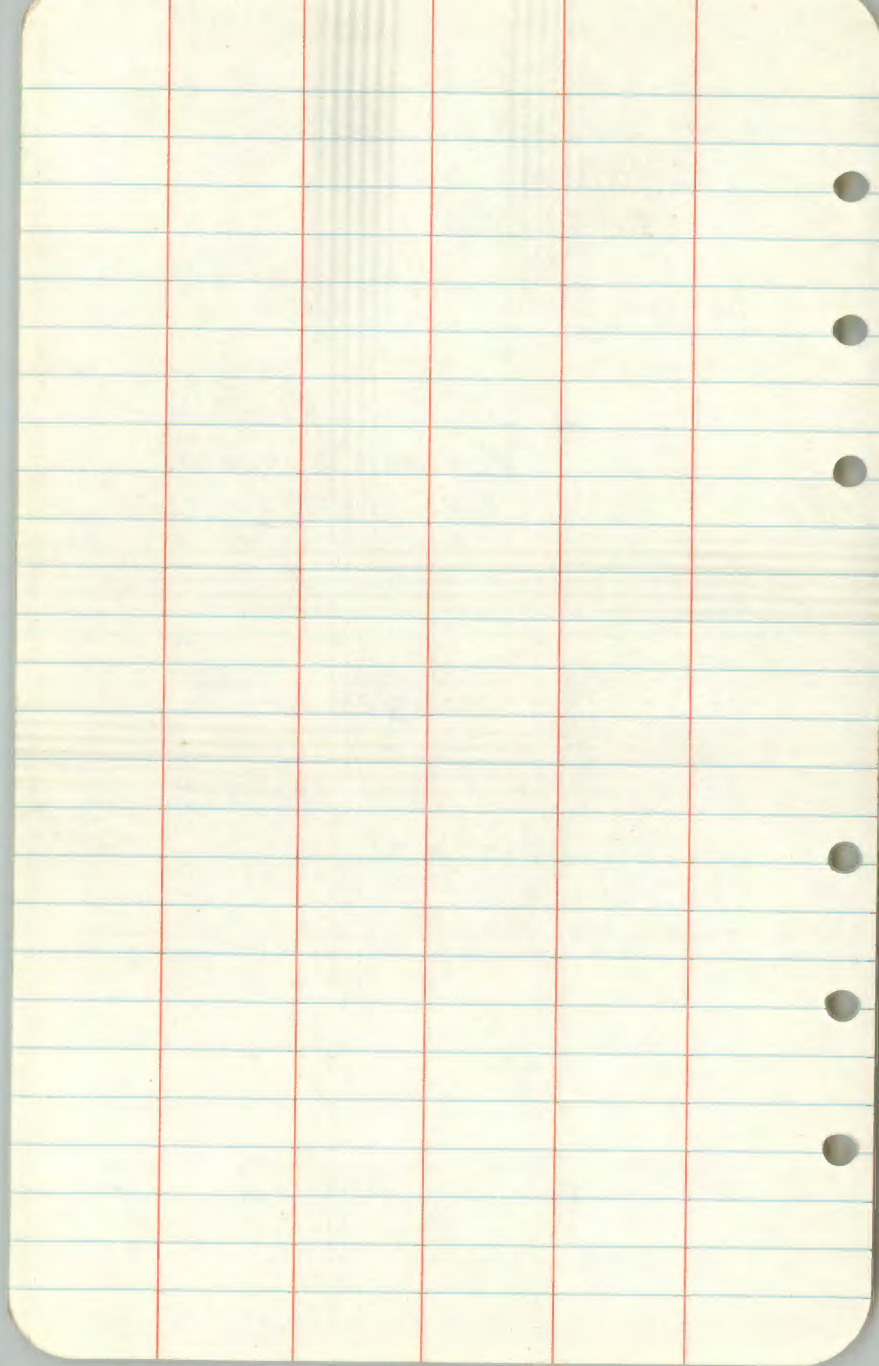

$$\begin{array}{r} 18112 \\ 18112 \\ \hline 36224 \end{array}$$

$$\begin{array}{r} 1346.4 \\ 1345.93 \end{array}$$

$$\begin{array}{r} 325.95 \\ 4.42 \\ \hline 321.53 \end{array}$$

~~S 31 + 32~~

S 26 + 25

35960

9034

28926

~~2.63 W~~
2.63 W

2.97 N

BT¹ SAT W 1/6 S 26+35

8' 2.63 W 54.2+4

8' 2.97 N 54.2+4

S.C. 26, 26-3435

8' EAST 3.60 E 54.2+4

8' NORTH 1.89 N 54.2+4

8/8/78
DK, P4
CM, DD

RANDOM + TRUE LINE
W $\frac{1}{16}$ S 26 + 35 TO
CW $\frac{1}{16}$ S 26
T 147 N R 31 W

TRUE LINE IS BRUSHED,
BLAZED, PAINTED, + PASTED
TO F. S. STANDARDS

BT'S + ACCESSORIES AT CW $\frac{1}{16}$ S 26

4x4 wood POST DUE SOUTH 461.10'

8" METAL POST DUE SOUTH 2.98'

54-2 + 54-4 SIGNS ATTACHED

12" TAMARAC N 16° W 89.26'

6" W OAK N 66° E 53.00'

4" SPRUCE S 06° W 70.32'

| STA | STA | 1ST X | 2ND X | MEAN X |
|-----|-----|-------|-------|--------|
|-----|-----|-------|-------|--------|

OCCUPIED SIGHTED
PT ON
W/1/16 S2635 LINE WEST 0° 00' 00"

| | | | | |
|---|--|-------------|--------------|----------------|
| 1 | | 87° 19' 00" | 174° 38' 00" | 87° 19' 00" |
| | | 92.29' | | 99.29' |
| | | 99.38' | | 99.38' |
| | | 99.87' | | 99.87' |
| | | 99.29' | | 99.29' |
| | | 45.76' | | 45.76' |
| | | | | <u>443.59'</u> |

1 W/1/16 S26435 0° 00' 00"

| | | | | |
|---|--|--------------|--------------|---------------|
| 2 | | 180° 00' 00" | 360° 00' 00" | 180° 00' 00" |
| | | 99.51 | | 99.51' |
| | | 99.36 | | 99.36' |
| | | 99.21 | | 99.21' |
| | | 65.95 | | <u>65.95'</u> |
| | | | | 364.03' |

2 1 0° 00' 00"

| | | | | |
|---|--|--------------|--------------|---------------|
| 3 | | 180° 00' 00" | 360° 00' 00" | 180° 00' 00" |
| | | 99.41 | | 99.41' |
| | | 99.49 | | 99.49' |
| | | 99.84 | | 99.84' |
| | | 61.29 | | 61.29' |
| | | 63.27 | | <u>63.27'</u> |
| | | | | 423.30' |

8/8/78
DK, P4
CM, DD

RANDOM + TRUE LINE

- W Y16 S 26 + 35 To

CW Y16 S 26

T 147 N R 31W

| STA Occupied | STA Sighted | 1ST X | 2ND X | MEAN X |
|-----------------|----------------|------------|------------|--------------|
| 3 | 2 | 0°00'00" | | |
| | 4 | 180°00'00" | 360°00'00" | 180°00'00" |
| | | 99.72 | | 99.72' |
| | | 99.75 | | 99.75' |
| | | 99.51 | | 99.51' |
| | | 99.39 | | 99.39' |
| | | 99.59 | | 99.59' |
| | | 99.71 | | 99.71' |
| | | 62.12 | | 62.12' |
| | | | | 659.79 1.15' |

| | | | | |
|---|---|------------|------------|---------------|
| 4 | 3 | 0°00'00" | | |
| | 5 | 180°00'00" | 360°00'00" | 180°00'00" |
| | | 99.59 | | 99.59' |
| | | 8.65 | | 8.65' |
| | | | | 108.24' 1.22' |

| | | | | |
|---|---|------------|--|---------------|
| 5 | 4 | 0°00'00" | | |
| | 6 | 180°00'00" | | |
| | | 99.71 | | 99.71' |
| | | 15.75 | | 15.75' |
| | | 92.98 | | 92.98' |
| | | | | 208.44' 1.35' |

8/8/78

DK CM

PY, DD

RANDON + TRUE

W 1/6 S 26 + 53 TO

CW 1/6 S 26

T147N R31W

| STA | STA | 1ST X | 2ND X | MEAN X |
|----------|---------|----------|-----------|---------------|
| OCCUPIED | SIGHTED | | | |
| 6 | 5 | 0'00"00" | | |
| | CW 1/16 | 180'300" | 360'2600" | 180'300" |
| | | 74.98 | | 74.98 |
| | | 99.43 | | 99.43 |
| | | 99.83 | | 99.83 |
| | | 99.82 | | 99.82 |
| | | 95.02 | | 95.02 |
| | | | | <u>469.08</u> |

TOTAL DISTANCE 2676.47'

RECORDED DIST 2674.32'

COMPUTED DIST. 2676.50'

2.18'

8/8/78
OK, CM
DD, P4

RANDOM + TRUE
w 1/16 S26 + S35 TO
C w 1/16 S26
T147N R 31W

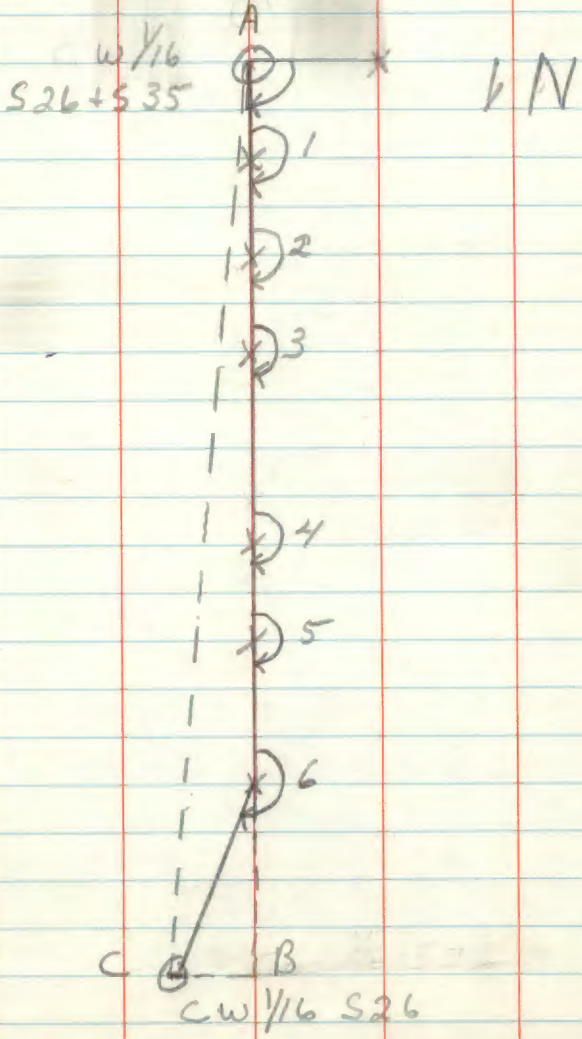

$$BC = 469.08(.00378) \\ = 1.77'$$

$$GC = 469.08(.99999) \\ = 469.08'$$

$$AB = 2676.47'$$

$$TANA = \frac{1.77'}{2676.47'} \\ = .0006613$$

$$= .07' \text{ OFFSET EAST}/100'$$

$$AC = \frac{2676.47'}{.99999} \\ = 2676.50'$$

| | | |
|--------|--------|-------|
| OFFSET | HTPT 1 | .31' |
| " | HTPT 2 | .57' |
| " | HTPT 3 | .86' |
| " | HTPT 4 | 1.32' |
| " | HTPT 5 | 1.40' |
| " | HTPT 6 | 1.55' |

8/3/78

DK CM

RANDOM + TRUE LINE PY 00

S COR 26, 27, 34, 35 TO

S $\frac{1}{16}$ COR S 26, 27

T 147 N R 31 W

TRUE LINE IS BRUSHED
BLAZED POSTED + PAINTED
TO F.S.M. STANDARDS

BT'S + ACCESSORIES AT

S $\frac{1}{16}$ COR S 26 + 27

4-17

N. PINE 11" S3°W 54.15'

R. OAK 14" S16°W 27.95'

GLO N. PINE 20" N48°W 19.14'

NO BT'S AVAILABLE TO EAST

| STA | STA | 1ST X | 2ND X | MEAN X |
|--|--------------------------------|--------------|--------------|-----------------|
| OCCUPIED SEC. COR 26, 27, 34, 35 | SIGHTED PT. ON EAST LINE | 0° 00' 00" | | |
| | 1 | 92° 49' 00" | | 92° 49' 00" |
| | | 99.65 | | 99.65 |
| | | 99.60 | | 99.60 |
| | | 12.96 | | 12.96 |
| | | | | 212.21' .85' |
| 1 | | 0° 00' 00" | | |
| | 2 | 180° 00' 00" | 360° 00' 00" | 180° 00' 00" |
| | | 99.86 | | 99.86 |
| | | 100.00 | | 100.00 |
| | | 99.96 | | 99.96 |
| | | 28.97 | | 28.97 |
| | | | | 328.79' 2.16' W |
| 2 | 1 | 0° 00' 00" | | |
| | 3 | 180° 00' 00" | 360° 00' 00" | 180° 00' 00" |
| | | 99.61 | | 99.61 |
| | | 99.79 | | 99.79 |
| | | 99.78 | | 99.78 |
| | | 20.75 | | 20.75 |
| | | | | 319.93' 3.44' |

8/3/78

DK, CM
P4, P0

Random + TRUE LINE

S. COR 26, 27, 34, 35 TO

S $\frac{1}{16}$ S 26 + 27

T 147 N R 31 W

| STA occupied | STA sighted | 1ST X | 2ND X | MEAN X |
|-----------------|----------------|------------|------------|------------|
| 3 | 2 | 0°00'00" | | |
| | 4 | 180°00'00" | 360°00'00" | 180°00'00" |
| | | 41.23' | | 41.23' |
| | | 72.30' | | 72.30' |
| | | 89.05' | | 89.05' |
| | | 24.59' | | 24.59' |
| | | 14.02' | | 14.02' |
| | | 21.09' | | 21.09' |
| | | | | 262.28' |

| | | | | |
|----|---|------------|------------|------------|
| *1 | 3 | 0°00'00" | | |
| | 5 | 180°00'00" | 360°00'00" | 180°00'00" |
| | | 24.81' | | 24.81' |
| | | 38.03' | | 38.03' |
| | | | | 62.84' |

| | | | | |
|---|---|----------------|------------|----------|
| 5 | 4 | 0°00'00" | | |
| | | S 1/16 S 26.27 | 177°47'00" | 355.3400 |
| | | | 177°47'00" | |
| | | 99.62' | | 99.62' |
| | | 42.06' | | 42.06' |
| | | | | 141.68' |

TOTAL DISTANCE 1327.73'
 RECORDED DIST. 1327.76'
 COMPUTED DIST. 1328.62'
 + .86'

8/4/78
OK, CM
P4, DP

RANDOM + TRUE LINE

S. COR 26, 27, 34, 35 TO

S 1/16 S 26 + 27

T147N R31W

OFFSET = .91/100 W

S 1/16

S 26 + 27

N 1

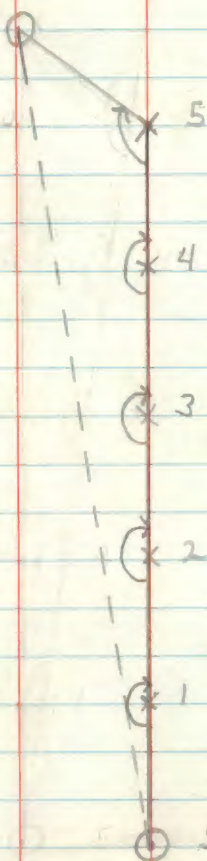

S.C. 26, 27, 34, 35'

$$BC = 141.68 (.03868) \\ = 5.48'$$

$$SC = 141.68 (.99925) \\ = 141.57'$$

$$AB = 1327.73 - (141.68 - 141.57) \\ = 1327.62'$$

$$\text{TAN } A = \frac{5.48'}{1327.62'} \\ = .0041276 \\ = .41' \text{ OFFSET WEST/100}'$$

$$AC = \frac{1327.62}{.99925} \\ = 1328.62'$$

OFFSET AT PT 1 .87'
AT PT 2 2.22'
AT PT 3 3.53'
AT PT 4 4.61'
AT PT 5 4.86'

7/10/78
DK, P4
CM, OD

RANDOM + TRUE LINE

SCORE 25, 26, 35, 36 TO

1/4 COR S 26 + 35

T147N R31W

TRUE LINE IS BRUSHED
BLAZED POSTED + PAINTED
TO F.S.M. STANDARDS

BT'S + ACCESSORIES AT 1/4 S 26 + 35

8' STEEL POST DUE EAST

1/4 X 4 WOOD POST EAST 765.35' 54-2,54%

STA STA

OCCUPIED SIGHTED 1ST X 2ND X MEAN X

S COR PT ON
25, 26, 35, 36 N/S S. LINE 0° 00' 00"

1 90° 18' 00" 180° 36' 00" 90° 18' 00"
352.06 90 05 05

1 S COR
25, 26, 35, 36 0° 00' 00"

2 180° 00' 00" 360° 00' 00" 180° 00' 00"
184.37' 91° 04' 20"

2 1 0° 00' 00"

3 180° 00' 00" 360° 00' 00" 180° 00' 00"

3 2 0° 00' 00"

4 180° 00' 00" 360° 00' 00" 180° 00' 00"

4 3 00° 00' 00"

44 COR
5 26+35 179° 50' 00" 359° 40' 00" 179° 50' 00"

RANDOM + TRUE LINES
S COR 25, 26, 35, 36 TO
1/4 COR 526 + 35

7/10/78
DR. PY
C.M. AD

1/4 COR 526 + 35



4" W. PINE 13.71' NE
7" J. PINE 10.88' NW

7" ASPEN 9.89' N
4" MAPLE 12.21' ESE

5" Basswood 5.65' W
4" Birch 4.61' N

S COR 25, 26, 35, 36

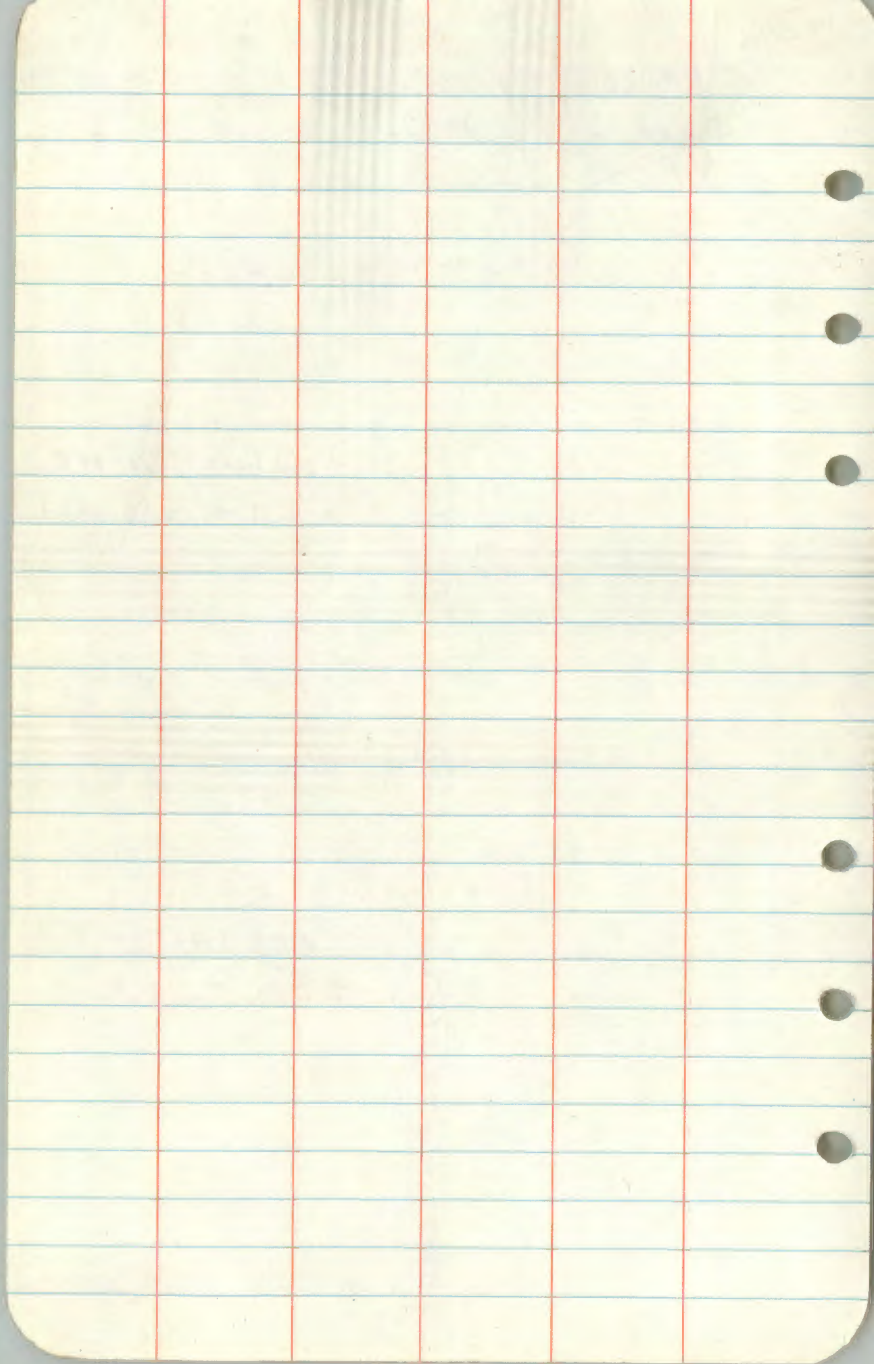

5/28/78

OK, MI

RANDOM + TRUE LINE

SEC. COR. 25, 26, 35, 36

TO

1/4 COR S 25 + 26

T147N R31W

TRUE LINES IS BRUSHED

BLAZED, PAINTED - POSTED

BT'S + ACCESSORIES AT S.C. 25, 26, 35 + 36

8' METAL POST DUE NORTH 3.13'

8' METAL POST DUE WEST 2.18'

| STA OCCUPIED | STA SIGHTED | 1ST X | 2ND X | MEAN X |
|-----------------|----------------|-------|-------|--------|
|-----------------|----------------|-------|-------|--------|

SEC. COR
34, 35, 36

DAE NORTH

| | | | | |
|---|--|--------|--|--------|
| 2 | | 99.40' | | 99.40' |
| | | 98.60' | | 98.60' |
| | | 97.85' | | 97.85' |
| | | 98.55' | | 98.55' |
| | | 99.45' | | 99.45' |
| | | 98.90' | | 98.90' |
| | | 99.10' | | 99.10' |
| | | 97.95' | | 97.95' |
| | | 98.90' | | 98.90' |
| | | 99.05' | | 99.05' |
| | | 99.10' | | 99.10' |
| | | 59.50' | | 59.50' |
| | | 75.20' | | 75.20' |

1221.55

2 SEC. COR 25, 26, 35, 36 0°00'00"

3 120°00'00" 360°00'00" 180°00'00"

| | | | | |
|-------------------|--|--------|-------------|---------|
| TIES: | | 99.00' | | 99.00' |
| 10" ASP 16.23' SE | | 1.05' | 8.35' E TOP | 1.05' |
| 10" ASP 13.85' E | | 98.70' | | 98.70' |
| | | 98.65' | | 98.65' |
| | | 99.45' | | 99.45' |
| | | 18.90' | | 18.90' |
| | | | | 415.75' |

5/25/78

DK, MW

RANDOM + TRUE LINE

SEC COR 25, 26, 35 + 36

TO

1/4 COR S 25 + 26

T147N R 31W

TIES: 4" ASP 1.02' W

3 2 0°00'00" "Birch 387'N

4 180°22'00" 360°44'00" 180°22'00"

99.25' 99.25'

98.45' 98.45'

98.50' 98.50'

90.95' 90.95'

387.15'

4 3 0°00'00"

5 180°29'00" 360°58'00" 180°58'00"

TIES: 98.70' 98.70'

ASP 9" S. 11' SW 97.10' 97.10'

ASP 10" 7.69' SE 53.75' 53.75'

249.55'

5 4 0°00'00"

1/4 COR 26+25 181°58'00" 363°57'00" 181°58'30"

TIES: 98.70' 98.70'

ASPEN 10" 16.23' SE 98.05' 98.05'

ASPEN 10" 13.85' E 98.25' 98.25'

77.10' 77.10'

372.10'

TOTAL DIST. = 2646.10'

5/25/78

RANDOM + TRUE LINE

DK, 111J

SEC COR 25, 26, 35, 36

TO 1/4 COR S 25 + 26

T147N R31W

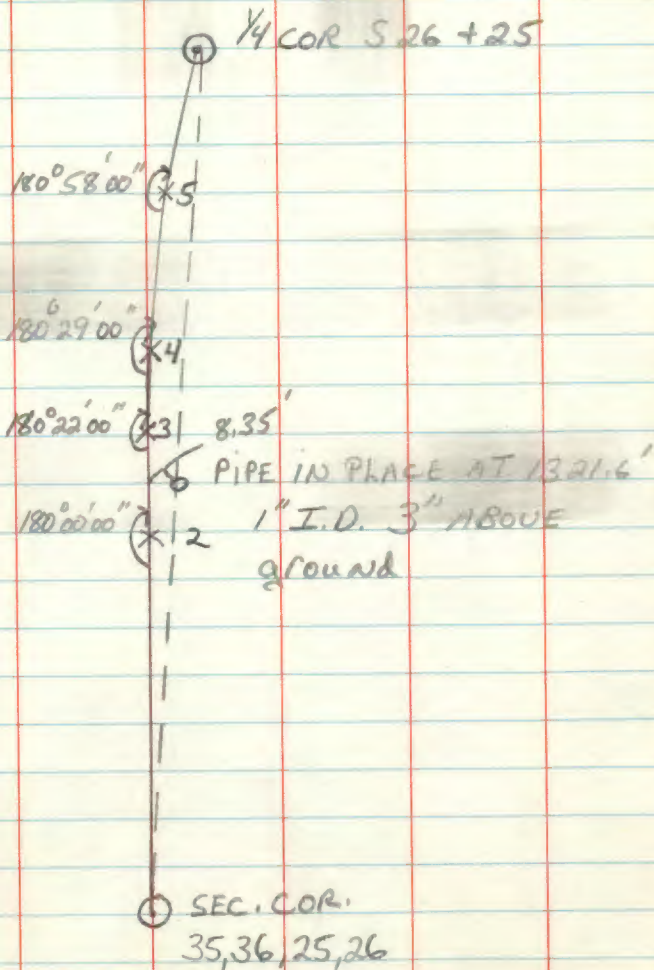

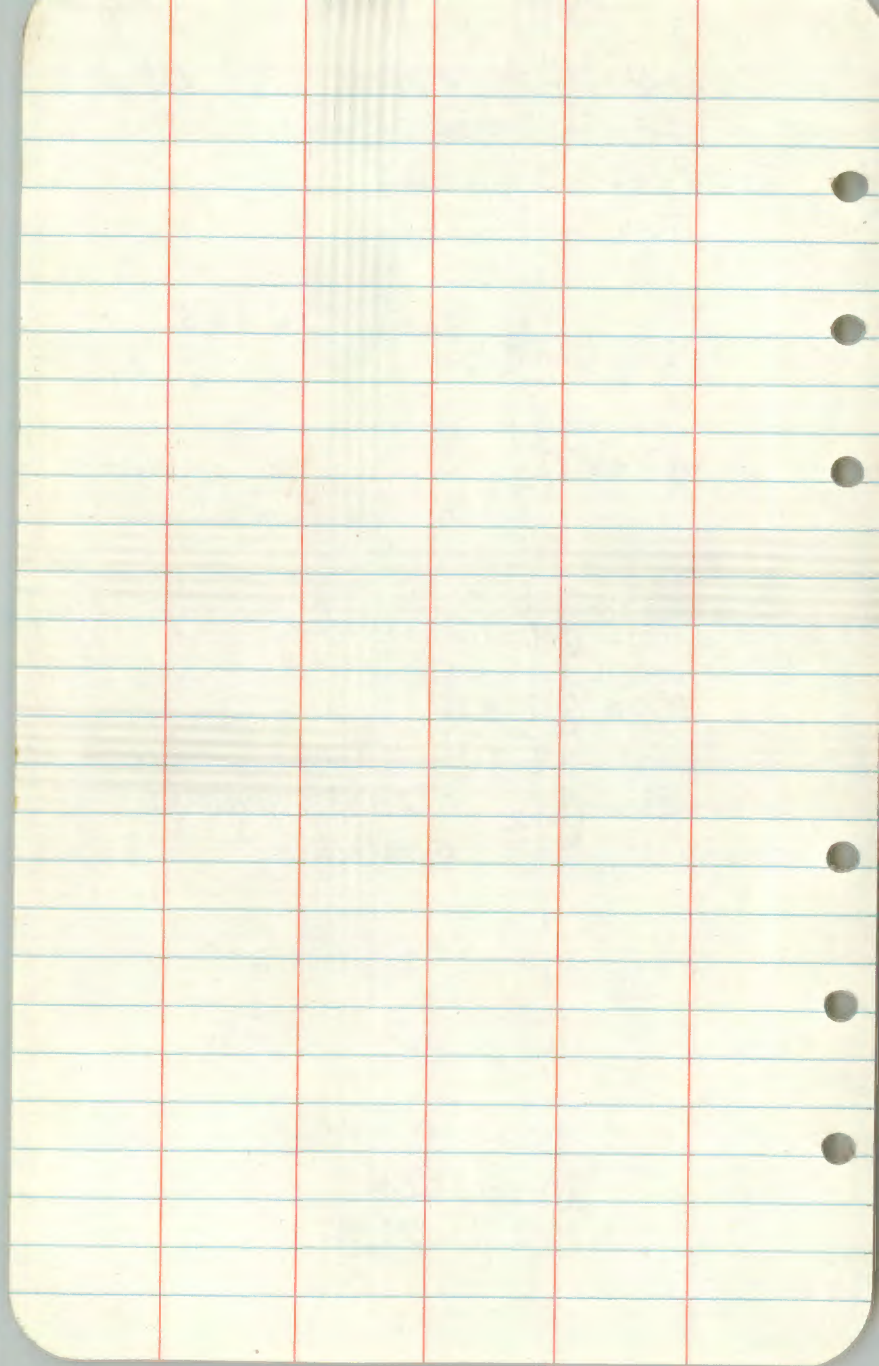

5/26/78
DK, MI

COMPUTATIONS

LINE FROM SCOR 25, 26, 35, 36 TO 1/4 COR. S 25+26
T147N R 31W

$$\begin{aligned} \times 3 \quad a &= C(\sin \angle A) \\ &= 387.15' (.006412) \\ &= 2.477' \end{aligned}$$

$$\begin{aligned} \times 4 \quad a &= 249.55 (.00844) \\ &= 2.106' \end{aligned}$$

$$\begin{aligned} \times 5 \quad a &= 372.1' (.03432) \\ &= 12.77' \end{aligned}$$

$$\text{TOTAL} = 17.36'$$

$$\begin{aligned} \text{TAN } \angle A &= \frac{17.36'}{2646.10} \\ &= .006656 \\ &= .66 \end{aligned}$$

$$\text{OFFSET} = .66''/100'$$

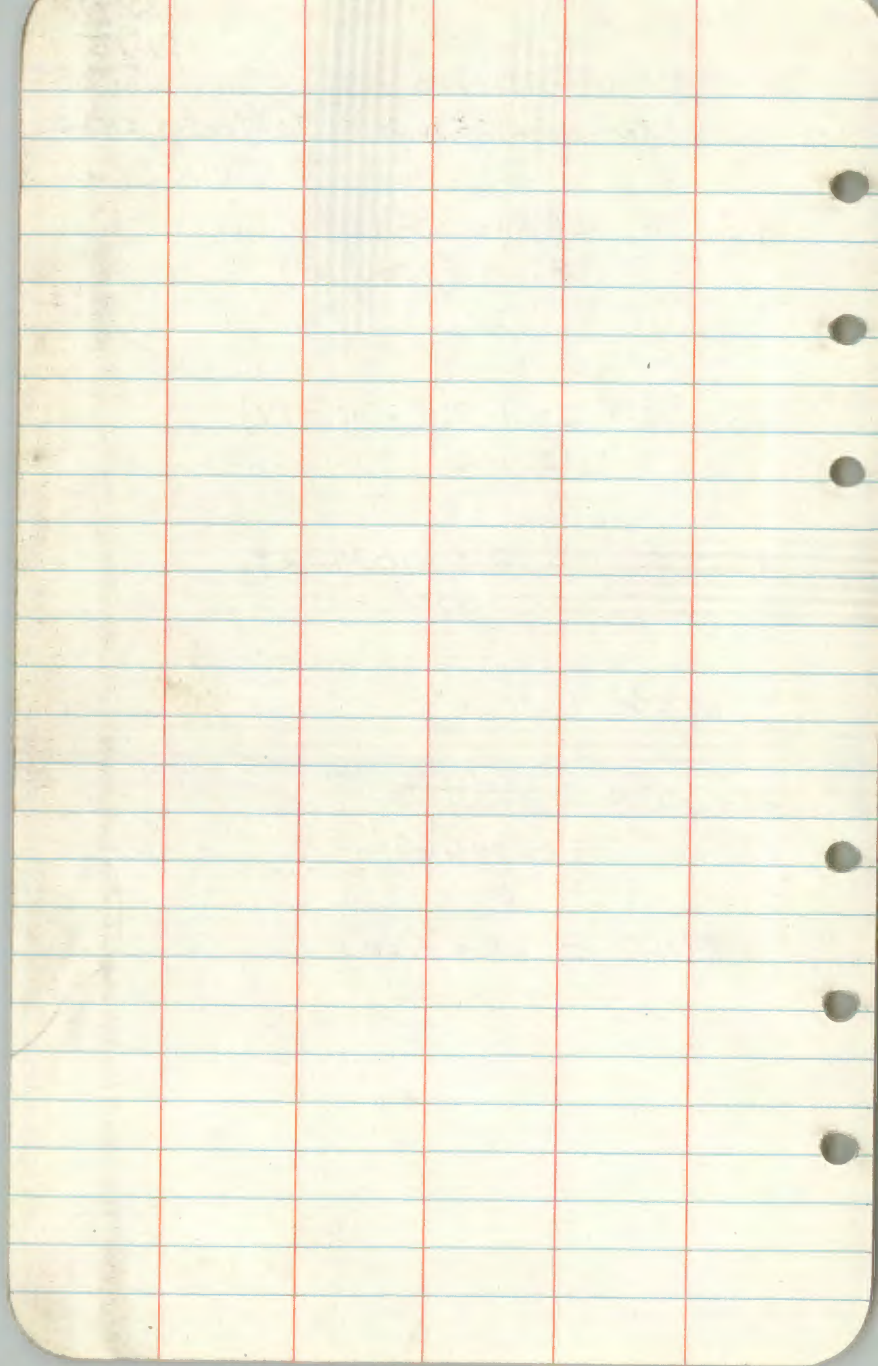

5/11/78

DK, MTPY

RANDOM + TRUE LINE

C $\frac{1}{4}$ S 26 TOCE $\frac{1}{16}$ S 26

T147N R31W

TRUE LINE IS BRUSHED
BLAZED POSTED + PAINTED
TO F.S.M. STANDARDS

BT'S + ACCESSORIES AT CE $\frac{1}{16}$ S 26

N. PINE 17" DUE EAST 132.22'

Ash 6" S35W 27.47'

N. PINE 16" S02W 152.74'

GLO N. PINE 21" S64E 172.20

8' STEEL POST DUE EAST 3.37' 54-2+4

8' STEEL POST DUE SOUTH 3.44' 54-2+4

BT'S + ACCESSORIES AT CE $\frac{1}{16}$ S 26

8' STEEL POST DUE WEST 3.10' 54-2+4

GLO N. PINE 9" S05E 14.75'

GLO N. PINE STAMP 2'11" N61W 12.0'

N. PINE 14" N15E 21.97'

N. PINE 14" S74W 8.12'

STA OCCUPIED STA SIGHTED

HORIZ. DIST.

1ST X 2ND X

X X

C/Y

DUE EAST

1

1

| | | |
|--------|----|---------------|
| 99.9' | 0° | 99.9' |
| 100.0' | | 100.0' |
| 37.85 | | 37.85 |
| 97.15 | | 97.15 |
| 97.40 | | 97.40 |
| 98.60 | | 98.60 |
| 97.30 | | 97.30 |
| 56.20 | | 56.20 |
| 45.45 | | 45.45 |
| | | <u>729.85</u> |

1

1

| | | |
|------------|------------|---------------|
| 0°00'00" | | |
| 180°00'00" | 360°00'00" | 180°00'00" |
| 97.30' | | 97.30 |
| 96.40' | | 96.40 |
| 89.80' | | 89.80 |
| 48.40' | | 48.40 |
| 52.20' | | 52.20 |
| 58.95' | | 58.95 |
| | | <u>443.05</u> |

1

1

| | | |
|------------|------------|---------------|
| 0°00'00" | | |
| 174°55'00" | 359°50'00" | 174°55'00" |
| 89.40' | | 89.40 |
| 65.90' | | 65.90 |
| | | <u>155.30</u> |

TOTAL

1328.20

5/11/76
OK, MI, P9

RANDOM + TRUE LINE

C 1/4 COR S 26 TO

C E 1/16 S 26

Z
↘

A ⊙ C 1/4

OFFSET
1.35'



$$\begin{aligned} & 179^{\circ} 60' 00'' \\ & - 174^{\circ} 55' 00'' \\ & \hline & 5^{\circ} 05' 00'' \end{aligned}$$

$$3B = C \cos A$$

$$3B = 155.30 (.99607)$$

$$3B = 154.69'$$

OFFSET
7.29' South



$$BC = C (\sin A)$$

$$BC = 155.30 (.28860)$$

$$BC = 44.759'$$

OFFSET

11.72'

South



$$\begin{aligned} AB &= 1328.20' - (155.30' - 44.76') \\ &= 1327.59' \end{aligned}$$

$$\begin{aligned} \tan \angle A &= \frac{13.76'}{1327.59'} \\ &= .0103646 \end{aligned}$$

$$\angle A = .01' \text{ OFFSET South}$$

C ⊙ B
C E 1/16

$$\begin{aligned} AC &= \frac{1327.59'}{.99995} \\ &= 1327.64' \end{aligned}$$

RECORDED DIST. 1325.94'

COMPUTED DIST. 1327.65'

+ 1.72'

6/5/78

DKP4CM

RANDOM + TRUE LINE

C $\frac{1}{4}$ COR TO CS $\frac{1}{16}$ S 26

T 147N R 31W

TRUE LINE IS BRUSHED

BLAZED POSTED + PAINTED

R TO F.S.M. STANDARDS

| STA OCCUPIED | STA SIGHTED PT ON E/W LINE | 1ST X | 2ND X | MEAN X |
|--------------|----------------------------------|-----------|------------|-----------|
| C/4526 | | 0°00'00" | | |
| | 1 | 88°35'26" | 177°10'00" | 88°35'00" |
| | | 98.45 | | 98.45 |
| | | 98.80 | | 98.80 |
| | | 98.25 | | 98.25 |
| | | 63.00 | | 63.00 |
| | | | | 358.50' |

| | | | | |
|---|--------|------------|------------|-----------|
| 1 | C/4526 | 0°00'00" | | |
| | 2 | 180°00'00" | 360°00'00" | 80°00'00" |
| | | 97.60' | | 97.60' |
| | | 96.10' | | 96.10' |
| | | 95.15' | | 95.15' |
| | | 93.25' | | 93.25' |
| | | 52.65' | | 52.65' |
| | | 63.25' | | 63.25' |
| | | | | 498.00' |

| | | | | |
|---|---|------------|------------|------------|
| 2 | 1 | 0°00'00" | | |
| | 3 | 180°00'00" | 360°00'00" | 180°00'00" |
| | | 98.30' | | 98.30' |
| | | 57.25' | | 57.25' |
| | | | | 155.55' |

6/29/78

RANDOM + TRUE LINE
C $\frac{1}{4}$ COR TO CS $\frac{1}{16}$ S26
T147N R31W

OK, C, M, P, Y

| STA OCCUPIED | STA SIGHTED | 1ST X | 2ND X | MEAN X |
|-----------------|----------------|-------|-------|--------|
|-----------------|----------------|-------|-------|--------|

| | | | | |
|---|---|----------|--|--|
| 3 | 2 | 0°00'00" | | |
|---|---|----------|--|--|

| | | | | |
|--|------------|------------|------------|------------|
| | SC 1/6 S2E | 179°49'00" | 359°38'00" | 179°49'00" |
|--|------------|------------|------------|------------|

| | | | | |
|--|--|-------|--|--------|
| | | 98.70 | | 98.70' |
|--|--|-------|--|--------|

| | | | | |
|--|--|--------|--|--------|
| | | 98.15' | | 98.15' |
|--|--|--------|--|--------|

| | | | | |
|--|--|-------|--|--------|
| | | 98.20 | | 98.20' |
|--|--|-------|--|--------|

| | | | | |
|--|--|--------|--|---------------|
| | | 38.00' | | <u>38.00'</u> |
|--|--|--------|--|---------------|

| | | | | |
|--|--|--|--|---------|
| | | | | 333.05' |
|--|--|--|--|---------|

TOTAL DIST = 1345.10'

$$BC = (.00320)(333.05')$$

$$= 1.07'$$

$$B3 = 333.05'(.99999)$$

$$= 333.05'$$

$$\text{TAN } \angle A = \frac{1.07'}{1345.10'}$$

$$= .0007954$$

$$= .08' \text{ OFFSET EAST}/100'$$

$$AC = \frac{1345.10'}{ONE}$$

$$= 1345.10'$$

RECORDED DIST. 1348.38'

COMPUTED DIST. 1345.10'

- 3.28'

6/29/78

RANDOM + TRUE LINE

DR, CM, P4

C 1/4 COR S 26 TO SC 1/4 S 26

T 147 N R 31 W

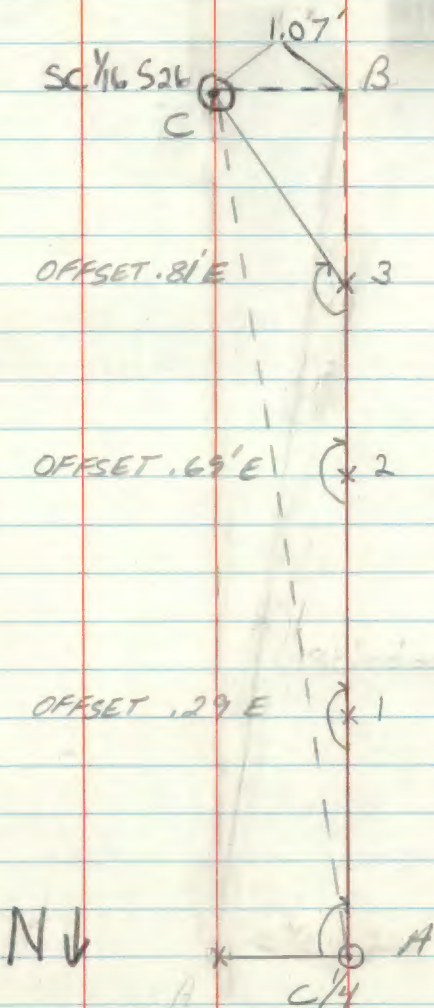

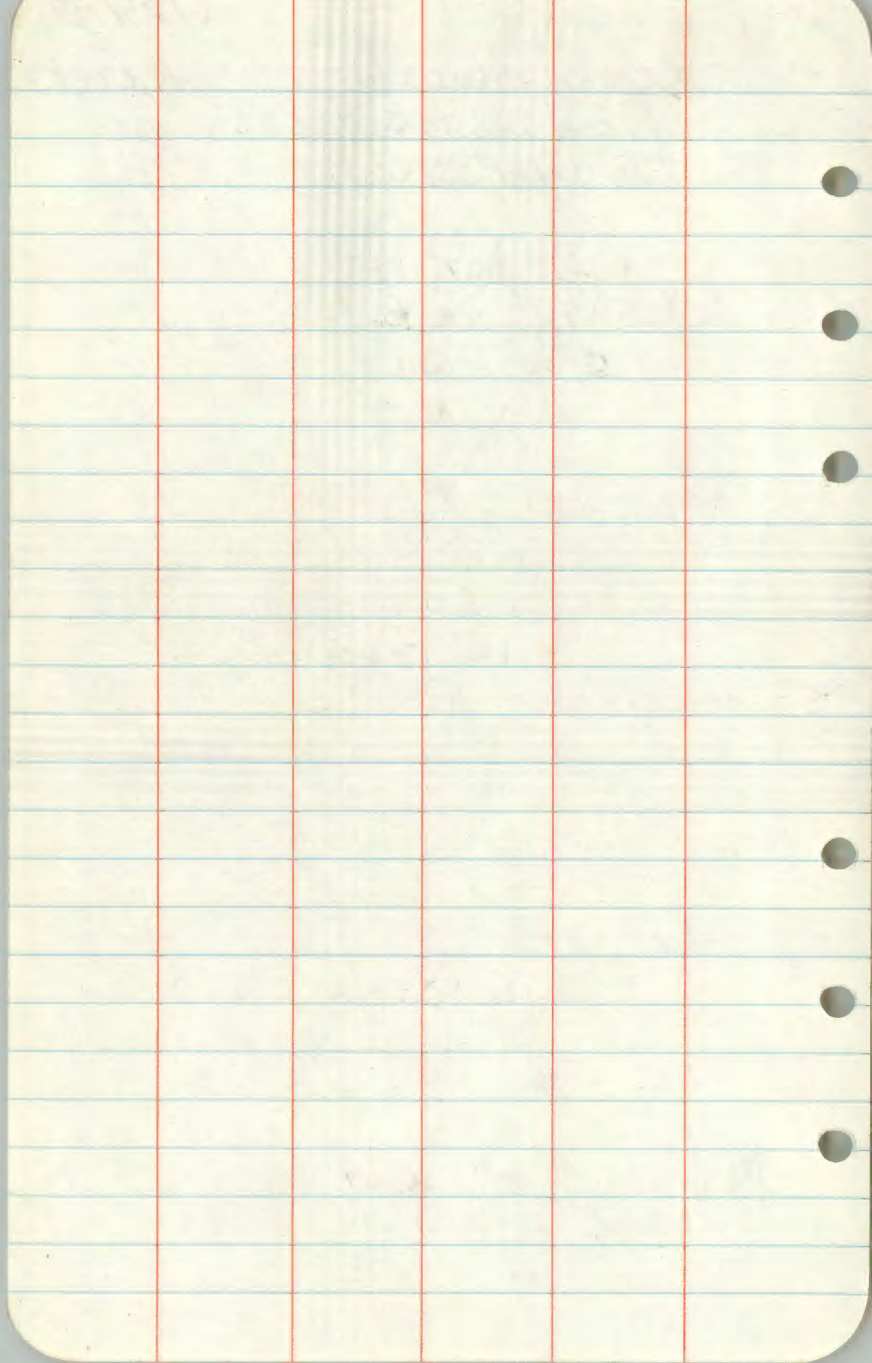

9/21/78

DK CM

DD

RANDOM + TRUE LINE

SEC COR 25+36 T147N R31W

+ SEC COR 29+30 T147N R30W

TO

S 1/6 S 25 T147N R 31W

+ S 29 T147N R 30W

ON EAST TOWNSHIP LINE

T147N R 31W

TRUE LINE IS BRUSHED
BLAZED PAINTED + POSTED
TO F.S.M. STANDARDS

BT'S + ACCESSORIES AT S 1/6 S 25+29

4x4 CEDAR POST 8.0' SOUTH 542+54-4

8' METAL POST DUE SOUTH 3.09 54-21559

54-5 TAG DUE N ON 6" ASH 52.80'

ONK 8" N36°E 16.21'

ONK 5" N74°E 13.85'

ONK 8" N62°W 42.75'

| STA OCCUPIED | STA SIGHTED | 1ST X | 2ND X | MEAN X |
|-----------------|----------------|-------|-------|--------|
|-----------------|----------------|-------|-------|--------|

| SEC COR | DUE | NORTH | | |
|---------|-----|-------|--|--|
|---------|-----|-------|--|--|

| | | | | |
|----------------|--|--------|--|----------------|
| 25, 29, 30, 36 | | 99.77' | | 99.77' |
| | | 99.58' | | 99.58' |
| | | 99.70' | | 99.70' |
| | | 26.24' | | 26.24' |
| | | | | <u>325.29'</u> |

| | | | | |
|---|---------|------------|--|--|
| 1 | SEC COR | 0° 00' 00" | | |
|---|---------|------------|--|--|

| | | | | |
|---|--|--------------|--------------|--------------|
| 2 | | 180° 00' 00" | 360° 00' 00" | 180° 00' 00" |
|---|--|--------------|--------------|--------------|

| | | | | |
|--|--|--------|--|----------------|
| | | 99.71' | | 99.71' |
| | | 99.97' | | 99.97' |
| | | 99.65' | | 99.65' |
| | | 99.82' | | 99.82' |
| | | 16.97' | | 16.97' |
| | | | | <u>416.12'</u> |

| | | | | |
|---|---|------------|--|--|
| 2 | 1 | 0° 00' 00" | | |
|---|---|------------|--|--|

| | | | | |
|---|--|--------------|--------------|--------------|
| 3 | | 180° 00' 00" | 360° 00' 00" | 180° 00' 00" |
|---|--|--------------|--------------|--------------|

| | | | | |
|--|--|---------|--|----------------|
| | | 99.89' | | 99.89' |
| | | 100.00' | | 100.00' |
| | | 100.00' | | 100.00' |
| | | 81.15' | | 81.15' |
| | | | | <u>381.04'</u> |

9/21/78
OK, cm,
DD

RANDOM + TRUE LINE

S.C. 25-36-29-30 TO

S $\frac{1}{16}$ S 25 + 29

T147N R31W

ON EAST TOWNSHIP LINE

STA STA
 Occupied SIGHTED 1ST X 2ND X MEAN X

| | | | | |
|---|--------------------------|------------|----------|----------------|
| 3 | 2 | 0°00'00" | | |
| | S ^{1/16} 525424 | 175°35'00" | 3511000" | 175°35'00" |
| | | 35.56' | | 35.56' |
| | | 99.52' | | 99.52' |
| | | 9.37' | | 9.37' |
| | | | | <u>144.45'</u> |

TOTAL DISTANCE 1266.90'

COMPUTED DIST 1266.52'

$$BC = 144.45' (.07701) \quad AC = \frac{1266.47}{.99991}$$

$$= 11.12' \quad AC = 1266.52'$$

$$B3 = 144.45' (.99203)$$

$$B3 = 144.02'$$

$$AB = 1266.90' - (144.45' - 144.02')$$

$$AB = 1266.47'$$

$$\text{TANG A} = \frac{11.12'}{1266.47'}$$

$$= .0087803 = 0^{\circ} 30' 00''$$

$$= .88' \text{ OFFSET WEST / 100'}$$

9/21/78
DK, CM
DD

RANDOM + TRUE LINE

S.C. 25+36+29+30 TO

S 1/4 S 25+29

T147N R30W

ON EAST TOWNSHIP LINE

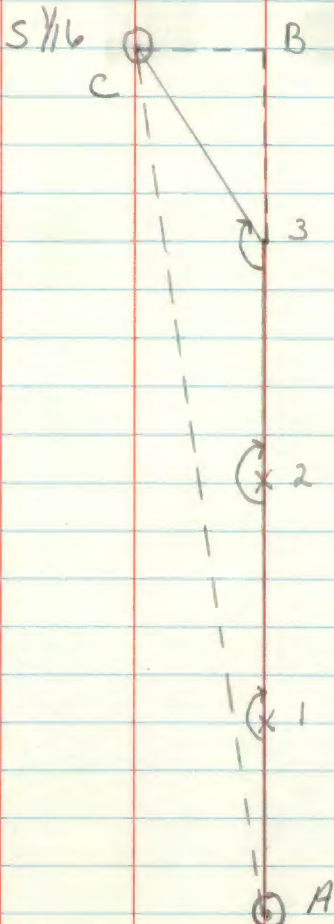

S.C. 25-36-29-30

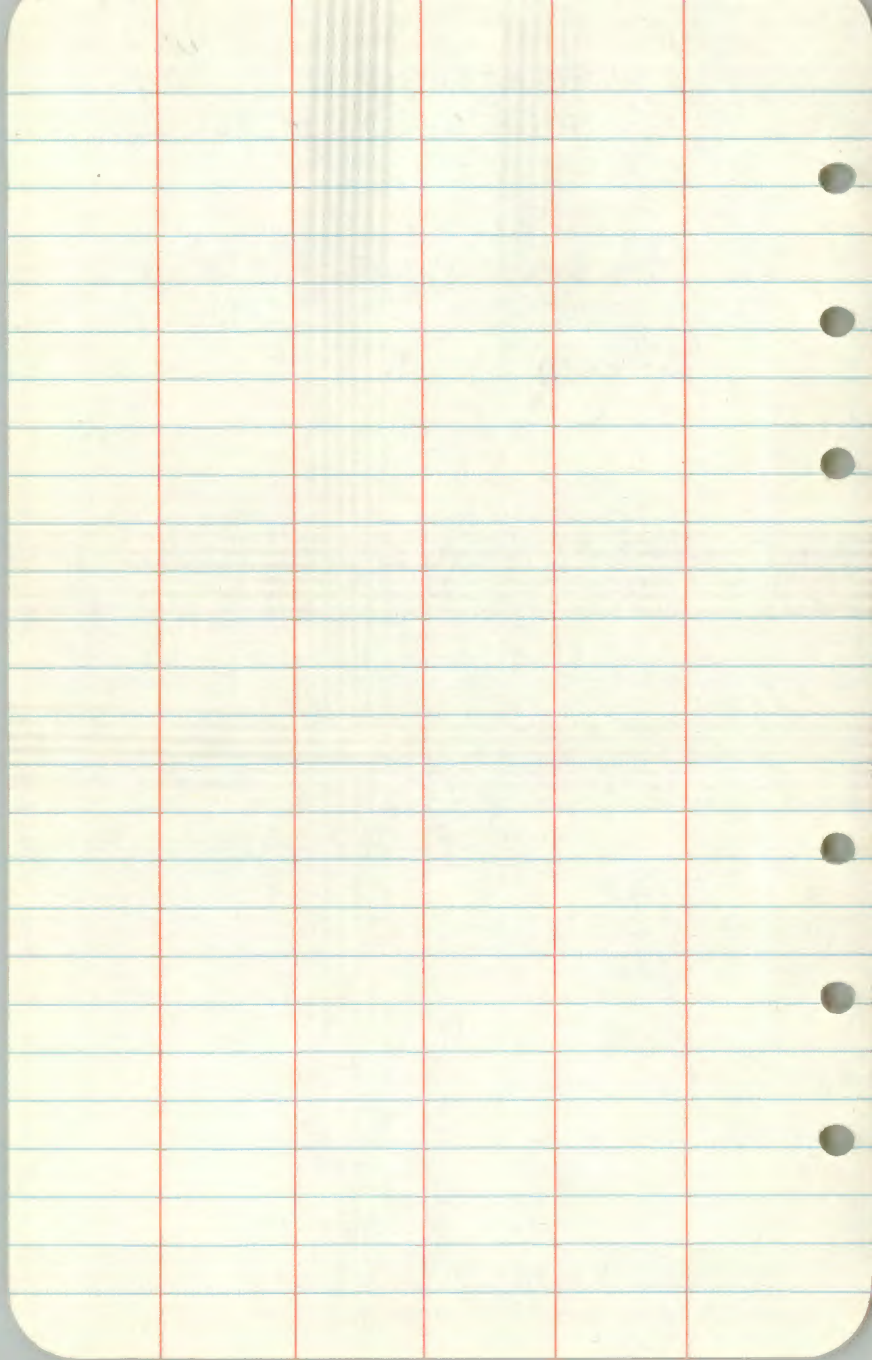

36.85 6" J.P. NNE

4.05 8" J. Pine E

359 60
67

S 35

| | |
|---------------|---------------|
| 175 35 | 179 60 |
| <u>175 35</u> | <u>175 35</u> |
| 350 70 | 4 25 |

351 70

4° 25'

9136
9136
 18272
 18312

17980
17950
 358100
 35940

1741630
1741630
 3483260

4.89 5" mcp 783
 -182
 521

3.29 3 mcp

97.7
37.4
 135.1

1754
1754
 35082
 35122

1.35' offset

155.3
10886
 9318
 12224
12224
 1353958

101019
 1328.2 / 1354000
13282
 25800
13282
 125190

13.71' 4" W.P NE

10.88' 7" I.P NW

7/28/78
CM, DD,
DK, PY

RANDOM + TRUE LINE

1/4 COR S 26 + 35 TO

CM 1/16 S 35

T147N R31W

TRUE LINE IS BRUSHED,
BLAZED, POSTED + PAINTED
TO F.S.M. STANDARDS

8' STEEL POST DUE EAST 336' 54.2 + 54.4

8' STEEL POST DUE SOUTH 2.60' 54.7 + 54.4

| STA OCCUPIED | STA SIGHTED | 1ST X | 2ND X | MEAN X |
|--------------|-------------|-------|-------|--------|
|--------------|-------------|-------|-------|--------|

Y4 S26435 ^{PT ON} LINE EAST 0° 00' 00"

| | | | |
|---|-------------|--------------|---------------|
| 1 | 90° 00' 00" | 180° 00' 00" | 90° 00' 00" |
| | 99.87 | | 99.87 |
| | 99.77 | | 99.77 |
| | 99.66 | | 99.66 |
| | 99.81 | | 99.81 |
| | 99.58 | | 99.58 |
| | 76.38 | | 76.38 |
| | | | <u>575.07</u> |

1 Y4 S26435 0° 00' 00"

| | | | |
|---|--------------|--------------|--------------|
| 2 | 180° 00' 00" | 360° 00' 00" | 180° 00' 00" |
| | 47.95 | | 47.95 |
| | 76.67 | | 76.67 |
| | 99.64 | | 99.64 |
| | 99.92 | | 99.92 |
| | 37.48 | | 37.48 |
| | 99.80 | | 99.80 |
| | 65.40 | | <u>65.40</u> |
| | | | 526.86 |

2

1
S.C
Y16 0° 00' 00"
174° 02' 00" 348° 04' 30" 174° 02' 00"

| | | | |
|--|-------|--|--------------|
| | 71.17 | | 71.17 |
| | 99.50 | | 99.50 |
| | 27.85 | | <u>27.85</u> |
| | | | 198.52 |

7/28/78
OK, CM
PY, DD

RANDOM + TRUS. LINE

N 1/4 COR S 26 + 35 TO

C.N 1/16 S 35

T 147 N R 31 W

NEW BT'S AT C.N 1/16 S 35

6" W OAK N 11° W 40.09'

6" W OAK N 65° W 14.43'

8" W OAK S 46° W 40.40'

8' STEEL POST DUE NORTH 2.93'

TOTAL DISTANCE 1300.45'

RECORDED DIST = 1300.86'

COMPUTED DIST = 1299.52'

- 1.34'

$$BC = 198.52' (.10395) \\ = 20.64'$$

$$B2 = 198.52' (.99458) \\ = 197.44'$$

$$AB = 1300.45' - (198.52' - 197.44') \\ = 1299.37'$$

$$\text{TAN } \angle A = \frac{20.64'}{1299.37'}$$

$$= 0.0158846$$

$$= 1.6 \text{ 'OFFSET EAST / 100'}$$

$$AC = \frac{1299.37'}{.99988} \\ = 1299.52'$$

OFFSET AT PT 1 9.14'

OFFSET AT PT 2 17.52'

7/28/78
OK, CM
OD, PY

RANDOM + TRUE LINE
Y4 S26+35 TO
CN Y16 S35
T147N R31W

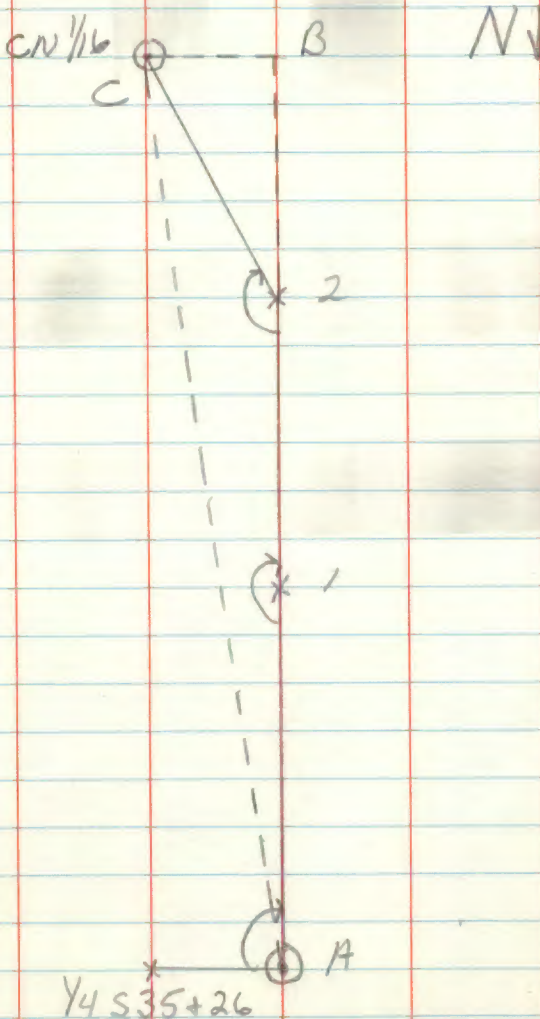

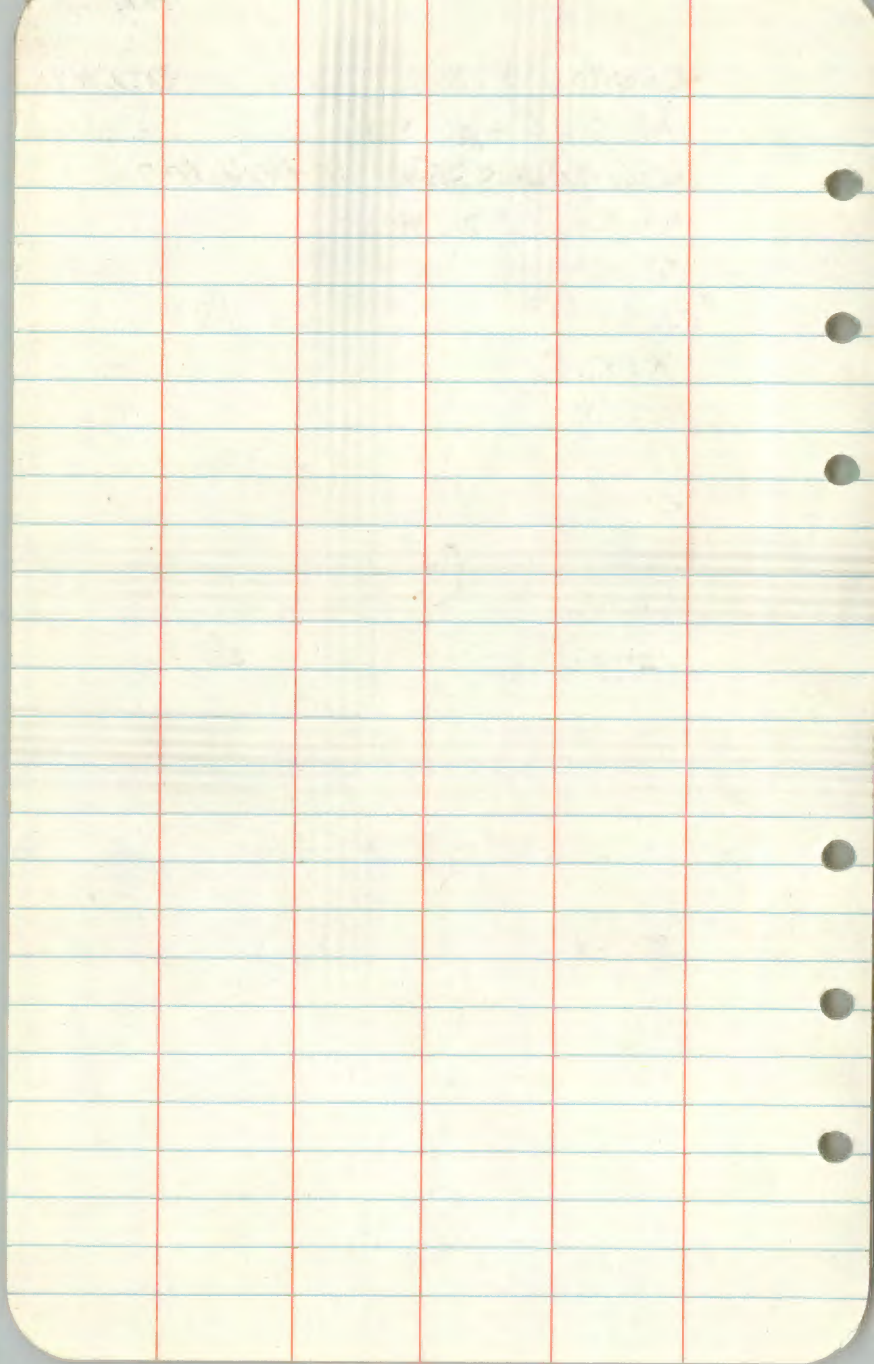

5/15/78

DK, M.J., P4

78° E

RANDOM + TRUE LINE

1/4 COR S34 E 35

TO

CW 1/4 COR S 35

T147N R31W

TRUE LINE IS BRUSHED

BLAZED POSTED + PAINTED

TO F.S.M. STANDARDS

BT'S + ACCESSORIES AT 1/4 S34+35

8' STEEL POST DUE EAST 3.34' 54-2-54-4

4x4 WOOD POST DUE EAST 89.9' 54-2, 54-6

ELM 10" S22E 6.60'

ELM 13" N86W 31.70'

MAPLE 5" N02E 30.64'

| STA Occupied | STA Sighted | 1ST X | 2ND X | FF |
|--------------|-------------|------------|------------|----------|
| Y4S34+35 | DUE EAST | | | |
| | | 20.05' | | 20.05' |
| | | 32.20' | | 32.20' |
| | | | | 52.25' |
| 1 | Y4S34+35 | 0°00'00" | | |
| | 2 | 180°00'00" | 360°00'00" | |
| | | 99.50' | | 99.50' |
| | | 95.25' | | 95.25' |
| | | 110.30' | | 110.30' |
| | | | | 235.05' |
| 2 | 1. | 0°00'00" | | |
| | CV116 | 0°35'00" | 190°00' | 035'00" |
| | | 95.30' | | 95.30' |
| | | 97.40' | | 97.40' |
| | | 97.00' | | 97.00' |
| | | 96.55' | | 96.55' |
| | | 95.70' | | 95.70' |
| | | 96.55' | | 96.55' |
| | | 96.35' | | 96.35' |
| | | 95.80' | | 95.80' |
| | | 94.25' | | 94.25' |
| | | 97.20' | | 97.20' |
| | | 61.35' | | 61.35' |
| | | | | 1023.45' |
| | | | TOTAL | 1310.75' |

5/16/78
OK, P4, 195

RANDOM LINE
1/4 COR S 34 E 35
TO CW 1/16 S 35
T 1/4 N R 31 W

N
N

A ○ 1/4 COR S 34 E 35

1 ○ OFFSET .41' South
3725

2 ○ OFFSET 2.27' South
235.05

BC = 1023.45 (.01018)

BC = 10.42'

2B = 1023.45 (.99995)

2B = 1023.40

AB = 1310.75 - (1023.45 - 1023.40)
= 1310.70'

C ○ B

CW 1/16 S 35 TAN A = 10.42' / 1310.70'

= .0079499

AC = 1310.70' / .99997

= .79 / 100'

AC = 1310.74'

1023.45

RECORDED DIST 1312.74'
COMPUTED DIST - 1310.74'
- 2.00'

5/22/78

RANDOM + TRUE LINE

OK, P₄, M₁

SW $\frac{1}{16}$ S 35

TO

SW $\frac{1}{16}$ S 35

T147N R31W

| STA OCCUPIED | STA SIGHTED | 1ST X | 2ND X | MEAN X |
|-----------------|----------------------|-------------|--------------|-------------|
| CW/6535 | STA 3 EW TRUE CWR | 0° 00' 00" | | |
| | | 88° 13' 00" | 176° 26' 00" | 88° 13' 00" |
| | | 98.70' | | 98.70' |
| | | 98.65' | | 98.65' |
| | | 97.75' | | 97.75' |
| | | 99.20' | | 99.20' |
| | | 98.80' | | 98.80' |
| | | 99.20' | | 99.20' |
| | | 99.40' | | 99.40' |
| | | 38.20' | | 38.20' |
| | | | | 729.90' |

| | | | | |
|---|---------|--------------|--------------|--------------|
| 1 | CW/6535 | 0° 00' 00" | | |
| | 2 | 180° 00' 00" | 360° 00' 00" | 180° 00' 00" |
| | | 98.80' | | 98.85' |
| | | 98.50' | | 98.50' |
| | | 99.00' | | 99.00' |
| | | 98.95' | | 98.95' |
| | | 61.65' | | 61.65' |
| | | | | 456.95' |

| | | | | |
|---|---------|---------------|--------------|--------------|
| 2 | 1 | 0° 00' 00" | | |
| | SW/6535 | 147° 25' 00" | 294° 50' 00" | 147° 25' 00" |
| | | 98.65' | | 98.65' |
| | | 58.00' | | 58.00' |
| | | | | 156.65' |
| | | TOTAL DIST. = | | 1343.50' |

5/24/78

DK, P4, 19J

RANDOM + TRUE LINE

CW 1/16 S35 TO SW 1/16 S35

T147N R31W

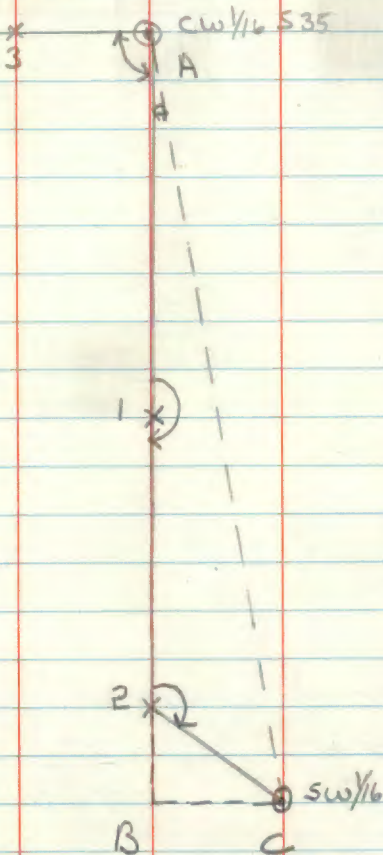

$$BC = 156.65 (.53853)$$

$$BC = 84.36'$$

$$2B = 156.65' (.84261)$$

$$2B = 131.99$$

$$AB = 1343.50 - (156.65' - 131.99')$$

$$AB = 1318.84$$

$$\tan A = \frac{84.36'}{1318.84}$$

$$= .0639653 = 3^{\circ}40'00''$$

$$= 6.40' \text{ OFFSET EAST } / 100'$$

$$AC = \frac{1318.84'}{.99795}$$

$$= 1321.54'$$

RECORDED DIST. 1322.64'

COMPUTED DIST. 1321.54'

- 1.10'

5/30/78

RANDOM + TRUE LINE
SW $\frac{1}{16}$ TO CS $\frac{1}{16}$ S35
T147N R31W

OK, RD, DN

TRUE LINE IS BRUSHED
BLAZED POSTED + PAINTED
TO F.S.M. STANDARDS

BT'S + ACCESSORIES AT SW $\frac{1}{16}$ S35

8' METAL POST DUE EAST 3.01'

8' METAL POST DUE NORTH 3.41'

54-2 + 54-4 ATTACHED

GLO Birch 13" N19W 17.34'

W.OAK 12" N08E 48.93'

R.OAK 10" N86E 16.42'

GLO R.OAK 11" S45E 14.76

Birch 9" N30E 18.6K5

BY DMS 11-7-66

| STA OCCUPIED | STA SIGHTED | 1ST X | 2ND X | MEAN X |
|-----------------|--------------------|-------------|---------|---------------|
| SW 1/4 COR | PT. ON NS 21 NE | 0° 00' 00" | | |
| | 2 | 91° 36' 00" | 1831200 | 913600" |
| | | 53.0' | | 53.0' |
| | | 95.0' | | 95.0' |
| | | 96.0' | | 96.0' |
| | | 95.0' | | 95.0' |
| | | 95.0' | | 95.0' |
| | | 95.0' | | 95.0' |
| | | 95.0' | | 95.0' |
| | | 60.2' | | 60.2' |
| | | | | <u>684.20</u> |

| | | | | |
|---|------------|--------------|--|----------------|
| 2 | SW 1/4 COR | 0° 00' 00" | | |
| | CS 1/4 COR | 180° 02' 00" | | |
| | | 95.0' | | 95.0' |
| | | 95.0' | | 95.0' |
| | | 95.0' | | 95.0' |
| | | 95.0' | | 95.0' |
| | | 95.0' | | 95.0' |
| | | 95.0' | | 95.0' |
| | | 61.15' | | 61.15' |
| | | | | <u>631.15'</u> |

TOTAL DIST = 1315.35'

5/31/78

RANDOM + TRUE LINE

DR, RO, DN

SW $\frac{1}{16}$ TO CS $\frac{1}{16}$ S. 75

T147N R31W

←
N

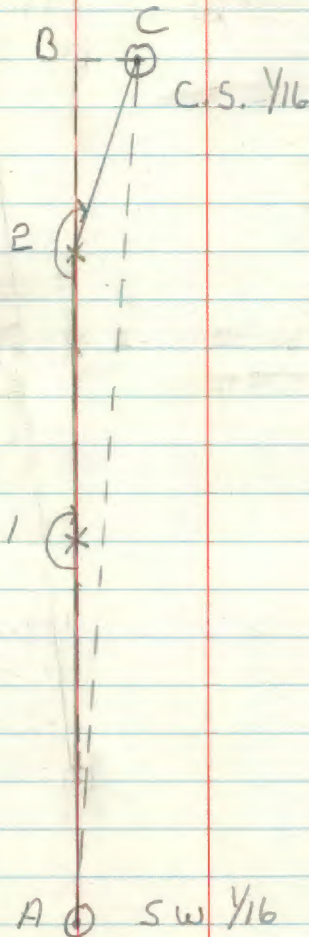

$$BC = 631.15' (.00058) \\ = .366067$$

$$2B = 631.15' (\text{ONE}) \\ = 631.15$$

$$AB = 1315.35'$$

$$\text{TAN } A = \frac{.37}{1315.35'} \\ = .0002812 = 0^{\circ} 01' 00'' \\ = .03' \text{ OFFSET South/100}'$$

$$AC = \frac{1315.35'}{\text{ONE}} \\ = 1315.35'$$

RECORDED DIST 1314.72'
COMPUTED DIST 1315.35'
+ .63'

7/31/78

RANDOM + TRUE LINE

DK, P4, 00

S C.S. $\frac{1}{16}$ S35 TO

S $\frac{1}{16}$ S 35 + 36

T147N R31W

TRUE LINE IS BRUSHED,
BLAZED, POSTED + PAINTED
TO F.S.M. STANDARDS

BT'S + ACCESSORIES AT CS $\frac{1}{16}$ S35

W. OAK 6" S64°W 40.16'

W. OAK 6" N30°W 34.43'

ELM 8" N69°E 13.61'

8' METAL POST DUE WEST 3.66'

8' METAL POST DUE EAST 3.13'

54-2 + 54-4 ATTACHED

| STA | STA | 1ST X | 2ND X | MAGN X |
|------------------------------|---------------------------------|--------------|----------|--------------|
| Occupied S. CENTER Y16 | SIGHTED PT ON TRUE LINE W | 0° 00' 00" | | |
| | 1 | 180° 19' 00" | 360.3800 | 180° 19' 00" |
| | | 99.87' | | 99.87' |
| | | 99.26' | | 99.26' |
| | | 98.58' | | 98.58' |
| | | 99.62' | | 99.62' |
| | | 99.72' | | 99.72' |
| | | 99.63' | | 99.63' |
| | | 56.67' | | 56.67' |
| | | 50.30' | | 50.30' |
| | | | | 703.65' |

| | | | | |
|---|------------------|--------------|----------|--------------|
| 1 | S. CENTER Y16 | 0° 00' 00" | | |
| | 2 | 180° 02' 00" | 360.0000 | 180° 02' 00" |
| | | 99.55' | | 99.55' |
| | | 72.20' | | 72.20' |
| | | 79.17' | | 79.17' |
| | | 99.33' | | 99.33' |
| | | 99.55' | | 99.55' |
| | | 62.94' | | 62.94' |
| | | | | 512.74' |

8/1/78
OK, CM,
P4, DP

RANDOM + TRUE LINE
S 1/16 S 35
S 1/16 S 35 + 36
T147N R 31W

| | | | |
|---|---|--------------|---------------------------|
| 2 | 1 | 0 00 00 | |
| | 3 | 180° 00' 00" | 360° 00' 00" 180° 00' 00" |
| | | 99.61' | 99.61' |
| | | 99.71' | 99.71' |
| | | 99.53' | 99.53' |
| | | 99.79' | 99.79' |
| | | 99.82' | 99.82' |
| | | 99.81' | 99.81' |
| | | 99.94' | 99.94' |
| | | 99.88' | 99.88' |
| | | 99.25' | 99.25' |
| | | 99.54' | 99.54' |
| | | 6.58 | 6.58' |
| | | | <u>903.85'</u> |

| | | | |
|---|---|--------------|---------------------------|
| 3 | 2 | 0° 00' 00" | |
| | 4 | 180° 00' 00" | 360° 00' 00" 180° 00' 00" |
| | | 67.50 | 67.50' |
| | | 99.89 | 99.89' |
| | | 14.63 | 14.63' |
| | | 14.12 | <u>14.12'</u> |
| | | | 196.14' |

8/1/78
DK, CM
P4, DD

RANDOM + TRUE LINE

C.S. $\frac{1}{16}$ S 35 TO

S $\frac{1}{16}$ S 35 + 30

T 147N R 31W

STA STA
 OCCUPIED SIGHTED 1ST X 2ND X MEAN X

| | | | |
|---------|---|-------------|--------------|
| 4 | 3 | 0° 00' 00" | |
| S 1/4 | | 180° 01' 0" | 360° 02' 0" |
| S 35+36 | | 180° 01' 0" | 180° 01' 00" |
| | | 99.77' | 99.77' |
| | | 99.97' | 99.97' |
| | | 27.36' | 27.36' |
| | | | 224.10' |

TOTAL DISTANCE 2640.09'

TRUE LINE MISSES NW CORNER OF
 ROGER WILKETS' HOUSE by 8.85'

BC = 224.09' (.00029)
 = 0.064986' RECDIST. 2638.68

COMPTD. = 2640.09'
 + 1.41'

2B = 224.09' (ONE)
 = 224.09'

AB = 2640.09'

TAN X A = $\frac{.06}{2640.09'}$
 = .0000227
 = 0.0 OFFSET

8/1/78
DK, Py
CM, DD

RANDOM + TRUE LINE
C.S. $\frac{1}{16}$ S35 TO
S $\frac{1}{16}$ S 35 + 36
T147W R31W

N7

S $\frac{1}{16}$ B C
S35+36 F ⊕

NO OFFSETS

⊗ 4

⊗ 3

⊗ 2

⊗ 1

⊕ C.S. $\frac{1}{16}$ S35

* PT ON TRUE LINE WEST

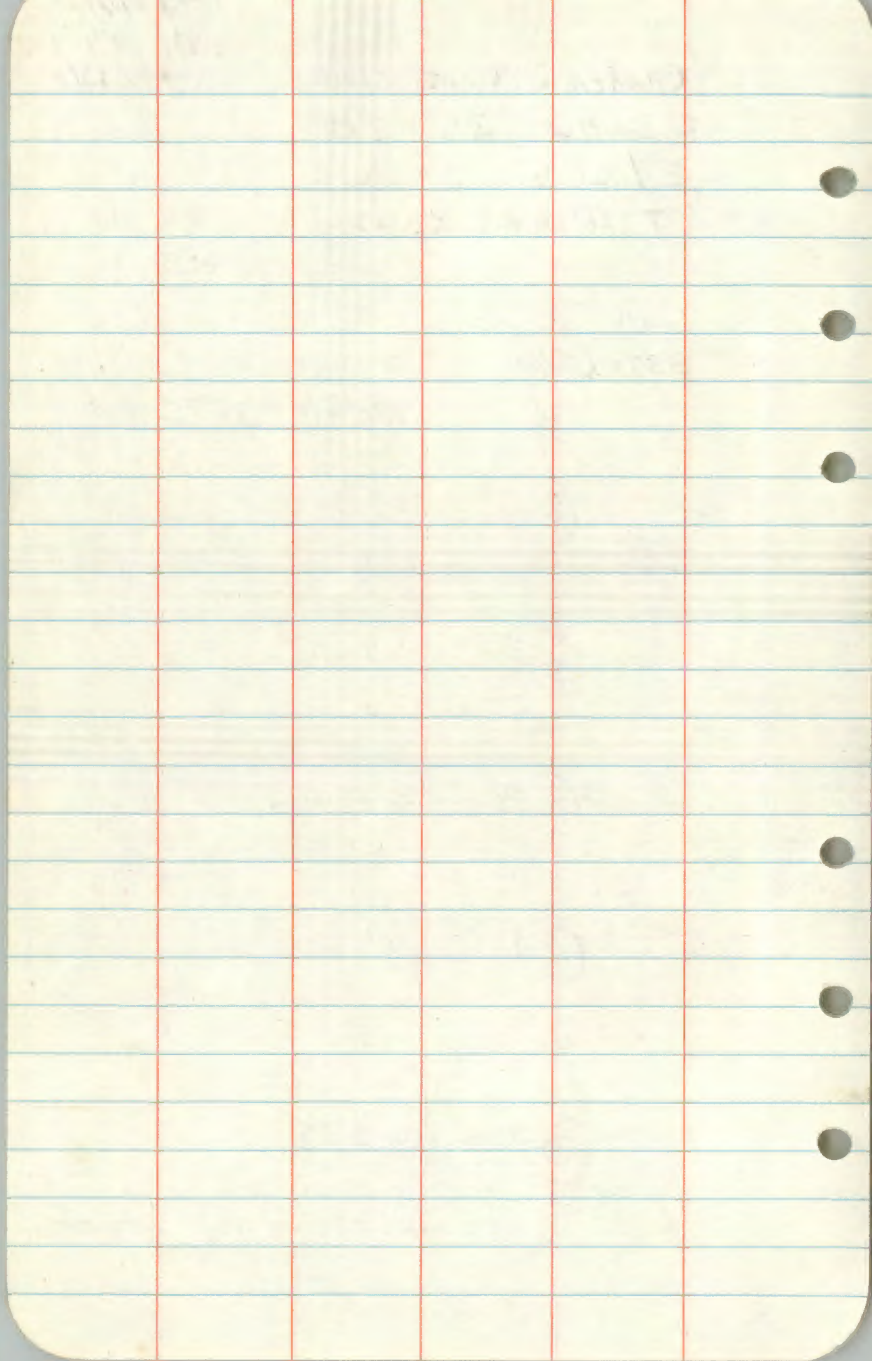

8/24/78
DK, CM
DD, JH

RANDOM + TRUE LINE

1/4 S35+S2 TO

W 1/16 S35+S2 T147N R31W
ON South Boundary
OF TOWNSHIP

TRUE LINE IS BRUSHED BLAZED
PAINTED + POSTED TO F.S. STANDARD

- BT'S + ACCESSORIES AT 1/4 S35+S2

8' METAL POST DUE SOUTH 11.58'
SIGNS 54-2 + 54-9 ATTACHED

| | | | |
|---------|-----|------|--------|
| ELM | 14" | S30E | 56.88' |
| W. OAK | 8" | S26W | 26.00' |
| N. PINE | 23" | S64W | 64.75' |

- BT'S + ACCESSORIES AT W 1/16 S35+S2

4x4 wood POST DUE SOUTH 9.47'
54-2; 54-9 + 5-6 ATTACHED

| | | | |
|--------|-----|------|--------|
| ELM | 17" | S48W | 52.82' |
| R. OAK | 25" | N28E | 85.83' |
| W. OAK | 7" | S72E | 49.38' |

STA STA
 OCCUPIED GATED 1ST & 2ND MIENNY

1/4 S3542 DUE WEST ON

COMPASS BEARING ALONG RD

| | |
|-------|-------|
| 99.77 | 99.77 |
| 99.73 | 99.73 |
| 99.55 | 99.35 |
| 99.46 | 99.46 |
| 99.33 | 99.33 |
| 99.99 | 99.99 |
| 99.93 | 99.33 |
| 99.53 | 99.53 |
| 99.11 | 99.11 |
| 66.62 | 66.62 |

962.22

1 1/4 S3542 0°00'00"

W 1/4 S3542 180°00'00" 360°00'00" 180°00'00"

| | |
|-------|-------|
| 99.97 | 99.97 |
| 98.76 | 98.76 |
| 99.78 | 99.78 |
| 56.06 | 56.06 |

354.57

TOTAL DISTANCE 1316.79'

RECORDED DIST. 1316.04'

.75'

8/24/78
DK, CM
DD, JH

RANDOM + TRUE LINE

$\frac{1}{4}$ S35+S2 TO

W $\frac{1}{16}$ S35+S2

ON SOUTH BOUNDARY OF
T147N R31W

W

○ W $\frac{1}{16}$ S35+S2

⊗ 1" WIGGLED IN

○ $\frac{1}{4}$ S35+S2

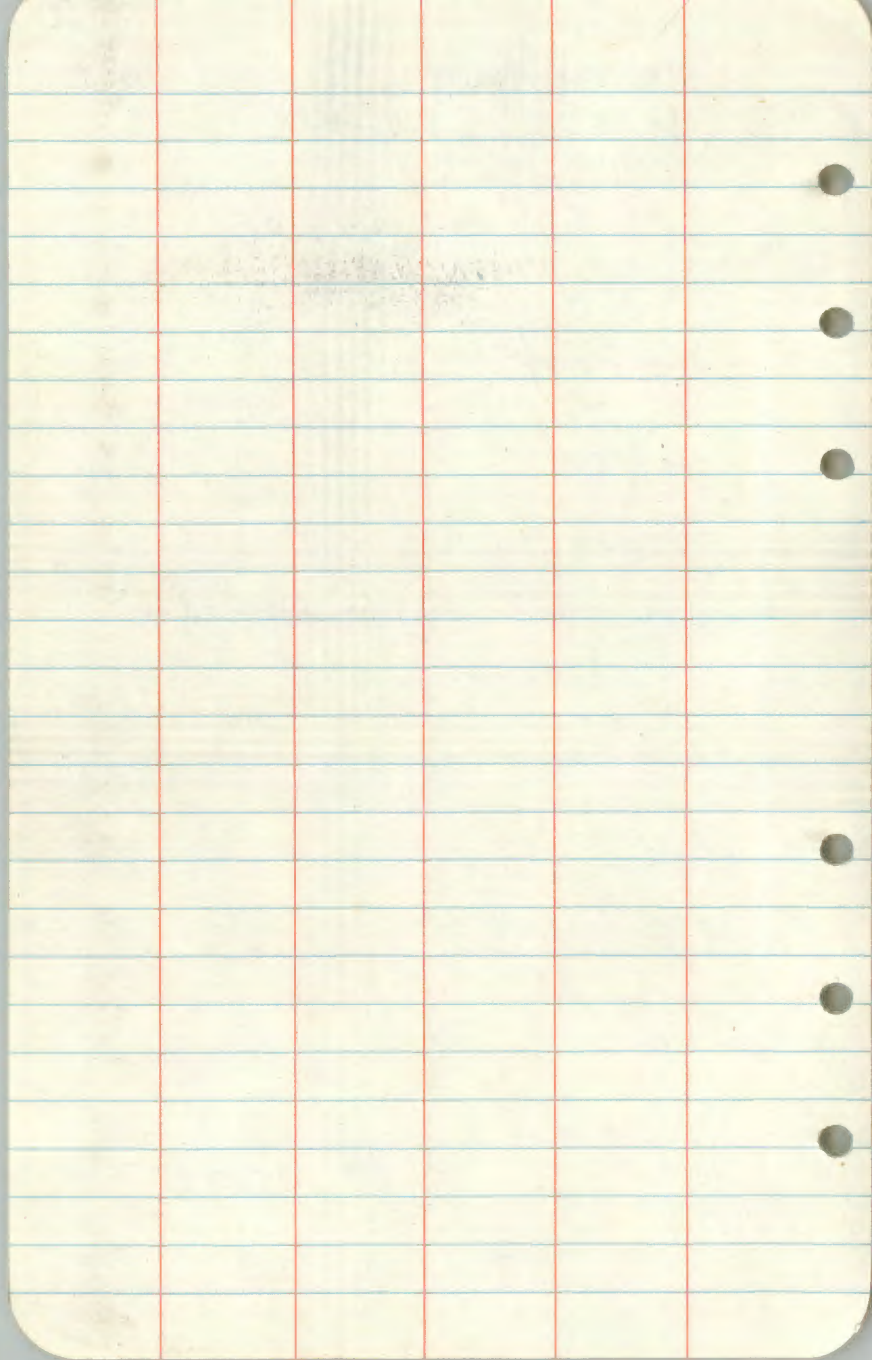

L. B. P. & L. CO. INC.

NATIONAL TRACING PAPER DIVISION

Round Cornered.
Packages of 100 or 250 Sheets Punched 6 holes and

For No. 412 LV and No. 412 TV

Sheet Size $5\frac{1}{2} \times 7\frac{1}{4}$

Dry Process Ammonia Developing Print Paper

No. 412 LV Level Book Sheets
No. 412 TV Transit Book Sheets
Ruling Special

(Sheet Size $5\frac{1}{2} \times 7\frac{1}{4}$)

Packages of 25 Right and 25 Left Hand Pages

(100% Rag No. 80 H Printfast vellum)

Loose Leaf Sheets or Filler on vellum

SPECIAL ENGINEERS

(No. 412 Extra Width Sheet Size $5\frac{1}{2} \times 7\frac{1}{4}$)

No. 412-T Transit Book Sheets
No. 412-L Level Book Sheets
Ruling Special

No. 410 Cross-Section Book Sheets
No. 409 Field Book Sheets
Ruling as No. 394

No. 408 Mining Transit Book Sheets
No. 407 Field Book Sheets
Ruling as No. 385

No. 406 Level Book Sheets
No. 407 Field Book Sheets
Ruling as No. 382

Packages of 50 Sheets

Size Sheets $4\frac{1}{4} \times 7\frac{1}{4}$ inches

Loose Leaf Sheets or Filler for above

STANDARD ENGINEERS

No. 412 6 Rings
No. 405 6 Rings
Size $8 \times 6\frac{1}{4}$

No. 404 6 Rings
No. 403 6 Rings
Size $7\frac{3}{4} \times 5$

Made in Fabrikoid cover, both stiff and flexible except
No. 405, 412 which are carried in stiff only.

Loose Leaf Field Book Binders

35948

STANDARD ENGINEERS

STANDARD ENGINEERS

17954

17954



Handwritten notes: 3 34, 7 9 1/2, 10 10 1/4

Handwritten note: 17954

8/31/78

DK CM
DD JH

RANDOM + TRUE

S $\frac{1}{16}$ S31+32 TO

SW $\frac{1}{16}$ S32

T147N R31W

TRUE LINE IS BRUSHED
BLAZED PAINTED + POSTED
TO F.S.M. STANDARDS

| STA OCCUPIED | STA SIGHTED PT ON LINE A | 1ST X | 2ND X | MEAN X |
|-----------------|-----------------------------------|--------------|--------------|----------------|
| S/631 | | 0° 00' 00" | | |
| S32 | 1 | 89° 36' 00" | | 89° 36' 00" |
| | | 45.39' | | 45.39 |
| | | 28.12' | | 28.12 |
| | | | | <u>73.51'</u> |
| 1 | S/65 ³¹ 32 | 0° 00' 00" | | |
| | 2 | 180° 00' 00" | 360° 00' 00" | 180° 00' 00" |
| | | 99.55' | | 99.55 |
| | | 99.87' | | 99.87 |
| | | 74.68' | | 74.68 |
| | | 99.43 | | 99.43 |
| | | 28.02 | | 28.02 |
| | | | | <u>461.55'</u> |
| 2 | 1 | 0° 00' 00" | | |
| | 3 | 180° 00' 00" | 360° 00' 00" | 180° 00' 00" |
| | | 99.68' | | 99.68' |
| | | 99.94' | | 99.94' |
| | | 99.72' | | 99.72' |
| | | 99.83' | | 99.83' |
| | | 99.61' | | 99.61' |
| | | 46.34 | | <u>46.34</u> |
| | | | | <u>545.12'</u> |

8/31/78
DK CM
DD JM

RANDOM + TRUE LINE

S 1/6 S31 + S32 TO

SW 1/6 S32

T147N R31W

| | | | |
|----|--------|------------|-----------------------|
| 3 | 2 | 0°00'00" | |
| Sw | 16.532 | 179°54'00" | 359°48'00" 179°54'00" |
| | | 99.58' | 99.58' |
| | | 99.66' | 99.66' |
| | | 40.83' | 40.83' |
| | | 39.90' | 39.90' |
| | | | <u>279.97'</u> :3' |

TOTAL DISTANCE 1300.15'

RECORDED DIST. 1298.22'

$$BC = 279.97' (.00175) \quad AC = \frac{1300.15'}{ONE}$$

$$BC = .4899475 \quad = 1300.15'$$

$$3B = 279.97' (ONE)$$

$$= 279.97'$$

$$AB = 1300.15'$$

$$\tan X A = \frac{.49}{1300.15'}$$

$$= .0003768$$

$$= .04' \text{ OFFSET North/100'}$$

8/31/78
DK cm
DD BH

RANDOM + TRUE LINE
S $\frac{1}{16}$ S 31 + 32 TO
SW $\frac{1}{16}$ S 32
T 147N R 31W

N 1

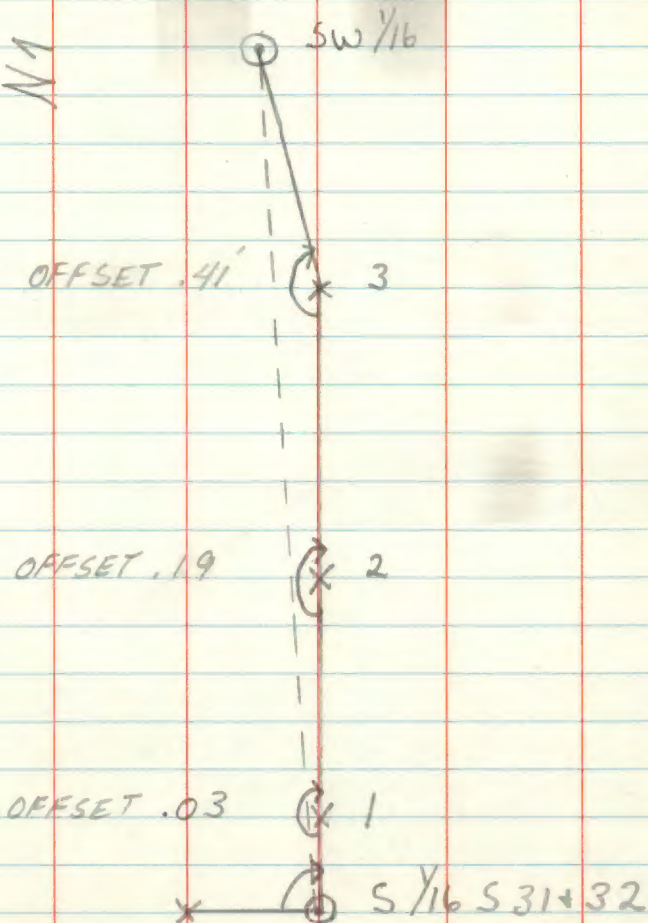

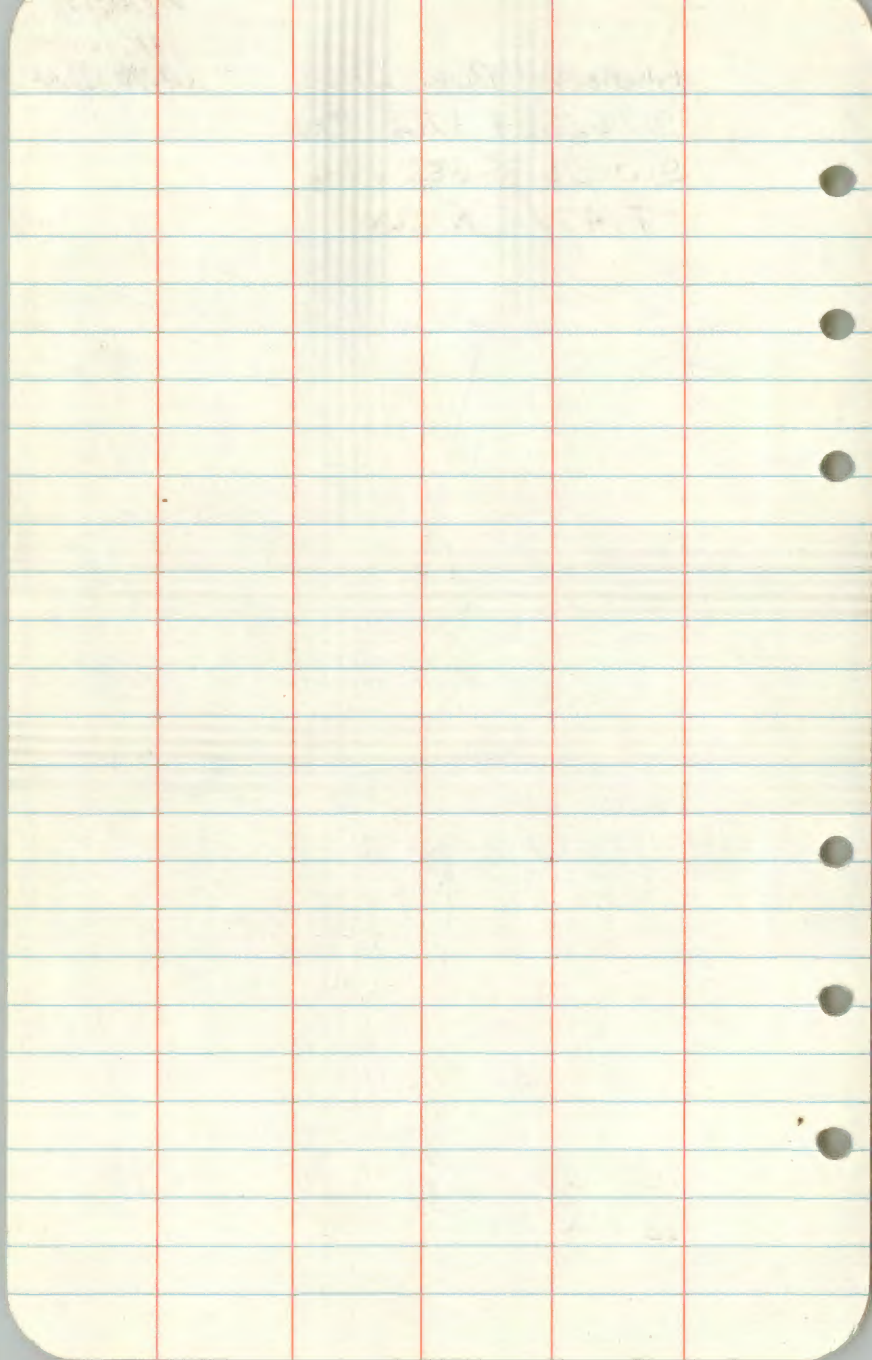

8/28/78
OK, CM
DO, JH

RANDOM + TRUE LINE

Y/4 S 31 + 32 TO

S Y/6 S 31 + 32

T147N R31W

TRUE LINE IS BRUSHED,
BLAZED, PAINTED + POSTED TO
F.S.M. STANDARDS

- BT'S + ACCESSORIES AT Y/4 S 32 + 33

| | | | |
|--------|-----|---------|--------|
| WASH | 7" | S 20° E | 38.70' |
| W. ASH | 6" | S 85° E | 38.80' |
| W. ASH | 13" | N 24° E | 37.2' |

- BT'S + ACCESSORIES AT S Y/6 S 31 + 32

| | | | |
|-----|--------|---------|--------|
| 7" | W. OAK | S 81° E | 42.91' |
| 9" | W. OAK | N 50° E | 50.61' |
| 12" | ELM | N 51° W | 71.63' |

STA STA
OCCURRED SIGHTED 1ST X AND X MEAN X

4532432 DUE SOUTH

| | |
|-------|---------------|
| 98.84 | 98.84 |
| 38.49 | 38.49 1.95 |
| 98.07 | 98.07 |
| 96.80 | 96.80 |
| 90.78 | 90.78 |
| 96.89 | 96.89 |
| | <u>519.87</u> |

| | | | | |
|---|---------|--------------|--------------|---------------|
| 1 | 4532432 | 0° 00' 00" | | |
| | 2 | 180° 00' 00" | 360° 00' 00" | 180° 00' 00" |
| | | 31.07' | | 31.07 |
| | | 51.76' | | 51.76 |
| | | 37.07' | | 37.07 |
| | | | | <u>119.90</u> |

| | | | | |
|---|---|--------------|--------------|---------------|
| 2 | 1 | 0° 00' 00" | | |
| | 3 | 180° 00' 00" | 360° 00' 00" | 180° 00' 00" |
| | | 98.57' | | 98.57 |
| | | 99.70' | | 99.70 |
| | | 99.43' | | 99.73 |
| | | 64.27' | | 64.27 |
| | | 56.62' | | 56.62 |
| | | | | <u>418.59</u> |

8/28/78

OK CM
00, 5H

RANDOM + TRWELINE

1/4 S31+32 TO

5 1/16 S31+32

T147 N R31 W

| STA OCCUPIED | STA SIGHTED | 1ST X | 2ND X | MEAN X |
|--------------|-------------|------------|-------|---------------|
| 3 | 2 | 0° 00' 00" | | |
| | 4 | 180 00 00 | | |
| | | 99.53' | | 99.53' |
| | | 59.20' | | <u>59.20'</u> |
| | | | | 158.73' |

| | | | | |
|---|-------|-------------|-----------|---------------|
| 4 | 3 | | | |
| | S/Y 6 | 00° 00' 00" | | |
| | | 194 45 00 | 29 30 00" | 194 45 00" |
| | | 26.64' | | 26.64' |
| | | 17.64' | | 17.64' |
| | | 27.56' | | <u>27.56'</u> |
| | | | | 71.84' |

TOTAL DIST. 1288.93'

RECORDED DIST. 1289.36'

COMPUTED DIST - 1286.56

2.20'

2/28/78
OK, CM
DD, JH

Random + True line

Y4 S 32 + 33 TB

S Y16 S 31 + 32

T147N R31W

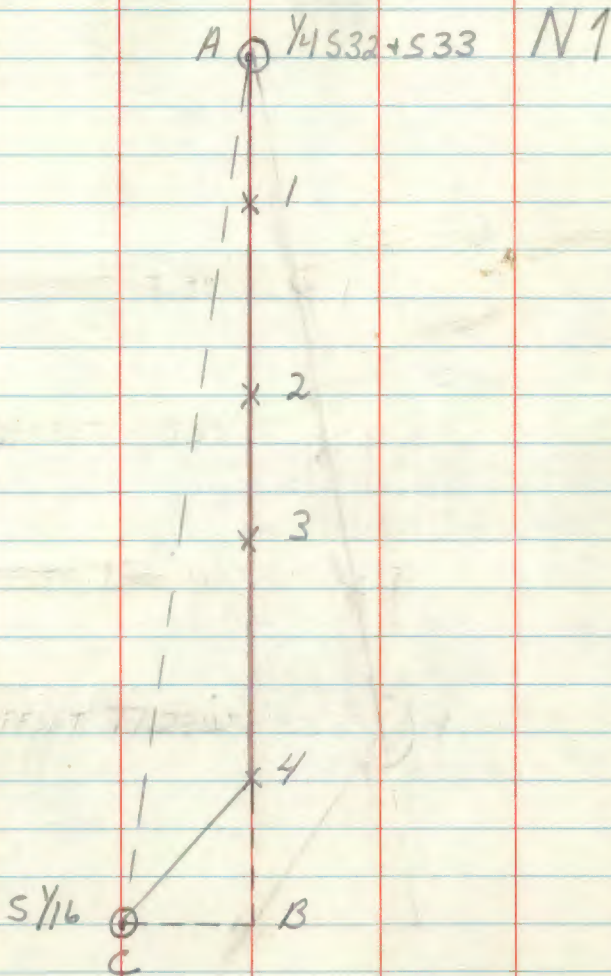

$$\begin{aligned}
 BC &= C \sin A \\
 &= 71.84' (.2546) \\
 &= 18.29'
 \end{aligned}$$

$$\begin{aligned}
 AC &= \frac{1286.56'}{.99999} \\
 &= 1286.57'
 \end{aligned}$$

$$\begin{aligned}
 AB &= C \cos A \\
 &= 71.84' (.96705) \\
 &= 69.47'
 \end{aligned}$$

$$\text{DIST.} = 1284.36 - (71.84' - 69.47')$$

$$\text{DIST.} = 1286.56'$$

$$\begin{aligned}
 \tan A &= \frac{a}{b} \\
 &= \frac{18.29'}{1286.56'}
 \end{aligned}$$

$$= .0142162$$

$$= 1.42 \text{ OFFSET WEST/100'}$$

$$= 0^{\circ}49'$$

OFFSET AT PT. 1 7.38'

" AT PT. 2 9.08'

" AT PT. 3 15.03'

" AT PT. 4 17.28'

TRAVERSE OF RANGE LINE
T 141N
BETWEEN
RANGES
27 & 28W

FROM SEC COR. 7, 12, 13 & 18 TO S $\frac{1}{16}$ BT. SEC. 1 & 6

| <u>PAGE</u> | POSITIONING OF 5 CORNERS |
|-------------|--|
| 8 | 1) $33\frac{1}{64}$ BT. SECTIONS 7 & 12 |
| 7 | 2) $\frac{1}{4}$ COR " " 7 & 12 |
| 6 | 3) $N\frac{1}{16}$ " " 7 & 12 |
| 5 | 4) SECTION COR. TO SEC. 1, 6, 7 & 12 |
| 4 | 5) $33\frac{1}{64}$ BT. SECTIONS 1 & 6 |
| 10 | 6) $\frac{1}{4}$ COR. BT. SECTIONS 1 & 6 |

| STATION OCCUPIED | STATION SIGHTED | VERTICAL ANGLE | SLOPE DISTANCE | MEAN ANGLE | HORIZONTAL DISTANCE |
|------------------|-----------------|----------------|----------------|-----------------------------|---------------------|
| 1 | 0 | 90-48-40 | 706.43 | | 706.36 |
| | | | | NEED COMPLEMENTARY Δ | |
| 1 | 2 | 00-00-00 | | OR 178-38-27 | |
| | 0 | 181-21-20 | 184-04-10 | 181-21-33 | |
| 1 | 2 | 89-28-30 | 604.57 | | 604.54 |
| 2 | X 3 | 00-00-00 | | NEED COMPLEMENTARY Δ | |
| | 8 1 | 179-34-20 | 178-43-30 | 179-34-30 | OR 180-25-30 |
| 3 | 2 | 90-21-20 | 1390.56 | | 1390.56 |
| 3 | 2 | 00-00-00 | | | |
| | 4 | 180-40-45 | 182-01-25 | 180-40-28 | |
| 3 | 4 | 90-03-00 | 2556.18 | | 2556.18 |

SIDE SHOT

| | | | | | |
|---|-----|-----------|-----------|-----------|--------|
| 3 | 2 | 00-00-00 | | | |
| | 1/4 | 315-28-10 | 116-24-50 | 315-28-16 | |
| 3 | 1/4 | 94-37-45 | 110.68 | | 110.32 |

CLEAR, 65°

PAGE # 2

JUNE 13, 1978

STEFAN & KRAUSE

"6" 5/16

TIES TO STA # 1

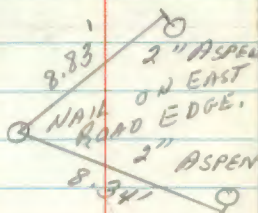
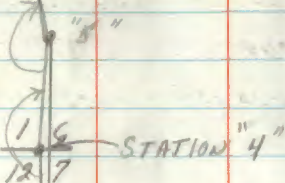

TIES TO STATION # 3

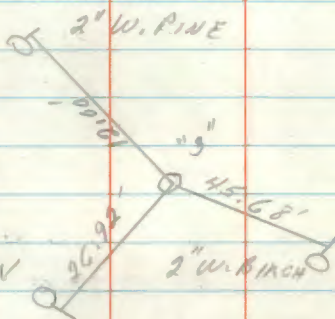

"2" 5/16

"1"

12.7
13.18
STATION "0"

STATION
OCCUPIED

STATION
SIGHTED

1st &
VERTICAL
ANGLE

3rd ANGLE
SLOPE
DISTANCE

MEAN
ANGLE

HORIZONTAL
DISTANCE

4

3

00-00-00

5

181-26-05

184-17-15

181-25-45

5

4

91-10-45

257.10

257.05

5

4

00-00-00

6

177-53-00

173-39-00

177-53-00

5

6

91-20-05

1051.34

1051.05

Checked by M.C. Hoyer
1/10/79

PAGE # 3

JUNE 13, 1978

STEPAN F. KRAUSE

STATION
OCCUPIED

STATION
SIGHTED

1st &
VERTICAL
ANGLE

2nd ANGLE
SLOPE
DISTANCE

3rd ANGLE
-ANGLE-

HORIZONTAL
DISTANCE

POSITIONING OF SS 1/64 RT. SEC 146

| | | | | | |
|---|---------|-----------|--|-------------------|--|
| 5 | 4 | 00-00-00 | | 2 ND X | |
| | SS 1/64 | 177-08-50 | | 177-08-50 | |

| | | | | | |
|---|---------|----------|--------|--|--------|
| 5 | SS 1/64 | 92-04-15 | 394.53 | | 394.27 |
|---|---------|----------|--------|--|--------|

Checked by M. C. H.
1/10/29

Cly-60

PAGE # 4

JUNE 15, 1978

STEFAN & KRAUSE

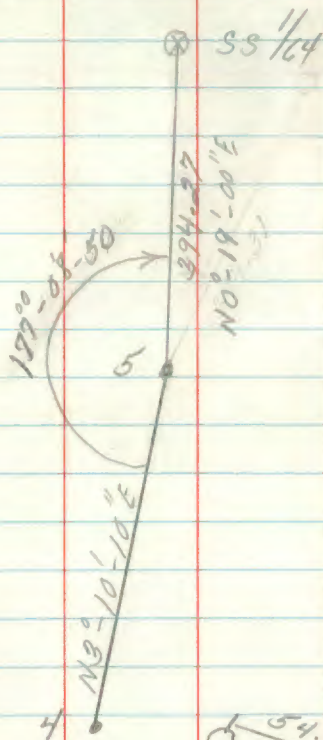

TIES TO SS 1/64

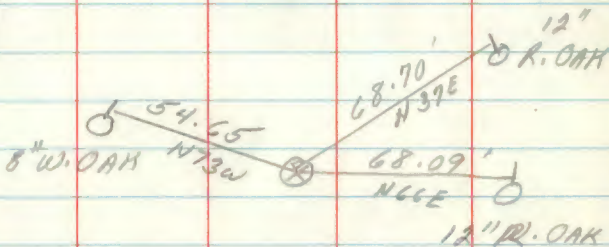

MONUMENTATION NOTES IN
BOOK 6, T14N, R.28W, PAGE 19.

STATION
OCCUPIED

STATION
SIGHTED

1st &
VERTICAL
ANGLE

2nd ANGLE
SLOPE
DISTANCE

MEAN
ANGLE

HORIZONTAL
DISTANCE

POSITIONING OF SECTION CORNER
COMMON TO SECTIONS 1, 6, 7, 12

| | | | | |
|---|---|--------------------|--|-----------------------------|
| 5 | 4 | 00-00-00 | | 2ND X |
| | | SEC. COR 0-05'-32" | | 0-05'-32" |

| | | | | |
|---|---|----------|--------|--------|
| 5 | 4 | 90-56-05 | 262.80 | 262.77 |
|---|---|----------|--------|--------|

Checked by M.C.H.
1/10/79

Cly-60

PAGE # 5

JUNE 15, 1978

STEFAN & KRAUSE

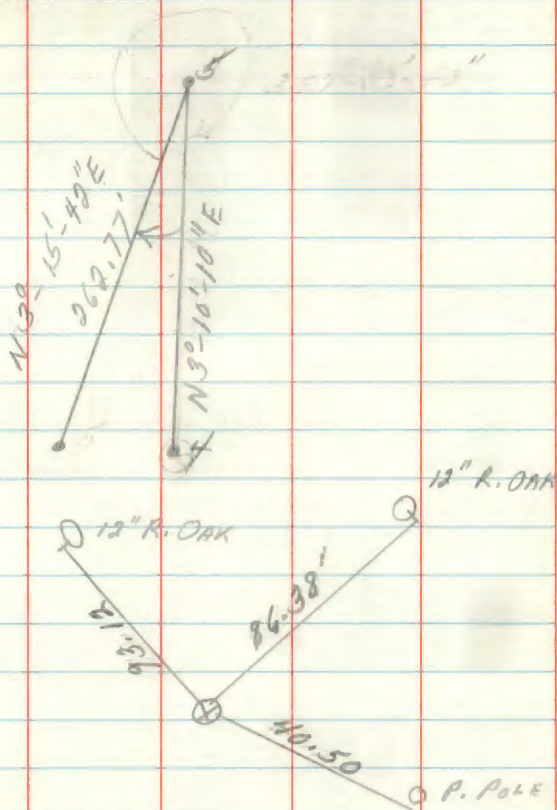

MONUMENTATION NOTES IN
BOOK # 3, PAGE # 72, T14N, R28W

3 4 00-00-00
N 1/16 0°-14'-08" 0°-14'-08"

3 N 1/16 90-03-10 1236.84 1236.84

Checked by M.C.H.
1/10/79

CLW-60°

PAGE #6

JUNE 22, 1978

STEFAN, KRAUSE &

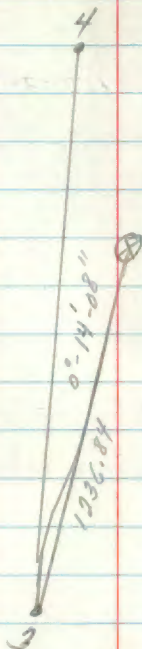

MONUMENTATION NOTES IN
BOOK #1, PAGE 41, T141N, R27W

| | | | |
|---|-----|-----------|-----------|
| 3 | 4 | 00-00-00 | |
| | 1/4 | 172-03-05 | 172-03-05 |

| | | | |
|---|-----|------------|--------|
| 3 | 1/4 | LEVEL TAPE | 77.56' |
|---|-----|------------|--------|

Checked by M.C.F.
1/10/79

JUNE 22, 1978

STEFAN, KRAUSE &

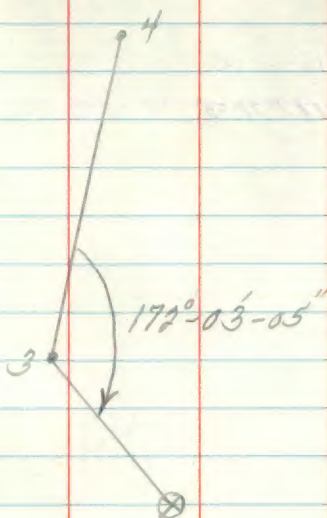

MONUMENTATION OF THIS CORNER
IS IN BOOK # 6, PAGE # 50, T141N,
R28W

1 2 00-00-00
SS 1/64 189-21-45 197-53-00

1 SS 1/64 Level Tape 51.50

Checked by M.E.H
1/10/79

JUNE 22, 1978

STEFAN, KRABBE & HANSEY

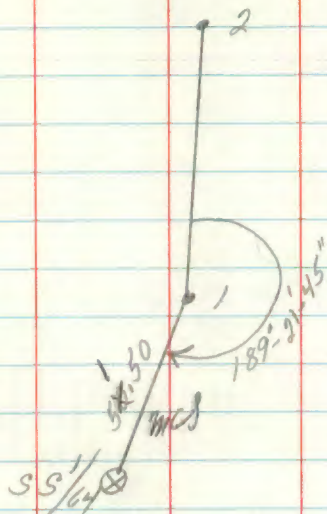

MONUMENTATION NOTES IN
 BOOK # 6, PAGE # 17, T 14 N, R 27 W

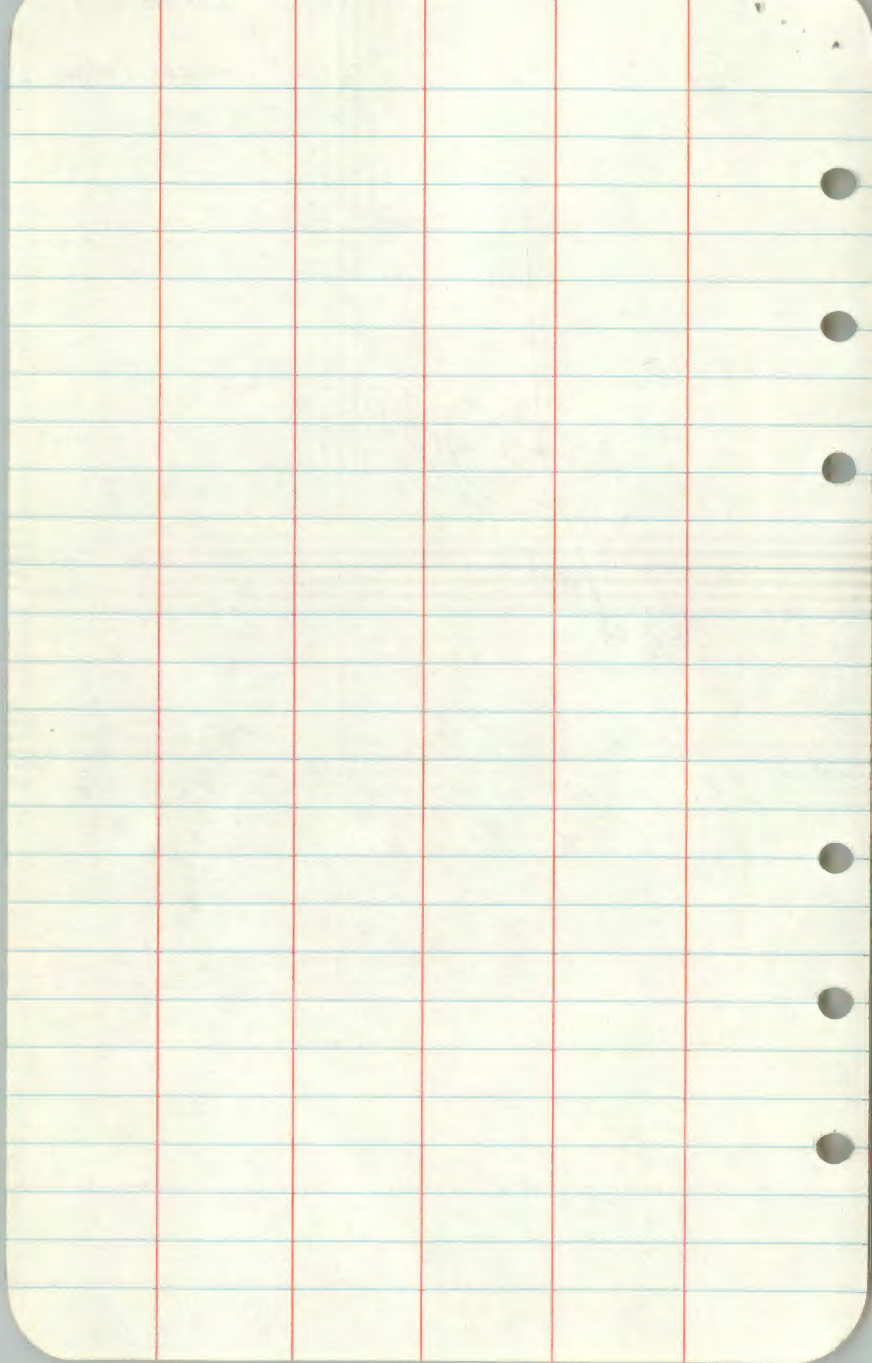

ESTABLISHMENT OF

$\frac{1}{4}$ CORNER

BETWEEN

SECTIONS 146 T14N R27-28W
5TH P.M.

SPRING 1978

STEFAN, KRAUSE & OAESEN

| STATION OCCUPIED | STATION SIGHTED | 1st & VERTICAL ANGLE | 2nd ANGLE SLOPE DISTANCE | MEAN ANGLE | HORIZONTAL DISTANCE |
|------------------|-----------------|----------------------|--------------------------|------------|---------------------|
|------------------|-----------------|----------------------|--------------------------|------------|---------------------|

STRADDLED IN ON LINE BET. $\frac{1}{4}$ & $N\frac{1}{16}$ TO POINT "A"

| | | | | | |
|---|-----------------|-----------|--|--|--|
| A | $N\frac{1}{16}$ | 00-00-00 | | | |
| | $\frac{1}{16}$ | 180-00-00 | | | |

| | | | | | |
|---|-----------------|----------|--------|--|--------|
| A | $N\frac{1}{16}$ | 73-07-05 | 493.49 | | 492.74 |
|---|-----------------|----------|--------|--|--------|

| | | | | | |
|---|----------------|----------|--------|-------|--------|
| A | $\frac{1}{16}$ | 89-37-25 | 168.99 | | 168.99 |
| | | | | | 661.73 |
| | | | 1918 | 620 = | 661.32 |
| | | | | | + .41' |

| | | | | | |
|---|---------------|----------|--------|--|--------|
| A | $\frac{1}{4}$ | 90-09-50 | 829.44 | | 829.44 |
|---|---------------|----------|--------|--|--------|

| | | | | | |
|---------------|---|----------|--|--|--|
| $\frac{1}{4}$ | A | 00-00-00 | | | |
| | B | 181-06- | | | |

| | | | | | |
|---|-----------------|-----------|-----|-----------------|-------------------|
| B | $\frac{1}{4}$ | 00-00-00 | | | |
| | $S\frac{1}{16}$ | 180-00-00 | HIT | $S\frac{1}{16}$ | GLO BEARING GOOD! |

| | | | | | |
|---|---------------|----------|--------|--|--------|
| B | $\frac{1}{4}$ | 90-05-00 | 916.54 | | 916.54 |
|---|---------------|----------|--------|--|--------|

| | | | | | |
|---|-----------------|----------|--------|--|--------|
| B | $S\frac{1}{16}$ | 93-25-20 | 399.11 | | 398.40 |
|---|-----------------|----------|--------|--|--------|

Checked by M.C.F.
1/10/79

| | |
|-------|---------|
| rec'd | 1314.94 |
| GLO | 1311.42 |
| | + 3.52 |

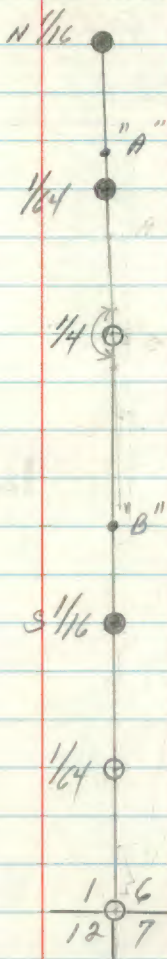

TIES TO 1/4 COR

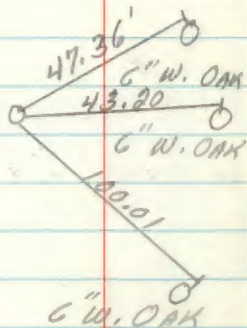

R 28W R 27W

MONUMENTATION NOTES
ON PAGE # 71, BOOK # 3
T141N, R 28W

See Computation Sheet #4 by Hayes

STATION
OCCUPIED

STATION
SIGHTED

1st &
VERTICAL
ANGLE

3rd ANGLE
SLOPE
DISTANCE

MEAN
ANGLE

HORIZONTAL
DISTANCE

ESTABLISHING CS 1/4 TO

SECTION 22 T147N R31W

BY

MILO STEFAN & CORT KRAUSE

8/31/78

STATION
OCCUPIEDSTATION
SIGHTED1st &
VERTICAL
ANGLE3rd ANGLE
SLOPE
DISTANCEMEAN
ANGLEHORIZONTAL
DISTANCESTADDLED IN BETWEEN S $\frac{1}{4}$ & C $\frac{1}{4}$ 1 S $\frac{1}{4}$ 00-00-00C $\frac{1}{4}$ 180-00-001 S $\frac{1}{4}$ 91-55-20 448.23

447.98

1 C $\frac{1}{4}$ ⁸⁹
~~88~~-51-30 2139.19

2129.18

2587.16

 $\frac{1}{2}$ 2

= 1293.58

- 447.98

845.601 C $\frac{1}{4}$ ON LINE1 CS $\frac{1}{2}$ C 90-51-40 845.77

845.60

1 S $\frac{1}{4}$ 447.98

1293.58

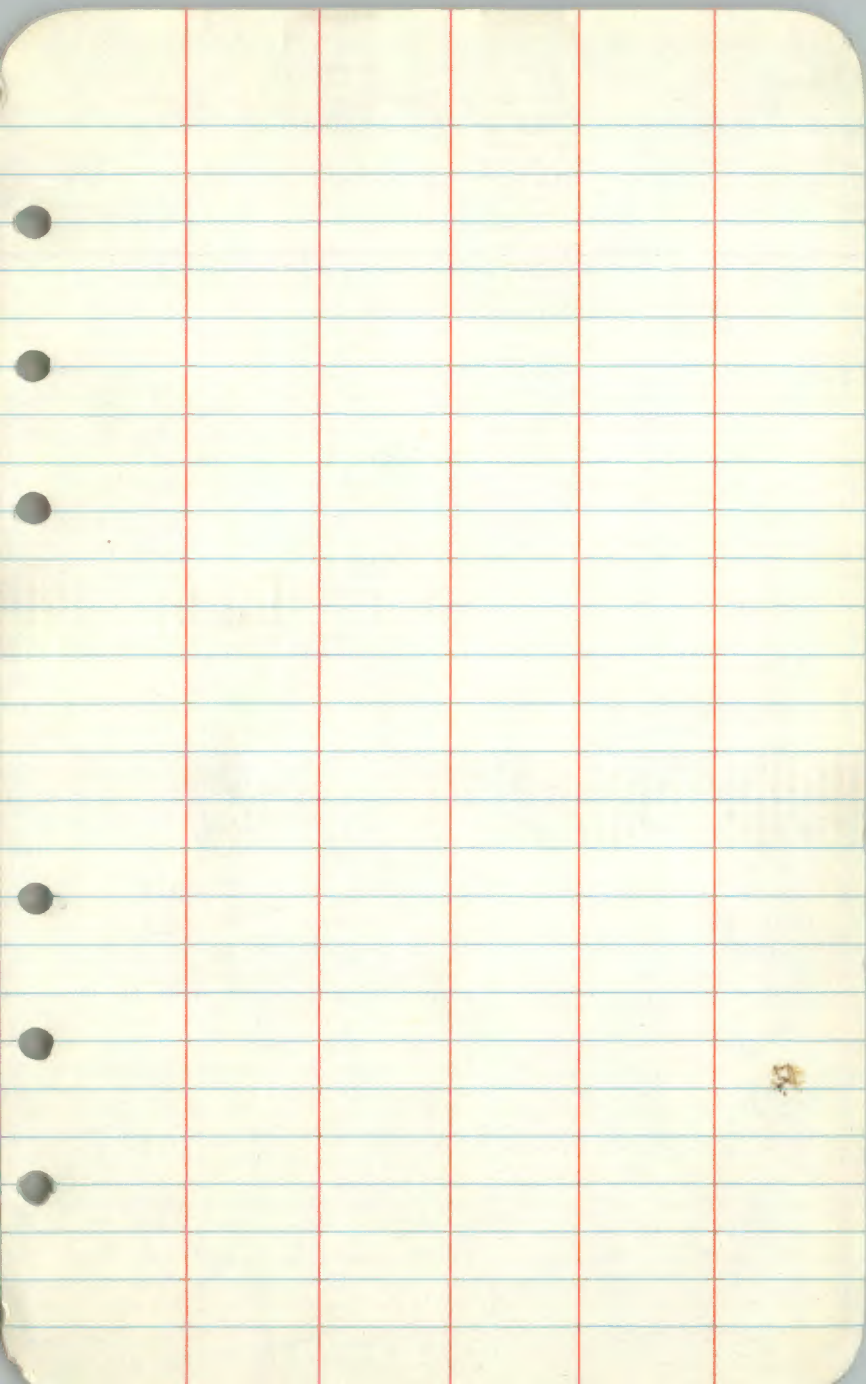

$175 - 55 = 120$
 $46 - 20 = 26$
~~175~~
~~116~~
 $116 - 52 = 64$

175
 31
 144
 116
 52
 64
 116
 52
 64

120
 46
 76
 31
 46
 76
 55
 26
 80
 106
 132