

CORNER RESTORATION
T150N R25W

K&S
MINING TRANSFER BOOK
82-0023

Book # 3

CORNER RESTORATION

T150N R25W

BOOK 3

T150N

R25W

Book 3 of 3

6	5	4	3	2	1
7	8	9	10	11	12
18	17	16	15	14	13
19	20	21	22	23	2 3 4 24 6 7
30	29	28	27	26	25
31	32	33	34	35	36

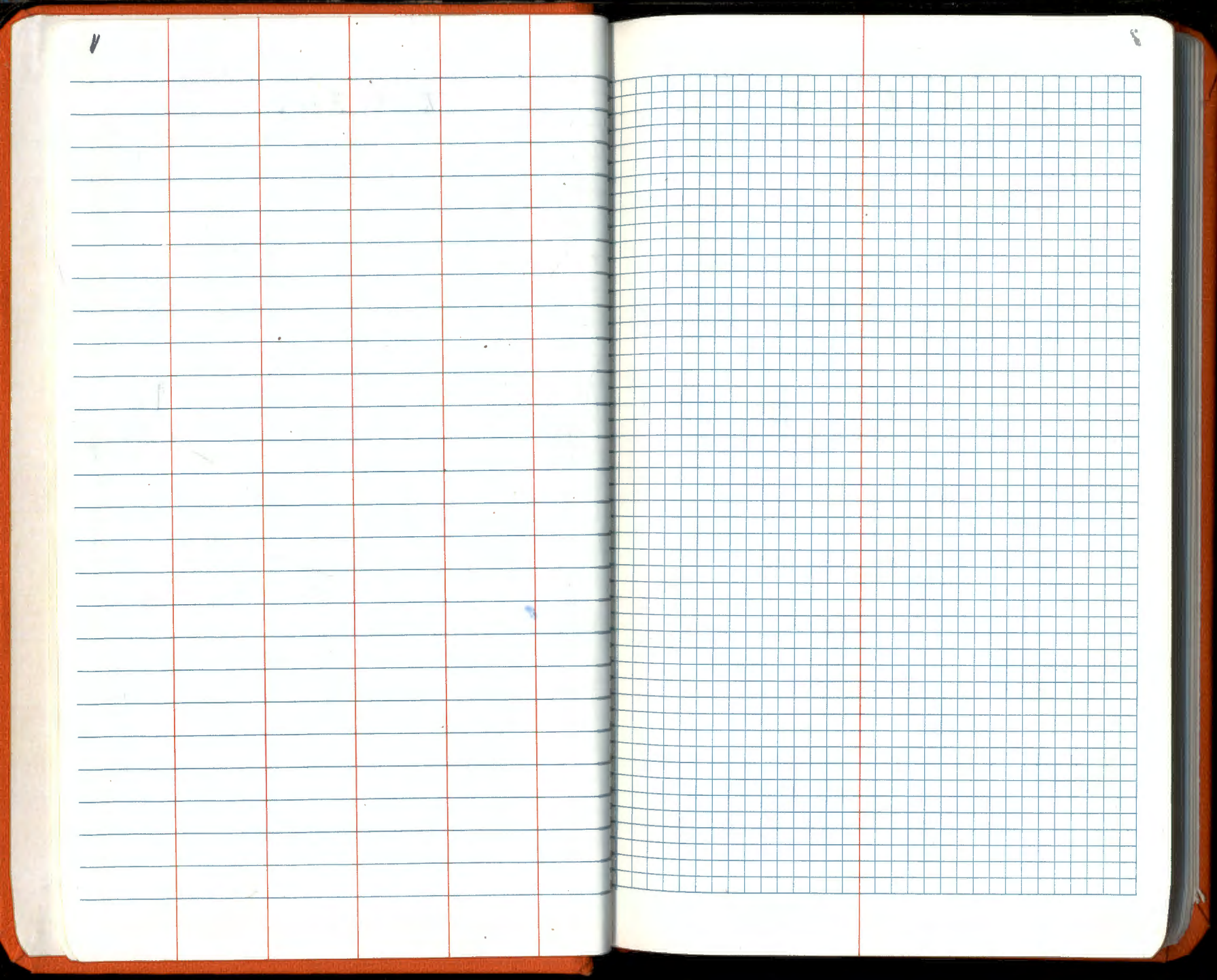

2 N-22

West $\frac{1}{16}$ Cor. Sec 13 & 24
from the Sub-division Survey
of Sec 24 by Milo Stefan USFS
1978.

Set a 2" dia. x 5' long steel
pipe with brass cap marked,

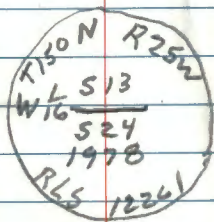

from which bears

W. spruce	W. Cedar	W. Pine
15"	7"	18"
N56E	S73W	S88E
60.45	86.63	109.80'
W 1/16 S13 BT	W 1/16 S24 BT	W 1/16 S24 BT

Set a 8' long steel sign post with
signs 54-2 & 54-4 East 4.5'

8/21/78
Ronald Olson

3 0-22

North West 1/16 Sec. 24
from the Sub-division survey of
Sec 24 by Milo Stefan U.S.F.S. 1978

set a 2" dia x 5' long steel pipe
with brass cap marked,

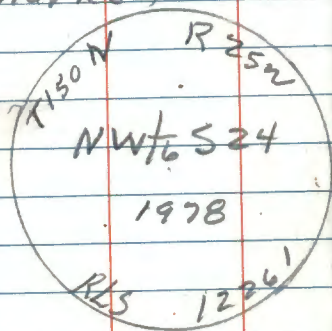

from which bears

W. spruce	W. Oak	Black Spruce
11"	6"	7"
N64E	N84W	S26E
32.21	36.99	24.63
NW 1/16 S24 BT	NW 1/16 S24 BT	NW 1/16 S24 BT

set a 8' long steel sign post with
signs 54-2 & 54-4 East 2.6'

8/21/79

Ronald Olson

4 0-23

Center North $\frac{1}{16}$ Sec 24
from the Sub-division Survey of
Sec 24 by Milo Stefan USFS. 1978

set a 2" dia x 5" long steel pipe
with brass cap marked

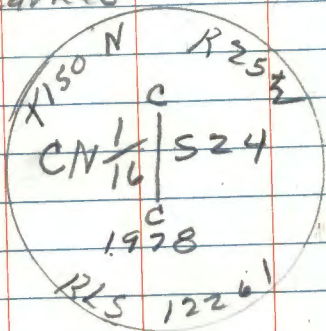

from which bears

Ash	Ash	Cedar
5"	6"	7"

N 44° E	N 38° W	S 56° W
1.92'	22.92'	39.60'

CN $\frac{1}{16}$ S24 BT CN $\frac{1}{16}$ S24 BT CN $\frac{1}{16}$ S24
BT

set a 8' long steel sign post with
signs 54-2 & 54-4 West 1.5'

8/22/78

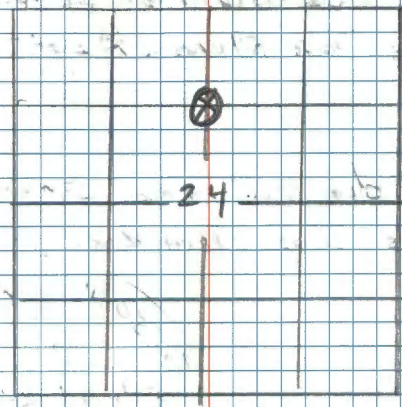

5 P-23

Center 1/4 cor sec 24

from the Sub-Division Survey
of Sec. 24 by Milo Stefan 1978 USFS

set a 2" dia x 5' long steel pipe
with Brass Cap marked,

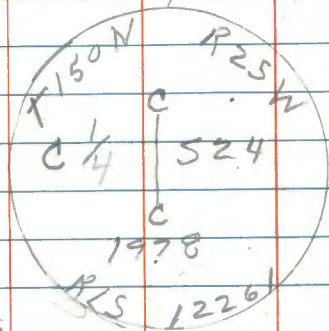

from which bears

W. Oak Cedar W. Oak

4" 12" 6"

N71E S5°W S46E

31.57 70.94 18.92

X BT C 1/4 S24 BT C 1/4 S24 BT

set 8' Long steel sign post with
signs 54-2 / 54-4 South 4.2'

4/22/78

T150N

R25W

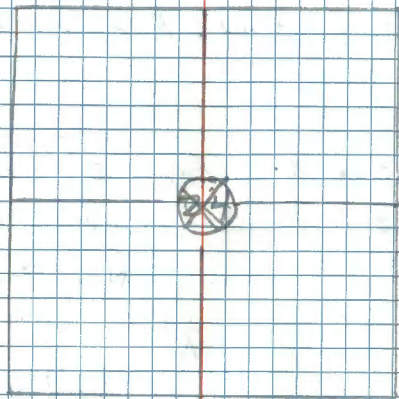

6 Q-23
Center South $\frac{1}{16}$ sec 24
from the subdivision of Sec 24
by Milo Stefan U.S.F.S. 1978

set a 2" dia x 5' long steel pipe
with Brass cap marked.

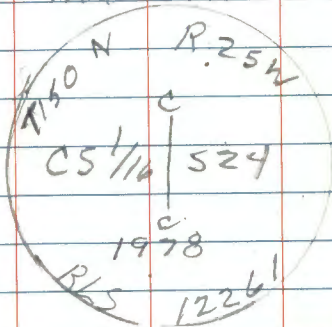

from which bears

Cedar Cedar W. Oak

9" 12" 7"

N 74 E N 38 W S 48 E

40.16 48.36 17.31

CS $\frac{1}{16}$ S24 BT CS $\frac{1}{16}$ S24 BT CS $\frac{1}{16}$ S24 BT

set a 8' long steel sign post with
signs 54-2 & 54-4 North 2.9°

8/27/78
Ronald Oline

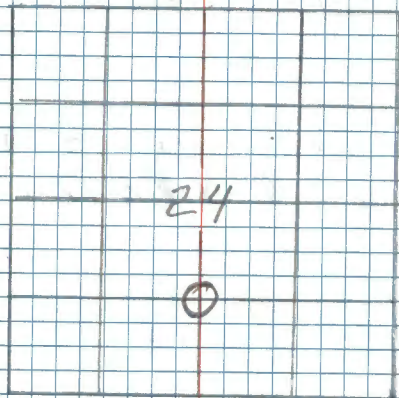

7 Q-25
 Standard South $\frac{1}{16}$ Sec. 24
 from the sub-division of Sec 24
 by Milo Stefan U.S.F.S. in 1978

Set a P.K. Nail in center of
 State Hwy. #6 at Cor. Location

from which bears

2" dia x 5' Long

Brass Cap Monument

$589^{\circ}40'45''$ W

60.00'

Birch Ash

6" 11"

$N70^{\circ}W$ 554W

98.60 70.12

SCS $\frac{1}{16}$ S24 SCS $\frac{1}{16}$

BT BT

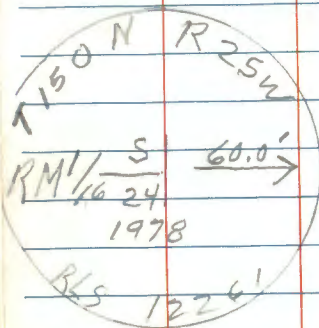

Set a 4" x 4" x 8' Long Cedar Post
 with signs 54-2 & 54-4 & 54-6
 $589^{\circ}40'45''$ W 50.0'

8/24/78
 Ronald [unclear]

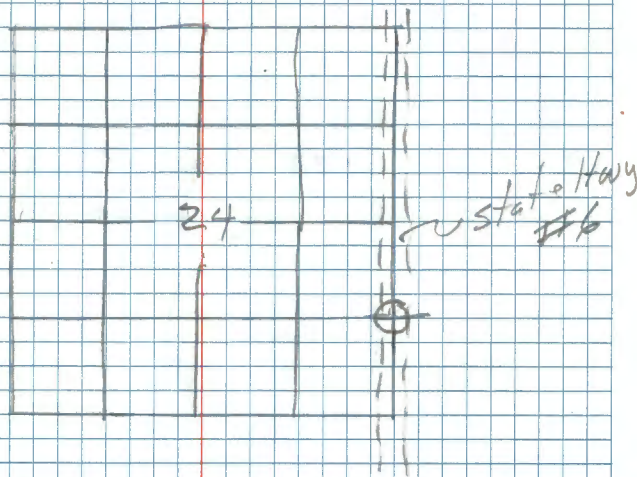

11/15/79

TIES TO W.C. $\frac{1}{16}$ COR. (SAME AS DEN. COR. B.T.S)

B. ASH 11" $55^{\circ}E$ 41.52' MKD SCS $\frac{1}{16}$ S24 BT

BIRCH 6" $N44^{\circ}W$ 45.81' MKD SCS $\frac{1}{16}$ S24 BT

MD

V-5
SOUTH $\frac{1}{16}$ SECS. 31-32

Corner position established on line
and midpoint btwn. $\frac{1}{4}$ cor north and sec.
cor. to the south.

11/15/80 Set a 30" x 2 3/4" Alum. monument with
Alum. cap 8" above ground marked:

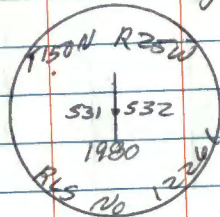

from which bears:

				scribed
ASH	6"	S57°E	31.39'	S $\frac{1}{16}$ 532 BT
ASH	6"	S35°W	16.16'	S $\frac{1}{16}$ 531 BT
W. Oak	8"	S72°W	27.90'	S $\frac{1}{16}$ 531 BT
Steel Sign Post		North		

All measurements are to nail on side of trees
Put FSLP on 5" Ash N84°W 72' to Cor.

M.C. Hayes
Entered in this book 1/29/81 from 789-750-4
by Hayes, Brown, Blair, Sherwood

Remainder of
Book -

Blank
Pages