

CORNER  
STORAGE  
149N, R30W, 5<sup>th</sup>

149N R. 30W  
Book # 1

BOOK 1



USFS

INDEX TO CORNERS

BOOK #1 of 2

T149N R30W

6	5	4	3	2	1							
9	8	7	10	11	12							
73												
18	17	16	15	14	13							
50	46	47	27	38	28	29	19	20	11	12	67	
17	45	20	36	21	27	22	18	23	10	99	68	
49	43	44	34	35	25	26	16	17	8	9	67	
30	42	29	33	28	24	20	15	26	7	25	66	
48	40	41	31	32	22	23	14	3	4	6	65	
4	39	32	30	28	21	34	13	35	5	26	64	
2	44	37	38	37	36	35	34	52	53	51	62	63

Colored numbers refer to page  
on which notes of that corner  
may be found

T149N R30W



2-1

Town Corner on the 18th Std. Par.

T149N  
R31 36 31 R30  
T148N

orig. BT's

R. Pine 12" N75°E 2 LKs or 4.6'

W. Pine 9" N23°W 24 LKs 15.8'

Found - W. Pine stp N31W 24 LKs (158')

MKD BT

Corner was marked by fence post & marked stake. Also found below ground a conic concrete monument approx. 1 1/2 ft long. set cor. in same spot.

Set:- a 2" inside dia. 5' long gal. wrought iron pipe filled w/ concrete & capped w/ a 3" dia. bronze tablet stamped:-

T149N  
R31W R30W  
536 531  
T148N  
1959  
R.L.S. No. 3628

New BT's

R. Pine S76°E 37.9' MKD T148 R31 S1 BT

R. Pine N4 1/2 E 10.5' MKD T149 R31 S36 BT

J. Pine S 45 1/2 W 28.5 MKD T148 R31 S1 BT

Also See T149N R31W  
Book #1 Pg. 4

Placed F.S. Location poster on Red Pine N 4 1/2 E 10.5' from corner

6-1-59

A.W. Flanahan

4/24/80 Krause & Hayes

Found monument and accessories as set by Flanahan in 1959, 316' west of Q. Co. Rd #39 (bearing on stones may not be with proper declination. Ed evidence of a recent survey line by persons unknown, punching was taken from road to center. Ed. old concrete monument lying on ground.

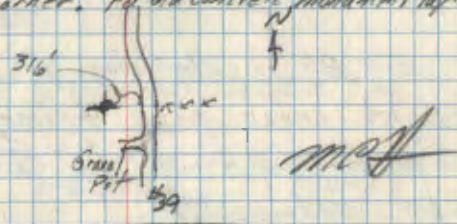

From Cor. Cert # 273717 by Baltimore Co. Survey Dept. July 1981 County to all the 1959 monument & ties and took the following new ties:

- 12" J. Pine N50°W 23.33' N.I.D. (scribed)
- 12" N. Pine N72°E 12.47' N.I.D. (scribed)
- 12" N. Pine S57°E 15.69' N.I.D. (scribed)
- 11" N. Pine S25°W 40.10' N.I.D. (scribed)

4/16/89 M. Hayes, R. Main, K. Smith, visited corner at request of District Ranger as gravel pit activities are close to monument. Found the 1959 monument in good condition with the following ties:  
1959 R. Pine cut stump S76°E 37.9' w/scar (stump is 0.5 high)  
1959 R. Pine N5°W 10.5' w/scar & F.S.P.  
1981 Co. N. Pine 12" N72°E 12.47' scribe visible  
1981 Co. N. Pine 12" S57°E 15.69' scribe visible  
Discoloration of soil at location of original W. Pine. The concrete monument was leaning against the West side of iron pipe.

Made the following new ties:  
10" R. Pine N10°E 67.35' MKD S31 BT w/Tag  
15" R. Pine N56°E 58.65' " S31 BT w/Tag  
5" R. Pine N87°E 58.65' " X BT w/Tag  
Steel sign post North 41.70 and East 41.70 w/both signs (lines were not painted due to rain)

MCA



Affidavit<sup>6-19</sup>

1/4 Cor. Sec. 26-35

$$\frac{26}{35}$$

Orig.

Tim 8" (Now 12" stump partly decayed  
with scribing partly visible) N10°W

2 Links or 1.3 Ft.

No other evidence of orig. BT's  
or corner was found.

Set a 2" inside dia. x 5' Long gal.  
brought iron pipe filled with concrete  
& capped w/a 3" dia. bronze  
Tablet stamped:-

T149 N R30 W

1/4 S26

S35

1958

R.L.S. NO. 3628

New B.T.s

Cedar N53°W 16.3' MKD T149 R30 S26 BT

B. Spruce S71°W 2.8' " T149 R30 S85 BT

B. Spruce S75½°E 2.4' " T149 R30 S35 BT

F.S. Metal location poster is on  
BT. B. Spruce N44°E 2.8'  
Blazed line East to Rd. Tag on  
post approx. 1260' East of Cor.

October 31, 1958

Joseph F. Lausehe

10-4-06 R. MAEN

FD IRON UP 3 FT AND GPS. ONLY BT FOUND  
IS BLACK SPRUCE STUMP/W/BLAZE S71°W 7.8'

FD CEDAR 12" S75°E 9.60 FT TO NAIL WITH  
TAG BY JO/JSB 7-6-1976 (NEW)

OK  
Wagon  
12-22-6



#

V-21  
Affidavit

Sec. Cov. 25-26-35-36

26	25
35	36

orig. Notes

- ① Tam 9" (New 10" stub with scribing visible) S49°W 30 Lks or 19.8'
- ② Tam. 10" (New 12" stump partly decayed with no scribing visible) N30W 17 Lks or 11.2'
- ③ Tam 9" (New stump mostly decayed with no scribing visible) S11°E 21 Lks or 13.9'

Set a 2" inside dia. 5' Long gal. wrought iron pipe filled w/ concrete & capped w/a 3" dia. bronze tablet stamped

T149N R30W

S26 S25  
S35 S36  
1958

RLS NO. 3628

New B.T.'s

- Cedar 4" N75°W 19.2' MKD T149R30 S26 BT
- Cedar 7" S33½°W 25.9' MKD T149R30 S35 BT
- Cedar 6" S41°E 34.2' MKD T149R30 S36 BT

October 31, 1958  
Joseph F. Lausche

CC DONE

SEARCH & TIED OUT FOR FIELD CHECK

9-22-82 CK-68 Fd. WOOD POST BESIDE F.S. I.P.  
FOUND 2" F.S. MOND. IN PLACE 18" HIGH IN RIDGE & WILLOW BRUSH SWAMP - ONLY TREES NEAR ARE BT'S.  
BLUE LINE RUN UP FROM SOUTH  
EVIDENCE OF ORIG. BT'S. REMAINS  
Fd. 10" X 20 TAM. SNAG LEANING INTO 8" CEDAR 3' SOUTH  
TAM SNAG HAS SCRIBE VISIBLE T149NR30WS35 BT

NO EVIDENCE OF CEDAR BT AT N30E 15.2' - ORIG. BT  
Fd. LARGE CEDAR AT N26E 21.5' CHAPPED INTO BY SOME ONE YEARS AGO - NO SCRIBE VISIBLE

FOUND TAM. STP. WELL ROTTED AT S11E 13.9'  
NO SCRIBE VISIBLE

FOUND WELL ROTTED TAM. STP. AT N50W 11.2'  
NO SCRIBE VISIBLE

1958 BT'S.

CEDAR N75W IS WINDFALL LYING ON GROUND  
SCRIBE NOW UNDER MOSS

CEDAR S34W SCRIBE ROTTED BUT NEARLY DEAD

CEDAR S41E SCRIBE CLOSED BT APPEARS TO BE IN GOOD SHAPE - BUT IS LEANING TOWARDS MOND. SO DISTANCE WILL NOT CHECK IN FUTURE

TEMP TIES 9-22-82

CEDAR 8 S40W 21.7' BASE BLAZE NAIL AT BASE  
CEDAR 10 N32W 45.8' " " " " " "

TREES HAVE BEEN TAGGED

ORIG. BT'S. 1893

CEDAR 8 N30E 23 Lks. = 15.18'  
TAM. 9 S49W 30 Lks. = 19.80'  
TAM. 10 N50W 17 Lks. = 11.22'  
TAM. 9 S11E 21 Lks. = 13.86'

10-5-06 R.M. MIN

GPS IRON



5  
QUARTER CORNER BETWEEN SEC'S. 35-36

NOTES OF ORIG. GOVT. SURVEY 1893

SET WOOD POST

TAM. 5 N40E 47 LKS. 31.0'

NOW 5" TAM WINDFALL N40E 31.0 FAINT SCRIBE VISIBLE

TAM. 5 N49W 66 LKS. 43.6'

9-22-82 CK-68

CHAINED 2640' SOUTH OF SEC. COR. 25-26-35-36  
FOUND 5" TAM WINDFALL LYING IN SWAMP WITH  
BOTH UPPER + LOWER BLAZES VISIBLE WITH FAINT  
SCRIBE - NO POST FOUND - NO EVIDENCE OF OTHER  
BT FOUND - END OF DAY WALK OUT - NEEDS MORE  
SEARCH



QUARTER CORNER BETWEEN SEC'S. 25-36

NOTES OF ORIG. GOVT. SURVEY 189<sup>3</sup>

SET WOOD POST

SPRUCE 10 S82E 4 LKS. 2.6'

J. PINE 14 N65W 11 LKS. 7.3'

NOTES BY JOHN A. GJELHAUG CIVILENG, 12-6-39

FOUND ASPEN POST AND ORIG. JACK PINE STP.

12" SSW 14 LKS, FD. LARGE STP. SSW 9.2' WELL ROTTED

MKD NEW BT'S.

J. PINE 3 N53E 21 1/4 LKS. 14.03'  
 N53E 14.0' OLD FSLA ON SAME DATE 1939  
 NOW 10 J. PINE SNAG WITH SCRIBE 1/4 S25 BT VISIBLE

J. PINE 3 N16W 32 1/2 LKS. 21.45'  
 NOW LIVING J. PINE 15 N16W 21.5' SCRIBE VISIBLE INSIDE  
 PUT FSLP ON NE BT AS ABOVE

9-13-82 CK-68

WALKED INTO CORNER LOCATION FROM NORTH ALONG  
 OLD WOODS TRAIL - FOUND BOTH BT'S. MKD. IN 1939  
 NO POST FOUND

AREA OF CORNER IS SOUTH EDGE OF N. PINE & J. PINE  
 PLANTATION - AREA HAS BEEN FURROWED YEARS AGO  
 OLD BLUE PAINTED EAST OF THIS COR. 82 CK

10/1/84 - JA GB

Mkd. Temporary BT'S

1. Jack Pine 6" S77W 18.65' Spike + tag.

2. N. Pine 8" N65E 44.6' Spike + tag



7  
QUARTER CORNER BETWEEN SECS. 25-26

NOTES OF ORIG. GOVT. SURVEY 1893

SET WOOD POST

ASPEN 20 N60W 10LKS, 6.6'

BIRCH 8 S72E 27LKS, 17.8'

NOTES BY JOHN A. GJELHAUG ENG + SURVEYOR

5/19/39 CCC BOOK PAGE 25

SET BY PROPORTIONATE DISTANCE

SET ASH POST 3" Ø, IN PILE OF STONE

NO GREEN TREES TO MARK

PUT FSLP ON BIRCH SNAG 10" N2E 42LKS, 27.7'



G SECTION CORNER TO SECTIONS 23-24-25-26  
 NOTES OF ORIG. GOV'T. SURVEY 1893  
 SET WOOD POST

A W.PINE 9 S47E 24 LKS. 15.8

E BIRCH 10 N33W 24 LKS. 15.8

BIRCH 8 S71W 6 LKS. 4.0

TAM. 13 N60E 28 LKS. 18.5'

NOTES BY JOHN A. GJELHAUG 5/24/39

SET BY PROPORTIONATE DISTANCE

SET ASPEN POST 4" X 48" IN PILE OF STONE

MKD NEW BT

ASPEN 6 N61°30'E 53 LKS. 35.0' ESLP

CERTIFICATE FILED



9 R-23

## QUARTER CORNER BETWEEN SEC'S. 24-25

NOTES OF ORIG. GOVT. SURVEY 1893

SET WOOD POST ORIGINAL WOOD POST HAS

PROBABLY ROTTED AWAY, AS NO EVIDENCE WAS FOUND

TAM. 6 N11W 4 LKS. 2.6

NOW WELL ROTTED TAM STP. N5W 2.6

TAM 8 S24W 15 LKS. 9.9

NOW WELL ROTTED TAM STP. S22W 9.9'

WITH NAG. SCRIBE UNDER MOSS

NOTES BY JOHN A. GJELHAUG CIVIL ENG. 5-31-39

FOUND CEDAR POST 40 HIGH AND EVIDENCE OF

BOTH ORIG. B.T'S.

TAM. STP. 8 S29W 12 LKS. 7.9' MKO BT

TAM. STA 6 N3W 7 LKS. 4.6' MKO BT

PUT FSLP ON BALSAM S CORNER. IS SOUTH

=20.0'  
30 1/2 LKS. OF TAG.

BALSAM STUMP REMAINS - BUT TOP WAS CUT

OFF AND TAG REMOVED YEARS AGO

SWAMP WAS LOGGED MANY YEARS AGO

CC DONE

10-4-89 CK-JA-68  
CHAINED SOUTH FROM C14 SEC. 24 1334'  
NO EVIDENCE OF C5'116 AT THIS TIME  
CONTINUE SOUTH THROUGH ALDER WILLOW SWAMP.TO 1334'S  
FD. 4"X4" CEDAR POST LYING IN SWP. 8' W  
OF OUR LINE AND 8' SHORT OF THE LAST 1334'  
SO TOTAL FROM N11W TO S14 IS 5310  
NORTH 1/2 IS OUR CHAIN 2650 - S 1/2 OUR CHAIN 2660'  
SET NEW 4"X4" CEDAR POST FOR CORNER POSITION  
OLD POST AT SOUTH EDGE OF NEA POST

TEMP TIES

TAM. 12 S80W 18.4' SPIKE &amp; TAG

TAM. 12 N75E 13.2' " "

BOTH OF ABOVE TAM. ARE DEAD - THERE ARE  
NO LIVING TREES NEAR CORNER - CREEK TO WEST  
HAS HAD MANY BEAVER DAMS OVER THE YEARS  
AND SWAMP HAS BEEN FLOODED WHICH KILLED ALL  
THE TREES N & E OF CORNER FOR 300' TO 400'CHECKED DISTANCE TO CREEK 480 W OF 1/4 COR.  
THIS DISTANCE TO OAK CHECK WITHIN 10'-15' OF  
ORIGINAL

5/30/86 JA DG

FD: Two wood post - tied out new post for mon.  
position.SET: Beltrami County 2"X2"X90" capped  
Iron monument marked T149NR20W1 1/4 524  
post point on south side. New post 525on East side and top of Old 1986  
post on west side. Set 1310 15810

8' fiber glass sign post WEST 3.79' Dry sign

8' fiber glass sign post SOUTH 3.74' Dry sign

8' fiber glass sign post NORTH 2.30' Dry sign

c.c. Done 1986



P-21

QUARTER CORNER BETWEEN SEC'S. 23-24

NOTES OF ORIG. GOVT SURVEY 1893

SET WOOD POST

BALSAM 8 N46E 10 LKS. 6.6

BIRCH 11 S36W 21 LKS. 13.9

10/16/84 CK JA GB

Chained west from C<sup>1/4</sup> (Fd) sec. 24

2633' - (GJELHANS distance) - fell 15'

West of  $\frac{1}{4}$  of Road N<sup>1</sup>S (in ditch). Then

E PM of distance from NW sec. 24 (Fd)

South 2643' (GJELHANS distance). Intersected

these two lines - searched area - no evidence

everything has been disturbed. Set a 6" x 7'

cedar post with Approy tag for this Approy-

position. CMC North 15' from corner. Fence

line East (down) rock ridge along fence

C. E. Done 1986

## CERTIFICATE FILED

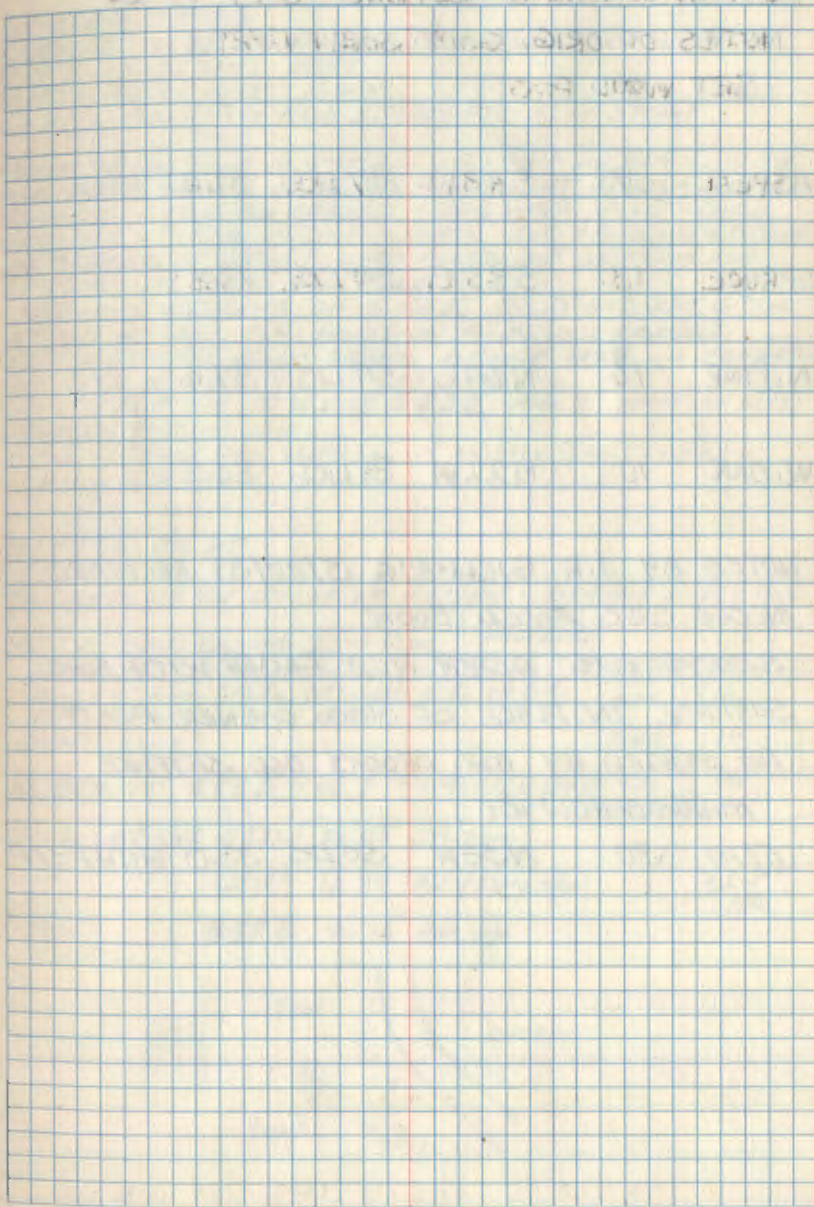



11 N-21

SECTION CORNER TO SECTIONS 13-14-23-24

NOTES OF ORIG. GOVT. SURVEY 1893

SET WOOD POST

ASPEN 7 S43W 47 LKS. 31.0

SPRUCE 13 S35E 20 LKS. 13.2

N. PINE 16 N64E 57 LKS. 37.6

W. OAK 10 N22W 31 LKS. 20.5

NOTES BY J.A. GJELHAUG 5/20/39 RECORDED  
IN OLD C.C.C. FIELD BOOK

SET 4" X 16" ASPEN HUB FLUSH WITH ROAD  
SURFACE IN PLACE OF ORIG. CORNER POST

AS STATED BY MR. BROOKS OLD SETTLER

MARKED NEW BT

ELM 30 N58W 50 LKS. 33.0' WITH FSLP

# CERTIFICATE FILED

10-2-84 OK-66

CHAINED SOUTH ALONG OLD TOWNSHIP ROAD N45  
1319.5 FENCE LINE EAST  
2690'S FENCE LINES E & W  
5280'S END CHAIN AND SEARCH FOR ELM STUMP

FOUND LARGE ELM BURNT LOG & STUMP IN PLACE WITH  
OLD FSLP ON SE SIDE NEXT TO DIRT PARTLY UNDER  
ELM LOG LYING ON GROUND - DUG AREA UP AND FOUND  
OUTLINE OF ELM STUMP - PLACE 50" SPIKE WITH RIBBON  
IN CENTER OF STUMP, ALSO PLACE 50" SPIKE IN LOG  
AT PLACE WE FOUND OLD FSLP

WE TAKE BEARING OF S52E 33.0' AND SET 6" X 1/2"  
REBAR AT SEC COR. POSITION 4" BELOW GROUND  
SET 2X2 X 98" ELM STAKE BEHIND IRON ON SHOULDER  
ON ROAD N45E 15' WEST OF CENTER LINE  
PUT FSLP ON 10 W. OAK S83E - 46.3' STAKE ON SIDE  
BLAZED FACING COR.

Total distance from centerline of blacktop (E+W) south to  
corner is 5276'

11/5/84 JA BT

FD: re-rod set for corner on 10/2/84 - tied out to set B.C.

SET: 2" Brass Capped Iron Pipe marked  
down 2" in road shoulder with  
2x2 x 4' Elm stake on south side of B.C. T149N R30W  
rocks around top of B.C. 514 + 513

Witness by: 523 524

W. Oak 10" S83E 46.3 T149N R30W 524 BT 1981  
(see tags reading) Res No 15810

Steel sign post 3' x 8" N52W 32.83' AM sign

" " WEST 12.98 AM & Reddy signs

" " S55E 70.78 AM sign

L.E. Doherty  
1986

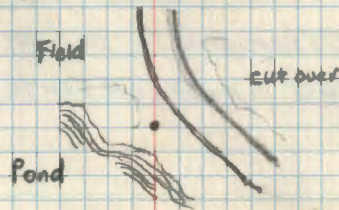



12  
QUARTER CORNER BETWEEN SEC'S, 13-24  
NOTES OF ORIG. GOV'T. SURVEY 1893  
SET WOOD POST

BIRCH 7 S15E 11 LKS. 2.3

Fd. no remains

BIRCH 9 N59W 13 LKS. 8.6

Fd. no remains

NOTES BY J. A. GJELHAUS-CIVIL ENG. -5-25-39

FOUND CEDAR POST 40" HIGH AND ORIG. BT.

DEAD BIRCH 8 S9E 16 1/2 LKS. MKD S24BT

PUT FSLP ON DEAD CEDAR 6 CORNER BRS. EAST  
3  
LKS. OF TAB.

10/3/84 CK, JA, GB

Found 2 cedar posts marking corner  
position. 3" x 48" & 2" x 36" (rotted)

Found cedar windfall 1.98' west of corner  
with old F.S.L.P. by Gjelhaug. Distance  
on tag says 3 lks. east.

Set a 4" x 4" x 7" cedar post at corner  
position. Other posts set on east side.  
Placed a sod spike on south side of new  
post.

# CERTIFICATE FILED

Mkd. New BT'S:  
Ash 5" N36W 11.20' 1/4 S13BT  
Ash 5" S29E 21.15' Placed old F.S.L.P. on this tree.  
1/4 S24BT  
Ash 6" S66W 27.66' 1/4 S24BT  
Spikes & tags on each tree.

Chained from sec. cor. 13, 14, 23, 24 east 2633' to  
corner. Corner falls in a Ash swale. 240' west  
is higher ground. Found old blazes on cedar stubs  
east of corner. Gjelhaug dist in 2638.70

6/25/86 - CK, GB, JA 87° Hot & humid  
Set a 2" x 60" galv. iron pipe with brass  
cap mkd. in place of 4x4x7" cedar post.  
B.C. sits 15" above ground. Placed cedar post  
on north side.

8" steel sign posts east 3.5 and west 3.5'  
with both signs attached

CC  
7/96



13

QUARTER CORNER BETWEEN SEC'S. 34-35

NOTES OF ORIG. GOVT. SURVEY 1893

SET WOOD POST

CEDAR 7 N60E 3 LKS. 2.0

TAM. 9 S65W 7 LKS. 4.6



SECTION CORNER TO SECTIONS 26-27-34-35

NOTES OF ORIG. GOV'T. SURVEY 1893

SET WOOD POST

BALSAM 6 S30E 12 LKS. 7.9

BALSAM 5 N88E 15 LKS 9.9

TAM. 10 S78W 60 LKS. 39.6

BASSWOOD 4 N87W 65 LKS. 42.9

SECTION CORNER BETWEEN SECTIONS 26-27-34-35

NOTES OF ORIG. GOV'T. SURVEY 1893

SET WOOD POST

BALSAM 6 S30E 12 LKS. 7.9

BALSAM 5 N88E 15 LKS 9.9

TAM. 10 S78W 60 LKS. 39.6

BASSWOOD 4 N87W 65 LKS. 42.9



QUARTER CORNER BETWEEN SEC'S, 26-27

NOTES OF ORIG. GOVT. SURVEY 1893

SET WOOD POST

BALSAM 6 S31E 13 LKS. 8.6

BALSAM 10 N16W 20 LKS. 13.2

QUARTER CORNER BETWEEN SEC'S, 26-27

NOTES OF ORIG. GOVT. SURVEY 1893

SET WOOD POST

BALSAM 6 S31E 13 LKS. 8.6

BALSAM 10 N16W 20 LKS. 13.2



## SECTION CORNER TO SECTIONS 22-23-26-27

NOTES OF ORIG. GOVT. SURVEY 1893

SET WOOD POST

B TAM. 10 N20E 5 LKS. 3.3

B CEDAR 7 S7E 6 LKS. 4.0

BALSAM 8 S65W 13 LKS. 8.6

CEDAR 14 N38W 25 LKS 16.5

4-9-84 GB-JA-DG. SEE PAGE 26 THIS BOOK

CHAINED EAST FROM 1/4 COR.

SEARCHED AREA OF SEC. COR. NO EVIDENCE FOUND

PUT FSLP ON 9 BIRCH S30W - 23.0' FROM END OF CHAIN



QUARTER CORNER BETWEEN SEC'S, 23-26

NOTES OF ORIG. GOVT. SURVEY 1893

SET WOOD POST

BALSAM 4 N 13W 11 LKS. 7.3

ASPEN 4 S 72 E 11 LKS. 7.3



QUARTER CORNER BETWEEN SEC'S. 22-23  
NOTES OF ORIG. GOVT. SURVEY 1893  
SET WOOD POST

BALSAM 5 N28W 10 LKS. 6.6

BALSAM 6 S63E 15 LKS. 9.9

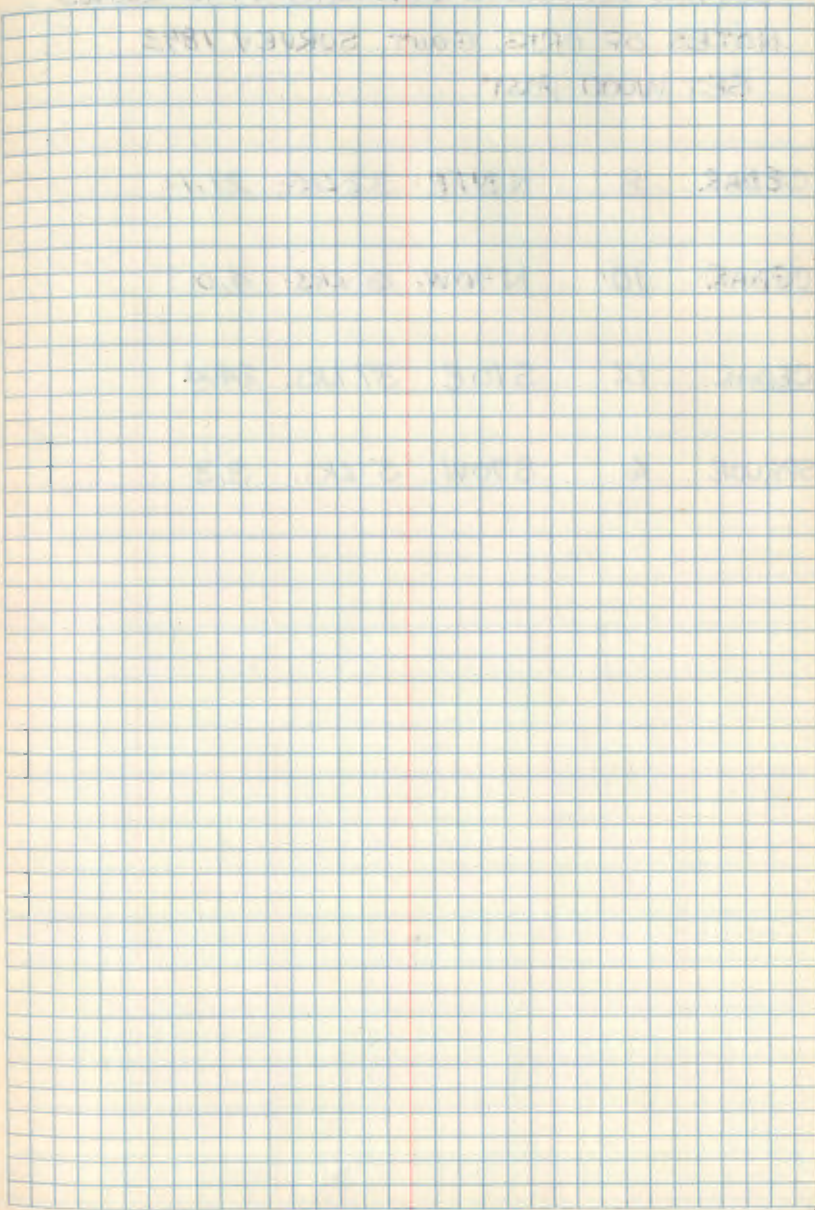



SECTION CORNER TO SECTIONS 14-15-22-23

NOTES OF ORIG. GOVT. SURVEY 1893

SET WOOD POST

CEDAR 8 N37E 32 LKS. 21.1

CEDAR 10 N70W 4 LKS. 4.0

CEDAR 12 S10E 37 LKS. 24.4

SPRUCE 6 S70W 5 LKS. 3.3



QUARTER CORNER BETWEEN SEC'S. 14-23

NOTES OF ORIG. GOV'T. SURVEY 1893

SET WOOD POST

FIR. 6 SOUTH 13 LKS. 8.6

CEDAR 7 N60E 8 LKS. 5.3



21

QUARTER CORNER BETWEEN SEC'S. 33-34

NOTES OF ORIG. GOVT. SURVEY 1893

SET WOOD POST

TAM. 5 S65E 6 LKS. 4.0

TAM. 10 N40E 10 LKS. 6.6



SECTION CORNER TO SECTIONS 27-28-33-34

NOTES OF ORIG. GOVT. SURVEY 1893

SET WOOD POST

SPRUCE 6 S13E 25 LKS. 16.5

SPRUCE 6 N35E 30 LKS. 19.8

SPRUCE 12 N32W 53 LKS. 35.0

SPRUCE 12 S64W 31 LKS. 20.5

SECTION CORNER TO SECTIONS 27-28-33-34

SPRUCE	6	S13E	25 LKS.	16.5
SPRUCE	6	N35E	30 LKS.	19.8
SPRUCE	12	N32W	53 LKS.	35.0
SPRUCE	12	S64W	31 LKS.	20.5



QUARTER CORNER BETWEEN SEC'S. 27-34

NOTES OF ORIG. GOVT. SURVEY 1893

SET WOOD POST

SPRUCE 10 S40W 5 LKS. 3.3

SPRUCE 10 N20W 19 LKS. 12.5

Blank grid page with faint mirrored text from the reverse side.



QUARTER CORNER BETWEEN SEC'S. 27-28  
NOTES OF ORIG. GOVT SURVEY 1893  
SET WOOD POST

: ASPEN 6 N27E 30 LKS. 19.8

§ ASPEN 8 S85W 12 LKS. 7.9



## SECTION CORNER TO SECTIONS 21-22-27-28

NOTES OF ORIG. GOVT. SURVEY 1893

SET WOOD POST

BIRCH	8	N9W	17 LKS.	11.2'
BIRCH	6	S23E	15 LKS.	9.9'
SPRUCE	7	S84W	28 LKS.	18.5'
BALSAM	5	N49E	34 LKS.	22.4'

## NOTES OF BELTRAMI COUNTY ROAD SURVEY 1908

FOUND NW BT STANDING AND NE+SE BT'S.

CUT OFF MARKS OK AND SW BT GRUBBED OUT

SET CEDAR POST IN STONE MOUND

MKD BT'S.

CEDAR	10	N18 $\frac{1}{2}$ E	59 $\frac{1}{4}$ LKS.
BIRCH	12	S15E	35 LKS.
CEDAR	8	N35W	47 LKS.

6-10-81 CK-GB-RN

DUG WITH BACKHOE IN INTERSECTION AND FOUND STONE MOUND 15 STONE FROM 2" TO 8" DIA. IN AN 20" CIRCLE

24" BELOW ROAD - NO POST FOUND IN MOUND

SET 1" X 1/4" IRON PIN IN STONE MOUND AT TRUE COR.

WITNESSED BY PIN IS 10" BELOW ROAD

POWER POLE SE 35.1' NAIL ON SIDE  
TEL. PED. POST SW 50.9' " " "

10-15-82 GB

SET. 2" X 24" F.S. MONUMENT WITH CAP MKD.

PLACED 2" PIPE IN ROCK MOUND T149N R30W  
10" BELOW ROAD SURFACE  
PLACE MAG. PELLET 2" UNDER 521 | 522  
F.S. MONUMENT 528 | 527  
REMOVED IRON PIN 1982

RLS NO 15810

8" STEEL SIGN POST N26E 45.76' WITH SIGN

" " " " N30W 51.97' " "

" " " " S41W 44.76' " "

" " " " S27E 48.30' " "

COUNTY WITNESS COR. MONUMENTS

2 X 2 X 30 STEEL TUBE WITH CAP MKD.

S41W 44.44' 9" ABOVE GROUND  
S27E 47.90'

4-6-84 CK

9-30-02 R. MAIN

FD IRON @ SURFACE OF RD WITH PART OF CAP SHEARED OFF.  
POUND WITH SLEDGE HAMMER BACK TO 8" BELOW RJ  
SURFACE - ALL TIES ARE GOOD.



## QUARTER CORNER BETWEEN SEC'S. 22-27

NOTES OF ORIG. GOV'T SURVEY 1893

SET WOOD POST

W. PINE 8 N50E 5 LKS. 3.3'

W. PINE 10 N60W 23 LKS. 15.2'

4-9-84 GB-JA-DG

FROM BRASS CAPPED IRON PIPE AT SEC. COR TO SEC'S.

21-22-27-28 CHAINED ALONG C. OF TSP. ROAD EAST  
2654.5' ORIG. DISTANCE (30.22 CHS.) SEARCHED FOR  
EVIDENCE OF 1/4 COR. BUT NO EVIDENCE WERE FOUND  
AT THIS TIME - SET SPIKE IN ROAD AT DISTANCECONTINUE EAST 40.22 CHS. OR 2654.5' TO SEC. COR  
22-23-26-27 SEARCH AREA - BUT NO EVIDENCE WAS  
FOUND - SCATTERED CEDAR STUMPS THAT HAVE BEEN  
BURNED YEARS AGO AND MOST ARE WELL ROTTED  
PUT FLAG ON 9 BIRCH 530W-23.0'



Quarter ~~But~~ Corner Between Sec's. 21, 22

Notes of Original Gov't survey 1893

Set wood post

Tam. 6" N68W 16 lks. 10.6'

Fd. TAM. STUB 8" X 8" HIGH N68W 10.6' MKD 1/4 S 21 BT

Tam. 10" N11E 14 lks. 9.2'

Fd. TAM. STUMP N11E 9.2' WELL ROTTED

12/9/77 - Fd. squared cedar post scribed in  
placed and frozen in swp. Top of post  
is 30" long lying in ice. Point of  
post in place 18" long. Fd. both  
original BT's; Tam stub, 8" X 8" high,  
N68W at 10.6' mkd. 1/4 S BT

Tam stump, 12", N11E at 9.2'. Well decayed  
and log found laying on the ground.

Placed a F.S.I.P. on Cedar, 10", S87W at 7.5'

Set a tam post 3" X 5" at corner position.

Chained dist. <sup>no<sup>th</sup></sup> 2650' from Ew rd. ~~Contd. R. Kham~~

9/14/82 - To perpetuate this corner I set

2" X 5" galv. concrete filled iron pipe  
with brass cap mkd. T149N R30W

1/4

S21 | S22

1982

R.L.S. NO. 15810  
4-9-84 CK-6C.

Witnessed By:

1. Cedar 8", S30W at 37.50' MKD 1/4 S 21 BT
2. Cedar, 11", S73W at 43.55' MKD 1/4 S 21 BT
3. Cedar, 12", N69W at 41.90' MKD. 1/4 S 21 BT

Forest Service rd. is approx. 700' east of corner.  
Area to SE-E-NE was sheared last year.

Gary Brama



Section Corner To Sections 15, 16, 21, 22  
Notes of Original Gov't Survey 1893  
Set a WOOD POST

Fir 12" S65W 16 lks 10.6'

N. Pine 24" N25W 27 lks. 17.8'

Fd. N. Pine stp. at N25W at 17.8' scribe vis.

Spruce 12" N65E 19 lks. 12.5'

Aspen 10" S34E 52 lks. 34.3'

12/18/77 - C. Krause, N. Beer

Chained from  $\frac{1}{4}$  bet. sec. 21/22 north  
2645'. Fd. original corner 16' west of line.  
Fd. N. Pine stp. at N25W at 17.8'. Not able  
to search for the other BT's because of  
deep snow. Set a 3" squared cedar post  
5' high at corner location. Fd. a N-S  
fence line 20' east of corner. E-W  
fence line 20' south. No wire up.  
Fence posts are burned.

Curt & Lorraine

9/16/82 To perpetuate this corner I set  
a 2" x 60" galv. concrete filled iron  
pipe with B.C. mkd.

T149N R30W

S16 S15

S21 S22

1982

RLS NO. 15810

Witnessed By:

1. Ash Twin (No. stem) 9" S89W at 68.10' 4-9-84 ERGC
2. Cedar, 7" N19°W at 72.50' T149N R30W S21 BT
3. Cedar, 12" N9°E at 74.20' T149N R30W S15 BT
4. Cedar, 8" N49°E at 69.50' T149N R30W S15 BT
5. Balm of G.I. 9" S23°E at 31.65' T149N R30W S22 BT

Placed a 8" steel sign post west 4.0 with both signs  
Placed a 8" steel sign post south 4.0 " " "

Gary Brama



QUARTER CORNER BETWEEN SEC'S. 15-22

NOTES OF ORIG. GOV'T. SURVEY 1893

SET WOOD POST

BIRCH 12 N89W 13 LKS. 8.6'

TAM. 12 S40E 23 LKS. 15.2'



Quarter CORNER Bct. Sec. 32, 33

NOTES OF ORIG GOV'T SURVEY 1893

Set a WOOD POST

TAM 8 N10E 34 lks. 22.44

Rot. Windfall N10E 22.44 Fd. pieces of scribe

TAM 8 N30W 28 lks. 18.48

Well rot. windfall N30W 18.48 Fd. top part B

H. Hoard found both original BT's and a tam.

post 4x4x48. Placed a F.S. Poster on a  
tam. S35°E at 18 lks. 12/5/39

9/21/82. Fd. tam post 2"x3"x36" set 1.5' above the  
mass. (set by Hoard) Fd. another 2"x2"x48" post  
laying under the mass. (This tam post is in two pieces).

Both posts are within one foot of the true orig. position

Fd. Hoards location poster on a tam. windfall.

Set 2"x2"x8" TAM POST AT TRUE CORNER

LOCATION - PLACE FSLP ON 4" BLK. SPRUCE

S65E 12.5' AND ANOTHER FSLP ON 4" BLK.

SPRUCE N48E 7.8' 9-21-82 CK-GB

CHAINED SOUTH FROM SEC. COR. 28-29-32-33

SWP. CALL AT 10 CHS. 660' SOUTH FIT WITHIN 10'

DISTANCE CHAINED 2640' FELL 48' E OF 1/4 COR.

TOTAL DISTANCE VERY GOOD

# CERTIFICATE FILED

4-10-84 CK-GB

SET 2"x5' F5 IRON PIPE WITH BRASS CAP MKD.

BOTH OLD POSTS ARE SET  
BESIDE IRON PIPE

DRIVE 8" STEEL POST BESIDE  
MONU. AND WIRE BOTH TOGETHER  
CAP IS 8" HIGH

T199N R.30W

1/4

S32°S33

1984

RLS NO 15810

TAM. 5 N15E 36.11 MKD 1/4 S33 BT

TAM. 7 S82E 41.36 " 1/4 S33 BT

TAM. 5 S47W 25.38 " 1/4 S32 BT

8" STEEL SIGN POST SET 2.2' EAST WITH SIGN



## SECTION CORNER TO SECTIONS 28-29-32-33

NOTES OF ORIG. GOVT. SURVEY 1893

SET WOOD POST

SPRUCE 10 S22W 6 LKS. 4.0'

1908 SURVEY FOUND THIS TREE

SPRUCE 14 N66W 26 LKS. 17.2'

1908 SURVEY FOUND GRUBBED OUT

W. PINE 13 S74E 40 LKS. 26.4'

1908 SURVEY FOUND THIS TREE

SPRUCE 8 N42E 37 LKS. 24.4'

1908 SURVEY FOUND THIS TREE

NOTES BY BELTRAMI COUNTY ROAD SURVEY 1908

FOUND ORIG. BT'S. TO SECTIONS 28-32+33 AND

BT TO SECTION 29 GRUBBED OUT

SET W. PINE POST IN STONE MOUND

MKD BT'S.

W. PINE 16 N32E 48 $\frac{1}{2}$  LKS.W. PINE 12 S54W 31 $\frac{3}{4}$  LKS.

NO EVIDENCE OF ABOVE BT'S. REMAIN

4-10-84

NO EVIDENCE OF POST OR BT'S. ABOVE - DUG  
IN ROAD AROUND WELL POINT - NO EVIDENCE OF  
ROCK MOUND - BUT UNDERLYING AREA OF CORNER  
IS SOLID GRAVEL DOWN 3' AND MORE - HIT  
FROST AT 36" CK

## CERTIFICATE FILED

4-10-84 CK-GB-JA+GC-DG  
LOCATED 1 $\frac{1}{4}$ " X 28" WELL POINT 2" BELOW ROAD  
INTERSECTION - FENCE LINE SOUTH - CEDAR 6" POST  
WITH OLD FSLP STATED CORNER TO BE N. 31 LKS. 20.5'

CORNER SET BY LAND FEATURES NAMELY  
E+W COUNTY ROAD # 28 AND E. OF ROAD # 311  
TO NORTH - AND OLD FENCE LINE SOUTH.  
TALKED TO LAND OWNER TO SE OF CORNER - HE SAID  
THE ROADS HAVE BEEN THE SAME FOR 75 YEARS  
AND FENCE LINE NEARLY 70 YRS. Corner checked out  
within 6' of recorded distance 1 mile to the west.

SET 2" DIA. X 24" LONG IRON PIPE WITH BRASS CAP

PLACE WELL POINT AT SOUTH  
EDGE OF FS MONUMENT  
12" BELOW ROAD SURFACE

<sup>MKD</sup>  
T149NR30W  
5291528  
532533  
1984  
RLS NO 15810

WITNESSED BY

W. OAK 10" S9W 59.00'  
P. POLE 11 S30E 38.47'

4 X 4 X 8 CEDAR POST SOUTH 21.85' <sup>54-9</sup> ~~BOTH~~ SIGN

FENCE COR. POST IS 23' SOUTH (DOWN) WIRE S+E



QUARTER CORNER BETWEEN SEC'S, 28-33

NOTES OF ORIG. GOVT. SURVEY 1893

SET WOOD POST

S N. PINE 18 S34E 16 LKS, 10.6'

S W. PINE 12 N22W 12 LKS, 7.9'

V

S

T



QUARTER CORNER BETWEEN SEC'S, 28-29

NOTES OF ORIG. GOVT. SURVEY 1893

SET WOOD POST

TAM. 9 S89W 27 LKS. 17.8'

BIRCH 18 S48E 22 LKS. 14.5'

NOTES OF BELTRAMI COUNTY ROAD SURVEY 1908

FOUND S.E. BT GRUBBED OUT & SW BT CUT

THESE CHECKED WITH FIELD NOTES

SET MAPLE POST IN STONE MOUND

MKD NEW BTS.

ELM 9 S45E 59 1/4 LKS.

BIRCH 24 N35W 67 LKS.



## SECTION CORNER TO SECTIONS 20-21-28-29

NOTES OF ORIG. CO. SURVEY 1893

SET WOOD POST

BIRCH 12 S56E 24 LKS. 15.8'

SPRUCE 14 N56W 53 LKS. 35.0'

SPRUCE 10 N32E 10 LKS. 6.6'

SPRUCE 10 S79W 36 LKS. 23.8'

## BELTRAMI COUNTY ROAD SURVEY 1908

Ed. ORIG. CO. POST & BT'S. EXCEPT BIRCH  
 WAS 30 LKS. INSTEAD OF 24 LKS.

SET CEDAR STAKE IN STONE MOUND

MKD BT'S.

BALM-GIVEN 14 S24W 89 LKS. 58.7'

" " 16 N43W 68 1/4 LKS. 45.1'

6-10-81 CK-66-RM DUG WITH BACKHOE  
 FOUND 4"X4"X24" CEDAR POST POINT IN PLACE

VERY LARGE ROCK ON WEST SIDE OF POST-ALMOST

FLUSH WITH ROAD SURFACE - WAS PLACED TO

PROTECT WOOD POST YEARS AGO - PLACE 1"X16" IRON

PIN AT TRUE COR. POSITION UNTIL WE MONUMENT

COR. - IN 1/4 OF COUNTY ROAD W+5 AND TOWNSHIP

ROAD E - FENCE LINE NORTH TEMP TIES

TELE. PED. POST SW 61.7'-3" FENCE POST FROM COR. NE 47.85'

SET 2"X24" IRON PIPE WITH BRASS CAP MKD.

IRON IS SET 10" BELOW ROAD T749N R30W

PLACE ORIG. CED POST POINT

AT SOUTH SIDE OF MONUMENT S20 S21

PLACE ROCK AROUND MONUMENTS

BELOW ROAD - REMOVED STEEL PINS S29 S28

10-15-82 GB

1982

RLS NO 15810 1984 CK

SET 8' STEEL POST N34W 47.30' WITH SIGN

" " " " N39E 46.90' " "

" " " " S55E 46.35' " "

" " " " S46W 63.23' " "

DROVE COUNTY WITNESS MONUMENTS AT

2"X2"X30" WITH CAP MKD. WITH BEARING &amp; DISTANCE

S46W 62.80', BOTH ARE 4" ABOVE GROUND  
 S55E 45.77'

8' STEEL SIGN POST IN BACK OF BOTH WIT. MONUM'S.

7-6-84



QUARTER CORNER BETWEEN SEC'S. 21-28  
 NOTES OF ORIG. GOVT. SURVEY 1893  
 SET WOOD POST

ELM 12 N52E 3 LKS. 2.0'

BALSAM 6 S31E 19 LKS. 12.5'

NOTES BY BELTRAMI COUNTY ROAD SURVEY 1908  
 FOUND BALSAM BT MARKED OK FROM WHICH  
 WE LOCATE CORNER - FOUND ELM BT GRUBBED  
 OUT

SET NEW ELM POST

MKD BT'S.

ELM 6 S4W 50<sup>1</sup>/<sub>2</sub> LKS.

ELM 8 N55<sup>1</sup>/<sub>2</sub>E 58<sup>1</sup>/<sub>4</sub> LKS.

CERTIFICATE FILED

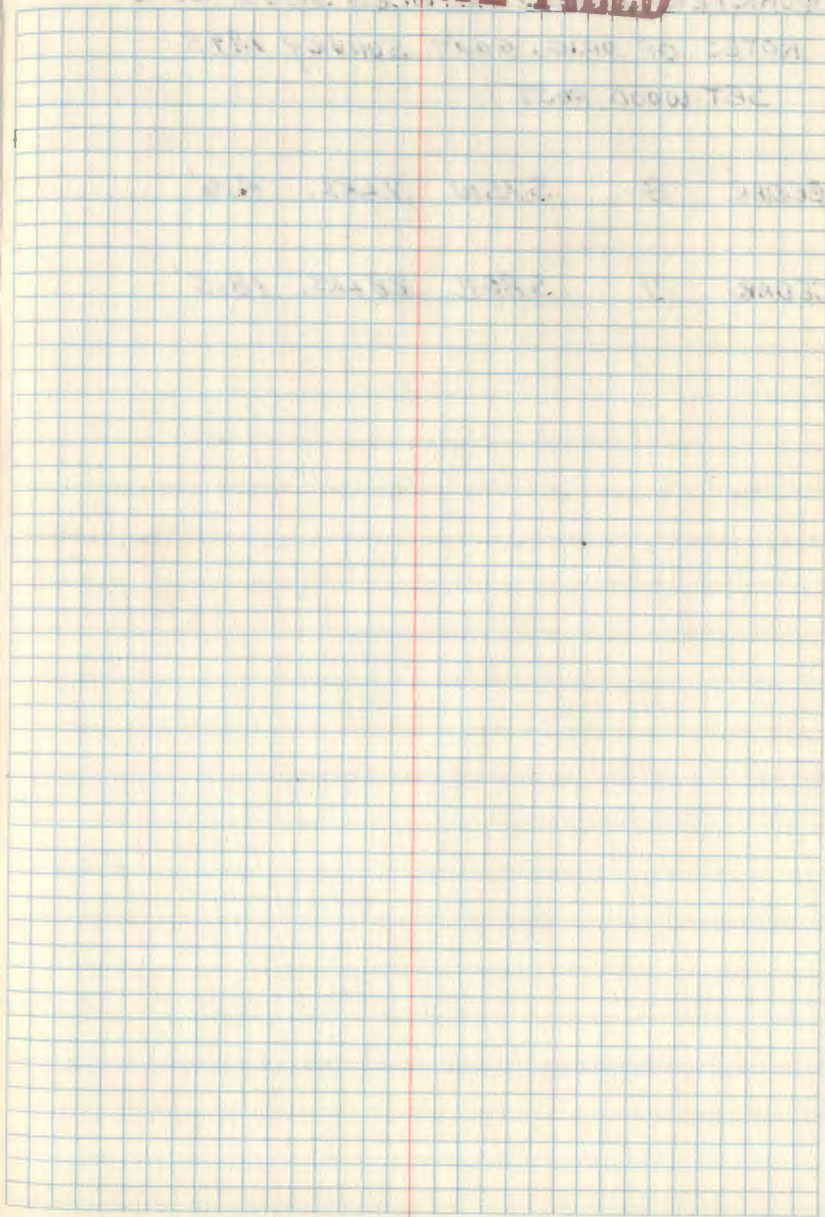



QUARTER CORNER BETWEEN SEC'S, 20-21  
NOTES OF ORIG. GOVT. SURVEY 1893  
SET WOOD POST

CEDAR 8 S75W 74KS. 4.6'

CEDAR 7 S86E 284KS. 18.5'

CERTIFICATE FILED



SECTION CORNER TO SECTIONS 16-17-20-21

NOTES OF ORIG. GOVT. SURVEY 1813

SET WOOD POST

BIRCH 14 N40W 14 LKS. 9.2'

SPRUCE 6 N8E 27 LKS. 17.8'

MAPLE 8 S75W 17 LKS. 11.2'

MAPLE 4 S38E 23 LKS. 15.2'

# CERTIFICATE FILED

CHAINED EAST FROM APPROX.  $\frac{1}{4}$  COR. LOCATION 26  
ALONG TOWNSHIP ROAD TO APPROX. SEC. COR. POSITION  
FELL 8' WEST OF FENCE BRG. NORTH AND CLEARING  
LINE SOUTH - E.S. PLANTATION TO EAST OF LINE SOUTH







QUARTER CORNER BETWEEN SEC'S. 31-32

NOTES OF ORIG. GOV'T. SURVEY 1893

SET WOOD POST

BIRCH 7 N45W 14 LKS. 9.2'

J. PINE 12 S88E 20 LKS. 13.2'

CERTIFICATE FILED



SECTION CORNER TO SECTIONS 29-30-31-32

NOTES OF ORIG GOV'T SURVEY OF 1893

SET WOOD POST - C.G. SPENCER FOUND

ORIG. POST &amp; BEARING TREES

BIRCH 14 S46W 34 LKS. 22.4'

1913 SPENCER FOUND THIS BT

ELM 7 N14E 29 LKS. 19.1'

1913 SPENCER FOUND THIS BT

ASH 7 N39W 19 LKS. 12.5'

ASPEN 4 S47E 63 LKS. 41.6'

BELTRAMI COUNTY 1908 FD. BT OK SET NEW

ELM POST 5" X 5" X 2 1/2'

BELTRAMI COUNTY 1921 SEC. 30 SUBDIVISION

FD. 1 GOV'T. BT OK - SET 1" X 20" IRON PIPE

WITNESSED BY ASPEN 8 S44E 40.3' AND

ELM 7 S35W 60.8'

FD. 1" IRON PIPE MARKING CORNER 6" BELOW

ROAD - NO BT'S. FOUND - FD. REMAINS OF OLD

POST BESIDE IRON - EST. TEMP TIES

BASSWOOD 12 N88E 74.3' - POWER POLE 10

N45W 41.25' - BASSWOOD 9 S44W 92.2'

TEL. POLE 10 S36E 35.95' AT INTERSECTION

OF ROADS E-W-S FENCE LINE BRS NORTH

10-1-74 CK

## CERTIFICATE FILED

10-15-82

FD. IRON IN PLACE CHECKED FROM TIES (OK)

SET STD. F.S. MONU. 2" X 24" I.P. WITH CAP MKD.

MONU. IS 10" BELOW ROAD  
PLACE IRON CO. AT N. EDGE OF  
FS MONU. AND WOOD POST AT  
EAST SIDE

NO BT'S. MKD TODAY

GARY BRAMA

8" STEEL SIGN POST AT S35E 36.16 WITH SIGN

" " " " " N38E 37.60 " "

" " " " " N35W 35.95 " "

" " " " " S42W 55.58 " "

7-28-83

SET BELTRAMI COUNTY WITNESS MONUMENTS

2" X 2" X 30" IRON TUBE WITH CAP MKD.

N38E 37.18' 4" ABOVE GROUND - IN FENCE LINE

N35W 35.50'  
DOCUMENT # 284403



QUARTER CORNER BET. SEC'S. 29-32  
 NOTES OF ORIG. GOV'T. SURVEY 1893  
 SET WOOD POST

BALM-GILEAD 8 S54E 9 LKS. 5.9'

ELM 8 N58W 11 LKS. 7.3'

1908 BELTRAMI COUNTY ROAD SURVEY  
 FOUND GOV'T BTS. OK AND ORIG. POST  
 SET MAPLE STAKE IN STONE MOUND  
 MKD BTS.

LIND 9 NORTH 41 LKS.  
<sup>OMP</sup>  
 BIRCH 9 S29W 31<sup>3</sup>/<sub>4</sub> LKS.

1908 40.05 CHS E4W







## SECTION CORNER TO SECTIONS 19-20-29-30

NOTES OF ORIG. GOV'T. SURVEY 1893

SET WOOD POST

ASPEN 13 N67W 6 LKS. 4.0'

W. OAK 13 S61E 40 LKS. 26.4'

MAPLE 8 N77E 19 LKS. 12.5'

BIRCH 14 S19W 43 LKS. 28.4'

BELTRAMI COUNTY ROAD SURVEY 1908

FOUND GOV'T. POST &amp; BT'S. OK

SET ELM POST 5"X5"X 2 1/2' & IRON HARROW  
TOOTH IN STONE MOUND

MKD NEW BT'S.

W. OAK 14 N22 1/2 W 57 1/4 LKS.

W. OAK 16 S27E 50 LKS.

BELTRAMI COUNTY SECTION SUBDIVISION SEC. 30

1921 - Fd. 2 BT'S. BY BLIVER ON ROAD SURVEY

POST IN STONE MOUND

W. OAK N22 1/2 W 37.7' SAME AS ABOVE

W. OAK S27E 33.0'

SET GAS PIPE 1"X24"

FOUND 1"X14" IRON PIPE TOP OF PIPE WAS PRESSED  
TOGETHER SET INSIDE A MOUND OF STONE  
ALL FLUSH WITH GROUND - COUNTY ROAD & N 1/4 E  
AND OLD TOWNSHIP ROAD WEST - FENCE LINE S  
MKD TEMP TIES

W. OAK &amp; NW 44.0' NAIL ON SIDE

W. OAK &amp; SW 58.10' " " "

6-10-81 CK-68-RM

FOUND BELTRAMI COUNTY CAST IRON MONUMENT  
AT SEC. COR. 6" BELOW ROAD - PLACE LARGE  
ROCK AROUND TOP OF MONUMENT - FLUSH WITH  
GROUND  
COUNTY BT'S. FOUND 7-8-83 CK-68-JA

OAK N E

OAK N W

OAK S W

BASSWOOD S E

8' SIGN POST SOUTH 18.9' WITH SIGN



44  
QUARTER CORNER BET. SEC'S. 20-29  
NOTES OF ORIG. GOVT. SURVEY 1893  
SET WOOD POST

BIRCH 9 N35W 15 LKS. 9.9'

W. PINE 7 S87W 29 LKS. 19.1'

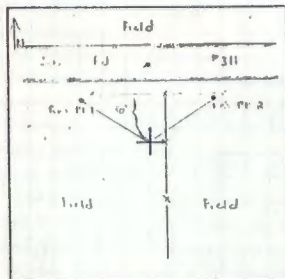

Monument Marked:



OTHER EVIDENCE AND RESTORATION INFORMATION

9-9-85 B. Dahlin, D. Graber FR 850012 Found nothing  
information was used from a correction survey done by  
R.K. Bliler in 1908 by which he set the Sk of section  
20. Bliler had set it on the road, but later found the  
F. 1/16 and projected a line from the NE corner through  
the 1/16th corner for the new position. The Beltrami  
County Remonumentation Crew reconstructed his distances  
and set the corner at its present location.

Ref Ties Found: none

-A nail still remains in the E of Co. Rd. #311 at which  
the mon. is approximately 80' to the South

PERPETUATION RECORD

9-9-85  
Monument and associated evidence Set 20" Cast Iron Monument 4' West  
of North-South Fence. Monument is 8" below road surface  
and 280 feet from the E of the road

Ref Ties Set:

4"x36" conc. mon. Ref. Pt. 1 N46°W 76.65 ft. flush  
5"x36" conc. mon. Ref. Pt. 2 N51°E 72.28 ft. flush  
Both concrete monuments have bearings and distance to  
the monumented corner on top.

Checked prepared by \_\_\_\_\_ Date Filed \_\_\_\_\_



QUARTER CORNER BET. SEC'S, 19-20  
 NOTES OF ORIG. GOV'T. SURVEY 1893  
 SET. WOOD POST

ASPEN 7 N54W 98 LKS. 64.7'

ELM 7 S17E 48 LKS. 31.7'

NOTES OF BELTRAMI COUNTY ROAD SURVEY 1908  
 FOUND ELM BT GRUBBED OUT & DOUBLE POPLAR  
 ONE MARKED OK - ONE WAS GUT OFF  
 SET NEW ELM POST IN STONE MOUND  
 MKD BT'S.

POPLAR 9 N55W 97 LKS.

ELM 6 S63½E 64 LKS.

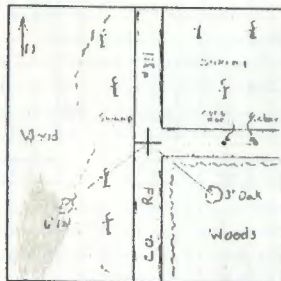

Monument Marked:



OTHER EVIDENCE AND RESTORATION INFORMATION

9-9-85 B. Dahlin, D. Graber FB 850011 Found nothing. Corner was set in an obliterated position of the  $\frac{1}{4}$  of the North-South road and the East road  $\frac{1}{4}$ . The measurements made of this mile from the Northwest to Southwest of section 20 were within 1 foot of the recorded distance in 1908 by R.K. Bliler.  
 Ref. Ties Found: None.

PERPETUATION RECORD

Monument and accessories established Set 20" C.I.M. in the  $\frac{1}{4}$  of both roads. Monument is 4" below the road surface  
 Ref. Ties Set: Vert & Stone dist. Horiz. Dist.  
 4"x36" conc. mon. 90°59'30" 90.775' 90.76' down 3"  
 Rebar 3/8"x10" 89°54'05" 180.585' 180.58' down 4"  
 W. Oak 3" S72°E 86.86' spike & disc, CLT  
 Ash 6" S62°W 64.21' blazed, scribed, CLT & ptd orange

Coefficient prepared: Yes \_\_\_\_\_ No \_\_\_\_\_ Date filed \_\_\_\_\_



Section Corner to Sections 17, 18, 19, 20

Notes of Original Gov't Survey 1893

Set a WOOD POST

Cedar 7" S19°E 91ks. 5.94'

Cedar 8" N33W 101ks. 6.60'

White Pine 30" N54E 311ks. 20.46

Balsam 9" S26°W 101ks. 6.60

NOTES BY BELTRAMI COUNTY ROAD SURVEY 1908

LOCATE CORNER FROM NE PINE BT

OTHERS HAVE BEEN GROBBED OUT

SET CEDAR POST IN STONE MOUND

LOCATE 3/4" X 1/4" REROD IN 1/4 OF CO. ROAD #311

AND TOWNSHIP ROAD 1/2'S E & W

THERE A GEMETRY SURVEY FROM THIS SEC. COR.

WHICH WAS CHECK WITH IRON'S FOUND AT NE

SE & SW COR'S. FOUND IN PLACE & MEASURMENTS

CHECK VERY CLOSE WITH PLAT

BELIEVE ROD IS AT TRUE LOCATION - THERE IS

NO OTHER EVIDENCE REMAINING OF BT'S OR

OTHER TIES. MKD. TEMP TIES

COCKING MAIL BOX POST NE 42.5' NAIL ON SIDE

POWER POLE SE 48.6' NAIL ON SIDE

6-10-81 CK-GB

SET 2" X 24" GALVANIZED IRON PIPE WITH BRASS CAP  
MARKED

PLACE MAG. PELLET IN BOTTOM  
OF HOLE AND PLACE REROD  
INSIDE 2" IRON - WEDGE CLAY  
INSIDE PIPE TO KEEP REROD  
IN PLACE

10-15-82

GB

T149N R30W

S18 | S17

S19 | S20

1982

RLS NO 15810

8' SIGN POST N45W 97.25' WITH SIGN

" " " N62E 63.28' " "

" " " S53E 57.60' " "

" " " S W 34.10' " "

NE CORNER OF TOWNHALL STANDS S41W 68.95'  
FROM SEC. COR.

7-28-83 CK-GB-JA



QUARTER CORNER BET. SEC'S. 17-20  
 NOTES OF ORIG. GOV'T. SURVEY 1893  
 SET WOOD POST

CEDAR 13 S1E 34 LKS. 22.4'

CEDAR 12 N14E 12 LKS. 7.9'

# CERTIFICATE FILED

CHAINED EAST FROM SEC. COR. 2638' ALONG CENTER LINE  
 OF TOWNSHIP ROAD TO APPROX. 1/4 COR. LOCATION  
 FOUND FENCE LINE ERS. NORTHERLY FROM END OF CHAINING  
 AND CLEARING LINE SOUTH WITH POSTS & WIRE DOWN  
 NO EVIDENCE OF ANY RT'S. WERE FOUND  
 MAY DIG WITH BACKHOE AFTER FROST GOES OUT

4-4-84 CK-66-WA

9-17-84 BELT COUNTY SURVEYOR & CREW  
 FOUND 5"X12" LONG POINT OF WOOD POST - IN STONE MOUND  
 12" BELOW ROAD SURFACE - WOOD POST POINT WAS  
 REMOVED AND IN IT'S PLACE SET COUNTY CAST IRON  
 MONUMENT 4" DIA X 20" LONG CAP MARKED

MONUMENT IS 14" BELOW  
 ROAD SURFACE

T149 N R30W

1/4  $\frac{517}{520}$

1984

RLS NO 15810

MARKED NEW BTR.

BALSAM	13	S34W	53.60'	} BLAZED, SCRIBED SPIKE-DISC - PAINTED
BALSAM	8	N49W	78.52'	
ELM	14	N23W	73.60'	

CORNER IS 2' SOUTH OF CENTERLINE OF TSP. ROAD E+W  
 FENCE LINE NORTH - OPEN PASTURE TO NE



QUARTER CORNER BET. SEC'S. 30 & 31  
 NOTES OF ORIG. GOVT. SURVEY OF 1893  
 SET WOOD POST

SPRUCE 12 N33W 35 LKS. 23.1'

SPRUCE 12 S45W 48 LKS. 31.7'

BELTRAMI COUNTY SEC. 30 SUBDIVISION  
 OF 1921

Fd. ORIG. SPRUCE S45W 31.6'

SET MONU. AT TRUE CORNER

WITNESSED BY

SPRUCE 14 N2W 76.2'

Fd. LARGE ROTTED STUMP AT NORTH 76.2'

SPRUCE 10 S42E 54.0'

NO EVIDENCE FOUND AT BEG. AND DISTANCE  
 CHAINED WEST FROM SEC. COR. 2643' TO 1/4  
 CORNER LOCATION Fd. LARGE SPRUCE STP. NORTH  
 76.2' WELL ROTTED ON SOUTH SIDE - NO SCRIBE  
 VISIBLE - NO IRON FOUND AT THIS TIME - SHOULD  
 DIG IN ROAD AT LOCATION FOR POSSIBLE WOOD  
 POST - PUT FSLP ON 5" ELM 39.8' SOUTH OF  
 CORNER - TEMP TIES ELM IS S34E 62.9'  
 BALM-GILEAD 9 S17W 52.1' 10-1-74 CK

4/25/86 CK 6/8 JA

Fd: splk in road tied out from Co. 5 NW  
 bearing tree and OK by Belt. Co Surveyors  
 Office Traverse.

SET:

2 1/2" x 2" Brass Capped Iron Pipe marked  
 down 10" in North side of road T149N R30W

BTS:

Ash 8" S57E 103.85'

Ash 7" S18E 57.55'

TAMMUCK 14" N60E 135.15'

Steel sign post 3" x 8" South 33.0' AT & Bdry signs

CORNER FALL 4' NORTH OF 1/4 of Co Rd # 28

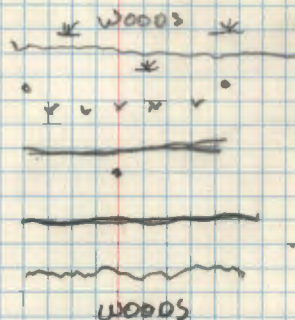



QUARTER CORNER BET. SEC'S. 19-30  
NOTES OF ORIG. GOV'T. SURVEY 1893  
SET WOOD POST

SPRUCE 5 N9W 16 LKS. 10.7'

SPRUCE 7 S9E 6 LKS. 4.0'



QUARTER CORNER BET. SEC'S. 18-19  
NOTES OF ORIG. GOV'T. SURVEY 1893

GEDAR 6 N14E 9 LKS.

BIRCH 9 S33E 25 LKS.







Std. Section Corner to Sections 34, 35

Notes of Orig. Gov't Survey 1871

Set a wood post

Fir 5" N14E 1671ks. 110.2'

Cedar 6" NBW 1271ks. 83.8'

Beltrami Co. Survey 1914 (Summit Road Survey)

Found stake & 2 BT's

Fir N14E at 110.2'

Cedar NBW at 83.8'

Found two other BT's mkd.

TAM N14W 15.6'

TAM. N42E 11.5'

Mkd new BT's:

1. Cedar 4" N50E at 39.0'

2. TAM 3" N37W 65.6'

9/28/82 - Krause & Brama

Chained co. 1914 dist from closing corner of sec. 3/4. Dug with back hoe at this location. Fd. no remains of post or BT's. Culvert falls closed to corner position.



Std. Quarter ~~25~~<sup>To</sup> Sections 35

Notes of Original Gov't Notes 1871

Fir 5" N22E 18 lks. 11.88'

Birch 9" N25W 37 lks. 24.42'

Wood Post Set

Belt Co. Summit Road Survey (1914)

Fd. old post of 1 BT

Birch N25W at 24.4

Set a Ash post 3"x3"x24"

Mkd. Balsam 8" S10W 44.7'

Balsam 7" S48E 47.6'

9/27/82 - Krause & Brama

Chained co. distance. Dug with back hoe. Found no evidence of corner position.



STANDARD QUARTER CORNER TO SECTION 34

NOTES OF ORIG. GOV'T. SURVEY 1871

SET WOOD POST

SPRUCE 11 N45E 24 LKS. 15.8'

SPRUCE 10 N40W 44 LKS. 29.0'

SURVEY OF COUNTY ROAD SURVEY MAY 1914

BY C.B. SPENCER SURVEYOR (BELT. CO.)

FOUND STAKE AND BOTH BT'S.

BASSWOOD N25E 11.3'

BASSWOOD N13W 22.2'

SET NEW ELM POST 3x3x2

MKD NEW BT'S.

SPRUCE 8 S42W 48.6'

ELM 6 S26E 32.3'

## CERTIFICATE FILED

CHAINED EAST FROM CLOSING CORNER, BET SECT. 344  
AS PER DISTANCE, BY BELTFRAM COUNTY ROAD SURVEY  
2661 - 271' CC = FROM CC TO 1/4 2390'  
NO MONUMENT IN ROAD - APPEARS TO HAVE BEEN  
BLADED OUT - FD. ELM BT BY COUNTY SE OF OUR  
END CHAINING - SCRIBE HAS ROTTED OUT - NO TRACE  
OF SPRUCE TO SW

9-27-82 CK-GB

1-22-92 CK-GB-TA

FD. DEAD ELM SNAG WITH BT TAG PLACED ON SAME IN  
1982 - TAKE BEARING AND PULLED DISTANCE FROM BT  
AND FOUND - EITHER REROD OR SPIKE FROZEN IN ROAD  
2" BELOW SURFACE AT TRUE POSITION FROM ELM BT  
COUNTY DISTANCE FROM C.C. 344 EAST TO STD 1/4 COR.  
CHECKED WITHIN .10' OF COUNTY DISTANCE

6-22-05 Romain

GPS IRON CAP SHEARED OFF BY GRADER. I LOWER  
IRON TO 6" BELOW RD SURFACE/W/MAUL.



STANDARD SECTION CORNER TO SECTIONS 33-34

NOTES OF ORIG. GOV'T. SURVEY 1871

SET WOOD POST

ASPEN 12 N12E 33 LKS.

ASPEN 11 N45W 9 LKS.

9-28-82 CK-6B

CHAINED 266.8' WEST FROM CLOSING COR. BET. 3+4

DISTANCE FALLS IN OPEN HAY FIELD

FD. 6" CCC POST WITH FSLP LYING ON GROUND

NORTH OF CORNER LOCATION - HAD BEEN PULLED

UP AND WAS LYING NEXT TO ROAD

CCC NOTES BY JOHN A. GJELHAUG 12-5-39

PLACED 6" CEDAR POST (IN ORIG. PLACE OF CORNER

WITH FSLP ON SOUTH SIDE OF POST

RE-ESTABLISHED FROM COUNTY NOTES IN ORIG. PLACE

FROM COUNTY BT'S. AND CORNER <sup>271.3'</sup> 4.11 CHS. TO EAST

# CERTIFICATE FILED

6-22-05 R. MAIN

MONUMENT 4" BELOW SURFACE OF HAY FIELD. I  
RESET IRON TO 1 FT BELOW AND GPS. LAND  
OWNER PULLED SIGN POSTS FROM FIELD TO CUT  
HAY. NO BT'S NEAR.



## STANDARD QUARTER CORNER TO SECTION 33

NOTES OF ORIG. GOV'T. SURVEY 1871

SET WOOD POST

W. PINE 5 N86E 35 LKS.

1914 FOUND W. PINE DOWN PLAINLY MKD.

SPRUCE 9 N54W 11 LKS.

1914 FOUND SPRUCE STUMP PLAINLY MKD

NOTES OF COUNTY ROAD SURVEY 1914

FOUND BOTH GOV'T. BT'S.

SET NEW CEDAR POST 4x4x3

MKD NEW BT'S.

BALM-GILEAD 8 N38W 26.6'

SPRUCE 4 N2W 26.9'

11-9-39

NOTES IN OLD FIELD BOOK BY J. A. GJELHAUG

Fd. 10" BALMIE N35W 40 1/2 LKS. = 26.7'

Fd. 5" SPRUCE DOWN NZW 41 LKS. = 27.06'

PLACE ESLP ON 3" BALSAM N56E 18 1/2 LKS. = 12.1'

## CERTIFICATE FILED

COUNTY DISTANCE FROM NE COR. OF SEC. 4 WEST  
2935 - 288' = 2647' FROM STD. SEC. COR. 33-34  
TO 1/4 SOUTH SIDE SEC. 33

4-6-84 GB-1A

CHAINED 2640' RAN LINE AT TRUE WEST  
FELL 25' E OF APPROX. STATE TAG AND 15' SOUTH OF  
CLEARCUT TO NE - BLOWDOWN & PUSHOUTS  
AROUND AREA OF APPROX. COR. - LOGGING ROAD RUNS  
SOUTH OF COR.

1-22-92 GB-CK-TF

FROM TRAVERSE POINT - MEASURE DISTANCE AND BEARING  
TO SEARCH AREA - POSITION TO SEARCH IS 18' SOUTH  
OF DISTANCE PROJECTED FROM TRAVERSE POINT  
18' SOUTH FELL ABOUT 8" NORTH OF 8" BALSAM WITH  
STATE (DNR) TAG BY SAM CHRISTENSON 1979  
STATES CORNER IS N - 1 1/2 PAGES OR 8 1/2' TOLD TO  
US BY SAM ON 1-23-92 - HE FOUND GJELHAUGS TAG  
ON BALSAM TO NE - WE ESTABLISHED CORNER FROM  
OLD TAG + FROM BALSAM AT N56E - 12.1'  
DNR TAG IS 8.5' AT S&W FROM 1939 POSITION  
NO OTHER EVIDENCE FOUND AT THIS TIME  
BELIEVE POSITION CAN BE MONUMENTED BY LANDECKER.



## STANDARD SECTION CORNER TO SECTIONS 32-33

NOTES OF ORIG. GOV'T. SURVEY 1871

SET WOOD POST

TAM. 12 N24E 74 LKS. = 48.84'

TAM. 9 N24W 108 LKS. = 71.28'

## NOTES OF BELTRAMI COUNTY ROAD SURVEY 1914

FOUND STAKE (ORIG) AND BOTH GOV'T. B.T'S.

TAM — N24E 48.8'

TAM — N24W 71.2'

12-1-39

NOTES IN OLD FIELD BOOK BY J. A. GJELHAUG

Fd. DOWN TAM. 14 N12W 48 LKS. = 31.68

PLACE FSLP ON TAM 12" NORTH 73 LKS. = 48.18'

SET 4" x 4" x 48" CEDAR POST

COUNTY TIES TO SEC CORNER. LINE CHAINING

5600' CROSS CREEK

5613 SEC. COR. - 32-33

5650' CROSS CREEK

1-22-92 GB-CK USFS - TERRY FREEMAN - WITH  
LANDECKER + ASSOC. WALKER, MN.

Fd. GJELHAUGS TAG ON 12" X 15" HIGH TAM. SNAG  
 MEASURE DUE SOUTH 48.2' WHICH FALLS AT EDGE  
 OF CREEK OR IN CREEK - NOW WAS STANDING ON ICE  
 8" TO 10" THICK - ICE BROKE OFF TO EAST AND DROPPED  
 12" DOWN TO WATER - CHECK DISTANCE FROM C.C. 4+5  
 383.3' - ALSO Fd. TAM STUB 12" X 10" HIGH AT N28E - 48.2'  
 FROM POSITION ON ICE FROM TAM SNAG NORTH 48.2'  
 LANDECKER TIE THESE STUBS INTO TRAVERSE TODAY



STANDARD QUARTER CORNER TO SECTION 32

NOTES OF ORIG. GOV'T. SURVEY 1871

SET WOOD POST

BLK. PINE 6 N20E 10 LKS.

BLK. PINE 6 N70W 17 LKS.

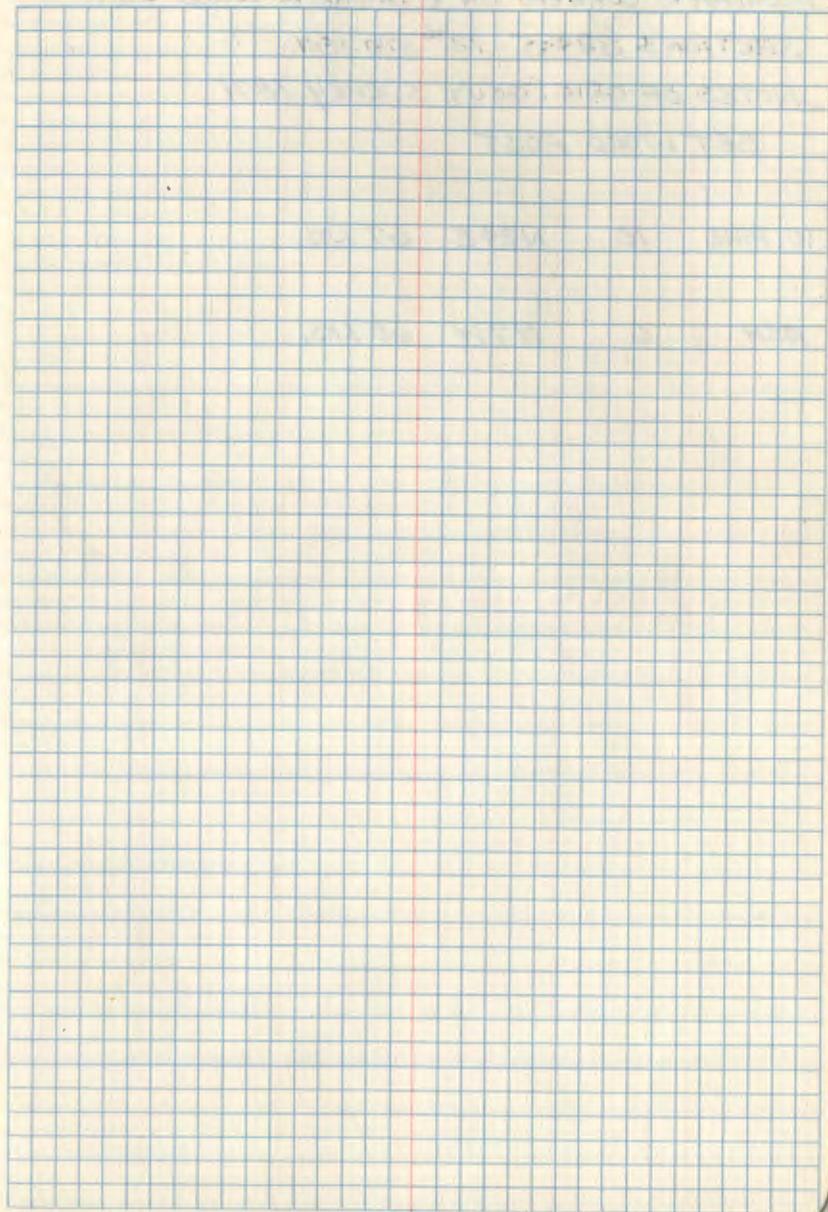



MEANDER CORNER ON E SHORE OF LAKE BET.

SECTIONS 32 & 5 12<sup>th</sup> STO. PAR.

NOTES OF ORIG. GOVT. SURVEY 1871

SET WOOD POST

W. PINE 10 N24E 67 LKS.

ASH 6 N7W 60 LKS.

384 5096



MEANDER CORNER ON W SHORE OF LAKE BET.  
SECTIONS 32 & 5 ON 12<sup>TH</sup> STD. PAR.

NOTES OF ORIG. GOV'T SURVEY 1871

SET WOOD POST

TAM. 9 N47W 34 LKS.

TAM. 7 N83W 26 LKS.

CERTIFICATE FILED



STANDARD QUARTER CORNER TO SECTION 31

NOTES OF ORIG. 600' T. SURVEY 1871

SET WOOD POST

SPRUCE 9 N37W 31 LKS.

TAM. 8 N55E 32 LKS.

62  
CERTIFICATE FILED



STANDARD QUARTER CORNER TO SECTION 36

NOTES OF ORIG. GOVT. SURVEY 1871

SET WOOD POST

BLK. PINE 10 S3E 21 LKS. 13.9'

BLK. PINE 11 N80W 59 LKS. 38.9'

NOTES OF COUNTY ROAD SURVEY MAY 1914

BY CC SPENCER - SURVEYOR

FOUND OLD STAKE AND ONE BT

BLK. PINE N80W 38.9'

SET NEW JACK PINE STAKE 3x3x2

MKD NEW BT'S.

DEAD BLK. PINE 10 S56W 57.0'

2  
DEAD BLK. PINE 10 S4E 45.0'

9-27-82 CK+GB

CHAINED COUNTY DISTANCE ALONG CENTER OF CO. RD.

SET SPIKE AT DISTANCE - DUG WITH BACKHOE IN AREA

NOTHING WAS FOUND - OLD CCC 6" CED. POST

WITH OLD FSLP STANDING AT NORTH SIDE OF ETW

ROAD - NOTHING COULD BE REESTABLISHED

OTHER THAN DISTANCE - 2649.9' FROM EAST

SOUTH LINE SEC. 36 - FROM 1914 CO. ROAD SURVEY  
W/2 2673.3' - E/2 - 2649.9'



TOWNSHIP CORNER BET. SEC'S. 31-36

NOTES OF 12<sup>th</sup> STANDARD PARALLEL RUN IN 1871

SET WOOD POST

BLK. PINE 11 N43W 56 LKS. 37.0'

BLK. PINE 12 N36E 52 LKS. 34.3'

NOTES BY GEORGE A. RALPH 1891 \*

FD. CORNER POST BADLY DECAYED LYING ON GROUND  
AND ABOVE BEARING TREES DESTROYED ENTIRELY BY  
FIRE WITH EXCEPTION OF BLK. PINE 11 N43W 56 LKS.  
RESTORED CORNER AS FOLLOWS

SET NEW POST AND MKD. NEW BT'S.

J. PINE 6 N21½E 37 LKS. 24.4'

J. PINE 10 S54½E 38 LKS. 25.1'

NOTES BY BELTRAMI COUNTY OF ROAD SURVEY BY  
C.C. SPENCER, MAY 1914 (ON FILE)

FOUND POST AND BOTH BOUY. BT'S

DISTANCE CHECKED OK BUT BEARING ARE WRONG

J. PINE N43E 36.9' &amp; J. PINE N36E 34.3'

MKD NEW BT'S. N. PINE 10 N41W 47.1'

N. PINE 11 N30E 48.2'

\* RECORDED IN BACK OF ORIG. FIELD NOTES BOOK  
T149N R29W PAGE 24 AT TOP OF LEFT HAND  
COLUMN



64 X-25

QUARTER CORNER BET. SEC'S. 31-36

NOTES OF ORIG. GOV'T. SURVEY 1891

SET WOOD POST

TAM. 14 S62W 18 LKS.

TAM. 12 N64½E 34 LKS.

64  
NOTES IN FIELD NOTES FOR T149N R29W

BACK 3 PAGES IN BOOK

22 CHS. ENT. SWP. - 40 CHS. ¼ COR. - 63.98 CHS. STREAM  
10' WIDE FLOWS SSE - 80 CHS. SEC. COR.



SECTION CORNER TO SEC'S, 25-30-31-36

NOTES OF ORIG. GOVT. SURVEY 1891

SET WOOD POST

SPRUCE 5 N30 $\frac{1}{2}$ E 14 LKS. 9.2'

SPRUCE 4 S62E 8 LKS. 5.3'

SPRUCE 5 S66 $\frac{1}{2}$ W 20 LKS. 13.2'SPRUCE 5 N64 $\frac{1}{2}$ W 19 LKS. 12.5'

NOTES BY JOHN A. GJELHAUG-CIVIL ENG. 5-19-39

FOUND WOOD POST 4' HIGH AND REMAINS OF 3 ORK. BT

SPR. STP. 8 N59W 17 LKS. 11.2' MKD BT

SPR. STP. 6 N52E 17 LKS. 11.2' MKD BT

SPR. STP. 12 S62E 12 LKS. 7.9 MKD BT

FSLP ON SPRUCE 8 N25W 4 LKS. FROM COR.

10/10/84-CK, GB, JA

Chained south 1° east from sec. cor. 25, 30, 31, 36  
5304'. Searched 2 hrs.

10/11/84-GB, JA

Chained from south quarter sec. 25 east 2640'. Intersected  
N-S and E-W lines. Searched 3 hrs. Placed a F.S.L.P.  
on 8" Birch as approx. corner. Approx. corner is  
350' west of N-S line and 130' south of E-W line.  
Stumps in this area have been cut off and are rotted.



66 T-25

QUARTER CORNER BET. SEC'S. 25-<sup>30</sup>

NOTES OF ORIG. GOVT. SURVEY 1891

SET WOOD POST

BIRCH 5 S7½E 19 LKS.

BIRCH 10 S55W 6 LKS.

NOTES BY JOHN A. GJELHAUG - ENG & SURVEYOR

618/39 CCC BOOK PAGE 25

SET ¼ COR. BY PROPORTIONATE DISTANCE

2651.8' N45

SET ASPEN POST 4" X 48"

MKD NEW B.T.S.

J. PINE 6 N42°30'W 8 LKS. 5.3' FSLP

J. PINE 6 N59°15'E 22 LKS. 14.5'

NOTES IN FIELD NOTES FOR T149N R29W

66

BACK 3 PAGES

10 CHS. LV. SWP. - 40 CHS. ¼ COR. - 80 CHS. SEC. COR.

10/9/84 - CK - GB

Chained south, east 2652' from sec. cor. Search area for corner. Corner falls in sheared area.

10/11/84 - GB, JA

Chained 175' west from random line and searched area for corner. Fd. rotted J. Pine stps. but no evidence of corner. Placed a F.S. L.P. on 3" Aspen S55°W 10' to approx. ¼ corner. Approx. corner falls on the edge of sheared area planted in R. Pine. (East) Aspen regeneration west. Definite N-S boundary present.

10-16-84

RECHAIN AND RUN LINE (CK) AT 53 W MY COMPASS AND FOLLOW ALONG CLEARING N-S FROM 2100'S TO APPROX. ¼ COR. - GRAD WERE CONTINUE CHAINING SOUTH TO LIVE BROUGHT UP FROM APPROX. SEC. COR. ON 10-11-84 T. 900' N 1748' FROM APPROX. ¼



SECTION CORNER TO SEC'S, 19-24-25-30

NOTES OF ORIG. GOVT. SURVEY 1891

SET WOOD POST.

BIRCH 14 N39 $\frac{1}{2}$ E 70 LKS.

W. PINE 14 S51E 2 LKS.

BIRCH 14 S52W 46 LKS.

BIRCH 14 N82W 32 LKS.

10/4/84 - CK, GB, JA

Fd. Gjshaug's rock ring with hole in center.

Fd. rotted birch stp. west 11.2 from corner. This tree had the F.S.L.P.

Fd. remains of 1 Aspen BT mkd. by J.A.G.

Rotted Aspen Stp. 567°W 21.8'

Mkd. New BT's:

Spruce 5" S43E 13.2 Upper blaze

Spruce 7" N30E 24.8 Upper blaze

Spruce 6" N62W 26.2 " "

Placed a F.S.L.P. on a 9" W. Spruce SSE 17.85'

All trees have spike &amp; tag

Found no evidence of original corner or BT's.

Corner falls in a planted Spruce plantation.

## CERTIFICATE FILED

Chained from  $\frac{1}{4}$  bot. sec. 24/25 2690' east.  
 Fd. corner at 2689' and 10' north of line.  
 Chained north from corner 200' to center of trail (E-W)  
 Placed a F.S.L.P. on a 11" W. Spruce N3°W 187' ON  
 SOUTH SIDE OF E-W TRAIL - OLD CCC POST & TAG LYING  
 ON GROUND NEAR THIS TREE STATES SEC. COR. IS SOUTH 188'

NOTES BY JOHN H. GJELHAUG 6-8-39 C.E. & RLS  
 CCC FIELD BOOK

SET ASPEN POST 4" X 48" IN ROCK RING  
 MKD. BT'S.

ASPEN 4 561 W 33 LKS.

ASPEN 4 511 E 38 $\frac{1}{2}$  LKS.

FSLP ON 4 BIRCH N88W 17 LKS.

THIS CORNER WAS SET AT PROPORTIONATE DISTANCE

FROM SEC. COR. 1 MILE SOUTH AND FROM  $\frac{1}{4}$  COR.

BET. SEC'S. 19 & 24  $\frac{1}{2}$  MILE NORTH

NO ORIGINAL EVIDENCE WAS FOUND THEN AND OUR

SEARCH NOW REVEALS NOTHING REMAINS

WE CHECK CREEK TIE 8.30 CHS W OF SEC. COR.

FROM 1939 LOCATION WE WOULD HAVE TO MOVE LINE

SOUTH 75' TO HAVE TIE CHECK ALSO DISTANCE

WOULD BE 50' SHORTER

C.C. Done 1986



## QUARTER CORNER BET. SEC'S. 19-24

NOTES OF ORIG. GOVT. SURVEY 1891

SET WOOD POST

ELM 7 N19W 11 LKS.  
 N17W 7.3' WITH OLD FSLP  
 Ed. ELM STUMP AND STUB LYING ON GROUND (10 LKS.)  
 BALSAM 10 S87E 15 LKS. 99' S25E

FOUND LARGE WINDFALL AT N68E 5.9' STUMP

HAS MADE HOLE WHEN THIS TILT OUT

MAY BE RECORDED WRONG BY ORIG.

(1939)

GJELHAUG STATES THIS IS ORIG. BT on form

874

(DOWN SPRUCE 14 N60E 9 LKS.)

5/30/86 JA DG

Ed: 5" Cedar Post - tied out to set B.C.

1" x 1" solid Iron pipe under post pt.  
(removed)

SET: 4' Brass Capped Iron marked T149N  
 up 15" with Iron pipe on R30W R29W  
 North side up 1" and 5" S241519  
 Cedar post on West side up R15 1986  
 4' - Old post point down under Res No 15810  
 Brass Capped Iron Pipe

12 CHS ENT. LOW WET GROUND - 20 CHS. LV. SWP ENT HIGHER GROUND  
 40 CHS. 1/4 COR. - 80 CHS. SEC. COR.

WALK SOUTH ALONG FENCE LINE AND OPEN HAY FIELD  
 TO EAST AT 1/4 COR. FOUND CABLE BRACE ON FENCE POST  
 IN N+S FENCE LINE FOUND 9" X 24" CEDAR POST BASE  
 IN GROUND IS BADLY DECAYED - PAINT IS STILL SOLID  
 EAST WAS 6" ABOVE GROUND 18" IN GROUND (MAY BE  
 ORIG. POST) CORNER IS 24' W OF N+S FENCE LINE  
 IN ELM - ASPEN + HEAVY BRUSH - APPROX. 400' SOUTH OF  
 E+W GRASS MEADOW WITH FENCE POST + WIRE E ON  
 NORTH AND SOUTH EDGE OF MEADOW  
 W. SPRUCE PLANTATION IS 100' W N+S EDGE

USED 5" CEDAR POST FROM FENCE LINE AND 500.  
 48" HIGH AS TRUE CORNER POSITION  
 USED OLD CABLE AND WIRE OLD POST AND NEW  
 TOGETHER - PLACE 1939 FSLP ON SW ELM BT

IRON TIES

BALDIE 11 N74W 56.00' } PAINTED RED  
 ELM 5 S3W 26.5' } DOUBLE BLAZED  
 ELM 10 N13W 61.00' } SPIKE & TAGS

10-5-84 CK-JA

(cont)

5/30/86 - remarked BTS - scribed double  
 blaze "1/4 S24" BT" on all three

Corner was chained to from the North and  
 South (NE SEC 24 + S 1/4 S24 E SEC 19)

2650.5' from the North - CCC dist.

1326' from the South - CCC dist.

Dist. checks from both directions

C.C. Done 1986



49 N-25

SECTION CORNER TO SECTIONS 13-18-19-24

NOTES OF ORIG. GOVT. SURVEY 1891

SET WOOD POST

TAM. 7 N22E 28 LKS.

ELM. 9 S33E 12 LKS.

TAM. 9 S71W 24 LKS.

TAM. 8 N56W 31 LKS.

CCC NOTES BY JOHN A GJELHAUG 5-26-39 BK#92

FOUND WOOD HUB - FLUSH WITH ROAD SURFACE

Fd. COUNTY BT'S.

ELM 9 S50E 48 LKS. = 31.68' SCRIBED

ASH 9 N51E 48 LKS. = 31.68 SCRIBED

PLACED FSLP ON ELM 6 ON WEST SIDE OF TREE

CORNER BEARS S76W .33 LKS. = 21.78

69  
CERTIFICATE FILED

J.A. Gjelhaug surveyed in this area 5/26/39. Found

2 BT'S mkd. by County:

ELM 9" S50°E 48 lks.

ASH 9" N52°E 48 lks.

He placed a F.S. poster on Elm 6" N76°E 33 lks. to corner in center of road.

1965

Itasca County found a post by Gjelhaug with tag stating the distance and due west to this corner. They set a 3/4" iron pipe in road for the true corner position and mkd. BT'S:

ELM 6" N66°W 46.60'

ASH 6" S88°E 35.70'

ELM 6" N70°E 36.60'

10/2/84 CK-GB

Fd. iron pipe with wood post alongside just under the road surface of a N-S road. Found remains of all 3 BT'S mkd. by county. ELM 7" N W at 46.60' Scar closed.

ELM 7" N E at 36.60 " "

ASH 7" S E at 35.70 " "

Found Gjelhaugs post with tag laying on the ground east of the corner. Also found tag NE of corner on Elm with fall tag being distance.

C.C. Done 1986

CHECKED WITH BELT COUNTY ON 3/18/92 - NO INFORMATION ON BT'S FOUND BY J.A. GJELHAUG



## CENTER QUARTER IN SECTION 24

NOTES BY JOHN A. GJELHAUG - ENG + SURVEYOR

6/1/39 IN OLD CCG FIELD BOOK PAGE 24

ESTABLISH C<sup>1</sup>/<sub>4</sub> BY LINES RUN FROM N<sup>1</sup>/<sub>4</sub>  
TO S<sup>1</sup>/<sub>4</sub> AND W<sup>1</sup>/<sub>4</sub> TO E<sup>1</sup>/<sub>4</sub> AT POINT OF  
INTERSECTION

SET 4" X 4" X 48" CEDAR POST IN STONE PILE  
FD. 4 X 4 X 36" CEDAR POST WITH SCRIBE C<sup>1</sup>/<sub>4</sub> S 24

MKD NEW BT.

ELM 10 N17°45'E 141 1/2 LKS. 93.4' FSLP

FD. ELM 20° N16'E AT 93.4' TO BLAZE

CHAINED SOUTH FROM N<sup>1</sup>/<sub>4</sub> SEC 24 1327 TO CN<sup>1</sup>/<sub>16</sub>  
NOTHING FOUND AT CN<sup>1</sup>/<sub>16</sub> - CAN'T CONTINUE SOUTH  
BECAUSE OF BEAVER POND 900' SOUTH - WILL HAVE TO  
USE E.D.M. TO MAKE DISTANCE TIE  
WE WALK AROUND POND AND ON WEST SIDE FOUND OLD DAM  
WHICH WE CROSS AND WALK EAST TO OLD FENCE LINE N<sup>1</sup>/<sub>4</sub>S  
FOLLOW SOUTH AND FOUND FENCE CORNER WITH WIRE + POSTS  
N<sup>1</sup>/<sub>4</sub>W AT THIS FENCE CORNER, WE FOUND 4" SQD. CEDAR  
POST SCRIBED C<sup>1</sup>/<sub>4</sub> S 24 LYING ON GROUND - POST WAS  
STOOD UP AND POINT WAS FOUND IN STONE MOUND  
FENCE COR. POST IS AT NORTH EDGE OF GJELHAUGS  
SET FENCE CORNER POST 6" SQD. X 48" HIGH AT  
TRUE CORNER - PLACE 50° SPIKE AT BASE OF POSTS  
IN STONE MOUND

MKD TIES TO POST

BALM-GILEAD 6 N35W 24.90' PAINTED RED

BALM-GILEAD 8 S1EW 25.50' SPIKE + TAGS

BALM-GILEAD 12 S85E 24.20' " "

10-3-84 CK-GB-JA



SOUTH 1/16 BETWEEN SECTIONS 19+24

NOTES BY JOHN A. GJELHAUG ENG. SURVEYOR

1939 SET MID POINT BETWEEN 1/4 COR.  
AND SEC. COR. TO SOUTH

SET ELM POST 4" X 48 PILE 3 LARGE

ROCK AROUND POST

FD. ELM POST 4 X 4 X 30 SCRIBED 1/16 #14

CHAINED FROM 1/4 COR. BET 19+24 SOUTH TO S 1/16  
1326' THIS DISTANCE IS WITHIN 0.5' OF GJELHAUG'S.  
FOUND 4 X 4 X 30 ELM POST LYING ON GROUND - STOOD  
UP AND FOUND BASE IN ROCK MOUND BESIDE 7"  
CEDAR FENCE CORNER POST LYING ON GROUND TO N  
OLD FENCE AND POSTS N + E FROM COR. - OPEN HAY  
FIELD TO NE IN HARDWOODS ON SIDE SLOPE  
STOOD GJELHAUG'S POST UP IN STONE MOUND AND  
PLACE 4 LARGE ROCK AROUND POST - OLD POST IS  
STILL SOLID AND SCRIBED

NEW TIES

ELM 7 N12W 39.60' PAINTED RED

BALM-GILEAD 13 S39W 7.00' DOUBLE GLAZED

ELM 7 S39E 11.50' SPIKE & TAGS

10-5-84 CK-JA



EAST 1/16 BET. SECTIONS 17+20

CONTRACTOR'S FIELD BOOK #1 Pgs. 81+82

E 1/16	17 1/2	82
		7/29/90
		Set 1 P
		Set 2 P
		Time 1
		Time 2
		Time 3
		Time 4
		Time 5
		Time 6
		Time 7
		Time 8
		Time 9
		Time 10
		Time 11
		Time 12
		Time 13
		Time 14
		Time 15
		Time 16
		Time 17
		Time 18
		Time 19
		Time 20
		Time 21
		Time 22
		Time 23
		Time 24
		Time 25
		Time 26
		Time 27
		Time 28
		Time 29
		Time 30

81	E 1/16	17 1/2	
1907	E. J. Bauged's Dep. Co. Surveyor		
	Set post for corner on point		
	between 1/4 Cor. 1. Sec. Co.		
	Clear 1/4" 5.02'E - 26.65S - 56'		
1910	R. K. Bicker Dep. Co. Surveyor		
	Found post and marks near ST		
	corner 18" 5.02'W 68.65S - 44.88' N		
	we used this Cr. and Sec. Cor. and		
	Projected line and checked distance		
	to west to reestablish 1/4 Cor. 17 1/2		
1916	K. O. Peterson and remains of old		
	corner stump at approx. 183' 1/2' S.		
	3 stumps in vicinity.		
	Below should dig for corner		
	Set up dark Beaumont County		
	Survey crew		

## CERTIFICATE FILED

8-22-90 KOVANAN - OSUFSON UNDER  
CONTRACT FOR SECTION 21CONTRACT # 43-6392-9-0256  
CONTRACTOR'S FIELD BOOK #1 PAGE 92  
SET 2 X 36 IRON PIPE WITH BRASS CAP MKD.SET 1.50 BELOW  
GROUND

T149N R30W

E 1/16  $\frac{517}{520}$ 

1990

RLS 17767

WITNESSED BY

BASSWOOD 10 575E - 50.46

ASH 8 536E - 59.65

ASH 11 525W - 52.90

CORNER IS 7' SOUTH OF CENTRE LINE OF E+W  
TOWNSHIP ROAD



## OUTSIDE FOREST BOUNDARY

CORNER TO SECTIONS 8-9-16+17

ORIG. GOV'T. SURVEY 1892

SET WOOD POST

BALSAM 4 S33W 20 Lks. = 13.20'

BALSAM 10 N67W 19 Lks. = 12.54'

BALSAM 8 S69E 20 Lks. = 13.20'

W. PINE 36 N44E 30 Lks. = 19.80'

CERTIFICATE FILED



