

TRAVERSE

T143N

R27W



Field Book
115300

TRAVERSE

T143N R27W

1

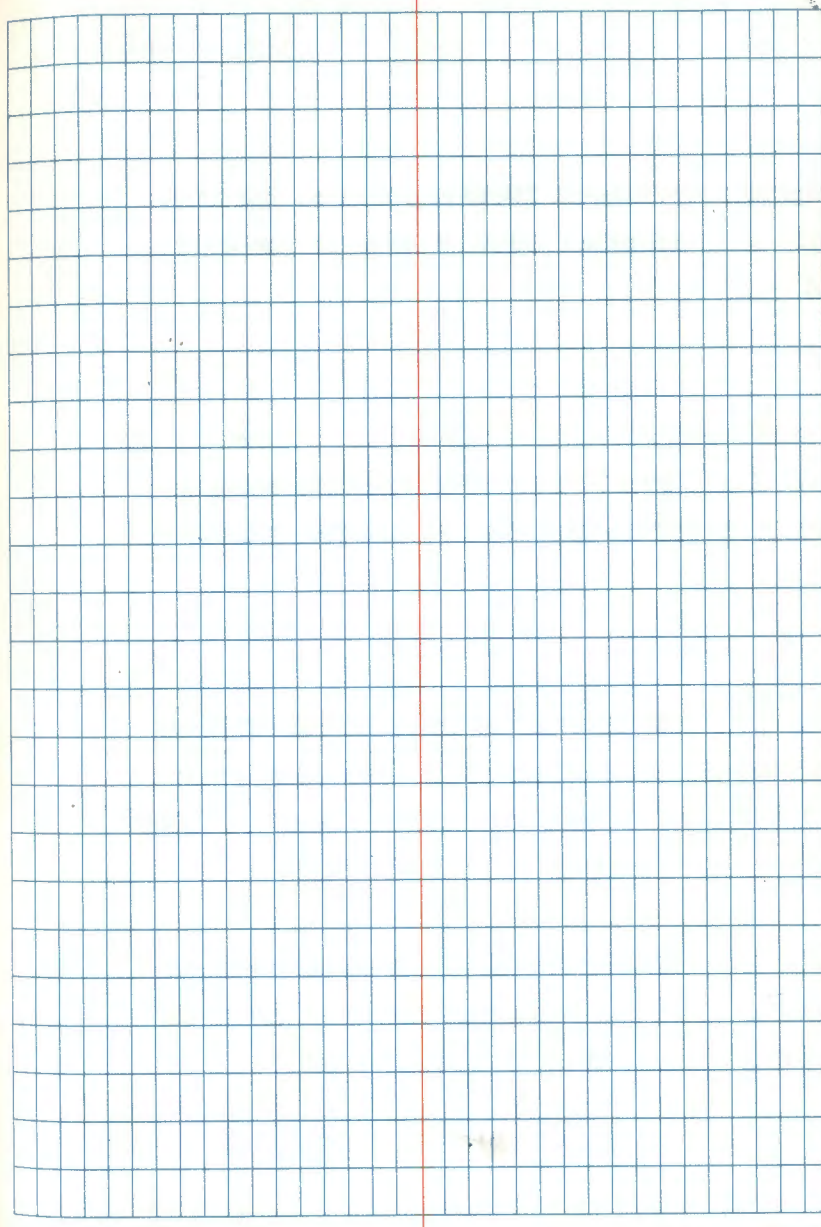

TRAVERSE OF COUNTY ROAD #135
T143N R27W 5 MILES

2

USFS, CASS COUNTY

FS 3 178-24-56 358-25-02 178-24-53 358-25-02

BS 1 00-00-07 180-00-18 00-00-07 180-00-16

π@2

m

VD 2-1 89-57-44 270-02-19 2645.250 806.272

VD 2-3 89-56-23 270-03-44 2600.940 792.767

~~FS 4 180-05-01 00-05-18 180-05-15 180-00-44~~

~~BS ² 00-00-12 00-00-12 180-00-52 00-00-27 00-00-16~~

~~π@3 49 26 48 28~~

FS 4 180-04-49 00-05-08 180-04-51 00-05-06

BS 2 00-00-19 180-00-37 00-00-18 180-00-35

π@3 30 29 33 29

8/ /89 C. KRAUSE □
R. MAINT
CLEAR 75° HEAT WAIVES
Weld T-2
TOPCON EDM

PT 1 SECTION CORNER

18/17
19/20
1970

2" E/M
(CLAMP)

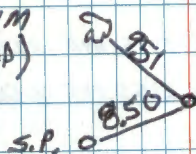

PT 2 Spk So Shoulder



PT 3
SPK

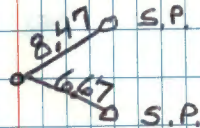

3

FS 5	179-38-30	359-38-41	179-38-38	359-38-47
BS 3	00-00-13	180-00-25	00-00-11	180-00-36
TR 4	17	16	27	11

m

VA 4-3	89-53-28	270-06-49	2715.640	827.731
VA 4-5	89- 22-47 ²³⁻¹⁶	270-37-35	2155.195	656.905

FS 6	178-26-43	358-26-56	178-26-39	358-26-57
BS 4	00-00-40	180-01-01	00-00-37	180-00-59
TR 5	03	55	02	58

FS 7	179-23-26	359-23-44	179-23-21	359-23-34
BS 5	00-00-09	180-00-20	00-00-05	180-00-21
TR 6	17	24	16	13

m

VA 6-5	90-12-35	269-47-46	674.030	205.445
VA 6-7	90-55-45	269-04-36	2474.895	754.353

2

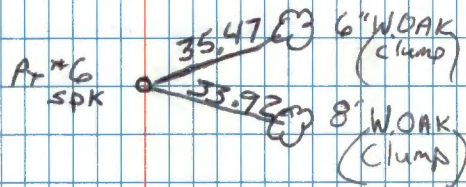
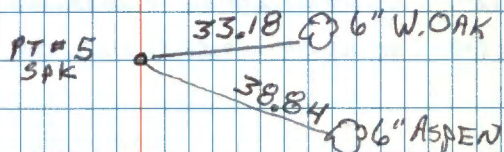
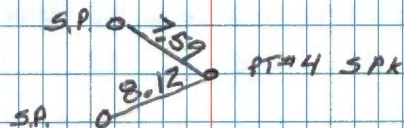

4

FS 8	178-46-11	358-46-31	178-46-19	358-46-27
BS 6	00-00-23	180-00-44	00-00-26	180-00-44
TK 7	58	57	53	43

FS 9	179-07-36	359-07-58	179-07-48	359-07-56
BS 7	00-00-09	180-00-25	00-00-08	180-00-35
TK 8	27	33	40	21

VΔ 8-7	89-54-07	270-06-10	2028.565	618.307
VΔ 8-9	90-05-34	269-54-35	3163.935	964.368

FS 10	183-54-27	03-5440	183-54-21	03-54-42
BS 8	00-00-27	180-00-33	00-00-21	180-00-35
TK 9	--	07	--	07

8/8/89 C. KRAUSE

R MAIN T

CLEAR 70° HEAT WAVES

Weld T-2

TOPDOWN EDM

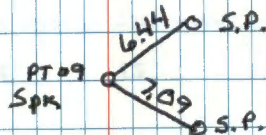
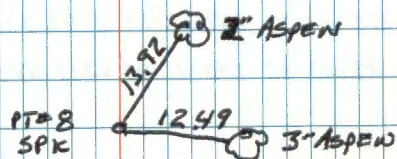
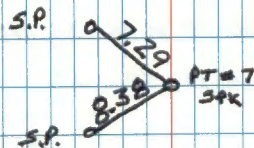

5

FS 11	177-23-29	357-23-37	177-23-26	357-23-37
BS 9	00-00-36	180-00-50	00-00-34	180-00-50
TR 10	53	47	52	47

VA 10-9	90-01-39	269-58-22	2662.520	811.538
---------	----------	-----------	----------	---------

VA 10-11	89-23-37	270-36-43	2212.683	674.427
----------	----------	-----------	----------	---------

FS 12	178-34-36	358-34-49	178-34-34	358-34-46
-------	-----------	-----------	-----------	-----------

BS 10	00-00-25	180-00-35	00-00-20	180-00-33
-------	----------	-----------	----------	-----------

TR 11	11	14	14	13
-------	----	----	----	----

FS 13	90 178-55-56	358-56-09	178-55-53	358-56-07
-------	-------------------------	-----------	-----------	-----------

BS 11	00-00-30	180-00-42	00-00-23	180-00-46
-------	----------	-----------	----------	-----------

TR 12	-26	27	30	21
-------	-----	----	----	----

VA 12-11	90-05-25	269-54-50	2738.835	834.800
----------	----------	-----------	----------	---------

VA 12-13	91-09-13	268-50-52	389.640	118.762
----------	----------	-----------	---------	---------

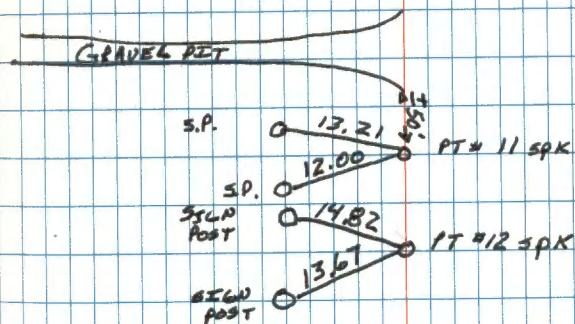
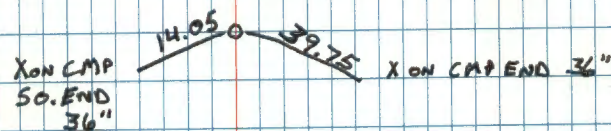

PT 13	2" I.P. CAP	743N
		R27 R26
		1318
		2419

6

END OF
BOOK