

T143N R26W

Traverse

RE
FIELD BOOK

92-0032

Book 5

T143N
R26W
Book 5

DISTANCES FROM SIDE STAKES FOR CROSS-SECTIONING

Roadway of any Width. Side Slopes $1\frac{1}{2}$ to 1.

In the figure below: opposite 7 under "Cut or Fill" and under .3 read 11.0, the distance out from the side stake at left. Also, opposite 11 under "Cut or Fill" and under .1 read 16.7, the distance out from the side stake at right.

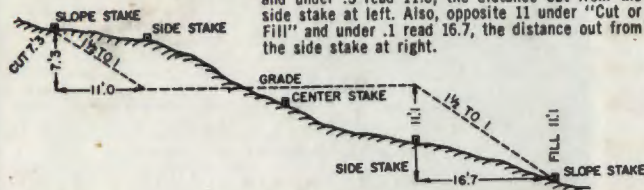

Cut or Fill	Distance out from Side or Shoulder Stake										Cut or Fill
	0	.1	.2	.3	.4	.5	.6	.7	.8	.9	
0	0.0	0.2	0.3	0.5	0.6	0.8	0.9	1.1	1.2	1.4	0
1	1.5	1.7	1.8	2.0	2.1	2.3	2.4	2.6	2.7	2.9	1
2	3.0	3.2	3.3	3.5	3.6	3.8	3.9	4.1	4.2	4.4	2
3	4.5	4.7	4.8	5.0	5.1	5.3	5.4	5.6	5.7	5.9	3
4	6.0	6.2	6.3	6.5	6.6	6.8	6.9	7.1	7.2	7.4	4
5	7.5	7.7	7.8	8.0	8.1	8.3	8.4	8.6	8.7	8.9	5
6	9.0	9.2	9.3	9.5	9.6	9.8	9.9	10.1	10.2	10.4	6
7	10.5	10.7	10.8	11.0	11.1	11.3	11.4	11.6	11.7	11.9	7
8	12.0	12.2	12.3	12.5	12.6	12.8	12.9	13.1	13.2	13.4	8
9	13.5	13.7	13.8	14.0	14.1	14.3	14.4	14.6	14.7	14.9	9
10	15.0	15.2	15.3	15.5	15.6	15.8	15.9	16.1	16.2	16.4	10
11	16.5	16.7	16.8	17.0	17.1	17.3	17.4	17.6	17.7	17.9	11
12	18.0	18.2	18.3	18.5	18.6	18.8	18.9	19.1	19.2	19.4	12
13	19.5	19.7	19.8	20.0	20.1	20.3	20.4	20.6	20.7	20.9	13
14	21.0	21.2	21.3	21.5	21.6	21.8	21.9	22.1	22.2	22.4	14
15	22.5	22.7	22.8	23.0	23.1	23.3	23.4	23.6	23.7	23.9	15
16	24.0	24.2	24.3	24.5	24.6	24.8	24.9	25.1	25.2	25.4	16
17	25.5	25.7	25.8	26.0	26.1	26.3	26.4	26.6	26.7	26.9	17
18	27.0	27.2	27.3	27.5	27.6	27.8	27.9	28.1	28.2	28.4	18
19	28.5	28.7	28.8	29.0	29.1	29.3	29.4	29.6	29.7	29.9	19
20	30.0	30.2	30.3	30.5	30.6	30.8	30.9	31.1	31.2	31.4	20
21	31.5	31.7	31.8	32.0	32.1	32.3	32.4	32.6	32.7	32.9	21
22	33.0	33.2	33.3	33.5	33.6	33.8	33.9	34.1	34.2	34.4	22
23	34.5	34.7	34.8	35.0	35.1	35.3	35.4	35.6	35.7	35.9	23
24	36.0	36.2	36.3	36.5	36.6	36.8	36.9	37.1	37.2	37.4	24
25	37.5	37.7	37.8	38.0	38.1	38.3	38.4	38.6	38.7	38.9	25
26	39.0	39.2	39.3	39.5	39.6	39.8	39.9	40.1	40.2	40.4	26
27	40.5	40.7	40.8	41.0	41.1	41.3	41.4	41.6	41.7	41.9	27
28	42.0	42.2	42.3	42.5	42.6	42.8	42.9	43.1	43.2	43.4	28
29	43.5	43.7	43.8	44.0	44.1	44.3	44.4	44.6	44.7	44.9	29
30	45.0	45.2	45.3	45.5	45.6	45.8	45.9	46.1	46.2	46.4	30
31	46.5	46.7	46.8	47.0	47.1	47.3	47.4	47.6	47.7	47.9	31
32	48.0	48.2	48.3	48.5	48.6	48.8	48.9	49.1	49.2	49.4	32
33	49.5	49.7	49.8	50.0	50.1	50.3	50.4	50.6	50.7	50.9	33
34	51.0	51.2	51.3	51.5	51.6	51.8	51.9	52.1	52.2	52.4	34
35	52.5	52.7	52.8	53.0	53.1	53.3	53.4	53.6	53.7	53.9	35
36	54.0	54.2	54.3	54.5	54.6	54.8	54.9	55.1	55.2	55.4	36
37	55.5	55.7	55.8	56.0	56.1	56.3	56.4	56.6	56.7	56.9	37
38	57.0	57.2	57.3	57.5	57.6	57.8	57.9	58.1	58.2	58.4	38
39	58.5	58.7	58.8	59.0	59.1	59.3	59.4	59.6	59.7	59.9	39
40	60.0	60.2	60.3	60.5	60.6	60.8	60.9	61.1	61.2	61.4	40

Property of:
 USDA Forest Service
 Deer River Ranger Dist.
 Deer River, MN 56636



The paper in this book is made of 50% high grade rag stock with a WATER RESISTING surface sizing.

KEUFFEL & ESSER CO.

USFS, CASS COUNTY, MN

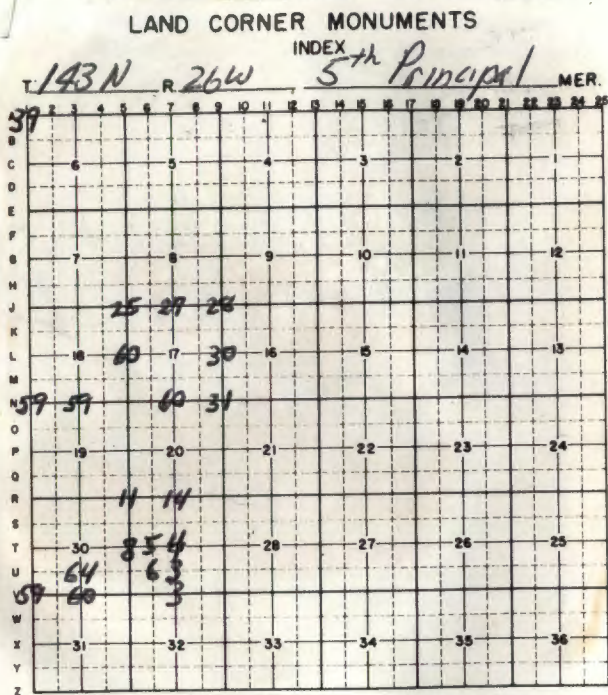

Description	INDEX	page
Traverse diagram of sec 29		2
Traverse of section 29		3-16
Traverse diagram of 17 & 18		18
Loop traav around sec 17 & 18		19-31
Spur traav sketch to NW town corner		32
Spur traav to NW township corner		33-39
Traav sketch of inter of S 17 & 18		41
Interior S 17 & 18 Traverse		42-58
Angles at Property Corners to lines		70-
Tie in Property Corners, Fence		59, 60
INTERIOR TRAVERSE Sec 30		61- 64 65
Property line between S 29 & S 30		71

3

T143NR26W

INTERIOR TRAVERSE SEC. 29

STA 1st H&D 2nd H&R 3rd H&D 4th H&R
H&R

FS 301 270-17-51 90-17-38 270-17-45 90-17-38

BS 207 ~~00-00-19 180-00-07 00-00-15 180-00-05~~

TP 208 270-17-32 270-17-31 270-17-30 270-17-33

270-17-32

208 to 301 90-18-02 269-42-04 90-17-59 440.305 440.297

301 to 208 89-43-50 270-16-10 89-43-50 440.310 440.305

FS 302 180-03-08 00-02-55 180-02-⁵¹~~57~~ 00-02-54BS 208 00-00-19 180-00-08 00-00-¹⁰~~12~~ 180-00-05TP 301 180-02-⁴¹~~49~~ 180-02-47 180-02-⁴¹~~39~~ 180-02-49

180-02-47

Dist 301-302 90-05-42 269-54-27 90-05-38 328.151 328.151

Dist 302-301 89-57-00 270-03-04 89-56-~~58~~ 328.151 328.151✓ OK ^{OK} 11/19/85

3

Nov 8, 1985

P.C. = G. Koskenko

T.P. = B. Ausk

Grunt = G. Robertson

STA 208

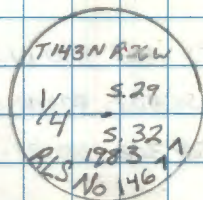

Brass cap set flush

440.302 ✓ 444.56A in highway

STA 301 =

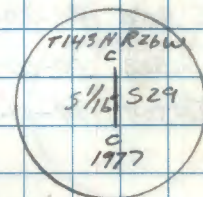

Iron Pipe w/BC

328.151 ✓

1076.61A

T143N R26W

Traverse cont'd from pg 3

STA 1st H&D 2nd H&D 3rd H&D 4th H&D
H&D

FS 303 180-21-28 00-21-18 180-21-28 00-21-13

BS 301 00-00-22 180-00-12 00-00-21 180-00-15

T@ 302 180-21-06 180-21-06 180-21-07 180-20-58

180-21-04

Dist 302-303 90-09-25 269-50-36 90-09-25 113.307 113.307

Dist 303-302 89-56-41 270-03-28 89-56-36 113.300 113.300

FS 304 94-20-00 274-19-43 94-19-53 274-19-44

BS 302 00-00-18 180-00-06 00-00-12 180-00-08

T@ 303 94-19-42 94-19-37 94-19-41 94-19-36

94-19-39

Dist 303-304 90-01-20 269-58-44 90-01-18 414.609 414.609

Dist 304-303 90-00-56 269-59-02 90-00-57 414.617 414.617

✓ OK Plc 11/14/85

Nov. 8, 1985

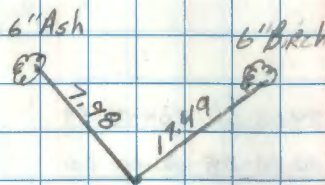

STA 302 = 60 d spike

113.303 ✓ 371.728

371.73 A

STA 303 =

T143NR26W

C 1/4 • S29

1977

Iron pipe w/BC

414.613 ✓ 1360.28 A

T143N R26W

Traverse, cont'd from pg 4

STA 1st H&D 2nd H&D 3rd H&D 4th H&D

H&D

FS 305 84-09-50⁵⁰ 264-08-58 84-08-57 264-08-53

BS 303 00-00-25 180-00-19 00-00-28 180-00-20

TI@304 84-08-35 84-08-39 84-08-29 84-08-33

84-08-34

Dist 304-305 89-59-44 270-00-15 89-59-45 378.527 378.527

Dist 305-304 90-01-34 269-58-32 90-01-31 378.531 378.531

FS 306 180-34-02^{3 52} 00-33-47 180-33-57 00-33-49

BS 304 00-00-14 180-00-04 00-00-04 180-00-04

TI@305 180-33-48 180-33-43 180-33-53 180-33-45

180-33-47

Dist 305-306 90-09-20 269-50-45 90-09-18 69.272 69.272

Dist 306-305 90-00-04 269-59-23 90-00-21 69.266 69.266

OK 11/14/85

Nov. 8, 1985

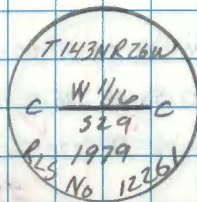

STA 304 =

378.529 ✓ 1241.899

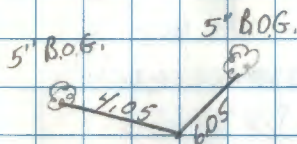

STA 305 = 60 d spike

69.269 ✓ 227.269

T143N R26W

Traverse cont'd from pg. 5
 STA 1st H&D 2nd H&R 3rd H&D 4th H&R

H&R

FS 307 270-06-32 90-06-26 270-06-31 90-06-27

BS 305 00-00-14 180-00-05 00-00-11 180-00-10

T@ 906 270-06-18 270-06-21 270-06-20 270-06-17

270-06-19

Dist. 306-307 87-58-53 270-01-13 270-01-10 78.157 78.157

Dist. 307-306 70-06-02 269-54-03 269-54-01 78.160 78.160

FS 308 182-23-33 02-23-19 182-23-27 02-23-18

BS 306 00-00-22 180-00-16 00-00-18 180-00-15

T@ 307 182-23-09 182-23-03 182-23-12 182-23-03

182-23-07

Dist 307-308 89-57-27 270-02-34 270-02-34 137.832 137.832

Dist 308-307 90-07-14 269-52-48 269-52-47 137.832 137.832

JBR 8/25/85

Nov. 8, 1985

6

T143N R26W

STA 306 = S.W. 1/4 S.29

1977

Nov. 20, 1985

78.159 256.43 ft

T-2 S/W 265184

RediA S/W 4863

X-X-X-X-X 9307



Partly cldy, calm, ^{calm}
 PC 40 T T G. Kasento
 O G. Robertson

STA 307 = bud spike

BPR = 30.1 Temp = 8°F

GCF = -3

137.832 452.20 ft

JBR 8/25/85

T14311, R26W

Traverse, cont'd from pg 6

STA 1st H&D 2nd H&R 3rd H&D 4th H&R

H&R

FS 309 184-48-20 04-48-15 184-48-17 184-48-03

BS 307 00-00-18 180-00-03 00-00-09 179-59-57

T@308 184-48-02 184-48-12 184-48-09 184-48-11

184-48-09

Dist 308-309 89-53-23 270-06-44 270-06-41 180.751 180.751

Dist 309-308 90-00-28 269-50-36 269-50-34 180.746 180.745

FS 310 265-58-14 85-59-05 265-59-10 85-59-02

BS 308 00-00-20 180-00-17 00-00-13 180-00-10

T@309 265-58-54 265-58-48 265-58-57 265-58-50

265-58-53

Dist 309-310 89-50-15 270-09-44 270-09-45 452.177 452.175

Dist 310-309 90-11-23 269-48-42 269-40-40 452.182 452.180

JDR 11/25/85

Nov 20, 1985

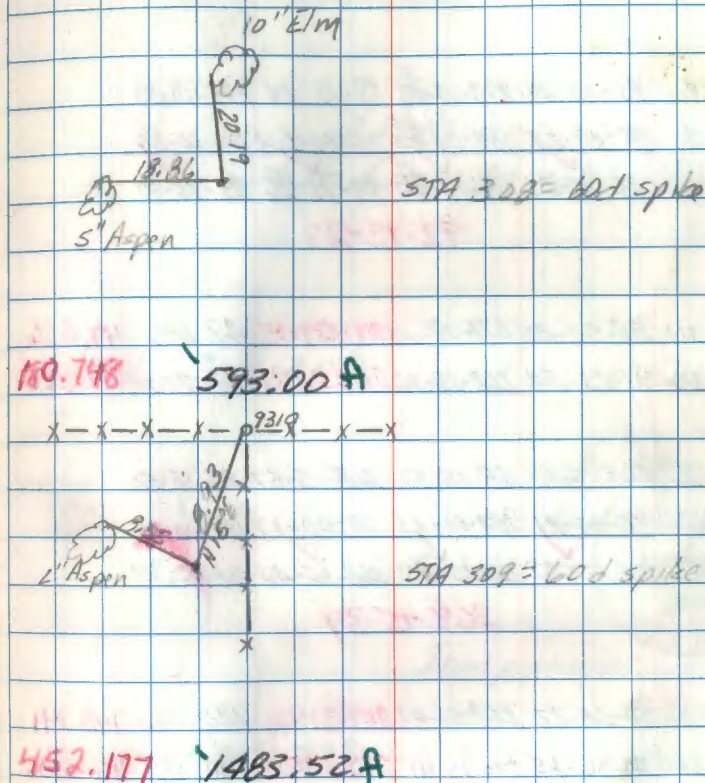

T43N R26W

Traverse cont'd from pg 7

STA 1st H&D 2nd H&R 3rd H&D 4th H&R

H&R

FS	311	93-13-29	273-13- 29 ³⁰	73-13-34	273-13-35
BS	309	00-00-22	180-00- 23 ²⁴	00-00-05	180-00-04
T@	310	93-13-26	93-13- 27 ³²	93-13-26	93-13-31

93-13-29

Dist 310-311 88-50-40 271-09-10 271-09-15 47.696 47.686

Dist 311-310 91-23-34 268-36-36 268-36-31 47.700 47.696

FS 312 268-15-58 268-15-52 268-15-57 268-15-52

BS 310 00-00-21 180-00-13 00-00-17 180-00-12

T@ 311 268-15-57 268-15-39 268-15-40 268-15-39

268-15-39

Dist 311-312 90-28-22 269-31-41 269-31-40 140.146 140.141

Dist 312-311 97-36-25 270-23-41 270-23-38 140.139 140.136

JMR 11/25/85

Nov 20, 1985

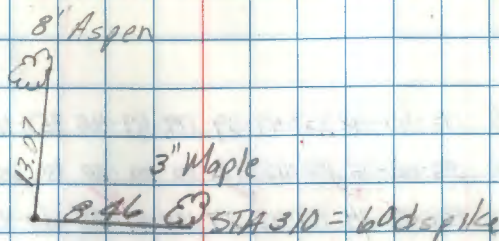

47.686 156.45 A

STA 311 =

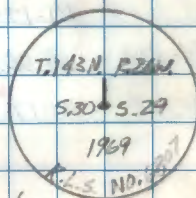

Iron pipe w/BC

140.139 459.77 A

9

T143N R26W

Traverse cont'd from page 8

STA 1st H&D 2nd H&E 3rd H&D 4th H&E

H&E

FS 313	179-49-42	359-49-39	179-49-45	359-49-42
BS 311	00-00-16	180-00-12	00-00-20	180-00-10
TP 312	179-49-24	179-49-27	179-49-25	179-49-32

179-49-27

Dist 312-313	90-19-27	269-40-35	269-40-34	270.057	270.053
Dist 312-312	89-43-03	270-16-45	270-16-51	270.061	270.058

FS 314	181-17-48	01-17-42	181-17-52	01-17-44
BS 312	00-00-21	180-00-17	00-00-21	180-00-21
TP 313	181-17-27	181-17-25	181-17-31	181-17-23

181-17-27

Dist 313-314	90-03-29	269-56-26	269-56-29	137.312	137.312
Dist 314-313	90-01-31	269-58-33	269-58-31	137.313	137.313

JDR 11/25/85

Nov, 21, 1985

9

4" Maple

1.87

STA 312 = 60d spike

886.01 A

270.055

6" Aspen

14" Aspen

45.37

STA 313 = 60d spike

4.13

2" Aspen

137.313 450.50 A

T143N R26W

Traverse cont'd from pg 9

STA 1st HAD 2nd HXR 3rd HAD 4th HXR

HXR

FS 315 174-45-51 354-45-41 174-45-50 354-45-35

BS 313 00-00-23 180-00-12 00-00-22 180-00-06

T0 314 174-45-28 174-45-29 174-45-28 174-45-29

174-45-29

Dist 314-315 90-16-35 269-43-30 269-43-28 165.329 165.327

Dist 315-314 89-47-23 270-12-30 270-12-34 165.321 165.326

FS 316 167-33-33 347-33-29 167-33-37 347-33-26

BS 314 00-00-09 179-59-58 00-00-07 180-00-00

T0 315 167-33-24 167-33-31 167-33-30 167-33-26

167-33-28

Dist 315-316 90-20-35 269-39-36 269-39-31 54.396 54.395

Dist 316-315 89-51-56 270-08-09 270-08-07 54.399 54.399

JHR 11/25/85

Nov. 20, 1985

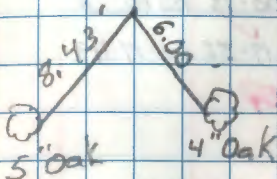

STA 314 = 60d spike

165.323 542.40A

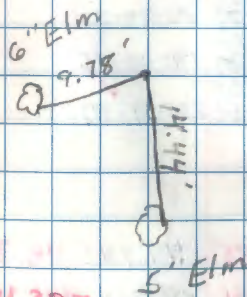

STA 315 = 60d spike

54.397 178.47A

Traverse cont'd from pg 10

STA 1st H&D 2nd H&R 3rd H&D 4th H&R

H&R

FS 317 283-20-14 163-20-05 283-20-10 103-20-00

BS 315 00-00-²¹29 180-00-10 00-00-18 180-00-12

TP 316 283-19-53 283-19-55 283-19-52 283-19-48

283-19-52

Dist 316-317 90-35-45 269-24-25 269-24-20 156.501 156.493

Dist 317-316 ⁸⁹⁻²⁸⁻³³ 91-44-08 270-31-28 270-31-28 156.498 156.491FS 318 236-39-35 56-39-23 236-39-³⁵27 56-39-25BS 316 00-00-¹⁸23 180-00-²⁰29 00-00-²⁰29 180-00-16TP 317 236-39-12 236-39-05 236-29-³⁹⁻⁰⁵58 236-39-07

236-39-08

Dist 317-318 ⁹¹⁻⁴⁴⁻⁰⁸ 89-28-33 268-15-57 268-15-55 44.783 44.763

Dist 318-317 88-30-21 271-29-32 271-29-36 44.769 44.754

JBR 11/25/85

STA 316 =

T 14311 R26W

S. 19 | S. 20

S. 30 | S. 29

1769

R.L.S. No. 680A

156.492 513.42 A

14" B. of G.

4.39

STA 317 = 60d spike

21.34

44.758

146.845 4" Maple

12

T143N R26W

Traverse cont'd from pg 11

STA 1st H&D 2nd H&R 3rd H&D 4th H&R

H&R

FS 319 121-14-36 301-14-31 121-14-35 301-14-32

BS 317 00-00-25 180-20-15 00-00-22 180-20-18

T@318 121-14-11 121-14-16 121-14-13 121-14-14

121-14-14

Dist 318-319 89-29-16 270-30-40 270-30-42 116.400 116.395

Dist 319-318 90-36-40 269-23-24 269-23-22 116.902 116.395

FS 320 180-21-02 00-20-52 180-21-01 00-20-55

BS 318 00-00-29 180-20-06 00-00-19 180-20-04

T@ 319 180-20-42 180-20-46 180-20-47 180-20-46

180-20-45

Dist 319-320 89-56-11 270-03-56 270-03-53 168.521 168.521

Dist 320-319 90-08-02 269-52-04 269-52-01 168.516 168.516

JHR 11/25/85

12

Nov 22, 1985

Snow, cold, windy

PC: RTT G. Kasonko

Brunt G. Robertson

T-2 S/N 265184

Roll A 4863

BPR = 30.2 ELF-2

Temp = 22° @ 9:45 AM

16" Aspen

5.90



STA 318 = good spike

116.395

12" Aspen

381.87 A

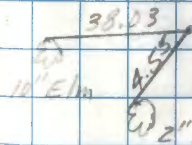

STA 319 = good spike

168.518

552.88 f

Traverse cont'd from pg 12

STA 1st H&D 2nd H&R 3rd H&D 4th H&R
H&R

FS 321 179-40-47 359-40-39 179-40-39 359-40-39

BS 319 00-00-20 180-00-01 00-00-19 180-00-08

TP 320 179-40-27 179-40-33 179-40-25 179-40-31

179-40-29

Dist 320-321 89-38-31 270-21-19 270-21-24 157.295 157.282

Dist 321-320 90-25-42 269-34-18 269-34-18 157.292 157.288

FS 322 187-02-22 07-02-14 187-02-24 07-02-18

BS 320 00-00-23 180-00-21 00-00-24 180-00-21

TP 321 187-02-00 187-01-53 187-02-00 187-01-57

187-01-58

Dist 321-322 89-50-07 270-10-00 270-09-57 178.078 178.077

Dist 322-321 90-13-47 269-46-06 269-46-10 178.079 178.078

JHR 11/25/85

Nov 22, 1985

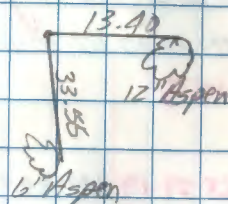

STA 320 = 60d spike

157.285 516.03 ft

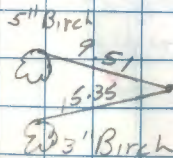

STA 321 = 60d spike

178.077 584.24 ft

14

T143N R26W

Traverse cont'd from pg 13

STA 1st H&R 2nd H&R 3rd H&R 4th H&R

H&R

FS 323 ~~177-00-24~~ 177-00-24 357-00-18 177-00-21 357-00-15BS 321 ~~177-00-24~~ 177-00-24 180-00-14 180-00-21 180-00-14TP 322 ~~177-00-24~~ 177-00-04 177-00-00 177-00-21

177-00-03

Dist 322-323 91-~~05-30~~ 268-54-18 268-54-19 148.884 148.857

Dist 323-322 88-59-03 271-00-57 271-00-57 148.876 148.853

FS 324 183-58-~~29~~⁴² 03-58-37 183-58-~~29~~⁴² 03-58-29BS 322 180-00-~~13~~¹³ 180-00-09 180-00-~~13~~¹⁵ 179-58-57TP 323 183-58-~~29~~²⁹ 183-58-32 183-58-~~29~~²⁷ 183-58-32

183-58-30

Dist 323-324 89-59-39 270-00-28 270-00-25 230.139 230.139

Dist 324-323 90-03-24 269-56-42 269-56-39 230.144 230.144

183-58-30

Nov 22, 1985

14

T143N R26W

1/4 528

5.87

1908

10/18/85

STA 322 =

Iron Pipe w/BC

148.855

488.37

6" Aspen

450

5.85

6" Aspen

STA 323 = 60' ds pike

230.141

755.05A

TIA3N R26W

Traverse cont'd from pg 14

STA 1st H&D 2nd H&D 3rd H&D 4th H&D

H&D

FS 325 164-37-20 344-37-15 160-37-15 344-37-12

BS 323 00-00-20 180-00-07 00-00-16 180-00-08

TQ 324 164-37-00 164-37-08 164-36-59 164-37-04

164-37-03

Dist 324-325 89-00-24 270-59-39 270-59-38 200.740 200.715

Dist 325-324 91-03-13 268-56-45 268-56-48 200.743 200.709

FS 203 197-02-05 17-01-55 197-02-00 17-01-51

BS 324 00-00-23 180-00-11 00-00-17 180-00-10

TQ 325 197-01-42 197-01-44 197-01-43 197-01-41

197-01-43

Dist 325-203 89-51-53 270-08-16 270-08-12 201.608 201.607

Dist 203-325 90-11-44 269-48-13 269-48-15 201.604 201.603

JYR 11/25/85

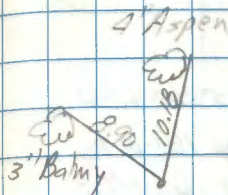

STA 324 = 60d spike

Approx 1/16

200.709 658.494

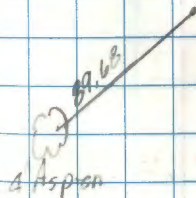
no close ties STA 325 = 60d spike
in old field

201.605 661.434

16

TIASN P26W

Traverse cont'd from pg 15

STA 1st HSD 2nd HSR 3rd HSD 4th HSR

H4

FS 202 80-47-35 260-47-31 80-47-35 260-47-24

BS 325 02-00-18 180-00-08 02-00-14 180-00-06

TD 203 80-47-17 80-47-23 80-47-21 80-47-18

80-47-20

END OF TRAVERSE

Nov 22, 1985

16

END OF TRAVERSE

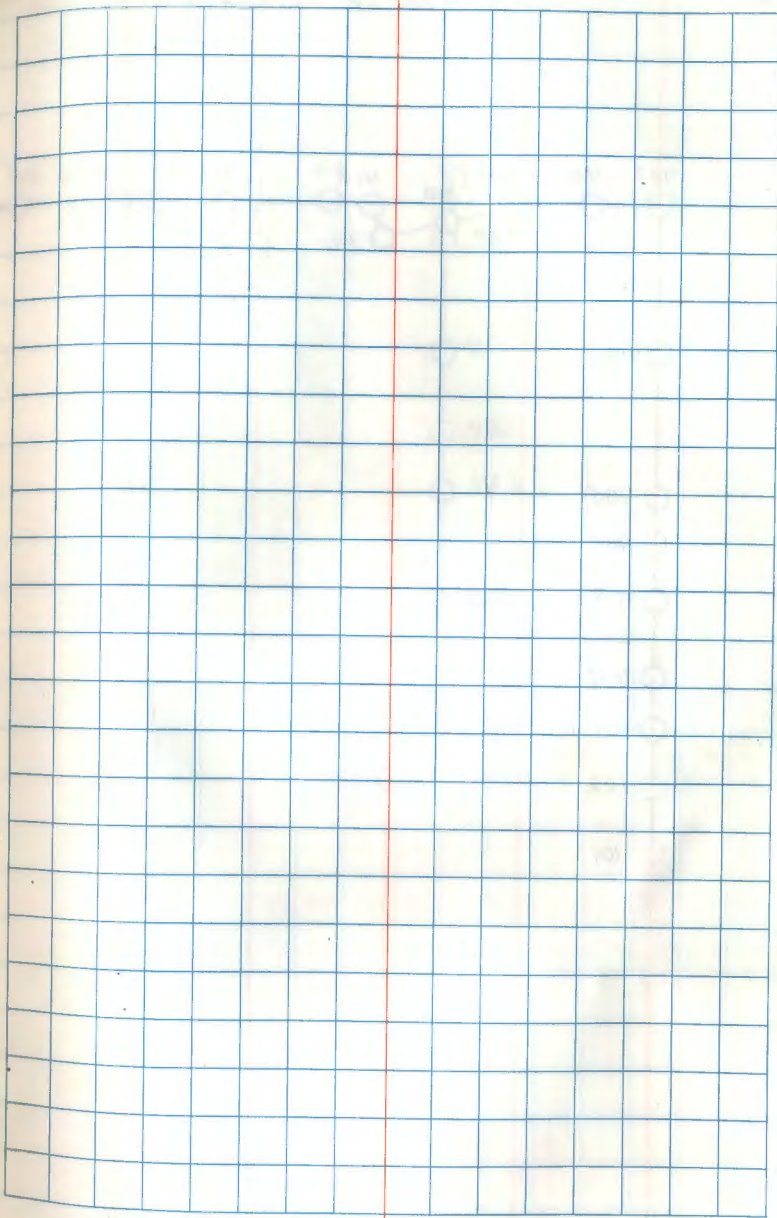

Traverse Diagram:

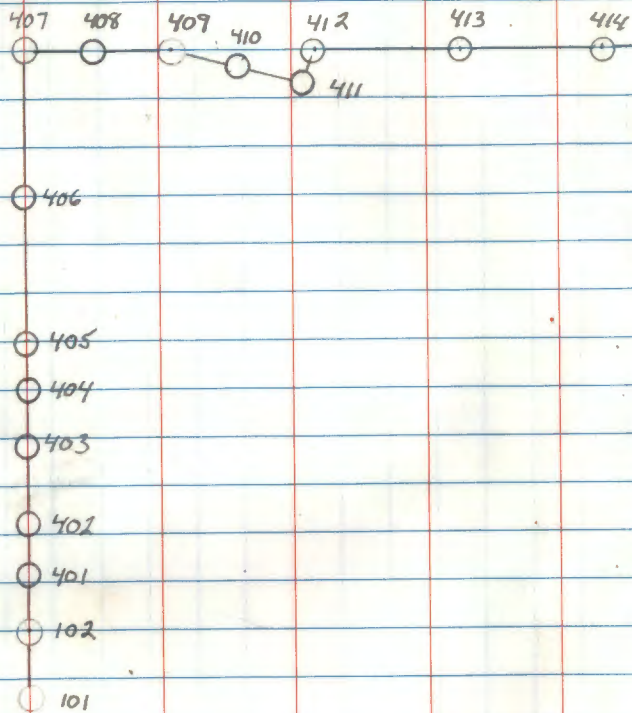

North Loop

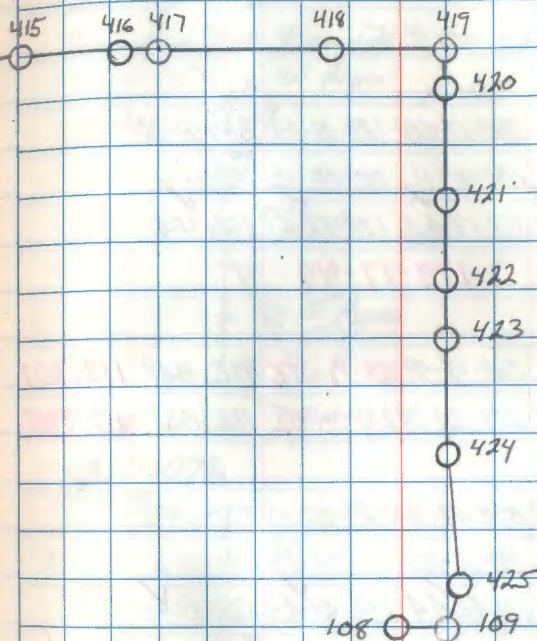

#400's traverse Loop around sec's 17 + 18

STA 1st H&D 2nd H&R 3rd H&D 4th H&R

H&R

ES 402 179-18-09 359-17-58 179-18-03 359-17-57

BS 102 00-00-16 180-00-11 00-00-12 180-00-12

T@ 401 179-17-53 179-17-47 179-17-51 179-17-45

179-17-49

Dist 401-402 91-39-54 268-19-49 268-19-58 112.849 112.801

Dist 42-401 88-26-00 271-34-02 271-34-02 112.837 112.795

ES 403 178-44-17 358-44-12 178-44-10 358-44-12

BS 401 00-00-30 180-00-28 00-00-29 180-00-27

T@ 402 178-43-47 178-43-44 178-43-45 178-43-46

178-43-45

Dist 402-418 90-19-30 289-40-20 289-40-25 150.651 150.617

Dist 418-402 87-45-00 270-15-10 270-15-05 150.656 150.655

JMR 11/25/85

snow, cold, calm

PETR CO G. Kisko

Grunt G. Robertson

BPR = 29.7 ECF = -3

Temp = 15°F @ 9:00 AM

T2 S/N 265184

Red/A S/N 4863

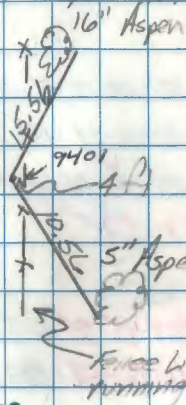

STA 401 = 60d spike

112.798

370.07R

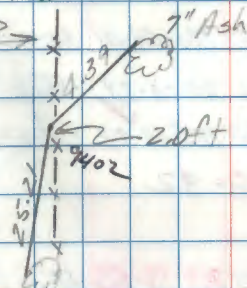
Fence line
running N+S

2.0ft STA 402 = 60d spike

150.637 7" Elm

494.21R

T143N R26W

Traverse cont'd from pg. 19

STA 1st HXD 2nd HXD 3rd HXD 4th HXD

4A

FS 404 181-28-12 01-28-07 181-28-15 01-28-05

BS 402 00-00-14 190-00-10 00-00-11 190-00-12

T@ 403 181-27-58 181-27-57 181-28-04 181-27-53

181-27-58

Dist 403-404 90-10-00 269-49-50 269-45-55 225.367 225.366

Dist 404-403 89-53-02 270-06-58 270-06-58 225.367 225.367

FS 405 175-48-58 355-48-52 175-49-01 355-48-54

BS 403 00-00-25 180-00-22 00-00-29 180-00-20

T@ 404 175-48-33 175-48-30 175-48-32 175-48-34

175-48-32

Dist 404-405 91-20-10 268-39-55 268-39-53 121.466 121.433

Dist 405-404 89-45-43 271-14-26 271-14-22 121.455 121.427

✓ JAR 11/29/85

Nov 23, 1985

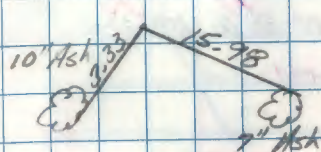

STA 403 = 60d spike
Fence corner south
10 ft ± (9403)

225.366 16" Aspen

739.39 ft

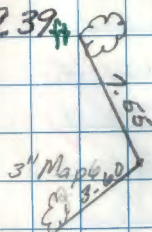

STA 404 = 60d Spike

121.436

398.39 ft

T143N - R26W

Traverse cont'd from pg 20

STA 1st H&D 2nd H&R 3rd H&D 4th H&R

HX

FS 406	180-38-22	00-38-12	180-38-17	00-38-04
BS 404	00-00-25	180-00-07	00-00-11	180-00-07
TA 405	180-37-57	180-38-05	180-38-16	180-37-57
		180-38-01		

Dist 405-406 90-05-33 269-54-19 269-54-23 381.999 381.999

Dist 406-405 89-56-06 270-03-45 270-03-50 382.005 382.008

FS 407 180-01-24 00-01-17 180-01-19 00-01-14

BS 405 00-00-22 180-00-11 00-00-14 180-00-15

TA 406 180-01-02 180-01-06 180-01-05 180-00-59

180-01-03

Dist 406-407 90-15-02 269-44-21 269-44-24 415.968 415.965

Dist 407-406 89-45-55 270-13-53 270-13-59 415.972 415.969

JDR 11/29/85

Nov 23, 1985

3" Elm

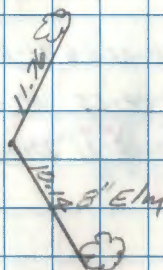

STA 405 = bad spike

set VA cor from here

352.003 1253.29 ft

7" Aspen

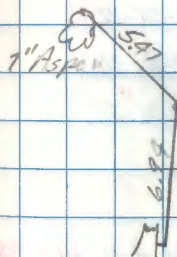

STA 406 = bad spike

415.969

1364.72 ft

T143N R26W

Traverse cont'd from pg 21

STA 1st H&D 2nd H&D 3rd H&D 4th H&D

H&D

FS 408 271-03-~~40~~³⁸ 91-03-26 271-03-26 91-03-28BS 406 00-00-~~37~~²¹ 180-00-18 00-00-25 180-00-11TQ 407 271-03-~~28~~¹⁷ 271-03-08 271-03-11 271-03-17

271-03-13

Dist 407-408 90-02-40 269-57-21 269-57-21 268.917 268.917

Dist 408-407 90-00-00 269-59-51 269-59-51 268.909 268.909

FS 409 180-35-28 00-35-22 180-35-30 00-35-22

BS 407 00-00-31 180-30-29 00-00-35 180-00-39

TQ 408 180-34-57 180-34-53 180-34-55 180-34-50

180-34-54

Dist 408-409 89-54-39 270-05-23 270-05-22 174.886 174.886

Dist 409-408 90-09-06 269-50-53 269-50-54 174.887 174.886

1 MR 11/29/85

Nov 23, 1985

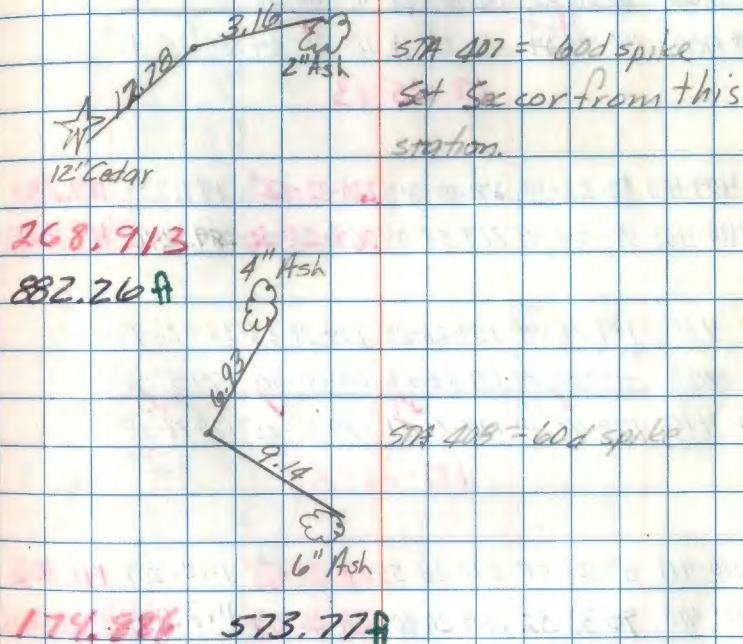

T/43N R26W

Traverse Cont'd from pg. 22

STA 1st H&O 2nd H&R 3rd H&O 4th H&R
H&A

FS 410 180-25-~~46~~⁴⁹ 00-25-42 180-25-~~50~~⁴⁹ 00-25-39

BS 408 00-00-~~27~~²³ 180-01-31 00-00-~~26~~²³ 180-00-26

π@ 409 180-25-~~34~~^{12.6} 180-25-11 180-25-~~24~~²³ 180-25-13

180-25-13

Dist 409-410 89-55-44 270-03-34 270-03-55 189.231 189.231

Dist 410-409 90-07-45 269-52-04 269-52-10 189.240 189.240

FS 411 179-26-~~40~~²⁸ 359-26-25 179-26-25 359-26-17

BS 409 ~~00-00-21~~³⁵⁹⁻⁵⁹⁻⁵⁴ 179-59-56 00-00-00 179-57-48

π@ 410 179-26-~~39~~³⁴ 179-26-~~21~~²⁷ 179-26-25 179-26-29

179-26-29

Dist 410-411 89-31-00 270-28-55 270-28-58 142.207 142.202

Dist 411-410 90-33-52 269-26-10 269-26-09 142.208 142.201

JMA 11/29/85

Nov. 25, 1985

π π □ G. Robertson
Aid B. Ausk

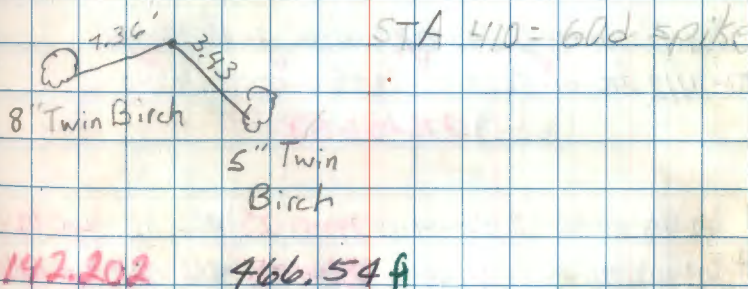
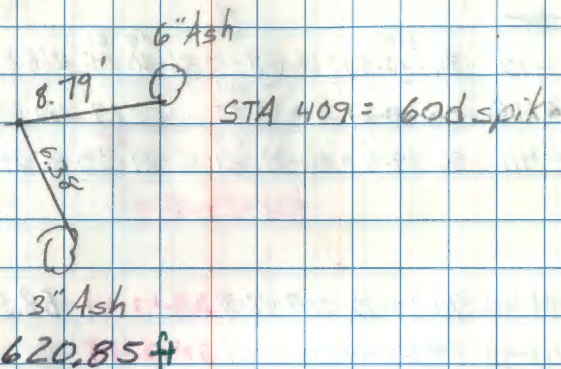

T143N R26W

Traverse Cont'd from Pg 23

STA 1stHAD 2ndHAR 3rdHAD 4thHAR
HX

~~FS 412~~
 FS 412 86-30-07 266-29-44 86-30-05 266-29-54
 BS T@ 410 00-00-27 80-00-25 00-00-27 80-00-16
 T@ 411 86-29-40 86-29-21 86-29-38 86-29-33
 86-29-39

Dist 411-412 70-17-12 269-42-34 269-42-41 68.546 68.545
 Dist 412-411 89-53-44 270-06-11 270-06-14 68.533 68.538

FS 413 276-02-19 96-02-12 276-02-15 96-02-15
 BS 411 00-00-23 180-00-14 00-00-20 180-00-14
 T@ 412 276-01-56 276-01-58 276-01-55 276-02-01
 276-01-58

Dist 412-413 89-45-32 270-14-15 270-14-22 406.027 406.024
 Dist 413-412 90-14-17 269-45-36 269-45-40 406.025 406.022

J, OR 11/29/85

Nov. 25, 1985

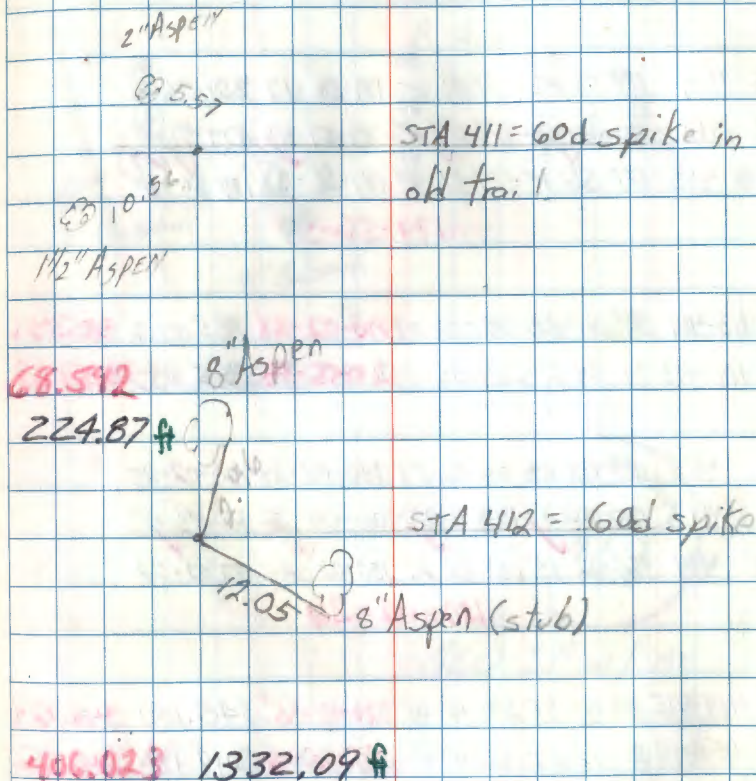

T. 143 N. R. 26 W.

Traverse Cont'd from Pg 24

STA 1st H&O 2nd H&R 3rd H&O 4th H&R
H&R

FS 414	179-56-22 ⁰⁹	259-56-22 ⁰⁰	179-56-17 ⁵	359-56-18 ⁰⁰
BS 412	259-59-33	179-58-45	257-59-44	179-59-23
TA @ 413	179-56-14 ³⁶	179-56-41 ⁴⁰	179-56-33 ³⁷	179-56-14 ³⁷

179-56-37

Dist 413-414 89-57-28 270-02-29 270-02-28 385.026 385.026
Dist 414-413 90-04-23 269-55-39 269-55-38 385.032 385.032

FS 415	180-02-38	00-02-29	180-02-38	00-02-29
BS 413	00-00-23	180-00-08	00-00-18	180-00-07
TA @ 414	180-02-15	180-02-21	180-02-20	180-02-22

180-02-20

Dist 414-415 89-49-35 270-10-45 270-10-35 348.130 348.128
Dist 415-414 90-12-25 269-47-29 269-47-32 348.130 348.128

JJA 11/29/85

Nov. 26, 1985

BPR = 29.6 Temp = 22°F

@ 10:30 E.C.F. = -1

G. Robertson P.C.

G. Kosenko L.S.I.T. T&R

B. Avsk

STA 413 = 60d spike

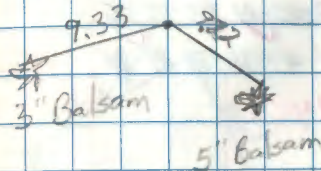

385.029 1263.22A

STA 414 =

T. 143 N. R. 26 W.
 575.8
 5.18 5.17
 1923

GLO IP W / BC

348.128 1142.150A

T.143 N. R.26W.

Traverse Cont'd from Pg 25

STA 1stH20 2ndH4R 3rdH4O 4thH4R

H4

FS 416 179-49-41 359-49-36 179-49-41 359-49-36

BS 414 00-00-22 180-00-09 00-00-22 180-00-09

T@ 415 179-49-24 179-49-24 179-49-24 179-49-24

179-49-24

D.S. 415-416 90-20-39 269-39-16 269-39-19 291.526 291.521

D.S. 416-415 89-41-52 270-18-12 270-18-10 291.514 291.510

FS 417 180-27-23 00-27-14 180-27-12 00-27-09

BS 415 00-00-16 180-00-08 00-00-16 180-00-04

T@ 416 180-27-07 180-27-06 180-27-06 180-27-05

180-27-06

D.S. 416-417 90-03-33 269-56-34 269-56-31 165.099 165.099

D.S. 417-416 90-00-40 267-59-27 267-59-27 165.106 165.106

Nov 26, 1985

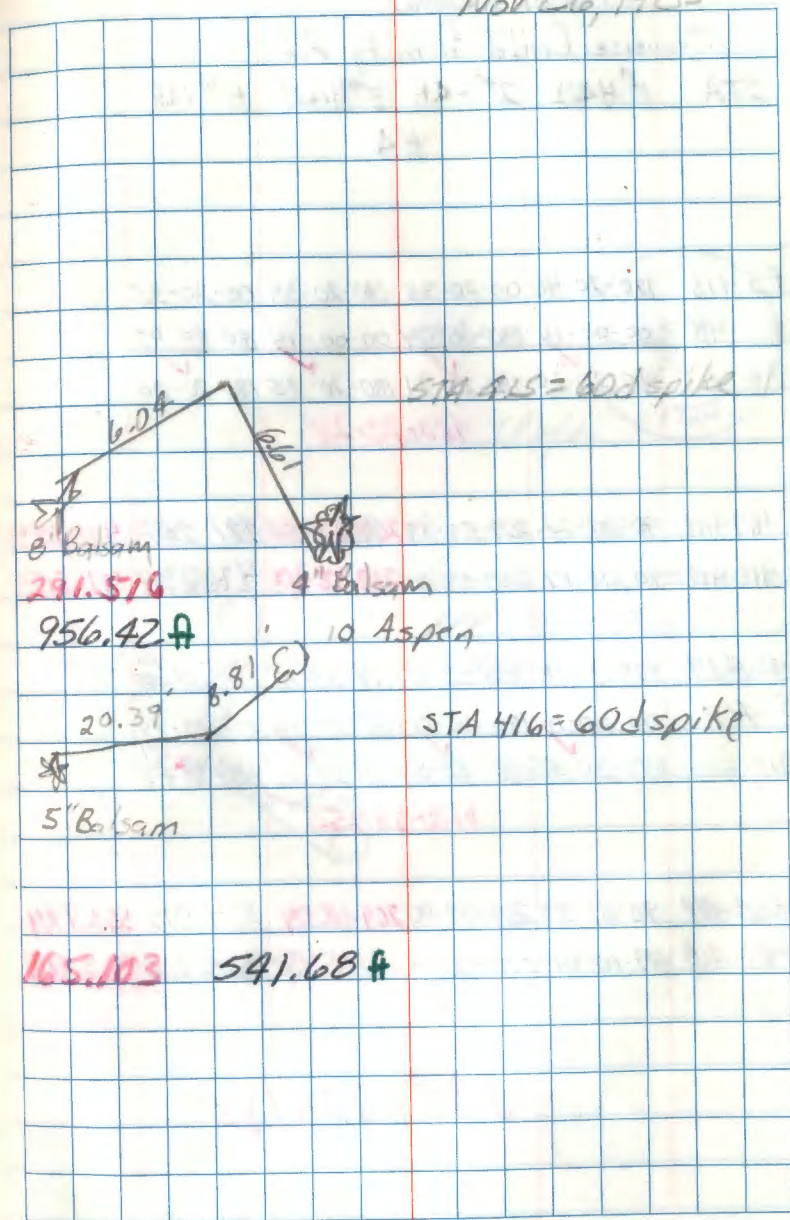

T143 N R26 W

Traverse Cont'd from Pg 26

STA 1st H&R 2nd H&R 3rd H&R 4th H&R

HA

FS 415 180-20-40 00-20-35 180-20-39 00-20-35

BS 416 00-00-14 180-20-04 00-00-14 180-00-05

TR 417 180-20-26 180-20-31 180-20-25 180-20-30

180-20-28

Dist 417-418 90-00-22 269-59-37 269-59-38 471.254 471.254

Dist 418-417 90-01-17 269-58-42 269-58-43 471.254 471.254

FS 419 179-39-09 259-38-54 179-39-15 359-39-10

BS 417 00-00-14 180-00-00 00-00-14 180-00-19

TR 418 179-38-55 179-38-54 179-38-59 179-38-56

179-38-55

Dist 418-419 90-51-53 269-08-00 269-08-04 334.012 333.974

Dist 419-418 89-10-07 270-49-44 270-49-49 334.002 333.967

JHR 11/29/85

Nov. 26, 1985

STA 417 =

S. 8

S. 17

1922

BLO. IPW/OC

471.254 1546.114 Nov 27, 1985

12" Aspen

Same crew as previous day

BPR = 30.0 Temp = 50°F

ELF = @ 9:00 AM

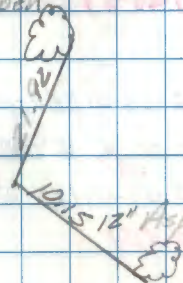

STA 418 = load spike

333.970 1095.70A

28

TK3N R26W

Traverse cont'd from pg 27

STA 1st 44 D 2nd 44 R 3rd 44 D 4th 44 R

44

FS 420 277-31-18 97-31-07 277-31-12 97-30-50

BS 418 00-00-28 180-00-14 00-00-29 180-00-15

T@419 277-30-50 277-30-55 277-30-48 277-30-43

277-30-49

Dist 419-420 90-00-22 269-59-17 269-59-28 62.535 62.535

Dist 420-419 90-10-04 269-49-58 269-49-57 62.541 62.541

FS 421 172-03-27 352-03-16 172-03-21 352-03-07

BS 419 00-00-23 180-00-11 00-00-22 180-00-12

T@420 172-03-04 172-03-05 172-03-09 172-03-58

172-03-04

Dist 420-421 89-52-25 276-07-26 276-07-32 226.824 226.824

Dist 421-420 90-10-42 269-49-23 269-49-21 226.823 226.823

JHP 11/21/85

Nov 27, 1985

28

STA 419 =

GLD IPW/R

TK3N R26W
58 | 59
517 | 516
1922

205.18 ft

A = per

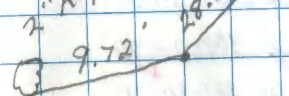

4" B. of G.

STA 420 = 60 d spike

226.823

744.17 ft

T43N R26W

Traverse cont'd from pg 28

STA 1st H&D 2nd H&D 3rd H&D 4th H&E

H&E

FS 422	178-58-09	358-58-01	178-58- ¹³ 14	358-58-01
BS 420	00-00- ³² 29	180-00- ³² 24	00-00- ⁴¹ 23	180-00- ⁴¹ 24
T@ 421	178-57-40	178-57-37	178-57- ⁴¹ 21	178-57-37

178-57-39

Dist 421-422 89-20-21 270-39-40 ~~270-39-40~~ 369.725 369.700Dist 422-421 96-41-33 269-18-26 ~~269-18-27~~ 369.721 369.694

FS 423 181-34-55 01-34-50 181-34-54 01-34-51

BS 421 00-00-³²~~23~~ 180-00-³²~~13~~ 00-00-³²~~18~~ 180-00-³²~~10~~T@ 422 181-34-³²~~32~~ 181-34-37 181-34-³²~~36~~ 181-34-41

181-34-37

Dist 422-423 89-13-15 270-46-40 ~~270-46-43~~ 169.329 169.313Dist 423-422 90-50-43 269-09-11 ~~269-09-14~~ 169.335 169.317

JDR 11/29/85

Nov. 27, 1985

10" Aspen



STA 421 = 60d spike

10" Aspen

369.697 12/2.914

no ties

STA 422 = 60d spike
on road in field

169.315 555.49 f

T143N R26W

Traverse cont'd from pg 29

STA 1st HOR 2nd HOR 3rd HOR 4th HOR

149

BS 424	179-21-51	359-21-44	179-21-53	359-21-47
BS 422	00-00-12	180-00-05	00-00-09	179-59- 51 ⁴³
TP 423	179-21-39	179-21-39	179-21-44	179-21-50

179-21-41

Dist 423-424 89-31-44 270-28-10 ~~270-28-13~~ 267.510 267.501Dist 424-423 90-30-47 269-29-25 ~~269-29-19~~ 267.512 267.501

FS 425 178-21-35 358-21-24 178-21-28 358-21-23

BS 423 00-00-18 180-00-07 00-00-09 180-00-01

TP 424 178-21-17 178-21-17 178-21-19 178-21-22

178-21-19

Dist 424-425 88-27-37 271-32-17 ~~271-32-20~~ 478.746 478.573Dist 425-424 91-33-38 268-26-23 ~~268-26-23~~ 476.728 478.551

JBR 11/29/85

Nov 27, 1985

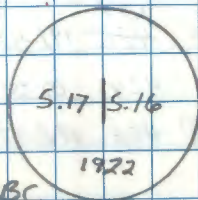

STA 423 =

GLO IP W/BC

267.501 877.63A

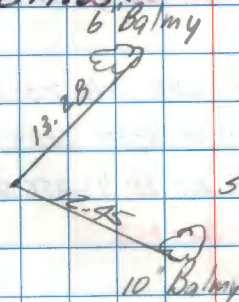

STA 424 = 62d spike

478.562 1570.08 f

T. BEN. R. 26W

Traverse cont'd from pg 30

STA 1st HSD 2nd HSD 3rd HSD 4th HSD

HSD

FS ¹⁰⁹ 426 192-42-50 12-42-34 192-42-50⁴¹ 12-42-36

BS 424 00-00-20 180-00-12 00-00-18 180-00-05

π@ 425 192-42-30 192-42-22 192-42-32 192-42-31

192-42-29

Dist. 425-109 90-37-34 269-22-35 269-22-31 76.626 76.621

Dist. 109-425 89-31-14 270-28-49 270-28-48 76.630 76.627

FS 108 258-33-21 78-33-12 258-33-16 78-33-14

BS 425 00-00-36 180-00-30 00-00-34 180-00-31

π@ 109 258-32-45 258-32-42 258-32-42 258-32-43

258-32-43

END OF THIS

Nov 27, 1985

noties

STA 425 = 60d spike

76.624 251.394

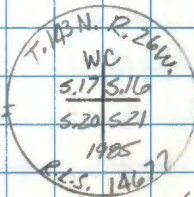

STA 109

Aluminum monument
flush w/ ground

TRAVERSE

TRAVERSE SKETCH

OF SPUR NORTH

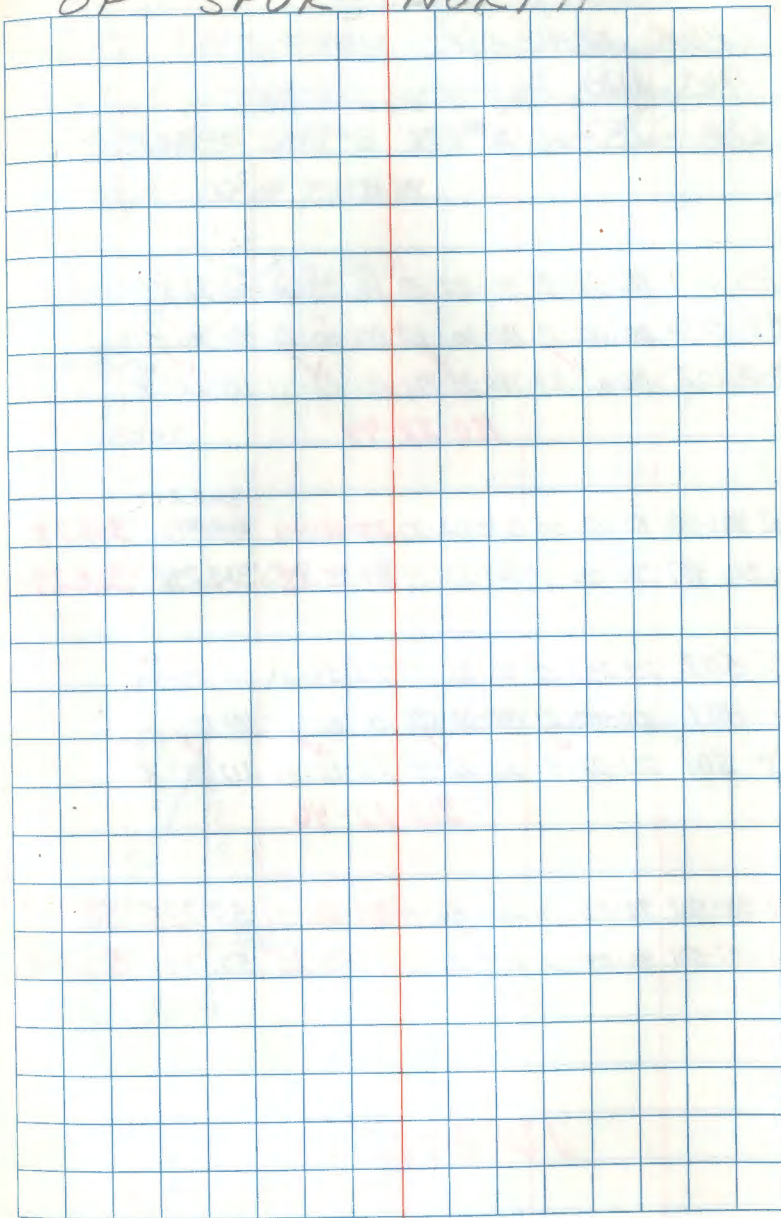

T143N R26W

SPUR TRAVERSE NORTH TO

THE NW Township Corner

STA 1st H&R 2nd H&R 3rd H&R 4th H&R

H&R

FS 501 180-22-59 00-22-53 180-23-00 00-22-53

BS 406 00-00-13 180-00-12 00-00-13 180-00-12

TP @ 407 180-22-46 180-22-41 180-22-47 180-22-44

180-22-44

368.297

Dist 407-501 89-57-00 270-02-27 270-02-44 415.776 368.297

Dist 501-407 90-04-39 269-55-14 269-55-18 368.298 368.298

FS 502 212-23-02 32-22-57 212-23-01 32-23-04

BS 407 00-00-21 180-00-08 00-00-15 180-00-12

TP @ 501 212-22-41 212-22-49 212-22-46 212-22-49

212-22-46

Dist 501-502 90-03-40 269-56-14 269-56-17 50.735 50.735

Dist 502-501 90-09-32 269-50-21 269-50-25 50.741 50.741

JBR 12-9-85

Dec 7, 1985

F-2 SNEZSIB4 Cloudy, mild, calm
Red IA S/N 4883 PC G. Kosenko

RPR = 27.5 ECF = -2 TP @ G. Robertson

Temp = 15° @ 9:00 A.M.

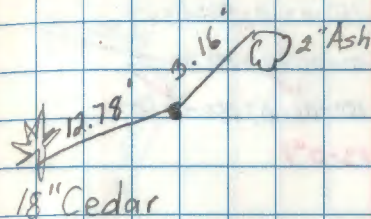

STA 407 = 60d spike

368.297 1208.32 ft

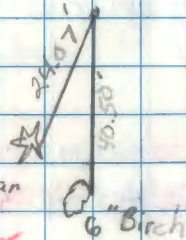

STA 501 = 60d spike

50.738

166.46 ft

T143N R26W

Traverse Cont'd from pg 33

STA 1stH&D 2ndH&R 3rdH&D 4thH&R

HX

FS 503 150-03-36 30-03-31 150-03-31 330-03-29

BS 501 00-00-28 10-00-26 00-00-24 160-00-22

X @ 502 150-03-08 140-03-05 150-03-07 150-03-07

150-03-07

Dist 502-503 89-55-57 270-03-40 270-03-52 401.580 401.580

Dist 503-502 70-05-41 269-54-06 269-54-13 401.571 401.570

FS 504 181-45-54 01-45-45 181-45-51 01-45-41

BS 502 00-00-18 180-00-04 00-00-05 179-59-58

X @ 503 181-45-36 181-45-41 181-45-46 181-45-43

181-45-42

Dist 503-504 90-01-02 269-58-41 269-58-50 443.703 443.703

Dist 504-503 269-59-29 90-00-47 90-00-42 443.704 443.704

1/2R 11-9-85

Dec 7, 1985

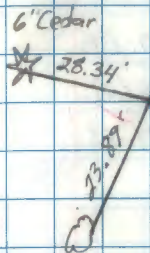

STA 502 = 60d spike

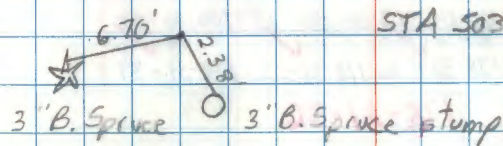
6" Birch
401.575 1317.50f

STA 503 = 60d spike

443.704 1455.72f

Traverse Cont'd from pg 34

STA 1stH4D 2ndH4R 3rdH4D 4thH4R

H4 -

FS 505 181-29-20 01-29-16 181-29-16 01-29-17

BS 503 00-00-20 180-00-14 00-00-15 180-00-09

K@ 504 181-29-00 181-29-02 181-29-01 181-29-08

181-29-03

Dist 504-505 89-42-06 270-17-58 270-17-56 256.198 256.194

Dist 505-504 90-20-37 269-39-21 269-39-22 256.206 256.201

FS 506 178-31-⁴²44 178-31-49 178-31-46 178-31-45BS 504 00-00-⁰⁵24 180-00-13 00-00-13 180-00-09K@ 505 178-31-³⁷28 178-31-36 178-31-33 178-31-37

178-31-36

Dist 505-506 90-35-11 269-24-27 269-24-38 170.058 170.029

Dist 506-505 89-28-31 270-31-04 270-31-17 170.024 170.017

JDR 11-9-85

Dec 7, 1985

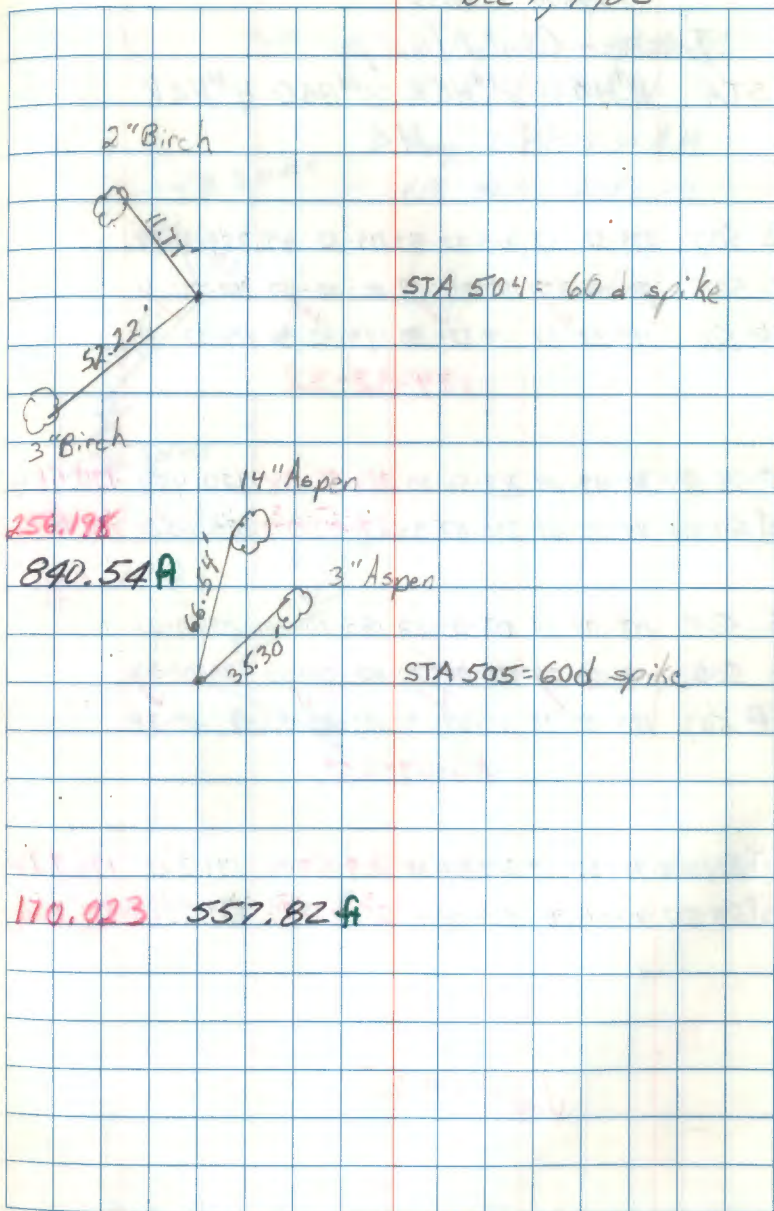

T143N R26W

Traverse Cont'd from pg 35

STA 1stH&D 2ndH&D 3rdH&D 4thH&D
H4

FS 507 179-32-52 359-32-47 179-32-47 359-32-48

BS 505 00-00-20 180-00-17 00-00-17 180-00-11

π@ 506 179-32-32 179-32-30 179-32-30 179-32-37
179-32-32

Dist 506-507 90-09-14 269-50-30 269-50-38 120.454 120.454

Dist 507-506 89-56-21 270-03-15 270-03-27 120.452 120.452

FS 508 183-09-55 03-09-58 183-10-06 03-10-01

BS 506 00-00-20 180-00-20 00-00-33 180-00-23

π@ 507 183-09-35 183-09-33 183-09-33 183-09-38
183-09-35

Dist 507-508 90-02-13 269-57-38 269-57-43 171.221 171.221

Dist 508-507 90-01-28 269-58-11 269-58-22 171.226 171.226

✓ JBR 11-9-85

Dec 9, 1985

G. Robertson π π

B. Ausk Aid

Temp: 25°F @ 7:30 A.M.

BPR: 30.0 FCF: -2

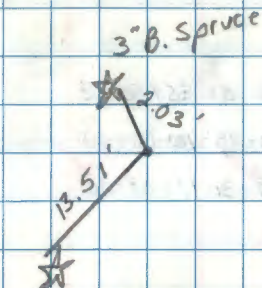

STA 506 = 60d spike

2" B. Spruce

120.453

395.19A

6" B. Spruce

8.48

STA 507 = 60d spike

2.46

5" B. Spruce

171.224

561.76A

T143 N R 26 W

Traverse Cont'd from pg 36

STA 1st H&D 2nd HAR 3rd H&D 4th HAR

H&D

FS 509 177-59-09⁶⁹ 357-58-54 177-58-58 357-58-53BS 507 00-00-37²⁶ 180-00-29²⁶ 00-00-28 180-00-23X@ 508 177-58-32 177-58-28²⁸ 177-58-30 177-58-30

177-58-30

Dist 508-509 90-02-45 269-57-06 269-57-11 280.905 280.805

Dist 509-508 89-59-44 270-00-26 270-00-21 280.799 280.799

FS 510 176-52-57 356-52-82³¹ 176-52-37 356-52-28

BS 508 00-00-31 180-00-04 00-00-07 180-00-04

X@ 509 176-52-26 176-52-48²⁷ 176-52-30 176-52-24

176-52-27

Dist 509-510 89-59-44⁴⁶ 270-00-08 89-59-49 199.598 199.598

Dist 510-509 90-03-50 269-56-03 90-03-54 199.596 199.596

VOK OK 12/11/85

Dec 9, 1985

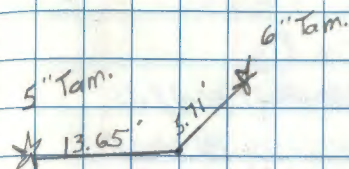

STA 508 = 60d spike

280.802 921.26 ft

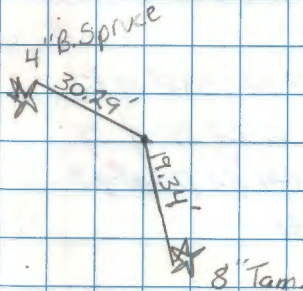

STA 509 = 60d spike

199.597

654.84 ft

T143 NR 26 W

Traverse Cont'd from pg 37

STA 1st HAR 2nd HAR 3rd HAR 4th HAR
HA

FS 511 180-49-53 00-49-43 180-49-47 00-49-43

BS 509 00-00-21 180-00-12 00-00-14 180-00-19

T@510 180-49-32 180-49-31 180-49-33 180-49-29

180-49-31

Dist 510-511 90-13-58 269-45-50 90-14-04 173.798 173.797

Dist 511-510 89-49-48 270-10-06 89-49-51 173.792 173.791

FS 512 178-34-57 358-34-54 178-34-53 358-34-52

BS 510 00-00-21 180-00-22 00-00-24 180-00-25

T@511 178-34-56 178-34-32 178-34-34 178-34-27

178-34-32

Dist 511-512 90-13-08 267-46-52 90-13-08 179.899 179.893

Dist 512-511 89-50-27 270-09-20 89-50-33 179.892 179.891

VOK/ck 12/11/85

December 10, 1995

Cloudy, cool, breeze

T2 SW 265/184

TTP SD PL B. Kasanko

Red 1 SW 4863

Arde- B. Ausk

STA 510 = 60d spike

570.19A

BPR=30.1 ECF=-3

173.794 ✓

Temp = 25°F @ 1200 PM

14" Aspen

12-13

STA 511 = 60d spike

179.892 ✓ 590.20A

T143N R26W

Traverse Cont'd from pg 38

STA 1stH&D 2ndH&D 3rdH&D 4thH&D

H&D

FS 513 180-14-45 00-14-39 180-14-40 00-14-32

BS 511 00-00-15 180-00-05 00-20-11 180-00-07

T @ 512 180-14-30 180-14-29 180-14-29 180-14-25

180-14-28

Dist 512-513 90-04-44 269-54-58 90-04-53 282.100 282.100

Dist 513-512 89-57-18 270-02-25 89-57-27 282.106 282.106

FS 514 181-24-⁰⁶37 01-24-28 181-24-³15 01-24-10BS 512 ³⁵⁹⁻⁵⁹⁻²⁹40-00-08 179-59-96 359-59-34 179-59-30T @ 513 181-24-³⁷29 181-24-42 181-24-41 181-24-40

181-24-40

Dist 513-514 90-03-48 269-56-02 90-03-53 227.361 227.361

Dist 514-513 89-59-00 270-00-43 89-59-09 227.356 227.356

End of TRAVERSE

DEC. 1 1985

KW

Dec 10, 1985

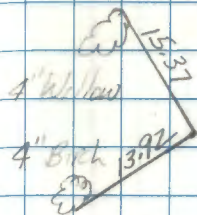

STA 512 = 60d spike
bent over, point is
right on the head

282.103 ✓ 925.53f

4" Tamarack

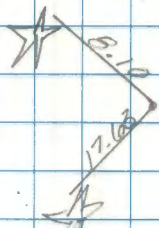

STA 513 = 60d spike
West of trail about
10 feet

4" Tamarack

227.358 ✓ 745.92f

STA 514 =

T143N
R26W
S36|S31
S1|S6
T143N

1937
GLO Concrete Measurement
M/EC See pg 49 Book 3
T143N R26W

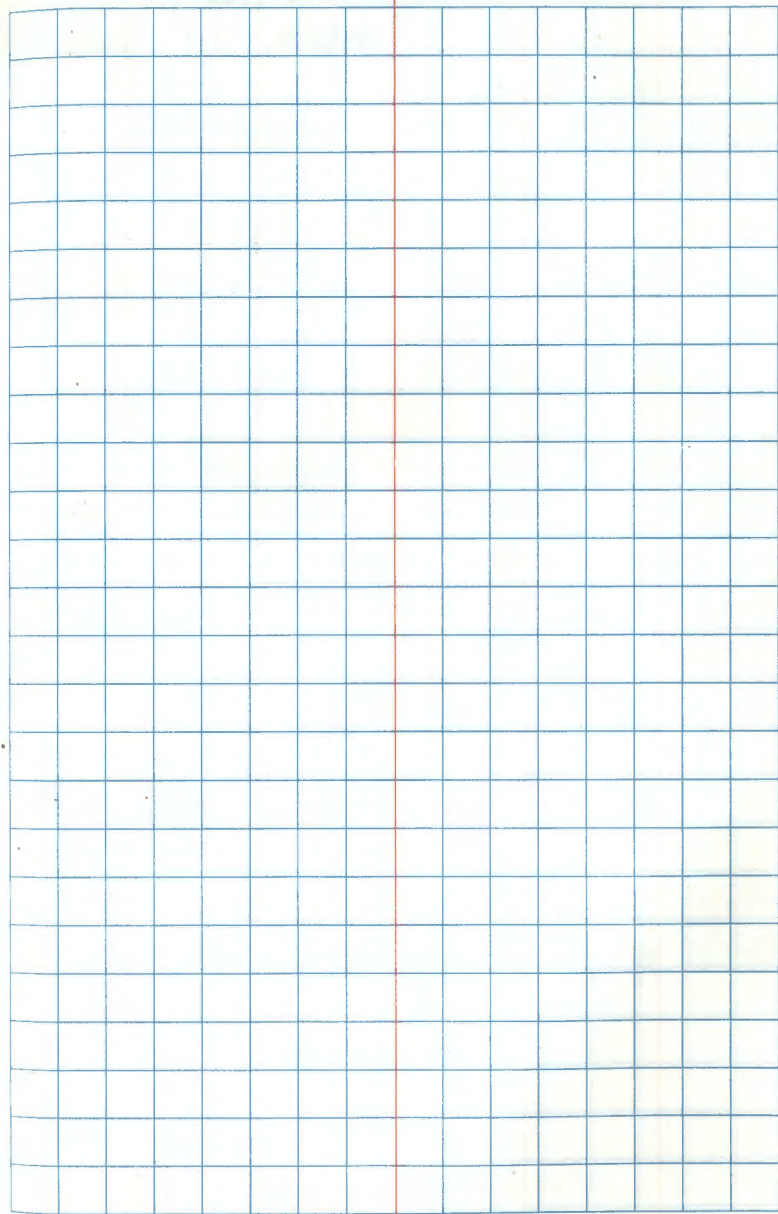
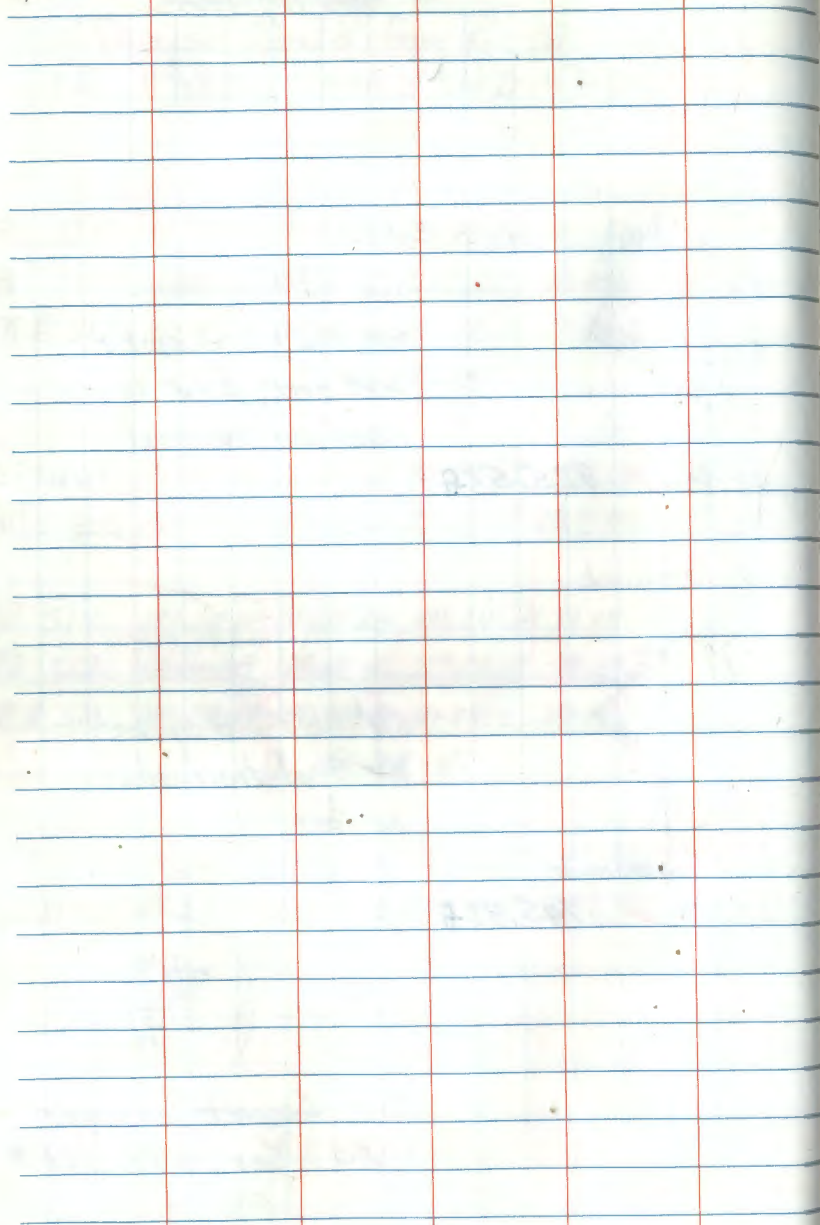

TRAVERSE

interior of

SKETCH

sed's 17 + 18

T193N R26W

Interior traverse of Sections 17 and

18 - From S 1/4 S18 to N4 Sec 18-17

STA 1st H&D 2nd H&R 3rd H&D 4th H&R

H &

FS 601 90-15-12 270-15-02 90-15-10 270-14-59

BS 103 00-00-33 180-00-22 00-00-26 180-00-22

T@ 1816 90-14-39 90-14-40 90-14-44 90-14-37

90-14-40

Dist 1816-601 90-24-16 269-36-04 90-24-06 1168.01 1168.98

Dist 601-1816 89-38-13 270-22-09 89-38-02 1168.97 1168.95

FS 602 180-00-28 10-00-19 180-00-25 00-00-14

BS 1816 00-00-22 180-00-07 10-00-15 180-00-01

T@ 601 180-00-06 180-00-12 180-00-10 180-00-13

180-00-10

Dist 601-602 90-33-22 269-27-03 90-33-10 920.05 920.01

Dist 602-601 89-29-30 270-30-51 270-30-41 920.07 920.03

✓ DR 1/16/85

Jan 13, 1985

Ckly, cld, breeze

T-2 S/W 265180

PC to G. Kasenko

Red 1/A 4863

Aides - G. Robertson

Temp = 10°F @ 9:00 AM T T - B. Aust

BPL = 29.7 ECF = -2 Volunteer - T. Withrow

STA 1816 = S 1/4 S 18

1168.96 ✓

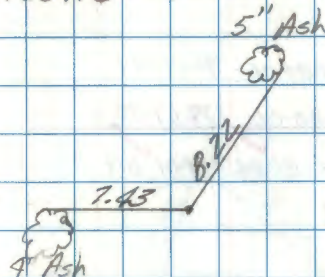

STA 601 = 60d spike

920.02

T143N R26W

Traverse cont'd from page 42

STA 1st H&D 2nd H&R 3rd H&D 4th H&R

H&R

FS 603 180-00-51 00-00-43 180-00-45 00-00-37

BS 601 00-00-24 180-00-16 00-00-15 180-00-06

T@602 180-00-27 180-00-27 180-00-30 180-00-31

180-00-29

Dist 602-603 90-31-04 269-29-10 269-27-03 602.31 602.29

Dist 603-602 89-33-12 270-27-08 270-26-58 602.34 602.32

FS 604 271-01-19¹⁰ 271-01-06 271-01-06 91-01-01BS 602 00-00-19¹⁰ 179-59-55 00-00-00 179-59-52

T@603 271-01-00 271-01-11 271-01-06 271-01-09

~~270-01-08~~
271

Dist 603-604 89-42-16 270-18-05 89-42-05 1124.49 1124.47

Dist 604-603 90-20-21 269-40-10 90-20-06 1124.51 1124.51⁴⁹

✓ DR 1/16/86

622.77
602.34
20.43

January 13, 1986

6" Birch

17.34

STA 602 = 60d spike
EAST OF Forest Road 60+

10.09

January 14, 1986

602.30

Clay, mild, lgt snow
same crew as previous day

BPRE = ELF =

Temp = @ 9:00 AM

STA 603 = 60d spike

c 1/4 5 18

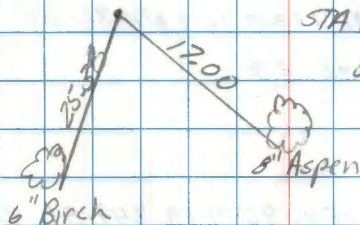

1124.48

Traverse cont'd from pg. 43

STA 1st H&D 2nd H&R 3rd H&D 4th H&R

#2

FS 605 180-00-31 00-00-26 180-00-35 00-00-27

BS 603 00-00-25 180-00-16 00-00-24 180-00-18

T@ 604 180-00-06 180-00-10 180-00-11 180-00-09

180-00-09

Dist. 604-605 88-37-02 271-23-21 88-36-50 1383.57 1383.15

Dist. 605-604 91-24-36 268-35-43 91-24-27 1383.55 1383.13

FS 606 268-36-55 88-36-41 268-36-49 88-36-45

BS 604 00-00-16 180-00-18 00-00-29 180-00-20

T@ 605 268-36-39 268-36-23 268-36-20 268-36-25

268-36-23

Dist. 605-606 90-14-23 269-45-45 90-14-19 349.51 349.51

Dist. 606-605 89-56-37 270-03-44 89-56-27 349.48 349.48

CK BA 1-23-86

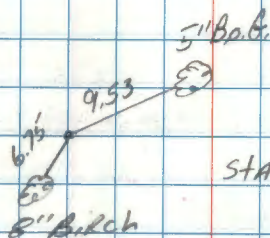

STA 604 = 60d spike

1383.15

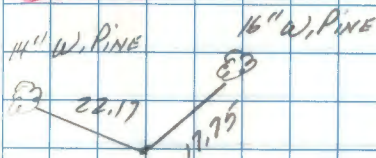
Approx 1/4
STA 605 = 60d spike

349.49

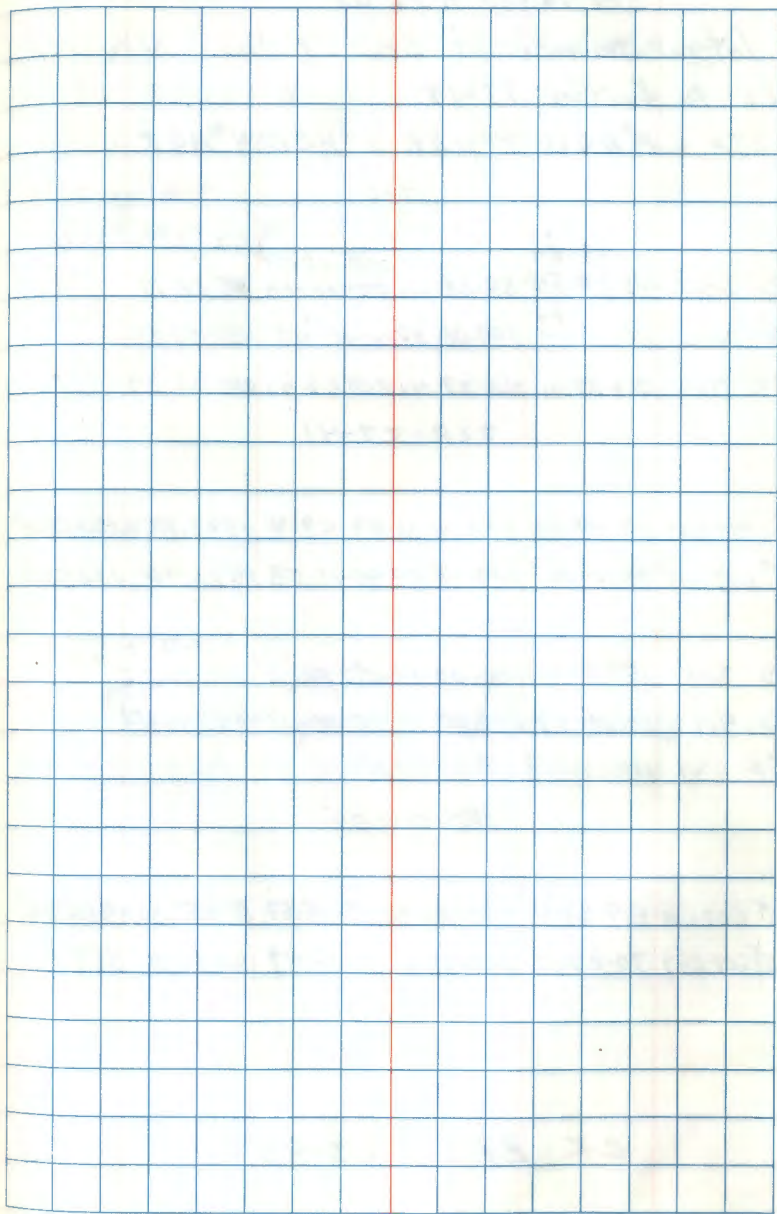

46

T143N R26W

Interior traverse of Sec. 17 from N 1/4 Sec
17 to 1/4 Sec 17+18STA 1st H&D 2nd H&R 3rd H&D 4th H&R
HAFS 607 ~~268-27-55~~²⁸⁻³¹ 88-28-18 ~~00-00-48~~²⁶⁸⁻²⁸⁻²⁹ 88-28-18BS 416 ~~00-00-44~~²⁸ 180-00-37 00-00-48 180-00-39

T@ 417 268-27-41 268-27-41 268-27-41 268-27-39

268-27-41

Dist 417-607 89-49-58 270-10-36 89-49-41 1525.86 1525.85

Dist 607-417 90-12-16 269-48-20 90-11-58 1525.90 1525.89

FS 608 180-00-20 00-00-14 180-00-18 00-00-22

BS 417 00-00-17 180-00-11 00-00-16 180-00-11

T@ 607 180-00-03 180-00-03 180-00-02 180-00-11

180-00-05

Dist 607-608 89-36-18 270-24-24 89-35-57 865.36 865.34

Dist 608-607 90-27-08 269-53-31 90-26-49 865.34 865.31

CK BA 1-23-85

46

1-21-86

B. Aok T@

J. Jackson

T. Withrow

T-2 SW 265184

Red 1A SW 4863

TEMP 5°F

BPR 29.5 ECF -1

1525.87

ED 5' Birch

B. 35 1741

11' Aspen

E

Sta 607 = 60d spike

865.33

T143 N R26 W

Traverse Cont'd from Pg 46

STA 1st H&D 2nd H&R 3rd H&D 4th H&R
H&R

FS 609 180-00-22 00-00-21 180-00-27 00-00-24

BS 607 00-00-17 180-00-16 00-00-21 180-00-18

TP 608 180-00-05 180-00-05 180-00-06 180-00-06
180-00-06

Dist 608-609 89-31-51 270-28-45 89-31-33 1091.63 1091.59

Dist 609-608 90-31-04 269-29-33 90-30-46 1091.62 1091.58

FS ~~608~~¹⁷⁰⁵ 180-00-20 00-00-15 180-00-20 00-00-15

BS 608 00-00-15 180-00-08 00-00-15 180-00-08

TP 609 180-00-05 180-00-07 180-00-05 180-00-07
180-00-06

Dist ~~609-608~~¹⁷⁰⁵ 89-48-18 270-12-15 89-48-01 599.16 599.16Dist ~~608-609~~¹⁷⁰⁵ 90-16-06 269-44-31 90-15-48 599.14 599.13

CK BA 1-23-85

1-22-86

SAME CREW plus

G. ROBERTSON

Temp 10°F

BAR 30.0

EOP -2

7" BoG.

E3

5.13

6.65

E3

6" BoG.

1091.59

13" ASPEN

E3

15.15

5" Birch

E3

17.62

STA 609 = 60d spike

599.15

T143N R26W

TRAVERSE Cont. from Pg 47

STA 1st H&D 2nd H&R 3rd H&D 4th H&R

HA

FS 611 271-38-20³⁰ 91-38-22 271-38-27 91-38-23BS 609 00-00-24³¹ 180-00-26 00-00-30 180-00-29T@ 610¹⁷⁰⁵ 271-37-59 271-37-56 271-37-57 271-37-54

271-37-57

Dist. 610¹⁷⁰⁵-611 89-16-28 270-44-12 89-16-08 609.17 609.12Dist. 611¹⁷⁰⁵-610 90-47-41 269-12-36 90-47-33 609.16 609.11

FS 612 180-00-19 00-00-14 180-00-15 00-00-11

FS 611¹⁷⁰⁵ 00-00-19 180-00-10 00-00-14 180-00-07

T@ 611 180-00-00 180-00-04 180-00-01 180-00-04

180-00-02

Dist. 611-612 90-06-27 269-53-51 90-06-18 1014.29 1014.29

Dist. 612-611 89-56-14 270-04-11 89-56-02 1014.26 1014.26

CK BA 1.23.85

E+W FENCE is 92'±

North of CORNER

Approx. CS 1/4 1705

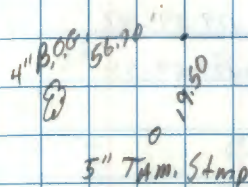
STA 610¹⁷⁰⁵ = 60d spikeThis Point Falls IN
IMPoundMENT

5" Tam. Stamp

609.12

4" Barb



5" Apple

21.10'

STA 611 = 60d spike

1014.27

TRAVERSE Cont From Pg 48

STA 15 H&D 2nd H&R 3rd H&D 4th H&R

H&

FS 1719 180-00-02 359-59-57 180-00-03 359-59-55

BS 611 00-00-04 179-59-57 00-00-03 179-59-57

T@ 612 ~~179-59-58~~ 180-00-90 180-00-00 179-59-58

179-59-59

Dist. 612-1719 89-41-39 270-18-52 89-41-24 932.78 932.77

Dist. 1719-612 90-04-03 267-56-25 90-03-49 932.73 932.73

FS 606 267-10-44 87-10-39 267-10-44 87-10-40

BS 612 00-00-23 180-00-23 00-00-24 180-00-23

T@ 1719 267-10-21 267-10-16 267-10-20 267-10-17

267-10-19

Dist 1719-606 89-05-40 270-54-42 89-05-29 1005.63 1005.50

Dist. 606-1719 90-43-22 267-17-05 90-43-09 1005.55 1005.47

CK BA 1-23-85

1-23-85 49

B. AUSA T T T

G. ROBERTSON

Temp -10°F

BAR 30.1

ECF -3

25.73 • 12.85

5" W OAK

932.75

11" ASPEN

1" CHERRY TREE

25.65

45.94

2" ASPEN

1005.49

STA 612 = 60 d spike
E & W FENCE is NORTH 9.7'

Approx 5 1/16
STA 1719 = 60 d spike
N + S Woods line
is 146' East of STA
FENCE CORNER which
RUNS East + North is
44' South of Property
LINE

TRAVERSE Cont from Pg 49

STA 1st HAD 2nd HAR 3rd HAD 4th HAR
HX

FS 605 180-00-43 00-00-37 180-00-43 00-00-33

BB 1719 00-00-18 180-00-12 00-00-18 180-00-11

TC 606 180-00-25 180-00-25 180-00-25 180-00-22

180-00-24

Dist. 606-605 SEE Pg 44 this book

END OF TRAVERSE

10.75 2" ASPEN
13.20 1/2" ASPEN
Sta 606 = 60d spike
From Sta 606 East to
Woods line is 157'
From 605 South to
Woods line is 87'

T143K R26W

INTERIOR TRAVERSE OF SECTION 18

starting from NE Sec Cor.

STA	1 st H&D	2 nd H&R	3 rd H&D	4 th H&R
				HX

FS 613 267-35-38 87-35-29 267-35-38 87-35-29

BS 413 00-00-29 180-00-32 00-00-43 180-00-31

TP 414 267-35-09 267-34-57 267-34-55 267-34-58

267-35-00

Dist	613	89-29-54	270-30-32	270-30-19	846.92	846.89
Dist	613	90-33-36	269-27-19	269-26-52	846.90	846.86

FS ~~613~~ 180-00-27 00-00-21 180-00-27 00-00-21

BS 414 00-00-20 180-00-24 00-00-18 180-00-05

TP 613 180-00-07 180-00-17 180-00-09 180-00-16

180-00-12

Dist 613-614 88-11-22 271-49-37 271-49-08 509.39 509.13

Dist 614-613 91-54-02 268-06-47 268-06-23 509.39 509.11

OK BA 2-4-86

Temp +10°F Hy = 29.4

Jan 28, 1986

ECF = -3

G. Robertson TX →

B. Ausk

T. Withrow

J. Jackson

846.87

10.00

4" B. FG

16.08

4" Birch

STA 613 = 16d nail
in 13' Aspen stump

509.12

T143N R26W

TRAVERSE CONT. FROM Pg. 52

STA 1st HD 2nd HD 3rd HD 4th HDH₃FS ~~614~~ ⁶¹⁵ 271-09-4³⁶ 271-09-32 271-09-4³⁷ 271-09-31BS ~~613~~ ⁶¹⁴ 00-00-2³⁷ 180-00-32 00-00-2⁴³ 180-00-37TP ~~614~~ ⁶¹⁵ 271-09-1⁰⁸⁻⁵⁷ 271-09-00 271-09-0⁰⁸⁻⁵⁶ 271-09-54

271-09-57 ✓

Dist ~~615~~ ⁶¹⁶ 91-13-45 268-47-25 268-46-50 643.57 643.42Dist ~~64~~ ⁶¹⁵ 98-50-56 270-59-57 .9998 643.56 643.45FS ~~615~~ ⁶¹⁶ 180-00-19 00-00-18 180-00-27 00-00-20BS ~~614~~ ⁶¹⁵ 00-00-20 180-00-15 00-00-20 180-00-18TP ~~614~~ ⁶¹⁵ 179-59-59 180-00-03 180-00-07 180-00-02

180-00-03 ✓

Dist ~~615-616~~ ⁶¹⁶⁻⁶¹⁵ 90-42-36 289-18-07 90-42-15 606.14 606.09Dist ~~616-615~~ ⁶¹⁵⁻⁶¹⁶ 28-41-05 87-10-11 89-19-33 606.13 606.09

CK BA 2-4-86

Jan 28, 1986

8" Birch

10.14

25.03 STA 1721 = 60d spike

5" Birch

Jan 29, 1986

G. Robertson, B. Ausk,
D. Ojanen, + T. Withrow

643.44

5" Aspen

17.99

5" Balsam

10.55

STA 614 = 60d spike

606.09

Traverse Cont'd from Pg 53

Sta 1st H&D 2nd H&R 3rd H&D 4th H&R

FS 617	269-01-58	89-01- 34 ⁵⁷	269- 01-34 ⁰²⁻⁰³	89-01-55
BS 615	10-00-20	180-00- 15 ¹²	00-00- 14 ²¹	180-00-17
T@616	269-01-38	269-01- 31 ⁴⁵	269-01- 27 ⁴²	269-01-38
		269-01-41 ✓		

616-617	99-21-32	269-30-11	90-21-10	1086.76	1086.14 ✓
Dist 617-616	89-43-07	270-17-40	89-42-44	1086.18	1086.15 ✓

FS 618	180-00-07	359-59-50	180-00-14	359-59-55
BS 616	00-00-15	180-00-11	00-00-16	180-00-09
T@617	179-59-52	179-59-39	179-59-48	179-59-46
		179-59-46 ✓		

Dist 617-618	90-09-41	269-51-13	90-09-14	264.65	264.65 ✓
Dist 618-617	89-59-32	270-01-17	89-59-07	264.67	264.67 ✓

CKBA 2-4-86

STA 1802 = 60d spike

Jan 30, 1986

Clear, cold, calm

PC G. Robertson

TTR G. Kosenko

J. Jackson

T. Whitrow

STA 617 = 60d spike

B. Ausk

264.66

09-4-5

Traverse cont'd from pg 54

Sta 1st H&R 2nd H&R 3rd H&R 4th H&R
H&RFS 619 90-~~44-26~~⁴⁵⁻⁰⁶ 270-44-55 90-45-06 270-45-01BS 617 10-00-~~13~~¹⁰ 180-00-05 00-00-09 180-00-03TP 618 90-~~44-13~~⁵⁶ 90-44-50 90-44-57 90-44-58
90-44-55

1824

Dist 618-619 90-08-30 269-52-13 90-08-09 1245.09 1245.09

Dist 619-618 89-54-08 270-06-38 89-55-45 1245.12 1245.12
1824

FS 412 213-21-27 33-31-17 213-31-25 33-31-17

BS 618 10-00-19 180-00-13 00-00-22 180-00-12

TP 617 213-31-08 213-31-04 213-31-03 213-31-05
213-31-05 ✓

END OF THIS TRAVERSE

CK BA 2-4-86

Jan 30, 1986

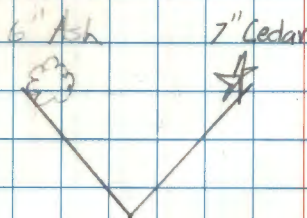
STA 618 = 60d spike
Approx E 1/4 S 18

1245.10

N 1/4 S 18

STA 617 = 60d spike

TRAVERSE SKETCH

AROUND

W 1/2 NW 1/4

SECTION 18

Interior traverse around W^{1/2} NW ^{1/4}

Sector 1B

STA 1st H&D 2nd H&R 3rd H&D 4th H&R

H &

FS 701 22-40-10 202-40-04 ²²~~202-40-09~~ 202-39-57

BS 409 00-00-20 180-00-05 00-00-16 180-00-00

TK@ 1823 22-39-50 22-39-59 22-39-53 22-39-57

22-39-55

Dist 1823-700 89-52-47 270-08-04 270-07-39 1485.80 1485.80

Dist 700-1823 90-10-20 269-50-08 90-10-06 1485.80 1485.79

FS 1807 180-00-24 ^{3 or 5?} 360-00-18 180-00-25 360-00-17

BS 1823 00-00-20 180-00-25 00-00-22 180-00-20

TK@ 701 180-00-04 179-59-55 180-00-03 179-59-59

180-00-00

Dist 701-1807 89-46-26 270-13-40 270-13-37 1195.08 1195.07

Dist 1807-701 90-15-54 269-48-12 90-13-51 1195.14 1195.13

CK BA 2-4-86

1485.80

4" Ash

4" Ash

11.40

13.01

1195.10

STA 1823 = 60d spike

Feb 3, 1986 Temp. = 30°F

G. Robertson TK@ 1823

B. Ausk

T. Withrow

STA 701 = 60d spike

TX43N R26W

Interior traverse cont'd from pg 57

STA 1st H&D 2nd H&R 3rd H&D 4th H&R

H&R

FS 1820	270-51- 48 ⁴⁰	90-51-28	270-51-38	90-51-31
BS 701	00-00- 21 ²³	180-00-70	00-00- 16 ²²	180-00-22
TA 1807	270-50- 31 ¹⁷	270-51- 08 ⁰⁸	270-51- 22 ¹⁶	270-51-09
	270-51-13 ✓			

Dist 1807-1809 70-11-52 70-48-26 90-11-43 1201.24 1201.23 ✓

Dist 1809-1807 89-50-36 270-10-00 89-50-18 1201.26 1201.26 ✓

FS 405 121-06-~~09~~¹⁵ 301-06-19 121-06-13 301-06-18BS 1807 00-00-~~20~~¹⁶ 180-00-16 00-00-~~28~~¹⁹ 180-00-16TA 1820 121-05-~~42~~⁵⁷ 121-05-~~03~~⁰⁶ 121-05-54 121-06-02

121-06-00 ✓

END TRAVERSE

CK BA 2-4-86

Feb 3, 1986

STA 1807 = 16d nail in
6" Ash stump

1201.24

59 T143N R26W

Tie in Property Corners
ON County Road #135

STA 1st H&D 2nd H&R
H&R

FS 1818 339-05-00 ⁶⁷⁸ 318-10-00

BS 101 00-00-00 339-05-00

T@ 102 339-05-00 339-05-00

Chained Dist 27.12'

FS 1816 240-31-45 ¹²¹⁻⁰³⁻⁵⁰ 121-03-00

BS 103 00-00-00 240-31-45

T@ 104 240-31-45-240-31-45

240-31-80

chained Dist 17.38'

NW COR S 31

FS 3018 0-00-00 171-58-42

BS 80 265-59-18 265-59-18

T@ 81 265-59-18 265-59-24

265-59-21

81 to 3018 92.77 chained

6 MAR 86

(10)

2-19-86 59

L147 T-60 SW 15882.7

B. Ausk

G. Robertson

T. J. Thron

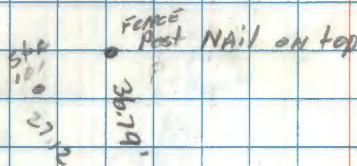

SW S 18 11'

STA = PK NAIL

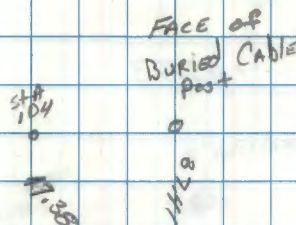

S 1/4 S 18 11'

STA = PK NAIL

SE Cor Sec 31

5-7-86

FS 3218 149 24 51 329-~~28-28~~²⁵⁻⁰¹

Whitehorn

BS 56 0-00-07 180-00-16

Ausk

T@ 57 149-24-44 149-24-45

149@24'44.5"

7.00 feet chained

T143 N REG

Tie in Property CORNERS
ON County Rd # 135 & #4
STA 1st H&D 2nd H&R

FS 1716 88-19-35 176-39-20

BS 106 00-00-00 88-19-35

T@ 107 88-19-35 88-19-35

88-19-35

Chained Dist. 43.53

FS 3016 253-30-10 ⁵⁰147-00-25

BS 211 00-00-00 253-30-10

T@ 212 253-30-10 253-30-15

253-30-12.5

Chained Dist. 20.39

FS Cor. 3108-04 211-06-01 NEAR E $\frac{1}{4}$ S18

BS 605 00-00-22 180-00-19

T@ 606 31-07-42 31-07-42

Dist. 606 Cor 70-49-10 269-11-96 308.89

2-19-86

2" Aspen

2" Aspen

5.51

5.47
8.78S $\frac{1}{4}$ S17

STA = 60 d spike

3" withood

5" Aspen

26.82

13.32

N $\frac{1}{4}$ S31

STA = 60 d spike

2-26-86

B. AUST

G. ROBERTSON

T. WITHWOOD

Traverse Sketch Interior of

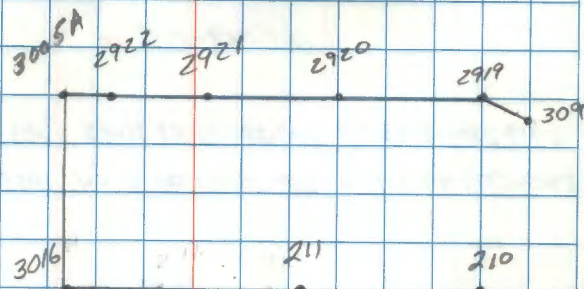

62

T143N R26W

TRAVERSE Interior SEC 30

Sta 1st H&R 2nd H&R 3rd H&R 4th H&R

FS 2920 166-49-26 346-49-13 166-49-20 346-49-08

BS 309 00-00-20 180-00-10 00-00-12 180-00-07

X @ 2919 166-49-06 166-49-03 166-49-08 166-49-01

166-49-05 ✓

Dist 2919-2920 89-32-07 270-28-43 89-31-42 1035.76 1035.72

Dist 2920-2919 90-31-09 269-29-41 90-30-44 1035.74 1035.78

FS 2921 180-00-20 00-00-13 180-00-22 00-00-15

BS 2919 00-00-12 180-00-09 00-00-19 180-00-11

X @ 2920 180-00-04 180-00-04 180-00-03 180-00-04

180-00-04 ✓

Dist 2920-2921 89-42-41 270-18-46 89-41-57 850.46 850.45

Dist 2921-2920 90-21-04 269-37-52 90-20-36 850.44 850.42

CK BA 2-25-86

62

2-20-86

T-2 SN 265184

TEMP 5°F Red 1A

BPR 29.8

ECF -3

B. Ausk TTR

G. Robertson

T.W. Thro

9" Aspen

E3

1535

4" Aspen

E3

1666

Sta 2919 = Godspike

1085.71 ✓

7 maple

E3

2902

4" willow

E3

1.98

2-21-86

B. Ausk TTR

G. Robertson

D. MAKI

D. Ojanev

850.43 ✓

T143N R26W

TRAVERSE Cont. from Pg 62

STA 1st H&D 2nd H&R 3rd H&D 4th H&R

2922					
FS 3005	190-00-33	00-00-30	180-00-36	00-00-27	
BS 2920	00-00-25	180-00-21	00-00-30	180-00-24	
T@ 2921	180-00-08	180-00-09	180-00-06	180-00-03	
		180-00-07			

Dist ²⁹²² 2921-3005	90-29-24	267-32-36	90-27-54	509.90	509.88
Dist ²⁹²² 3005-2921	89-37-05	270-23-51	89-36-37	509.87	509.86

FS 3005*	180-00-24	00-00-15	180-00-25	00-00-16	
BS 2921	00-00-16	180-00-11	00-00-19	180-00-13	
T@ 2922	180-00-08	180-00-04	180-00-06	180-00-03	
		180-00-05			

Dist. 2922-3005	92-14-20	267-46-41	92-13-49	152.96	152.84
Dist. 3005-2922	88-38-10	271-22-42	88-37-44	152.91	152.87

LK BA 2-25-86

4' Basswood

E

S

STA 2921 = 60 d spike

6" Ash

509.87 ✓

6" Balmy

5" Ash

E

S

2929

152.86 ✓

64

T143N R26W

TRAVERSE Cont from Pg 63

STA 1st H&D 2nd H&R 3rd H&D 4th H&R

H&S

FS 3016 86-27-40 266-27-30 86-27-35 266-27-28

BS 2922 00-00-17 180-00-07 00-00-17 180-00-06

K @ 3005 86-27-23 86-27-23 86-27-18 86-27-22

86-27-22 ✓

Dist. 3005-3016 90-03-20 269-57-52 90-02-39 1409.05 1409.05

Dist 3016-3005 89-59-44 270-01-13 89-59-16 1409.07 1409.07

FS 211 94-24-04 274-23-50 94-24-05 274-23-53

BS 3005 00-00-21 180-00-08 00-00-20 180-00-15

K @ 3016 94-23-43 94-23-42 94-23-45 94-23-38

94-23-42 ✓

Dist. 3016-211 89-36-03 270-24-18 1702.59

Dist 211-3016 90-26-28 269-34-08 1702.61

Traverse Cont'd on pg 66

CK BA 2-25-85

SAME INSTRUMENTS 2-2586

64

TEMP = 20°P

BPR = 29.5

E.C.F. = -2

BLANK TRAVERSE

G. Robertson

J. Jackson

T. Withrow

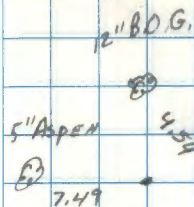

STA 3005 = 60d spike

1409.06 ✓

Trespass at CS 1/6 Sec 30

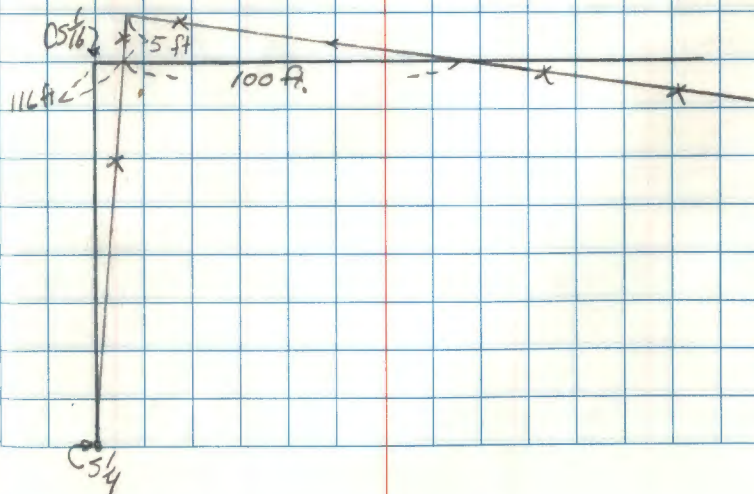

65

T143N R26W

A at NW cor. Sec 31 (3018) to cut
property line to the S $\frac{1}{4}$ Sec 25 & 30 (3019)

STA 1st H&D 2nd & R

FS 3019 101-48-37 281-48-44

BS 81 00-00-19 160-00-11

A@ 3018 101-48-18 101-48-33

Feb. 25, 1986

65

G. Robertson A D

B. Ausk

J. Jackson

T. Withrow

66

T143 N R26 W

Traverse Cont'd from pg. 64

STA 1st H&D 2nd H&R 3rd H&D 4th H&R
H&R

FS 210 180-04-41 00-04-34 180-04-36 00-04-31

BS 3016 00-00-28 180-00-18 00-00-15 180-00-14

T@211 180-04-13 180-04-16 180-04-21 180-04-17

April 7, 1986 66

Pty Cldy, breeze, mild

PC by G. Kosenko

TT by B. Ansk

Aide G. Robertson

T-2 S/N 265184

Red 1A S/N 4863

ELF = 0

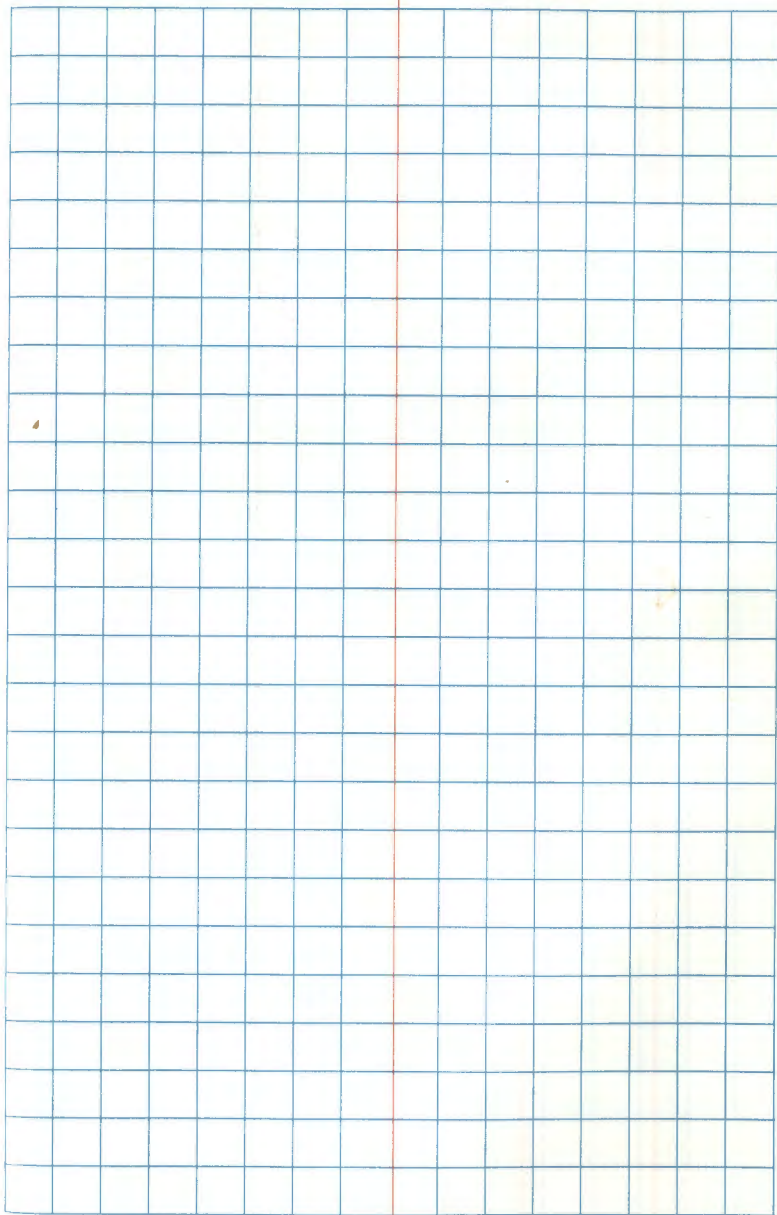
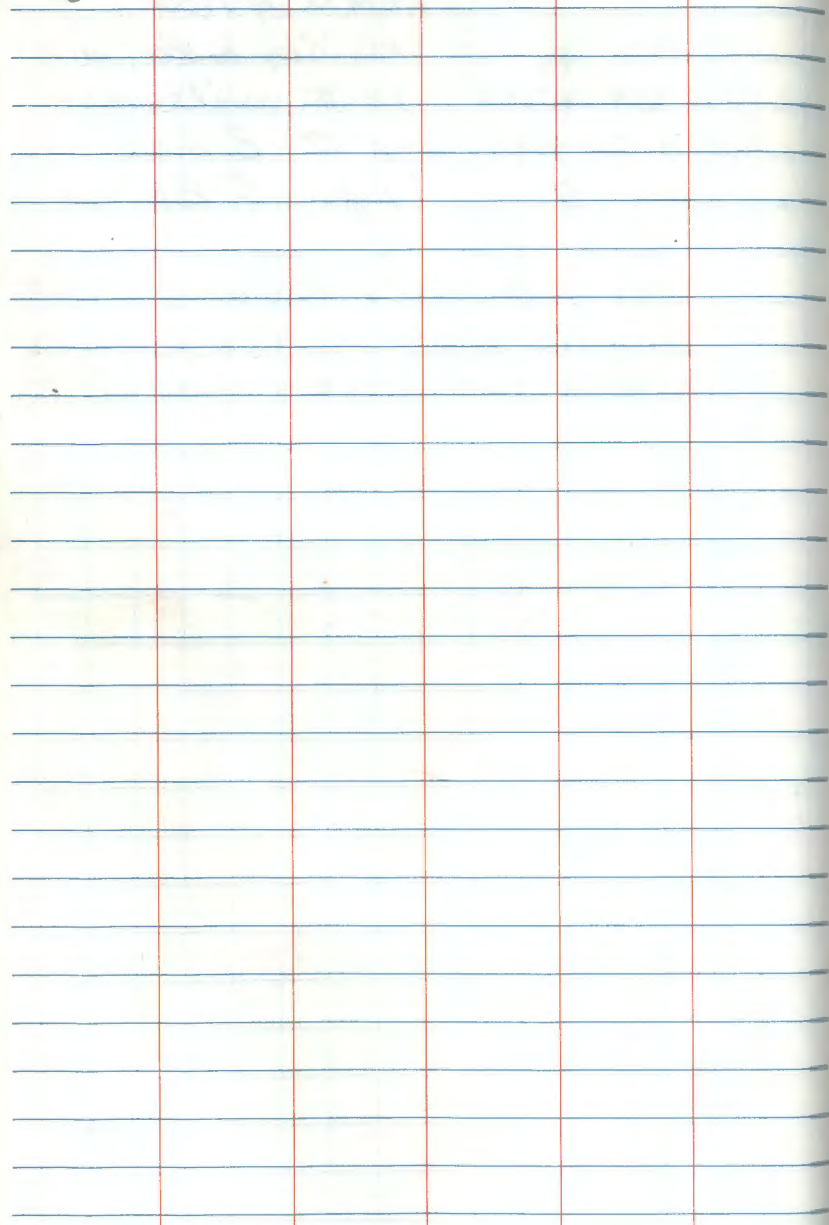

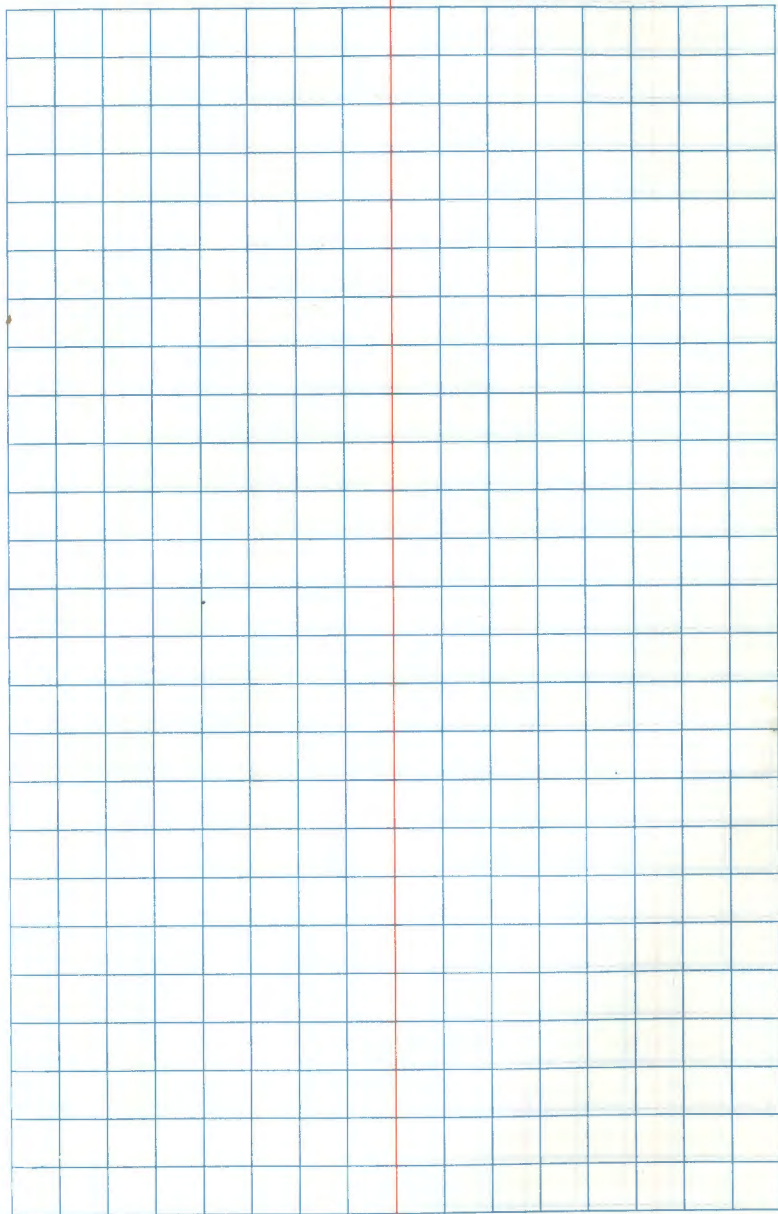

69

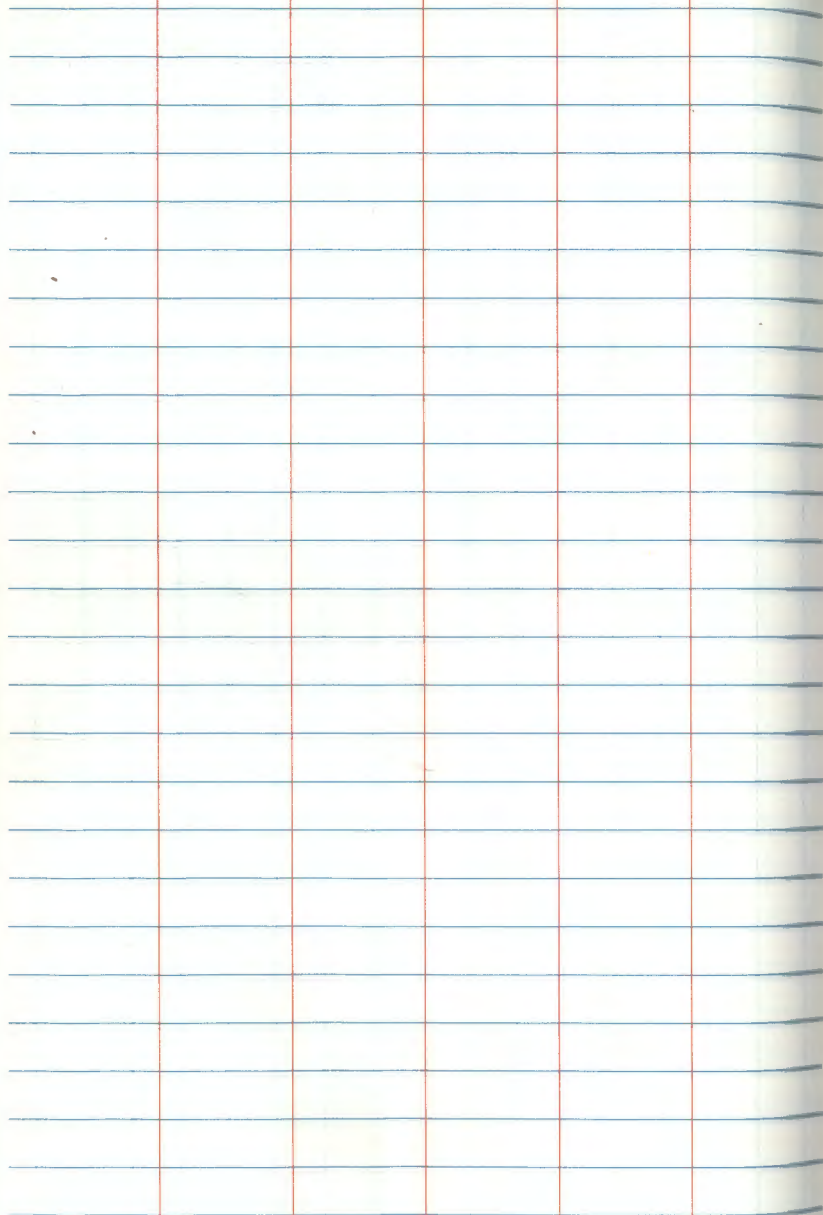

69

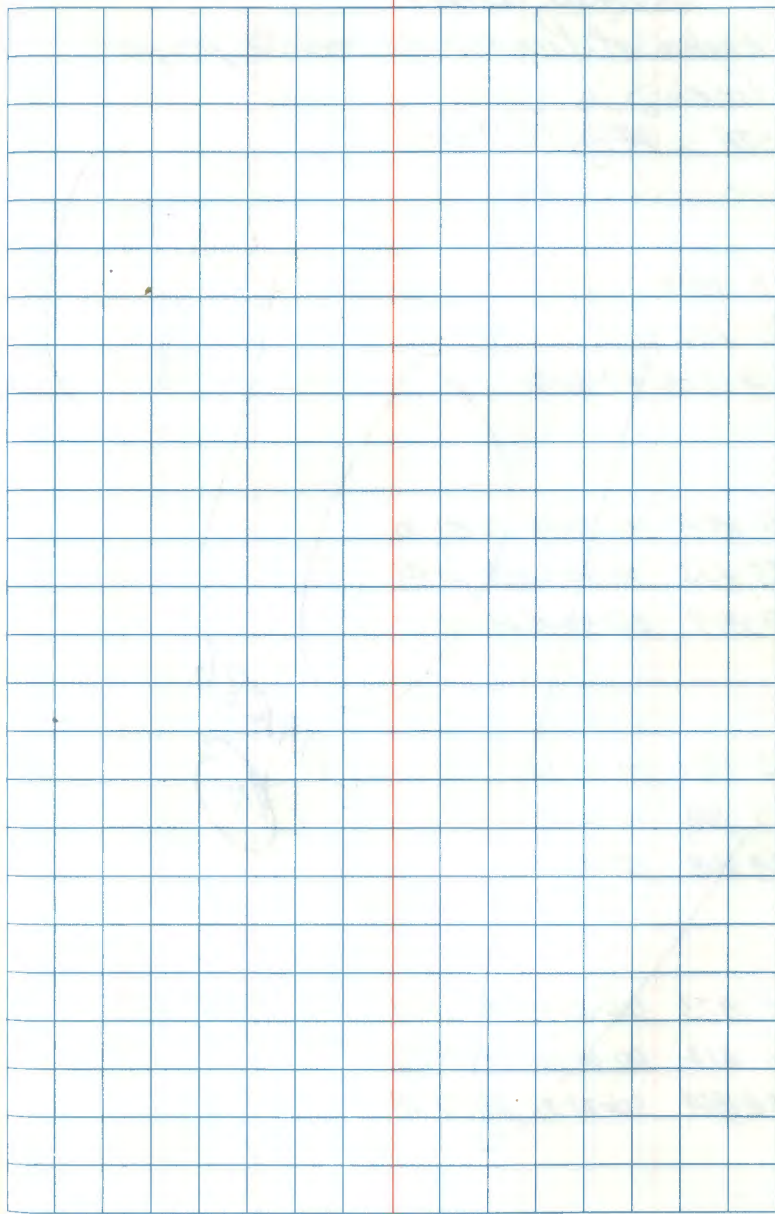

70

T143N P26W

Angles at Property corners to property
lineSTA 1st H&D 2nd H&P
H&

FS 1819

BS 102

T@1818 49-32-58

FS 1818 732-50-48 52-51-00

BS 403 00-00-12 180-00-43

T@1819 232-50-36 232-50-17

FS 1921 229-33-12

BS 102 00-00-19

T@1818 229-32-53

FS 1823 326-28-03 146-27-44

BS 412 00-00-12 174-59-56

T@1824 326-27-51 326-27-48

6 MAR 86
TW

January 15, 1986

70

FZ S/N 265184

PC # T G. Kosenko

Aides - G. Robertson

- B. Rusk

- T. Withrow

71

T143NK26W

Angles at Property CORNERS to

PROPERTY LINE

STN 1st H&D 2nd H&R

H&R

FS 311 14-39-20 ²⁹ 18-50

BS 315 00-00-00 14-39-20

T @ 316 14-39-20 14-39-30

FS 2919 274-31-11 94-31-09

BS 305 00-00-16 180-00-33

T @ 306 274-30-45 274-30-36

FS 2919 190-02-²² ~~19~~ 10-01-⁰²⁻⁷³ ~~47~~BS 308 00-00-³⁸ ~~30~~ 180-00-31T @ 309 190-01-⁴² ~~49~~ 190-01-~~44~~

31.43

2-12-86

71

B. AUSK

J. JACKSON

T. WITHROW

T-60 SN/158827

T-2 SN/265184

2-20-86

B. AUSK

G. ROBERTSON

T. WITHROW

T143N R26W

Angles @ Property Corners to Lines

STA 1st H&D 2nd H&R

FS 1819

BS 102

T@1818

FS 1818

BS 403

T@1819

FS 1921

BS 102

T@1818 199-19-51

FS 1823

BS 412

T@1824

73

T143N R26W

Angles @ Property Corners to Lines

STA 1st H&D 2nd H&R

HA

FS 3121

BS 76

T@ 3120 335-52-38

FS 3118

BS 76

T@ 3120 155-52-38

FS 1818 ~~182-27-42~~ ~~177-32-34~~ 177-32-34 357 32 30BS 99 ~~0-00-01~~ ~~179-59-58~~ ~~0-00-15~~ 180-00-11T@ 1921 ~~182-27-41~~ ~~172-27-41~~ 177-32-19 177-32-19

CO PS

73

April 9, 1986

Clear, breeze, mild

PC by G. Kosenko

T-2 S/N 265184 T K. Whitehorn

Aides - B. Ausk

- G. Robertson

