

T143N R26W

Traverse

Book 4

T143N R26W Book 4

DISTANCES FROM SIDE STAKES FOR CROSS-SECTIONING

Roadway of any Width. Side Slopes 1½ to 1.

In the figure below: opposite 7 under "Cut or Fill" and under .3 read 11.0, the distance out from the side stake at left. Also, opposite 11 under "Cut or Fill" and under .1 read 16.7, the distance out from the side stake at right.

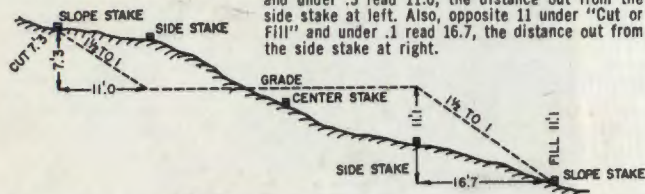

Cut or Fill	Distance out from Side or Shoulder Stake										Cut or Fill
	0	.1	.2	.3	.4	.5	.6	.7	.8	.9	
0	0.0	0.2	0.3	0.5	0.6	0.8	0.9	1.1	1.2	1.4	0
1	1.5	1.7	1.8	2.0	2.1	2.3	2.4	2.6	2.7	2.9	1
2	3.0	3.2	3.3	3.5	3.6	3.8	3.9	4.1	4.2	4.4	2
3	4.5	4.7	4.8	5.0	5.1	5.3	5.4	5.6	5.7	5.9	3
4	6.0	6.2	6.3	6.5	6.6	6.8	6.9	7.1	7.2	7.4	4
5	7.5	7.7	7.8	8.0	8.1	8.3	8.4	8.6	8.7	8.9	5
6	9.0	9.2	9.3	9.5	9.6	9.8	9.9	10.1	10.2	10.4	6
7	10.5	10.7	10.8	11.0	11.1	11.3	11.4	11.6	11.7	11.9	7
8	12.0	12.2	12.3	12.5	12.6	12.8	12.9	13.1	13.2	13.4	8
9	13.5	13.7	13.8	14.0	14.1	14.3	14.4	14.6	14.7	14.9	9
10	15.0	15.2	15.3	15.5	15.6	15.8	15.9	16.1	16.2	16.4	10
11	16.5	16.7	16.8	17.0	17.1	17.3	17.4	17.6	17.7	17.9	11
12	18.0	18.2	18.3	18.5	18.6	18.8	18.9	19.1	19.2	19.4	12
13	19.5	19.7	19.8	20.0	20.1	20.3	20.4	20.6	20.7	20.9	13
14	21.0	21.2	21.3	21.5	21.6	21.8	21.9	22.1	22.2	22.4	14
15	22.5	22.7	22.8	23.0	23.1	23.3	23.4	23.6	23.7	23.9	15
16	24.0	24.2	24.3	24.5	24.6	24.8	24.9	25.1	25.2	25.4	16
17	25.5	25.7	25.8	26.0	26.1	26.3	26.4	26.6	26.7	26.9	17
18	27.0	27.2	27.3	27.5	27.6	27.8	27.9	28.1	28.2	28.4	18
19	28.5	28.7	28.8	29.0	29.1	29.3	29.4	29.6	29.7	29.9	19
20	30.0	30.2	30.3	30.5	30.6	30.8	30.9	31.1	31.2	31.4	20
21	31.5	31.7	31.8	32.0	32.1	32.3	32.4	32.6	32.7	32.9	21
22	33.0	33.2	33.3	33.5	33.6	33.8	33.9	34.1	34.2	34.4	22
23	34.5	34.7	34.8	35.0	35.1	35.3	35.4	35.6	35.7	35.9	23
24	36.0	36.2	36.3	36.5	36.6	36.8	36.9	37.1	37.2	37.4	24
25	37.5	37.7	37.8	38.0	38.1	38.3	38.4	38.6	38.7	38.9	25
26	39.0	39.2	39.3	39.5	39.6	39.8	39.9	40.1	40.2	40.4	26
27	40.5	40.7	40.8	41.0	41.1	41.3	41.4	41.6	41.7	41.9	27
28	42.0	42.2	42.3	42.5	42.6	42.8	42.9	43.1	43.2	43.4	28
29	43.5	43.7	43.8	44.0	44.1	44.3	44.4	44.6	44.7	44.9	29
30	45.0	45.2	45.3	45.5	45.6	45.8	45.9	46.1	46.2	46.4	30
31	46.5	46.7	46.8	47.0	47.1	47.3	47.4	47.6	47.7	47.9	31
32	48.0	48.2	48.3	48.5	48.6	48.8	48.9	49.1	49.2	49.4	32
33	49.5	49.7	49.8	50.0	50.1	50.3	50.4	50.6	50.7	50.9	33
34	51.0	51.2	51.3	51.5	51.6	51.8	51.9	52.1	52.2	52.4	34
35	52.5	52.7	52.8	53.0	53.1	53.3	53.4	53.6	53.7	53.9	35
36	54.0	54.2	54.3	54.5	54.6	54.8	54.9	55.1	55.2	55.4	36
37	55.5	55.7	55.8	56.0	56.1	56.3	56.4	56.6	56.7	56.9	37
38	57.0	57.2	57.3	57.5	57.6	57.8	57.9	58.1	58.2	58.4	38
39	58.5	58.7	58.8	59.0	59.1	59.3	59.4	59.6	59.7	59.9	39
40	60.0	60.2	60.3	60.5	60.6	60.8	60.9	61.1	61.2	61.4	40

Property of:

USDA Forest Service
Deer River Ranger Dist
Deer River, MN 56636



The paper in this book is made of 50% high grade rag stock with a WATER RESISTING surface sizing.

USFS, CASS COUNTY, MN

LAND CORNER MONUMENTS

INDEX
143N R 26W 5th Principal MER.

A	1	2	3	4	5	6
B	7	8	9	10	11	12
C	13	14	15	16	17	18
D	19	20	21	22	23	24
E	25	26	27	28	29	30
F	31	32	33	34	35	36
G						
H						
I						
J						
K						
L						
M						
N						
O						
P						
Q						
R						
S						
T						
U						
V						
W						
X						
Y						
Z						

143-26 Book #4

Description INDEX page

Traverse sketch (Main Loop)	2
Solar Observation	3,4
Main traverse	6-63
Tying in Solar Obs	5
Sketch of 1 st Loop	65
1 st Loop traverse	66-74
Sideshot to Loop #400	57
Sideshot to Tamarack Sale	33
Traverse S8 T142N R26W	

USE (ASS) XE 115

[Faint, illegible handwriting on lined paper]

[Faint, illegible handwriting on grid paper]

TRAVERSE

Main traverse for the SW part

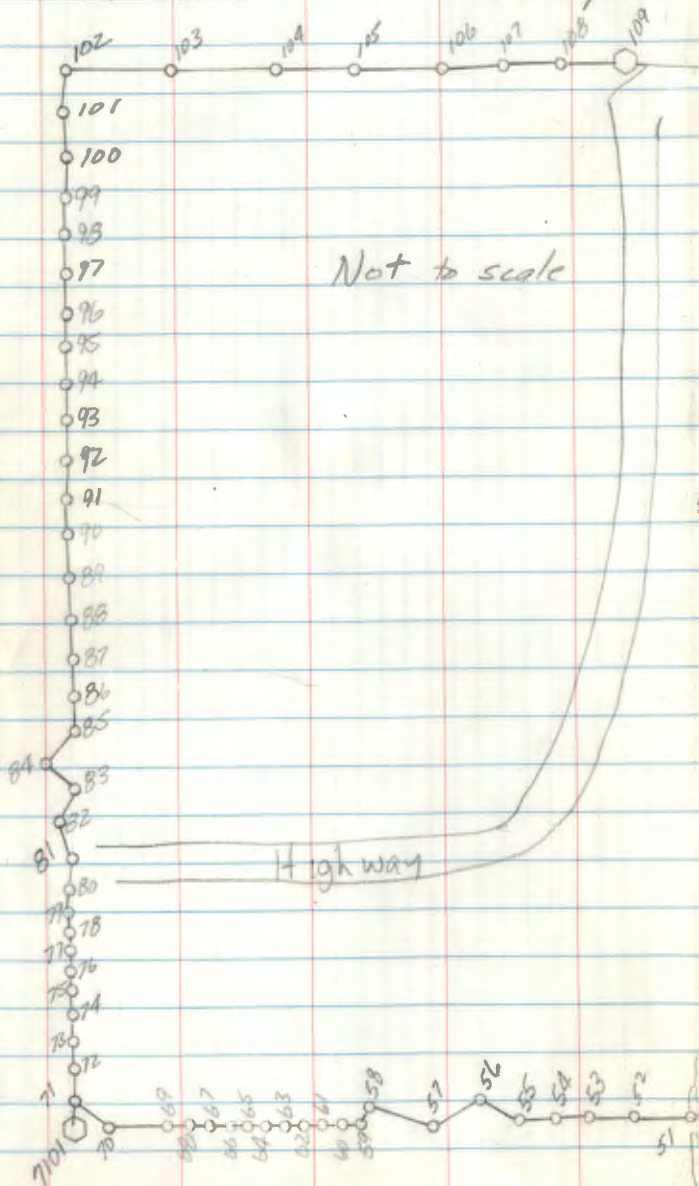

SKETCH
of T143N R26W 5 P.M.

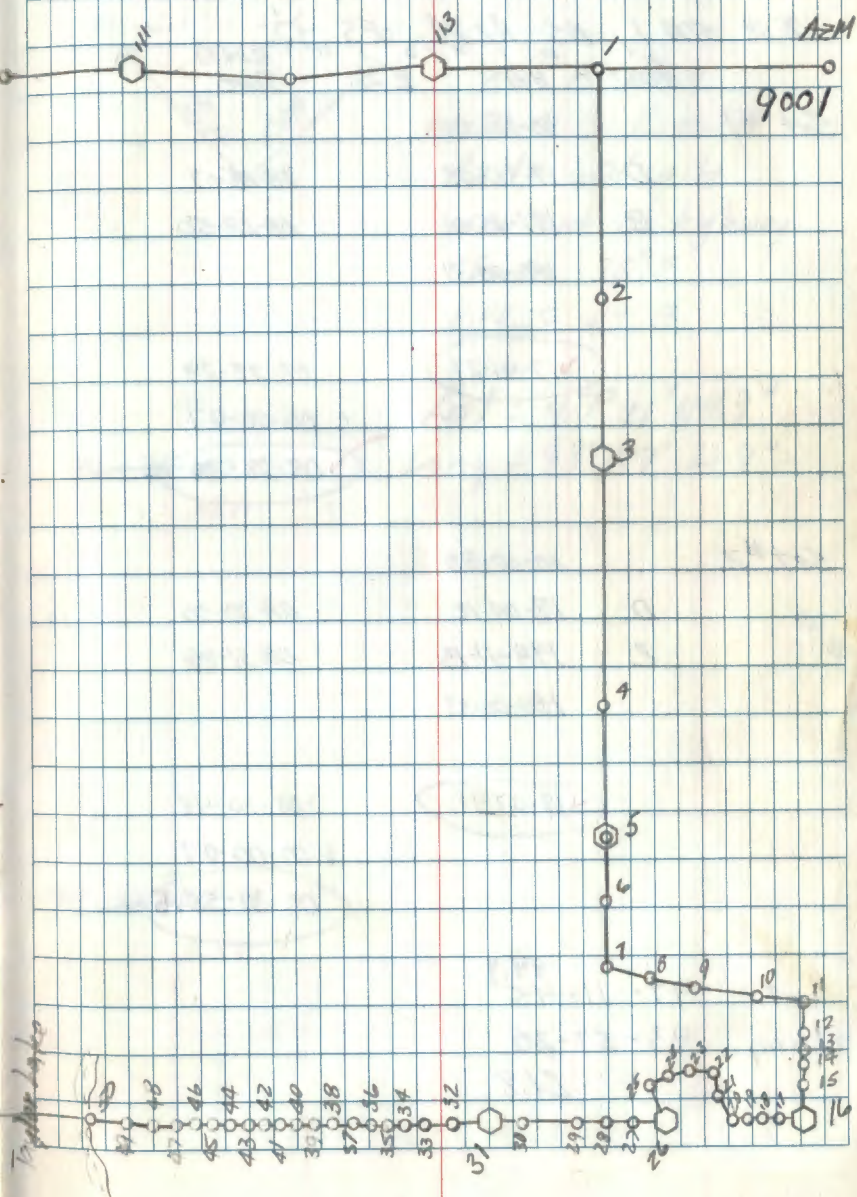

T143N R26W

Solar Observation

T @ STA 1, BS AZM FS \odot
 Post HA ZZ Time (East)

Set #1 10-00-33
 D 17-56-45 08-28-07
 R 197-45-01 08-28-50
 180-00-31

17-40-21 08-28-29

+ 00-00-07

08-28-36

Set #2 10-00-30
 D 18-04-12 08-30-30
 R 198-11-13 08-31-06
 180-00-53

18-07-11 08-30-48

+ 00-00-07

08-30-55.5

Lat 47-11-44.9
 45
 Long. 93-57-20
 21.8

Oct 16, 1985

Watch time is 7 seconds slow DUT = 40.5 sec

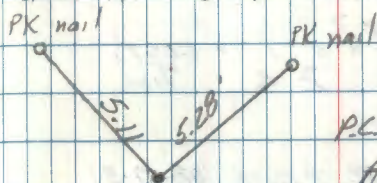

T B. Ausk
 P.C. PD @ G. Kazuo
 AZM = 60d spike
 south side of highway
 Temp = 35°F
 BPR = 29.8

Lat = 47° 11' 44.9"
 Long = 93° 57' 21.8"

~~94-35-10~~
 07.11

~~94-35-07~~
 11.58

T143N 1226W

Solar Observation

Cont'd from p. 3, " (cont)

Post H₄ Z₄ Time

Set #3

00-00-28

D 19-25-58 19-25-20 08-37-31

R 199-30-97 19-30-17 08-37-57

180-00-30

6.56

~~19-27-54~~

✓ 8-37-44

+ 0-00-07

8-37-51.5

Set #4

00-00-30

D 17-49-24 19-48-54 08-39-31

R 199-56-24 19-55-49 08-40-08

00-00-35

02.05

~~19-52-22~~

8-39-50

+ 0-00-07

8-39-57Avg Az = 94-~~35-06~~³⁴⁻¹⁹Big 1-Azm = 585-~~24-52~~²⁵⁻⁴¹ E~~94-35-03~~

07.57

~~94-35-10~~

35-44.00

T43N R26W

Tying into Solar Observation

STA 1st H&D 2nd H&R 3rd H&D 4th H&R

H4

FS 2 89-00-44 264-00-43 89-00-47 264-00-40

BS AzM 00-00-27 180-00-18 00-00-21 180-00-19

T₀ 1 89-00-17 89-00-25 89-00-26 89-00-21

84-00-22.25

Dist 1- AzM 89-20-39 270-39-13 89-20-43 1727.67 ft 1727.56

1 + AzM 89-20-54 270-39-16 89-20-49 526.59 ft 526.55 ft

FS 113 177-59-33 ^{15 + 44} 177-59-27 177-59-27 357-59-17BS AzM 0-00-22 ¹⁷⁷⁻⁵⁹⁻⁵³ 180-00-00 0-00-13 177-59-59T₀ 1 177-59-11 ^{22.5} 177-59-27 177-59-14 177-59-19

177°-59'-16.5"

Oct 21, 1985

Mild, Clear, Calm

PC at G. Kasenko

T₀ at G. Robertson

© B. Ausk

526.559 1727.55 ft

T143N R226W

Main traverse for SW part of 143-26

STA 1st H&D 2nd H&R 3rd H&D 4th H&R

H&R

Dist 1-2 89-30-24 270-27-43 270-27-40 2978.15 2978.04

Dist 2-1 90-30-39 269-29-19 269-29-20 2978.16 2978.04

FS 3 180-45-10 00-45-09 180-45-11 00-45-05

BS 1 00-00-13 180-00-06 00-00-17 180-00-07

T@2 180-44-52 180-44-53 180-44-54 180-44-53

180-44-55 54.75

Dist 2-3 89-57-50 270-02-35 270-02-35 2446.12 2446.12

Dist 3-2 90-03-19 269-56-24 269-56-21 2446.10 2446.10

FS 4 181-06-34 01-06-28 181-06-33 01-06-24

BS 2 00-00-21 180-00-16 00-00-19 180-00-13

T@3 181-06-13 181-06-12 181-06-14 181-06-06

181-06-11.25

Dist 3-4 89-57-39 270-02-23 270-02-22 4856.29 4856.29

Dist 4-3 90-03-36 269-56-24 269-56-24 4856.29 4856.29

JDR 10/23/85

Oct 21, 1985

T-2 S/N 265184

Roll-A S/N 4863

Clear, mild, calm

PG, PR G. Kesenka

TTR G. Robertson

STA 1 = PK nail in

road intersection

@ B. Avick

BPR = 29.8 ELF = 0

Temp = 45°F @ 8:30 AM

STA 2 = Wood spike

East ditch of road

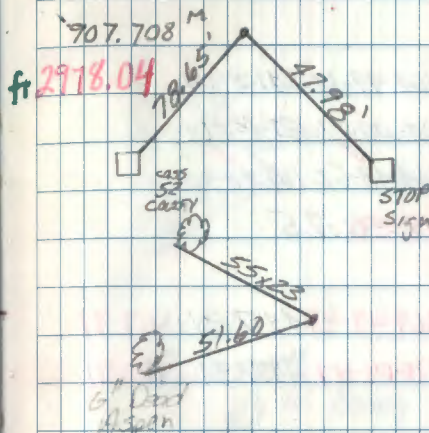
745.576 M
2446.11 ft

R-15

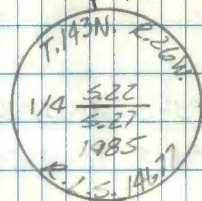

STA 3 =

1480.200 m
4856.29 ftAluminum pipe w/ Alum
cap, 1 foot under road
surface

T143N R26W

Traverse cont'd from pg. 6

STA 1st HXR 2nd HXR 3rd HXR 4th HXR

HX

FS 5 164-49-15 344-49-00 164-49-15 344-49-09

BS 3 00-00-29 180-00-20 00-00-21 180-00-19

ITD 4 164-48-51 164-48-48 164-48-52 164-48-50

164-48-50.25

Dist 4-5 90-10-21 269-49-46 269-49-43 417.91 417.91

Dist 5-4 89-55-15 270-04-40 270-04-47 417.91 417.91

FS 6 222-19-20 42-19-14 222-19-17 42-19-14

BS 4 00-00-22 180-00-19 00-00-17 180-00-19

ITD 5 222-18-58 222-18-55 222-19-00 222-18-55

222-18-57

Dist 5-6 89-49-29 270-10-52 270-10-40 250.45 250.45

Dist 6-5 90-19-45 269-40-20 269-40-19 250.43 250.43

JJR 10/23/85

Oct 21, 1985

Top of Page NORTH

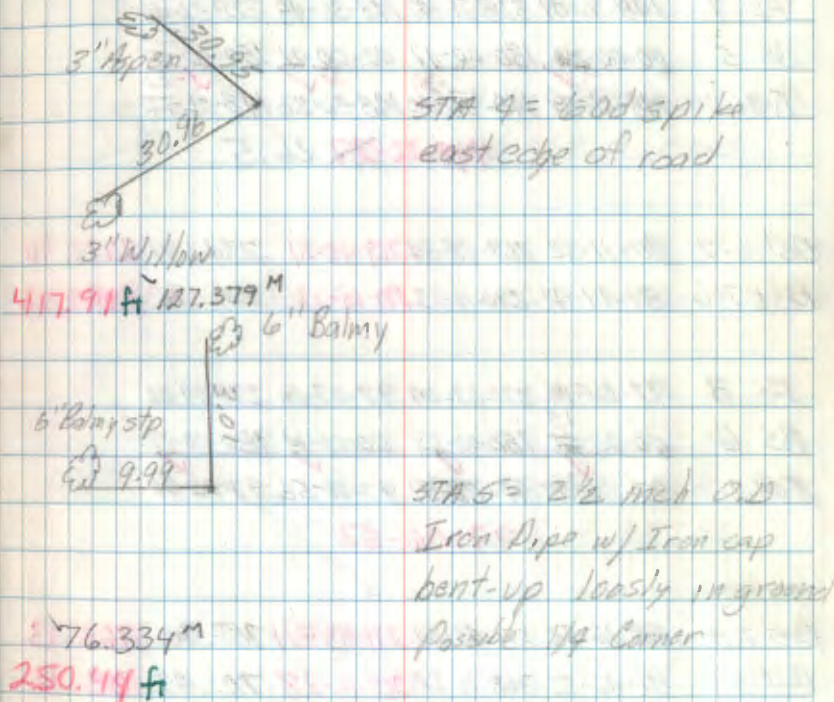

T143N R26W

Traverse cont'd from pg 7

STA 1st H&D 2nd H&R 3rd H&D 4th H&R

H&R

FS 7 148-36-49 328-36-47 148-36-98 328-36-~~40~~⁴¹BS 5 00-00-20 180-00-17 00-00-22 180-00-~~21~~²⁰T@6 148-36-29 148-36-~~30~~³⁰ 148-36-26 148-36-~~26~~²¹

148-36-27 26.5

Dist 6-7 90-11-32 269-48-34 269-48-31 2347.91 2347.90

Dist 7-6 89-49-47 270-10-13 270-10-13 2347.93 2347.92

FS 8 97-07-14 277-07-04 97-07-06 277-07-02

BS 6 00-00-~~15~~¹⁵ 180-00-13 00-00-14 180-00-12

T@7 97-06-59 97-06-51 97-06-52 97-06-50

97-06-53

Dist 7-8 88-16-32 271-43-39 271-43-34 763.48 763.13

Dist 8-7 91-44-33 268-13-28 268-13-28 763.49 763.12

✓ DR 10/24/85

Oct 21, 1985

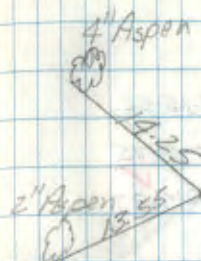

STA 6 = God spike

West edge of road

715.644 m

2347.91 ft

USES POST



STA 7 = God spike

middle of FR 2113

232.602

763.13 ft

FR 2113
post

9

T143N R26W

Traverse cont'd from pg 8

STA 1st H&D 2nd H&R 3rd H&D 4th H&R
H&R

FS 9 181-15-59 01-15-50 181-15-54 01-15-52

BS 7 00-00-20 180-00-15 00-00-18 180-00-15

T@ 8 181-15-34 181-15-35 181-15-36 181-15-37

181-15-36 35.5

Dist 8-9 91-56-06 268-04-09 268-03-59 388.20 387.96

Dist 9-8 88-09-53 271-50-13 271-50-10 388.16 387.97

FS 10 213-45-08 33-45-08 213-45-16 33-45-14

BS 8 00-00-20 180-00-20 00-00-21 180-00-22

T@ 9 213-44-48 213-44-48 213-44-52 213-44-52

213-44-50

Dist 9-10 89-28-48 270-31-29 270-31-21 1040.07 1040.03

Dist 10-9 90-33-37 269-26-31 269-26-27 1040.10 1040.05

JXP 11/25/85

9

Oct 21, 1985

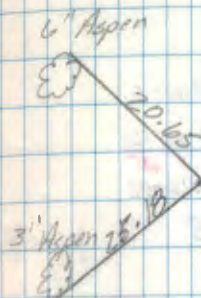

STA 8 = 60d spike

North side of FR 2113

118.255 m

387.97A 4" W. oak



STA 9 = 60d spike

317.005 m

1040.04 ft

T143N R26W

Traverse cont'd from pg 9

STA 1st H&D 2nd H&R 3rd H&D 4th H&R

H&R

FS 11 179-02-20 359-02-09 179-02-07 359-02-07

BS 9 00-00-15 180-00-10 00-00-10 180-00-05

T@ 10 179-02-05 179-01-59 179-01-57 179-02-12

179-02-04 00.75

Dist 10-11 90-00-08 269-57-56 269-57-54 953.53 953.53

Dist 11-10 90-02-24 269-57-39 269-57-37 953.53 953.53

FS 12 183-10-25 03-10-20 183-10-21 03-10-17

BS 10 00-00-20 180-00-14 00-00-16 180-00-13

T@ 11 183-10-05 183-10-06 183-10-05 183-09-59

183-10-04 03.75

Dist 11-12 93-12-15 266-47-29 266-47-37 135.37 135.16

Dist 12-11 87-04-06 272-55-56 272-55-55 135.33 135.15

✓ DR 11/25/85

Oct 21, 1985

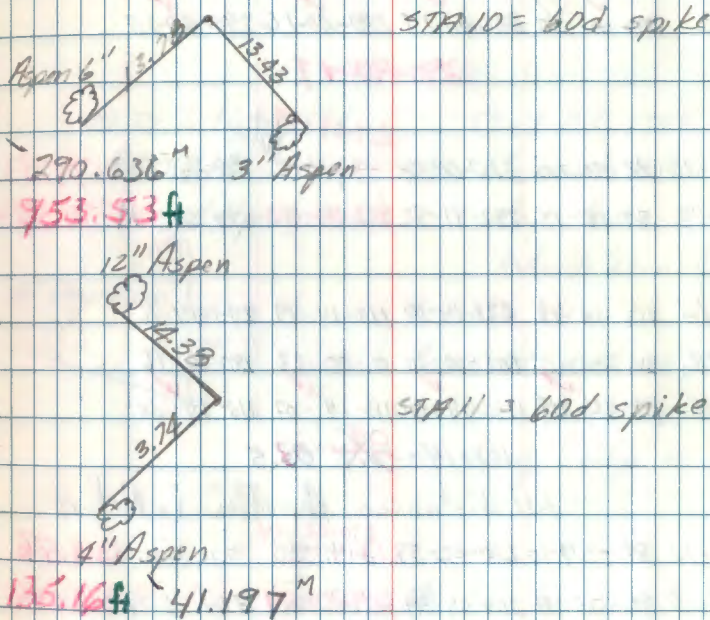

T143N R26W

Traverse cont'd from pg 10

STA 1st H&O 2nd H&R 3rd H&O 4th H&R

H&O

FS 13 290-40-~~34~~³⁷ 110-40-33 290-40-33 110-40-38BS 11 00-00-~~28~~²⁹ 180-00-16 00-00-17 180-00-20T@12 290-40-~~26~~¹⁷ 290-40-17 290-40-16 290-40-19

290-40-17

Dist 12-13 92-50-20 267-09-59 ²⁶⁷⁻⁰⁹⁻⁴⁹ _{Meter} 261.25 M 79.531

Dist 13-12 87-18-13 272-41-52 272-41-50 79.612 M 79.524

FS 14 113-14-18 293-14-10 113-14-19 293-14-16

BS 12 00-00-11 180-00-10 0-00-12 180-00-16

T@13 113-14-07 113-14-00 113-14-07 113-14-00

113-14-0~~3~~⁵ 03.5

All distances hereafter in Meters

Dist 13-14 89-59-10 270-02-58 ²⁷⁰⁻⁰²⁻⁵⁴ 314.586 314.586

Dist 14-13 90-05-11 269-54-59 269-54-54 314.604 314.604

JHR 10/25/85

Oct 21, 1985

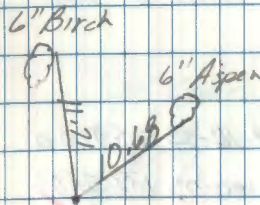
~~29.25 in Hg 55°F~~~~Kasen to P.C.~~~~Robertson TTP~~~~Whitehorn ♂~~

STA 12 = 60d spike

29.25 in Hg 55°F

260.918

Oct 23, 1985

Kasen to P.C.

Robertson TTP

Whitehorn ♂

79.527 M 2" Aspen (cut at PC)

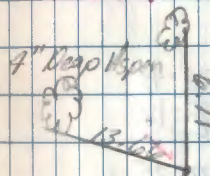

Couldn't put any
sta mark here because
of a log (edge of swamp)

314.595 M 1032.13A

T143N R26W

Traverse cont'd from pg 11

STA 1st H&D 2nd H&R 3rd H&D 4th H&R

H&R

FS 15 179-10-26 359-10-~~28~~⁰⁹ 179-10-14 359-10-06BS 13 00-00-~~21~~¹⁷ 179-59-~~58~~⁵⁹ 00-00-03 179-59-56T@ 14 179-10-09 179-10-~~22~~¹¹ 179-10-11 179-10-10

179-10-10.25

Dist 14-15 81-04-02 278-56-01 ~~79.289~~ 80.260 79.287

Dist 15-14 99-04-20 260-55-44 260-55-42 80.289 79.285

FS 16 186-23-45 06-23-38 186-23-45 06-23-43

BS 14 0-00-24 180-00-20 0-00-25 ~~06-23-18~~

T@ 15 186-23-21 186-23-18 186-23-20 186-23-25

186-23-21 ✓

Dist 15-16 88-11-22 271-48-27 271-48-33 47.519 47.493

Dist 16-15 92-03-10 267-57-41 267-57-01 47.515 47.485

✓ H&R 10/25/85

Oct 23, 1985

10" Cedar

10.14

33.59

3" Balsam

79.286

260.124

5" Maple

13.834

10.604

4" Aspen

47.489

155.804

STA 14 = 301 spike
edge of SWAMP

STA 15 = 601 spike

T14311 R26W

Traverse cont'd from pg. 12

STA 1st H&D 2nd H&D 3rd H&D 4th H&D

H&D

FS 17 268-48-46 88-48-42 268-48-50 88-48-43

BS 15 0-00-12 180-00-24 0-00-27 180-00-21

TQ 16 268-48-27 268-48-18 268-48-23 268-48-22

268-48-24.15 22.5

Dist 16-17 89-59-36 270-00-35 270-00-30 75.435 75.435

Dist 17-16 90-09-13 269-50-26 269-50-42 75.441 75.441

FS 13 180-00-40 0-00-35 180-00-35 0-00-30

BS 16 0-00-19 180-00-12 0-00-17 180-00-15

TQ 17 180-00-21 180-00-23 180-00-18 180-00-15

180-00-19.25

17 to 18 92-02-55 267-57-07 267-57-06 112.613 112.541

18 to 17 88-03-20 271-56-51 271-56-46 112.606 112.541

SIDE SHOT

FS 9017 174-01-30 354-02-01

BS 16 0-00-17 180-00-15

TQ 19 174-01-13 174-01-46

174-01-30

16 to 9017 120-49-45

120-49-45

JDR 12/25/85

12.78 ft

360
48
444

Oct 23, 1985

T143N R26W
5.34 | 5.35
5.9152
T143N R26W
1963
P.L.S. NO. 6867

STA 16 =

75.438 247.50A

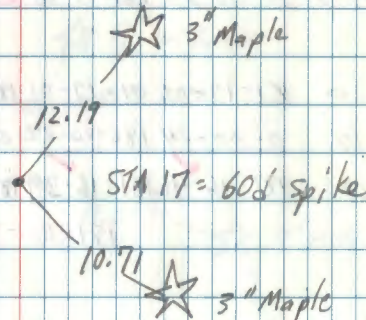

112.541 369.23ft

End M. Vo's Traverse nail in base of Stump
STA 9017 = M. Vo's Traverse STA # 1 (see PPI
of Tidd Lake Traverse Book)

T143N R26W

Traverse cont'd from pg 13

STA 1st H&D 2nd H&D 3rd H&D 4th H&D

H&D

FS 17 178-59-16 358-59-09 178-59-17 358-59-14

BS 17 0-00-20 180-00-17 0-00-18 180-00-18

TC 18 178-58-56 178-58-52 178-59-59 178-58-56

178-58-56 55.75

18 to 19 89-22-01 270-38-00 270-38-00 89.965 89.960

19 to 18 90-15-30 269-14-28 269-14-29 89.959 89.955

FS 20 81-17-05 01-17-01 81-17-02 01-16-57

BS 18 0-00-24 180-00-22 0-00-22 180-00-19

TC 19 181-16-41 181-16-39 181-16-40 181-16-38

181-16-40 39.5

19 to 20 90-27-49 269-32-07 269-32-09 99.157 99.154

20 to 19 89-39-04 270-21-03 270-21-00 99.162 99.160

J. J. J. 11/25/85

Oct 23, 1983

STA 18 = 60d spike

17.42 ft

16.16 ft

3" Aspen

7" Aspen

89.955 295.134

9" W. Birch

26.55 ft

STA 19 = 60d spike

19.51 ft

9" W. Birch

99.157 325.324

T143N R26W

Traverse Cont From pp 14

STA 1st H&D 2nd H&R 3rd H&D 4th H&R

H&R

FS 21	237-14- ¹⁸ 21	57-13- ¹⁷ 58	237-13- ¹³ 49	57-13- ³⁹ 49
BS 19	0-00- ²⁴ 24	179-59- ²¹ 21	0-00- ⁰³ 03	179-59-42 ✓
AB 20	237-13- ⁵⁴ 44	237-13- ⁵⁶ 54	237-13- ⁵⁶ 40	237-13- ⁵⁷ 56

237-13-~~56~~55
55.75

20 to 21 90-23-44 269-36-14 269-36-15 112.291 112.288

21 to 20 89-42-26 270-17-49 270-17-41 112.291 112.290

FS 22 207-51-56 27-51-52 207-51-54 27-51-47

BS 20 0-00-16 180-00-09 0-00-08 180-00-10

AB 21 207-51-40 207-51-43 207-51-46 207-51-37

207-51-~~42~~41.5

21 to 22 92-33-20 267-26-39 267-26-40 125.317 125.192

22 to 21 89-32-18 272-27-46 272-27-44 125.302 125.186

JDR 10/25/85

Oct 23, 1985

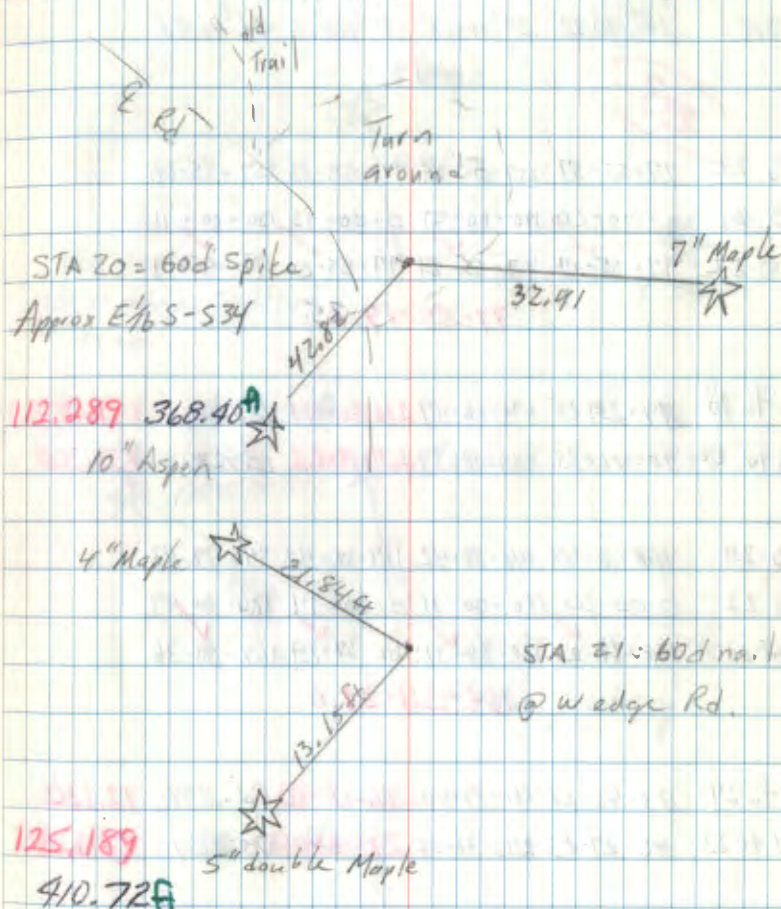

T143N R26W

Traverse Cont From pp 15

STA 1st H&R 2nd H&R 3rd H&R 4th H&R

H&R:

FS 22 77-55-37 257-55-28 77-55-33 257-55-28

BS 21 0-00-20 180-00-07 0-00-13 180-00-11

TB 22 77-55-19 77-55-21 77-55-20 77-55-19

77-55-19.25

22 to 23 99-23-25 270-36-47 270-36-41 139.301 139.293

23 to 22 90-41-33 269-18-37 269-18-32 139.310 139.300

FS 24 168-38-48 348-38-42 168-38-43 348-38-43

BS 22 0-00-20 180-00-11 0-00-14 180-00-07

TB 23 168-38-28 168-38-31 168-38-29 168-38-36

168-38-31.0

23 to 24 93-42-21 266-19-40 266-18-40 72.280 72.130

24 to 23 86-27-03 273-33-02 273-33-00 72.267 72.128

J 12/21/85/BS

Oct 23, 1985

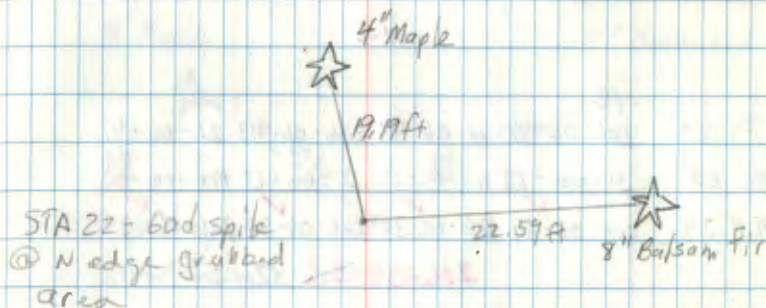

139.297 457.01 ft

4" double Oak (PI 33-35) 4" Oak (PI 33-27.0)

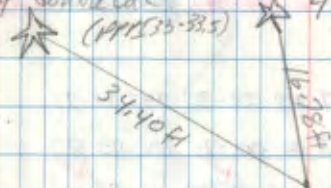

72.129 236.64 ft

T143 N R26W

TRAVERSE CONT FROM pp 16

STA 1st HAR 2nd HAR 3rd HAR 4th HAR
HA

FS 25	206-06-48	26-06-43	206-06-43	26-06-47
BS 23	0-00-17	180-00-11	0-00-13	180-00-09
TS 24	206-06-31	206-06-32	206-06-30	206-06-37
	206-06-32.5			

24 to 25	93-27-06	266-32-54	266-32-54	129.162	128.928
25 to 24	86-38-15	273-21-39	273-21-42	129.143	128.921

FS 26	112-28-36	292-28-27	112-28-32	292-28-27
BS 24	00-00-30	180-00-17	00-00-15	180-00-09
TS 25	112-28-16	112-28-15	112-28-17	112-28-13
	112-28-15.25			

25 to 26	89-00-50	270-59-05	270-59-08	50.295	50.288
26 to 25	91-12-31	268-47-43	268-47-36	50.305	50.294

✓ 2x 14/25/85

Oct 23, 1985



STA 24 = 60d spike
in grubbed area

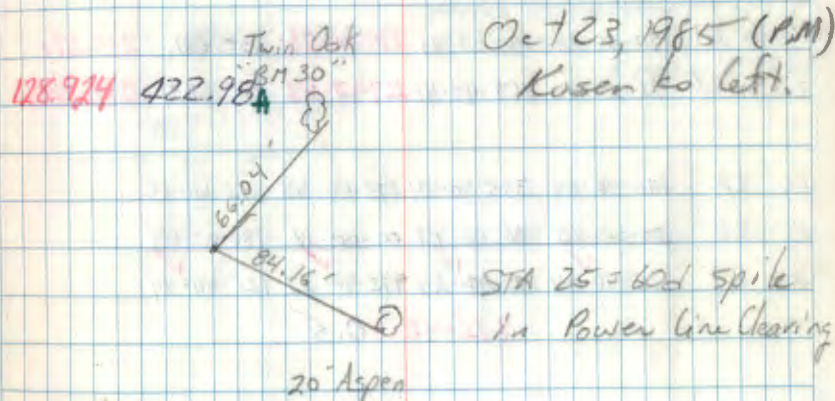

STA 25 = 60d spike
in Power Line Clearing

50.291 165.00A

T143N R26W

Traverse Cont'd from P₇ 17STA 1st H&R 2nd H&R 3rd H&R 4th H&R

H&R

27?

FS	25	358-05-56	78-05- ⁴⁶ 23	258-05-51	78-05-46
BS	24	00-00-20	180-00- ⁰⁹ 26	00-00-08	180-00-09
TP	26	258-05-56	258-05- ⁻³⁷ 47	258-05-43	258-05-37
258-05-38.25					

26 to 27	87-50-38	272-09-21	279-09-22	239.681	239.511
27 to 26	92-12-26	267-47-41	267-47-38	239.685	239.507

FS	28	175-40-54	355-40-44	175-40-45	355-40-43
BS	26	00-00-20	180-00-17	00-00-18	180-00-09
TP	27	175-40-34	175-40-27	175-40-27	175-40-34
175-40-30.5					

27 to 28	94-06-27	265-53-44	265-53-39	146.096	145.721
28 to 27	85-58-26	274-01-27	274-01-36	146.077	145.716
= = = side shot = = =					

FS	9027	358-09-31	178-09-16
BS	26	00-00-18	180-00-09
TP	27	358-09-13	358-09-07
358-09-10			

O.S.	27-9027	94-53-23	265-06-49	94-53-17	139.722	139.214
------	---------	----------	-----------	----------	---------	---------

V12R1425185

Oct 23, 1995

STA 26 = 0.11 ft (00) IP

For possible S₄ cor

See 34 (Cerro Pine)

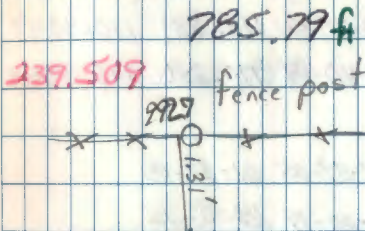
IP set by H. Nilsson at
Milo's calculated positionNilsson owns 643 52
T142N R26WSTA 27 = 60d spike near
fence line

145.719 478.084

STA 9027 = fence corner
by county road N57°E

456.74 ft

T143N R26W

TRAVERSE CONT FROM PP 18

STA	1 st HZ	2 ^d HZ	3 ^d HZ	4 th HZ
	MEAN HZ			

BS 29	175.48- ⁴⁰ 45	355.48-45	175.48-43	355.48-44
BS 27	00-00- ¹¹ 14	180.00-10	00-00-11	180.00-09
TO 28	175.48- ²⁹ 26	175.48-35	175.48-32	175.48-35
	175.48- 33 ✓ 32.75			

28 to 29	90-29-46	269.30-18	90-29-44	110.739	110.3349
29 to 28	89- ⁴⁰⁻¹⁸ 36 -19	270.19-40	89-40-19	110.336	110.3341

FS 30	181-39-08	01-39-02	181-39-05	01-39-00
BS 28	00-00-23	180-00-17	00-00-19	180-00-15
TO 29	181-38-45	181-38-45	181-38-46	181-38-45
	181-38-45.25			

29 to 30	87-23-10	272.36-59	87-23-09	207.559	207.343
30 to 29	92-40-16	267.17-37	92-40-20	207.566	207.340

SIDE SHOT TO LOCATE FENCE LINE

TO	HZ	BS	HZ	S.D.	M.D.
28	9028	27	00-00-00	S.D.	M.D.
Fence	9028		00-15-40	89-07-50	81.474 M 81.465 M 269.27F
Fence	9228		66-36-50	chained	26.36 ft 8.035 M
Fence	9228		168-55-00	92-29-00	40.102 M 40.064 M 131.57F

31
Oct. 28, 1985

Cloudy, mild calm

PC RP G. Kosenko

T-2 SW 265185

Red 1/4 SW 4863

TT G. Robertson

O B. Auck

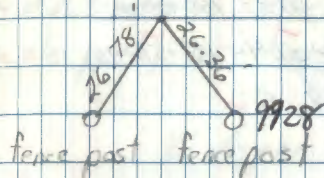

STA 28 = 60d spike in pasture

110.334 361.99F

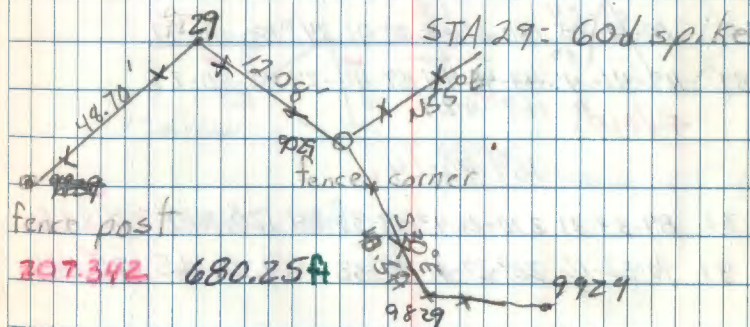

STA 29 = 60d spike

207.342 680.25F

Side shots to locate fence line

TO	HZ	BS	HZ	S.D.	M.D.
29	9029	28	00-00-00	S.D.	M.D.
Fence	9029		36-46-10	chained	12.08 ft 3.682 M
Fence	9229		46-45-00	90-30-30	29.599 M 29.598 M
Fence	9229		62-52-30	89-45-20	16.359 M 16.359 M

T143N R26W

TRAVERSE CONT FROM PP 19

STA 1st H₃ 2nd H₃ 3rd H₃ 4th H₃
MEAN H₃

FS 31 188-57-00 ⁴⁸08-56-57 188-56-57 08-56-50
BS 29 00-00-22 ⁰⁵180-00-11 00-00-13 180-00-05
TB 30 188-56-38 ⁴³188-56-33 188-56-44 188-56-45
188-56-42.5 ✓

30 to 31 91-16-19 268-4344 91-16-17 107.078 107.052
31 to 30 88-49-50 271-10-14 88-49-48 107.071 107.099

FS 32 ~~169-42-08~~ ⁴¹⁻⁴⁰349-42-11 ³⁴169-41-58 349-42-14
BS 30 ~~00-00-23~~ ²⁴180-01-27 ¹³00-01-34 180-01-47
TB 31 ~~169-41-45~~ ⁵⁹169-40-21 ⁴¹169-40-24 169-40-27
169-40-24 ✓

31 to 32 89-33-31 270-26-43 89-33-24 120.670 120.666
32 to 31 90-32-12 269-27-41 90-32-16 120.665 120.660

CK BA 11-13-85

Oct 31, 1985

BPR = 29.5
Temp = 47°F 2' Aspen
ELF = 0

Reset M₁₀ Δ10
PP4 of his notes
(see also pp 16)

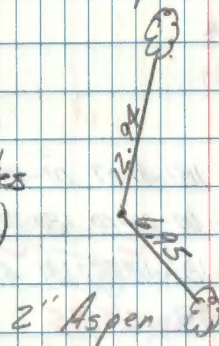

STA 30 = 60d spike

107.052 351.21A

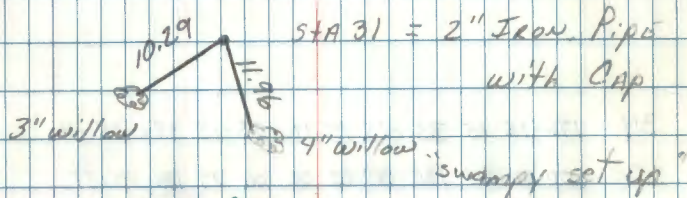

STA 31 = 2" Iron Pipe with Cap

120.663 395.88A

21

T143N R26W

Traverse, Cont from pp 20

STA 1st H 4" 2nd H 4" 3rd H 4" 4th H 4"

SIX H 4

FS 33 181-49-20 01-49-06 181-49-07 01-49-04

BS 31 00-00-20 180-00-06 00-00-10 180-00-06

NB 32 181-49-00 181-49-00 181-49-57 181-49-58

181-49-58 58.75

32 to 33 83-13-19 276-46-45 83-13-17 50.830 50.475

33 to 32 97-00-04 263-00-05 9700-00 50.852 50.473

FS 34 176-25-15 356-25-15 176-25-15 356-25-16

BS 32 00-00-20 180-00-12 00-00-17 180-00-11

NB 33 176-24-55 176-25-03 176-24-52 176-25-05

176-25-00 25

33 to 34 91-15-57 268-44-24 91-15-46 235.179 235.122

34 to 33 88-47-20 271-12-44 88-47-18 235.179 235.126

Sideshot

FS 9032

CK BA 11-13-85

BS 31 0-0-00

TC 32 25-30-00

Dist = 146.50A (chained)

Happy Halloween
Oct 31, 1985

21

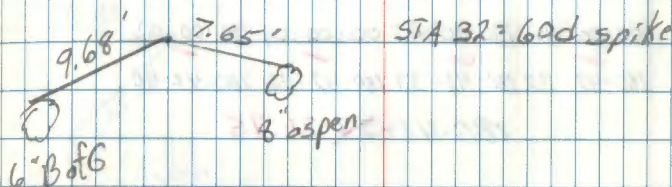

50.474 165.60A

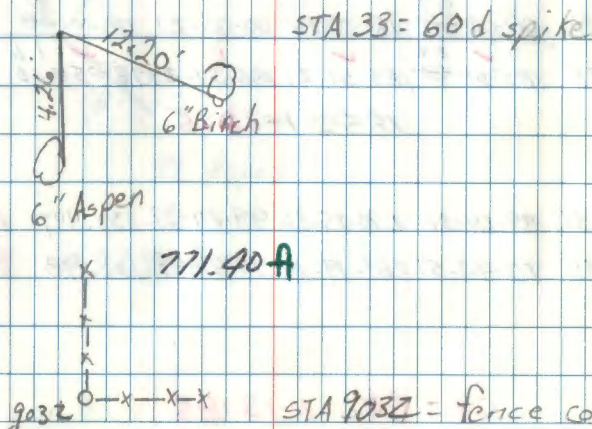

235.124 771.40A

STA 9032 = fence corner

T143N R26W

TRAVERSE CONT FROM PP 21

STA	1 st H _x 1 st V _x	2 nd H _x 2 nd V _x	3 rd H _x	4 th H _x Slope Dist	Horiz ₂ Dist
	MEAN H _x				

FS 35 180-42-52 00-42-46 180-42-45 00-42-43

BS 33 00-00-20 180-00-07 00-00-09 180-00-03

34	180-42-32	180-42-39	180-42-36	180-42-40	
----	-----------	-----------	-----------	-----------	--

180-42-37 36.75

34 to 35 26-08-15 273-51-50 86-08-13 84.020 83.829

35 to 34 94-00-15 266-00-07 94-00-04 84.026 83.821

FS	36	185-51-50	05-51-45	185-51-44	05-51-43
----	----	-----------	----------	-----------	----------

BS	34	00-00-33	180-00-24	00-00-21	180-00-38
----	----	----------	-----------	----------	-----------

35	185-51-27	185-51-21	185-51-23	185-51-16	
----	-----------	-----------	-----------	-----------	--

185-51-20.5

35 to 36 89-24-31 270-35-26 89-24-32 133.497 133.490

36 to 35 90-40-57 269-11-14 90-40-48 133.498 133.489

CK BA 11-13-85

Oct. 31, 1985

8" Aspen

41.02'

25.20'

12" Aspen

STA 34 = 60d spike

83.825 275.02A

8" Aspen

8.46'

14.28'

14" Aspen

STA 36 = 60 d spike

133.489 437.96A

T143N R26W

TRAVERSE CONT FROM PP 22

STA	1 st H ^g 1 st V ^h	2 nd H ^g 2 nd V ^h	3 rd H ^g	4 th H ^g Slope Dist	Horiz Dist
	MEAN \bar{x}				

FS 37 220-16-03 40-15-56 220-16-06 40-16-04

BS 35 00-00-20 180-00-21 00-00-24 180-00-26

76 36	220-15-43	220-15-35	220-15-4	220-15-38	
	220-15-70 \checkmark 39.5				

36 to 37 90-27-38 769-72-45 90-27-27 72.558 72.556

37 to 36 89-42-06 270-17-51 89-42-08 72.564 72.563

FS 38 123-31-32³¹ 903-31-29 123-31-29 303-31-32BS 36 00-00-18¹⁸ 180-00-06 00-00-16 180-00-10

76 37	123-31-13 ¹³	123-31-23	123-31-13	123-31-22	
	123-31-78 \checkmark 17.75				

37 to 38 92-32-56 267-27-22 92-32-47 139.083 138.946

38 to 37 87-32-22 272-47-42²⁷ 87-32-20 139.080 138.952

CK BA 11-13-85

Oct. 31, 1985



72.559 238.05A

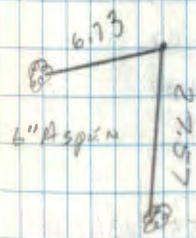

138.949 455.87A

T143N R26W

TRAVERSE CONT FROM PP 23

STA	1 st H ₄ V ₄	2 nd H ₄ V ₄	3 rd H ₄	4 th H ₄ Slope Dist
	MEAN H ₄			

FS 39	190-26- ²⁶ 55	10-26-52	190-26- ²⁷ 01	10-27-00
BS 37	00-00- ¹⁷ 35	180-00-10	00-00- ¹⁸ 28	180-00-15
TO 38	190-26- ³⁸ 27	190-26-42	190-26- ⁴⁴ 29	190-26-45
	190-26-42.25			

38 to 39 87-28-28 272-31-36 87-28-26 181.346 181.170

39 to 36 92-35-31 267-24-40 92-35-25 181.347 181.162

FS 40 181-36-⁴⁷57 01-36-47 181-36-48 01-36-44BS 38 00-00-⁰⁷20 180-00-07 00-00-12 180-00-07TO 39 181-36-³⁸27 181-36-40 181-36-36 181-36-27

181-36-39.75

39 to 40 88-34-39 271-25-28 88-34-36 131.155 131.115

40 to 39 91-30-59 268-29-59 91-30-30 131.166 131.115

CK-BA 11-13-85

Oct. 31, 1985

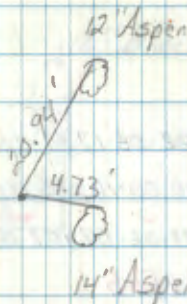

STA 38 = 60d spike
Set S_{1/4} S33 from this PT

181.166 594.38 A

Maple clump

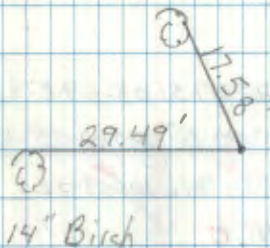

STA 39 = 60d spike

131.115 430.17 A

T143N R26W

TRAVERSE CONT FROM PP 24

STA 1st H4 2nd H4 3rd H4 4th H4
MEAN H4

FS 41 182-06-27 ⁰⁹ 02-06-20 182-06-17 02-06-08
BS 39 00-00-18 ⁰⁴ 180-00-05 00-00-10 180-00-04
TB 40 182-06-09 ⁰⁵ 182-06-15 182-06-07 182-06-04
182-06-06.25

40 to 41 89-37-34 270-22-22 89-37-36 103.616 103.614
41 to 40 90-29-09 269-31-09 90-29-00 103.623 103.619

FS 42 183-59-36 ³¹ 03-59-27 183-59-31 03-59-27
BS 40 00-00-19 180-00-10 00-00-15 180-00-05
TB 41 183-59-17 ¹⁷ 183-59-17 183-59-16 183-59-22
183-59-18.0

41 to 42 89-31-58 270-27-57 89-32-01 86.975 86.972
42 to 41 90-35-46 269-24-37 90-35-37 86.976 86.971

CK BA 11-13-85

Oct. 31, 1985

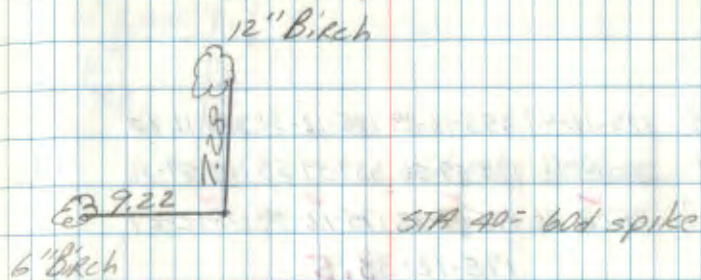

103.617 339.954

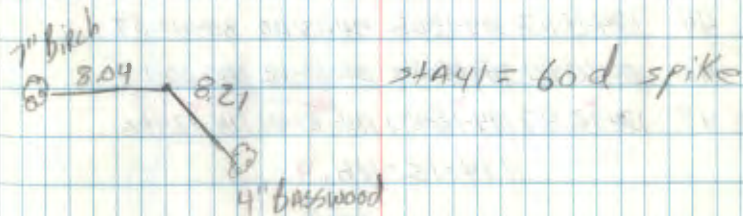

86.972 285-344

T/43N R26W

TRAVERSE CONT FROM PP 25 "

STA 1st H $\frac{1}{4}$ " 2^d H $\frac{1}{4}$ " 3^d H $\frac{1}{4}$ " 4th H $\frac{1}{4}$ "MEAN H $\frac{1}{4}$ "

FS 43 125-12-47 355-12-29 125-12-31 355-12-23

BS 41 00-00-11 179-59-56 359-59-53 179-59-56

TG 42 175-12-36 175-12-33 175-12-38 175-12-27

175-12-33.5

42 to 43 83-45-25 276-14-46 83-45-19 65.375 64.987

43 to 42 96-25-15 263-34-56 96-25-10 65.388 64.978

FS 44 174-13-07 354-13-06 174-13-00 354-12-59

BS 42 00-00-20 180-00-16 00-00-19 180-00-13

TG 43 174-12-47 174-12-50 174-12-41 174-12-46

174-12-46.0

43 to 44 90-29-18 269-30-50 90-29-14 210.183 210.175

44 to 43 89-34-00 270-26-00 89-34-00 210.181 210.175

CK BA 11-13-85

Oct 31, 1985

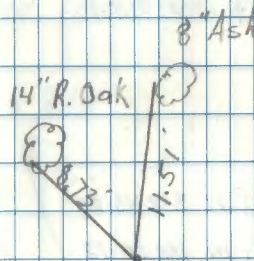

STA 42 = 60 d spike

64.983 213.204

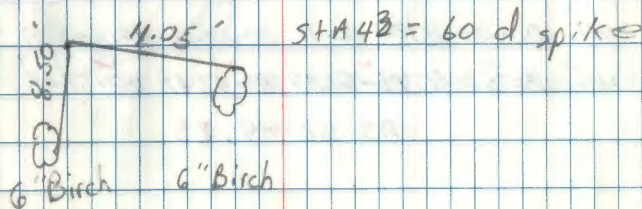

STA 43 = 60 d spike

210.175 689.554

T143N R26W

TRAVERSE CONT FROM PP 26

STA	1 st HX	2 nd HX	3 rd HX	4 th HX
	HX			

FS 45 178-43-20 358-43-12 178-43-11 358-43-09

BS 43 00-00-23 180-00-11 00-00-14 180-00-12

TI 44	178-42-57	178-43-01	178-42-57	178-42-57
	178-42-58.0			

44 to 45 91-58-40 268-01-22 91-58-39 171.924 171.822

45 to 44 88-05-30 271-5434 88-05-28 171.924 171.829

FS 46 183-53-03 03-52-58 183-52-58 03-52-55

BS 44 00-00-23 180-00-11 00-00-16 180-00-07

TI 45	183-52-40	183-52-47	183-52-42	183-52-48
	183-52-44.25			

45 to 46 90-23-10 219-36-54 90-23-08 231.331 231.326

46 to 45 89-40-00 270-20-16 89-39-52 231.327 231.318

CK BA 11-13-85

Nov. 1 1985

T-2 S/N 265185

SAME CREW

Red 1A S/N 4363

Cloudy CALM

DTR B. Husk E. G. Kosko

Temp. = 45.0F = G. Robertson

BIR = 29.2

FCF = 0

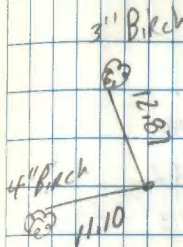

5295.5

171.825 563.73 #

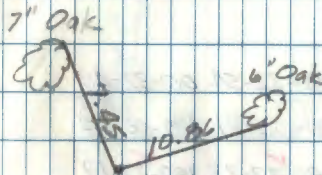

STA 45 = 60d spike

231.322 758.93 #

T143N R26W

Traverse Cont from pp 27

STA	1 st H ⁺ "	2 ^d H ⁺ "	3 ^d H ⁺ "	4 th H ⁺ "
	Mean H ⁺			

FS 47	181-00-43	01-00-38	181-00-42	01-00-40
BS 45	00-00-31	180-00-28	00-00-33	180-00-27
X @ 46	181-00-12	181-00-10	181-00-09	181-00-13
	181-00-11.0			

46 to 47	87-54-07	272-06-07	87-54-00	48.485	48.452
47 to 46	92-20-01	267-39-48	92-20-07	48.490	48.450

FS 48	180-32-54	00-32-48	180-32-54	00-32-49
BS 46	00-00-27	180-00-28	00-00-31	180-00- ³⁰ 34
X @ 47	180-32-27	180-32-20	180-32-23	180-32-19
	180-32-22.25			

47 to 48	91-01-44	268-58-25	91-01-40	144.606	144.583
48 to 47	89-03-15	270-56-50	89-03-13	144.610	144.590

CK BA 11-14-85

Nov. 1, 1985

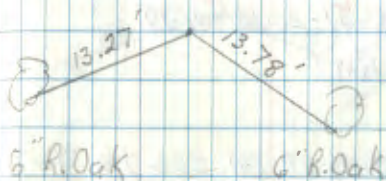

STA 46 = bad spike on west edge river channel

48.451 158.96A

24" R. Oak



24" Basswood STA 47 = bad spike

144.587 474.37A

T143NR26.4x

Traverse Cont'd from Pg 28

STA 1stH40 2ndH4R 3rdH40 4thH4R
HX

FS 49 181-41-36 01-41-26 181-41-23 01-41-19

BS 47 00-00-13 180-00-09 00-00-03 180-00-00

T@48 181-41-23 181-41-22 181-41-20 181-41-19
181-41-21.0

48 to 49 88-46-29 271-13-33 88-46-28 130.226 130.196

49 to 48 91-18-54 268-41-21 91-18-46 130.224 130.196

FS 50 182-30-57 02-30-48 182-30-55 02-30-46

BS 48 00-00-26 180-00-14 00-00-20 180-00-17

T@49 182-30-31 182-30-34 182-30-35 182-30-29
182-30-32.25

49 to 50 93-20-03 266-40-12 93-19-56 97.648 97.483

50 to 49 86-47-18 273-13-00 86-47-09 97.637 97.483

CK BA 11-14-85

Nov. 1, 1985

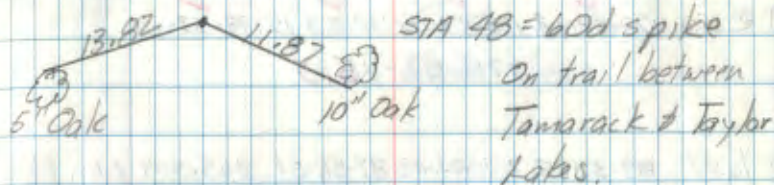

130.193 427.14 #

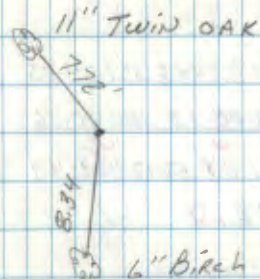

97.483 319.83 #

T143 N R26 W

Traverse Cont'd from Pg. 29

STA 1st HAD 2nd HAR 3rd HAD 4th HAR
HA

FS 51 178-53-20 358-53-12 178-53-20 358-53-20

BS 49 00-00-07 179-59-57 00-00-05 180-00-01

TA 50 178-53-13 178-53-15 178-53-15 178-53-19
178-53-15.5

50 to 51 89-58-05 270-02-03 89-58-01 265.509 265.509

51 to 50 90-04-46 269-55-22 90-04-42 265.517 265.517

FS 52 177-24-07 357-24-01 177-24-08 357-24-05

BS 50 00-00-20 180-00-15 00-00-18 180-00-16

TA 51 177-23-47 177-23-46 177-23-50 177-23-49
177-23-48.0

51 to 52 88-45-24 271-14-49 88-45-18 101.586 101.562

52 to 51 91-23-40 268-38-26 91-23-37 101.583 101.553

Nov. 1, 1985

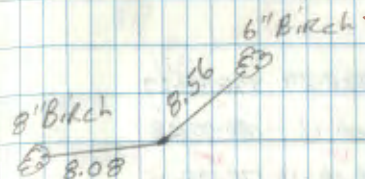

STA 50 = 60 d spike
East Side of
Taylor Lake

265.513 871.10 A

880.58



STA 51 = 60 d spike
West side of
Taylor Lake

101.557 333.19 A

T143 N R26W

Traverse Cont'd from pg. 30

STA 1st HAD 2nd HAR 3rd HAD 4th HAR
 HX

FS 53 178-28-~~29~~²⁶ 358-28-22 178-28-29 358-28-23

BS 51 00-00-~~27~~¹¹ 180-00-13 00-00-11 180-00-08

TP 52 178-28-~~29~~¹⁵ 178-28-09 178-28-18 178-28-15

178-28-14.25

52 to 53 91-09-06 268-51-04 91-09-01 56.640 56.627

53 to 52 89-02-47 270-57-17 89-02-45 56.642 56.634

FS 54 183-36-40 03-36-31 183-36-38 03-36-32

BS 52 00-00-23 180-00-23 00-00-22 180-00-16

TP 53 183-36-17 183-36-08 183-36-16 183-36-16

183-36-14.25

53 to 54 88-25-33 271-34-38 88-25-28 115.133 115.090

54 to 53 91-42-12 268-17-32 91-42-20 115.142 115.091

CK BA 11-14-85

Nov. 1, 1985

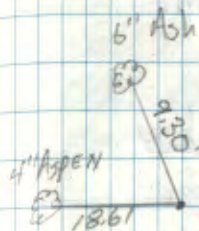

STA. 52 = 60 d spike

56.631 185.804

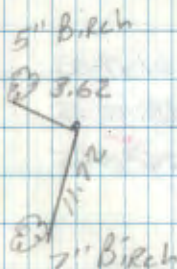

STA 53 = 60 d spike

115.090 377.594

T143 N R26W

Traverse Cont'd from pg 31

STA 1st HAD 2nd HAR 3rd HAD 4th HAR
HA

FS 55 176-16-30 356-16-24 176-16-25 356-16-29

PS 53 00-00-12 180-00-06 00-00-15 180-00-05

TR 54 176-16-18 176-16-18 176-16-20 176-16-24
176-16-20.0

54 to 55 89-26-07 270-33-50 89-26-09 113.377 113.372

55 to 54 90-39-53 269-20-06 90-39-50 113.378 113.370

FS 56 241-19-18 61-19-10 241-19-12 61-19-08

PS 54 00-00-28 180-00-15 00-00-20 180-00-23

TR 55 241-18-50 241-18-55 241-18-52 241-18-45
241-18-50.5

65 to 56 90-23-28 269-36-36 90-23-26 178.743 178.739

56 to 55 89-41-26 270-19-08 89-41-09 178.735 178.732

CK BA 11-14-85

Nov 4th, 1985

Clear, cold, calm

T-2 S/W 265184 RC 50 G. Kozenko

Reel-A S/W 9863 TR G. Robertson

BPR = 29.8 Temp = 35°F Angles - B. Ausk

ECF = -1 @ 8:30 AM B. Whitehorn

STA 54 = 60d spike

113.371 371.95A

4" Maple

STA 55 = 60d spike

SE corner of Hayfield

32-19

3" Maple

178.736 586.40A

T143N R26W

Traverse cont'd from pg 32

STA 1st H&D 2nd H&R 3rd H&D 4th H&R

H&R

FS 57 61-03-~~59~~⁵⁰ 241-03-46 61-03-52 241-03-44BS 55 00-00-~~14~~¹⁴ 180-00-09 00-00-12 180-00-08T@ 56 61-03-~~37~~³⁶ 61-03-~~35~~³⁷ 61-03-40 61-03-36
61-03-37.25

Dist 56-57 89-48-51 270-11-00 89-48-56 161.089 161.088

Dist 57-56 90-15-30 269-44-34 90-15-38 161.089 161.087

9057FS ~~54~~ 147-22-00 327-21-40 147-21-41 327-21-34

BS 56 00-00-20 180-00-00 00-00-01 179-59-56

T@ 57 147-21-40 147-21-40 147-21-40 147-21-38

147-21-40

CK BA 11-14-85

Nov 4, 1985

STA 56 = 60d spike
in middle of the field,
no ties

161.088 528.504

Sideshot to tie into Tamarack
Sale Traverse (T143N R26W Sec 3)STA 57 = STA 2005 of
the Tamarack Sale traverse
of 19839057 = 2004 Tamarack
sale traverse

T143N R26W

Traverse cont'd from pg 33

STA 1st H&D 2nd H&R 3rd H&D 4th H&R
H&R

FS 58 ²¹ 254-36-08 74-35-56 254-36-02 74-35-58
BS 56 00-00-20 180-00-00 00-00-01 179-59-56
TØ 57 ⁰¹ 254-35-48 254-35-56 254-36-01 254-36-02
254-36-00.0

Dist 57-58 89-50-15 270-09-50 89-50-13 298.128 298.127

Dist 58-57 90-12-13 269-47-53 90-12-10 298.134 298.132

FS 59 87-24-10 267-24-13 87-24-15 267-24-07
BS 57 10-00-20 180-00-22 00-00-20 180-00-¹⁵23
TØ 58 ²³ 87-~~37~~50 87-23-51 87-23-55 87-23-52
87-23-52.0

Dist 58-59 93-52-02 266-07-20 93-52-11 70.509 70.348

Dist 59-58 86-17-47 273-42-03 86-17-52 70.489 70.342

CK BA 11-14-85

Nov 4, 1985

298.130 978.11A

STA 57: PK nail in
E & fence line west intersect
100' in Hwy # (Use 1983
ties)

Older fence bears
south, 70 feet. Measured
south 70 ft from sta 57
for inter. E & old fence

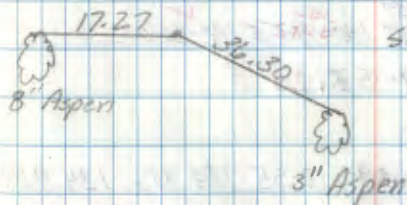

STA 58 = 60d spike
West side of hay
field

70.345 230.79 #

T143N R26W

Traverse cont'd from pg. 34.

STA 1st H&D 2nd H&D 3rd H&D 4th H&K

H4

FS 60 258-08-55 78-08-49 258-08-~~46~~⁵⁰ 78-08-46BS 58 00-00-18 180-00-11 00-00-~~18~~¹² 180-00-08T@59 258-08-37 258-08-38 258-08-~~28~~³⁸ 258-08-38258-08-~~38~~ 37.75

Dist 59-60 90-50-36 269-07-14 90-50-41 106.061 106.050

Dist 60-59 89-16-07 270-43-50 89-16-08 106.064 106.055

FS 61 180-20-06 00-20-~~11~~¹² 180-20-16 00-20-18BS 59 00-00-11 ~~180-00-15~~¹⁸⁰⁻⁰⁰⁻¹⁵ 00-00-21 180-00-16T@60 180-19-56 180-20-~~17~~¹⁹⁻⁵¹ 180-19-53 180-20-02

180-19-57.25

Dist 60-61 90-12-54 269-07-14 90-12-55 134.956 134.955

Dist 61-60 89-48-47 270-10-58 89-48-55 134.955 134.954

CK BA 11-14-85

Nov 4, 1985

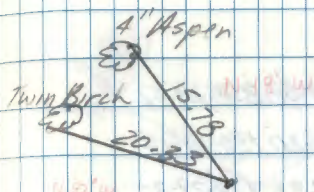

STA 59= 601 spike
(Near wooden gate SW edge
of field)

106.052 347.94A

STA 60 = 1 3/4 inch O.D.
rusted Iron pipe @
Fence corner. Fence
running N & E & W
(Possible 1/16?)

134.955 442.76A

T143N R26W

Traverse cont'd from pg 35

STA. 1st H&D 2nd H&D 3rd H&D 4th H&D
H&D

FS 62 178-29-59 358-29-57 178-29-58 358-29-52

BS 60 00-00-22 180-00-16 00-00-20 180-00-15

T@ 61 178-29-37 178-29-41 178-29-38 178-29-37

178-29-38.25

Dist 61-62 88-33-39 271-26-17 88-33-41 135.774 135.731

Dist 62-61 91-31-34 268-28-13 91-31-40 135.773 135.725

FS 63 182-48-28 02-48-24 182-48-28 02-48-21

BS 61 00-00-19 180-00-08 00-00-11 180-00-08

T@ 62 182-48-09 182-48-16 182-48-17 182-48-13

182-48-~~13~~ 13.75

Dist 62-63 88-49-54 271-10-21 88-49-47 140.845 140.816

Dist 63-62 91-15-23 268-04-40 91-15-22 140.849 140.815

CK BA 11-14-85

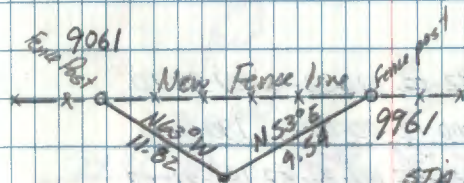
Nov 4th 1985

STA 61 = wood spike

135.728 445.30A

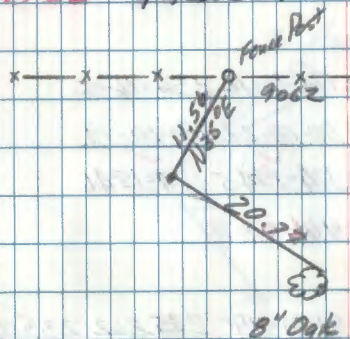

STA 62 = wood spike

140.815 461.99ft

T143N R26W

Traverse cont'd from pg 36

STA 1st HAR D 2nd HAR 3rd HAR D 4th HAR

H X

FS 64 181-32-15 01-32-~~02~~⁰⁶ 181-32-10 01-32-10

BS 62 00-00-13 180-00-12 00-00-13 180-00-13

T@ 63 181-32-02 181-31-~~50~~^{-5A} 181-31-57 181-31-57181-31-~~58~~ 57.5

Dist 63-64 90-05-32 269.5429 90-05-31 109.869 109.869

Dist 64-63 90-00-55 269.5909 90-00-53 109.878 109.878

FS 65 174-16-~~10~~¹⁵ 354-16-10 174-16-12 354-16-05BS 63 00-00-~~25~~²⁵ 180-00-27 00-00-27 180-00-19T@ 64 174-15-~~36~~⁵⁰ 174-15-43 174-15-45 174-15-46

174-15-46.0

Dist 64-65 91-01-46 268.5808 91-01-49 235.862 235.824

Dist 65-64 89-01-~~26~~²⁷⁰ 271-58-48 270-58-41 235.858 235.824

JDR 11-14-85

Nov 4, 1984

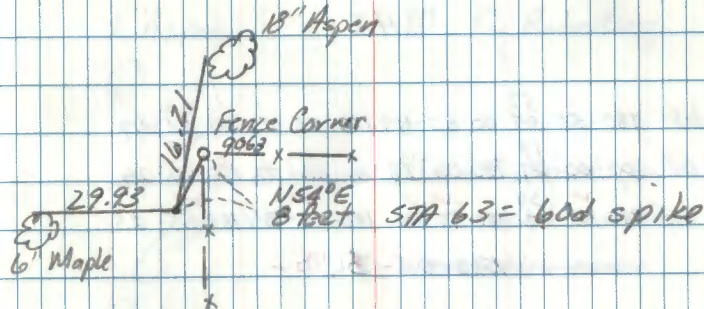

109.873 360.484

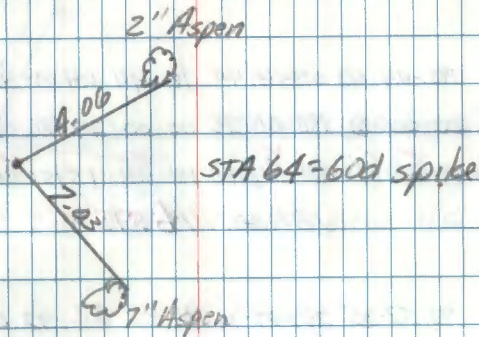

235.824 773.704

T143N R26W

Traverse cont'd from pg 37.

STA 1st H&D 2nd H&D 3rd H&D 4th H&D
H&D

FS 66 180-55-⁵²29 00-55-49 180-55-57 00-55-49
BS 64 00-00-¹⁸27 180-00-18 00-00-23 180-00-24
T@ 65 180-55-³⁴23 180-55-31 180-55-34 180-55-25
180-55-31.0

65 to 66 88-42-30 271-17-36 88-42-27 82.619 82.598
66 to 65 91-25-47 268-34-15 91-25-46 82.617 82.591

FS 67 181-44-49 01-44-44 181-44-44 01-44-44
BS 65 00-00-31 180-00-26 00-00-29 180-00-24
T@ 66 181-44-18 181-44-18 181-44-15 181-44-16
181-44-16.75

66 to 67 90-52-35 269-07-31 90-52-32 92.042 92.031
67 to 66 89-15-11 270-45-00 89-15-06 92.039 92.031

CK BA 11-14-85

Nov 4, 1985 P.M.

T@ G. Kosceko
□ G. Robertson

1" Aspen

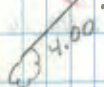

1" Aspen

82.594 270.98^A
~~89.595~~ 16" Aspen

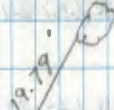

25.23'

8" Aspen

STA 65 = 60d spike on
West edge swamp
Linear 1/16 corner

STA 66 = 60d spike in
center of old logging
road (near 1/16 corner)

92.031 301.944

T143N R26W

Traverse cont'd from pg 38

STA 1st H&D 2nd H&D 3rd H&D 4th H&D

H&D

FS 68 217-40-38 37-40-31 217-40-33 37-40-30

BS 66 00-00-24 180-00-11 00-00-¹⁶ 180-00-14

X@ 67 217-40-14 217-40-20 217-40-17 217-40-16

217-40-16.75

67 to 68 89-07-22 270-52-48 89-07-17 65.680 65.672

68 to 67 91-03-11 268-56-55 91-03-08 65.690 65.677

FS 69 145-29-32 325-29-²³ 145-29-29 325-29-19BS 67 00-00-35 180-00-²⁸ 31 00-00-34 180-00-28X@ 68 145-28-57 145-28-⁵⁵ 45 145-28-55 145-28-51145-28-~~50~~ 54.5

68 to 69 91-25-07 268-35-01 268-34-57 105.074 105.042

69 to 68 88-41-34 271-18-30 271-18-28 105.070 105.043

✓ DR 11-14-85

Nov 4, 1985



STA 67 = 60d spike

6" Birch

65.676 215.47 f

12-91'

23.09

STA 68 = 60d spike

12" Aspen

105.042 344.63 f

38 11-11-85

T143N R26W

Traverse cont'd from pg 39

STA 1st H&D 2nd H&R 3rd H&D 4th H&R
HX

FS 70 172-43-40 352-43-32 172-43-30 352-43-23⁴²

BS 68 00-00-15 180-00-07 00-00-00 179-59-56

T@ 69 172-43-25 172-43-25 172-43-30 172-43-27

172-43-26.75

69 to 70 90-52-56 269-07-01 269-07-03 82.063 82.053

70 to 69 89-15-35 270-44-34 270-44-30 82.052 82.045

FS 71 228-31-34 48-31-32 228-31-26 48-31-23

BS 69 00-00-26 180-00-20 00-00-19 180-00-19

T@ 70 228-31-08 228-31-12 228-31-07 228-31-04

228-31-08 7.75

70 to 71 89-59-08 270-00-51 270-00-52 65.331 65.331

71 to 70 90-11-24 269-48-32 269-48-34 65.331 65.331

✓ DR 11-14-85

Nov 4, 1985

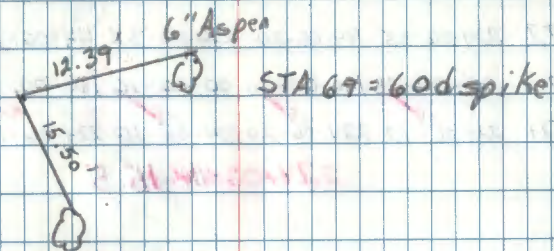

6" Birch
82.049 269.19A

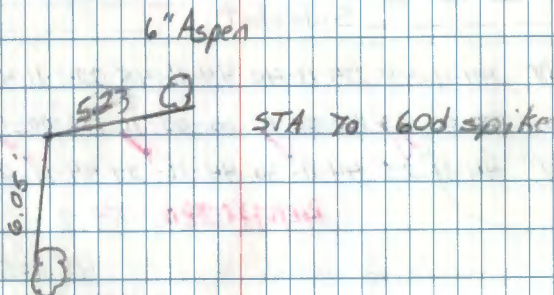

6" Aspen
65.331 210.34A

T143NR26W

Traverse Cont'd from Pg 40

STA 1st H&O 2nd HAR 3rd H&O 4th HAR
H4

Fs 72 224-06-35 44-06-30 224-06-32 44-06-28

BS 70 00-00-23 180-00-10 00-00-16 180-00-14

TP 71 224-06-12 224-06-20 224-06-16 224-06-14

224-06-16 15.5

71 to 72 88-56-44 271-03-27 271-03-22 172.328 172.299

72 to 71 91-07-25 268-52-41 268-52-38 172.338 172.305

Sideshot

Fs 3118 44-11-48 224-11-40 44-11-45 224-11-43

BS 70 00-00-23 180-00-10 00-00-16 180-00-14

TP 71 44-11-25 44-11-30 44-11-29 44-11-29

44-11-28

48.905M ^{160.40} 48.891M

71 to 3118 91-16-52 268-43-23 268-43-16 160.45 Ft 160.41 Ft

J DR 11-14-85

Nov 4, 1985

8" Aspen

13.02'

11.52'

10" Birch

STA 71 = 60d spike

172.302 565.294

STA 3118 = $\begin{matrix} 5.361531 \\ 5.115.6 \end{matrix}$

corner in swamp

48.893 160.416 too shaky to set up over

T 143 N R 26 W

Traverse Cont'd from Pg 41

STA 1st H&O 2nd HAR 3rd H&O 4th HAR

H&O

FS 73 178-34-00⁶⁰ 358-33-46 178-33-48 358-33-43

BS 71 00-00-27 180-00-15 00-00-11 180-00-14

T@ 72 178-33-33 178-33-31 178-33-34 178-33-29

178-33-~~00~~
91.75

72 to 73 91-18-23 268-41-49 268-41-43 95.447 95.422

73 to 72 88-49-02 271-11-20 271-11-09 95.437 95.417

FS 74 154-57-13 334-57-00 154-57-60 334-57-00⁰⁰BS 72 00-00-10 180-00-00 00-00-05 ~~179-57-56~~¹⁸⁰⁻⁰⁰⁻⁰⁰

T@ 73 154-57-03 154-57-00 154-56-55 154-57-00

154-57-~~00~~ 59.5
56

73 to 74 90-39-36 269-20-31 269-20-28 59.021 59.017

74 to 73 89-32-14 270-27-57 270-27-52 59.025 59.023

✓ DR 11-14-85

Nov 4, 1985

5" Birch

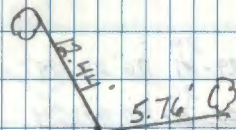

Twin Birch

STA 72 = 60d spike

95.419

313.054

6" W. Oak

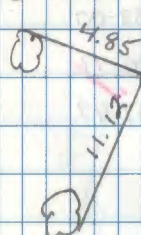

STA 73 16d nail

59.020

193.634

28451

T143 N R26 W

Traverse Cont'd from Pg 42

STA	1 st H&D	2 nd H&R	3 rd H&D	4 th H&R
				H&A

FS 75	206-29-37	26-29-36	206-29- ²⁹ 31	26-29-29
-------	-----------	----------	--------------------------	----------

BS 73	00-00- ²⁶ 25	180-00- ²⁶ 26	00-00- ²⁰ 20	180-00-24
-------	-------------------------	--------------------------	-------------------------	-----------

TC 74	206-29-12	206-29-10	206-29- ⁰³ 01	206-29-05
-------	-----------	-----------	--------------------------	-----------

206-29-08 07.5

74 to 75 90-28-26 269-31-40 ~~269-31-37~~ 166.470 166.46475 to 74 89-36-00 270-24-13 ~~270-24-07~~ 166.461 166.460

FS 76	182-38-06	02-37-59	182-38- ⁶⁴ 64	02-38-00
-------	-----------	----------	--------------------------	----------

BS 74	00-00-17	180-00-11	00-00-13	180-00-11
-------	----------	-----------	----------	-----------

TC 75	182-37-49	182-37-48	182-37-51	182-37-49
-------	-----------	-----------	-----------	-----------

182-37-49.25

75 to 76 89-39-49 270-20-22 270-20-17 209.106 209.102

76 to 75 90-23-32 269-36-33 269-36-31 209.111 209.106

✓ H&R 11-14-85

Nov 4, 1985

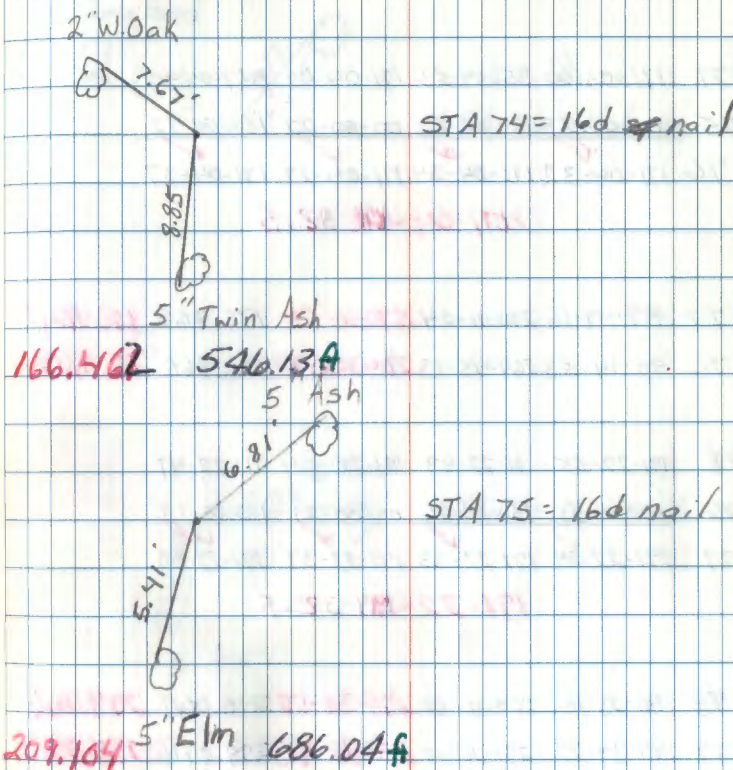

T143 N R26W

Traverse Cont'd from Pg 43

STA 1stH4D 2ndH4R 3rdH4D 4thH4R
H4

FS 77 171-05-⁶⁰ 351-04-53 171-04-49 351-04-49
BS 75 00-00-28 180-00-19 00-00-22 180-00-12
T@ 76 171-04-32 171-04-34 171-04-27 171-04-37
171-04-~~08~~ 32.5

76 to 77 89-49-16 270-11-04 270-10-54 176.868 176.867

77 to 76 90-14-53 269-45-13 269-45-10 176.865 176.863

FS 78 191-22-55 11-22-49 191-22-54 11-22-47

BS 76 00-00-21 180-00-16 00-00-21 180-00-17

T@ 77 191-22-34 191-22-33 191-22-33 191-22-30

191-22-~~00~~ 32.5

77 to 78 90-23-10 269-36-50 269-36-50 298.069 298.062

78 to 77 89-39-22 270-20-48 270-20-43 298.074 298.067

✓ DE 11-14-85

Nov 4, 1985

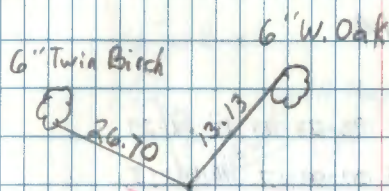

STA 76 = 16d nail

176.865 580.26A

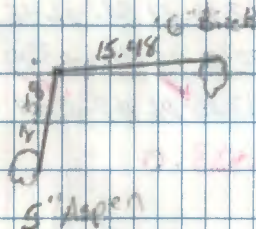

STA 77 = 16d nail

298.065 977.90A

T 143 N R 26 W

Traverse Cont'd from Pg 44

STA 1st H40 2nd H4R 3rd H40 4th H4R
H4

FS 79 ²⁸⁻³⁶ 193-28-26 13-28-35 193-28-28 13-28-29

BS 77 00-00-22 186-00-15 00-00-17 180-00-15

TA@78 193-28-14 193-28-20 193-28-11 193-28-14

193-28-14 14.75

78 to 79 92-04-58 267-55-11 267-55-07 75.594 75.544

79 to 78 88-04-05 271-56-01 271-55-58 75.587 75.544

FS 80 167-36-28 347-36-17 167-36-21 347-36-15

BS 78 00-00-29 180-00-16 00-00-15 180-00-14

TA@79 167-36-04 167-36-01 167-36-06 167-36-01

167-36-03.0

79 to 80 89-56-48 270-03-20 270-03-16 125.708 125.708

80 to 79 90-03-35 269-53-29 269-53-57 125.703 125.703

✓ JR 11-14-85

Nov 4, 1985

4" W Birch



4" R. Maple



5.11'

10.87'

STA 78 = ~~66~~ 16d nail

Nov 5, 1985

Clear, cold, windy

75.544 247.85 ft

Same crew as previous day

BPR = 29.4 ELF = -1

Temp = 35°F @ 8:30 AM

STA 79 = 60d spike

3" Ash



10.43'

7.42'



4" Ash

125.705 412.42 ft

T143N R26W

Traverse Cont'd from Pg 45

STA 1stHAD 2ndHAD 3rdHAD 4thHAD
H&

FS 81 166-36-46 346-36-44 166-36-48 346-36-46

BS 79 00-00-12 190-00-06 0-00-11 190-00-07

166-36-34 166-36-38 166-36-37 166-36-39

166-36-37.0

80 to 81 90-00-20 270-00-02 270-00-02 210-124 210.124

81 to 80 90-03-20 269-56-39 269-56-40 210-131 210.131

FS 82 192-15-55 02-15-49 192-15-52 02-15-48

BS 80 00-00-20 190-00-13 0-00-17 190-00-14

192-15-35 192-15-36 192-15-35 192-15-34

192-15-35.0

81 to 82 89-25-21 270-34-49 270-34-44 227.745 227.733

82 to 81 90-37-51 269-22-16 269-22-13 227.740 227.726

✓ 2R 11-14-85

Nov 5, 1985

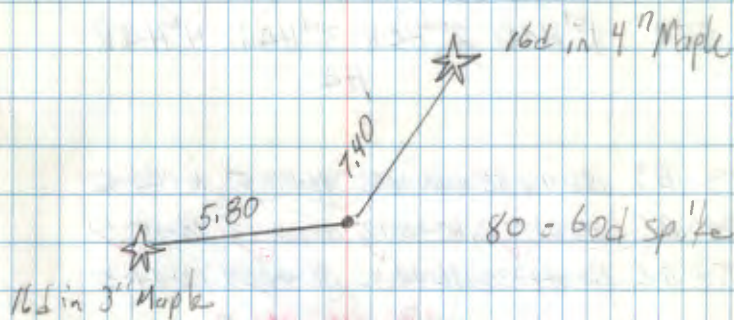

210.128 689.39 ft

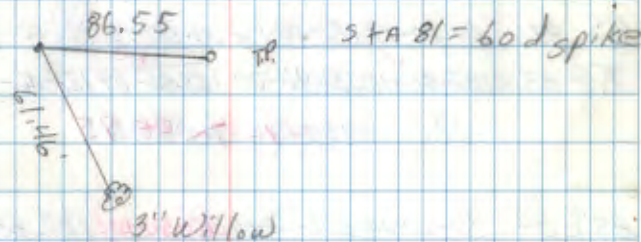

227.730 747.14 ft

T143 N R 26 W

Traverse Cont'd from Pg 46

STA 1st H&D 2nd H&R 3rd H&D 4th H&R
H&R

FS 83 196-44-52 16-44-42 196-44-57 16-44-42

BS 81 00-00-17 180-00-17 00-00-17 180-00-19

T@ 82 196-44-35 196-44-30 196-44-39 196-44-32

196-44-34.0

82 to 83 90-00-47 269-59-13 269-59-13 191.095 191.095

83 to 82 90-03-07 269-57-03 269-56-58 191.101 191.101

FS 84 137-46-29 317-46-23 137-46-25 317-46-19

BS 82 00-00-19 180-00-16 00-00-16 180-00-18

T@ 83 137-46-10 137-46-07 137-46-09 137-46-01

137-46-06.75

83 to 84 90-10-04 269-50-15 269-50-01 177.884 177.883

84 to 83 89-54-14 270-06-00 270-05-53 177.877 177.877

J AP 11-14-85

Nov 5, 1985

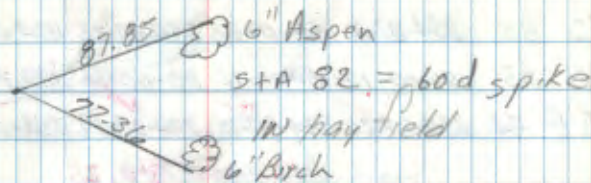
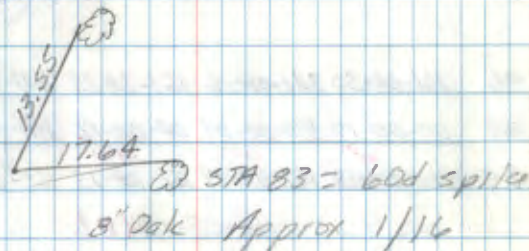
191.098 626.96[#] 20' Oak

177.880 583.594

T 143 N R 26 W

Traverse Cont'd from Pg 47

STA 1st HAD 2nd HAR 3rd HXD 4th HAR
HX

FS 85 234-07-31 54-07-32 234-07-33 54-07-29

BS 83 00-00-17 180-00-12 00-00-14 180-00-11

T@ 84 234-07-20 234-07-20 234-07-19 234-07-18

234-07-19.25

84 to 85 88-49-29 271-10-45 88-49-19 262.789 262.734

85 to 84 91-13-23 268-46-40 91-13-22 262.799 262.739

FS 86 161-08-30 341-08-26 161-08-25 341-08-22

BS 84 00-00-17 180-00-09 00-00-12 180-00-07

T@ 85 161-08-13 161-08-19 161-08-13 161-08-15

161-08-15.0

85 to 86 90-05-29 269-54-45 90-05-22 97.987 97.987

86 to 85 90-01-48 269-58-20 90-01-44 97.977 97.977

✓ OK Calc 11/14/85

Nov 5, 1985

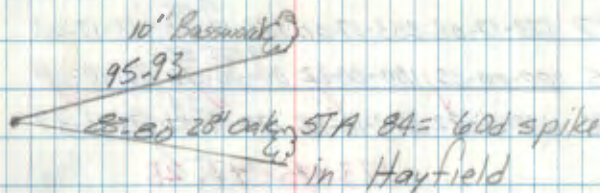

262.736 ✓ 861.99A

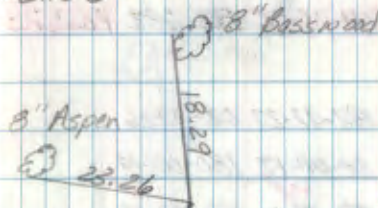

STA 85 = 60d spike

Approx 1/4 cor

97.982 ✓ 321.46A

T 143 N R 26 W

Traverse Cont'd from Pg 48

STA 1st H&D 2nd HAR 3rd H&D 4th HAR
HAFS 87 173-17-05 353-17-00 173-17-~~00~~^{15 05} 353-17-08BS 85 00-00-23 180-00-27 00-00-~~30~~^{41 55} 180-00-29T@ 86 173-16-42 173-16-38 173-16-~~34~~³⁴ 173-16-39

173-16-38.25

86 to 87 89-18-34 270-41-27 270-41-27 190.673 190.659

87 to 86 90-45-25 269-14-34 269-14-35 190.682 190.665

FS 88 182-42-28 02-42-23 182-42-27 02-42-26

BS 86 00-00-15 180-00-16 00-00-17 180-00-14

T@ 87 182-42-13 182-42-09 182-42-10 182-42-12

182-42-10.5

87 to 88 89-30-15 270-29-42 270-29-44 200.924 200.917

88 to 87 90-33-20 269-26-39 269-26-40 200.918 200.909

JDR 11/18/85

Nov 5, 1985

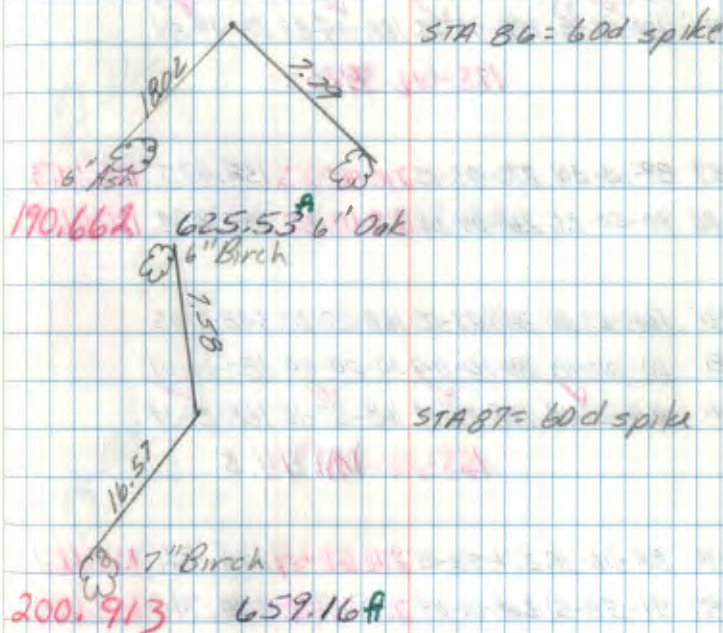

T143N R26W

Traverse cont'd from pg 49

STA 1st HAD 2nd HAR 3rd HAD 4th HAR
 0 0 0 0
 HX

FS 89 188-04-32³² 08-04-38 188-04-35 08-04-35BS B7 179-59-54⁵⁴ 179-59-55 359-59-58 179-59-54T@88 188-04-33³³ 188-04-43 188-04-37 188-04-41

188-04-38.5

Dist 88-89 89-14-40 270-45-25 270-45-23 135.475 135.463

Dist 89-88 90-50-36 269-09-36 269-09-30 135.484 135.469

FS 90 168-27-24 348-27-18 168-27-20 348-27-15

BS 88 00-00-10 180-00-04 00-00-04 180-00-01

T@89 168-27-14 168-27-14 168-27-16 168-27-14

168-27-14.5

Dist 89-90 88-06-18 271-53-45 271-53-44 134.741 134.667

Dist 90-89 91-58-51 268-01-09 268-01-09 134.740 134.660

JHR 11-11-85

Nov 5, 1985

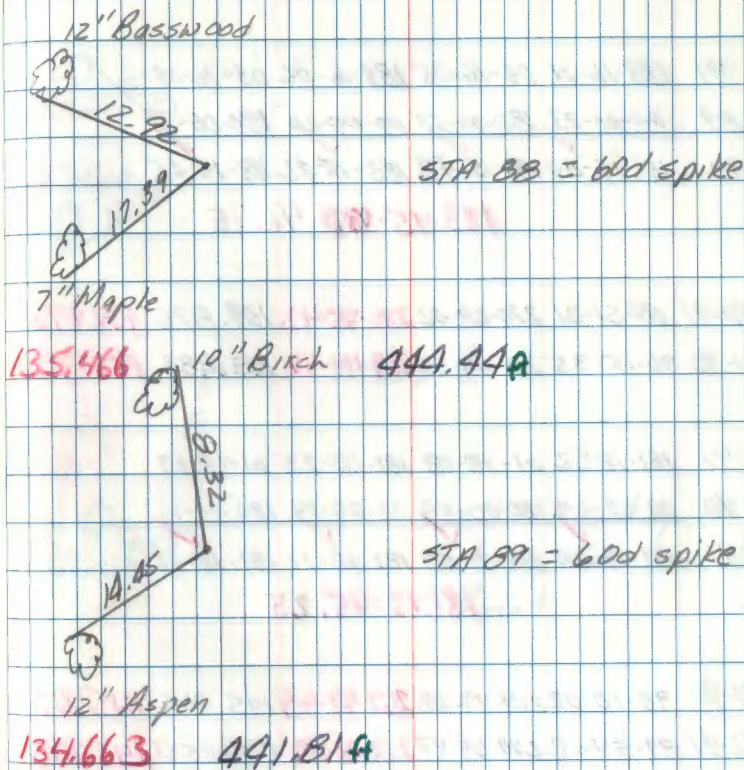

T 143N R26W

Traverse cont'd from pg. 50

STA 1st H&D 2nd H&D 3rd H&D 4th H&D

H&D

FS 91 183-16-11 03-16-05 183-16-06 03-16-04

BS 89 00-00-23 180-00-17 00-00-20 180-00-19

TP 90 183-15-48 183-15-48 183-15-46 183-15-45

183-15-48 46.75

Dist 90-91 89-51-21 270-08-42 270-08-41 109.876 109.876

Dist 91-90 90-15-35 89-44-59 269-44-40 109.883 109.882

FS 92 181-18-32 01-18-18 181-18-25 01-18-17

BS 90 00-00-24 180-00-19 00-00-14 180-00-11

TP 91 181-18-08 181-18-08 181-18-11 181-18-06

181-18-08.25

Dist 91-92 90-10-02 269-49-28 269-49-43 145.862 145.861

Dist 92-91 89-54-18 270-05-47 270-05-45 145.853 145.853

J MAR 11-17-85

Nov 5, 1985

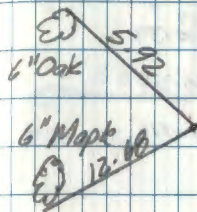

STA 90 = 60d spike

109.879 2" Maple 360.49A

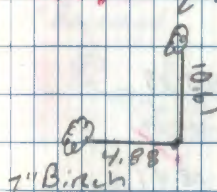
STA 91 = 60d spike
Set Sec Cor from this
Point

145.857 478.53A

T143N R26W

Traverse cont'd from pg 51

STA 1st H&D 2nd H&R 3rd H&D 4th H&R

H&R

FS 93 ⁸179-00-30 ³⁸359-00-36 ⁸179-00-45 ⁹359-00-39BS 91 00-01-01 ⁵⁵180-00-57 ⁵⁵00-00-54 180-00-54T@ 92 178-59-49 ⁴³178-59-39 ⁴³178-59-51 ⁴³178-59-45

178-59-47.0

92 + 93 90-03-58 269-56-15 ~~269-56-07~~ 155.485 155.48593 + 92 90-00-53 269-59-50 ~~269-59-40~~ 155.491 155.491

FS 94 192-03-16 12-03-12 192-03-18 12-03-13

BS 92 00-00-33 180-00-23 20-00-33 180-00-24

T@ 93 192-02-43 192-02-49 192-02-46 192-02-47

192-02-46.25

93 + 94 91-40-58 268-19-17 ~~268-19-10~~ 146.395 146.33294 + 93 88-24-05 271-36-05 ~~271-36-00~~ 146.382 146.325

JMR 11-18-85

Nov. 5, 1985

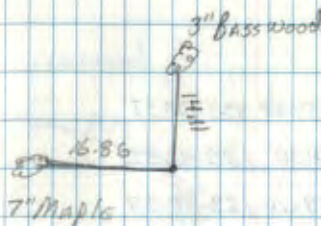

STA 92 = 60 d spike



STA 93 = 60 d spike

146.329 480.08 ft

T143N R26W

TRAVERSE CONT FROM Pg 52
 STA 1st H&D 2nd H&R 3rd H&D 4th H&R
 H&R

FS 95 153-54-48 333-54-86 853-54-44 333-54-37
 BS 93 00-00-32 180-00-28 00-00-30 180-00-30
 T@ 94 153-54-16 153-54-08 153-54-14 153-54-07

153-54-11.25

94 to 95 91-07-17 268-52-45 91-07-16 160.200 160.169
 95 to 94 88-57-11 277-03-02 88-57-05 160.204 160.177

FS 96 192-29-44 12-29-37 192-29-42 12-29-38
 BS 94 00-00-33 180-00-21 00-00-28 180-00-22
 T@ 95 192-29-11 192-29-16 192-29-14 192-29-16

192-29-14.25

95 to 96 92-14-20 267-46-01 92-14-10 121.843 121.750
 96 to 95 87-51-40 272-08-30 87-51-35 121.828 121.743

✓ OK Ck. 11/18/85

Nov. 5, 1985

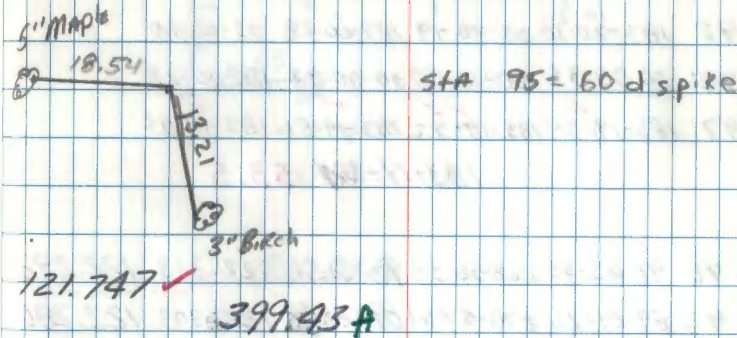
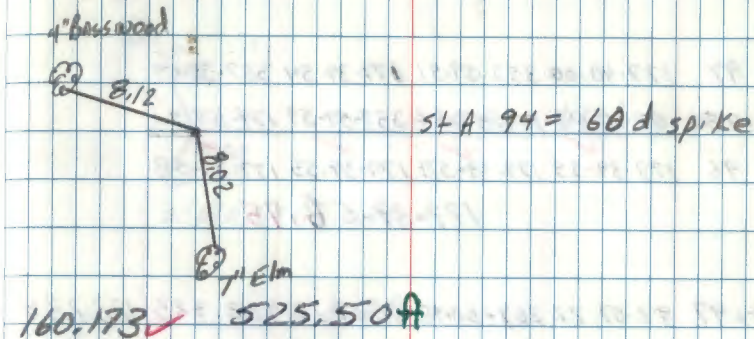

T143N R26W

TRAVERSE Cont from Pg 53

STA 1st H&D 2nd H&R 3rd H&D 4th H&R

H&R

FS 97 177-40-00 357-39-51 177-39-54 357-39-49

BS 95 00-00-05 179-59-52 357-59-59 179-59-51

T@ 96 177-39-55 177-39-59 177-39-55 177-39-58

177-39-56.75

96 to 97 92-07-22 267-52-38 92-07-22 122.323 122.239

97 to 96 87-58-14 272-01-50 87-58-12 122.320 122.243

FS 98 183-20-30¹⁹ 03-20-19⁸ 183-20-28⁸ 03-20-20

BS 96 00-00-36 180-00-27 00-00-32 180-00-28

T@ 97 183-19-54 183-19-52 183-19-56 183-19-52

183-19-~~54~~ 53.5

97 to 98 91-03-35 268-56-33 91-03-31 122.313 122.292

98 to 97 89-01-26 270-57-51 89-01-48 122.303 122.286

VOK Br. 11/18/85

Nov. 5, 1985

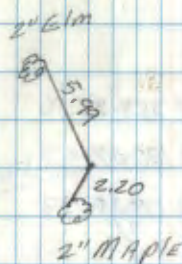

STA 96 = 60d spike

122.241 ✓ 401.05 A

7" Basswood

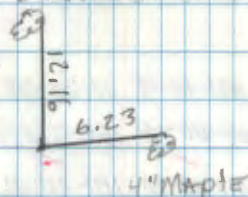

STA 97 = 60d spike

122.289 ✓ 401.21 A

T143N R26W

TRAVERSE Cont from Pg 54

STA 1st H&D 2nd H&D 3rd H&D 4th H&D

H &

FS 99 179-36-04 159-35-57 179-36-02 359-35-56

BS 97 00-00-41 180-00-29 00-00-30 180-00-23

T@ 98 179-35-23 179-35-28 179-35-32 179-35-33

179-35-29.0

78 to 99 89-31-39 270-28-27 89-31-36 122.254 122.250

99 to 98 90-34-20 269-25-45 90-34-17 122.259 122.253

FS 100 181-20-34 01-20-29 181-20-28 01-20-25

BS 98 00-00-25 180-00-10 00-00-18 180-00-09

T@ 99 181-20-09 181-20-19 181-20-10 181-20-16

181-20-14 13.5

99 to 100 90-52-21 269-07-49 90-52-16 188.802 188.780

100 to 99 89-11-29 270-48-37 89-11-26 188.792 188.773

✓ OK Hk. 11/18/85

Nov. 5, 1985

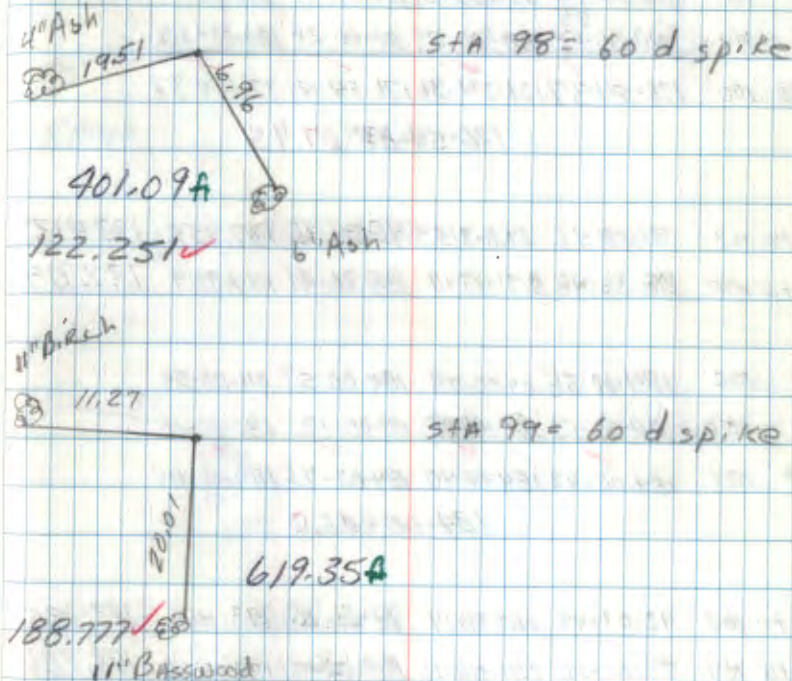

2/11/85

7143N R260

TRAVERSE Cont. from Pg 55

STA 1st H&R 0 2nd H&R 3rd H&R 4th H&R

H 4

FS 101 176-55-02⁴ 356-55-0⁵ 176-55-09 356-55-07BS 99 00-00-25²⁵ 180-00-25 00-00-28 180-00-30

T@ 100 176-54-37 176-54-36 176-54-41 176-54-37

176-54-48 37.95

100 to 101 91-28-16 268-3153 91-28-12 137.958 137.913

101 to 100 88-36-48 271-23-10 88-36-49 137.959 137.919

FS 102 184-00-56 04-00-48 184-00-57 04-00-54

BS 100 00-00-13 186-00-08 00-00-12 180-00-10

T@ 101 184-00-43 184-00-40 184-00-45 184-00-44

184-00-43.0

101 to 102 92-01-49 267-58-14 92-01-48 193.406 193.285

102 to 101 98-01-38 271-58-16 88-01-41 193.400 193.286

✓ OK br. 11/18/85

Nov, 5, 1985

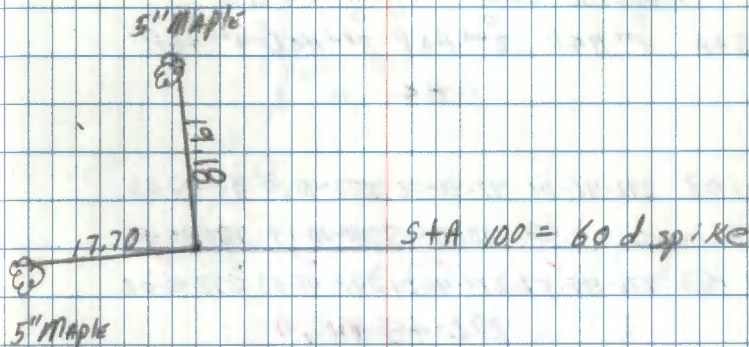

137.916 ✓ 452.48A

8" ASPEN

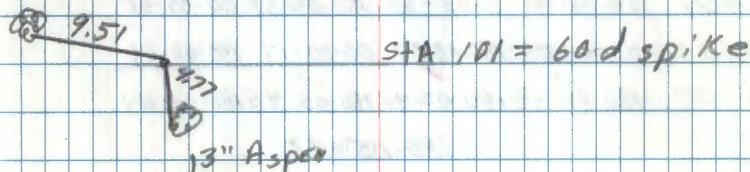

193.285 ✓ 634.14A

T143N R 26W

TRAVERSE CONT From Pg 56

STA 1st H&P 2nd H&P 3rd H&P 4th H&P

H&P

FS 103 272-46-14 272-46-08 272-46-10 272-46-09

RS 101 0-00-22 180-00-07 00-00-13 180-00-26

T@ 102 272-45-52 272-46-01 272-45-57 272-46-02

272-45-58.0

102 to 103 89-35-16 270-24-47 87-35-14 506.848 506.835

103 to 102 90-26-22 269-33-49 90-26-16 506.848 506.833

— SIDESHOT TO LOOP TRAV 400's —

FS 401 180-06-50 0-05-53 180-05-58 00-05-50

RS 101 0-00-22 180-00-07 00-00-13 180-00-06

T@ 102 180-05-38 180-05-46 180-05-45 180-05-44

180-05-43

102 to 401 89-47-55 270-12-10 87-47-52 139.412 139.411

401 to 102 90-13-08 269-46-43 90-13-12 139.396 139.395

VOK CR 11/18/85

Nov. 5, 1985

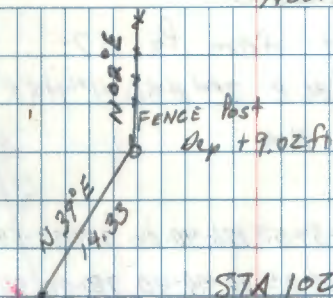

STA 102 = 60d spike in
ditch, N side of Rd
Near SW Cor S18

506.834 ✓ 1662.84A

LOOP TRAV AROUND SEC'S 18 x 17

89.403 457.36A

T143N R26W

TRAVERSE Cont. from Pg 57

STA 1st H&D 2nd H&R 3rd H&D 4th H&R

H4

FS 104 176-39-54 356-39-50 178-40-00 356-39-58

BS 102 20-00-31 180-00-35 80-00-40 180-00-37

PI@ 103 176-39-23 176-39-15 176-39-20 176-39-21

176-39-20 19.75

103 to 104 90-21-16 280-032 280.027

104 to 103 89-39-47 270-20-01 89-39-53 280.028 280.023

FS 105 179-13-49 359-13-40 179-13-49 359-13-44

BS 103 20-00-06 180-00-05 20-00-09 180-00-06

PI@ 104 179-13-43 179-13-35 179-13-40 179-13-38

179-13-39.0

Dist 104-105 89-53-15 270-06-41 89-53-17 807.434 807.433

Dist 105-104 90-08-03 269-52-04 90-08-00 807.437 807.435

VOK Bk 11/18/85

Nov. 5, 1985

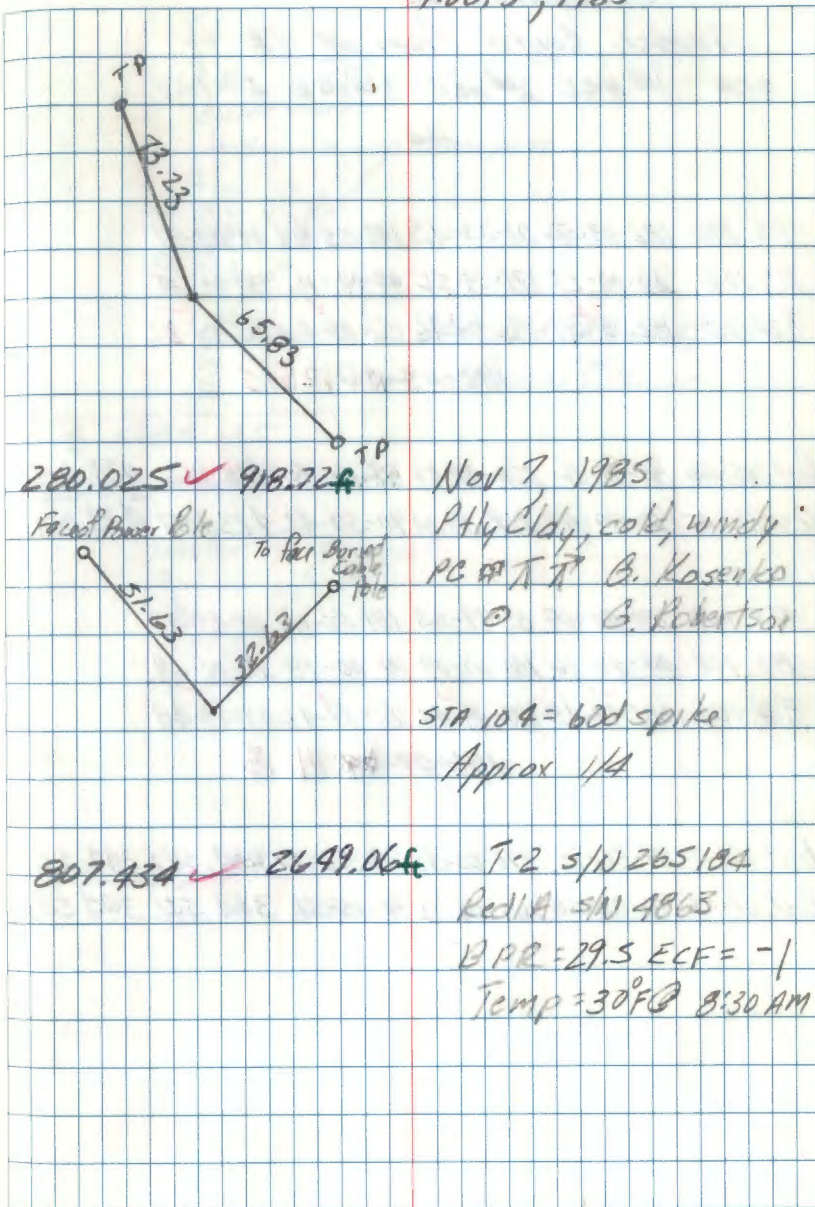

T14311 R26W

Traverse Cont'd from pg 58

STA 1st H&D 2nd H&D 3rd H&D 4th H&D

H4

FS 106 182-03-56 02-03-42 182-03-51 02-03-41

BS 104 00-00-17 179-59-56 00-00-11 180-00-12

T@ 105 182-03-39 182-03-46 182-03-41 182-03-36

182-03-40.25

Dist 105-106 89-11-16 270-48-47 89-11-15 423.056 423.013

Dist 106-105 90-50-48 269-09-29 90-50-42 423.057 423.011

FS 107 181-50-04 01-49-53 181-50-04 01-49-57

BS 105 00-00-16 180-00-09 00-00-18 180-00-09

T@ 106 181-49-48 181-49-44 181-49-46 181-49-43

181-49-44 46.5

Dist 106-107 89-56-13 270-03-56 89-56-08 344.547 344.547

Dist 107-106 90-05-55 269-54-13 90-05-51 344.546 344.546

✓ OK. 11/18/85

Nov 5, 1985

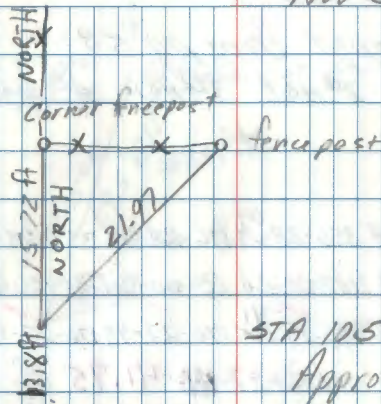

423.012 ✓ 1387.83 f

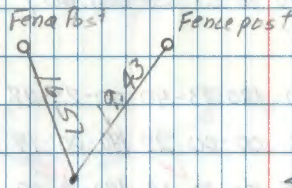

STA 106 = 60d spike

Approx 1/16

344.546 ✓ 1130.40 f

T143N R26W

Traverse cont'd from pg. 59

STA 1st H&D 2nd H&D 3rd H&D 4th H&D

45

FS 108 176-28-14 356-28-23⁰⁹ 176-28-18 356-28-10

RS 106 00-00-34 180-00-28 00-00-34 180-00-28

T@ 107 176-27-40 176-27-41⁴¹ 176-27-44 176-27-42

176-27-42 41.75

Dist 107-108 89-40-17 270-19-57 89-40-10 631.014 631.004

Dist 108-107 90-21-25 269-38-40 90-21-23 631.009 630.997

FS 109 180-23-42 00-23-30 180-23-40 00-23-28

RS 107 00-00-23 180-00-18 00-00-22 180-00-19

T@ 108 180-23-19 180-23-12 180-23-18 180-23-09

180-23-18 14.5

Dist 108-109 91-59-49 268-20-18 91-39-46 104.821 104.777

Dist 109-108 88-26-42 271-33-20 88-26-41 104.815 104.776

✓ OK Acc. 11/18/85

Nov 7, 1985

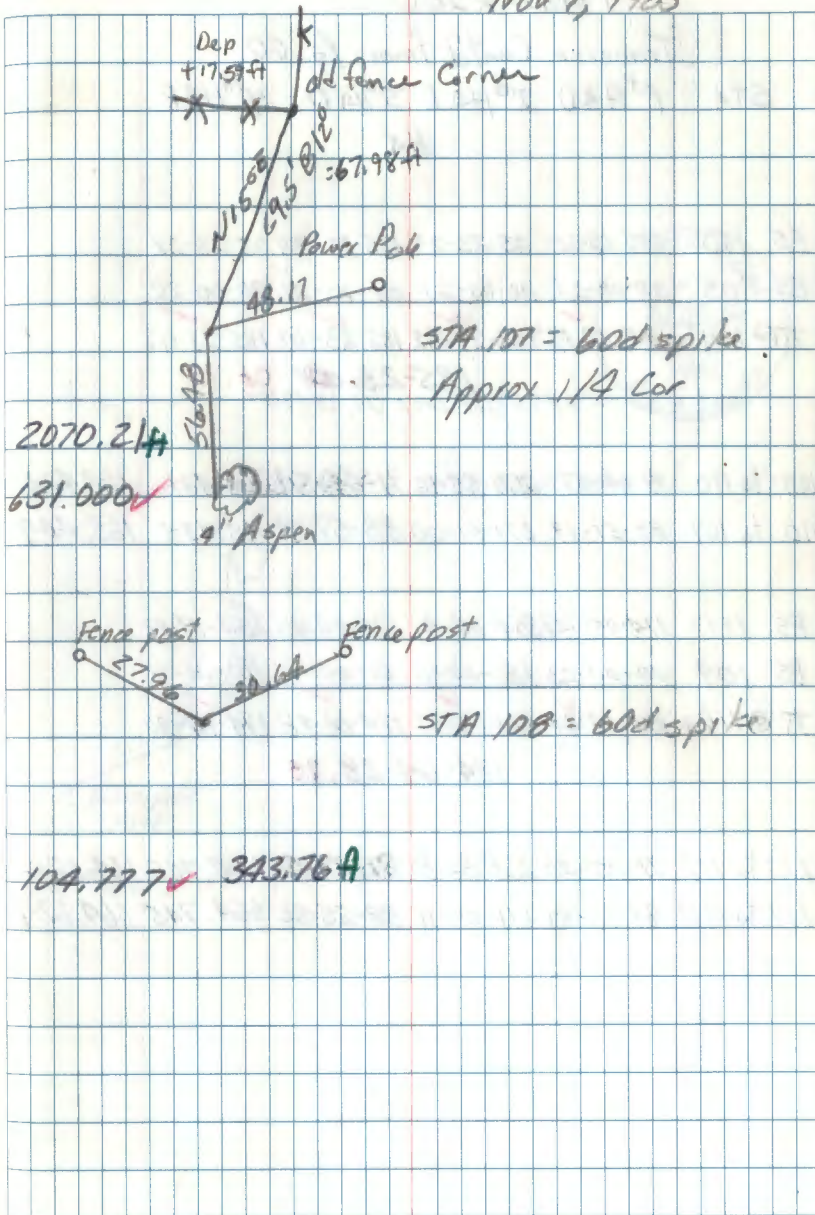

T143N R26W

Traverse Cont'd from Pg. 60

STA 1st H&O 2nd HAR 3rd H&O 4th HAR
H&A

FS 110 185-23-32 05-23-23 185-23-24 05-23-28

BS 108 00-00-21 180-00-21 00-00-26 180-00-22

T@ 109 185-23-11 185-23-02 185-23-08 185-23-06

185-23-09 06.75

Go to P1 65 for Loop 20, 29 & 30

109 to 110 91-04-57 268-55-10 91-04-54 163.431 163.402

110 to 109 88-59-19 271-01-00 88-59-09 163.435 163.409

FS 111 174-04-47 354-04-41 174-04-46 354-04-43

BS 109 00-00-23 180-00-10 00-00-18 180-00-15

T@ 110 174-04-24 174-04-51 174-04-28 174-04-30

174-04-28.25

110 to 111 91-05-40 268-54-30 91-05-35 664.745 664.624

111 to 110 88-55-54 271-04-11 88-55-52 664.745 664.629

OK G&C 11/18/85

Nov 7, 1985

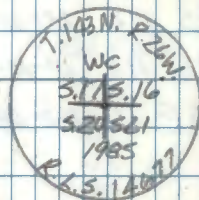

STA 109 =

163.406 ✓ 536.11A
6" Aspen

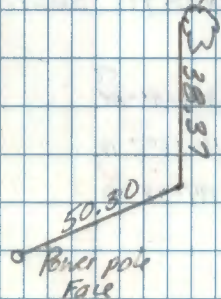

STA 110 = 60d spike

664.627 ✓ 2180.53A

T143 N R26W

Traverse Cont'd from Pg 61

STA 1stH&D 2ndH&R 3rdH&D 4thH&R
HX

FS 112 183-05-05 03-05-01 183-05-12 03-05-09

BS 110 00-00-18 180-00-22 00-00-31 180-00-27

X @ 111 183-04-47 183-04-39 183-04-41 183-04-42
183-04-42.25

111 to 112 90-02-30 269-57-39 90-02-26 503.986 503.986

112 to 111 89-59-19 270-00-52 89-59-11 503.998 503.978

FS 113 174-49-03 354-48-58 174-49-02 354-48-48

BS 111 0-00-19 180-00-12 0-00-16 180-00-10

X @ 112 174-48-44 174-48-46 174-48-46 174-48-48
174-48-46.0

112 to 113 89-58-26 270-01-36 89-58-25 320.123 320.123

113 to 112 90-03-49 269-56-16 90-03-46 320.124 320.124

✓ OK Gk 11/18/85

Nov 7, 1985

T.143N. R.26W.

1/4 S. 1/4
S. 21
1966
W.C.
P. 110, 180

STA 111 =

Concrete Monument w/BS

503.982 ✓ 1653.08 ft



STA 112 = 60d spike

No ties available

320.123 ✓ 1050.27 ft

63

T143N R26W

Traverse cont'd from pg 62

STA 1st H&D 2nd H&R 3rd H&D 4th H&R

H4

PS 1 184-23-03⁵ 04-20-31^{19 8} 184-20-43 04-14-49PS 112 0-00-16 179-57 48^{179-57 48} 357-58-00 179-51-58

PS 113 184-22-47 174-22-43 184-22-43 184-22-49

184-22-00 45.5

113 to 1 90-02-46²⁶⁹ 57-21 90-02-43 820.370 820.370

1 to 113 89-58-32 270-01-39 89-58-27 820.373 820.373

END MAIN TRAV LOOP

See p 5 for closing angle

T@1

✓ OK G.P. 11/18/85

Nov 7, 1985

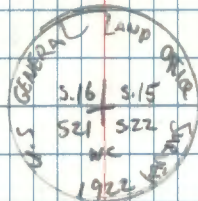
STA 113E 1 3/4 dia
IP W/2 1/2 BC

820.372 ✓ 2691.50 ft

1952

1953

1954

1955

1956

1957

1958

1959

1960

1961

1962

1963

1964

1965

1966

1967

1968

1969

1970

1971

1972

1973

1974

1975

1976

1977

1978

1979

1980

1981

1982

1983

1984

1985

1986

1987

1988

1989

1990

1991

1992

1993

1994

1995

1996

1997

1998

1999

2000

2001

2002

2003

2004

2005

2006

2007

2008

2009

2010

2011

2012

2013

2014

2015

2016

2017

2018

2019

2020

2021

2022

2023

2024

2025

1952

1953

1954

1955

1956

1957

1958

1959

1960

1961

1962

1963

1964

1965

1966

1967

1968

1969

1970

1971

1972

1973

1974

1975

1976

1977

1978

1979

1980

1981

1982

1983

1984

1985

1986

1987

1988

1989

1990

1991

1992

1993

1994

1995

1996

1997

1998

1999

2000

2001

2002

2003

2004

2005

2006

2007

2008

2009

2010

2011

2012

2013

2014

2015

2016

2017

2018

2019

2020

2021

2022

2023

2024

2025

65

T143N R26W

SKETCH

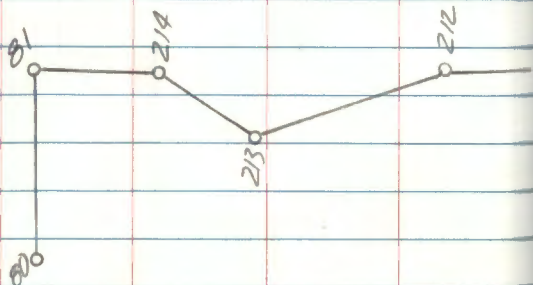
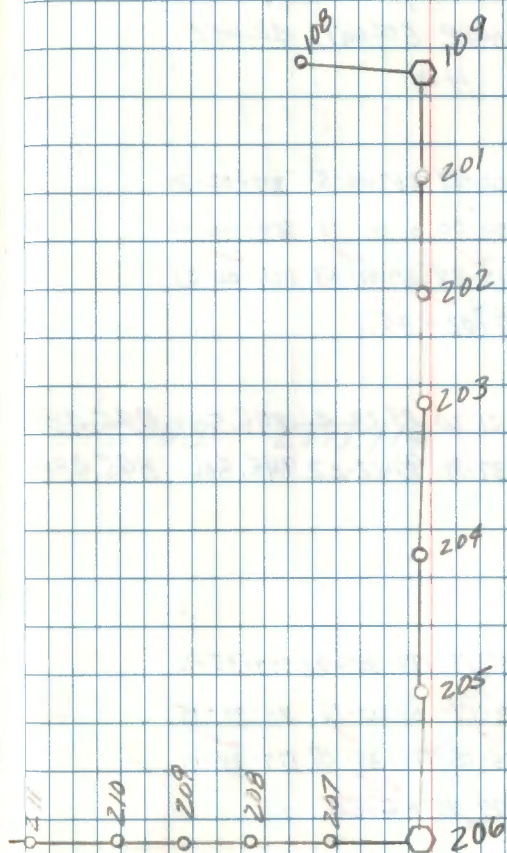
OF 1st Loop

66

T143N R26W

TRAVERSE C.S.A.H * 65 1/4

Sec 20, 29 & 30 1st LoopSTA 1st H&D 2nd H&R 3rd H&D 4th H&R

H&R

FS 201 267-02-48 87-02-58 267-02-31 87-02-39

BS 108 0-00-16 180-00-00 0-00-13 180-00-06

AB 109 267-02-32 267-02-38 267-02-39 267-02-33
 267-02-35

109 to 201 89-38-52 270-21-20 89-38-46 845.503 845.487

201 to 109 90-22-22 267-37-39 90-22-22 845.506 845.488

FS 202 179-35-28 359-35-17 179-35-23 359-35-16

BS 109 0-00-19 180-00-14 0-00-16 180-00-15

AB 201 179-35-09 179-35-08 179-35-07 179-35-01
 179-35-05

201 to 202 89-58-37 270-01-32 89-58-33 406.646 406.644

202 to 201 90-03-29 269-56-46 90-03-21 406.653 406.653

✓ OK Ch. 11/18/85

Nov 7, 1985

Cloudy / Cool / Breezy

P.C. T R G. Kosenko

M K. Whitehorn

Φ B. Ansk, G. Robertson

• STA 109 = Aluminum Mon
 see pp 61 thru Book

845.488 ✓ 2773.91A

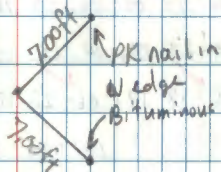

STA 201 = 60d spike

406.648 ✓ 1334.14A

67

T143N R26W

Traverse Continued from page 66

STA 1st HD 2nd H&R 3rd HD 4th H&R
H&R

FS 203 180-07-17 0-07-00 180-07-06 0-07-00

RS 201 0-00-17 180-00-04 0-00-06 180-00-05

AB 202 180-07-00 180-06-56 180-07-00 180-06-55

180-06-59.75 SB

202 to 203 90-20-22 269-39-48 269-39-43 396.784 396.777

203 to 202 89-41-23 270-18-26 270-18-27 396.783 396.777

FS 204 181-06-43 01-06-35 181-06-38 1-06-38

RS 202 0-00-25 180-00-13 0-00-21 180-00-12

AB 203 181-06-18 181-06-22 181-06-17 181-06-16

181-06-18.25 18

203 to 204 90 89-00-04 270-00-14 270-00-05 810.005 810.005

204 to 203 90-01-18 269-58-36 269-58-39 809.999 809.999

JDR 11-18-85

Nov 7, 1985

STA 202 = 60d spike

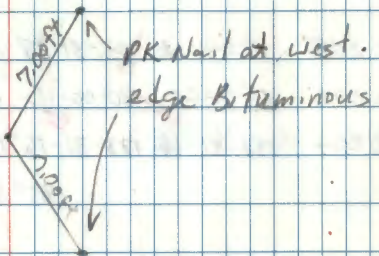

396.777 1301.764

Baricade post

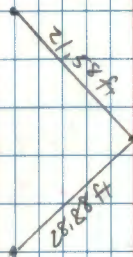
STA 203 = 60d Spike
for Approx See Cor 20/21
29/28Baricade post
810.002 2657.484

68

TK43N R26W

Traversed Continued From page 67

STA 1st H&D 2nd H&R 3rd H&D 4th H&R

H&R

FS 205 183-31-22 03-31-27 183-31-36 03-31-29

RS 203 0-00-20 180-00-11 0-00-20 180-00-15

T@ 204 183-31-16 183-31-16 183-31-16 183-31-14

183° 31' 15.5" 16

204 to 205 90-01-21 269-58-40 269-58-40 398.227 398.227

205 to 204 90-00-30 269-59-34 269-59-32 398.227 398.227

SIDESHOT - TIE IN FENCE CORNER

9204

FS Fence Cor 271-47

RS 203 0-00-20

T@ 204 271-47

204 to FC 67.0 chained

1 PR 11-18-85

Nov 7, 1985

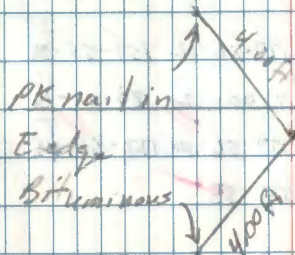

398.227 1306.528

69

T143N R26W

Traversed Continued From Page 68

STA 1st H&D 2nd H&R 3rd H&D 4th H&R

H&R

FS 206 177-56-15^{55'} 357-55-58 177-56-12 357-55-58⁵⁹BS 204 0-00-21 180-00-07 0-00-12 180-00-12¹²IB 205 177-55-54 177-55-51 177-56-00 177-55-54⁴⁷

177-55-53

205 to 206 89-46-15 270-13-53 270-13-50 405.034 405.031

206 to 205 89-55-06 270-05-08 270-05-01 405.040 405.040

FS 207 266-08-27 86-08-14 266-08-20 86-08-14

BS 205 0-00-27 180-00-18 0-00-20 180-00-14

IB 206 266-08-00 266-07-56 266-08-15 266-08-00

266° 07' 59"

206 to 207 89-49-37 270-10-33 270-10-28 420.135 420.133

207 to 206 90-02-17 269-57-43 269-57-43 420.132 420.132

✓ BR 11-18-85

Nov 7, 1985

Snowing (a little)

STA 205 = 60d spike

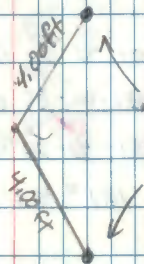
PK nail in west
edge bituminous

405.035 1328.85 f

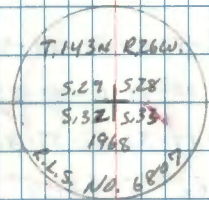

STA 206 =

6" diam Conc
Mon with
Brass Tablet.

420.133 1378.39 A

70

T143N R26W

Traverse Continued From page 69

STA 1st HAR 2nd HAR 3rd HAR 4th HAR

H&H

FS 208 181-43-33 01-43-27 181-43-35 01-43-29
 BS 206 0-00-29 180-00-09 0-00-29 180-00-09
 TB 207 181-43-13 181-43-18 181-43-15 181-43-18
 181° 43' 16"

207 to 208 70-08-36 269-51-22 269-51-23 313.783 313.782
 208 to 207 89-53-39 270-06-29 270-06-25 313.797 313.777

FS 209 182-57-55 02-57-50 182-57-55 02-57-50
 BS 207 0-00-29 180-00-19 0-00-23 180-00-21
 TB 208 182-57-26 182-57-31 182-57-32 182-57-29
 182° 57' 29.5" 30

208 to 209 90-05-16 269-54-55 269-54-50 424.046 424.046
 209 to 208 89-56-42 270-03-21 270-03-20 424.047 424.047

VBR 11-18-85

Nov 9, 1985

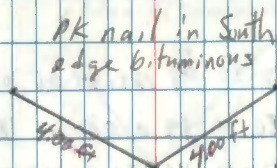

STA 207 = 60d spike

313.780 1029.46A

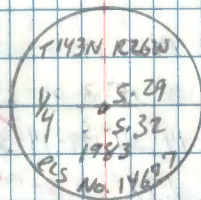
STA 208 = B capped
II

424.046 1391.22A

T 143N R26W

Traverse Continued from page 70

STA 1st H&D 2nd H&D 3rd H&D 4th H&D

H&D

FS 207 182-34-11 182-34-04³ 182-34-06³ 182-34-02³

BS 208 0-00-28 180-00-19 0-00-21 180-00-16

T 209 182-33-43 182-33-45 182-33-45 182-33-46

182° 38' 44.75" 45

207 to 210 90-01-54 269-58-13 269-58-10 366.513 366.513

210 to 209 90-00-02 270-00-00 269-59-59 366.520 366.520

FS 211 179-14-57 179-14-51¹ 179-15-02¹⁴ 179-14-56⁶

BS 209 0-00-20 180-00-14 0-00-27 180-00-25

T 210 179-14-37 179-14-37 179-14-35 179-14-31

179° 14' 35"

210 to 211 89-12-18 270-47-52 270-47-47 278.901 278.874

211 to 210 90-51-05 269-08-52 269-08-54 278.911 278.880

✓ 22R 11-18-85

Nov 7, 1985

32° F 29.40 Hg"

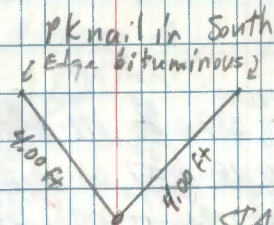

STA 209 = 60d spike

366.517 1202.48A

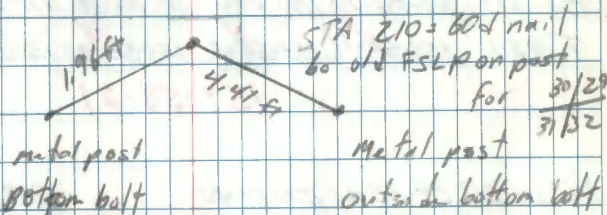

278.877 914.95A

T143W R26W

Traverse cont'd from pg 71

STA 1st H&D 2nd H&R 3rd H&D 4th H&R
H &

FS 212 179-~~17-50~~¹⁶⁻⁵⁰ 359-16-~~29~~²⁹ 179-16-~~37~~³⁷ 359-16-~~42~~⁴²
 BS 210 00-00-~~27~~¹⁷ 180-00-~~27~~¹² 00-00-~~28~~⁰⁷ 180-00-~~25~~⁰⁷
 T@211 179-16-~~40~~⁻³³ 179-16-~~43~~⁻¹⁷ 179-16-~~46~~⁻³⁰ 179-16-~~47~~¹⁷

179-16-24

Dist 211-212 90-18-44 269-41-11 269-41-14 517.159 517.151

Dist 212-211 89-43-00 270-17-12 270-17-06 517.155 517.149

FS 213 153-58-35 333-58-29 153-58-30 333-58-18

BS 211 00-00-19 180-00-05 00-00-08 179-59-57

T@212 153-58-16 153-58-21 153-58-22 153-58-21

153-58-21

Dist 212-213 89-58-20 270-01-45 203.307 203.307

Dist 213-212 90-05-17 269-54-44 269-54-44 203.312 203.312

✓ 179-11-18-85

Nov 8, 1995

T-2 S/N 265184 Pth, eldy, cold, calm
 RedNA S/N 9863 PC TA G. Kosenko
 BPK=29.7 FOF=-1 TT B. Husk
 Temp=25° @ 8:45AM @ G. Robertson

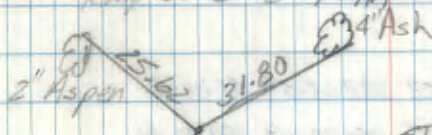

STA 211 = 60d spike

517.150 1696.68 ft



STA 212 = 60d spike

203.309 667.02 ft

T143N R26W

Traverse cont'd from pg 72

STA 1st H&D 2nd H&R 3rd H&D 4th H&R

44

FS 214 222-04-06 42-03-53 222-03-59 42-03-47

BS 212 00-00-18 179-59-55 00-00-02 180-00-20

TO 213 222-03-48 222-03-58 222-03-57 222-03-47

222-03-53

Dist 214 59-57-19 270-02-54 270-02-48 374.085 374.085

Dist 214 79-05-02 269-55-07 269-55-03 374.083 374.083

FS 81 163-40-42 343-40-31 163-40-35 343-40-27

BS 213 00-00-19 180-00-11 00-00-11 180-00-07

TO 214 163-40-23 163-40-20 163-40-24 163-40-20

163-40-22

Dist 214⁸¹ 90-55-55 269-04-11 269-04-08 321.527 321.485Dist 214⁸¹ 89-06-34 270-53-34 270-53-30 321.517 321.471

JDR 11-18-85

Nov 8, 1985

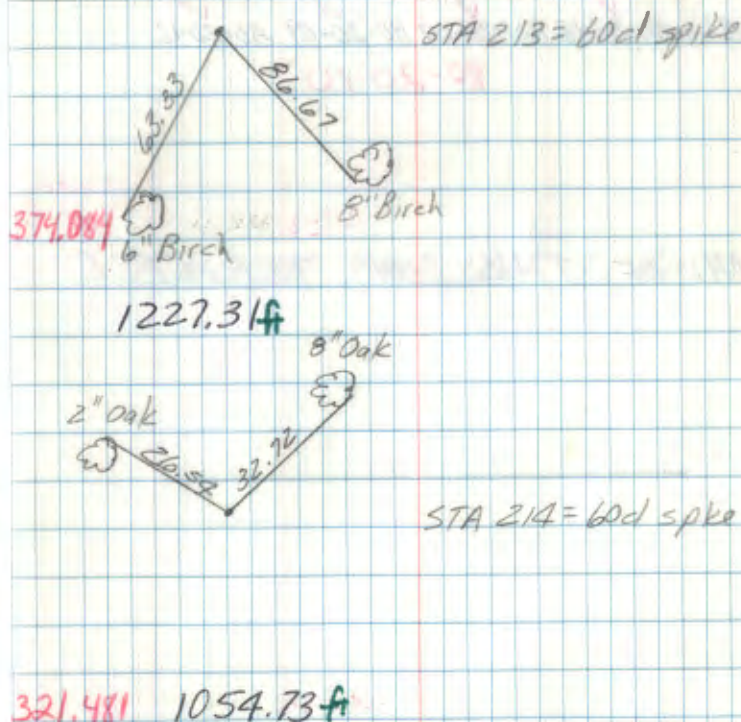

T43N R26W

Traverse cont'd from 73

STA 1st HX " 2nd HX " 3rd HX " 4th HX "

HX

FS 80 80-20-29 260-20-17 80-20-27 260-20-20

BS 214 00-00-17 180-00-10 00-00-18 180-00-08

T@ 81 80-20-12 80-20-07 80-20-09 80-20-12

80-20-10

END OF THIS LOOP TRAVERSE

J. M. R. 11-11-85

(Kw) DEC. 1 1 1985

Nov 8, 1985

STA 81 = 60cl spike

END OF THIS LOOP TRAVERSE