

CORNER RESTORATION T143N R26W

CORNER

RESTORATION

T143N R26W

K
M
FIELD BOOK

Book #2

BOOK #204146

T143N, R26W 5th P.M.

USFS,

CASS COUNTY
MN

27	35	31	33	-	37	30	29	28
26	6	15	5	4	3	2	1	
25	13	11						
24	7	8	9	10	11	12		
23								
22	18	17	16	15	14	13		
21								
20	19	37	28	2	21	22	23	24
19		36	5	4				
18	30	6	10	9	4	27	26	25
17		7	3	12	10			43
16	31	32	33	34	35	36	44	45

Note:

See page 77 for subdivision of Sec. 29

" " 78 for line between S 27, 28, 29, 33, 34

" " 78 for E-W line across center of Twp.

1
S 1/4 corner bet Sec's 20 & 21

County Surveyor Note 1919

James H. Flynn Book C p 151

Yellow Birch 10" S 51° 45' W 53.8'

W Pine Stp. 22" S 66° E 31.7'

N 1/4 corner bet. Secs 20 & 21

County Survey Notes 1919

County Surveyor James H. Flynn

Cedar N. ^{90°} E 36.7'

yellow Birch 6 N. ^{90°} W 20.2'

Refer to Book 1, page 53 for running notes

3 T-7

C/4 Corner to Sec. 29

Affidavit
8/21/78 T-7

Book C Survey Record #405 Page 149-152

County Surveyor James H. Flynn

Iron monument set by Flynn 1918

Set 2 1/2" x 30" capped iron pipe

Fd. iron pipe with cap - in place - beside fence post

E 7m 20" S 72° W 26.5 ft

Distance ^{1/2} bearing falls in cleared area - fd. depression

Black Ash 10" N 35° E 12.5 ft

found soft depression at brq ^{1/2} dist.To perpetuate this corner I set 2" dia. x 5' long
galvanized steel pipe - with concrete inside and
capped with 3" dia. brass tablet marked.

Reset County iron beside T143N R26W

F.S. monument C/4 S29

Set 10" Cedar corner post ^{at south edge} beside iron 1977

Witnessed by

W. Oak 16 N 85 W 55.40' mkd. C/4 S29 BT

Ash 9 N 38 E 61.55' mkd. C/4 S29 BT

Ash 7 S 19 E 34.55' mkd. C/4 S29 BT

Ash 10 S 60 W 40.40' mkd. C/4 S29 BT

Set 8' steel sign post due south 4.1' ^{w/FS signs 54-234}Set 8' steel sign post due west 4.2' ^{w/FS signs 54-234}

4-15-77 Curtis R. Krame

A9-7250-4

South 2898' to 1/4 Corner

North 2557 " " "

West 2718 " " " 1359

East 2528

Chained north ^{N 1/4 E} from S 1/4 - Sec. 29 - 1449' to C 5/16Found 1 1/2" x 18" iron pipe - old fence line has been
pushed to east - but holes from posts still remainChained north 1449' to C 1/4 and found iron pipe
in place - beside 10" Cedar fence corner post - fenceto west has been pushed north - wire and posts
lying on ground West and South of this cornerChained west to C W 1/16 ^{N 87° W} 1359' - then chained 1359'west to W 1/4 Sec. 29 which was F.S. established
with 2" dia iron pipe - fence line down runs between
C 1/4 and W 1/4 distance check OK 4-13-77 GK-RO

A R-8

E 1/16 Cor. bet's Sec's 20 & 29

County Surveyor, James H Flynn

Set wood Post in 1910

"Surveyors Record" BKC Pg 150

FIR 8" N47°W 3 ft

Yellow Birch 10" S29°W 13 ft.

Chained along fence west from E of
road 1345 to new fence corner and 1362
to ~~old~~ fence corner - No sign of
post or B.T.'s described above

8/30/68

W.H. Okuma

October 18, 1985 Recovery by: G. Kasenko

B. Ausk

Chained to this corner from the
NE 1/16 S29. We found no
evidence of the 1910 survey

CERTIFICATE FILED

5 R-6

W 1/4 bet Sec's 20 & 29

County Survey Notes 1919

James H. Flynn "Surveyors Record" BKC Pg 150

Set wooden post

Black Ash 8" S46°W 3ft

Cedar 7" N43°E 10ft

Chained west from relocated 1/4
corner 1311.0'. Found possible B.T.'s
but Cedar was down and no markings
a double ash was now growing out of
possible ash location - No post

9/2/68

W.H. O'Kernal

N 1/4 bet Sec's 29 & 30

County Survey notes 179 J. H. Flynn

"Surveyors Record" BKC Pg 151

W. Pine 24" N 51° W 54 ft

Aspen 5" N 31° E 17 ft

Oct 28, 1985 Recovery by: G. Kosenko

B. Ausk

G. Robertson

Chained to this corner 1254.5
feet from the W 1/4 cor of
Sec 29. Found no evidence of
corner

7 21-5

S¹/₁₆ Corner bet Sec's 29 & 30

County Surveyor Notes 1919 W.H. Flynn

Set wood post

no post found

Pine stub 16" N²⁷°W 58' ft

Fd. remains below ground of pine stump at brq¹/₂ dist.

W. Pine stub 10" N⁶⁴°E 84 ft

no evidence of this pine was found

"Surveyors Record" BK C Pg 151

Chained to S¹/₁₆ from SW¹/₁₆ 1328' along down
fence line to approx. 250' west of SW¹/₁₆ then
follow fence line which is being used and maintained
to 1303' west and intersect fence line running south³/₄
remains of old fence line north - fence continues
west - chaining ended at 3rd post west of fence
corner post

crossed wood trail N³/₅ approx. 60' west of SW¹/₁₆

May have to set this corner by survey between
¹/₄ Corner to north and Section corner to south

4-25-77 CRK-RO

728

S 5/16 bet Sec's 29 & 28
C County Surveyor V. H. Flynn 1919
"Surveyors Record" BK C Pg 151
Set wood Post

P

F Yellow Birch 10" N 86° E 29 ft.

W

L Double Elm 16" S 66° W 26.6 ft.

SEE BOOK 3, P 965

CN 1/16 Sec 29

S-7

County Surveyor J.H. Flynn 1919

wooden post - set "Surveyors Record" BK C₁ 157

W. Birch 10" S80°E 6.7 ft

Passwood 12" S88°W 36.6 ft

NW $\frac{1}{4}$ Corner Sec. 29

S-6

County Surveyor V. H. Flynn 1919

Set wooden post "Surveyors Record" BKC 6, 151

W. Birch 12" $53^{\circ}E$ 22.0 ftW. Pine 10" $N11^{\circ}E$ 9.9 ft

11 T-6

T-6

CW 1/16 Cor Sec 29

County Surveyor J. H. Flynn 1919

Set wooden Post, no post found

Stub
W. Pine 32" S 32° W 10.5 ft

Fd. large pine stump - burned at S32W 10.5'

Elm - 8" N 79° W 25 ft

no evidence remains

J. Gratiot

7/26/79

C. Krause, M. Hayes, J. Schaeffer

Ran line from C 1/4 to W 1/4 and found distance to be 2720.85'. CW 1/16 cor. position falls at 1360.42'. This position agrees very well with the position established from the county

W. Pine stump. To perpetuate this corner:

Set a 5' x 2" dia, concrete filled, galvanized iron pipe with a brass tablet stamped: T143N R06W

W 1/4
C ——— C
5.29
1979
P.L.S. No. 1226

From which bear:

W. OAK 8" N 45° E 46.46' MKD. CW 1/16 529 BT

W. OAK 8" S 60° W 41.00' MKD. CW 1/16 529 BT

W. OAK 11" N 10° W 27.00' MKD. CW 1/16 529 BT

STEEL SIGN POST EAST 38.7'

7/26/79

Krause, Hayes,
Schaeffer

T143N R06W

Sec 29

11 T-6

T-6

CW 1/16 Cor Sec 29

County Surveyor J. H. Flynn 1919

Set wooden Post, no post found

^{Stub}
W. Pine 32" S 32° W 10.5 ft

Ed. large pine stump - burned at S 32° W 10.5'

Elm 8" N 79° W 25 ft

no evidence remains

J. Gratiot

7/26/79

C. Krause, M. Hayes, J. Schreiber

Ran line from C 1/4 to W 1/4 and found distance to be 2720.85'. CW 1/16 cor. position

falls at 1360.42'. This position agrees very well with the position established from the county

W. Pine stump. To perpetuate this corner:

Set a 5' x 2" dia, concrete filled, galvanized iron pipe with a brass tablet stamped:

T143N R26W

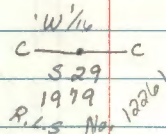

From which bear:

W. OAK 8" N 45° E 46.46 MKD. CW 1/16 S 29 BT

W. OAK 8" S 60° W 41.80 MKD. CW 1/16 S 29 BT

W. OAK 11" N 10° W 27.00 MKD. CW 1/16 S 29 BT

STEEL SIGN POST EAST 38.7'

24

Put FSLP on 10" W. Oak N 10° W 27.0' from 5" Squared Cedar post 30" high set for approx CW 1/16 - 18' south of down wire fence line bearing E-W

Chained to this location from C 1/4 1359' then continued west to 1/4 Bet Sec's, 29-30 which is E.S. monumented - 1359' this distance checked very good - also chained north from SW 1/16 - 1465' this distance checked very good We don't believe there is enough evidence

to monument this corner position - may have to run line from C 1/4 to W 1/4 by transit to set properly 4-25-77 CRK-RO

Painted blue line today from SW 1/16 to CW 1/16 lines bears N 3° 30' W using 6° Declination

12 21-7

Affidavit 8/22/78

CS 1/16 Sec 29

County Surveyor J. H. Flynn 1918

Set 1 1/2" x 18" gas pipe

gas pipe set at this point

Fd. gas pipe in place - next to fence post

Basswood 10" N 62° E - 14.6 ft

Sugar Maple 6" S 48° W - 13.0 ft

To perpetuate this corner I set 2" dia. x 5' long
galvanized steel pipe - with concrete inside and
capped with 3" dia. brass tablet marked

T143NR26W

C

S 1/16 S29

C

1977

Witnessed by

W. Oak 6 S78 E 10.4' mkd CS 1/16 S29 BT

W. Oak 7 S39 W 27.2' mkd CS 1/16 S29 BT

W. Oak 7 S6 E 62.4' mkd CS 1/16 S29 BT

Set 8' steel post due north 4.2' with FS signs 54-2 3/4

Set 8' steel post due south 4.2' with FS signs 54-2 3/4

4-28-77

R9-7150-4

Chained north of S 1/4 - Sec 29 1449' - found 1 1/2" x 18"
iron pipe - bent south with base in place - beside
7" Cedar fence post - top broken off - lying on ground
Fence line to north 3/4 south has been pushed down
to east - wire 3/4 posts lying on ground
Found old fence line mostly down runs west from
CS 1/16 - chained west to SW 1/16 - 1328' - found
evidence of SW 1/16 - will monument later

4-13-77

13

$\frac{1}{2}$ Between Secs. 6 & 7

Original Gov't survey notes of 1872

Set Post

Fix 4" N25°W 221K5 - 19.62'

Fix 6" S29°E 181K5 - 11.88'

Sec. Cor. to Secs. 5, 6, 7 & 8

Original Gov't survey notes of 1872

Surface level + wet

Set post

G.L.O. Resurvey of 1922

Set 2" dia 36" long 27" in ground with cap mkd.

T143N R26W

56 | 55'

57 | 58'

1922

Tam. 5" N54°30'E 15 lks. 99'

Tam 10" S63°E 73 lks. 48.2'

Tam. 8" S48°W 53 lks. 35.0'

Tam. 6" N47°W 101 lks. 66.7'

North

40.00 Temp $\frac{1}{4}$ Sec. Post

55.00 Enter N. Pine

15 C-5

Affidavit
8/18/78

1/4 Between Secs. 5+6

Original Gov't survey notes of 1872

Set. Post - G.L.O. Found

Cedar 7" N83°W 20 IKS - 13.20'

Fd fallen & rotted

Cedar 3" S36°E 15 IKS - 9.90'

Fd Now a 6" Cedar at brg & dist. (half dead)
with flat blaze facing corner no scribe

Set iron post mtd. ^{1/4} 56/55 2" dia Iron pipe

Found Iron & cap, in place 1922

15" above ground, in good condition

Cedar 7" N48°15'E 67 IKS - 49.22'

Now a down and rotted cedar at brg & dist.

Spruce 7" S18°W 147 IKS - 97.02'

Now a rotted stump at brg & dist.

To perpetuate this corner I scribed (3)
new bearing trees as follows.

9" Cedar S63°W - 31.8 ft. scribed 1/4 56 Bt.

8" Tam. N77°E 10.6 ft. scribed 1/4 55 Bt.

6" Tam. N16°W - 32.0 ft. scribed 1/4 56 Bt.

Put F.S. sign 54-4 on a 4" Cedar

S62°E 14.5 ft. from corner.

Also drove a 4" Cedar post sward
next to corner 10-6-70

CERTIFICATE FILED Curtis R. Krause
6-12-77 Steffan

16

1/4 Between Secs. 31-36

Original Gov't survey notes of 1872

Set Post

Birch 8" S37W 4.1Ks - 2.64'

Maple 6" N52°W 20.1Ks - 13.20'

CERTIFICATE FILED

North

Ent. Tamarack NE-NW 74.00

Ent Birch & Aspen SE-NW 77.50

Sec Cor 80.00

19
Sec. Cor. to 25-30-31-36 V-1

Original Gov't survey notes of 1872

Set Post

Fir 10" S38°E 21 IKS - 13.86'

Birch 8" S78°W 9 IKS - 5.94'

Fir 8" N40°E 33 IKS - 21.78'

Birch 10" N59°W 13 IKS - 8.58'

Inverse and Monumentation info to set STA

3018, Sec Cor 25, 30, 31, + 36 (FT)

STA 1st H&D 2nd H&R H. Dist
HX

FS 3018 265-59-19 265-59-20

BS 80 00-00-00 180-00-00

TA@ 81 265-59-19 265-59-20 92.77

T. 143N.
R. 27W. R. 26W.
S. 25 S. 30
S. 36 S. 31
1986
R.L.S. 14677

5° Decl. East
CARD filed

North

27.50 Enter open marsh round

35.00 " birch & W. Pine scattering

40.00 1/4

6-3-86 G. Robertson/B. Ausk

Set a 2 ft long by 2 1/2 in. outside diameter
concrete filled galvanized iron pipe with a
3 in. diam brass cap stamped as shown.
Slightly below road surface with cap covered.
Magnet at base of monument.

From which:

W. Oak, 12.2" N63°E, 107.4 ft. to a 1/2" nail in SE face,
double blazed, scribed "S 30 BT" w/60d spike

W. Oak, 5.5" S 03°W, 64.76 ft. to a 1/2" nail in E. face,
base blazed, scribed "BT" w/60d spike

R. Oak, 5.8" N 08°W, 47.78 ft. to a 1/2" nail in W. face,
double blazed, scribed "S 25 BT" w/60d spike
& highway, South, 3.0 ft.

1/4 Between Secs. 30-25

Original Gov't survey notes of 1872

Set Post

W. Pine 8" S89°E 14.1K5 - 9.24'

W. Pine 8" S40°W 20.1K5 - 13.20'

G. Robertson, B. Ausk, T. Withrow 3-18-86

Inverse & monumentation to set this corner
back lost.

STA	1 st H&O	2 nd H&O	(FT)	H. Dist
-----	---------------------	---------------------	------	---------

FS 3020 161-05-29 341-05-40

BS 84 00-00-24 180-00-24

T@ 85 161-05-05 161-05-16 49.51

Decl = 5° East

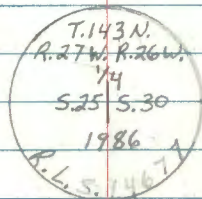

Set a 5 foot long by 2 1/2 inch outside diameter galvanized iron pipe with a 3 inch diameter domed brass cap stamped as shown, and a magnetized plastic break-off bottom, up 13 inches from which:

North

80.00 Sec Cor

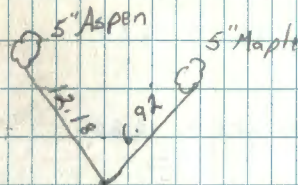

April 11, 1986
Per G. Kosenko
Tech B. Ausk

W. Oak, 13.3 in, N14°E, 24.06 ft to a 16d nail in
N. face, double blaze, "1/4 S30 BT" w/60d spike
W. Oak, 10.4 in, S29°E, 53.36 ft to a 16d nail in
NE face, double blaze, "1/4 S30 BT" w/60d spike
Red Maple, 7.4, N57°W, 50.57 ft to a 16d nail in
N. face, double blaze "1/4 S25 BT" w/60d spike

Metal fence post, North, 3.0 ft w/54-2
Metal fence post, West, 5.0 ft w/54-2, 54-9

This corner was set at single pro-
portionate measure on the Range line
between R27W - R26W. No previous
survey evidence was recovered

[Signature]
Recorded

Sec. Cor. to 19-24-25-30 R-1

Original Gov't survey notes of 1872

Set Post

Maple 8" N64°E 10 IKS - 6.60'

No evidence

Maple 9" S29°E 21 IKS - 13.86'

No evidence

Basswood 9" S62°W 14 IKS - 9.24'

No evidence

Maple 10" N10°W 20 IKS - 13.20'

No evidence

Chained to this area from the South
searched two man hours.

Sept. 24 1968

Styler Elliott

Inverse & monumentation info to set this corner
back last

STA 1stH&O 2ndH&R

(FT)
H. Dist.

FS 1918 16-44-22 196-44-10

BS 70 00-00-20 180-00-23

K@ 71 16-44-02 16-43-47

119.69

North

40.00 1/4 Cor

Recorded

10.73 3' Birch

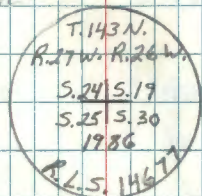
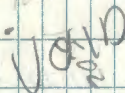

5" Birch

3-25-86 G. Kaseřka,
G. Robertson; Br. Ausk

4-16-86 B. Ausk & G. Robertson

Set a 5 ft. long by 2 1/2 in.
outside diameter concrete
filled galvanized iron
pipe with a magnetized
plastic break-off bottom
and a 3 in. dia. damed
brass cap stamped as shown.
UP - 18 inches

5" Maple

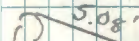

5.08'



2" Birch

From which:

S. Maple, 7.8 in, N01°E, 40.07 ft to a 16d nail in E FACE
double blazed, "S19 BT" w/60d spike

S. Maple, 5.2", S10°E, 38.45 ft to a 16d nail in the E face,
double blazed, scribed "S30 BT" w/a 60d spike

S. Maple, 5.2", S71°W, 5.15 ft to a 16d nail in the NW
FACE, double blazed, "S25 BT" w/60 d spike

Metal Fence Post South 3.0' w/54-9

20 P-1

1/4 Between Secs. 19-24

Original Gov't survey notes of 1872

Set. Post

Birch 8" S87°W 19 1K3 - 12.54'

No evidence

R. Oak 8" N63°E 17 1K3 - 11.22'

No evidence

Chained to this area from the South
found no evidence. Searched this
area 2 1/2 man hours.

9-24-68

Lyle Elliott

WHITEHORN, Anusk, Robertson 4-22-86

Inverse & monumentation info. to set this corner
back last

STA	1 st H&D	2 nd H&R	(FT)	H. Dist
	HA			

FS 1920 176-22-15 356-21-51

BS 95 60-00-20 119-59-50

AC 96 176-21-55 176-22-01

200.89

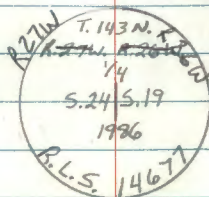

Mon up
1.6 ft

North

75.00 Enter tamarack & cedar E-W

80.00 Sec. Cor.

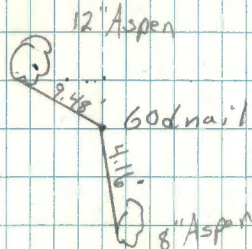

10" Aspen

E. Oak

3-25-86 G. Kasenko,
G. Robertson, B. Anusk

4-22-86

M K Whitehorn, RLS
Φ Anusk, Robertson

All BT have 60d spike in base of Baseblaze? 54-3 tags
Replace 60d nail with 5' long X 2 1/2" (OD)
galv IP with domed Brass tablet, stamped as
shown to identify corner, and plastic breakoff
base with embedded magnetized pellet, from:

R. Oak 7.2 in dia N30°E 41.40 ft to 16d nail
in the SE face. Double blazed & scribed "1/4 S19" & "BT"
R. Oak 7.8 in dia S34°E 54.86 ft to 16d nail
in NE face. Double blazed & scribed "1/4 S19" & "BT"
S. Maple 4.8 in dia S57°W 20.89 ft to 16d nail
in NW face. Double blazed & scribed "1/4 S24" & "BT"
8' steel post easterly 3.0 ft W54-9

card filed

21 N-1

Sec. Cor. to 13-18-19-24

Original Gov't survey notes of 1872

Set Post

Spruce 7" N30°W 18 IKS - 11.88'

Spruce 7" S72°W 13 IKS - 8.58'

Spruce 6" S28°E 7 IKS - 4.62'

Spruce 6" N51°E 19 IKS - 12.54'

Date Unknown, Geo. Ralph Found old post
Found:

Tam 8" N16°30'W, 7.4'

Tam 12" S54°30'W, 8.4'

Spruce 6" S-E, 7.3'

New BT's

Tam 8" N26°30'E, 47.0'

Cedar 12" S80°W, 59.2'

Tam 16" S25°E, 52.6'

1925, Cal. Hwy Dept. State Rd #4 "corner"

Tam stp, 12" S-E, 43.7'

Tele Pole, S, 29.0'

North

CERTIFICATE FILED

2.50 Enter birch & maple

34.50 Creek 51ks wide No evidence of creek

36.50 Enter Tam & Spruce E-W dk

40.00 1/4 Cor

distance was long 180'

Chained North from this point
found F.S. N.P. at approx location
of 1/4 corner. Poster or fence post.

See BK 3, p 19

22 L-1

1/4 Between Secs. 13-18

Original Gov't survey notes of 1872

Set Post

Cedar 6" S50°E 7 IKS - 4.62'

No evidence

Spruce 6" S83°W 6 IKS - 3.96'

No evidence

Chained to this area from the south. Searched area 3 man hours. Chainage falls in willow swamp.

9-25-68

Egle Elliott

12/19/85 G. Kosenko B. Ask

Swamp call is 75' North of sta
Swamp runs S62°E, N30°W

Inverse & monumentation info. to set this corner back lost

STA	1 st H&D	2 nd H&R	(FT)	H. Dist
FS 1820	214-42-18	34-42-18		
BS 404	00-00-00	180-00-15	86	
T@ 405	214-41-58	214-42-03		167.22
	214-42-01			

FS 1820 214-42-18 34-42-18

BS 404 00-00-00 180-00-15 86

T@ 405 214-41-58 214-42-03 167.22

214-42-01

2-5-86
K0

North

80.00 Sec Cor

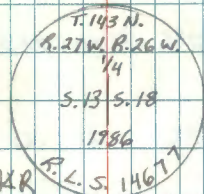
5° Decl East
CARD Filed

STA	H&D	H&R	H. Dist
FS 1820	191-47-35	11-47-25	
BS 404	00-00-00	180-00-10	
T@ 405	191-47-35	171-47-15	181.54

6-2-86 B. Ask G. Robertson.

Set a 5/8" by 5' long Aluminum Rod with a 3/4" O.D. Aluminum Cap stamped as shown. up 1.2 ft, from which

Ash, 6", N20°E, 32.62 ft, to a 16d NAIL ON E. FACE double blaze SCR. 1/4 518 BT" w/60d spike

Ash, 7.9", S13°W, 19.25 ft, to a 16d NAIL ON E. SIDE double blaze SCR. 1/4 513 BT" w/60d spike

Ash, 6.7", N80°W, 38.49 ft, to a 16d NAIL ON N. SIDE double blaze SCR. 1/4 513 BT" w/60d spike

Two CARSONITE Boundary Post North, 3.0', w/ 54-2A
" " " East, 3.0', w/ 54-2A
LSM-130

23
Sec. Cor. to 7-12-13-18

J-1

Original Gov't survey notes of 1872

Set Post

Cedar 6" S32°E 10 IKS - 6.60'

Spruce 8" N51°E 21 IKS - 13.86'

Spruce 8" S32°W 21 IKS - 13.86'

Spruce 6" N50°W 24 IKS - 15.84'

Dec 19, 1985 Recovery by: G. Kosanko
B. Husk

We compared the proportions to
position #718 to the Original
Government survey natural feature
calls as shown below:

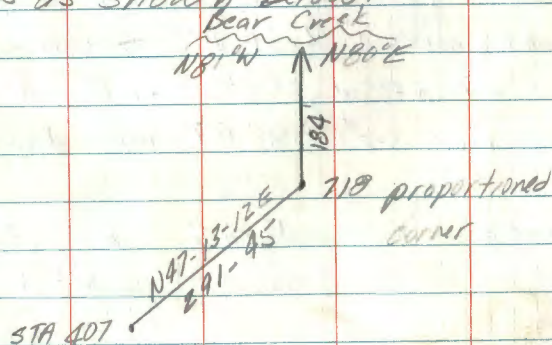

North

CERTIFICATE FILED

2.50 Creek 25 IKS wide

4000 1/4 Cor

Inverse + monumentation info. to set this corner
back lost.

STA 1st HAD 2nd HAD (FI)
H.D. DIST.

H 2

FS 718 307-31-28 127-31-30

BS 400 00-00-00 180-00-00 Dist. CHAINED

T@407 307-31-28 307-31-30 281.49 ft

5-20-86

B. Husk

G. ROBERTSON

J. JACKSON

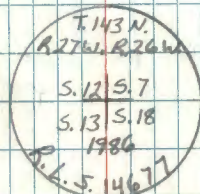

5° Decl. EAST

CARD FILED

Set a 5/8 inch OD. by 5 ft long Aluminum Pipe with
a 3/4 inch Aluminum Cap stamped as shown
up 1.1 ft from which:

Cedar, 7.4", S67°E, 26.40', to a 1/2d nail on N FACE
double blaze "S18 BT" w/60d spike

Cedar, 14.3", S21°W, 68.33 ft, to a 1/2d nail on E FACE
double blaze "S13 BT" w/60d spike

Tamarack, 14.1", N78°W, 85.47 ft, to a 1/2d nail on N FACE
double blaze "S12 BT" w/60d spike

Trees are not painted red

CARSONITE Post South S. 0' w/5/42A, LSM 150

1/4 Between Secs. 7-12

Original Gov't survey notes of 1872

Set Post

Spruce 8" S66°W 16 IKS - 10.56'

Spruce 6" S47°E 19 IKS - 12.54'

Inverse & monumentation info. to set this corner back lost

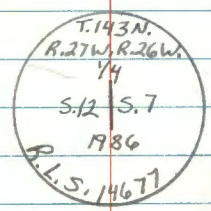
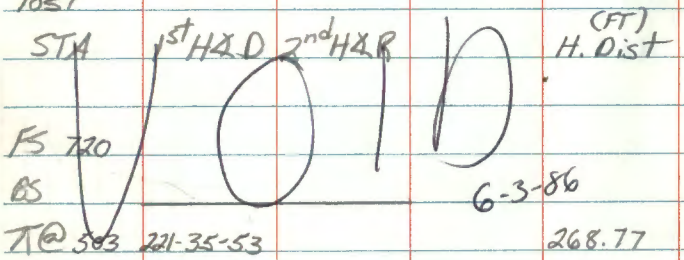

North

67.00 Enter birch & balsam E-W

73.50 " spruce & tam. sup. SE-NW

Sec. Cor. to 1-6-7-12

Original Gov't survey notes of 1872

Set Post

Spruce 8" S63°W 7 IKS - 4.62'

Spruce 6" S28°E 9 IKS - 5.94'

Spruce 5" N82°E 10 IKS - 6.60'

Spruce 8" N60°W 21 IKS - 13.86'

Inverse & monumentation info. to set this
corner back lost.

STA 1st H&D 2nd H&R ^(FT) H. Dist

FS 618

BS 505

TA @ 506 251.20.52

69.23

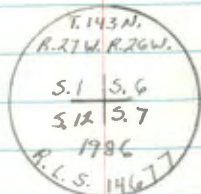

North

40.00 1/4 Cor

26

1/4 Between Secs. 1-6

Original Gov't survey notes of 1872

Set Post

Cedar 14" S22°W 13 IKS - 8.58'

Spruce 8" N72°E 22 IKS - 14.52'

1900, Corps of Engineers

Found 14" Cedar laying down with
blaze intact. (BK 236 Pg 21)

1937, GLO Found nothing

Inverse & monumentation info to set this corner
back lost.STA 1st H&O 2nd H&R(FT)
H. Dist

FS 620

BS 510

X @ 511 2-58-32

410.16

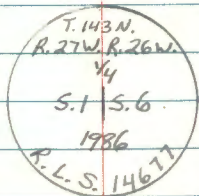

North

80.00 Twp. Cor.

29 A-1

Town Cot. Secs. 1-6-21-36

Original Gov't survey notes of 1872

Birch 6" S17°E 10 1/2 - 6.60'

Spruce 5" N73°E 15 1/2 - 9.90'

Spruce 5" S70°W 6 1/2 - 5.96'

Spruce 6" N20°W 8 1/2 - 5.28'

B.L.O. resurvey notes of

Set concrete monument - fd concrete mon.
with brass cap as shown belowCedar 6" S83°E 1.88 - Not found; burned
badly

Ash 7" N2°E .55 - Not found

Cedar 14" N4°W .91 - Now a cedar windfall
with all scribing visible

10/3/68

W.D. Keenan

T 144 N R 27

R 27 W R 26 W

536 | 531

51 | 56

T 143 N

1937

D.F.F. davis

A-1 pg

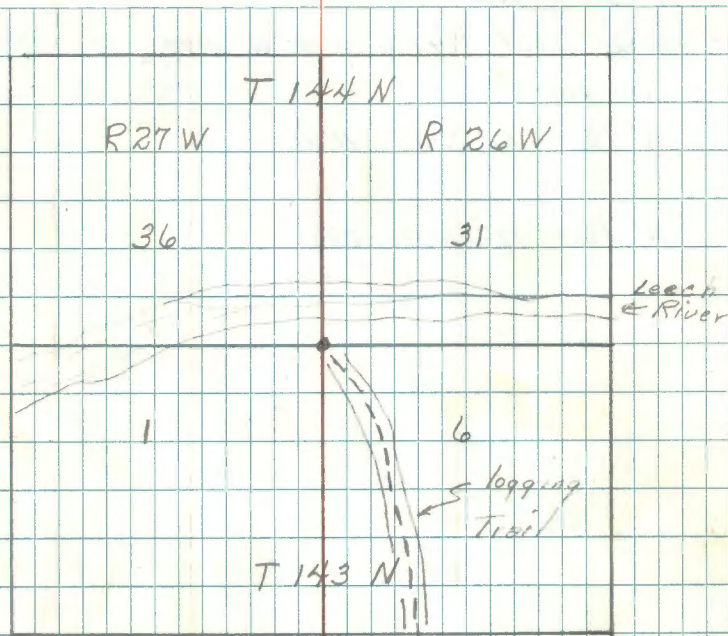

New Bts

Ash 6" N66°W - 51.85' scribed 536 BT

Ash 5' N1°E - 36.53' scribed 531 BT

6" Steel sign post with FS. signs 54-4 & 54-2
attached Due South 70°6" Steel sign post with FS. sign 54-1 attached
set Due North 58.5°

10/8/68

See T 143 N R 26 W Bk 3 pg 49 Lyle Elliott

1/4 Cor between Secs 1 & 6

Original Gov't survey notes of 1872

Set post

W. Pine 10" S51E 101ks

W. Pine 12" N33E 81ks

CERTIFICATE FILED

West

70.00 Enter cedar N & S

80.00 Sec. cor

Sec Cor to 1, 2, 35 & 36

Original Govt. survey notes of 1872

Set post

Cedar 7" S9W 20ks

C.

Cedar 15" S41E 50ks

Cedar 10" N23E 40ks

Birch 14" N57W 35ks

CERTIFICATE FILED

West

1.00 Enter spruce swp. N-S

40.00 1/4 Cor.

30

1/4 Cor between 2 & 35

Original Gov't. survey notes of 1872.

Set post

Spruce 4" SSE 23 lbs

Spruce 5" N25W 15 lbs

CERTIFICATE FILED

West

73.00 Leave sup N.E.S

See Corner to Secs 2, 3, 34 & 35

Original Gov't. survey notes of 1872

Set post found

Spruce 8" N8W 251ks

Spruce 6" N66E 51ks

Rotten stump

Spruce 5" S45E 141ks

Stump with B.T. visible

Spruce 14" S47W 201ks

G.L.O. Resurvey of 1922

Set iron post with brass cap marked

T144N R26W
S31/53S
S31/52
T143N
1922

Maple 12" N30°45'E 1171ks 77.82

Spruce 6" S3°E 801ks 52.80

Tamarack 8" S55°45'W 741ks 48.89

Basswood 14" N43°W 901ks 59.40

CERTIFICATE FILED

West

20.25 M.C. at margin of Rice Lake

11.30 Lu timber

17.10 Road bears N's

19.90 Road under const N's

Lu. timber enter hay meadow

20.25 M.C.

~~6/18/79~~ ~~Steffan~~ ~~PW~~

M.C. between S 3 & S 34

From C.L.O. resurvey notes of 1922

Set an iron post 3' long 2" dia. 27" in ground

with brass cap stamped

	T144N
	R26W
M.C.	<u>S34</u>
	S3
	T143N
	1922

Ash 8" N83°15' E 293 lks

White Oak 10" S11°45' E 120 lks

38 A-6,7 Affidavit 8/18/78

M.C. between Secs. 5 & 32

Original Gov't survey notes of 1872

Aspen 14" S57W 242 lks

C.L.O. resurvey of 1922

Set iron post 3' x 2", 21" in ground with
brass cap marked

Found iron cap in place

16" above ground

in good condition

Poplar 6" S59°W 1144 lks - 755'

T144N
R26W
S32/MC
S5
T143N
1922

I drove a 72" steel sign post 29" down next
to iron & wired post and iron together.

Also - 72" steel sign post due East 1.9 ft.
with F.S. sign 54-2 & 54-4 attached.

10-6-70

Curtis R. Kramer

CERTIFICATE FILED

6-12-79 Steffan

West

18.50 Lu meadow enter tam

22.00 Enter small Norway pine

29.00 Cor S56

34 A-5

Affidavit 8/18/78

Sec. Cor. to Secs 5 & 6

Original Govt. survey notes or 1872

Aspen 14° 563°W 121ks

Poplar sp 544°W 121ks

Cedar 6° N25°W 101ks

Cedar sp.

Spruce 7° N43°E 81ks

Fallen spruce

Spruce 14° 56°E 111ks

Stump hole

G.L.O. Resurvey of 1922

Set iron post 3' x 2" x 27" in the ground with brass

Cap marked

T144N R26W

Found iron cap, in place

S31 S37
S6 S58" above ground, in good
condition.T143N
1922

Norway Pine 6° N35°E 851ks 56.1'

scribe

Now a 20" Norway Pine at brg & dist overgrown

Birch 5° S11°15'E 901ks 59.4'

Found rotted and burned at brg & dist.

Norway Pine 6° S49°W 481ks 31.7'

scribe

Now a 16" Norway Pine at brg & dist exposed

Norway Pine 5° N88°15'W 431ks 28.4'

scribe

Now a 21" Norway Pine at brg & dist overgrown

West

30.00 Enter dense spruce & cedar N's dk

40.00 1/4 Cor

East

2.34 Lv. timber enter small marsh

4.80 Lv. marsh timber

7.30 Lv. rolling land enter tam & cedar swamp

12.00 Lv. timber & enter hay meadow

29.00 M.C.

To perpetuate this corner I scribed
(2) two new bearing trees as follows.
20" Norway Pine S57°W-66.1 ft. scribed SW Bt.
9" Ash S40°E -46.3 ft. scribed SE Bt.
72" steel sign post due East 1.8 ft.
with F.S. signs 59.2 & 59.9 Attached.

10-6-70

Curtis R. Krause

CERTIFICATE FILED

6/12/99 Stoffan

1/4 Cor between Secs 6 & 31
Original Gov't survey notes of 1872

Set post

Cedar 14" S61°W 121ks 7.9'

Cedar 6" N53°E 131ks 8.6'

S $\frac{1}{4}$ Corner between 19th & 20th
Survey notes of John Curo 1917
Survey book B, p 81

Ash 9" N33°55'W 544' 105.7'

Ash 9" N62°30' E 99.00

N 1/4 between Secs 19 & 20

Survey notes of John Curo 1917

Recorded in Survey Book B, p 81

Birch 8" N31°43' W 544'

Spruce 7" S87°11' ? 40.50'

1/4 between Sec's 36 & 31

Taken from resurvey of Sumas
tower location

See Book 2, pp 44, T143NR26W
T143NR25W Bk 1, pp 44

The notes for this corner are in Book #1 T143NR25W
page 44
New Bt's

R Pine 21" 96.3' S14°E scribed S31 Bt
B Spruce 6" 15.05 N74°E scribed S31 Bt
B Spruce 5" 19.25 N22°E scribed S31 Bt

Set 6" steel sign post with F.S. signs
54-4 & 54-2 attached Due South 6.55

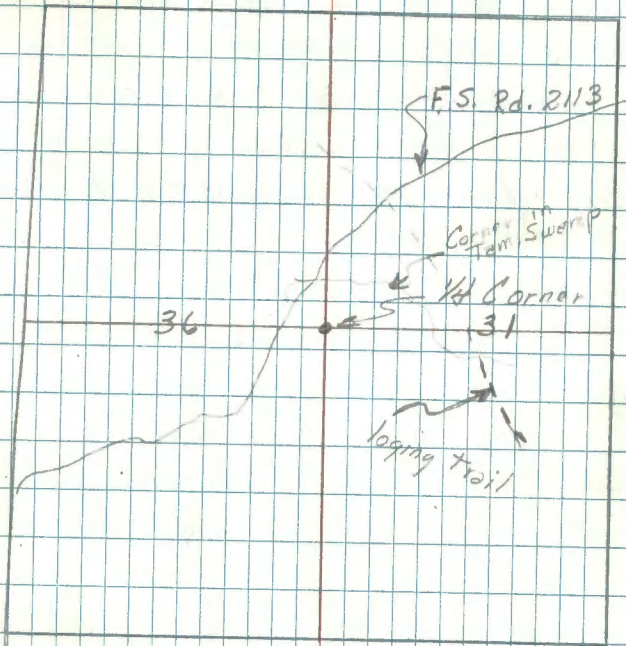

Set a 2" dia, 5' long gal. pipe with
a 3" dia bronze tablet stamped:

T143N
R26W 1/4 R25W
S36 S31

1968

RLS No. 6807

10/14/68
J. E. Daurt
Cust. Trans.
Sumas, B.C.

21-6

Offered 8/21/78

South West 1/4 Section 29

Subdivision survey by J. H. Flynn 1918 Book C

Survey Record # 405 page 149-152

Set wood post - no evidence of post found
area has been burned very severely years ago

W. Pine stp. 30" S34E 62.6'

Ed. large burned pine stp. S34E 62.6' scribe visible

W. Pine stp. 30" S89E 10.5'

Ed. evidence of large pine stump - burned level with ^{ground}To perpetuate this corner I set a 2" dia. x 5' long
galvanized steel pipe, with concrete inside, and
capped with 3" dia. brass tablet marked

T143N R26W

SW 1/4 S29

1977

Witnessed by

W. Oak 10 S63E 31.8' mkd SW 1/4 S29 BT

W. Oak 6 N38W 62.4' mkd SW 1/4 S29 BT

W. Oak 13 N70W 81.4' mkd SW 1/4 S29 BT

Set 8' steel post due north 3.9' with FS signs 54-274

Set 8' steel post due west 4.4' with FS signs 54-274

4-28-77

Set 4" Squared Cedar post at corner location

Put FSLP on 10" W. Oak S63E - 31.8' from post
approx. 30' east of N-5 wood roadChained N88W from CS 1/4 Sec. 29 - 1328' along down
fence line to SW 1/4 - distance chained and bearing
to pine stump check very good at end of line.Chained north to CW 1/4 1465' to check both corner
positions - as bearing trees marked by Flynn
are burned beyond any remaining evidence
except the pine. BT's. - and they are burned
level with ground 4-15-77 CK-RO

South east 1/16 Corner in Section 29

Subdivision Survey by J.H. Flynn 1918 Book C

Survey Record # 405 - pages 149-152

Marked 5" Spruce tree as corner post.

No BT's.

Oct 18, 1985 Recovery by: G. Kasenko
B. Aush

Chained to this corner from
the 05 1/16 529. We found no
evidence of the 1918 survey

5/2/86 G. Robertson / B. Aush

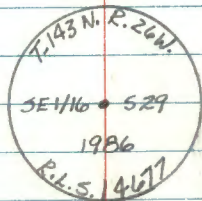

Measured N 45°W, 0.07 feet from
traverse station to set point 2409
which is a 5 ft. long by 5/8 in. dia.
aluminum rod with a 3 1/4 in. diameter

aluminum cap. up 1.0 ft. From which
Tamarack, 12.6" ^(twin) N 50°E, 155.40 ft. to a 16d nail in
NW face, double blazed, scribed "SE 1/16 529 BT" w/60d spike
Metal fence post, S 50°W, 15.33 ft. to face of post
B. Spruce, 7.0" N 02°W, 140.64 ft to a 16d nail in E face,
double blazed, scribed "SE 1/16 529 BT" w/60d spike
Metal fence post, North, 3.0' w/54-2 & 54-9
Metal fence post, East, 3.0' w/54-2
Card filed 6-11-86

Center east 1/6 Corner in Section 29

Subdivision Survey by J.H. Flynn 1918 Book C

Survey Record # 405 pages 149-152

Set wood post

Y. Birch 9" S70W 19.0'

Fir 10" S18E 11.3'

Oct 18, 1985 Recovery by: G. Kosenko
B. Ausk

Chained to this corner from
the SE 1/6 S29. We found
no evidence of the 1918 survey

Decl. 5° East

5-2-86

B. Ausk
G. Robertson

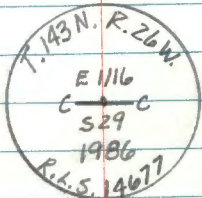

Measured S 58° E, 0.08 feet from
traverse station 3002 to setpoint 2903
which is

A 5ft long by 5/8 inch Aluminum Rod
with a 3/4 inch diam. Aluminum Cap
Stamped as shown = UP 1.3'
From which:

- W. OAK, 8.1", N16°E, 78.30ft to a 16d nail on East
FACE double BLAZE "CES29BT" w/60d spike
- S. Maple, 5.0", S55°E, 28.71 ft. to a 16d nail on NE
FACE double BLAZE "CES29BT" w/60d spike
- R. Maple, 7.5", S13°W, 6.81 ft to a 16d nail on East
FACE double BLAZE "CES29BT" w/60d spike

Metal FENCE Post south 3.0' w/ 54-2
Metal FENCE Post North 3.0' w/ 54-2, 54-9

North east 1/16 Corner in Section 29 S-8

Subdivision survey by J. H. Flynn 1918 Book C

Survey Record #405 - pages 149-152

Set wood post

Soft Maple 4 N30E 10.0'

Birch 11 S8E 5.0'

October 18, 1985 Recovery by: G. Kosenko

B. Husk

Chained to this corner from
the CE 1/16 329. We found no
evidence of the 1918 survey

49
V-25

1976 BLM Dependent Resurvey

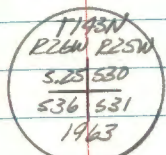

EUS 6807

Recovered

Iron post, 2½" diam, concrete filled, firmly set,
projecting 24" above ground w/BC

From which:

aspen, 8", S36E 63.1th (41.6')
elm, 5", S08°W, 24½th (16.2')
elm, 4", S26°W, 44th (29.0')
elm, 7", N45W 8th (5.3')
steel sign post, 54-26-54-4, East, 8th (5.3')

G. Kosenko, K. Matson 7-21-82

Recovered:

2½" O.D iron pipe w/BC
aspen, 10 in, S34°E 44.47 ft
elm, 7 in, S10°W 15.75 ft
elm, 6 in, S26°W 28.71 ft
elm, 9 in, N46°W 4.95 ft
Steel sign post, East, 5.2 ft
W. Pine ^{burned} stump, S14°W, 7.4 ft

See: T143N R25W BL 1 pg 45

All BT's are measured from a
nail in the side of the tree.
Placed 60d spike in base line
of each BT

X-25

1976 BLM Dependent Resurvey

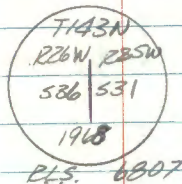

Recovered

Iron post, 2 1/2" diam., concrete filled, firmly set,
projecting 24" above ground w/bc

From which:

- spruce, 6" , N25°E, 29 lks (19.1')
- spruce, 5" , N76°E, 22 lks (14.5')
- steel sign post, 54-21-54-4, south, 9 1/2 lks (6.3')

1968 Forest Service Perpetuation
set the above described monument
from which:

- R. Pine, 21" , S14°E, 96.3'
- B. Spruce, 6" , N74°E, 15.05'
- B. Spruce, 5" , N22°E, 19.25'
- Steel sign post, w/54-26-54-4 signs, south, 6.55

See: T143N R25W Book 1 pg 44
T143N R26W Book 2 pg 38

7-21-82

Whitehorn Recovery

Recovered: 2 in galvanized iron pipe
with 2 1/2 in. brass cap.

stamped:

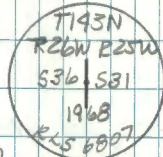

up 2.3 ft in swamp.
Also found 4x4 in x 3.4 ft
cedar post lying in swamp
by pipe drove back in swamp
on north side of pipe

From which:

- N. Pine, 23.3 in, S10 1/2°E, 95.79 ft to 60d
spike, verticle in baseblaze. Scribing "531"
and "BT" visible. Only half blaze visible.
- B. Spruce, 6.9 in, N77 1/2°E, 14.70 ft to the
face of the baseblaze. scribing "531" and
"BT" visible.
- B. Spruce, 6.6 in, N24°E, 19.05 ft to nail
in SE face. Put 60d verticle spike in
~~center~~^{bottom} of baseblaze. Scribing "531" and "BT"
visible. Tree has a 45° SE lean
- Popple, 6.9 in, S75 1/2°W, 56.13 ft to 60d
verticle spike in baseblaze. Scribing
"536" and "BT" visible

Z-25

1976 BLM Dependent Resurvey

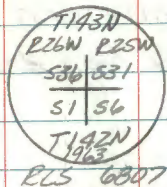

Recovered

Iron post, 2½" diam, concrete filled, firmly set,
projecting 24" above ground w/bc

From which:

aspen, 6" N16°E, 31 lks (20.5')
ash, 5" S68°E, 36 lks (23.8')
aspen, 6" S48°W, 14 lks (9.2')
aspen, 7" N62°W, 17 lks (11.2')

1872 Original survey

marked the following BT's

tamarack, 10" S46°E, 26 lks (17.2')
tamarack, 12" N85°E, 5 lks (3.3')
Cedar, 6" N59°W, 8 lks (5.3')
Spruce, 10" S63°W, 29 lks (19.1')

1937 Gelhaug recovery notes

recovered:

tamarack stump 10" N85°E, 5 lks
Cedar, down, N59°W, 8 lks

Established: Cedar post for corner
Balm of Gilead, 9", S59°E, 236 lks (155.8')

Recovery by Bob McDonald (USFS)

recovered: Cedar post (1937)

tamarack stump, cedar stump
established: 2" x 60" galv pipe (skerman)
aspen, 6", S49°W, 9.1'
aspen, 7", N64°W, 11.2'
aspen, 6", N18°E, 20.0'
elm, 4", S68°E, 24.0'
Cedar post, 4x4, west, 2.2'

K. Matson

July 21, 1982 LRP Recovery, G. Kosenko

aspen (dead snag) aspen, 12"
aspen 8" aspen, (dead snag)
elm 4" aspen, (stump scr. visible)
elm 5" aspen, 9"

placed 6d spike in base of each tree.
corner perpetuated in 1981 and in good condition.

V-7

1/4 Corner Common to
Sections 29 and 32

8-10-83 Ken Whitehorn pulled corner
maintenance. 2 in by 24 inch
galvanized iron pipe with brass
tablet stamped:

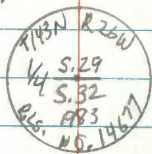

monument is flush with the road surface
and 1.5 ft northerly of the centerline in
curve of CSAH #65. The 1969 BT are
grown completely shut but are marked
with red enamel & BT tag #34-3

References

1980 Bwer Pole - $S.5^{\circ}W$ 52.65 ft to a 20d
nail in westerly face driven through a
folded aluminum tag

1969 W. Oak 9.8 in $N43^{\circ}E$ 92.82 ft to 20d
nail in the northwesterly face.

1969 W. Oak 12.7 inch $N^{\circ}E$ 70.46 ft to 20d
nail in the easterly face.

See Book #1, pp 62

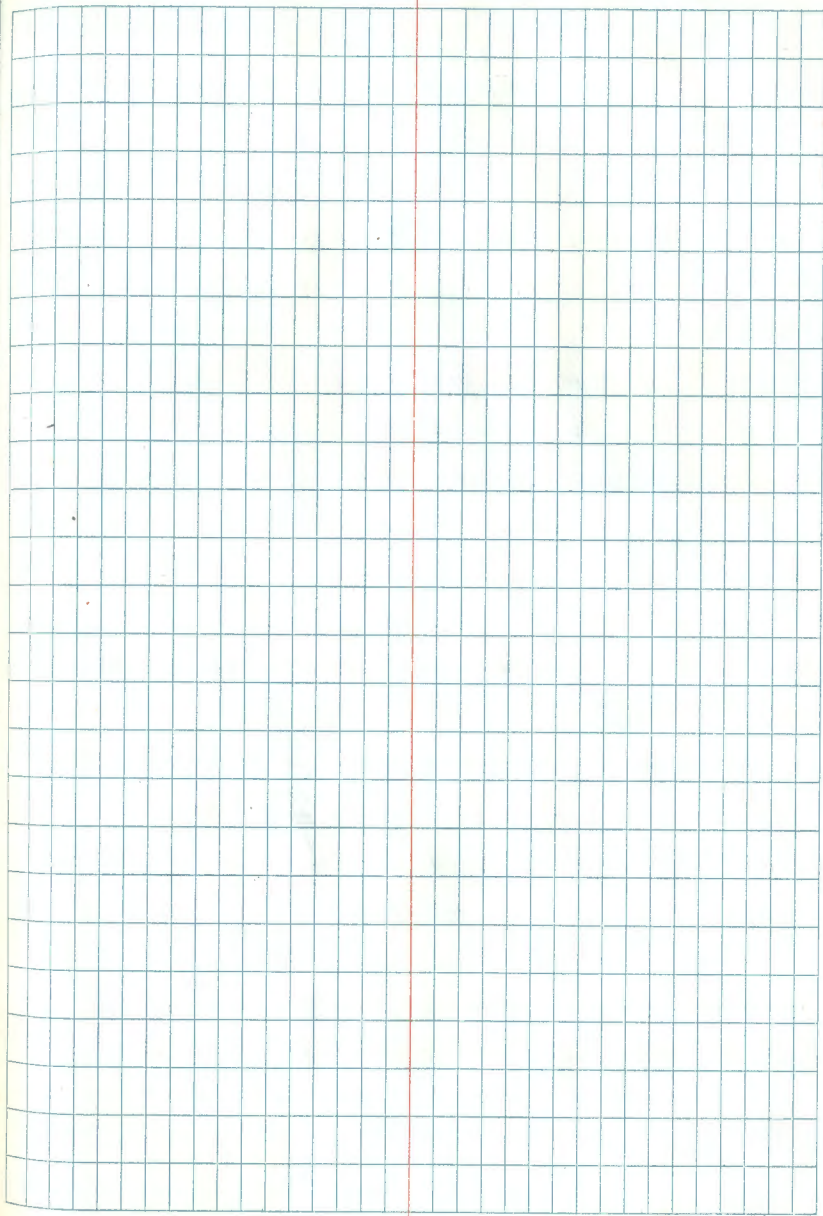
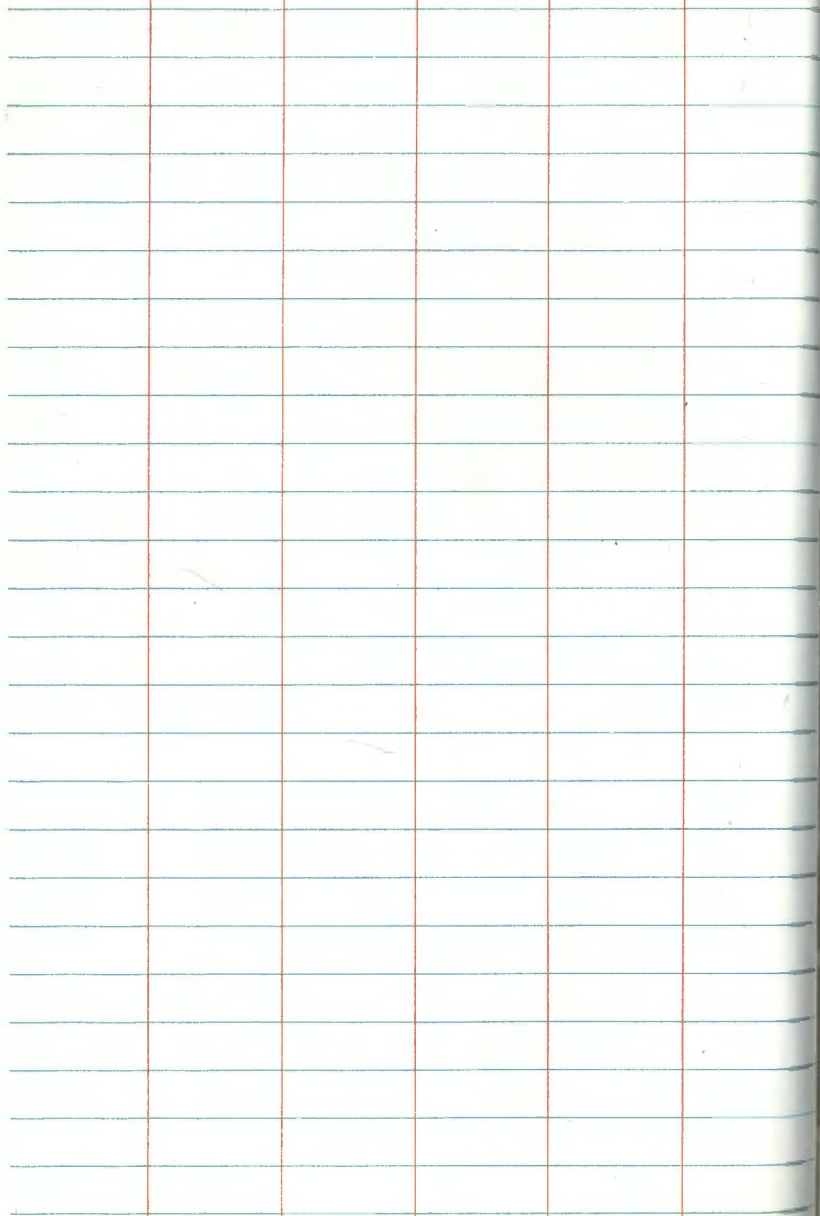

T143N R 26W

Traverse along Cass County rd 45

 STA 1st H&D 2nd H&R 3rd H&D 4th H&R
 HX

Dist 1-2 90-01-01 269-58-34 90-01-13 2635.03 2635.03

Dist 2-1 90-00-00 269-59-21 90-00-19 2635.05 2635.05

ES 3 176-34-~~14~~¹³ 356-34-13 176-34-15 356-34-11BS 1 00-00-~~13~~¹³ 180-00-12 00-00-11 180-00-10
 T@ 2 176-~~33-52~~³⁴⁻⁰⁰ 176-34-01 176-34-04 176-34-01
 176-34-02
Dist 2-3 90-04-47 269-54-43 90-05-02 ~~2633.10~~⁸ 2833.10

Dist 3-2 89-56-29 270-03-07 56-41 2833.12 2833.12

FS 4 180-07-19 00-07-09 180-07-~~18~~⁰² 00-06-59BS 2 20-00-29 180-00-27 00-00-~~19~~¹⁹ 180-00-24
 T@ 3 180-06-40 180-06-42 180-06-~~42~~⁴³ 180-06-35
 180-06-40

Dist 3-4 90-04-27 269-55-10 90-04-39 2705.52 2705.52

Dist 4-3 89-56-43 270-03-05 89-56-49 2705.54 2705.54

August 1, 1984

T2 SW 265184

Red IA SW 4863

Temp = 75°F BPR = 29.7

ELF = +1 @ 8:30 AM

Sunny, humid, breeze

PC RT G. Kosenko

TTT G. Robertson

A B. Ausk

2635.04

STA 1 =

Section corner under road

@ intersection of C 65

(under road surface) C 158

STA 2 = PK nail @ intersection
of road & and fence line to N.

2833.11

STA 3 = PK nail in intersection
on Road & and fence line to N

2705.53

T143N R26W

Traverse cont'd from pg. 48

STA 1st H&D 2nd H&R 3rd H&D 4th H&D

H&R

FS 5 181-26-35 01-26-33 181-26-36 01-26-34

BS 3 00-00-31 180-00-24 00-00-24 00-00-23

TQ 4 181-26-09 181-26-09 181-26-12 181-26-11

181-26-09

Dist 4-5 90-03-19 269-56-06 90-03-37 1318.49 1318.49

1318.49

Dist 5-4 89-58-27 270-01-02 89-58-43 1318.50 1318.50

FS 6 180-02-44 00-~~02-20~~⁰²⁻³⁷ 180-02-41 00-02-41

BS 4 00-00-20 180-00-13 00-00-23 180-00-15

TQ 5 180-02-24 180-02-24 180-02-18 180-02-26

180-02-23

Dist 5-6 90-26-26 269-33-19 90-26-34 1337.51 1337.47

1337.48

Dist 6-5 89-35-16 270-24-09 89-35-34 1337.53 1337.50

August 1, 1984

STA 4 = PK nail @ intersection
of road & old fence running N
and S

STA 5 = PK nail @ intersection
of road and 1/2" fence line running
S

T143N R26W

Traverse cont'd from pg. 49

STA 1st H&D 2nd H&R 3rd H&D 4th H&R

H&R

FS 7 181-40-21 01-40-23 181-40-20 01-40-27

BS 5 00-00-27 180-00-23 00-00-27 180-00-27

PT 6 181-39-54 181-40-00 181-39-53 181-40-00

181-37-57

Dist 6-7 89-48-51 270-10-41 89-49-05 902.10 902.10

Dist 7-6 90-13-32 269-45-54 90-13-49 902.12 902.11

FS 8 180-06-27 00-06-28 180-06-23 00-06-26

BS 6 00-00-23 180-00-23 00-00-20 180-00-24

PT 7 180-06-04 180-06-05 180-06-03 180-06-02

180-06-04

Dist 7-8 90-42-02 269-17-39 90-42-12 1774.69 1774.56

Dist 8-7 89-19-33 270-40-05 89-19-44 1774.72 1774.60

August 1, 1984

STA 6 = PK rail @ intersection
of road & Fena line running N

902.10

STA 7 = intersection of
road E's of 65 & S2

1774.58

63
T143N R26W

Traverse cont'd from pg 50

STA 1st H&D 2nd H&R 3rd H&D 4th H&R

HA

FS 9 178-31-37 358-31-38 178-31-32 358-31-35

BS 7 00-00-23 180-00-22 00-00-20 180-00-26

TA @ 8 178-31-14 178-31-16 178-31-12 178-31-09

178-31-13

Dist 8-9 89-57-53 270-01-43 ~~89-58-05~~ 2691.57 2691.57

Dist 9-8 90-03-08 269-56-06 90-03-30 2691.59 2691.59

END OF THIS TRAVERSE

45.2

62
August 1, 1984

STA 8 = intersection of
road & S 65° 52'

2691.58

END OF THIS TRAVERSE

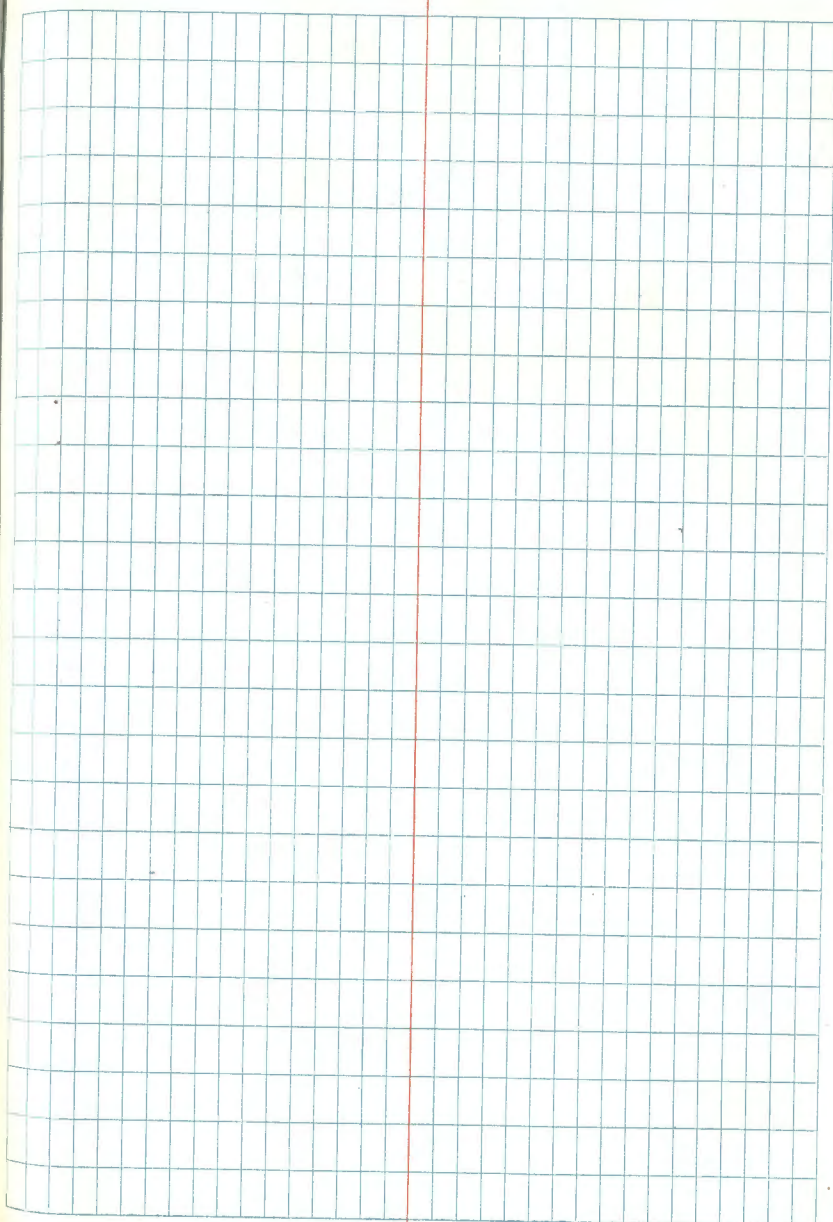
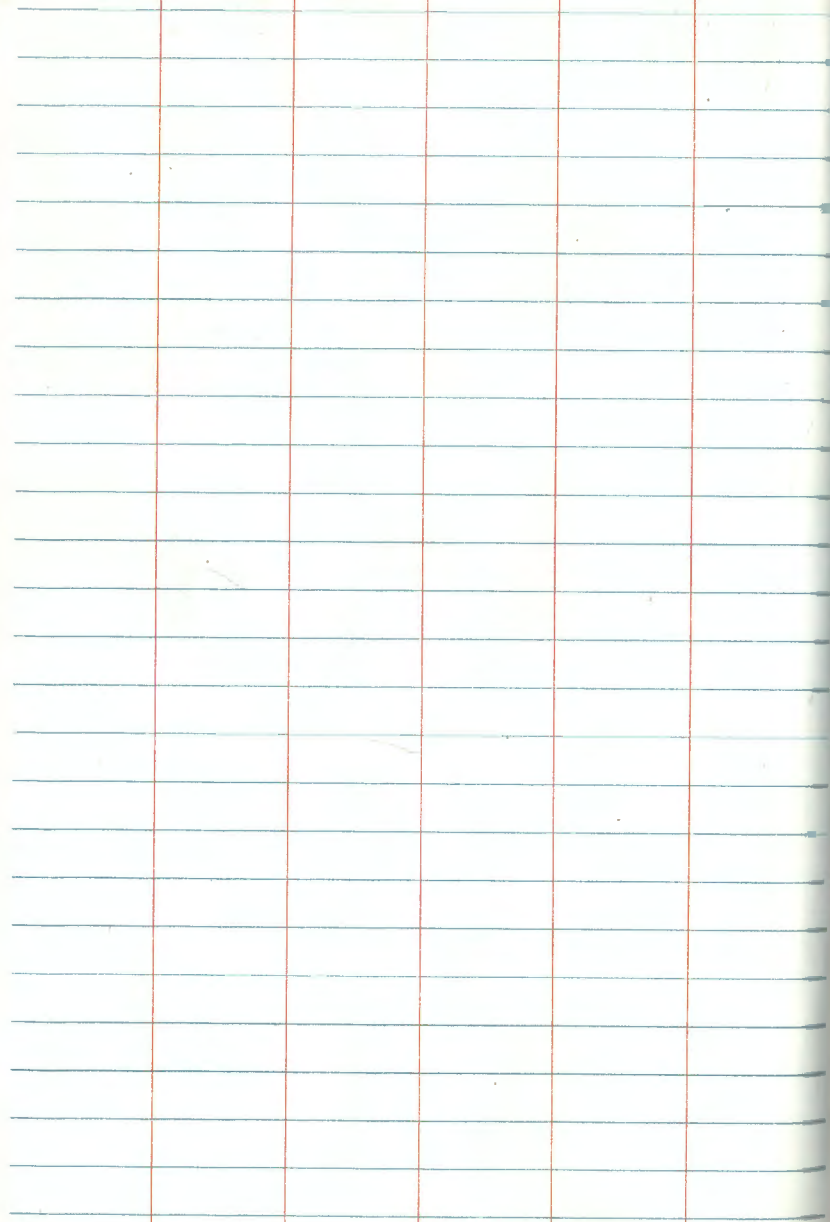

55 V-80

T143N R26W

V-8

E 116 29-32

Aug 19-1988 JAMES H. FLYNN

SURVEYORS RECORD Book "C" pg 152

Set Wood Post

5th mp W. PINE 28" N110°E 55.00'

Basswood 5" S230°E 49.25'

Inverse Monumentation info to set sta 2915

E 1116 29-32

STA 1st H&D 2nd H&R(H&D)
H. Dist

HA

FS 2915 354-56-37 174-56-40

BS 206 00-00-00 180-00-20

AC 207 354-56-37 354-56-20 175.37

354-56-29

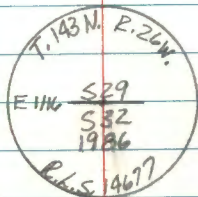

Set

6-3-86 G. Robertson / B. Ausk

Set a 2 ft long by 2 1/2 in outside diameter concrete filled galvanized iron pipe with a 3" dia brass cap stamped as shown, slightly below road surface and exposed. Magnet pellet at base of monument.

From which:

W. Oak 10.0 in, N38°E, 117.10 ft to a 1/6d nail

in NW face, double blaze "E 1116 S29 BT" w/60d spike

R. Oak, 6.6 in, S ~~47~~³⁷°E, 136.80 ft to a 1/6d nail

in NE face double blaze "E 1116 S32 BT" w/60d spike

R. Oak, 12.4 in, N37°W, 85.74 ft to a 1/6d nail

in SW face, double blaze "E 1116 S29 BT", w/60d spike

BT Blazes painted red

⊕ CSAH #65 is 3.5 feet south of corner

Card filed 6-3-86

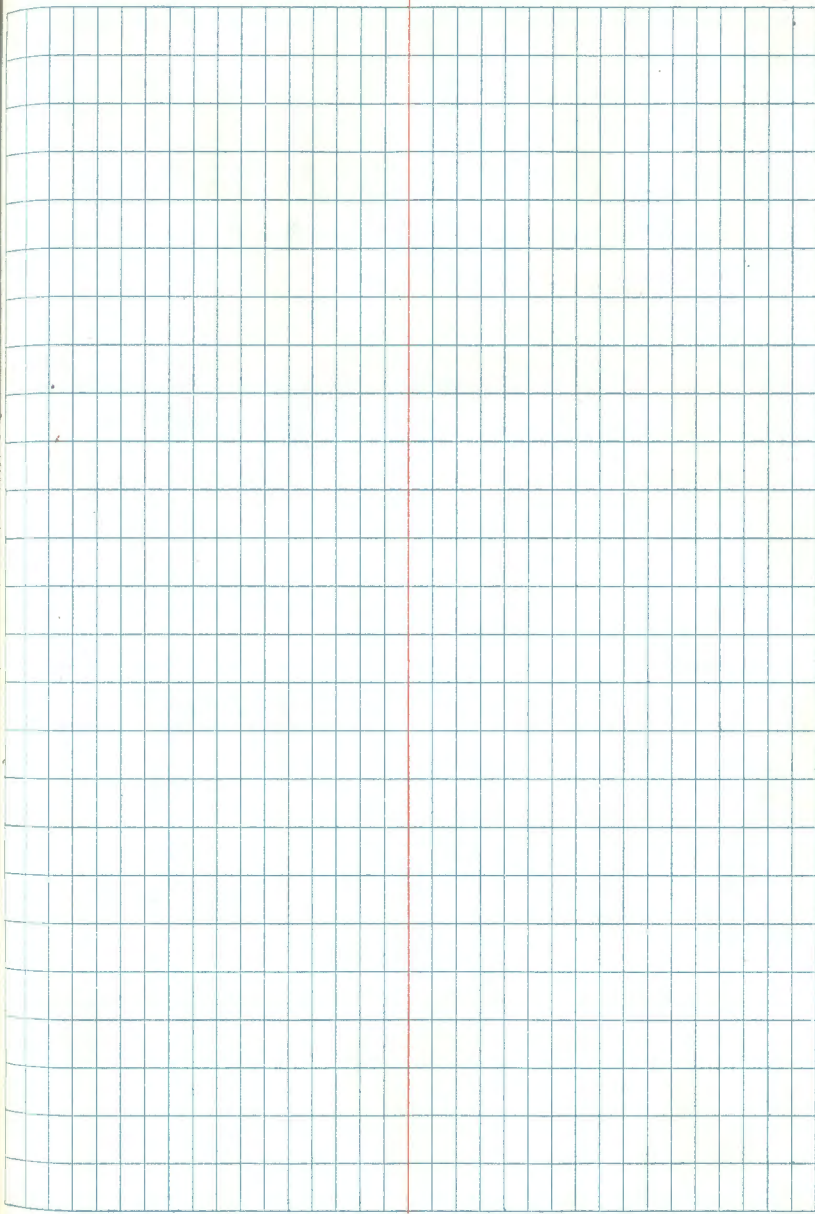
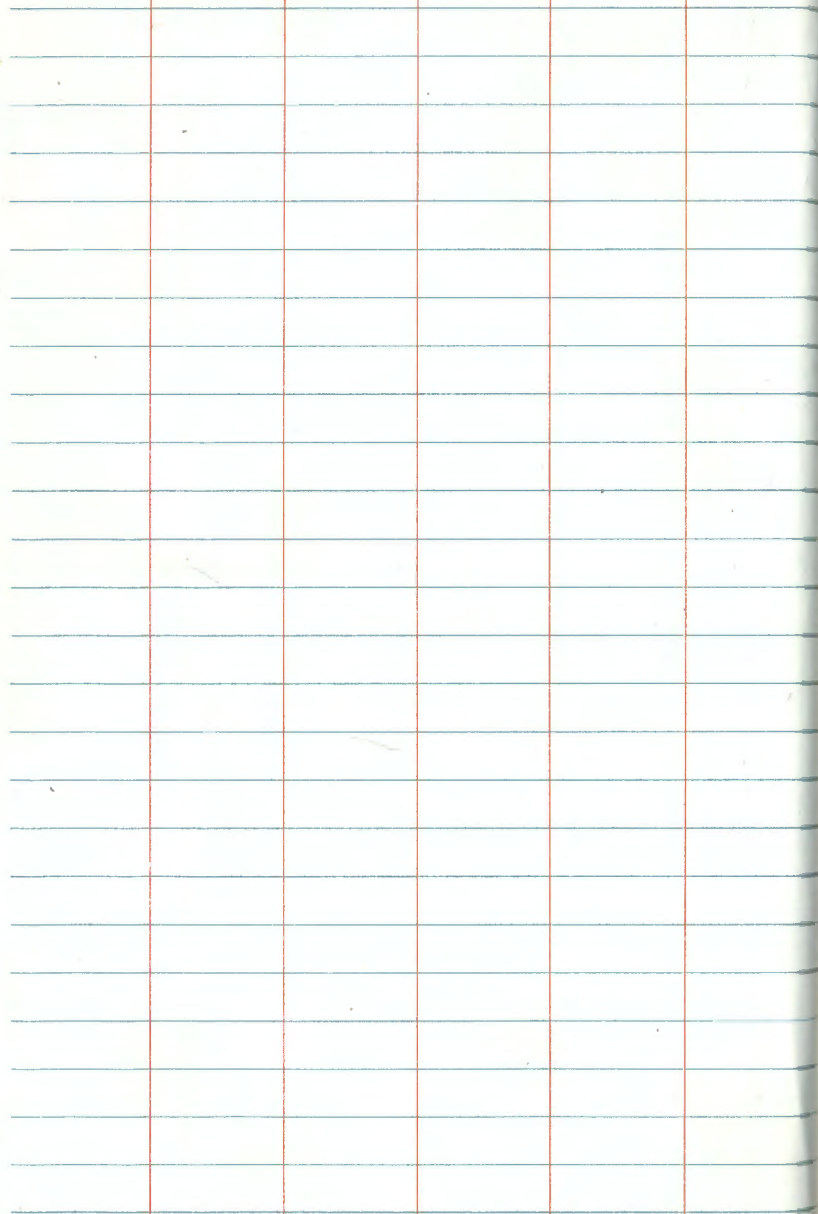

V-6 T143NR26W
W 1/16 29-32

Aug 19, 1918 JAMES H. FLYNN
SURVEYORS RECORD BOOK "C" pg. 152
THIS CORNER IN GARDEN,
NO TREES NEAR

Inverse and Monumentation info to
set the W 1/16 29-32, sta 2917
STA 1st H&D 2nd H&R H. Dist
HX

FS 2917 171-58-13 351-58-05

BS 210 00-00-00 180-00-50

TO 209 171-58-13 171-57-15 91.19

6-3-86

B. Ausk / G. Robertson

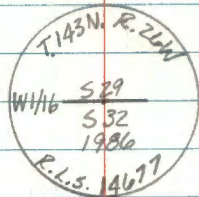

Set a 2 ft long by 2 1/2 in. outside diameter concrete
filled galvanized iron pipe with a 3 in. dia. brass cap,
slightly below road surface and exposed, stamped as
shown. Magnet at base of monument.

From which:

culvert, 15 in. dia., S 27° E, 39.22 ft to a nail
hole in the top of the west end.
Aspen, 10.2", S 51° W, 90.37 ft to a 16 d nail
in SE face, double blazed, scribed "W 1/16 532 BT"
5.3 ft North to highway E
Aspen blazes painted red with 60d spike in BT place
Card filed 6-3-86

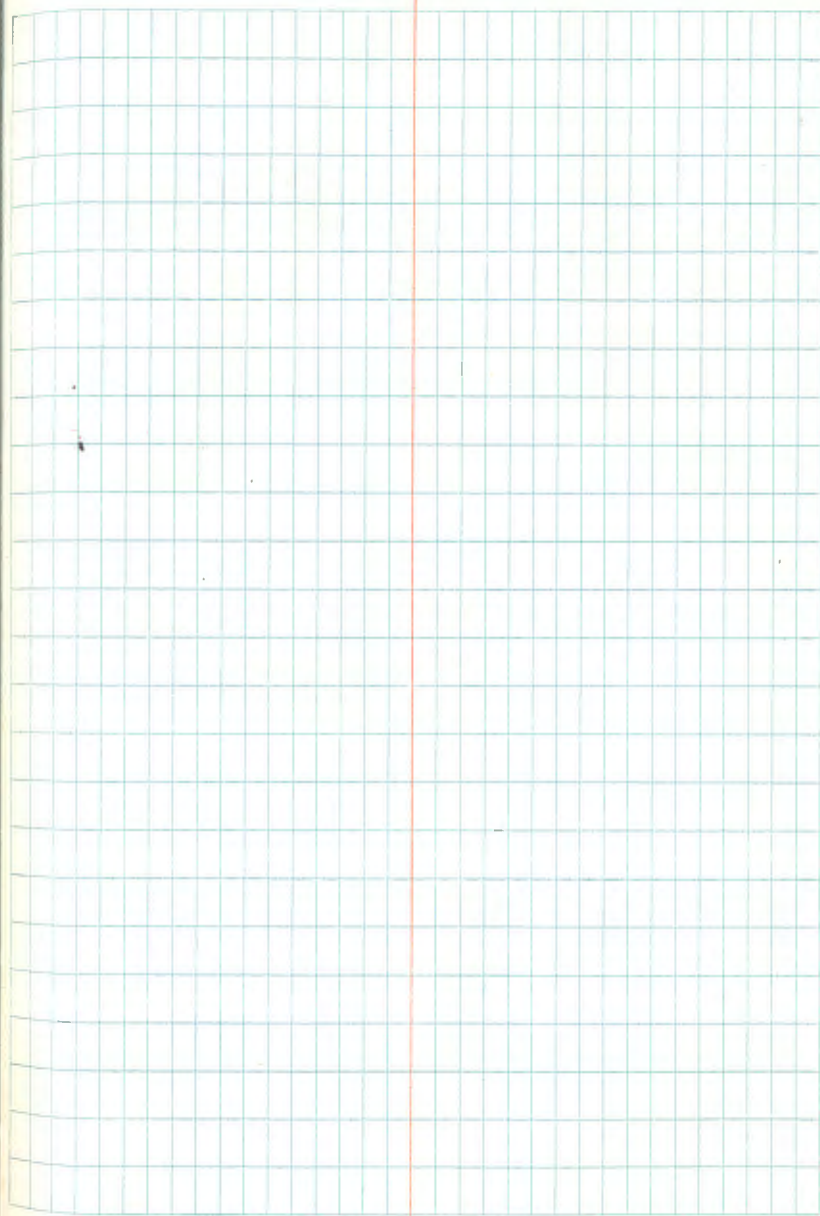
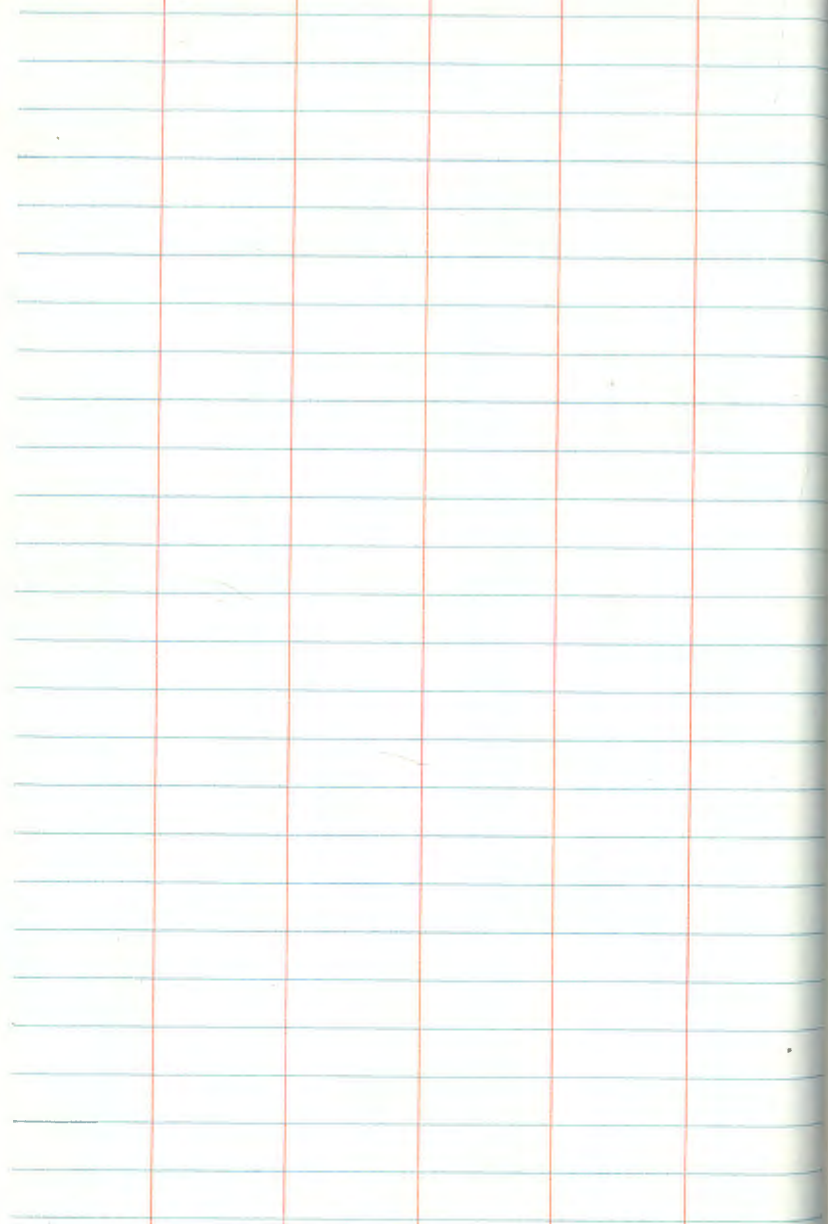

57 5-9

T143N R26W

N 1/4 529-28

Aug 19, 1988 James H. Flynn
Surveyors Record Book C pg 151

Set wood post

Basswood 6" N71°E 24.0'

W. Pine Stamp 26" S75°W 28.2'

SKIPPED SOME
BLANK PAGES
IN THIS
BOOK

Sec 29, T148N, R26W Co. Rec. Book C
 Horst. Surv. p149

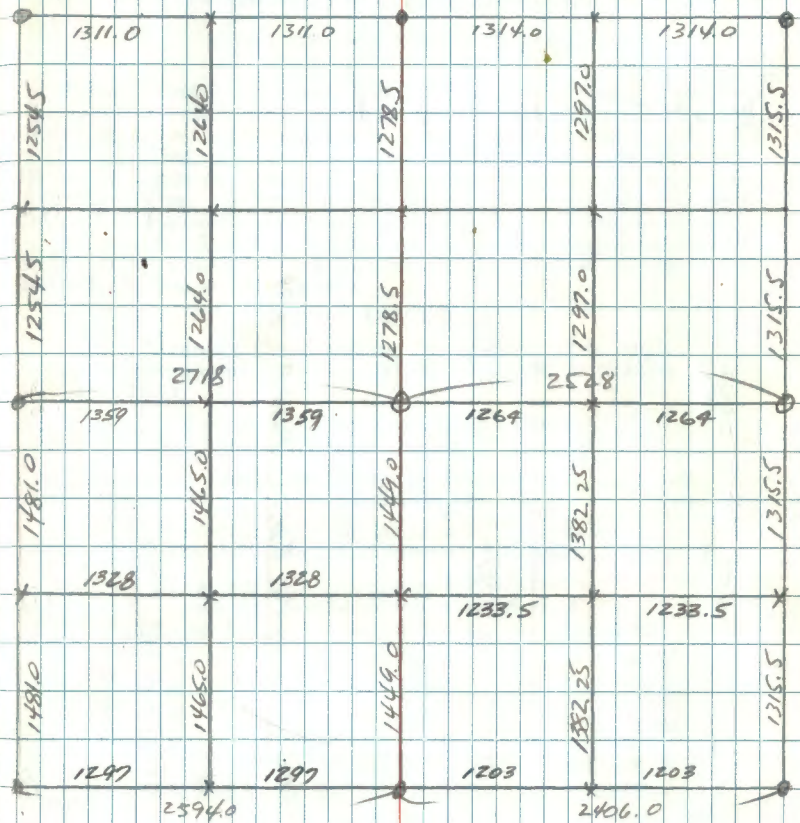

- $2\frac{1}{2}$ " i.m. from orig. B.T.
- o $2\frac{1}{2}$ " i.m. established by survey
- x $2\frac{1}{2}$ " x 4" x 30" wood posts

29	*	2594 V 721'	32	2630.8 Var 8"	2743	19
		2400 V 11025'		2628 V 7030'	2767	17
		2656 V 803'		27319	2659	16
28	*	2622 V 805'	33	27319 V 1030'	2741	15
		2625 V 60'		2753.8 V 12030'	2658	14
			19	2679.3 V 110'	2640	13
			20		2736	24

S. R. H. #45
Survey #261
Book B p 98

CURVE TABLES

Published by KEUFFEL & ESSER CO.

HOW TO USE CURVE TABLES

Table I. contains Tangents and External to a 1° curve. Tan. and Ext. to any other radius may be found nearly enough, by dividing the Tan. or Ext. opposite the given Central Angle by the given degree of curve.

To find Deg. of Curve, having the Central Angle and Tangent: Divide Tan. opposite the given Central Angle by the given Tangent.

To find Deg. of Curve, having the Central Angle and External: Divide Ext. opposite the given Central Angle by the given External.

To find Nat. Tan. and Nat. Ex. Sec. for any angle by Table I.: Tan. or Ext. of twice the given angle divided by the radius of a 1° curve will be the Nat. Tan. or Nat. Ex. Sec.

EXAMPLE

Wanted a Curve with an Ext. of about 12 ft. Angle of Intersection or I. P. = 23° 20' to the R. at Station 542+72.

Ext. in Tab. I opposite 23° 20' = 120.87
120.87 + 12 = 10.07. Say a 10° Curve.

Tan. in Tab. I opp. 23° 20' = 1183.1
1183.1 + 10 = 118.31.

Correction for A. 23° 20' for a 10° Cur. = 0.16
118.31 + 0.16 = 118.47 = corrected Tangent.

(If corrected Ext. is required find in same way)
Ang. 23° 20' = 23.33° + 10 = 2.3333 = L. C.

2° 19½' = def. for sta.	542	I. P. = sta.	542 + 72
4° 49½' = " " "	+50	Tan. =	118.47
7° 19½' = " " "	543	B. C. = sta.	541 + 53.53
9° 49½' = " " "	+50	L. C. =	2.3333
11° 40' = " " "	543 +	E. C. = Sta.	543 + 86.86
	86.86		

100 - 53.53 = 46.47 × 3' (def. for 1 ft. of 10° Cur.) = 139.41' =

2° 19½' = def. for sta. 542.

Def. for 50 ft. = 2° 30' for a 10° Curve.

Def. for 36.86 ft. = 1° 50½' for a 10° Curve.

