

T 143 R 25

TRAVERSE

T 143 N R 25 W

TRAVERSE

FIELD BOOK

NO. 0012

BOOK # 5

T 143 N R 25 W TRAVERSE

TRAVERSE ONLY

LITHIUM

BOOK 2

T143 NR 25 W
TRAVERSE (BK5)

INDEX

Project	pg.
Vermillion Lake - Sec. 28	
Control Traverse	1-17
Sketch	17
Supp. Traverse	18-19

USFS, CASS COUNTY, MN

1 Traverse of Sec 28, T43N R25W
Vermillion Lake Project

FT METERS #D

FS 3 234-48-00 54-47-52 234-47-51 54-47-51

BS-NE 28 00-00-09 180-00-05 00-00-01 180-00-05

PC 2 234-47-51 234-47-47 234-47-50 234-47-46

234-47-49

DIST 2-1 90-26-43 269-33-36 287,935 87.763 287.926

DIST 2-3 89-24-11 270-36-06 331,175 100.942 331.157

FS 4 193-37-16 13-37-10 193 37 07 13-37-10

BS 2 00-00-28 180-00-18 00-00-13 00 15

PC 3 193-36-48 193-36-52 193-36-44 193-36-55

193-36-50

FS 5 164-15-24 344-15-23 164-15-15 344-15-16

BS 3 00-00-23 180-00-09 00-00-06 180-00-04

PC 4 164-15-01 164-15-14 164-15-09 164-15-12

164-15-09

2/8/89
CIBAR -10°F
Wind T-2 SW 265184
Letz Rod EDM

DT R MAIN
D. MAKI

NEAR VA

NE OF 28

52025

N
4

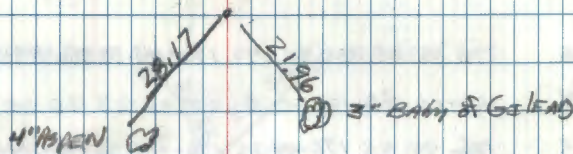

90-26-34

89-24-03

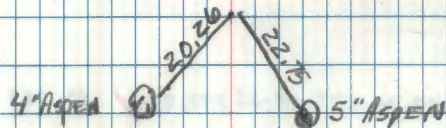

Road
Post

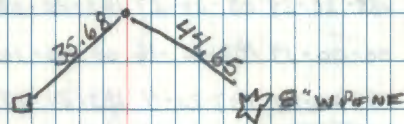

Vermillion Lake Project

FT M #D

	90-49-36	269-10-24			
DIST 4-3	90-49-36	269-10-24	437.58 ✓	193.371	437.535
	87-84-09	272-25-58			
DIST 4-5	87-84-09	272-25-58	614.29 ✓	187.235	613.737

FS 6	176-44-05	356-44-49	176-44-59	356-44-49
BS 4	00-00-20	180-00-11	00-00-23	180-00-12
IT@ 5	176-44-45	176-44-38	176-44-36	176-44-37

176-44-39

FS 7	240-14-24	60-14-14	240-14-20	60-14-04
BS 5	00-00-22	180-00-14	00-00-11	180-00-14
IT@ 6	240-14-02	240-14-00	240-14-09	240-13-30

240-13-58

DIST 6-5	86-57-50	273-08-26	272.21 ✓	82.969	271.828
DIST 6-7	91-12-55	268-47-30	502.27 ✓	153.090	502.157

FS 8	183-20-29	03-20-27	183-20-33	03-20-25
BS 6	00-00-19	180-00-16	00-00-16	180-00-15
IT@ 7	183-20-10	183-20-11	183-20-17	183-20-10

183-20-122/9/89
Cloudy 10°FWHTZ
Light EBM
Mean VAW. R. MAJEN
D. MAKE
E. SCHMEIDT

90-49-36

87-84-09

12" BIRCH

4" BIRCH

3" BIRCH

5" BIRCH

86-57-42

91-12-48

10" BIRCH

12" BIRCH

Vermillion Lake Project

FT M AD

FS 9	245-49-30	65-49-30	245-49-26	65-49-28
BS 7	00-00-19	180-00-18	00-00-11	180-00-11
PC 8	245-49-11	245-49-12	245-49-15	245-49-17
	245-49-14			

DIST 8-7	87-22-18	272-37-52	530.135	161.586	529.577
DIST 8-9	91-42-23	268-17-47	1185.430	361.320	1184.904

^{N¹/₄} FS 10	90-21-47	270-21-47	90-21-46	270-21-35
BS 8	00-00-39	180-00-33	00-00-37	180-00-32
PC 9	90-21-08	90-21-14	90-21-09	90-21-03
	90-21-09			

FS 11	49-19-28	229-19-12	49-19-18	229-19-13
BS 9	00-00-15	180-00-04	00-00-09	180-00-04
PC 10	49-19-13	49-19-08	49-19-09	49-19-09
	49-19-10			

DIST 10-9	89-38-38	270-21-21	125.070	38.121	125.063
DIST 10-11	89-37-35	270-23-10	219.610	66.938	219.605

Menn V4

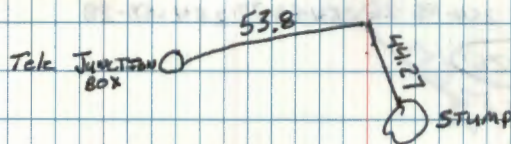

87-22-13

91-42-18

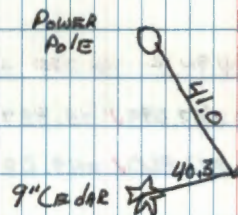
N¹/₄ SEC 28

89-38-39

89-36-60

Vermillion Lake Project

FS 13 254-58-44 74-58-39 254-58-45 74-58-42
 BS 10 00-00-21 180-00-13 00-00-18 160-00-14
 TC 11 254-58-23 254-58-26 254-58-27 254-58-28

254-58-26

FS 204-17-25 24-17-17 204 17 20 24-17-18

BS 00-00-27 180 00 25 00-00-25 180 00-26

TC 12 204-16-58 204-16-52 204-16-55 204-16-52

204-16-54

Dist 12-11 93-00-29 266-59-48 247.695 ✓ 75.497 247.354

12-13 89-27-25 270-32-50 817.860 ✓ 249.284 817.823

FS 160 27-47 340 27-44 160-27-48 340-27-45

BS 00-00-39 180 00-39 00-00-43 180-00-38

TC 13 160-27-08 160-27-05 160-27-05 160-27-07

160-27-06

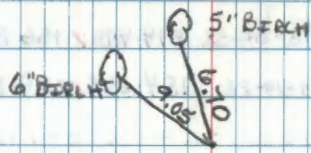
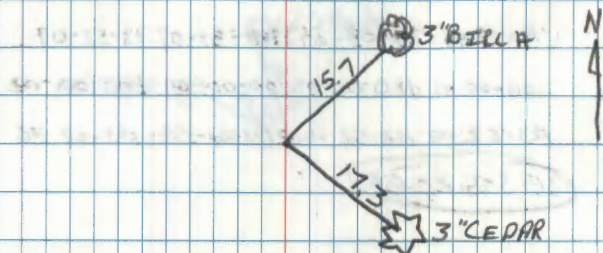

93-00-21
89-27-18

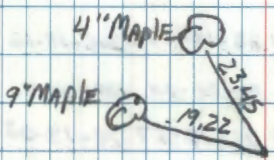

Vermillion Lake Project

FT M HD

FS 15	193-52-13	193-52-07	193-52-07	193-52-07
BS 13	00-00-41	180-00-05	00-00-09	180-00-02
TC 14	193-52-02	193-52-02	193-51-58	193-52-05

193-52-02

DIST 14-13	89-54-18	270-05-55	514.485	156.814	514.484
DIST 14-15	90-40-47	269-19-26	754.255	229.898	754.202

FS 16 MC	282-29-13	102-29-13	282-29-07	102-29-04
BS 14	00-00-36	180-00-28	00-00-28	180-00-20
TC 15	282-28-23	282-28-15	282-28-21	282-28-24

282-28-21

FS 17	25-13-16	205-13-14	25-13-17	205-13-13
BS 15	00-00-22	180-00-16	00-00-20	180-00-11
TC 16 MC	25-12-54	25-12-58	25-12-57	25-12-02

25-12-58

DIST 16-15	89-40-12	270-19-58	2353.960	717.488	2353.921
DIST 16-17	90-00-49	269-59-29	2865.045	873.267	2865.045

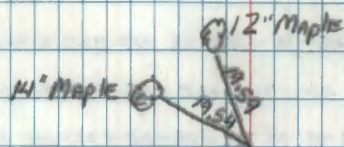

N

89-54-12

90-40-40

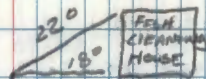

MC secs. 20 & 21

89-40-07

90-00-40

Vermillion Lake Project

FT M HD

~~FS 18 122-05-28 30205-15 122 05 07 302-0454 122 04 57~~
~~BS 16 MC 00-00-09 180-00-07 00-00-05 180-00-00 00-00-00~~
~~T@17 17 122-05-08 122-05-02 122-04-54 122-04-57~~

122-05-00

FS 239-16-20
~~239-16-24~~ 59-16-18 239-16-21 59-16-12
 00-00-85
 BS ~~00-00-29~~ 180-00-28 00-00-39 180-00-32
 239-15-45
 T@18 239-15-50 229-15-42 239-16-40
 W 1/4 R 28

239-15-44

07 54-50
 DIST 18-17 92-05-22 267-55-09 289,385/88,205 289,193
 26 31
 18-19 89-13-38 270-46-44 681,945/207,857 681,882

FS 20 220-02-63 40-02-09 220-02-17 40-02-09
 BS 18 00-00-18 180-00-12 00-00-21 180-00-17
 T@19 220-01-45 220-01-57 220-01-56 220-01-52

220-01-53

2/13/89

R MAEN

CLEAR 15°

D MAKI

WILD T-2
 LIETZ EDM

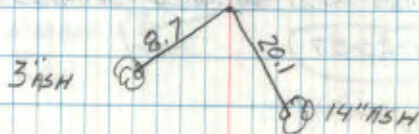
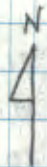

T.M. 3N 125W
 1/4
 529 & 528
 1964
 P.L.S. NO 6807

92-05-09

89-13-28

8" Balm of
 Gilead



Vermillion Lake Project

FT M HD

FS 21 141-21-21 321-21-10 141-21-15 321-21-06

BS 19 140-00-24 180-00-16 00-00-20 180 00 12

TC 20 141-20-57 141-21-00 141-20-55 141-20-54

141-20-57

OJST 20-19 88-21-23 271-38-31 190.135 ✓ 57.953 190.057

OJST 20-21 89-39-15 270-20-47 756.005 ✓ 230.430 755.991

FS 22 177-32-56 357-32-52 177-33-00 357-33-02

BS 20 00-00-20 180-00-06 00-00-19 180 00 13

TC 21 177-32-36 177-32-46 177-32-41 177-32-49

177-32-43

FS 23 179-34-52 359-34-42 179-34-46 359-34-40

BS 21 00-00-23 180 00 10 00-00-13 180-00-05

TC 22 179-34-29 179-34-32 179-34-33 179-34-35

179-34-32

OJST 22-21 95-16-08 264-47-42 167.015 ✓ 50.906 166.309

OJST 22-23 87-40-25 272-19-25 288.755 ✓ 88.015 288.517

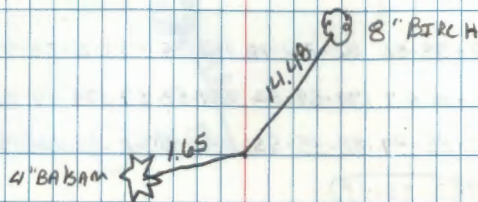

88-21-26

89-39-14

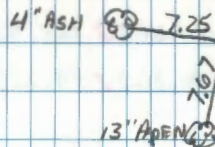

5 Maple 3.97

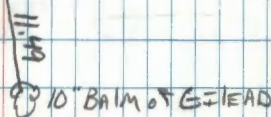

95-16-13

87-40-30

Vermillion Lake Project

FT M HD

FS - 24 182-35-56 02-35-48 182-35-49 02-35-45

BS - 22 00-00-07 179-59-53 359-59-57 179-59-50

T@ 23 182-35-49 182-35-55 182-35-52 182-35-55

182-35-53

FS - 25 175-32-27 355-32-13 175-32-19 355-32-14

BS - 23 00-00-25 180-00-16 00-00-20 180-00-13

T@ 24 175-32-02 175-31-57 175-31-59 175-32-01

175-32-00

Dist 24-23 94-38-11 265-21-46 411.605 ✓ 125.458 410.258

Dist 24-25 86-49-49 273-10-05 190.865 ✓ 58.177 192.573

FS 26 160-36-52 340-36-37 160-36-45 340-36-37

BS 24 00-00-22 180-00-13 00-00-18 180-00-10

T@ 25 160-36-30 160-36-24 160-36-27 160-36-27

160-36-27

12" ASPEN

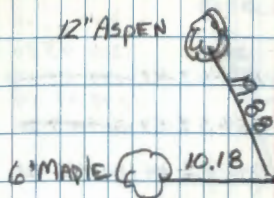

N

6" MAPLE

10.18

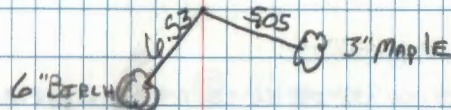

94-38-13

86-49-52

7143N R25W

529 528

632 533

1976

Vermillion Lake Project

FT M HD

		309 43 36		309 43 36
FS 27	129-43-43	180-00-00	129-43-43	179 59 54
		180 00 00		179 59 54
BS 25	00 00 00	309 43 36	359-59-59	309 43 36
TP 26	129-43-43	129-43 36	129-43-44	129-43-42

129-43-41

Dist 26-25	93-00-03	266-57-47	171.275	✓ 52.205	171.040
26-27	86-30-27	273-29-28	682.245	✓ 207.749	680.978

FS 28	119-54-32	299-54-23	119-54-27	299-54-17
BS 26	00-00-31	180 00-17	00-00-27	180-00-14
TP 27	119-54-01	119-54-06	119-54-00	119-54-03

119-54-63

FS 29	202-45-39	22-45-31	202-45-48	22-45-29
		179-59-54		
BS 27	00-00-08	180	00-00-06	179-59 57
TP 28	202-45-31	202-45-37	202-45 38	202-45-32

202-45-35

		268-16-42		
Dist 28-27	91-43-04	270-09-02	290.480	✓ 88.537
		427.760		290.350
28-29	88-50-45	270-09-02	290.480	✓ 130.441
		427.935		427.873
	88-43-42	271-16-21	427.935	130.434

re-measured 3/4/89

2-14-89

Cloudy 10°
WIND T-2

DTR MAIN

E. SCHMIDT

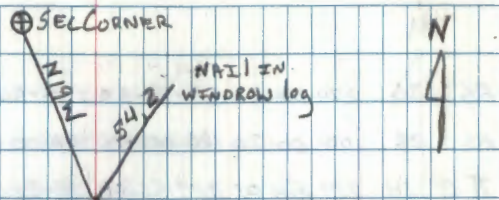

95-00-08

86-30-30

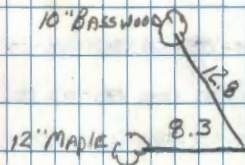
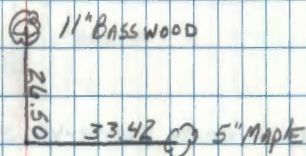

91-43-11

88-43-40

Vermillion Lake Project

FT M HD

FS 30 229-56-21 49-56-30 229-56-21 49-56-28

BS 28 00-00-20 180-00-30 00-00-24 180-00-30

PI @ 29 229-56-01 229-56-00 229-55-57 229-55-58

229-55-59FS 31 151-18-48 ~~151-18-48~~ 331-18-38 151-18-56 331-18-48

BS 29 00-00-49 180-00-37 00-00-47 180-00-53

PI @ 30 151-17-59 151-18-01 151-18-09 151-17-59

151-18-01

DIST 30-29 90-46-03 268-13-45 277.410 84,555 277.385

DIST 30-31 89-27-35 270-32-15 213.985 65,223 213.976

FS 170-37-00 350-36-58 170-36-56 350-36-57

BS 00 00 07 180-00-01 00-00-09 180-00-00

PI @ 31 170-36-33 170-36-57 170-36-48 170-36-57

170-36-54

T 1430 R 25W

W 1/16	5	28
	5	33

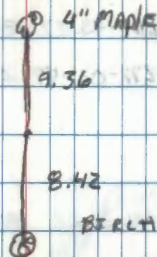
 1976

90-46-09

89-27-40

D'ROAK

16" Maple

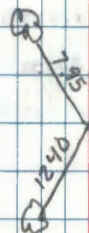

Vermillion Lake Project

FT M HD

FS 33	96-30-20	276-30-12	96-30-19	276-30-18
BS 31	00-00-28	180-00-29	00-00-35	180-00-28
Π @ 32	96-29-52	96-29-43	96-29-44	96-29-47
SOUTH 1/4 SEC 28	(96-29-47)			

DIST 32-31	90-16-24	269-43-22	885.195	269,808	885.185
32-33	87-56-01	272-03-49	280.710	85.560	280.528

	39	82		84	88
FS 34	181-31-29	001-31-22	181-31-30	001-31-24	181-31-28
BS 32	00-00-32	180-00-41	00-00-40	180-00-38	00-00-44
Π @ 33	181-30-47	181-30-41	181-30-40	181-30-46	181-30-44
		(181-30-43)			

FS 35	178-48-13	358-48-07	178-48-11	358-48-04
BS 33	00-00-13	179-59-55	00-00-06	179-59-57
Π @ 34	178-48-00	178-48-12	178-48-05	178-48-07
	(178-48-06)			

DIST 34-35	81-21-21	270-38-33	298.370	90.941	298.351
DIST 34-35	95-06-30	264-53-00	716- 715.995	218.235	713.145

5 1/4 Sec. 28



90-16-31
87-56-06

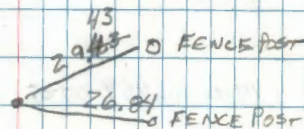
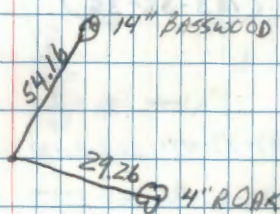

89-21-24
95-06-55

Vermillion Lake Project

FT M NO

FS 30 271-22-02⁰⁰ 91-22-56 271-22-57 91-22-56BS 34 ~~00-00-00~~ 359-59-42 179-59-39 359-59-41 179-59-42

TP 35 271-22-18 271-23-17 271-23-16 271-23-14

271-23-16

FS 37 183-35-44 03-35-40 183-35-30 03-35-27

BS 35 00-00-10 180-00-00 00-00-03 179 59 47

TP @ 36 183-35-34 183-35-40 183-35-27 183-35-40

183-35-35

Dist 35-35 93-79-41 266-10-32 720.650 219.654 719.042 ✓

Dist 36-37 90-36-43 269-23-35 ~~719.654~~ 209.747 688.10 ✓

FS-38 179-07-06 359-07-02 179 07 01 359-07-04

BS-36 00-00-07 180-00-07 00-00-05 180 00-07

TP @ 37 179-06-59 179-06-55 179-06-56 179-06-55

179-06-56

2/27/89

CLEAR 15°

WILD T-2 S/N 287203 (CL zone)

Topcon EDM S/N 659066

R. MAIN

D. OJENEN

J. JACKSON

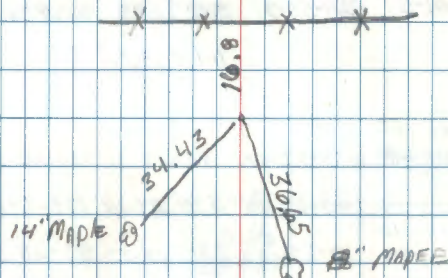
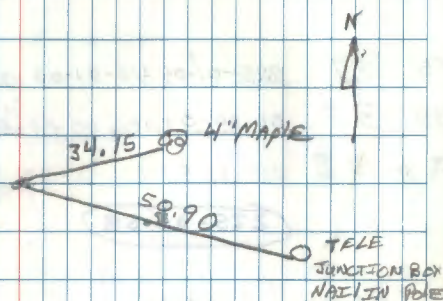

93-49-35

90-36-34

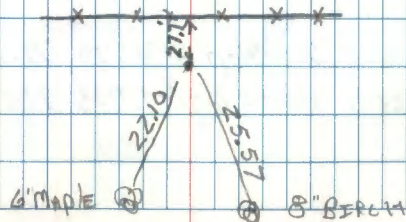

Vermillion Lake Project

ET M HO

FS 39 225-01-04 45-01-00 225-00-58 45-00-58

BS 37 00-00-07 180 00 01 00-00-00 180-00-00

T₀ 38 225-00-57 225-00-59 225-00-58 225-00-58225-00-58

Dist 38-37 87-15-38 272.44-37 658.330 200.661 657.578 ✓

Dist 38-39 95-01-51 264.58-31 332.695 101.466 331.413 ✓

Dist 38-FENCE 142.50' 142.50

FS 40 ~~53-22-52~~ 233-22-57 53-22-51 233-22-52BS 38 ~~00-00-07~~ 180-59-24 359 89-24 179-59-24T 39 ~~53-23-40~~ 53-23-33 53-23-27 53-23-2653-23-32

FS 41 168-30-51 348-30-51 168-30-44 348 30 43

BS 37 00-00-03 179 59 50 359-59-49 179 59 44

T₀ 40 168-30-4-8 168-31 01 168-30-55 168-30-59168-30-56

Dist 40-37 94-24-11 265-36-14 243.670 74.271 242.951 ✓

Dist 40-41 89-28-11 870-32-12 501.905 152.980 501.884 ✓

Dist 40-FENCE 15.30

FENCE
POST

87-15-30

95-01-40

14" Basswood
Clump

T143NR25W

5 1/2

28-27

1983

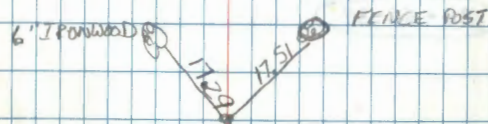

94-23-59

89-28-00

FENCE POST

Vermillion Lake Project

Ft. meters HD

FS 42 177-30-04 357-29-53 177-30-04 357-30-01
 BS 40 00-00-08 180-00-07 00-00-04 180-00-03
 T@ 41 177-29-56 177-29-50 177-30-00 177-29-58

177-29-56

ES 42 178-40-40 358-40-42 178-40-41 358-40-41
 BS 41 00-00-01 179-59-56 359-59-57 179-59-59
 T 42 178-40-39 178-40-46 178-40-44 178-40-42

178-40-43

Dist 42-41 86-06-40 273-53-48 324.905 99.032 324.157 ✓
 Dist 42-43 93-04-20 266-56-13 256.865 78.294 256.496 ✓

FS 44 180-57-06 00-57-13 180-57-08 00-57-02
 BS 42 00-00-24 180-00-34 00-00-24 180-00-30
 T@ 43 180-56-42 180-56-39 180-56-44 180-56-32

180-56-39

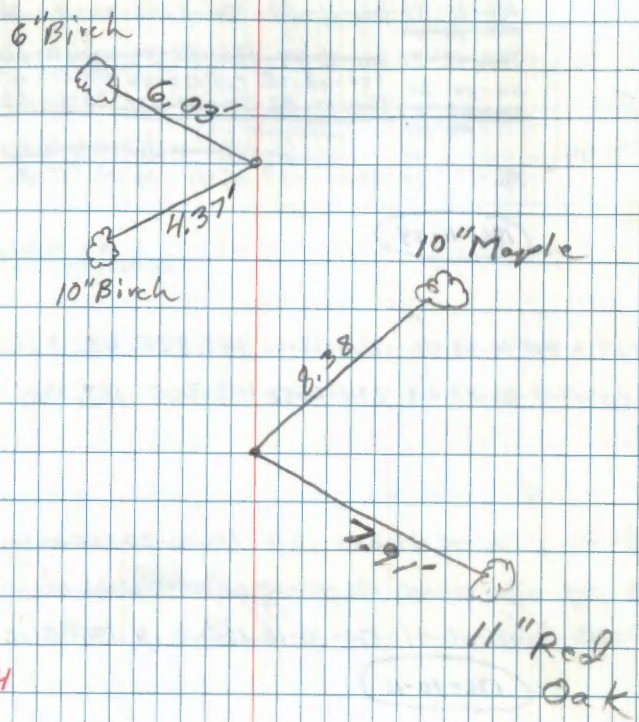

T43MR25N

1/4
 528 ♦ 527
 1983

Vermillion Lake Project

F7 M HD

~~186-11-46~~ ~~06-11-39~~ ~~186-11-42~~ ~~06-11-36~~
~~186-12-39~~ ~~06-12-14~~ ~~186-12-39~~ ~~06-12-10~~
 FS 45
~~00-00-20~~ ~~180-00-02~~ ~~00-00-06~~ ~~180-00-00~~
 BS 43
~~00-00-27~~ ~~180-00-53~~ ~~00-00-27~~ ~~180-00-53~~
~~186-11-26~~ ~~186-11-37~~ ~~186-11-36~~ ~~186-11-36~~
 TC 44

186-11-34

DIST 44-43 94-46-26 265-13-45 143.820 43.836 143.32 ✓
 DIST 44-45 85-33-03 274-26-52 418.200 127.468 416.94 ✓

FS 46 175-10-21 355-10-12 175-10-20 355-10-10
 BS 44 00-00-10 180-00-02 00-00-06 180-00-00
 TC 45 175-10-11 175-10-10 175-10-14 175-10-10

175-10-11

FS 184-45-02 04-44-59 184-45-04 04-45-00
 BS 00-00-15 180-00-09 00-00-18 180-00-13
 TC 46 184-44-47 184-44-50 184-44-46 184-44-47

184-45-48

DIST 46-45 85-07-39 274-52-10 526.54 160.489 524.637 ✓
 DIST 46-47 89-24-43 270-35-07 236.48 72.080 236.468 ✓

3/3/89

Cloudy 0°

Wind T-2

KIRK MAIN

J JACKSON

7" MAPLE @ 10.10
 6" MAPLE @ 7.67

note: bad tripod was the reason for multiple readings

94-46-21

85-33-06

2" MAPLE @ 3.87
 4" MAPLE @ 5.83

6" YEL BIRCH @ 9.46
 15.47
 12" MAPLE

85-07-45

89-24-48

Vermillion Lake Project

FT M HD

FS - 48	182-40-42	02-40-37	4037	
	182-41-12	02-40-36	182-41-16	02-40-33
BS - 46	00-00-21	180-00-28	00-00-10	180-00-29
	182-40-21	182-40-20	182-40-27	182-40-21
TC 47	40-49	40-12	182-40-33	40-04

182-40-22

FS - 49	173-54-45	353-54-31	173-54-40	353-54-31
BS - 47	00-00-38	180-00-35	00-00-34	180-00-33
TC 48	173-54-07	173-53-56	173-54-06	173-53-58

173-54-02

Dist 48-47	86-04-40	273-55-10	204.99	62.483	204.51 ✓
Dist 48-49	91-05-08	268-54-38	477.45	145.528	477.364 ✓

FS 50	179-54-50	359-54-49	179-54-44	359-54-43
BS 48	00-00-22	180-00-16	00-00-18	180-00-20
TC 49	179-54-28	179-54-33	179-54-26	179-54-23

179-54-28

Dist 49	91-03-16	268-56-24	639.42	194.896	639.312 ✓
---------	----------	-----------	--------	---------	-----------

7143NRZ5W
N 1/6
528527
1983

note: bad tripod was the reason for multiple readings.

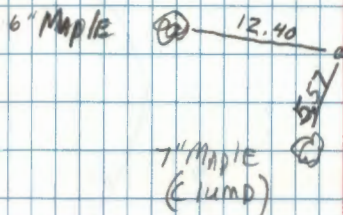

86-04-45

91-05-15

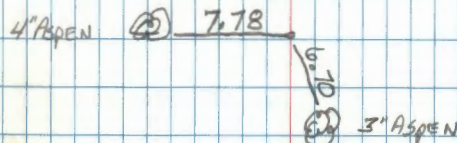

91-03-26

Vermillion Lake Project

E M HD

ES 2 359-55-02 179-54-56 359-54-56 179-54-54

BS 4/9 00-00-30 180 00 15 00-00-20 180 00 11

T 1 359-54-32 359-54-41 359-54-36 359-54-43

359-54-38

TH3NR25W

Z1 @ Z2

Z8 Z7

1983

Traverse Sketch

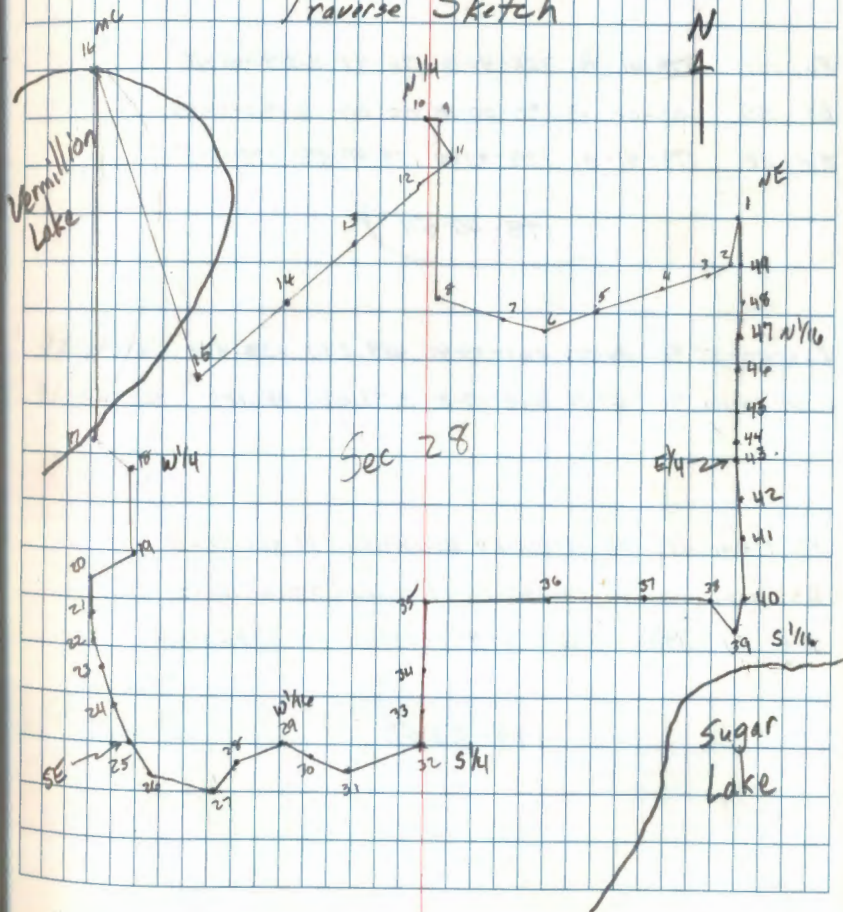

Vermillion Lake Project

FT Meters HD

FS 100 181-51-13 01-51-12 181-51-16 01-51-17

BS 34 00-00-30 180-00-39 00-00-40 180 00 40

TE 35 181-50-43 181-50-33 181-50-36 181-50-37

181-50-37

FS 101 178-41-16 358-41-18 178-41-16 358-41-16

BS 35 00-00-15 180-00-18 00-00-18 180-00-19

TE 100 178-41-01 178-41-00 178-40-58 178-40-57

178-40-59

DIST 100-35 92-24-00 267-35-55 454.230 138.447

DIST 100-101 91-52-14 268-07-35 1673.630 590.122

FS 9 ~~102~~ 179-54-19 359-54-22 179-54-21 359-54-19

BS 100 00-00-23 180-00-19 00-00-25 180-00-21

TE 101 179-53-56 179-54-03 179-53-56 179-53-58

179-53-58

Mean VA

3/8/89

Traverse to Tie between the
N's lines of Sec. 28. Traverse is
down Co. Rd. 137

92-24-08

91-52-20

Vermillion Lake Project

N ^{1/4}					
FS 10	89-22-10	769-22-02	89-22-12	218-22-03	
BS 10R	00-00-25	180 00 17	00-09-16	180 00 16	
TR 9	89-21-45	89-21-45	89-21-56	89-21-47	

89-21-48

Dist 9-10 87-46-12 272-13-21 1856.325 565.805 ✓

3/8/89

87-46-21

3rd GUIDE MERIDIAN

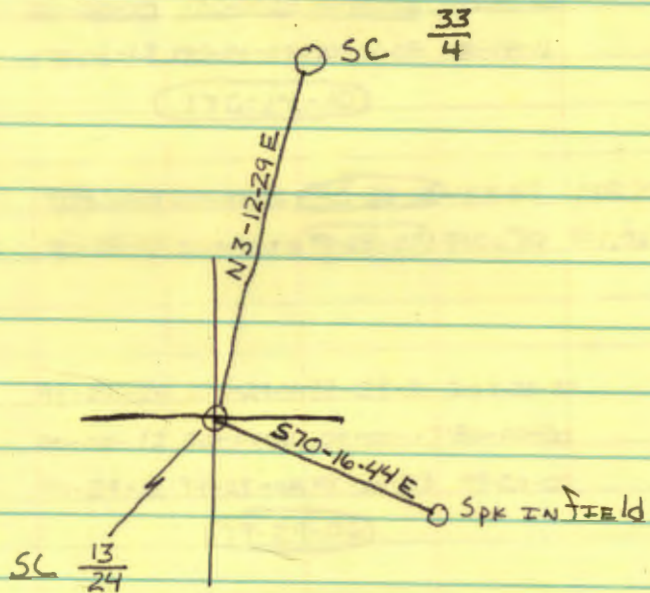

$$\Delta RT = 253^{\circ} - 29' - 13''$$

RANDOM TRANSFER CCLX Sa4
T54 R27 To SC - 13/24 T143 R25

CCLX Sa4
T143 R25

N1=10,000.0000
E1=50,000.0000

N=26,0000 E
HD=453.6763

N2=10,426.3163
E2=50,155.1664

N=10,1410 E
HD=990.6036

N3=11,401.2143
E3=50,331.2127

N=70.1644 W
HD=263.1290

N4=11,490.0051
E4=50,001.5172

HD=1,490.0051

N5=10,000.0000

3rd GUIDE MERIDIAN

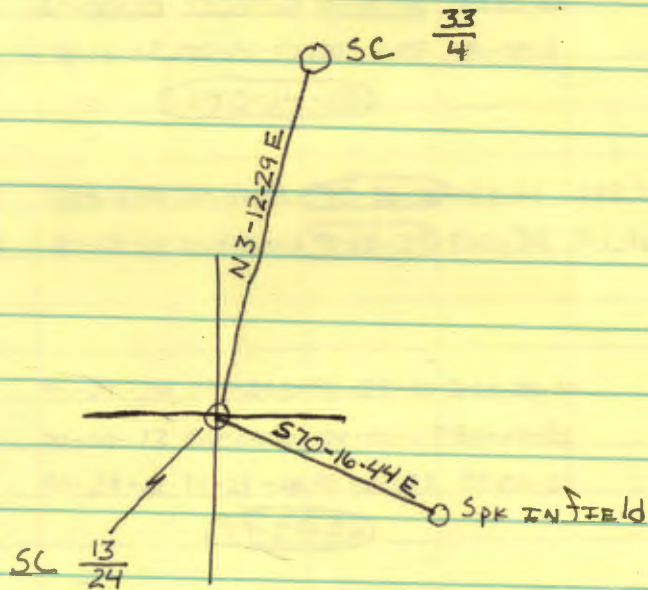

$$\Delta RT = 0^{\circ} 253' 29'' - 13''$$

WILD T2
 RED 1A EDM
 30°

12/11/91

R MAIN

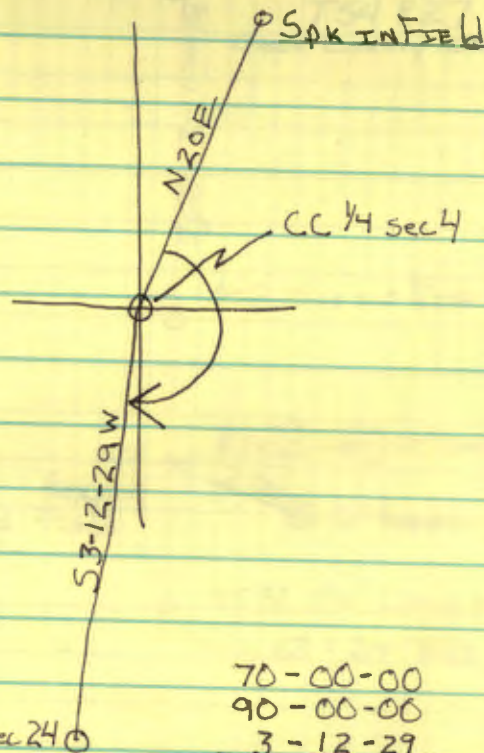

$$\begin{array}{r} 70-00-00 \\ 90-00-00 \\ \hline 3-12-29 \\ \Delta RT 163-12-29 \end{array}$$

3rd GUIDE MERIDIAN

FS 3 170-14-23 350-14-36 170-14-34 350-14-37

BS 1 00-00-10 180-00-29 00-00-16 180-00-26

TC 2 170-14-13 170-14-07 170-14-08 170-14-11

170-14-10VD 2-1 90-26-40 269-33-15 90-26-42 453.69 138.283VA 2-3 90-28-40 269-31-23 90-28-39 490.70 301.967

FS 4 99-29-24 279-29-34 99-29-30 279-29-30

BS 2 00-00-12 180-00-26 00-00-17 180-00-31

TC 3 99-29-12 99-29-08 99-29-03 99-29-00

99-29-06VD 3-4 90-09-25 269-50-25 90-09-30 263.13 80.205WILD T 2
RED I A EDM
30°

12/11/91

R MAIN

S

N

Closing
PT 1 STD CORNER Sec 4
T54 R27
ITASKA COUNTY I.P.

BEARING 1-2 N 20° E

PT 2 SPK IN FIELD

PT 2
(SPKEN)
2nd FIELD
82.73 10" ASPEN
2780 12" ASPENPT 4 STD CORNER SEC
13 E 24 T143 R25



REST OF
BOOK IS
EMPTY