

CORNER RESTORATION

T142N, R27W

KE
FIELD BOOK

82 0012

BOOK 1

CORNER RESTORATION T142N, R27W

DISTANCES FROM SIDE STAKES FOR CROSS-SECTIONING

Roadway of any Width. Side Slopes 1½ to 1.

In the figure below: opposite 7 under "Cut or Fill" and under .3 read 11.0, the distance out from the side stake at left. Also, opposite 11 under "Cut or Fill" and under .1 read 16.7, the distance out from the side stake at right.

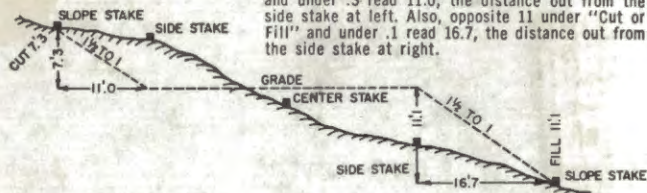

Cut or Fill	Distance out from Side or Shoulder Stake										Cut or Fill
	0	.1	.2	.3	.4	.5	.6	.7	.8	.9	
0	0.0	0.2	0.3	0.5	0.6	0.8	0.9	1.1	1.2	1.4	0
1	1.5	1.7	1.8	2.0	2.1	2.3	2.4	2.6	2.7	2.9	1
2	3.0	3.2	3.3	3.5	3.6	3.8	3.9	4.1	4.2	4.4	2
3	4.5	4.7	4.8	5.0	5.1	5.3	5.4	5.6	5.7	5.9	3
4	6.0	6.2	6.3	6.5	6.6	6.8	6.9	7.1	7.2	7.4	4
5	7.5	7.7	7.8	8.0	8.1	8.3	8.4	8.6	8.7	8.9	5
6	9.0	9.2	9.3	9.5	9.6	9.8	9.9	10.1	10.2	10.4	6
7	10.5	10.7	10.8	11.0	11.1	11.3	11.4	11.6	11.7	11.9	7
8	12.0	12.2	12.3	12.5	12.6	12.8	12.9	13.1	13.2	13.4	8
9	13.5	13.7	13.8	14.0	14.1	14.3	14.4	14.6	14.7	14.9	9
10	15.0	15.2	15.3	15.5	15.6	15.8	15.9	16.1	16.2	16.4	10
11	16.5	16.7	16.8	17.0	17.1	17.3	17.4	17.6	17.7	17.9	11
12	18.0	18.2	18.3	18.5	18.6	18.8	18.9	19.1	19.2	19.4	12
13	19.5	19.7	19.8	20.0	20.1	20.3	20.4	20.6	20.7	20.9	13
14	21.0	21.2	21.3	21.5	21.6	21.8	21.9	22.1	22.2	22.4	14
15	22.5	22.7	22.8	23.0	23.1	23.3	23.4	23.6	23.7	23.9	15
16	24.0	24.2	24.3	24.5	24.6	24.8	24.9	25.1	25.2	25.4	16
17	25.5	25.7	25.8	26.0	26.1	26.3	26.4	26.6	26.7	26.9	17
18	27.0	27.2	27.3	27.5	27.6	27.8	27.9	28.1	28.2	28.4	18
19	28.5	28.7	28.8	29.0	29.1	29.3	29.4	29.6	29.7	29.9	19
20	30.0	30.2	30.3	30.5	30.6	30.8	30.9	31.1	31.2	31.4	20
21	31.5	31.7	31.8	32.0	32.1	32.3	32.4	32.6	32.7	32.9	21
22	33.0	33.2	33.3	33.5	33.6	33.8	33.9	34.1	34.2	34.4	22
23	34.5	34.7	34.8	35.0	35.1	35.3	35.4	35.6	35.7	35.9	23
24	36.0	36.2	36.3	36.5	36.6	36.8	36.9	37.1	37.2	37.4	24
25	37.5	37.7	37.8	38.0	38.1	38.3	38.4	38.6	38.7	38.9	25
26	39.0	39.2	39.3	39.5	39.6	39.8	39.9	40.1	40.2	40.4	26
27	40.5	40.7	40.8	41.0	41.1	41.3	41.4	41.6	41.7	41.9	27
28	42.0	42.2	42.3	42.5	42.6	42.8	42.9	43.1	43.2	43.4	28
29	43.5	43.7	43.8	44.0	44.1	44.3	44.4	44.6	44.7	44.9	29
30	45.0	45.2	45.3	45.5	45.6	45.8	45.9	46.1	46.2	46.4	30
31	46.5	46.7	46.8	47.0	47.1	47.3	47.4	47.6	47.7	47.9	31
32	48.0	48.2	48.3	48.5	48.6	48.8	48.9	49.1	49.2	49.4	32
33	49.5	49.7	49.8	50.0	50.1	50.3	50.4	50.6	50.7	50.9	33
34	51.0	51.2	51.3	51.5	51.6	51.8	51.9	52.1	52.2	52.4	34
35	52.5	52.7	52.8	53.0	53.1	53.3	53.4	53.6	53.7	53.9	35
36	54.0	54.2	54.3	54.5	54.6	54.8	54.9	55.1	55.2	55.4	36
37	55.5	55.7	55.8	56.0	56.1	56.3	56.4	56.6	56.7	56.9	37
38	57.0	57.2	57.3	57.5	57.6	57.8	57.9	58.1	58.2	58.4	38
39	58.5	58.7	58.8	59.0	59.1	59.3	59.4	59.6	59.7	59.9	39
40	60.0	60.2	60.3	60.5	60.6	60.8	60.9	61.1	61.2	61.4	40

T142NR27W BOOK 1 Pg

Indet

6004 Lot 4 Sec 27

Area Survey

47

USFS

CASS

COUNTY, MN



The paper in this book is made of 50% high grade rag stock with a WATER RESISTING surface sizing.

X-25 1/4 CORNER TO SECTIONS 31/36
FROM G.L.O. RESURVEY NOTES OF 1919
AT 42.52 SET IRON POST 3' X 1" DIA.
FOR 1/4 CORNER WITH D.C. MARKED

1/4
S36 S31

1919

FROM WHICH ORIGINAL B.T. BEARS:
20" R. PINE, N38°E, 261KS (17.16')

10" TAM., S32 3/4°E, 261KS (17.16')

NEW B.T. BEARS:

10" R. PINE, N46 3/4°E, 881KS (58.02)

NOW 10" X 12" HIGH N. PINE STUMP N47E 58.1' SCRIBE (T)

6" BIRCH, N63 1/2 W, 1351KS (89.10')

CENTER OF BIRCH CLUMP N63 W 89.10' 12" X 14" STANDING

5680-2 by Cjr 3-2-61 CUT 1 OFF

BOOK B-SURVEY RECORD #371 PAGES 602 + 603 (PLAT)

7/27/1917 E.B. HORST CASS COUNTY SURVEYOR

SET 2 1/2" X 48" IRON PIPE FROM ORIG. B.T.'S

NOTE: COUNTY IRON MUST HAVE BEEN GONE WHEN GLO

WAS THERE IN 1919 AS THEY DIDN'T FIND

POST OR IRON - RESTORED FROM ORIG. B.T.'S

7/15/97 RMYCK

SEARCH WITH LOCATOR - NO IRONS COULD BE
FOUND - BOTH ORIG. B.T.'S WOULD NOW FALL IN
DITCH ON EAST SIDE OF COUNTY RD # 128
FROM EVIDENCE OF BOTH GLO B.T.'S.

SET 3/4" X 18" ROD MONUMENT WITH CAP MKD.
FLUSH WITH GROUND

6 ROCKS AROUND CAP

MAGNETIC PELLET AT BASE OF ROD
W.OAK 4" N49°W 71.58

T142N
R28W R27W

1/4

S36 S31

1997

USFS

FT TOSPK NOT MKD

R PINE 19" S70°W 936.92 FT TOSPK MKD 1/4 S36 BT

X ROCK 4' X 2' N75°E 236.20

OLD FSLP 1961 ATTACHED
W OAK 10 1/2" 573°W 412.05 FT TOSPK NOT MKD

MONUMENT IS 14'± EAST OF CENTER LINE OF
COUNTY ROAD 128 - 2' EAST OF GRADED EDGE
IN SHOULDER GRASS

DROVE 8' STEEL SIGN POST IN GLO N. PINE STUMP
N47E - 58.1' W/SIGN

POINT OF ROD IS ON SOLID ROCK IN BOTTOM OF HOLE
SO YOU CAN'T DRIVE MONUMENT DEEPER
MAG. PELLET IS 18" DEEP CLOSE TO POINT
PACKED HOLE WITH CLAY + ROCK

EAST 1/16 BET. SEC'S, 8-17

NOTES OF GLO RESURVEY 1919

SET IRON POST 1" DIA X 36" LONG

WITH BRASS CAP MKD.

FD. IRON CAP 8" ABOVE GRD.	E 1/16	<u>58</u>
IN GOOD CONDITION	8-8-79 CRK	517
		1919

FROM WHICH

W. OAK 14 S53E 169 LKS. = 111.5'

W. PINE 14 N19W 203 LKS. = 134.0'

NOTE: THIS BT IS R. PINE

4/28/93 R. MAEN C. KRAUSE

FD GLO MONUMENT IN PLACE UP 8"

WITNESSED WITH.

GLO R. PINE	24"	N19W	134 FT	NO NAIL BLAZE OVER BARK TOP OF TREE BUSTED OFF
GLO W. OAK	23"	S53E	111.5 FT	NO NAIL BLAZE OVER GROWN

W. OAK	9"	N32°W	16.88 FT	TO SPK MKD E 1/6 S 8 BT
--------	----	-------	----------	-------------------------

W. OAK	8"	N5°E	22.52 FT	TO SPK MKD E 1/6 S 8 BT
--------	----	------	----------	-------------------------

W. OAK	7"	S43°E	15.00 FT	TO SPK MKD E 1/6 S 17 BT
--------	----	-------	----------	--------------------------

8 FT STEEL SEGN POST SOUTH 4.0 EAST 3.05
 NEW BTs double blazed PAINTED RED/W/TAGS
 A9-7150-4

NORTHEAST 1/16 OF SEC'S, 17

K-8

NOTES OF GLO RESURVEY 1919

SET IRON POST 1" DIA X 36" LONG
WITH BRASS CAP MKD.

Fd. IRON AND CAP IN PLACE

TOP 10" BENT SHARPLY TO SOUTHE 1/16 S17

REPLACED GLO MONUMENT 1919

FROM WHICH

W. PINE 10 S40E 160 LKS. 105.6'

NOW 24 W. PINE S40E 105.6' SCAR SCRIBE CLOSED

POPLAR 4 N11E 83 LKS. 54.8'

DISTANCE AND BEARING FALLS IN ROAD DITCH

TO PERPETUATE THIS CORNER SET 2" DIA X 24"

LONG GALV. STEEL PIPE - WITH CONCRETE INSIDE

AND CAPPED WITH 3" DIA. BRASS TABLET MARKED.

MONUMENT IS 12" BELOW T142N R27W

ROAD

NE 1/16 S17
1979

WITNESSED BY

RLS NO 12261

W. OAK 5 S88W 58.26' MKD NE 1/16 S17 BT

N. PINE 12 S71E 98.28' MKD NE 1/16 S17 BT

8' STEEL SIGN POST SET DUE EAST BOTH SIGNS

8-23-79 Curtis R. Krause

4-11-02 R. MAIN

CAP HAS BEEN SHEARED OFF PIPE WHICH IS
NOW @ ROAD SURFACE. POUND IRON BACK DOWN
8" BELOW GROUND. BITS STILL IN GOOD SHAPE

CENTER EAST 1/16 OF SEC. 17

L-8

NOTES OF GLO RESURVEY 1919

SET IRON POST 1" DIA. X 36" LONG

WITH BRASS CAP MKD.

FD, IRON AND CAP IN PLACE

IN GOOD CONDITION 6" ABOVE

C E 1/16 C
1919

GROUND

FROM WHICH

SPRUCE 6 N 68 1/2 W 320 LKS. 211.2'

FALLS IN GUT OVER SWP. NO EVIDENCE FOUND

N. PINE 6 S 60 1/2 E 444 LKS. 293.0'

NOW 19 N. PINE S 60 E 293.0' SCRIBE OVERGROWN

TO PERPETUATE THIS CORNER MARKED 4 NEW
BEARING TREES

N. PINE 20 S 66 E 37.65' MKD CE 1/16 S 17 BT

N. PINE 17 S 18 E 51.35' MKD CE 1/16 S 17 BT

N. PINE 13 S 38 W 34.98' MKD CE 1/16 S 17 BT

N. PINE 17 N 23 W 59.05' MKD CE 1/16 S 17 BT

8' STEEL POST SET DUE EAST 4.2' w/54-9

8-23-79

Curtis R. Krause

NORTH 1/16 BET. SEC'S. 16-17

K-9

NOTES OF GLO RESURVEY 1919

SET IRON POST 1" DIA X 36" LONG
WITH BRASS CAP MKD.

FD. IRON CAP IN PLACE

N^{1/16}

IN GOOD CONDITION 8" ABOVE GED. S17 | S16

LINE TO STANDARD EAST & WEST

1919

FROM WHICH

BIRCH 4 S80E 33 LKS. = 21.8'

NOW 11" BIRCH S80E 21.8' SCRIBE OVERGROWN

R. OAK 14 S88W 234 LKS. = 154.4'

FD. WELL ROTTED OAK STP. AND LOG AT BR. AND DISTANCE

TO PERPETUATE THIS CORNER - SCRIBED 3 NEW BT'S.

R. OAK 7 N46W 40.18 MKD. N^{1/16} S17 BT

W. OAK 6 N2W 86.16' MKD. N^{1/16} S17 BT

W. OAK 4 S77E 40.57' MKD. BT

8' STEEL SIGN POST SET DUE EAST 2.5' BOTH SIGNS

8-29-79

Orville R. Knauss

K-9,10

S.M. C. IN SEC. 16 ON NORTH 1116 LINE
WEST SHORE OF BOY LAKE
NOTES OF GLO RESURVEY 1919
SET IRON POST 1" DIA. X 36" LONG
WITH BRASS CAP MKD.

FD. IRON CAP 12" ABOVE GRD.

IN GOOD CONDITION - ON SIDE

N 516
516 | N SMC

SLOPE 20'± WEST OF LAKE SHORE 8-13-79 CK
1919

FROM WHICH

W. OAK 36 S60½W 12 LKS. = 7.9'

NOW 41" W. OAK S60W 7.9' SCRIBE OVERGROWN HAS SCAR
FACING IRON

W. OAK 28 N18½W 167 LKS. 110.2'

FOUND WELL ROTTED OAK STP. AT BRG DIST.

TO PERPETUATE THIS CORNER - SCRIBED 2 NEW BT'S.

W. OAK 5 S21W 106.05' MKD. SMC S16 BT

ASH 8 S50W 94.30' MKD. SMC S16 BT

NE COR.
CONG. POST 10 NORTH 46.90 FACE OF POSTSE COR.
CONG. POST 10 N73W 26.45 FACE OF POST

8' STEEL SIGN POST SET 2.4' WEST OF IRON BOTH SIGNS.

OK
8/10/79
9/1/79

8-13-79 Curtis R. Krause

8-13-79 Jeff C Reimer

R9-7150-4

6

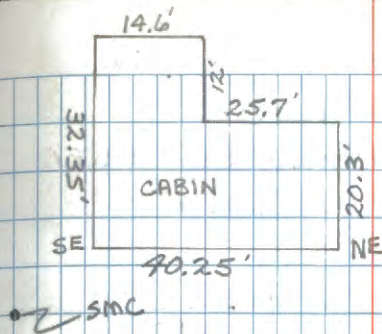

SECTION CORNER TO SEC'S. 8-9-16-17

NOTES OF GLO RESURVEY 1919

FOUND WOODEN STAKE FROM ORIG. SURVEY

SET IRON POST 2" DIA. X 36" LONG

WITH BRASS CAP MKD.

T142NR27W

58	59
517	516

FROM WHICH

1919

NO B.T'S, SUITABLE

RAISE MOUND OF STONE 2' X 2' X 1 1/2' HIGH

WEST OF CORNER

4/3/35 874-9 R. PIERRIZIE

FOUND IRON POST. PLACED LOCATION POSTER ON

SE SIDE OF 3" ASPEN FROM WHICH CORNER BEARS

S40°E .24 CHAINS

8/12/93 R. MAIN

FD 2" IRON PIPE (GLO) IN PLACE BENT WITH CAP

REMOVED. SET A 2" X 4 FT GALVANIZED STEEL PIPE

WITH 2 1/2 IN BRASS CAP UP 1 FOOT. MAGNET

IS ± 2" BELOW BASE OF MONUMENT. GLO IRON

PIPE IS NEXT TO NEW MONUMENT ON NORTH

SIDE. BRASS CAP MKD° T142NR27W

FD RUSTED TAG ON 12" ASPEN SNAG
N32W 16.4 FT TO E OF TREE

58 | 59

517 | 516

1993

USFS

W. OAK 6" N75E 61.33 FT To Spk MKD° S9 BT

W. OAK 7" S61°E 82.74 FT To Spk MKD° S16 BT

W. OAK 5" S86°W 65.12 FT To Spk MKD° S17 BT

W. OAK 8" N38W 22.15 FT To Spk MKD° S8 BT

8 FT STEEL SIGN POST ~~NORTH 2.65 FT~~ WEST 3.9 FT

M.C. BET. SEC'S. 9-16

NOTES OF GLO RESURVEY 1919

FOUND DECAYED CEDAR STAKE FROM ORIG. SUR.

AND CEDAR STUMPS WITH 'BT' SCRIBE

SET IRON POST 1" DIA. X 36" LONG

WITH BRASS CAP MKD.

T142N
S9 / MC
S16
R27W
1920

FROM WHICH

CEDAR 12 S56W 221 LKS. 145.9'

CEDAR 12 N79W 186 LKS. 122.8'

Fd. no evidence on 4/7/95, Grd. froze.

4/7/95 BRAMA

Fd. GLO iron pipe under frozen swamp.

Didn't dig out at this time.

Fd. F.S.L.P. by Tom Shackman dated

1/17/92. Tag is on a 12" Ash S81W

111' from M.C.

4/10/95 Brama, Schoonover, Geiger

Dug out monument and broke GLO iron pipe trying to straighten it.

Set a new 2 1/2" x 48" galv. iron pipe with brass cap mkd. Set GLO irons (2 pieces) along U.S.F.S. monument.

S89°56'E bet 9 & Sec. 16 17.00 chains

1122'

4/10/95 - set steel sign posts for reference objects

8' steel sign post N40W 12.4 Sign att.

8' steel sign post S30W 11.1 " "

8' steel sign post West 5.7 " "

8' steel sign post on east side of U.S.F.S. monument with sign att.

Brass Cap mkd. T142N R27W

S9 / MC
S16

1995

USFS

QUARTER CORNER BET. SEC'S. 16-17

NOTES OF GLO RESURVEY 1919

REMAINS OF OAK STAKE FROM ORIG. SURVEY

SET IRON POST 1" DIA. X 36" LONG

WITH BRASS CAP MKD.

$\frac{1}{4}$

S17 | S16

1919

FROM WHICH

POPLAR 4 S53E 34 LKS. = 22.4'

R. OAK 8 S28W 95 LKS. = 62.7'

4/29/93 R. MAJIN C. KRAUSE

CHAINED EAST FROM CE 1/16 FOUND NO EVIDENCE OF
MONUMENT OR BEARING TREES. IRON PEPE FALLS IN
ROAD.

633.6' WEST OF SMC

1293.6' EAST OF CE 1/16

L-9, 10

SM.C. IN SECTION 16 ON E-W CENTER LINE
ON WEST SHORE OF BOY LAKE BRS NE-SW

~~THE~~ NOTES OF GLO RESURVEY 1919

SET IRON POST 1" DIA. X 36" LONG
WITH BRASS CAP MKD.

Fd. IRON ¹/₂ CAP LEANING IN SWP. GRASS
IN GOOD CONDITION - IRON NOW $C \frac{5}{16} / C$ SMC

STANDS 12" ABOVE SWP. - WIRED TO ⁸/₁₉₂₀

FROM WHICH STEEL POST - ROCKS PILED AROUND

PINE 24 S29W 136 LKS. = 89.8'

NOW LARGE W. PINE STP. ROTTEN S29W 89.8' LOG ON SWAMP

W. OAK 6 N65¹/₂W 83 LKS. = 54.8'

NOW 16" W. OAK N65W 54.8' SCRIBE OVERGROWN

RESCRIBED ABOVE OAK WITH MARKS "BT"

TO PERPETUATE THIS CORNER - MARKED 2 NEW

BT'S. AS FOLLOWS

W. PINE 22" N35W 131.0' MKD. SMC S16 BT

ASH 9" S47W 59.7' MKD. SMC S16 BT

SET 8' STEEL SIGN POST DUE WEST 3.8' BOTH SIGNS

R9-7150-4

J-7

QUARTER CORNER BET SEC'S. 8-17

NOTES OF GLO RESURVEY 1919

PROPORTIONAL POSITION

SET IRON POST 1" DIA. X 36 LONG

WITH BRASS CAP MARKED

FD. IRON BROKEN IN TWO PIECES

 $\frac{1}{4} \frac{S8}{S17}$

BURIED IN ROAD - NO CAP FOUND

1919

FOUND BOTH FLANGES 36" BELOW ROAD - IN PLACE

FROM WHICH

N. PINE 5 N10 $\frac{1}{2}$ E 60 LKS. 39.6'

FD. PINE STUMP N10E - 39.6' WITH SCRIBE "8 BT" VISIBLE

N. PINE 6 S W 53 LKS. 35.0'

DISTANCE AND BEARING FALLS IN ROAD DITCH

TO PERPETUATE THIS CORNER SET 2" DIA X 24" LONG
GALVANIZED STEEL PIPE - WITH CONCRETE INSIDE
AND CAPPED WITH 3" DIA. BRASS TABLET MARKED.

IRON IS 12" BELOW ROAD

T142N R27W

BOTH FLANGES AND PIECES OF

 $\frac{1}{4} \frac{S8}{S17}$

GLO IRON AT NORTH EDGE OF IRON

1979

WITNESSED BY

RLS NO. 12261

N. PINE 12 N40W 79.57' MKD 1/4 S8 BT

W. OAK 9 N2E 69.73' MKD 1/4 S8 BT

N. PINE 18 S17W 61.33' MKD 1/4 S17 BT

W. OAK 15 S48W 120.28' MKD 1/4 S17 BT

8' STEEL SIGN POST SET DUE NORTH 28.10' W/54-9

OK
M 8
9) 4/79

8-31-79 Curtis R. Krause

R4 7150-4

11

CORNER IS IN SOUTH TRACK OF WEST-NE
ROAD TO BOY LAKE LANDING

THIS CORNER WAS RESTORED AS IT WILL BE
NEEDED TO REESTABLISH THE W/16 BET
SEC'S. 8-17 WHICH HAS BEEN TAKEN OUT
BY ROAD CONSTRUCTION YEARS AGO

WEST 1/16 BET. SEC'S. 8-17

NOTES OF GLO RESURVEY 1919

SET IRON POST 1" DIA. X 36" LONG

WITH BRASS CAP MARKED

W 1/16 $\frac{SB}{S17}$

FROM WHICH

POPLAR 6 N63E 38 LKS. 25.1'

POPLAR 6 S19W 68 LKS. 44.9'

3/30/93 R. MAIN

Fd NO EVIDENCE OF IRON MONUMENT. Falls
IN ROAD INTERSECTION.

T-5
SECTION CORNER TO SEC'S. 7-8-17-18

NOTES OF GLO RESURVEY 1919

RESTORED FROM WOODEN STAKE AND REMAINS
OF 2 ORIG. BT'S. AS FOLLOWS

PINE STUMP 16 S45W 17 LKS - 11.2' ^{SCRIBE} SHOWING
FD. LARGE PINE STP. S45W 11.2' WITH SCRIBE ^{VISIBLE} 8

MAPLE STUMP 15 N40W 13 LKS. - 8.6' ^{SCRIBE} SHOWING

DISTANCE AND BEARING NOW FALL IN CLEARING

SET IRON POST 2" DIA X 36" LONG

WITH BRASS CAP MARKED T142NR27W

FD. IRON ³ CAP IN PLACE - IN GOOD 57 | 58

CONDITION - 2" ABOVE GROUND 518 | 517

PLACE ROCK RING AROUND CORNER 1919

FROM WHICH 8-22-79 *Clinton R. Klammer*

MAPLE 14 N33¹/₂E 83 LKS. 54.8'

DISTANCE AND BEARING NOW FALL IN CURVE OF ROAD

W. PINE 10 S5¹/₂W 117 LKS. 77.2'

FD. PINE STUB SSW - 77.2' WITH SCRIBE ^{VISIBLE} 42NR27WS

R. OAK 12 N41W 126 LKS. 83.2'

NOW 18" ^{TWIN} SE FORK WITH SCAR N41W 83.2' ^{SCRIBE} OVERGROWN

PUT E SLP ON 6" R. OAK S48W - 3.5' FROM COR.

NORTH WEST 1/16 IN SECTION 17
NOTES OF GLO RESURVEY 1919
SET IRON POST 1" DIA. X 36" LONG
WITH BRASS CAP MARKED

NW 1/16 S 17
1919

FROM WHICH

BALSAM 7 S 52 1/2 E 79 LKS. = 52.1'

W. PINE 8 N 17 E 61 LKS. 40.3'

6/15/93 R. MAIN C. KRAUSE

NO EVIDENCE OF IRON OR B.T.S. FALK EN ROAD

L-6
CENTER WEST 1/16 IN SECTION 17
NOTES OF GLO RESURVEY 1919
SET IRON POST 1" DIA. X 36" LONG
WITH BRASS CAP MARKED

C $\frac{W 1/16}{S 17}$ C

1919

FROM WHICH

W. PINE 10 S87W 162 LKS. = 106.9'

POPLAR 6 S33E 22 LKS. = 14.5'

6/15/93 R. MAIN C. KRAUSE

CHAINED NORTH FROM SW 1/16 fd NO EVIDENCE
OF GLO MONUMENT. POSSIBLE PINE STUMPS

~~Ed SURVEY PLAT B. 1/16 SECTION 1974~~
~~BIG BOY ACRES PLAT NAME~~
~~SET 1" X 36" LONG IRON PIPE SET 1/16~~

M65 SOUTHWEST 1/16 IN SECTION 17

NOTES OF GLO RESURVEY 1919

SET IRON POST 1" DIA. X 36" LONG
WITH BRASS CAP MARKED

SW 1/16 S17

1919

FROM WHICH

R. OAK 10 S80E 55 LKS. 36.3'
NO REMAINS

POPLAR 16 N21½W 16 LKS. 10.6'
NO REMAINS

16

6/15/93 R MAIN C. KRAUSE

Fd 1.2 FT X 1" IRON PIPE SET BY SPAIN AGENT
BUT IN PLACE NEAR ROAD SURFACE. ALSO FOUND
TWO PIECES OF GLO IRON PIPE IN AREA.
SPAINS IRON RESET 0.9 FT BELOW ROAD SURFACE
SPAINS IRON WITNESSED WITH ♂

R. OAK 11" N42°E 72.55 FT TO SPK MKD: SW 1/16 S17 BT

ASH 4" S82°E 59.10 FT TO SPK MKD: BT

MAPLE 6" N68°E 39.03 FT TO SPK MKD: BT

8' STEEL SIGN POST E 17.25'

L-7

CENTER QUARTER OF SECTION 17

NOTES OF GLO RESURVEY 1919

SET IRON POST 1" DIA. X 36" LONG

WITH BRASS CAP MARKED

C 1/4 S 17

1919

FROM WHICH

POPLAR 6 S 56 E 47 LKS. 31.0'

POPLAR 6 N 52 W 31 LKS. 20.5'

2/2/94 RMAEN

R. PINE 20" S 48 W 80.28

R. PINE 19" N 80 E 61.55

W OAK 10" N 20 W 76.10

8 FT STEEL SIGN POST 3.75 SOUTH

M-N

CENTER SOUTH 11/6 IN SECTION 17

NOTES OF GLO RESURVEY 1919

SET IRON POST 1" DIA. X 3/6" LONG

WITH BRASS CAP MARKED

C
S 1/16 | S 1/7
C

FROM WHICH

1919

POPLAR 8 N 19 W 62 LKS. 40.9'

POPLAR 4 S 78 1/2 E 62 LKS. 40.9'

2/2/94 R. MAIN

W. OAK 15" S 52 E 61.68

MAPLE 8" S 21 E 13.72

MAPLE 7 1/2" N 77 W 37.92

40.1 FT NORTH

N-6
WEST 1/16 BET. SECTION 17-20
NOTES OF GLO RESURVEY 1919
SET IRON POST 1" DIA. X 36" LONG
WITH BRASS CAP MARKED

W^{1/16} S17
S20
1919

FROM WHICH

W. OAK 12 S76^{1/2}W 15 LKS. 9.9'

FALLS IN ROAD

MAPLE 10 N8W 43 LKS. 28.4'

FALLS IN ROAD DITCH AT BRG + DISTANCE

MARKED NEW BT'S.

W. OAK 8" N52°E 57.48 FT To Spk MKD: W^{1/16}S17BT

R. OAK 10" N78°E 56.07 FT To Spk MKD: W^{1/16}S17BT

R. OAK 12" S46°E 57.73 FT To Spk MKD: W^{1/16}S20BT

8' STEEL SIGN POST DUE EAST 18.7 FT

BIG BOY ACRES PLAT BY Wm. SPAIN 1974
SET 1" X 21" LONG IRON PIPE AT W^{1/16} CORNER

6/2/93 RM-CK

Fd. BENT PIPE AT SURFACE OF COUNTY ROAD 172
NEED TO MONUMENT AND MARK NEW TIES

FD 1" IRON PIPE 33.13' WEST OF W^{1/16} COR.

CHAINED EAST TO S^{1/4} SEC 17 DISTANCE WAS WITHIN 1.0'

6/10/93 CK

TIED OFF 1" BENT PIPE AND REMOVE TO STRAIGHTEN

USE LOCATER AND GOT DRAW TO EAST OF IRON PIPE

DUG DOWN 24" AND LOCATED GLO IRON WITH CAP

LYING FLAT IN BLACK SOIL - WHICH IS UNDER ROAD

FILL - IRON WAS BENT WITH FLANGES GOING BACK

UNDER IRON SET BY Wm. SPAIN - DUG HOLE FOR

GLO IRON AND SET BY TIES USED FOR SPAIN IRON

STRAIGHTEN IRON (GLO) AND SET IN PLACE OF SPAIN'S

IRON TO MONUMENT W^{1/16} CORNER

BRASS CAP IS 12" BELOW ROAD SURFACE

0-6
NORTH WEST 1/16 IN SECTION 20

NOTES OF GHD RESURVEY 1919

SET IRON POST 1" DIA. X 36" LONG

WITH BRASS CAP MARKED

IRON & CAP HAVE BEEN REMOVED

BY ROAD CONSTRUCTION

NW 1/16 S20

1919

FROM WHICH

R. OAK 8 S1E 54 LKS. 35.6'

FALLS IN ROAD CLEARING

POPLAR 6 N10W 43 LKS. 28.4'

FALLS IN ROAD CLEARING

7/16/84 CK JA GB - searched for corner - Fed Nothing

Traversed from MC to CN 1/16 - set NW 1/16 on

line and proportional distance - see traverse

7/24/84 CK JA GB

SET 1" X 24" IRON PIPE FOR TEMP. CORNER

MAPLE 11 S69W 58.80' SPIKE & TAG

W. PINE 25 S35E 67.20' SPIKE & TAG

4X4X6 CEDAR POST EAST 19.95' WITH BOTH SIGNS

1 1/2" X 18" ^{1" BELOW GRASS} IRON PIPE AT ROW WEST 33.63'

CORNER IS IN EAST SHOULDER ON N+S CO. ROAD

5-24-2010 R. MAIN

GPS IRON, ACCESSORIES ARE IN GOOD SHAPE

0-7
CENTER NORTH 1116 IN SECTION 20

NOTES OF GLO RESURVEY 1919

SET IRON POST 1" DIA. X 36" LONG
WITH BRASS CAP MARKED

Ed. IRON AND CAP - IN PLACE 7/16/84
14" ABOVE GROUND

0-7
C
N 1116 S 20
C

FROM WHICH 1919

R. OAK 12 N 6 E 27 LKS. 17.8'

Found well rotted Oak stump at bearing + dist.

R. OAK 14 S 80 W 31 LKS. 20.5'

Found no remaining evidence

7/24/84 CK JA GR

SET:

W. Oak 7" S 38 W 31.15' } Blanked & Scribed
NOW 10" } Tag, SAKS

Maple 8" N 11 W 53.20' } Red rings
NOW 9" }

W Oak 12" S 46 E 85.06'
NOW 14"

Steel signpost 3" x 8' East 3.75' } A.H. 9/1/84

Steel signpost 3" x 8' West 3.60'

A9-7150-4

5-24-2010 R MAIN

Ed IRON IN PLACE AND GPS CORNER IS N 45 E

± 90 FT FROM FR AND PUT Rd. ALSO.

± 60 FT FROM POWER LINE CLEARING EDGE.

SEC 20

0-8

S.M.C. ON NORTH 1/16 LINE SHORE OF

BOY LAKE - BRS. NE-SW

NOTES OF GLO RESURVEY 1919

SET IRON POST 1" DIA. X 36" LONG

WITH BRASS CAP MARKED

FD IRON AND CAP IN PLACE

18" HIGH - RESET MONUMENT TO $N \frac{S20}{S20} / N$ SMC

8" HIGH AND PLACE ROCK RING

AROUND MONUMENT LEVEL WITH GROUND

1919

FROM WHICH

MAPLE 10 N74W 78 LKS. 51.5' NOW STANDS
DEAD 2010

NOW 23" MAPLE N74W 51.5' - SCAR-SCRIBE CLOSED

W. OAK 36 WEST 113 LKS. 74.6'

NO EVIDENCE REMAINS AT BRG. AND DISTANCE

TO PERPETUATE THIS CORNER MARKED

3 NEW BEARING TREES

W. OAK 12 N4E 102.43' MKD SMC S20 BT

W. OAK 7 N21W 96.44' MKD SMC S20 BT

ASH 10 N57W 107.38' MKD SMC S20 BT

8-30-79 Curtis R. Kiser

A9-7150-4

22

CORNER IS NOW AT TOP OF SLIGHT RIDGE
1' ABOVE WATER LEVEL - APPROX. 15'
EAST TO WATER'S EDGE - GRASSY BOG
CORNER IS NE APPROX. 100' OF PRIVATE
HOME - PERSONAL PROPERTY OF LOCAL
OWNER IS STORED ON F.S. LAND - BUT NO
PERMANENT BUILDINGS.

5-24-2010 R. MAIN 1

FD IRON IN PLACE AND GPS. GRASS IS
MOWED AROUND CORNER

N-7

QUARTER CORNER BETWEEN SEC'S. 17-20

NOTES OF GLO RESURVEY 1919

PROPORTIONAL POSITION

SET IRON POST 1" DIA. X 36" LONG

WITH BRASS CAP MARKED

$\frac{1}{4}$ $\frac{S17}{S20}$

1919

FROM WHICH

W. OAK 12 S14 $\frac{1}{2}$ E 61 LKS. 40.3'
STANDING DEAD

W. OAK 10 N69W 92 LKS. 60.7'
NO EVIDENCE REMAINS

5/18/93 R. MAEIN C. KRAUSE

FD GLO IRON PIPE IN PLACE AND WITNESSED BY:
MONUMENT 6" ABOVE GROUND

R OAK 10 N57°E 54.05 FT TO SPK MKD: $\frac{1}{4}$ S17BT

W OAK 8 S12°E 56.38 FT TO SPK MKD: $\frac{1}{4}$ S20BT

W OAK 5 N82W 84.87 FT TO SPK MKD: $\frac{1}{4}$ S17BT

G-5
 QUARTER CORNER BET SEC'S. 7-8
 NOTES OF GLO RESURVEY 1919
 RESTORED FROM ORIG. OAK POST
 SET IRON POST 1" DIA. X 36" LONG
 WITH BRASS CAP MARKED

$\frac{1}{4}$
 57 | 58
 1919

FROM WHICH

SPRUCE 6 S87E 55 LKS. 36.3'

SPRUCE 6 S67 $\frac{1}{2}$ W 59 LKS. 38.9'

8/28/93 R. MAJN C. KRAUSE

NO EVIDENCE OF MONUMENT FOUND.
 Fd STUMP TO UEST WITH SPE AND LATH
 NEAR BY, STUMP IS POSSIBLE BUT UNSURE.

25 F-5

NORTH $\frac{1}{16}$ CORNER BETWEEN SEC'S. 7+8

1920 GLO RESURVEY Pg 81

SET AN IRON POST 3 FT X 1 IN LH 26 INCHES
IN THE GROUND WITH BRASS CAP MKD: N $\frac{1}{16}$

57/58
1920

WITNESSED WITH

SPRUE 6" S54 $\frac{3}{4}$ E 48 LBS 31.68 FT MKD: N $\frac{1}{16}$ S8 BT

SPRUE 8" N84 $\frac{1}{4}$ W 89 LBS 58.74 FT MKD: N $\frac{1}{16}$ S7 BT

6-21-93 R. MAIN CKRAUSE

NO EVIDENCE OF MONUMENT OR BEARING TIES

Fd

26 E-5

CORNER TO SECTIONS 5-6-7-8

NOTES OF ORIG. GOV'T. SURVEY 1873

1920 GLO RESURVEY NOTES Pg 81

SET AN IRON POST 3 FT X 2" 26 INCHES IN THE

GROUND WITH BRASS CAP MKD: T142N R27

FD OAK STAKE ACCEPT AS ONLY

EVIDENCE OF ORIGINAL COR.

NO EVIDENCE OF ORIGINAL BT'S

WITNESSED BY

MAPLE 16 N16 $\frac{1}{4}$ E 150/ks 99.00ft

E1m 16 S49 $\frac{1}{4}$ W 335/ks 221.10ft

E1m 10 N35 $\frac{1}{4}$ W 212/ks 139.92ft

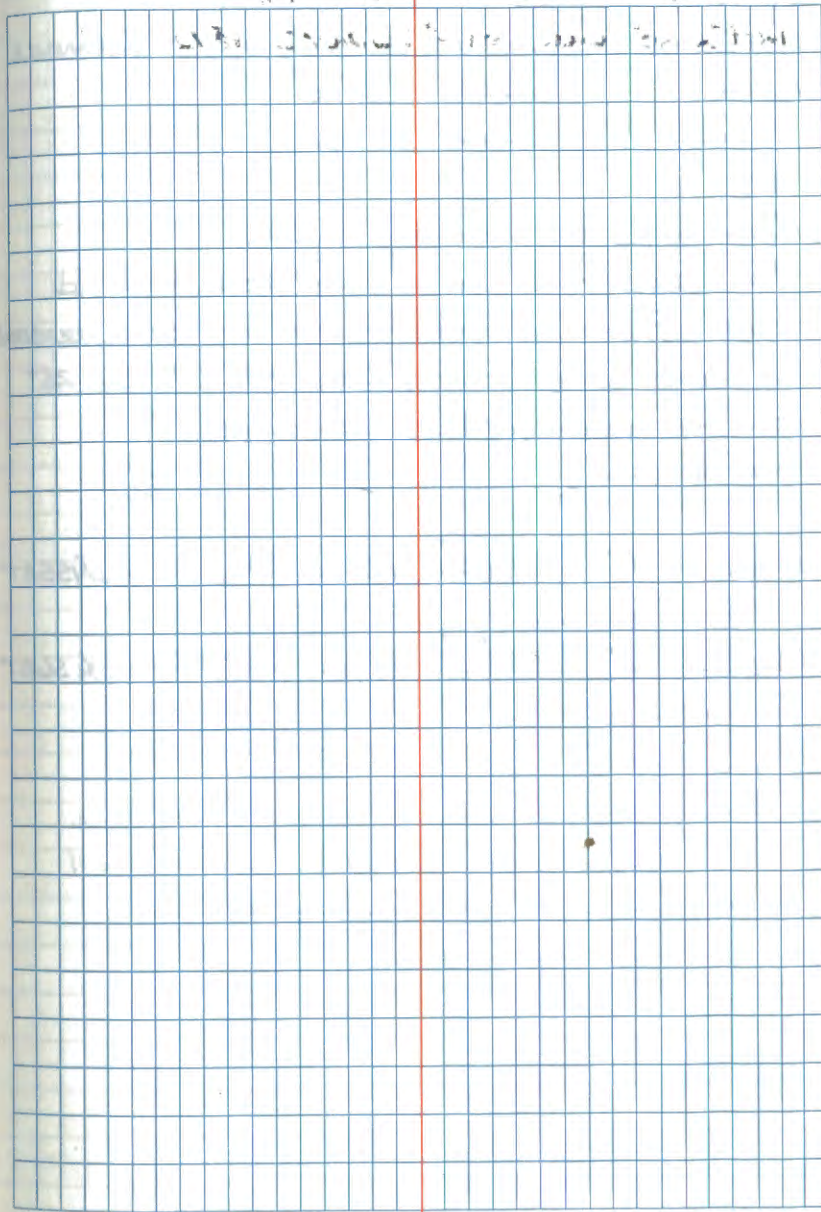

27 C-5

QUARTER CORNER BETWEEN SEC'S. 5+6

NOTES OF ORIG. GOV'T. SURVEY 1873 P.H. CONGER

POPULAR 7 N80W 30/ks

BIRCH 9 S4W 25/ks

1920

NOTES OF GLO RESURVEY Pg 102

Fd CEDAR STAKE SET AT END OF ROAD. WAS TOLD

THAT BOTH TREES WERE THERE BUT WERE REMOVED

BY ROAD CONSTRUCTION. SET 3 7/8" x 1" I.P. 26"

IN THE GROUND/N/ BRASS CAP STAMPED 1/4

WITNESSED BY:

56/55
1920

MAPLE 10" N34⁰15'E 128/ks 84.48 FT MED/455BT

Fd. no evidence.

MAPLE 12" S88⁰15'W 39/ks 25.74 FT MED/456BT

powerline clearing

4/13/95 BRAMA

String chained from A.P. 4 along old fence

line GLO distance of 647.5. Distance fell

in the ^{west} center of N-S graveled road.

Fd. no evidence of iron.

28 QUARTER CORNER BETWEEN SEC'S. 5+8

NOTES OF ORIG. GOV'T. SURVEY 1873

Nov 1873 P.H. CONGER

SET CEDAR POST 4" WITNESSED BY
CEDAR 15° N15W 191KS 12.54FT

1920 GLO RESURVEY NOTES Pg 83

Fd CORNER MARKED BY CEDAR STAKE.

SET AN IRON POST 3FT X 1" 26 INCHES IN THE
GROUND WITH BRASS CAP MKD: $\frac{55}{58}$

WITNESSED BY.

CRIP CEDAR STP 20" N15°W 191KS 12.54FT MKD BT
NO EVIDENCE REMAINING

CEDAR 8" S33¼E 581KS 38.28FT 458 BT

CEDAR 7" N58½W 1041KS 68.64FT 455 BT

3/16/93 R. MAJIN

FOUND GLO MONUMENT LEANING AND FROZEN IN
THE GROUND. WILL NEED TO RETURN TO STRAIGHTEN
AND WITNESS. WITNESSED 4/26/93 MONUMENT NOW UP 2"

CEDAR 7" S 77°E 16.85FT TOSP MKD 458 BT

CEDAR 8" S55°W 8.58FT TOSP MKD 458 BT

CEDAR 4" N19°W 41.50 TOSP MKD BT
BTS DOUBLE BLAZED PAINTED RED/W/TAGS.

29 E-6

WEST $\frac{1}{16}$ CORNER BETWEEN SEC'S. 5+8

1920 GLO RESURVEY NOTES Pg 83

SET AN IRON POST 3 FT X 1" 26 INCHES IN THE
GROUND WITH BRASS CAP MKD: W $\frac{1}{16}$ $\frac{55}{58}$
1920

WITNESSED BY:

BIRCH 8 N48 $\frac{3}{4}$ E 116 KS 76.56 FT W $\frac{1}{16}$ 55 BTBIRCH 8 S55°W 183 KS 120.78 FT W $\frac{1}{16}$ 58 BT

3/16/93 R MAIN B. AUSK

FOUND MONUMENT SET AND SURROUNDED BY
ROCK. FOUND TAG ON 8" MAPLE BY R.E. 7-78. FROM
WHICH CORNER BEARS N42W 9' FIELD NORTH AND WEST

WITNESSED BY:

WOAK 12 S26W 22.50 TO SPE MKD: W $\frac{1}{16}$ 58 BT

WOAK 4 S64°E 23.41 TO SPE MKD: X 8T

WOAK 11" N2°W 59.80 TO SPE MKD: W $\frac{1}{16}$ 55 BT

8 FT STEEL SIGN POST WEST 10 FT

LTS NORTH OF CORNER

30 B-5

NORTH $\frac{1}{16}$ CORNER BETWEEN SEL'S. 5+6

1920 GLO RESURVEY Pg 103

SET IRON POST 3FT X 1 INCH 26" IN GROUND

WITH BRASS CAP MKD: N $\frac{1}{16}$

56/55

1920

CEDAR 14" S32E 84/LS 554 FT MON $\frac{1}{16}$ 55 BT

V-11
QUARTER CORNER BET. SEC'S. 28-33

NOTES OF GLO RESURVEY 1919

RESTORED FROM ORIG. WOODEN STAKE

SET IRON POST 1" DIA. X 36" LONG

WITH BRASS CAP MARKED

NO IRON LOCATED CRK-RDO

3-30-77

$\frac{1}{4}$ $\frac{528}{533}$

1919

FROM WHICH

R. OAK 6 S41E 44 LKS. 29.0'

DISTANCE AND BEARING FALLS IN DITCH OF ROAD

J. PINE 12 N33W 60 LKS. 39.6'

Ed. J. PINE 17" N33W 39.6' SCRIBE VISIBLE

12-8-04 R. MAIN McBOUCHONVILLE

Ed J PINE STUMP WITH RED PAINT.

PLACE PK IN ROAD AT BEARING AND DISTANCE

AND PLACE PSLPON 8" W. OAK (TWIN) N8°E

2802 FT0

A9-7150-4

PUT BT TAG ON J. PINE

2-2-05 R. MAIN C. BETTER J. SHONOVER G. BRAMA

SET A PK FOR NEW PROPORTIONED CORNER POSITION
BETWEEN SECTION CORNER $\frac{28}{33}$ $\frac{27}{34}$ AND THE MC $\frac{28}{33}$ AND
MARK TWO NEW BTS. WILL RETURN AFTER THAW
TO SET IRON IN ROAD.

W. OAK 16" N60W 70.38 FT TO SPK MKD: 528 BT

W OAK 6" (TWIN) N41°E 26.43 FT TO SPK MKD: 528 BT

4-22-05 R. MAIN

SET 2" X 2 FT IRON PIPE W/ 3" BRASS CAP

1 FT BELOW ROAD SURFACE COUNTY RD #53

CAP MKD: T142NRZ7W

$\frac{1}{4}$ $\frac{528}{533}$

2005
U.S.F.S.

V-1213

M.C. WEST END OF BRIDGE ON LEFT BANK
OF BOY RIVER

NOTES OF GLO RESURVEY 1919

PROPORTIONAL POSITION

SET IRON POST 1" DIA X 36" LONG

WITH BRASS CAP MARKED

NO IRON LOCATED CRK-R00

T142N

S28

S33

MC

R27W

FROM WHICH

1919

ELM 14 S24W 43 LKS. 28.4'

W. OAK 12 N73W 90 LKS. 59.4'

FD. W. OAK N73W 59.4' SCRIBE OVERGROWN

A9-7150-4

PUT BT TAG ON W. OAK

V-15

QUARTER CORNER TO SECS. 27 & 34

1981 Forest Service Contract to
Gary Stenson, R.L.S.:

Set a cast iron monument at
the last position 5" below road
surface. References:

PK nail in North end CMP, $N50^{\circ}E, 31.20'$

PK nail in South end CMP, $S65^{\circ}E, 23.25'$

Certificate Filed # 260591 at Cass County

CERTIFICATE FILED

V-17

CORNER TO SECTIONS 26-27-34-35

1981 Forest Service Contract to Gary
Stevenson, RLS:

Set a cast iron monument. From which

Nail & Disc in North end 24" CMP, NE 89.21'

Nail & Disc in South end 24" CMP, SE 88.72'

Certificate filed # 260597 at Cass County

CERTIFICATE FILED

V-19

Quarter Corner to sections 26-35

1981 Forest Service Contract to Gary
Steverson, R. 15:

Set a 2" x 60" iron pipe with brass cap.

From which:

18" Balsam, N42°W, 90.87'

w/ Nail & Disc and scribed "BT" in lower blaze.

12" Spruce, S44°W, 44.87', with N&D

and scribed "BT" in lower blaze.

10" Birch, N5°E, 15.45', with N&D

and scribed "BT" in lower blaze.

Certificate filed # 260592 in Cass County.

CERTIFICATE FILED

V-13

CORNER TO SECTIONS 27-28-33-34

1981 Forest Service contract to Gary
Stevenson, R.L.S.:

Set a cast iron monument 10" below
road surface. From which:

CK 8" W. Oak, $549^{\circ}W$, 86.85' w/ N & D inscribed BT

CK 5" W. Oak, $53^{\circ}E$, 62.78' w/ N & D inscribed BT

CUT DOWN 2" R. Oak, $5E$, 60.36' w/ spike in place

SNAE 12" R. Oak, $58^{\circ}E$, 74.38' w/ N & D inscribed BT

12-7-04
Certificate filed # 200594 in Cass County

CERTIFICATE FILED

T-13

QUARTER CORNER TO SECTIONS 27-28

1981 Forest Service contract to Gary
Stevenson, RLS;

Found and left G.L.O. monument. From which:

6" R. Oak, N5°E, 24.10' w/NEID & scribed BT

8" R. Oak, East, 23.15' w/NEID & scribed BT

6" R. Oak, S56°W, 3.41' w/NEID & scribed BT

14" R. Oak, N72°W, 64.0' (GLO BT)

Certificate filed #260596 in Cass County

CERTIFICATE FILED

T-17

QUARTER CORNER SECTIONS 26-27

1981 Forest Service Contract to Gary
Stevenson, RLS:

Set a cast iron monument from which:

0" Maple N 25° E, 16.81' w/n:ID scribed BT

8" Birch S 68° E, 17.62' w/n:ID scribed BT

10" Birch South, 16.33' w/n:ID scribed BT

7" Ash N 35° W 21.56' w/n:ID scribed BT

Certificate filed #260598 in Cass County

CERTIFICATE FILED

R-13

CORNER SECTIONS 21-22-27-28

1981 Forest Service contract to Gary Stearns

ALS:

Found and left G.L.O. resurvey iron pin
which is

6" W. Oak N65°E, 33.52' w/N/D inscribed BT

6" Ash S52°E, 15.57' w/N/D inscribed BT

6" Ash N60°W, 14.37' w/N/D inscribed BT

Certificate filed # 260595 in Cass County

~~NOTES OF G.L.O. RESURVEY 1919~~~~FOUND TO BE MARKED BY WOODEN STAKE~~~~NO EVIDENCE OF THE ORIG. BT'S. - ACCEPT THIS STAKE AS BEING THE~~~~BEST AVAILABLE EVIDENCE OF THE ORIG. COR. FOR THE REASON THAT IT~~~~HAS BEEN RECOGNIZED AS THE TRUE POSITION FOR THE COR. FOR AT~~~~LEAST 16 YEARS. THIS DETERMINED FROM BT'S WHICH WERE MARKED~~~~ABOUT 16 YEARS~~~~SET 2" x 1/2" IRON POST WITH BRASS CAP MARKED~~~~T 142N R 27W~~~~S 20 | S 21~~~~R. OAK 8 N 34 E 82 LKS. (54.12')~~~~R. OAK 8 S 50 E 47 LKS. (31.02')~~~~R. OAK 8 S 31 W 154 LKS. (101.14')~~~~R. OAK 14 N 62 W 180 LKS. (144.0')~~

CERTIFICATE FILED

11/14/87

now a dead 7" Elm

Took the following new tie

8" W. Oak S 61° E 50.77' double blazed S 27° BT

150
102
101.64 572

R-14, 15

MEANDER CORNER WEST SHORE SWIFT
LAKE BTWN SECTIONS 22-27.

1981 Forest Service contract to Gary Stevenson,
R.L.S.:

Set a 2" x 60" iron pipe w/ brass tablet
for reference to meander corner position.

From which:

8" Ash $N60^{\circ}W$, 20.21' w/ N.S.D. scribed BT

5" Maple $N60^{\circ}W$, 40.83' w/ N.S.D. scribed BT

Certificate filed # 260600 in Cass County

CERTIFICATE FILED

R-17

CORNER SECTIONS 22, 23, 26 & 27

1981 Forest Service contract to Gary
Stevenson, RLS:

Set a 2" x 20" iron pipe with brass tablet
from which:

10" Balsam North, 8.04' w/ N & D

5" Balsam S 65° E, 19.65' w/ N & D described BT

10" Balsam S 3° W, 9.85' w/ N & D described BT

12" Balsam West, 9.83' w/ N & D

Certificate filed # 260593 in Cass County

~~R9-1150-4 by L. Wittboett dated 10-4-72~~

~~states that he found a 1" iron pipe 1' above
ground marked \odot . Pipe lies on east
side of road with small marsh on west
side of road. I placed a yellow tag on west
side of 12" Aspen tree marked 514W 15 lbs to
1/4 cor pipe. Pipe is on East edge of ~~R/W~~.~~

CERTIFICATE FILED

R-19

QUARTER CORNER SECTIONS 23-26

1981 Forest Service Contract to Gary Stevenson,
RLS:

Set a cast iron monument from which:

12" W. Pine N15°W, 66.45' w/l N 5' D scribed BT

4" Balsam N77°E, 23.30' w/l N 5' D scribed BT

10" Balsam S34°W, 13.06' w/l N 5' D scribed BT

Corner is $\pm 38'$ East of Q. Co. Rd #53

Certificate filed # 260599 in Cass County

R9-7152-4 by L. W. Hootch dated 10-4-72 states
that he found a 1" iron pipe 1' above ground
mbd. $(N 5' D)$. Pipe lies on East side of road
with a small marsh on west side of road. I
placed a yellow tag on west side of 12"
Aspen tree marked S14°W, 15 lks to pipe.
Pipe is on east edge of road R/W.

8-2-2011 R. MAIN

FD IRON IN PLACE AND GPS. 1981 W PINE
NOW DEAD 20". 1981 BALSAMS ARE BOTH
WINDFALLS. HEAVY STEEL SIGN POST NORTH
1.55 FT TO NEAR FACE OF POST

42

CERTIFICATE FILED

T142N R27W X 11

C 1/4 Corner S. 33

1919 GLO Dependent Resurvey

Set a 1" x 36" Iron pipe with
a brass cap stamped

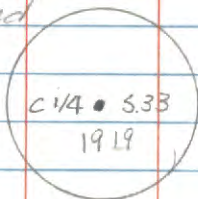

from which:

W. Pine, 24" N44¹/₄°E, 24 lbs. (15.80')

J. Pine, 16" N33¹/₂°W, 243 lbs. (160.38')

Nov. 19, 1984 Recovery by G. Kasenko

B. Ausk

G. Robertson

Recovered a 1" outside diameter
iron pipe with a 2¹/₂" diameter brass
cap stamped as shown, up 0.5 ft

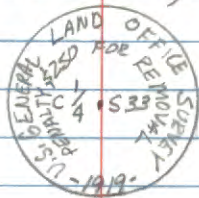

Decl = 5° East

from which:

White Pine (1919), 47" N50°E, 15.74 ft to 16d nail
in NW face, blaze overgrown, w/60d spike

Jack Pine (1919), ⁽¹⁹¹⁹⁾ dead snag, N33°W, 168.93 ft
to 16d nail in NE face, single blaze "C 1/4 S33 BT" visible, 60d spike

Established:

Jack Pine, 14.1" S41°W, 58.93 ft to 16d nail in east
face, double blaze, sci: "C 1/4 S33 BT" w/60d spike

Jack Pine, 10.5" N64°W, 28.35 ft to a 16d nail in
south face, double blaze sci: "C 1/4 S33 BT" w/60d spike

Metal fence post, north, 5.0 ft w/54-2, 50-9

Metal fence post, east, 5.0 ft w/54-2

12-7-04 R. MAIN

GPS IRON: WHITE PINE NOW 50" (WSW)

J PINE SWW NOW AT 20 FT SNAG.

J PINE N64W NOW AT ± 10 FT SNAG.

2-2-05 R. MAIN

MARK ONE NEW BT. LINE TO STANDARD NORTH OF IRON

ROAK 4" N72°E 44.00 FT TO SPR MKD: X BT

T142N R27W X-13
E 1/4 of Section 33

1873 Original Gov't Survey
set post from which:
Tam, 10", S10°W, 9.24'

1919 GLO Dependent Resurvey
Set a 1" x 36" Iron pipe with
a brass cap stamped:

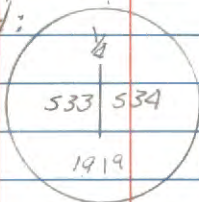

from which:
Find Gov't BT

Tam, 6", S06¼°E, 33.00ft

Cedar, 6", S52½°W, 21.78ft

1941 R. T. Defant find an iron pipe
and two BT's. The 874 is very
hard to read

1980 L. Witthoeft find an iron pipe
from which:
Cedar, 12", S55°W, 21.78ft

1/2/82 B. Ausk find an Iron pipe
bent over from which:
Used one GLO tree

W. Oak, 5", N12°W, 41.9ft

W. Oak, 6", N11°E, 47.5ft

Nov 19, 1989

Corner recovery by G. Kosenko, B. Ausk, G.
Robertson

Recovered a 1" outside diameter iron pipe with
a 2½" diameter brass cap stamped as shown.
up 1.0ft
decl: 5° East

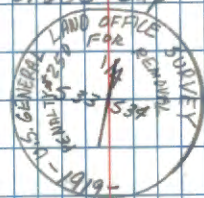

From which:

Oak 6.4", N14°E, 47.61 ft, " 160 nail SE face
" 1/4 533 BT
Cedar, 13.3", S57°W, 21.68 ft, " 160 nail NW face
" scr overgrown
Oak, 5.4", N03°W, 41.99 ft, " 160 nail NE face
" 1/4 533 BT
Metal fence posts, North & West, 4.0 ft, 3.5 ft both with
542, 549

All trees have 60d spikes, paint, and BT tags
Searched for 1919 Tamarack and found a stump
hole at record bearing and distance. Found
no evidence of the OGS tree

T142N R27W X-11/12

SMC on E-W Center quarter line of S 33

1919 GLO Dependent Resurvey set
a 1" x 36" Iron Pipe with
a brass cap stamped:

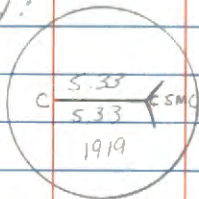

from which:

J. Pine, 14" , $S60^{\circ}W$, 232.00, 153.12'

W. Pine, 24" , $N82^{\circ}W$, 243.00, 160.38'

Nov 19, 1984 Recovery by G. Kosenko

B. Ausk

G. Robertson

R Recovered a 1" outside diameter
iron pipe with a 2 1/2" diameter
brass cap stamped
as shown, up 1.0 ft

Δ cl = 5° East

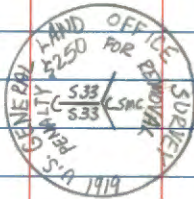

from which:

Jack pine (1919) ^(16.5") SMC, $S60^{\circ}W$ 55.97 ft to a 16d nail
in the NW quad, sec: "S33 SMC BT" visible, w/60d spike
White pine (1919), 47" $N80^{\circ}W$ 171.67, to 16d nail in
north face, blaze overgrown, (same tree as on pg 43)

Established:

Oak, $S76^{\circ}W$, 5.9 in, 97.50 ft to 16d nail in south
face, double blaze sec "S33 SMC BT" w/60d spike

Metal fence post, west, 3.0 ft w/54-2, 54-9

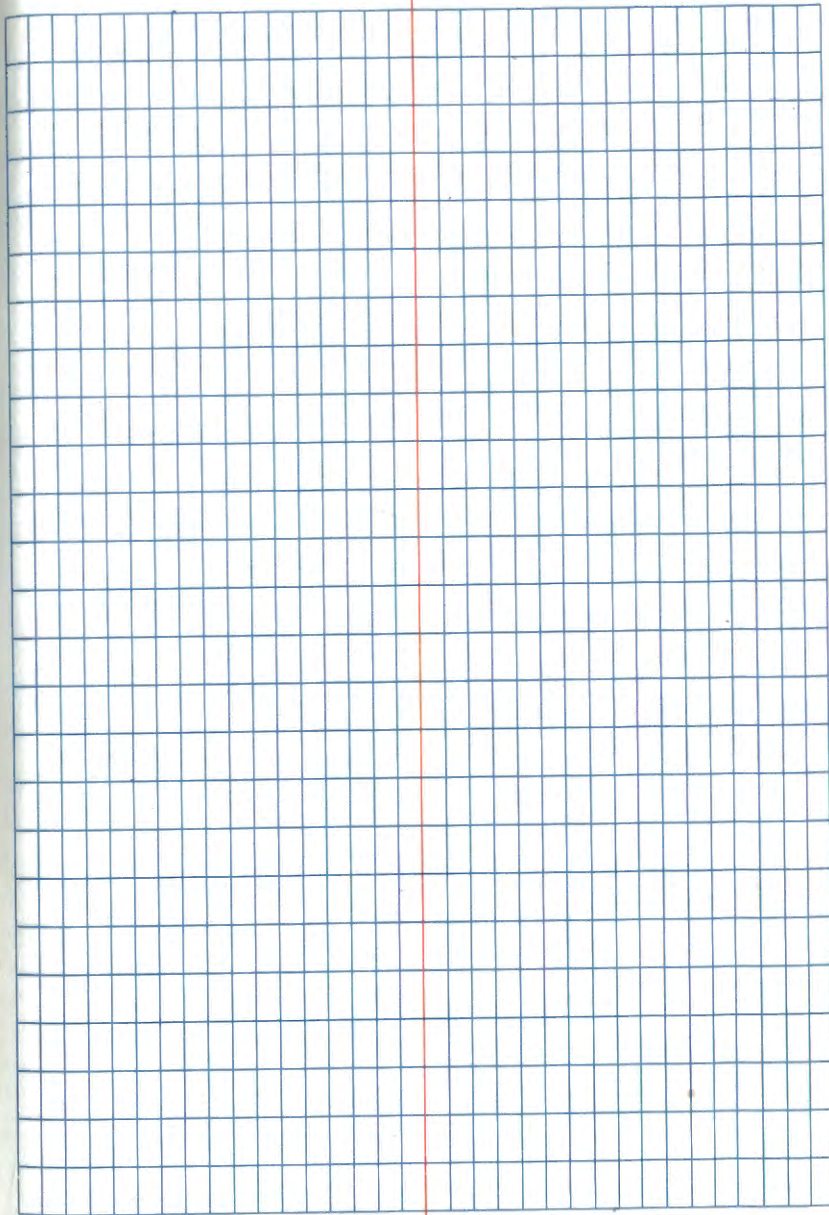
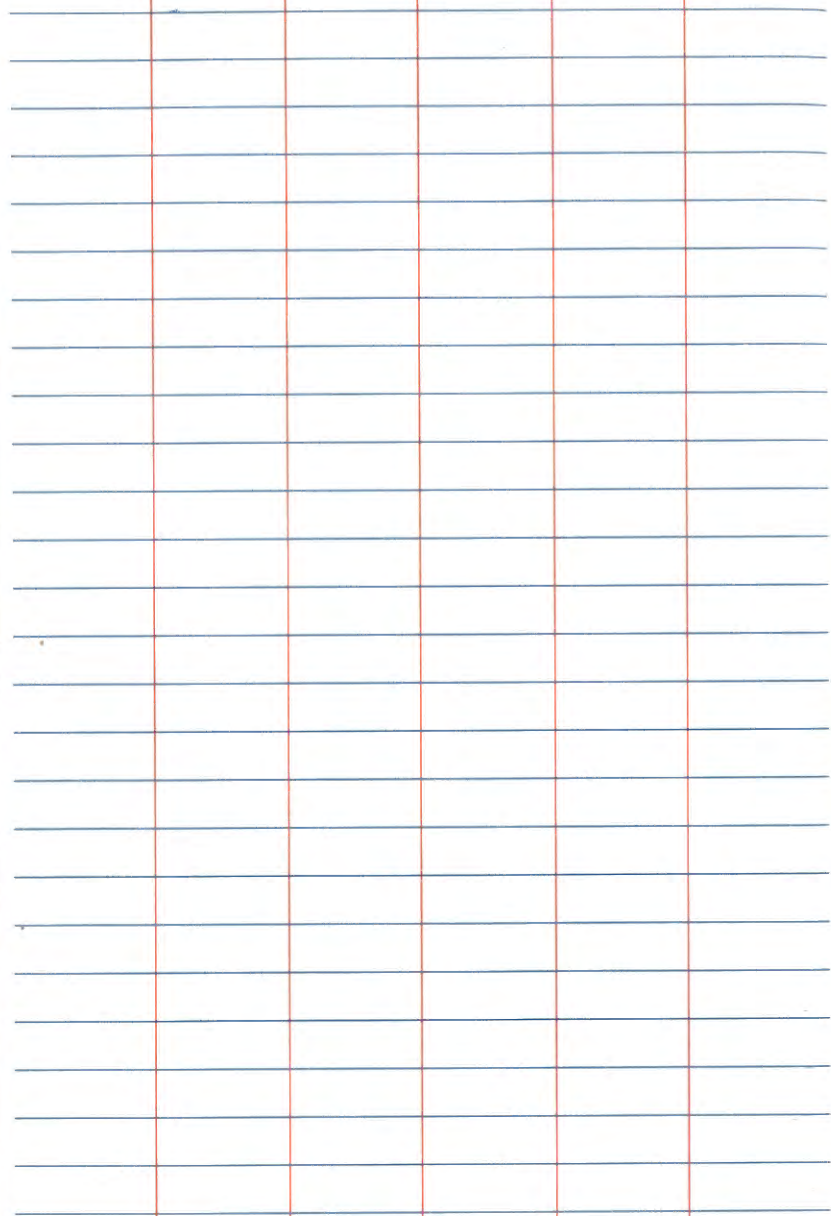

T142N R27W Sec 27
 Gov't lot 4, Swift Lake area survey

H₄

H. Dist

BS 1

Iron 144

FS 2 47-52-00 384.3

FS 3 67-35-00 332.3

FS 4 95-42-00 441.9

FS 5 118-13-00 577.00

FS 6 95-10-00 490.70 ?

FS 7 90-09-00 530.40 ?

FS 8 127-11-00 631.10

FS 9 136-18-00 691.10

FS 10 140-48-00 832.40

FS 11 143-32-00 1045.20

G. Kosenko, B. Ansk, G. Robertson
 3/18/85

P-9 47

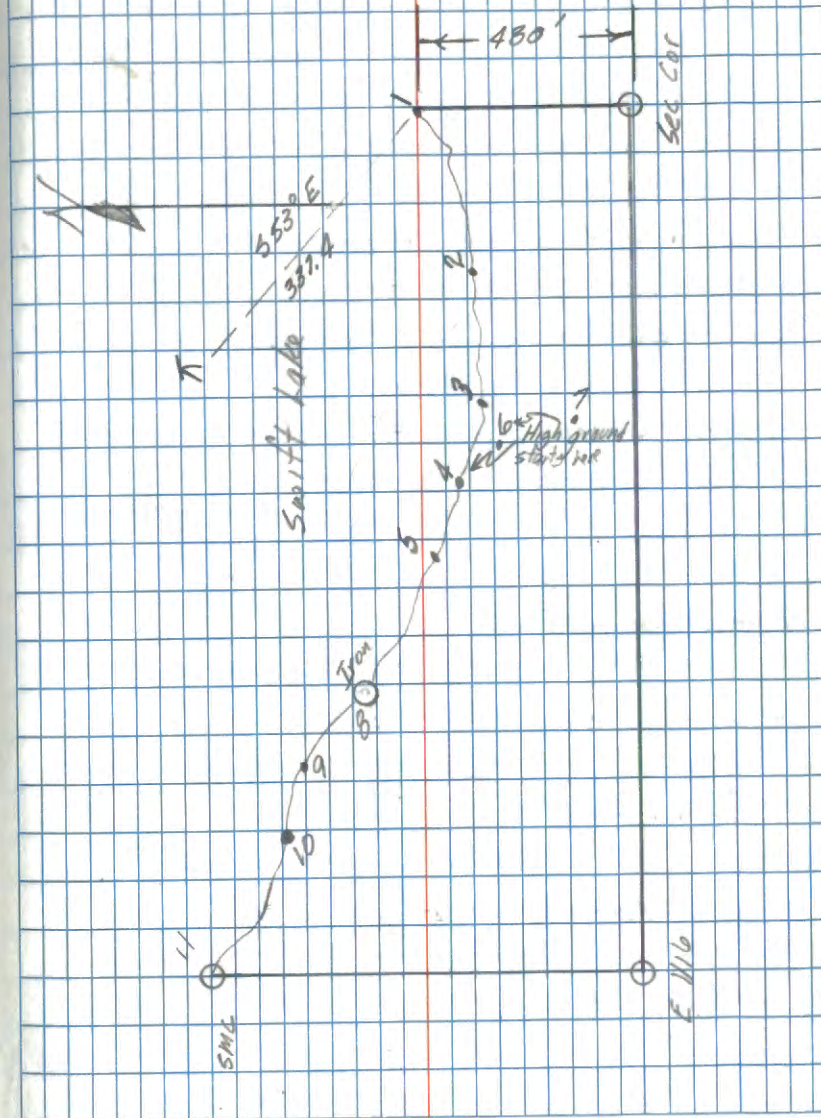

R-9

Section Corner To sec's 20, 21, 28, 29

Notes of GLO Resurvey of 1919

Found a wooden stake m'king corner position.

Accept this stake as being the best available evidence of the orig. corner for the reason that it has been recognized as the true pos. for the cor. for at least 16 years. This position determined from the BT's which were m'kd. about 16 years ago.

Set a 2" dia by 36" long iron post with brass cap m'kd.

7/29/85 - Fd. iron pipe with T142N R27W

B.C. set under road surface 520 | 521

5" 529 | 528

1919

From which bears:

R. Oak 8" N39°E 82 lks. 54.12

Powerline clearing

R. Oak 8" S50½°E 47 lks. 31.02

Falls in road

R. Oak 8" S31°W 154 lks. 101.64

Found stp hole at b'ring & dist.

R. Oak 14" N62½°W 100 lks. 66 - Falls in road

8/7/85 - M'kd New BT's:

R. Oak 14" N82E 69.66 T142N R27S21BT

R. Oak 5" S42°E 105.40 T142N R27S28BT

R. Oak 15" S38W 92.67 T142N R27S29BT

R. Oak 14" N44W 132.95 T142N R27S20BT

48

7/29/85 - JA, GB

Corner falls in center of gravel road.

Fd. Crip Ip. 33' west of corner

CC. Done

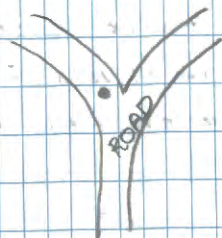

10

WEST $\frac{1}{16}$ Det. Sections 21 and 28

Notes of GLO Resurvey 1919

Set iron post 1" Dia. by 36" long with brass cap mkd. 7/29/85

Fd. iron pipe with B.C. set $\frac{W\frac{1}{16}}{528}$ $\frac{521}{528}$

12" above grd. 3' white sign post 1919

set along side. Flanges rusted off of iron pipe.

From which bears

Red Oak 6" S2°E 171ks. 11.22'

Fd. rotted stp at bearing + dist.

W. Pine 12" N56½E 491ks. 32.39

Fd. 20" W. Pine at bearing + dist.

Mkd. New BT'S:

1. R. Oak 11" N39W 49.9' Scribed $\frac{W\frac{1}{16}}{521BT}$

2. N. Pine 10" N74°E 22.60' $\frac{W\frac{1}{16}}{521BT}$

3. W. Pine 14" S85E 23.70' BT

Found a nail + disc in a blazed face on this tree.

CC. Done 8/5/85

01-49

7/29/85-GB, JA

Chained down a old brushed line 1334' and felt about 6' north of corner.

5-10

North-West 1/16 Sec. 28

Notes of GLO Resurvey 1919

Set iron post 1" dia. by 36" long
with brass cap mkd. 7/29/85

Fd. I.P. with B.C. set 7"

above grid. I.P. bent but straighten ¹⁹¹⁹ NW 1/16 S28
today and reset. Flanges rusted off of iron pipe

From which

R. Oak 10" N43W 77 lks. 50.82'

Fd. no remains of BT. Falls in R. Pine plantation

R. Oak 8" S87 3/4 E 22 lks. 14.52

Fd. R. Oak snag 15" S88E 14.52 Scar visible

Mkd. new BT'S:

1. N. Pine 16" N38 E 32.4' NW 1/16 S21 BT

2. R. Oak 14" S12 E 34.6' split blazes NW 1/16 S21 BT

3. W. Oak 10" S52 W 27.6' NW 1/16 S21 BT

cc. Done 8/5/85

50

7/29/85 GB, JA

Chained SW from W 1/16 1320.6' Fall
west of corner. Distance ^{check} 1900d.

Corner falls on south edge of R. Pine plantation

Fd. W. Oak 9" with F.S.L.P. placed by Co. Surveyor

Terry Freeman S69W 31.2' from corner

T-10

Center - West $\frac{1}{16}$ Sec. 28

Notes of GLO Resurvey 1919

set iron post 1" dia. by 36" long
with brass cap mkd.

Fd. I.P. with B.C. set 8"

above grd. in good condition $c \frac{W\frac{1}{16}}{528} c$

7/30/85

From which bears

Red Oak 10" N39 $\frac{1}{2}$ E 401ks 26.40

Fd. rottd R. oak stp at brging & dist.

red oak 10 S16W 731ks 48.18'

Fd. R. oak 17" S16°W at 48.18' scribed burned out

Mkd. New BT's:

R. Oak 9" N40W 33.75 CW $\frac{1}{16}$ 528BTMAPLE 7" S46W 15.45' CW $\frac{1}{16}$ 528BTBirch 10" S36°E 35.08 CW $\frac{1}{16}$ 528BT

cc. done 8/5/85

01.9.51

7/30/85 GB, JA

Ran compass line east and found corner
at the end of our line.Fd. F.S.L.P. by Co. Surveyor Terry Freeman
ON 10" MAPLE N75E 38'

T.9,10

Angle point 142

Notes of G20 Resurvey 1919

Set iron post, dia by 36" long
with brass cap mkd.

Fd. iron pipe with B.C.

set 9" above grd. Good cond.

7/30/85

528

AP1 AP2

TR TR

1716 1556

1919

Mkd. New B.T.'s:

R. Oak 8" N26E 16.90 528 BT

W. Oak 8" S80E 36.75 AP2 BT

Poplar 10" S8'E 14.6' AP2 BT

Placed F.S.L.P. on Poplar 12 West 2.0'

cc. done

1-2 52

7/30/85 GB, JA

Chained from 1/4 corner east 662.5.

Distance is good. Corner falls on top of
a small knoll.

S-17

Center North 1/4 Sec. 28

Notes of GLO Resurvey 1919

Set iron post 1" dia by 36" long
with brass cap mkd. C7/31/85 Fd I.P. with B.C. N 1/4 | S28
set 15" above grd. B.C.is 9" above water today. One C
flange busted off. 1919

From which bears:

Cedar 10" S29 3/4 E 114 lks. 75.24'

Fd no remaining evidence

Cedar 10" N54°W 187 lks. 123.42

Fd 13" Cedar at bearing & dist. scribe visible

Mkd New BT'S:

W. Oak 5" S20°W 13.17' CN 1/16 S28 BT

W. Oak 5" N86°W 40.2' CN 1/16 S28 BT

Ash 9" N14°W 51.4' CN 1/16 S28 BT

cc. Done 8/10/85

11-953

7/31/85 GB-JA

Old east-west fence line goes thru corner.

Corner falls in a burned over cedar swamp
with Aspen, Ash, Birch, Oak, etc in area today.

Quarter Corner bet. sec's 21, 28

Notes of GLO Resurvey 1919

Found no evidence of original corner.

Set $\frac{1}{4}$ corner proportionate

set iron post 1 1/2 dia. by 36" long with
brass cap mkd. 7/31/85

Fd. iron pipe with B.C. $\frac{1}{4}$ $\frac{521}{528}$

set approx. 5" above swamp

mat. approx 2' of water over B.C.

From which bears

N. Pine 14" S43°E 4771ks 314.82'

Fd. burned pine stp. at bearing & dist.

cc. Done

Note: W. Oak 14", south of corner approx
230' may be poss. BT. Sign posts for BT

7/31/85 GB-JA

Chained from CN $\frac{1}{16}$ North 1° East
1324' Found corner at end of our
line and distance was good.
Placed poplar picket with ribbon
at corner.

T-11

CENTER QUARTER Sec. 28

Notes of G.L.O. Resurvey of 1919

Set an iron post 1" dia by 36" long
with brass cap mkd.8/1/85 Fd. iron post with brass cap $C\frac{1}{4}$ S 28leaning under water. Straighten
monument into place. B.C. flush with water

From which bears: surface, 12" above grd.

TAMARACK 14" $50^{\circ}45'E$ 56 lks. 36.96'

Fd. rotted tam. stp. at brying & dist.

Cedar 8" $N73\frac{1}{2}W$ 36 lks. 23.76'

Fd. rotted cedar stp. at N80W and at dist.

MKd. New BT'S:

Cedar 11" $N22W$ 29.35' $C\frac{1}{4}$ S 28 BTCedar 13" $S78W$ 27.05' $C\frac{1}{4}$ S 28 BTAsh 6 $S41W$ 38.40' $C\frac{1}{4}$ S 28 BT

C. Done

55

8/1/85-G.B

Corner falls in a flooded ash & cedar
area. Approx 35' to high ground to
the west.North, south woods road is approx.
west of corner that runs up to three
cabins on Little Boy River.Old fence line laying down goes west
of corner.

T-11, 12

Special Meander Corner (west shore Little Bay River)

East-West Centerline in sec. 28

Notes of GLO Resurvey of 1919

Set an iron post 1" dia. by 36" long with
brass cap mkd. 8/1/85

Fd. iron pipe with B.C.

in upright position under
water in grass meadow

528	C SMC
528	
1919	

From which bears:

Cedar 10" Siw 75 lks. 49.5

Fd. burned cedar stp. at bearing & dist.

Cedar 10" N87W 93 lks. 61.38

Fd. burned cedar stp. at bearing & dist.

DC Done

8/1/85-GB

Chained from C/4 east 237.6' and
found corner at dist.

Couldn't see Little Bay River from this point

Need to monument in winter with sign posts

U-11
Center South $\frac{1}{16}$ Sec. 28

Notes of GLO Resurvey of 1919

Set a iron post 1" dia. by 36" long
with brass cap mkd.

C
S $\frac{1}{16}$ | S 28
C
1919

From which bears

Jack Pine 8" N34 $\frac{1}{2}$ E 16 lks. 11'

Jack Pine 13" N34E 11.0' scrub visible

W. Oak 12" N55 $\frac{3}{4}$ W 14 lks. 9'

W. Oak 14" N55W 9.0' overgrown

8/6/85 JA GB

Fd: 1" Brass lapped Iron pipe up 10" OK
left as found

SET:

Red Pine 23" N72E 31.82' "S $\frac{1}{16}$ S 28 AT"
spk tag redring

Set spks in at dist. on both GLO trees painted
red and tagged C.C. Done

11-17-99 R MAIN. GISED IRON 12-7-04

July WINDSTORM of THIS YEAR RAISED HELL WITH
THIS CORNER. Fd MONUMENT IN PLACE BUT
TIPPED. GLO J PINE BT NW AT 20 FT SWAGE

GLO W OAK SNAPPED OFF @ STUMP 1985 R. PINE
NOW A WINDFALL CUT OFF ABOVE TAG BY LOGGING

OF STORM DAMAGE. SIGN POST EAST OF CORNER
I R. PINE ROOT TIP CUT LEANING EAST.
CORNER IS ON NORTH FACING SLOPE AND
 \pm 75' SOUTH OF GRASS SLOUGH. STRAIGHTEN
MONUMENT NEED TO RETURN NW/ SAW.
GLO J PINE 10 FT TO NAIL. GLO W OAK
9.45 FT TO NAIL. PLACED A #10 SPIKE IN
A 23" DIA PINE STUMP N31W 12.45 FT
MKD BT ON FACE.

Special Meander Corner (west shore Little Bay River)

South $\frac{1}{16}$ line in sec. 28

Notes of GLO Resurvey of 1919

Set a iron post 1" dia. by 36" long
with brass cap mkd.

8/6/85 Fd. iron pipe with	S	528		
B.C. in place standing		528	S	SMC
12" below water surface		1919		

Note: High water year

From which bears

Ash 6" S51W 381ks. 25.08

Fd. rotted ash stp. at bearing & dist.

Ash 12" West 141ks. 9.24

Fd. no remains.

Mkd New BT'S

Ash 6" N83W 35.55 SMC 528 BT

Ash 7" S57W 44.30' SMC 528 BT

W. Oak 4" S21W 36.60 "X" BT

CC Done

2/6/85 - JA, GB

Chained S88E 1496' from C.S. $\frac{1}{16}$ Sec. 28

Distance good to SMC.

Corner falls approx. 25' west of Little Bay
River and 30' east of high ground.

U-10

South-West $\frac{1}{16}$ Sec. 28

Notes of GLO Resurvey of 1919

Set a iron post 1" x 36" long with
brass cap mkd. 8/6/85

Fd. iron pipe with brass

cap leaning south. Straighten SW $\frac{1}{16}$ S 28 BT
and reset B.C. 4 to 6" above swamp.

From which bears:

Tamarack 12" N 55 E 7 lks. 4.62

Fd. rotted roots at dist + bring.

Tam. 12" N 61 W 21 lks. 13.86

Fd. rotted stp. at dist + bring

MKd. New BT'S:

Tam 10" S 54 W 80.25 SW $\frac{1}{16}$ S 28 BTJ. Pine 7" N 4 E 64.30' SW $\frac{1}{16}$ S 28 BT

8" Steel sign post south 6.55" land survey sign att.

cc Done

8/5/85 GB, JA

Chained from SMC (East shore of Portage Lake
588 E 640'. Found B.C. with iron pipe
at the end of line. Dist. is good.Corner falls approx. 30' south of $\frac{1}{2}$ of
gravel road and directly under powerline.

u-9,10
Special Meander Corner (East Shore Portage Lake)

South $\frac{1}{16}$ line in sec. 28

Notes of G.L.O. Resurvey of 1919

Set a iron post $\frac{1}{2}$ " x 36" long with
brass cap mkd. 8/5/85

Fd. iron pipe with brass

cap leaning but in place. SMC

Straightened iron and reset

B.C. to 10" above grd.

S 528
S 528
1919

From which bears:

Tam 12" S86 $\frac{3}{4}$ E 161 lks. 106.26

Fd. 13" Tam S87E 106.7' to spike. Scribe vis.

Tam N85 $\frac{3}{4}$ W 124 lks. 81.84

Fd. Tam. windfall N82E at 81.84 Scribe vis.

Twin R. Oak 8" N48E 33.15' SMC S28BT

Cedar 11" S82W 4.35' SMC 28BT

R. Oak SMC 28BT

Distance from SMC to SMC is 30.9'

at N43W. See page 63

CC Done

8/5/85 - GB, JA

Corner falls approx. 3' from the
waters edge of Portage Lake on firm
ground.

u-9

North $\frac{1}{16}$ bet. sec's 28, 29

Notes of GLO Resurvey of 1919

Set a 1" dia. by 36" long iron post
with brass cap mkd.No evidence remains. Corner $N\frac{1}{16}$
position falls in a 3' cut
area in a gravel road. N-S.

S29 | S28

1919

From which bears

R. Oak 5" S43E 691ks. 45.54

No evidence

R. Oak 6" S50 $\frac{1}{2}$ W 491ks. 32.34

No evidence

cc. Done

8/7/85-JA, GB

Chained south down road from
Sec. cor 20, 21, 28, 29. 1320'. Found
a spike at the end of our chainage.

T-9

Quarter Corner bet. sec's 28, 29

Notes of GLO Resurvey of 1919

Set a iron post 1" dia. by 36" long
with brass cap mkd.

8/7/85 Found $\frac{5}{8}$ " Re-rod 1" $\frac{1}{4}$

below road surface in

center of road.

S29 S28

1919

From which bears

R. Oak 6" N62 $\frac{3}{4}$ E 65 lks. 42.9

Falls under power line. No remains

R. Oak 14" S34 $\frac{1}{2}$ W 128 lks. 84.48

Fd a mound of rotted remains at bearing & dist

CC Done

8/7/85 GB:JA

Corner falls in center of N & S road.

7, 2-9, 10

Special Meander Corner (Shore of Portage Lake)

Centerline through NW $\frac{1}{4}$ of SW $\frac{1}{4}$

Notes of GLO Resurvey 1919

Set 1" x 36" long iron pipe with brass cap mkd.

Fd. iron pipe with brass cap 528 528

leaning on the shore of Portage

Lake. Straighten iron and reset BC SMC

to 16" above ground.

1919

From

W. Pine 8" N53 $\frac{1}{2}$ W 118 lks. 77.88

Fd. N. Pine 16" N53W 77.88 Scribe rotting out

Poplar 8" N35W 52 lks. 34.32

Fd. Poplar stump rotted rollover evident.

Mkd. New BT's:

R. Oak 9" N34W 138.30' SMC 528 BT

z. Tripple R. Oak Clump 4" N48E 25.90 "X" "BT"

N.P 16" N53W 77.88 Rescribed "BT"

Distance from SMC to SMC is 30.9 at S43E

CC Done

8/5/85 JA, GB

Fd. corner on shore of Lake approx

1.0' from waters edge on firm grd.

Gravel road approx. 200' north
of corner runs NW-SE

V-3

QUARTER CORNER Bct. Sec's 30,31

Notes of GLO Resurvey of 1919

Found original evidence for reestablishment of corner.

Maple 8" S26E 381ks. 25.08

Maple 12" N77½E 531ks. 34.98

Set a 1" x 36" long iron pipe with brass

cap mkd. 8/8/85 - Found iron

pipe with brass cap set 12" $\frac{1}{4}$ $\frac{530}{531}$

above gr d. in place

1919

From which bears:

Maple 10" N43E 141ks. 9.24

Fd. no evidence

Maple 12" S20E 41ks. 2.64

Found a stp. hole at bearing & dist

Found original Maple 14" N77E 34.98

Scar overgrown and tree is in good shape

Found no evidence of other original BT

Mkd. New BT's:

Maple 6" S48E 9.48' $\frac{1}{4}$ S31BTMaple 6" S41W 12.15' $\frac{1}{4}$ S31BTBasswood 8" N34W 32.37 $\frac{1}{4}$ S30BT

CC Done

8/8/85 - GB JA

8/8/85 - GB JA

Came to this corner by boat across Rabbit Lk

Placed a F.S.L.P on 9" Ash east 100'
from corner on shore of Rabbit Lake.

~~Study~~ T, U-2, 3

Special Meander Corner Sec. 30

(S.M.C. on $\frac{1}{4}$ of SE $\frac{1}{4}$ SW $\frac{1}{4}$ on south shore Bay Lake

Notes of GLO Resurvey of 1919

Set a 1" x 36" long iron pipe with brass cap mkd. 8/8/85

Fd. iron pipe with brass cap SMC
leaning south with flanges
- embedded into rocks. Stood iron up 18" High 1919

From which bears:

Spruce 10" 568E 102 lks 67.32'
no evidence

Mkd New BT's.

Cedar 12" 565E 63.70' SMC S30 BT

Ash 4" N89E 41.0' "X" BT

Placed a few rocks around iron.

(need sign post for third B.O.)

CC Done

8/8/85 GB-JA

Chained North / East 1624' from
Angle Point 4. Corner on south shore
of Bay Lake. Distance good.

V-2,3

Angle Point #4 Sec. 30³¹ (west of S⁴ 5.30)

Notes of GLO Resurvey of 1919

Set a 1" x 36" long iron pipe with brass cap mkd.

Chained west 681' from S^{1/4} - dist. good

~~Survey~~ 8/8/85 JA GB

Fcl: 1" Brass Capped Iron Pipe up 1' OK

Left as found

SITE

B. of Gil	9"	S54E	5.23'	S31 BT	} 5pk + 955 red ring
Cedar	13"	S25W	46.86'	S31 BT	
Ash	5"	S68W	30.95'	S31 BT	

Corner falls in Balsam, Bal of Gil low corner
at East Edge

CC Done

Quarter Corner bet. Sec's 25, 30

Notes of GLO Resurvey 1919

Set ~~this corner~~ ^{based from original BT and} ~~proper locate~~
original post

Set a 1" x 36" long iron pipe with
brass cap mkd.

1/4

Fd. iron pipe with brass cap
standing up. B.C. is 1' below

525 | 530

water surface.

1919

No trees near

Original BT found by GLO 1919

Cedar 14 S20W 18 lks. 11.9

8/15/85 Fd. Cedar Stp. S20W 11.9. (Rotting)

CC Done

8/15/85 CK, JA, GB

Chained from W.C. to M.C. South bet.

Sec. 25/30 837'. Found corner at the
end of line. Distance checked good.

Corner is approx. 100' west of Boy Lake.

Corner falls in a very wet alder & willow
swamp. High water this year.

U-1

South $\frac{1}{4}$ bet sec's 25, 30

Notes of GLO Resurvey of 1919

Set 1" dia. by 36" long iron pipe
with brass cap mkd.

8/9/85 - Fd. iron pipe with

S $\frac{1}{16}$

brass cap set 12" above

525 S 30

ground. Placed rocks around

mon.

1919

From which bears

Cedar 10" S50E 41ks. 27.06'

Fd. a Cedar stub at bearing & dist. No scribe vis

Cedar 5" N30 $\frac{1}{2}$ W 42ks. 27.72

Fd. a 10" Cedar at bearing & dist. Scribe closed

8/17/85 - CK, 68

Rescribed BT.

Mkd. New BT's:

Cedar 11" S76E 58.3 S $\frac{1}{16}$ S30 BTCedar 10" S8E 39.4 S $\frac{1}{16}$ S30 BT

CC Done

See Book 5 T142N R28W pg. 68

68

8/9/85-GB

Measured from Sec. Cor. north down
road 1386'. Found corner approx.
400' north of a graveled road

QUARTER CORNER BET. SEC'S. 15-22.
 NOTES OF ORIG. GOVT. SURVEY 1873
 SET WOOD POST

ELM 6 N50E 25 LKS.

NOTES OF GLO RESURVEY 1919

FOUND ORIG WOODEN STAKE AND BT

ELM 12 N50E 25 LKS. MKD 1/4 S BT

SET IRON POST 1" DIA. X 36" LONG

WITH BRASS CAP MKD.

FD. GLO IRON BENT AND LYING BESIDE

1/4 $\frac{515}{522}$

ELM WITH BLAZE NORTH OF ROAD TO SUMMER HOMES

1919
8-10-79 CRK-MH-JX

FROM WHICH

ELM 10 N87 1/2 W 57 LKS. = 37.6'

BALSAM 6 SITE 41 LKS. = 27.1'

FALLS IN POWER LINE CLEARING

CASS COUNTY RECORD BOOK "C" PAGES 432-433-434

SURVEY # 462

FD. GLO RESURVEY IRON 3/4 CAP MKD NEW BT'S.

BALSAM 5 SITE 27.2'

FALLS IN ROAD CLEARING

ASPEN 12 N45E 22.2'

FALLS IN CLEARING

RE-7150-4

NOTES ON FILE AT S.O. CASS LAKE MN.

BY JOHN X. STARK RLS MKD. NEW TIES

ELM 10 N70W 72.7' NOW 4' X 12' ELM STUB N64W 72.7'

REA. P.P. S5W 63.2' REA POWER POLE SOUTH 63.2'

MC WEST (IRON PIPE) 541.8 ON SWIFT LAKE

SET 20" SPIKE AT 1/4 COR. POSITION 8-15-79 SEE BACK COVER ^{INSIDE}

5/23/96 CK

FD. CASS COUNTY CAST IRON MONUMENT

IN PLACE - AT NORTH EDGE OF FR. 25-28

OLD MOSTLY DOWN FENCE LINE RUNS NORTH
 OF CORNER AT WEST EDGE OF WOODS TRAIL NORTH
 CAP IS 3" BELOW ROAD

TIES FROM BACK OF THIS BOOK

ASPEN 12 N63W 38.09' - NOW LIVE ASPEN W/TAG

MAPLE 8 S54W 72.17' - NOW LIVE MAPLE W/TAG

ELM 11 N10E 61.50' NOW 12" X 5' HIGH STUB

POWER POLE 9" SOUTH 63.20' - POWER POLE W/TAG

SET 8' STEEL SIGN POST NORTH 14.70'

N-17

SECTION CORNER TO SEC'S. 14-15-22-23

NOTES OF ORIG. GOV'T. SURVEY 1873

SET WOOD POST

FIR	5	S16E	13 LKS.
H. MAPLE	4	N74E	14 LKS.
BIRCH	9	S35W	38 LKS.
BIRCH	7	N55W	36 LKS.

NOTES IN BOOK "C" CASS COUNTY RECORDS

SURVEY # 462 PAGES 432-433-434

FOUND ORIG. MAPLE BT STANDING MARKED AND

BOTH BIRCH BT'S. DOWN WINDFALLS AT BRGS. DIST.

SET 2 1/2" X 30" IRON PIPE

MKD NEW BT'S. SEARCHED 8-10-79 CK-MH-JR

R. OAK 16 N18W 42.8

FD. 23" R. OAK WITH SCAR FACING ROAD (NOW DEAD SNAG) ^{5/23/96 CK}

B. WOOD 12 N18E 45.2

FD. MAPLE 12 N49E 55.62' SCRIBED

R9-7150-4

70

DISTANCE WEST TO 1/4 CORNER 2676.0'

5/23/96 CK

FD. CASS COUNTY CAST IRON MONUMENT

IN PLACE - 5" BELOW ROAD SURFACE - 6.10'±

SOUTH OF CENTERLINE OF E+W ROAD FR 252B

FD. MAPLE 12 N49E - 55.62' SCRIBED

MARKED NEW BT'S.

R. OAK 9 N33W 77.25' MKD 515 BT

R. OAK 10 S37W 90.03' " 522 BT

R. OAK 9.5 SOUTH 95.42' " S BT

8' STEEL SIGN POST NORTH 26.32'

QUARTER CORNER BET. SEC'S, 14-23

NOTES OF ORIG. GOVT. SURVEY 1873

SET WOOD POST

W. PINE 15 NORTH 15 LKS.

NOTES IN BOOK "C" CASS COUNTY RECORDS

SURVEY # 462 PAGES 432-433-434

FOUND ORIG. BT STANDING

SET 2" X 20" KING BOLT IRON PIN AT CORNER

DISTANCE WEST TO SEC. COR. 2622.0'

N-21

SECTION Corner to Secs. 13-14-23-24
Notes of Original Govt. Survey 1873

Set wood post - id. decayed post
and pair -

Tam. 5" S58°E 12 lks (7.92') - Id. Tam.
Stamp S50°E 7.92'

Tam. 5" S58°W 14 lks (9.24) no evidence

Tam. 6" N45°W 10 lks (10.56) - Id. Tam.
Stamp 6" N50°W 10.56 w/scar & cur.

Tam. 5" N46°E 12 lks (7.92') - Id. Tam.
Stamp 6" N40°E 7.92' w/scrise B.T. 11510

To perpetuate this corner, set a 2" x 5' long
iron pipe w/ brass cap marked:

R. L. S.	
514	513
523	524
1980	

from which bears:

Tam. 5" N61°E 35.32'

Tam. 7" N72°W 29.0'

Tam. 9" S67°W 14.64'

Tam. 6" S67°E 27.65'

Steel post 8' long North 2.9' w/ signs

Steel post 8' long West 5.0' w/ signs

/s/ Ronald Olesen 6/19/80

data from R9-7150-4 by R. Olesen - copied into this
book by MCH 8/13/80 - hope to have Gary Stevenson
R.L.S. certify

Located this corner by pulling East from intersection
of FR 2528 & 53 a distance of 2652' to
locate this corner by rough chain & R.D.

Angle Point # 2 & 3 (Tr. 1377 & 1382)

(North of Section Corner 25, 30, 31, 34 693')

Notes of GLO Resurvey 1919

Set 1" x 36" long iron pipe with brass
cap mkd.

See Book 5 T142N R28W page 67

U, V-2

ANGLE POINT 4 (Track 1377) & ANGLE POINT 1

(North of W 1/4 sec. 30, 31)

(Track 1382)

Notes of GLO Resurvey of 1919

Set a 1" dia by 36" long iron pipe with brass cap mkd.

8/14/85 - CK, GB - Found iron pipe with brass cap leaning in swamp. Straightened iron and reset brass cap to 6" above swamp.

TR	
1377	TR
AP4	
AP1	1699
TR	
1392	
S30	

Mkd New BT'S:

Cedar 9" S4E 23.6 APS30BT

Cedar 7" S64E 9.35 BT

Placed F.S.L.P. also on this tree.

Ash 6" N54E 28.15 BT

CC Done

8/14/85 - Chained N1E 693' from W 1/4 bet sec 30/31. Distance check good. Corner falls in a Cedar & alder swamp.

V-2

WEST $\frac{1}{16}$ Bet sec's 30, 31

Notes of GAO Resurvey of 1919

Set a 1" x 36" long iron pipe with
brass cap mkd.

8/14/85-CK, GB Found iron

W $\frac{1}{16}$ 530

pipe with brass cap leaning

531

SE. Straighten iron and reset 8" above grd. 1919

From which bears

Cedar 6" S1E 261ks. 17.16'

Fd. 12" Cedar S1E 17.16 Scar closed

Cedar 6" N60 $\frac{1}{2}$ E 481ks. 31.68'

Fd. 9" cedar N60E 31.68' scar closed.

Mkd. New BT's:

Cedar 10" 555 W 17.95 W $\frac{1}{16}$ 531 BT

C. C. Dome

75

8/14/85 - Chained 589E 1529' from Sec. cor.
30, 31, 25, 36. Distance & line check good.
Corner falls in a Cedar & alder swamp.

T, U-9

Meander Corner Bet. Sec's. 28/29

(North shore of Portage Lake)

Notes of G.L.O. Resurvey 1919. Re-established from oak stake. No evidence of original BT'S.

Set a 1" x 36" long iron pipe with brass cap mkd.

Found iron pipe with brass

T142N, R27W

cap in good condition set 10" ^{Place}

529 528

above grd. Iron set in place ^{rocks around}

MC

From which bears:

Red Oak 6" N72E 48.18 Falls in road

Red Oak 8" N35 $\frac{3}{4}$ W 105 lks. 69.3'

Found no evidence

Mkd New BT'S

TWIN MAPLE 9" S35E 3.28 MC S28 BT

R. Oak 9" N45W 18.13 MCS29 BT

R. Oak 3" N69W 4.68 Bark scribe BT

Placed a F.S.L.P. on power pole N35E at 21' on south side of road.

CC Done

8/16/85 - CK, GB

Found corner 3' north of Portage Lake.

Corner falls approx. 40' south of

a Y intersection

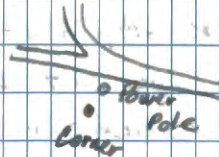

Y-2 SOUTH-WEST $\frac{1}{16}$ IN SEC 31

Notes of GLO Resurvey 1919

Set iron post 1" x 36" long
with brass cap mkd.

11/7/85-CK, GB, JA Found SW $\frac{1}{16}$ S31

GLO iron pipe set 12" above grd. 1919

B.C. in place

From which

N. Pine 12" S39 $\frac{3}{4}$ W 731Ks. 48.18'

Now Pine stub S40W 48.2 Blaze vis. No scribe

R. Oak 6" N74W 1121Ks. 73.92'

Now R. Oak snag 13" N74W 74'

Fd. F.S.L.P. on 10" Maple N19W 5' from
corner.

Corner falls on side slope on south side
in birch + balsam.

QUARTER CORNER BETWEEN SECTIONS 21+22

NOTES OF ORIGINAL GOVT. SURVEY 1873

SET WOOD POST

POPLAR 13 S49E 25 LKS. 16.5'

NO EVIDENCE WAS FOUND AT BRG. + DIST.

OAK 7 S87W 21 LKS. 13.86

NO EVIDENCE WAS FOUND AT BRG. + DIST.

11/4/87 CK MH

FROM SLO 2" IRON AT SEL. COR TO SEL'S. 21-22-27-28
 RAN LINE AT N2E WITH (5° DECLINATION) DOWN
 OLD ABANDONED POWER LINE CLEARING WHICH IS 21' WEST
 OF SLO IRON AT SEL. COR. POSITION - CHAINED 2640'
 AND FELL 12' SOUTH OF WOODS ROAD NW-SE - THEN
 CHAIN EAST 21' AND FELL APPROX. 8' NORTH OF F.SLP
 BY L.W. + RON OLSON 1976 ON SOUTH SIDE OF TRAIL
 TAG IS ON 5" BIRCH AND STATES APPROX. CORNER IS
 NE 10' - OUR CHAIN + LINE WOULD AGREE WITH
 THIS POSITION TOO WITHIN 3'
 ALSO CHAIN NORTH TO BOG WHICH ORG. STATE AS
 BEING 5 CHS. OR 330' - FROM OUR LOCATION THIS
 DISTANCE TO BOG WAS WITHIN ± 10'
 APPROX. 100' N OF APPROX. 1/4 EQ. LARGE BIRCH STUB
 WHICH WAS BLAZED NYS MANY YEARS AGO - ALSO
 OLD HOMESTEAD CLEARING IS APPROX. 150' NW OF COR.
 APPROX. LOCATION WOULD FALL IN CENTER OF WOOD
 ROAD NW-SE

CENTER NORTH $\frac{1}{16}$ SECTION 33

1919 GLO RESURVEY Pg #7

SET 3 FT X 1 INCH Z6 IN IN THE GROUND WITH

CAP MARKED: N $\frac{1}{16}$ | S33

C
1919

ASPEN 8" S56 $\frac{3}{4}$ E 124 IKS 81.84 FT
NO EVIDENCE

SPRUCE 6" S8 $\frac{1}{2}$ W 157 IKS 103.62 FT
NO EVIDENCE

12-2-14 REMAIN M₃ BOULCHONVILLE

FD IRON IN PLACE FLUSH WITH LEATHER
LEAF BOG. IRON IS \pm 100 NORTH OF SOUTH
EDGE OF BOG AND APPROX 100 FT EAST AND WEST
OF TREE LINE. GPS IRON

2-2-05 REMAIN

WITNESS WITH

W. OAK 7" S24 $^{\circ}$ E 86.60 FT TO SPRK MCD S33 BT

8 FT STEEL SIGN POST 3.85 NORTH 3.35 SOUTH TO C OF POST
LINE TO STANDARD NORTH AND SOUTH

1/4 BET SEC'S. 15-22

TEMP. TIES 8-15-79 CK-JR



USED LOT PIPES WEST AND SOUTH TO ESTABLISH TRUE LINE AND MEASUREMENTS FROM PLAT THEN PULLED TIES BY J. STARK BOTH LOCATIONS FALL WITHIN .10 OF EACH OTHER SET SPIKE AT COR.

FS 3 187 38 20
BS 1 00 00 00
K02 187 38 20

2-1 341.655

2-3 325.905

74.38

620.78

TRIGONOMETRIC FORMULÆ

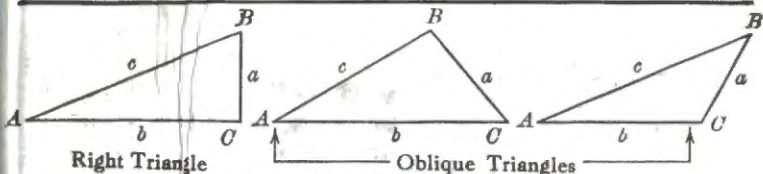

Solution of Right Triangles

For Angle A. $\sin = \frac{a}{c}$, $\cos = \frac{b}{c}$, $\tan = \frac{a}{b}$, $\cot = \frac{b}{a}$, $\sec = \frac{c}{b}$, $\operatorname{cosec} = \frac{c}{a}$

Given	Required	Formulas
a, b	A, B, c	$\tan A = \frac{a}{b} = \cot B$, $c = \sqrt{a^2 + b^2} = a \sqrt{1 + \frac{b^2}{a^2}}$
a, c	A, B, b	$\sin A = \frac{a}{c} = \cos B$, $b = \sqrt{(c+a)(c-a)} = c \sqrt{1 - \frac{a^2}{c^2}}$
A, a	B, b, c	$B = 90^\circ - A$, $b = a \cot A$, $c = \frac{a}{\sin A}$
A, b	B, a, c	$B = 90^\circ - A$, $a = b \tan A$, $c = \frac{b}{\cos A}$
A, c	B, a, b	$B = 90^\circ - A$, $a = c \sin A$, $b = c \cos A$

Solution of Oblique Triangles

A, B, a	Required b, c, C	$b = \frac{a \sin B}{\sin A}$, $C = 180^\circ - (A + B)$, $c = \frac{a \sin C}{\sin A}$
A, a, b	B, c, C	$\sin B = \frac{b \sin A}{a}$, $C = 180^\circ - (A + B)$, $c = \frac{a \sin C}{\sin A}$
a, b, C	A, B, c	$A + B = 180^\circ - C$, $\tan \frac{1}{2}(A - B) = \frac{(a - b) \tan \frac{1}{2}(A + B)}{a + b}$ $c = \frac{a \sin C}{\sin A}$
a, b, c	A, B, C	$s = \frac{a + b + c}{2}$, $\sin \frac{1}{2}A = \sqrt{\frac{(s - b)(s - c)}{bc}}$ $\sin \frac{1}{2}B = \sqrt{\frac{(s - a)(s - c)}{ac}}$, $C = 180^\circ - (A + B)$
a, b, c	Area	$s = \frac{a + b + c}{2}$, $\text{area} = \sqrt{s(s - a)(s - b)(s - c)}$
A, b, c	Area	$\text{area} = \frac{bc \sin A}{2}$
A, B, C, a	Area	$\text{area} = \frac{a^2 \sin B \sin C}{2 \sin A}$

REDUCTION TO HORIZONTAL

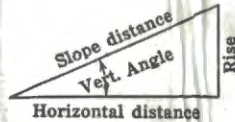

Horizontal distance = Slope distance multiplied by the cosine of the vertical angle. Thus: slope distance = 319.4 ft. Vert. angle = 5° 10'. From Table, Page IX. $\cos 5^\circ 10' = .9959$. Horizontal distance = 319.4 × .9959 = 318.09 ft. Horizontal distance also = Slope distance minus slope distance times (1 - cosine of vertical angle). With the same figures as in the preceding example, the following result is obtained. $\cosine 5^\circ 10' = .9959$. $1 - .9959 = .0041$. $319.4 \times .0041 = 1.31$. $319.4 - 1.31 = 318.09$ ft.

When the rise is known, the horizontal distance is approximately:—the slope distance less the square of the rise divided by twice the slope distance. Thus: rise = 14 ft., slope distance = 302.6 ft. Horizontal distance = $302.6 - \frac{14 \times 14}{2 \times 302.6} = 302.6 - 0.32 = 302.28$ ft.