

CORNER
RESTORATION
T141N R30W

MINING TRANSIT BOOK

EGS/A

BOOK 3

CORNER RESTORATION T141N R30W

In the
from 1

Cal 7.9

Out of
File

- 0
- 1
- 2
- 3
- 4
- 5
- 6
- 7
- 8
- 9
- 10
- 11
- 12
- 13
- 14
- 15
- 16
- 17
- 18
- 19
- 20
- 21
- 22
- 23
- 24
- 25
- 26
- 27
- 28
- 29
- 30
- 31
- 32
- 33
- 34
- 35
- 36
- 37
- 38
- 39
- 40

USFS

BOOK #3

BOOK # 3 of 5

T141N R 30W

Cass County

54
55-53

41	35	38								52
37	34	36	31	5	4	3	2	1		51
40	33									50
	22	19	20							49
	25	29								48
	24	24	18	8	9	10	11	12		47
	30	23	27	17	21					46
	12	11	10	9						45
	16	13	14	15	8	7	54			44
	18	3	17	21	16	15	14	13		43
70	69	62	71	56	57	58	59			42
	19	20	76	21	75	22	23	24		
	68	61		77	72	63	73	74	65	
	30	29	78	28	79	27	26	25		
					67	66	64			
	31	32	33	34	35	36				

Colored Numbers refer
to page on which Notes
for that corner may
be found

1.
L-8 Center East $\frac{1}{2}$ Cor. Sec. 17
Notes of G.L.O. Resurvey of 1917.
Set an Iron post 3' long
1" ϕ w/brass Cap MKD.
(Found in place.)

C E $\frac{1}{16}$ C
S17
1917

Balsam 6" N15 $\frac{1}{2}$ °E 33 Lks - 21.78'

(Not found)

Poplar 6" S75 $\frac{1}{2}$ °E 34 Lks - 22.44'

(Now a 11" windfall I chopped in & scribe is
visible stump is at record bearing & dist.)

To perpetuate this corner I marked 3 new
BTs

Oak 10" N44°W 37.2 feet MKD CE $\frac{1}{16}$ S17 BT

Oak 8" N12°E 39.75 feet MKD CE $\frac{1}{16}$ S17 BT

Elm 11" S18°E 42.25 feet MKD CE $\frac{1}{16}$ BT

2-19-63 G.H. McDonald

Steel sign post 72" long, set 24" in ground
w/ FS. standard signs 54-2 & 54-4 attached
due East 4.8 feet. RHM

Affidavit RHM

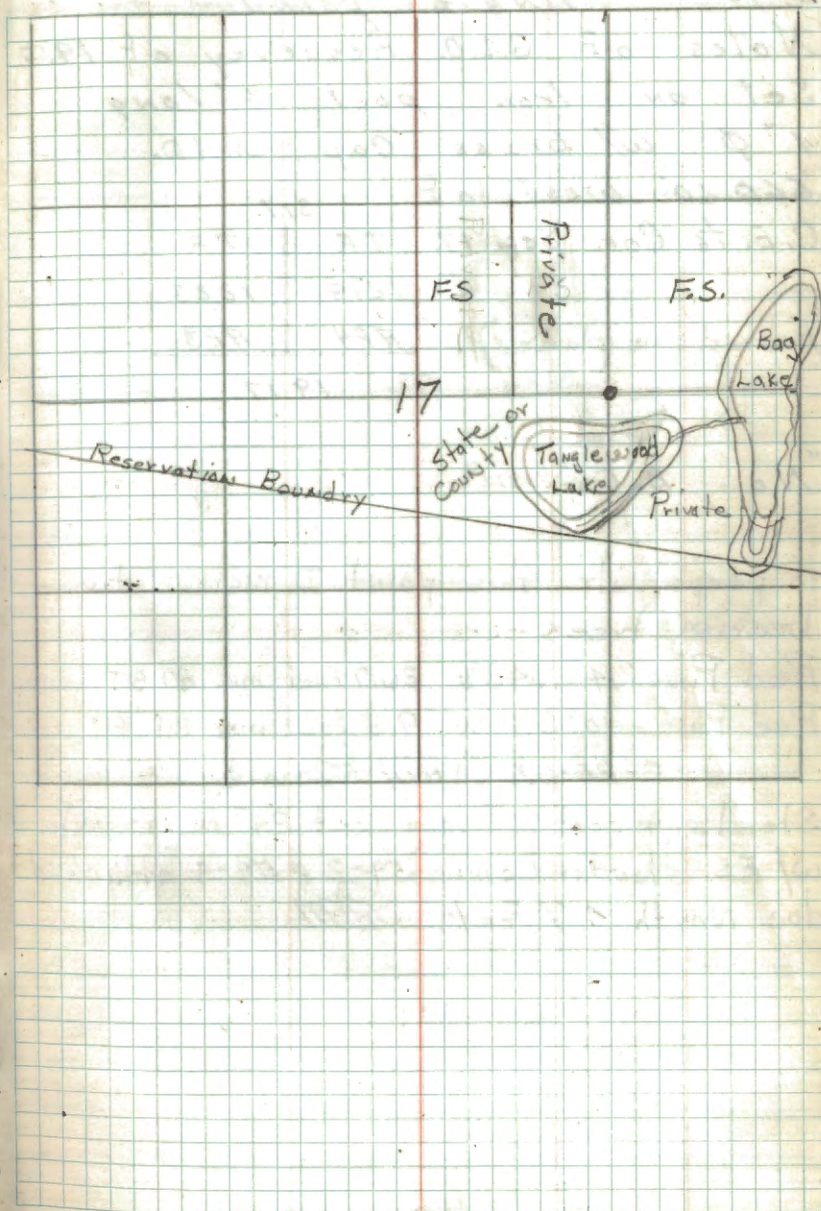

1-7,8 Angle point 3 & 4
Notes of G.L.O. Resurvey of 1917.

Set an Iron post 3' long,
1" ϕ w/ brass Cap MKD.

660.60' west of
C.E. $\frac{1}{8}$ Cor. Sec. 17. TR | TR

1219 | 1225

(Found in place) AP4 | AP3

1917

"No B.T.s"

To perpetuate this point I marked two
bearing trees -

Red Pine 14" N48°W 26.7 Feet MKD BT BT

Red Pine 10" S3°W 9.3 Feet MKD BT BT

2-20-63 (A McDonald)

Steel sign post 72" long, set 24" in ground
w/ F.S. standard signs 54-2 & 54-4 attached
due North 4.7 Feet (A McDonald)

Affidavit
RHM

T141N R30W

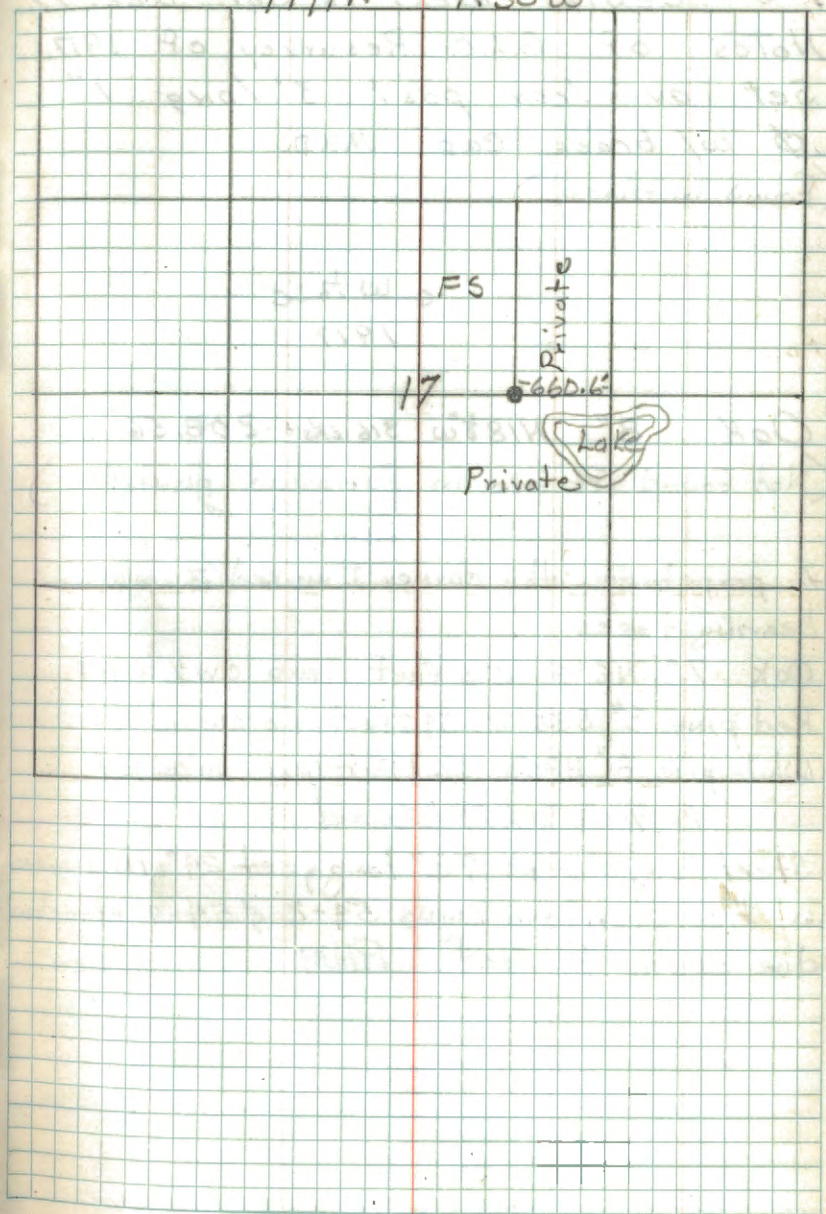

3

L-6 Center West $\frac{1}{8}$ Cor. Sec. 17.

Notes of G.L.O. Resurvey of 1917.

Set an Iron post 3' long 1"

Ø w/ brass cap MKD.

(Found in place.)

C W $\frac{1}{2}$ C
1917

Oak 8" N18 $\frac{1}{2}$ W 316 Lks - 208.56'

(Not Found Pt falls in Furrowed plantation)

To perpetuate this corner I marked 3 new bearing trees.

Oak 7" N2°E 15.5 Feet MKD CW $\frac{1}{16}$ BTRed pine 8" S55°W 59.7 Feet MKD CW $\frac{1}{16}$ RTWhite pine 8" N80°W 66.1 Feet MKD CW $\frac{1}{16}$ BT

2-18-63 R.H.M. Donald

Steel sign post 72" long, set 24" in ground w/ F.S. standard signs 54-2 & 54-4 attached due south 4.1 Feet. RHM

Affidavit RHM

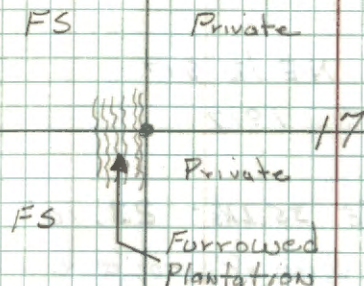

4

K-8 North East $\frac{1}{16}$ Cor. Sec. 17

Notes of G.L.O. Resurvey of 1917.

Set on Iron post 3' long 1" ϕ
w/ brass Cap MKD.

(Found in place.)

NE $\frac{1}{16}$ S17

1917

N. Pine 12" N25 $\frac{1}{2}$ °E 35 Lks - 23.10'

Now 12" pine w/ fall-blaze w/ part of scribe at record

N. Pine 12" S43°E 17 Lks - ^{bearing & dist} 11.22'Now a 19" Red pine w/ scribe overgrown, at record
bearing and distance.

Remarked the S-E Gov't BT.

Red pine 19" S43°E 11.22 feet MKD NE $\frac{1}{16}$ BTWhite pine 25" S36°W 29.0 ft. MKD NE $\frac{1}{16}$ BT

2-20-63 P.H. McDonald

Steel sign post 72" long, set 24" in ground
w/ F.S. standard signs 54-2 & 54-4 attached
due west 3.75 Feet RHM

Affidavit RHM

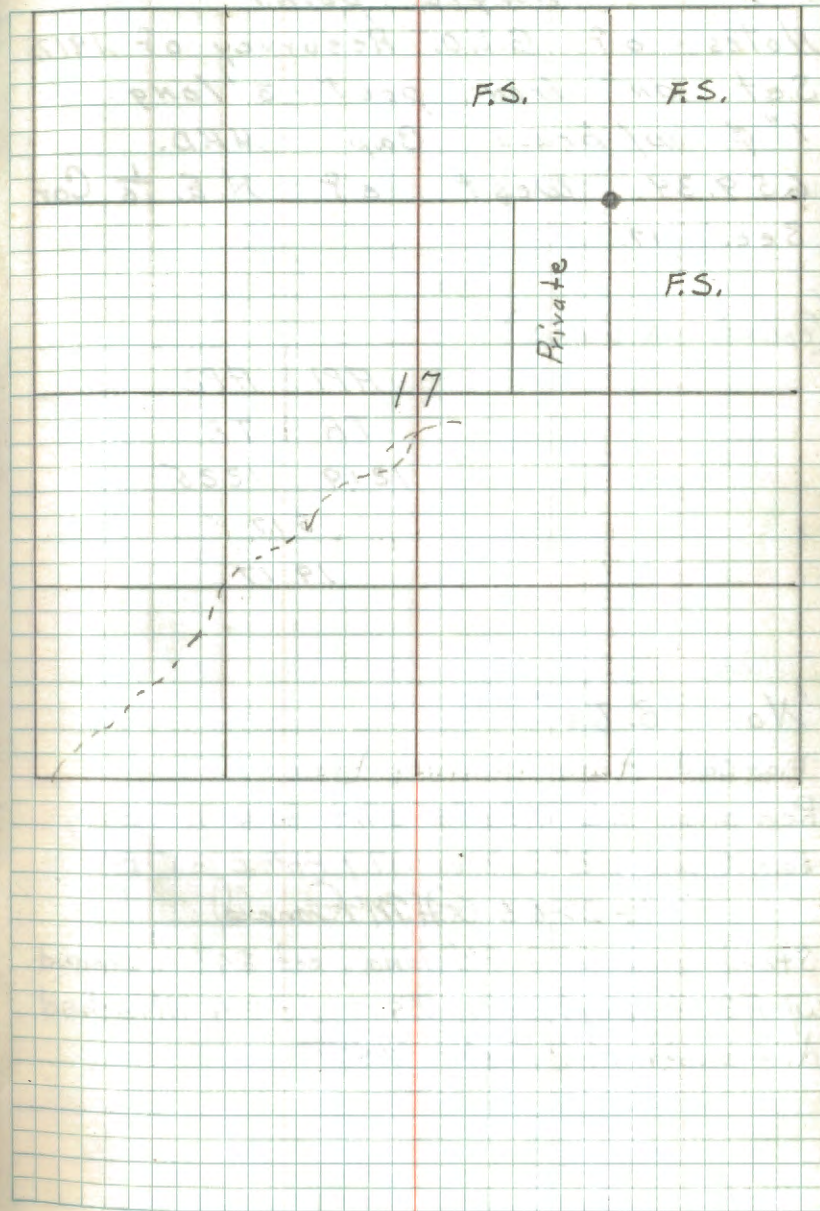

5
 K-7,8 Angle point 152
 Notes of G.L.O. Resurvey of 1917.
 Set an iron post 3' long
 1" ϕ w/ brass Cap MKD.
 659.34 West of N.E. $\frac{1}{6}$ Cor
 Sec. 17.

(Found in place)

AP1	AP2
TR	TR
1219	1225
517	
1917	

"No B.T.s"

Marked two bearing trees.

Red pine 22" N84 $\frac{1}{2}$ °E 57.4 Ft MKD BT BT

Jack pine 12" S67°W 17.9 Ft MKD BT BT

2-20-63 G.H. McDonald

Steel sign post 72" long, set 24" in ground
 w/ FS standard signs 54-2 & 54-4 attached
 due south 4.3 feet G.H.M.

Affidavit RHM

T141N

R30W

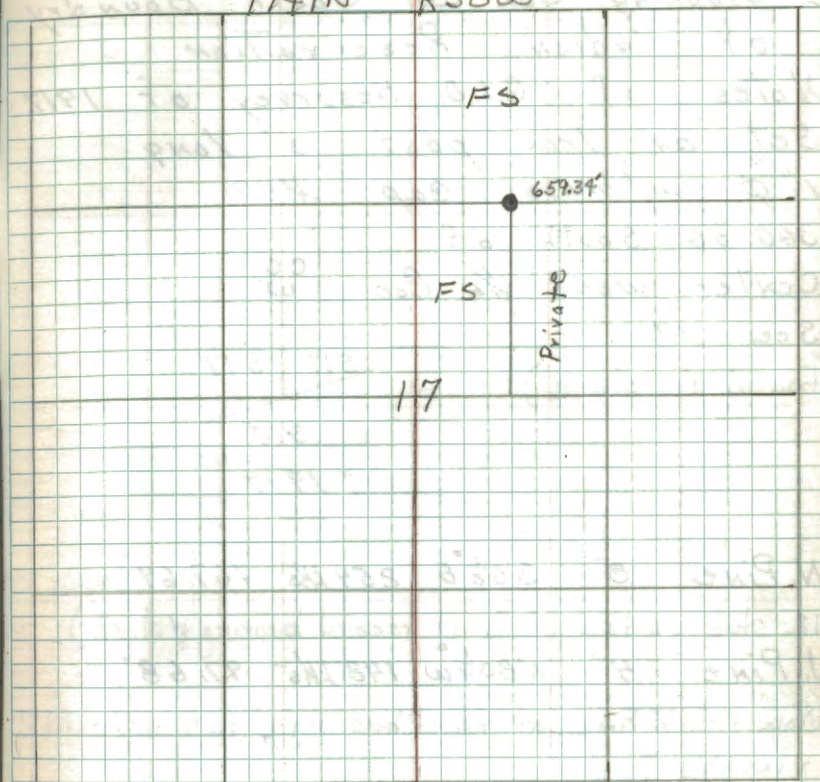

6 L, M-6

Closing Cor. on South Boundary
of Indian Reservation

Notes of G.L.D. Resurvey of 1917

Set an Iron post 3' long
1" ϕ w/brass cap MKD.

360.36' South of

Center west $\frac{1}{6}$ Cor. $\begin{matrix} CC \\ W \end{matrix}$

Sec 17.

(Found in place)

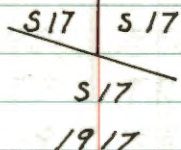

N. Pine 8" S62°E 254 Lks - 167.64' (Now
12 stub scribe plain at record bearing & dist.)

J. Pine 4" N80°W 148 Lks - 97.68'

(Now 13" J. Pine at record bearing & dist. w/ scribe
visible.)

to perpetuate this corner I marked 2 new BTs

Jack pine 12" S81°W 72.45 ft. MKD BT BT

White pine 7" S30°E 71.8 ft. MKD BT BT

2-19-63 *RAM* Donald

Steel sign post 72" long, set 29" in ground
w/ F.S. standard signs 54-2 & 54-4 attached
due North 4.4 Feet *RAM*

Affidavit *RAM*

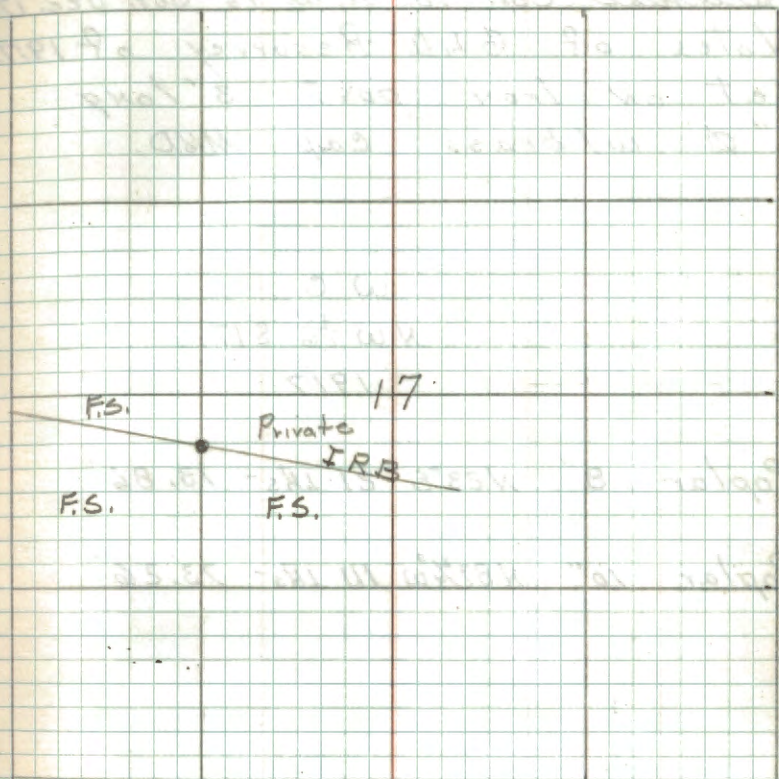

Witness Cor. to N.W. $\frac{1}{6}$ Cor. Sec. 17
 Notes of G.L.O. Resurvey of 1917.
 Set an Iron post 3' long
 1" ϕ w/brass cap M.H.D.

W C

NW $\frac{1}{6}$ S17

1917

Poplar 8" N23°E 21 Lks - 13.86'

Poplar 10" N87 $\frac{3}{4}$ °W 111 Lks - 73.26'

Angle point North Edge of
Lake, 844.14' North of
witness Cor to the N.W. $\frac{1}{4}$
Cor Sec. 17. or 611.16'
South of west $\frac{1}{4}$ Cor
Sec 8-17.

Notes of G.L.O. Resurvey of 1917.

Set an Iron post 3' long
1" ϕ w/ brass Cap MKD.

S 17

TR	
1329	AP2
	TR

wc 1328
1917

No B.T.s

Angle point

Notes of G.L.O. Resurvey of 1917

Set an iron post 3' long 1" ϕ
w/brass cap MKD.

655.38' west of Sec. Cor. 7-8-17-18

TR	TR
1597	1323
AP6	AP3
AP1	AP2
TR	TR
1321	1322
1917	

10 J-4

East $\frac{1}{16}$ Cor. Sec. 7-18

Notes of G.L.O. Resurvey of 1917.

Set an Iron post 3' long 1" ϕ w/ brass cap MHD.

$\frac{E\frac{1}{16}}{S7}$

S18

1917

Poplar 8" N30 $\frac{1}{2}$ \circ E 121 1/4s 79.86'

No EVIDENCE

Form 458 on 4" ASPEN 539 \circ E - 33'66 FT

FOUND BY RANDY SILBAUGH 10/78

11/7/79 FOUND G.L.O. IRON BENT AND

TOUCHING GROUND. BASE OF IRON IN PLACE.

REPLACED G.L.O. IRON WITH A CONCRETE
FILLED, 2" x 36" GALVANIZED PIPE W/ BRASS

TABLET STAMPED:

T1410 R35 W

$\frac{E\frac{1}{16}}{S.7}$
S.18

1979

R.L.S. No. 12261

IN GROUND 28". PLACED G.L.O. IRON ALONG
SIDE.

FROM WHICH BEAR: (ALL TREES SINGLE BLADE)

A. OAK 8" N 73 \circ E 51.25 E $\frac{1}{16}$ 57 BT

W. OAK 5" S 10 \circ E 18.44 X BT

R. OAK 9" N 83 \circ W 31.67 E $\frac{1}{16}$ 57 BT

STEEL SIGN POST EAST 3.4'

M.C. Fayer

LINE TO EAST IS TO STANDARD
CORNER IS ON NORTH EDGE OF OLD ROAD AT KINK

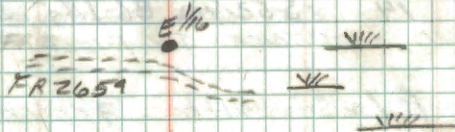

J-3
Witness Cor. to $\frac{1}{4}$ Sec. 7-18

Notes of G.L.O. Resurvey of 1917.
Set an Iron post 3' long 1" ϕ
w/brass cap MKD. Fr 12" ABOVE
GROUND IN GOOD CONDITION WITH REMAINS
OF STONE MOUND. M.C.F.

$\frac{1}{4}$ S7 WC
S18
1917

R. Oak 8" N81°W 82.14s 54.12'
NO EVIDENCE - IN ROAD CLEARING M.C.F.

R. Oak 14" S52 $\frac{1}{2}$ W 86.14s 56.26'
NO EVIDENCE - IN FIELD M.C.F.

CAP flush with ground
From 457 on 5" ASPEN N2°W 7.26 FT.
From old Field Book No date

11/7/74 Found G.L.O. IRON POST &
CAP 12" ABOVE GROUND WITH REMAINS
OF STONE MOUND. TO PERPETUATE I
MARKED 3 NEW B.T.S

B. ASH 10" N1°E 7.13' MKD X BT
R. OAK 9" N73°W 46.85' MKD X BT
W. OAK 22" N39°W 79.25' MKD X BT
STEEL SIGN POST EAST 3.3'

ALL BT'S WITH LARGE SINGLE BLAZE.
DISTANCE WEST TO A.P. #4 CHECKS WITH G.L.O.
BT 545'

M.C. Joyce

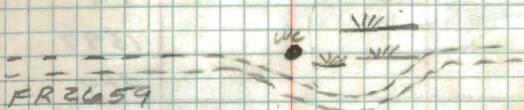

8/14/91 GB-CK

REMOVED GLO IRON & SIGN POST AND PLACE BY SURVEY
PLACE MAGNETIC PELLET IN HOLE AT COR. LOCATION
MONUMENT IS ± 6 FT NORTH OF ϕ

6/13/96 RM-CK

8 FT STEEL SIGN POST 20.9 FT NORTH
RESET GLO MONUMENT FROM TIES

12 J-2,3

Angle point

Notes of G.L.O. Resurvey of 1917.

Set an Iron post 3' long

1" ϕ w/ brass cap MKD.545.16' West of $\frac{1}{4}$ w. c. Sec. 7-18

	TR
	1597
	AP4
TR	1318
	1917

No B.T.s

Found By RANDY SILBAUGH, 10/78

11/7/79 Found G.L.O. Iron Boundary Feet
TO EAST ON SOUTH EDGE OF ROAD. RE-
PLACED G.L.O. IRON WITH A 24" X 2" GALVANIZED
EQUED GALVANIZED PIPE W/ BRASS TAPED STAMPED
TJH/R30 W
TOOK AND DESTROYED G.L.O.
MONUMENT AS TOO ZENT TO
RESET. SET MONUMENT 6" BELOW SURFACE

3.7	TR 1597
	AP4
3.18	TR 1318

R. OAK	12"	N10°E	82.75'	MKD AP4 57 BT
R. OAK	12"	S77°E	77.45'	MKD AP4 518 BT
R. OAK	15"	N32°W	34.58'	MKD AP4 57 BT

STEEL SIGN POST NORTH 18.6'

ALL TREES ARE SINGLE BLADED

CONTINUED TO CORNER FROM W.C. $\frac{1}{4}$ COR. AND FOUND
DISTANCE TO BE 545' WHICH IS WHAT G.L.O. CALL FOR

LINE TO NORTH IS TO STANDARD

TAPED FROM W.C. $\frac{1}{4}$ COR. EAST TO A.P.
POSITION AND FOUND DISTANCE TO CHECK
WITH G.L.O. AT 545'. ALIGNMENT WITH
FENCE CORNERS IS ALSO GOOD.

+ M.C. Hayes

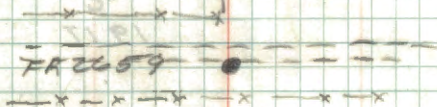

6-18-96

RESET MONUMENT USING PLAT DISTANCE (657.09) FROM
THE WEST $\frac{1}{6}$ BETWEEN SECTION 7-18 AND THE R. OAK BT @
N10°E 82.75'. MONUMENT SET 8" BELOW ROAD
SURFACE AND ON 4" MKD WITNESSES AS FOLLOWS

1979 R. OAK 16" N10°E 82.75' SCRIBE OVERGROWN
NEW W OAK 9" N32°W 46.98 FT To Spk MKD @ AP5 7 BT
NEW W OAK 10" N61°W 80.99 FT To Spk MKD @ AP5 7 BT
HEAVY 8 FT STEEL SIGN POST NORTH 32.35 FT
FSLP ON 6" ASH FROM WHICH CORNER BEARS NZE
28.2 FT

R9-7150-4

LIGHT PENCIL DUE TO WET PAGES

Center North $\frac{1}{16}$ Cor. Sec. 18

Notes of G.L.O. Resurvey of 1917
 Set an Iron post 3' long 1" ϕ
 w/brass cap MRD.

C
 |
 N $\frac{1}{16}$ S 17 2
 |
 C

Check Brass
 1917 Cap Notes
 show to be MRD
 as Sec 17
 and should be 18

there line was run N $0^{\circ} 38' E$ on
 a true center line through Sec 18.

R. Oak 14" N $67^{\circ} 2' W$ 37 LKs - 24.42'

R. Oak 12" S $42^{\circ} 4' E$ 71 LKs - 46.86'

14

North East $\frac{1}{4}$ Cor. Sec. 18

Notes of G.L.O. Resurvey of 1917

Set an Iron post 3' long 1" ϕ
w/brass cap MHD.

NE $\frac{1}{4}$ S18

1917

Poplar 10" N74 $\frac{3}{4}$ °E 37 Lhs - 24.42'

Mound of stone 2' Base 1 $\frac{1}{2}$ ' High
west of Corner.

Form 458 on 5" ASPEN EAST 5'94 FT

No date

R.O.V. 12" S42 $\frac{1}{2}$ °E 71 Lhs 46.83'

No Angle point.

Notes of G.L.O. Resurvey of 1917.

Set an Iron post 3' long 1" ϕ
w/brass cap M.H.D.652.74' West of N $\frac{1}{16}$ Cor. Sec.

17-18

TR	TR
1321	1322
AP4	AP3

S 18

1917

No B.T.s

North West $\frac{1}{16}$ Cor. Sec. 18

Notes of G.L.O. Resurvey of
1917. Set an Iron post 3' long
1" ϕ w/brass cap MHD.

NW $\frac{1}{16}$ S18

1917

W. Oak 8" N60°E 113 Lhs - 74.58'

W. pine 10" N81°W 180 Lhs - 118.80'

See Book 5 page 6

for information on corner

South $\frac{1}{16}$ Cor. Sec. 7-8

Notes of G.L.O. Resurvey of 1917
Set an Iron post 3' long 1" ϕ
w/brass cap MHD.

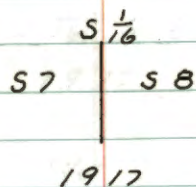

R. Oak 14" S 16° E 172 Lks - 113.52'
UNDER SNOW NO EVIDENCE

R. Oak 8" N $31\frac{1}{2}^{\circ}$ W 99 Lks - 65.34'
UNDER SNOW NO EVIDENCE

1-28-99

Fd IRON IN place up 6" CORNER IN MIXED
HARDWOODS NEAR THE TOP OF A HILL ON A WEST
FACING SLOPE & LINE TO STANDARD NORTH AND EAST
OF CORNER. WITNESS WITH 8

ROAK 8" N 85° E 37.63 FT TO NAIL MKD S 8 BT

ROAK 12" S 18° W 38.94 FT TO NAIL MKD S 7 BT

ROAK 6" N 33° E 50.85 FT TO NAIL MKD S 8 BT

8 FT STEEL SIGN POSTS 30.15 EAST 40.0 NORTH

Quarter Cor. Sec. 7-8

Notes of G.L.O. Resurvey of 1917.
Set an iron post 3' long 1" ϕ
w/brass cap MKD.

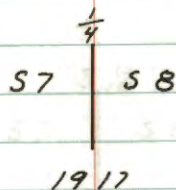

Orig B.T.
Birch stump - N70°W 16 Lks - 10.56'
(badly decayed)

"New B.T.s"

Oak 6" N12°E 162 Lks - 106.92'
Clump of three oak @ BRG & DIST. TREES ARE STANDING
DEAD

Oak 14" N47°W 115 Lks - 75.90'
NO EVIDENCE

TA9 457 on 6" Red oak S?W
No date

12-3-98 R. MAIN

Fd GLO IRON IN GOOD CONDITION UP 8" Fd 8"
X 4 FT PLANTATION POST LAYING DOWN NEXT TO
IRON. IRON IS ON A HARDWOOD RIDGE BETWEEN
SMALL LAKE WEST AND A SMALL POTHOLE EAST.
MKD TWO NEW B.T.s

ROAK 10" N11°E 33.85 FT To SPK MKD S 8 BT

ROAK 13" N83°E 43.30 FT To SPK MKD S 8 BT

8' steel sign posts: 1. 3.05' west
2. 2.95' East
3. 3.25' south
4. 3.95' North } Center of
post

NEW line to standard goes east, AND SOUTH
OF CORNER

Section Cor. Sec. 5-6-7-8

Notes of G.L.O. Resurvey of
1917. From remains of Orig
Wooden stake and stumps.
Set an Iron post 3' long
2" ϕ w/ brass cap MKD.

T141N	R30W
56	55
57	58

1917

"Orig B.T.s"

Maple stump N72°W 14 Lks-

Pine stump S16 $\frac{1}{2}$ °W 64 Lks-

"New B.T.s"

Oak 12" S89°W 186 Lks-122.76 FT

Oak 12" N88 $\frac{1}{2}$ °W 143 Lks-94.38 FT

Raise a Mound of stone 2'
Base 1 $\frac{1}{2}$ ' high west of Corner.

Quarter Cor. Sec. 5-8

Notes of G.L.O. Resurvey of 1917.

From remains of orig stake
and B.T.s set an iron post
3' long 1" ϕ w/ brass cap MKD.

8/11/87 CK-MH

FD. IRON + CAP IN PLACE IN GOOD CONDITION

12" ABOVE GROUND $\frac{1}{4}$ S 5

IN BRUSH + ASPEN-OAK S 8

150' SOUTH OF HWY #200 1917

Orig B.T.s

pine stump 24" S18°W 17 LKs - 11.22'

WELL ROTTED PINE STUMP (LARGE) AT S18W 11.2'

pine stump N11°W 51 LKs - 33.66'

NO EVIDENCE REMAINS

"New B.T.s"

R. Oak 12" N54½°W 390 LKs - 257.40'

DISTANCE 4 BRG. FALL IN NORTH DITCH OF HWY #200

R. Oak 12" S79°W 435 LKs - 287.10'

NOW ROTTED OAK STUMP (LARGE) S79W 287.10'

8/11/87

MARKED NEW B.T.s.

R. OAK 9 N 5° E 7.45' MKD 1/4 S S BT

NOW A WINDFALL 1998

R. OAK 10 N 85° E 35.90' 1/4 S S BT

NOW A WINDFALL 1998

W. OAK 8 S 16° E 17.45' 1/4 S 8 BT

R. OAK 7 S 87° W 26.10' 1/4 S 8 BT

8' FG SIGN POST DUE SOUTH 3.4' WARNING STICKER

FSLP ON 11" N. PINE 105' NORTH OF CORNER SOUTH SIDE
OF HWY. 200 AND INTERSECTION WITH CO. RD. #13
TO NORTH

South West $\frac{1}{16}$ Cor. Sec. 8

Notes of G.L.O. Resurvey of 1917.
Set an Iron post 3' long 1" ϕ
w/brass Cap MKD.

SW $\frac{1}{16}$ 58

1917

Oak 12" S89 $\frac{1}{2}$ W 308 LKs - 203.28'
UNDER SNOW NO EVIDENCE

Oak 12" N72 $\frac{1}{2}$ W 230 LKs - 151.80'
UNDER SNOW NO EVIDENCE

1-28-99

Fd G/LC IRON IN PLACE UP 6" CORNER IN MIXED HARDWOODS
LINE TO STANDARD SOUTH AND WEST OF CORNER

W OAK 11" S27W 60.82 FT TO SPK MKD: 58 BT
DOUBLE BLAKE

R OAK 10" N42W 20.70 FT TO SPK MKD: 58 BT
N/BL 6 INJIE 6 INZ

R OAK 10" N36E 22.05 FT TO SPK MKD: 58 BT
N/BL 6 INJIE 6 INZ

8 FT STEEL SIGN POST 4.4' SOUTH 3.1' WEST

Quarter Cor. Sec. 6-7

Notes of G.L.O. Resurvey of 1917.
 From remains of Orig stake
 and B.T.s set an Iron post
 3' long 1" ϕ w/brass cap MHD.

$$\frac{1}{4} \frac{56}{57}$$

1917

Orig B.T.s

Oak stump 10" N29°W 34 Lks - 22.44'

"New B.T.s"

Basswood 6" S40 $\frac{1}{4}$ °E 36 Lks - 23.76'Poplar 8" N11 $\frac{1}{4}$ °W 36 Lks - 208.56'

Center South $\frac{1}{4}$ Cor. Sec. 7
 Notes of G.L.O. Resurvey of 1917.
 Set an Iron post 3' long 1" ϕ
 w/brass Cap MKD.

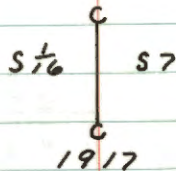

R. Oak 12" N23 $\frac{3}{4}$ W 210 LKs 138.60'

R. Oak 12" N64 $\frac{1}{4}$ E 171 LKs 112.86'

Center Quarter Cor. Sec. 7

Notes of G.L.D. Resurvey of 1917.

Set an iron post 3' long 1" ϕ
w/brass cap MKD.C $\frac{1}{4}$ S 7

1917

R. Oak 8" S $61\frac{1}{4}^{\circ}$ E 141 Lhs - 93.06'R. Oak 10" S $13\frac{1}{2}^{\circ}$ W 145 Lhs - 95.70'

Center North $\frac{1}{8}$ Cor. Sec. 7

Notes of G.L.D. Resurvey of 1917.
Set an Iron post 3' long 1" ϕ
w/brass cap MKD.

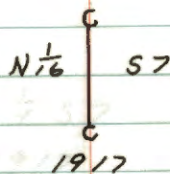

R. Oak 14" N41°E 93 Lks - 61.38'

R. Oak 10" N37°W 409 Lks - 269.94'

Center East $\frac{1}{6}$ Cor. Sec. 7

Notes of G.L.D. Resurvey of 1917.

Set an Iron post 3' long 1" ϕ
w/brass cap MND.

C $\frac{E \frac{1}{2} C$

S7

1917

Oak 6" N68 $\frac{1}{2}$ °E 34 Lks - 22.44'

Poplar 6" S25 $\frac{1}{2}$ °W 35 Lks - 23.10'

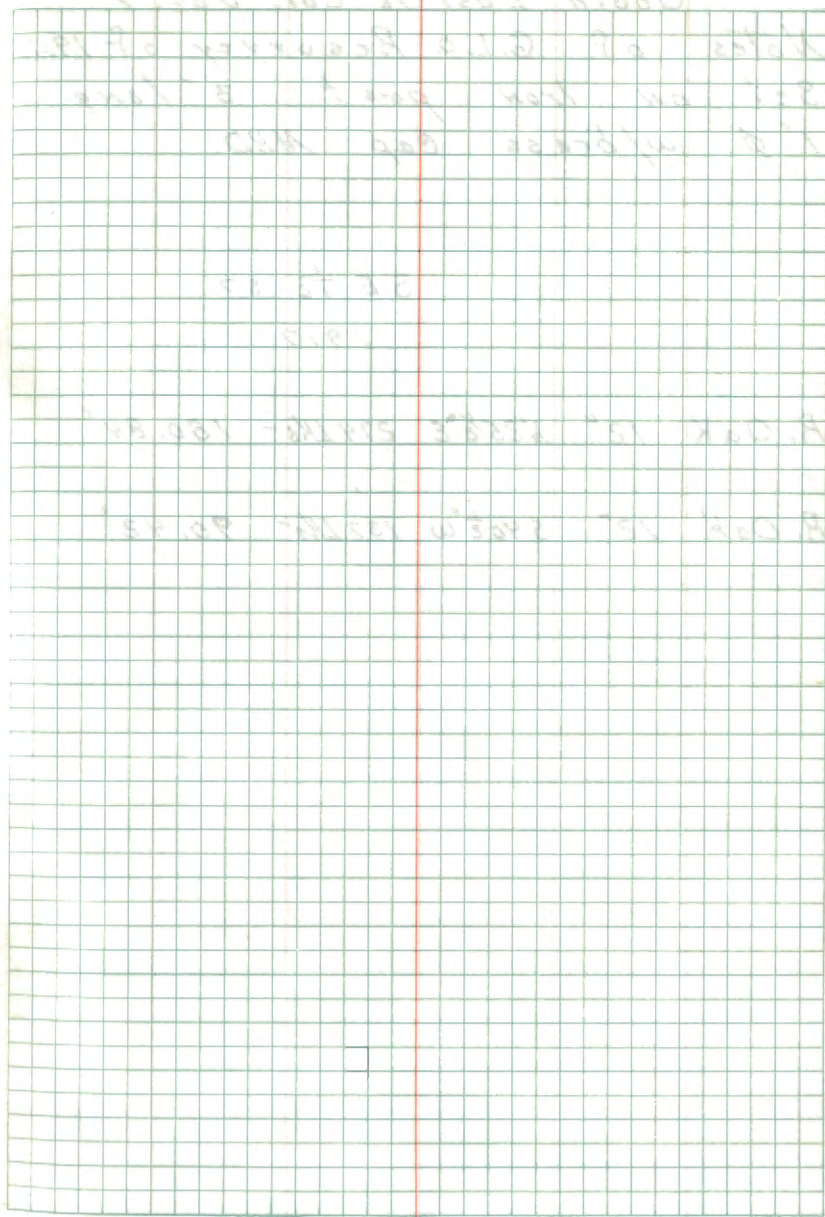

South East $\frac{1}{4}$ Cor. Sec. 7

Notes of G.L. & Resurvey of 1917.

Set an Iron post 3' long
1" ϕ w/brass cap MKD.

SE $\frac{1}{4}$ S7

1917

R. Oak 12" N25 $\frac{1}{2}$ °E 274 Lhs - 180.84'

R. Oak 12" S40 $\frac{1}{2}$ °W 137 Lhs - 90.42'

Angle point

Notes of G.L.O. Resurvey of 1917.

Set an Iron post 3' long 1" ϕ
w/brass cap MKD.669.24' North of Center East
 $\frac{1}{16}$ Cor. Sec. 7.

TR	37
1627	
APY	

1917

"No B.T.s"

North East $\frac{1}{16}$ Cor. Sec. 7

Notes of G.L.O. Resurvey of 1917.

Set an Iron post 3' long 1" ϕ
w/brass Cap MKD.

NE $\frac{1}{16}$ S7

1917

Oak 6" S53°E 77 Lks- 50.82'

Oak 6" S19 $\frac{1}{4}$ °W 12 Lks- 7.92'

Angle point.

Notes of G.L.O. Resurvey of 1917.
 Set an Iron post 3' long 1" ϕ
 w/brass Cap MKD.
 656.04' West of Center South
 $\frac{1}{16}$ Cor. Sec. 7.

TR 1272

AP3

TR

1597

57

1917

"No B.T.s"

31 Affidavit 8/17/78

C-5 Quarter Cor. Sec. 5-6

Notes of G.L.O. Resurvey of F 1917.

From remains of orig stake and B.T.s set an iron post 3' long 1" ϕ w/ brass Cap MKD.

Found Iron $\frac{3}{4}$ " Cap, in place

bent and buried in ground $\frac{1}{4}$

will try to straighten S6 | S5

and use G.L.O. monument

IRON 10" Above ground 1917

Orig B.T.

R. Oak 20" N48°E 56 Lks - 36.96'

Now large oak stump well rotted at brg.

and dist. no marks on stump

New B.T.

W. Oak 8" N74°W 228 Lks 150.48'

Now 14" W. Oak N74°W 150.5' scribe overgrown

scar on oak is facing more to north of corner

cut into oak and found center rotted also

found faint chop marks - this is bearing tree

Newly constructed fence line west and south from corner and old fence North and East

Corner is PI of road tangents south and East

old-new FSLP on post -
Post is turned tags face west

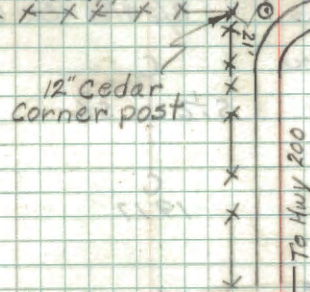

To perpetuate this corner I scribed 4 new bearing trees as follows.

12" W. Oak N71°W - 99.0' - SCRIBED $\frac{1}{4}$ S6 Bt.

10" W. Oak S14°W - 78.3' - SCRIBED $\frac{1}{4}$ S6 Bt.

10" W. Oak S30°E - 117.8' - SCRIBED $\frac{1}{4}$ S5 Bt.

10" Elm S60°E - 120.6' - SCRIBED $\frac{1}{4}$ S5 Bt.

72" steel sign post set due east 3.0' with ES. signs 54-2-54-4 attached.

4-2-74

Curtis R. Krause

Jack O. Sturdy

12/18/74

Wit. - corner - evidence & tra

Dorris E. Pepper RLS 5333

D-3

Center South $\frac{1}{8}$ Cor. Sec. 6

Notes of G.L.A. Resurvey of
1917. Set an iron post 3' long
1" ϕ w/ brass cap MKD.

Fd. iron pipe with brass 8/24/84-CK-GB

cap mkd. set in a leather

leaf bog in an upright $S\frac{1}{2}^{\circ}$ S6

position. B.C. is set 1"

above the water level.

C
1917

Poplar 7" $N54\frac{1}{4}^{\circ}E$ 406 Lhs - 267.96'

Poplar 7" $N60\frac{1}{4}^{\circ}W$ 606 Lhs - 406.56'

Too dangerous to look for BT'S at this time
because of the beaver activity.

Need 16' sign posts for BT'S

Chained from Angle Point 3, 648' south. Found
CS $\frac{1}{6}$ at bry. a distance. Monument falls
in a very boggy area. Beaver activity around
the outside perimeter of this bog.

Angle point

Notes of G.L.O. Resurvey of 1917.

Set an iron post 3' long
1" ϕ w/ brass cap MKD.648.12' North of Center
South $\frac{1}{6}$ Cor. Sec. 6.

Fd. iron pipe with brass 8/24/84 - CK, GB

cap mkd. set 14" above 1327

grd. in good condition. TR TR

Iron set in place. AP3

1404

56

1917

"No B.T.s"

MKD BT'S:

1. W. Oak 7" S51°W 28.15' AP3 S6BT

2. W. Oak 10" N49°W 29.25' AP3 S6BT

3. W. Oak 6" N6°W 53.85' AP3 S6BT

Placed two rocks around monument

Iron pipe is on the NW side of a 12" Cedar
corner post.Fence line runs east and south with 4 strands of wire
Chained from this angle point south to CS $\frac{1}{6}$. Distance
check good at 648.1'

Center Quarter Cor. Sec. 6.

Notes of P. G. L. O. Resurvey of 1917.

Set an Iron post 3' long 1" d
w/brass cap MKD.

Fd. iron pipe with 8/23/84 - GK, JA, GB

brass cap mkd. set

8" above ground. C $\frac{1}{4}$ S 6

Iron set in place. 1917

Poplar 10" N29°E 43.44s - 28.38'

Fd. well rotted popple stp. at bring & dist.

R. Oak 7" S27°W 68.14s - 44.88'

Fd. R. Oak 15" S27°W at 32.65 Believe

this is the BT recorded in 1917. No scar visible.

MKD. New BT'S:

1. R. Oak 8" S36°E 35.4' C $\frac{1}{4}$ S 6 BT2. W. Oak 8" S3°W 58.5' C $\frac{1}{4}$ S 6 BT

3. R. Oak 15" S27°W 32.65' Rescribed BT

4. R. Oak 10" N38°E 56.8' C $\frac{1}{4}$ S 6 BT

Placed three rocks around monument

Contractor Roger Mustonen set 8' steel sign posts

North 4.45', south 4.1', east 4.85' and west 4.15'

with both signs attached.

Line to std. goes north, south, east and west.

Corner falls down in the dip between two hills.
Corner is approx. 250' south of a grassy field.

Center North $\frac{1}{16}$ Cor. Sec. 6

Notes of G.L.O. Resurvey of 1917.

Set an iron post 3' long 1" ϕ
w/brass cap MKD.

8/23/84 - CK-JA-GB

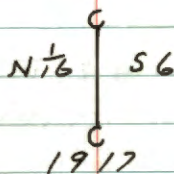
Fd. 1" iron pipe with
brass cap mkd set
16" above ground. Corner
set in place.R. Oak 6" S $43\frac{1}{2}^{\circ}$ E 344 Lts 227.04'R. Oak 10" S $59\frac{1}{2}^{\circ}$ E 456 Lts 300.96'

Mkd. New BT's:

W. Oak 8" S 35° E 26.70' CN $\frac{1}{16}$ S 6 BTW. Oak 12" S 6° W 36.20' CN $\frac{1}{16}$ S 6 BTR. Oak 13" N 80° W 20.55' CN $\frac{1}{16}$ S 6 BT

Not able to search for BT's at this time, because
of impassable beaver channel in the summer.
Contractor Roger Mustonen set 8' steel sign posts
North 3.0', east 3.4', west 3.0' and south 3.35'.
with both signs attached 11/5/85 JB
line to standard goes north, south, east and west

8/23/84 - fence line runs south and west from corner.
Corner is on the eastern slope of a knoll approx.
70' west of an open marsh

Center East $\frac{1}{16}$ Cor. Sec. 6

Notes of G.L.D. Resurvey of 1917.

Set an iron post 3' long 1" ϕ
w/ brass cap MKD.

8/23/84 CK, GB, JA

Fd. iron pipe with brass

cap mkd. set 1.0'

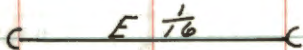
above ground in good  C

condition. Iron set

in place. 1917

"No B.T.'s"

Raise a mound of stone 2'
base 1 1/2' High North of Corner

Fd. rock mound north of corner.

Piled other rocks around corner.

Fence runs south and east from corner.

13" cedar corner post is south .6' from iron.

Fairly new 4 strand fence.

MKD. New BT's:

1. R. Oak 10" S52°E 38.70' CE $\frac{1}{16}$ S6BT2. W. Oak 8" N49°E 17.15' CE $\frac{1}{16}$ S6BT3. W. Oak 5" N14°E 32.35' CE $\frac{1}{16}$ S6BT

Center West $\frac{1}{16}$ Cor. Sec. 6

Notes of G.L.O. Resurvey of 1917.

Set an iron post 3' long
1" ϕ w/brass cap MKD.C $\frac{1}{16}$ C

56

1917

R. Oak 8" N52°E 36 Lks - 23.76'

No evidence

Poplar 12" S68 $\frac{1}{2}$ °W 25 Lks - 16.50'

Stump - rotten aspen at dist. & bearing

8/27/84 CK JA

Fd: 1" Brass capped Iron pipe 8" long

(top) broken off lying down beside

bottom part of iron pipe upright down

Placed top next to bottom base (in place)

Set: BTs

Red Oak 6" S87°E 57.6' } Blazed

W. Oak 7" N20°E 71.7' } + scribed
spl. tags
red line

W. Oak 10" N27°W 53.5'

Old Fence line North - electric fence S75°E

Open field North approx 250'

Contractor Roger Mustonen set 8" steel sign posts
east 2.9' and north 3.8' with both signs attached.
Line to standard goes north and east 11/5/85 JAB

Special Meander Cor. Sec. 6
South Shore Little turtle Lk.

Notes of G.L.O. Resurvey of 1917.
Set an iron post 3' long
1" ϕ w/brass cap MKD.

Fd. iron pipe with brass 8/23/84 - CK, J.A.G.

cap mkd. set 16" E S M C

above ground in good 56 56

condition. Corner falls

8' south of shore of Little E
1917

Turtle Lk. at the toe of a steep bank going south.

Birch 6" S 9° E 40 Lks 26.40'

Fd. clump of birch growing out of stump.

Birch 6" S 2° W 22 Lks 14.52'

Well rotted Birch roots at bring + dist

Special Meander Cor Sec 6
West shore Little Turtle Lk.

Notes of G.L.O. Resurvey of 1917.

Set an Iron post 3' long
1" ϕ w/ brass cap MKD.

Fd. iron pipe with 8/23/84-CK, GB, JA

brass cap mkd set

16" above grd. in N 56 | N 56

good condition, Iron 56

set in place.

R. Oak 10" N52 $\frac{1}{2}$ W 35 Lks 23.10'

Fd. 12" R. Oak N52W 22.1

Poplar 6" S33W 32 Lks 21.12'

Fd. poplar stp. well rotted at brg. & dist.

Corner falls approx. 20' west of shore
of Little Turtle Lake.

Monument in winter. W. Oak BT's.

South west $\frac{1}{16}$ Cor. Sec. 6

Notes of G.L.O. Resurvey of
1917. Set an iron post 3'
long 1" ϕ w/ brass Cap MKD.

Fd. iron pipe with 8/29/84-CK, GB

B.C. mkd, set 8" above

grd. in good condition. SW $\frac{1}{16}$ S6

Iron set in place. 1917

Fd. some deep pits in iron pipe directly above ^{the} ground.

R. Oak 8" N31 $\frac{1}{2}$ °E 195 Lks- 128.70'

Fd. R. Oak 13" N32°E 128.70' scar visible

R. Oak 8" N8 $\frac{1}{4}$ °E 165 Lks- 108.90'

Fd. R. Oak 22" N8°E 108.90' scar visible

Mkd. New BT'S.

W. Oak 10" N50°E 37.30' SW $\frac{1}{16}$ S6 BT

W. Oak 6" S51W 76.70' SW $\frac{1}{16}$ S6 BT

Corner falls on the eastern edge of a small bowl shape depression.
Old down fence runs south of corner.

Affidavit 8/17/78

B-2 North west 1/4 Cor. Sec. 6

Notes of G.L.O. Resurvey of 1917.

Set an Iron post 3' long 1" ϕ w/ brass cap MKD.

Found Iron $\frac{3}{4}$ cap, in place, in good condition 10" above ground 1' West of 8" Cedar Cor. post.

Fence line East $\frac{3}{4}$ South NW 1/4 S6

corner is in aspen $\frac{3}{4}$ oak 1917

At NORTH end of small brush swamp

Pine 6" S11°W 244 Lhs - 161.04'

No evidence found at brq. $\frac{3}{4}$ distance.

To perpetuate this corner I scribed 3 new bearing trees as follows

W. Oak 9" N65°E 37.2' scribed NW 1/4 S6 Bt.

W. Oak 10" N4°W 58.7' " NW 1/4 S6 Bt.

W. Oak 8" N53°W 85.5' " NW 1/4 S6 Bt.

72" steel sign post set due East 2.6' with F.S. signs 54-2-54-4 attached.

4-3-74

Jack O'Grady Curtis R. Kramer

Found FSLP on 6" Aspen 524 W 6.6' 1969

Also FSLP on 8" W. OAK 285' South of corner

on north side of woods trail to old field

12/18/74 Wit. Corner - evidence

& ties

Donna E. Papp RL 5 5333

Contractor Roger Mustonen set 8' steel sign posts east 3.0' and South 4.7' with both signs attached. Line to std. goes east and south. 11/5/85 NB

Section Cor. 12.7.13.18

Notes of G.L.O. Resurvey of 1917

From remains of Orig B.T.s.

Set an Iron post 3' long

2" ϕ w/brass Cap MKD.

T 141 N

R30W R29W

S12 S7

S13 S18

1917

"Orig B.T.s"

W. pine stump 26" N65°W 54 Lks - 35.64'

W. pine stump 30" N48½°E 12 Lks - 7.92'

W. pine stump 30" S68°W 78 Lks - 51.48'

"New B.T.s"

W. Oak 8" N32¾°E 408 Lks - 269.28'
rotted stumpSpruce 4" S87½°W 665 Lks - 438.90'
no evidenceTam 4" N82¼°W 425 Lks - 200.50'
in ditch (road got it)

5/8/81 CK GB WO

Fd: GLO brass capped Iron pipe .5' under
road intersection in good conditionChained to sec lot from S½ 7-12 - dist. OK
BTS:

Oak stump rotted NE

Set: left monument as found

BTS:

W. Oak 5" N33W 105.46' "S12 BT" spike tag red ring

W. Oak 7" S12W 153.15' } Blayed & Scribed
Twin W. Oak 12" N52E 113.86' } spike tags
R. Oak 10" S56E 81.79' } red ringCorner falls in intersection county road N-W
Woods road East and TSP. road South.

South $\frac{1}{16}$ Cor. Sec. 12-7

Notes of G.L.D Resurvey of 1917.
Set an Iron post 3' long
1" ϕ w/brass Cap MKD.

S $\frac{1}{16}$
S12 | S7
1917

R. Oak 18" N40°E 38 Lks 25.08'

NO EVIDENCE WAS FOUND

W. Oak 12" N66 $\frac{1}{4}$ °W 136 Lks 89.76'

NO EVIDENCE WAS FOUND

FROM CORNER CARD 9/2/88 CK

WILLIAM N OLSON 7/16/80

FOUND GLO MONUMENT IN ROAD WITH BRASS CAP SHEARED

OFF - REPLACED WITH F.S. IRON PIPE 2" x 24" WITH BRASS

CAP MARKED - MONUMENT IS

12" BELOW ROAD SURFACE

MARKED NEW BT'S.

T141N
R30W R29W
S $\frac{1}{16}$
S12 | S7
1980

R. OAK 9 N40W 69.65' MKD S $\frac{1}{16}$ S12 BT

W. OAK 9 S47W 86.26' MKD S $\frac{1}{16}$ S12 BT

W. OAK 6 S60E 43.88' MKD S $\frac{1}{16}$ S7 BT

LINE TO STANDARD WEST OF CORNER

Affidavit 8/17/78

G-25 Quarter Cor. Sec. 12-7.

Notes of G.L.O. Resurvey of 1917.

Set an Iron post 3' long 1"

Ø w/ brass cap MKD.

Set From remains of orig

stake and B.T.s

Found 19" of G.L.O. IRON

BRASS CAP SHEARD OFF

but remainder is in S12 57

original location

set base of G.L.O. IRON BY NEW 1917

"Orig B.T.s"

poplar stump 10" S56°E 25 Lks - 16.50'

"New B.T.s"

poplar 6" S32½°E 112 Lks - 73.92'

Falls in road

R. Oak 12" S66½°W 62 Lks - 40.92'

Found 4' High stump top broken off AT BRG-DIST.

cut into this stump and Found flat area

of scribe, interior of stump is rotten

and froze at this time, so we don't try

pick away to find scribe as this could

destroy any marks

PUT FSLP ON 5" RED OAK S4°E 18.6'
 CORNER FALLS AT SOUTH EDGE OF OPEN GRASS
 SLOUGH AND APPROX. 125' NORTH OF CURVE TO
 NE IN ROAD FSLP ON SAME IN GOOD CONDITION 8/2/88 CK

to perpetuate this corner I set a 2" DIA.
 5' long GAL. STEEL PIPE, with 3" DIA. BRASS
 tablet stamped.

3-28-74

Curtis R. Kramer,
Jack O. Landry

Witnessed by.

6" RED OAK N80°W - 95.6' - SCRIBED ¼ S12 BT.

8" RED OAK S73°W - 74.1' - SCRIBED ¼ S12 BT.

10" RED OAK S38°W - 40.0' - SCRIBED ¼ S12 BT.

7" RED OAK S1°E - 29.7' - SCRIBED ¼ S7 BT.

SET 72" STEEL SIGN POST DUE NORTH 2.4' WITH
 FS SIGNS 54-2E 54-4 ATTACHED

Wil. Corner - evidence 9 ties

Norm E. Pepper RLS 5333

8/2/88 CK-RM

FD. F.S. MONU. LYING IN SLOUGH GRASS - NOT IN PLACE - RESET FROM
 4 BT'S. IN GOOD CONDITION AS FOLLOWS2" X 5" GALVANIZED PIPE IN TRUE CORNER POSITION 18" HIGH WITH
 LOWER PIECE OF G.L.O. IRON AT NORTH SIDE OF 2" IRON WITH CAP

NOW R. OAK 10 N80W 95.6' SCRIBE OVER GROUND SPK + TAG

" R. OAK 12 S73W 74.1' " " " " "

" R. OAK 14 S38W 40.0' " " " " "

" R. OAK 10 S1E 29.7' " " " " "

8" STEEL POST SETS 4.02' WEST WITH BOTH SIGNS
 LINE TO STANDARD TO WEST OF THIS CORNER. WINTER OF 87
 G.L.O. OAK STUMP AT S66W 40.9' IS NOW WELL ROTTED AND CENTER IS
 BADLY DECAYED

North $\frac{1}{2}$ Cor. Sec. 12-7

Notes of G.L.D. Resurvey of 1917
Set an Iron post 3' long 1" ϕ
w/brass Cap MKD.

N $\frac{1}{2}$
S12 | S7

1917

R. Oak 14" N40°E 55 Lks 36.30'

CURO - FOUND ROTTED REMAINS OF R. OAK STUMP N40E-36.0'

W. Oak 10" N36 $\frac{3}{4}$ °W 298 Lks 196.68'

CURO - FOUND 24" W. OAK STUMP N36W 166.7'

CURO CONTRACT 1981

11/10/81 W.C. P.J.

NO MONUMENT WAS FOUND - REMOVED BY ROAD

CONSTRUCTION COUNTY ROAD #124

SET NEW F.S. 2" X 24" IRON PIPE WITH BRASS CAP MKD.

T14N
R30W R29W
N116
S12 | S7
1981
RLS NO 11395

MARKED NEW BT'S.

R. OAK 6 N38W 51.05' Now 7" X 6 FT SNAG

R. OAK 7 N76W 36.32' Now 9" STANDING DEAD

R. OAK 7 S55W 46.26' Now 11" X 5 FT SNAG

8' STEEL SIGN POST WEST 26.2' SIGNS

CORNER IS 1.0' EAST OF CENTER LINE OF COUNTY ROAD
#124

3-31-99 R. OAK

FD CURRO IRON IN PLACE \pm 6" UNDER ROAD SURFACE.
MARK NEW WITNESSES AS FOLLOWS.

W. OAK (CUMP) 8" N47°E 34.93 FT TO SPKAKD: 57 FT

R. OAK 18" N34°E 116.17 FT TO SPKAKD: NOT MKD

OLD HOMESTEAD NORTHEAST OF CORNER. FOUR
INDIAN GRAVES \pm 40 FT EAST OF CORNER.

Angle point

Notes of G.L.D. Resurvey of 1917.
 set an Iron post 3' long 1" dia
 w/brass cap MKD.
 660.0' North of N $\frac{1}{16}$ Cor
 512 - 57

	TR	
	TR	1216
1286	AP4	57
512	AP2	
	TR	
		1211
		1817

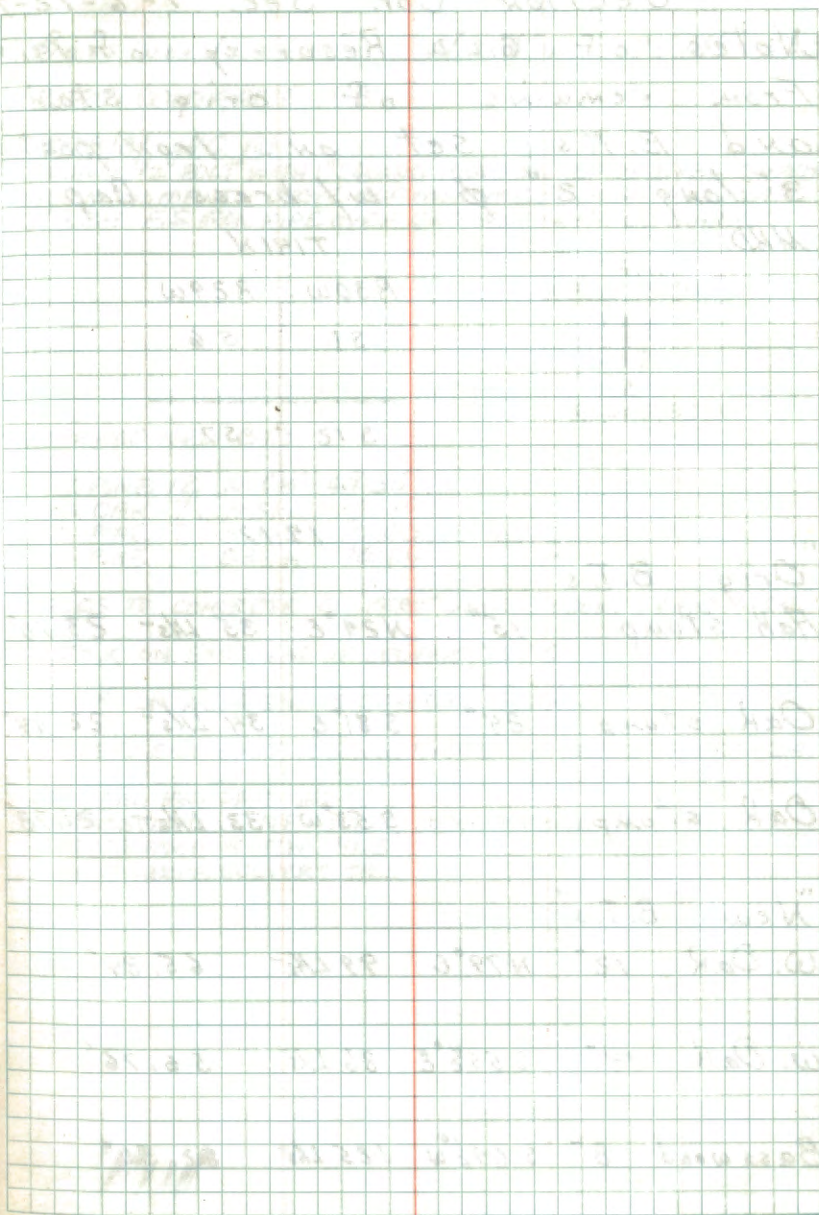

Section Cor. Sec. 1-6-12-7

Notes of G.L.D. Resurvey of 1917
 From remains of orig stake
 and B.T.s set an iron post
 3' long 2" ϕ w/ brass cap
 MKD.

T141N	
R30W	R29W
51	56
512	57
1917	

"Orig B.T.s"

Hick stump 15" N29°E 35 Lks - 23.10'

Oak stump 24" S81°E 34 Lks - 22.44'

Oak stump S53°W 33 Lks - 21.78'

"New B.T.s"

W. Oak 12" N79°E 99 Lks - 65.34'

W. Oak 14" S55½°E 86 Lks - 56.76'

Basswood 8" S69½°W 125 Lks - 82.19'

Basswood 10" N37½°W 96 Lks - 63.36'

CURO CONTRACT 1981

10/28/81 WC RJ

FOUND ½" BOLT WITH 1" SQUARD HEAD ON TOP OF 2"X36" CAPPED
 GLO MONUMENT - DROVE GLO MONUMENT DOWN AND PLACE
 2"X24" F.S. IRON PIPE OVER GLO IRON - WITH CAP MARKED

T141N	
R30W	R29W
116	
1217	
1981	
RLS NO 13395	

MARKED NEW BT'S.

N. PINE 12 N10W 69.35'
 R. OAK 7 N36E 101.10'
 J. PINE 7 S46E 91.03'
 N. PINE 7 S38W 70.64'

TIES TO CONCRETE CULVERT UNDER COUNTY ROAD #124

TO X ON EAST END OF CULVERT 57.5'

TO X ON WEST END OF CULVERT 55.6'

8' STEEL SIGN POST 102' NORTH AND 33' WEST OF SEC. COR.

1941 MN. HWY DEPT TIES

BASSWOOD 5 NE 111.8' SPIKE ON SIDE
 BASSWOOD 8 NW 91.5' " " "
 AND ABOVE CULVERT TIES

D-25

South $\frac{1}{16}$ Cor. Sec. 1-6

Notes of G.L.O. Resurvey of 1917

Set an Iron post 3' long 1" ϕ
w/brass Cap MKD.

	S $\frac{1}{2}$	
S1		S6

1917

Oak 12" S37°E 56 LHs - 36.96'

CURRO - NO TRACE OF BT REMAINS

Oak 12" S39 $\frac{1}{2}$ °W 242 LHs - 159.72'

CURRO - NO TRACE OF BT REMAINS

CURRO CONTRACT 1981

9/14/81 WC PJ

FOUND IRON AND CAP - IN PLACE - IN GOOD CONDITION

MARKED NEW BT'S.

MAPLE 7 N56°58'E 50.97'

MAPLE 5 S61°16'W 41.38'

REDOAK 8 S27°34'W 58.31'

8' STEEL SIGN POST NORTH 3.0' BOTH SIGNS

CORNER IS 11' WEST OF FR#3744

Quarter Cor. Sec. 1-6
 Notes of G.L.D. Resurvey of
 1917. Set an Iron post 3' long
 1" ϕ w/ brass cap MRP.

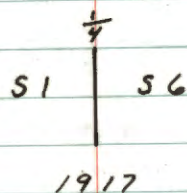

Pine 12" N11 $\frac{3}{4}$ °E 110 Lbs - 72.60'

CURO FOUND 14" PINE SNAG N12°20'E - 72.16' (OLD TAG)

Oak 6" S60 $\frac{1}{2}$ °W 67 Lbs - 44.22'

CURO FOUND OAK STUMP HOLE REMAINS S60W 44.2'

CURO CONTRACT 1981

9/11/81 WC PJ

FOUND IRON AND CAP - IN PLACE - IN GOOD CONDITION

MARKED NEW BT'S.

R.OAK 12 N10 $\frac{1}{2}$ °W 30.00'

W.OAK 5 S82°03'W 50.73' NW 8 $\frac{1}{2}$ " 9-15-99

W.OAK 12 N78°11'E 57.75' NW 14" 9-15-99

8' STEEL SIGN POST SOUTH 2.4' BOTH SIGNS

83.5' WEST OF N+S ~~TEEN~~ ROAD - FR # 3744

9-15-99 R.M.AIN

FD MONUMENT AND SIGN POST IN GOOD CONDITION.
 R.OAK N10W 30 FT NW AS SNAG MARK ONE NEW BT.
 CORNER IS \pm 70 FT NORTH OF GRASS SLOUGH.

W.OAK 10" S26°W 44.82 FT TO SPR MRO: 51 BT

ADD 8 FT STEEL SIGN POST 3.3 FT NORTH

Angle point

Notes of G.L.O. Resurvey of 1917.

Set an iron post 3' long

1" ϕ w/ brass cap MKD.

652.08' North of Quarter Sec 1-6

	TR	
	1287	TR
SI	FP4	1477
	FP1	56
	TR	
	1667	1917

CURRENT CORNER INFO BK#5 Pg#50

North $\frac{1}{16}$ Cor. Sec. 1-6
 Notes of G.L.O. Resurvey of 1917.
 Set on Iron post 3' long
 1" ϕ w/brass Cap MKD.

N $\frac{1}{16}$
 S1 | S6
 1917

Oak 16" S29 $\frac{1}{2}$ °E 51 Lks- 33.66'

CURD FOUND ROTTED REMAINS IN STUMP HOLE S40°E 33.16'

Pine 16" N48 $\frac{1}{2}$ °W 70 Lks- 46.20'

CURD FOUND ROTTED PINE STUMP WITH SCRIBE BT N88°W 46.2'

CURD CONTRACT 1981

9/14/81 WC-PJ

NO MONUMENT WAS FOUND - TAKEN OUT BY ROAD CONST.

SET NEW MONUMENT 2" X 36" IRON PIPE WITH CAP MKD.

T141N
 R30W R29W
 N $\frac{1}{16}$
 S1 | S6
 1981

RLS NO 11395

MARKED NEW BT'S.

R.OAK 8 N51°18'W 17.68

R.OAK 8 S18°21'W 41.35'

R.OAK 10 S79°16'E 60.15'

8' STEEL SIGN POST SOUTH 3.0' BOTH SIGNS

CORNER IS 15' SOUTH OF OLD TRAIL NW $\frac{1}{4}$ SE

1-31-2000 R. MAIN

Add 8 FT STEEL SIGN POSTS 30 S WEST 20 N NORTH
 LINE TO STANDARD WEST AND NORTH OF CORNER

Meander Cor. Sec. 1-6

Notes of G.L.O. Resurvey of 1917.

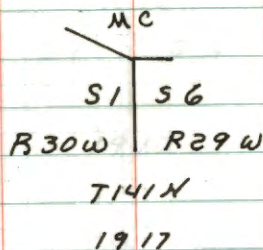
Set an Iron post 3' long 1" ϕ
w/ brass cap MRD.Set From Orig stake and
B.T.s.

"Orig B.T.s"

Cedar stump 14" $S6\frac{1}{2}^{\circ}E$ 23 Lks - 15.18'Cedar 12" $S13^{\circ}W$ 47 Lks - 31.02'

"New B.T.s"

Birch 6" $S0^{\circ}30'E$ 431 Lks - 284.46'
NO EVIDENCEOak 10" $S35^{\circ}W$ 271 Lks - 178.86'
NO EVIDENCE

1-18-2000 R MAIN

FD GLO IRON IN PLACE TIPPED OVER IN
TALL GRASS OF SHORE, LEECH LAKE. STRAIGHTEN
IRON AND DRIVE 8 FT STEEL SIGN POST ALONG
IRON AND WIRE MONUMENT TO SIGN POST
IRON AND SIGN POST UP 6" ABOVE GROUND.
WITNESS WITH 8 FT STEEL SIGN POST 406 FT
SOUTH LINE TO STANDARD SOUTH OF CORNER

A-19 Quarter Corner Sections 2-35

Twp. 141-142N, Range 30 W

Found.

- ① A 1" ϕ iron post with G.L.O. Brass Cap stamped:-
 $\frac{1}{4}$ S 35
 S 2
 1917
- ② Jack pine 11" with blaze facing corner but scribe decayed N20°W 2.0 feet.
- ③ Jack pine 12" with scribe $\frac{1}{4}$ S 2 8" visible S52°W 56.76 feet - call of G.L.O. notes is 3" J Pine S54½°W 86 1ks or 56.76 feet.

to perpetuate this corner I marked new:-
 Jack pine 11" N19°E 18.0' mkd $\frac{1}{4}$ S 35 BT
 Jack pine 12" S52°W 56.76' - MKD BT
 Steel sign post 72" Long with sign 54-4 attached S89½°E 2.75 feet

9-25-62 R.H. McDonald

G.L.O. has white oak 3" N35°E 65 1ks

Set sign 54-2 on same steel post

4-29-64

W.H.O.

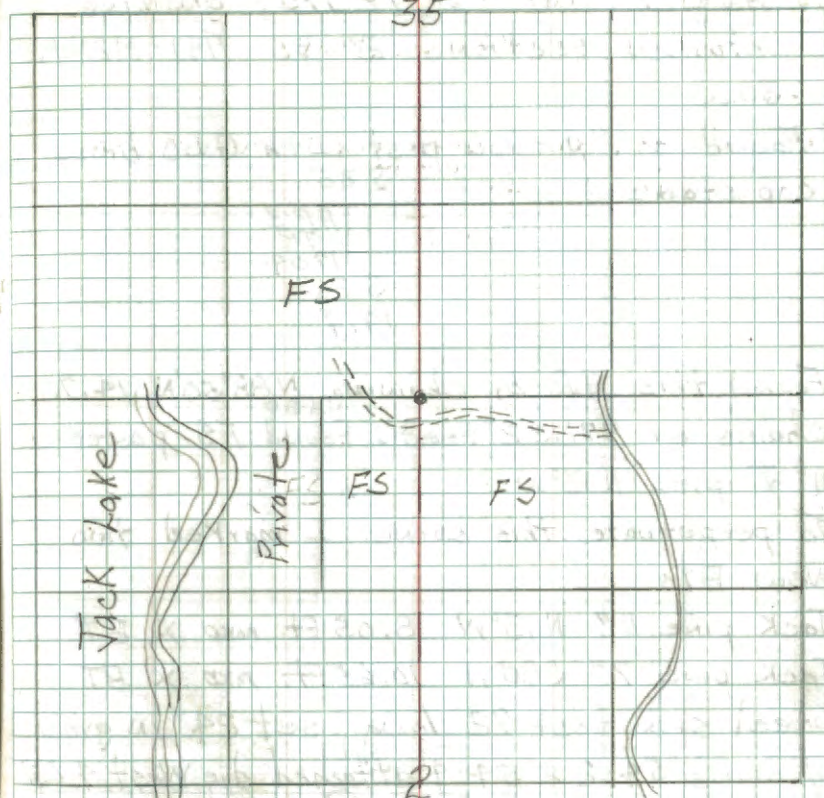

G.U.R.O. CONTRACT 1981

10/20/81 W.C. P.J.

FD. IRON Y-CAP IN PLACE - IN GOOD CONDITION

FD. 1962 J. PINE WIND FALL AT NITE 18.10' WITH BT TAG

MARKED NEW BT'S.

J. PINE 9 NSW 39.65'

R. OAK 9 NZSE 43.31'

W. OAK 3 S85E 42.43'

8' STEEL SIGN POST NORTH 3.0' BOTH SIGNS

8' STEEL SIGN POST EAST 3.0' " "

54 A-18,19

Angle Point #3 Tr 1704 on line
between sections 2-35 T141-142NR
30W

① Found a 1" ϕ iron post with GLO brass
cap stamped

S 35
AP 3
TR
1704
S 2
1917

Found this A.P. by chaining N88°50'N 14.72
Chains or 971.52 feet. Found FS. poster on
11" J. pine N13°W

To perpetuate this corner I marked two
New BTs

Jack pine 11" N13°W 8.05 ft. MKD X BT

Jack pine 7" S80°W 10.65 ft. MKD X BT

Steel sign post 72" long, set 24" in ground

W/ signs 54-2 & 54-4 attached due West 4.65'
9-25-62 RHM

1/11/84 GB JA

Fd corner

Set: Steel sign post B' South 5.15'

Steel sign post C' West 4.7'

Affidavit RHM

35

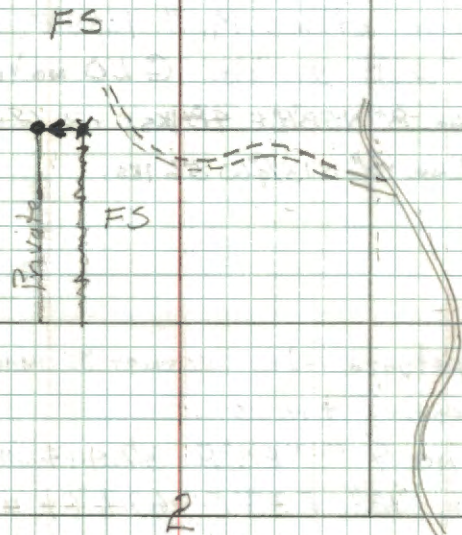

6/16/83 CR JA GB

Fd: iron pipe with B.C. set 8" above ground
by chaining from wire between sec 2 & 25 S89E

BTs:

J. Pine 13" N13W 8.05' scribe visible

J. Pine 11" S80W 10.65' scribe closed

marked BTs:

R. Pine 22" S82°E 66.6' marked AP S.2 BT

Corner approx. 180' north of a private road

324.06

A-18 West 1/16 Sections 2-35 T141-142N
R30 W

① Found a 1" ϕ iron post with GLO Brass
cap stamped: - W $\frac{1}{16}$ $\frac{\$35}{\$2}$
1917

② Jack pine stump 14" N58°E 31.6 feet w/
scribe "B" visible GLO notes call for
Jack Pine 8" N58½°E 48 lks. or 31.68 ft
Norway Pine 10" S13¼°W 56 lks.

To perpetuate this corner I marked two
New Bearing trees

Jack pine 9" N8½°E 37.4 ft, MKD W 1/16 S35 BT

Red pine 12" S33°E 69.6 ft, MKD W 1/16 S2 BT

Steel sign post 72" long, set 24" in ground
w/ signs 54-2 & 54-4 attached due East 4.65'

9-25-62 RHM Donald

1/11/84 GB TA

Fd corner

steel sign post 6' east 4.7' Aug 13 by signs

35

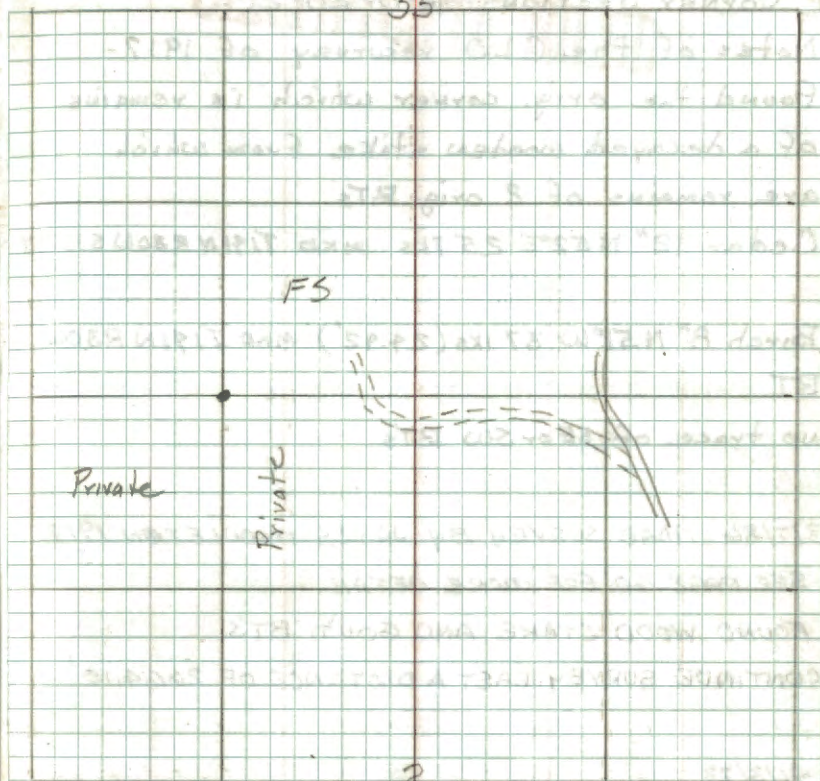

6/16/83 CK TA GB

Fd: iron pipe 8" above set in place

BFS:

J. Pine 11" N09°E 37.4 scribe visible

N. Pine 17" S31°W 69.6 scribe overgrown

J. Pine GLO stamp N59°E 31.68 RT blaze visible

N. Pine GLO stamp S13°W 36.96 scribe visible

Set:

J. Pine 10" S45°W 39.55' w/ no 52 BT spe tag red ring

Corner falls approx 225' North of a private road
that ends at a house

Corner Sections 16-17-20-21

Notes of the GLO resurvey of 1917-
Found the orig. corner which is remains
of a decayed wooden stake from which
are remains of 2 orig. BTs

Cedar 12" N52°E 251ks MKD T191NR30WS16BT

Birch 8" N51°W 371ks (24.42') MKD T191NR30W
BT

No trace of SE or SW BTs

3/7/86 ROAD SURVEY BY JAMES MIDDLETON 1914

SEE PAGE 60 FOR MORE DETAIL

FOUND WOOD STAKE AND GOVT. BT'S.

CONTINUE SURVEY EAST A DISTANCE OF 2664.10'

4/13/73

CHAINED TO THIS LOCATION FROM APPROX 1/4 COR. TO E
2660' FD. FSLD ON DEAD TWP. 7" AS APPROX. COR. 1947
NO EVIDENCE FOUND AT THIS TIME - OUT OF TIME TODAY

CERTIFICATE FILED

N-1/4 Quarter Corner Sections 16-21

orig Govt Survey notes

Wooden Post

White pine 30"N14½°E 123 lks. (81.18')

White pine 30" S76E 56 lks. (36.96')

Notes of GLO resurvey of 1917 - find remains of decayed wooden stake - orig corner - and stumps of the two original BTs at reported dist. & bearing. Both stumps marked BT.

Chained west from sec. Corner 15-16-21-22 2640' as Call For in orig Notes and also chained East to this Corner from evidence found at sec Corner 16-17-20-21 but No evidence of orig stumps. Dist. from both direction were very close to same area, along time resident of area said at one time this Corner was reset w/ new B.T.'s and post by County Surveyor. For the purpose of surveying the road, thru the Center of Sec 21.

11-25-64
James Ekstun

CERTIFICATE FILED

3/7/86 ROAD SURVEY BY JAMES MIDDLETON 1914
SEE PAGE 60 FOR MORE DETAIL
FOUND WOOD HUB FOR CORNER & BOTH GOV'T. BTs;
W. PINE 30 STUMP OF WINDFALL N14E 123 LKS,
W. PINE 30 STUB OF S76E 56 LKS.
CONTINUE SURVEY EAST A DISTANCE OF 2668.30'

4/19/73 CK

CHAINED FROM C/4 SEC. 16 SOUTH 2690' - FELL ON W SIDE 50'
OF OLD ROAD TO SOUTH - THEN CHAINED WEST 2660'
TO SEC. COR. - 1/4 COR. SHOULD FALL ON E SIDE OF ROAD
SOUTH - NO EVIDENCE FOUND TODAY
FD. BURNT & ROTTED PINE STUMPS IN AREA
PUT FSLP ON 5" ELM - 15' NORTH AS APPROX. 1/4 COR.

N-13, Corner Sections 15-16-21-22

Notes of original govt. survey of 1873

Yellow Pine 20" N26°E 33 lks. (21.78')

White Pine 12" N69°W 45 lks. (29.70')

Yellow Pine 16" S18°W 49 lks. (32.34')

Yellow Pine 18" S47½°E 104 lks. (68.64')

Notes of G.L.O. resurvey of 1917 - Find a wooden stake 4"x4"x24" and the stumps of the 4 orig. BT's agreeing with the reported dist. & bearing, No scribe marks visible. Accept the wooden stake as true pt. for Cor.

Chained South From a G.L.O. brass Cap ¼ Cor Sec's 15 & 16 40.40 Chains as they Call For. Found three stumps at this location w/ scribe being visible. also a F.S.L.P. set up in 1939. believe these stumps were put there by a County Surveyor. unable to tie any in for orig bearing & dist.

11-25-64

James E. Johnson

SEPT 15, 1978

STEFAN OLESEN

By SURVEY BY STEFAN PLACED
6" X 6" X 24" CONCRETE POST 4" BELOW
WOODS ROAD SURFACE, WITH BRASS
TABLET STAMPED AS FOLLOWS:

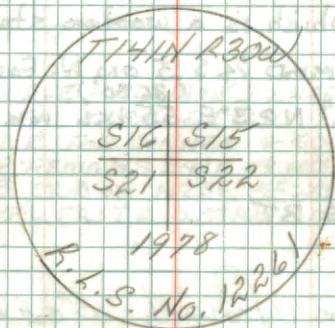

FROM WHICH THE FOLLOWING BEAR:

6" RED OAK N33E, 71.72'

8" RED OAK S43E, 12.61'

6" WHITE OAK S53⁵⁸W, 79.48'

6" RED OAK N39W, 18.92'

Stake Post 16.5' North with 54-4
3/7/86 ROAD SURVEY BY JAMES MIDDLETON 1914
SEE PAGE 60 FOR MORE DETAIL
FOUND WOOD STAKE AT CORNER & GOVT. BT'S,
YELLOW PINE 20 STUMP OF N26E 33 LKS,
WHITE PINE 12 STUMP OF N64W 45 LKS,
YELLOW PINE 16 STUMP OF S18W 49 LKS,
YELLOW PINE 18 STUMP OF S47E 104 LKS,
CONTINUE SURVEY EAST A DISTANCE OF 2766.20'

59 N-15

Quarter Corner Sections 15-22

Notes of Orig Gov't Survey of 1873.

Post

Yellow Pine 18° S 49° E 19 lks.

Yellow Pine 13° N 23° E 55 lks.

Notes of GLO resurvey of 1917 - Find the orig. 1/4 cor. which is a wooden stake 3"x3"x24" above ground mxd 1/4 S 15 on N. Face. 1 orig BT

Pine (dead) 16" N 23° E 55 lks mxd 15

No trace of SE BT

No evidence found, searched two Man hours.

11-27-64

James E. Clifton

REMONUMENTATION BY SURVEY OF 1978 BY MILO E. STEFAN:

SET A 5' X 6" DIA. CONCRETE POST 36" IN GROUND WITH BRASS CAP STAMPER

AS FOLLOWS:

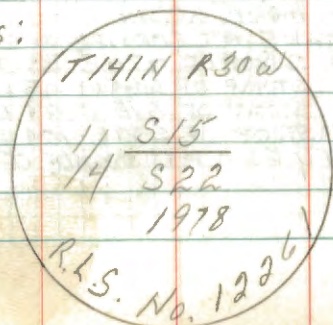

FROM WHICH THE FOLLOWING BEARS:

WHITE BIRCH 9" S 37° E 18.51'

RED OAK 13" S 80° W 47.99'

RED OAK 12" N 54° W 108.29'

STEEL POST 2' Long with sign 54-4 North 1.9'

3/7/86 ROAD SURVEY BY JAMES MIDDLETON 1914

SEE PAGE 60 FOR MORE DETAIL
FOUND WOOD HUB FOR CORNER & GOVT. BT'S.

YELLOW PINE 18 REMAINS S 48° E 19 LKS.

YELLOW PINE 13 STUB OF N 23° E 55 LKS.

CONTINUE SURVEY EAST A DISTANCE OF 2499.70'

60 SEE PAGE 69 THIS BOOK

Quarter Corner Sections 18-19

Notes of original Gov't. Survey of 1873 -
Post

Tamarack 6" N 8° E 92 lks.

Tamarack 3" S 19° W 33 lks. (21.78')

Notes of GLO resurvey of 1917 - reestablish
corner from remains of the SW BT which is
a Tamarack stp. 4" dia. mxd BT. set a Temp.
wood stake at pt. for corner.

3/7/86 NOTES IN CASS COUNTY COURTHOUSE
OF ROAD SURVEY BY JAMES MIDDLETON 7/3/1914
THRU 7/18/1914 BOOK B SURVEY RECORD # 343
PLAT ON PAGE 516 & NOTES ON PAGES 517-520
SURVEY STARTED AT THIS CORNER AND CONTINUED EAST
FOUND STAKE SET BY COUNTY SURVEYOR
FROM ORIGINAL BT'S.
BEGIN STATIONING AT THIS CORNER STA. 000+00.0'
TO SECTION CORNER EAST A DISTANCE OF 2553.40'

CERTIFICATE FILED

COUNTY TIES EAST ALONG SEC. LINE
270' LV. TAM. SWA - 4.70' BRAINERD & LEECH LAKE ROAD
1700' BROOK 10 LKS. WIDE - FLOWNE - 18.50 ENT. ROUND MARSH
1975' LV. MARSH 2553.4' SEC. COR.

61 R-5

Corner Sections 19-20-29-30

Notes of orig. Govt Survey of 1873

- ① Yellow pine 15" N49½°W 50 lks or 33.0 Feet
- ② White pine 10" S20½°W 38 lks or 25.08 Feet
- ③ White pine 13" S43°E 11 lks or 7.26 Feet
- ④ Tamarack 12" N46°E 66 lks or 43.56 Feet

No evidence of orig. B.T.'s Found.

CASS COUNTY SURVEY #467 BOOK C BY E.B. HORST

PAGE 466 - SET 2½" X 48" IRON MONUMENT 1920

C-C Notes From 1937, they found
a 2" iron pipe in good condition
16" above ground. Metal Location
Poster on a (6" Oak N50°E
9.90')

Found a 2" diam. pipe at Old Fence
Corner. - Fence runs west & south

10-5-64

James Ekstrom

From C.C. Book #102 p25

10" N. Pine N34°W 64 lks - Now rescribed
as new B.T.

Affidavit

2/12

To perpetuate this Corner I set a
2" inside dia 5 Foot long galvanized
steel pipe Filled w/ Concrete &
Capped w/a 3" dia bronze Tablet
stamped.

T141N R30W

519 520

530 529

1965

ALS NO. 6807

From which bears

N Pine - 20" N34°W 42.5' Scribed 519 BT

Ash - 8" N65°E 24.1' Scribed 520 BT

Maple - 4" S44°E 10.4' Scribed 529 BT

Oak - 14" S52°W 10.3' Scribed 530 BT

steel sign post 72" long set 24" in
ground with signs 54-2 & 54-1 attached
due west 3.6'

James Ekstrom
7/19/65

5-19-65
James Ekstrom

62 N-5

Corner of Sections 17-18-19-20

Notes of original Govt. survey of 1873

White pine 24" S57 $\frac{1}{2}$ °E 371ks 24.42

poplar 12" S55W 771ks.

poplar 7" N42 $\frac{1}{2}$ °W 1071ks

White pine 24" N26°E 2271ks. - 149.82

Notes of the GLO resurvey of 1917 - Found
the orig. corner which is a decayed wooden
stake from which are remains of SE & NE BT's.

Pine stump 24" S67 $\frac{1}{2}$ °E 371ks. (24.92)

Pine stump N26°E 2271ks (149.82)

No evidence of orig BT's, Found
a F.S.L.P. is on post on North
side of old road that was put up
in 1947. This area has been all
furrowed up.

11-23-64

James Elatum

CERTIFICATE FILED

3/7/86 ROAD SURVEY BY JAMES MIDDLETON 1914

SEE PAGE 60 FOR MORE DETAIL

FOUND WOOD STAKE AND GOVT. BT'S.

W. PINE STUMP N26°E 227 LKS.

W. PINE STUMP S57°E 37 LKS.

POPLAR REMAINS N42W 107 LKS.

POPLAR BURNTUP S55W 77 LKS.

CONTINUE SURVEY EAST TO $\frac{1}{4}$ COR. DISTANCE 2687.50'

63 A-13

Corner Sections 21-22-27-28

Notes of original Govt. Survey of 1873.

Spruce 10" N5½°E 15 1ks. or 9.90 feet

Birch 12" N44°W 10 1ks. or 6.6 feet

W. Pine 16" S26°W 73 1ks. or 48.18 feet

Birch 8" S33°E 77 1ks. or 50.82 feet.

Chained East to This Corner
on orig running Notes dist. and
found an Approx F.S. & P. put up
in 1939. No evidence of orig
B.T.'s.

11-24-64

James E. Johnson

CERTIFICATE FILED

Corner Sections 25-26-35-36

Notes of orig. Gov't Survey of 1873.

1. Birch 10" S65½°E 59 lks. 38.99 Feet
2. Maple 8" S5°W 34 lks. 22.44 Feet
3. Poplar 5" N20°E 48 lks. 31.68 Feet
4. White Pine 14" N38°W 65 lks. 42.90 Feet

refer to Book # 4 page 26.

CERTIFICATE FILED

Corner sections 23-24-25-26

Notes of original Govt. Survey of 1873

1. Yellow Pine 24° S 87° E 68 lks.
2. Yellow Pine 18° S 19° W 76 lks.
3. White Pine 29° N 59° W 39 lks.
4. Yellow Pine 18° N 46° E 117 lks.

CERTIFICATE FILED

Corner Sections 26-27-34-35

Notes of original Govt. survey of 1873

1. Yellow Pine 13" S45°E 46 lks. 30.36 feet
2. Yellow Pine 14" N70°E 49 lks. 32.34 feet
3. Yellow Pine 9" NB1½°W 44 lks. 29.04 feet
4. Yellow Pine 16" S41°W 98 lks. 64.68 feet

CERTIFICATE FILED

Corner Sections 27-28-33-34

Notes of orig. Govt. Survey of 1873

1. Yellow pine 8" S 90° E 46 lks. 30.36 Feet
2. Yellow pine 11" N 50° E 47 lks. 31.02 Feet
3. Yellow pine 7" S 70° E 44 lks. 29.04 Feet
4. Yellow pine 5" N 47° W 79 lks. 52.14 Feet

Page 33 Book # 4

CERTIFICATE FILED

R-3 Quarter Cor, Sec's 19 & 30
Notes of original gov't survey
of 1873.

Tamarack 6" N41°W 139 Lks - 91.74'

Tamarack 4" 59°W 154 Lks 101.64'

Notes of County Survey. Notes
are on record in Cass Co.

Court house, BOOK C SURVEY #467-1920

PAGE 469 SET 2 1/2 X 48" IRON MONUMENT

Found a 3" iron pipe under
Bog at fence corner. Fence
runs East & south.

10-5-64

James Esterson

Affidavit
1-7-66 JTE

To perpetuate this Cor. set a 2"
inside dia 5' Long galvanized steel
Pipe Filled w/ Concrete & Capped
w/a 3" dia bronze tablet stamped

T141N R30W

1/4 519

4 530

1965

R15 N0 6807

From which bears;

Tamarack 5" S26°W 75.3' scribed 1/4 530 BT

Tamarack 7" S5°E 86.9' scribed 1/4 530 BT

steel sign post 72" Long, set 24" in
ground w/signs 54-2 & 54-4 attached
due North 12.7'.

5/10/65

James Esterson

69 SEE PAGE 60 THIS BOOK
N-3 Quarter Corn Sec's 18719
Notes of orig govt survey of
1873.

Tamarack 6" N3°E 92 Lks - 60.72

Tamarack 3" S19°W 33 Lks - 21.78

Found a 1½" Iron pipe lying on
ground and a rotted of post
w/a pointed end, also a few
feet away from pipe, also found
a rotted stump S22°W 21.78' Could
possibly be the Tamarack.

11-23-64

James Ekstrom

JUNE 27, 1977

STEPHAN, OLESEN & KRAUSE

LOCATED A 3" IRON PIPE CAPPED WITH A
"A" CAP STAMPED TO IDENTIFY CORNER.

R.L. # 3091 ON PLASTIC PLUG IN CAP CENTER.

REFERENCES:

* W. PINE	* J. PINE	J. PINE	* R. PINE
7"	12"	14"	3"
S79°E	N17°E	S42°W	N44°W
18.0'	57.7'	49.3'	63.3'

* DEAD THIS DATE.

CERTIFICATE FILED

70 Affidavit
N-1 Section Cor. Section's 18-19-13-24
Notes of orig gov't Survey of
1873.

R Oak 8" N56°E 16 Lks - 10.56'

W Pine 4" N70½°W 13 Lks - 8.58'

J Pine 6" S52½°W 40 Lks - 26.40'

Aspen 6" S87½°E 17 Lks - 11.22'

Found two squared post at
Corner location No evidence of
any BT's.

11-23-64

James E. Stram

JUNE 24, 1977 STEFAN & OLESEN
LOCATED A 3" IRON PIPE WITH A 3"
"A1" CAP STAMPED TO IDENTIFY CORNER.
PLASTIC PIPE WITH R.L.S. # GONE & CAP
DAMAGED - SEE PAGE 69.

REFERENCES:

J. PINE	R. PINE	W. BIRCH
16"	24"	6"
N42°E	S65°E	N59°W
62.28'	74.85'	49.39'

SEE PAGE 43, BOOK 2, T141N, R 31W

N-7 Quarter Cor Sec's 17 & 20
Notes of orig govt survey of
1873.

- Y Pine 4" S49°E 18 Lks - 11.88'

Poplar 10" N47°W 32 Lks - 21.12'

Found a F.S.L.P put up in 1937
at this location also a very old
Pine stump at this location that
would check close from old tag.
No scribbling visible -

11-23-64

James Ekstrom

3/7/86 ROAD SURVEY BY JAMES MIDDLETON 1914

SEE PAGE 60 FOR MORE DETAIL

FOUND WOOD STAKE FOR CORNER AND GOVT. BT'S.

YELLOW PINE 14 STUMP OF S49E 18 LKS.

POPPLE 10 STUMP OF N47W 32 LKS.

CONTINUE SURVEY EAST A DISTANCE 2666.30'

CERTIFICATE FILED

R-11 Quarter Con Sec's 21st 28
Notes of orig gov't Survey
of 1873

W Pine 16" N7 $\frac{1}{2}$ W 134 Lks - 88.44'

BEARING & DISTANCE FALLS IN OPEN PASTURE

W Pine 13" S25 $^{\circ}$ E 9 Lks - 5.94'

NO EVIDENCE FOUND

1937
Found a old F.S.L.P East of Fence
Corner about 25' that states Corner
to be N50 $^{\circ}$ E 0.04 Chains, a circle
of stones are close. No evidence
of orig trees. Chained East
and hit small Lake from this
Point 265.0' as per Call for in
orig running Notes.

11-24-64

James E. Burton

CERTIFICATE FILED

4/26/73 CK-J6

CHAINED WEST FROM POND 268' - Fd. 1939 F.S.L.P ON
11" ELM STATED CORNER 15 IN FENCE LINE N50 $^{\circ}$ E 3'
Fd 12" FENCE COR. POST 46' W OF TAG
PUT F.S.L.P ON 11 ELM AS APPROX. 1/4 CORNER

R-15 Quarter Cor Sec's 22⁵' 27
Notes of orig govt Survey of
1873.

Birch 9" S27°E 19 Lks - 12.54'

Poplar 7" N38°W 31 Lks - 13.86'

Chained East to this location
from the (1/4^{approx} Cor sec's 21-28)
and intersected very old Fence
Line running North very close to
distance, but North about 100'
also on this old Fence Corner
post, were small Nails that look
as if a F.S.L.P. had been there
at one time. another Fence
Line runs south but is about
100' short of East-West dist.
No evidence of orig B.T.'s.

11-24-64
James Estlin

CERTIFICATE FILED

74

R-15, 16 Meander Cor. West Bank of
Hovde Lake. Bet. sec's 22, 27

Notes of orig govt survey of
1873.

Birch 8" S70°W 84 Lks - 55.44'

Birch 6" N60°W 70 Lks - 46.20

No evidence found

11-24-64

James Chitum

CERTIFICATE FILED

4/23/86 - CK, IA, GB

Established approx. position on the shore
of a bay of Hovde Lake. Position in middle of
bay. C.C. Done 1/23/86 98.

75

P-13 Quarter Cor. Sec's 21-22
 Notes of orig gov't survey
 of 1873

y Pine 30" 562°W 26 Lks - 17.16'

w Pine 30" 585°E 252 Lks - 166.32'

Chained south from evidence
 found at Sec Corner 15-16-21-22
 2640.0' as call for in orig notes.
 Found a F.S.L.P. put up in 1939
 close to area I stopped chaining.
 No other evidence found.

6-25-64

James Whitman

CERTIFICATE FILED

76

P-9 Quarter Cor. Sec's 20 & 21
Notes of orig gov't Survey
of 1873

y Pine 14" 500¹/₂W 21 Lks 13.86'

y Pine 12" 555°E 21 Lks - 13.86'

Searched 2 Man hrs no evidence
Found area has been heavily
Burned. No evidence Found

4-27-65

James Elstun

95-15-05
CERTIFICATE FILED
P-9

77

R-9 Section Cor. Sec's 20-21-28-29
Notes of orig gov't Survey
of 1873.

R Oak 13" N46 $\frac{1}{2}$ °W 56 Lks - 36.96'

R Oak 11" N20°E 61 Lks - 40.26'

W Pine 9" S71 $\frac{1}{2}$ °E 34 Lks - 22.44'

Maple 8" S78 $\frac{1}{2}$ °W 49 Lks - 32.34'

Chained Fast To This location
from a Co. Pipe at Section
Cor. 19-20-29-30. Found a F.S.L.P.
Put up in 1937 w/ stat's that
this tag w/ established as an
approx Corner at that Time. Searched
2 Man hrs, No evidence found, area
had been burned over heavily
years ago.

4-27-65

James Ekstun

CERTIFICATE FILED

12-13-88 LANDECKER AND ASSOCIATES

SET 2" X 48" IRON MONUMENT. REFER TO
CORNER CERT.

ASH 5" N65°W 71.27 FT

BIRCH 8" S50°W 4.24 FT NOW 4 FT SNAG

W. OAK 6" N89°E 19.19 FT

R. OAK 5" S29°E 29.57 FT

8 FT STEEL SIGN POST 4.6 FT NORTH

8-29-01 R. MAIN

FD CORNER IN GOOD CONDITION IN MIXED
HARDWOODS. BIRCH BT NOW A 4 FT SNAG. ALL
OTHER BTS ARE IN GOOD CONDITION.

78

T-9 Quarter Cor Sec's 28 & 29
Notes of orig gov't Survey
of 1873.

R, Oak 10" 54°E 16 Lks - 10.56'

y Pine 12" N68°W 7 Lks - 4.62'

Used type Map to locate search
area for Cor. Falls on West
side of plantation. No evidence
found.

9-22-64

James Ekstrom

~~SEE NOTES DATED 7/21/39 IN OLD FIELD BOOK #4~~

~~SEE APPROX OR PROPORTIONATE DISTANCE~~

~~PLANTATION 3" LONG 3" WIDE 4" HIGH FROM 1" FIELD BOOK~~

CERTIFICATE FILED

79

T-13 Quarter Cor Sec's 27 & 28
Notes of orig govt Survey
of 1873.

W Pine 10" S82°W 22 Lks - 14.52'

W Pine 12" S77°E 30 Lks - 19.80'

Found a old E.S.L.P. put up in
1937 By the C-C's that is
approx. searched 2 Man hrs
in area for orig evidence
None found. area has been very
heavily burned.

4-27-65

James Ekstrom

CERTIFICATE FILED

CERTIFICATE FILED

Quarter Cor. Sec's 13 E 24

Notes of orig govt survey of
1873.

Tamarack 5" 528'W 14 Lhs - 9.24'

Tamarack 5" 51 1/2°E 11 Lhs - 7.26'

CURVE TABLES.

Published by KEUFFEL & ESSER CO.

HOW TO USE CURVE TABLES.

Table I. contains Tangents and External to a 1° curve. Tan. and Ext. to any other radius may be found nearly enough, by dividing the Tan. or Ext. opposite the given Central Angle by the given degree of curve.

To find Deg. of Curve, having the Central Angle and Tangent: Divide Tan. opposite the given Central Angle by the given Tangent.

To find Deg. of Curve, having the Central Angle and External: Divide Ext. opposite the given Central Angle by the given External.

To find Nat. Tan. and Nat. Ex. Sec. for any angle by Table I.: Tan. or Ext. of twice the given angle divided by the radius of a 1° curve will be the Nat. Tan. or Nat. Ex. Sec.

EXAMPLE.

Wanted a Curve with an Ext. of about 12 ft. Angle of Intersection or I. P. = 23° 20' to the R. at Station 542+72.

Ext. in Tab. I opposite 23° 20' = 120.87

120.87 ÷ 12 = 10.07. Say a 10° Curve.

Tan. in Tab. I opp. 23° 20' = 1183.1

1183.1 ÷ 10 = 118.31.

Correction for A. 23° 20' for a 10° Cur. = 0.16

118.31 + 0.16 = 118.47 = corrected Tangent.

(If corrected Ext. is required find in same way)

Ang. 23° 20' = 23.33° + 10 = 2.3333 = L. C.

2° 19 1/2' = def. for sta.	542	I. P. = sta.	542+72
4° 49 1/2' = " " "	+50	Tan. =	118.47
7° 19 1/2' = " " "	543	B. C. = sta.	541+53.53
9° 49 1/2' = " " "	+50	L. C. =	2.3333
11° 40' = " " "	543+	E. C. = Sta.	543+86.86
	86.86		

100 - 53.53 = 46.47 × 3' (def. for 1 ft. of 10° Cur.) = 139.41' =

2° 19 1/2' = def. for sta. 542.

Def. for 50 ft. = 2° 30' for a 10° Curve.

Def. for 36.86 ft. = 1° 50 1/2' for a 10° Curve.

