

T60N R27W TRAVERSE # 2

TRAVERSE

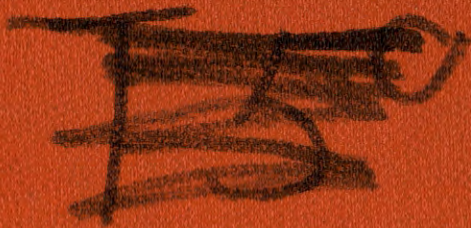

R.S.
FIELD BOOK
82-0012

T60N
R27W
Book 2

Index

Traverse of the East line of Section 26 pp 1-8

Traverse of Sec. 27 - Control pp 9-46

T 159N R 27W

1

23 \square 24 105 $\frac{1}{4}$

• #104

• #103

• #102

• #101

23 \square 24
#100 SEC. COR.
26 25

TRAVERSE IN BETWEEN SE SEC COR.
OF 23 TO $\frac{1}{4}$ OF 23 + 24

TEMP. 18°F H_g 29.68

2

2-9-83 B. AUSK G. ROBERTSON

STA 1st H-D 2nd H-R 3rd H-D 4th H-R H₂X

94.21-27

101 to 100

265.79.19

91

178-41-01 178-40-58 178-40-59 178-40-58 89-31-57

101 00-00-29 180-00-25 00-00-33 180-00-20 270-29-59

178-40-32 178-40-33 178-40-26 178-40-38

178-40-32

208-58-07 208-57-59 208-58-06 208-57-58 90-03-22

102 00-00-30 180-00-24 00-00-32 180-00-23 269-57-19

208-57-37 208-57-35 208-57-34 208-57-35

208-57-35

152-49-54 332-49-43 152-49-52 332-49-44 88-51-16

103 00-00-33 180-00-19 00-00-29 180-00-21 271-09-29

152-49-21 152-49-24 152-49-23 152-49-23

152-49-23

2/14/83

JJR

2

S D

H D

788.92

788.93

788.92

788.92

619.20

619.20

619.20

619.20

270.27

270.28

270.26

270.27

456.02

456.02

456.01

456.02

~~786.79~~

65

~~619.26~~

19

270.27

~~455.81~~

93

888 2/14/83

STA	1 st	2 nd	3 rd	4 th	Az
	180-21-35	00-21-25	180-21-34	00-21-24	91-17-00
104	20-00-35	180-00-25	00-00-33	180-00-24	268-43-52
	180-21-00	180-21-00	180-21-01	180-21-00	90
	180-21-00				

105

Set up over 105 BS 104
 TURN \times $1^{\circ}51'53''$ to
 Right
 Split BRASS CAP

Std. 2-10-83 B.A.

Fin. 2-11-83 G.R.

2/14/83 JGR

SD

509.97

509.97

509.97

509.97

~~509.97~~
 84

TRUE LINE BETWEEN $\frac{1}{4}$ &
 SEC COR

#3

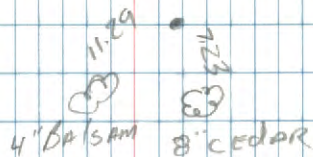

#2

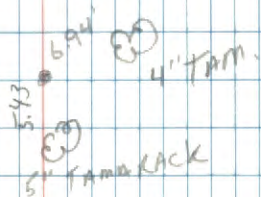

M

23 24
 #10
 26 25

#400#3

#500#2

26 #1
 25

5
 STA, 1st 2 2^d 3^d 4th A 2 5

L To 2

260-38-05
 99-22-46
 99-22-20

179-54³ / 16359-54-02⁵ 179-54⁶ / 359-54-02⁵ 88-42-52

2 00-00-35 180-00-27 00-00-29 180-00-23 271-17-49

179-53-41 179-53-35 179-53-46 179-58-39

179-53-40

3

101 180-19-59 00-19⁹-48 180-19-57 00-19-48 272-15-07
 87-45-37

8 00-01-06 180-00-55 00-01-04 180-00-53 272-15-07

180-18-53 180-18-53 180-18-53 180-18-55

180-18-53
 54

101

8 00-02-28 180-02-18 00-02-29 180-02-21 272-05-37

101 00-00-19 180-00-08 00-00-21 180-00-10 87-55-32

00-02-09 00-02-10 00-02-08 00-02-11

00-02-09

S D H D

360.22

360.28

360.28

360.28

~~358.21~~
 355.48

1055.24

1055.25

1055.24

1054.97

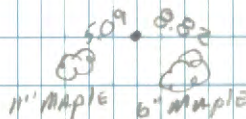
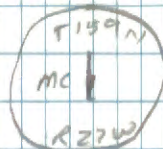

484.18

484.18

484.18

484.18

483.81

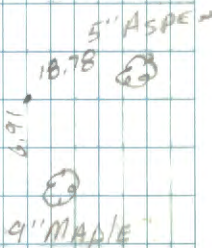

484.21

484.21

484.21

484.21

483.89

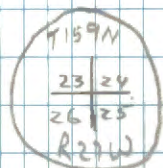

white
 188

STA 1 2 3 4 Az 5

179-38-56 359-38-45 179-38-59 359-38-45 88-43-57

4 00-00-15 179-59-57 00-00-28¹⁰ 179-59-57 271-16-39

179-38-41 179-38-46 179-38-49 179-38-48

179-38-46

180-04-22 00-04-14 180-04-21 00-04-14 99-21-28

5 00-00-26 180-00-15 00-00-25 180-00-20 240-39-11

180-03-56 180-03-59 180-03-56 180-03-54

180-03-56

00-03-04 180-02-47 00-03-00 180-02-46

1 00-00-27 180-00-12 00-00-22 180-00-13

00-02-37 00-02-35 00-02-38 00-02-33

00-02-36

2/14/83
JBR

SD

HD

1055.13

1055.13

1055.13

1055.13 1054.87

360.33

360.33

360.33

360.33 355.54

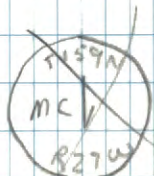

⑦

STA 1A 2A 3A 4A A25

~~179-59-00~~

~~180-00-35~~ 359-59-57 179-59-06 359-59-55 270-01-07

1 00-00-47 ⁵⁹179-59-02 ⁵⁹⁻²⁶359-59-10 179-59-19 89-59-46

~~179-59-37~~ ~~179-59-28~~ ~~179-59-56~~ ~~180-00-36~~

179-59-52 359-59-40 179-59-55 359-59-41 359-59-13

00-00-29 180-00-07 00-00-21 179-59-~~50~~⁵⁴ 179-59-50

179-59-23 179-59-33 179-59-34 59-45 179-59-23

179-59-28

2-2283 GR. BA. 2(22183) JBR

TIE IN WICOMAPLE LAKE

BS #2 F.S. WITNESS CORNER

⑧

SD HD

1636.46

1636.46

1636.46

1636.46

1636.46

47

34

46

36

4

1636.46

1636.46

1636.46

1636.46

8

T60N R27W WEASLE LAKE
Angles ~~to~~ property CORNERS ~~to~~ ~~line~~
to

STA. 1st H4 D 2nd H4 R 3rd H4 P 4th H4 R H. Dist
H4

1785 180-00-51 00-00-58 180-00-59 180-01-20
00-00-12 180-00-06 00-00-53 180-00-50

27 180-00-39 180-00-12 180-00-06 180-00-30

180-00-22

223.026

2091
EN 116FS

corner
and filled

8

March 29, 1983

Pty. day, windy, mild

PC. to G. Kosenko

Aides - B. Ansk

G. Robertson

T-2 SW 265189

Monumentation Information

Set a 3 ft long by 2 1/2 in outside diameter
galvanized iron pipe, concrete filled, 2 ft in
ground with a 3 in diameter brass cap
stamp:

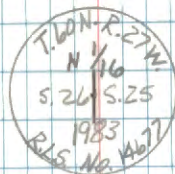

From which:

Sugar Maple, 6.9", N80°E, 10.48 ft to 1/4d on south
face, double blaze, ser: "N 116 S 25 BT" w/60d verticle spike

Sugar Maple, 10.4", S08°W, 44.24 ft to 1/4d on SE
face, double blaze, ser: "N 116 S 26 BT" w/60d verticle spike

Sugar Maple, 5.7", N24°W, 22.53 ft to 1/4d on SW
face, double blaze, ser: "N 116 S 26 BT" w/60d verticle spike

Metal sign post, North, 3.0 ft w/54-2, 54-9

Metal sign post, east, 5.0 ft w/54-2

All trees painted red

⑨

T60N R27W

Angle @ property corner to property line
STA 1st H&D 2nd H&R 3rd H&D 4th H&R
H X

Z BS

2001 N 179-59-01

1001 FS

⑨

11/22/86 TA 9
T60N R27W
Traverse of Sec 27, T60N R27W

Pt 2	Pt 1	00-00-30 180-00-3 180-00-05.5	180-00-06.5
	Pt 3	001-11-43 01-11-05.5 181-11-39	01-11-06.5
2	1	90-00-44 270-00-40 180-00-07.5	
	3	91-11-50 01-11-07.5 271-11-49	
2	1	88-51-48 3072.945 271-08-20M 936.635M	3072.340
2	3	88-52-19 3084.960 271-07-47M 940.296M	3084.362

30
48 10
35.5
5.5

49.5
42
7.5

11/26/86 JA R GB II CK - setups JS setups
Wild T2 Topcon - EDM (DM-52)
Temp 35° - Clear

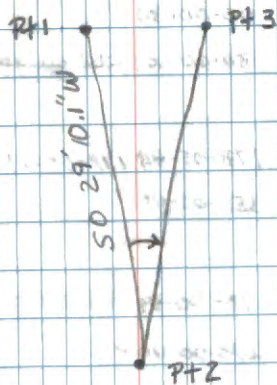

Pt 1 - Turtle Geodetic Station

Pt 2 - Azimuth station



Setup hole

Pt 3 - 1" iron pipe with spike marking

Sec. corner 26, 27, 34, 35

①

3	2	00-00-30		
		180-00-30	178-00-79	<u>178-00-47.5</u>
	4	178-05-49	178-05-17	<u>178-05-16.75</u>
		358-05-45		
3	2	90-00-39	178-00-76.5	
		270-00-40 ✓		
	4	268-05-57	178-05-16.5	
		088-05-55 ✓		

47	56.0
<u>30</u>	<u>39.5</u>
17	16.5

11/26/86

①

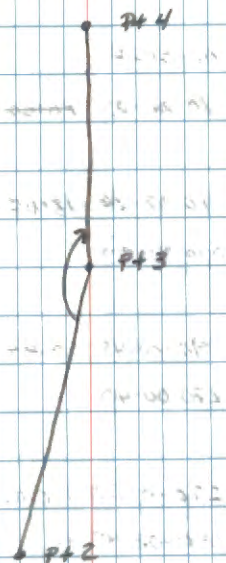

P+4 - PK nail in road for $5\frac{1}{4}$ bet sec's 26/27
 See Field Book 1 page 59 for ties

(12)

4	3	00-00-30		
		180-00-27	180-00-06	<u>180-00-04.5</u>

	5	180-02-36	180-02-06	<u>180-02-04.5</u>
		000-02-33		

4	3	90-00-48	180-00-03	
		270-00-40	✓	

	5	270-02-47	180-02-03	
		090-02-47	✓	

4	3	89-58-36	1316.745	✓
		270-01-38	401.346	✓

4	5	91-12-51	1702.085	✓
Possible blunder in setup		268-47-28	518.797	✓

5	4	88-50-06	1702.025	✓
		271-10-00	518.778	

34.5	47
28.5	44
6.0	3

11/26/86

(12)

P+5

P+4

P+3

5	4	00-00-30		
		180-00-26		
	6	179-38-32	179-38-02	<u>179-38-01.5</u>
		359-38-28		

5	4	090-00-41		
		270-00-40 ✓		
	6	269-38-44	179-38-01	
		089-38-39 ✓		

5	6	93-17-49	845.285	843.886
		266-42-19	257.642M ✓	

30	41.5
<u>28</u>	<u>40.5</u>
02	1.0

11/26/86

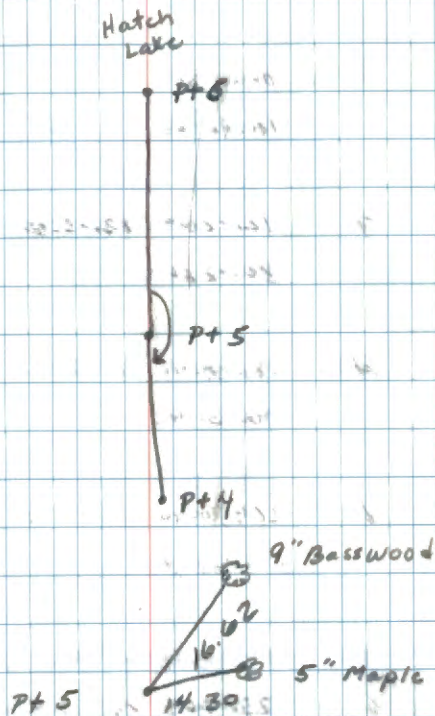

Pt 6 is Witness to Meander Corner
 Bet. Sec's 26/27. Co. iron pipe
 with alum. cap.

6	5	00-00-30 180-00-24		
	7	121-26-49 121-26-18 301-26-42	<u>121-26-17.75</u>	
6	6A	181-31-18 181-31-03 001-31-42	<u>181-31-20.5</u>	
	J.	181-31-18		
6	5	090-00-36 270-00-40 ✓		
	7	211-26-50 121-26-17.5 031-26-51 ✓		
6	6A	271-32-22 181-31-38 091-32-00		
6	6A	Steel Tape	51.241	
	45	30	71	20.5
	27	27	33	33
	18	3	38	17.5

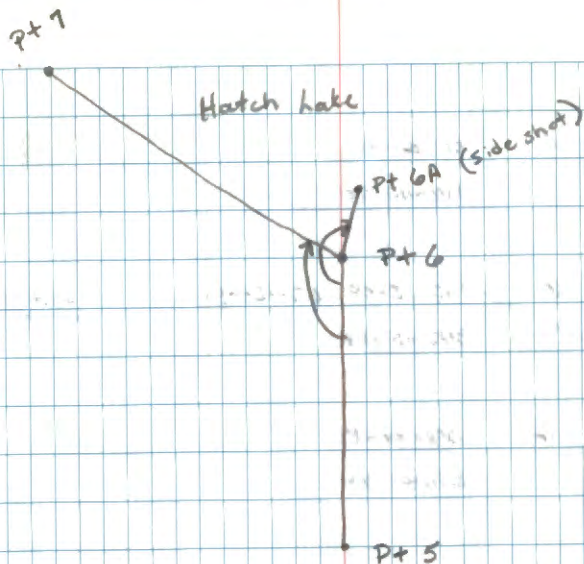

Pt 6A - 500 spike set in ice to mark
Meander Corner But. Sec's 26/27.
Position established by original BT
and county.

8 7 00-00-30
180-00-27

9 149-35-10 149-34-40.5 149-34-39
329-35-08

8 7 90-00-46
270-00-40 ✓

9 239-35-23 149-34-38.5
059-35-20 ✓

⁸ 69.10
28.5
40.5

⁸ 69.10
28.5
30.5

⁷ 21.5
43
38.5

⁷ 21.5
43
38.5

11/26/86

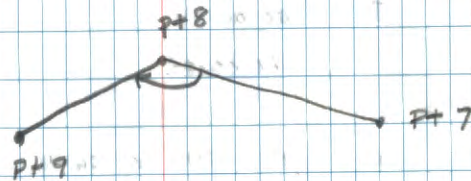

9	8	00.00-30 180.00-29		
	10	187-07-13 187-06-41 007-07-10	<u>187-06-42</u>	
9	8	90-00-30 270.00-40 ✓		
	10	277-07-19 187-06-43.5 097-07-18 ✓		
9	8	107-19-42 231.225 252-40-40 70.479 ✓	✓ 220.730	
9	10	086-18-32 145.510 273-41-50 44.352 ✓	✓ 145.208	

6.0	
71.5	78.5
<u>29.5</u>	<u>35</u>
41.0	43.5

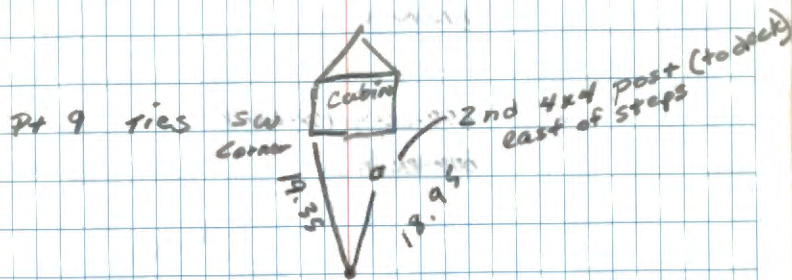
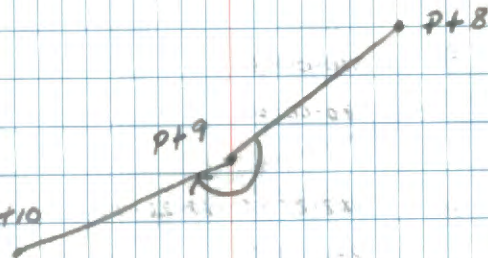

10 9 00-00-30

180-00-27

11 168-25-57 168-25-25

348-25-50

168-25-27

10 9 090-00-47

270-00-40 ✓

11 258-26-16 168-25-30

078-26-11 ✓

4	73.5
813.5	
28.5	43.5
<u>25.0</u>	<u>30.0</u>

11/26/86

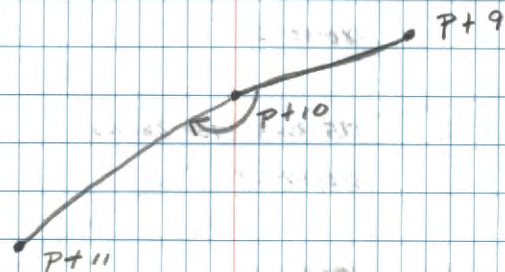

Pt 10 Ties

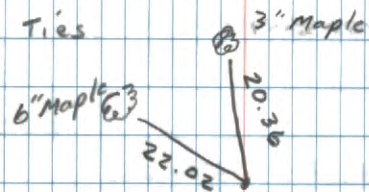

11	10	00-00-30 180-00-25		
	12	175-38-35 175-38-04.5 355-38-29	175-38-06	
11	10	090-00-43 270-00-40 ✓		
	12	265-38-49 175-38-07.5 085-38-49 ✓		
11	10	89-36-26 514.265 270-23-46 156.747 M ✓	514.253	
11	12	093-53-42 641.405 266-06-31 195.500 M ✓	639.924	

211	8
32 10	49 10
27.5	41.5
4.5	7.5

11/26/86

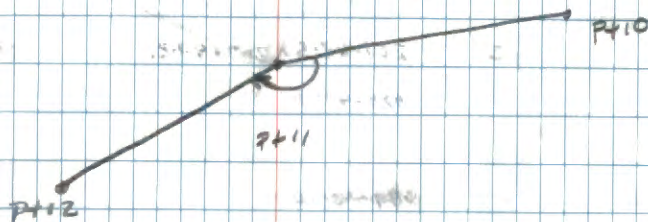

F+11 Ties

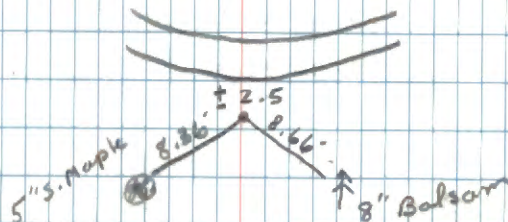

12 11 00-00-30
180-00-30

13 207-48-53 207-48-21
027-48-49

12 11 090-00-40
270-00-40 ✓

13 297-49-00 207-48-20
117-49-00 ✓

51
30
21

60
40
20

11/26/86

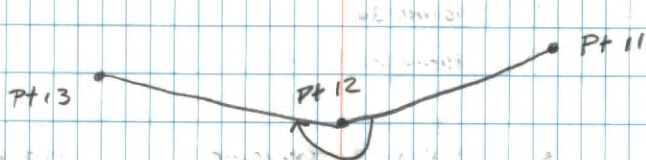

Pt 12 Ties

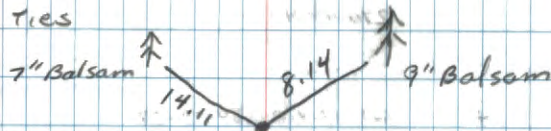

13	12	00-00-30 180-00-21		
	14	238-15-32 058-15-29	238-15-05	<u>238-15-04</u>

13	12	90-00-45 270-00-40 ✓		
	14	328-15-50 148-15-43 ✓	238-15-04	

13	12	88-43-51 271-16-19	553.940	553.804 ✓
			168.843M ✓	

13	14	089-39-00 270-21-23	368.230	368.223 ✓
			112.235M ✓	

END OF DAY

30.5	46.5
<u>25.5</u>	<u>42.5</u>
5.0	4.0

11/26/86

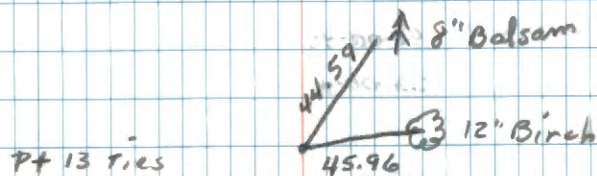
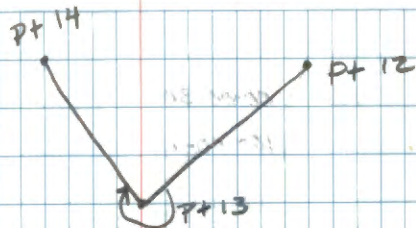

Pt 14 Ties

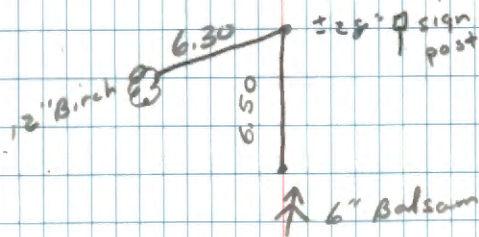

14 13 00-00-30
180-00-25

15 113-53-54 113-53-23.5
293-53-48

14 13 90-00-44
270-00-40 ✓

15 203-54-06 113-53-23
023-54-04 ✓

40	65
5+10	
<u>27.5</u>	<u>42</u>
23.5	23

12/1/86 - JA, GB, CK, JR

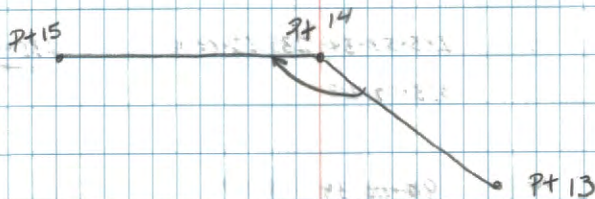

Pt. 15 is NW Section corner of Sec. 27

15	14	00-00-30 180-00-30		
	16	235-57-34 055-57-27	235-57-00.5	<u>235-57-00.2</u>
15	14	90-00-38 270-00-40 ✓	235-57	
	16	325-57-41 145-57-37 ✓	235-57-00	
15	14	96-24-12 263-36-10	401.490 ft 122.374 m ✓	398,985
15	16	89-29-13 270-31-00	322.055 ft 98.164 m ✓	322.042

30.5	39
30.	<u>39</u>
<u>0.5</u>	

12/1/86

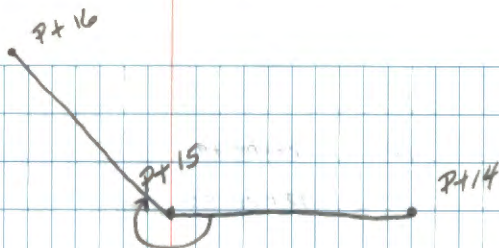

Pt 16 Ties

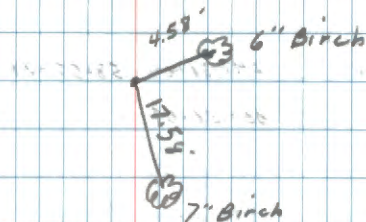

16 15 00-00-30

180-00-25

17 158-55-58 158-55-28.5

338-55-54

16 15 090-00-39

270-00-40 ✓

17 248-56-09 158-55-28

068-56-04 ✓

4.15	5
56.10	66.5
<u>27.5</u>	<u>39.5</u>
28.5	28.0

12/1/86

P+17

P+16

P+15

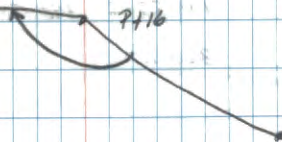

17	16	00-00-30 180-00-30		
	18	143-27-23 323-27-20	143-26-51.5	<u>143-26-50.2</u>
17	16	90-00-42 270-00-40 ✓		
	18	233-27-31 053-27-29 ✓	143-26-49	
17	16	88-45-10 90-00-42 271-15-20	245.450 74.814 M ✓	245.392
17	18	89-00-22 270-59-51	284.550 86.731 M ✓	284.507

8	28	51.5
21.5	30	
<u>30</u>	<u>41</u>	<u>49</u>
51.5	49	100.5

12/1/56

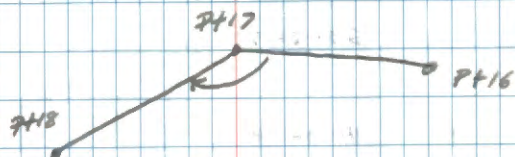

Pt 17 Ties

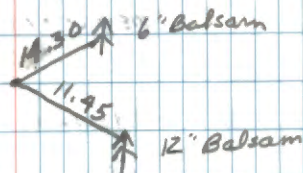

18 17 00-00-30
180-00-25

19 168-32-45 168-32-14.5 168-32-12.2
348-32-39

18 17 90-00-38
270-00-40 ✓

19 258-32-51 168-32-10
078-32-47 ✓

3.1	
42.10	49
<u>27.5</u>	<u>39</u>
14.5	10

12/1/86

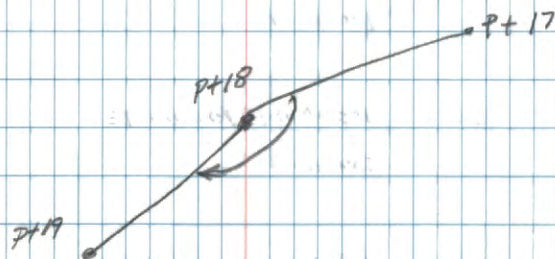

P+18 Ties

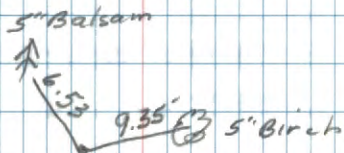

19	18	00-00-30 180-00-22		
20		106-00-48 106-00-22 286-00-48	<u>106-00-18.75</u>	
20A		119-44-15 119-43-50.5 299-44-18	<u>119-43-52.5</u>	
18		90-00-45 270-00-40 =		
20		196-01-01 106-00-15.5 016-00-55 ✓		
20A		209-44-27 119-43-54.5 029-44-27 ✓		
19	18	90-50-32 249.975 269-09-39 76.192M ✓	249.948	
19	20	90-40-10 1754.355 269-20-12 534.728M ✓	1754.235	
19	20A	091-14-09 236.740 269-46-02 72.158M ✓	236.685	

12/1/86

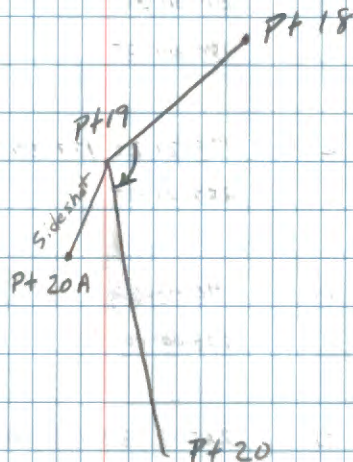

Pt. 20A Closing Corner to sec's 21/28

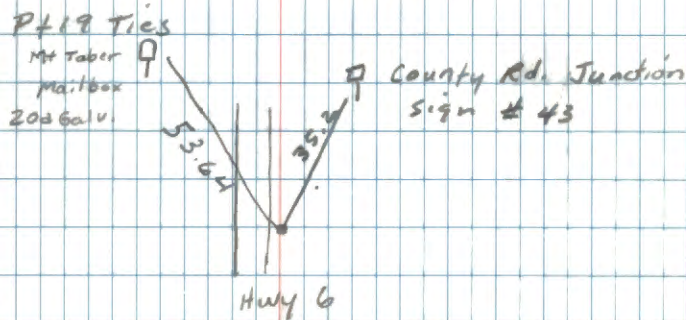

48	76.5	7	27.10	48	58.10
26	26	42.5	42.5	26	42.5
22	59.5	15.5	54.5	22	15.5

20

19

00-00-30

180-00-25

21

177-21-21

177-20-51.5

177-20-50.0

357-21-17

20

19

90-00-45

270-00-40 ✓

21

267-21-33

177-20-50.0

087-21-32 ✓

$$\begin{array}{r} 8 \\ 79.0 \\ \underline{27.5} \\ 51.5 \end{array}$$

$$\begin{array}{r} 9 \\ 32.5 \\ \underline{42.5} \\ 50.0 \end{array}$$

12/1/86

Pt 19

Pt 20

Pt 21

Pt 20 TIGS

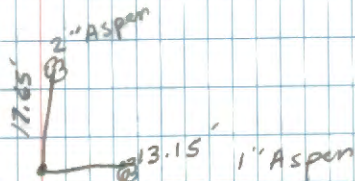

21 20 00-00-30
180-00-22

22 111-48-46 111-48-16 111-48-15.5
291-48-38

21 20 090-00-44
270-00-40 ✓

22 201-48-59 111-48-15
021-48-55 ✓

21 20 88-31-01 1086.135 1085.771
271-29-05 331.054M ✓

21 22 88-25-14 539.250 539.045
271-35-05 164.363M ✓

$\frac{3}{2}$ 57
26 42
16 15

12/1/86

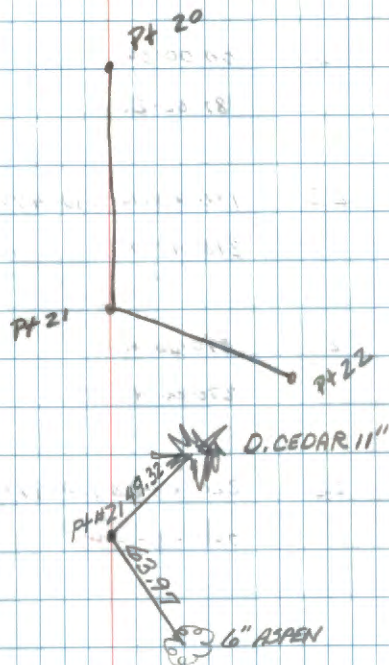

22 21 00-00-30
180-00-25

23 130-48-10 130-47-40 130-47-39
310-48-05

22 21 090-00-46
270-00-40 ✓

23 220-48-23 130-47-38
040-48-19 ✓

67.5	78
27.5	21
400	43
	38

12/1/86

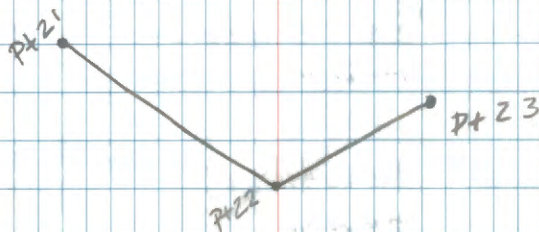

Pt 23 is $\frac{1}{4}$ corner bet. sec. 27/28

23	22	000 00 30		
		180-00-26		
	24	359-14-51	359-14-20.5	359-14-19.5
		179-14-46		
	22	90-00-41		
		270-00-40		
	24	089-14-59	359-14-18.5	
		269-14-59		

VOID
 (all) by memo
 for # 24

23	22	90 35 26	381.195 ✓	381.175 ✓
----	----	----------	-----------	-----------

		269-24-50	116.189M ✓	
--	--	-----------	------------	--

END OF DAY 24		70 36 21	375.930	
---------------	--	----------	---------	--

12/2/86		269-23-53	114.584	
---------	--	-----------	---------	--

23	22	00-00-30		
----	----	----------	--	--

		180-00-21		
--	--	-----------	--	--

	24	359-13-16	359-12-47	359-12-46.75
--	----	-----------	-----------	--------------

		179-13-09		
--	--	-----------	--	--

23	22	90-00-46		
----	----	----------	--	--

		270-00-40 ✓		
--	--	-------------	--	--

	24	089-13-30	359-12-46.5	
--	----	-----------	-------------	--

		269-13-29 ✓		
--	--	-------------	--	--

48.5				
------	--	--	--	--

28				
----	--	--	--	--

20.5				
------	--	--	--	--

59.10				
-------	--	--	--	--

40.5				
------	--	--	--	--

18.5				
------	--	--	--	--

6				
---	--	--	--	--

712.5				
-------	--	--	--	--

25.5				
------	--	--	--	--

47.0				
------	--	--	--	--

29.5				
------	--	--	--	--

43				
----	--	--	--	--

46.5				
------	--	--	--	--

12/1/86

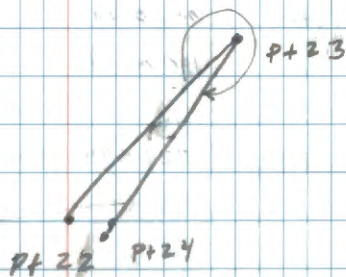

24	23	00-00-30		
		180-00-27		
	25	229-57-36	229-57-05	<u>229-57-04</u>
		049-57-31		

VOID
 due to normal
 at #24

24	23	90-00-34		
		270-00-40		

	25	319-57-40	229-57-03	
--	----	-----------	-----------	--

12/2/86

139-57-40

24	23	00-00-30		
		180-00-26		

	25	229-53-18	229-52-47	<u>229-52-48.2</u>
		049-53-12		

24	23	090-00-39		
		270-00-40 ✓		

	25	319-53-30	229-52-49.5	
		139-53-28 ✓		

24	23	89-29-34	377.265	377.250
		270-30-52	114.991 M ✓	

2	313.5	40	6	75	818
	28.5	37		28	39.5
	5	3		41	49.5

12/1/86

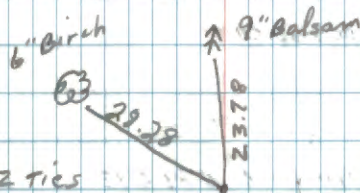
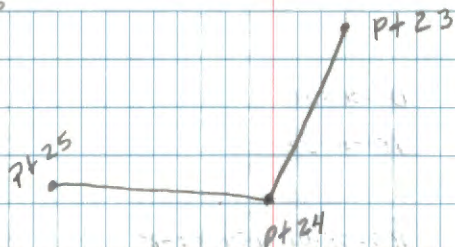

Pt 24 Ties

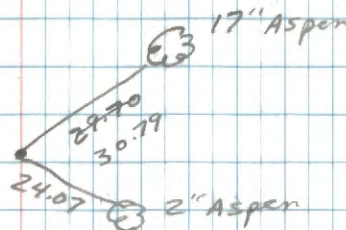

25 24 00-00-30
180-00-32

26 159-53-01 159-52-29 159-52-29
339-52-59

25 24 090-00-46
270-00-40 ✓

26 249-53-16 159-52-29.5
069-53-09 ✓

~~24~~ ~~25~~ 91-16-56 579.675 ✓ 579.530
~~25~~ ~~24~~ 268-43-16 176.686M ✓

$\begin{array}{r} 610 \\ 31 \\ \hline 29 \end{array}$ $\begin{array}{r} 92.5 \\ 43 \\ \hline 29.5 \end{array}$

12/2/86 CK, JA, GB Cloudy, snow, 25°

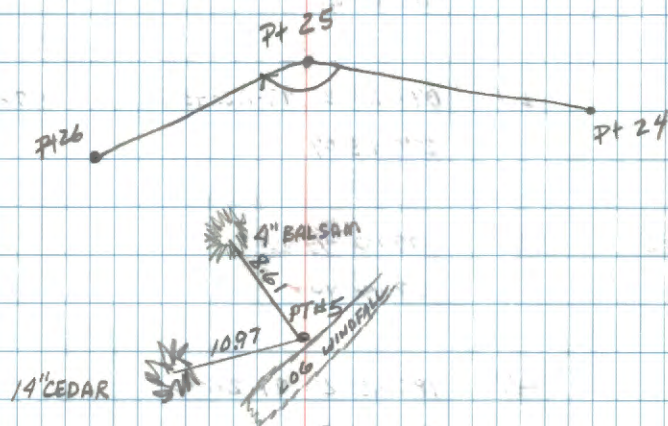

26	25	00-00-30		
26	25	180-00-23		
	27	097-23-13	97-22-43.5	<u>97-22-43</u>
		277-23-07		

26	25	090-00-44		
		270-00-40 ✓		

	27	187-23-25	97-22-42.5	
		007-23-24 ✓		

26	25	90-16-58	260.985	260.982 ✓
		269-43-27	79.549 M ✓	

26	27	89-46-29	1346.980	1346.970 ✓
		270-13-46		
		277-23-07	410.561 ✓	

69	8
70	24.5
10	
26.5	42
43.5	42.5

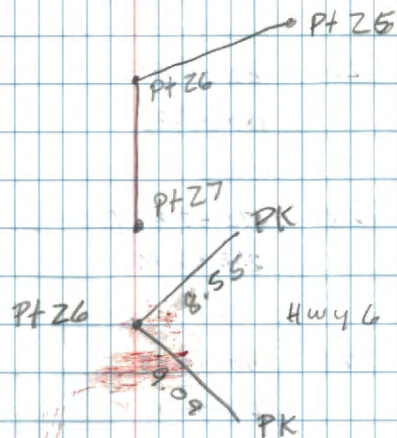

27 26 00:00-30
180:00-26

28 172-47-22 172-46-53 172-46-53.5
352-47-20

27 26 90:00-45
270:00-40 ✓

28 262-47-31 172-46-53.5
082-47-36 ✓

27	9.5
28	36.10
<u>53</u>	<u>42.5</u>
	53.5

12/2/86 Snow getting heavy

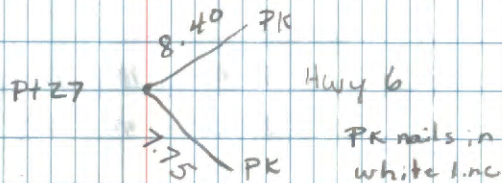
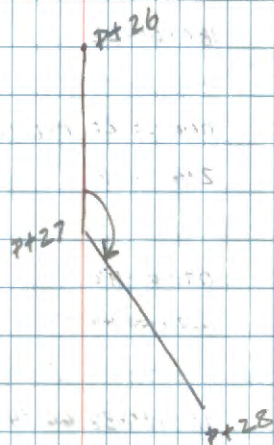

28 27 00-00-30
180-00-22

29 066-35-23 066-34-56
246-35-21

28 27 090-00-42
270-00-40 ✓

29 156-35-38 66-34-54.5
336-35-33 ✓

28 27 90-05-21 ~~1325.425~~ 1723.715 1723.713 ✓
269-55-06 ~~403.991M~~ 525.390 ✓

28 29 90-35-05 ~~1723.715~~ 1325.425 1325.356 ✓
269-25-12 ~~525.390~~ 403.991M ✓

END OF DAY

1st 22 9
35.5
26
56 41
54.5

12/2/86

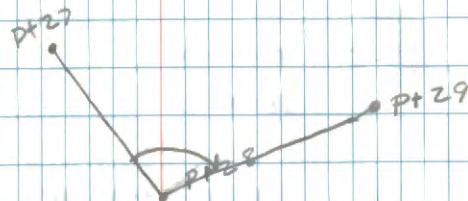

Pt 29 is SW Section Corner of Sec. 27.
Co. iron pipe with alum. cap.

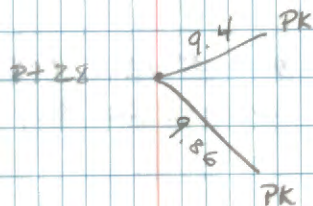

PK nails in
whiteline

29 28 00-00-30
180-00-20

30 258-22-17 258-21-46.5 258-21-46.5
078-22-06

29 28 090-00-40
270-00-40

30 348-22-26 258-21-46.5
168-22-27

29 30 90-01-35 1205.735 1205.735
269-58-51 367.509

$\begin{array}{r} 6 \\ 71.5 \\ \hline 25 \\ 46.5 \end{array}$

$\begin{array}{r} 8 \\ 26.5 \end{array}$

$\begin{array}{r} 6 \\ 71.5 \\ 25 \\ \hline 46.5 \end{array}$

$\begin{array}{r} 8 \\ 26.5 \\ 40 \\ \hline 46.5 \end{array}$

12/9/86 0° - windy, cold, clear

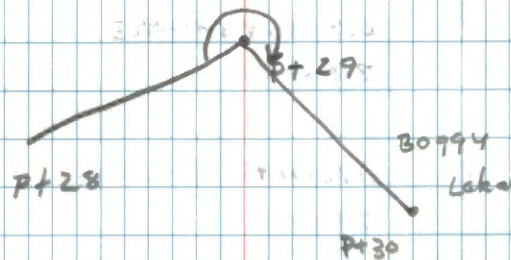

30 29 00-00-30
180-00-22

31 068-01-29 68-01-02 68-01-02.7
248-01-29

30 29 090-00-45 68-01-03.5
27000-40

31 158-01-47
338-01-45

29	48.10	29	48.10
<u>20</u>	<u>42.5</u>	<u>27</u>	<u>42.5</u>
62	35		3.5

12/9/86

Pt 29

Pt 31



Pt 30

Pt 30 is spike in ice on Boggy Lake

31 30 80-00-30
180-00-30

32 237-37-15 237-36-44 237-36-44.5
857-37-13

31 30 390-00-30
270-00-40

32 327-37-24 237-36-45
147-37-24

31 30 90-01-53 1161.635 1161.635
269-58-45 354.068

31 32 89-31-08 684.100 684.076
270-29-27 208.514

74 ⁸ 724
30 39
44 45

12/9/86

Pr 31

Pr 32

Pr 30

32 31 00-00-30
180-00-24

33 A 179-45-43 179-45-09 179-45-10
359-45-39

33 180-00-08 179-59-35 179-59-34
200-00-06

32 31
270-00-40
091-00-40

33 A
089-45-50 179-45-12
269-45-54

33 276-00-13 179-59-33
90-00-13

32 - 33A 89-37-32 676.080 ft 676.066
206 070

$\frac{3}{41}$	67	52	73
$\frac{32}{9}$	$\frac{32}{35}$	$\frac{40}{12}$	$\frac{40}{33}$

12/9/86

Pt 31

Pt 32

Pt 32A

Pt 33

Pt 32 Ties

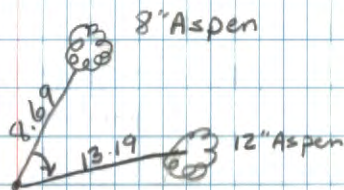

Pt 32A is a side shot to ^{south} $\frac{1}{4}$ corner of
Sec 27. Itasca county iron pipe (2' high) with
alum. cap.

33 32 000-00-30

180-00-30

3

33A 000-40-51 00-40-20.5

180-40-50

00-40-21

34 180-01-03 180-00-29.5

000-00-56

180-00-30.5

33 32 90-00-40

276-00-40

33A 90-40-58 00-40-21.5

270-41-05

34 270-01-11 180-00-31

090-01-11

33 32 90-58-48 916.975

268.23-03 279.495

916.841

33A 90-33-46 240.785

240.775

34 91-37-26 824.865

824.534

31 269-01-52 251.419

12/9/86

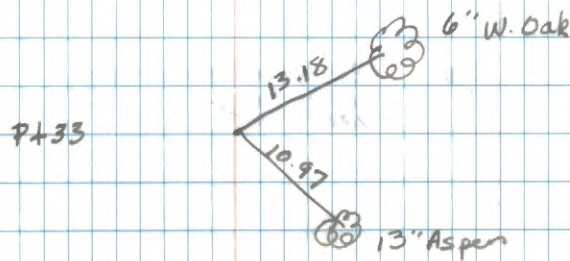
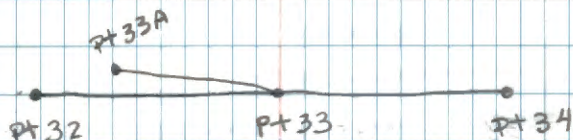

$$\begin{array}{r} 71 \\ 40 \\ \hline 31 \end{array} \quad \begin{array}{r} 59.5 \\ 30 \\ \hline 89.5 \end{array} \quad 11$$

$$\begin{array}{r} 6 \\ 21.5 \\ 40 \\ \hline 21.5 \end{array} \quad \begin{array}{r} 50.5 \\ 30 \\ \hline 20.5 \end{array}$$

34 32 00-00-20

180-00-21

35 179-58-49 179-58-20

369-58-42

34 33 090-00-44

270-00-40

35 269-59-03 179-58-19.5

089-59-00
090

45.5

 $\frac{25.5}{20.0}$ 5
61.542
 $\frac{19.5}{}$

12/9/86

p+33

p+34

p+35

34⁵ 38⁴ 00-00-30

180-00-35

36 180-01-04 180-00-31.5 180-00-32.5
000-01-04

34⁵ 35⁴ 090-00-39
270-00-40

36 270-01-14 180-00-34
090-01-13

34⁵ 34⁴ 091-21-43 550.560 550.404
34⁵ 35⁴ 268-39-03 167.818

34⁵ 36 92-33-59 343.165 342.821
34⁵ 36 267-27-56 104.598

12/9/86

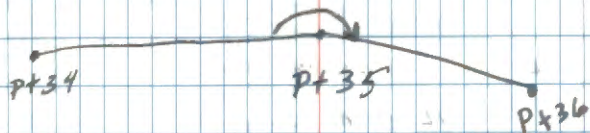

3 04 10	6 713.5
32.5	39.5
51.5	34.0

36 35 000-00-30
180-00-27

37 ~~180-00-09~~ ~~150-00-40~~ 179-59-40
000-00-08 179-59-39

36 35 090-00-23
278-00-40

37 270-00-21 / 179-59-35
090-00-18

68.5

28.5

40 0

79.5

41.5

38 0

12/9/86

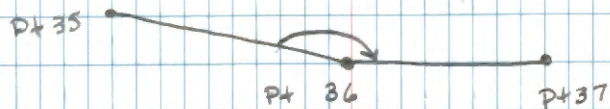

37	36	00-00- ³⁰ 00 180-00-24		
	1	183-42-45 003-42-38	183-42-14.5	<u>183-42-14.75</u>

37	36	090-00-38 270-00-40		
	1	273-42-57 093-42-51	183-42-15	

37	36	96-58-39 263-01-16	478.995 472.015 143.871 M	468.504
----	----	-----------------------	--	---------

37	1	87-55-27 272-04-39	190.710 58.128	190.585
----	---	-----------------------	-------------------	---------

³ 41.5	⁴ 814
27	39
<u>14.5</u>	<u>15</u>

12/11/86

JA R GB □ CK Setup

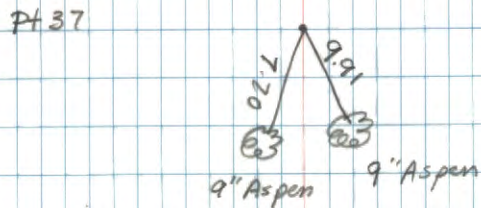
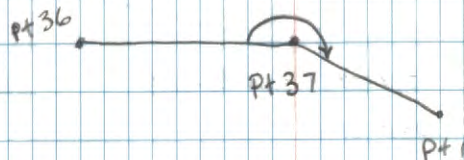

1	37	00-00-30		
		180-00-22		
	2	265-28-20	265-27-50.5	<u>265-27-48</u>
		085-28-13		
1	37	090-00-45		
		270-00-40		
	2	355-28-27	265-27-45.5	
		175-28-27		

76.5	8
<u>26</u>	<u>27</u>
50.5	42.5
	<u>45.5</u>

12/11/86

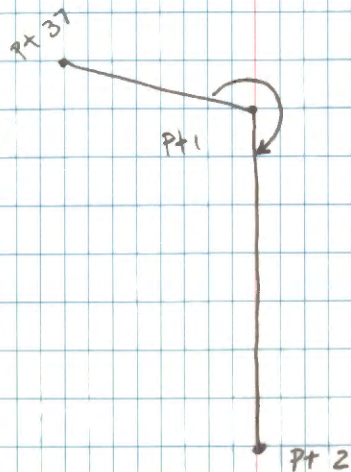

Turtle
Station



Hole used for setup.

Remainder of
Book —

Blank
Pages