

T58N R25W
TRAVERSE

T58N R25W TRAVERSE

K&S
FIELD BOOK

82 0032

TRAVERSE

I

T 58 N R 25 W 4th PM

INDEX

<u>Project</u>	<u>Page</u>
Traverse from E $\frac{1}{4}$ sec. 12	
to NE cor. sec. 12	1-3
TRAVERSE FROM SW CORNER	4-6
TO NORTHWEST CORNER SECTION 18	

COGO PRINTOUTS
NOT SCANNED

T50 W R25 W
 Traverse from Elkhor. Sec. 12 to NE

cor. sec. 12

STA 1st H&D 2nd H&R 3rd H&D 4th H&R 5th D

FS 3 180-00-40¹ ~~00-00-40~~ 180-00-57 00-00-53 180-00-04

BS 1 00-01-23² ~~180-01-23~~ 00-01-19 180-01-18 00-00-29

TC 2 179-59-24 ~~179-59-24~~ 179-59-38 179-59-35 179-59-35

179-59-35 ✓

V&D V&R feet meters

Dist 2-1 91-30-37 268-28-50 528.76 161.167 ✓ 91-30-37 ✓

Dist 2-3 85-19-15 274-40-09 574.26 175.036 ✓ 85-19-33 ✓

FS 4 180-01-07 ~~180-01-07~~ ⁰⁰⁻⁰⁰⁻⁵⁸ 180-01-04 00-00-48

BS 2 0-03'-32" 180-03-33 00-03-20 180-03-16

TC 3 179-57-35 179-57-25 179-57-34 179-57-32

179-57-32 ✓

4-1-87

30°F Sunny R. Main
 29.5 M. Hayes

Wild TZ Hoodolite
 Lietz Rod 1A EDME

ppm = 1

6th R

0-00-00 Sta 1 is a spike set at base of
 180-00-28
 179-59-32
 180-00-28
 179-59-32
 528.574^S
 572.350

Sta 3 Ties Spike

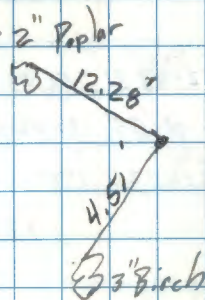

STA	1st H&D	2nd H&R	3rd H&D	4th H&R	Mean V&R
FS 5	180-13-51	00-13-49	180-13-49	02-13-48	
BS 3	01-01-25	180-01-13	00-01-19	180-01-16	
TC 4	180-12-26	180-12-26	180-12-30	180-12-32	
			180-12-31	✓	

	V&D	V&R	FEET	METRES
DIST 43	90-29-14	269-30-29	766.65	233.
DIST 45	90-16-10	269-47-21		90-16-25

4/7/87

Dist 4-3	90-34-00	269-25-30	765.68	233.381	90-34-15 ✓
Dist 4-5	90-17-21	269-42-10	605.42	184.533	90-17-30 ✓

FS 6	172-43-31	352-43-32	172-43-52	352-43-50
BS #	00-01-55	180-02-01	00-02-07	180-02-09
TC 5	172-41-36	172-41-31	172-41-45	172-41-41
		172-41-38		

Dist 5-6	93-29-25	266-29-55	161.38	49.190	93-29-45 ✓
----------	----------	-----------	--------	--------	------------

4-1-87

Horz Dist

EDM battery went
dead
~~70-26-32~~

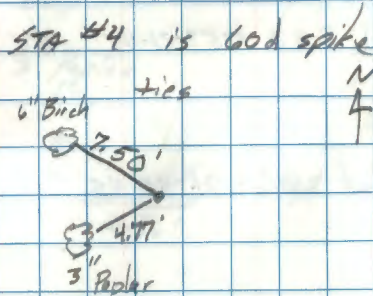

4/7/87 Miss Hayes
Hg = 30.0 Temp 55°
PPM = 0

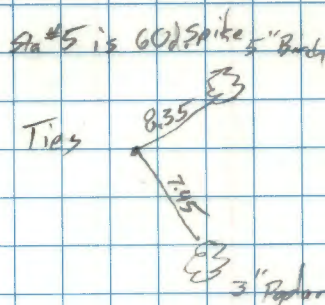

Sta #6 is County Monument
at 11/6
12/7

FS N¹/₆ 357-31-47

BS 4 00-00-00 turned twice

T@3 357-31-47

Dist. 3-N¹/₆ 91-03-45

215.20 65.576

Hore Dist

215.16

+ .03

215.19

4/7/87

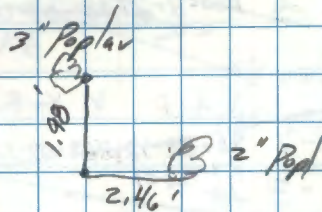
Set Spike for N¹/₆Temp Ties to N¹/₆ N

4

STA.	1 st	2 nd	3 rd	4 th
FS 3	180-13-01	180-13-01	00-13-00	
BS 1	00-09-33	180-09-54	180-09-54	
TC 2	180-3-28	180-03-03	180-03-06	

HEAT WAVING
TRIPOD

V

	V X D	V X R		
V-2-1	90-47-42	269-09-32	190.80	58,156
V-2-3	89-58-53		2801.01	853.752

FS 3

180-03-09	00-03-08	180-02-48	00-02-59
BS 1	00-00-20	180-00-24	00-00-04
TC 2	180-02-49	180-02-44	180-02-55

180-02-48

VA 2-1	90-47-01	269-12-33	190.78	58.153
VA 2-3	89-58-47	270-00-38	2801.03	853.757

FS

179-53-27	359-53-37	179-53-20	359-53-40	179-53-23
BS	00-00-30	180-00-31	00-00-20	180-00-34
TC 3	179-52-57	179-53-08	179-53-06	179-53-06

179-53-03

11/30/89
20° PARTLY Cloudy
Nov 11
R MAIN
DOJANEN

Wild T2
LIEZ REO JA

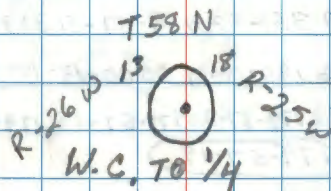
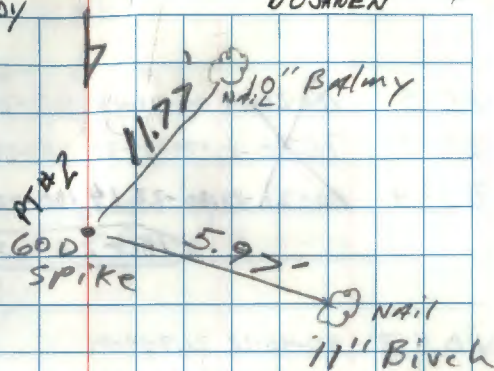

FS 5 ~~180-21-84~~ ³¹00-21-43 ¹²180-21-31 ~~00-21-41~~ 180-21-24
 BS 3 ~~00-00-10~~ 179-59-29 359-59-16 179-59-26 359-59-18
 TC 4 ~~180-21-24~~ ~~180-22-14~~ 180-22-15 180-22-15 180-22-06

180-22-13

VA 4-3 90-45-12 269-14-34 530.92 161.825

VA 4-5 85-14-22 274-45-16 368.59 112.340

FS 6 ~~179-34-33~~ ³²359-34-50 179-34-34 ¹²359-35-08 179-35-01

BS 4 ~~00-00-26~~ 180-00-47 ~~00-00-40~~ 180-01-16 ~~00-00-59~~

TC 5 ~~34-13~~ 179-34-03 179-33-54 179-33-52 179-34-02

179-33-58

FS 5A ²⁵209-21-15 ³²29-21-32

BS 4 00-00-26 180-00-47

TC 5 209-20-49 209-20-45

209-20-47

NOTE
 40.67 FT TO APPROX
 CENTER OF STR
 POSS GOVT LINE
 TREE

FS 7 179-57-29 359-57-41 179-57-31 359-57-40

BS 5 00-00-06 180-00-21 ~~00-00-13~~ 180-00-20

TC 6 179-57-23 179-57-20 179-57-18 179-57-14

179-57-19

VA 6-5 98-16-26 281-43-19 208.56 63.579

VA 6-7 87-47-41 272-11-56 312.09 96.649

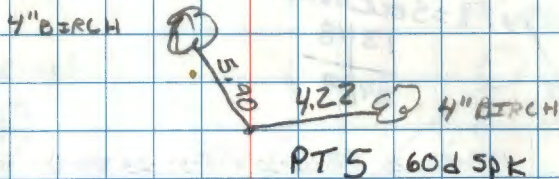
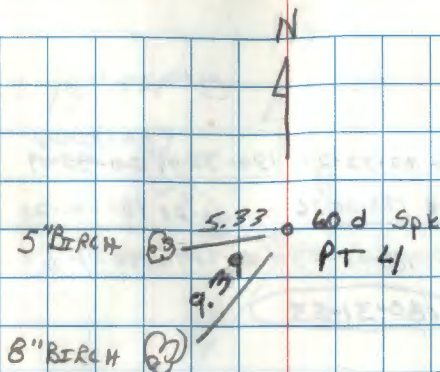

Possible Gov't Line tree

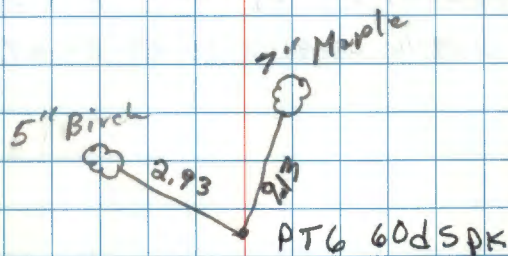

FS-8	190-32-12	00-32-28	190-32-09	00-32-27
BS-6	00-00-18	180-00-36	00-00-23	180-00-29
X @ 7	180-31-54	180-31-53	190-31-46	180-31-58

180-31-53

PT 9 = Sec CORNER

$$\begin{array}{r} 13 \overline{) 18} \\ \underline{24} \\ 19 \end{array}$$

FS-9	178-55-26	358-55-30	178-55-23	358-55-36
BS-7	00-00-22	180-00-28	00-00-12	180-00-29
X @ 8	178-55-04	178-55-02	178-55-11	178-55-07

178-55-06

8-7				
V Δ 7-7	38-50-17	276.09-31	662.90	202.088
V Δ 8-9	101-19-16	250.40-23	185.29	56.477

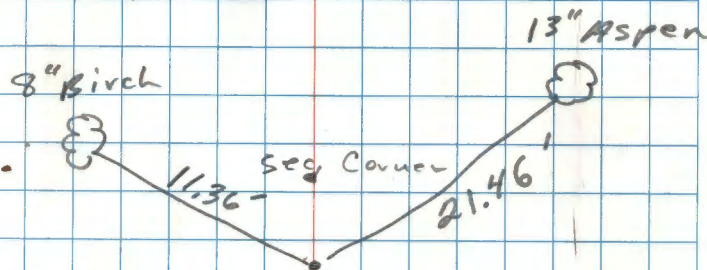
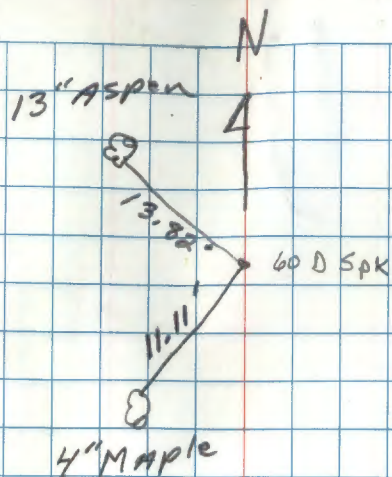



F
B
T

F
B
T

V
V

END OF
BOOK