

CORNER
RESTORATION
T58N R25W



MINING
TRANSIT BOOK

No. 384F

BOOK 1

CORNER RESTORATION T58N R25W

Original Govt. Survey was made
by Eli W. Griffin, Deputy Surveyor
February 10 to 26, 1873

INDEX TO CORNERS

			70	50	22		
	6	5	71	51	23	2	1
			68	48	24	20	21
7	8	9	67	47	25	19	12
			69	49	26	18	17
10	17	16	63	15	14	15	13
			61	62	38	39	12
19	20	21	60	22	37	28	11
			72	57	33	34	9
30	29	28	58	27	30	26	6
			75	54	35	29	2
31	32	33	54	53	34	27	35
			73	55	26	1	36

COLORLED NUMBERS REFER TO PAGE
ON WHICH NOTES FOR THAT CORNER
MAY BE FOUND.

1 X-21

1/4 Cor. Sec's 35 & 36

Orig. Notes: Spruce 10" NB7W 18Lks

Spruce 10" S78E 12Lks

5610-4 BY JANUKE 1/65

CERTIFICATE FILED

2

Sec. Cor. 25-26-35-36

Orig. Notes: - W. Pine 10" N20W 12Lks.

W. Pine 8" N.35E 20Lks

W. Pine 12" S61E 48Lks (31.68')

Aspen 10" S22W 22Lks

6/19 B.C. Craig

Found

Pine stump 30" S61E 44.4'

Est.

Balsam 8" N 02'E 17.00'

Aspen 6" S 63°W 45.80'

Aspen 2" S 17°E 13.40'

Aspen 7" N 30°E 83.10'

5/38

Found

Balsam 8" N 09°E 17.16'

Aspen 9" S 59°W 44.22'

Aspen 7" S 21°E 13.20'

Est.

Metal location poster on wht. spruce 7" N21°E 20.46'

(corner on edge of beaver pond). Balsam + Spruce
on edge of water.

CERTIFICATE FILED

6/65

Found no evidence of corner

5/83 K. Whitehorn B. Ausk G. Robertson D. Herman

Searched for approx 3 hrs. Found no evidence

3.

M.C. Sec. 25-36 W. BANK HANSON LAKE

Orig. Notes: Tam. 6" S85W 38LKs

Aspen 12" N78W 42LKs.

7

M.C. Sec. 25-36 E. bank McAlpine Lake

Orig. Notes: Aspen 6" N78E 30 LKs

Aspen 6" S67E 30 LKs

CERTIFICATE FILED

5

M.C. Sec. 25-36 on W. bank McAlpine Lake
Orig. Notes: Tam. 10" NB2W 55 Lks.

Tam. 8" S 48 W 110 Lks

CERTIFICATE FILED

6

1/4 Cor. Sec. 25-26

Orig. Notes: Aspen 11" S 20W 14 Lks.

Aspen 8" N 15E 21 Lks.

1919 B.C. Craig (No evidence found)

Est.

Aspen S 75° E 29.7'

Aspen 4" S-W 34.4'

Aspen 4" N-E 581.00'

6/79 Corner Gone

CERTIFICATE FILED

CERTIFICATE FILED

7

Sec. Cor. 23-24-25-26

Or Orig. Notes: N. Pine 16" N55W 16KG (10.56')

A. W. Pine 14" N41E 18KG (11.88')

N. Pine 12" S26E 42LKS (27.72')

Birch 8" S46W 6LKS

6/1919 B.C. Craig

Found

Dead Norway Pine West 11.0'

Pine stump N32°E 11.8'

Pine stump S35°E 27.7'

Est.

Aspen 3" N61°E 22.7'

1937

Found

GLO Pine N32°E 33.40'

Aspen 3" N61°E 22.7'

GLO Pine S35°E 27.7'

GLO Pine West 11.0'

~~At evidence~~ Recovered 3 GLO stumps
Est. (No Date, early 70's?) (1 legible stub)

Aspen 6" S25°E 16.88'

Aspen 5" S22°W 16.25'

Aspen 6" N80°W 14.22'

Aspen 7" N08°E 28.86'

5-18-83

B. AUST

G. ROBERTSON

So B.C.

D. HARMAN

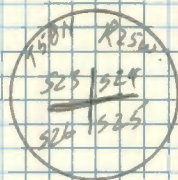

The SE. ASPEN is dead

8

M.C. Sec. 24-25 E. bank Hendricks LK.

0. Orig. Notes: Tam. 6" N65E 26 LKs

A W. Pine 14 S33E 13 LKs

CERTIFICATE FILED

9

MC Sec. 24-25 W. Bank Hendrichs Lk.

Orig. Notes: mkd a Spruce 7" for cor.

Tam. 7" N41W 11 Lks

Spruce 5" S62W 12 Lks

CERTIFICATE FILED

10

1/4 Cor. Sec. 24-25

Orig. Notes: Spruce 6" N64W 20 LKs

Spruce 6" SIDE 16 LKs

CERTIFICATE FILED

11

1/4 Cor. Sec. 23-24

Orig. Notes: Aspen 10" N20W 62 Lks

Tam. 8" N52°E 44 Lks

No Evidence (no date)

Est.

Spruce 4" S54°E 99.2'

Birch 9" S80°W 61.34'

CERTIFICATE FILED

12 N-21

Sec. Cor. 13-14-23-24

Orig. Notes: Aspen 10" N46W 16 LKs

Aspen 12 N45E 15 LKs

Aspen 14" S57E 26 LKs

Aspen 11" S14W 36 LKs

from the notes of Itasca County
Corner perpetuation Record

Set County Monument:

from which bears

Birch 7" S52E 31.23'

(Found Dead & Down Birch 8" S46E 31.23')

Birch 5" S40W 24.51'

(Found Dead Birch. S46W 24.51') a/14/10 gone

Birch 4" N46W 36.17'

(Found Dead Birch 6" N60W 36.17') a/14/10 gone

Aspen 5" N05E 19.00'

(Found Aspen stub 8" N18E 19.00') a/14/10 Gone

To bring this corner to standard I.C. of new BT

Birch 7" S22E 66.18' 524 BT ±20' SWAG

Maple 8" N39E 55.45 513 BT ±25' SWAG

Aspen 8" N21E 37.27 513 BT NOW A STUMP

Steel post 8' west 4.2' w/sign 54.2 54-9

4/51 Ronald Olson

CERTIFICATE FILED

11-15-99 R MAIN

FD ALL BTS DEAD. CORNER & SIGN POST IN GOOD
CONDITION. LINE TO STANDARD WEST TO 1/4 1/4
CORNER SURROUNDED BY YOUNG ASPEN 2 to 4" class 23

9/14/10 R. Main & M. Hayes
Itasca County monument in place 1.4' above ground
FD trees as noted.

New BT - Birch 6" N80°E 13.92' x 13.92' x 13.92'
513 BT

Hang pink ribbons running north for approx. sec. line

9/14/10 on ground

9/14/10 on ground

9/14/10 now 13" live w/broken top

9/14/10 gone

9/14/10 sign posts in place

13

M.C. E. of Cutaway LK Sec 13-24

Orig. Notes: W. Pine 20" N5 1/2 E 32 Lks.

W. Birch 10" S60E 26 Lks

CERTIFICATE FILED

17

M.C. W. of Cutaway LK. Sec 13-24
Orig. Notes. Tam. 10 N85W 126 LKs.

Tam. 10" S88W 130 LKs.

CERTIFICATE FILED

15

1/4 Sec. 13-14

orig. Notes: Tam 6" N10W 45 Lks

Tam 7" S88E 10 Lks

16

Sec. Coy. 11-12-13-14

Orig. Notes: Spruce 10" NBOW 10 LKs

Spruce 8" N52E 13 LKs

Spruce 6" S58E 9 LKs

Spruce 8" SBW 14 LKs

1961 Itasca County Peliquin
Set County Mon. from which:

Spruce	3"	S19W	6.73'
"	4"	N34E	13.60'
"	6"	N48W	2.55'
"	6"	S63W	26.00'

CERTIFICATE FILED

17

M.C. East bank Spring Lake - 12-13

Orig. Notes: Post

Tam 4" N61E 11 LKs

Tam 6" S29E 33 LKs

18

M.C. West bank Spring Lake 12-13

Orig. notes: post.

Tam. 7" NB6 W 52 LKs

Tam 6" S58 W 42 LKs

CERTIFICATE FILED

PL

19 G-21

1/4 Cor. Sec. 11-12

Orig. notes

Aspen 12" N83W 15.4Ks

Aspen 12" S95W 15.4Ks

From Notes of Itasca County Survey

Set County Monument.

from which bears

Red oak 5" N 35°E 13.64

Red oak 6" N 66°W 15.77

I found County Monument in place

and Red oak 8" N49E 13.64

Red oak 9" N51W 16.03

I cut New bearing there

N. Pine 19 S 86°W 57.10

Set 8' Long Steel sign post with
signs 54-2 & 54-4 North 2.6

10/13/78

Ronald W. Olson

CERTIFICATE FILED

20 E-21

Sec. Cor. 1-2-11-12

Orig. Notes: Past

W. Pine 11" N21W 45 Lks

N. Pine 18" N15E 29 Lks

N. Pine 18" S15E 17 Lks

W. Birch 10" S16W 15 Lks

5680-1 by G. JAHNKE 1W 1974

1961 Itasca County Peliquin

Set County Mon. from which:

Aspen 6" N28W 11.24'

Aspen 5" S22E 13.40'

N. Pine 14" N23E 48.65'

Aspen 6" S63W 6.95'

1981 Itasca County

found County Mon. AND all Bts

Established

Aspen 12" S62°E 14.54'

CERTIFICATE FILED

21 E-23

1/4 Cor. Sec's 1-12

orig. notes:-

BLK. Pine 12" N59W 10 LKs

N. Pine 10" S51W 8 LKs

5680-1 By JAHNKE, 1964

1961 Itasca County Peliquin

Set County Mon. from which:

J. Pine 10" S80°E 39.9'

Birch 6" N10°W 27.61'

22

M.C. North bank Hunters LK. Sec. 1-2

Orig. notes: Tam 3" for. Cor.

Tam. 6" N35W 19 LKs

Tam 6" N50E 22 LKs

1921 Itasca County Peliquin
Set County Mon. from which:

Ash	4"	N58W	42.72'
Birch	10"	N20°E	58.58'

CERTIFICATE FILED

23

M.C. South bank Hunters Lake Sec. 1-2

0 Orig. Notes: 3" Tam For Cor.

i Tam. 6" S1°W 7 Lks

7 Tam 4" S15E 42 Lks

1961 Itasca County Peliquin
found original stake and one
Bt. Stamp.

found

(Tam. Stp 501°W 4.62'

Set County Mon from which:

Tam. 5" N40°E 24.09'

Birch 9" S86°W 115.09'

CERTIFICATE FILED

24

1/4 Cor. Sec. 1-2

orig. notes: Aspen 14" N78W 14 LKS

W. Pine 14" S15E 42 LKS

1961 Itasca County Peliquin

set County Mon. from which:

Birch 6" N59E 25.00'

Birch 5" S68W 9.89'

1981 ITASCA Co.

found monument + Bts

Established

Birch 9" N13E 17.83

CERTIFICATE FILED

25 Y, Z-17

M.C. South bank Skeeter Lk. Sec 34-35

Orig. Notes: Tam 8" S33E 154Ks

Tam. 9" S57W 204Ks

5680-11 By Gorman

25

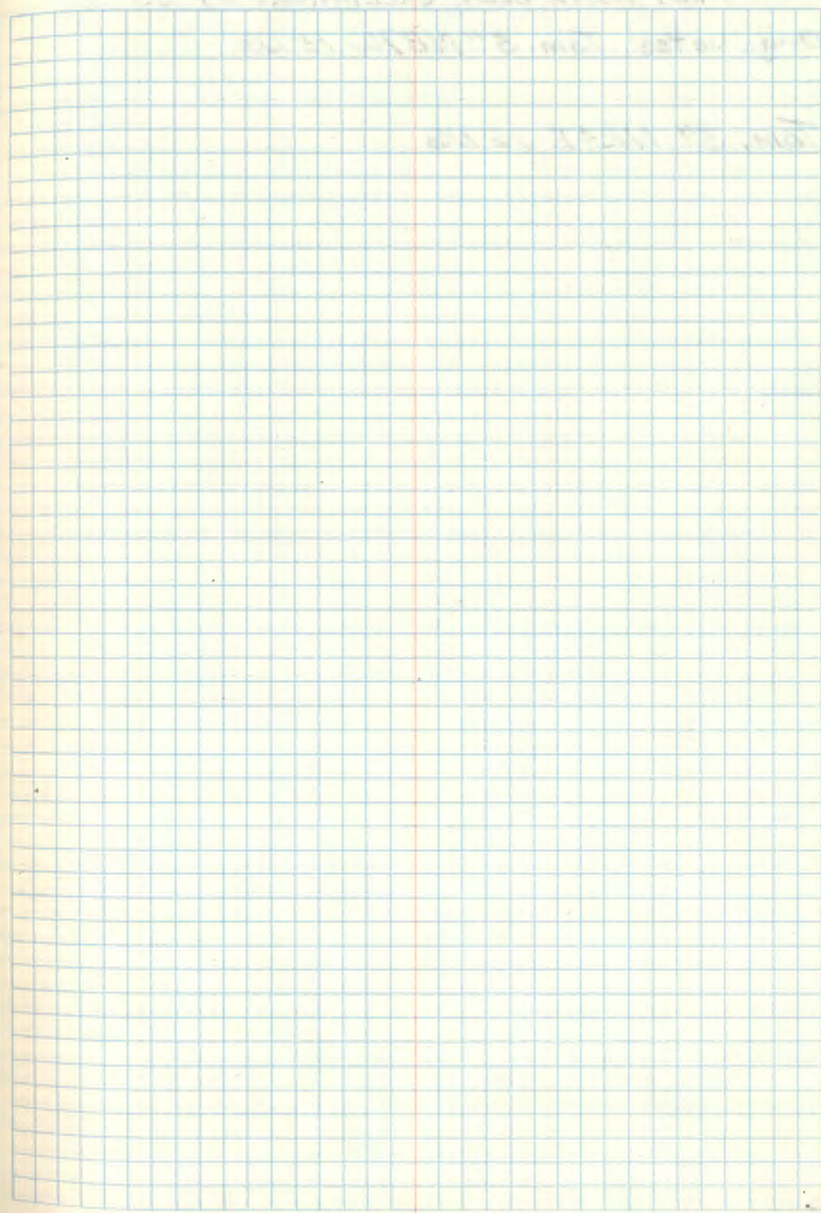

26

M.C. North bank Skeeter Lk. 34-35

Orig. notes: Tam. 5" NB7W 15 LKs

Tam. 3" NR4E 16 LKs

27

1/4 Cor. Sec. 34 - 35

Orig. Notes: W. Birch 10" N35W 50 Lks

Ironwood 6" S72E 10 Lks

CERTIFICATE FILED

35

28

Sec. Cor. 26-27-34-35

Orig. Notes: Tam 6" N22W 37 LKs

Tam. 6" N16E 26 LKs

Tam 3" S44E 18 LKs

Tam. 3" S30W 22 LKs

99
CERTIFICATE FILED

08-03-2009 R. MAIN

FD IRON IN PLACE AND GPS. ALL 1981 BTS ARE
DEAD OR DOWN. CORNER FALLS IN LARGE
BOE.

29

1/4 Cor. Sec. 26-35

orig. notes: N. Pine 12" N43W 30 LKs

W. Pine 14" S85E 20 LKs

CERTIFICATE FILED

30.

1/4 Cor. Sec. 26-27

Orig. Notes: post

Tam. 12" N70W 11 LKs

W. Cedar 6" N45E 6 LKs

31

M.C. South bank Plantation Lk. 26-27

orig. Notes: Tam 11" S60W 25 Lks

Tam 5" S27E 15 Lks

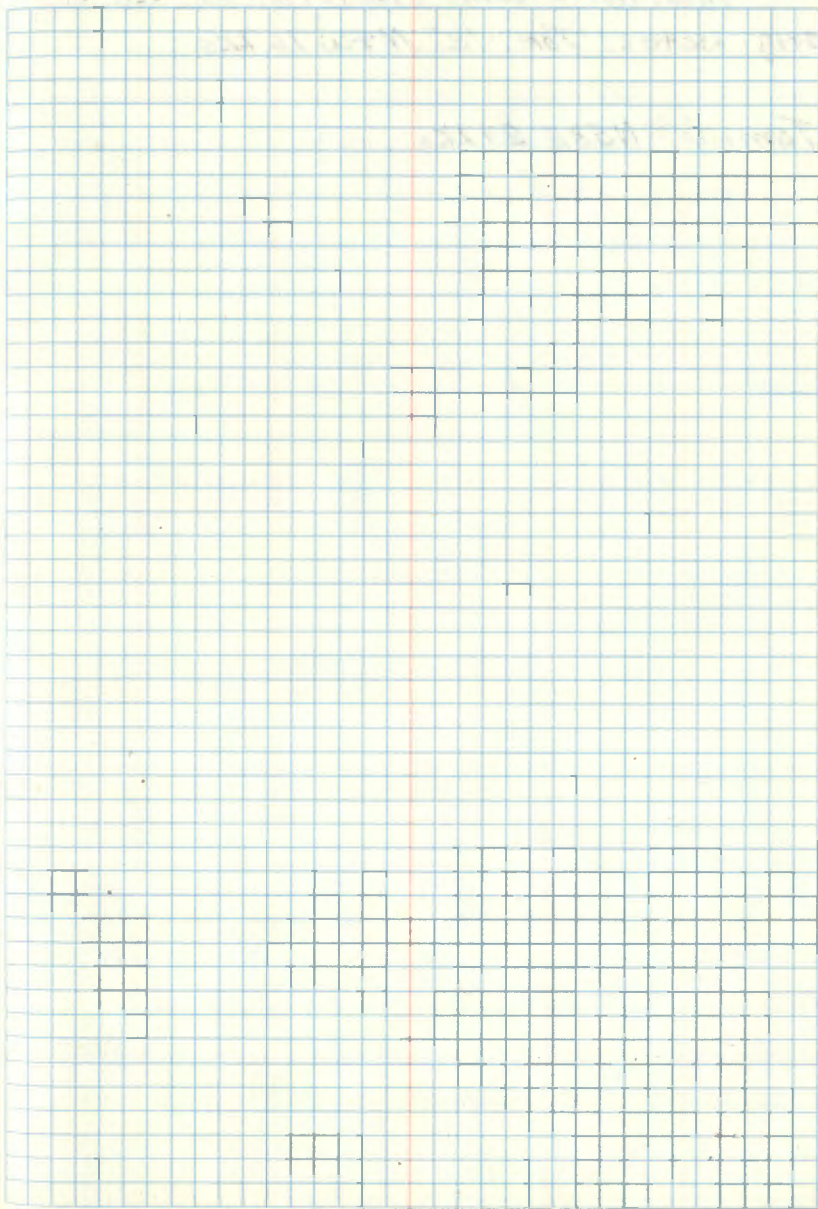

32

M.C. North bank Plantation LK. 26-27
orig. notes: Tam. 12" N4W 16 LKs

Tam. 6" N53E 29 LKs

33

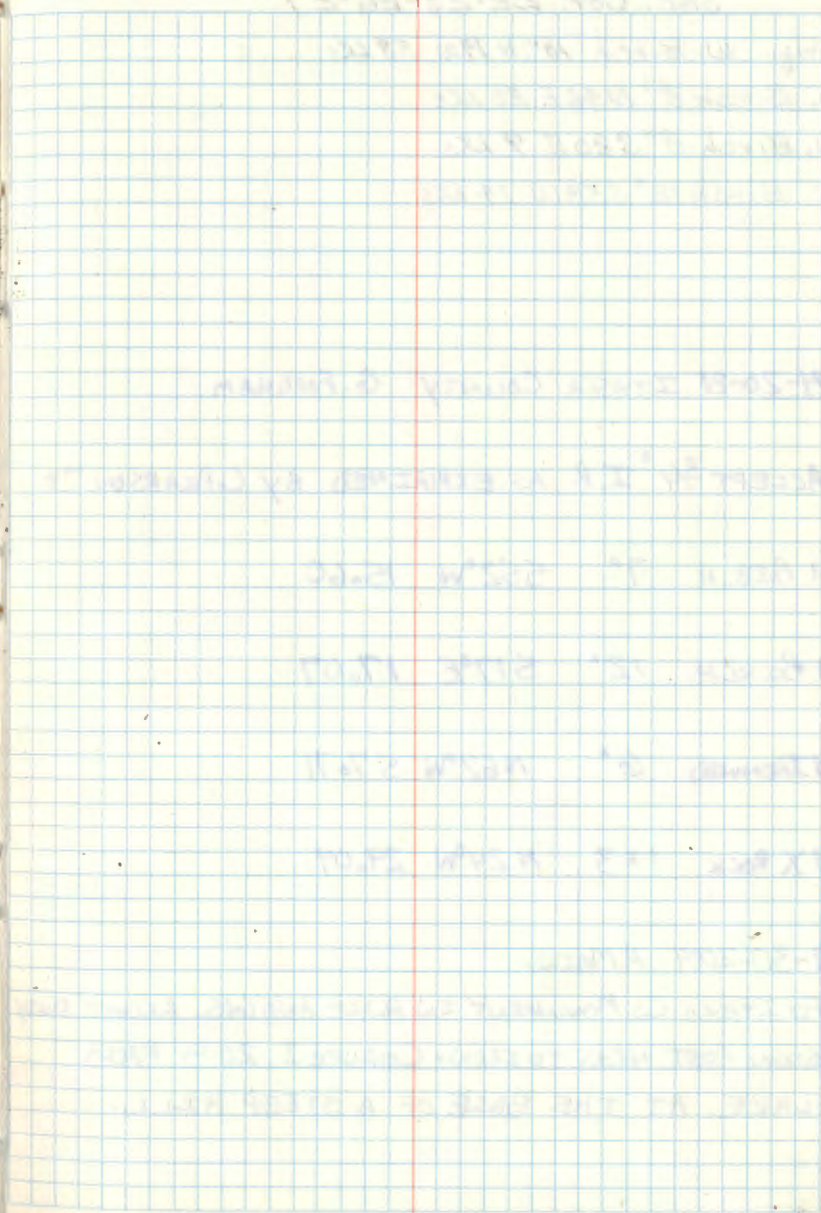

Sec. Cor. 22-23-26-27

Orig. W. Birch 10" N 19W 38 LKs

W. Birch 8" N 46 E 20 LKs

W. Birch 8" S 20 E 9 LKs

W. Birch 12" S 58 W 14 LKs

4-20-81 ITASCA COUNTY G. FORDHAM

ACCEPT $\frac{3}{4}$ " I.P. AS EXPLAINED BY C. PEARSON JR.

A81 BIRCH 7" S 52°W 15.60

A81 BIRCH 12" S 17°E 17.07

A81 IRONWOOD 6" N 62°W 57.71'

A81 X ROCK 1 X 3 N 24°W 29.09

7-30-2009 R MAIN.

FD ITASCA CO MONUMENT IN PLACE AND GDS. LIGHT DUTY
SIGN POST NEXT TO IRON. CORNER \pm 20 FT FROM
LAKE AT THE BASE OF A STEEP HILL.

34

1/4 Cor. Sec. 23-26

orig. W. Birch 8" N 28 1/2 E 17 LKs

Aspen 10" S 28 1/2 W 6 LKs

35

M.C. East bank Plantation Lk. 23-26

orig. Tam. 10" N42E 54 LKs

Tam. 8" S87E 62 LKs

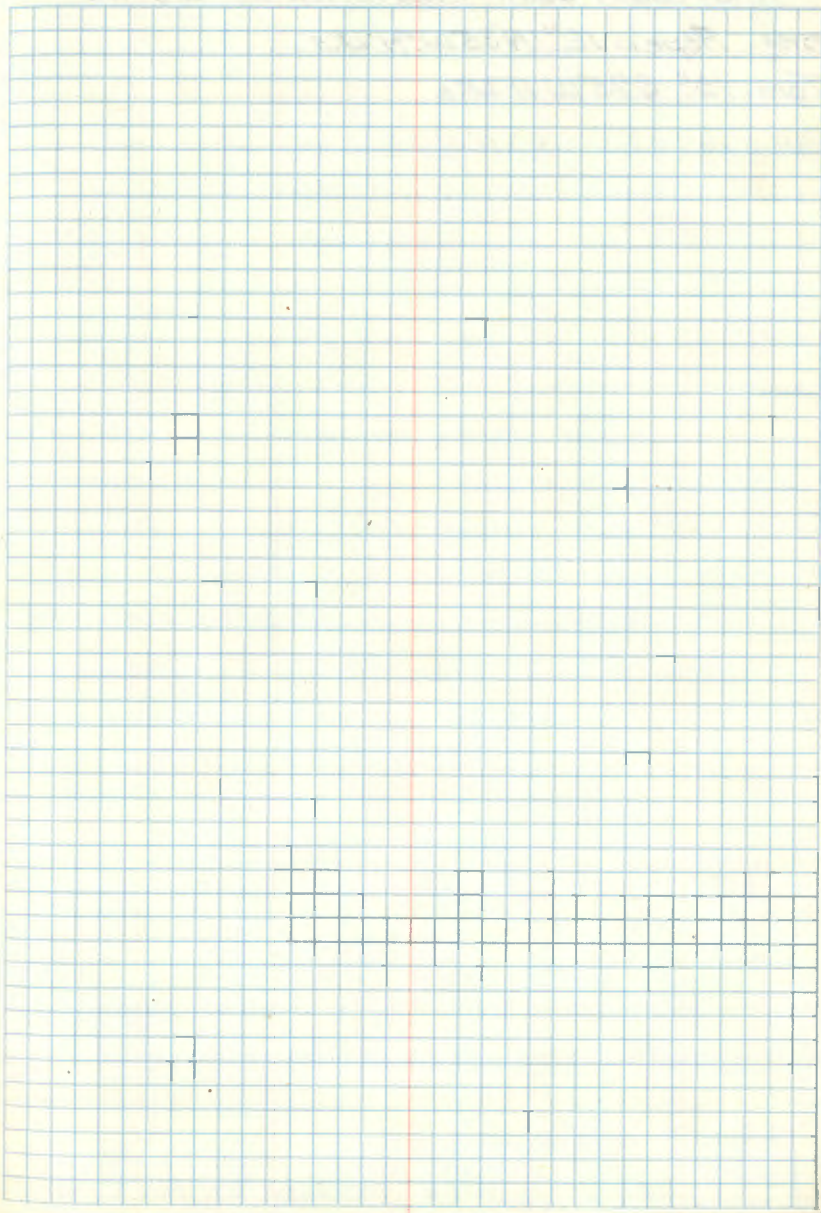

36

M.C. West bank Plantation Lk. 23-26

Orig. Aspen 12" N35W 91 Lks

Tam. 10" S75W 11 Lks

37

1/4 Cor. Sec. 22-23

orig. N. Pine 12" S81W 20 LKs

W. Pine 12" S84E 9 LKs

9-481 ITASCA COUNTY

COUNTY MONUMENT AND ROCK MOUND \pm 59 FT WEST
OF TRAIL

R PINE 6 S27W 20.35

R PINE 8 S56E 12.42

R PINE 28 N43E 33.23

X ROCK 1/2 X 1/2 N58W 40.68

7-30-09 R. MAEN

FD IRON AND ACCESSORIES IN PLACE AND GPS

38

Sec. Cor. 14-15-22-23

orig. W. Pine 12" N85W 181 LKS

W. Pine 10" S87W 175 LKS

01-08-1981 ITASCA COUNTY G. FORDHAM
FIND COUNTY MONUMENT 4" DEEP IN 808.

GLO STUMP N85W 119.46

BIRCH 4" N87W 122.10 (1961)
4 FT TALL X 8" STUB. ROTTED IN CENTER BY
ANTS.

J PINE 4" S44W 101.50 (1961)
NOW 30 FT X 6" SNAG SCRIBE VISIBLE

J PINE 6" S24W 114.20 (1981)
NOW 8" W/ NEW TAGS SCRIBE VISIBLE

8-03-2009 R. MAIN

FD IRON IN PLACE WITH CAP RUSTED OFF AND
PIPE DET. RESTORED. IRON IS ± 80 FT OUT
IN GRASS SLOUGH.

8-06-2009 R. MAIN

SET 5 FT X 3/4 INCH ROD MONUMENT WITH 3
INCH ALUMINUM CAP INSIDE 2 FT OF
SALVAGEABLE ITASCA COUNTY PIPE.
CAP STAMPED: TEBN R25W

S15|S14
S22|S23
2009
U.S.F.S.

MARK ONE NEW BT

R. PINE 10" S50°W 83.35 FT TO SPK MKD: S22 BT

39

N-19

1/4 Cor. Sec. 14-23

Orig. Notes: Spruce 10" S2E 51Ks

N. Pine 14" N60E 102Ks

From the Notes of Itasca County
Corner perpetuation recordSet a County Monument ^{found} _{monument} + OK
from which bears

Birch 4" S05W 46.6'

(found Birch 6" S11W 46.6')

Spruce 4" N20W 127.6'

(found spruce 6" N26E 127.6')

Z set a steel post 8' long East 3.6'

w/signs 54-2 & 54-9

6/51 Road Oban

A9-7150-4 by Olsen 6/81

11-15-99 R. MAIN

Fd Co IRON IN grass slough \pm 50 FT NORTH AND
 \pm 200 FT EAST OF HIGH GROUND. Co IRON up 2".

R. OLESEN SIGN POST up only 2 FT. ONLY SIGNS ABOVE

slough. Co BIRCH NOW A 10 FT TALL SWAG.

Co SPRUCE (BLACK) NOW 9" W/FS shield N22E @ Co DIST.

40 L-17

1/4 Cor. Sec. 14-15

Orig. Notes: Aspen 10" N87W 81K3

N. Pine 9" S88E 81K3

SEE 7100-52 HUNG TAG CHAINS WEST ON FR3755
NO DATE OR NAME ON CARD. R.M.

1961 ITASCA COUNTY EARL PELGREN

CO MONUMENT

BIRCH 6" S1W 99.97

J PINE 11" S50E 97.7

41 J-17

Sec. Cor. 10-11-14-15

orig. notes: Sugar 10" N46W 38 LKs

W. Birch 7" N24E 38 LKs

W. Birch 7" S78E 20 LKs

W. Birch 14" S51W 3 LKs

SEE CARD FILE

1961 Itasca County Peliquin
Set County Mon. ? from which:

DAK 3" S29W 37.40

Maple 20" N40W 9.88

ASPEN 6" N20E 25.33

Maple 4" S82E 35.22

CERTIFICATE FILED

42

1/4 Cor. 11-14

orig. notes: BLK. Pine 8" N75E 4 LKs

BLK. Pine 8" S73E 4 LKs

1961 Itasca County Reliquary

Set County Mon. from which:

Aspen 6" S30°E 25.27'

Aspen 6" N11°W 8.12'

CERTIFICATE FILED

43

1/4 Cor. 10-11

orig. notes: Aspon 12" S24W 32LKs

Aspon 12" S11E 43LKs

1961 Itasca County Peliquin

Set County Mon. from which

Birch 5" N70°W 10.45'

Birch 4" N75°E 8.92'

CERTIFICATE FILED

44

M.C. South bank Burrows Lk. 10-11

orig. W. Birch 12" S10W 20 Lks

Spruce 8" S57E 24 Lks

1961 Itasca County Peliquin

Set County Mon. from which:

Birch 9" S65°W 13.50'

Birch 9" S57°E 40.30'

45

M.C. North bank Burrows Lk. 10-11

orig. Aspen 6" SB2W 37 Lks

Aspen 6" N69W 21 Lks

1961 Itasca County Monument

Birch 4" N25°E 20.51'

Elm 4" West 38.55'

CERTIFICATE FILED

46. E-17

Sec. Coy. 2-3-10-11

orig. notes: W. Pine 16" N84W 980 LKS

N. Pine 12" S30E 170 LKS

W. Pine 18" S87W 405 LKS

Searched 2 hrs 12-7-60 did not find 1576 but believe we can tie in natural features. RHM

1982 Itasca County

Popple 7" S55°E 86.32'

Birch 7" S20°E 83.87'

1961 Itasca Co. Peliquin

Set County Mon. from which

Spruce 2" N44°E 3463'

Birch 7" S42°E 63.39'

found old Post which sits
unreadable Stamps

CERTIFICATE FILED

T58N

R25W

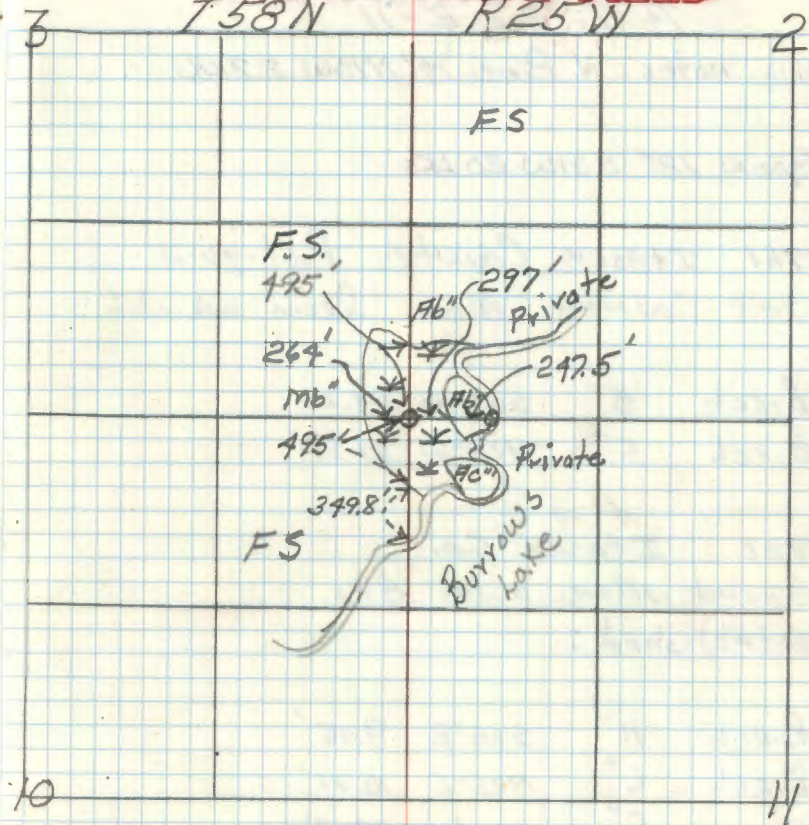

47

1/4 Cor. Sec. 2-11

orig. notes: N. Pine 14" N10W 27.1Ks

Aspen 12" S31W 20.4Ks

1961 Itasca County Peliquin
Set County Mon. from which:

Birch 5" S07°W 21.26'

Birch 5" N24°W 21.37'

1982 Itasca Co.

Found Mon. and Bts

Established:

Birch 11" S66°E 9.05'

Birch 6" N25°E 10.71'

Spruce 8" West 48.17'

CERTIFICATE FILED

48

M.C. East bank Burrows LK 2-11
 orig. notes: W. Pine 10" N26E 27 LKs

W. Pine 6" S54E 17 LKs

1961 Itasca County Peliquin
 Set County Mon. from which:

Birch 6" N57°E 25.0'

Birch 5" S68°W 9.89'

1982 Itasca Co.

Reset M.C.

Old Birch 12" N25°E 22.28'

Old N. Pine 17" S57°E 29.58'

1/2 W. Pine 6" N34°E 23.50'

CERTIFICATE FILED

49 E-17, 18

M.C. West bank Burrows LK 2-11
orig. notes: W. Pine 10" N21W 25.1Ks

W. Pine 16" S86W 91.4Ks

Searched 2 hrs 12-2-60 no evidence found RWD

1961 Itasca County Peliquin
Set County Mon. from which:
(AMC)

Birch 8" N55°W 10.62'

Birch 7" S61°W 44.21'

1982 ITASCA Co.

Set AMC

N. Pine 3" S62°W 17.22'

Maple 5" N80°W 19.22'

W. Pine 6" N15°W 47.68'

50 B, C-17

M.C. North bank MOON LK. Sec. 2-3

orig: MKD Norway pine 6" for cor.

N. Pine 15" N 4W 62 AKs or 70.92' ✓

N. Pine 10" East 33 AKs or 21.78'

Searched 2 hours but could not tie in
any stumps. 12-8-60 RHM

1961 Itasca County Peliquin

OAK 6" N60°E 56.13'

Birch 8" N15°W 31.50'

found GLO Stp. 15" N4W 40.92'

1981 Itasca County

Set A X Rock for corner

Co. Mon. Witness Bears south 0.75'±

OAK 6" N60°E 56.13

Birch 8" N15°W 31.50

Two new B's.

OAK 20" N89°E 61.26'

W. Pine 22" N09°E 34.14'

CERTIFICATE FILED

T58N

R25W

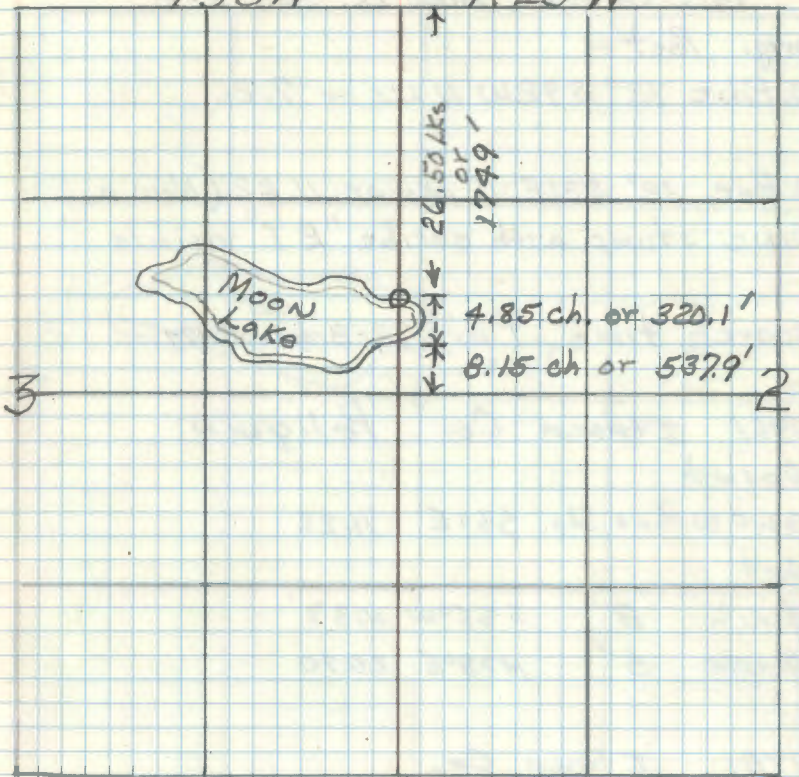

51 B, C-17

M.C. So. bank MOON LK. Sec. 2-3

orig. Post-

W. Pine 12" S 72 W 11 LKs or 7.26'

W. Pine 12" S 31 E 17 LKs or 11.22' (Now a
pine stump with scribe "BT" visible

search time 1 hr. 12-8-60 RHM

1961 Itasca Co. Reliquia
found

GLOW. Pine Stp. S 31 E 11.22'

Set

Birch 8" S 35 W 4.33'

Maple 6" N 78 E 20.70

1981 Itasca Co.

Sound Monument & Bts

GLOW. Pine Stp S 31 E 11.22

1961 Birch 8" S 35 W 4.33 Stb.

1961 Maple 6" N 78 E 20.70

1981 Birch 10" S 10 E 25.53

1981 X Rock 3 X 4 S 75 W 21.94

CORNER WAS VERIFIED BY USING GLOW STP.
& 1961 BIRCH, CORNER WAS FOUND STRAIGHT UP
& MATCHED GOOD. (Maple 20.25)

CERTIFICATE FILED

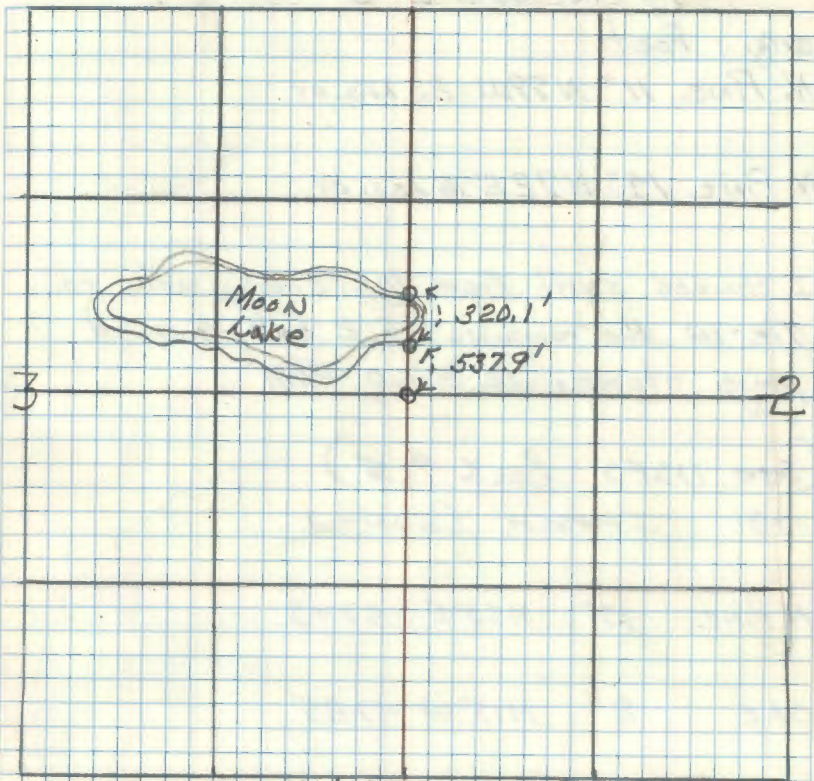

Taken from USFS Cadastral Survey Book 5
10/68 OKERMAN Found Itasca Co. Mon. Stmp

From which

Birch 10" S 62 W 4.5'

Tw. Maple 11" N 83 E 21.0'

Set Cedar Post 4X4 South 11.0'

ITASCA
M.C.
55
372

52

C-17

1/4 Cor. Sec. 2-3

orig. : Post.

N. Pine 11" N79W 23 Lks. or

N. Pine 14" N72E 6 Lks. or

I chained south from M.C. & was able to
Tie-IN the remains of 2 badly burned
pine stumps 12-8-60 RHM

(see USFS Book # 5)

1981 Itasca County

N. Pine 17" N53°E 57.43

OAK 8" N13°W 47.85

1961 Itasca County Peliquin
Set County Mon. From which:

N. Pine 12" S86E 38.27

Maple 5" N57W 21.07

10/68 okerman

Found Itasca Co. Mon. 1 3/4" Iron Pipe
with 2 1/2" Aluminum CAP Stmp.

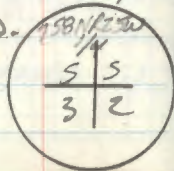

CERTIFICATE FILED

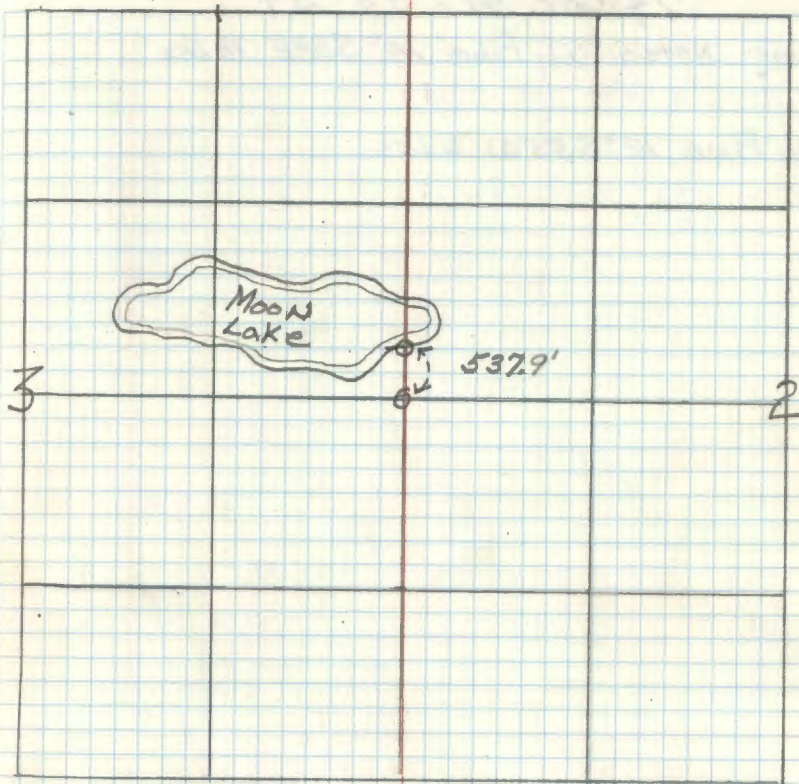

From which:

R. Pine 13" S87E 39.0 ft

S. Maple 6" N45W 21.3 ft

Set Cedar post 484 North 10.0' w/59-2

53

1/4 Cor. Sec. 33-34

orig. notes: W. Pine 14" S88E 18 Lks

W. Pine 12" S55W 6 Lks

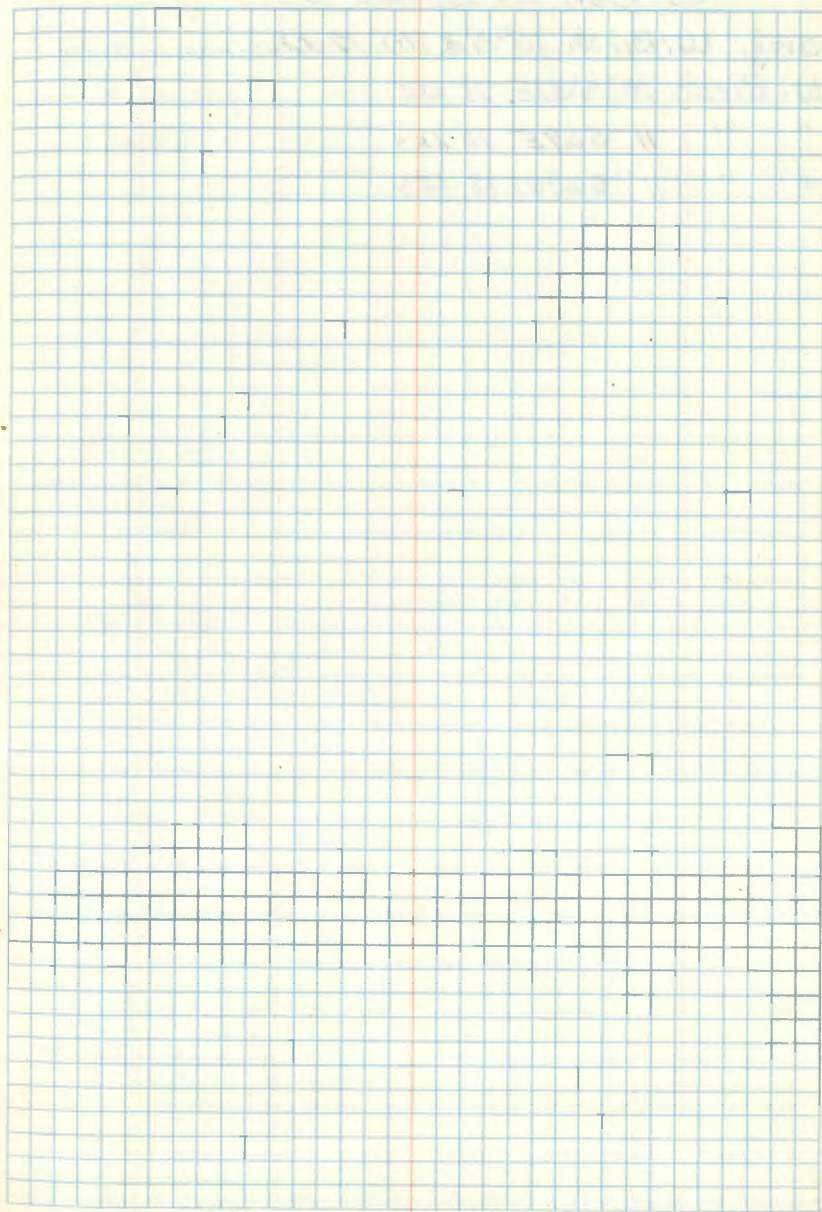

54

Sec. Cor. 27-2B-33-34

orig. W. Birch 10" N 37W 17 LKS

W. Birch 10" N 31E 11 LKS

" " 11" S 69E 10 LKS

" " 11" S 69W 13 LKS

55

1/4 Cor. 27-34

1 orig. notes: Balsam 5" S31W 12 LKs

1 BLK. Pine 8" N30W 10 LKs

56

W. P. South bank Moonshine LK. 27-28

orig. Notes: Maple 5" Fox W.P

W. Pine 12" S85°E 16 LKs

Aspen 12" S6W 29 LKs

57

W. P. North bank moonshine LK. 27-28
orig. notes: W. Pine 18" N20W 10 LKs.

Balsam 6" N40E 17 LKs.

58

1/4 Cor. Sec. 27-28

orig. notes: Spruce 12" N30W 24 Lks.

W. Birch 8" N62°E 20 Lks.

Spruce 10" S41E 23 Lks.

Spruce 10" S72W 32 Lks.

59

59

1/4 Cor. Sec. 22-27

orig. notes: Aspen 10" N6W 15.4Ks

Aspen 8" S56W 18.4Ks

12-22-1980 ITASCA COUNTY G. FORDHAM

SET 1/4 22²⁷ BY RETRACTING SURVEY BY
MN DNR.

FORDHAM SETS REDTOP FOR CORNER AND WITNESS

8/31 X ROCK 24" N35°W 37.66FT FLUSH

17/118 POLE 541°E 64.25

12/1180 W. PINE 7" N57°E 75.34 GONE/BACKSLOPE
CLEARING

06/1988 R. PINE 13" N45°E 57.46

06/1988 W. PINE 13" N06°W 54.03

7-30-2009 R. MAEVO

FD 1/2 IRON PIPE DOWN ± 1 FT AND GPS.

FROM ON NORTH SHOULDER RD TO PUBLIC ACCESS

SAND LAKE.

1/4 Cor. Sec. 21-22

orig. notes: W. Birch 6" S47W 54ks

Y. Pine 20" S39E 104ks

1919 B.C. Craig set 4' x 3" x 3" Post
from which:

Birch, 3", S32°W, 6.6 ft

Poplar, 3", S44°E, 26.7 ft

11/17/39 this corner was visited
by the state which left a tag
on a tree N60°W, 29 lks to
corner

Dec 1980 Itasca County found the county
monument from which:

DOWN Old Birch, 4", S26°W, 15.5 ft

ROTTED STP Birch, 7", N25°W, 21.46 ft

SNAG Poplar, 8", S37°E, 22.94 ft

DOWN Birch, 5", S30°W, 32.57 ft

1-3-87

B. AUSK
G. ROBERTSON

RECOVERED A "Iron Pipe with a
Aluminum cap stamped as shown:

DECT 5°E Up. #1 FACING SW

158 NR 25W
S | S
21 22

From which:

999
DOWN Poplar 9.7 S62°E 18.90' to a 16d nail on S FACE
Single Blaze No Scribing Visible w/60d SPIKE
SNAG Poplar 10.0 S46°E 23.28' to a 16d nail on NE FACE
Double Blaze SCR. " 1/4 S22 BT" w/60d SPIKE
DOWN Birch 5.9 S39°W 15.65' to a 16d nail on SE FACE
Double Blaze SCR. " 1/4 S21 BT" w/60d SPIKE
DOWN Birch 5.9 S46°W 33.03' to a 16d nail on SE FACE
Double Blaze SCR. " 1/4 S21 BT" w/60d SPIKE
ROTTED STP Birch 7.6 N14°W 21.85' to a 16d nail on NE FACE
Double Blaze SCR. " 1/4 S21 BT" w/60d SPIKE

STEEL Sign Post North 4.5' w/54-2
STEEL Sign Post South 4.2' w/54-2, 54-9

ALL TREES ARE PAINTED RED

NO OTHER TREES

7-30-2009 R. MAZZO

FD IRON IN PLACE AND GPS. ONE NEW COUNTY BT.

MAPLE 8" S62°E 21.20 FT TO SPK/WASHER
NOT SCRIBED 2/15/06

61 N-13

Sec. Cor. 15-16-21-22

orig. notes: W. Pine 10" S3W 68LKs (44.88 ft)

W. Birch 10" N85E 88LKs (58.08 ft)

Spruce 10" S18E 48LKs (31.68 ft)

Record in Itasca County - Court House
1961

Set Iron pipe with Alu. cap.
from which bears. (Monument in good condition)

N. Pine 16" S73E 119.4'

(Now N Pine 18" S67E)

Aspen 10" S77W 96.08'

(Now Aspen 14" S84W)

Aspen 8" N62W 103.47

(Now Aspen 13" N56W)

Birch N45E 217.75

(Now Birch 11" N51E)

I set a steel post 8' west 98.5' 4/21/90 54-9

9/10/80 Ronald Olsen

RA-7150-4 by Olsen

1919 B.C. Craig

Set 4" x 4" x 14" Pine Post

Found two stumps

N. Pine, 6", S73°E, 119.4 ft

Pine Stp, 15", S05°W, 70.0 ft

August 23, 1934 Recovery by E. Perry
4" Iron Post and 3/4" Iron pipe
N. Pine, 10", S69°E, 118.8 ft

1980 Itasca County Recovery

1919 N. Pine, 16", S73°E, 118.75 ft

Aspen, 10", S77°W, 96.08 ft

Aspen, 8", N62°W, 103.47 ft

Birch, 12", N45°E, 217.75 ft

See: T58N R25W BK 2 pg. 76

62.

N-15

 $\frac{1}{4}$ Cor. Sec's 15-22

orig. notes: Aspen 19" N33E 16 LKS

W. Birch 10" S53E 18 LKS.

5670-11 By JANNKE, 1964

01-07-1981 ITASCA Co G. FORDHAM
 FIND COUNTY MONUMENT 25' SOUTH OF SOUTH
 END OF OPEN BOG.

12/6 BIRCH	4"	S15°W	10.57	GONE 8/3/09
12/6 BIRCH	7"	N64°W	21.10	NOW 14" 8/3/09
1/81 MAPLE	6"	N85°W	35.15	NOW 11" DYING
1/81 MAPLE	8"	N50°E	19.00	GONE (BEAVER)
1/81 ASPEN	8"	S12°E	20.23	GONE (BEAVER)

08-03-2009 R. MAEN

Fd CO IRON UP 5 FT IN HEAVY BRUSH.
 GPS ED IRON.

63

1/4 Cor Sec. 15-16

orig. notes: Maple 6" S30W 18 LKS

W. Pine 10" N35E 27 LKS

7.16 ch. north of 1/4 cor. MKD 24" W. Pine
ON LINE.

64

Sec. 9-10-15-16

orig. Notes: W. Birch 8" N30W 12 LKs

W. Pine 8" N38E 10 LKs

W. Birch 8" S55E 10 LKs

Aspen 11" S90W 19 LKs

1961 Itasca County Peliquin
Set Co. Monument from which:

Birch 4" N58°E 15.95'

Birch 4" N55°W 11.60'

Aspen 4" S42°W 21.91'

Aspen 5" S32°E 27.68'

1981 Itasca Co.

Sound County Mon. AND All Bts

Set

Birch 5" N26°E 23.92'

W. Pine 30" S42°E 94.25'

CERTIFICATE FILED

65

M.C. East bank Last moose Lake 10-15
orig. notes W. Birch @ N56E 53 LKS

W. Pine 10" S83E 35 LKS

1961 Itasca Co. Peliquin
Set County Mon. Grow which:

Birch 7" S25°E 13.82'

Birch 6" S62°W 19.36'

CERTIFICATE FILED

66

M.C. West bank Lost Moose LK. 10-15

orig. W. Birch 4" N29W 23.4Ks

W. Birch 10" S81W 39.4Ks

1961 Itasca County Peliquin

Set County Mon. from which:

Birch 5" N85°W 27.23'

Birch 6" S62°W 19.36'

CERTIFICATE FILED

68 E-13 Affidavit 7-3-77

Sec. Cor. 3-9-9-70

orig. notes: Balsam 6" N46W 16 LKS

Balsam 6" N67E 10 LKS

N. Pine 10" S67E 19 LKS

Spruce 12" S31W 11 LKS

I found no original BT's

Survey by Itasca County recorded in
Itasca County Court House

"1961 Peliquin Set Monument

"Iron Monument." I found a 2" x 40"

Iron monument Laying on ground and
bent.

Aspen - 6" S48°W 13.03'

I found 7" Aspen dead S60°W 13.03'

Aspen 5" N48°W 12.7'

I found a 9" Aspen in good condition
with scar N42°W 12.7'

Aspen 7" N57°E 20.0'

I found a 10" Aspen in good condition
with scar N63°E 20.0'

Aspen 5" S57E 16.7'

I found a 9" Aspen in good condition
with scar S45°E 16.7'

CERTIFICATE FILED

To perpetuate this corner I reset
The County Monument from the distances
of the County BT's

I set a 8" Long Steel sign post
North 4.2' with standard FS. Signs 54-2
and 54-4

set a 8" Long Steel sign post East 4.2'
with standard signs 54-2 - 54-4

OK
M.E.S.
4/22/77
R.H.S.

4/22/77

Ronald D. Olson

CERTIFICATE FILED

9/15/81 Steffan

67

E-15 1/4 Sec. 3-10

affidavit 7-31-79

orig. Aspen 10" N18E 74KS

W. Pine 16" S60E 54KS

found no original BTs

County Notes of survey
recorded in Itasca County Court
house

1961 Reliquin Set Monument

Aspen 6" S76°W 20.25'

I found a stump cut by beaver with
scribe. Aspen 9" S89°W 20.25'

Birch 3" N26°E 19.79'

I found birch stump cut by beaver with open
face rotted N34°E 19.8' scribe visible

Iron Monument 2" x 40" capped

found Iron Monument in place in
good condition

To perpetuate this corner I witnessed
it by.

Elm 7" S59°E 55.7' Scribed 1/4 510 BT

Steel sign post 8' Long N53°E 10.6'
with standard F.S. signs 54-4 & 54-3

Steel sign post 8' Long N71°W 9.1'
with standard F.S. signs 54-4 & 54-3

Steel sign post 8' Long Due North 2.1'
with standard F.S. Sign 54-4

ok
M.C. 7/22/61
F.H.G.

4/21/77

Ronald W. Olson

CERTIFICATE FILED

9/15/81 Stetson

T. 58 N. R. 25 W.

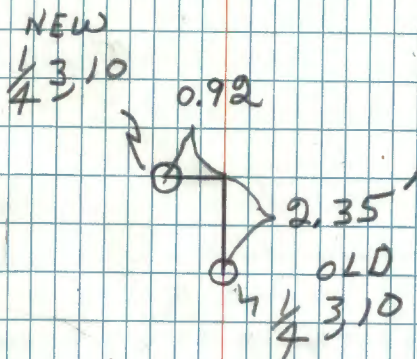
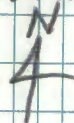

ASPEN 6" S. 76° W. 20.25'
BIRCH 3" N. 26° E. 19.79'

To perpetuate this corner I Witnessed
it by.

Elm 7" S 59° E 55.7' Scribed 1/4 510 BT

Steel Sign post 8' Long N 53° E 10.6'
with standard F.S. signs 54-4 & 54-3

Steel sign post 8' Long N 71° W 9.1'
with standard F.S. signs 54-4 & 54-3

Steel sign post 8' Long Due North 2.1'
with standard F.S. Sign 54-4.

OK
M.C. E 12261
F.W.S.

4/21/77

Ronald W. Oleam

CERTIFICATE FILED

9/15/81 Steffen

70

M.C. on South bank of LK. 3-7

orig. i W. Ash $12^{\circ} 55' 2'' E$ 6 Lks.

Red Elm $12^{\circ} 51' 4'' W$ 51 Lks.

1961 Itasca County Peliquin
County Monument from which:

Ash 4" $S 44^{\circ} E$ 33.63'

Ash 5" $S 40^{\circ} W$ 19.38'

71 C-13 Affidavit 7-31-79

1/4 Cor. Sec. 3-4

orig. notes: W. Birch 8" N85°E 36 LKS.
W. Birch 8" S 15W 20 LKS

11/9/77

STEFAN

ITASCA COUNTY HAS RESURVEYED SECTION
3; IT HAS NOT BEEN APPROVED AS
OF THIS DATE:

SET "AL" CAPPED IRON PIPE STAMPED
TO IDENTIFY CORNER FROM WHICH
THE FOLLOWING BEAR:

ASH	ASH
4"	8"
N30°E	S77°W
4.83'	5.77'

FOUND: "AL" CAP ON IRON PIPE

ASH STUB	ASH
6"	10"
N36°E	S88°W
4.8'	5.8'

CERTIFICATE FILED

9/15/81 Stefan

SET: ONE NEW B.T.

ASH	STEEL
14"	POST
N17°W	WEST
25.12'	3.3'

OK
MOS
R.L.S. #12261

CERTIFICATE FILED

1961 ITASCA COUNTY PELIGRIN
SET IRON MONUMENT FROM WHICH IS

ASH 4"	N30°E	4.83'
ASH 8"	S77°W	5.77'

Sec. Cor. 21-22-27-28

orig. Notes: Spruce 12" N30W 24 Lks. (15.84')

W. Birch 8" N62E 20 Lks. (13.2')

Spruce 10" S41E 23 Lks. (15.18')

Spruce 10" S72W 32 Lks. (21.12')

1919 B.C. Craig find post set by P.C. Warner
from which:

found one Gov't spruce

Spruce, 3" , S17½°W, 32.8 ft

Spruce, 3" , N71½°W, 42.5 ft

Pine Stp, 8" , N44½°E, 66.3 ft

Spruce, 3" , S50½°E 36.2 ft

Oct 23, 1934 E. Mergher (874) found
a 3" spruce post from which:
1873 Spruce, 12" , N25°W, 15.84 ftJune 1979 Itasca County set county
monument from which:
1919 Spruce, 3" , S17°W, 32.80 ft

1919 Spruce, 3" , S50½°E, 36.20 ft

Spruce, 8" , S59°E, 15.50 ft

Spruce, 8" , S84°W, 9.56 ft

Spruce, 8" , N27°W, 19.25 ft

"X" Rock, 1x2, North, 47.40 ft

Dec 1980 Itasca County recovered all
trees listed for 1979

Refer to Book 2 Pg 77

73

Sec. 32-33

M.C. on South bank Trout LK -

orig. Notes: W. Birch 10" S 65° E 20 Lks
or 13.2'

W. Birch 12" S 12° W 30 Lks. or

74

Sec 32-33

M.C. North bank Trout Lake

Orig. Notes: W. Birch 12' NBW 28 AKs or

Spruce 10" N 41 E 31 LKs

75

Sec. Cor. 28-29-32-33

Orig. Notes: W. Birch 10" N25°E 27 Lks

W. Birch 10" N25W 9 Lks

Ash 10" S61E 25 Lks

W. Birch 12" S46W 9 Lks

76

Sec. 28-33

MC. East bank moonshine lake

orig. notes: Spruce 8° N 68° E 16 Lks

W. Birch 14° S 63° E 15 Lks

77

Sec 28-33

M.C. West bank moonshine Lake

Orig. Notes: - Maple 12" N62W 8LKs

Spruce 8" S40W 12LKs.

87

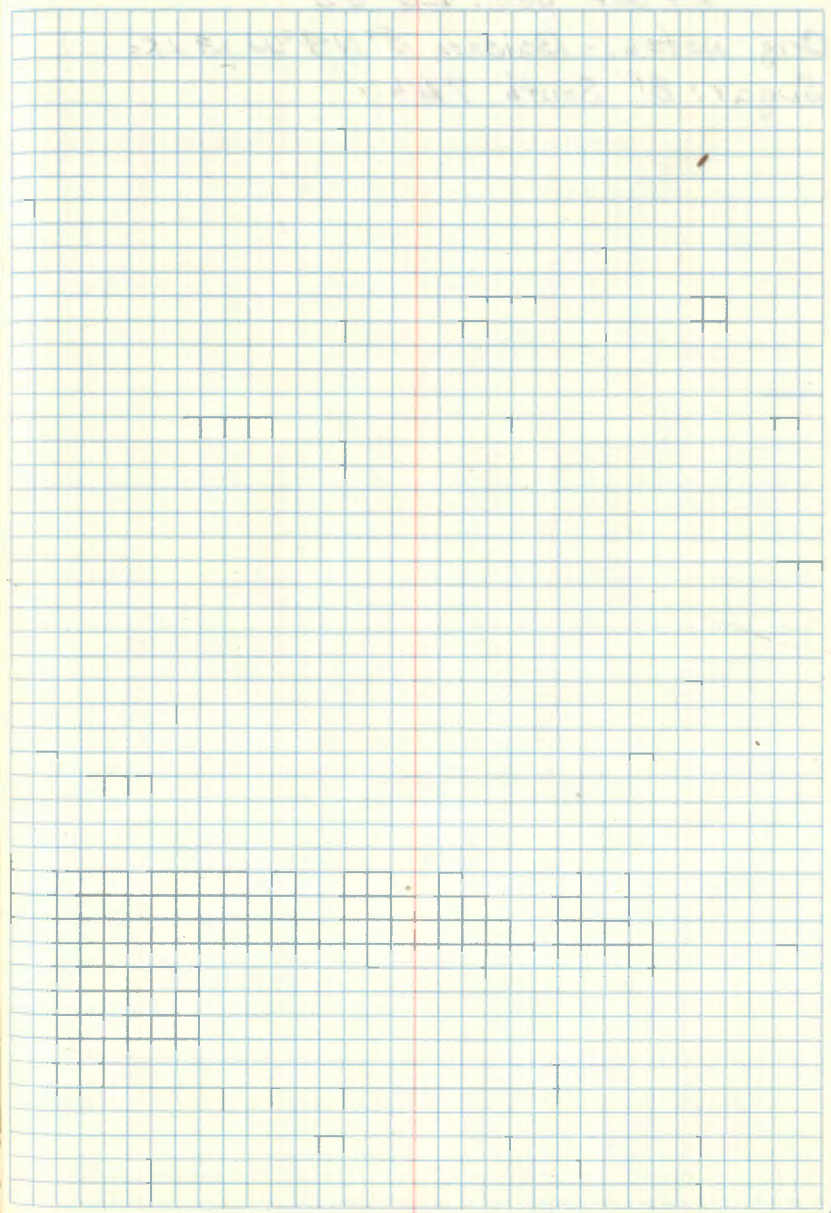

78

1/4 Cor. Sec. 28-33

Orig. notes: - Balsam 8" N 4° W 13 LKs

Sugar: 8" South 7 LKs

IMPROVED TABLES

Line Tree - E line Section 12-58-26

See page 71 Corner Restoration

Book 2, T58N R26W

10-26-81 KiW Ritehorn

24
5
3.70

IMPROVED TABLES AND INFORMATION

HORIZONTAL STADIA CORRECTIONS

2°-00'	— 0.1	21°-00'	— 12.8	33°-00'	— 29.7
3°-00'	— 0.3	21°-30'	— 13.4	33°-15'	— 30.1
4°-00'	— 0.5	22°-00'	— 14.0	33°-30'	— 30.5
5°-00'	— 0.8	22°-30'	— 14.7	33°-45'	— 30.9
6°-00'	— 1.1	23°-00'	— 15.3	34°-00'	— 31.3
7°-00'	— 1.5	23°-30'	— 15.9	34°-15'	— 31.7
8°-00'	— 1.9	24°-00'	— 16.5	34°-30'	— 32.1
9°-00'	— 2.5	24°-30'	— 17.2	34°-45'	— 32.5
10°-00'	— 3.0	25°-00'	— 17.9	35°-00'	— 32.9
10°-30'	— 3.3	25°-30'	— 18.6	35°-15'	— 33.3
11°-00'	— 3.6	26°-00'	— 19.2	35°-30'	— 33.7
11°-30'	— 4.0	26°-30'	— 19.9	35°-45'	— 34.1
12°-00'	— 4.3	27°-00'	— 20.6	36°-00'	— 34.6
12°-30'	— 4.7	27°-30'	— 21.3	36°-15'	— 35.0
13°-00'	— 5.1	28°-00'	— 22.0	36°-30'	— 35.4
13°-30'	— 5.5	28°-30'	— 22.8	36°-45'	— 35.8
14°-00'	— 5.9	29°-00'	— 23.5	37°-00'	— 36.2
14°-30'	— 6.3	29°-30'	— 24.3	37°-15'	— 36.6
15°-00'	— 6.7	30°-00'	— 25.0	37°-30'	— 37.1
15°-30'	— 7.2	30°-15'	— 25.4	37°-45'	— 37.5
16°-00'	— 7.6	30°-30'	— 25.8	38°-00'	— 37.9
16°-30'	— 8.1	30°-45'	— 26.2	38°-15'	— 38.3
17°-00'	— 8.5	31°-00'	— 26.5	38°-30'	— 38.7
17°-30'	— 9.0	31°-15'	— 26.9	38°-45'	— 39.1
18°-00'	— 9.5	31°-30'	— 27.3	39°-00'	— 39.6
18°-30'	— 10.1	31°-45'	— 27.7	39°-15'	— 40.0
19°-00'	— 10.6	32°-00'	— 28.1	39°-30'	— 40.5
19°-30'	— 11.2	32°-15'	— 28.5		
20°-00'	— 11.7	32°-30'	— 28.9		
20°-30'	— 12.3	32°-45'	— 29.3		

Chains to Feet

1	66
2	132
3	198
4	264
5	330
6	396
7	462
8	528
9	594
10	660

Feet to Chains

100	1.515
200	3.030
300	4.545
400	6.060
500	7.575
600	9.090
700	10.606
800	12.121
900	13.636
1,000	15.151