

THE UNIVERSITY
SAN FRANCISCO, CALIF.

#1

UNIVERSITY
FIELD BOOK
76 MF

CCC #97
found 1/17/92

TABLE OF STADIA REDUCTIONS.—Continued.

Min.	24°		25°		26°		27°		28°		29°		30°	
	Hor. Dist.	Diff. Elev.	Hor. Dist.	Diff. Elev.	Hor. Dist.	Diff. Elev.	Hor. Dist.	Diff. Elev.	Hor. Dist.	Diff. Elev.	Hor. Dist.	Diff. Elev.	Hor. Dist.	Diff. Elev.
0	83.46	37.16	83.14	36.20	82.78	35.40	82.39	34.75	81.96	34.15	81.50	33.60	81.00	33.00
2	83.41	37.23	83.09	36.24	82.74	35.44	82.35	34.79	81.92	34.19	81.46	33.64	80.96	33.04
4	83.37	37.28	83.05	36.28	82.69	35.47	82.31	34.83	81.88	34.23	81.42	33.68	80.92	33.08
6	83.33	37.31	83.01	36.31	82.65	35.50	82.27	34.86	81.84	34.26	81.38	33.71	80.88	33.11
8	83.28	37.33	82.96	36.33	82.60	35.52	82.22	34.88	81.79	34.28	81.33	33.73	80.83	33.13
10	83.24	37.35	82.92	36.35	82.56	35.54	82.18	34.90	81.75	34.30	81.29	33.75	80.79	33.15
12	83.20	37.39	82.88	36.39	82.51	35.57	82.13	34.92	81.70	34.32	81.24	33.77	80.74	33.17
14	83.15	37.43	82.83	36.43	82.46	35.61	82.08	34.95	81.65	34.34	81.19	33.79	80.70	33.19
16	83.11	37.47	82.79	36.47	82.41	35.64	82.03	34.97	81.60	34.36	81.14	33.81	80.65	33.21
18	83.07	37.51	82.74	36.51	82.36	35.68	81.98	35.00	81.55	34.38	81.09	33.83	80.61	33.23
20	83.02	37.54	82.70	36.54	82.32	35.71	81.94	35.03	81.51	34.40	81.05	33.85	80.57	33.25
22	82.98	37.58	82.65	36.58	82.27	35.75	81.89	35.06	81.46	34.42	81.00	33.87	80.53	33.27
24	82.93	37.62	82.60	36.62	82.22	35.78	81.84	35.09	81.41	34.44	80.95	33.89	80.49	33.29
26	82.89	37.66	82.56	36.66	82.18	35.82	81.80	35.12	81.37	34.46	80.91	33.91	80.45	33.31
28	82.85	37.70	82.52	36.70	82.13	35.85	81.75	35.15	81.32	34.48	80.86	33.93	80.41	33.33
30	82.80	37.74	82.48	36.74	82.08	35.89	81.70	35.18	81.27	34.50	80.81	33.95	80.37	33.35
32	82.75	37.77	82.43	36.77	82.03	35.92	81.65	35.21	81.22	34.52	80.76	33.97	80.33	33.37
34	82.71	37.81	82.39	36.81	81.99	35.95	81.60	35.24	81.17	34.54	80.71	33.99	80.29	33.39
36	82.67	37.85	82.34	36.85	81.94	35.99	81.55	35.27	81.12	34.56	80.66	34.01	80.25	33.41
38	82.63	37.89	82.30	36.89	81.90	36.02	81.50	35.30	81.07	34.58	80.61	34.03	80.21	33.43
40	82.59	37.93	82.25	36.93	81.85	36.06	81.45	35.33	81.02	34.60	80.56	34.05	80.17	33.45
42	82.54	37.96	82.20	36.96	81.80	36.09	81.40	35.36	80.97	34.62	80.51	34.07	80.13	33.47
44	82.49	38.00	82.15	37.00	81.75	36.13	81.35	35.39	80.92	34.64	80.46	34.09	80.09	33.49
46	82.45	38.04	82.11	37.04	81.71	36.16	81.30	35.42	80.87	34.66	80.41	34.11	80.05	33.51
48	82.40	38.08	82.06	37.08	81.66	36.20	81.25	35.45	80.82	34.68	80.36	34.13	80.01	33.53
50	82.36	38.11	82.02	37.11	81.61	36.23	81.20	35.48	80.77	34.70	80.31	34.15	79.97	33.55
52	82.32	38.15	81.97	37.15	81.56	36.27	81.15	35.51	80.72	34.72	80.26	34.17	79.92	33.57
54	82.27	38.19	81.92	37.19	81.51	36.30	81.10	35.54	80.67	34.74	80.21	34.19	79.88	33.59
56	82.23	38.23	81.88	37.23	81.46	36.34	81.05	35.57	80.62	34.76	80.16	34.21	79.83	33.61
58	82.18	38.27	81.83	37.27	81.41	36.37	81.00	35.60	80.57	34.78	80.11	34.23	79.79	33.63
60	82.14	38.30	81.79	37.30	81.36	36.41	80.95	35.63	80.52	34.80	80.06	34.25	79.74	33.65
c = 75	68	31	68	32	67	33	66	35	65	36	64	37	63	38
c = 115	1.05	48	1.04	50	1.03	51	1.02	53	1.01	55	1.00	57	0.99	59
c = 190	1.73	79	1.72	82	1.70	85	1.69	88	1.67	91	1.65	94	1.64	95

Published by the A. LITZ Co., San Francisco, Cal.

T146N R30W		T146N R31W		T147N R30W		T147N R31W	
Sec	Page	Sec	Page	Sec	Page	Sec	Page
1	8	8	74	5	5	17	4
2	9	14	75	9	7	18	15
		4	76	10	10	17	16
		15	77	16	77	36	49
		15	78	19	27	14	62
		2	79	29	24	15	63
		6	82	30	23	9	64
		7	83	18	28	9	72
		7	84	7	32	36	73
				12	38	5	80
				1	39	6	81
				9	52	27	76
				7	53	4	53
				15	54		
				16	55		
				17	56		
				5	57		
				2	58		
				16	59		
				9	60		
				8	61		

T148N R30W		T148N R31W		T149N R30W		T149N R31W	
Sec	Page	Sec	Page	Sec	Page	Sec	Page
32	11	27	30				
31	12	22	65				
29	13	21	66				
20	14						
15	26						
18	17						
17	18						
16	19						
33	20						
28	21						
21	22						
2	22						
36	40						
25	41						
25	42						
24	43						
32	44						
32	45						
33	46						
33	47						
4	48						
5	50						
4	51						
29	67						
28	68						
29	69						
32	70						
30	71						
17							
10	82						

T147
R29
Sec Page
19 54
20 55
17 36
21 61

Blank Pages

61-65 (58)

509

507

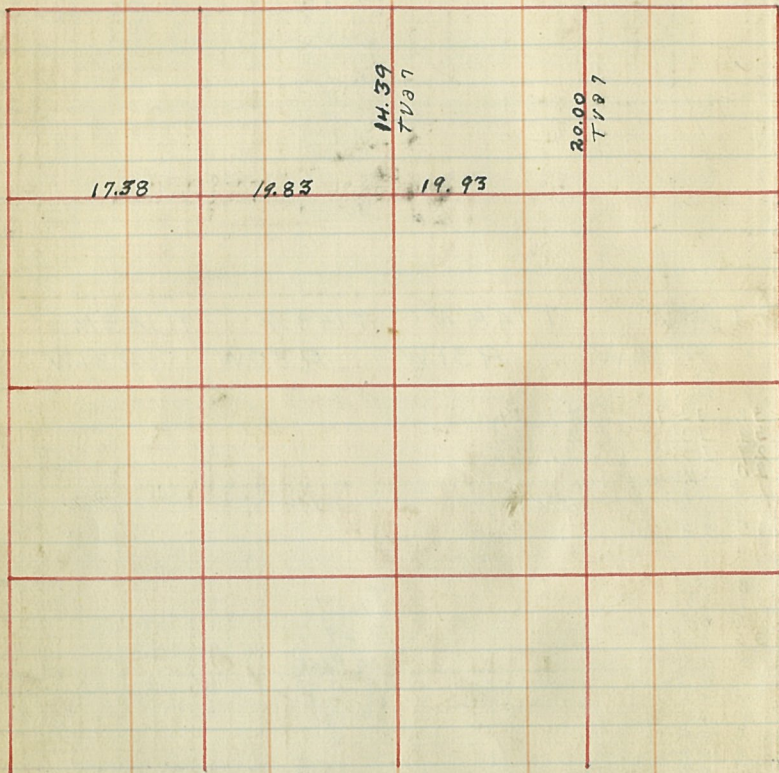

Sec. 7 T146

R30

4/15/35

Murphy

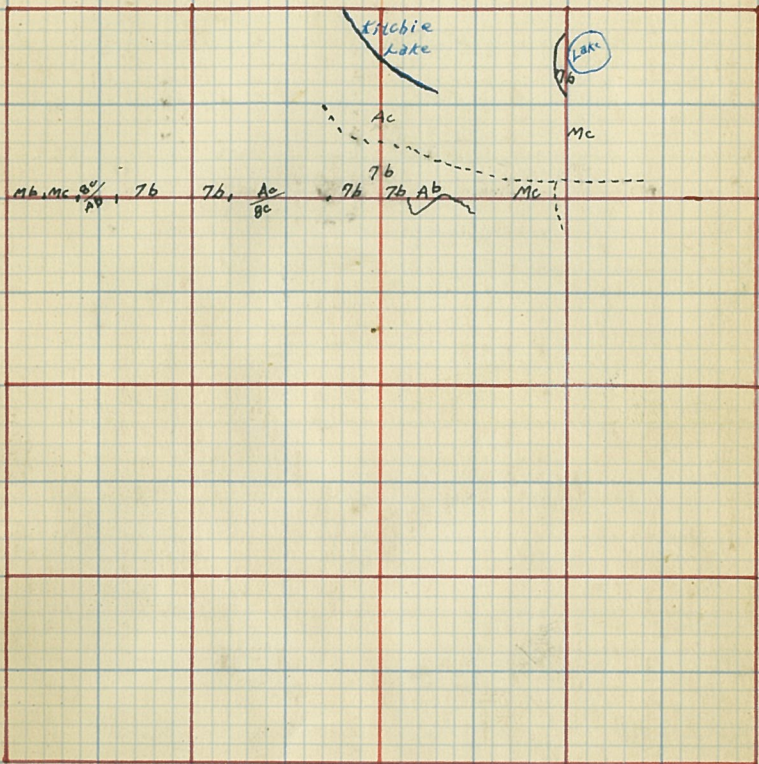

Sept 19 - July - 30

100
5000

56

1000
2

56

Inman

S.T.A.	Direction	Dec°	Type	Chainage	Remarks
S.W.C.	N	8°	5c	20	
18 chs. W. of True Cor. (G.L.S.)	E 90°	8°	Aa	20	
	S		1	20	
	W 90°		5a+3a	20	

STARTING POINT. G.L.O. 1/4 Cor. Sec.-17-20.

W. 40 chs. N 20 chs. ALL corners on N.W. 1/4 S.W. 1/4

Temporary.

Lund
6-21-34

S 117 1516 520 521	N	12°	8c 36	3+70	sec. Cor. 1/4 Cor. Mid B-45 cut Bb/Ab
3+70			0	705	
10+75			Ac	75	
11+50			1	150	Willow
13+00			0	20	1
13+20 1/8c			0	400	Temp. Cor. set in MEADOW
17+20			M/MB	400	
21+20			Ab	520	Temp 1/4 Stake N.E. of large W. Oak In man's Stake S 60° E 136 ft old Line 5.6 ft
E 1/8	W	10°	0	1320	

Sec 17 T.147N. R. 31W.

4

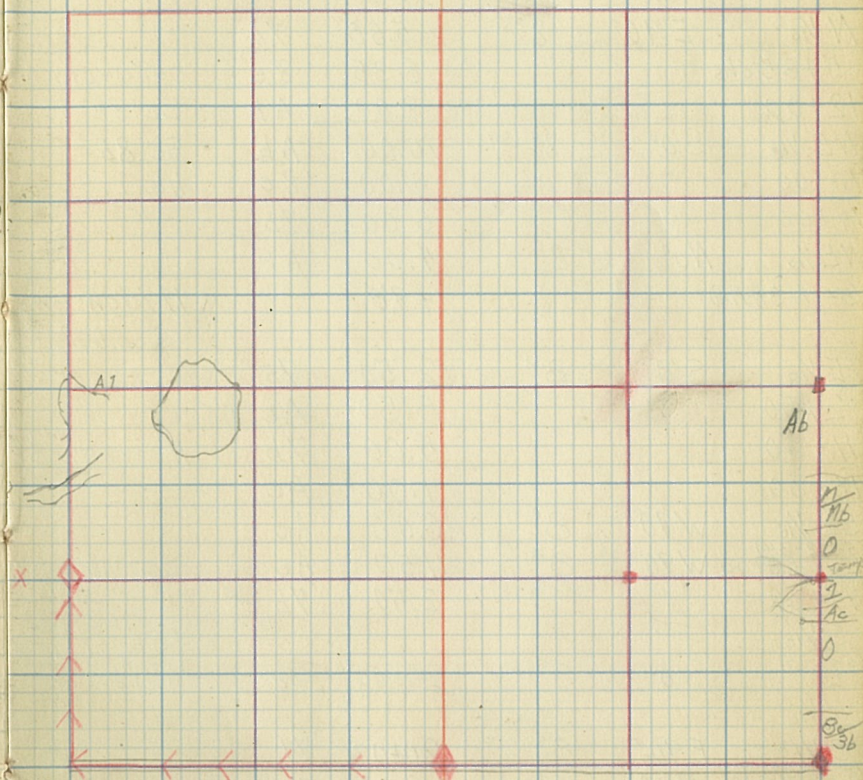

Sta.	Direction	Declination	CHAINAGE	Type	REMARKS
N 1/4 Sec. 5	S 0°	8°	19.16	7b	Old Blazed Line

May 17, 1934 Lund-Murphy-Westby-Finner

N 1/16	E 90°	8°	5.65	7b	
5+65 chs			6.35	8e	cut over N.P.
12+00			8.00	Ab	Sc. 8b
NE 1/16	S 0°	8°	10.00	Ab	Sc. 8b
10+00			4.00	8e	Heavy Slash
14+00			6.00	7b	" "
NE 1/16	N 0°	8°	4.00	Ab	
(5-18-34) 4+00			14.96		19.75 chs. to N.E. Sec. 5
E 1/16	S 0°	8°	2.50	7b	
2+50			8.50	Ac	
11+00			5.00	7b	Heavy Sl + Br.
16+00			4.00	Ac	
SE 1/16	W 90°	8°	6.00	Ac	
(5-22-34) Lund 6+00	W 90°	8°	11.50	Ac	Small Alder SW.
17+50			2.50	7b	
S 1/16					Cedar Stake Set in Small Swamp 12 to 20 chs. Very Thin
(5-19-34) Inmate	S 0°	8°	20+00	7b	
N 1/16					
C 1/4	E 90°	8°	20+03	7b	
(5-22-34) 5 1/16	N 0°	8°	3.00	7b	
3+00			11.00	Ac	
14+00			5.86	7a	Muskeg-Stagnant B. Sp. Swamp 24 chs E of C 1/4

Sec. 5 T147N R30W

Haroldson

10/21/34

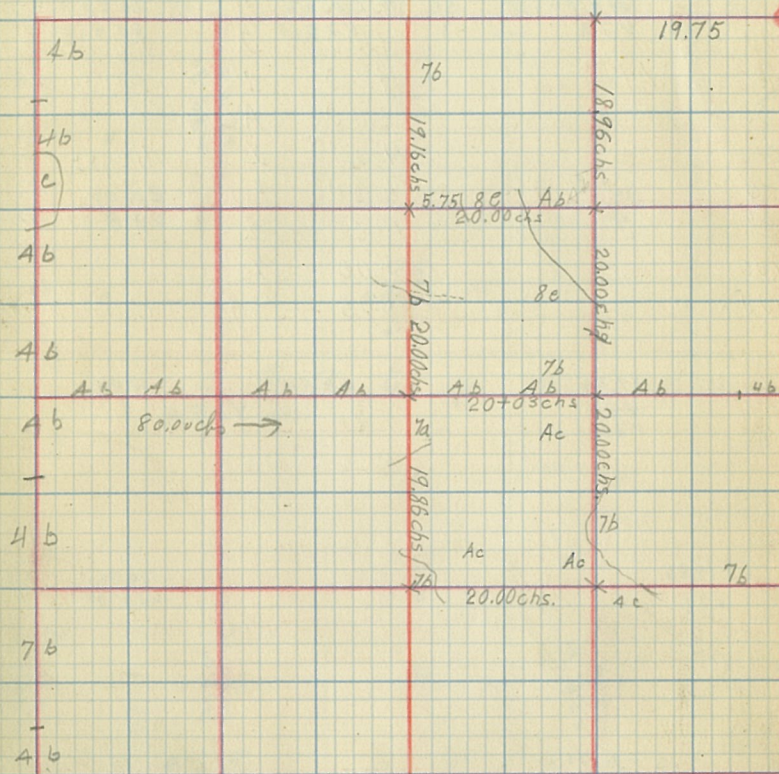

STA.	Direction	Decl.	CHAINAGE	Type	REMARKS
(5-24-34)					
Sec. Cor 4-5-89	E	N8°E	2.00	Bb	
2+00			10.00	7b	
(6-6-34)			5.50	3c	
12+00			2.50	7b	Set Tem. 1/8 Old line 10ft N
17+50			5.00	7b	
W 1/8			2.00	8d/Bb	
5+00			1.00	O	
7+00			6.00	Bd	cut along line SLASH
8+00			5.86	Bc	Old 1/4 STAKE .67 chs. South
14+00	S1°W	N8°E	10.00	Bc	HEAVY CUTTING
1/4 (Sec. 4-9)			10.00	Bc	Set TEM. 1/8 Cor.
(6-8-34)			14.00	Bc	
14+00			6.00	Bc	Set cedar stake at 1/4 cor.
C 1/4 Sec. 9			16.25	3b	
16+25			3.75	7b	Set p 1/8 stake, 7 chs. to E ROAD
1/8			20.30	7b	.70 chs. W. of old 1/4 STAKE
1/4 cor. Sec. 9-16	N89°30'W	N8°E	16.00	7b	
(6-11-34)			3.00	7b	
18+00			1.00	Ab	Set Tem 1/8 cor.
19+00			6.00	Ab	
W 1/8 - Sec 9-16			2.00	7b	
6+00			11.80	M/Bb	Line came out on STAKE CHAINAGE to stake beside ROAD.
8+00					

Sec. 9 T147N. R30W

7

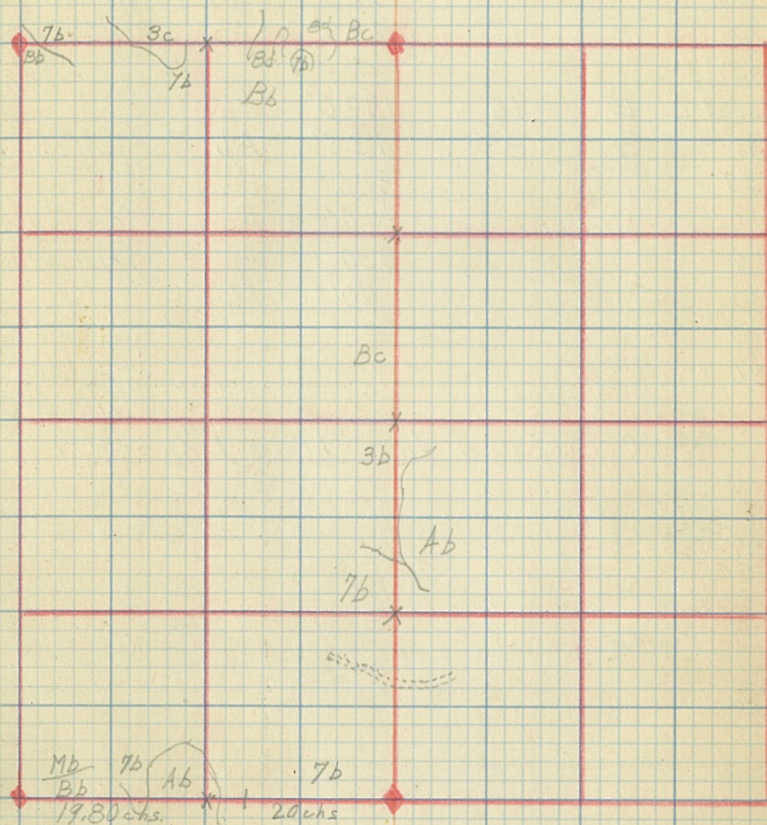

Lund (6-1-34) Sta.	Direction	Declination	CHAINAGE	Type	REMARKS
Sec. Cor. 1-2-11-12	E	17°	400'	A	
4+00			250'	2-0	Muskeg-grass
6+50			350'	Ac	Few J.P. Piles
10+00			320'	Ab	No STAKES or BT3 TEMP. COR.
W 1/16	E	17°	245'	Ab	BURNS ROAD
(6/22/34)					
5 1/8 Sec 1-2	E	16°	1320'	Ab	Checked Line
SW 1/16	S	8°	135'	Ab	Cross Road With Line
1+35			365'	O	Grass Swamp To East
5+00			400'	Ac	Willow Creek Rd
9+00			330'	Ac	Road at 350'
12+30			70'	Ac	TRIAL line at 1230'
13+00				Ac	Old Survey 1/16
13+00					Line 12.4' E of Old 1/16
					Old TRIAL line N. of Old 1/16

20.52
TV 214'15"

18.6.30

20.00
V 3 1.50

20.95
V 2 16
TV 214'15"

Old Trial Line E 1/16 - Sec. 1-2-11-12

Sec. 1 T146N R30W

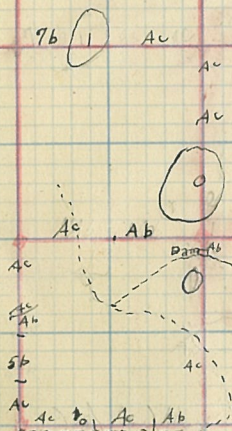

Lund

(15-29-34)

STA.	direction	Declination	Chairage	Type	REMARKS
Sec. Cor. 2-3-94	E 90°	8°	2.00	7c	PEAT 4ft +
2.00			2.00		" 2.5' clay
4.00			2.00		" 1.0' "
6.00			2.00	A	W. SAND.
8.00			12.00	A	SAND GRAVEL Clay
W 1/8 (8-31-34)	S 40° W		0.475		Old Survey ^{Tree} _{Post} 20' W 25' N
W 1/8	S 88° 30' E	8°	1060'	A	
10+60			239'	7 1/2	1.5' Peat 17' N to Old Acorn
1/4 Sec. 2-11	S 89° E		1000'	A	
10+00			200'	0	creek at 11+60
12+00			115.5'	A	35.3' S. to Old 1/2 Stake
E 1/8	S 89° E	8°	300'	1	cut over T.P.
(6-1-34)					
3+00			700'	3 1/2	
10+00			320'	Ac	Post Hole N. at 11+00 31' S to Old Stake
Sec. Cor. 2-11-72					

Sec. 2 T146N R30W

9

7c, A, Ab, Ab, (7b), Ab, 1/4, 46.3521, 1/4

Lund:

Sta.	Direction	Decl.	Chainage	Type	Remarks
(6-2-34)					
1/4 cor Sec. 1931	S. 0°	8°	383'	M	Road
3+83.			937'	M	ROAD AT 1050' Old line = 1305'

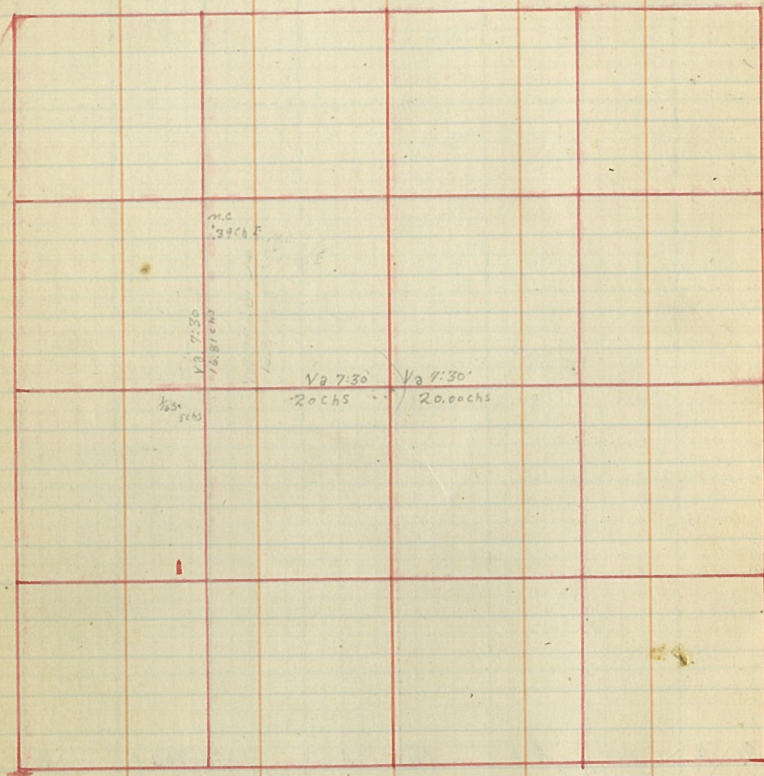

Abc at 16 chs north end of rd
 16 chs at 1/4 cor Sec. 1931

Sec. 30

T147N R30W

10

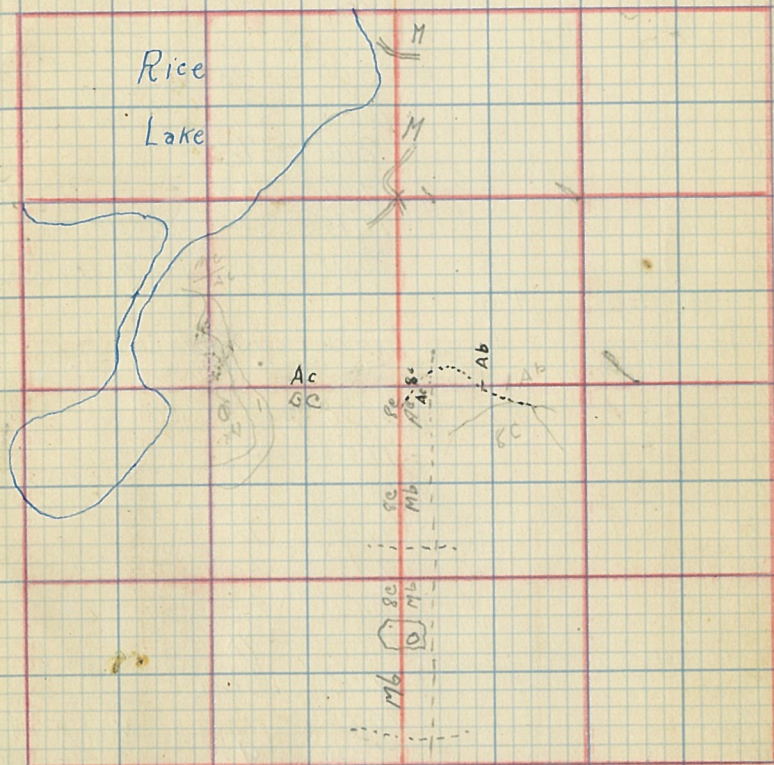

(6-11-34) STA	Direction	Declination	Chainage	Type	Remarks
Sec 32-33-4-5	N	11°20'	20.00	Ab	Set Temp 1/16 Corner
1/16			3.75	Ab	
3+75			.25	Ac/Bc	
(6-12-34) 17+00			5.50	7c	
5+50					Set Temp 1/4 corner
20+00-1/4			3.00	7b	
3+00			20.00		Set Temp 1/16 Corner
20+00			2.00	7c	
2+00			4.00	Ac	
4+00			19.75	Ac	Alder Swamp
19+75			20.00		Set Temp Sec. Corner
20+00					
(6-13-34) 0+00 NW corner	E	9°30'	.50	Ac/16+9b	
0+05					
4+00					
(6-14-34) 4+00			17.50	8c	
17+50			20.00		Set Temp 1/16 Corner
20+00			0.25	7b	
0+25			2.75	Ac	
2+75			13.00	8+9c	
13+00			15.00	7b	
15+00			17.00	5c	
17+00			20.00		Set Temp 1/16 None Found
20+00			2.00	9c	
2+00			6.00	Ac/9b	
6+00			8.00	Ac	
8+00				7b	
19+08					Set Temp 1/16 corner
20+00					

Sec. 32 T148N R30W

11

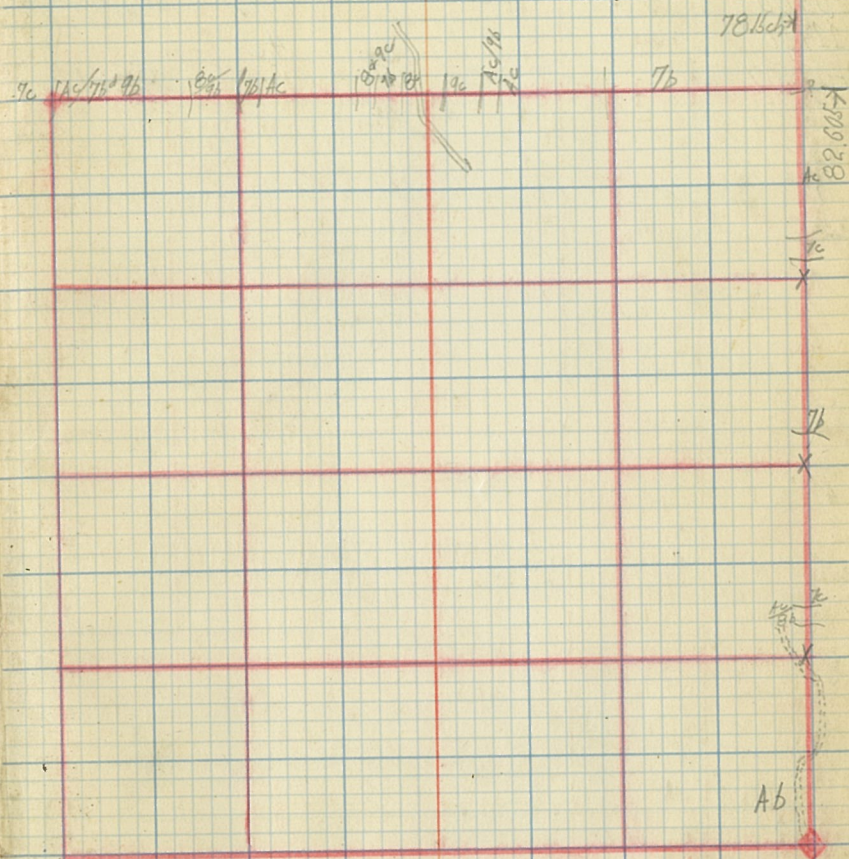

(6-13-34)

STA	Direction	Decl	Chainage	Type	Remarks
se 1/4 Corner	E	10°20'		Ac	
5+75				7b	
20+00					set temporary 1/6 Corner
11+00				4c	
40+07					45ch Not Sec. Cor. 07 W

Sec. 31 T148N R30W

12 3

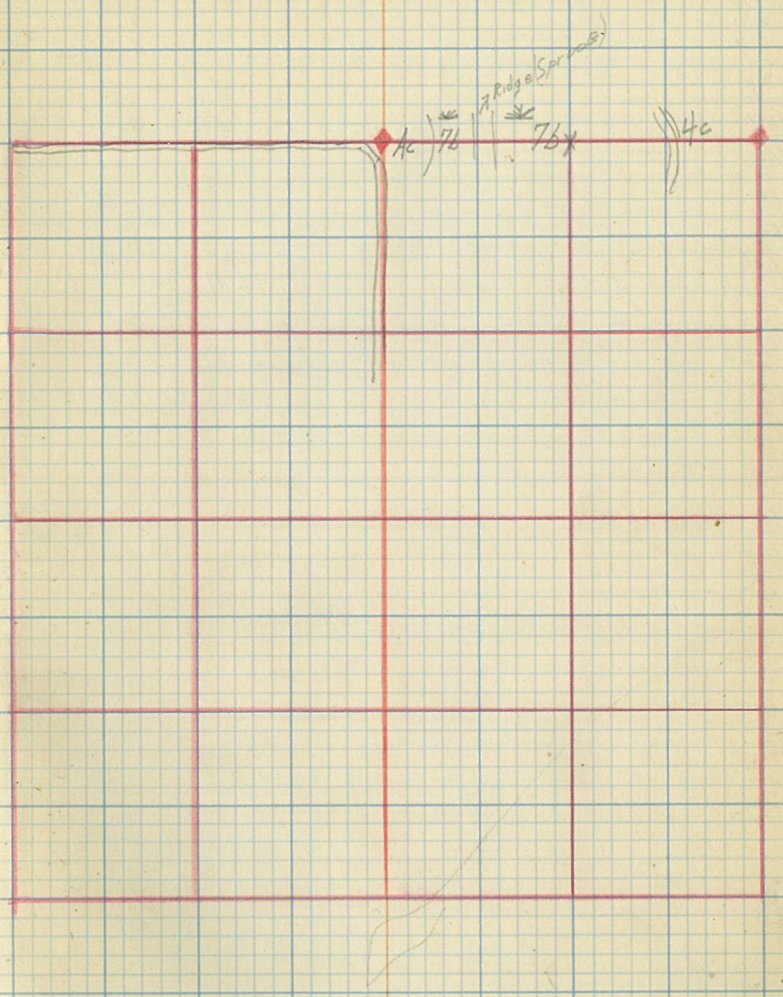

(6-15-34)

Chains	Direction	Decl.	Type	Remarks
0	N	3°	7b	Start from assumed cor
2			Ac	
4			7b	
20				set temp 1/4 corner
27			Ac	few 504 8c
35			8c	Needs Release ^{From} _{Aspen}
40				Set Temp 1/4 Cor
48			Ac	
50				End
50.25			2	START
60.00			Ac	Set Temp 1/4 cor
79.00				

50
16-18-34
50

Sec. 29 T148N R30W

13

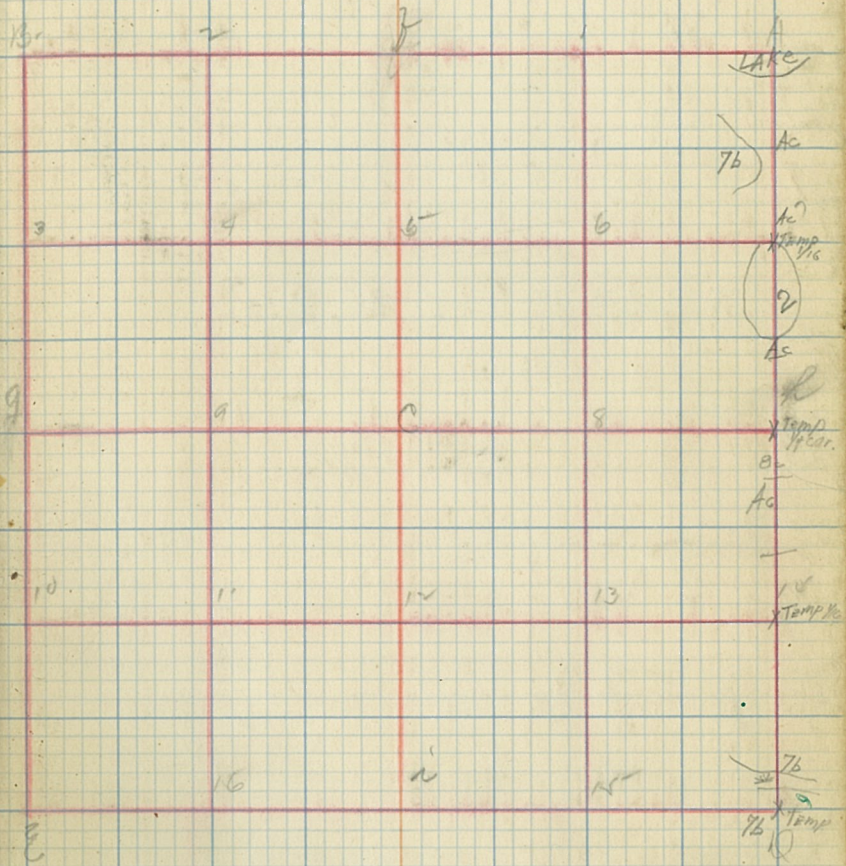

Chains	Direction	Dec.	Type	Remarks
0400	N	8°	LAKE	
24.33				
30.00		9°		Offset, 525chs

Sec 20 T148N R 30W

14

LAKE

(6-19-34)

CHAINS	Direction	Decl	Type	Remarks
SE Cor - 518	W	10°30'	5b	Sighted Along road
2.00			5a	
20.00				Set temporary 1/16 cor
15.00	N	7°30'	8 1/2 5b	J.P. & N.P. SEEDLINGS Present
20.00				Set temporary 1/16 cor
24.50			5a	
27.00			Ab	Temp 1/16 Corner
40.00		10°30'		
7.00	E		A	
13.00			5	
20.00				Set 1/4 Corner

Error, 51 chs E, 32 chs N of 1/4 cor set by Inman

(6-22-34)

NW cor SE, SE	E	10°30'	8 1/2 5b	scattered patches
10.50			5a	5b in openings
19.50			3 1/2 5b	
20.00				1/16 Corners
40.00				Corner

Sec. 18 T147N R31W

15

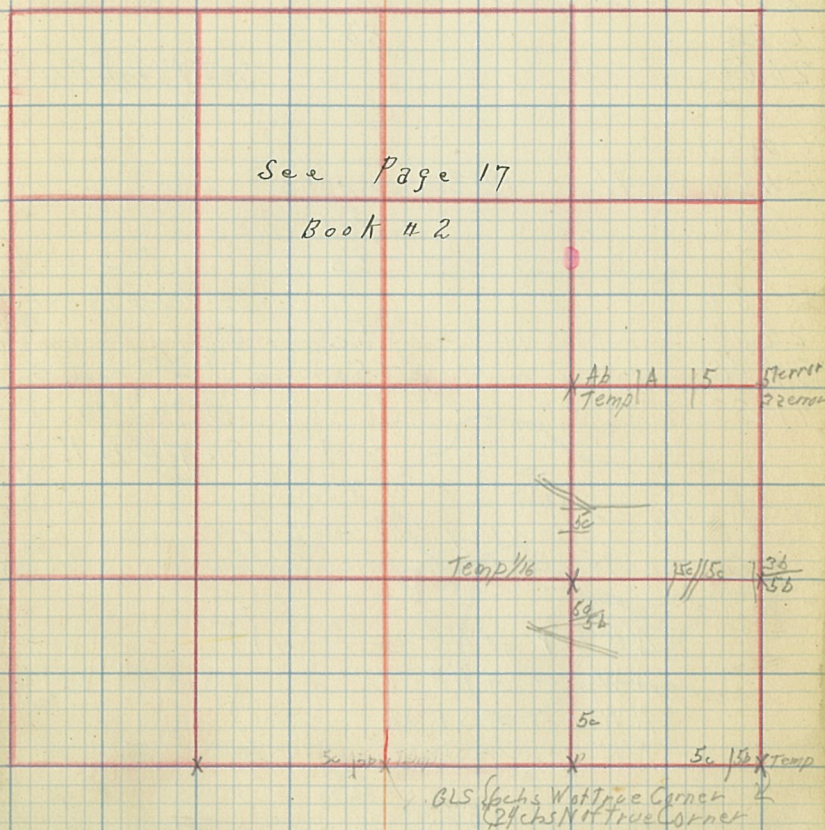

(6-20-31)

CHAINS	Direction	Decl.	Type	Remarks
SW	E	10°30'	5b	
9.00			5c	
17.50			8d/3b	
20.00				set Temp 1/16
2.75	N	8°	5c	
6.00			5b	
20.00				set Temp 1/16

(6/21/31)

SW cor	N	12°30'	8d/5b	
6.00			5c	
7.5			5b	
20.00				set Temp 1/16 cor
22.00			5c	patchy-mixed with 5b
34.00			5	
41.33				set Temp 1/4 cor Single B.T.

The following corners have been corrected:- (descriptions on temp/stakes)

NE cor of NE, SE (1/4 cor)
 NW cor of NE, SE
 NW cor of SE, SE
 NE cor of SE, SE } Section 18

NE cor of NW, SW
 SE cor of NW, SW
 SE cor of SW, SW } Section 17

Sec 17 T147N R31W

16

Gamache

8/23/35

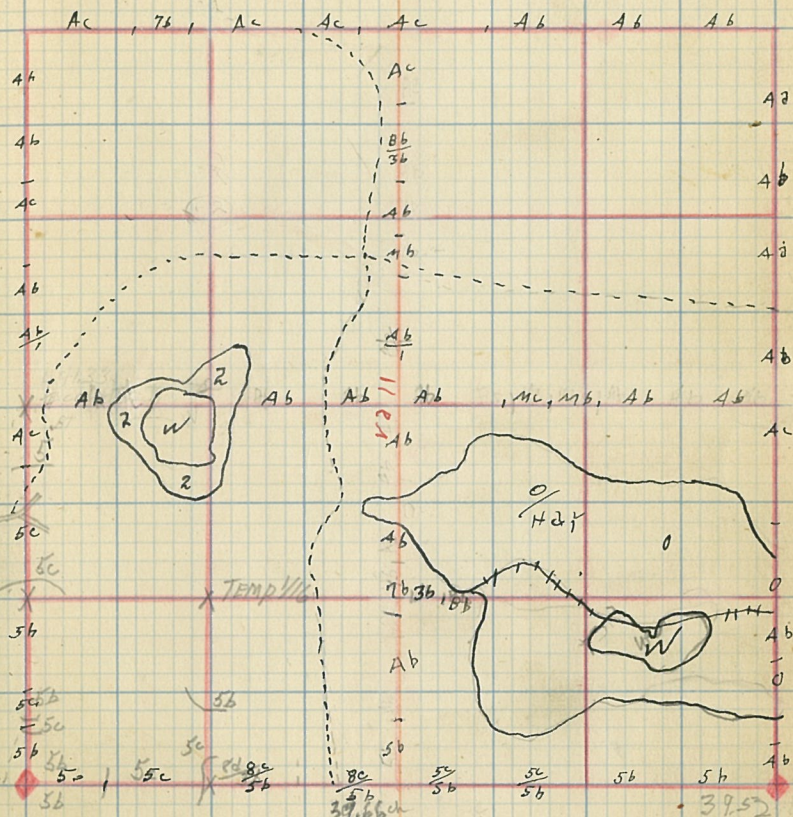

Corrected

149.00
Ab
Ab

719-34 573	Direction	Declination	Type	Remarks
Sec. cor. 18	E	8'		
250'			4, 7, b	swamp
500			a, b	
700			a, Bb	
1150			a, b	
1320				Set. Tem. 1/16 Cor.
1950			a 3 b	
2400			7 b	
(7-20-34) 2640				Set. Tem. 1/16 Cor.
2800			a, b	swamp ends
3200			a 3 b	
3960				Set. Tem. 1/16 Cor.
4800			Alder	Swamp
5220				Set. Tem. Sec. Cor.

Sec 18 T. 148 N. R. 30 W

17

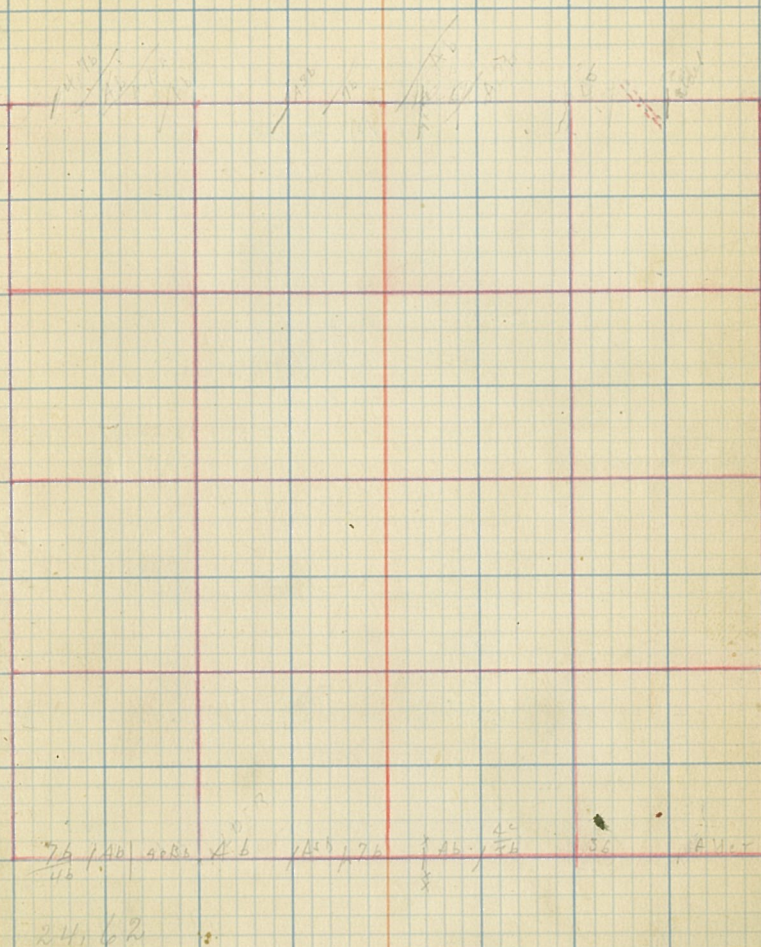

(7-25-34)	Sta.	Chains	Direction	Declination	Type	Remarks
	Sec. 16	SW 1/4	E	8°		Scattered ca. W. Pine
0-	12.00				Be 7c	Heavy Underbrush
12.00-					BA, B, Be, Bass	
20.00						Set W. Tem 1/4 Cor.
(7-26-34)						
21.00					Lb, Bess, Pal	
29.00					Be, Be, Bass	
39.00					0	
40.00						Set Tem 1/4 Cor.
41.00					Abc, 3b	
44.00					Alder	
(7-27-34)						
51.00					Abc	

Sec. 16 T148 N. R. 30 W.

19

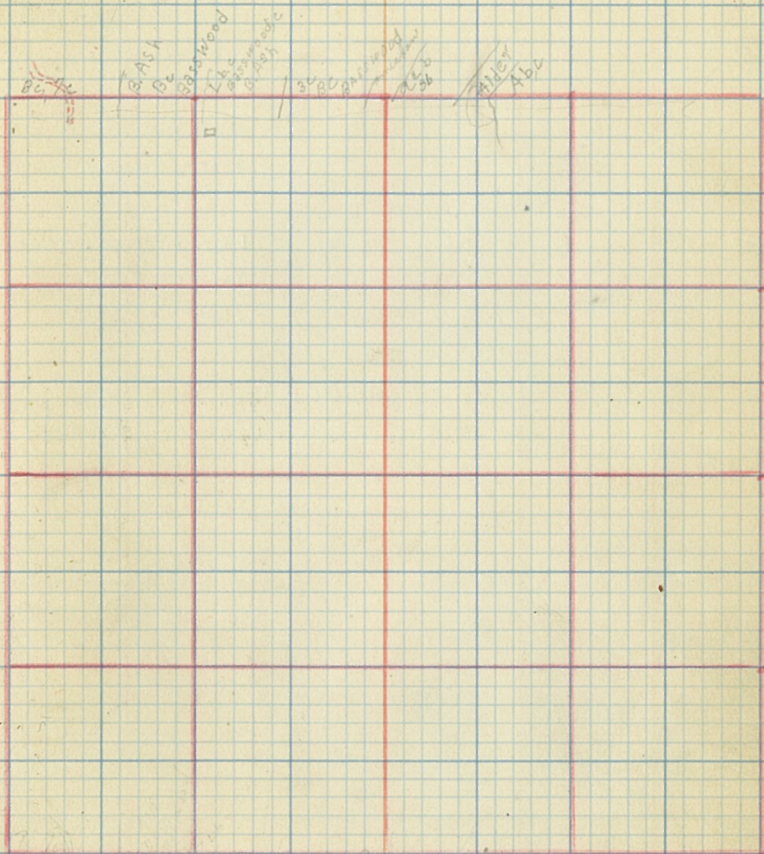

(7-28-34)

Sta. chains Direction declination TYPE Remarks

Sec. Cor. SE 33

N

8'

0-

Ac Bb, 4b

Slashings

Some Aspen Seedlings

12.00

Crossed Old Blazed Line

18.00

7b

SW 27th

20.00

Set Temp. SW 1/4 Cor. Old

Blazed Line SW 1/4 W.

(7-30-34)

31.00

4b, 7b

Larch & Spruce Mixed

40.00

Set Temp. NW 1/4 Cor. E

42.00

Ab

Alder, Mixed 7b

45.50

Ac

54.00

Ac, Bb

60.00

Set Temp. N. 1/4 Cor

(7-31-34)

80.00

Set Temp. Sec. Cor

Sec. 33

T148N.

R. 30 W

20

~~Ac~~
Bb

~~Ac~~
Ab

~~7b~~
7b

7b

~~4b~~
~~Bb~~
Ac

S.E. Sec 28

Sta	Chains	Direction	Declination	Type	Remarks
0 - 4		N	8°	Ac, Bb	Started From Temp. Cor.
4.00				Ac, Alder	
7.00				Ac, Bb, Bb	Few Sect. Alder Birch
13.00				Ac, Alder	
16.00				7b Alder	Swamp
20.00					Set Temp. 1/4 Cor.
25.00				Ab, Bb	Ridge
27.00				2.	
31.00				Ac, Bb, Bb	
60.00					Set Temp. 1/4 Cor.
(8-1-34)					
60.00				Alder	Swamp
63.00				Ac	
65.00				Alder	Heavy Alder
69.00				Ab	
73.00				Bb.	
80.00					Set Temp. Sec. Cor.

Sec 28

T148N.

P30W

21

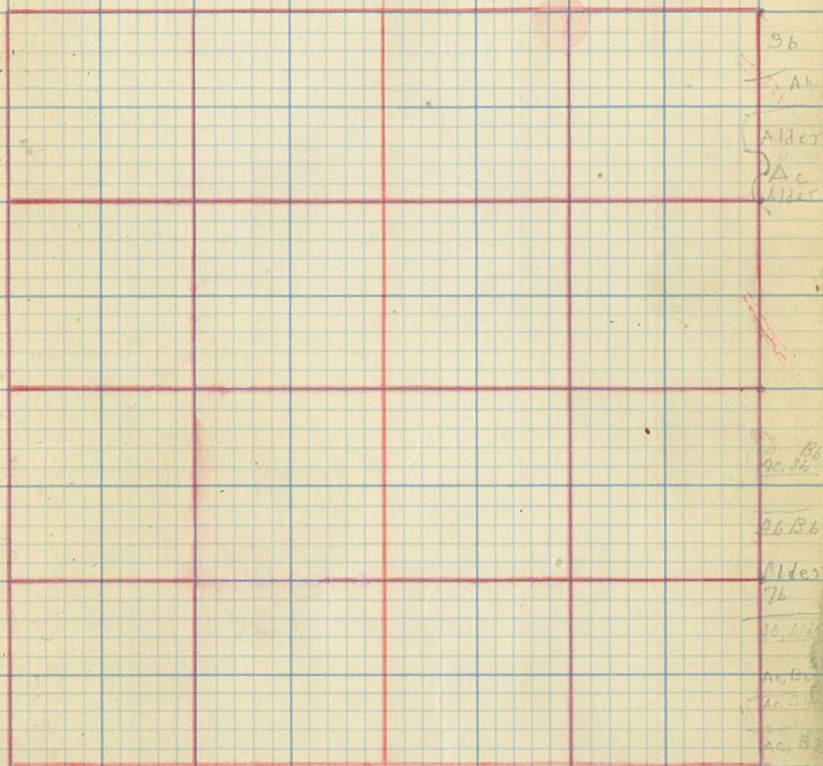

8-1-34

Sta.	Chains	Direction	Declination	Type	Remarks
SE. Sec. Cor 21		N	8'		

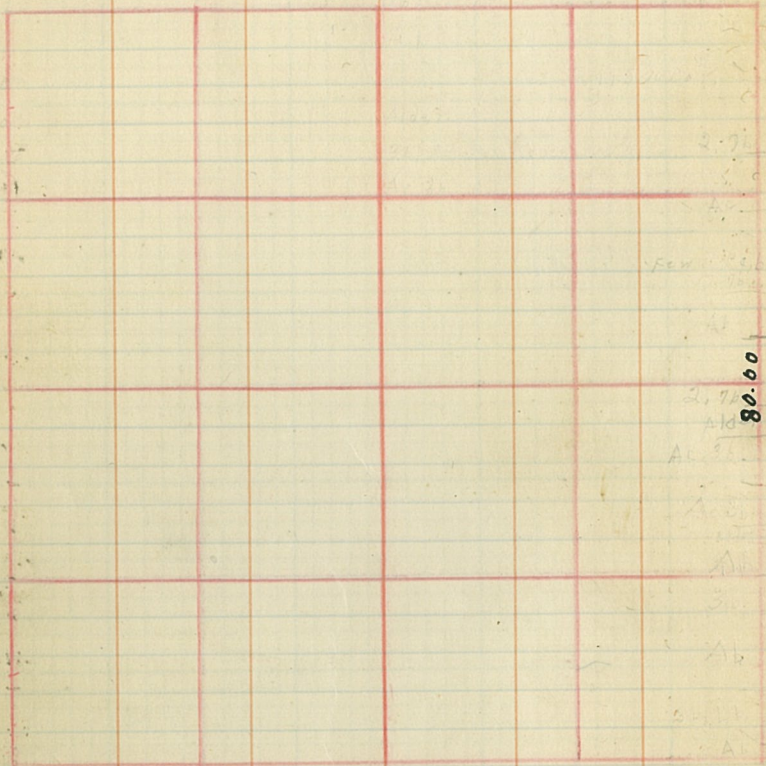

Sec 21 T148 N. R. 30 W.

22

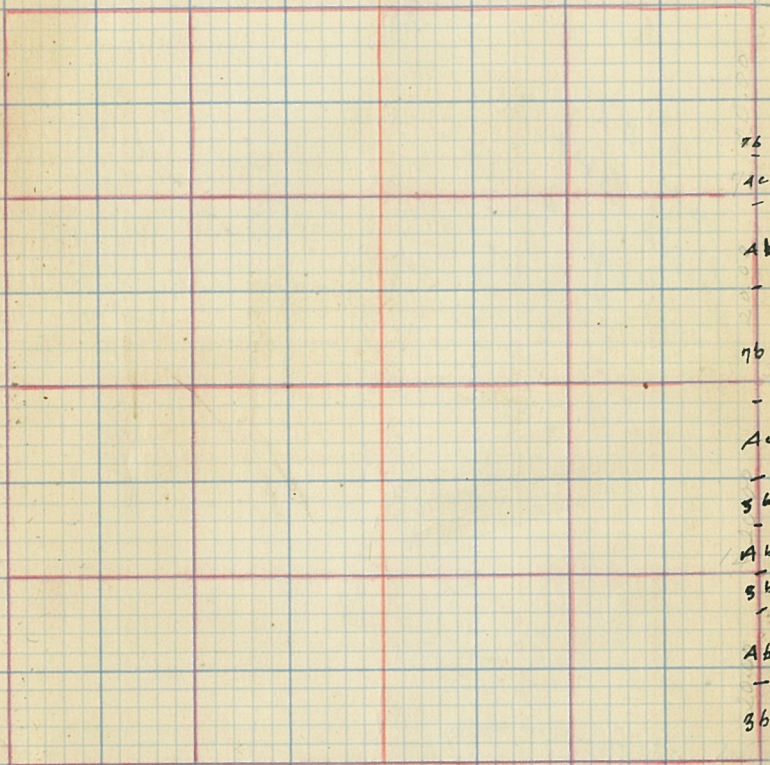

25

S-15 T-148 R-30

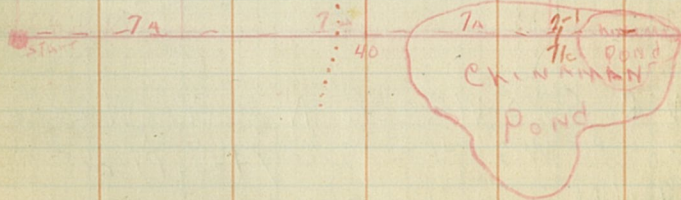
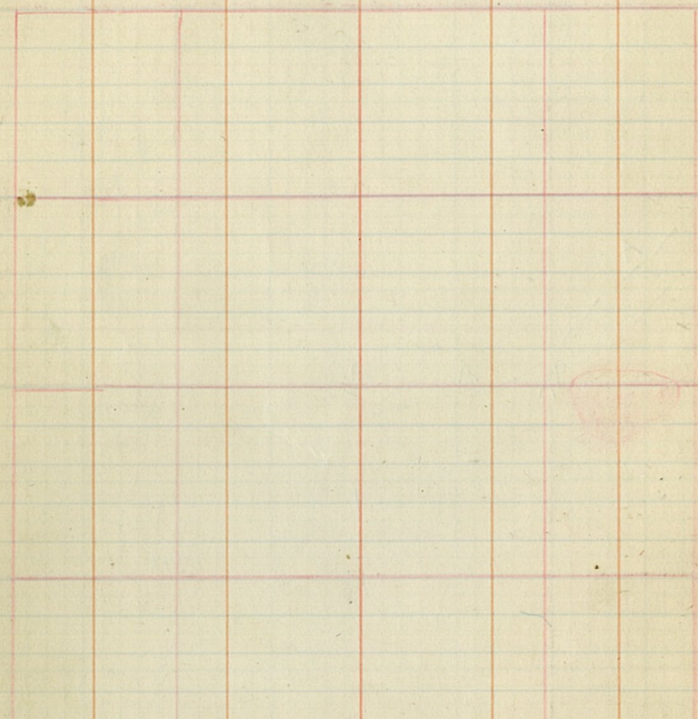

S-15 T-148 R-30

26

Robt. A. Grill

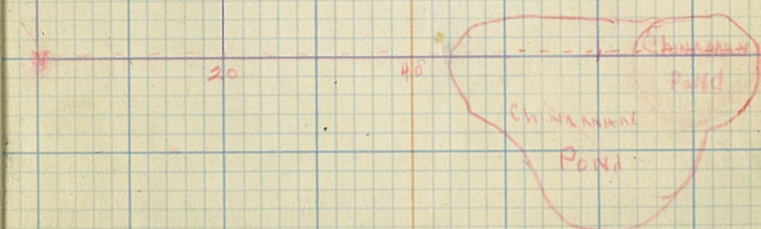
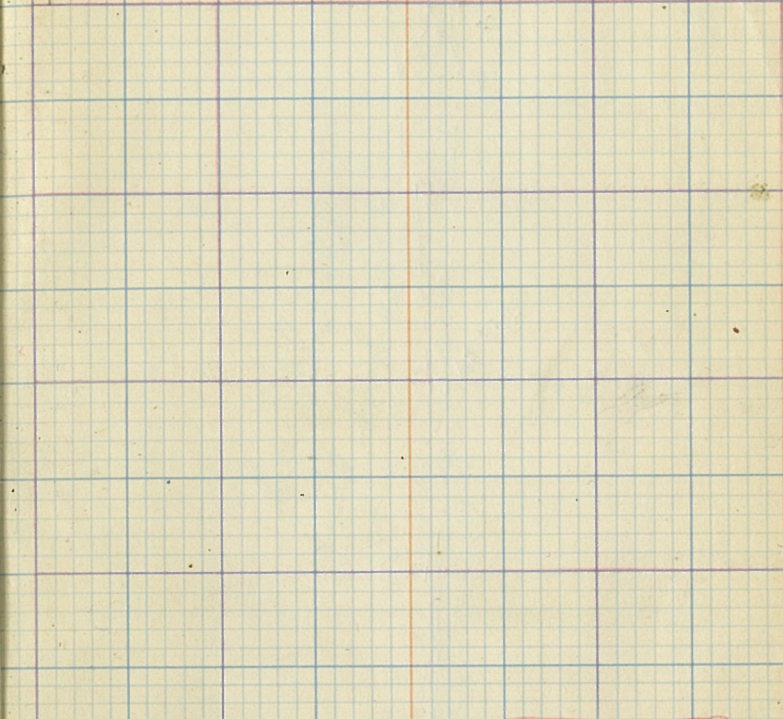

29

S-27 T-148 31-W

HARVEY HARALDSON

8/21/34

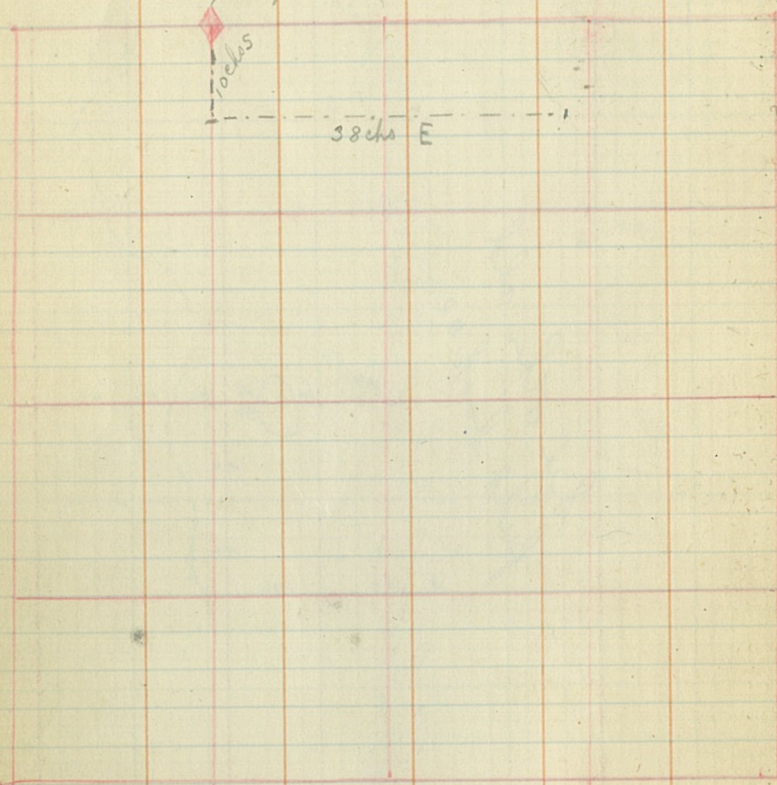

DECL-8°

30

S-27 T-148 31-W

HARVEY HARALDSON

8/21/34

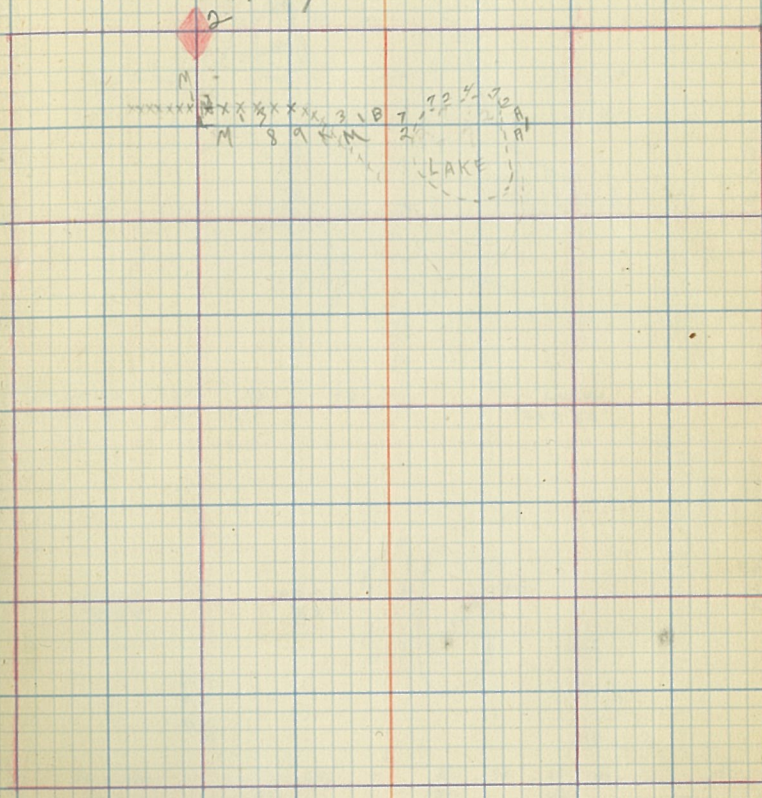

NOTE

South-10 chs + E, 38 chs

31

S-7 T-149 R-30-W

HARVEY HARALDSON

8/22/34

40.00
V₃ 8' 7.30'

W 40 ch

49.42
V₃ 8' 1.5'40.00
V₃ 8'20.00
V₃ 8'20.00
V₃ 8'20.00
V₃ 8'20.00
V₃ 8'

DECL 8°

Suckano

S-7

T-147 R-30-W

32

HARVEY HARALDSON

8/22/34

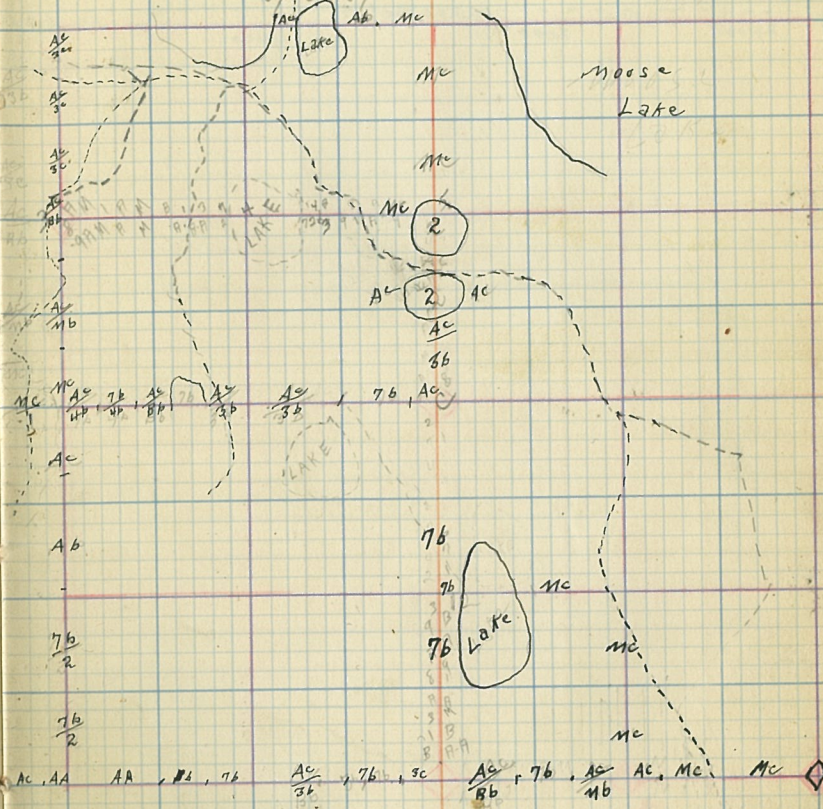

33

S-2271 T-147-29

L. H. W. MURPHY

11/27/36

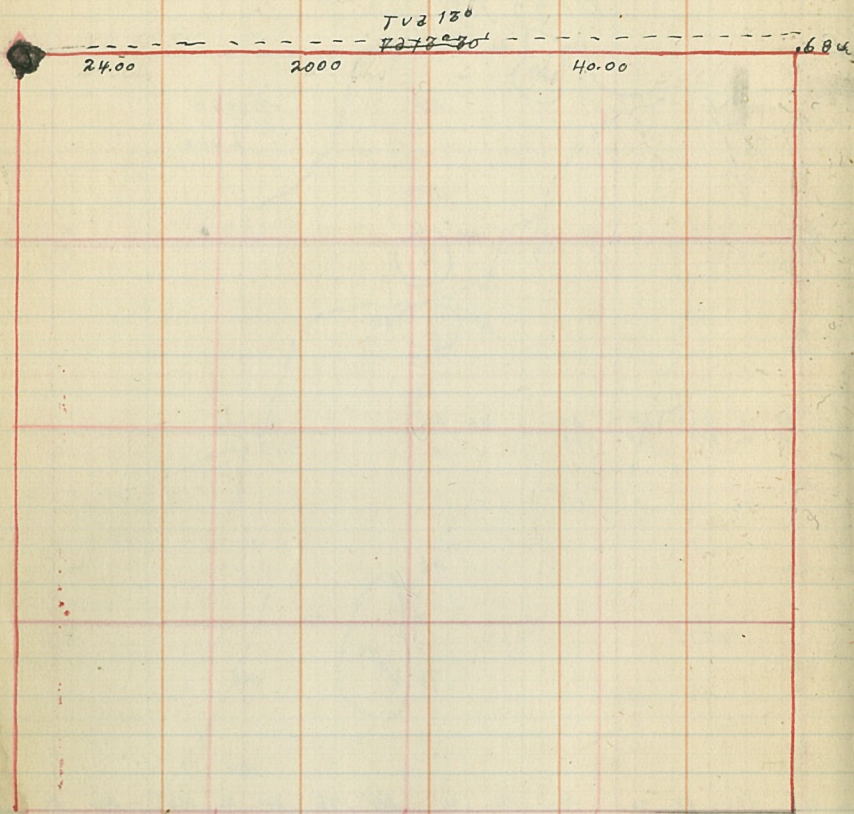

C = 19

Sec. 19 T 147 - R 29

34

L. H. W. MURPHY

2/24/36

MURPHY

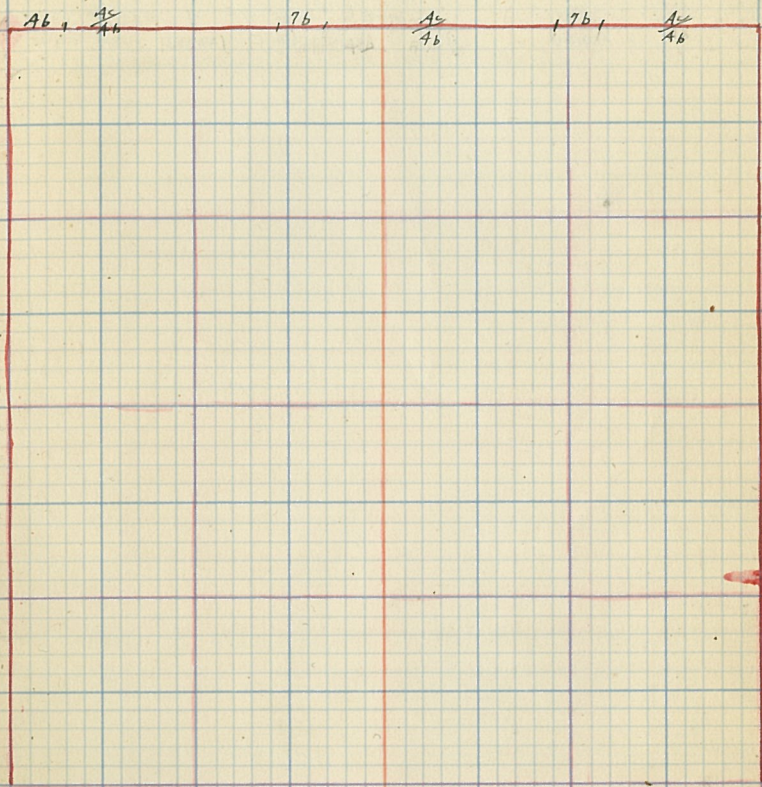

L. H. W. MURPHY

S-2271 T-147-29

L. H. W. MURPHY

Sec. = 20

T147- R 29

35

2/24/36

Morphy

TV 25030
--- V 26 --- 4300
40.00 40.00

$\frac{Ac}{Ab}$

$\frac{Ac}{Ab}$

$\frac{Ac}{Ab}$

$\frac{Ac}{Ab}$

10

$\frac{Ac}{Ab}$

NOTE:

LIVE RUN

F 8 1/2 mi. 17 mi.

NO 1/2 mi. COX could BE FOUND

40° N-E

S-11 T-147-29

HARVEY HARALDSON

8/29/34

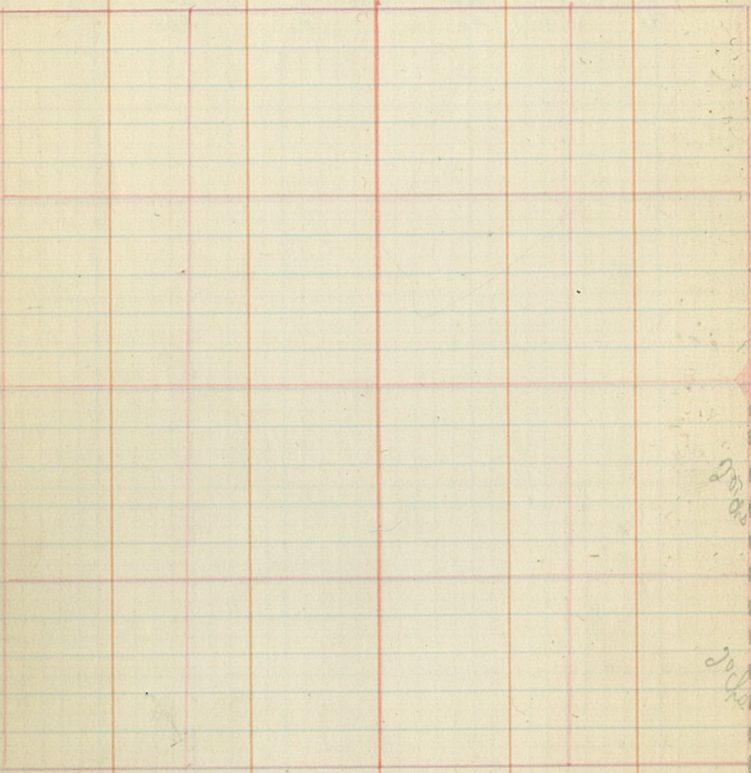

DECL. 8°

NOTE:

LINE RUN
Bchs S of Cor.
COR. NOT FOUND

S-17 T-147-29

36

HARVEY HARALDSON

8/29/34

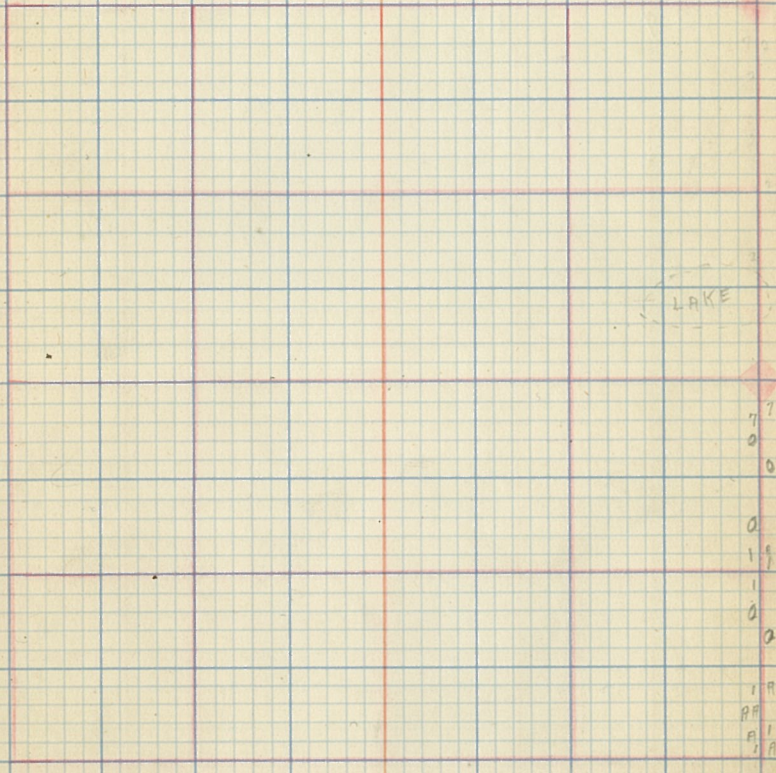

LAKE

7
0
0
0
1
1
0
0
1
1
1
1

T-147

R-30

S-12

9/18/34

HARVEY HARALDSON

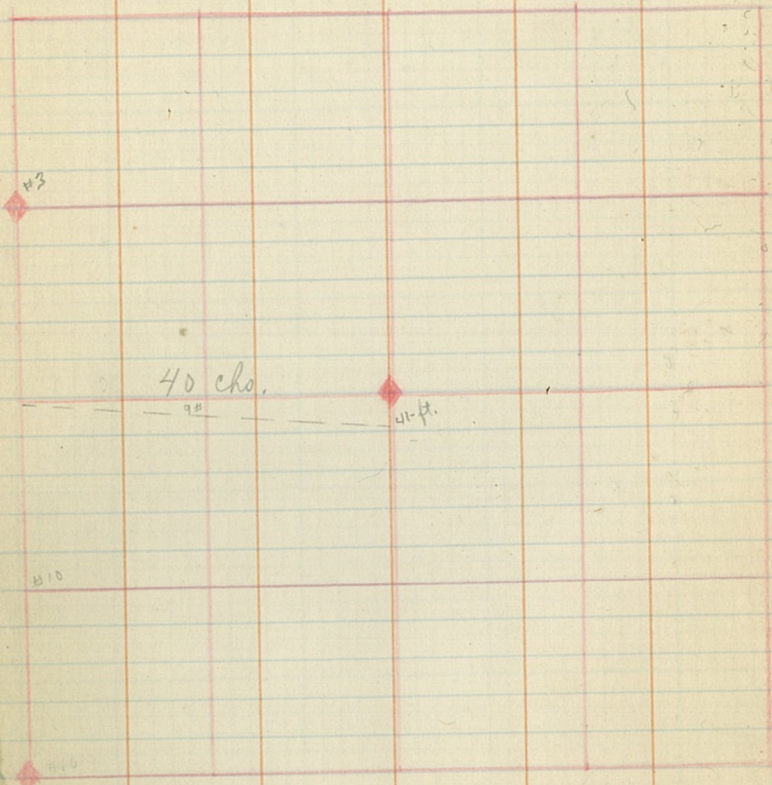

NOTE:

STARTED S.W. COR. S-12

CHAINED NORTH $\frac{1}{16}$ cor.

PUT TEMP $\frac{1}{4}$ cor. RUN LINE W-

T-147

R-30

38

S-12

HARVEY HARALDSON

9/18/34

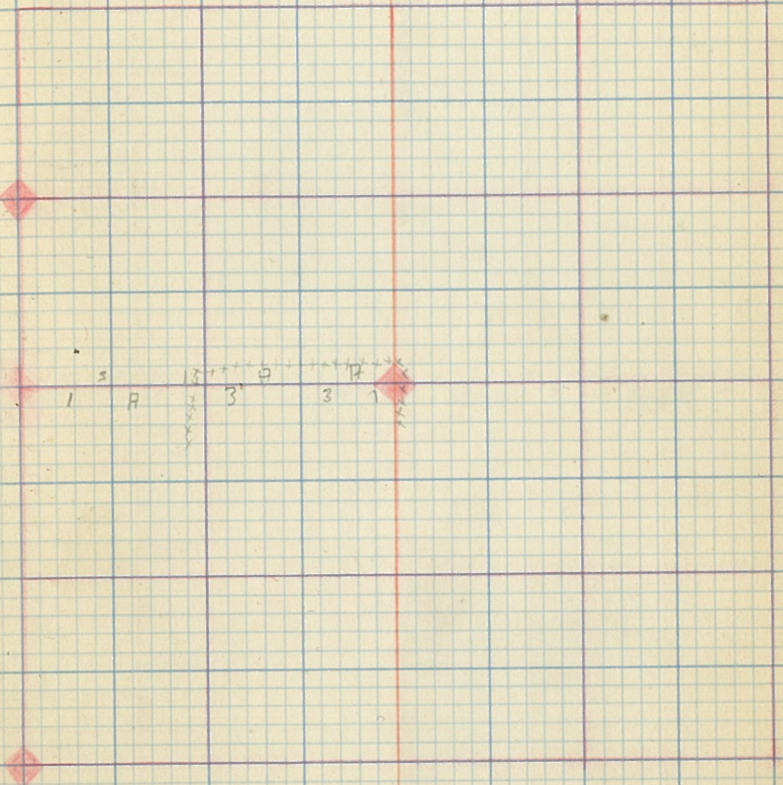

DECL-8°

T-147
S-1

R-30

9/19/34

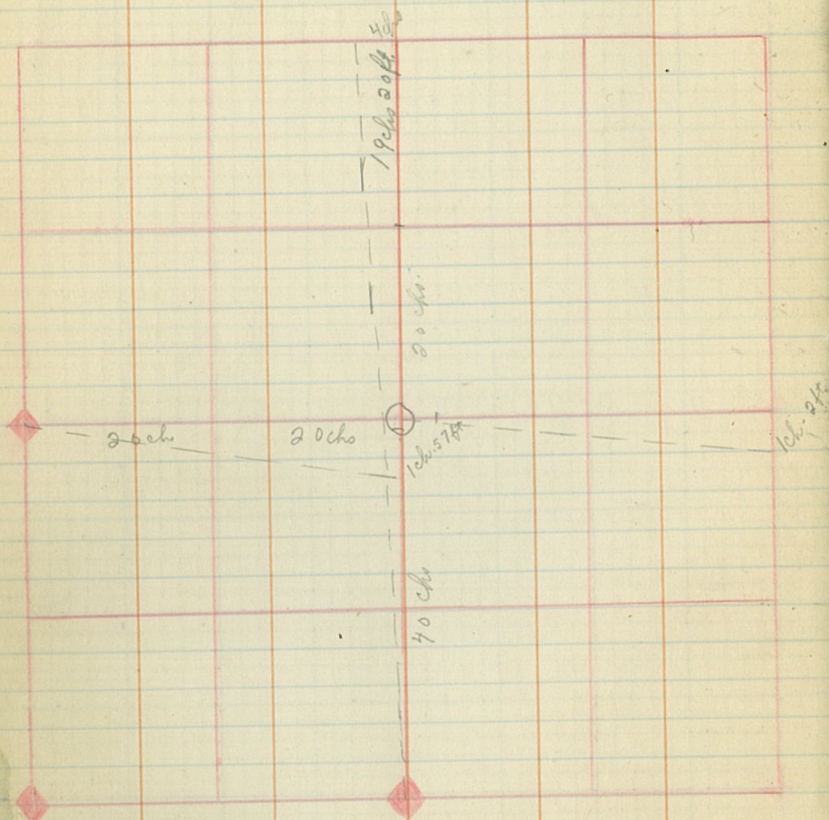

T-147

R-30

39

S-1

9/19/34

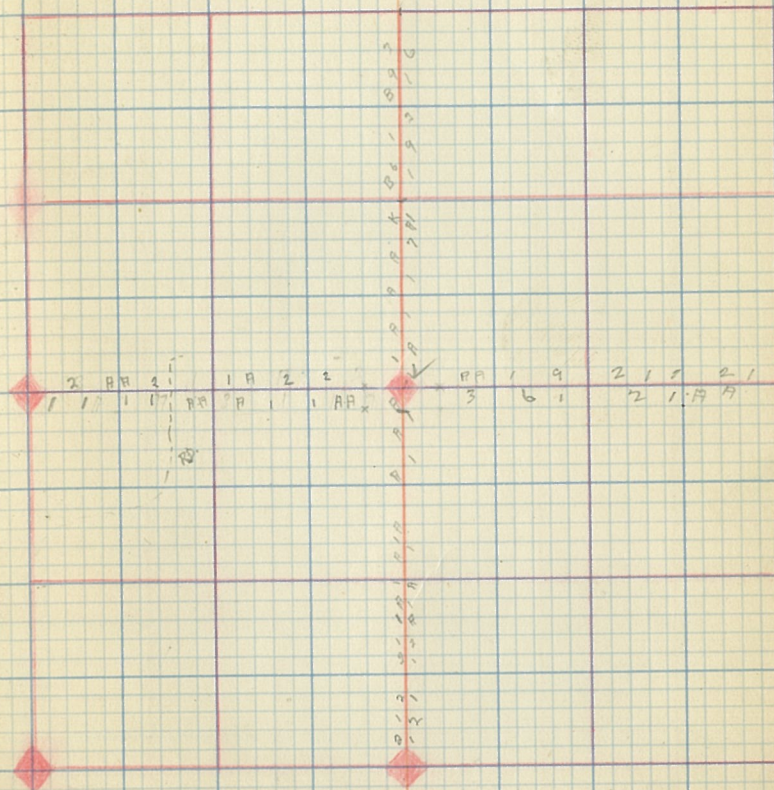

DECL-8°

T-148 S-26-55

HARVEY HARALDSON
9/26/34

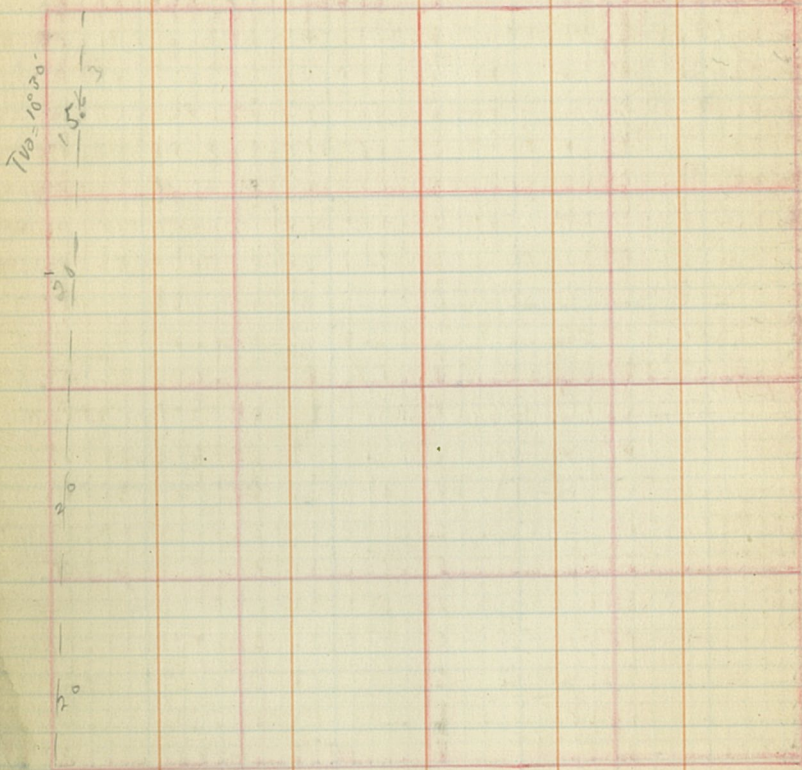

T-148-30 S-25426

HARVEY HARALDSON
9/26/34

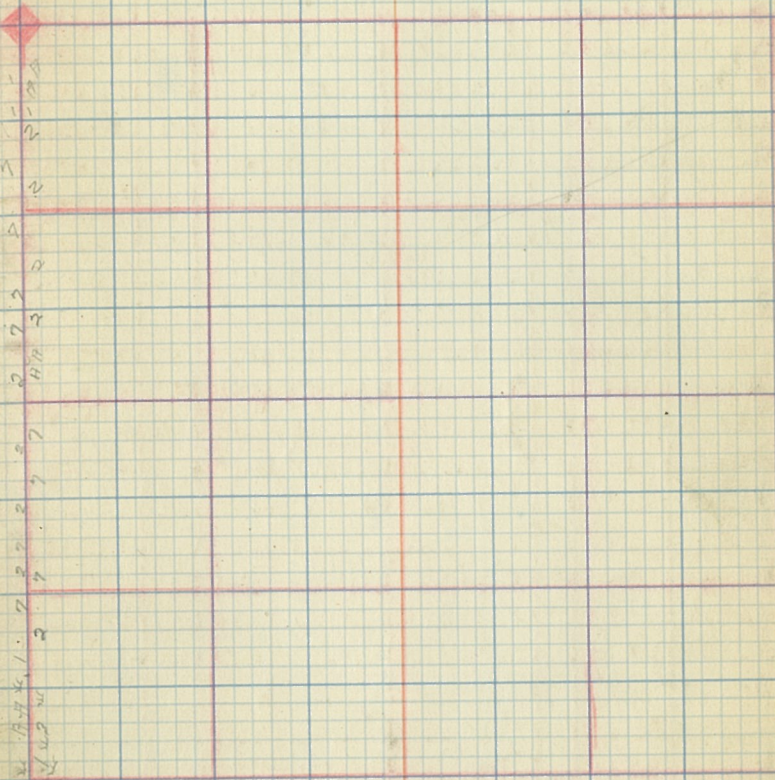

DECL - 8°

TVD = 10° 30'

T-148 S-25

HARVEY HARALDSON
10/2/34

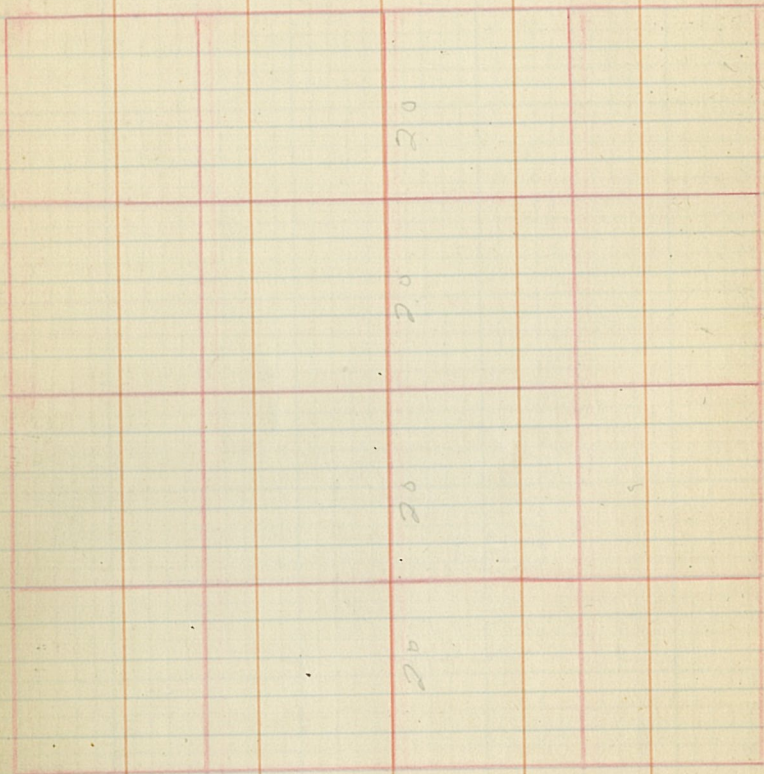

T-148-30 S-25

112

HARVEY HARALDSON
10/2/34

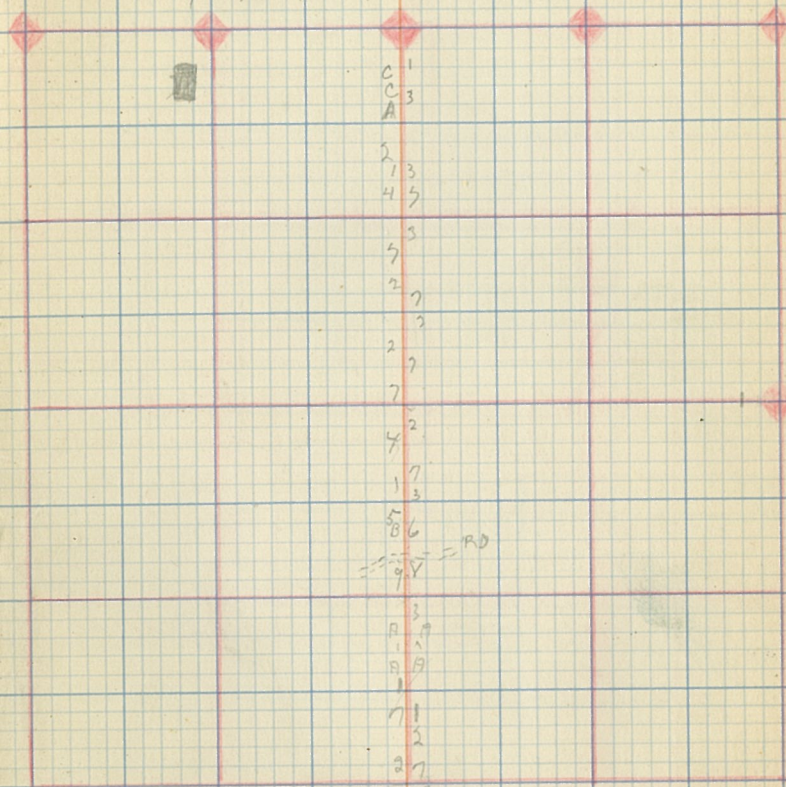

DECL: 10°

T-148-30 S-24-2B

HARVEY HARALDSON

10/8/34

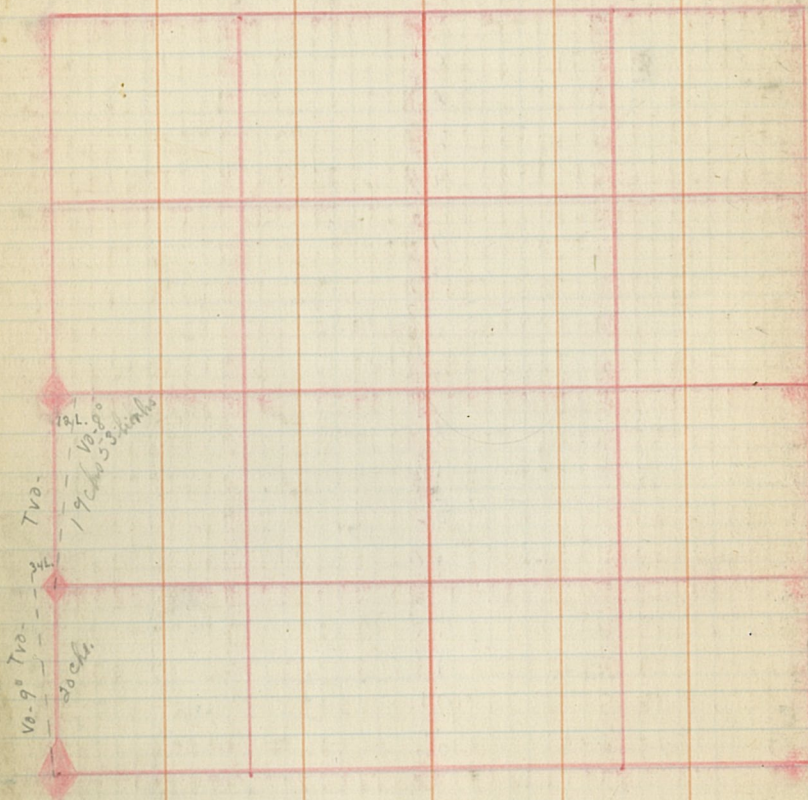

$V\theta = 9^\circ$ 1st 20 ch.

$V\theta = 8^\circ$ 2-st 20 ch.

T-148-30 S-24-2B

HARVEY HARALDSON

10/8/34

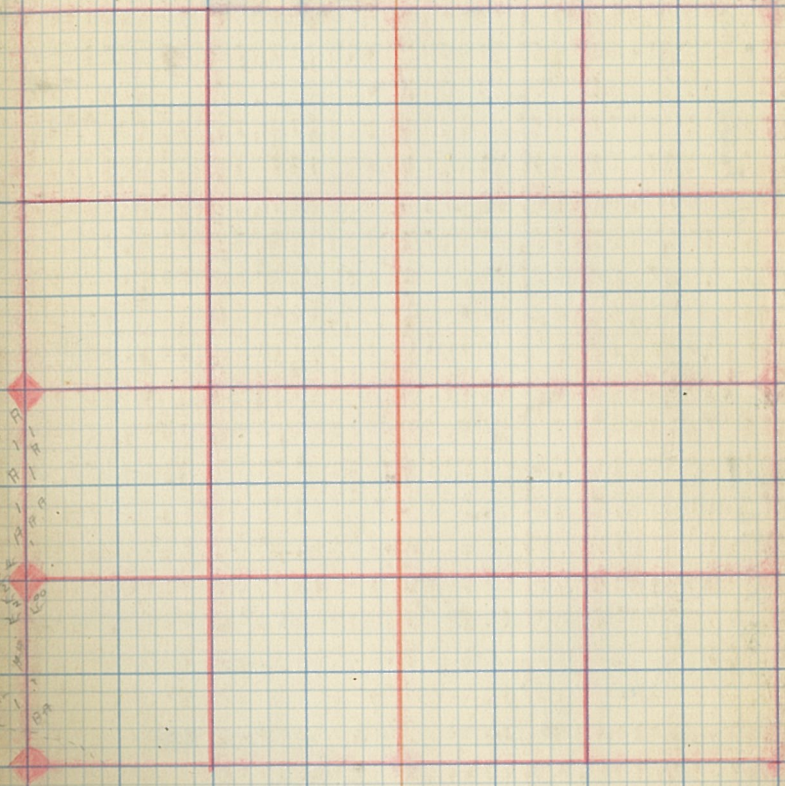

DECL - $9^\circ + 8^\circ$

T-148-30 S-33

HARVEY HARALDSON

10/15/34

ra-8° Tva
41.66 ch.

T-148-30 S-33

46

HARVEY HARALDSON

10/15/34

0.0000 21.27 47.12 1.751
0.14 10 7 14 1 27 14 13 17

DECL-8°

T-148-30 S-4

HARVEY HARALDSON
10/17/34

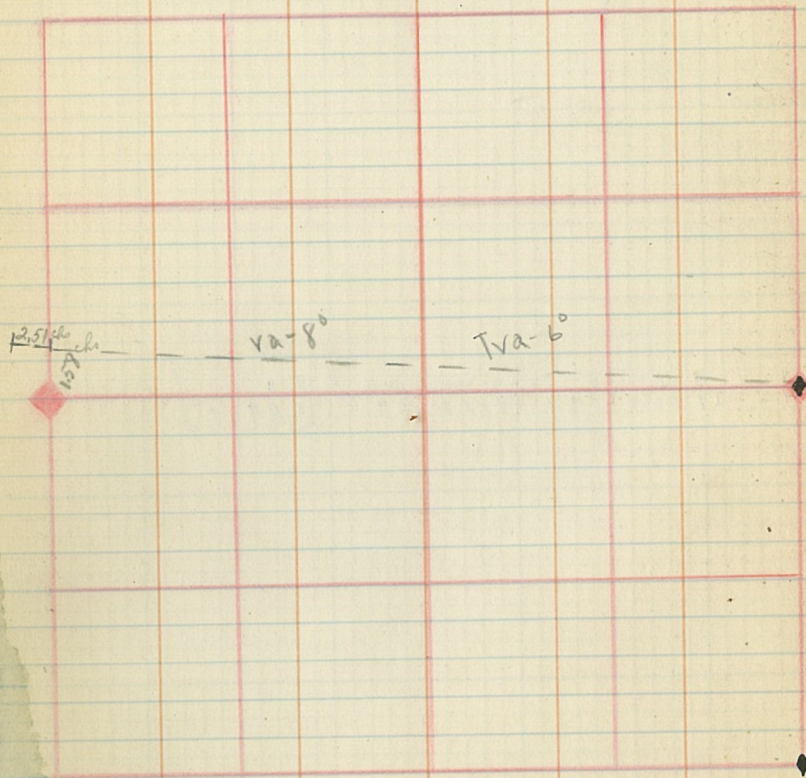

T-148-30 S-4

48

HARVEY HARALDSON

10/17/34

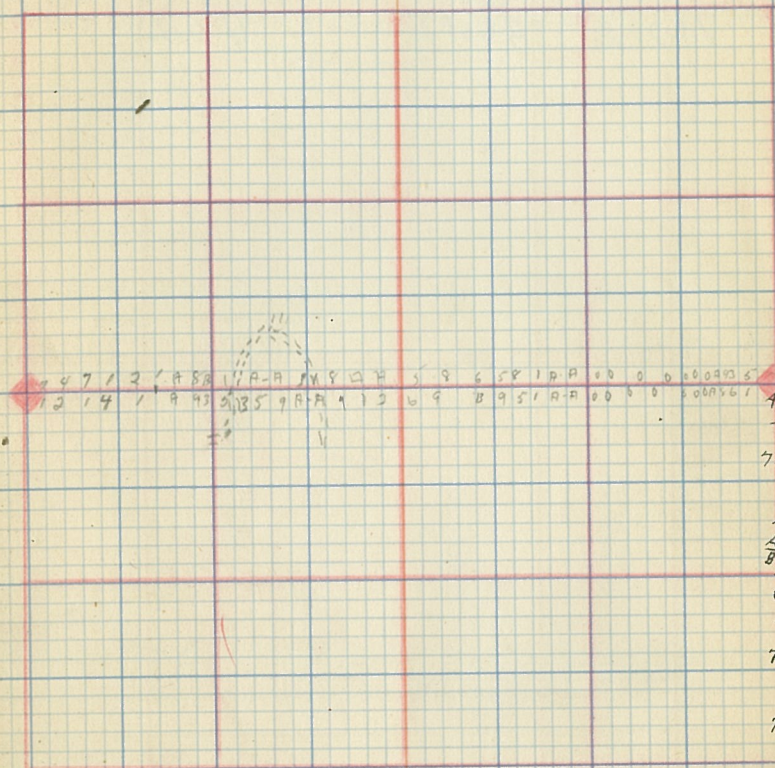

DECL-8'

T-147-31W S-36-

HARVEY HARALDSON

10/18/34

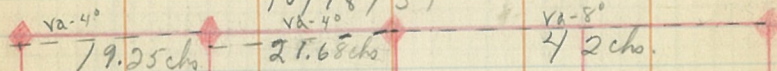

DECL-8° 1st 1/2 mi.
2nd 1/2 mi, 4°

T-147-31W S-36-

49

HARVEY HARALDSON

10/18/34



DECL-8°

T-148-30-5th

S-5

HARVEY HARALDSON
10/23/34

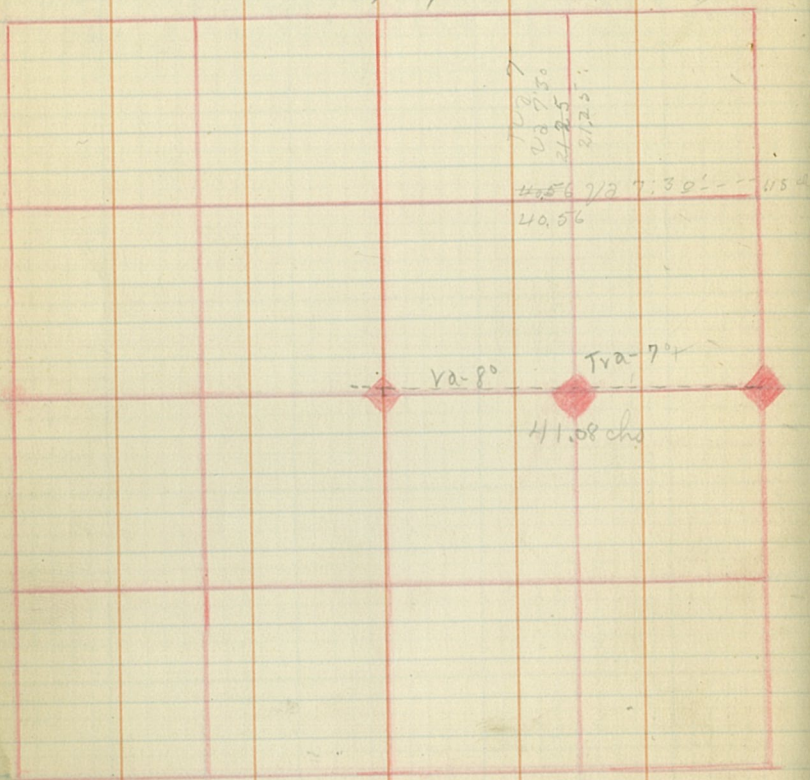

T-148-30-5

S-5

HARVEY HARALDSON

10/23/34

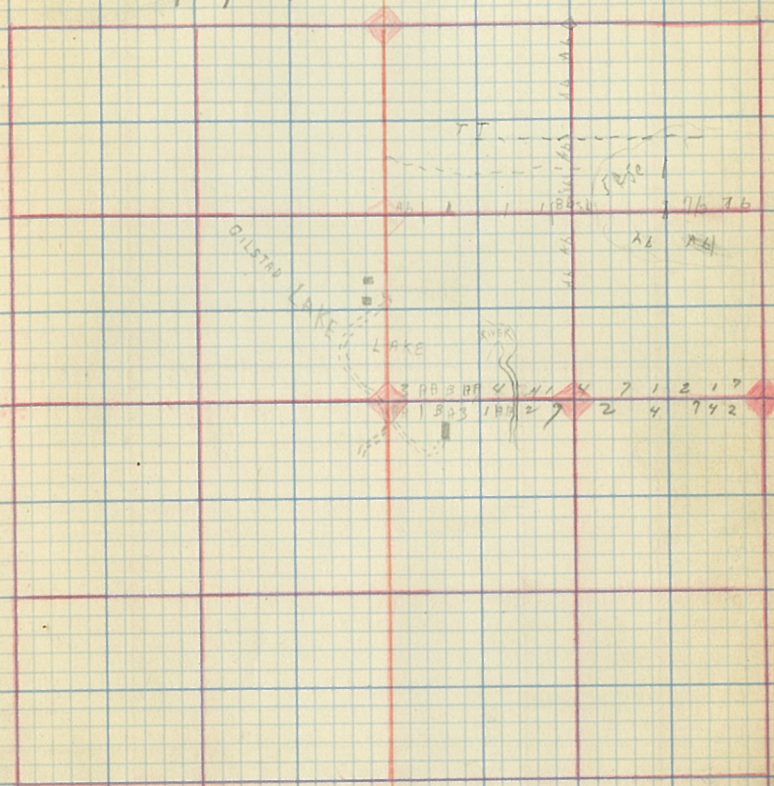

DECI-80

T-148 R-30

S-1-4

HARVEY HARALDSON
10/25/34

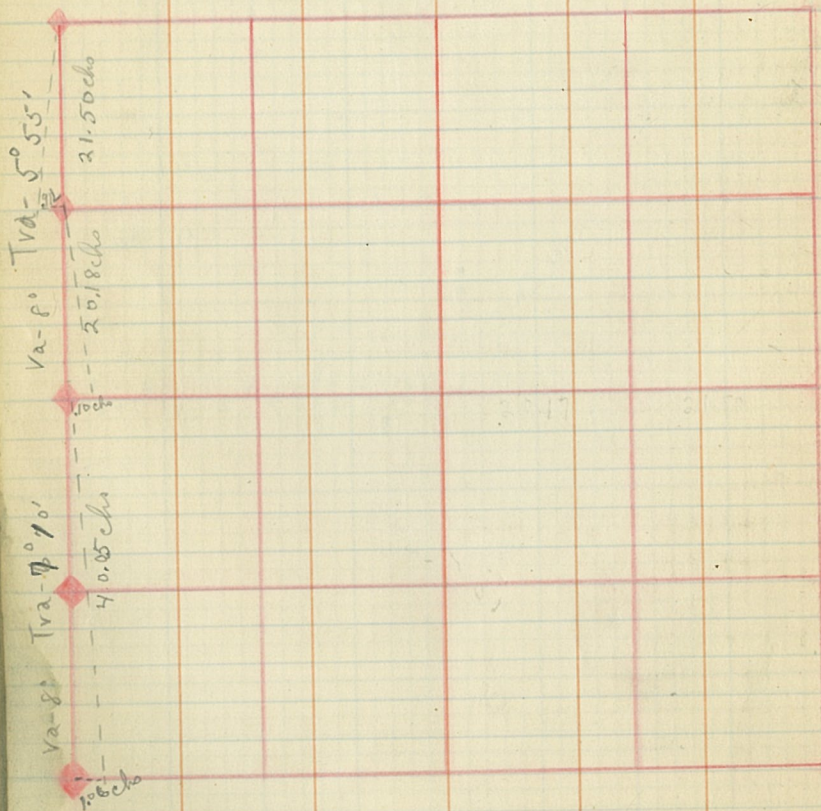

T-148 R-30

S-1-4

HARVEY HARALDSON

10/25/34

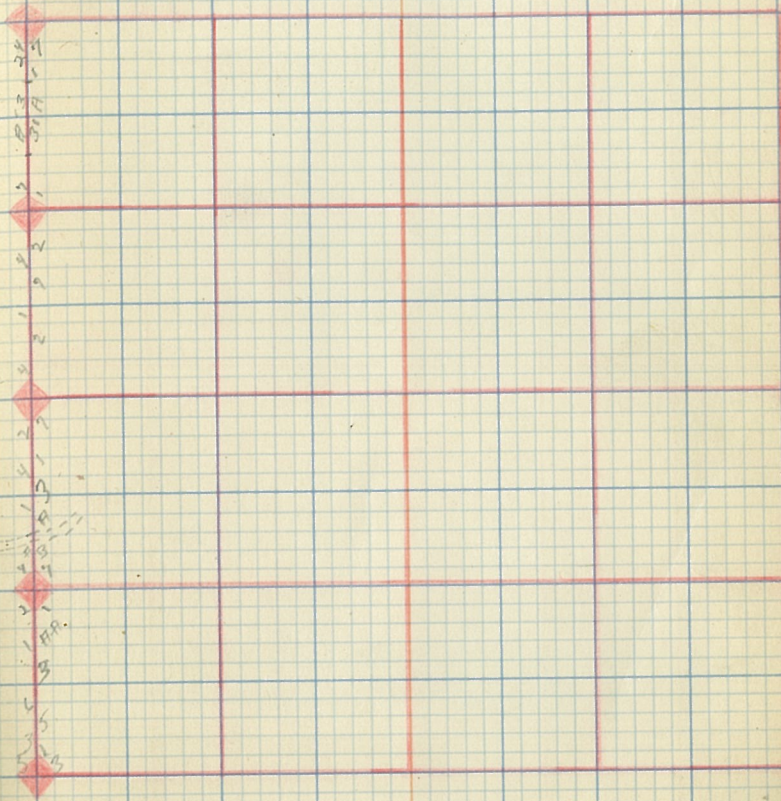

DECK-80

T 147 Sec 90

S-5

MARLEY HARRISON

1/21/31

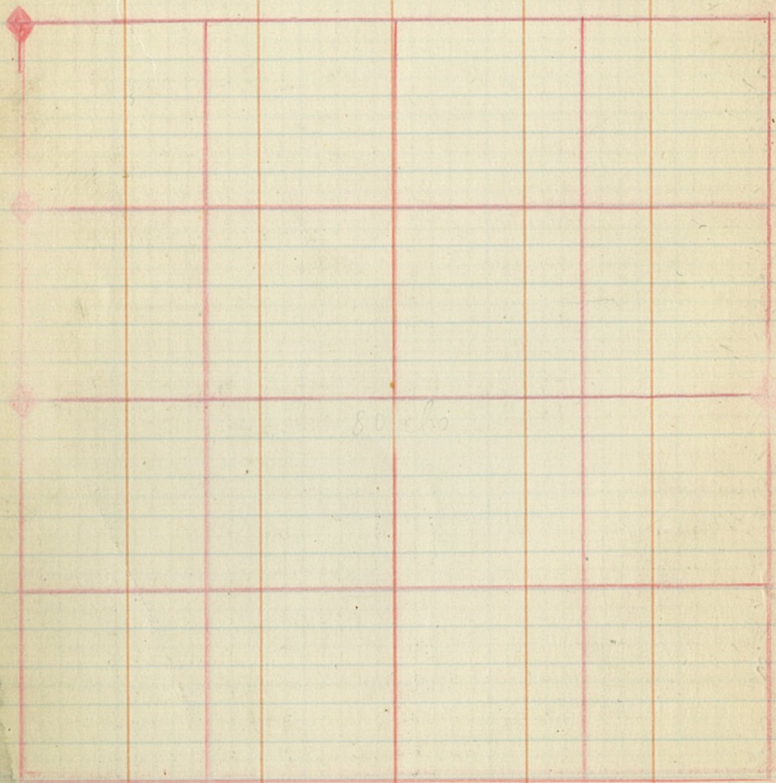

T 147 Sec 90 - 148-30

52

S-5

MARLEY HARRISON

1/21/31

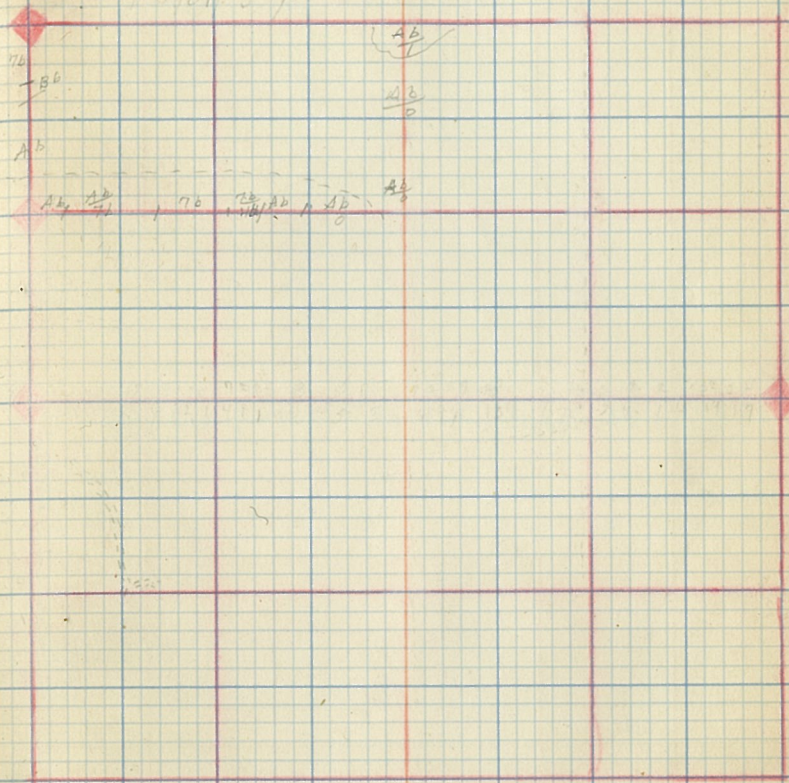

T-147 S-9 R-30

HARVEY HARALDSON

10/31/34

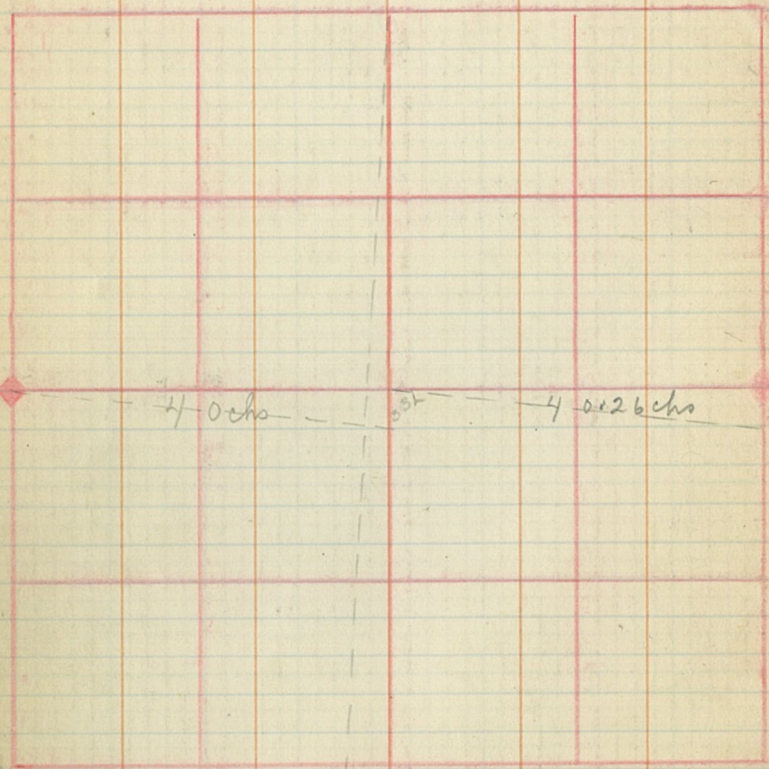

70L

T-147 S-9 R-30

58

HARVEY HARALDSON

10/31/34

~~14 15g AA 1 91 B 19 AA 5 8 B 1 3 AA 3 9 71 AA 5
 27 38 B AA 4 5 AA 5 8 31 3 9 9 5 B 8 5 4 2 9 9~~

DECK - 7 1/2

T-147 R-30

S-17

10/6/34

HARVEY HARALDSON

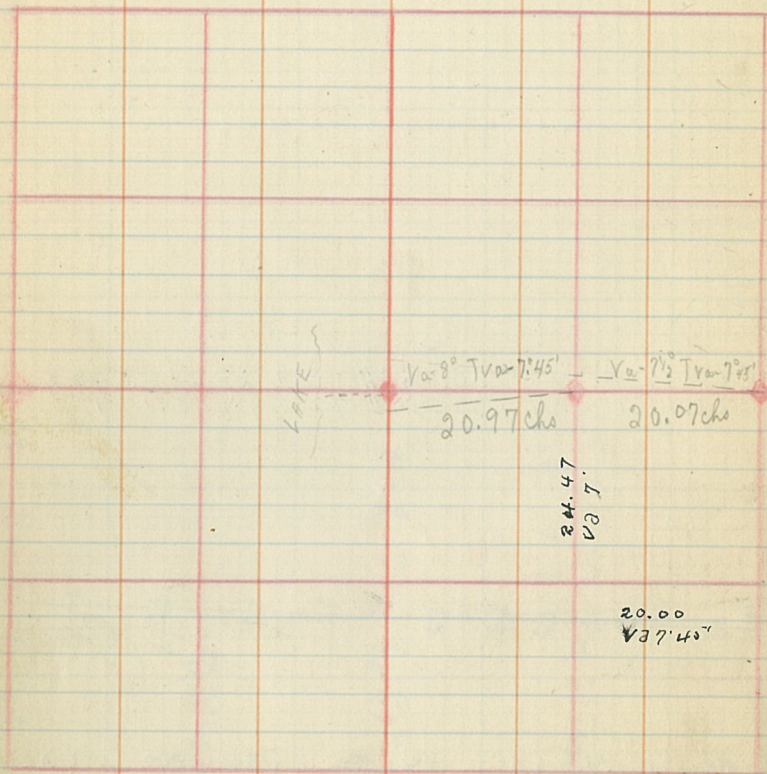

T-147 R-30

56

S-17

HARVEY HARALDSON

10/6/34

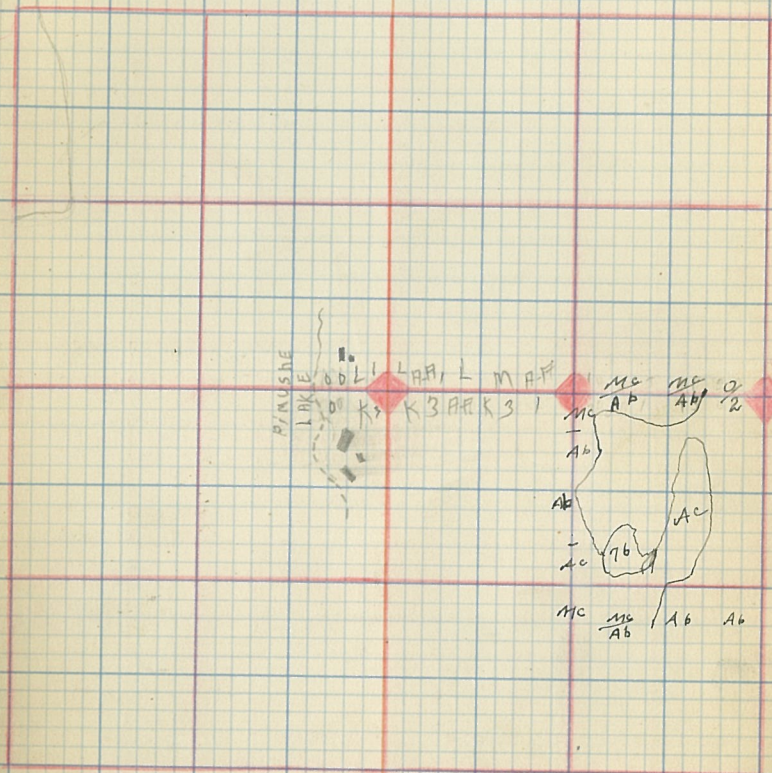

T-147 R-30

S-5

11/7/34

HARVEY HARALDSON

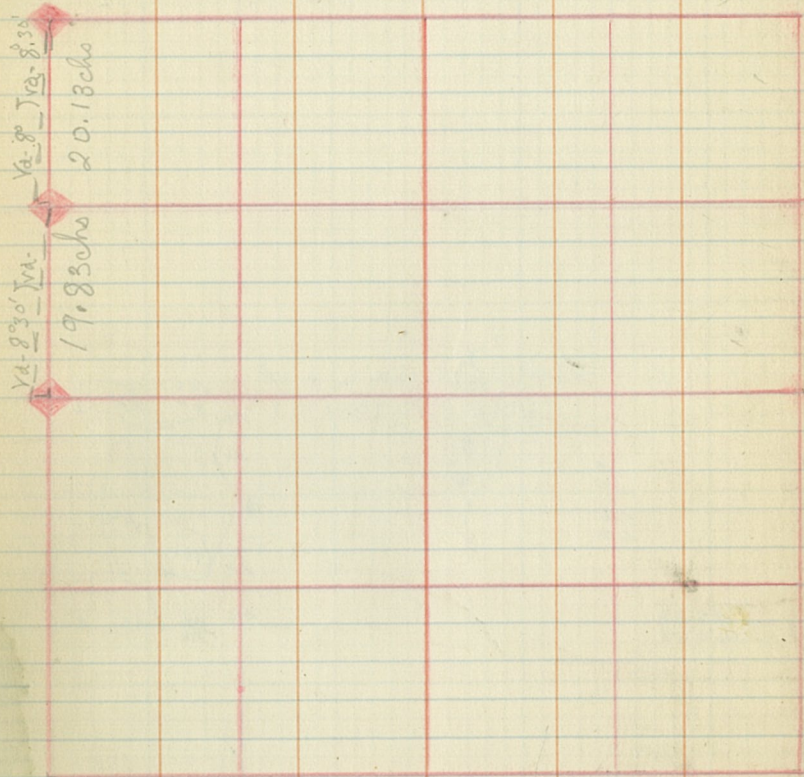

↑ DECL-8°15'
FOUND. MC. Cor.

T-147 R-30

57

S-5

11/7/34

HARVEY HARALDSON

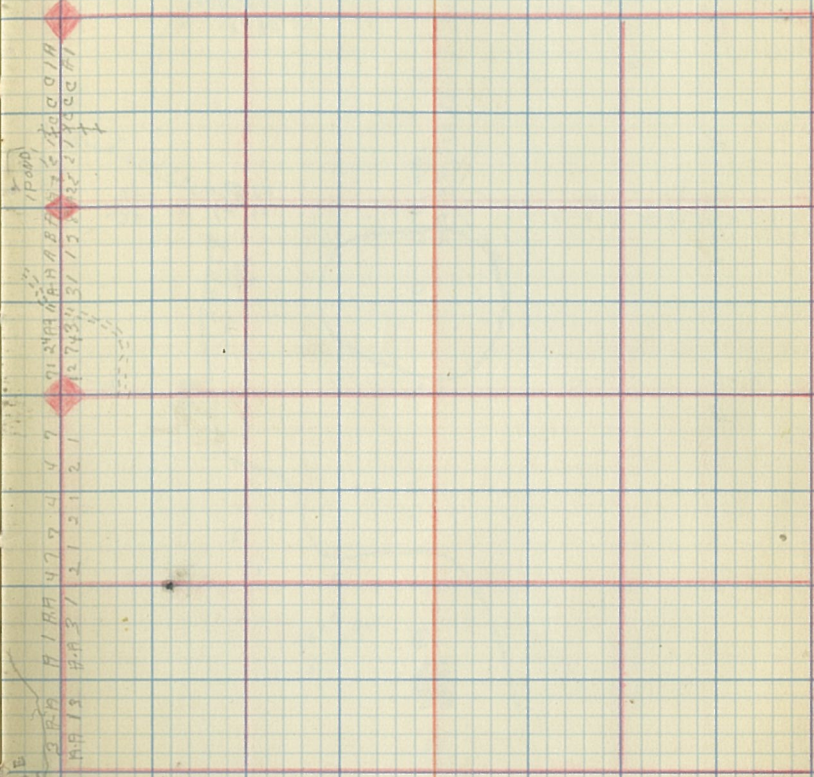

↑ DECL-8°30'

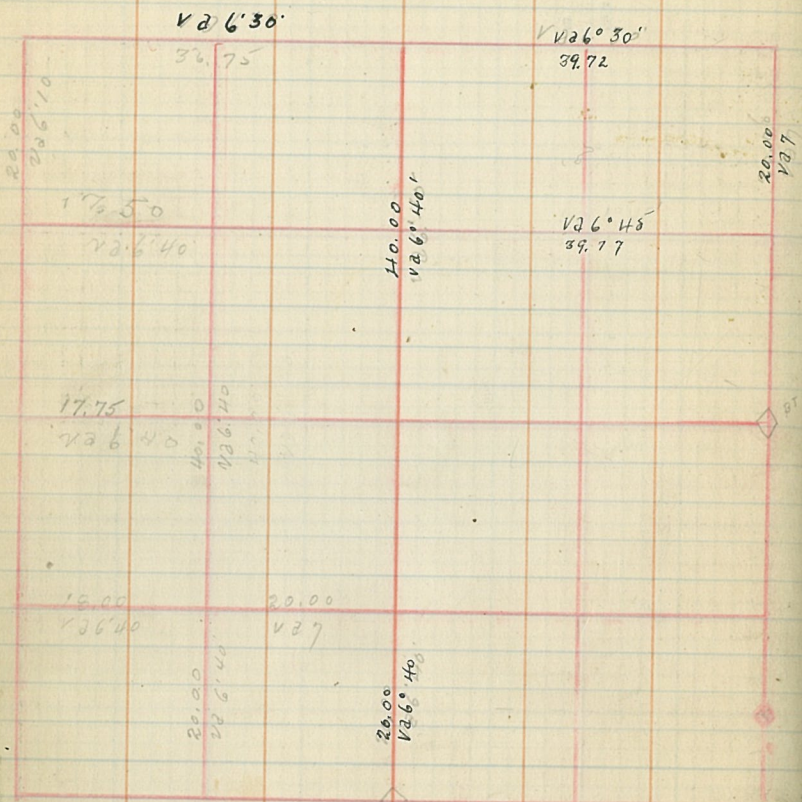

North $\frac{1}{4}$ line is only 17.50 chs. to W. Sec. line
 E + W $\frac{1}{4}$ " " " 17.75 " " " "
 South $\frac{1}{4}$ " " " 18.00 " " " "
 All of these lines were ran from a
 line starting at the South $\frac{1}{4}$ Cor. of Sec. 9.

Sec. 9 T147N. R 31W.

58

2/12/36

Murphy

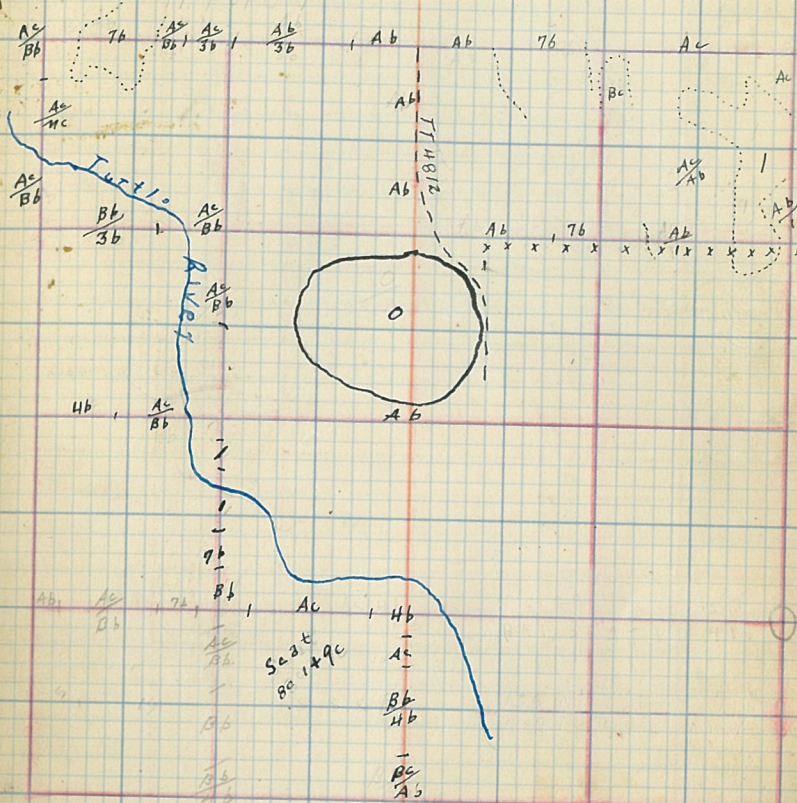

T-147-30

S-16

HARVEY HARALDSON

11/12/34

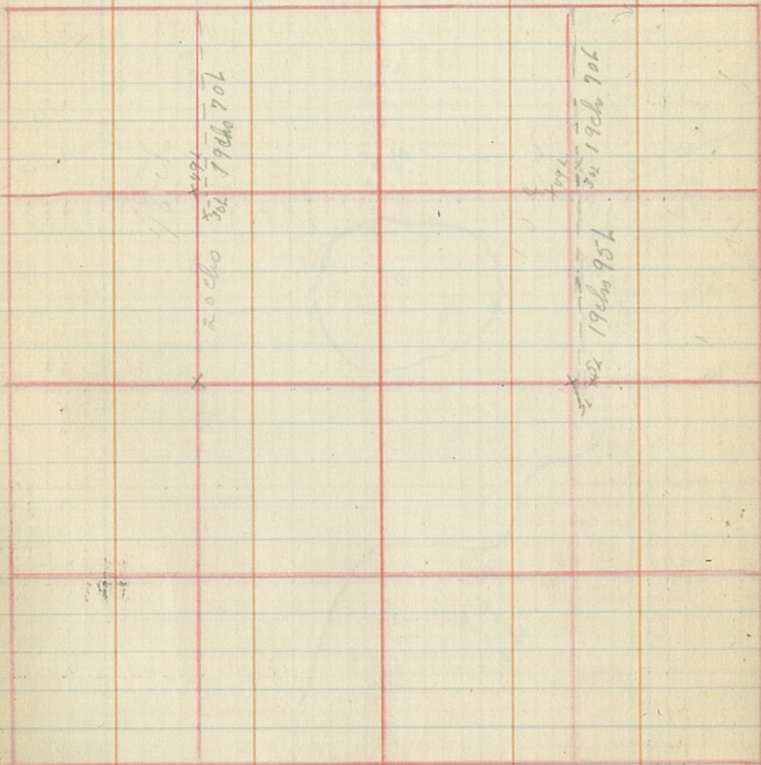

147-30

59

S-16

HARVEY HARALDSON

11/12/34

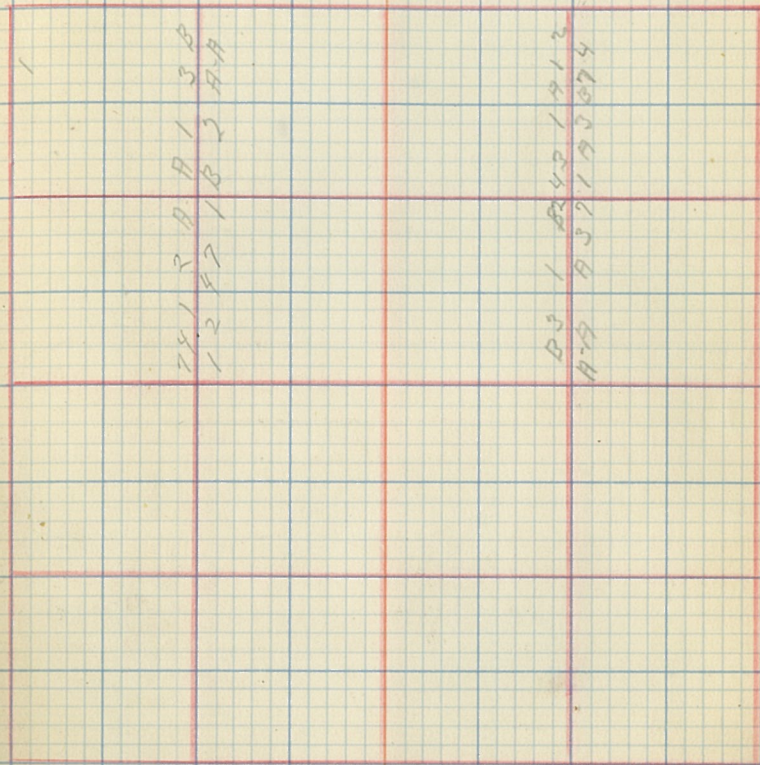

T-147-30

S-9

HARVEY HARALDSON

11/13/34

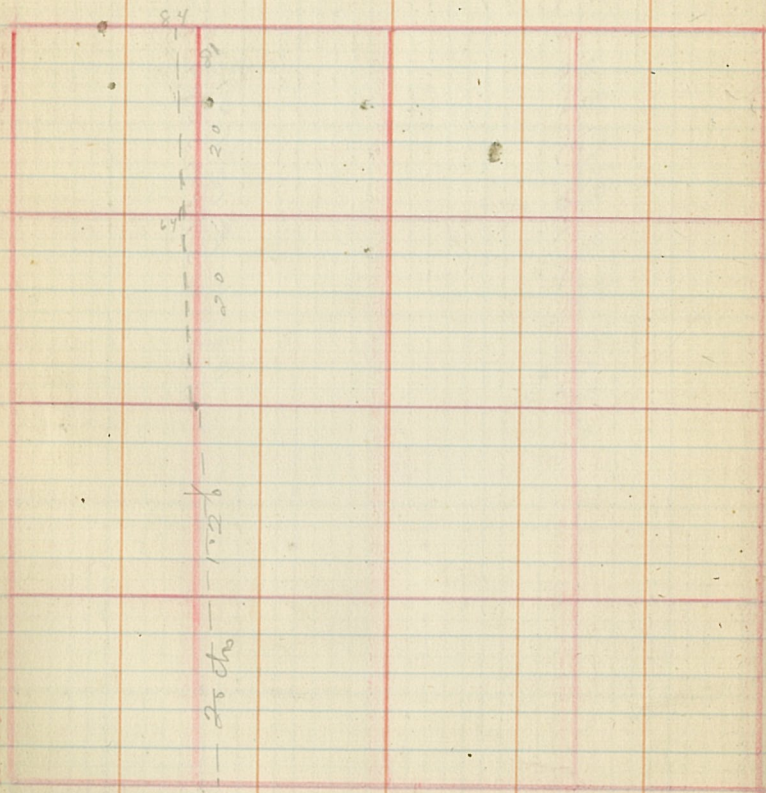

DECL-80

T-147-30

S-9

HARVEY HARALDSON

11/13/34

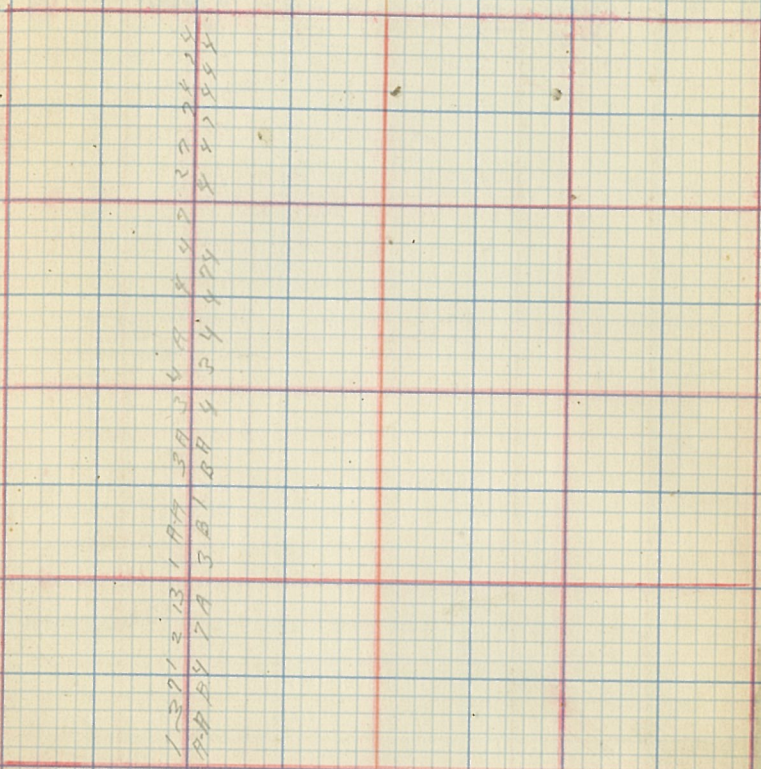

DECL-80

T 02 50 45
+ 26° 15'
40.00

T 02 50 45
+ 26° 15'
40.00

71 ch.

Sec. 21 T147 - R 29.

61

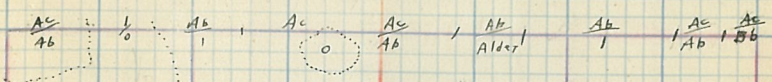

T-148 31W 5th

S-22

HARVEY HARALDSON

12/12/34

1291

20.28

20.28

21.28

20.01

T-148 31W 5th

65

S-22

HARVEY HARALDSON

12/12/34

1291

20.28

20.28

21.28

20.01

TICE
POND

SWAMP

T-148 31W 5th
sec-21
HARVEY HARALDSON
12/13/34

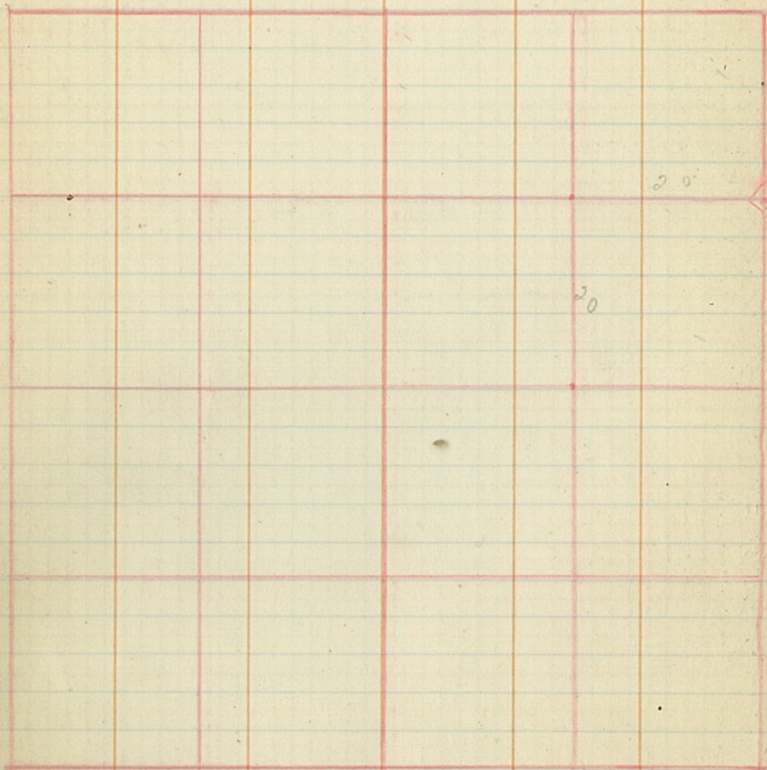

T-148 31W 5th
66
HARVEY HARALDSON
S-21
12/13/34

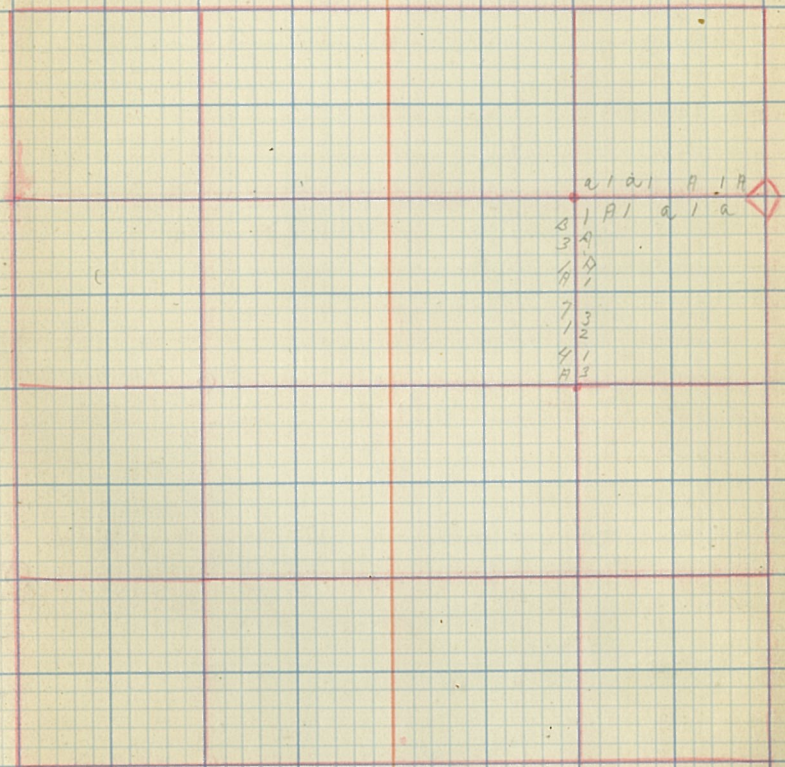

T. 148 R. 30 Sec 29

2/5/35 - 2/6/35
R. R. Grill 2/25/35

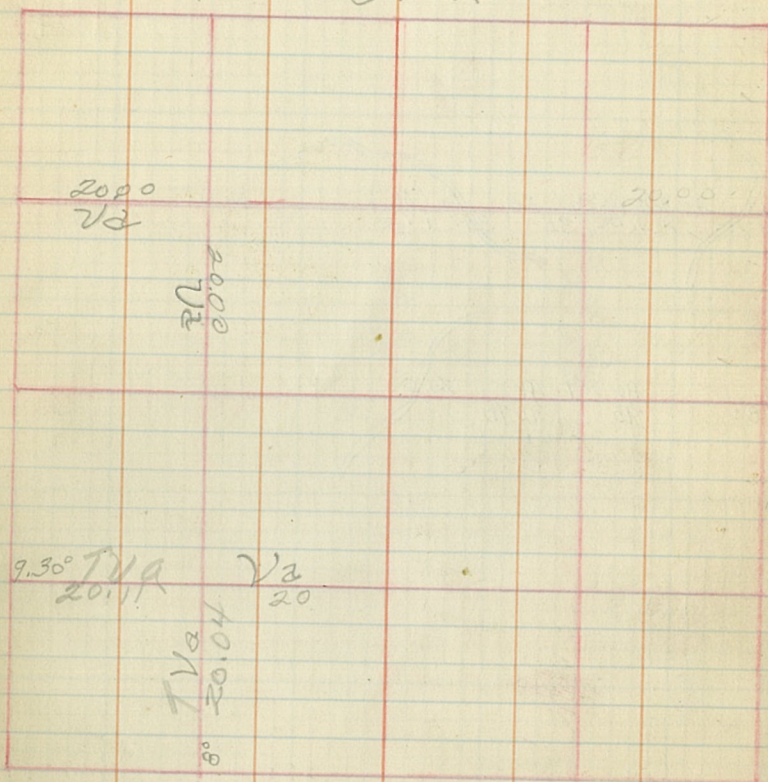

T. 148 R. 30 Sec 29

69

2/5/35 - 2/6/35
R. R. Grill 2/25/35

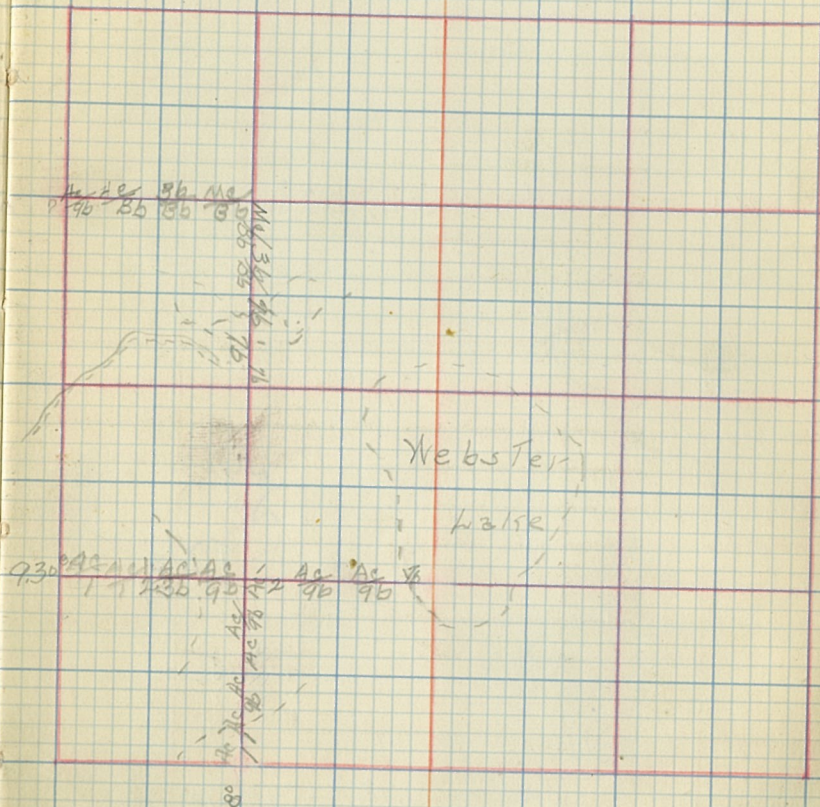

T 148 R 30 Sec 30

R. G. C. 111

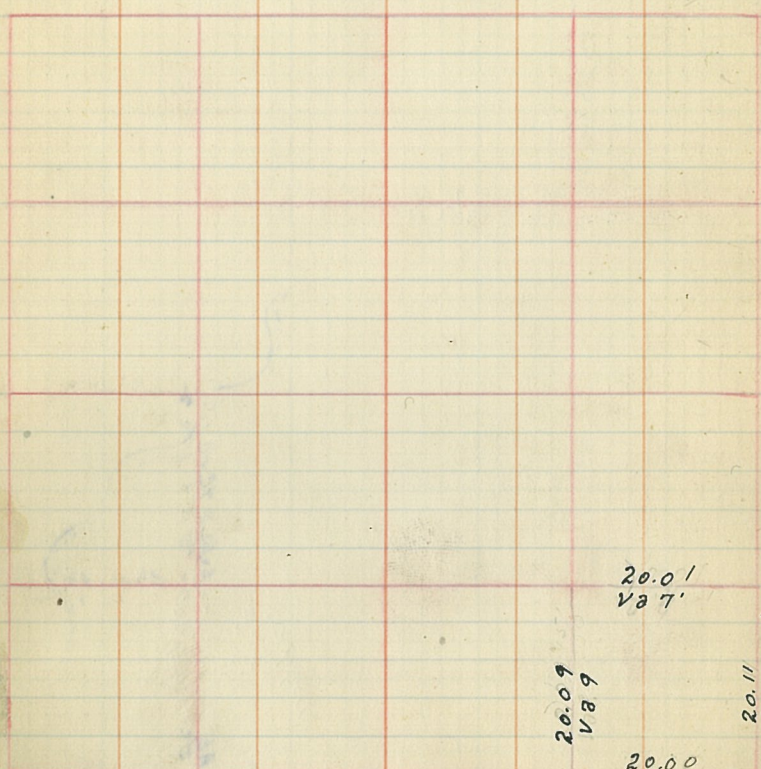

20.01
V 27'

20.09
V 29'

20.00
V 27'

20.11
V 29' 15"

Sec. 27 - 147 - 31

71

11/12/35

Espe

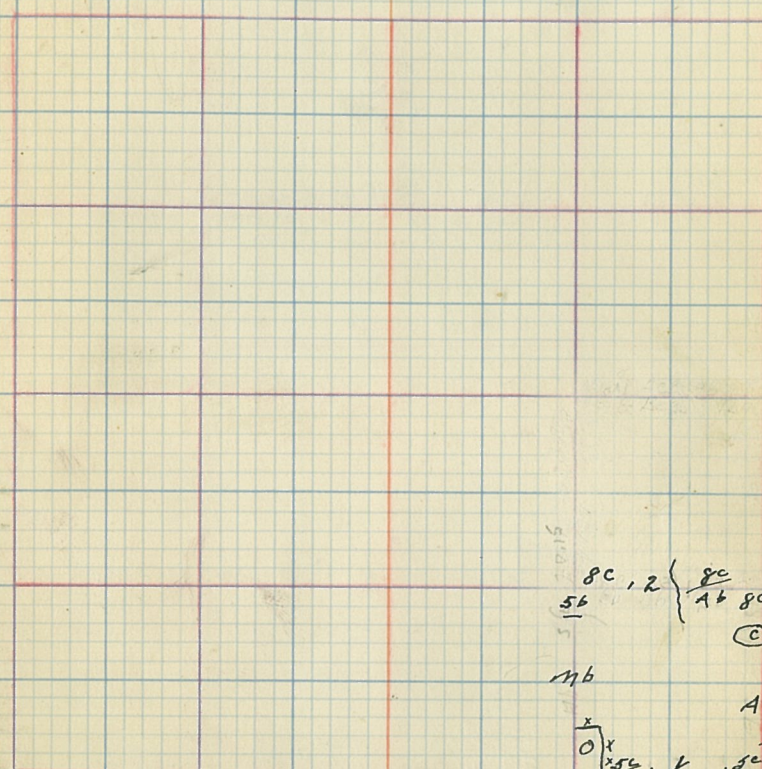

8c 1.2 } 8c
 56 } 16 8c
 (C)

mb

Ac

0 } 15c 1 10 15c
 16 10 16

Sec 8 T. 146 R. 31

3/20/35

R. Q. Gill

old Random line

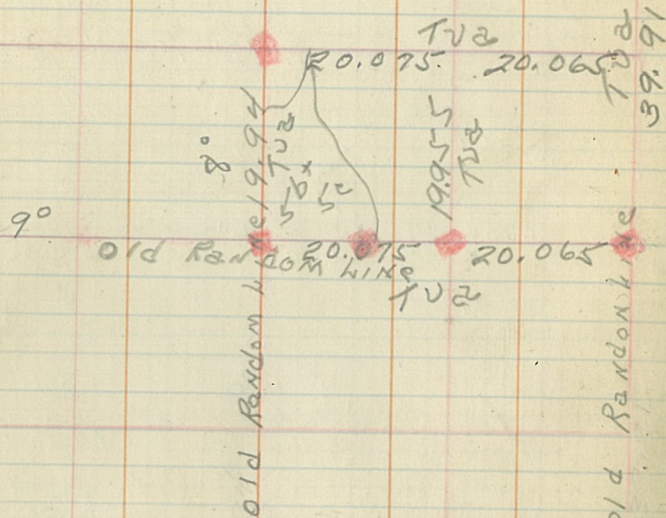

Sec 8 T. 146 R. 31

2/20/35

R. Q. Gill

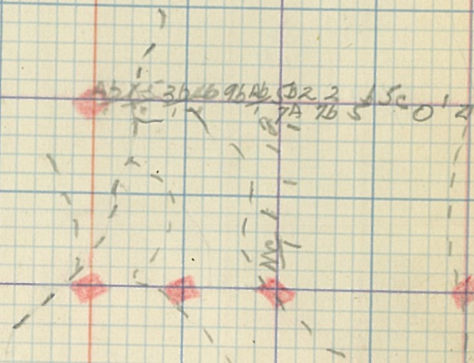

Sec 9 T. 146 R. 31

2/21/35
Robert Hill

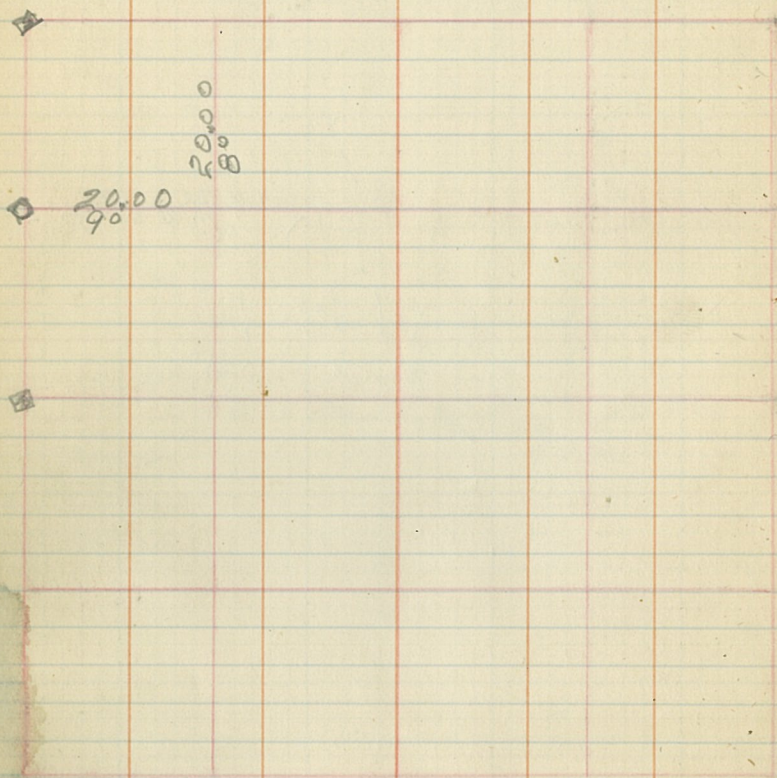

Sec. 9 T. 146 R. 31

2/21/35
Robert Hill

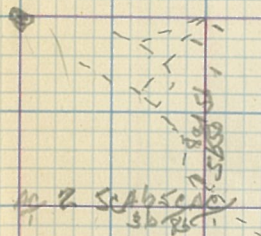

Sec 4 T. 146 R. 31

3/22/35

Babb Gull

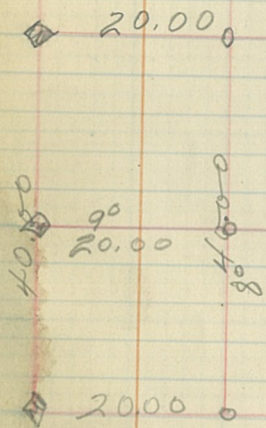

Sec 4 T. 146 R. 31

3/22/35

Babb Gull

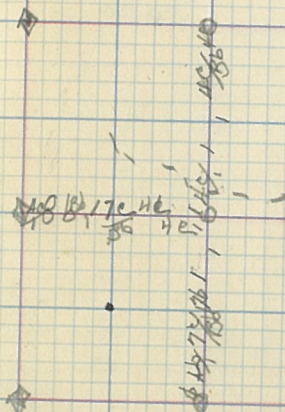

See 16 T. 146 R. 31

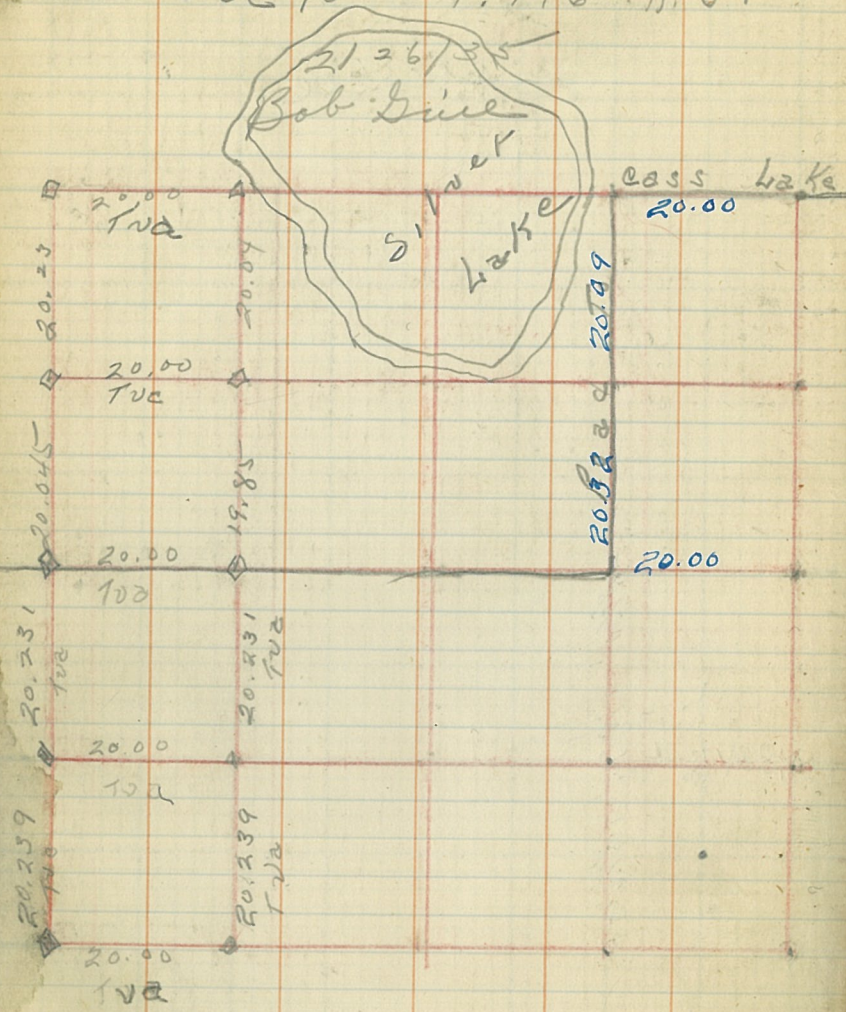

See 16 T. 146, R. 31

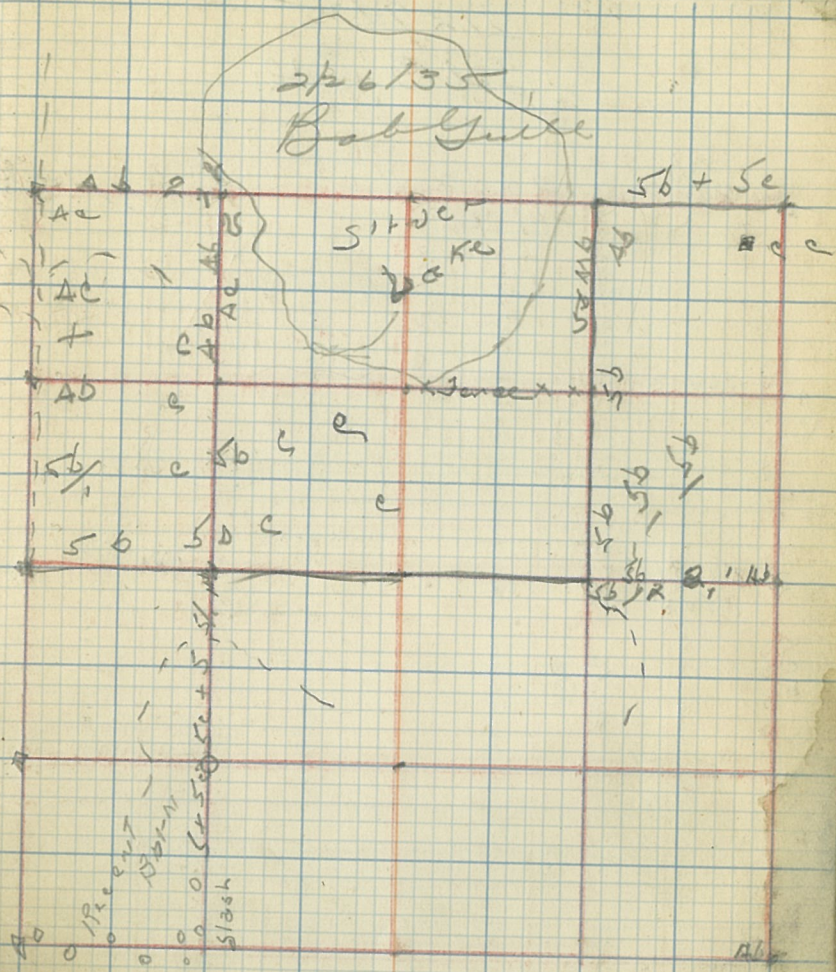

Sec 15 T. 146 R. 31

2127135

Bob Grull

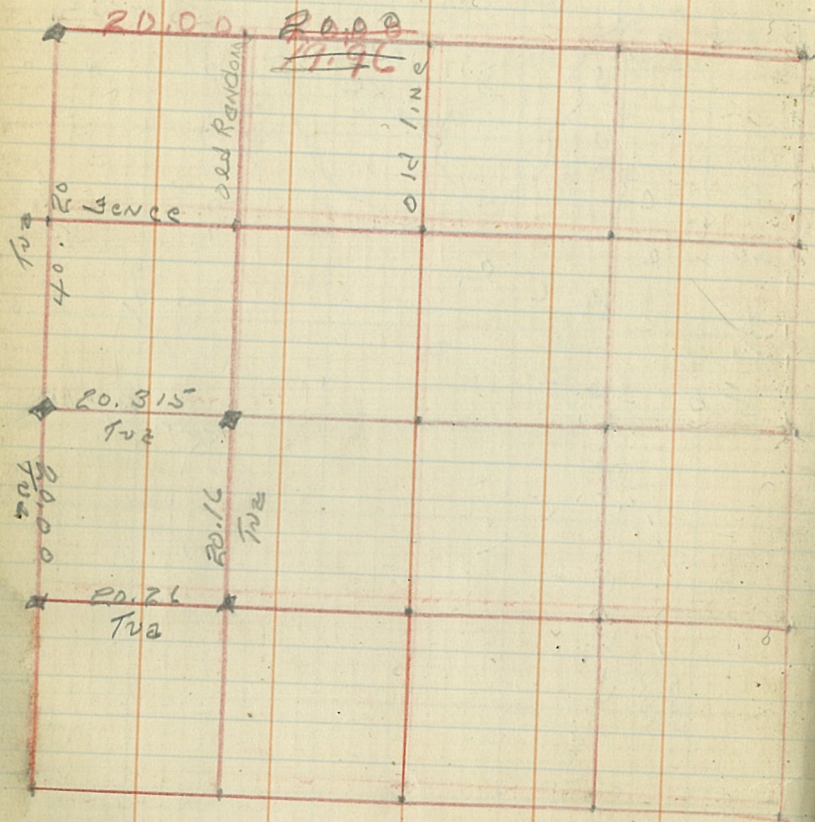

Sec 15 T. 146 R. 31

2127135

Bob Grull



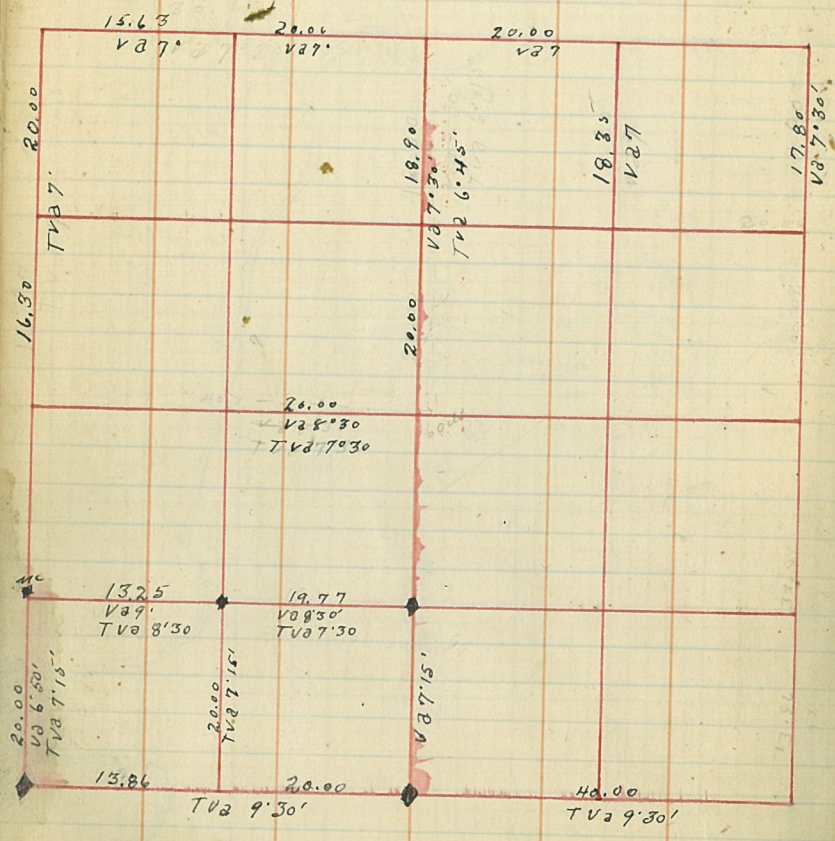

See 6 T. 147 N. R 31

4/4/35
8/19/35
8°

Murphy
Frank

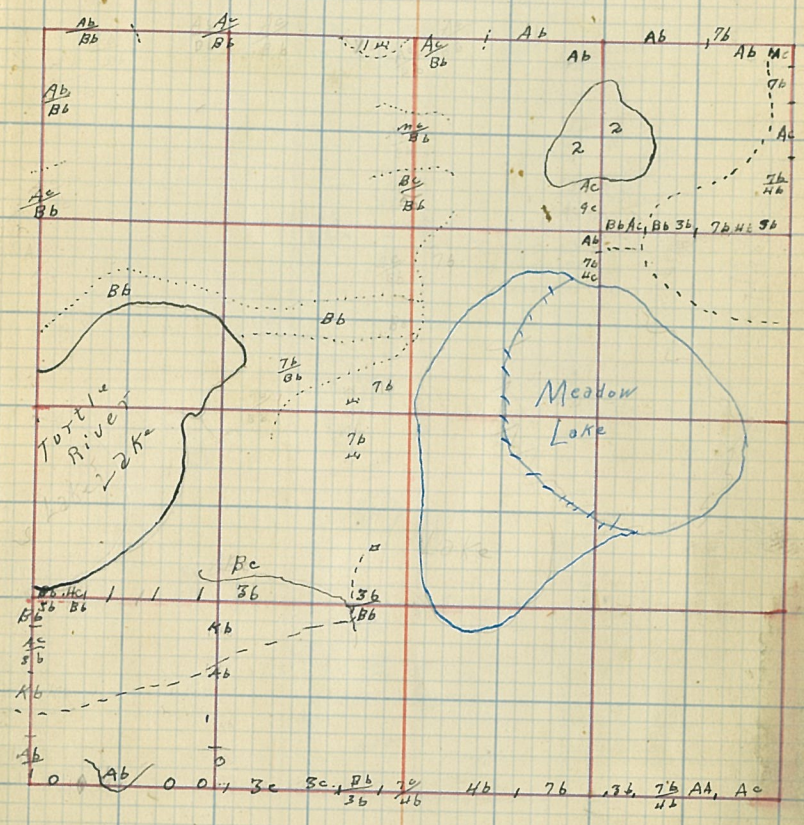

Sec. 2 T146

R. 31

82

4/8/35

Murphy

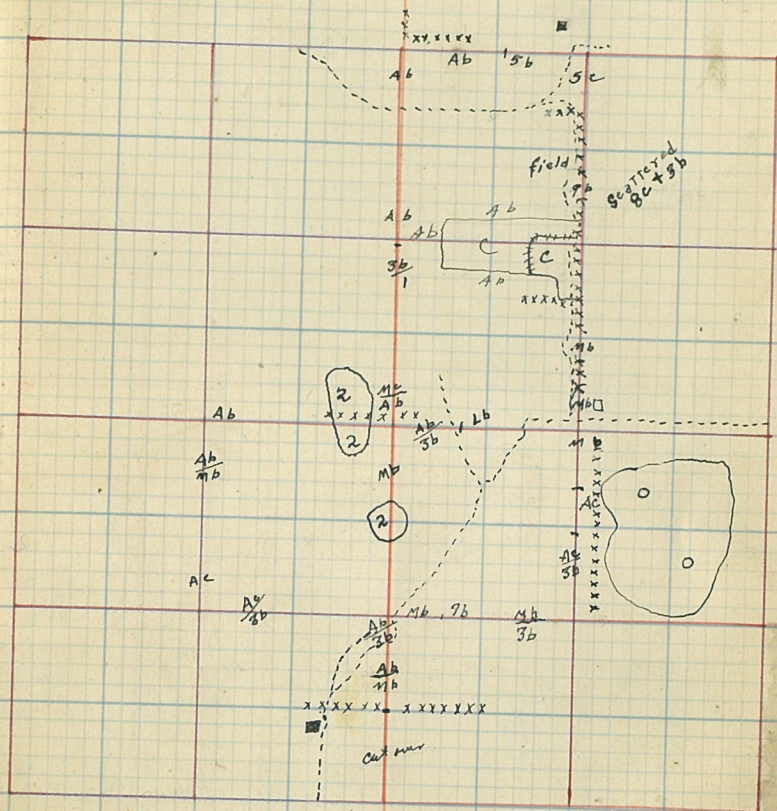
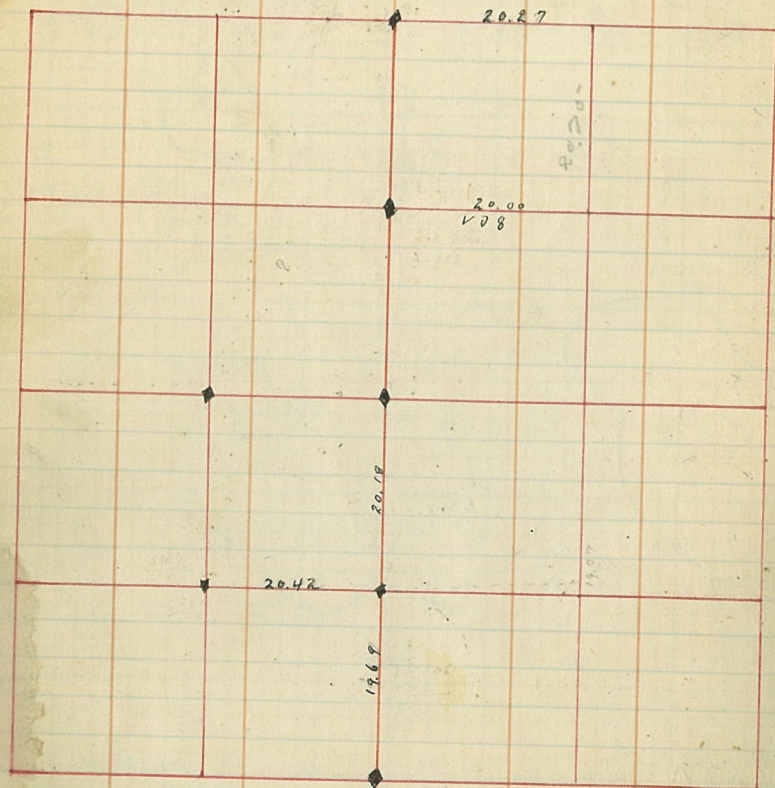

Sec. 7 T146

R 31

4/10/35

Murphy

8°

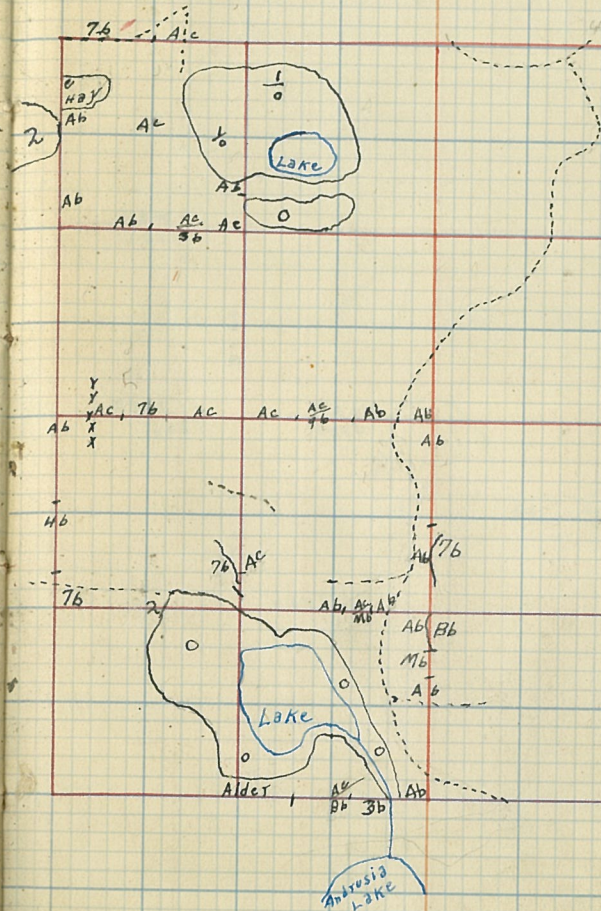
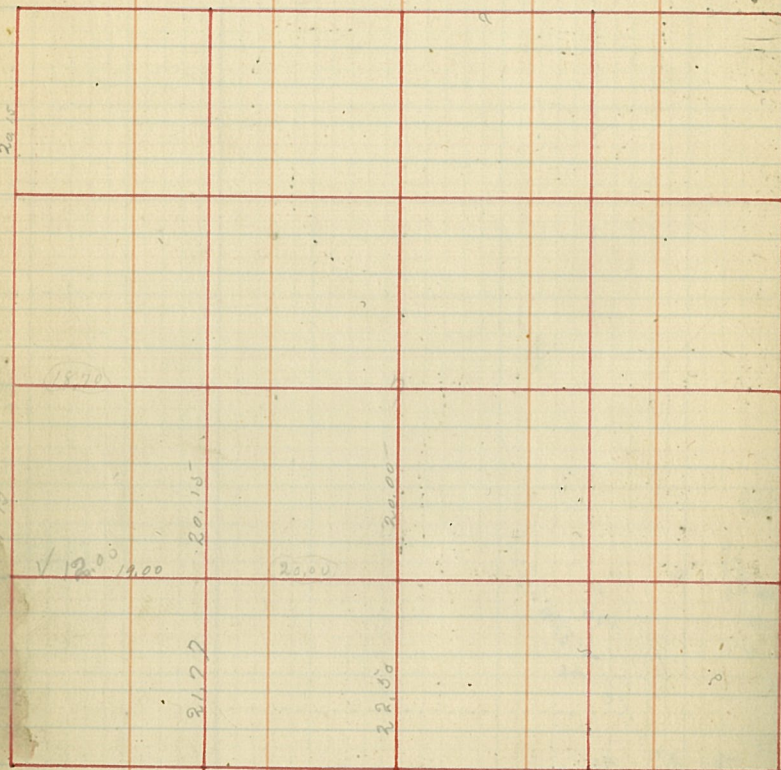

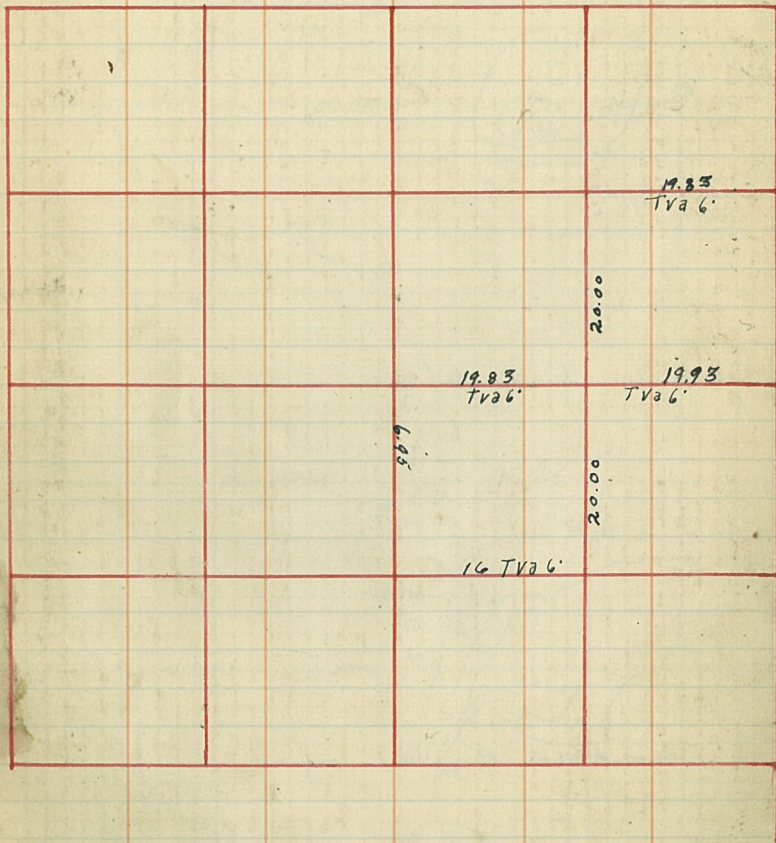

Sec. 12 T146

R 31

4/16/35

Murphy

