

DIETZGEN  
MINING

MINING  
TRANSIT BOOK

Road  
Traverse

ccc 67

- ① TRUCK TRAILS & MINOR ROADS - 4 TO 6 MI APART.  
 ② TRUCK TRAIL FIRE ROADS BETWEEN.  
 200' RESERVED STRIP ON EACH SIDE OF & OF ①

SYMBOL	SERV CLASS	MIN HR	CONST STD.	STANDARD WIDTHS AFTER SETTLEMENT SECTION					NOTES
				A	B	C	D	E	
LS	LOW	7-15	ST	11	10	12	10	12	1
LS	LOW	7-15	ST	14	13	15	13	15	2
MS	MED	16-25	DT	18	17	19	17	19	3
HS	HIGH	25 UP	DT	21	20	22	20	22	4

\* ADD 2 FT WHERE DITCHES ARE NOT USED.

A - SIDE HILL B - THROUGH CUT C - FILL  
 D - TURN PIKE E - FILL SECTION

NOTES: (1) (2) FOR ALL PROJECTS APPROVED AS LOW SERVICE USE (1) WHERE SURFACING IS NOT REQUIRED (2) WHERE SPOT OR CONTINUOUS SURFACING IS REQUIRED.  
 (3) ALL PROJECTS MED. SERVICE, WHETHER SURFACED OR UNSURFACED  
 (4) ALL HIGH SERVICE PROJECTS.

ABOVE IS EXCLUSIVE OF DRAINAGE DITCHES.  
 UNSURFACED - DITCH ONLY WHERE NECESSARY.  
 SURFACED - DITCH MODERATELY.  
 ALLOW 1 FT WIDTH FOR SETTLEMENT.

WIDEN CURVES 2' 40'-60' RAD ; 1' 60'-100' RAD

CURVES: ORD. MIN. RAD.  
 LS - 100' MS - 200' HS - 300'  
 RAD = 1000' OR MORE WHERE POSSIBLE

GRADE: FOR 500' MAX  
 LS - 12% MS - 10% HS - 8%

FOR 300' MAX  
 LS - 15% MS - 12% HS - 10%

SURFACE: LS - 9' MS - 12' HS - 16'

SPOT SURFACING ON ALL ROADS EXCEPT HS  
 UNLESS SOIL REQUIRES CONTINUOUS SURFACING  
 SPOT SURF. - 1 COURSE. CONT. SURF. - 2 COURSE

BANKING CURVES: ODD MIN OR MORE RAD -  $\frac{1}{2}$ "/FT.  
LESS THAN ODD MIN -  $1$ "/FT.

CUT & FILL SLOPES:

FILL - EARTH  $1\frac{1}{2}$ :1

CUT - FIRM SOIL -  $\frac{3}{4}$ :1

LOOSE SOIL OR WET CLAY: 1:1

CLEARING: LS - 24' MS - 28' HS - 30'

TURNOUTS: INTER-VISIBLE & ADEQUATE

LOCATE ON CRESTS TO AVOID DITCHING.

TURNAROUNDS: - TURNOUTS CAN BE USED IF  
NO DITCHES.

SPECIFICATIONS: LS & MS - 4 COPIES MR-1  
HS - 2 COPIES MR-1

MAP - LOCATION SHOWING  $\perp$  TRAVERSE &

POSITION WITH REFERENCE TO SEC. COR.

CORNERS - IN ALL CASES PRESERVE FROM  
DAMAGE

ROW EXECUTE ONE, ONE CARBON EACH  
TO SUPERVISOR & GRANTOR.

2 FORMS - CORP. & INDIVIDUAL.

ALL BLANKS - FILL OR RULE OUT.

NAME OF GRANTOR SAME AS  
ON TITLE.

ONE DOLLAR

EXAMPLE: ROW DESCRIPTION.

"A STRIP OF LAND 66 FEET WIDE EXTENDING  
33 FEET ON EACH SIDE OF CENTER LINE  
BEGINNING AT A POINT ON THE NORTH  
BOUNDARY OF THE NW $\frac{1}{4}$ , SECTION 32  
WHENCE THE SECTION CORNER COMMON  
TO SECTIONS 29, 30, 31 & 32 BEARS  
DUE WEST 1250 FEET; THENCE DUE  
EAST 475 FEET; THENCE SOUTH 450  
EAST 1230 FEET TO A POINT ON  
THE EAST BOUNDARY OF SAID NW $\frac{1}{4}$ ,  
SECTION 32; WHENCE THE CORNER  
COMMON TO SECTIONS 29 AND 32  
BEARS NORTH 860 FEET.

CULVERTS:

40# CULV. LARGE ENOUGH FOR GALV. CULV.  
DITCHES - BOTTOM WIDTH = 1" MORE THAN  
CULV. DIA SIDES  $1\frac{1}{2}$ :1  
LAY ON 1% GRADE

CORRUGATED IRON PIPE

DIA	SINGLE		REL COST	NO. PER	MULTIPLE		REL COST
	GF/SEC				DIA	GF/SEC.	
12	2.3			2	12	4.6	1.6
15	4.0	1		2	15	8.0	1.7
18	6.5	1		2	18	13.0	1.2
24	14.0	1		2	24	28.0	1.6
30	24.0	1		2	30	48.0	1.2
36	39.0	1		2	36	78.0	1.4
48	80.0	1		2			

BORROW PITS: 200' FROM ROAD - CONCEAL.  
AVOID - WIDEN CUTS & SLOPE; LOWER PROFILE

DAMAGED TREES - REMOVE IF DYING.

MAINT. - 1- $1\frac{1}{2}$ % OF CONST COST ANNUALLY

FIREBREAKS - LOW GRADE & LOW COST - SINUOUS.

• NO GREEKS, RIVERS OR LOW GROUND  
UNLESS ABSOL. NECESS. FEW CUTS & FILLS.  
THE LS. TR. SPEC.  
15' GRADE 16' FOR A.B.C.D. NO DITCHES FOR A.B.C.  
SECTIONS

## INSPECTION:

1. SPEC. - CHECK SPEC. & SERV. STA.
2. CLEARING - CHECK WIDTH, BRUSH & TIMBER DISPOSAL & EFF. CREWS.
3. BLASTING - EQUIPT., SAFETY, EFF, ECON.
4. STUMPING -
5. GRADING - WIDTH, SHAPE, RATES OF GRADE & BACK SLOPING, REGULARITY OF SECT. & CURVES, REMOVAL ROOTS.
6. EXCAVATION - WIDTH, HT. & QUAL. FILLS LOC. & APPEAR BORROW PITS,
7. DRAINAGE - LOC. INSTALL. DEPTH OF COVER, INLET & OUTLET DITCHES CULV. LOC. INSTALL. FOUND ETC. BRIDGES

## NOTES ON TR. TR. TRAVERSE.

SHOW BY STA. NO. THE FOLLOWING:-

1. TIE - INS.
2. STREAM CROSSINGS.
3. BEGINNING OF SWAMPS
4. END OF SWAMPS
5. P.I.'S
6. RIVER CROSSINGS - BRIDGES.
7. GULVERT LOCATIONS. - SIZE & MAT
8. SHOW LENGTH OF TANGENT AT EACH P.I.

## EXAMPLE:

STA No. CHS.	DIFF. CHS.	BEARING	REMARKS.
PI 0	5.47	S45E	# No TANG 10.11 CHS. W TO S.G. 2, 3, 10, 11. T 60N R 36W
PI 5.47	3.02	S33W	TANG 15 CHS.
6.82			ENTER SWP.
7.45			GULVERT STEEL 24' x 18"
PI 8.49	7.16	S17E	TANG 227 CHS.
10.47			LEAVE SWP.
14.74			RED RIVER - BRIDGE
PI 15.65	1.75	S45E	TANG 1.5 CHS.
16.10			4.72 CHS E TO 1/4 COR S 104 N T 60N R 36W.
PI 17.40			

Sta. No. Chs.	DIFF. Chs	BEAR.	REMARKS
0	8.10/1.34	S. 17 E. ✓	NOTANG ENTER BC TYPE 5.49 8.32 Ch W. To Sec. 2-3-10-11 T. 60N R. 26W
PI. 8.10	1.49/2.06	S. 51 E. ✓	TANG 100'
PI. 20.59	1.38/1.14	S. 29 E. ✓	TANG. 100'
PI. 24.97	3.09/1.33	S. 3 W. ✓	TANG 100'
26.25	1.78/21		20 ch. W. To N $\frac{1}{4}$ COR. SEC. 10-11 T. 60N R. 26W
PI. 33.06	4.63/1.10	S. 15 $\frac{1}{4}$ W. ✓	TANG. 100'
38			LEAVE 8C ENTER ASH SWP.
PI. 40.69	5.67/1.43	S. 3 W. ✓	TANG. 100'
45.68			CULV. CEDAR 2'x3'x22'
48			LEAVE ASH SWP. ENTER AB
PI. 49.36	14.13/2.33	S. 10 E.	TANG 120'
54.			46 ch N. To S. L. ON W. $\frac{1}{4}$ LINE
PI. 63.49	10.73/1.77	S. 2° E. ✓	TANG. 100'
70.			26.50 ch. W. To SEC LINE 10-11 South $\frac{1}{4}$ LINE SEC. 11 T. 60N. R. 26W
PI. 74.22	5.33/0.88	S. 10 $\frac{1}{2}$ W. ✓	TANG. 75'
PI. 79.55	4.50/1.74	S. 37 $\frac{1}{2}$ E. ✓	TANG. 100'
PI. 84.05	11.13/1.84	S. 24 $\frac{1}{2}$ E. ✓	TANG. 57'
88			LEAVE 8C ENTER AB ON BOTH SIDES
92.49			CROSS SEC. LINE VAN BY Montgomery - 36.15 ch W. To SEC COR. 10-11-14-15 T. 60N R. 26W

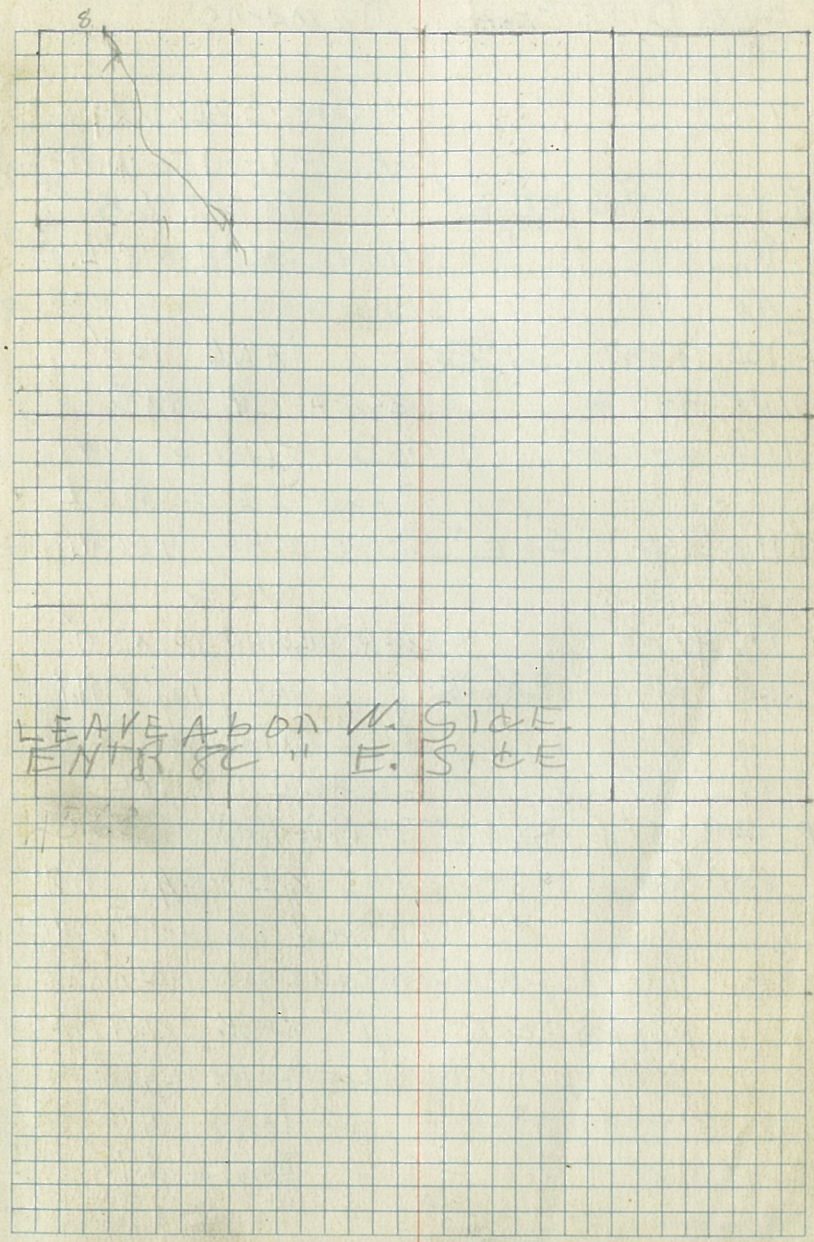

LEAVE AB ON W. SIDE  
ENTER 8C " E. SIDE

STANDARD DIFF BEARING REMARKS  
 CHS CHS

92.77 White post 5.81 E To 4  
 cot. SEC 11-14 T 61 N  
 P.I. 95.18 10.61/1.75 S 8 1/4 E. TANG 65'  
 98.25 STEEL CULV diam 18" L. 20'  
 98. SPRUCE SW. & POPS OFF T.W.  
 P.I. 105.79 17.72/1.77 S 35 3/4 E. TANG 100'  
 108 2.71/1.36 LEAVE AB ENTER ARC  
 112 6.21/1.07 CROSS LINE SECTION  
 R 26 W L 2 ch. S to S L  
 P.I. 113.51 6.86/1.13 S 21 E. TANG 100' begin CONTIN-  
 UOUS CURVE  
 115.49 1.98/.32 CEDAR CURVE 21' x 20'  
 P.I. 120.37 17.83/2.11 S 8 1/2 W. TANG 100' END  
 OF CONTINUOUS CURVE  
 120 END ARC ENTER ARC  
 P.I. 133.70 5.18/.85 S 49 E. TANG 130'  
 136 7.80/.46 CROSS LINE 46 ch W.  
 TO SEC. LINE 14-15 T 60 N R 26 W  
 AT 136 PINE CONTINUE S ALONG ROAD  
 but on EAST side, 7' on W. OPEN MARSH  
 with pond 6 ch. LONG 68 ch wide  
 P.I. 138.38 7.73/1.19 S 32 3/4 E. TANG 48'  
 P.I. 145.41 6.65/1.10 S. 22 E. TANG 69'  
 P.I. 152.26 17.25/1.19 S. 55 E. TANG 150'

723

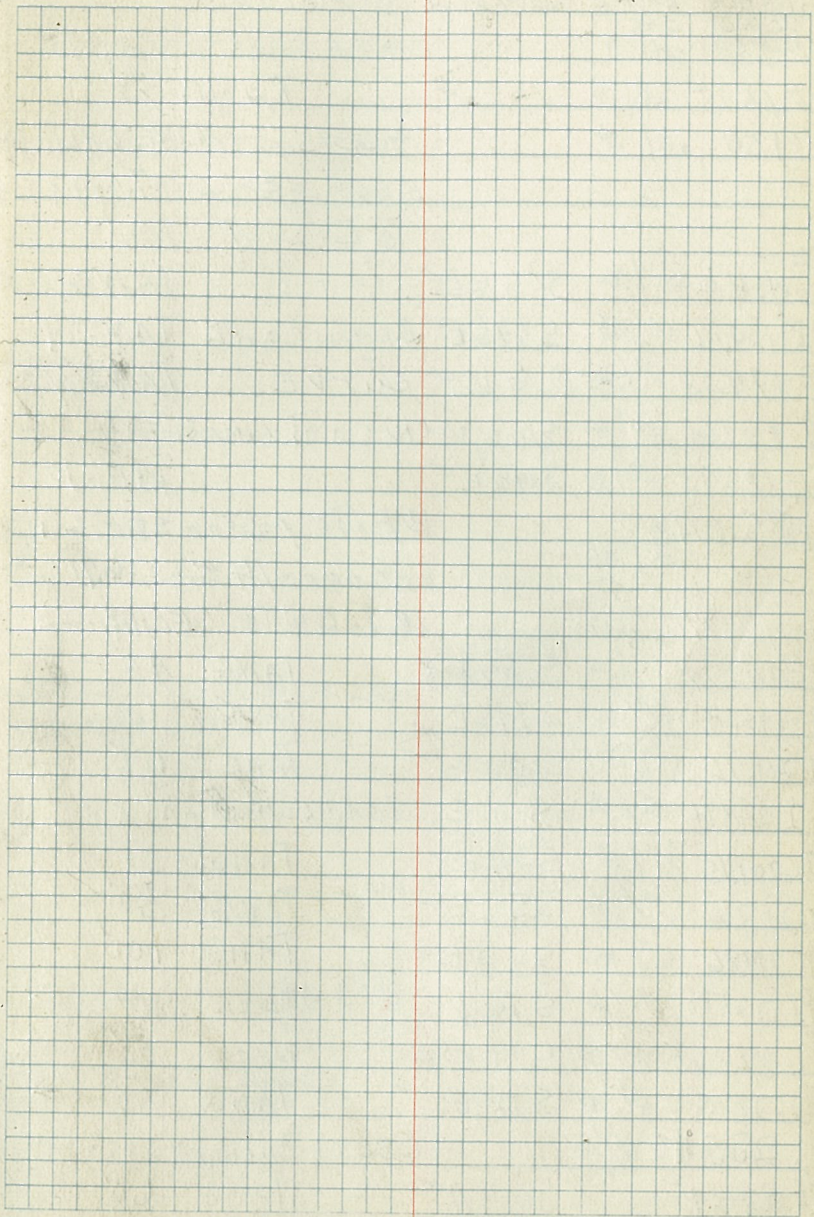

STATION	DIFF	BEARING	REMARKS
159.38	1.17/1.17		CROSSE. 1/2 LINE S. 1/2 ST. 0.51
P.I. 154.51	4.89/1.81	S 1/5 E ✓	TANG 72'
161.58	2.07/1.94		CROSSES S. 1/2 LINE 68 LINES EAST OF E 1/2 COR. T. 60 N R 24 W SEC. 14
P.I. 164.40	4.77/1.78	S 55 1/2 E ✓	TANG 100'
P.I. 169.12	5.16/1.85	S 37 1/2 E ✓	BEGIN CONT. TANG 39'
P.I. 174.28	3.38/1.96	S. 6 W ✓	CURVE. TANG 45'
P.I. 177.66	3.71/1.87	S 16 3/4 W ✓	END CONT. CURVE. 33 TANG
P.I. 182.93	4.90/1.80	S 19 3/4 E ✓	TANG 100'
185.04	2.11/1.35		WHITE POST ON SEC. LINE BETWEEN 14 & 23. 6.91 CH. W. TO E 1/2 COR. SEC. 14 - 23.
P.I. 187.77	8.35/1.38	S 38 1/2 E ✓	TANG 45'
P.I. 196.14	5.67/1.93	S 74 1/2 E ✓	TANG 100'
P.I. 201.76	7.39/1.72	S 48 1/4 E ✓	TANG 100'
208.54	1.78/1.74		CEDAR CULVERT 2' X 3' X 20'
P.I. 209.15	4.51/1.74	S 24 E ✓	TANG. 37'
P.I. 213.66	6.20/1.02	S 5 E ✓	TANG 50'
P.I. 219.86	6.00/1.99	S 47 3/4 E ✓	TANG 100'
P.I. 225.86	2.19/1.46	S 1 1/4 W ✓	TANG 100' →
P.I. 228.65	2.15/1.35	S 89 W ✓	TANG 50'
P.I. 230.80	5.35/1.88	S 72 1/2 W ✓	TANG. 50' →
P. 235.40	1.60/1.36		CEDAR CULVERT 2' X 3' X 20'
P.I. 236.15	11.16/1.84	S 42 1/2 W ✓	TANG 60'

→ END OF  
BEGIN CURVE

→ 192 CH CEDAR CULVERT  
2' X 3' X 20'

BEGIN CONT. CURVE

END CONT. CURVE

STA. No.	DIFF.	BEARING	REMARKS
chs	chs.		
245.56	9.41	1.55	Whitepost Withpaste Shot up. Not Readable, Probably S. 4 cor. SEC. 23 & 24
PI. 247.31	19.00	3.13	S 10 1/4 W. ✓ TANG 100'
PI. 266.31	8.15	1.39	S. 5 E. ✓ TANG 65'
PI. 274.76	7.54	1.74	S 37 3/4 W. ✓ TANG 150'
PI. 282.30	7.21	1.19	S 13 1/4 E. ✓ TANG 100'
284.03	1.73	.28	White post on LINE 23-26 3467 ch W to cor SECS-23-26 T. 60 N. R. 26 W.
284.			ENTER 76 <sup>th</sup> on W. of road
PI. 289.54	6.63	1.09	S 3 1/4 E. ✓ TANG 45'
PI. 296.17	7.74	1.28	S 38 W. ✓ TANG 140'
PI. 303.91	21.94	3.67	S. 42 W. ✓ TANG 100'
302.			END 76 <sup>th</sup> on W. begin Mb
314			END Mb begin Mc
322			END Mc " " 8c
PI. 325.85	9.64	1.59	S 51 1/4 W. ✓ TANG 100'
PI. 335.47	20.44		S. 75 1/2 W. ✓ TANG 90' →
336.			END 8c BEGIN Mb-c
PI. 338.17	6.35	1.05	N. 53 1/4 W. ✓ TANG 48' →
PI. 344.52	7.57	1.25	N. 9 1/4 W. ✓ TANG 100'
PI. 352.09	9.31	1.54	N. 31 1/2 W. ✓ TANG 100'
35A.			White post 38 LINKS E. FROM CENTER OF ROAD. 26.15 ch N. TO 400' SEC. 23 & 26 T. 60 N. R. 26 W.

BEGIN CONT. CURVE

END CONT. CURVE

23 & 26 T. 60 N. R. 26 W.



## 601A SCENIC Hwy south

STA. NO. CHS	DIFF. CHS	BEARING	REMARKS
356.53			CEDAR CULVERT 12 X 20
PI. 361.40	1.51	N 49 1/4 W	TANG 100'
364			END MC BEGIN BC.
PI. 368.97	6.80	N 4 1/2 W	TANG 100'
PI. 375.77	3.20	N. 22 1/2 W.	TANG 100' BEGIN CONT. CURVE.
PI. 378.97		N. 51 1/4 W	END "
378			BEGIN CLEARING on E. of Road
381			END CLEARING on E. of Road
PI. 386.46		S. 74 1/4 W.	TANG 100'
387			END BC BEGIN MC
PI. 397.02		N. 81 1/4 W	TANG. 65'
PI. 401.15		S. 31 W.	TANG 60'
398			END MC BEGIN BC
PI. 406.16		S. 46 W	TANG 100'
408			END BC BEGIN BC
414.48			White post S. of road 14.53 CH N. To SC. 22-23 27-26 T. 60 N - P. 26 W.
PI. 416.20			TANG 100' BEGIN CONT. CURVE

BEGIN 601A south

STA. NO. Ch.	DIFF. Ch.	BEARING	REMARKS
			ENTER 80
PT. 0	7.89	S 15 E.	832 CH. W. TO SC. 23-10-11
PT. 7.89	10.44	S 48 <sup>3</sup> / <sub>4</sub> E	TANG 100'
PT. 18.33	4.47	S 27 E	TANG 100'
PT. 22.80	7.69	S 5 W.	TANG 100'
2426	1.56		CROSS N. $\frac{1}{6}$ LINE SEC. 11 51 $\frac{1}{2}$ LINKS W TO NW $\frac{1}{6}$ COR. POST.
PT. 3049		S 15 $\frac{1}{4}$ W.	TANG 100'
36			L.V. 80 CENT. ASH SWP.
PT. 3834		S <sup>3</sup> / <sub>4</sub> W.	
43.14			CEDAR CULVERT 2' x 3' x 22
44.42			CROSS N. LINE SEC. 11 17.20 CHS. W. TO S.L. L.V. ASH SWP.

STA. NO. chs	DIFF chs.	BEAR.	REMARKS
H 7.19		S 40 E.	ENTER BC TANG 120'
51.78			CROSS $W\frac{1}{2}$ LINE 46.15 CH. N. TO SEC. LINE.
PI. 61.34		S 2 E.	TANG 100'
67.81			CROSS $S\frac{1}{2}$ LINE SEC 11 26.50 CH W. TO S. L.
72.05			STAKE FOR 12' STEEL CULVERT.
PI. 72.28		S 10 $\frac{1}{2}$ W.	TANG 75'
PI 77.52		S 37 $\frac{3}{4}$ E	TANG 100'
PI. 82.09		S 24 $\frac{3}{4}$ E	TANG 57'
83.80			STAKE 21' CULVERT & DIVER
90.35			CROSS SEC. LINE - 11-14 34.05 CH W TO SEC. 11-14 - 10.15
90			ENTER M b
PI. 93.10		S 8 $\frac{1}{4}$ E	TANG 65'
PI. 103.60		S 35 $\frac{1}{2}$ E	TANG 100'
104			LEAVE M b ENTER A-AC
109.78			CROSS $\frac{1}{4}$ LINE SEC 14 62.28 CH S. TO S. L.
PI 111.38		S 21 E.	TANG 100'
112.46			CROSS $\frac{1}{2}$ LINE 41.59 CH W TO SEC LINE.
PI 118.22		S 3 $\frac{1}{2}$ W	TANG 100'
118			LV. AC ENTER 8C
PI. 131.05		S 49 $\frac{1}{4}$ E	TANG 130'

STA. NO. CNS.	DIFF CNS	BEARING	REMARKS
PI. 13611		S 33 1/2 E	TANG 48'
13381			CROSS 1/4 LINE - SEC 14 145.51 ch W. To S.L.
PI 142.59		S 27 1/4 E	TANG 69'
PI. 150.09		S 55 E	TANG 150
157.36			CROSS E 1/16 LINE SEC. 14 21.76 ch S. To S.L.
PI. 157.28		S 16 1/4 E	TANG 72
159.35			CROSS S. 1/16 COR SEC 14 68 1/2 L.W. To S.E. 1/16 COR.
PI. 162.27		S 55 E	TANG 100'
PI. 167.01		S 37 1/4 E	CONT. CURVE 68 1/2 W TANG 89'
PI 172.04		S 6 W.	TANG 45'
PI 175.38		S 17 1/4 W	END CONT CURVE TANG 33'
PI 179.79		S 8 W.	beginning CURVE TANG 33'
182.72			CROSS SEC. LINE - 14-23 7.21 ch W. To E 1/16 COR.
PI 183.31		S 18 1/2 E	TANG 33'
PI. 185.34		S 39 1/2 E	END CONT. TANG 33
PI. 192.88		S 7 1/4 E	CURVE TANG 100
PI. 199.59		S 47 1/2 E	TANG 100
201.28			GEAR CULVERT
PI. 207.		S 2 1/4 E	TANG 100'

STA. NO.	DIFF	BEAR.	REMARKS
PI. 211.38		S 3 1/4 E	TANG 60'
PI. 216.		S 27 1/4 E	TANG 90'
PI. 219.21		S 52 E.	TANG 60'
PI. 223.11 ✓		S 1 3/4 E	TANG 100' <sup>begin curve</sup>
PI. 226.07		S 37 3/4 W	TANG 60'
PI. 228.36		S. 72 W.	TANG 60' <sup>END</sup> CONT. CURVE
232.98			CEGAR CULV. 2x2x20'
PI. 233.71		S 42 3/4 W.	TANG 100'
242.52			CROSS SEC Line - 23-24 S. 21 ch. South of 1/4 cor.
PI. 244.71		S 10 3/4 W.	TANG 100'
245			LV. MB ENT. M.C.
246.46			CEGAR CULV. 2x4x20'
PI. 260.97		S 5 E	TANG 100'
269.47			CROSS ROAD (cut out)
PI. 270.44		S 16 1/4 W	TANG 60'
PI. 273.26		S 38 1/2 W	TANG 50'
PI. 278.26		S 14 1/2 W.	TANG 50' <sup>begin curve</sup>
PI. 280.32		S 18 E.	TANG 50' <sup>END curve</sup>
281.09			white post 34.91 ch W. to 1/4 cor. Sec. 26-23
PI. 286.59		S. 6 E.	TANG 60'
PI. 291.68		S 19 W.	TANG 30' <sup>begin curve</sup>
PI. 295.06		S. 39 1/2 W.	TANG 100' <sup>END curve</sup>
PI. 300.33		S 42 1/4 W	TANG 60'

STAND.	DIRE	BEAR.	REMARKS
318			L.V. MC enter RC.
PI 322.52	S 56 1/2 W		TANG 100'
PI 332.26	S 80 1/2 W		TANG 60' begin cur.
PI 335.19	N 53 W		TANG 60' end cur.
END 601A & BEGIN 602A			
PI 341.28	N 9 W		TANG 100'
PI 349.67	N 32 1/2 W		TANG 100'
350.51		26.55 ch. N. to 4. 0. 11	
		Sec. 23-26	
353.27		cedar culvert 11 x 11 20	
356		L.V. MC begin RC	
PI 358.02	N. 49 3/4 W		TANG 60'
PI 364.18	N 29 W		TANG 45' begin cur.
PI 366.12	N 4 1/2 E		TANG 60' end cur.
PI 372.40	N. 24 3/4 W		TANG 60' begin cur.
PI 375.51	N 55 W.		TANG 60'
PI 380.63	N 73 3/4 W.		TANG 60'
382		L.V. RC begin M5-C	
PI 383.95	S 74 1/2 W		TANG 100' end cur.
PI 393.55	S 82 W.		TANG 60'
PI 397.43	S 32 W		TANG 100'
PI 401.56	S 41 1/2 W		TANG 60'
H 4		L.V. MC begin RC	
PI 407.67	S 50 W.		TANG 100'
H 10-75		white post # 55 ch. N. to SC.	
		22-23-26-27 T 60 N R 26 W.	

336 L.V. RC. begin M5-C

30. LINKS Left of Road

STA. NO.	DIFF.	BEAR.	REMARKS
PT. 413.10		S 80½ W.	TANG 60' <sup>curve</sup> begin
PT. 415.40		N. 65½ W.	TANG 60' end
PT. 417.69		N 40½ W.	TANG 20' curve
PT. 432.22		N. 28 W.	TANG 75'
432.27			ROAD BEARS TO LEFT.
			N. 41 W. (cut out)
437.31			White post 20 Links N. from E of road 2.27 ch. W. to east ¼ cor. Secs 23-27.
PT. 437.43		N. 28 W.	TANG 60'
438			LK. 8C enters MB
PT. 447.20		N 28¾ W.	
460			LV. MB ENTER MC
PT. 476.79		S 88 W.	TANG. 150'
477.74			White post 4.91 ch. no. to center Sec 22. (On tangent 37 Links So. to E of curve)
478			LV. MC. Begin hay meadow
488.25			LV. hay meadow begin AB
496.62			cedar culvert 3x4x20'
			496.25-498. cedar camp.
500			LVA C begin 8-90
PT. 499.47		N. 47 W.	Tang. 150'
510			LV. 89 begin AC
518.55			cedar culvert 3x4x18

STA. No.	DIFF	BEAR.	Remarks
52433			Side road to south
PT 534.33		N 62 $\frac{3}{4}$ W	TANG 45' <sup>begin</sup> curve
PT 536.79		Due west	TANG 45' end curve
PT 542.53		N 62 $\frac{1}{4}$ W	Tang 45' begin curve
PT 545.54		N 47 W	Tang 45' end curve
544			L.V. AC begin Mb-c
PT 566.06		N 8 W	TANG 100'
PT 571.39		S 89 $\frac{3}{4}$ W	TANG 60'
574			L.V. Mb-c. Enter H <sub>2</sub> Sup
575.32			yellow tag on top pole con. sec. 16-21 →
575.56	begin 600.		cross E of 600 going north.
586.	going west		Leave H sup. enter willow & elder swale
588.67			cross Rice River bridge
PT 589.56		S 81 $\frac{3}{4}$ W	TANG 50'
PT 592.47		N 84 $\frac{3}{4}$ W	TANG 60'
PT 596.04			TANG 50'
592			L.V. Willow Swale enter H <sub>2</sub> <sup>sup.</sup>
598	Due West		L.V. H <sub>2</sub> Sup. enter 8-c
613.87			White post 30 LINKS S of E Sec. con 16, 17, 20, 21
625			end 8c begin swale with cedar balsam etc.
632			end swale begin 8c

end of 600 A

to con sec. 16+17+20 at 594.60



STA. NO.	D. FF	BEAR.	REMARKS
PI 635.86		N 89° W	TANG. 100'
656		L.V. 8 E	Begin bush
PI 66031		One West	TANG. 100'
673.08			E. N. of ROAD
chs			Beginning 600. going North cedars sup.
0			
PI 0		N ½ W.	
4			L.V. sup. enters clearing on east M. of on west
14			M. b. on both sides of road
20			clearing on east again
19.95			Strac. Sec. 16.
22			L.V. M. B. enters 8-90 on W. of road.
PT. 4020		S 89° W	TANG. 150'
40			1/4 COR. Sec. 16
5946			F.S. Tag W 1/4 cor. SEC. 16
PI 62444		N ½ E	TANG. 150'
66.			L.V. 8 C ENTER MC
85			L.V. M. C. ENTER 9 C
PI 9847		N 3 E	TANG. 60'
100.23			Cross Sec. Line 1 P. H. 3 ch West to N.W. cor Sec. 16
101			L.V. 9 C begin Mb
PI 107.60		N 2 ½ W.	TANG. 50'

653.89 → 65 Links  
south to 1/4 Cor. Sec. 17-20.

STA. NO.	DIFF	BEAR.	REMARKS
PT 111.05		N 15° W.	TANG 75' begin curve
PT 114.13		N 53° W.	TANG 50'
PT 116.54		N. 71° W.	TANG 60' end curve
PT 122.77		S 89° W.	TANG 75'
PT 126.27		S 86 3/4° W.	TANG 30'
PT 132.29		N 61° W.	Tang 60' begin curve
13340			cross sec. line 8-9 62.31 ch No. to sec. cor.
132			LV M6 F center line
PT 133.93		N 26 3/4° W.	Tang 30' end curve
PT 135.60		S. 41° W.	Tang 60' curve
14214			center line 314 120
PT 14317		N 31° W.	Tang 75'
146			LV M6 sup. center PC
156			115 ch E to 4 cor. sec. 8-9 begin curve by F&P
PT 15636		N 10° E	TANG 75'
157			LV PC begin older curve
15816			cross R. P. 2 steel
+			curve to 20' 10"
15878			77 ch E to 4 cor. sec. 8-9
PT 16050		N 10 1/2° W.	TANG 75'
PT 16146		D. 11° N	TANG 75'
169			LV line center 80
PT 171.65		N 31 1/2° E	TANG 45' begin curve

STATION DIRECTION REMARKS

PT 73	N 61 1/2 E	TANG 30'
PT 17435	N 85 E	TANG 60'
PT 18852	N 68 E	TANG 100'
PT 18817	S 85 E	TANG 75' <sup>original</sup> <sub>curve</sub>
PT 19055	S 57 1/2 E	TANG 75' <sub>curve</sub>
PT 19511	N 84 1/2 E	TANG 100'
198		LV. 80 Enter 90 Supp.
210		LV. 70 Supp. enter 80
PT 21481	N 4 E	TANG 150'
214HH		Cross by 1 inch 3/16 NO to 5/8 cor SEC. 9
220		LV. 80 Enter NO
PT 23860	N 89 1/2 E	TANG 100' cor. by So. Big Sak school

going south on 602 a  
from farm comp.

STA. NO.	DIFF.	BEAR	Remarks
0		S55 $\frac{1}{2}$ W	ENTER AC
2.58			cross $\frac{1}{4}$ line 4.50 W. <sup>(key mark)</sup> to $\frac{1}{4}$ cor. Sec 26.
PT. 6.97		S65W.	TANG 100'
10.25			CROSS Rice River
PT. 13.56		N.72 $\frac{1}{2}$ W	TANG 100'
PT. 18.39		S.69 $\frac{3}{4}$ W.	TANG 100'
PT. 20.96		S.44 $\frac{1}{2}$ W	TANG 100'
PT. 30.02		S.17 $\frac{1}{2}$ W	TANG 100'
31			L.V. AC ENTER RC.
PT. 36.64		S37 $\frac{1}{2}$ E	TANG 100'
36.64			Turn back road to Right
PT. 41.56		S1 $\frac{3}{4}$ E	TANG 100'
44.50			L.V. RC ENTER ASD SWP.
50.			L.V. ASH SWP. ENTER MC
PT. 50.58		S39 $\frac{1}{2}$ E	tang 75' <sup>begin</sup> curve
PT. 52.98		S65 $\frac{1}{2}$ E	tang 60'
PT. 54.84		N.87E.	tang 75' <sup>end</sup> curve
PT. 58.25		S.65E.	TANG 100'
60			L.V. MC ENTER ASH SWALE
66			L.V. ASH SWALE ENTER MB
PT. 65.30		S77 $\frac{1}{2}$ E	TANG 100'
PT. 70.83		S13 $\frac{1}{2}$ E	TANG 150'
PT. 77.56		S34 $\frac{1}{2}$ E	TANG 100'
PT. 85.27		S1E	TANG 100'

at 72.73 white post  
approx 38.65 ch. W. to  
cor. sec. 27-26-34-35

STAKO	DIF. BEAR	REMARKS
PI 92.53	S 16° E	TANG 100'
93		L.V. Mb ENTER MC
PI 95.78	S 13° E.	TANG 75'
PI 101.99	S 1/2° E.	TANG 60'
98		L.V. Ac. begin cedars b-c
104.45		cedar culvert 20' x 3' x 4'
PI 107.95	S 37 1/4° E.	TANG 75' <sup>begin</sup> culvert
107.90		cedar culvert 2' x 4' x 20'
109.		L.V. cedars b-c enter MC.
PI 110.66	S 61 3/4° E.	TANG 60'
PI 113.70	S 85° E.	TANG 75' <sup>end</sup> curve
PI 121.12	S 61° E.	TANG 100'
124.85		cedar culvert 3' x 4' x 20'
PI 125.56	S 79° E.	TANG 100'
PI 129.76	S 71 1/2° E.	TANG 74'
133.75		cedar culvert 3' x 4' x 20'
PI 133.82	S 45 3/4° E.	TANG 75'
PI 136.88	S 34° E.	TANG 100'
PI 143.19	S 21° E.	TANG 75'
PI 146.65	S 17 1/2° E.	TANG 50'
144		L.V. MC enter Mb
PI 149.38	S 16 1/2° E.	TANG 60'
PI 153.26	S 4 W.	TANG 75'
PI 157.06	S 17 W.	TANG 60'
158		L.V. Mb enter MC.

STA. NO CHS	DIFF CHS	BEAR.	REMARKS
PT. 160.02		S 30 W.	TANG. 60'
PT. 164.79		S 6 1/2 W.	TANG. 75' <sup>begin</sup> curve
PT. 166.47		S 18 1/2 E.	TANG. 75' <sup>end</sup> curve
166.			L.V. MC. Begin <sup>bush</sup> kumtows.
172			L.V. burning begin M.C.
PT. 174.10		S 1 3/4 E.	TANG. 75'
PT. 176.75		S 10 1/2 W.	
177.61			cross term line between 59 + 60. 2.25 ch. E. to sec. cot 35-36-1-2. IRON pipe in ground.
PT. 183.40		S 1 3/4 W.	TANG. 75' <sup>begin</sup> curve
PT. 186.11		S 15 E.	TANG. 75' <sup>end</sup> curve
193.11			Cedar Culvert 3x4' x 20
PT. 202.22		S 33 1/2 E.	TANG. 75'
204.88			54.45 ch. S. to cot. sec. on 12-11-12. T. 59 N. P. 26 W.
PT. 205.77		S 37 1/2 E.	TANG. 45'
207			L.V. MC. begin Birch b
PT. 213.98		S 1 1/2 E.	TANG. 75' <sup>begin</sup> curve
PT. 216.85		S 1 1/4 W.	TANG. 75' <sup>end</sup> curve
PT. 222.39		S 1 1/2 W.	TANG. 50'
PT. 233.30			

TEST PIT IN CREEK BED.

#0 FROM ELEV 87 TO 75 - GRAVEL  
RAISE WATER TO ELEV 99.

#1 STRATUM OF GRAVEL AT ELEV 90  
BOTTOM OF WELL POINT AT ELEV 72.1

#2 BOTTOM OF WELL POINT  
AT ELEV 81.5.

#3 GROUND ELEV 95.7 (IN CREEK BED)  
BOTTOM OF WELL POINT E-67.0  
NO WATER AT EL 71.

#4 GROUND ELEV 100.2  
BOTTOM OF WELL POINT ELEV 68.2  
WATER FROM EL 97.2 TO 72.2

#5 Gnd. Elev. 101±  
Top of Gravel 95±  
Water & Quicksand (pumps hard) 86±

#6 Gnd. Elev. 98±  
Bottom of Well Point 85± Clay 86  
Gravel from 88 to 92

W

E

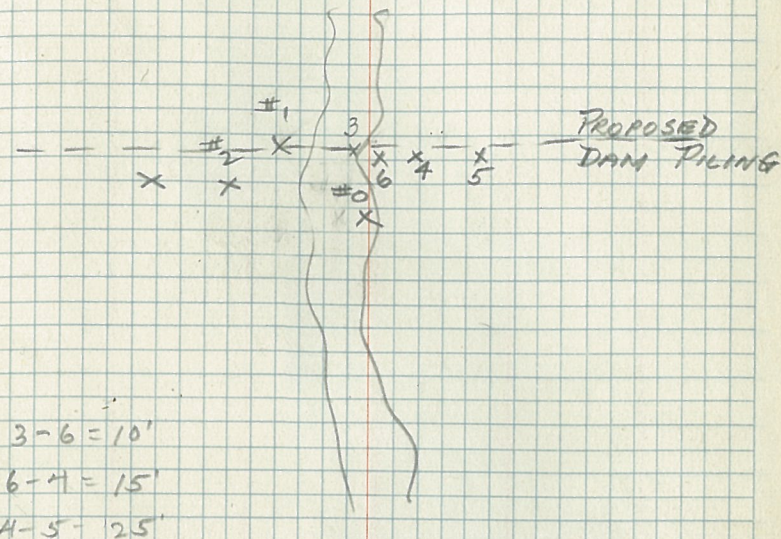

STA.	DIFF. DIST	BEARING	REMARKS
0		N 20 <sup>3</sup> / <sub>4</sub> W	1 TYPE
PI 8		N 46 <sup>1</sup> / <sub>4</sub> W	
PI 14		N 80 <sup>3</sup> / <sub>4</sub> W	
PI 17.17		S 52 <sup>1</sup> / <sub>2</sub> W	
PI 23.20		N 69° W	
PI 34.76		<del>N 44<sup>3</sup>/<sub>4</sub> W</del> N 4 <sup>1</sup> / <sub>2</sub> ° W	
PI 41.28		N 44 <sup>3</sup> / <sub>4</sub> W	
PI 51.70		N 23 <sup>1</sup> / <sub>2</sub> ° W	
PI 55.37		N 44 <sup>3</sup> / <sub>4</sub> W	
PI 59.74		N 6 <sup>3</sup> / <sub>4</sub> ° W	
PI 72.00		N 57° W	
PI 82.00		N 27 <sup>3</sup> / <sub>4</sub> ° W	
PI 86.51		S 69° W	
PI 102.00		N 89° W	
PI 106.47		N 44 <sup>1</sup> / <sub>4</sub> ° W	
PI 111.16		N 72 <sup>3</sup> / <sub>4</sub> ° W	
PI 114.53		N 64 <sup>1</sup> / <sub>4</sub> ° W	
116.48			76.24 CH. S. TO SEC. COR. SEC. 11-12 - 13 <sup>1</sup> / <sub>4</sub> 14 14825
PI 117.41		S 54° W	
PI 124.00		S 44 <sup>3</sup> / <sub>4</sub> ° W	
PI 126.00		S 56 <sup>1</sup> / <sub>2</sub> ° W	
131.72			END OF TRAVERSE AT PROPOSED BASS REARING POND NENE SEC. 11 T 148 N - R 25 W

EAST  
BIG TOO MUCH  
TRUCK TRAIL  
T 148 N R 25 W

MARCH 13, 1936  
MARCH 14, 1936

START SH. W. #6  
SEC. 12 - 148-25

ED. PANEK C.P.

MONTGOMERY T.

KURTZ H.C.  
SALING R.C.

EQUIPMENT

1 F.S. STAND, COMPASS

1 ARNEY LEVEL

3 HAND AXES

1 2 CHAIN TAPE

LUMBER ORAWN



STA.	DIFF DIST.	BEAR. ING	REMARKS
0		S86½°W	1 TYPE
3.64			62.33 Ch. S <sub>0</sub> TO E. ¼ <sup>1/6</sup> COR. SEC. 11-14
PI. 3.71	3.71	S42¾°W	58.54 Ch. WEST TO N ¼ <sup>1/6</sup> COR. OF SEC. 10 & 11.
6.25		S47½°E	46.70 Ch. TO E ¼ <sup>1/6</sup> COR. SEC. 11 & 14.
PI. 15.55		S47½°E	67.95 Ch. W. TO ¼ <sup>1/4</sup> COR. SEC. 10-11.
27.21		S31½°E	M TYPE
35.27		S22¾°E	
37.27		S51°E	
PT. 38.0		S24½°E	
PI. 43.19			67 LINKS S. OF S <sub>0</sub> ¼ <sup>1/6</sup> COR SEC. LINE BETWEEN SEC. 11 & 12
PI. 46.96		S60½°E	1 TYPE
PI. 52.58		S60½°E	
69.89		S54°E	
PI. 60.95		S66½°E	
PI. 66.90		S18¾°E	
PI. 69.97		S39½°E	
PI. 78.0			
PI. 81.33			
PI. 86.68			
94.0			END OF TRAVERSE CONNECTING TO COUNTY ROAD TRAVERSE ON SEC. LINE OF 12 & 13 81 FT. WEST OF MC. BIG TOO MOCH LAKE

WEST Big Too MARCH 18, 1936

MUCH T. T.

T 148 N. R. - 25 W PARTY

STARTED AT

PROPOSED PASS ED. PANEK C.P.

PEARING POND MONTGOMERY T

SITE SOUTH VAN BUSKIRK F.C.

T NENE VANCE R.C.

SEC. 11-148-25

EQUIPMENT

1 F.S. STANDARD

COMPASS-STAFF

1 2 CHAIN TAPE

3 HAND AXES

1 LUMBER CRAYON

1 ABNEY LEVEL

T.T. # 480-B.  
(Dec. used = 6°45')

Sta Remarks Course

26+26 1/4 Cor.

24+00 Trai. Lt.

N. 0°30'E 10 1/2 E.

18+00 P.I.

N. 2°00'E (N 1°40'E Solms)

0+00

J.A. Gelhaus  
Unvollst. Koenen chain 4/15/36.  
W.F. Fief

(S.A)

1/4 Cor. (S3)

A-b

A-b

End 70'

(4)

(3)

(9)

(10)

T.T. # 470  
See Post  
T. 147N. R. 25W.

Sta	Remarks	Course	Solar Bearing
-----	---------	--------	---------------

76+36	P.I. and 1/4 cor.		
-------	----------------------	--	--

(S 87° 45' W) S 86° 15' W

50+81	P.I. and sec. cor.		
-------	-----------------------	--	--

(N 1° 45' E) N 0° 30' E

38+00	Leaves swp		
-------	------------	--	--

36+00	Enter swp.		
-------	---------------	--	--

5=6

T. 147 N.

④

③③

T. 148 N.

Δ = 94.15'  
E = 70'  
R = 150'  
T = 163'

Sec. cor.

3/4" Iron Pipe

④

③

swp  
\*  
swp

Sta Remarks Course <sup>Solar Bearing</sup>

109+50 Enter SWP

N0°30'E N1°00'E

101+80 C 1/4 cor

100+50 Low draw

97+00 Leave 5-6

93+50 Trail

N2°00'E

76+36 Pl. and 1/4 cor

(N5°45'E) N1°00'E. N1°04'E

(Dec. 5°)

N89°15'W S.86°15'W.

2674

66 4745  
26 396  
2 490  
2 262

Place 24" cor.

post  
N P in 10" N82°48'W 4 1/2 FT = 67 1/2 LPI  
H 11 3" S50°30'E 4 1/2 FT C 1/4 cor.

Ka 7 1/2'

Place 24" cor.  
M-6

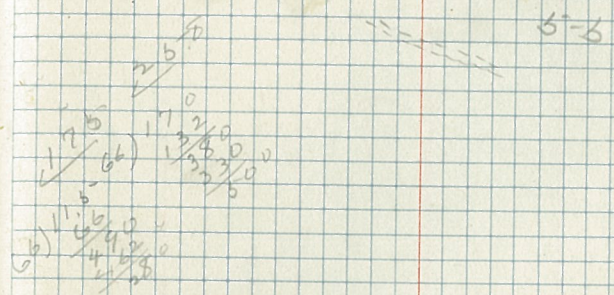

Solar Br. Val 30  
post. 11 1/2 25 3/4  
Pines 11 1/2 25 3/4  
post. 11 1/2 25 3/4

(33)

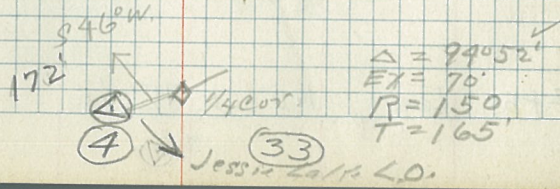

End of T.T. #480-B

Sta. Remarks Course

West,  
114+72 P.I. Lt. = Sta. 94+65 T.T. 480-Main.

112+50 Leave  $N0^{\circ}30'E. N1^{\circ}00'E.$   
SNP.

1/16 Cor.

T.T. #480 - Main,  
(Dec. used = 6°45')

Sta Remarks Course

21+80 Wooden  
Bridge  
16' long.

17+02 RR Gr.  
cut needed.

7+10 cutv. needed  
15"

S. 85° W.

0+00

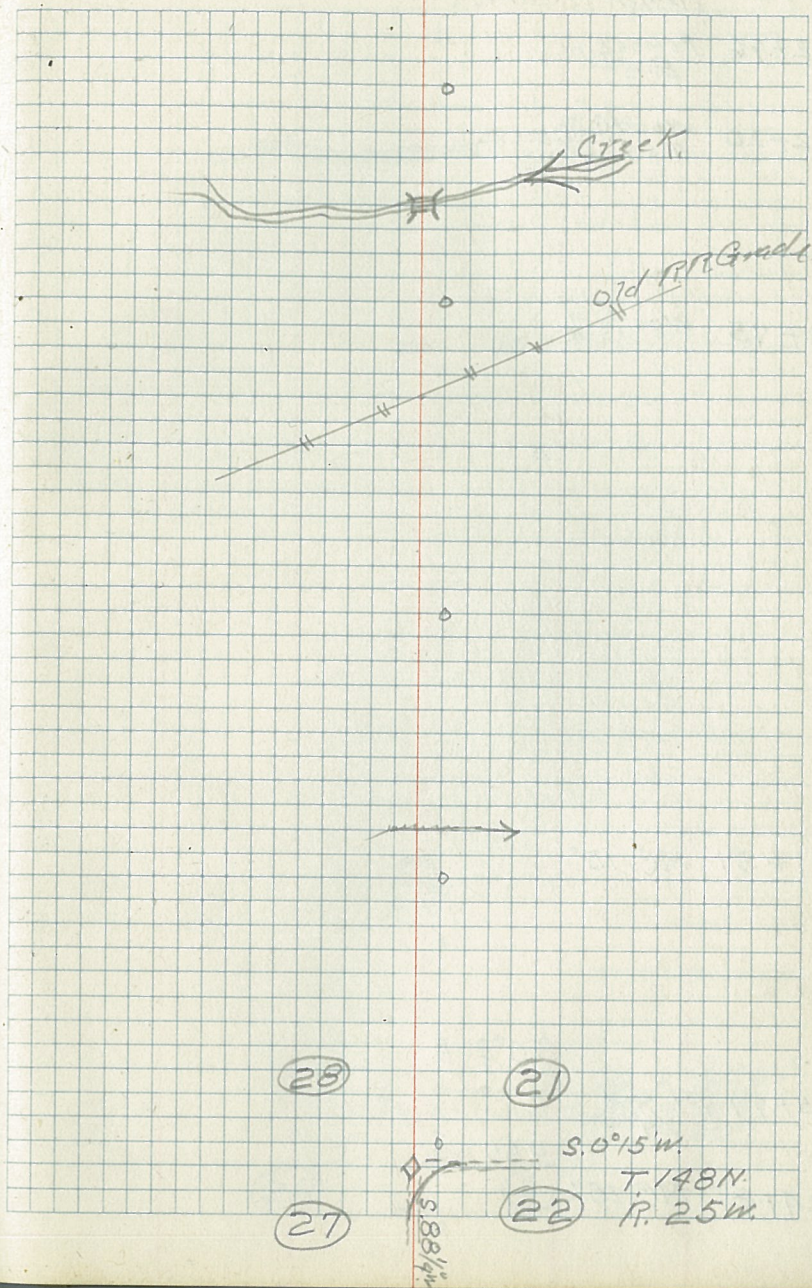

Sta Remarks Course

52+96 Fence Line East

52+20 woodcut 4'x4'

48+75 woodcut

31+51 MC-15"

S. 0° 30' E.

25+99 Pl. and 1/4 cor.

S 85° 00' W.

24+85 MC 15"

x  
x  
x  
x  
x  
x  
x  
x  
x  
x



□ Farm House

(28)

△ = 85° 30'  
EX = 15'  
PP = 30'

(28)

(21)

Sta Remarks Course

81+88 Trail  
East

S. 0° 45' W.

79+00 Pl and  
Trail Pt.

S. 0° 30' E.

67+93 Fence Line  
East

60+43 Cutv.  
Wood

S. 0° 30' E.

56+25 Road  
S.E.

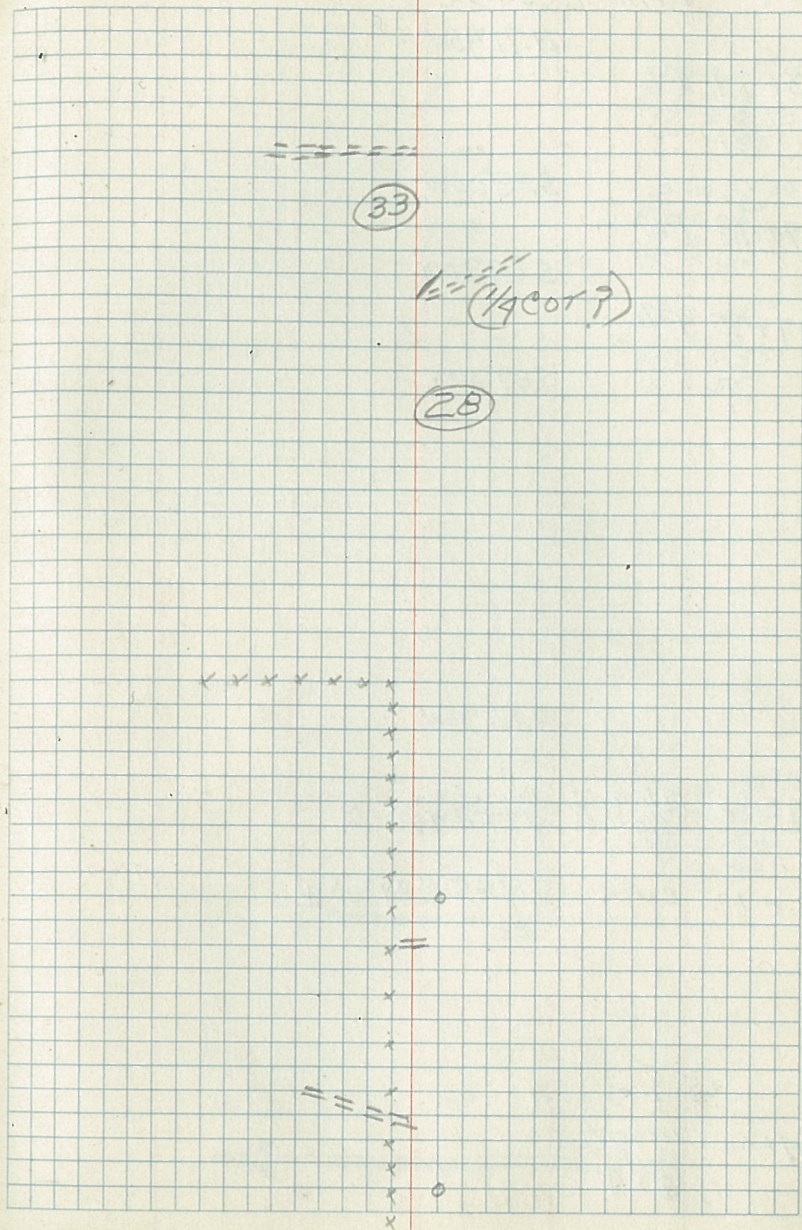



Sta	Remarks	Course	Solut Br
		N. 71° 45' W	
113+74	Pt.		
		S. 88° 00' W	
109+78	Pt.		
		S. 69° 30' W	
107+48	Pt.		
		S. 89° 30' W	
		S. 89° 30' W	
99+65	Pt. and 1/16 cor.	Junction of T.T.#480-B.	
93+10	cut V.	S. 0° 45' W. S. 1° 00' W.	
89+00	Wood cut V. 3x4'		

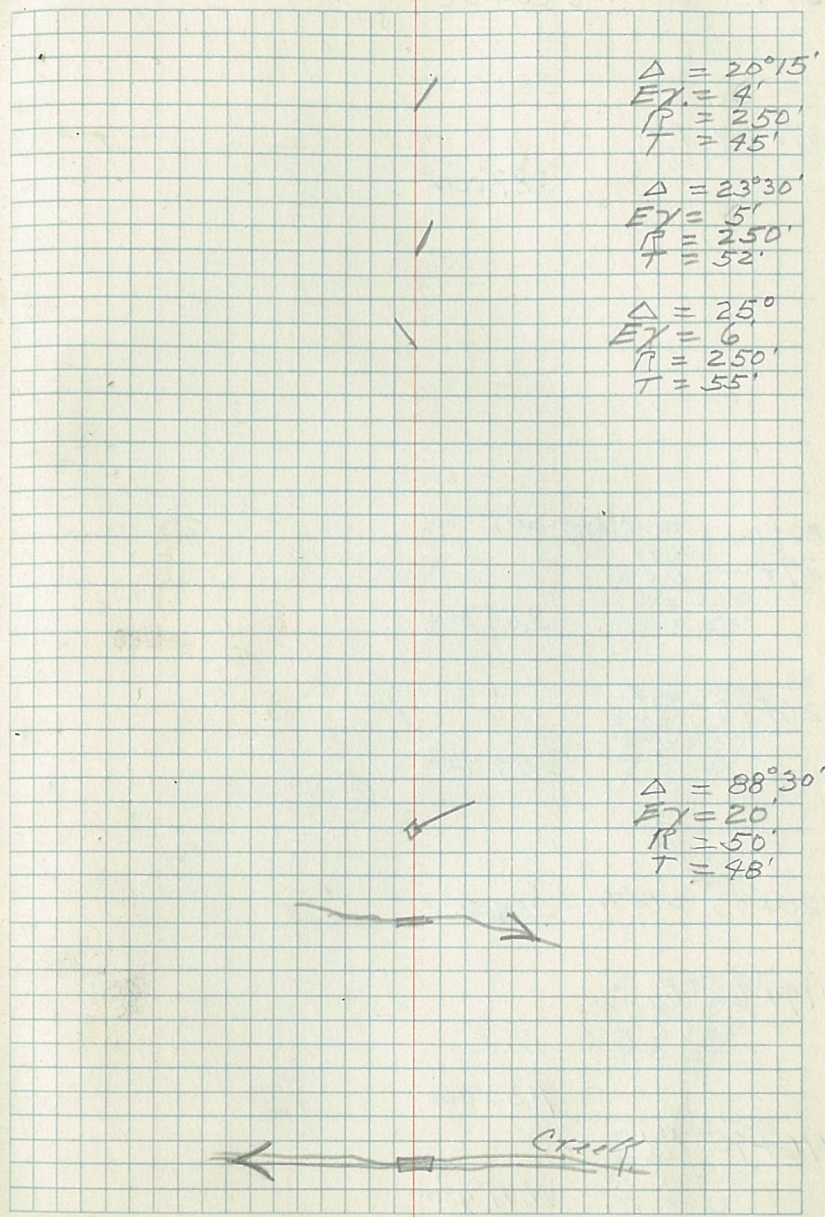

Sta.	Remarks	Course
		S88°00'W
137+27	P.I.	S87°00'W
(129+10 = Tr. Pt. #40)		S87°00'W
129+00	P.I.	S59°30'W
126+75	P.I.	S89°45'W
120+93	old trail	S84°45'W
119+63	P.I.	
		N.50°00'W
116+95	P.I.	N.71°45'W

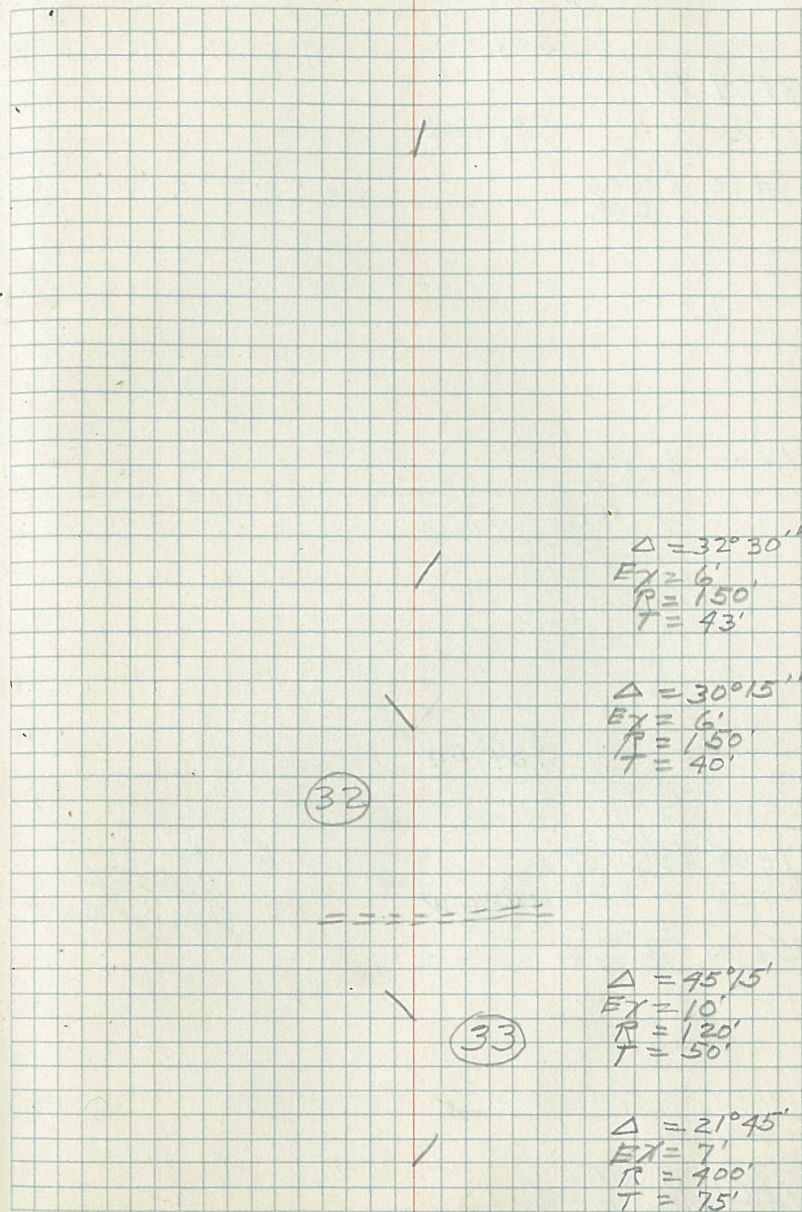

Sta	Remarks	Course	
		S. 84° 30' W.	
163+57	Pl.	S. 89° 15' W.	
162+10	Fence S.W.		
156+00	Leave Swp.		
		S. 89° 15' W.	
147+00	Pl. Fence North	S. 88° 00' W.	Enter Swp. Shallow Drain East.
145+65	Farm Road Rt		
139+61	Wood cut.		

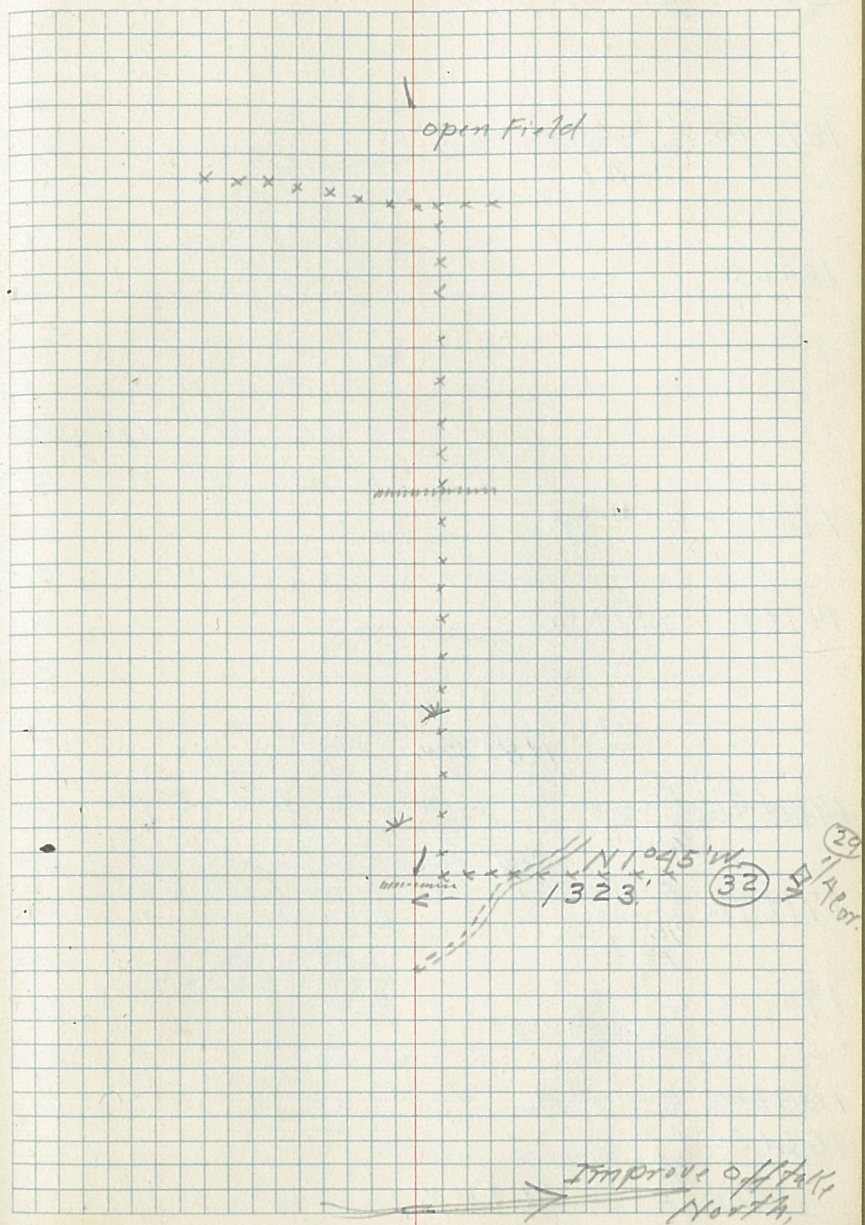

Sta Remarks Course

187+15 Low drain  
Place  
cut 1/15'

189+50 Leave  
swp.

178+50 Enterswp.

177+50 Trail N<sup>o</sup> 8.

N. 83° 30' W.

172+41 Pl. on  
1/16 line

Leave swp.

S 84° 30' W.

171+72 See Line  
1/16 cor  
14' South

170+00 Enter  
Road clearing  
again

168+00 Enterswp.

166+80 Leave  
open field.

S 84° 30' W.

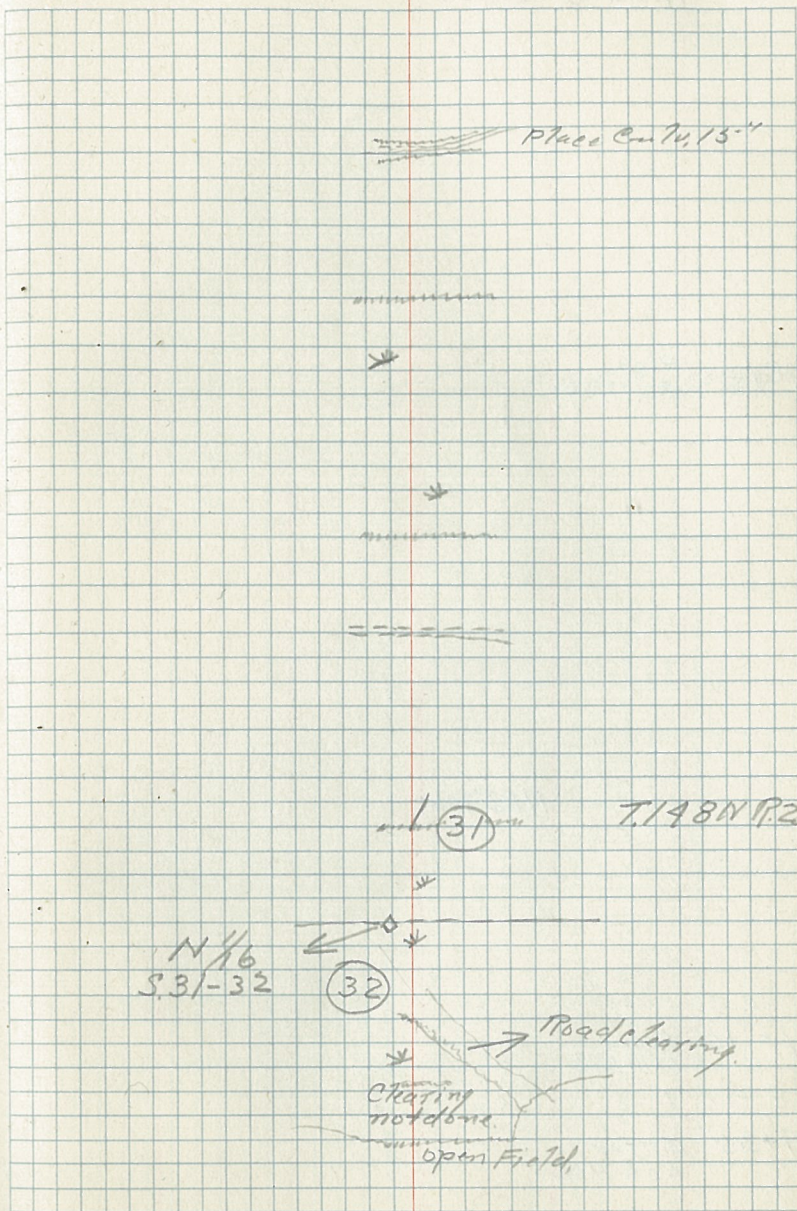

Sta Remarks Course

208+00 Place  
Cut 24"

NB3°30'W

191+10 Leave  
Low Hole

189+35 Enter  
Low Hole

~~Place Cut 24"~~ Place Cut 24"



Sta Remarks Course

240+34

237+50 Leave  
swp.

233+53 Enter  
swp.

230+82 Pl. and  
1/6 cot.

N89°00'W

N.83°30'W

Enter open  
field

222+00 Leave  
swp.

218+00 Enter  
swp.

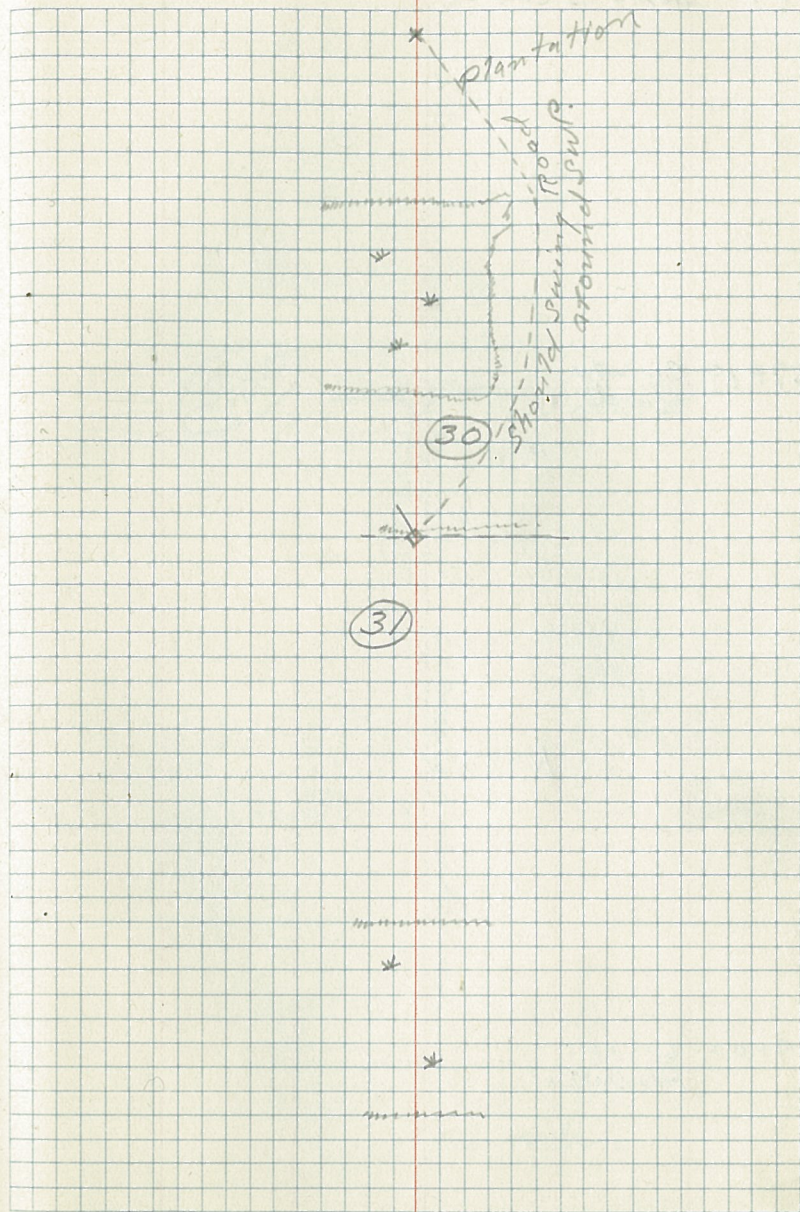

End T.F. #480  
(Dec. used = 6°45')

Sta Remarks Course

257+19 County  
Road.

N89°00'W

299+00 Leave  
Plantation

J.A. Goltz      †  
Bob Goltz      Chain  
Red Williams    "

4/17/36

(S.30)

1/4 Line  
N. 0° 15' E

County Road

Plantation.

T.T.#602

Sta	Remarks	Course
		N86°30'E
50+30	P.I.	
		S75°45'E ✓
37+70	Ord. end	2' x 1'
33+89	Road	
		S45°48'E ✓
26+26	P.I.	
		N89°45'E ✓
21+48	P.I.	
		S68°45'E ✓
19+89	P.I.	
		S47°15'E ✓
6+18	P.I.	
		S6°30'E ✓
2+74	P.I.	
0+00		N89°00'E ✓

J.A. Gielhang  
Fiefe  
RushChain  
" "

4/24/36

$$\Delta = 47^{\circ}45'$$

$$Ex = 33'$$

~~off talk~~  
Std. Road.

$$\Delta = 44^{\circ}30'$$

$$Ex = 31'$$

$$\Delta = 21^{\circ}30'$$

$$Ex = 6'$$

$$\Delta = 21^{\circ}30'$$

$$Ex = 6'$$

$$\Delta = 40^{\circ}45'$$

$$Ex = 29'$$

$$\Delta = 84^{\circ}30'$$

$$Ex = 20'$$

T.T.#600  
N1°00'W.

(16)

1/4 cor.

(21)

T.GON. P. 26W.



Sta Remarks Course

109+86 (1/4 Lin) See Line.  
N48°30'E

1455±15 N to  
(@ 1/4 Sta 27)  
see Cot.

106+46 P.I.

S41°15'E

94+83 P.I.

(S28° E) S29°00'E

91+25 see Line.

122' W to E. // S 22-27

(S28°30'E)

(S30°00'E) S29°00'E

65+24 P.I.

64+65 1/4 Line.

(N87°00'E) N86°30'

1/4 Line W. post.

57+23

cut V. Cedar. 2' x 1'

52+18 cut

Cedar cut V. 3' x 2'

$\Delta = 90^{\circ}15'$   
 $Ey = 108'$

$\Delta = 12^{\circ}15'$   
 $Ey = 8'$

$\Delta = 64^{\circ}30'$   
 $Ey = 51'$

325'  
491±15  
N to C. 1/4  
(S22)

Sta.	Remarks	Course	Remarks
150+10	See Line		39' N to Post = 2615 C.A.S. N 70 1/2 W 5 23-26
148+11	cut W.		Cedar on N. 4' x 2'
		S 32° E	
145+00	P.I.		
		S 51° E	
140+87	P.I.		
		S 28° E	
139+57	P.I.		
		S 5° 00' W	
135+61	P.I.		
		S 16° 30' E	
133+58	P.I.		
		S 58° E	
128+38	P.I.		
		(N 75° E) N 76° 00' E	
		(N 78° E) N 76° 00' E	
118+45	P.I.		
		N 30° E ✓	
115+92	P.I.		
		N 92° E ✓	
110+50	P.I.		
		N 98° 30' E ✓	

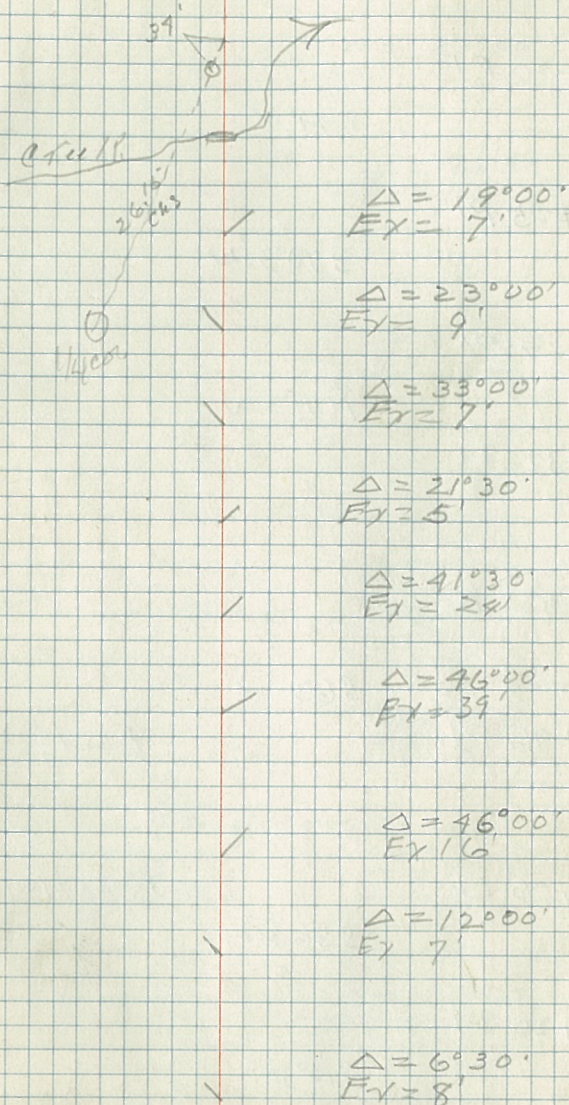

Sta.	Remarks	Course	Remarks
		S 17° W	
180+00	P.I.		
		S 44° W	
174+05	P.I.		
		S 70° 30' W	
172+95	P.I.		
		N 71° 30' W	
169+37	P.I.		
166+46	Bridge		
		S 63° W ✓	
163+96	P.I.		End of Curve.
		S 53° 30' W ✓	
160+06	P.I.		Junction on G.O.L.
		S 56° 30' E ✓	
156+20	P.I.		
		S 10° 30' E ✓	
150+21	P.I.		
		S 32° E ✓	

$$\Delta = 27^{\circ}00'$$

$$EY = 12'$$

$$\Delta = 26^{\circ}30'$$

$$EY = 13'$$

$$\Delta = 38^{\circ}00'$$

$$EY = 12'$$

$$\Delta = 8^{\circ}30'$$

$$EY = 16'$$



$$\Delta = 9^{\circ}30'$$

$$EY = 3'$$

$$\Delta = 110^{\circ}00'$$

$$EY = 16'$$

$$\Delta = 46^{\circ}00'$$

$$EY = 27'$$

$$\Delta = 21^{\circ}30'$$

$$EY = 10'$$

T.T#602

Sta.	Remarks	Course	Remarks
208+62	W. Post Lt		Approx. 38.65 chs W. to 2726 3935 T60 R26
		S 13° E	
206+72	PI		
		S 78° 30' E	
203+36	PI		
203+00	Leave		Asht sup
200+30	Enter	S 65° E	Asht sup
198+78	PI		
		N 86° E	
196+50	PI		
196+00	Leave	S 76° E	Fill sec.
195+58	PI		
		S 43° E	
193+73	PI		
190+20	Enter		Fill sec.
		S 2° 00' E	
187+87	PI		
		S 45° 30' E	
184+45	PI		and Junct 601-B.
		S 17° W	

