

FIELD BOOK
T. 147 N. R. 25 W.

DUNZON
IN TRADE MARK

MINING
TRANSIT BOOK
No. 422F

ccc 28

EUGENE DIETZGEN CO.

DRAWING MATERIALS, MATHEMATICAL and SURVEYING INSTRUMENTS
Chicago New York San Francisco New Orleans Pittsburg Toronto

DISTANCES FROM CENTER OF ROADWAY FOR CROSS-SECTIONING.

Roadway 16 feet wide. Side Slopes 1 on 1.

For Single Track Embankment.

H	0	.1	.2	.3	.4	.5	.6	.7	.8	.9	H
0	8.0	8.1	8.2	8.3	8.4	8.5	8.6	8.7	8.8	8.9	0
1	9.0	9.1	9.2	9.3	9.4	9.5	9.6	9.7	9.8	9.9	1
2	10.0	10.1	10.2	10.3	10.4	10.5	10.6	10.7	10.8	10.9	2
3	11.0	11.1	11.2	11.3	11.4	11.5	11.6	11.7	11.8	11.9	3
4	12.0	12.1	12.2	12.3	12.4	12.5	12.6	12.7	12.8	12.9	4
5	13.0	13.1	13.2	13.3	13.4	13.5	13.6	13.7	13.8	13.9	5
6	14.0	14.1	14.2	14.3	14.4	14.5	14.6	14.7	14.8	14.9	6
7	15.0	15.1	15.2	15.3	15.4	15.5	15.6	15.7	15.8	15.9	7
8	16.0	16.1	16.2	16.3	16.4	16.5	16.6	16.7	16.8	16.9	8
9	17.0	17.1	17.2	17.3	17.4	17.5	17.6	17.7	17.8	17.9	9
10	18.0	18.1	18.2	18.3	18.4	18.5	18.6	18.7	18.8	18.9	10
11	19.0	19.1	19.2	19.3	19.4	19.5	19.6	19.7	19.8	19.9	11
12	20.0	20.1	20.2	20.3	20.4	20.5	20.6	20.7	20.8	20.9	12
13	21.0	21.1	21.2	21.3	21.4	21.5	21.6	21.7	21.8	21.9	13
14	22.0	22.1	22.2	22.3	22.4	22.5	22.6	22.7	22.8	22.9	14
15	23.0	23.1	23.2	23.3	23.4	23.5	23.6	23.7	23.8	23.9	15
16	24.0	24.1	24.2	24.3	24.4	24.5	24.6	24.7	24.8	24.9	16
17	25.0	25.1	25.2	25.3	25.4	25.5	25.6	25.7	25.8	25.9	17
18	26.0	26.1	26.2	26.3	26.4	26.5	26.6	26.7	26.8	26.9	18
19	27.0	27.1	27.2	27.3	27.4	27.5	27.6	27.7	27.8	27.9	19
20	28.0	28.1	28.2	28.3	28.4	28.5	28.6	28.7	28.8	28.9	20
21	29.0	29.1	29.2	29.3	29.4	29.5	29.6	29.7	29.8	29.9	21
22	30.0	30.1	30.2	30.3	30.4	30.5	30.6	30.7	30.8	30.9	22
23	31.0	31.1	31.2	31.3	31.4	31.5	31.6	31.7	31.8	31.9	23
24	32.0	32.1	32.2	32.3	32.4	32.5	32.6	32.7	32.8	32.9	24
25	33.0	33.1	33.2	33.3	33.4	33.5	33.6	33.7	33.8	33.9	25
26	34.0	34.1	34.2	34.3	34.4	34.5	34.6	34.7	34.8	34.9	26
27	35.0	35.1	35.2	35.3	35.4	35.5	35.6	35.7	35.8	35.9	27
28	36.0	36.1	36.2	36.3	36.4	36.5	36.6	36.7	36.8	36.9	28
29	37.0	37.1	37.2	37.3	37.4	37.5	37.6	37.7	37.8	37.9	29
30	38.0	38.1	38.2	38.3	38.4	38.5	38.6	38.7	38.8	38.9	30
31	39.0	39.1	39.2	39.3	39.4	39.5	39.6	39.7	39.8	39.9	31
32	40.0	40.1	40.2	40.3	40.4	40.5	40.6	40.7	40.8	40.9	32
33	41.0	41.1	41.2	41.3	41.4	41.5	41.6	41.7	41.8	41.9	33
34	42.0	42.1	42.2	42.3	42.4	42.5	42.6	42.7	42.8	42.9	34
35	43.0	43.1	43.2	43.3	43.4	43.5	43.6	43.7	43.8	43.9	35
36	44.0	44.1	44.2	44.3	44.4	44.5	44.6	44.7	44.8	44.9	36
37	45.0	45.1	45.2	45.3	45.4	45.5	45.6	45.7	45.8	45.9	37
38	46.0	46.1	46.2	46.3	46.4	46.5	46.6	46.7	46.8	46.9	38
39	47.0	47.1	47.2	47.3	47.4	47.5	47.6	47.7	47.8	47.9	39
40	48.0	48.1	48.2	48.3	48.4	48.5	48.6	48.7	48.8	48.9	40

Example—If point is 22.6 ft. above grade, how far should it be from center line to be a slope stake point? Ans. from Table 30.6. For same slopes but other widths of roadbed, correct above figures by one-half difference in width of roadbed; thus in example above, for 20 ft. roadbed distance will be $30.6 + (20 - 16) \div 2$ or 2 ft. added to $30.6 = 32.6$. For slopes of 1 on 1½ see inside of back cover.

Copyright, 1914, by Eugene Dietzgen Co.

147-25
Scanned
8-20-12
Ranney

Township	Range	Sec	Mer	Page
T147N	R25W	1	5	3
		2		5
		3		6
		4		7
		5		8
		6		9
		7		10
		8		11
		9		4
		10		12
		11		13
		12		14
		13		15
		14		16
		15		17
		16		18
		17		19
		18		20
		19		21
		20		22
		21		23
		22		24
		23		25
		24		26
		25		27

Township	Range	Sec	MER	Page
T147N	R25W	26	5	28
		27		29
		28		30
		29		31
		30		32
		31		33
		32		34
		33		35
		34		36
		35		37
		36		38

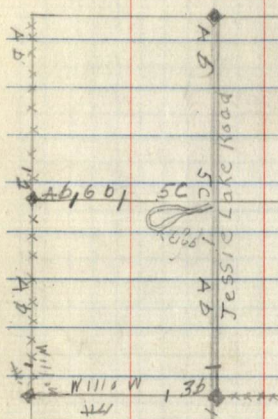

Sept. 19. 1935 Mcagher
 Sec 1 T147N R25W S44 Mer

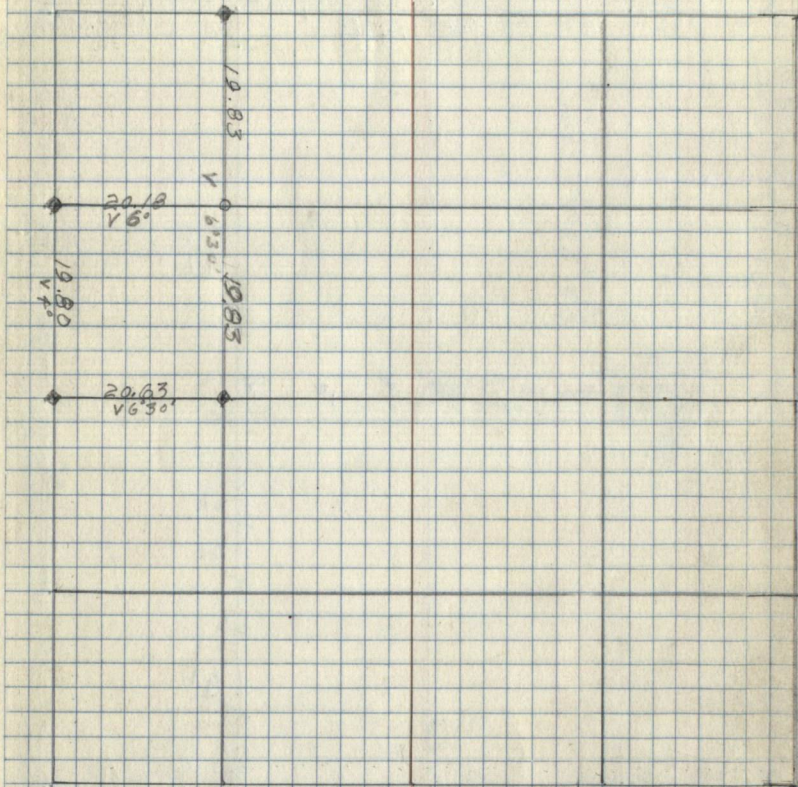

- Cor. Bearing tree
 211 spec B&H Bears Dist.
 Y4 Ash post 4" 30" high
 B. Spr 8" N33E 11 L.
 N116 cedar post 4" 3" high
 2-1 W.P. 40" S80E 20 L.

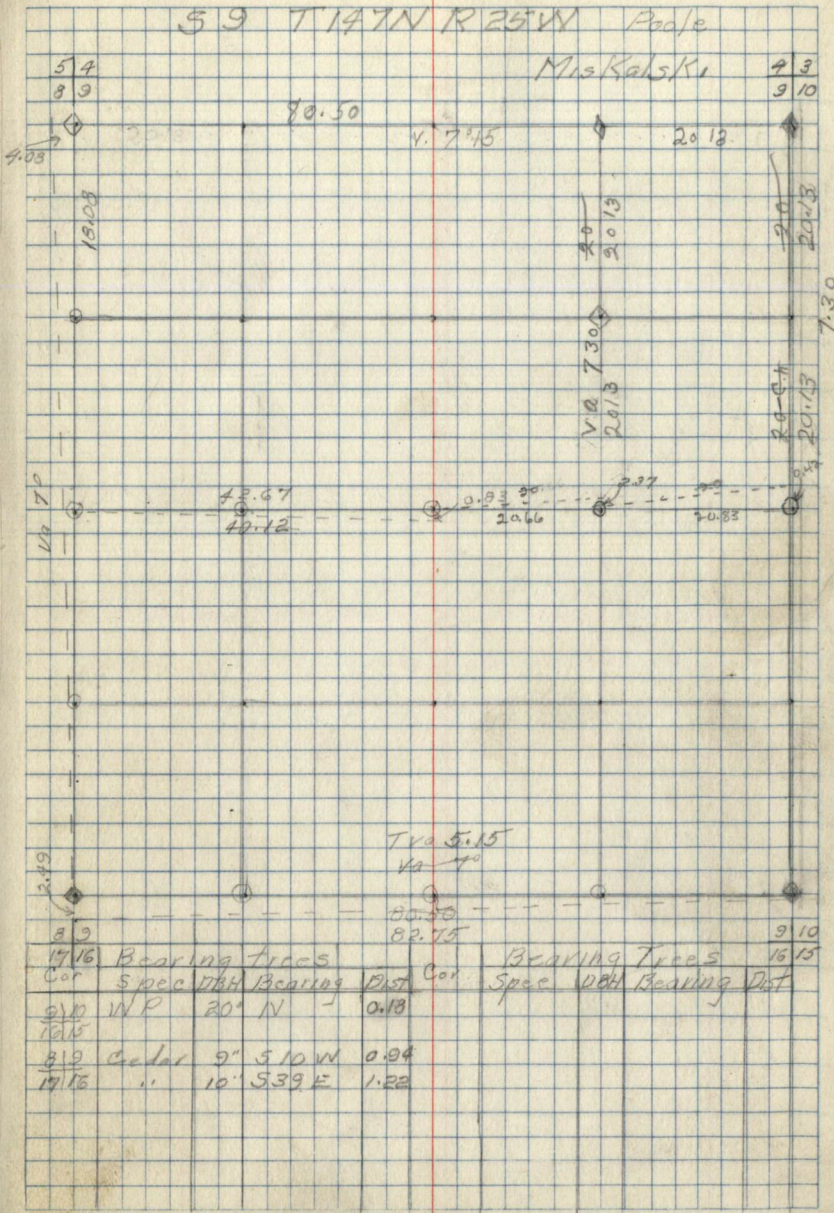
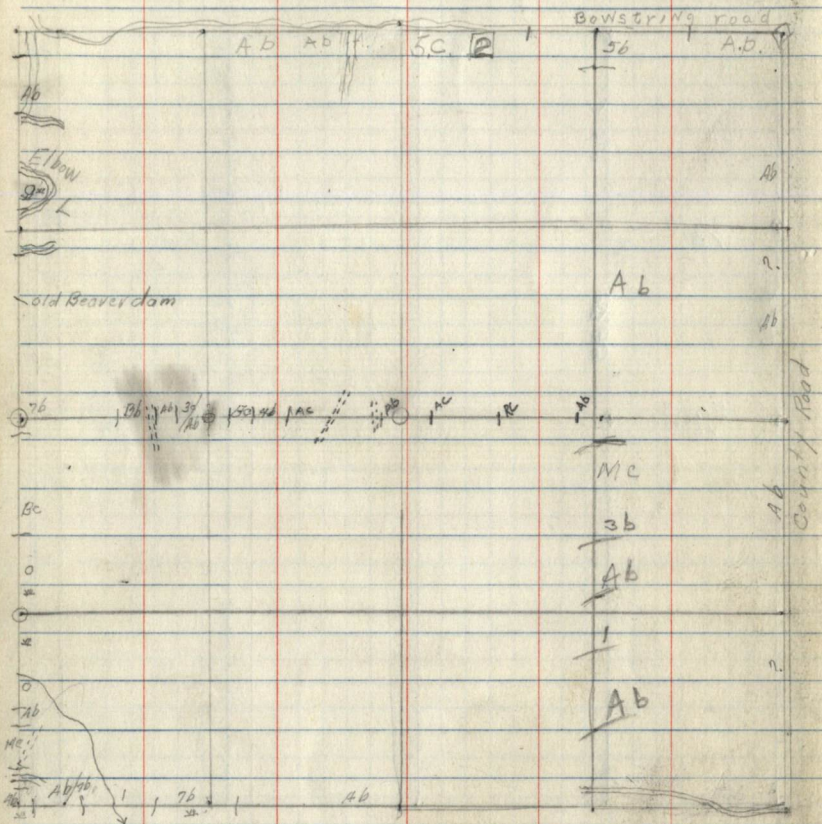

Sec 2

18.70

Sec 9 T19N R25W

33 34
4 3

34 35
3 2

12.95
VA 1
EO

4 3
9 10

3 2
10 11

Cor	Bearing	Trees	Cor	Bearing	Trees
	Spec	Dist		Spec	Dist

Sec 7

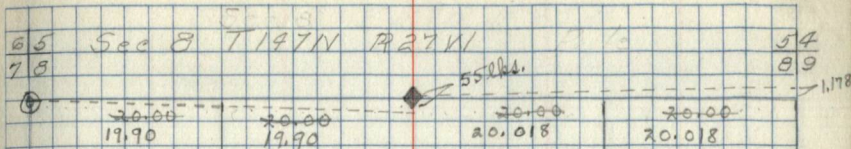

elbow L

old beaver
dam

76

"

30

"

0

10

18

76

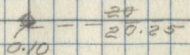

V 6.00°

78
131789
1716

No	Bearing Trees				Cor	Bearing Trees			
	Spec	DBH	Bearing	Dist		Spec	DBH	Bearing	Dist
5	Cedar	6"	N 6° E	5 1/2					
8	Tam	14"	S 24° W	22 1/2					

Remarks.

6/5
7/8 county B.T.'s there. Get notes from county.

Sec 10 T147N R25W

9/3
9/103/2
10/11

10/2/10

9/10
10/1510/11
15/14

Cor	Bearing	Trees	Spec	Dist	Bearing	Dist	Cor	Bearing	Trees	Spec	Dist	Bearing	Dist

County Road

16

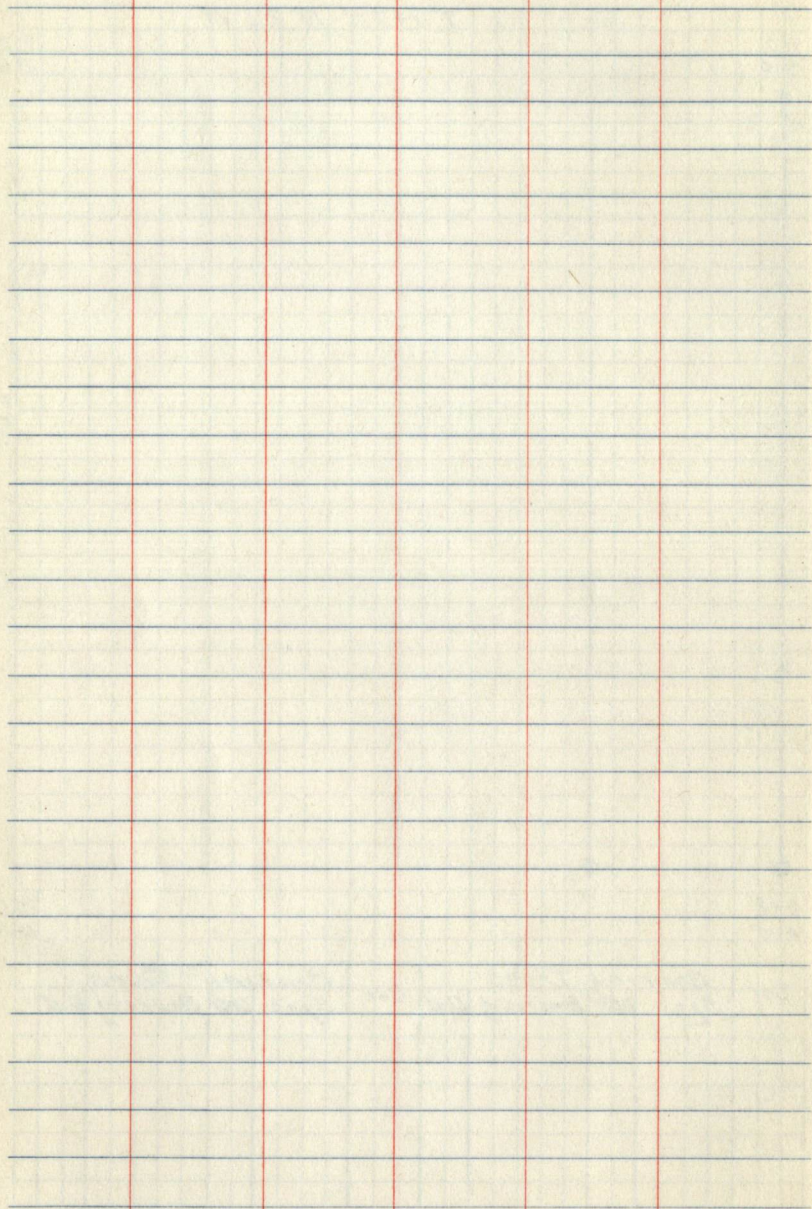
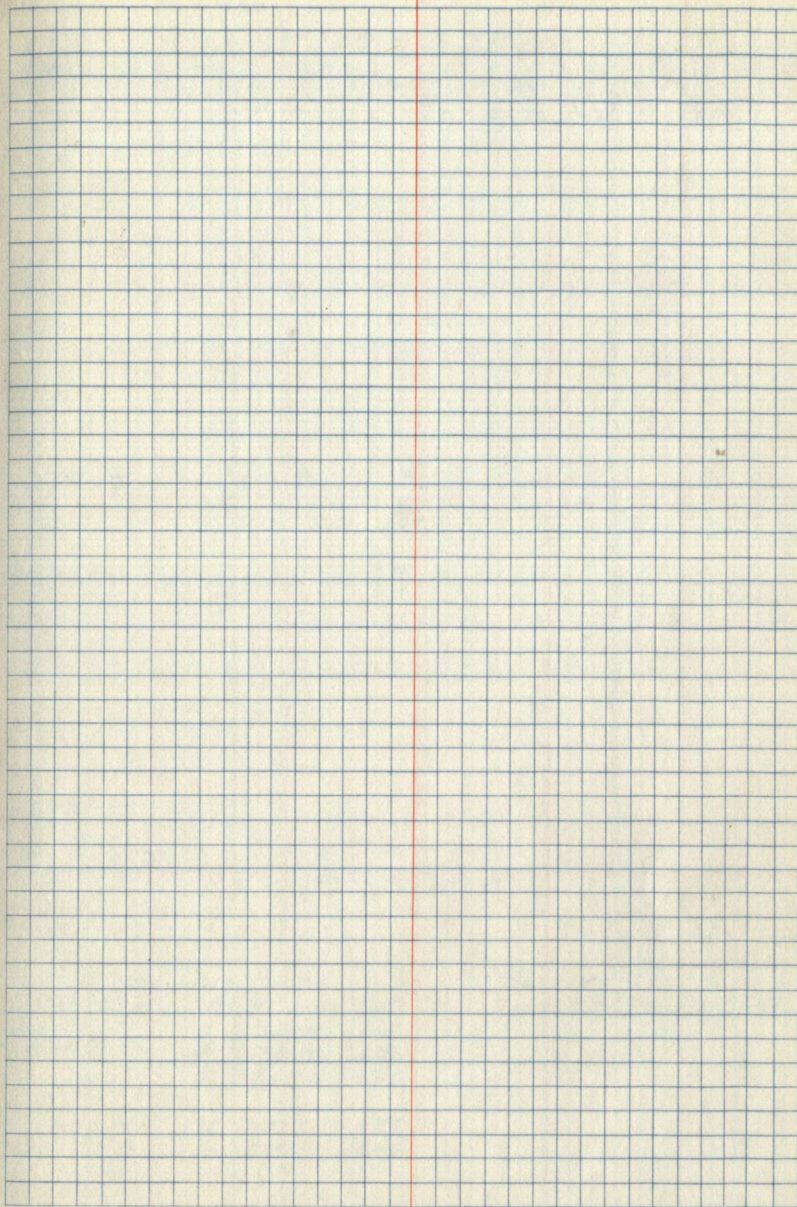

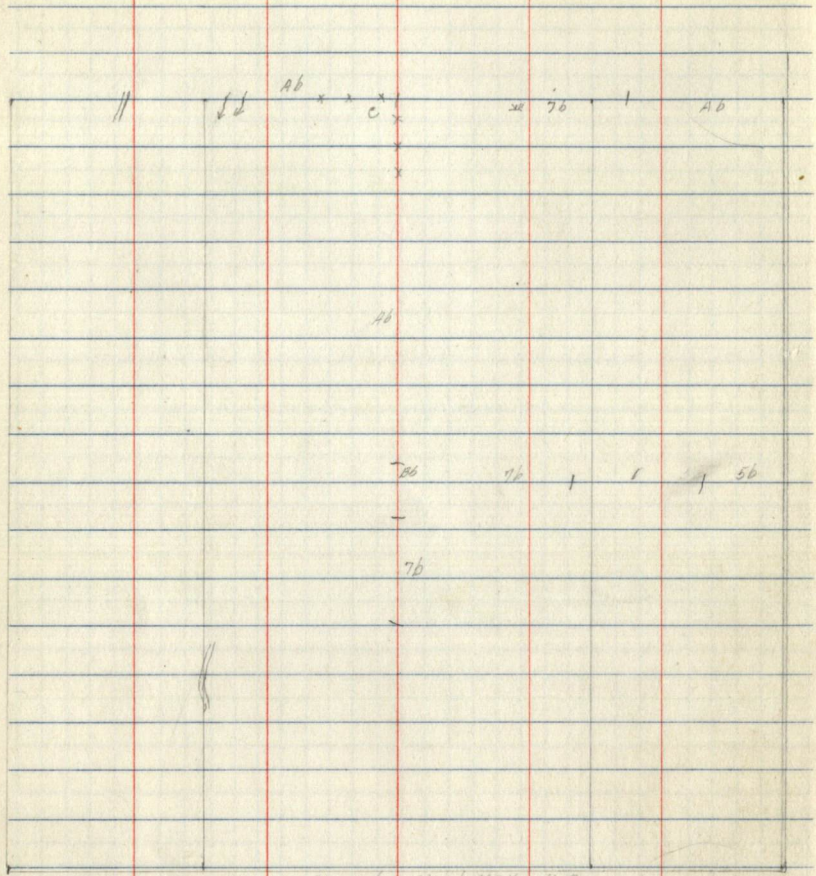

County Highway #6

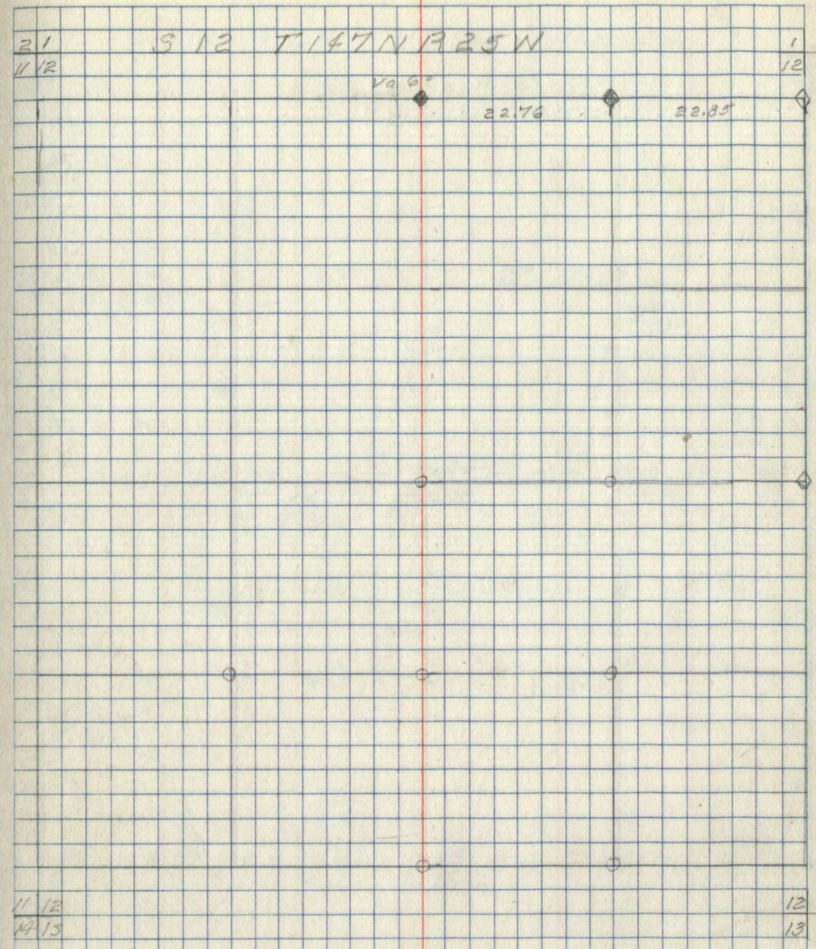

Bearing Trees				Bearing Trees					
Cor	Spec	Dist	Bearing	Dist	Cor	Spec	Dist	Bearing	Dist
EX 1		8	90°W	0.16					
11/12		4	N 10°W	0.50					
		7	S 65°W	1.52					
1									
12	WD	12	N 50°E	1.27					
	B		S 30°E	0.99					

Pages 016-023
are blank

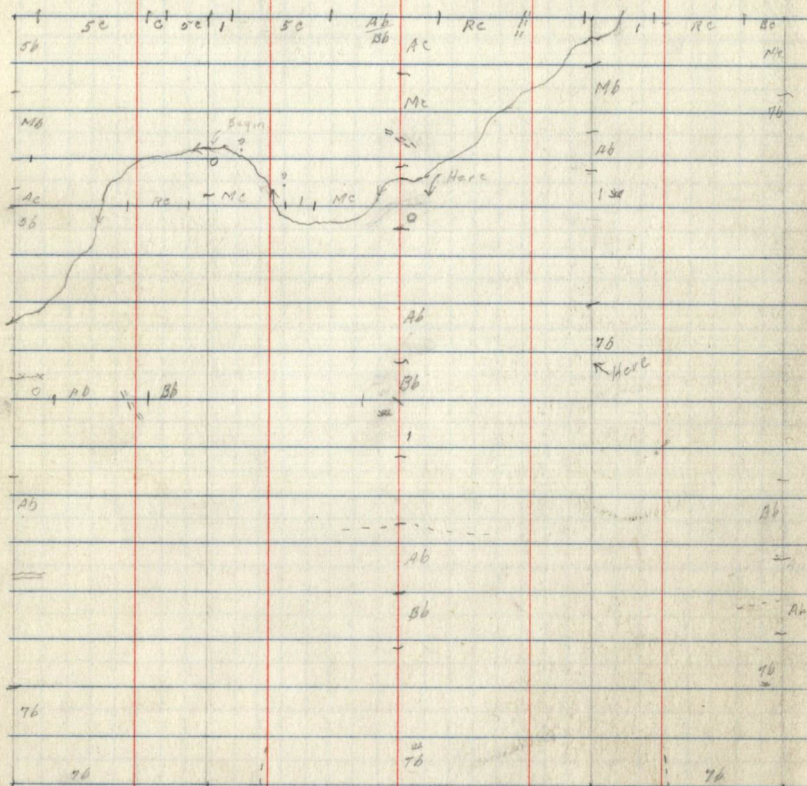

S 24 T 197 N R 25 W

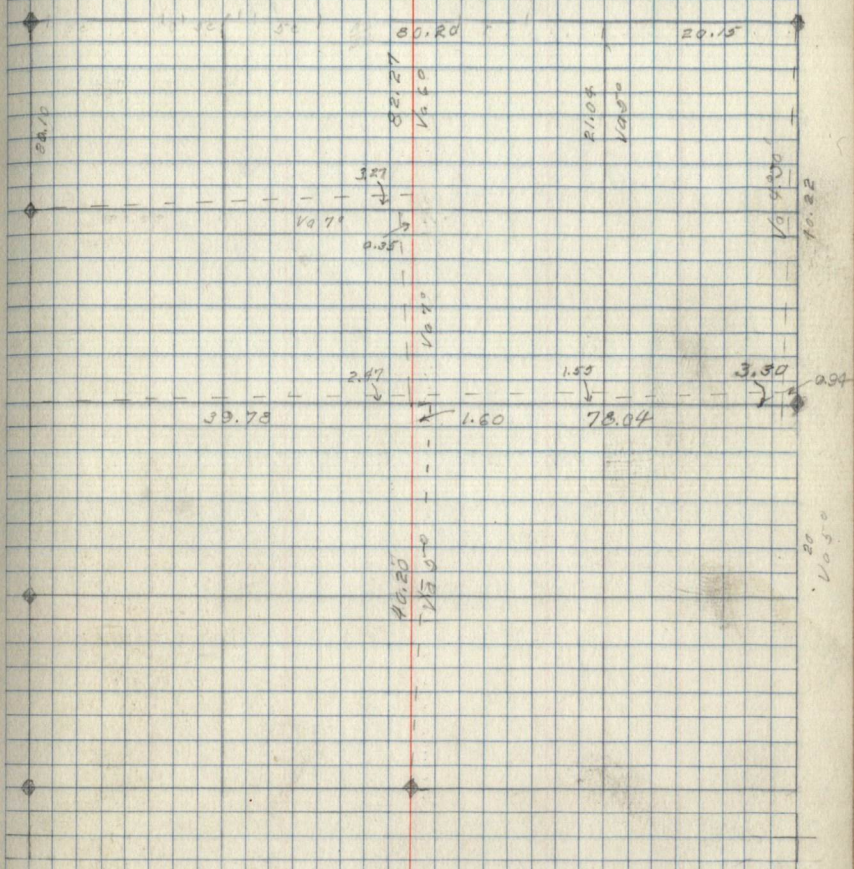

Cor	Spec	Bearing	Tree's	Dist
4/23/24	Oak	13° N 50° E		6.05
5/21/24	Oak	12° S 50° E		0.59
7/6	Ash	10° N 10° E		1.01
23/24	Spruce	8° S 10° E		1.81
26/25	"	8° S 55° W		1.28

Pages 025-End
are Blank