

U. S. Department of Agriculture

FOREST SERVICE

Chippewa NATIONAL FOREST

CORNERS OF THE PUBLIC SURVEY

T. 150 R. 28 S Mer. Sec. Corner common to Sections

13, 14, 23, and 24

Corner consists of a _____ (not) in place

State condition _____

Dimensions above ground _____ inches

Sketch grooves, letters, figures, or notches, on proper face or edge.

CARDINAL POSITION

DIAGONAL POSITION

--	--	--	--

N W S E

--	--	--	--

NW SW SE NE

Mound of _____ is located _____

Pits are located _____

Sketch markings of Bearing Trees (or Rocks) in proper box and fill blanks below, giving bearings from Corner to Trees and Distances in Links.

			N T 150 R 28 W
			B.T.

Species _____ Birch

Diameter _____ 8"

Bearing _____

Distance _____ 20 Paces

Do you believe this to be a genuine Land Office Corner? No.

If not, why? Resurveyed.

John Kirkald.

(Signature)

12-29-33.

(Date)

Estimator

(Title)

Metal Location Poster is on a tree inches diameter, on the side of from which this Corner bears chains distant. Give any further facts which will aid in finding this Corner again.

Elm Tree West of B.T.

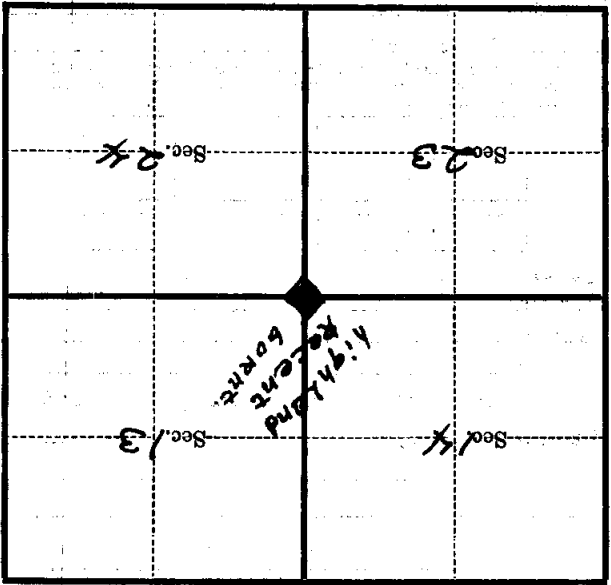

(Make sketch of topography near Corner)

T. 150 R. 28 Mer. 5

N21

posted

13 4, 23, 24

150

28

5 PM

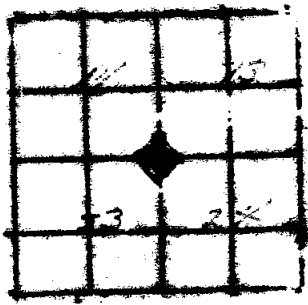

Aspen

40

2"

stone

Birch

16"

N 1° E

95 2 1/2

Aspen 5° N 19 W 45

2-7-34

W. H. Jones

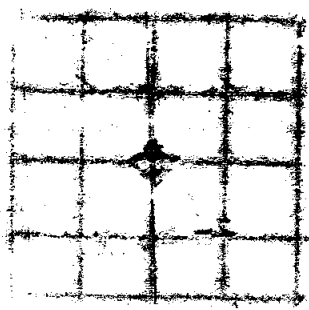

[Heavily obscured and illegible text, possibly bleed-through from the reverse side of the page.]

[Extremely faint and illegible text, possibly bleed-through from the reverse side of the page, arranged in several horizontal lines.]