

U. S. Department of Agriculture

FOREST SERVICE

K21
posted

Chippewa NATIONAL FOREST

CORNERS OF THE PUBLIC SURVEY

T. 150 N R. 27 W 5 Mer.

N-1/16 Corner common to Sections

14, and 13

Corner consists of a POST (not) in place

State condition good

Dimensions above ground 30 inches

Sketch grooves, letters, figures, or notches, on proper face or edge.

CARDINAL POSITION

DIAGONAL POSITION

--	--	--	--

N W S E

--	--	--	--

NW SW SE NE

Mound of _____ is located _____

_____ Pits are located _____

Sketch markings of Bearing Trees (or Rocks) in proper box and fill blanks below, giving bearings from Corner to Trees and Distances in Links.

Species _____

Diameter _____

Bearing _____

Distance _____

Do you believe this to be a genuine Land Office Corner? _____

If not, why? _____

Edward W. Johnson

(Signature)

Jan-10-1934

(Date)

Secretary

(Title)

K-21

Corner again.
This probably belongs
IN Road
M. R. 1st of 1st 49 1/2 W. E.
CONT Road 310 1/2 S. WEST

Give any further facts which will aid in finding this

55 1/2 W. chain-distant.

from which this corner bears
side of Road
Post
tree 7 inches diameter, on the East
Metal Location Poster is on a Tol. Pole

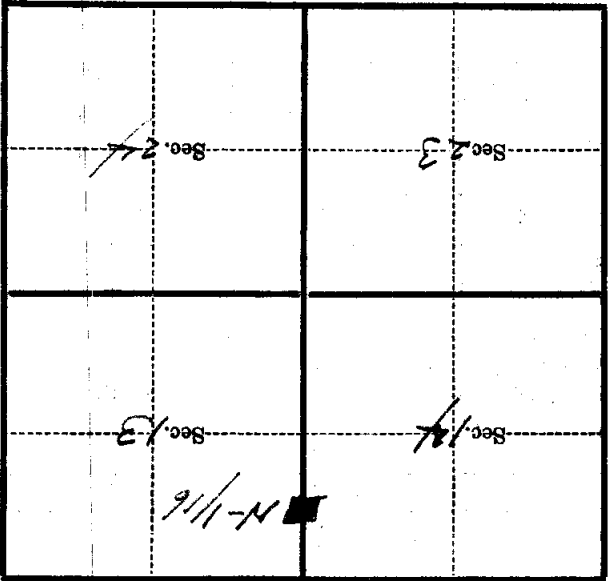

(Make sketch of topography near Corner)

T. 150 N R. 37 W 5 Mer. R-21