

U. S. Department of Agriculture

FOREST SERVICE

9

Chippewa NATIONAL FOREST J-17

CORNERS OF THE PUBLIC SURVEY

T. 150 R. 22 S. P. Mer. Sec. Corner common to Sections 10, 11, 14, and 15

Corner consists of a (not) in place State condition No Post.

Dimensions above ground inches

Sketch grooves, letters, figures, or notches, on proper face or edge.

CARDINAL POSITION

DIAGONAL POSITION

Diagram showing cardinal positions N, W, S, E.

Diagram showing diagonal positions NW, SW, SE, NE.

Mound of is located

Pits are located

Sketch markings of Bearing Trees (or Rocks) in proper box and fill blanks below, giving bearings from Corner to Trees and Distances in Links.

Grid for sketching bearing trees and rocks.

Species

Diameter

Bearing

Distance

Do you believe this to be a genuine Land Office Corner? yes.

If not, why?

L. H. Johnson (Signature)

(Signature)

Surveyor (Title)

1-10-34 (Date)

J-17

-----  
-----  
-----

Post for B.T.N.W.  
con. in road.  
This corner can be  
located from county  
Road Notes.

Corner again.

Give any further facts which will aid in finding this

324KTS. across distant.

from which this Corner bears S 40° E

side of Road

tree 6 inches diameter, on the North

Metal Location Poster is on a Fence Post

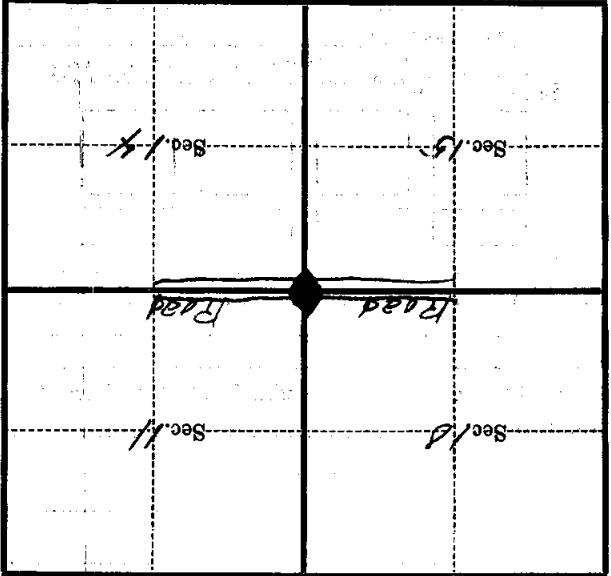

(Make sketch of topography near Corner)

J-17

Mer.

T. 150 R. 27 S