

U. S. Department of Agriculture
FOREST SERVICE

9

Chippewa NATIONAL FOREST J-13

CORNERS OF THE PUBLIC SURVEY

T. 150 R. 27 S. 5 Mer.

See Corner common to Sections 9, 10, 15, and 16

Corner consists of a NO STAKE (not) in place
State condition

Dimensions above ground inches

Sketch grooves, letters, figures, or notches, on proper face or edge.

CARDINAL POSITION

DIAGONAL POSITION

--	--	--	--

N W S E

--	--	--	--

NW SW SE NE

Mound of is located

Pits are located

Sketch markings of Bearing Trees (or Rocks) in proper box and fill blanks below, giving bearings from Corner to Trees and Distances in Links.

S-15			
------	--	--	--

B.T		B.T	B.T.
-----	--	-----	------

Species - Dead rotten stump. W.P. stump.

Diameter - 12" dead.

Bearing - 3'

Distance -

Do you believe this to be a genuine Land Office Corner?

If not, why?

Paul C. Hamant
(Signature)

12-5-33
(Date)

(Title)

Corner again.

Give any further facts which will aid in finding this

chains distant.

from which this Corner bears

side of Road at center section.

tree 8" inches diameter, on the E & W line west

Metal Location Poster is on a Spruce

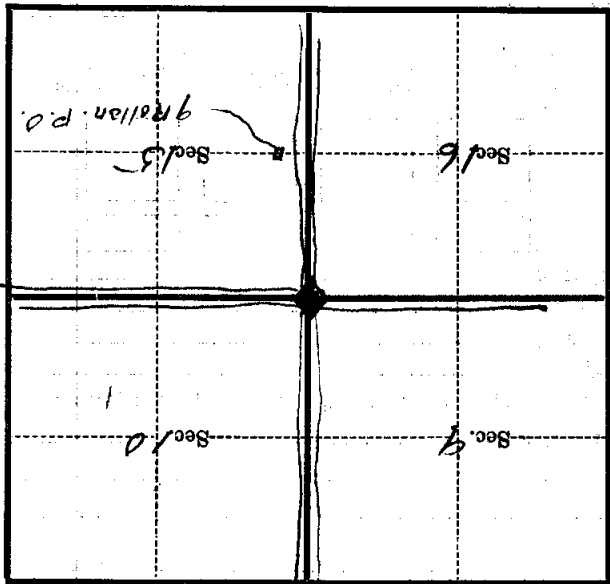

(Make sketch of topography near Corner)

Mer. J-13

T. 150 R. 27

5

J-13

posted

150 - 27

See Col 9-10-10-15

No Stake

B+

S15

137

dead rotten tan sta

12" 3' High

B+

W/ Raw Shrimp
dead

GLD corner

12-5-33

Wally Stewart
Party Chief

5-13

5-13

Center Point on Avenue
8" on E + W line West
west of road at intersection

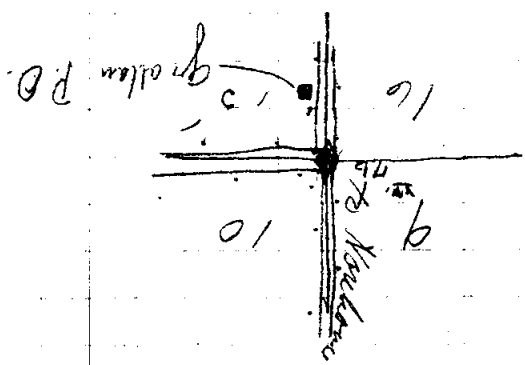

5-13
150 - 27 - 5