

U. S. Department of Agriculture

FOREST SERVICE

A9

posted

Chippewa

NATIONAL FOREST

CORNERS OF THE PUBLIC SURVEY

T. 150N R. 27W 5P, Mer.

Sec. 32, 33, 4, and 5

Corner common to Sections 32, 33, 4, and 5. Corner consists of a Cont. Iron (not) in place. State condition

Dimensions above ground _____ inches

Sketch grooves, letters, figures, or notches, on proper face or edge.

CARDINAL POSITION

DIAGONAL POSITION

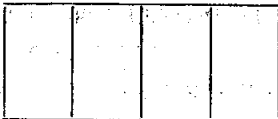

N W S E

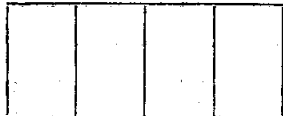

NW SW SE NE

Mound of _____ is located _____

Pits are located _____

Sketch markings of Bearing Trees (or Rocks) in proper box and fill blanks below, giving bearings from Corner to Trees and Distances in Links.

5

32

33

4

T4, Post

197

187 T4 Post

Species T4, Post 197 187 T4 Post OAK T4, Post

Diameter 9 9 12 9

Bearing S28W N34W N60E S36E

Distance _____

Do you believe this to be a genuine Land Office Corner? Yes

If not, why? _____

Lloyd W. Johnson
(Signature)

Jan. 15, 1934
(Date)

(Title) A-9

Corner again.
This corner can be
located from the
North corner by measuring
off the

Give any further facts which will aid in finding this
chains distant.
from which this Corner bears
side of Road
8 inches diameter, on the East
Metal Location Poster is on a *Leves Post*

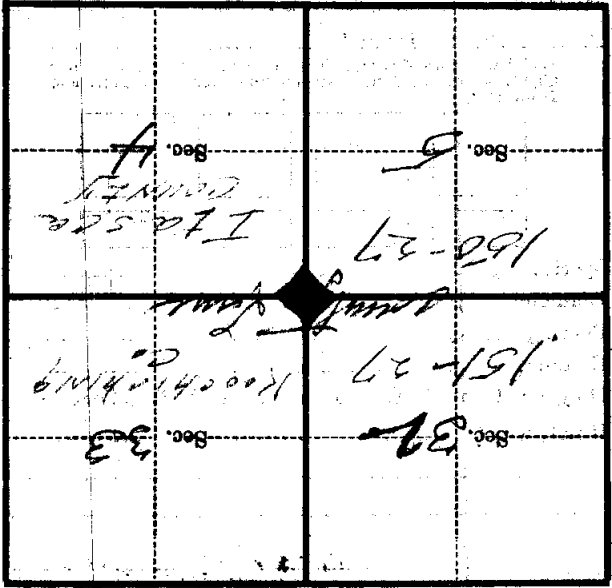

(Make sketch of topography near Corner)
T. 150 N. R. 27 W. 58. Mer. A-9