

U. S. Department of Agriculture
FOREST SERVICE

Chippewa NATIONAL FOREST

CORNERS OF THE PUBLIC SURVEY

T. 150 R. 26 S. 2 Mer.

Section 17 Corner common to Sections
16, 15, 21, and 22Corner consists of a Post (not) in place
State condition CharredDimensions above ground 26 inches
Sketch grooves, letters, figures, or notches, on proper face or edge.

CARDINAL POSITION

N	W	S	E

DIAGONAL POSITION

16	22	21	15
NW	SW	SE	NE

Mound of _____ is located _____

Pits are located _____

Sketch markings of Bearing Trees (or Rocks) in proper box and
fill blanks below, giving bearings from Corner to Trees and
Distances in Links.

Species _____

Diameter _____

Bearing _____

Distance _____

Do you believe this to be a genuine Land Office Corner? Yes

If not, why? _____

G. Sherman

(Signature)

1-11-34

(Date)

Engineer

(Title)

T. 120 R. 26 5th Mer.

(Make sketch of topography near Corner)

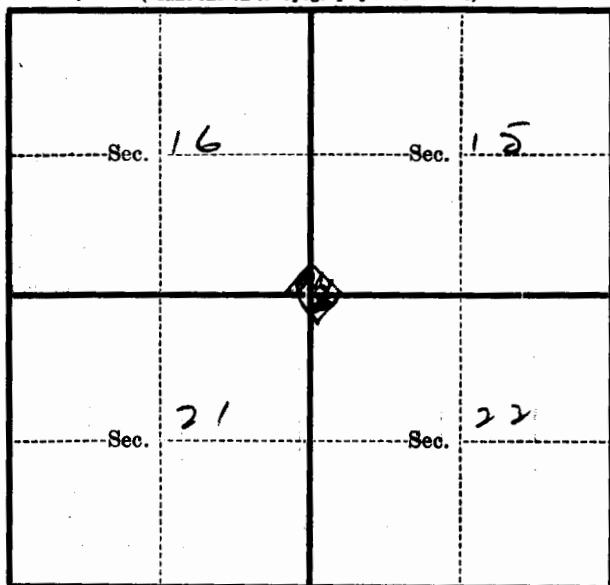

Metal Location Poster is on a Corner Post
tree 4 inches diameter, on the North
side of Post
from which this Corner bears (At Corner)
..... chains distant.

Give any further facts which will aid in finding this
Corner again.

Found no B.T's

Post is AT end of
Road.