

V9  
P

**U. S. Department of Agriculture**  
**FOREST SERVICE**

Chippewa NATIONAL FOREST

**CORNERS OF THE PUBLIC SURVEY**

T. 150 N. R. 26 W. 5<sup>th</sup> Mer.

Section Corner common to Sections

28, 29, 32, and 33

Corner consists of a Pine Post (not) in place

State condition Good!

Dimensions above ground 40 inches

Sketch grooves, letters, figures, or notches, on proper face or edge.

CARDINAL POSITION

DIAGONAL POSITION

--	--	--	--

N      W      S      E

--	--	--	--

NW   SW   SE   NE

Mound of \_\_\_\_\_ is located \_\_\_\_\_

Pits are located \_\_\_\_\_

Sketch markings of Bearing Trees (or Rocks) in proper box and fill blanks below, giving bearings from Corner to Trees and Distances in Links.

0.19

--

B.T.

--

--

Mkd New B.T.

<u>5</u> <u>28</u>
-----------------------

B.T.

--

--

--

B.T.

--

Species JPSTP    J. Pine Sp.    N. Pine

Diameter 1.0"    1.0"    1.2"

Bearing S 26° E    N. 4° N    N 25° E

Lks. Distance 9    10    11.8

Do you believe this to be a genuine Land Office Corner? yes

If not, why? \_\_\_\_\_

\_\_\_\_\_

\_\_\_\_\_

J. A. Gjelhaug  
(Signature)

Jr. Civil Engr.  
(Title)

1/10/36  
(Date)

T. 150N R. 26W 5<sup>th</sup> Mer.

(Make sketch of topography near Corner)

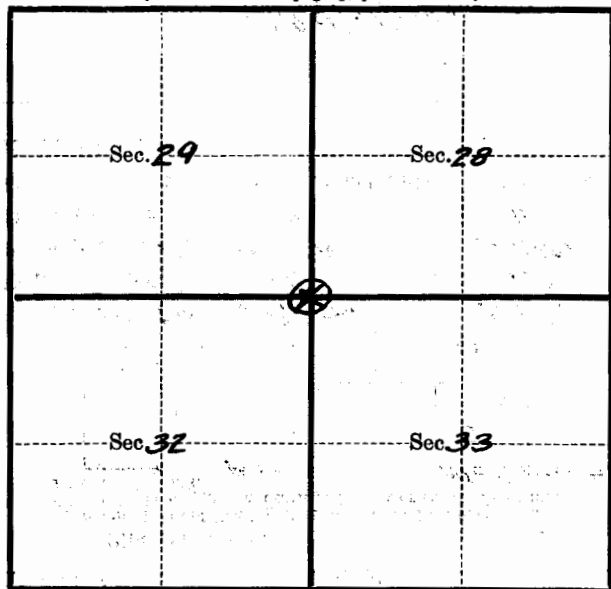

Metal Location Poster is on a N. Pine  
tree 12 inches diameter, on the SW  
side of Tree  
from which this Corner bears S 25° W  
1.18 chains distant.

Give any further facts which will aid in finding this  
Corner again.