

Form 874-B—Revised May, 1918
U. S. Department of Agriculture
FOREST SERVICE

N 25

Chippewa NATIONAL FOREST

CORNERS OF THE PUBLIC SURVEY

T. 149 N R. 30 W 5th. P. Mer.

Section Corner common to Sections

13, 24, and 18 - 19 T.149N

R.29W

Corner consists of a Wood Hub (~~not~~) in place

State condition Fair

Dimensions above ground Flush with ~~old~~ road inches

Sketch grooves, letters, figures, or notches, on proper face or edge.

CARDINAL POSITION

DIAGONAL POSITION

--	--	--	--

N W S E

--	--	--	--

NW SW SE NE

Mound of _____ is located _____

Pits are located _____

Sketch markings of Bearing Trees (or Rocks) in proper box and fill blanks below, giving bearings from Corner to Trees and Distances in Links.

County BTS

T. 149N R. 29W

S19

S18

BT

BT

Species Elm

Adh

Diameter 9"

9"

Bearing S70°E

N51°30'E

Distance 48

48

Do you believe this to be a genuine Land Office Corner? yes

If not, why? _____

John A. Gjelhaug

(Signature)

5/26/39

(Date)

Jr. Civil Eng.

(Title)

Metal Location Poster is on a Elm
 tree 6 inches diameter, on the West
 side of Tree
 from which this Corner bears S76°W
 0.33 chains distant.
 Give any further facts which will aid in finding this
 Corner again.

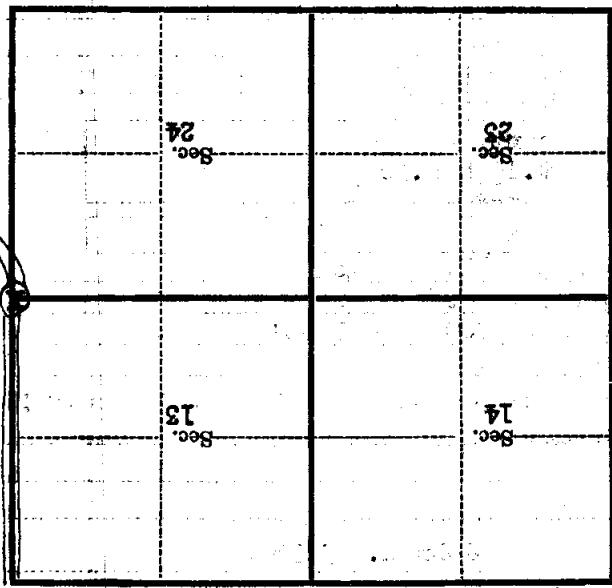

(Make sketch of topography near Corner)

T. 149 N. R. 30 W. 5th. P. Mer.