

Form 874-9—Revised May, 1918
 U. S. Department of Agriculture
 FOREST SERVICE

217

Chippewa NATIONAL FOREST

CORNERS OF THE PUBLIC SURVEY

T. 149 N R. 29 W 5th P. Mer.

Section Corner common to Sections
 34, and 35

Corner consists of a Wood Post (not) in place
 State condition Good

Dimensions above ground 40 inches

Sketch grooves, letters, figures, or notches, on proper face or edge.

CARDINAL POSITION

DIAGONAL POSITION

--	--	--	--

N W S E

--	--	--	--

NW SW SE NE

Mound of _____ is located _____

Pits are located _____

Sketch markings of Bearing Trees (or Rocks) in proper box and fill blanks below, giving bearings from Corner to Trees and Distances in Links.

Orig. B.T.

--	--	--	--

B.T.			
------	--	--	--

Species W. pine

Diameter 16"

Bearing N. 70° W

Distance 30

Do you believe this to be a genuine Land Office Corner? Yes

If not, why? _____

John A. Gjellaug

(Signature)

Jr. Civil Engineer

(Title)

1/30/40
 (Date)

(Make sketch of topography near Corner)

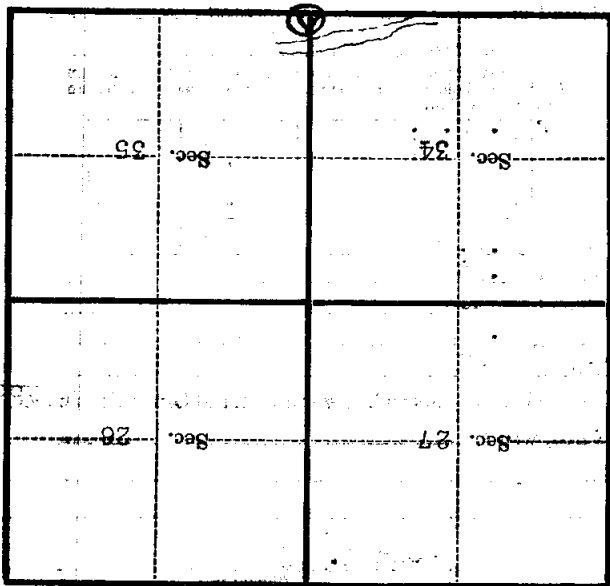

Metal Location Poster is on a W. Pine

tree 16 inches diameter, on the S. E.

side of Tree

from which this Corner bears S 70° E.

0.50 chains distant.

Give any further facts which will aid in finding this

Corner again.

U. S. Department of Agriculture
FOREST SERVICE

~~Section 217~~
Section 217

NATIONAL FOREST

CORNERS OF THE PUBLIC SURVEY

T. 149N R. 29W 5 Mer.
Section Corner common to Sections

34, and 35

Corner consists of a ? (not) in place

State condition ?

Dimensions above ground ? inches

Sketch grooves, letters, figures, or notches, on proper face or edge.

CARDINAL POSITION

DIAGONAL POSITION

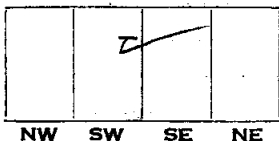
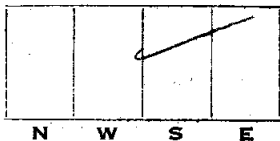

Mound of is located

Pits are located

Sketch markings of Bearing Trees (or Rocks) in proper box and fill blanks below, giving bearings from Corner to Trees and Distances in Links.

<u>Iron</u> <u>over</u>	<u>Iron</u> <u>over</u>		

Species N. Pine Basswood

Diameter 16" 12"

Bearing AP. NW AP. NE

Distance AP. 10 AP. 10

Do you believe this to be a genuine Land Office Corner? Yes

If not, why?

Milton S. Johnson
(Signature)

Estimator
(Title)

2/21/35
(Date)

Corner again.
Could not find corner
but found two bearing
trees

Give any further facts which will aid in finding this
Approx 1 chains distant.
from which this corner bears
Approx SE
side of tree
tree 16 inches diameter, on the
South
Metal Location Poster is on a
Norway

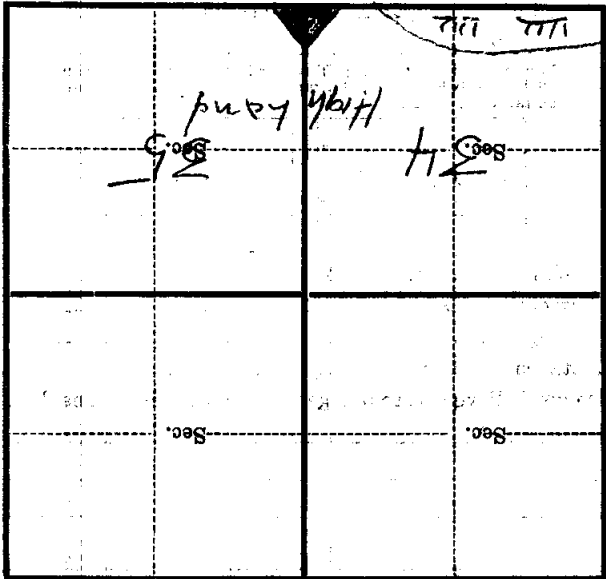

(Make sketch of topography near corner)

T. 149 N. R. 29 W. 6 Mer.

Form 874-9—Revised May, 1918
U. S. Department of Agriculture
FOREST SERVICE

217

Chippewa NATIONAL FOREST

CORNERS OF THE PUBLIC SURVEY

T. 149 R. 29 5th Mer.

Section Corner common to Sections
34, 35 and 2, and 3 of T148-R29

Corner consists of a _____ (not) in place

State condition _____

Dimensions above ground _____ inches

Sketch grooves, letters, figures, or notches, on proper face or edge.

CARDINAL POSITION

DIAGONAL POSITION

--	--	--	--

N W S E

--	--	--	--

NW SW SE NE

Mound of _____ is located _____

Pits are located _____

Sketch markings of Bearing Trees (or Rocks) in proper box and fill blanks below, giving bearings from Corner to Trees and Distances in Links.

Species _____

Diameter _____

Bearing _____

Distance _____

Do you believe this to be a genuine Land Office Corner? _____

If not, why? _____

Duff M Johnson
(Signature)

Dec. 30-1954
(Date)

(Title)

Corner again.

Give any further facts which will aid in finding this

chains distant.

from which this Corner bears

side of

tree 18 inches diameter, on the

white pine
near

Metal Location Poster is on a

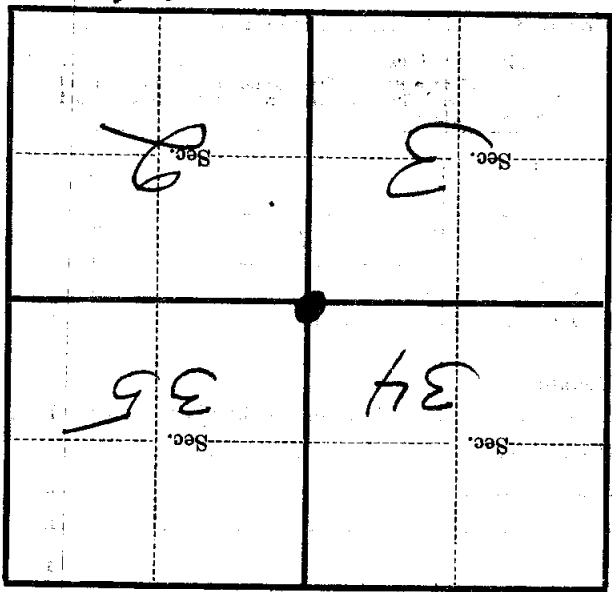

(Make sketch of topography near Corner)

T. 149 R. 29 5th Mer.