

U. S. Department of Agriculture  
FOREST SERVICE

N9  
posted

Chippewa NATIONAL FOREST

CORNERS OF THE PUBLIC SURVEY

T. 117 N R. 25 W S. Mer.

Corner common to Sections  
16, 17, 18, and 19

Corner consists of a stone in place  
State condition good

Dimensions above ground \_\_\_\_\_ inches  
Sketch grooves, letters, figures, or notches, on proper face or edge.

CARDINAL POSITION

DIAGONAL POSITION



Mound of \_\_\_\_\_ is located \_\_\_\_\_

Pits are located \_\_\_\_\_

Sketch markings of Bearing Trees (or Rocks) in proper box and fill blanks below, giving bearings from Corner to Trees and Distances in Links.



Species Pinus strobus Suber

Diameter 1 1/2 1 1/2

Bearing \_\_\_\_\_

Distance \_\_\_\_\_

Do you believe this to be a genuine Land Office Corner? Yes

If not, why? \_\_\_\_\_

John W. ...  
(Signature)  
Estimator  
(Title)  
1-11-31  
(Date)

Corner again.

Give any further facts which will aid in finding this  
chains distant.  
from which this Corner bears  
side of  
tree inches diameter, on the  
Metal Location Poster is on a

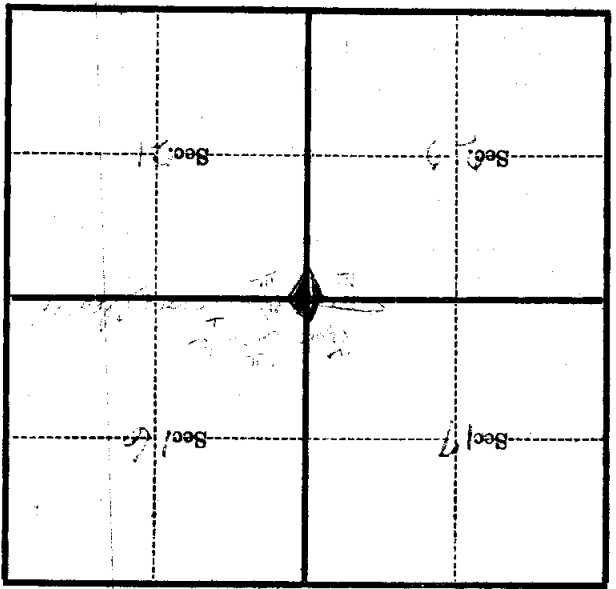

(Make sketch of topography near Corner)

T. L. H. R. Mer.

Form 874-9—Revised May, 1918  
 U. S. Department of Agriculture  
 FOREST SERVICE

Chippewa NATIONAL FOREST

CORNERS OF THE PUBLIC SURVEY

T. 149 R. 28 5 Mer.  
Section Corner common to Sections  
16, 17, 20, and 21

Corner consists of a \_\_\_\_\_ (not) in place  
 State condition \_\_\_\_\_

Dimensions above ground \_\_\_\_\_ inches

Sketch grooves, letters, figures, or notches, on proper face or edge.

CARDINAL POSITION

DIAGONAL POSITION

--	--	--	--

N W S E

--	--	--	--

NW SW SE NE

Mound of \_\_\_\_\_ is located \_\_\_\_\_

Pits are located \_\_\_\_\_

Sketch markings of Bearing Trees (or Rocks) in proper box and fill blanks below, giving bearings from Corner to Trees and Distances in Links.

3 17		T149N R28W S21	149N R28W S16
---------	--	----------------------	---------------------

B.T		B.T	B.T
-----	--	-----	-----

Species S. PROCESSTAMP S. PROCESSTAMP SPURCE STUB

Diameter 12" 12" 8"

Bearing \_\_\_\_\_

Distance 7 paces 3 paces 6 paces

Do you believe this to be a genuine Land Office Corner? No

If not, why? Resurveyed

John Kirkbold  
 (Signature)

1-10-33  
 (Date)

Estimator  
 (Title)

N-9

Corner again.  
Rightaway cleared out  
from corner south.  
 $\frac{1}{2}$  mile also cleared  
East and West.

Metal Location Poster is on a N.E. B.T.  
tree inches diameter, on the  
side of from which this Corner bears  
chains distant.  
Give any further facts which will aid in finding this

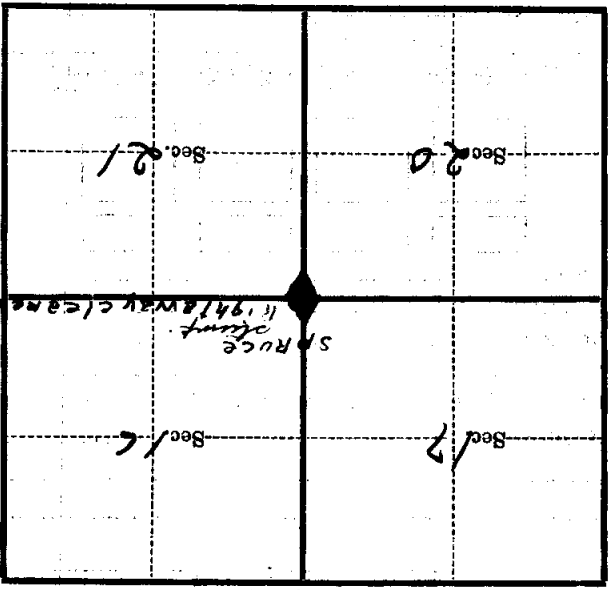

(Make sketch of topography near Corner)

T. 149 R. 28  
Mer. 31