

Form 874-0—Revised May, 1918
 U. S. Department of Agriculture
 FOREST SERVICE

25
 Posted
 p3

Chippewa NATIONAL FOREST

CORNERS OF THE PUBLIC SURVEY

T. 149N R. 28W 5th Mer. Quarter
 Corner common to Sections

19, 20

Corner consists of a Aspen post (not) in place
 State condition Placed by lineal crew.

Dimensions above ground 30" inches

Sketch grooves, letters, figures, or notches, on proper face or edge.

CARDINAL POSITION

DIAGONAL POSITION

N	W	S	E

SE	NE	NW	SW
NE	SE	SW	NW
S-19	S-19	S20	S20
NW	SW	SE	NE

Mound of _____ is located _____

Pits are located _____

Sketch markings of Bearing Trees (or Rocks) in proper box and fill blanks below, giving bearings from Corner to Trees and Distances in Links.

1/4 S-19	---	---	
B.T.	B.T.	B.T.	

Species Aspen Birch Spruce
 Diameter Stump Stump Stump
 Bearing S 32°W N 62°E S 63°E
 Distance 1.08 0.65 0.57 chains

Do you believe this to be a genuine Land Office Corner? Yes
 If not, why? _____

[Signature]
 Chief of party.
 t/15/35 (Date) _____ (Title)
 8-7894

p-5 X

Lined area for notes at the top of the page.

Corner again.

Give any further facts which will aid in finding this

0.61 chains distant.

from which this Corner bears N 55° W

side of tree

tree 5 inches diameter, on the East

Metal Location Poster is on a Aspen

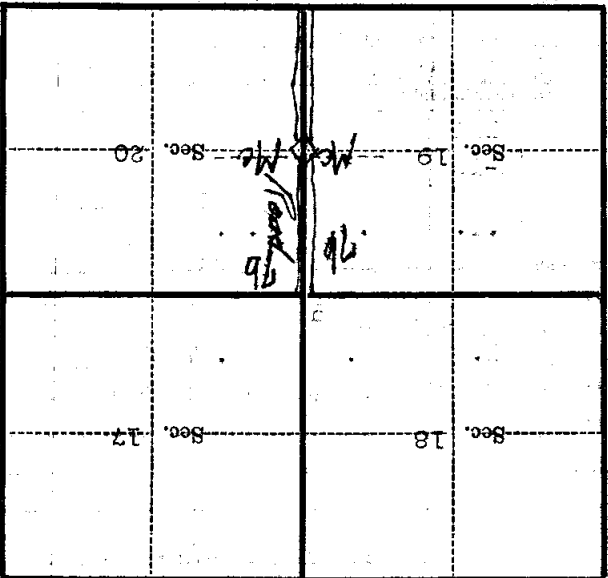

(Make sketch of topography near Corner)

T. 149N R. 28W 5th Mer.

U. S. Department of Agriculture

FOREST SERVICE

Chippewa NATIONAL FOREST

CORNERS OF THE PUBLIC SURVEY

T. 149 R. 28 Mer.

1/4 Corner common to Sections 19, and 20

Corner consists of a (not) in place

State condition

Dimensions above ground inches

Sketch grooves, letters, figures, or notches, on proper face or edge.

CARDINAL POSITION

DIAGONAL POSITION

N	W	S	E

NW	SW	SE	NE

Mound of is located

Pits are located

Sketch markings of Bearing Trees (or Rocks) in proper box and fill blanks below, giving bearings from Corner to Trees and Distances in Links.

	1/4 S 19		
	B.T.		

Species Balm of G. bead

Diameter 22"

Bearing S.W.

Distance

Do you believe this to be a genuine Land Office Corner? yes

If not, why?

Karl E. Kobes
(Signature)

1-6-34
(Date)

Estimator
(Title)

Corner again.
Tree near Road ditch
across from Telephone line
on Itasca County Road No

Give any further facts which will aid in finding this
chains distant.

from which this Corner bears
side of Tree
tree 4 inches diameter, on the
Metal Location Poster is on a
Aspen

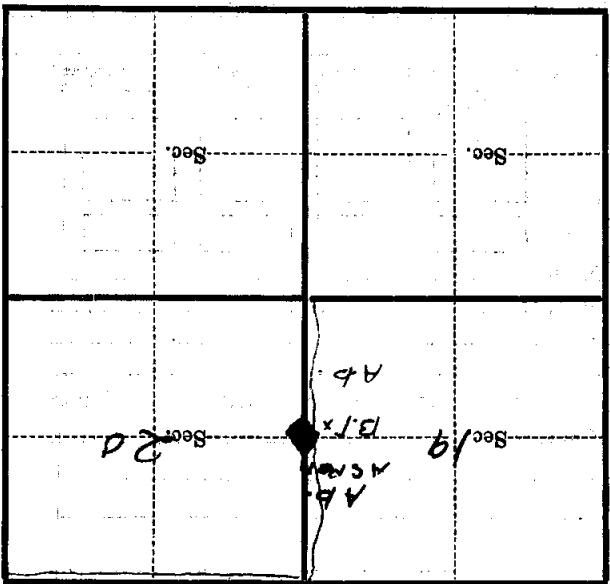

(Make sketch of topography near Corner)

T. 149 R. 28
Mer. 5

U. S. Department of Agriculture
FOREST SERVICE

Whippoorwill NATIONAL FOREST

CORNERS OF THE PUBLIC SURVEY

T. 14 N R. 28 W S. 11 P. Mer.

14 Corner common to Sections
19, 20, and _____

Corner consists of a Post (not) in place
State condition Good

Dimensions above ground 30 inches
Sketch grooves, letters, figures, or notches, on proper face or edge.

CARDINAL POSITION

N	W	S	E

DIAGONAL POSITION

SE	NE	NW	SW
NE	SE	SW	NW
S19	S19	S20	S20
NW	SW	SE	NE

Mound of _____ is located _____

Pits are located _____

Sketch markings of Bearing Trees (or Rocks) in proper box and fill blanks below, giving bearings from Corner to Trees and Distances in Links.

<u>V4</u> <u>S19</u>			
<u>B.T.</u>	<u>B.T.</u>	<u>B.T.</u>	

Species Aspen Birch Spruce
Diameter Stump Stump Stump
Bearing S32°W N62°E S62°E
Distance 1.08 ch 0.65 ch 0.57 ch

Do you believe this to be a genuine Land Office Corner? Yes

If not, why? _____

A. H. Jensen
(Signature)

5/12/36
(Date)

Richard P. P. P. P.
(Title)

P-5

Corner again.

Give any further facts which will aid in finding this

corner distant.

From which this Corner bears

N 55° E

side of

tree 5 inches diameter, on the

E 25°

Metal Location Poster is on a

ASPER

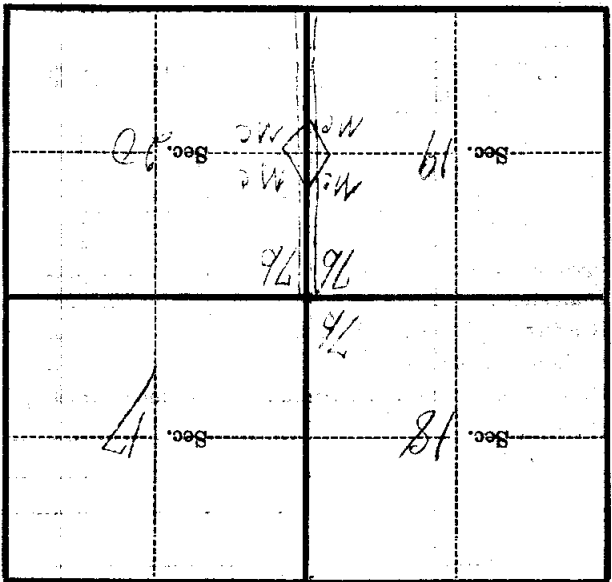

(Make sketch of topography near Corner)

T. 119 N R. 28 W S. 4 P Mer.