

U. S. Department of Agriculture
FOREST SERVICE

Superior
51
Posted

..... NATIONAL FOREST

CORNERS OF THE PUBLIC SURVEY

T. 149 N. R. 26 W. 5th Mer.
.....
Section Corner common to Sections
12, 7, 13, and 18.....

Corner ~~consists of a~~ (not) in place
State condition Assumed corner to be at
intersection of road.

Dimensions above ground inches
Sketch grooves, letters, figures, or notches, on proper face or edge.
CARDINAL POSITION DIAGONAL POSITION

N	W	S	E

NW	SW	SE	NE

Mound of is located
..... Pits are located

Sketch markings of Bearing Trees (or Rocks) in proper box and fill blanks below, giving bearings from Corner to Trees and Distances in Links.

S. 7	S. 13	S. 13	
B. T.	B. T.	B. T.	

Species Cedar Cedar Tamarack
Diameter Stump Stump 6"
Bearing N. 32° E N. 71° W N. 53° W
Distance 77 Li. 83 Li. 98 Links

Do you believe this to be a genuine Land Office Corner? **Yes.**
If not, why?

Harrison Adams
.....
(Signature)

9/12/34
(Date)

C.C.S. Park Leader
.....
(Title)

T. 149 N. R. 26 W. + 27 5th Mer.

(Make sketch of topography near Corner)

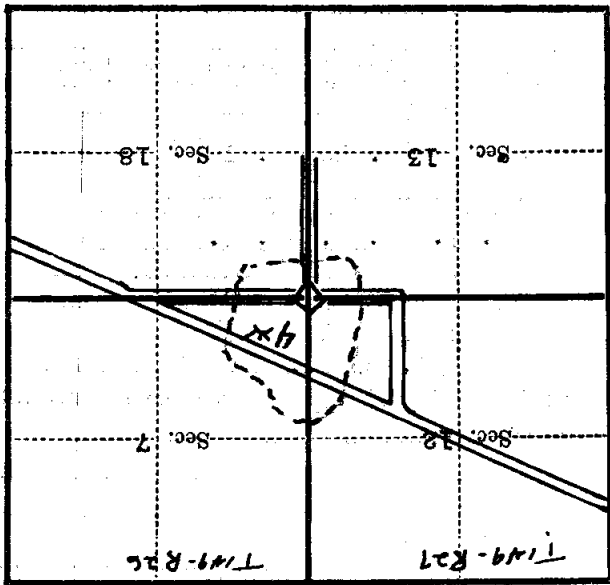

Metal Location Poster is on a stake

tree 6" inches diameter, on the north

side of the corner of the road.

from which this Corner bears 15 links south

chaine distant.

Give any further facts which will aid in finding this

Corner again.