

Form 874-B—Revised May, 1918
U. S. Department of Agriculture
FOREST SERVICE

N-13
N-13

Chippewa NATIONAL FOREST

CORNERS OF THE PUBLIC SURVEY

T. 148N. R. 31W. 5thP. Mer.

Section Corner common to Sections
15, 16, 21, and 22

Corner consists of a 21 Iron Post (~~not~~) in place

State condition Fair

Dimensions above ground 24 inches

Sketch grooves, letters, figures, or notches, on proper face or edge.

CARDINAL POSITION

DIAGONAL POSITION

--	--	--	--

N W S E

--	--	--	--

NW SW SE NE

Mound of _____ is located _____

Pits are located _____

Sketch markings of Bearing Trees (or Rocks) in proper box and fill blanks below, giving bearings from Corner to Trees and Distances in Links.

0119 BT.

S. 16

--	--	--

BT.

0119 BT.

--	--	--

Species ASH ASH

Diameter 9" 9"

Bearing S. 85 W. S 16 E

Distance 56 20

Do you believe this to be a genuine Land Office Corner? Yes

If not, why? _____

K.V. Styler

(Signature)

Compass Man

(Title)

2/25/38

(Date)

Corner again.

Give any further facts which will aid in finding this

062 chains distant.

from which this Corner bears N94°W

side of tree

tree 10 inches diameter, on the N.W.

Metal Location Poster is on a 7' 4 1/2" ASP

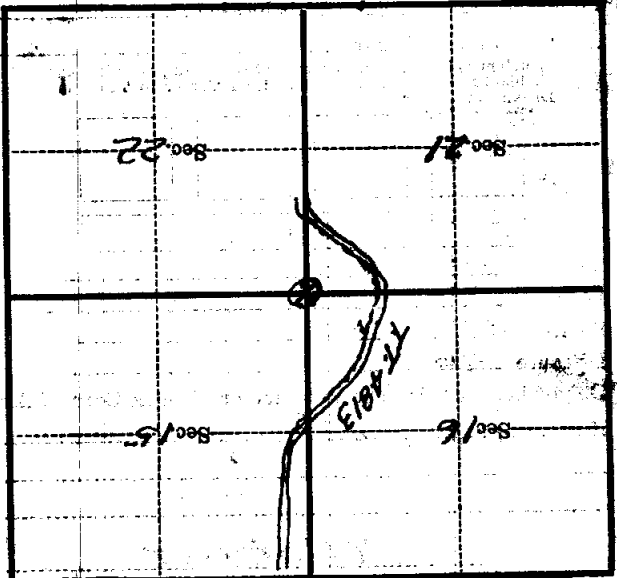

(Make sketch of topography near Corner)

T 198N R 31W 532 P N-13 M.B.T.

Form 874-9—Revised May, 1918
U. S. Department of Agriculture
FOREST SERVICE

A-13
N-13

Chippewa NATIONAL FOREST

CORNERS OF THE PUBLIC SURVEY

T. 148 N. R. 31 W. 5th P. Mer.

Section _____ Corner common to Sections

15, 16, 21, and 22

Corner consists of a Tam's Post (not) in place

State condition Fair

Dimensions above ground 24 inches

Sketch grooves, letters, figures, or notches, on proper face or edge.

CARDINAL POSITION

DIAGONAL POSITION

--	--	--	--

N W S E

--	--	--	--

NW SW SE NE

Mound of _____ is located _____

Pits are located _____

Sketch markings of Bearing Trees (or Rocks) in proper box and fill blanks below, giving bearings from Corner to Trees and Distances in Links.

Orig. B. T. S. 16			
B. T.			

Species Ash

Diameter 9"

Bearing S. 15W.

Distance 56

Do you believe this to be a genuine Land Office Corner? Yes

If not, why? _____

K. Styler

(Signature)

Compass Man

(Title)

2/25/38

(Date)

Corner again.

Give any further facts which will aid in finding this

0.62 chains distant.

from which this Corner bears N. 44. W.

side of Tree

inches diameter, on the N. W.

Metal Location Poster is on a Ash

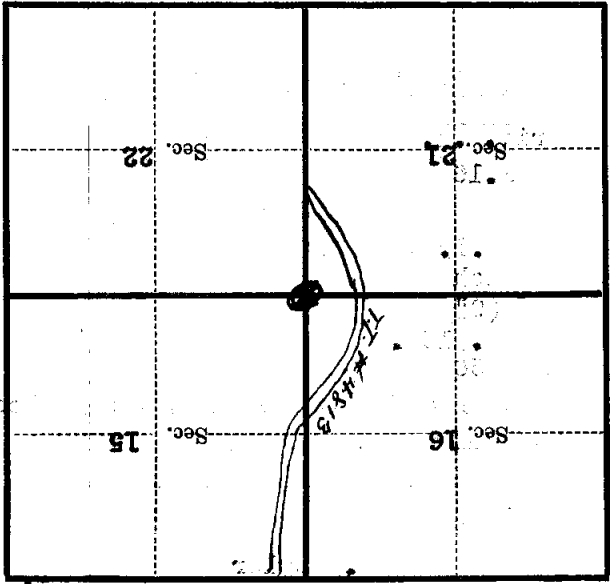

(Make sketch of topography near Corner)

T. 148 N. R. 31 W. 5th Mer. N-13