

## U. S. Department of Agriculture

## FOREST SERVICE

Chippewa NATIONAL FOREST

## CORNERS OF THE PUBLIC SURVEY

T. 148 N R. 28 N 5th - Mer.

W.C. — Corner common to Sections  
21, and 22

Corner consists of a Elm — (not) in place

State condition New —

Dimensions above ground 40" inches

Sketch grooves, letters, figures, or notches, on proper face or edge.

CARDINAL POSITION

DIAGONAL POSITION

	S- 21		S- 22
N	W	S	E

NW	SW	SE	NE

Mound of \_\_\_\_\_ is located \_\_\_\_\_

Pits are located \_\_\_\_\_

Sketch markings of Bearing Trees (or Rocks) in proper box and fill blanks below, giving bearings from Corner to Trees and Distances in Links.

S- 21			
BT			

Species Tom - Tom FallenDiameter 16" 10"Bearing S-33°W S-80°EDistance .14 Lks .12 Lks -Do you believe this to be a genuine Land Office Corner? yes

If not, why? \_\_\_\_\_

\_\_\_\_\_

\_\_\_\_\_

\_\_\_\_\_

\_\_\_\_\_

10/27/36 (Date)

Bolke (Signature)

(Title)

Corner is located on -  
South side of pond -  
One B.T. Has fallen - the  
other a large 16" stub - 6 ft  
scrubbed, tree put away to  
show scribbling - water level  
covering bottom of corner -

Corner again.

Give any further facts which will aid in finding this

chains distant.

from which this Corner bears

side of

tree inches diameter, on the

Metal Location Poster is on a

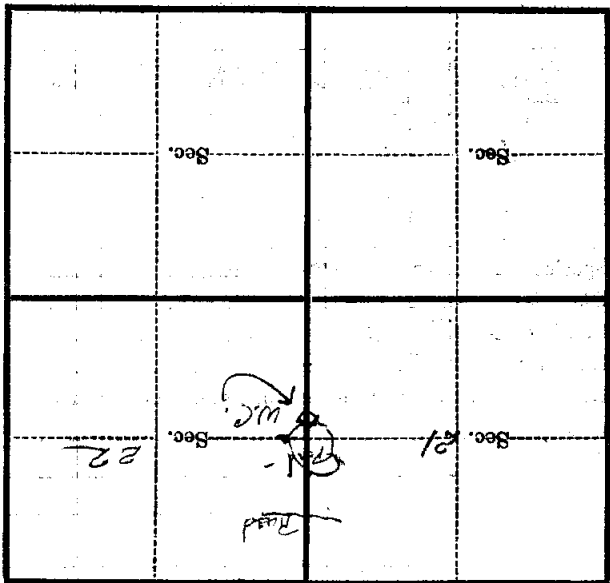

(Make sketch of topography near Corner)

T. 1981 R. 28W 574 Mer.

U. S. Department of Agriculture  
FOREST SERVICE

PQ-13

Chippewa NATIONAL FOREST

CORNERS OF THE PUBLIC SURVEY

T. 45 R. 28 5th Mer.

N. C. Corner common to Sections

21, and 22

Corner consists of a FLM (~~rod~~) in place

State condition New

Dimensions above ground 40 inches

Sketch grooves, letters, figures, or notches, on proper face or edge.

CARDINAL POSITION

DIAGONAL POSITION

	3-		3-
	21		22

N W S E

NW SW SE NE

Mound of \_\_\_\_\_ is located \_\_\_\_\_

Pits are located \_\_\_\_\_

Sketch markings of Bearing Trees (or Rocks) in proper box and fill blanks below, giving bearings from Corner to Trees and Distances in Links.

3-			
21			
22			

Species 9371 Large Yellow

Diameter 16" 10"

Bearing S. 33° W S. 50° E

Distance 14 12

Do you believe this to be a genuine Land Office Corner? Yes

If not, why? \_\_\_\_\_

P. A. L.

(Signature)

10/27/36

(Date)

Forester

(Title)

ON SOUTH SIDE OF POND  
BOTTOM OF CORNER UNDER  
WATER

Corner again.

Give any further facts which will aid in finding this

chains distant.

from which this Corner bears

side of

tree inches diameter, on the

Metal Location Poster is on a

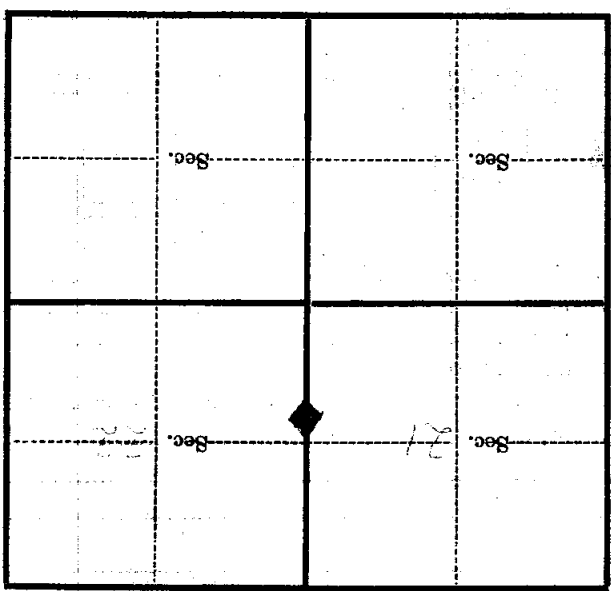

(Make sketch of topography near Corner)

T. 148 R. 29 Mer.

U. S. Department of Agriculture  
FOREST SERVICE

PQ-13

Chippewa NATIONAL FOREST

CORNERS OF THE PUBLIC SURVEY

T. 149 R. 38 5<sup>th</sup> Mer.

M. C. Corner common to Sections  
21, and 22

Corner consists of a FLM (not) in place

State condition New

Dimensions above ground 40 inches

Sketch grooves, letters, figures, or notches, on proper face or edge.

CARDINAL POSITION

DIAGONAL POSITION

	S-		S-
	21		22
N	W	S	E

NW	SW	SE	NE

Mound of \_\_\_\_\_ is located \_\_\_\_\_

Pits are located \_\_\_\_\_

Sketch markings of Bearing Trees (or Rocks) in proper box and fill blanks below, giving bearings from Corner to Trees and Distances in Links.

S-			
21			
B.T.			

Species TAM. TAM. FALLEN.

Diameter 10" 10"

Bearing S. 33° W S. 00° E

Distance 114 112

Do you believe this to be a genuine Land Office Corner? Yes

If not, why? \_\_\_\_\_

Balke  
(Signature)

Leader  
(Title)

10/27/36  
(Date)

ON SOUTH SIDE OF FORT  
SECTION OF CORNER

Corner again.

Metal Location Poster is on a  
tree inches diameter, on the  
side of  
from which this Corner bears  
chains distant.

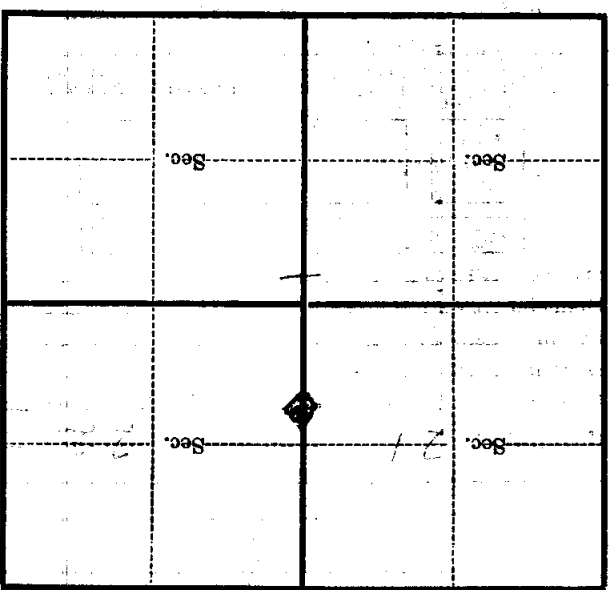

(Make sketch of topography near Corner)

T. 148 R. 22 Mer.