

U. S. Department of Agriculture
FOREST SERVICE

L23

Chippewa NATIONAL FOREST

CORNERS OF THE PUBLIC SURVEY

T. 148N R. 28W 5th Mer.

Center Quarter Corner common to Sections

-----, -----, 13, and -----

Corner consists of a Post (not) in place

State condition Fair.

Dimensions above ground 30" inches

Sketch grooves, letters, figures, or notches, on proper face or edge.

CARDINAL POSITION

DIAGONAL POSITION

Not scribed.			
N	W	S	E

NW	SW	SE	NE

Mound of ----- is located -----

Pits are located -----

Sketch markings of Bearing Trees (or Rocks) in proper box and fill blanks below, giving bearings from Corner to Trees and Distances in Links.

Center 1/4 S-13		Center 1/4 S 13	
B.T.		B.T.	

Species Elm Ash

Diameter 10" 8"

Bearing N 55° W S 12° W

Distance .68 ch. 0.90 chains.

Do you believe this to be a genuine Land Office Corner? Yes

If not, why? -----

Harrison Adams
(Signature)

4/15/35
(Date)

CCC Ast. Leader.
(Title)

L-23

Corner again. Corner is at intersection of roads.

Give any further facts which will aid in finding this corner distant. 0.56 from which this Corner bears N 120 E side of tree. 10 inches diameter, on the North Metal Location Poster is on a Ash

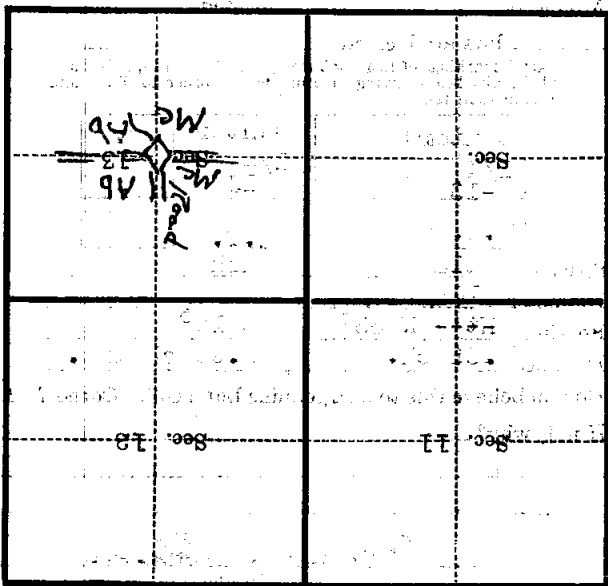

(Make sketch of topography near Corner)

U. S. Department of Agriculture
FOREST SERVICE

L-23

Chippewa NATIONAL FOREST

CORNERS OF THE PUBLIC SURVEY

T. 148N R. 28W 574 Mer.
Center 1/4 Corner common to Sections

13, and

Corner consists of a post (not) in place
State condition Fair

Dimensions above ground 30" 4" inches

Sketch grooves, letters, figures, or notches, on proper face or edge.

CARDINAL POSITION

DIAGONAL POSITION

N	W	S	E

NW	SW	SE	NE

Mound of _____ is located _____

Pits are located _____

Sketch markings of Bearing Trees (or Rocks) in proper box and fill blanks below, giving bearings from Corner to Trees and Distances in Links.

Center 1/4 513		Center 1/4 513	
BT		BT	

Species	Elm	Ash
Diameter	10"	8"
Bearing	N55W	S120W
Distance	90	90

Do you believe this to be a genuine Land Office Corner? *yes*

If not, why? _____

(Signature)

(Date)

(Title)

570

Give any further facts which will aid in finding this corner again.

From which this Corner bears _____ side of _____ tree _____ inches diameter, on the _____ Metal Location Poster is on a _____ chains distant.

Sec. 13	Sec.
Sec.	Sec.

(Make sketch of topography near Corner)

T/1484 R. 28 W. 5 T. Mer.

Form 874-0--Revised May, 1918
 U. S. Department of Agriculture
 FOREST SERVICE

L-23

Chippewa NATIONAL FOREST

CORNERS OF THE PUBLIC SURVEY

T. 148N R. 28W 5th Mer.
 Center 1/4 Corner common to Sections
 _____, _____, 13, and _____

Corner consists of a Post (not) in place
 State condition Fair

Dimensions above ground 30" x 4" inches
 Sketch grooves, letters, figures, or notches, on proper face or edge.
 CARDINAL POSITION DIAGONAL POSITION

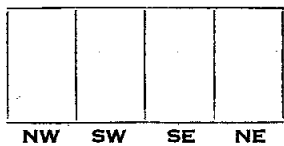
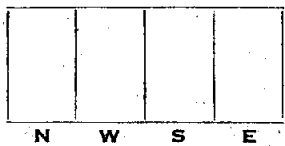

Mound of _____ is located _____

Pits are located _____

Sketch markings of Bearing Trees (or Rocks) in proper box and fill blanks below, giving bearings from Corner to Trees and Distances in Links.

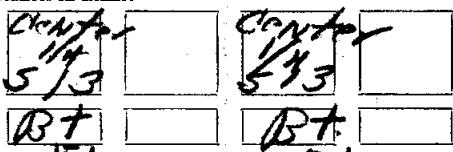

Species	<u>Elm</u>	<u>Ash</u>
Diameter	<u>10"</u>	<u>8"</u>
Bearing	<u>N55W</u>	<u>S120W</u>
Distance	<u>98</u>	<u>90</u>

Do you believe this to be a genuine Land Office Corner? yes
 If not, why? _____

(Signature)

(Date)

(Title)

572

Corner again.

Give any further facts which will aid in finding this

chains distant.

from which this Corner bears

side of

tree inches diameter, on the

Metal Location Poster is on a

	Sec.		Sec.
	Sec.	23	Sec.

(Make sketch of topography near Corner)

T. 14N R. 29W 5th Mer.

Form 874-B—Revised May, 1918
 U. S. Department of Agriculture
 FOREST SERVICE

L-23

Chippewa ~~Ag~~ NATIONAL FOREST
 CORNERS OF THE PUBLIC SURVEY

T. 148 N. R. 28 W. 5th Mer.

Center $\frac{1}{4}$ Corner common to Sections
 _____, 13, and _____

Corner consists of a post (not) in place

State condition Fair

Dimensions above ground 30" inches

Sketch grooves, letters, figures, or notches, on proper face or edge.

CARDINAL POSITION

DIAGONAL POSITION

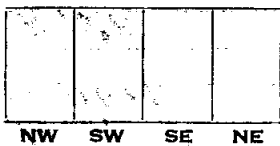
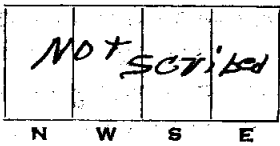

Mound of _____ is located _____

Pits are located _____

Sketch markings of Bearing Trees (or Rocks) in proper box and fill blanks below, giving bearings from Corner to Trees and Distances in Links.

Center
 $\frac{1}{4}$
 13

Center
 $\frac{1}{4}$
 13

B.T.

B.T.

Species Elm Ash

Diameter 12" 10" 10" 8"

Bearing N 55° W S 12° W

Distance 67 links 92 L. 56 links 90

Do you believe this to be a genuine Land Office Corner? Yes

If not, why? _____

Harrison Adams

(Signature)

4/15/35

(Date)

C.C. Pittsinger

(Title)

Corner again.
Corner is at intersection
of roads.

Give any further facts which will aid in finding this

56 Links distant.

from which this Corner bears

N 13° E

side of tree

tree 10 inches diameter, on the

NORTH

Metal Location Poster is on a

ASH

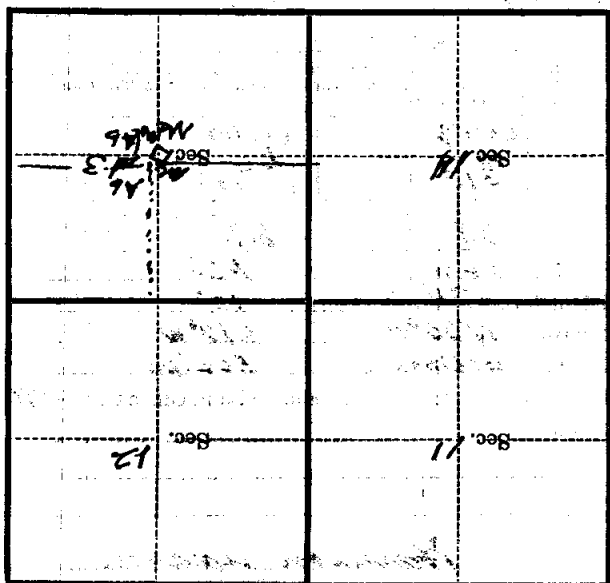

(Make sketch of topography near Corner)

T. 149N R. 28W S. 74 Mer.