

Form 874-9—Revised May, 1918
U. S. Department of Agriculture
FOREST SERVICE

A 21
P

Chippewa NATIONAL FOREST

CORNERS OF THE PUBLIC SURVEY

T. T148 N R. 28 W 5 th Mer.

Section Corner common to Sections
35, 36, 2, and 1

Corner consists of a Spruce post (not) in place
State condition good

Dimensions above ground 48 inches
Sketch grooves, letters, figures, or notches, on proper face or edge.

CARDINAL POSITION

DIAGONAL POSITION

N	W	S	E

T148N	T148N		
R28W	R28W		
S. 2	S. 1		
NW	SW	SE	NE

Mound of is located

Pits are located

Sketch markings of Bearing Trees (or Rocks) in proper box and fill blanks below, giving bearings from Corner to Trees and Distances in Links.

T148N
R28W
S. 1

T148N
R28W
S. 2

B. T.

B. T.

Species Aspen Ash

Diameter 24" 14"

Bearing S. 38° E. S. 27° W.

Distance 0.58 0.96

Do you believe this to be a genuine Land Office Corner? Yes
If not, why?

W. Ernest

(Signature)

Chief of party

(Title)

7/22/35
(Date)

A-21

Blank lined area for notes at the top of the page.

Corner again.

Give any further facts which will aid in finding this

chains distant.

0.30

From which this Corner bears

East

side of

Tree

tree 26 inches diameter, on the

West

Metal Location Poster is on a

Aspen

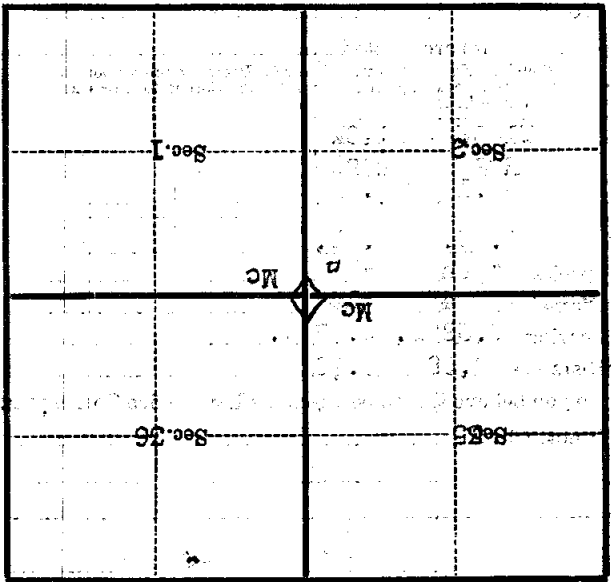

(Make sketch of topography near Corner)

T 148 N R 28 W S 4th Mer.

U. S. Department of Agriculture
FOREST SERVICE

A-21

NATIONAL FOREST

CORNERS OF THE PUBLIC SURVEY

T. 143N R. 23E Mer.

Sdc

Corner common to Sections

30, 10, 2, and 1

Corner consists of a SPU (not) in place

State condition Good

Dimensions above ground 481 inches

Sketch grooves, letters, figures, or notches, on proper face or edge.

CARDINAL POSITION

DIAGONAL POSITION

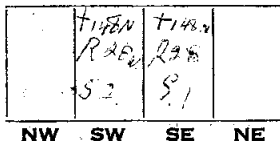
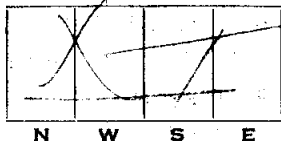

Mound of _____ is located _____

Pits are located _____

Sketch markings of Bearing Trees (or Rocks) in proper box and fill blanks below, giving bearings from Corner to Trees and Distances in Links.



Species ASP A?H

Diameter 2 1/2" 1 1/2"

Bearing S 16 E S 21 W

Distance 53.0 90

Do you believe this to be a genuine Land Office Corner? _____

If not, why? _____

W A [Signature]

(Signature)

7/22/1918
(Date)

RR 1718
(Title)

Corner again.

Give any further facts which will aid in finding this

from which this Corner bears

side of

tree 8 1/2 inches diameter, on the *W side*

Metal Location Poster is on a

ASP

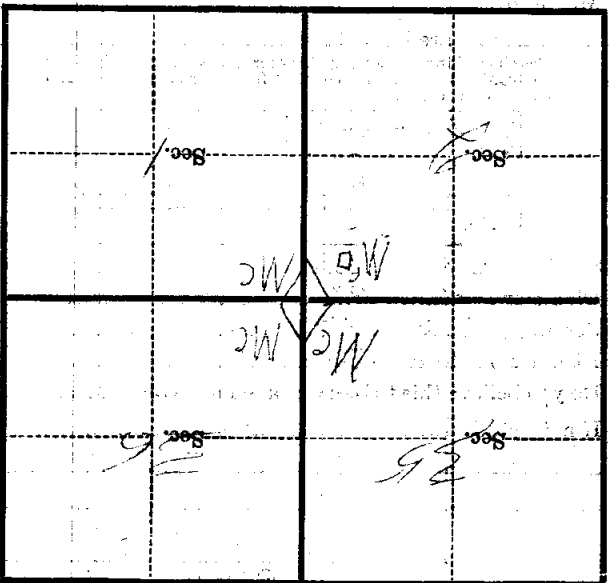

(Make sketch of topography near Corner)

U. S. Department of Agriculture
FOREST SERVICE

A-21

Chippewa NATIONAL FOREST

CORNERS OF THE PUBLIC SURVEY

T. 148 R. 28 S. Mer.

Corner common to Sections 35, 36, 2, and 1

Corner consists of a Sp. (not) in place

State condition good

Dimensions above ground 48 inches

Sketch grooves, letters, figures, or notches, on proper face or edge.

CARDINAL POSITION

DIAGONAL POSITION

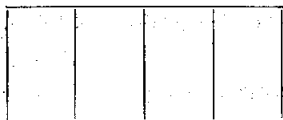

N W S E

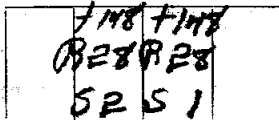

NW SW SE NE

Mound of _____ is located _____

Pits are located _____

Sketch markings of Bearing Trees (or Rocks) in proper box and fill blanks below, giving bearings from Corner to Trees and Distances in Links.

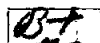
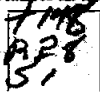

Species ASD Ash

Diameter 14" 14"

Bearing S38°E S77W

Distance 58 96

Do you believe this to be a genuine Land Office Corner? _____

If not, why? _____

(Signature)

(Date)

(Title)

129

Corner again.

Give any further facts which will aid in finding this chain distant.

from which this Corner bears

side of

tree inches diameter, on the

Metal Location Poster is on a

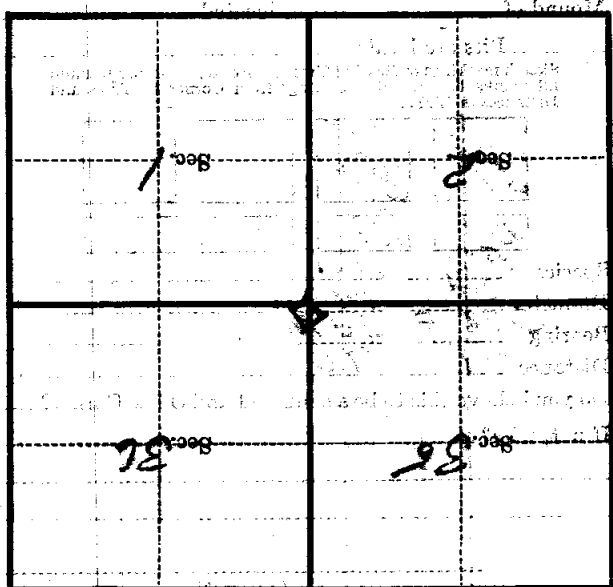

(Make sketch of topography near Corner)