

Form 874-B—Revised May, 1918  
**U. S. Department of Agriculture**  
**FOREST SERVICE**

*AD*  
*posted*

NATIONAL FOREST

**CORNERS OF THE PUBLIC SURVEY**

T. 149 + 148 R. 28 Mer. 5

Section Corner common to Sections

5, 6, 31, and 32

Corner consists of a \_\_\_\_\_ (not) in place

State condition THIS FOR STD. COR. NOT C.C.

Dimensions above ground \_\_\_\_\_ inches

Sketch grooves, letters, figures, or notches, on proper face or edge.

CARDINAL POSITION

DIAGONAL POSITION

--	--	--	--

N W S E

--	--	--	--

NW SW SE NE

Mound of \_\_\_\_\_ is located \_\_\_\_\_

Pits are located \_\_\_\_\_

Sketch markings of Bearing Trees (or Rocks) in proper box and fill blanks below, giving bearings from Corner to Trees and Distances in Links.

	<i>16</i>	<i>illegible</i>	
	<i>07</i>	<i>07</i>	

Species Red Oak Stump

Diameter 12" 16"

Bearing SW

Distance \_\_\_\_\_

Do you believe this to be a genuine Land Office Corner? Yes

If not, why? \_\_\_\_\_

*Karl L. Huber*

(Signature)

1-13-34

(Date)

*By \_\_\_\_\_*

(Title)

at corner East side  
pole on East side  
road near ditch

X = B.T.O.

Corner again.

Give any further facts which will aid in finding this

chains distant.

from which this Corner bears

NE

side of

pole

tree inches diameter, on the W

Metal Location Poster is on a telephone pole

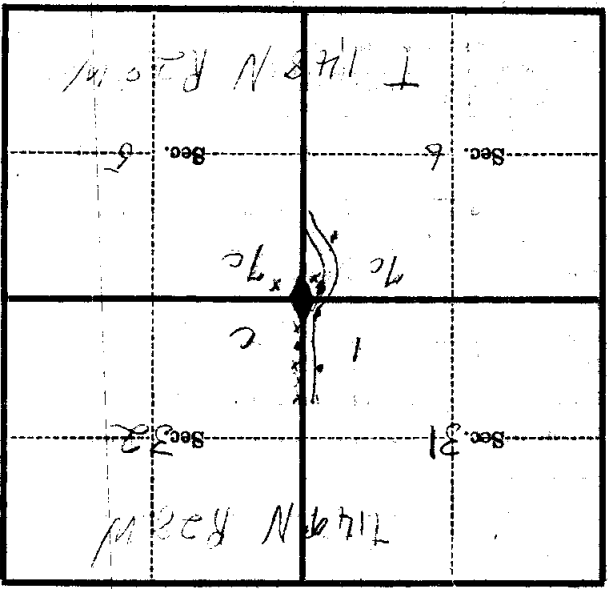

(Make sketch of topography near Corner)

T. 148 N R. 20 W Mer.

U. S. Department of Agriculture

FOREST SERVICE

A-5

NATIONAL FOREST

CORNERS OF THE PUBLIC SURVEY

T. 122 R. 12 Mer.

Corner common to Sections

31, 32, 6, and 7

Corner consists of a Iron (not) in place

State condition Fair

Dimensions above ground 47 1/2 inches

Sketch grooves, letters, figures, or notches, on proper face or edge.

CARDINAL POSITION

DIAGONAL POSITION

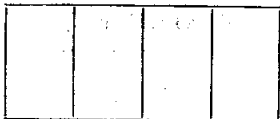

N W S E

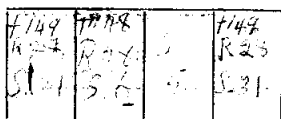

NW SW SE NE

Mound of \_\_\_\_\_ is located \_\_\_\_\_

Pits are located \_\_\_\_\_

Sketch markings of Bearing Trees (or Rocks) in proper box and fill blanks below, giving bearings from Corner to Trees and Distances in Links.

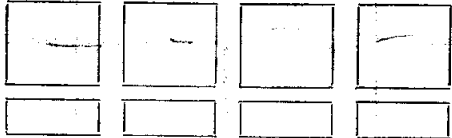

Species \_\_\_\_\_

Diameter \_\_\_\_\_

Bearing \_\_\_\_\_

Distance \_\_\_\_\_

Do you believe this to be a genuine Land Office Corner? Yes

If not, why? \_\_\_\_\_

\_\_\_\_\_

\_\_\_\_\_

F. J. M. E. T. (Signature)

\_\_\_\_\_ (Title)

\_\_\_\_\_ (Date)

Handwritten notes on a series of horizontal lines.

Corner again.

Give any further facts which will aid in finding this

chains distant.

from which this Corner bears

side of

tree inches diameter, on the

Metal Location Poster is on a

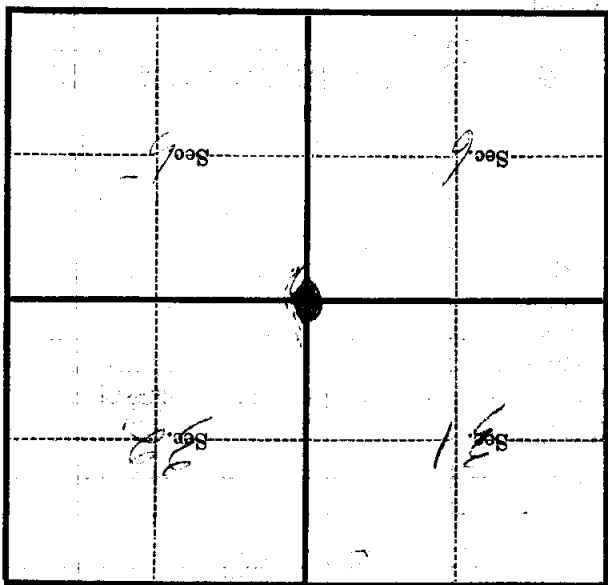

(Make sketch of topography near Corner)

T. R. Mer.