

U. S. Department of Agriculture

FOREST SERVICE

E 1

posted

Chippewa NATIONAL FOREST

CORNERS OF THE PUBLIC SURVEY

T. 145 R. 29/35 Mer.

Sec. Corner common to Sections
1, 12, 6, and 7

Corner consists of a _____ (not) in place
State condition _____

Dimensions above ground _____ inches

Sketch grooves, letters, figures, or notches, on proper face or edge.

CARDINAL POSITION

DIAGONAL POSITION

--	--	--	--

N W S E

--	--	--	--

NW SW SE NE

Mound of _____ is located _____

Pits are located _____

Sketch markings of Bearing Trees (or Rocks) in proper box and fill blanks below, giving bearings from Corner to Trees and Distances in Links.

<u>S 77</u>	<u>10</u>	<u>S 6</u>	
<u>B.T</u>	<u>10</u>	<u>10</u>	

Species Tax. spruce Cedar

Diameter 6 10 14

Bearing S 40 W N 41 W N 37 E

Distance 107 98 100

Do you believe this to be a genuine Land Office Corner? Yes

If not, why? _____

(Signature)

(Date)

(Title)

Jan. 24 - 1934

Arthur W. Johnson
Surveyor

Metal Location Poster is on a *Palmer* tree *5 ft.* inches diameter, on the side of *Range 12* from which this Corner bears *N 65° W* *106* chains distant.

Give any further facts which will aid in finding this Corner again.

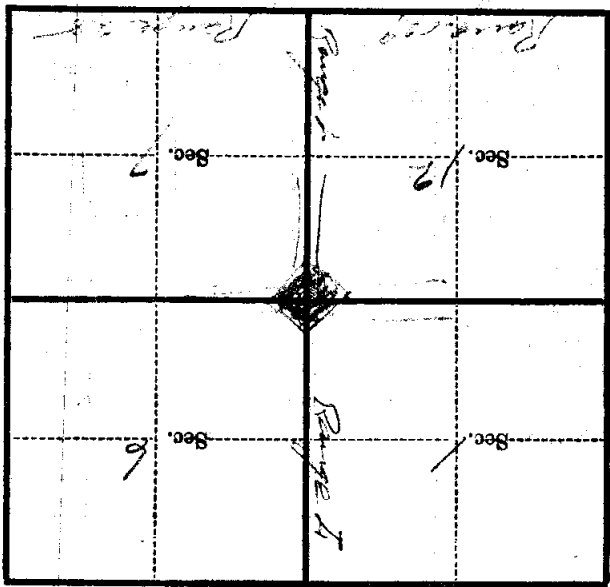

(Make sketch of topography near Corner)

T. 148 R. 28 S. Mer.