

U. S. Department of Agriculture

FOREST SERVICE

J 1

posted

Chippewa

NATIONAL FOREST

CORNERS OF THE PUBLIC SURVEY

T. 148 R. 29/28 5 Mer.

Corner common to Sections 7, 18, 12, and 13

Corner consists of a (not) in place State condition

Dimensions above ground inches Sketch grooves, letters, figures, or notches, on proper face or edge.

CARDINAL POSITION

DIAGONAL POSITION



N W S E



NW SW SE NE

Mound of is located

Pits are located

Sketch markings of Bearing Trees (or Rocks) in proper box and fill blanks below, giving bearings from Corner to Trees and Distances in Links.

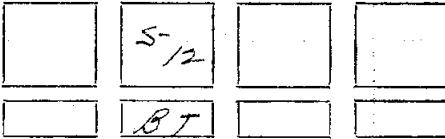

Species T. PINE

Diameter 7"

Bearing N 85° W

Distance 0.57

Do you believe this to be a genuine Land Office Corner? No

If not, why? Set by Privatized by Deputy Co. Surveyor

Handwritten signature of Fred W. Johnson

(Signature)

Jan. 25 - 1931

(Date)

Surveyor

(Title)

J-1

Corner again.
AT P. 110 7' N 85° W 10.57
Center corner to
Road N.E. 1/4

Metal Location Poster is on a *11.11.11* side of *Road* from which this Corner bears *55* chains distant.
Give any further facts which will aid in finding this

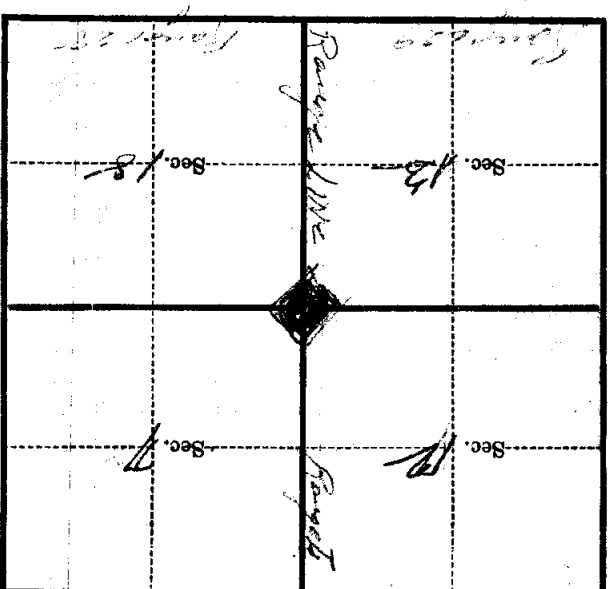

(Make sketch of topography near Corner)

T. 148 R. 25 Mer. 5

U. S. Department of Agriculture
FOREST SERVICE

J-1

Chippewa NATIONAL FOREST

CORNERS OF THE PUBLIC SURVEY

T. 142N R. 28-29W 511 - Mer.

Sec - 5 Corner common to Sections
12, 7, 13, and 18

Corner consists of a stone (not) in place

State condition New

Dimensions above ground Covered by Road Bed inches
Sketch grooves, letters, figures, or notches, on proper face or edge.

CARDINAL POSITION

DIAGONAL POSITION

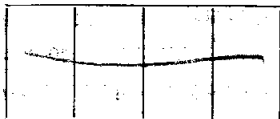

N W S E



NW SW SE NE

Mound of stone is located at

Pits are located at

Sketch markings of Bearing Trees (or Rocks) in proper box and fill blanks below, giving bearings from Corner to Trees and Distances in Links.

S-12
REY

BT

Species J. Pine

Diameter 21

Bearing N-75°W

Distance 60

Do you believe this to be a genuine Land Office Corner? No

If not, why? Corner B.T. scribed
by County Surveyor

Balke

(Signature)

Leahy

(Date)

(Title)

Corner is located in
Center of Road-Belt
About the chain North of
old Road - Running West-

Corner again.

Give any further facts which will aid in finding this

chains distant.

From which this Corner bears

side of

tree inches diameter, on the

Metal Location Poster is on a

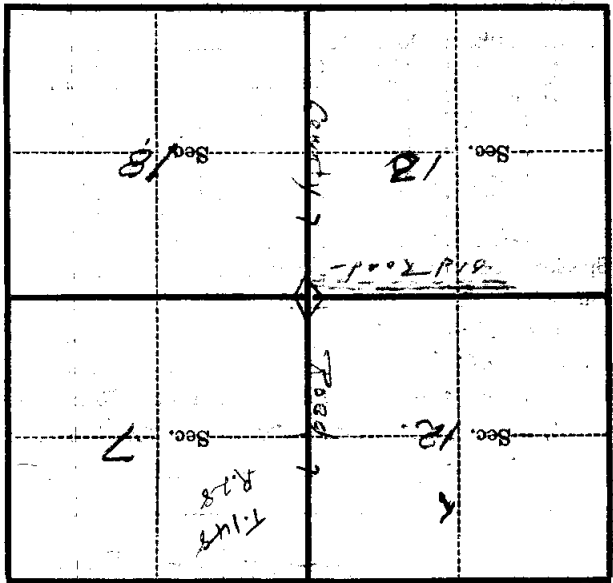

(Make sketch of topography near Corner)

T. 148 N. R. 28 W. 5th Mer.

U. S. Department of Agriculture
FOREST SERVICE

J-1

Chippewa NATIONAL FOREST
CORNERS OF THE PUBLIC SURVEY

T. 148 R. 28 5th Mer.

Sec. Corner common to Sections
12, 7, 13, and 18

Corner consists of a Aspen ^(is NOT in place)

State condition New

Dimensions above ground covered by dead inches
Sketch grooves, letters, figures, or notches, on proper face or edge.

CARDINAL POSITION

DIAGONAL POSITION

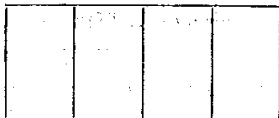

N W S E

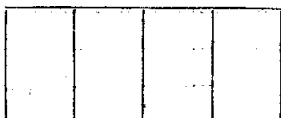

NW SW SE NE

Mound of _____ is located _____

Pits are located _____

Sketch markings of Bearing Trees (or Rocks) in proper box and fill blanks below, giving bearings from Corner to Trees and Distances in Links.

S-12 R-29			
B.T.			

Species 2 PINE

Diameter 8"

Bearing N. 75° W

Distance 60

Do you believe this to be a genuine Land Office Corner? No

If not, why? by county surveyor

B. alba
(Signature)

Leader
(Title)

(Date)

.....
.....
.....
.....
.....
.....
.....
.....

CENTER OF ROAD BED

Corner again.

Give any further facts which will aid in finding this
chains distant.
from which this Corner bears
side of
tree inches diameter, on the
Metal Location Poster is on a

	Sec. 13	
Sec. 12		
	Sec. 12	
Sec. 7		

T. 148
R. 28
S. 29

(Make sketch of topography near Corner)

T. 148 R. 28 S. 29 Mer.

U. S. Department of Agriculture
FOREST SERVICE

J-1

Chippewa NATIONAL FOREST

CORNERS OF THE PUBLIC SURVEY

T. 148 R. 28 S. 5 Mer.

Sec. _____ Corner common to Sections
12, 7, 13, and 19

Corner consists of a Aspen ~~is~~ IS NOT IN (not) in place

State condition None

Dimensions above ground Covered by Road inches

Sketch grooves, letters, figures, or notches, on proper face or edge.

CARDINAL POSITION

DIAGONAL POSITION

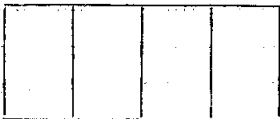
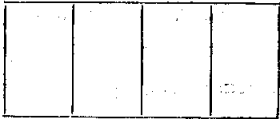

N W S E

NW SW SE NE

Mound of _____ is located _____

Pits are located _____

Sketch markings of Bearing Trees (or Rocks) in proper box and fill blanks below, giving bearings from Corner to Trees and Distances in Links.

S-12
N-14

B.T.

Species SPINE

Diameter _____

Bearing N. 70° W.

Distance 160

Do you believe this to be a genuine Land Office Corner? NO

If not, why? BY COUNTY SURVEYOR

[Signature]

(Signature)

(Date)

(Title)

[Faint, illegible handwriting on ruled lines]

CENTER OF ROAD BED

Corner again.

Give any further facts which will aid in finding this
chains distant.
from which this Corner bears
side of
tree inches diameter, on the
Metal Location Poster is on a

<p>Sec. 14</p>	<p>Sec.</p>	<p>13</p>	<p>Sec.</p>
<p>Sec. 14</p>	<p>Sec.</p> <p>1100</p>	<p>12</p>	<p>Sec.</p>

(Make sketch of topography near Corner)

T. 143 R. 29
Mer. 5.24