

U. S. Department of Agriculture
FOREST SERVICE

R-17

Chippewa NATIONAL FOREST

CORNERS OF THE PUBLIC SURVEY

T. 14 N R. 27 W S. 5th Mer.

Section Corner common to Sections
22, 23, 27, and 28

Corner consists of a Post (not) in place
State condition Very poor

Dimensions above ground 130 inches

Sketch grooves, letters, figures, or notches, on proper face or edge.

CARDINAL POSITION

DIAGONAL POSITION

<u>Unreadable</u>			
N	W	S	E

NW	SW	SE	NE
----	----	----	----

Mound of _____ is located _____

Pits are located _____

Sketch markings of Bearing Trees (or Rocks) in proper box and fill blanks below, giving bearings from Corner to Trees and Distances in Links.

<u>None</u>	<u>Found</u>		

Species _____

Diameter _____

Bearing _____

Distance _____

Do you believe this to be a genuine Land Office Corner? Yes

If not, why? _____

Re Nelson

(Signature)

2-7-35

(Date)

(Title)

Corner again.

Give any further facts which will aid in finding this

from which this Corner bears ~~301~~ 301

South

side of ~~301~~ 301

6 inches diameter, on the ~~west~~ ^{west} side

Metal Location Poster is on a ~~wooden post~~ wooden post

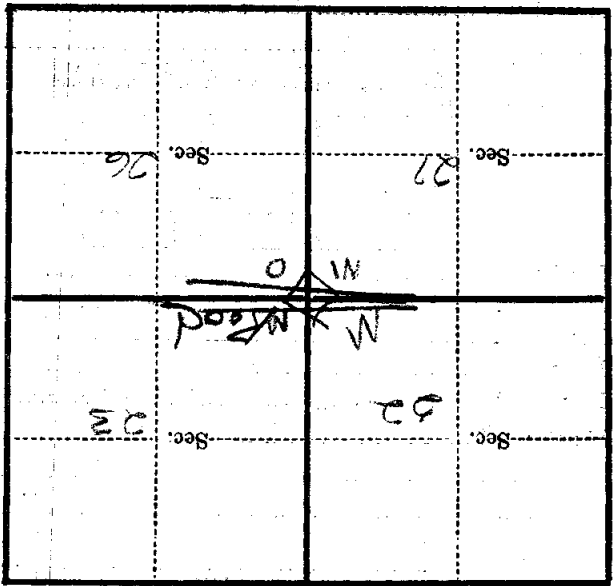

(Make sketch of topography near Corner)

T. 148 N. R. 27 W. S. 5

R17

U. S. Department of Agriculture

FOREST SERVICE

Posted

Chippewa Acq. NATIONAL FOREST

CORNERS OF THE PUBLIC SURVEY

T. 148 N R. 27 W 5th Mer.
 section Corner common to Sections
22, 23, 27, and 26

Corner consists of a post (not) in place
 State condition Very poor.

Dimensions above ground 30 inches
 Sketch grooves, letters, figures, or notches, on proper face or edge.

CARDINAL POSITION

DIAGONAL POSITION

unreadable			
N	W	S	E

NW	SW	SE	NE

Mound of _____ is located _____

Pits are located _____

Sketch markings of Bearing Trees (or Rocks) in proper box and fill blanks below, giving bearings from Corner to Trees and Distances in Links.

None found			

Species _____
 Diameter _____
 Bearing _____
 Distance _____

Do you believe this to be a genuine Land Office Corner? **Yes**

If not, why? _____

Roy Wilson
 (Signature)

2/7/35
 (Date)

Chief of party CCC
 (Title)

Metal Location Poster is on a **regular post** tree 6 inches diameter, on the **south** side of **road** from which this Corner bears **south** 0.30 chains distant.

Give any further facts which will aid in finding this Corner again.

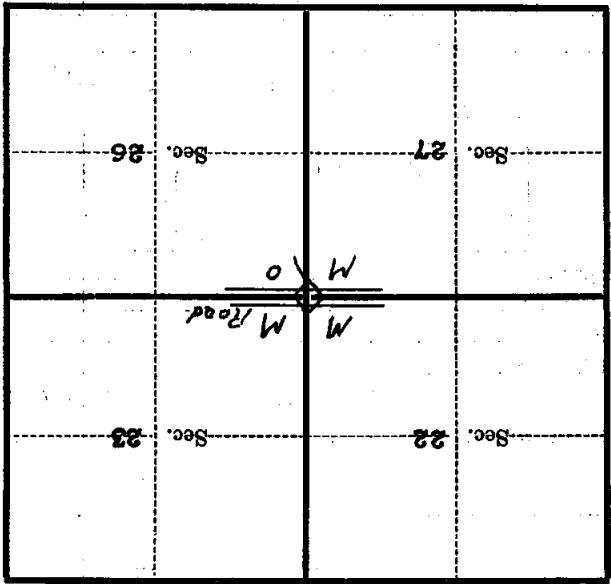

(Make sketch of topography near Corner)

T. 148 N. R. 27 W. 5th Mer.

R-17