

U. S. Department of Agriculture  
FOREST SERVICE

2-17  
~~AA~~

..... NATIONAL FOREST

CORNERS OF THE PUBLIC SURVEY

T. 44 N R. 20 W Mer. 5th

..... Corner common to Sections  
....., 3, and 2

Corner consists of a Post (not) in place  
State condition P.

Dimensions above ground 2 1/2" inches  
Sketch grooves, letters, figures, or notches, on proper face or edge.

CARDINAL POSITION

DIAGONAL POSITION

--	--	--	--

--	--	--	--

N W S E

NW SW SE NE

Mound of ..... is located .....

..... Pits are located .....

Sketch markings of Bearing Trees (or Rocks) in proper box and fill blanks below, giving bearings from Corner to Trees and Distances in Links.

Species .....

Diameter .....

Bearing .....

Distance .....

Do you believe this to be a genuine Land Office Corner? Yes

If not, why? .....

.....

.....

.....

.....

8/9/35  
(Date)

.....  
(Signature)  
CCS. H. ...  
(Title)

Corner again.  
Blazed like Run 7170  
East 9 West 215 215 215 215 215 215

Give any further facts which will aid in finding this  
18 lines, chains distant.  
From which this Corner bears  $562^{\circ}30'W$   
side of Tree  
tree 8 inches diameter, on the South East  
Metal Location Poster is on a Bluff

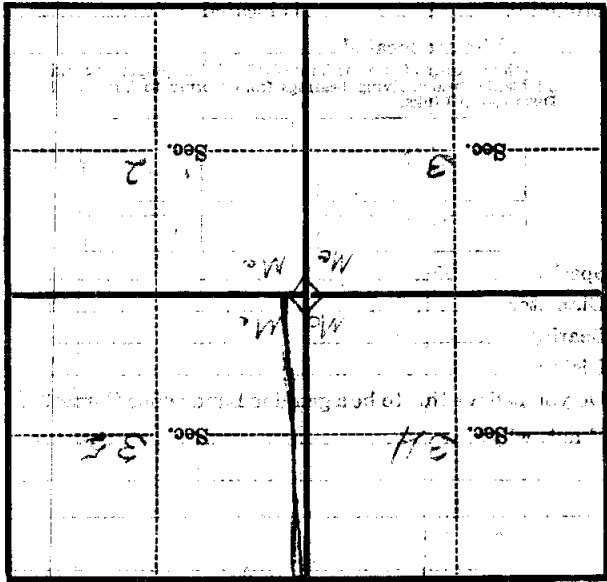

(Make sketch of topography near Corner)

T. 118 N. R. 27 W. S. 14 Mer.