

U. S. Department of Agriculture

FOREST SERVICE

Chippewa NATIONAL FOREST

V-13

CORNERS OF THE PUBLIC SURVEY

T. 148 R. 27 5th Mer.

Section Corner common to Sections 28, 29, 34, and 33

Corner consists of a Placed by (not) in place

State condition Linear Crown

Dimensions above ground inches

Sketch grooves, letters, figures, or notches, on proper face or edge.

CARDINAL POSITION

DIAGONAL POSITION

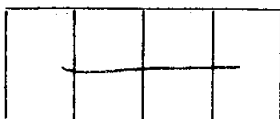

N W S E

NW SW SE NE

Mound of is located

Pits are located

Sketch markings of Bearing Trees (or Rocks) in proper box and fill blanks below, giving bearings from Corner to Trees and Distances in Links.

Table with 2 rows and 4 columns for sketching bearing trees and rocks.

Species Tain

Diameter 8"

Bearing North

Distance 1550

Do you believe this to be a genuine Land Office Corner? Yes

If not, why?

Handwritten signature

(Signature)

3/20/35

(Date)

Handwritten title

(Title)

Department of Agriculture

Forest Service

GENERAL LOCATION POSTER

CORNERS OF THE PUBLIC SURVEY

Corner of Section 22, Township 10N, Range 10E, Meridian 10W, is located at the intersection of the north-south line of Section 22 and the east-west line of Township 10N, Range 10E, Meridian 10W.

Corner of Section 23, Township 10N, Range 10E, Meridian 10W, is located at the intersection of the north-south line of Section 23 and the east-west line of Township 10N, Range 10E, Meridian 10W.

From which this Corner bears side of _____ tree _____ inches diameter, on the _____ Metal Location Poster is on a _____ chains distant.

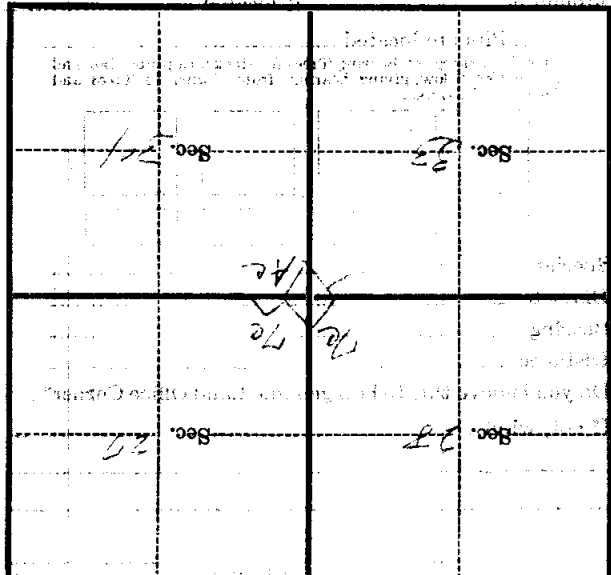

(Make sketch of topography near Corner)

Form 874-9—Revised May, 1918
 U. S. Department of Agriculture
 FOREST SERVICE

*Copied
 Posted
 7/36
 V13*

----- NATIONAL FOREST
CORNERS OF THE PUBLIC SURVEY

T. 148 R. 27 5 Mer.

----- Corner common to Sections
27, 28, 33 and 34
 -----, and
 Corner consists of a 3" stake new (not) in place

State condition -----

Dimensions above ground ----- inches

Sketch grooves, letters, figures, or notches, on proper face or edge.

CARDINAL POSITION

DIAGONAL POSITION

--	--	--	--

N W S E

--	--	--	--

NW SW SE NE

Mound of ----- is located -----

----- Pits are located -----

Sketch markings of Bearing Trees (or Rocks) in proper box and fill blanks below, giving bearings from Corner to Trees and Distances in Links.

Species -----

Diameter -----

Bearing -----

Distance -----

Do you believe this to be a genuine Land Office Corner? -----

If not, why? -----

 (Signature)

 (Date)

 (Title)

Metal Location Poster is on a _____ inches diameter, on the _____ side of _____ from which this Corner bears _____ chains distant.

Give any further facts which will aid in finding this Corner again.

6" tam, dead N 2- E 60 ft scribed
 a pruce down S 70- E 50 ft marks
 not read able
 10" tam stub N 3- W 60 ft
 8" tam stump N 363 - W 70 ft scribed
 B J

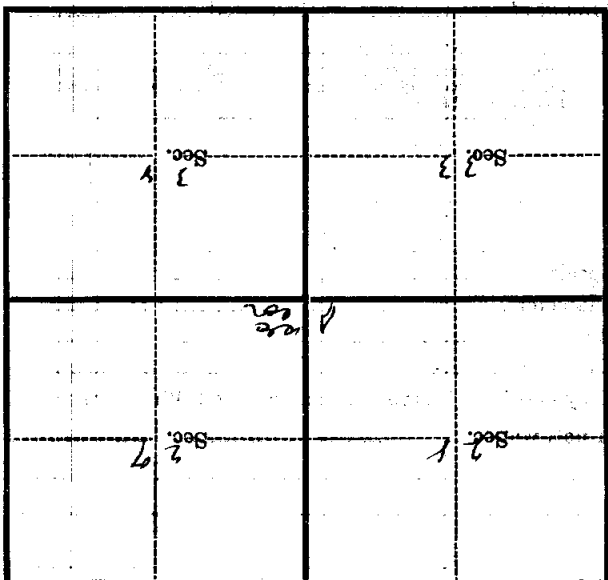

(Make sketch of topography near Corner)

T. R. Mer.