

Form 874-0—Revised May, 1918
U. S. Department of Agriculture
FOREST SERVICE

R-9, 10

Chippewa NATIONAL FOREST

CORNERS OF THE PUBLIC SURVEY

T. 148 N R. 26 W 5th Mer.

MC Corner common to Sections
21, and 28

Corner consists of a Aspen Stake (not) in place
State condition Temporary Stake

Dimensions above ground 1 1/2" x 1 1/2" x 2' inches

Sketch grooves, letters, figures, or notches, on proper face or edge.

CARDINAL POSITION

DIAGONAL POSITION

--	--	--	--

N W S E

--	--	--	--

NW SW SE NE

Mound of _____ is located _____

Pits are located _____

Sketch markings of Bearing Trees (or Rocks) in proper box and fill blanks below, giving bearings from Corner to Trees and Distances in Links.

R26 S.28			

Species W. Pine

Diameter 18"

Bearing S 17° W

Distance 26 Lks.

Do you believe this to be a genuine Land Office Corner? ?

If not, why? Corner not in place by old G.O. notes. B.T. (W. Pine) an old G.O. B.T.

Herbert Norman

(Signature)

Nov. 27, 1934

(Date)

Tech Foreman

(Title)

Metal Location Poster is on a _____
 tree _____ inches diameter, on the _____
 side of _____
 from which this Corner bears _____
 chains distant.

Give any further facts which will aid in finding this
 Corner again.

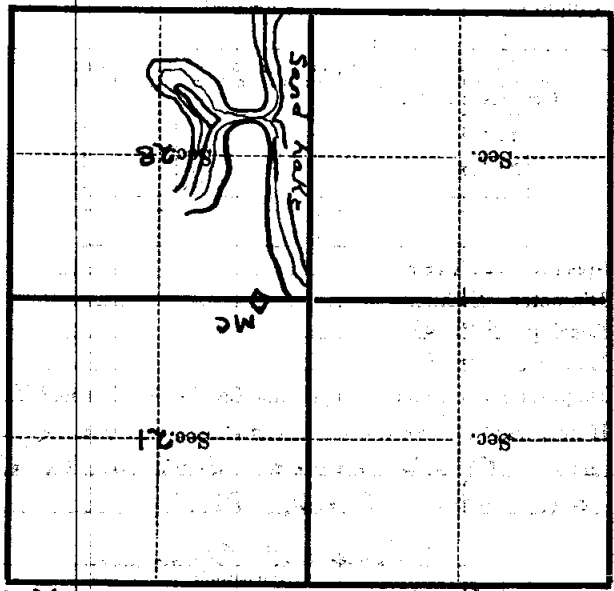

(Make sketch of topography near Corner)

Mer. R-9,10

574

R. 26 W

T. 148 N

U. S. Department of Agriculture

FOREST SERVICE

Chippewa National Forest

CORNERS OF THE PUBLIC SURVEY

T. 148N R. 26W 5th Mer. MC
Corner common to Sections 21, and 28

Corner consists of a *Response* (not) in place

State condition *Response* *Temporary stake*
Dimensions above ground $1\frac{1}{2} \times 1\frac{1}{2} \times 2$ inches

Sketch grooves, letters, figures, or notches, on proper face or edge.

CARDINAL POSITION				DIAGONAL POSITION			
N	W	S	E	NE	SE	SW	NW

Mound of _____ is located

Pits are located
Sketch markings of Bearing Trees (or Rocks) in proper box and
All blanks below, giving bearings from Corner to Trees and
Distances in Links.

28	5	28	
26	5	28	

Species *White Pine*
Diameter *1 1/2*
Bearing *W 17.5*
Distance *26 Link*

Do you believe this to be a genuine Land Office Corner?
If not, why? *Can't say not in place by old*

670 notes, B.T. (White Pine) and old
670 B.T.

Johnston
Nov. 27, 1934
(Date)
J. Ch. Foreman
(Title)

R-9/10

ASN R. 26 W
(Make sketch of topography near Corner)

R-4

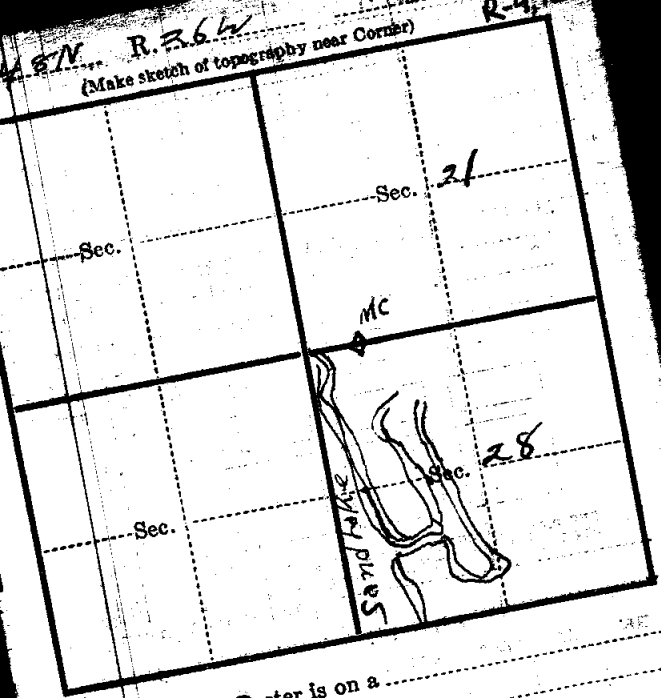

Metal Location Poster is on a
 tree _____ inches diameter, on the
 side of _____
 from which this Corner bears _____
 _____ chains distant.

Give any further facts which will aid in finding this
 Corner again.

U. S. Department of Agriculture
FOREST SERVICE

R 9-10

Chippewa NATIONAL FOREST

CORNERS OF THE PUBLIC SURVEY

T. 148 N. R. 26 W. 5th Mer.

MC Corner common to Sections

21, and 28

Corner consists of a Aspen stake (not) in place

State condition Temporary stake

Dimensions above ground $1\frac{1}{2}'' \times 1\frac{1}{2}'' \times 2''$ inches

Sketch grooves, letters, figures, or notches, on proper face or edge.

CARDINAL POSITION

DIAGONAL POSITION

--	--	--	--

N W S E

--	--	--	--

NW SW SE NE

Mound of _____ is located _____

Pits are located _____

Sketch markings of Bearing Trees (or Rocks) in proper box and fill blanks below, giving bearings from Corner to Trees and Distances in Links.

R 26 S 28			

Species White pine

Diameter 18"

Bearing W 17° S

Distance 26 link

Do you believe this to be a genuine Land Office Corner?

If not, why Corner not in place by old GLO

notes. Bearing trees (white pine) an old

GLO BT

Herbert Norman
(Signature)

Nov. 27, 1934
(Date)

TECH. Forman
(Title)

Corner again.

Give any further facts which will aid in finding this
 ----- chains distant.
 ----- from which this Corner bears
 ----- side of
 ----- tree ----- inches diameter, on the
 ----- Metal Location Poster is on a

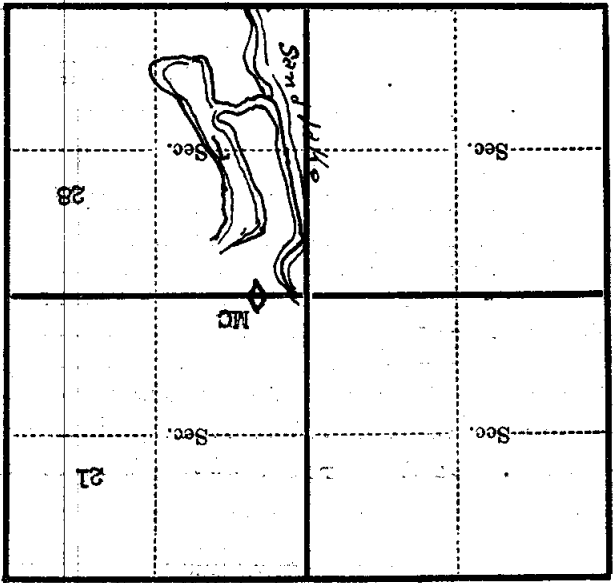

(Make sketch of topography near Corner)