

U. S. Department of Agriculture  
FOREST SERVICE

E 24

Posted

Chippewa NATIONAL FOREST

CORNERS OF THE PUBLIC SURVEY

T. 148N R. 26W 15th Mer.

E 1/16 Corner common to Sections  
12, and 1

Corner consists of a \_\_\_\_\_ (not) in place  
State condition \_\_\_\_\_

Dimensions above ground \_\_\_\_\_ inches

Sketch grooves, letters, figures, or notches, on proper face or edge.

CARDINAL POSITION

DIAGONAL POSITION

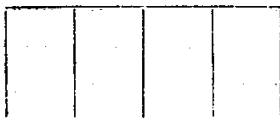
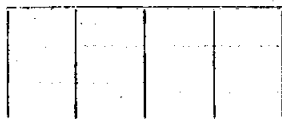

Mound of \_\_\_\_\_ is located \_\_\_\_\_

Pits are located \_\_\_\_\_

Sketch markings of Bearing Trees (or Rocks) in proper box and fill blanks below, giving bearings from Corner to Trees and Distances in Links.



Species White pine

Diameter 12 in chs

Bearing Due west

Distance 42 links

Do you believe this to be a genuine Land Office Corner?   ?

If not, why? \_\_\_\_\_

Herbert Norman  
(Signature)

Tech. Foreman  
(Title)

Sept. 1934  
(Date)

Corner again.  
 Take road to E  $\frac{1}{4}$  corner  
 S 12. Travel 70 ch. N. at  
 No. 6° 30' and 80 ch. W. at  
 No. of 6° 30'.

Metal Location Poster is on a  
 tree ..... inches diameter, on the  
 side of .....  
 from which this Corner bears  
 ..... chains distant.  
 Give any further facts which will aid in finding this

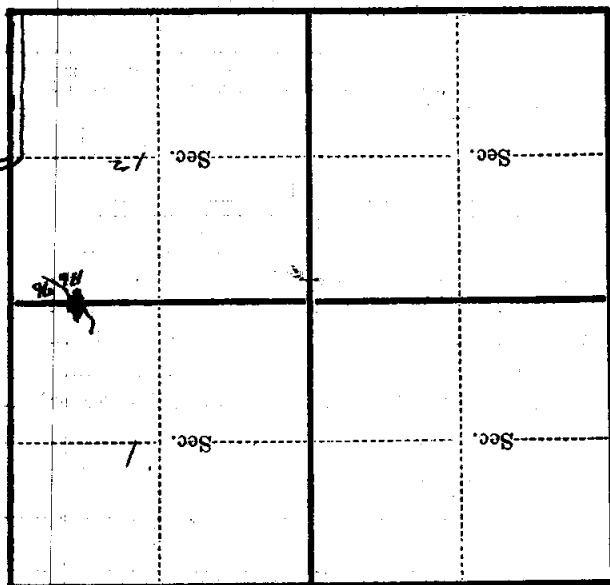

(Make sketch of topography near Corner)

T. 148 N. R. 26 W. N. 7. 5 1/4 Mer. E-24