

U. S. Department of Agriculture
FOREST SERVICE

Posted

517

Chippewa NATIONAL FOREST
CORNERS OF THE PUBLIC SURVEY

T. 148 N R. 26 W Fifth Mer.

Section 10 Corner common to Sections

10, 11, 14, and 15
Corner consists of a in road ^{Exact position not known} (not) in place

State condition Taken at center of crossroads

Dimensions above ground _____ inches

Sketch grooves, letters, figures, or notches, on proper face or edge.

CARDINAL POSITION

DIAGONAL POSITION

--	--	--	--

N W S E

--	--	--	--

NW SW SE NE

Mound of _____ is located _____

Pits are located _____

Sketch markings of Bearing Trees (or Rocks) in proper box and fill blanks below, giving bearings from Corner to Trees and Distances in Links.

	T 148 N R 26 W S 15		
	BT		

Species Ask

Diameter 12 inches

Bearing S 32 1/2° W (Taken from center of

Distance 133 links crossroads)

Do you believe this to be a genuine Land Office Corner? yes

If not, why? _____

Herbert Norman

(Signature)

Tech. Foreman

(Title)

Sept. 24 1934

(Date)

Corner again.
Take corner of Road B to
SW corner of Sec. 11

Give any further facts which will aid in finding this
chains distant.

from which this Corner bears S. 31 1/2° W
side of post

tree inches diameter, on the S.W.
Metal Location Poster is on a telephone post

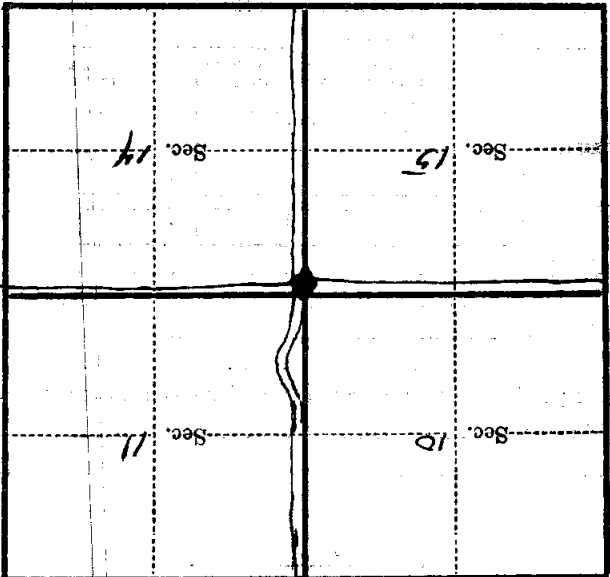

(Make sketch of topography near Corner)

T. 148 N. R. 26 W. E. 5th Mer. 5-11