

U. S. Department of Agriculture
FOREST SERVICE

Costed C9

CHIPPEWA

NATIONAL FOREST

CORNERS OF THE PUBLIC SURVEY

T. 148N R. 25W 5 Mer.

$\frac{1}{4}$ Corner common to Sections 4 and 5

Corner consists of a 1 1/2 Fe Pipe in place

State condition Good

Dimensions above ground 16 Inches

Sketch grooves, letters, figures, or notches, on proper face or edge.

CARDINAL POSITION

DIAGONAL POSITION

--	--	--	--

N W S E

--	--	--	--

NW SW SE NE

Mound of _____ is located _____

Pits are located _____

Sketch markings of Bearing Trees (or Rocks) in proper box and fill blanks below, giving bearings from Corner to Trees and Distances in Links.

Species _____

Diameter _____

Bearing _____

Distance _____

Do you believe this to be a genuine Land Office Corner? **No**

If not, why? **Corner set by County Engineers.**

Larson

(Signature)

CCC Enrollee

(Title)

3-9-35

(Date)

Iron pipe in ditch on east side of road on top of hill

Corner again.

Give any further facts which will aid in finding this

chains distant.

0.81

from which this Corner bears

N48E

side of

Pole

10 inches diameter, on the

N

Metal Location Poster is on a Telephone Pole

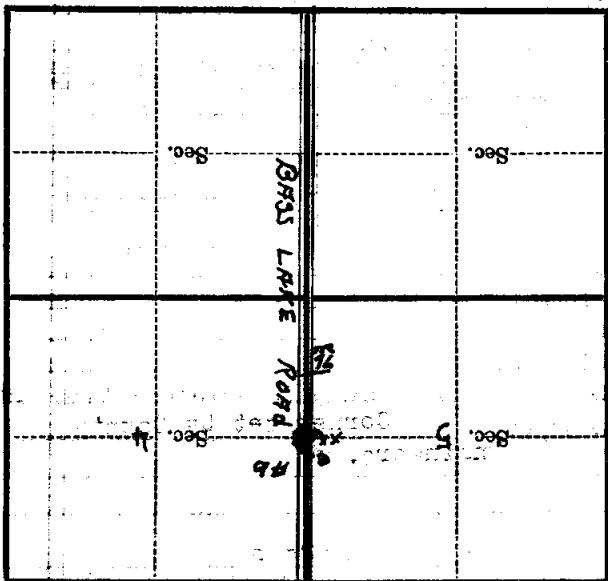

(Make sketch of topography near Corner)

5 Mer.

R. 25N

T. 148N

U. S. Department of Agriculture
FOREST SERVICE

C-9

GREYHAWK

NATIONAL FOREST

CORNERS OF THE PUBLIC SURVEY

T. **14N** R. **21W** S. **5** Mer.

Corner common to Sections **4**, **5**, and **5**

Corner consists of a **1 1/2" Pipe** (not) in place

State condition **Good**

Dimensions above ground **16** inches

Sketch grooves, letters, figures, or notches, on proper face or edge.

CARDINAL POSITION

DIAGONAL POSITION

--	--	--	--

N W S E

--	--	--	--

NW SW SE NE

Mound of _____ is located _____

Pits are located _____

Sketch markings of Bearing Trees (or Rocks) in proper box and fill blanks below, giving bearings from Corner to Trees and Distances in Links.

Species _____

Diameter _____

Bearing _____

Distance _____

Do you believe this to be a genuine Land Office Corner? **No**

If not, why? **Corner set by County Engineers.**

L. Larson

(Signature)

Ed. Harollee

(Date)

(Title)

Iron pipe in block on east side of road on top of hill

Corner again:

Give any further facts which will aid in finding this

chain distant

0.25

from which this Corner bears

N 65° E

side of

100.0

10 inches diameter, on the

N 65° E

Metal Location Poster is on a Telephone Pole

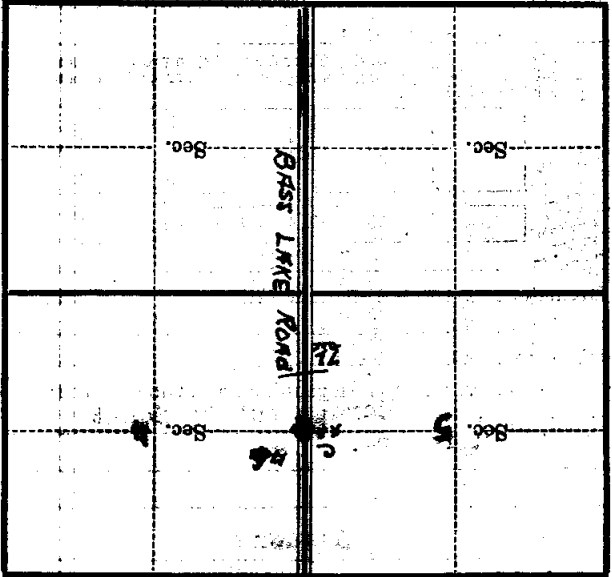

(Make sketch of topography near Corner)

U. S. Department of Agriculture
FOREST SERVICE

0-9

Chippewa NATIONAL FOREST
CORNERS OF THE PUBLIC SURVEY

T. 18 N R. 25 W Mer. 5

----- $\frac{1}{4}$ ----- Corner common to Sections
-----, -----, 4, and 5-----

Corner consists of a $\frac{1}{4}$ " Fe Pipe (not) in placeState condition GoodDimensions above ground 16 inches

Sketch grooves, letters, figures, or notches, on proper face or edge.

CARDINAL POSITION

DIAGONAL POSITION

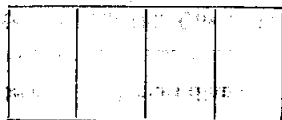

N W S E

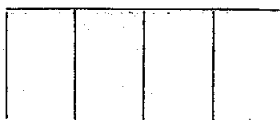

NW SW SE NE

Mound of ----- is located -----

Pits are located -----

Sketch markings of Bearing Trees (or Rocks) in proper box and fill blanks below, giving bearings from Corner to Trees and Distances in Links.

Species -----

Diameter -----

Bearing -----

Distance -----

Do you believe this to be a genuine Land Office Corner? NoIf not, why? Corner set bycounty engineersLarson

(Signature)

7-9-35

(Date)

C.C. Enrollee

(Title)

Iron pipe in ditch on
east side of road on
top of hill

Corner again.

Give any further facts which will aid in finding this

0.81 chains distant.

from which this Corner bears N 88 E

side of pole

10. inches diameter, on the N E

Metal Location Poster is on a Telephone pole

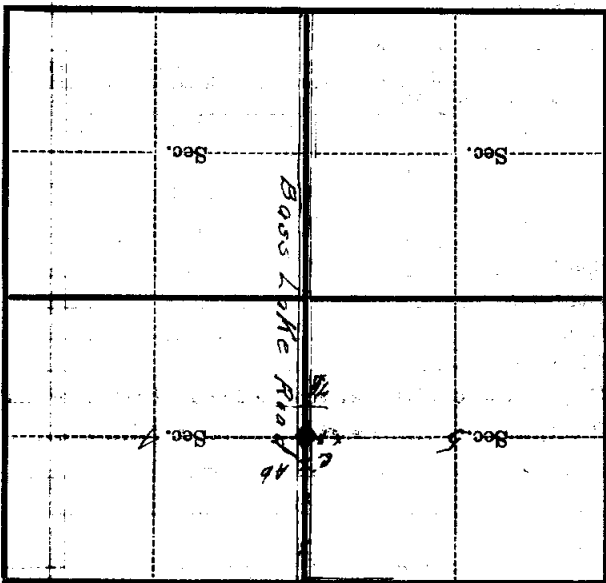

(Make sketch of topography near Corner)

T. 148N. R. 25W. 5 Mer.