

Form 874-9—Revised May, 1918  
 U. S. Department of Agriculture  
 FOREST SERVICE

N-25

Chippewa NATIONAL FOREST

CORNERS OF THE PUBLIC SURVEY

T. 147 N R. 30 W 5th P. Mer.

Section Corner common to Sections  
 13, 24, and 18-19 T147N R29W

Corner consists of an Iron Bar, ~~5/8~~ in place  
 State condition Good

Dimensions above ground 8 inches  
 Sketch grooves, letters, figures, or notches, on proper face or edge.  
 CARDINAL POSITION DIAGONAL POSITION

N	W	S	E

NW	SW	SE	NE

Mound of \_\_\_\_\_ is located \_\_\_\_\_

Pits are located \_\_\_\_\_

Sketch markings of Bearing Trees (or Rocks) in proper box and fill blanks below, giving bearings from Corner to Trees and Distances in Links.

County	B.T.'s		
B.T.	B.T.		

Species Aspen Aspen  
 Diameter 14" 18"  
 Bearing S69°E N75°W  
 Distance 15½ 23½

Do you believe this to be a genuine Land Office Corner? Yes  
 If not, why?

John A. Gjelhaug  
 (Signature)

Jr. Civil Engineer  
 (Title)

2/1/40  
 (Date)

Section 23  
Section 24  
Section 13  
Section 14

Corner again.

Give any further facts which will aid in finding this

chains distant.

0.11

from which this Corner bears

N3°W

side of Tree

tree 4 inches diameter, on the North

Metal Location Poster is on a Aspen

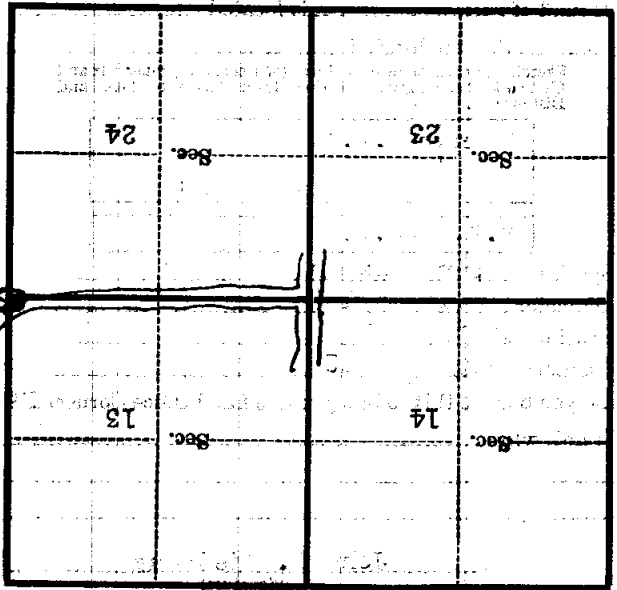

(Make sketch of topography near Corner)

U. S. Department of Agriculture

FOREST SERVICE

N-25

Chippewa NATIONAL FOREST

CORNERS OF THE PUBLIC SURVEY

T. 147 N R. 30 W 5th P. Mer.

Section Corner common to Sections  
15, 24, and 18-19 T147N R29W

Corner consists of an Iron Bar. 1000 in place

State condition Good

Dimensions above ground 8 inches

Sketch grooves, letters, figures, or notches, on proper faces or edge.

CARDINAL POSITION

DIAGONAL POSITION

--	--	--	--

N W S E

--	--	--	--

NW SW SE NE

Mound of \_\_\_\_\_ is located \_\_\_\_\_

Pits are located \_\_\_\_\_

Sketch markings of Bearing Trees (or Rocks) in proper box and fill blanks below, giving bearings from Corner to Trees and Distances in Links.

County	B.T.'s		
B.T.	B.T.		

Species Aspen Aspen

Diameter 14" 18"

Bearing S69°E N75°W

Distance 15 1/2 23 1/2

Do you believe this to be a genuine Land Office Corner? yes

If not, why? \_\_\_\_\_

John A. Gjelhaug  
(Signature)

Jr. Civil Engineer

2/1/40  
(Date)

(Title)

N-25

Metal Location Poster is on a  
 tree 4 inches diameter, on the  
 side of  
 from which this Corner bears  
 0.11 chains distant.  
 Give any further facts which will aid in finding this  
 Corner again.

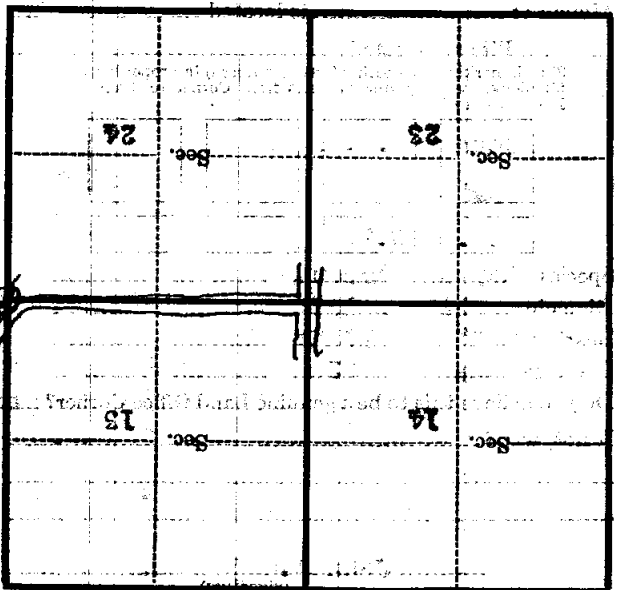

(Make sketch of topography near Corner)