

Form 874-9—Revised May, 1918
U. S. Department of Agriculture
FOREST SERVICE

R-7

NATIONAL FOREST
CORNERS OF THE PUBLIC SURVEY

T. _____ R. _____ Mer.

_____ Corner common to Sections
_____, _____, and _____

Corner consists of a 90 OAK Post (not) in place
State condition Good

Dimensions above ground 28 inches
Sketch grooves, letters, figures, or notches, on proper face or edge.

CARDINAL POSITION

DIAGONAL POSITION

--	--	--	--

N W S E

--	--	--	--

NW SW SE NE

Mound of _____ is located _____

Pits are located _____

Sketch markings of Bearing Trees (or Rocks) in proper box and fill blanks below, giving bearings from Corner to Trees and Distances in Links.

County
BT
S-29

--

--

--

BT

--

--

--

Species E/M

Diameter 10"

Bearing S.80°W.

Distance 32

Do you believe this to be a genuine Land Office Corner? Yes

If not, year _____

(Signature)

(Title)

Corner again.

Give any further facts which will aid in finding this

0.51 chains distant.

from which this Corner bears

side of *Tree*

tree ϕ inches diameter, on the

Metal Location Poster is on a *Map*

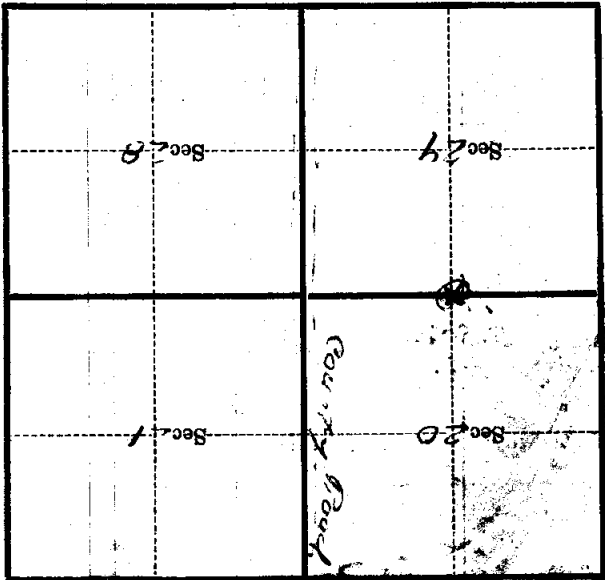

(Make sketch of topography near Corner)

U. S. Department of Agriculture
FOREST SERVICE

2-9

Chippewa NATIONAL FOREST

CORNERS OF THE PUBLIC SURVEY

T. 147 R. 30 5th Mer.

Section Corner common to Sections
20, 21, 28, and 29

Corner consists of a St. L. (not) in place

State condition Good

Dimensions above ground Underground inches
Sketch grooves, letters, figures, or notches, on proper face or edge.

CARDINAL POSITION

DIAGONAL POSITION

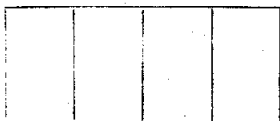
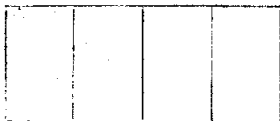

Mound of _____ is located _____

Pits are located _____

Sketch markings of Bearing Trees (or Rocks) in proper box and fill blanks below, giving bearings from Corner to Trees and Distances in Links.

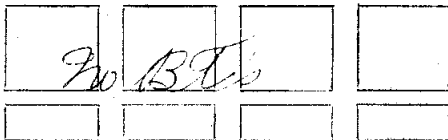

Species _____

Diameter _____

Bearing _____

Distance _____

Do you believe this to be a genuine Land Office Corner? Yes

If not, why? _____

[Signature]
(Signature)

4/29/35
(Date)

(Title)

Corner again.

Give any further facts which will aid in finding this

2.53 chains distant.

from which this Corner bears side of *Hammer*

tree 14 inches diameter, on the *SW* Metal Location Poster is on a *W. P. ...*

	Sec. 28	Sec. 29	
	Sec. 21	Sec. 20	

(Make sketch of topography near Corner)

T. 147 R. 30 Mer. 5-22