

NATIONAL FOREST

CORNERS OF THE PUBLIC SURVEY

T. 1474 R. 3211 Mer. 5

Corner common to Sections 5, 31, 32, 33, 34, 35, 36, 37, 38, 39, 40, 41, 42, 43, 44, 45, 46, 47, 48, 49, 50

Corner consists of a L (not) in place  
State condition 1

Dimensions above ground 1 inches  
Sketch grooves, letters, figures, or notches, on proper face or edge.

CARDINAL POSITION

DIAGONAL POSITION



N W S E

NW SW SE NE

Mound of \_\_\_\_\_ is located \_\_\_\_\_

Pits are located \_\_\_\_\_

Sketch markings of Bearing Trees (or Rocks) in proper box and fill blanks below, giving bearings from Corner to Trees and Distances in Links.

<u>12.7</u>			

Species 12.7

Diameter \_\_\_\_\_

Bearing \_\_\_\_\_

Distance \_\_\_\_\_

Do you believe this to be a genuine Land Office Corner? Yes

If not, why? \_\_\_\_\_

(Signature)

(Date) 2/20/34

(Title) Forester

FOREST SERVICE

Metal Location Poster is on a tree inches diameter, on the side of from which this Corner bears chains distant.

Give any further facts which will aid in finding this Corner again

*Near Turn North on W. from 1/4 corner*

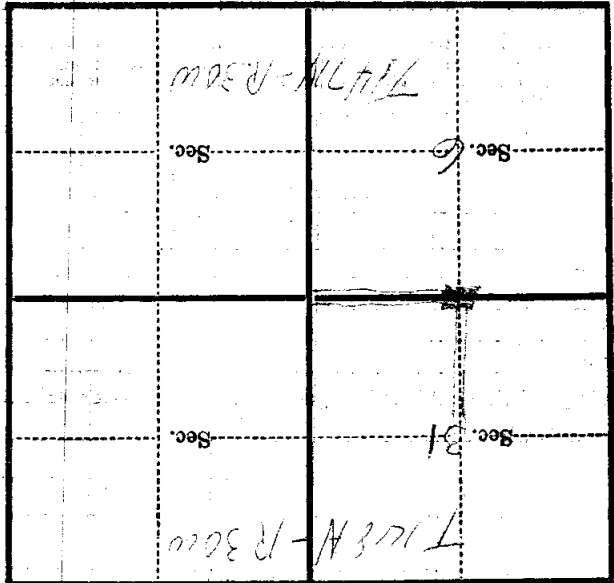

(Make sketch of topography near Corner)

T. 148 N. R. 30 W. Mer.